

NEW MEXICO OIL CONSERVATION COMMISSION  
WELL LOCATION AND ACREAGE DEDICATION PLAT

Form C-102  
Supersedes C-128  
Effective 1-1-65

All distances must be from the outer boundaries of the Section

Operator <b>Cambrian Oil Inc.</b>		Lease <b>Bewitched 12 State Com</b>		Well No. <b>1</b>
Tract Letter <b>I</b>	Section <b>12</b>	Township <b>14 South</b>	Range <b>32 East</b>	County <b>Lea</b>
Actual Fracture Location of Wells: <b>1980</b> feet from the <b>south</b> line and <b>660</b> feet from the <b>east</b> line				
Ground Level Elev. <b>4274.6'</b>	Producing Formation <b>Bough "B" Penn</b>	Foot <b>Baum Upper Penn</b>	Dedicated Acreage <b>160</b>	

- Outline the acreage dedicated to the subject well by colored pencil or hachure marks on the plat below.
- If more than one lease is dedicated to the well, outline each and identify the ownership thereof (both as to working interest and royalty)
- If more than one lease of different ownership is dedicated to the well, have the interests of all owners been consolidated by communitization, unitization, force-pooling, etc?

Yes  No If answer is "yes," type of consolidation Communitization

If answer is "no," list the owners and tract descriptions which have actually been consolidated (Use reverse side of this form if necessary.) \_\_\_\_\_

No allowable will be assigned to the well until all interests have been consolidated (by communitization, unitization, forced-pooling, or otherwise) or until a non-standard unit, eliminating such interests, has been approved by the Commission.

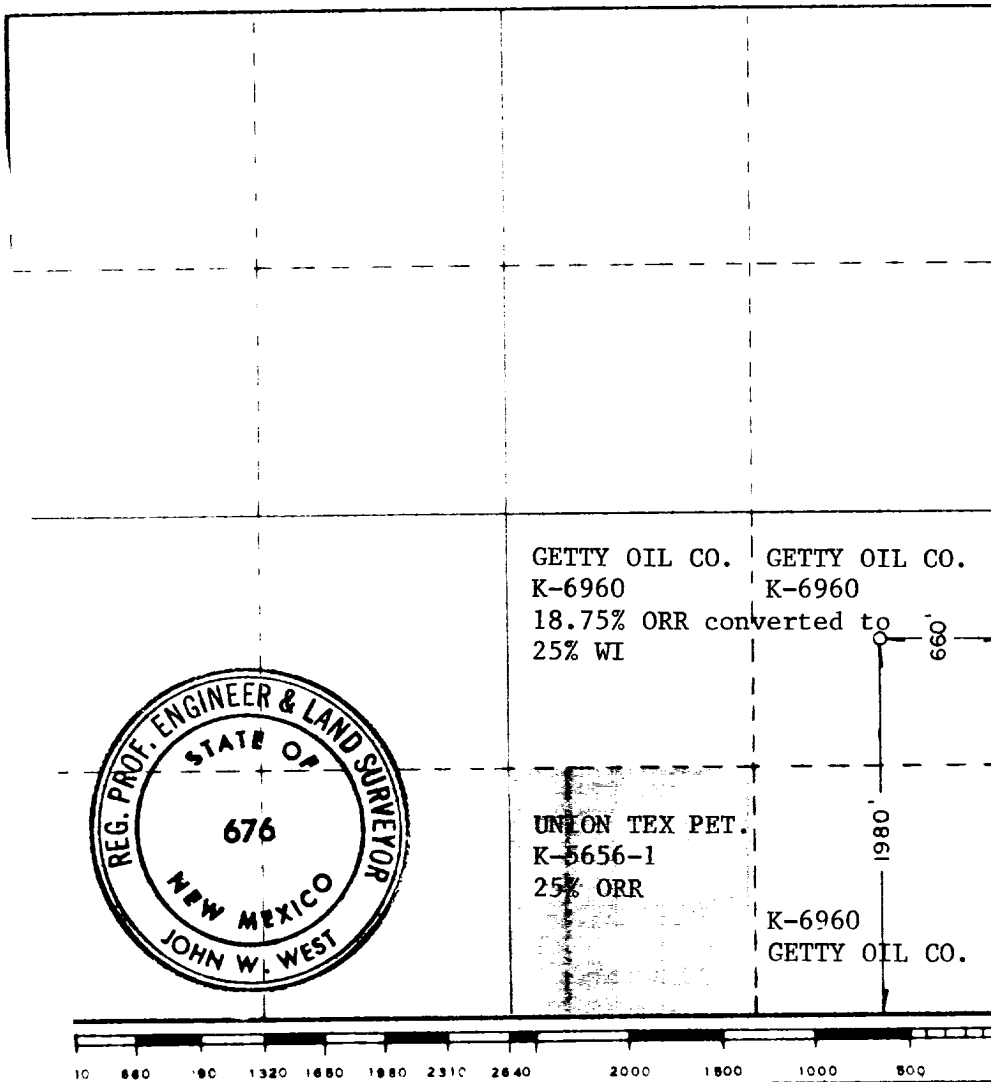

CERTIFICATION

I hereby certify that the information contained herein is true and complete to the best of my knowledge and belief.

*R. Dean McManigle*

R. Dean McManigle

President

Cambrian Oil, Inc.

March 31, 1983

I hereby certify that the well location shown on this plat was plotted from field notes of actual surveys made by me or under my supervision, and that the same is true and correct to the best of my knowledge and belief.

Date Surveyed  
March 28, 1983

Registered Professional Engineer  
and/or Land Surveyor

*John W. West*

Certificate No  
John W. West, NM L.S. 676

RECEIVED  
APR 13 1983

117