

NEW MEXICO OIL CONSERVATION COMMISSION
WELL LOCATION AND ACREAGE DEDICATION PLAT

Form C-101
Superseded C-128
Effective 1-1-65

All distances must be from the outer boundaries of the Section

Operator J. Cleo Thompson		Lease State 36		Well No. 1
Tract Letter I	Section 36	Township 13 South	Range 32 East	County Lea
Actual Footage Location of Well: 1980 feet from the South line and 660 feet from the East line				
Ground Level Elev. 4292.0	Producing Formation Upper Penn	Pool Baum	Dedicated Acreage 320/160	

1. Outline the acreage dedicated to the subject well by colored pencil or hachure marks on the plat below.
2. If more than one lease is dedicated to the well, outline each and identify the ownership thereof (both as to working interest and royalty).
3. If more than one lease of different ownership is dedicated to the well, have the interests of all owners been consolidated by communitization, unitization, force-pooling, etc?

☐ Yes ☐ No If answer is "yes," type of consolidation **NA**

If answer is "no," list the owners and tract descriptions which have actually been consolidated (Use reverse side of this form if necessary.)

No allowable will be assigned to the well until all interests have been consolidated (by communitization, unitization, forced-pooling, or otherwise) or until a non-standard unit, eliminating such interests, has been approved by the Commission.

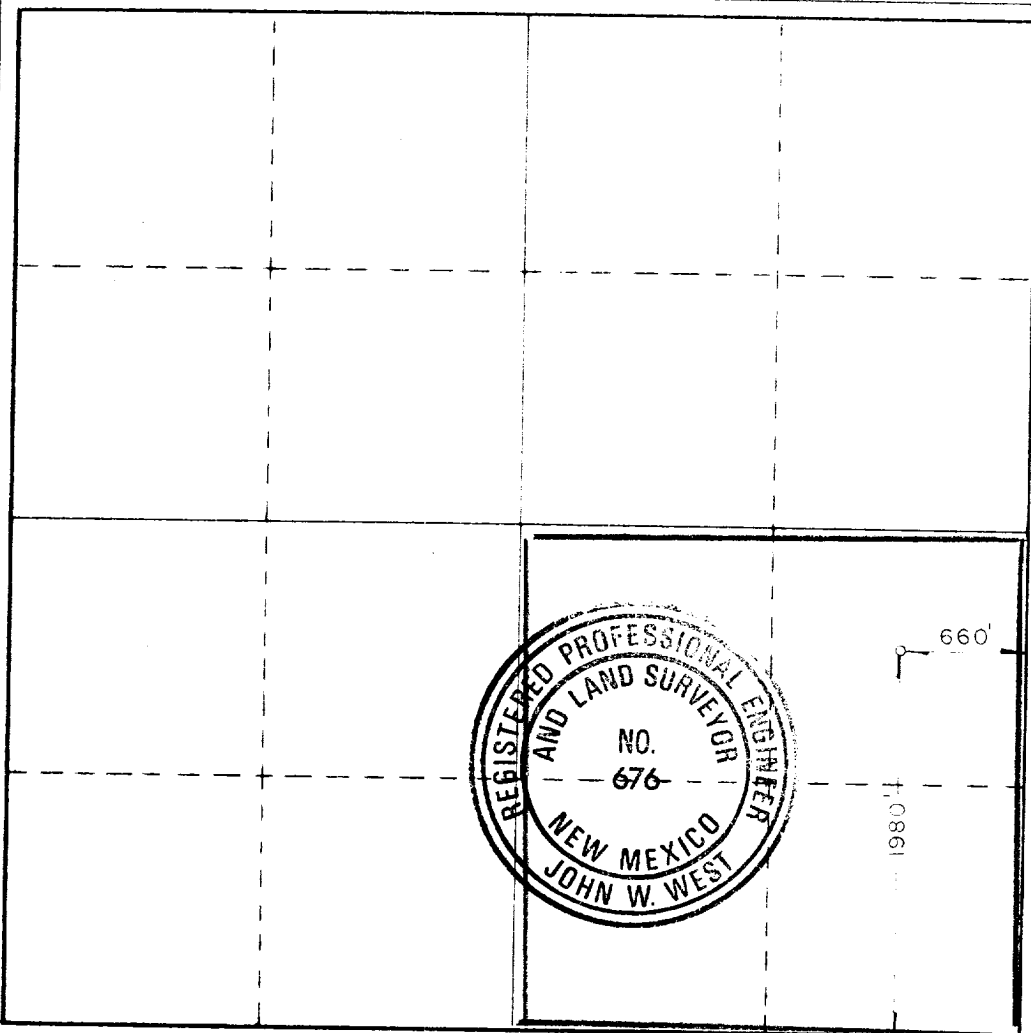

CERTIFICATION

I hereby certify that the information contained herein is true and complete to the best of my knowledge and belief.

Lois Cannady
Name
Agent

Position
J. Cleo Thompson

Compting
4-20-87
Date

I hereby certify that the well location shown on this plat was plotted from field notes of actual surveys made by me or under my supervision, and that the same is true and correct to the best of my knowledge and belief.

Date Surveyed
April 8, 1987
Registered Professional Engineer and/or Land Surveyor

John W. West
Certificate No **JOHN W. WEST, 676**
RONALD J. EIDSON, 3239

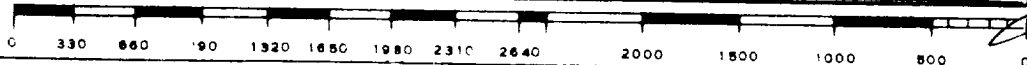

REC'D
9-25-87

1987
SEP 29 1987
FBI
RECEIVED

WRS COMPLETION REPORT

REISSUES SEC 36 TWP 13S RGE 32E
PI# 30-T-0006 06/05/89 30-025-29903-0000 PAGE 1

NMEX LEA * 1980FSL 660FEL SEC NE SE
STATE COUNTY FOOTAGE SPOT
THOMPSON JAMES CLEO D D
OPERATOR WELL CLASS INIT FIN

1 STATE "36"
WELL NO. LEASE NAME
4306KB 4292GR BAUM
OPER ELEV FIELD POOL AREA

API 30-025-29903-0000
LEASE TYPE NO PERMIT OR WELL I.D. NO

05/01/1987 09/11/1987 ROTARY D&A-OG
SPUD DATE COMP. DATE TYPE TOOL STATUS
10200 PNSLVN U ROCK ISLAND 3 RIG SUB 13
PROJ. DEPTH PROJ. FORM CONTRACTOR
DTD 10130 FM/TD BOUGH C
DRILLERS I.D. LOG I.D. FLOG BACK I.D. OLD I.D. FORM I.D.

LOCATION DESCRIPTION

17 MI S CAPROCK, NM

CASING/LINER DATA

CSG 13 3/8 @ 352 W/ 370 SACKS
CSG 8 5/8 @ 4100 W/ 2450 SACKS
CSG 5 1/2 @ 10130 W/ 1375 SACKS

TYPE	FORMATION	LTH	TOP DEPTH/SUB	BSE DEPTH/SUB
LOG	RUSTLER		1700	2606
LOG	YATES		2560	1746
LOG	SN ANDRS		3995	311
LOG	GLORIETA		5460	-1154
LOG	TUBB		6898	-2592
LOG	ABO		7666	-3360
LOG	WOLFCAMP		9160	-4854
LOG	BOUGH B		9702	-5396
LOG	BOUGH C		9845	-5539

SUBSEA MEASUREMENTS FROM KB

FORMATION TEST DATA

DST 1 9759- 9810 BOUGH B S
REC 650.0 CC OIL 300.0 CC SWTR
REC .6 CFT GAS
INIT OP 15M IFP 130
FINAL OP 1H FFP 151
ISIP 2665 1H FSIP 2621 2H IHP 4873 FHP 4823

CONTINUED IC# 300257010787

REISSUES SEC 36 TWP 13S RGE 32E
PI# 30-T-0006 06/05/89 30-025-29903-0000 PAGE 2

THOMPSON JAMES CLEO
1 STATE "36"

D D

FORMATION TEST DATA

NO DP REC
SPL REC .67 CFT GAS
NO OTHER DETAILS

PRODUCTION TEST DATA

BOUGH B PERF W/ 12/IT 9715- 9923
PERF 9715- 9923
ACID 9715- 9923 7000GALS
15% NEFE
PPD NON-COMMERCIAL OIL
PERFS OVERLAP BOUGH C

LOGS AND SURVEYS /INTERVAL,TYPE/

LOGS DI GR

DRILLING PROGRESS DETAILS

THOMPSON JAMES CLEO
4500 REPUBLIC BANK TWR
DALLAS, TX 75201
214-742-1991
04/23 LOC/1987/
05/11 DRLG 4102
05/19 DRLG 8175
05/26 10130 TD, WOCT
06/01 10130 TD, TSTG
06/08 10130 TD, TSTG
07/02 10130 TD, TSTG
07/09 10130 TD, TSTG
07/23 10130 TD, TSTG
08/07 10130 TD, TSTG
08/28 10130 TD, TSTG
09/11 10130 TD, HOLDING FOR DATA
09/30 TD REACHED 05/25/87
10130 TD
COMP 9/11/87, D&A
NO CORES, ONE DST RPTD
05/31 REISSUED TO CORRECT PROD TEST & ADD DST
& DELETE TITE STATUS
REPLACEMENT FOR CT ISSUED 10/5/87