

NEW MEXICO OIL CONSERVATION COMMISSION
Santa Fe, New Mexico

NOTICE OF INTENTION TO DRILL OR RECOMPLETE

Notice must be given to the District Office of the Oil Conservation Commission and approval obtained before drilling or recompletion begins. If changes in the proposed plan are considered advisable, a copy of this notice showing such changes will be returned to the sender. Submit this notice in QUINTUPPLICATE. One copy will be returned following approval. See additional instructions in Rules and Regulations of the Commission.

Magnolia, Arkansas

(Place)

April 24, 1961

(Date)

OIL CONSERVATION COMMISSION
SANTA FE, NEW MEXICO

Gentlemen:

You are hereby notified that it is our intention to commence the (Drilling) (~~RECOMPLETION~~) of a well to be known as

McAlester Fuel Company

(Company or Operator)

State

(Lease)

Well No.

0

(Unit)

located 1980 feet from the North line and 2310 feet from the East line of Section 33, T. 15S, R. 32 E, NMPM.

(GIVE LOCATION FROM SECTION LINE) Anderson Ranch Wolfcamp Pool, Lea County

If State Land the Oil and Gas Lease is No. E 6078

If patented land the owner is

Address

We propose to drill well with drilling equipment as follows: Forester Drilling Company rig, Odessa, Texas

The status of plugging bond is covered by \$10,000 blanket bond.

Drilling Contractor Forester Drilling Company
Odessa, Texas

We intend to complete this well in the Wolfcamp formation at an approximate depth of 9900 feet.

CASING PROGRAM

We propose to use the following strings of Casing and to cement them as indicated:

Size of Hole	Size of Casing	Weight per Foot	New or Second Hand	Depth	Sacks Cement
16 "	13-3/8"	48#	New	350	120 sacks - 4% gel
12-1/4"	9-5/8"	40#, 36#	New	4,200	800 sacks / 6% gel, 25% stratacrete
7-7/8"	5-1/2"	20#, 17#	New	10,000	300 sacks / 6% gel, 25% stratacrete

If changes in the above plans become advisable we will notify you immediately.

ADDITIONAL INFORMATION (If recompletion give full details of proposed plan of work.)

Sincerely yours,

McALESTER FUEL COMPANY
(Company or Operator)

By

Position Chief Engineer

Send Communications regarding well to

Name Chas. Dillard

Address Post Office Box 210
Magnolia, Arkansas

Approved

Except as follows:

CEMENT MUST BE CIRCULATED BEHIND CASING.

OIL CONSERVATION COMMISSION

By

Title

NEW MEXICO OIL CONSERVATION COMMISSION
WELL LOCATION AND ACREAGE DEDICATION PLAT

FORM C-128
Revised 5/1/57

SEE INSTRUCTIONS FOR COMPLETING THIS FORM ON THE REVERSE SIDE

SECTION A

Operator MCALLESTER FUEL COMPANY		Lease STATE "JG"		Well No. 1
Unit Letter G	Section 33	Township 15 SOUTH	Range 32 EAST	County LEA
Actual Footage Location of Well: 1980 feet from the NORTH line and 2310 feet from the EAST line				
Ground Level Elev. To be run later	Producing Formation Wolfcamp	Pool Anderson Ranch	Dedicated Acreage: 40 Acres	

1. Is the Operator the only owner in the dedicated acreage outlined on the plat below? YES _____ NO ☒ ("Owner" means the person who has the right to drill into and to produce from any pool and to appropriate the production either for himself or for himself and another. (65-3-29 (a) NMSA 1955 Comp.)
2. If the answer to question one is "no," have the interests of all the owners been consolidated by communitization agreement or otherwise? YES ☒ NO _____. If answer is "yes," Type of Consolidation Lease Operating Agreement
3. If the answer to question two is "no," list all the owners and their respective interests below:

Owner	Land Description

SECTION B

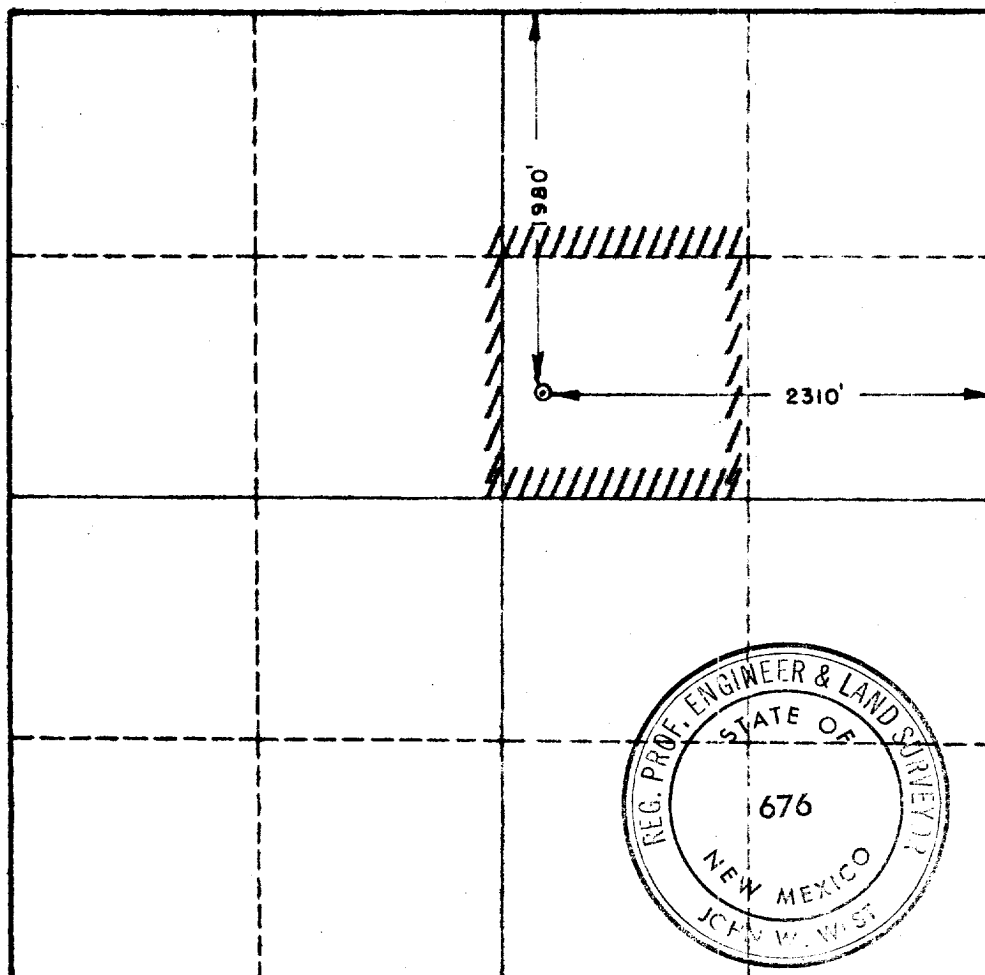

CERTIFICATION

I hereby certify that the information in SECTION A above is true and complete to the best of my knowledge and belief.

Name S. S. Lacy

Position Chief Engineer

Company MCALLESTER FUEL COMPANY

Date April 24, 1961

I hereby certify that the well location shown on the plat in SECTION B was plotted from field notes of actual surveys made by me or under my supervision, and that the same is true and correct to the best of my knowledge and belief.

Date Surveyed 3-21-61

Registered Professional Engineer and/or Land Surveyor, JOHN W. WEST

John W. West
Certificate No. N.M. - P.E. & L.S. NO. 676

0 330 660 990 1320 1650 1980 2310 2640 2000 1500 1000 500 0