

N. E. 100  
P. O. BOX 100  
UNITED STATES  
DEPARTMENT OF THE INTERIOR  
BUREAU OF LAND MANAGEMENT

SUBMIT IN TRIPLICATE\*  
(Other instructions on  
reverse side)

Form approved.  
Budget Bureau No. 1004-0136  
Expires August 31, 1985

APPLICATION FOR PERMIT TO DRILL, DEEPEN, OR PLUG BACK

1a. TYPE OF WORK

DRILL ☐

CARLISLE FORCE  
AREA DEEPEN ☐

PLUG BACK ☒

b. TYPE OF WELL

OIL  
WELL ☐

GAS  
WELL ☒

OTHER

SINGLE  
ZONE ☒

MULTIPLE  
ZONE ☐

2. NAME OF OPERATOR

Texaco Inc.

3. ADDRESS OF OPERATOR

P. O. Box 728, Hobbs, New Mexico 88240

4. LOCATION OF WELL (Report location clearly and in accordance with any State requirements.)\*

At surface

1650' FSL & 660' FEL (Unit Letter I)

At proposed prod. zone

Same

14. DISTANCE IN MILES AND DIRECTION FROM NEAREST TOWN OR POST OFFICE\*

2 Miles Southeast of Maljamar, New Mexico

15. DISTANCE FROM PROPOSED\*

LOCATION TO NEAREST  
PROPERTY OR LEASE LINE, FT.  
(Also to nearest drlg. unit line, if any)

660'

16. NO. OF ACRES IN LEASE

80

17. NO. OF ACRES ASSIGNED  
TO THIS WELL

80

18. DISTANCE FROM PROPOSED LOCATION\*

TO NEAREST WELL, DRILLING, COMPLETED,  
OR APPLIED FOR, ON THIS LEASE, FT.

19. PROPOSED DEPTH

3810' PBTD

20. ROTARY OR CABLE TOOLS

Pulling Unit

21. ELEVATIONS (Show whether DF, RT, GR, etc.)

4033' DF

22. APPROX. DATE WORK WILL START\*

December 1, 1987

PROPOSED CASING AND CEMENTING PROGRAM

SIZE OF HOLE	SIZE OF CASING	WEIGHT PER FOOT	SETTING DEPTH	QUANTITY OF CEMENT
11"	7-5/8"	24#	295'	200 (Circulated)
6-3/4"	4-1/2"	11.6#	4150'	650 (TOC @ 1530' by T.S.)

1. MIRU. Pull rods & pump. Install BOP. Pull tubing.
2. By wireline, run gauge ring to  $\pm$  3850'. POH. RIH w/4-1/2" CIBP & set @  $\pm$  3850'. Dump 40' cement on top CIBP.
3. Test casing to 1700 PSI. Squeeze any leaks.
4. Run GR-CCL from PBTD to 2000'.
5. GIH w/4-1/2" packer to  $\pm$  3220'. Spot 100 gallons 10% acetic acid from 3070'-3220'. Set packer @ 3000'.
6. Perf. Queen w/2 JSPF 3187'-96' & 3200'-08'. (38 Holes).
7. Acidize perfs w/2000 gallons 15% NEFE. Max. rate & press: 3 BPM, 4000, psi.
8. Swab back load. Evaluate for additional stimulation.
9. If necessary, sand-frac w/10,000 gallons 30# HPG gelled 2% KCL water and 16,000# 20/40 sand. SION.
10. Release packer. POH.
11. Run production equipment. Place on production to pump back load water.
12. After load water recovered, run BHP bombs. Run 4-point test on 72 Hr. pressure buildup test. Place back on production.

IN ABOVE SPACE DESCRIBE PROPOSED PROGRAM: If proposal is to deepen or plug back, give data on present productive zone and proposed new productive zone. If proposal is to drill or deepen directionally, give pertinent data on subsurface locations and measured and true vertical depths. Give blowout preventer program, if any.

24.

SIGNED

*L. J. Seeman*

TITLE

L. J. Seeman  
Dist. Petr. Engr.

DATE

November 2, 1987

(This space for Federal or State office use)

PERMIT NO.

APPROVAL DATE

APPROVED BY

TITLE

DATE

11-16-87

CONDITIONS OF APPROVAL, IF ANY:

All distances must be from the outer boundaries of the Section.

Operator <b>Texaco Inc.</b>		Lease <b>Federal U. S. A "C"</b>		Well No. <b>2</b>
Unit Letter <b>I</b>	Section <b>15</b>	Township <b>17-S</b>	Range <b>32-E</b>	County <b>Lea</b>
Actual Postage Location of Well: <b>1650</b> feet from the <b>South</b> line and <b>660</b> feet from the <b>East</b> line				
Ground Level Elev. <b>4033 DF</b>	Producing Formation <b>Queen</b>	Pool <b>Maljamar Queen Gas</b>	Dedicated Acreage: <b>80</b> Acres	

1. Outline the acreage dedicated to the subject well by colored pencil or hatchure marks on the plat below.
2. If more than one lease is dedicated to the well, outline each and identify the ownership thereof (both as to working interest and royalty).
3. If more than one lease of different ownership is dedicated to the well, have the interests of all owners been consolidated by communitization, unitization, force-pooling, etc?

☐ Yes ☐ No If answer is "yes," type of consolidation \_\_\_\_\_

If answer is "no," list the owners and tract descriptions which have actually been consolidated. (Use reverse side of this form if necessary.) \_\_\_\_\_

No allowable will be assigned to the well until all interests have been consolidated (by communitization, unitization, forced-pooling, or otherwise) or until a non-standard unit, eliminating such interests, has been approved by the Division

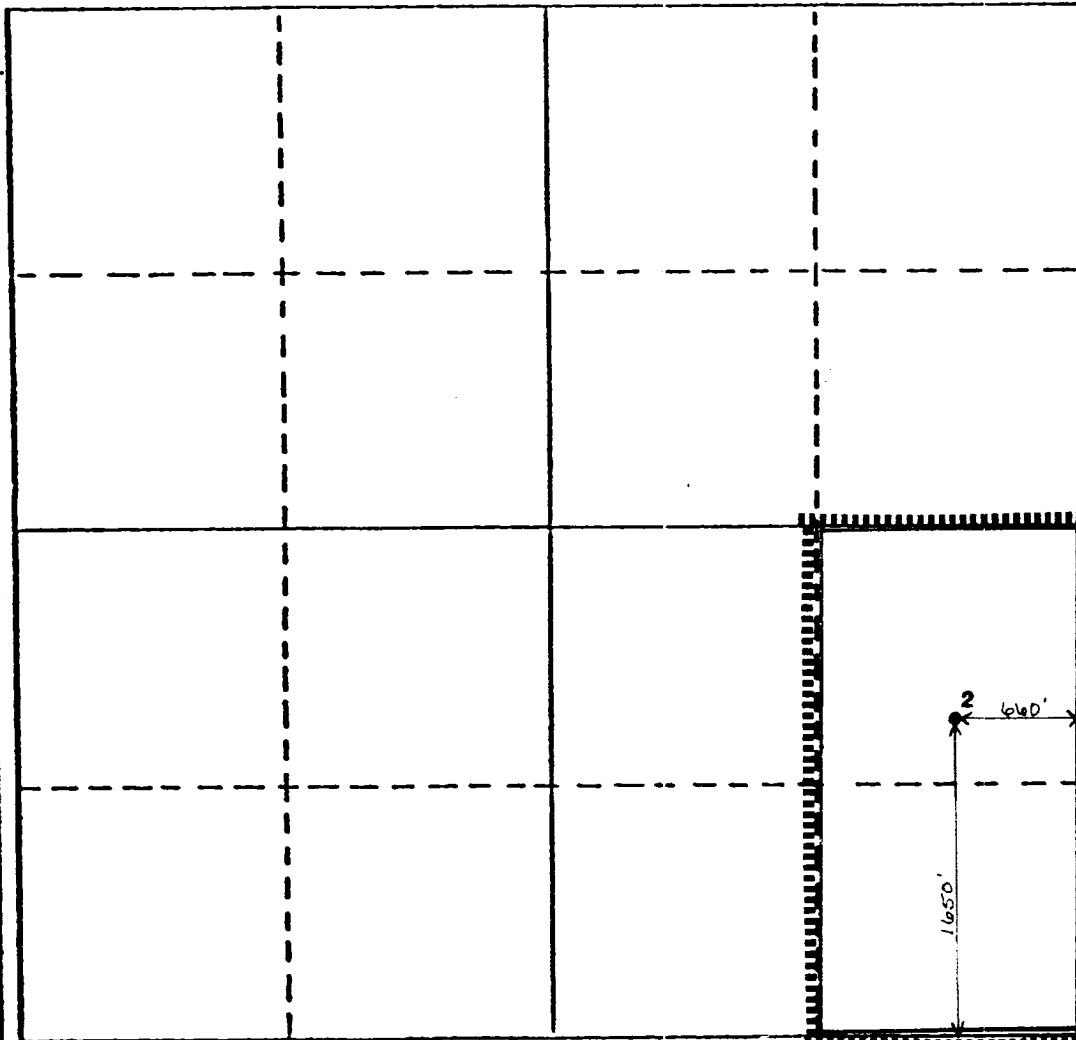

CERTIFICATION

I hereby certify that the information contained herein is true and complete to the best of my knowledge and belief.

*L. J. Seeman*  
Name

L. J. Seeman

Position

Dist. Petr. Engr.

Company

Texaco Inc.

Date

November 2, 1987

I hereby certify that the well location shown on this plat was plotted from field notes of actual surveys made by me or under my supervision, and that the same is true and correct to the best of my knowledge and belief.

Date Surveyed

Registered Professional Engineer and/or Land Surveyor

Certificate No.