

QUINTUPLICATE
- REVISED -

NEW MEXICO OIL CONSERVATION COMMISSION
Santa Fe, New Mexico

Form G-101
Revised (12/1/55)

NOTICE OF INTENTION TO DRILL

- REVISED -

Notice must be given to the District Office of the Oil Conservation Commission and approval obtained before drilling or recompletion begins. If changes in the proposed plan are considered advisable, a copy of this notice showing such changes will be returned to the sender. Submit this notice in QUINTUPLICATE. One copy will be returned following approval. See additional instructions in Rules and Regulations of the Commission. If State Land submit 6 Copies Attach Form G-128 in triplicate to first 3 copies of form G-101

Hobbs, New Mexico

(Place)

May 25, 1960

(Date)

OIL CONSERVATION COMMISSION
SANTA FE, NEW MEXICO

Gentlemen:

You are hereby notified that it is our intention to commence the Drilling of a well to be known as
Phillips Petroleum Company

(Company or Operator)

New Mex "A"

(Lease)

Well No. **3**, in **J** (Unit) The well is

located **1900** feet from the **south** line and **1900** feet from the **east** line of Section **25**, T. **16-S**, R. **33-E**, NMPM.

(GIVE LOCATION FROM SECTION LINE) **Kennits (Wolfcamp)** Pool, **Lea** County

If State Land the Oil and Gas Lease is No. **E-1614**

If patented land the owner is.....

Address.....

We propose to drill well with drilling equipment as follows: **Rotary**

The status of plugging bond is **blanket.**

Drilling Contractor **Phillips Petroleum Company**
Bartlesville, Oklahoma

We intend to complete this well in the **Wolfcamp** formation at an approximate depth of **10,850'** feet.

CASING PROGRAM

We propose to use the following strings of Casing and to cement them as indicated:

Size of Hole	Size of Casing	Weight per Foot	New or Second Hand	Depth	Sacks Cement
17-3/4"	13-3/8"	48#	New	375'	Circ.
12-1/4"	8-5/8"	36#	New	4550'	400
7-7/8"	5-1/2"	23#	New	10850'	Suff. to tie into 8-5/8"

If changes in the above plans become advisable we will notify you immediately.

ADDITIONAL INFORMATION (If recompletion give full details of proposed plan of work.)

Revised report filed in accordance with NMOCC Order No. R-1683.

Approved....., 19.....
Except as follows:

Sincerely yours,

PHILLIPS PETROLEUM COMPANY

(Company or Operator)

By.....

Position **District Chief Clerk**

Send Communications regarding well to
Phillips Petroleum Company

Name.....

Address **Box 2105, Hobbs, New Mexico**

OIL CONSERVATION COMMISSION

By *Joe S. Ramsey*

NEW MEXICO OIL CONSERVATION COMMISSION

- REVISED -

Well Location and Acreage Dedication Plat

- REVISED -

Section A.

Date May 25, 1960

Operator Phillips Petroleum Company Lease New Mex "A"
Well No. 3 Unit Letter J Section 25 Township 16-S Range 31-E NMPM
Located 1960 Feet From north Line, 1960 Feet From east Line
County Lee G. L. Elevation Furnish later Dedicated Acreage 60 * Acres
Name of Producing Formation Wolfcamp Pool Kennits (Wolfcamp)

1. Is the Operator the only owner* in the dedicated acreage outlined on the plat below?
Yes No
2. If the answer to question one is "no," have the interests of all the owners been consolidated by communitization agreement or otherwise? Yes No . If answer is "yes," Type of Consolidation _____
3. If the answer to question two is "no," list all the owners and their respective interests below:

* NOTE: Revised form filed in accordance with NMCC Order R-1683

Owner

Land Description

<u>Owner</u>	<u>Land Description</u>

Section B

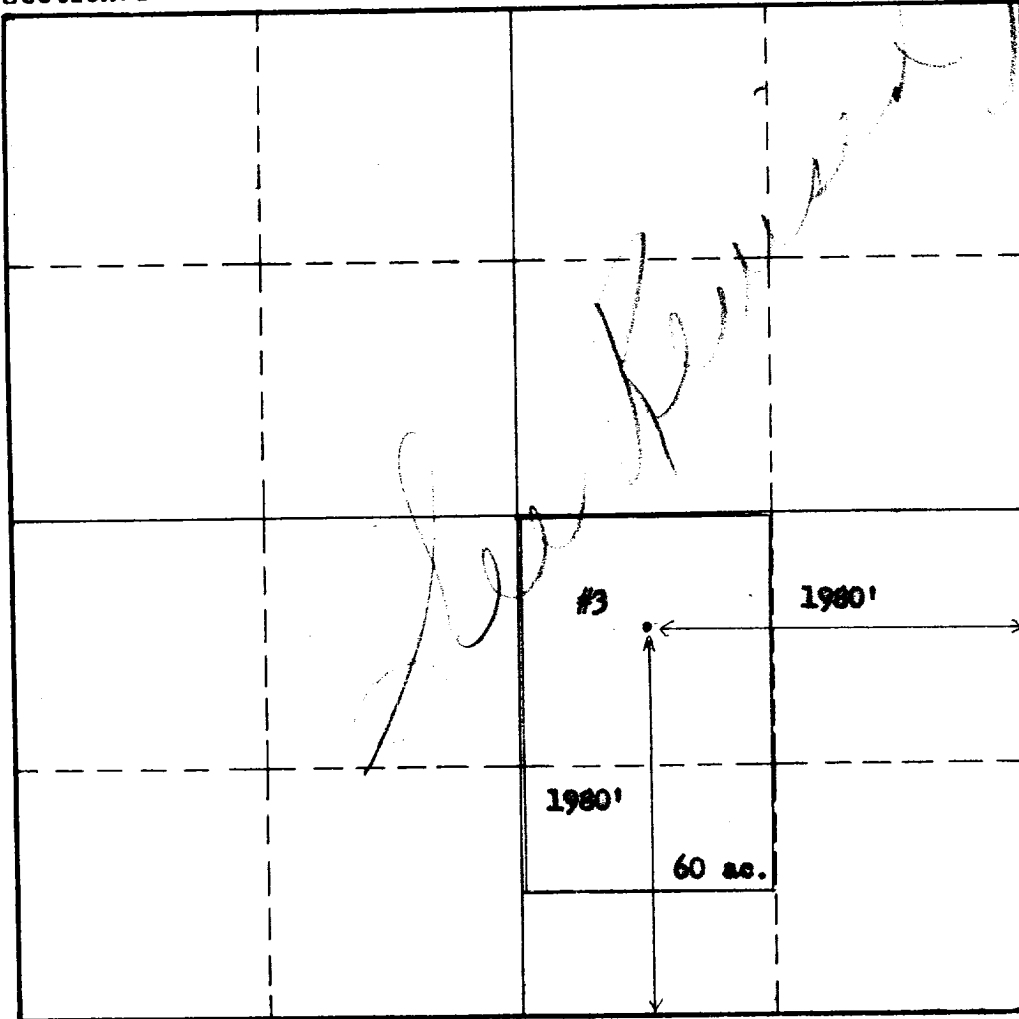

This is to certify that the information in Section A above is true and complete to the best of my knowledge and belief.

Phillips Petroleum Company
(Operator)

W. E. Spang
(Representative)

Box 2105, Hobbs, New Mexico
Address

This is to certify that the well location shown on the plat in Section B was plotted from field notes of actual surveys made by me or under my supervision and that the same is true and correct to the best of my knowledge and belief.

Date Surveyed 3-31-60

W. E. Spang
Registered Professional
Engineer and/or Land Surveyor.

Certificate No. 679

INSTRUCTIONS FOR COMPLETION:

1. Operator shall furnish and certify to the information called for in Section A.
2. Operator shall outline the dedicated acreage for both oil and gas wells on the plat in Section B.
3. A registered professional engineer or land surveyor registered in the State of New Mexico or approved by the Commission shall show on the plat the location of the well and certify this information in the space provided.
4. All distances shown on the plat must be from the outer boundaries of Section.
5. If additional space is needed for listing owners and their respective interests as required in question 3, Section A, please use space below

* "Owner" means the person who has the right to drill into and to produce from any pool and to appropriate the production either for himself or for himself and another. (65-3-29 (e) NMSA 1953 Comp.)