

MEXICO OIL CONSERVATION COMMISS.
WELL LOCATION AND ACREAGE DEDICATION, LAT

Form C-102
 Supersedes C-128
 Effective 1-1-65

All distances must be from the outer boundaries of the Section

Operator SANTA FE ENERGY CORP.			Lease STATE UTP		Well No. NO. 2
Plot Letter G	Section 21	Township 15 SOUTH	Range 32 EAST	County LEA	
Actual Footage Location of Well:					
1650 feet from the NORTH line and		1980 feet from the EAST line			
Ground Level Elev. 4302.8	Producing Formation WOLFCAMP	Pool NORTH ANDERSON RANCH		Dedicated Acreage: 80 Acres	

1. Outline the acreage dedicated to the subject well by colored pencil or hachure marks on the plat below.
2. If more than one lease is dedicated to the well, outline each and identify the ownership thereof (both as to working interest and royalty).
3. If more than one lease of different ownership is dedicated to the well, have the interests of all owners been consolidated by communitization, unitization, force-pooling, etc?

☐ Yes ☐ No If answer is "yes," type of consolidation _____

If answer is "no," list the owners and tract descriptions which have actually been consolidated. (Use reverse side of this form if necessary.) _____

No allowable will be assigned to the well until all interests have been consolidated (by communitization, unitization, forced-pooling, or otherwise) or until a non-standard unit, eliminating such interests, has been approved by the Commission.

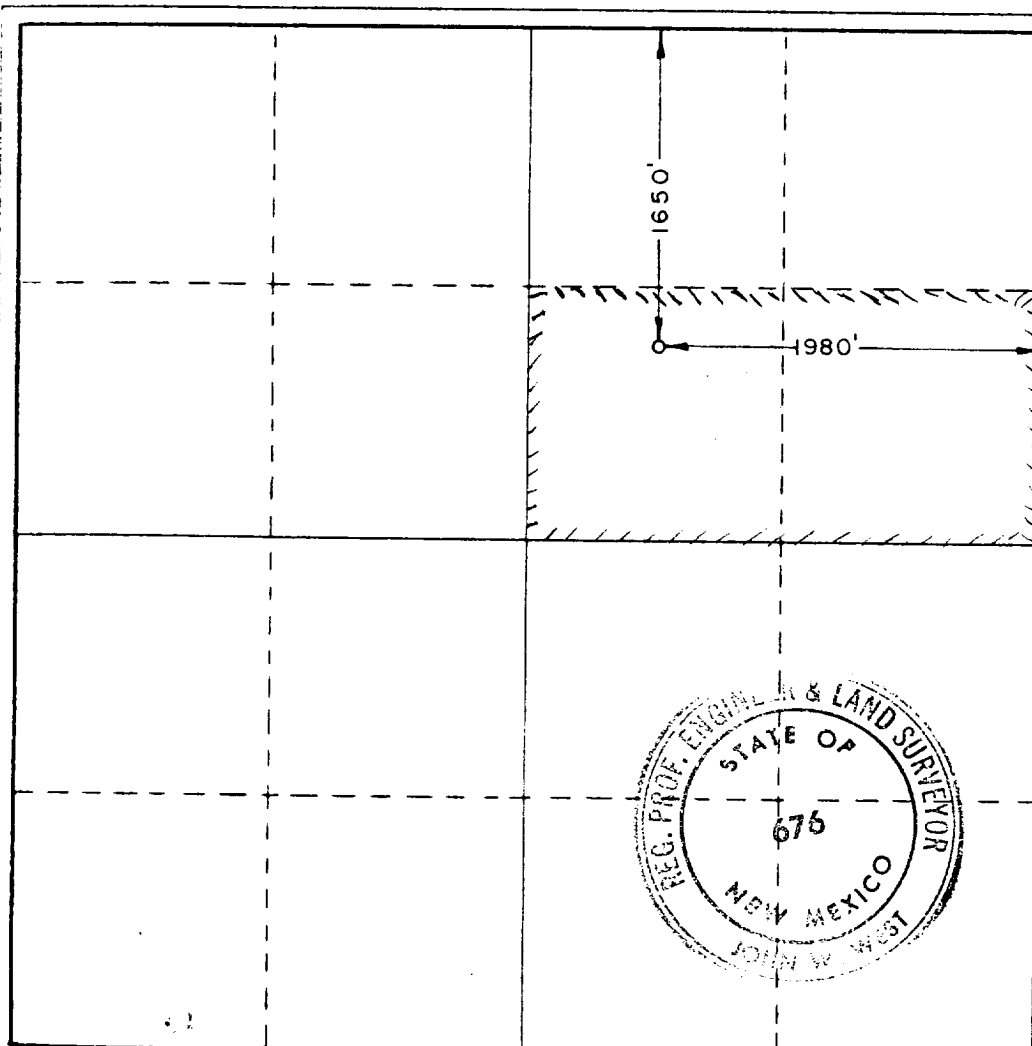

CERTIFICATION

I hereby certify that the information contained herein is true and complete to the best of my knowledge and belief.

Thomas E. Gentry
 Name

THOMAS E. GENTRY

Position
DIST. OPERATIONS MANAGER

Company **SANTA FE ENERGY**
OPERATING PARTNERS, L.P.

Date
JUNE 3, 1988

I hereby certify that the well location shown on this plat was plotted from field notes of actual surveys made by me or under my supervision, and that the same is true and correct to the best of my knowledge and belief.

JUNE 30, 1983

Date Surveyed

Registered Professional Engineer and/or Land Surveyor

Ronald J. Eidson
 Certificate No. **JOHN W. WEST, 676**

RONALD J. EIDSON, 3239

