

STATE OF NEW MEXICO  
ENERGY AND MINERALS DEPARTMENT

C.L. CONSERVATION DIVISION

P. O. BOX 2088

SANTA FE, NEW MEXICO 87501

Form C-101  
Revised 10-1-78

NO. OF COPIES RECEIVED	
DISTRIBUTION	
SANTA FE	
FILE	
U.S.G.S.	
LAND OFFICE	
OPERATOR	

5A. Indicate Type of Lease  
STATE ☒ FEE ☐

5. State Oil & Gas Lease No.  
LG-6638

APPLICATION FOR PERMIT TO DRILL, DEEPEN, OR PLUG BACK

1a. Type of Work  
b. Type of Well DRILL ☒ DEEPEN ☐ PLUG BACK ☐  
OIL WELL ☐ GAS WELL ☐ OTHER ☐ SINGLE ZONE ☐ MULTIPLE ZONE ☐

2. Name of Operator  
Hondo Drilling Company

3. Address of Operator  
P. O. Drawer 2516, Midland, Texas 79702-2516 **UNDESIGNATED**

4. Location of Well UNIT LETTER I LOCATED 1,930 FEET FROM THE South LINE  
AND 890 FEET FROM THE East LINE OF SEC. 7 TWP. 16-S RGE. 33-E NMPM

7. Unit Agreement Name

8. Farm or Lease Name State Hill Bar

9. Well No.  
1

10. Field and Pool, or Wildcat  
North Sanmal-Penn

12. County  
Lea

19. Proposed Depth  
11,500'

19A. Formation  
Cisco

20. Rotary or C.T.  
Rotary

21. Elevations (Show whether D.F., R.T., etc.)  
GR 4,262.5'

21A. Kind & Status Plug. Bond  
798G5505

21B. Drilling Contractor  
Hondo Drilling Co.

22. Approx. Date Work will start  
December 31, 1986

PROPOSED CASING AND CEMENT PROGRAM

SIZE OF HOLE	SIZE OF CASING	WEIGHT PER FOOT	SETTING DEPTH	SACKS OF CEMENT	EST. TOP
17 1/2"	13 3/8"	48 lb.	450'	400	Circulate Cement
11"	8 5/8"	32 lb.	4,500'	1,700	Circulate Cement
7 7/8"	Test Cisco Canyon formation or 11,500'				

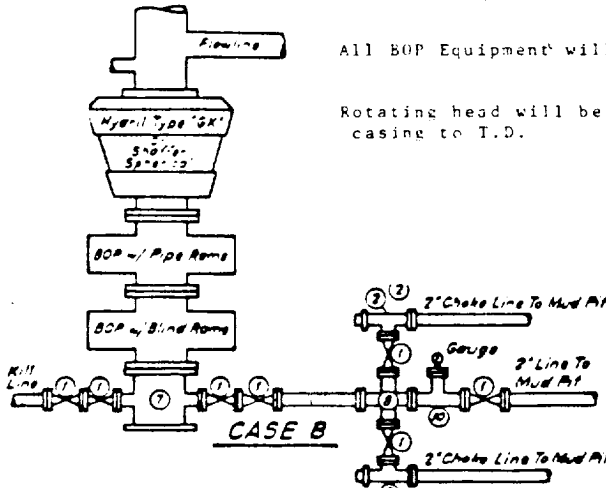

All BOP Equipment will be 11", 5000'

Rotating head will be used from intermediate casing to T.D.

IN ABOVE SPACE DESCRIBE PROPOSED PROGRAM: IF PROPOSAL IS TO DEEPEN OR PLUG BACK, GIVE DATA ON PRESENT PRODUCTIVE ZONE AND PROPOSED NEW PRODUCTIVE ZONE. GIVE BLOWOUT PREVENTER PROGRAM, IF ANY.

I hereby certify that the information above is true and complete to the best of my knowledge and belief.

Signed Paul Kautz Title President Date December 12, 1986

(This space for State Use)

Offg. Signed by  
Paul Kautz

Geologist

APPROVED BY Geologist TITLE Geologist DATE DEC 12 1986

CONDITIONS OF APPROVAL, IF ANY:

Permit Expires 6 Months From Approval  
Date Unless Drilling Underway.

NEW MEXICO OIL CONSERVATION COMMISSION  
WELL LOCATION AND ACREAGE DEDICATION PLAT

Form C-102  
Supersedes C-128  
Effective 1-1-65

All distances must be from the outer boundaries of the Section.

Operator Hondo Drilling Company			Lease State "N" Barr "E" State		Well No. 1
Unit Letter I	Section 7	Township 16 South	Range 33 East	County Lea	
Actual Footage Location of Well: 1930 feet from the South line and 890 feet from the East line					
Ground Level Elev. 4262.5 4238.3	Producing Formation Cisco Canyon		Pool North Sanmal-Penn		Dedicated Acreage: 40 Acres

1. Outline the acreage dedicated to the subject well by colored pencil or hachure marks on the plat below.
2. If more than one lease is dedicated to the well, outline each and identify the ownership thereof (both as to working interest and royalty).
3. If more than one lease of different ownership is dedicated to the well, have the interests of all owners been consolidated by communitization, unitization, force-pooling, etc?
- ☐ Yes ☐ No If answer is "yes," type of consolidation \_\_\_\_\_
- If answer is "no," list the owners and tract descriptions which have actually been consolidated. (Use reverse side of this form if necessary.) \_\_\_\_\_
- No allowable will be assigned to the well until all interests have been consolidated (by communitization, unitization, forced-pooling, or otherwise) or until a non-standard unit, eliminating such interests, has been approved by the Commission.

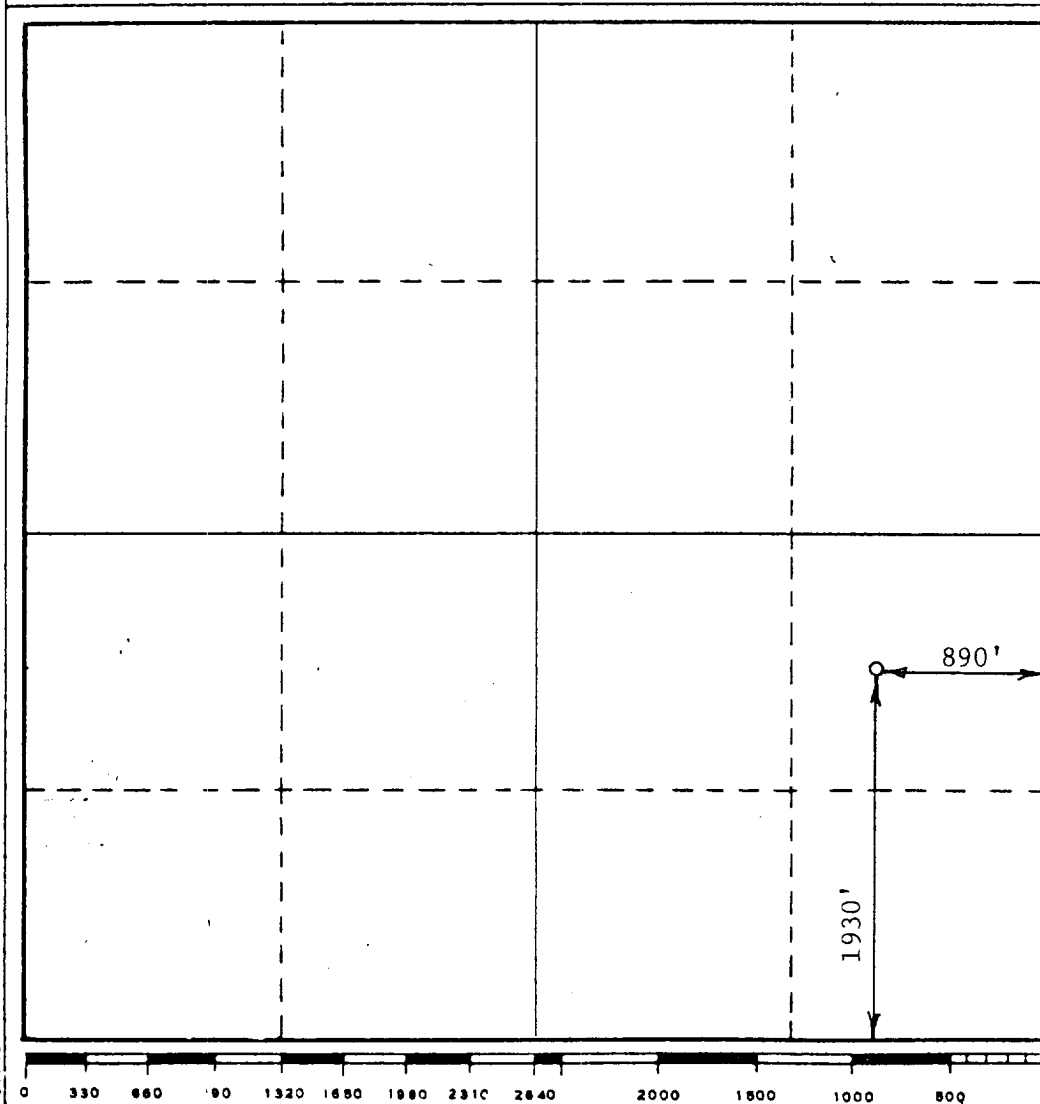

CERTIFICATION

I hereby certify that the information contained herein is true and complete to the best of my knowledge and belief.

*N. W. Outlaw*

Name

N. W. Outlaw

Position

President

Company

Hondo Drilling Company

Date

December 12, 1986

I hereby certify that the well location shown on this plat was plotted from field notes of actual surveys made by me or under my supervision, and that the same is true and correct to the best of my knowledge and belief.

Date Surveyed

12-12-86

Registered Professional Engineer and/or Land Surveyor

Certificate No.

JOHN W. WEST,

676

RONALD J. EIDSON,

3239

RECEIVED  
DEC 15 1986  
FBI  
RECORDS SECTION

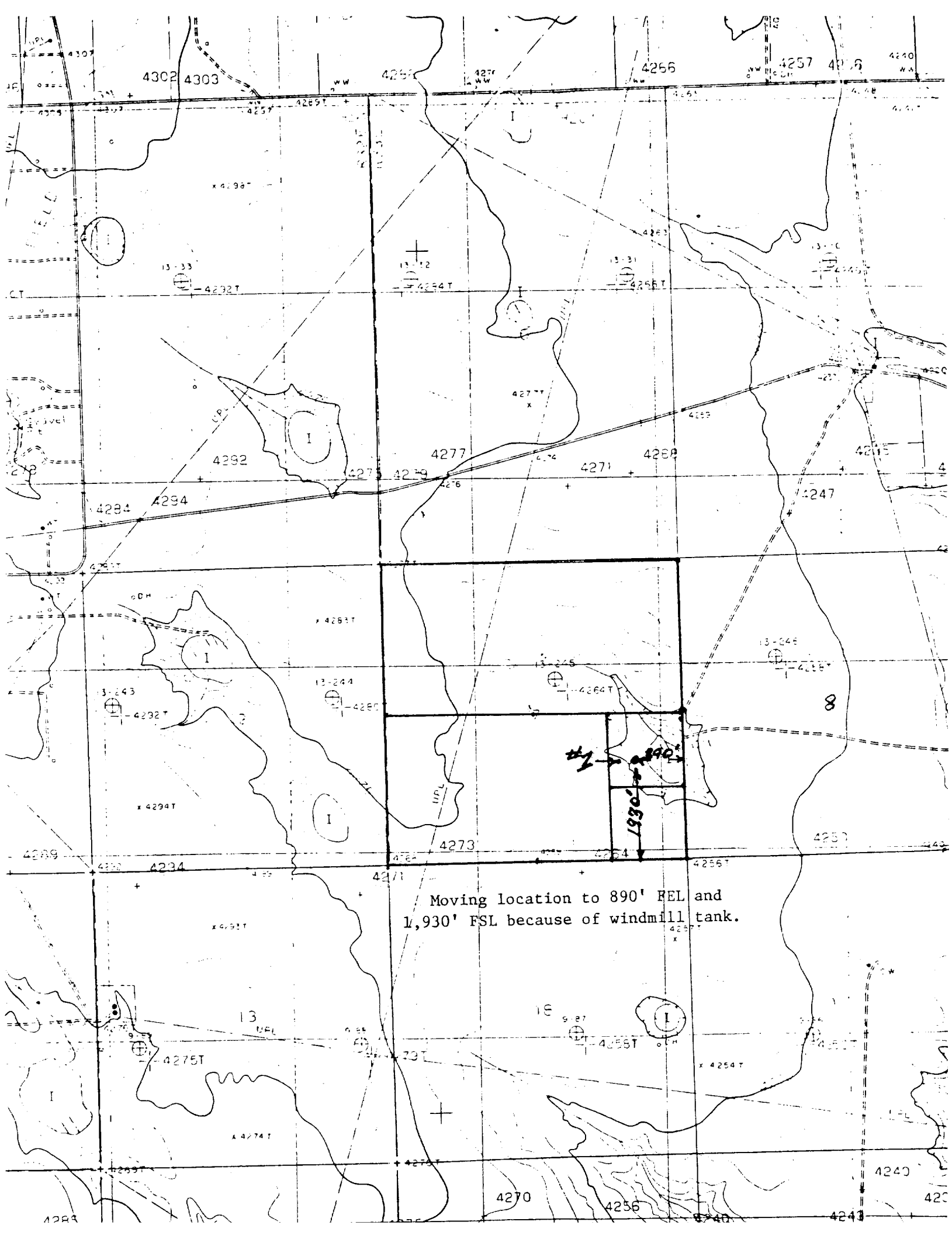

Moving location to 890' FEL and  
1,930' FSL because of windmill tank.

RECEIVED  
DEC 15 1986  
OCD  
HOBBS OFFICE

10-11-86 197