

NO. OF COPIES RECEIVED	
DISTRIBUTION	
SANTA FE	
FILE	
U.S.G.S.	
LAND OFFICE	
OPERATOR	

NEW MEXICO OIL CONSERVATION COMMISSION

Form C-101
Revised 1-1-65

5A. Indicate Type of Lease
STATE <input checked="" type="checkbox"/> FEE <input type="checkbox"/>
5. State Oil & Gas Lease No.
B-1520

APPLICATION FOR PERMIT TO DRILL, DEEPEN, OR PLUG BACK

1a. Type of Work		7. Unit Agreement Name	
b. Type of Well DRILL <input checked="" type="checkbox"/> DEEPEN <input type="checkbox"/> PLUG BACK <input type="checkbox"/> OIL WELL <input checked="" type="checkbox"/> GAS WELL <input type="checkbox"/> OTHER <input type="checkbox"/> SINGLE ZONE <input checked="" type="checkbox"/> MULTIPLE ZONE <input type="checkbox"/>		8. Farm or Lease Name Bridges State	
2. Name of Operator Mobil Oil Corporation		9. Well No. 144	
3. Address of Operator P. O. Box 633, Midland, Texas 79701		10. Field and Pool, or Wildcat Undesignated	
4. Location of Well UNIT LETTER P LOCATED 660 FEET FROM THE East LINE AND 460 FEET FROM THE South LINE OF SEC. 15 TWP. 17 S RGE. 34 E NMPM		12. County Lea	
19. Proposed Depth 8750		19A. Formation Abo	
20. Rotary or C.T. Rotary		21. Elevations (Show whether Dr, RT, etc.) 4046.1 GL	
21A. Kind & Status Plug. Bond On File		21B. Drilling Contractor Marcum	
22. Approx. Date Work will start Sept. 30, 1970			

PROPOSED CASING AND CEMENT PROGRAM

SIZE OF HOLE	SIZE OF CASING	WEIGHT PER FOOT	SETTING DEPTH	SACKS OF CEMENT	EST. TOP
12-1/4	8-5/8	20#	1200		
12-1/4	8-5/8	24#	1650	Circulate	Surface
7-7/8	5-1/2	15.5#	1043		
7-7/8	5-1/2	14.0#	5374		
7-7/8	5-1/2	15.5#	7049		
7-7/8	5-1/2	17.0#	8651	Circulate	Above San Andres zone est. @ 4640'
7-7/8	5-1/2	17.0#	8700		

Mud Program

0 - 1650 Spud Mud
1650 - 8000 Brackish Water
8000 - 8700 Brackish Water, Flosal and Oil as needed to clean hole and obtain samples

Logging Program

2800 - 8200 - Laterolog CASING.
2800 - 8700 - Sidewall Neutron - GR Col.

APPROVAL VALID
FOR 90 DAYS UNLESS
DRILLING COMMENCED,

EXPIRES 11-10-70

IN ABOVE SPACE DESCRIBE PROPOSED PROGRAM: IF PROPOSAL IS TO DEEPEN OR PLUG BACK, GIVE DATA ON PRESENT PRODUCTIVE ZONE AND PROPOSED NEW PRODUCTIVE ZONE. GIVE BLOWOUT PREVENTER PROGRAM, IF ANY.

I hereby certify that the information above is true and complete to the best of my knowledge and belief.

Signed A. D. Bond A. D. Bond Title Proration Staff Assistant Date August 4, 1970

(This space for State Use)
APPROVED BY Leslie A. Clements TITLE Assistant Secretary DATE 8-12-70
CONDITIONS OF APPROVAL, IF ANY:

RECEIVED

AUG 11 1970

OIL CONSERVATION COMM.
HOBBS, N. M.

NEW MEXICO OIL CONSERVATION COMMISSION
WELL LOCATION AND ACREAGE DEDICATION PLAT

Form C-102
Supersedes C-128
Effective 1-1-65

All distances must be from the outer boundaries of the Section.

Operator Mobil Oil Corporation			Lease Bridges State			Well No. 144		
Section P	Distance 15	Township 17 S	Range 34 E	County Lea				
Actual Footage - Location of Well:								
660		East		460		South		
feet from the		line and		feet from the		line		
4046.1		Abo		Undesignated		Dedicated Acreage 80		Acres

1. Outline the acreage dedicated to the subject well by colored pencil or hatchure marks on the plat below.
2. If more than one lease is dedicated to the well, outline each and identify the ownership thereof (both as to working interest and royalty).
3. If more than one lease of different ownership is dedicated to the well, have the interests of all owners been consolidated by communitization, unitization, force-pooling, etc?

☐ Yes ☐ No If answer is "yes," type of consolidation _____

If answer is "no," list the owners and tract descriptions which have actually been consolidated. (Use reverse side of this form if necessary.) _____

No allowable will be assigned to the well until all interests have been consolidated (by communitization, unitization, forced-pooling, or otherwise) or until a non-standard unit, eliminating such interests, has been approved by the Commission.

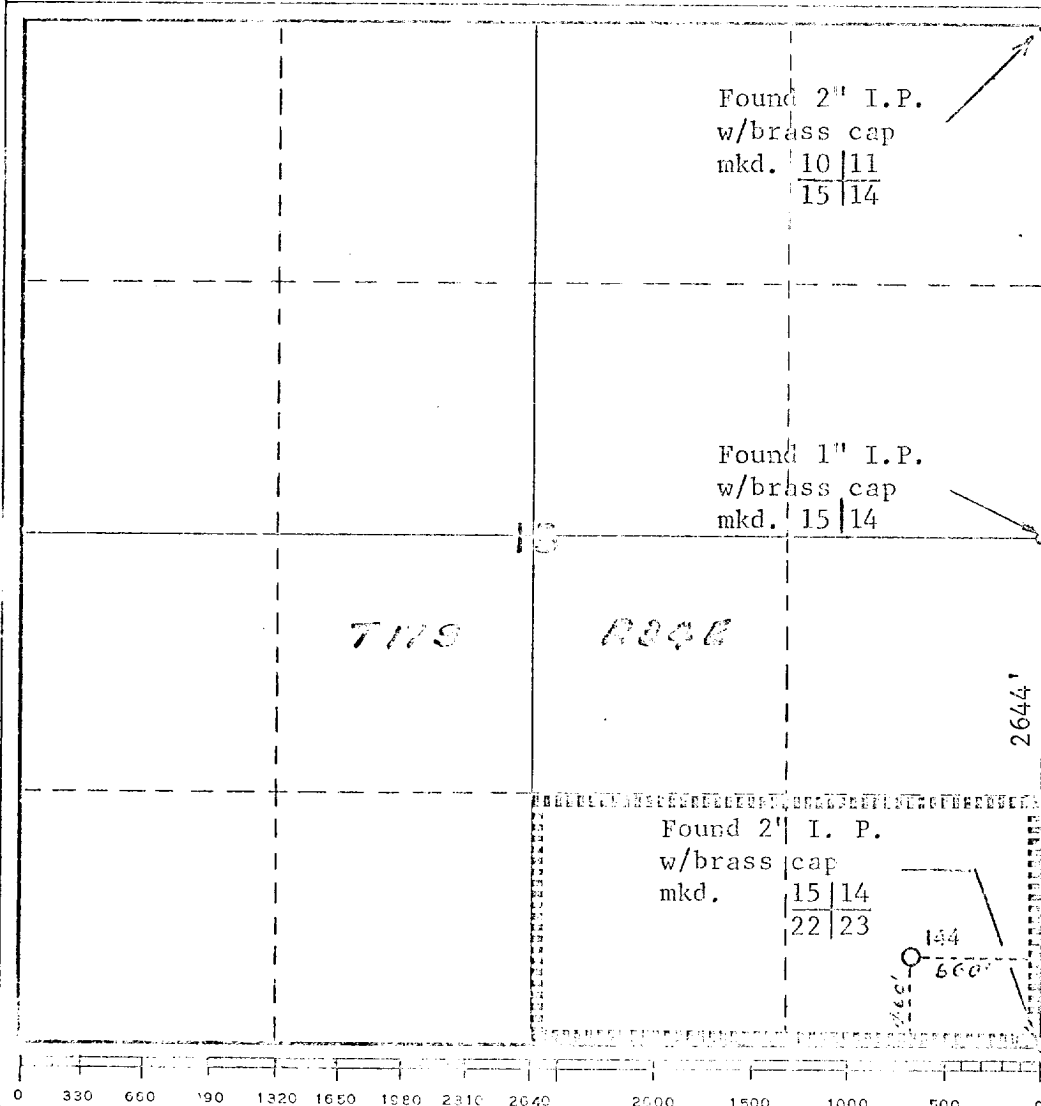

CERTIFICATION

I hereby certify that the information contained herein is true and complete to the best of my knowledge and belief.

A. D. Bond

Name

A. D. Bond

Position

Proration Staff Assistant

Company

Mobil Oil Corporation

Date

August 4, 1970

I hereby certify that the well location shown on this plat was plotted from field notes of actual surveys made by me or under my supervision and that the same is to the best of my knowledge and belief.

NEW MEXICO

Date Surveyed

June 19, 1970

Registered Professional Engineer and/or Land Surveyor

John H. Seerey

Certificate No.

3572

173

RECEIVED

AUG 11 1970

OIL CONSERVATION COM.
WASH. D.C.