

MEXICO OIL CONSERVATION COMMISSION  
Well Location and Acreage Dedication Plat

Section A.

Date December 16, 1958

Operator THE TEXAS COMPANY Lease A. N. Etz  
Well No. 1 Unit Letter P Section 26 Township 19-South Range 38 East NMPM  
Located 660 Feet From South Line, 660 Feet From East Line  
County Lea G. L. Elevation 3588 Dedicated Acreage 40 Acres  
Name of Producing Formation Clear Fork Pool Wildcat (On Structure)

1. Is the Operator the only owner\* in the dedicated acreage outlined on the plat below?  
Yes x No \_\_\_\_\_.
2. If the answer to question one is "no," have the interests of all the owners been consolidated by communitization agreement or otherwise? Yes \_\_\_\_\_ No \_\_\_\_\_. If answer is "yes," Type of Consolidation \_\_\_\_\_
3. If the answer to question two is "no," list all the owners and their respective interests below:

<u>Owner</u>	<u>Land Description</u>

Section B

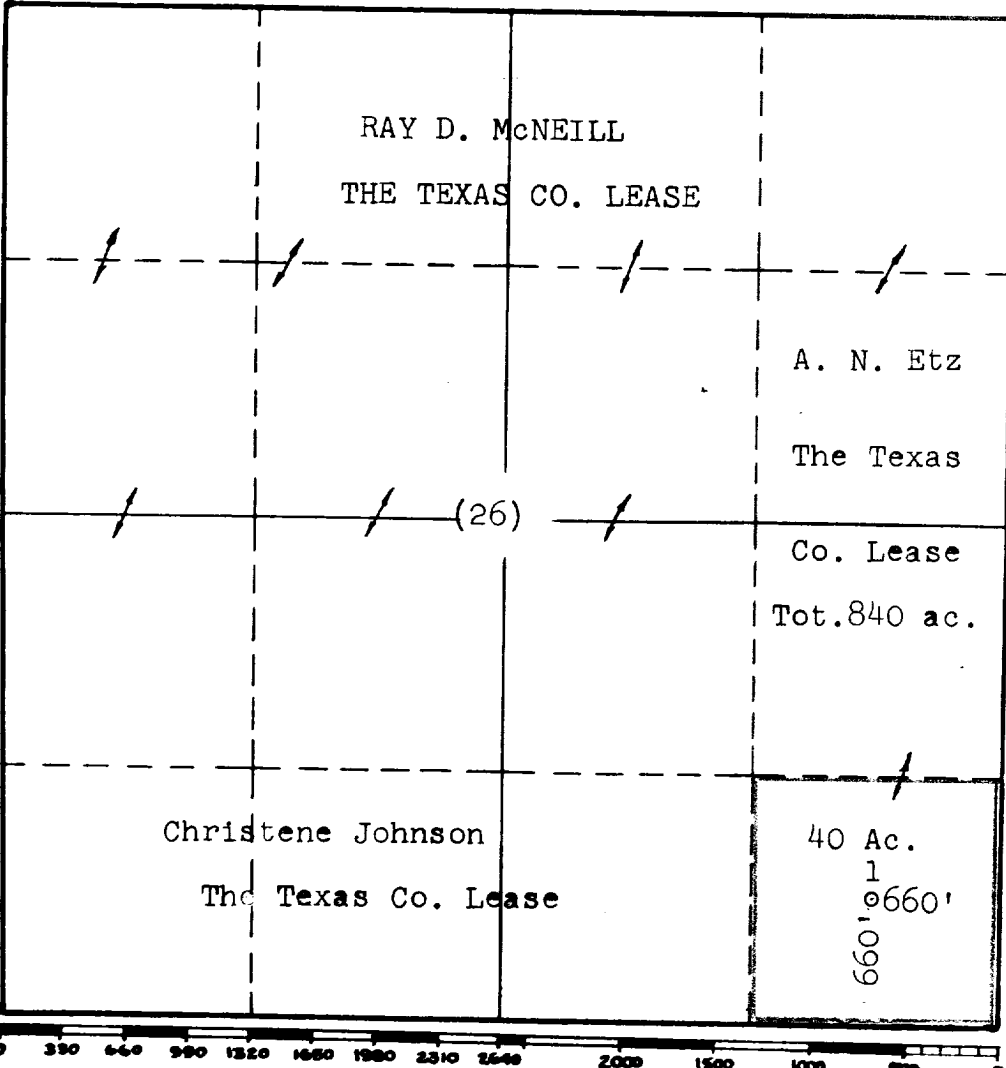

This is to certify that the information in Section A above is true and complete to the best of my knowledge and belief.  
THE TEXAS COMPANY  
(Operator)  
J. J. Felton  
(Representative)  
Division Civil Engineer  
P. O. Box 1720, Ft. Worth, Tex.  
Address

This is to certify that the well location shown on the plat in Section B was plotted from field notes of actual surveys made by me or under my supervision and that the same is true and correct to the best of my knowledge and belief.  
Date Surveyed 12-14-58  
J. J. Felton  
Registered Professional Engineer and/or Land Surveyor.

Certificate No. 8174