



IN REPLY REFER TO:

UNITED STATES
DEPARTMENT OF THE INTERIOR
GEOLOGICAL SURVEY
P. O. Box 1338
Hobbs, New Mexico

July 1, 1957

Continental Oil Company
Box 427
Hobbs, New Mexico

Re: Lease Pat Cruces 131670(b)

Gentlemen:

Receipt is acknowledged of "Notice of Intention to Drill" dated June 23, 1957, covering your well No. 62 SEMU McKee on the subject leasehold in the NE1/4 sec. 20, T. 20 N., R. 33 E., N.M.P.M., Warren McKee Pool, Lea County, New Mexico.

Your proposed work is approved subject to compliance with the provisions of the "Oil and Gas Operating Regulations" revised May 25, 1942, copy of which will be furnished you on request, and subject to the following conditions:

1. Drilling operations so authorized are subject to the attached sheet (revised February 1955) for general conditions of approval.
2. Cement behind the 7 5/8" casing must cover the salt section as determined by temperature survey.

Very truly yours,

T. E. Godfrey
Acting District Engineer

UNITED STATES
DEPARTMENT OF THE INTERIOR
BUREAU OF LAND MANAGEMENT



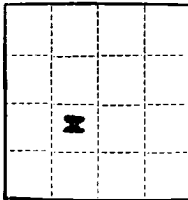

(SUBMIT IN TRIPLICATE)

UNITED STATES
DEPARTMENT OF THE INTERIOR
GEOLOGICAL SURVEY

Land Office Las Cruces
Lease No. 051670 b
Unit N. M. P. U.

SUNDRY NOTICES AND REPORTS ON WELLS

NOTICE OF INTENTION TO DRILL.....	<input checked="" type="checkbox"/>	SUBSEQUENT REPORT OF WATER SHUT-OFF.....	
NOTICE OF INTENTION TO CHANGE PLANS.....		SUBSEQUENT REPORT OF SHOOTING OR ACIDIZING.....	
NOTICE OF INTENTION TO TEST WATER SHUT-OFF.....		SUBSEQUENT REPORT OF ALTERING CASING.....	
NOTICE OF INTENTION TO RE-DRILL OR REPAIR WELL.....		SUBSEQUENT REPORT OF RE-DRILLING OR REPAIR.....	
NOTICE OF INTENTION TO SHOOT OR ACIDIZE.....		SUBSEQUENT REPORT OF ABANDONMENT.....	
NOTICE OF INTENTION TO PULL OR ALTER CASING.....		SUPPLEMENTARY WELL HISTORY.....	
NOTICE OF INTENTION TO ABANDON WELL.....			

(INDICATE ABOVE BY CHECK MARK NATURE OF REPORT, NOTICE, OR OTHER DATA)

SEIU McKee Co. 62

Hobbs, New Mexico

June 28, 1957

Well No. 62 is located 1880 ft. from XXX line and 1980 ft. from W line of sec. 20

SW 1/4 Section 20

208

38E

N. M. P. U.

(1/4 Sec. and Sec. No.)

(Twp.)

(Range)

(Meridian)

Harriet McKee

Lea

New Mexico

(Field)

County or Subdivision

(State or Territory)

The elevation of the derrick floor above sea level is _____ ft.

DETAILS OF WORK

(State names of and expected depths to objective sands; show sizes, weights, and lengths of proposed casings; indicate mudding jobs, cementing points, and all other important proposed work)

It is our intention to drill a well at the above location to a total depth of approximately 9250' with rotary tools in order to continue development of McKee oil reserves and to meet demands of the U. S. G. S. for further development of federal leases comprising the Southeast Monument Unit. All casing points will be cemented in accordance with approved methods of the U. S. G. S. and any other special requirements will be complied with.

It is planned to use the following casing pattern: 10 3/4" to be set at 250' and cemented with approximately 250 sacks, cement to be circulated. 7 5/8" to be set at 4000' and cemented with 1900 sacks. 5 1/2" to be set at 9250' with 375 sacks and perforated opposite the pay zone.

Approval to produce this well upon completion is also requested.

I understand that this plan of work must receive approval in writing by the Geological Survey before operations may be commenced.

Company Continental Oil Company

Address Box 427

Hobbs, New Mexico

By [Signature]

Title District Engineer

100-443887-100

01	02	03	04	05	06	07	08	09	10	11	12	13	14	15	16	17	18	19	20	21	22	23	24	25	26	27	28	29	30	31	32	33	34	35	36	37	38	39	40	41	42	43	44	45	46	47	48	49	50	51	52	53	54	55	56	57	58	59	60	61	62	63	64	65	66	67	68	69	70	71	72	73	74	75	76	77	78	79	80	81	82	83	84	85	86	87	88	89	90	91	92	93	94	95	96	97	98	99	100
----	----	----	----	----	----	----	----	----	----	----	----	----	----	----	----	----	----	----	----	----	----	----	----	----	----	----	----	----	----	----	----	----	----	----	----	----	----	----	----	----	----	----	----	----	----	----	----	----	----	----	----	----	----	----	----	----	----	----	----	----	----	----	----	----	----	----	----	----	----	----	----	----	----	----	----	----	----	----	----	----	----	----	----	----	----	----	----	----	----	----	----	----	----	----	----	----	----	----	-----

[illegible]

WOTO 10 1-10-68

1120

1000 of each

1070-1075 44-1070-1075

NEW MEXICO OIL CONSERVATION COMMISSION
Well Location and Acreage Dedication Plat

Section A.

Date 6-28-57

Operator Continental Oil Company Lease SEMU McKee
Well No. 62 Unit Letter K Section 20 Township 20 S Range 38 E NMFM
Located 1880 Feet From South Line, 1980 Feet From West Line
County Lea G. L. Elevation _____ Dedicated Acreage 40 Acres
Name of Producing Formation McKee Pool McKee

1. Is the Operator the only owner* in the dedicated acreage outlined on the plat below?
Yes X No _____.
2. If the answer to question one is "no," have the interests of all the owners been consolidated by communitization agreement or otherwise? Yes _____ No _____. If answer is "yes," Type of Consolidation _____
3. If the answer to question two is "no," list all the owners and their respective interests below:

Owner

Land Description

Section B

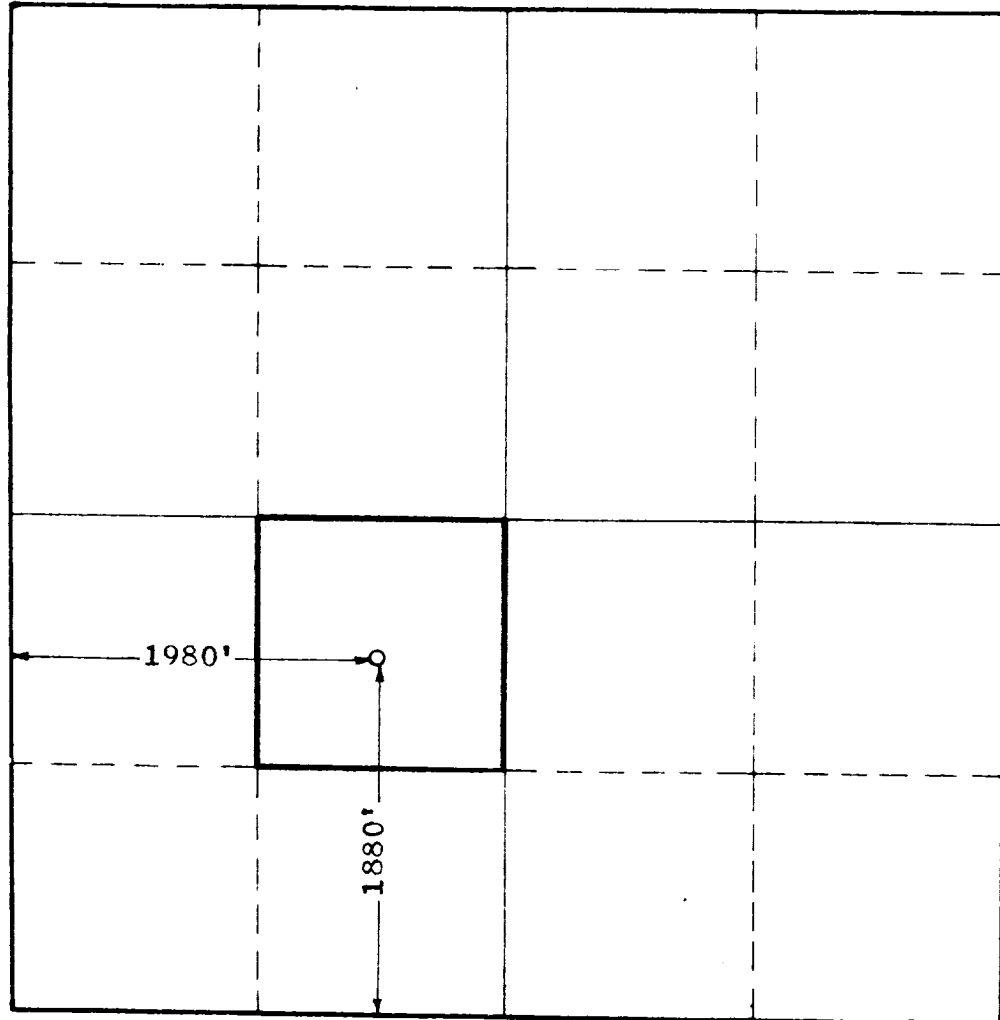

This is to certify that the information in Section A above is true and complete to the best of my knowledge and belief.

Continental Oil Company
(Operator)

(Representative)

Box 427, Hobbs, N. M.
Address

This is to certify that the well location shown on the plat in Section B was plotted from field notes of actual surveys made by me or under my supervision and that the same is true and correct to the best of my knowledge and belief.

Date Surveyed 6-27-57

John W. West
Registered Professional
Engineer and/or Land Surveyor.

Certificate No. 676