



UNITED STATES
DEPARTMENT OF THE INTERIOR
GEOLOGICAL SURVEY
Box 1838
Baker, New Mexico

IN REPLY REFER TO:

March 20, 1957

Oil Producer Company
113 Central Building
Midland, Texas

Gentlemen:

Re: Lease Law Cases 256011 a)

Receipt is acknowledged of "Notice of Intention to Drill" dated March 19, 1957, covering our well No. 1 Federal on the subject leasehold in the SW 1/4 Sec. 8, T. 21 N., R. 31 W., N.M.P.M., Litterman San Andres Pool, Lea County, New Mexico.

Four proposed work is approved subject to compliance with the provisions of the "Oil and Gas Permitting Regulations" revised May 25, 1952, copy of which will be furnished upon request, and subject to the following condition:

1. Drilling operations to be performed are subject to the attached sheet (revised February 1955) for general conditions of approval.
2. Litterman recent record the 5" production casing must cover the all way down as determined by temperature curves on the production test be isolated by use of a two-stage cementing process.

In accordance with our discussion yesterday, it will be satisfactory for you to run and cement the 4 1/2" casing in the Anhydrite at approximately 1500 feet. If the procedure is followed, you may direct and condition as 2 above and also all inside the 13 3/8" surface casing should you desire to do so.

Very truly yours,

E. A. DuPont
District Engineer

IN REPLY REFER TO

UNITED STATES
DEPARTMENT OF THE INTERIOR
GEOLOGICAL SURVEY



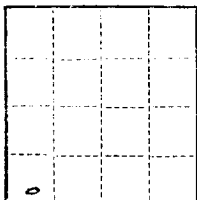

(SUBMIT IN TRIPLICATE)

UNITED STATES
DEPARTMENT OF THE INTERIOR
GEOLOGICAL SURVEY

Land Office _____
Lease No. LC-056011(a)
Unit _____

SUNDRY NOTICES AND REPORTS ON WELLS

NOTICE OF INTENTION TO DRILL	<input checked="" type="checkbox"/>	SUBSEQUENT REPORT OF WATER SHUT-OFF	
NOTICE OF INTENTION TO CHANGE PLANS		SUBSEQUENT REPORT OF SHOOTING OR ACIDIZING	
NOTICE OF INTENTION TO TEST WATER SHUT-OFF		SUBSEQUENT REPORT OF ALTERING CASING	
NOTICE OF INTENTION TO RE-DRILL OR REPAIR WELL		SUBSEQUENT REPORT OF RE-DRILLING OR REPAIR	
NOTICE OF INTENTION TO SHOOT OR ACIDIZE		SUBSEQUENT REPORT OF ABANDONMENT	
NOTICE OF INTENTION TO PULL OR ALTER CASING		SUPPLEMENTARY WELL HISTORY	
NOTICE OF INTENTION TO ABANDON WELL			

(INDICATE ABOVE BY CHECK MARK NATURE OF REPORT, NOTICE, OR OTHER DATA)

March 19, 19 57

Well No. 1 is located 330 ft. from N line and 600 ft. from E line of sec. 8
NE/4 Sec. 8 21-3 34-2 NMPM
(1/4 Sec. and Sec. No.) (Twp.) (Range) (Meridian)
Littman San Andres Lea New Mexico
(Field) (County or Subdivision) (State or Territory)

The elevation of the derrick floor above sea level is unknown.

DETAILS OF WORK

(State names of and expected depths to objective sands; show sizes, weights, and lengths of proposed casings; indicate mudding jobs, cementing points, and all other important proposed work)

San Andres @ 10 approximately 4400'.

Surface casing 13 3/8" o. d. into red beds at approximately 160', to be cemented.

Intermediate casing 8 5/8" o. d. into anhydrite at approximately 1600', to be mudded off.

Production string casing 1 1/2" o. d. into lime at approximately 4300' to be cemented with 100 sacks cement.

Intermediate casing 8 5/8", to be pulled.

I understand that this plan of work must receive approval in writing by the Geological Survey before operations may be commenced.

Company M&J Producing Company

Address 118 Central Building

Midland, Texas

By Edward H. Judson

Title Vice-President & Secretary

NEW MEXICO
OIL CONSERVATION COMMISSION

Form C-128

Well Location and/or Gas Proration Plat

M.W.J. Producing Co.

Date 3-15-57

Operator And W.D. Anderson & Sons

Lease Federal

Well No 1 Section 8 Township 21 S Range 38E NMPM

Located 330 Feet From South Line, 660 Feet From West Line,

Lea County, New Mexico G. L. Elevation

Name of Producing Formation Pool Dedicated Acreage

(Note: All distances must be from outer boundaries of Section.)

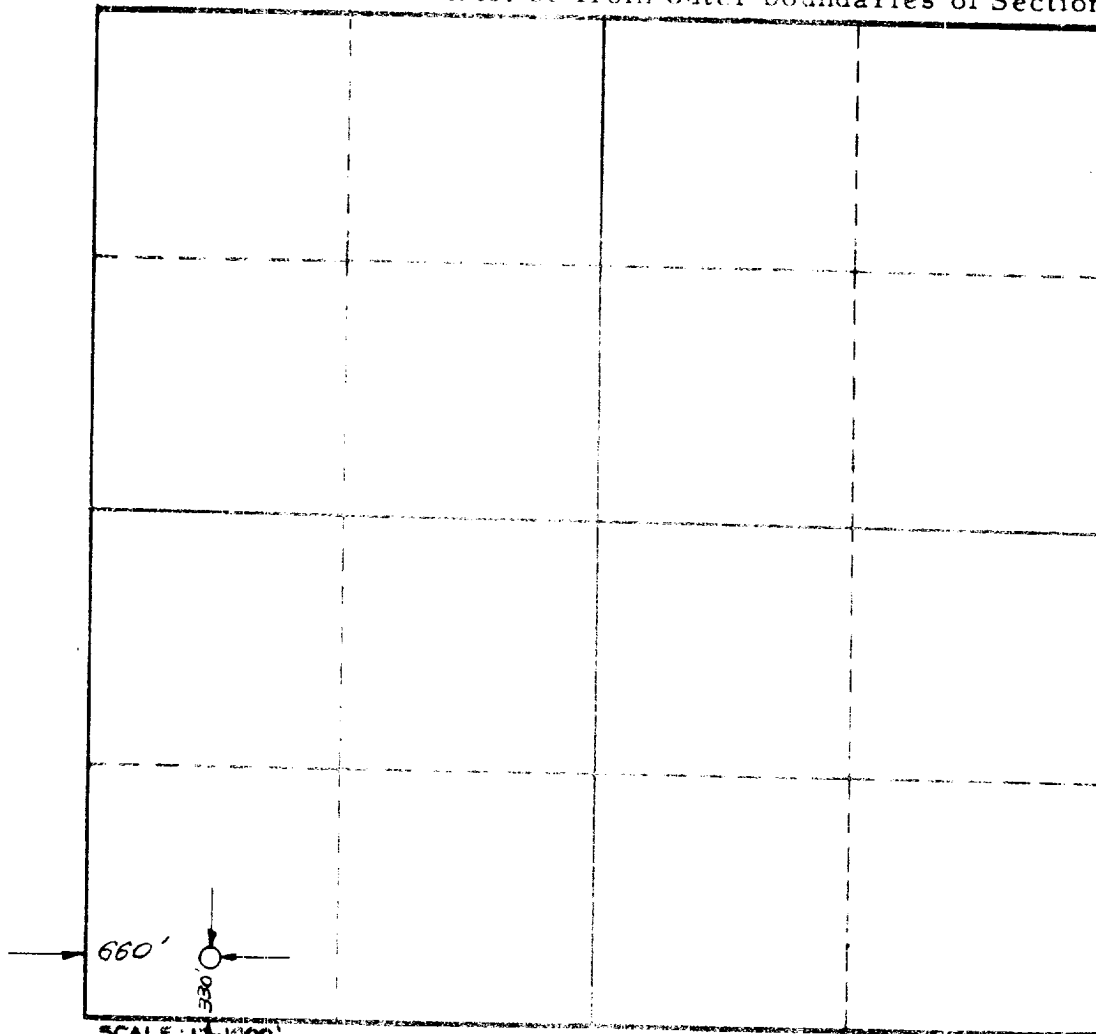

1. Is this Well a Dual Comp. ? Yes No

2. If the answer to Question 1 is yes, are there any other dually completed wells within the dedicated acreage? Yes No

This is to certify that the above plat was prepared from field notes of actual surveys made by me or under my supervision and that the same are true and correct to the best of my knowledge and belief.

Name
Position
Representing
Address

Date Surveyed 3-14-57

Registered Professional Engineer and/or Land Surveyor