

NEW MEXICO OIL CONSERVATION COMMISSION
Santa Fe, New Mexico

Form G-101
Revised (12/1/55)

NOTICE OF INTENTION TO DRILL

Notice must be given to the District Office of the Oil Conservation Commission and approval obtained before drilling or recompletion begins. If changes in the proposed plan are considered advisable, a copy of this notice showing such changes will be returned to the sender. Submit this notice in QUINTUPPLICATE. One copy will be returned following approval. See additional instructions in Rules and Regulations of the Commission.

If State Land submit 6 Copies Attach Form G-128 in triplicate to first 3 copies of form G-101

MIDLAND, TEXAS

(Place)

May 20, 1958

(Date)

OIL CONSERVATION COMMISSION
SANTA FE, NEW MEXICO

Gentlemen:

You are hereby notified that it is our intention to commence the Drilling of a well to be known as

THE BRITISH AMERICAN OIL PRODUCING CO., P.O. BOX 474, MIDLAND, TEXAS

(Company or Operator)

HALL STATE "F"

(Lease)

Well No. 11

in

G

The well is

located 1980 feet from the NORTH line and 2310 feet from the

EAST

line of Section 11

T. 22-S

R. 35-E

NMPM.

(GIVE LOCATION FROM SECTION LINE)

UNDESIGNATED

Pool,

IRA

County

If State Land the Oil and Gas Lease is No. STATE NO. E-8244

If patented land the owner is

Address

We propose to drill well with drilling equipment as follows: ROTARY

The status of plugging bond is \$ 10,000. Continental Casualty Company effective 1947.

Drilling Contractor J.C. Crain Drilling Company
528 Wilson Bldg., Dallas 1, Texas

We intend to complete this well in the YATES SAND formation at an approximate depth of 3800-4100 feet.

CASING PROGRAM

We propose to use the following strings of Casing and to cement them as indicated:

Size of Hole	Size of Casing	Weight per Foot	New or Second Hand	Depth	Sacks Cement
12 1/4"	8 5/8" OD	22.7	NEW	330	200 Sacks
7 7/8"	5 1/2" OD	14.0	NEW	4100	250 Sacks

If changes in the above plans become advisable we will notify you immediately.

ADDITIONAL INFORMATION (If recompletion give full details of proposed plan of work.)

NOTE: Please call collect Approval to Drill to: Cecil E. Brandon, Dist. Supt.,
Phone MU 3-4201, Midland, Texas

Approved _____, 19____
Except as follows:

Sincerely yours,

The British American Oil Producing Co.
(Company or Operator)

By German B. French
Position Dist. Clerk

Send Communications regarding well to

Name Cecil E. Brandon, Dist. Supt.

Address Box 474, Midland, Texas

OIL CONSERVATION COMMISSION

By _____

NEW MEXICO OIL CONSERVATION COMMISSION
Well Location and Acreage Dedication Plat

Section A.

Date MAY 20. 1958

Operator BRITISH AMER. OIL PROD'G CO. Lease HALL-STATE "F"
Well No. 11 Unit Letter G Section 11 Township 22-S Range 35-E NMPM
Located 1980 Feet From NORTH Line, 2310 Feet From EAST Line
County LEA G. L. Elevation 3612 Dedicated Acreage 40 Acres
Name of Producing Formation VATES-SAND Pool JALNET

1. Is the Operator the only owner* in the dedicated acreage outlined on the plat below?
Yes Yes No _____.
2. If the answer to question one is "no," have the interests of all the owners been consolidated by communitization agreement or otherwise? Yes _____ No _____. If answer is "yes," Type of Consolidation _____
3. If the answer to question two is "no," list all the owners and their respective interests below:

Owner

Land Description

Section B

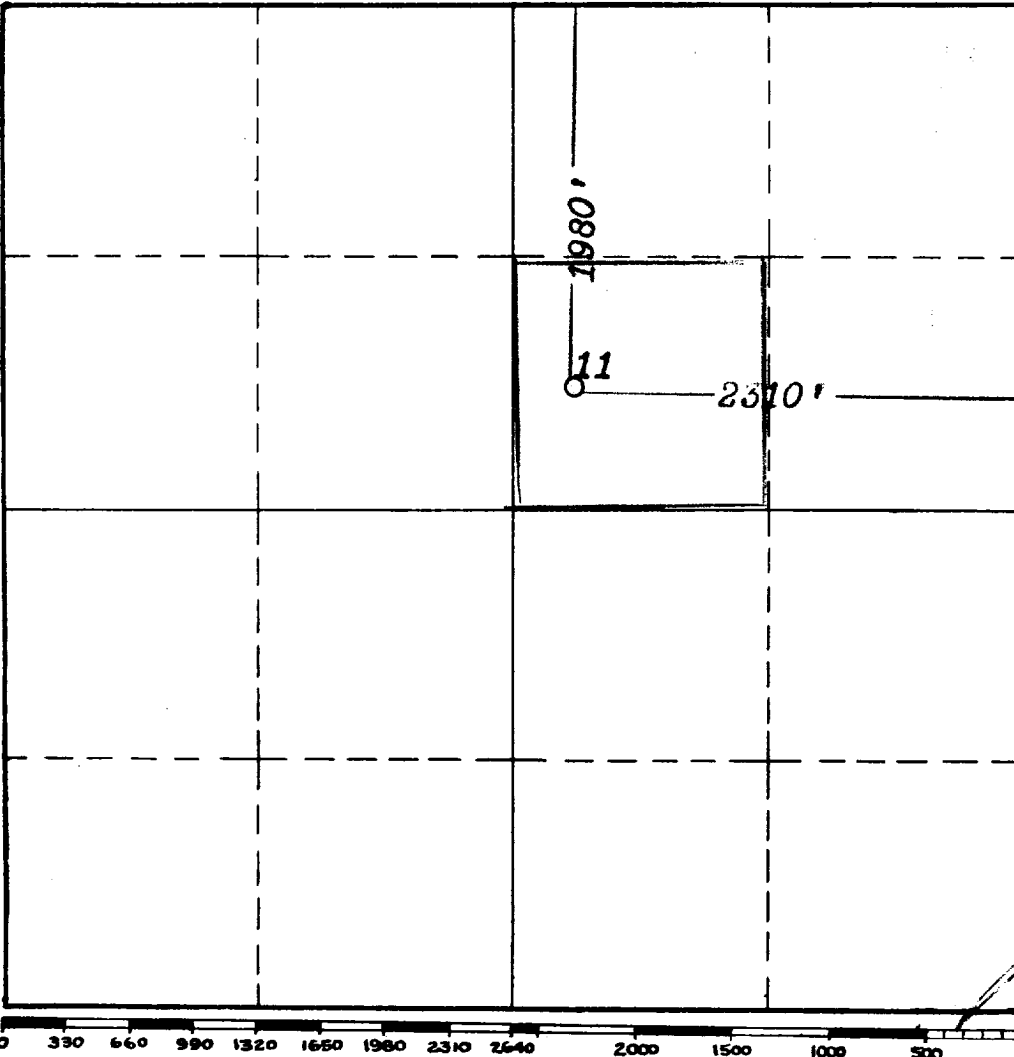

This is to certify that the information in Section A above is true and complete to the best of my knowledge and belief.

The British American Oil
Producing Co.
(Operator)

Vernon B. French
(Representative)

German B. French, Dist. Clerk
Box 171, Midland, Texas
Address

This is to certify that the well location shown on the plat in Section B was plotted from field notes of actual surveys made by me or under my supervision and that the same is true and correct to the best of my knowledge and belief.

Date Surveyed MAY 19, 1958

[Signature]
Registered Professional
Engineer and/or Land Surveyor.

Certificate No. 754

(See instructions for completing this form on the reverse side)

INSTRUCTIONS FOR COMPLETION:

1. Operator shall furnish and certify to the information called for in Section A.
2. Operator shall outline the dedicated acreage for both oil and gas wells on the plat in Section B.
3. A registered professional engineer or land surveyor registered in the State of New Mexico or approved by the Commission shall show on the plat the location of the well and certify this information in the space provided.
4. All distances shown on the plat must be from the outer boundaries of Section.
5. If additional space is needed for listing owners and their respective interests as required in question 3, Section A, please use space below

* "Owner" means the person who has the right to drill into and to produce from any pool and to appropriate the production either for himself or for himself and another. (65-3-29 (e) NMSA 1953 Comp.)