

NEW MEXICO OIL CONSERVATION COMMISSION

Santa Fe, New Mexico

NOTICE OF INTENTION TO DRILL OR RECOMPLETE

Notice must be given to the District Office of the Oil Conservation Commission and approval obtained before drilling or recompletion begins. If changes in the proposed plan are considered advisable, a copy of this notice showing such changes will be returned to the sender. Submit this notice in QUINTUPLICATE. One copy will be returned following approval. See additional instructions in Rules and Regulations of the Commission.

If State Land submit 6 Copies

MIDLAND, TEXAS

(Place)

DECEMBER 22, 1956

(Date)

OIL CONSERVATION COMMISSION
SANTA FE, NEW MEXICO

Gentlemen:

You are hereby notified that it is our intention to commence the (Drilling) (Recompletion) of a well to be known as
THE BRITISH AMERICAN OIL PRODUCING COMPANY

(Company or Operator)

NEW MEXICO "B"

(Lease)

, Well No. **7**, in **Q** The well is

(Unit)

located **1900** feet from the **North** line and **1650** feet from the

EAST

Line of Section **14**, T. **22-S**, R. **35-E**, NMPM.

(GIVE LOCATION FROM SECTION LINE)

JALMAT

Pool,

LEA

County

If State Land the Oil and Gas Lease is No. **E-6173**

If patented land the owner is

Address

We propose to drill well with drilling equipment as follows: **Rotary to T.D. of 4100'**

The status of plugging bond is **\$ 10,000 Continental Casualty Company**
effective 1947.

Drilling Contractor **Unknown**

We intend to complete this well in the **Yates Formation**

formation at an approximate depth of **3800-4100** feet.

CASING PROGRAM

We propose to use the following strings of Casing and to cement them as indicated:

Size of Hole	Size of Casing	Weight per Foot	New or Second Hand	Depth	Sacks Cement
12 1/4"	8 5/8"OD	22.7#	New	320	350
7 7/8"	5 1/2"OD	14.0#	New	4100	250

If changes in the above plans become advisable we will notify you immediately.

ADDITIONAL INFORMATION (If recompletion give full details of proposed plan of work.)

Note: Please Telephone approval collect to: C.E.Brandon, Dist. Supt. Phone MU 2-3240, Midland, Texas

Approved **DEC 22 1956**, 19

Except as follows:

Sincerely yours,

The British American Oil Producing Co.

(Company or Operator)

By

Cecil E. Brandon
Dist. Supt.

Position

Send Communications regarding well to

Name **The British American Oil Producing Company**

Address **P.O. Box 2818, Midland, Texas**

OIL CONSERVATION COMMISSION

By

R. F. Montgomery

NEW MEXICO
OIL CONSERVATION COMMISSION

Form C-128

Well Location and/or Gas Proration Plat

Date Dec. 20, 1956

Operator BRITISH AMERICAN OIL PROD'G CO. Lease NEW MEXICO "B" E/2 SEC. 14

Well No. 7 Section 14 Township 22-S Range 35-E NMPM

Located 1980 Feet From NORTH Line, 1650 Feet From EAST Line,

LEA County, New Mexico. G. L. Elevation 3589

Name of Producing Formation YATES-SAND Pool JALMAT Dedicated Acreage 40

(Note: All distances must be from outer boundaries of Section)

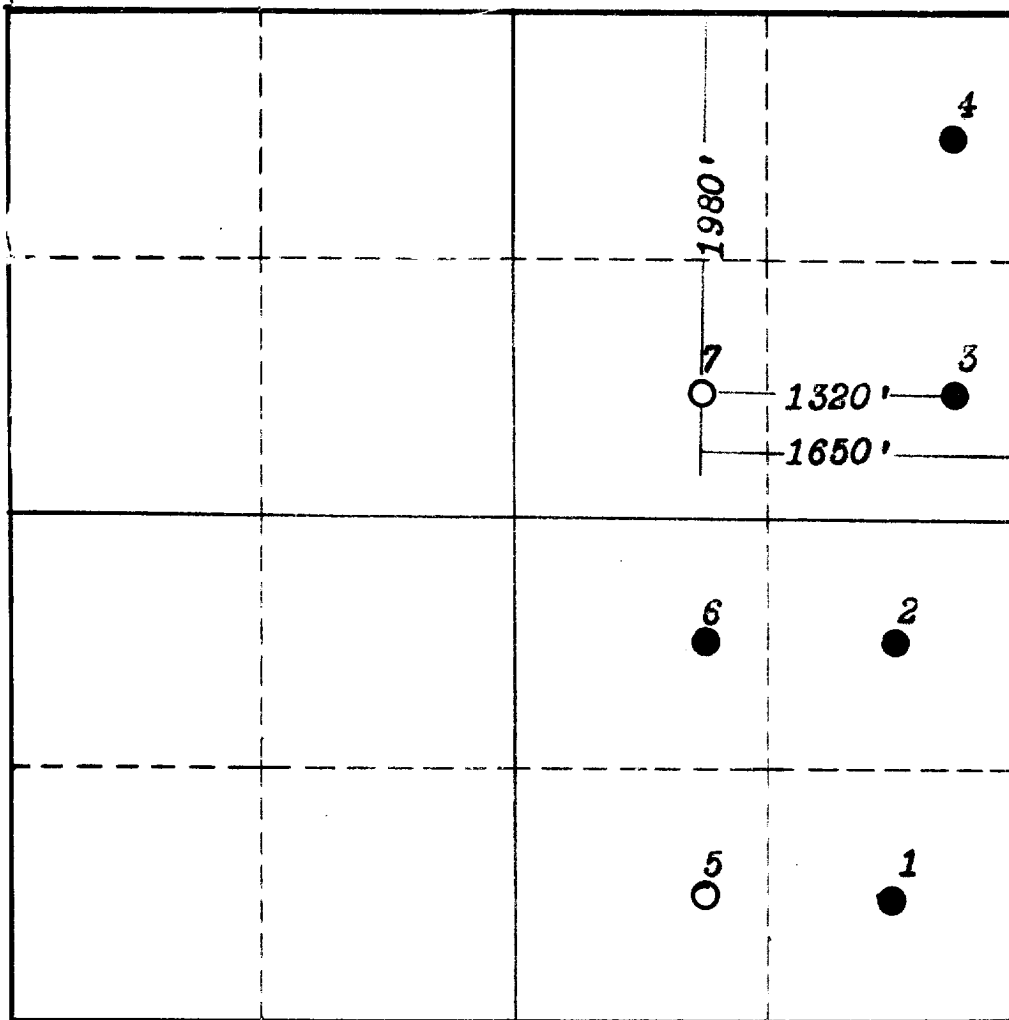

NOTE

This section of
form is to be
used for gas
wells only.



SCALE: 1"=1000'

1. Is this Well a Dual Comp. ? Yes ___ No ___
2. If the answer to Question 1 is yes, are there any other dually completed wells within the dedicated acreage ? Yes ___ No ___

Name _____
Position _____
Representing _____
Address _____

This is to certify that the above plat was prepared from field notes of actual surveys made by me or under my supervision and that the same are true and correct to the best of my knowledge and belief.

Date Surveyed Dec. 20, 1956

Joseph M. Anderson
Registered Professional Engineer and/or
Land Surveyor