

NEW MEXICO OIL CONSERVATION COMMISSION
MISCELLANEOUS REPORTS ON WELLS
(Submit to appropriate District Office as per Commission Rule 1106)

COMPANY Shell Oil Company Box 1957 Hobbs, New Mexico
(Address)

LEASE State WELL NO. 20 UNIT "V" S-2 T-21-S R-37-E
DATE WORK PERFORMED April 17, 1956 POOL Terry Blinebry

This is a Report of: (Check appropriate block) ☒ Results of Test of Casing Shut-off
☐ Beginning Drilling Operations ☐ Remedial Work
☐ Plugging ☐ Other _____

Detailed account of work done, nature and quantity of materials used and results obtained.

Ran 270' of 13-3/8" casing and cemented at 283' with 300 sacks regular neat cement.
Plug down at 12:22 P. M. April 17, 1956. Circulated out an estimated 50 sacks
cement. After WOC 24 hours tested casing and cement with 500 psi for 30 minutes
before and after drilling plug. Test OK.

FILL IN BELOW FOR REMEDIAL WORK REPORTS ONLY

Original Well Data:

DF Elev. _____ TD _____ PBD _____ Prod. Int. _____ Compl Date _____
Tbng. Dia _____ Tbng Depth _____ Oil String Dia _____ Oil String Depth _____
Perf Interval (s) _____
Open Hole Interval _____ Producing Formation (s) _____

RESULTS OF WORKOVER:

BEFORE AFTER

Date of Test	_____	_____
Oil Production, bbls. per day	_____	_____
Gas Production, Mcf per day	_____	_____
Water Production, bbls. per day	_____	_____
Gas-Oil Ratio, cu. ft. per bbl.	_____	_____
Gas Well Potential, Mcf per day	_____	_____

Witnessed by B. L. Simmers Drilling Foreman Shell Oil Company
(Company)

OIL CONSERVATION COMMISSION

Name C. M. Lueder
Title Engineer
Date APR 25 1956

I hereby certify that the information given
above is true and complete to the best of
my knowledge.

Original signed by
Name D. C. Meyers D. C. Meyers
Position Division Mechanical Engineer
Company Shell Oil Company

NEW MEXICO OIL CONSERVATION COMMISSION
MISCELLANEOUS REPORTS ON WELLS
Submit to appropriate District Office as per Commission Rule 1106
HOBBBS OFFICE OCC
APR 19 PM 3:45

COMPANY Shell Oil Company Box 1957 Hobbs, New Mexico 3:45
(Address)

LEASE State WELL NO. 20 UNIT "V" S -2 T -21-S R -37-E
DATE WORK PERFORMED April 16, 1956 POOL Terry Blinbry

This is a Report of: (Check appropriate block) ☐ Results of Test of Casing Shut-off
☒ Beginning Drilling Operations ☐ Remedial Work
☐ Plugging ☐ Other _____

Detailed account of work done, nature and quantity of materials used and results obtained.

Spudded 7:00 P. M. April 16, 1956

FILL IN BELOW FOR REMEDIAL WORK REPORTS ONLY

Original Well Data:

DF Elev. _____ TD _____ PBD _____ Prod. Int. _____ Compl Date _____
Tbng. Dia _____ Tbng Depth _____ Oil String Dia _____ Oil String Depth _____
Perf Interval (s) _____
Open Hole Interval _____ Producing Formation (s) _____

RESULTS OF WORKOVER:	BEFORE	AFTER
Date of Test	_____	_____
Oil Production, bbls. per day	_____	_____
Gas Production, Mcf per day	_____	_____
Water Production, bbls. per day	_____	_____
Gas-Oil Ratio, cu. ft. per bbl.	_____	_____
Gas Well Potential, Mcf per day	_____	_____
Witnessed by <u>B. L. Simmers</u> Drilling Foreman <u>Shell Oil Company</u>		
	(Company)	

OIL CONSERVATION COMMISSION	I hereby certify that the information given above is true and complete to the best of my knowledge.	Original signed by
Name <u>C. M. Lueder</u>	Name <u>D. C. Meyers</u>	D. C. Meyers
Title _____	Position <u>Division Mechanical Engineer</u>	
Date _____	Company <u>Shell Oil Company</u>	

NEW MEXICO OIL CONSERVATION COMMISSION
Santa Fe, New Mexico

NOTICE OF INTENTION TO DRILL OR RECOMPLETE

Notice must be given to the District Office of the Oil Conservation Commission and approval obtained before drilling or recompletion begins. If changes in the proposed plan are considered advisable, a copy of this notice showing such changes will be returned to the sender. Submit this notice in QUINTUPPLICATE. One copy will be returned following approval. See additional instructions in Rules and Regulations of the Commission.

Hobbs, New Mexico
(Place)

April 1, 1956
(Date)

OIL CONSERVATION COMMISSION
SANTA FE, NEW MEXICO

Gentlemen:

You are hereby notified that it is our intention to commence the (Drilling) (~~Recompletion~~) of a well to be known as

Shell Oil Company
(Company or Operator)

State

Well No. 20

in (Unit)

The well is

located 200 feet from the South line and 200 feet from the

East

line of Section 2, T. 21-S, R. 37-S, NMPM.

(GIVE LOCATION FROM SECTION LINE) Terry-Blinebry Pool, 1st County

2-37-S

D	C	B	A
E	F	G	H
L	K	J	I
M	N	O	P

Section 2

If State Land the Oil and Gas Lease is No. 1-9745

If patented land the owner is

Address

We propose to drill well with drilling equipment as follows:

The status of plugging bond is Blank et Bond

Drilling Contractor Moran Drilling Company

We intend to complete this well in the Blinebry

formation at an approximate depth of 500 feet.

CASING PROGRAM

We propose to use the following strings of Casing and to cement them as indicated:

Size of Hole	Size of Casing	Weight per Foot	New or Second Hand	Depth	Sacks Cement
17"	13 3/8"	40#	New	300'	300
11"	8 5/8"	30#	New	3250'	1500
7 7/8"	5 1/2"	15.5#	New	5005'	100

If changes in the above plans become advisable we will notify you immediately.

ADDITIONAL INFORMATION (If recompletion give full details of proposed plan of work.)

Approved _____, 19____
Except as follows:

OIL CONSERVATION COMMISSION

By _____

Title _____

Sincerely yours,

Shell Oil Company
(Company or Operator)

By

B. Nevill

Position Division Exploitation Engineer

Send Communications regarding well to

Name Shell Oil Company

Address Box 1957

Hobbs, New Mexico

Original signed by
B. Nevill

NEW MEXICO
OIL CONSERVATION COMMISSION

Form C-128

Well Location and/or Gas Proration Plat

Date Jul 1, 1956

Operator Shell Oil Company Lease State

Well No. 20 Section 2 Township 1-S Range 37-S NMPM

Located 990 Feet From South Line, 2300 Feet From East Line,

Las County, New Mexico. G. L. Elevation Not available

Name of Producing Formation Alinobry Pool Alinobry Dedicated Acreage 10

(Note: All distances must be from outer boundaries of Section)

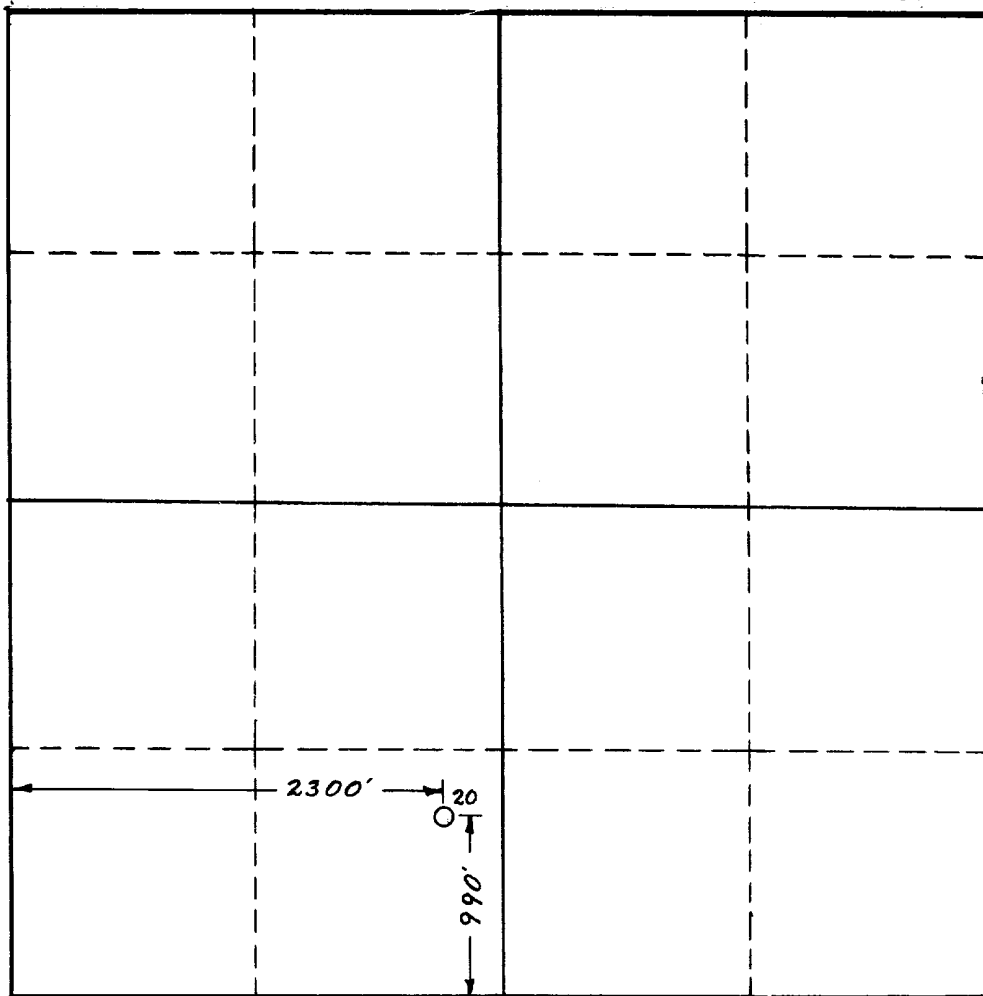

SCALE: 1"=1000'

HOBBS OFFICE OCC
1956 MAR 30 AM 9:24

1. Is this Well a Dual Comp. ? Yes No x

2. If the answer to Question 1 is yes, are there any other dually completed wells within the dedicated acreage? Yes No

Name E. Merrill
Position Division Exploitation Engineer
Presenting Shell Oil Company
Address Box 1957, Hobbs, New Mexico

This is to certify that the above plat was prepared from field notes of actual surveys made by me or under my supervision and that the same are true and correct to the best of my knowledge and belief.

Date Surveyed 2-22-56
Paul R. Shepard N.M. Cert #1467
Registered Professional Engineer and/or
Land Surveyor