

udget Bureau No. 42-R358.4.  
orin Approved.

			X

APR 10 1988 (SUBMIT IN TRIPLICATE)

UNITED STATES  
E. G. HUBBLE  
ACTING DISTRICT ENGINEER  
DEPARTMENT OF THE INTERIOR  
GEOLOGICAL SURVEY

Land Office ----- 1-1-1902

Lease No. 031741 b

Unit 1

APR 16 1963

## SUNDRY NOTICES AND REPORTS ON WELLS

NOTICE OF INTENTION TO DRILL	✓	SUBSEQUENT REPORT OF WATER SHUT-OFF
NOTICE OF INTENTION TO CHANGE PLANS		SUBSEQUENT REPORT OF SHOOTING OR ACIDIZING
NOTICE OF INTENTION TO TEST WATER SHUT-OFF		SUBSEQUENT REPORT OF ALTERING CASING
NOTICE OF INTENTION TO RE-DRILL OR REPAIR WELL		SUBSEQUENT REPORT OF RE-DRILLING OR REPAIR
NOTICE OF INTENTION TO SHOOT OR ACIDIZE		SUBSEQUENT REPORT OF ABANDONMENT
NOTICE OF INTENTION TO PULL OR ALTER CASING		SUPPLEMENTARY WELL HISTORY
NOTICE OF INTENTION TO ABANDON WELL		

(INDICATE ABOVE BY CHECK MARK NATURE OF REPORT, NOTICE, OR OTHER DATA)

Hawk B-1

April 9, 1963

Well No. 13 is located 1900 ft. from S line and 660 ft. from E line of sec. 9

NE/4 SE/4 Sec. 9  
(1/4 Sec. and Sec. No.)

21-8  
(Twp.)

**37-**  
(Range)

**MEM**  
(Meridian)

Drinkard & Elinsbry  
(Field)

**Log**

New Mexico  
(State or Territory)

The elevation of the derrick floor above sea level is \_\_\_\_\_ ft.

## DETAILS OF WORK

(State names of and expected depths to objective sands; show sizes, weights, and lengths of proposed casings; indicate mudding jobs, cementing points, and all other important proposed work)

It is intended to drill a well with rotary tools at the above location to an approximate total depth of 6750' in the Drinkard & Elinebry formations. Casing will be set in accordance with USGS regulations and other special requirements will be complied with.

The following casing pattern is planned: 9-5/8" OD 36# H-40 set at 1300' with 450 sacks cement, cement to circulate; 5-1/2" OD 14 & 15.5# J-55 set at 6750' with 500 sacks cement, cement to return to 2400'.

Permission to produce this well upon completion is also requested.

**I understand that this plan of work must receive approval in writing by the Geological Survey before operations may be commenced.**

Company ----- Continental Oil Company

Address Box 68 Dunice, New Mexico

By

~~1300-5 w/5 plates; HEDCC-2 w/2 plates; NAM Title District Superintendent~~  
~~HRR-plate File Pan Am-HBO-3 Atl-Rose-2~~  
~~Calif.-Houst. Mid - 1 each~~

GPO 9149

NEW MEXICO OIL CONSERVATION COMMISSION  
WELL LOCATION AND ACREAGE DEDICATION PLAT

FORM C-126  
Revised 9/1/57

SEE INSTRUCTIONS FOR COMPLETING THIS FORM ON THE REVERSE SIDE

SECTION A

Operator <b>CONTINENTAL OIL COMPANY</b>			Lease <b>HAWK B-1</b>		Well No. <b>13</b>
Unit Letter <b>1</b>	Section <b>9</b>	Township <b>21 SOUTH</b>	Range <b>37 EAST</b>	County <b>LEA</b>	
Actual Footage Location of Well: <b>1980</b> feet from the <b>SOUTH</b> line and <b>660</b> feet from the <b>EAST</b> line					
Ground Level Elev.	Producing Formation		Pool	Dedicated Acreage: Acres	

1. Is the Operator the only owner in the dedicated acreage outlined on the plat below? YES ☒ NO ☐ ("Owner" means the person who has the right to drill into and to produce from any pool and to appropriate the production either for himself or for himself and another. (65-3-29 (e) NMSA 1955 Comp.)
2. If the answer to question one is "no," have the interests of all the owners been consolidated by communitization agreement or otherwise? YES ☐ NO ☐ If answer is "yes," Type of Consolidation \_\_\_\_\_
3. If the answer to question two is "no," list all the owners and their respective interests below:

Owner	Land Description

SECTION B

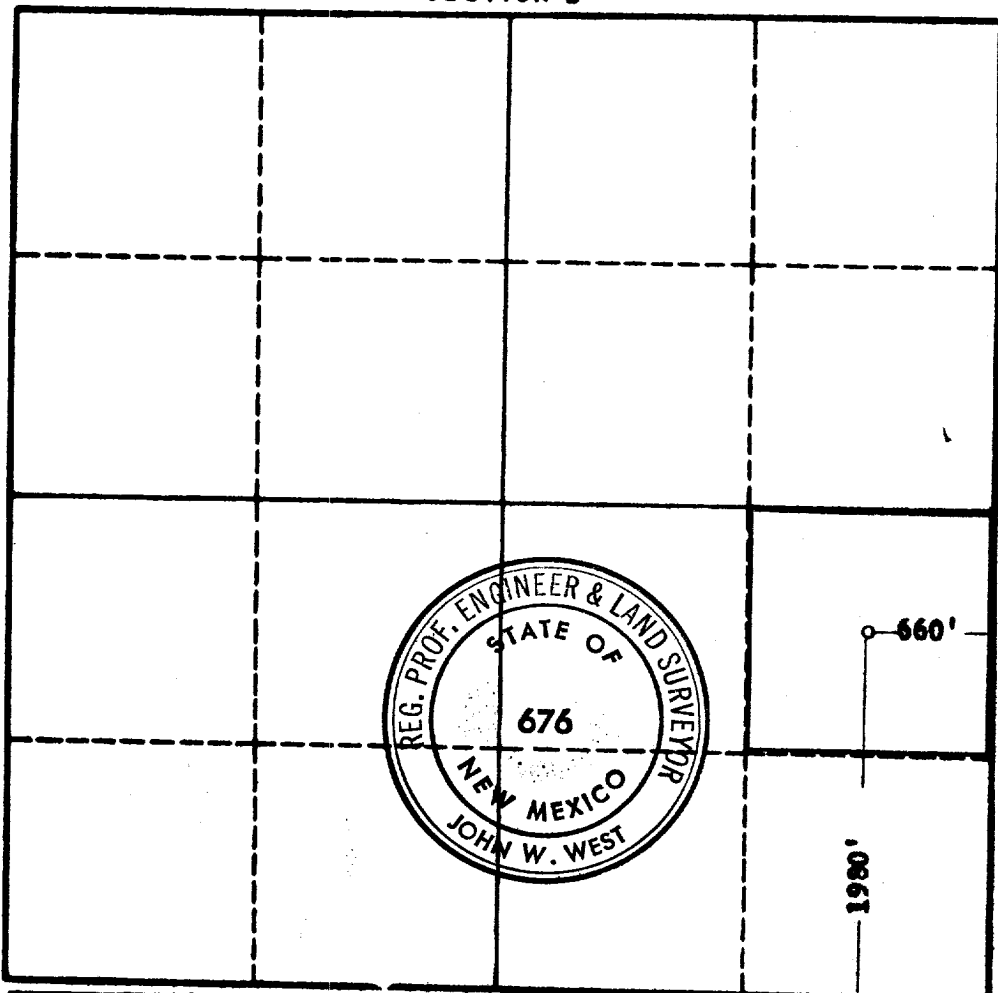

CERTIFICATION

I hereby certify that the information in SECTION A above is true and complete to the best of my knowledge and belief.

Name	<b>SIGNED: J. R. PARKER</b>
Position	<b>[REDACTED]</b>
Company	<b>[REDACTED]</b>
Date	<b>[REDACTED]</b>

I hereby certify that the well location shown on the plat in SECTION B was plotted from field notes of actual surveys made by me or under my supervision, and that the same is true and correct to the best of my knowledge and belief.

Date Surveyed	<b>4-9-53</b>
Registered Professional Engineer and/or Land Surveyor, <b>JOHN W. WEST</b>	
<b>[Signature]</b>	
Certificate No. <b>N. M. - P. E. - D. L. S. NO. 676</b>	

0 330 660 990 1320 1650 1980 2310 2640 2970 3300 3630 3960 4290 4620 4950