

NEW MEXICO OIL CONSERVATION COMMISSION
WELL LOCATION AND ACREAGE DEDICATION PLAT

FORM C-128
Revised 5/1/57

SEE INSTRUCTIONS FOR COMPLETING THIS FORM ON THE REVERSE SIDE

SECTION A

Operator Western Natural Gas Co.		Lease Matkins		1960 APR 25 AM 10:32		Well No. 2	
Unit Letter I	Section 15	Township 23 South	Range 36 East	County Lee County			
Actual Footage Location of Well: 1980 feet from the South line and 660 feet from the East line							
Ground Level Elev. 3300.7	Producing Formation		Pool L. J. Matthews	Dedicated Acreage: 40			Acres

1. Is the Operator the only owner in the dedicated acreage outlined on the plat below? YES ☒ NO ☐ ("Owner" means the person who has the right to drill into and to produce from any pool and to appropriate the production either for himself or for himself and another. (65-3-29 (e) NMSA 1935 Comp.)
2. If the answer to question one is "no," have the interests of all the owners been consolidated by communitization agreement or otherwise? YES ☐ NO ☐ If answer is "yes," Type of Consolidation _____
3. If the answer to question two is "no," list all the owners and their respective interests below:

Owner	Land Description

SECTION B

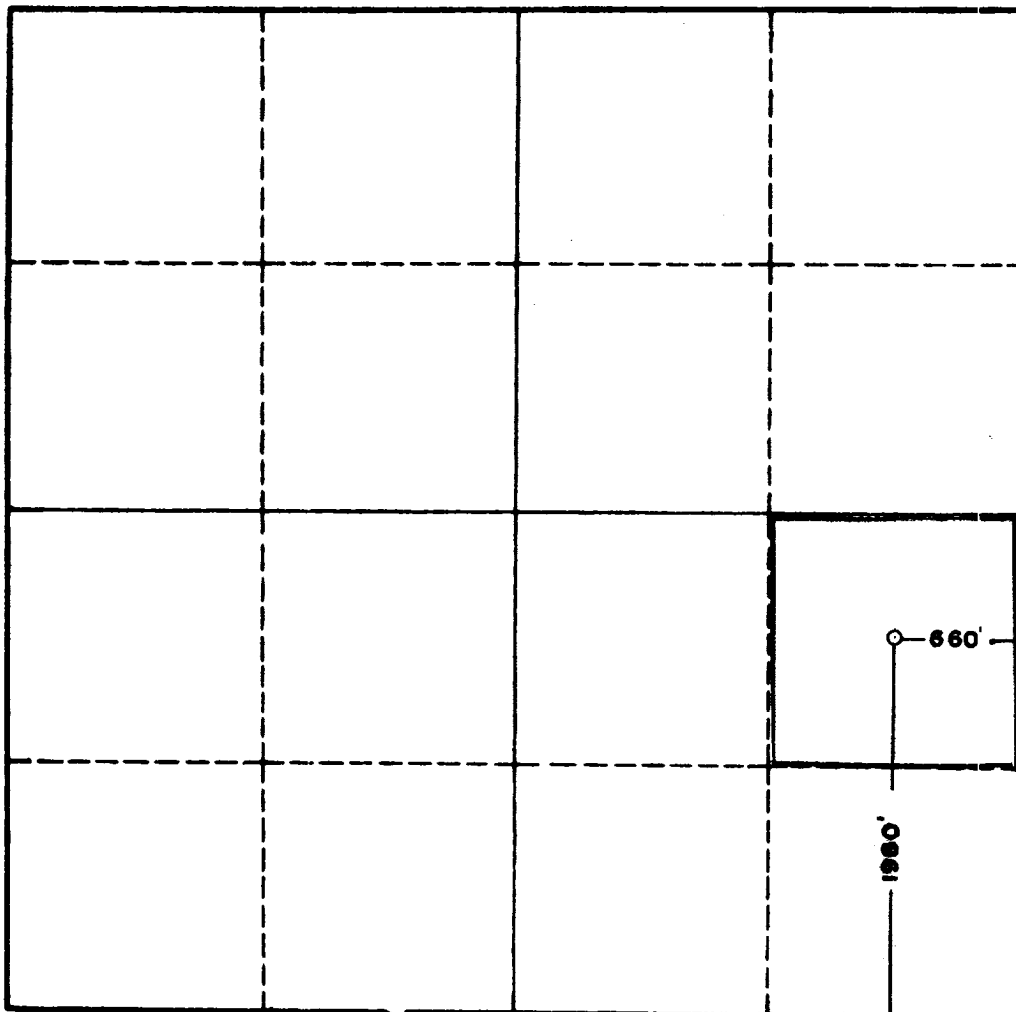

CERTIFICATION

I hereby certify that the information in SECTION A above is true and complete to the best of my knowledge and belief.

Paul Woodward

Name **Paul Woodward**

Position

Office Manager

Company

Western Natural Gas Co.

Date

April 25, 1960

I hereby certify that the well location shown on the plat in SECTION B was plotted from ~~the~~ ^{the} ~~original~~ ^{original} surveys made by me or under my supervision and that the same are true and correct to the best of my knowledge and belief.

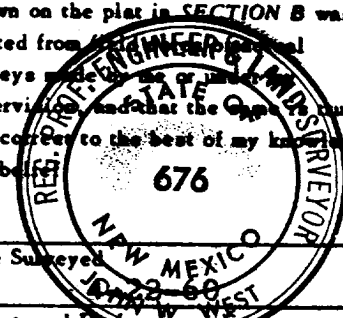

Date Surveyed

Registered Professional Engineer

and/or Land Surveyor, **JOHN W. WEST**

John W. West

Certificate No.

N.M. - P.E. & L.S. NO. 676

0 330 660 990 1320 1650 1980 2310 2640 2000 1500 1000 500 0