

District I  
1625 N. French Dr., Hobbs. NM 88240

District II  
PO Drawer DD, Artesia, NM 88211-0719

District III  
1000 Rio Brazos Rd. Aztec, NM 87410

District IV  
PO Box 2088, Santa Fe. NM 87504-2088

State of New Mexico  
Energy, Minerals & Natural Resources Department

OIL CONSERVATION DIVISION  
PO Box 2088  
Santa Fe, NM 87504-2088

Form C-102

Revised February 21, 1994

Instructions on back

Submit to Appropriate District Office

State Lease - 4 Copies

Fee Lease - 3 Copies

☐ AMENDED REPORT

### WELL LOCATION AND ACREAGE DEDICATION PLAT

API Number 30-025-20977		2 Pool Code 79240	3 Pool Name Jalmat: Tan-Yates-7 rvrs (Pro Gas)
4 Property Code 24669	5 Property Name State "A" A/C 1		6 Well Number 109
7 OGRID No. 162791	8 Operator Name Raptor Resources		9 Elevation

#### 10 Surface Location

UL or lot no.	Section	Township	Range	Lot Idn	Feet from the	North/South line	Feet from the	East/West line	County
A	23	23S	36E		560	North	660	East	Lea

#### 11 Bottom Hole Location If Different From Surface

UL or lot no.	Section	Township	Range	Lot Idn	Feet from the	North/South line	Feet from the	East/West line	County

12 Dedicated Acres 320	13 Joint or Infill	14 Consolidation Code	15 Order No.
---------------------------	--------------------	-----------------------	--------------

NSL-3023-A (SD)

NO ALLOWABLE WILL BE ASSIGNED TO THIS COMPLETION UNTIL ALL INTERESTS HAVE BEEN CONSOLIDATED  
OR A NON-STANDARD UNIT HAS BEEN APPROVED BY THE DIVISION

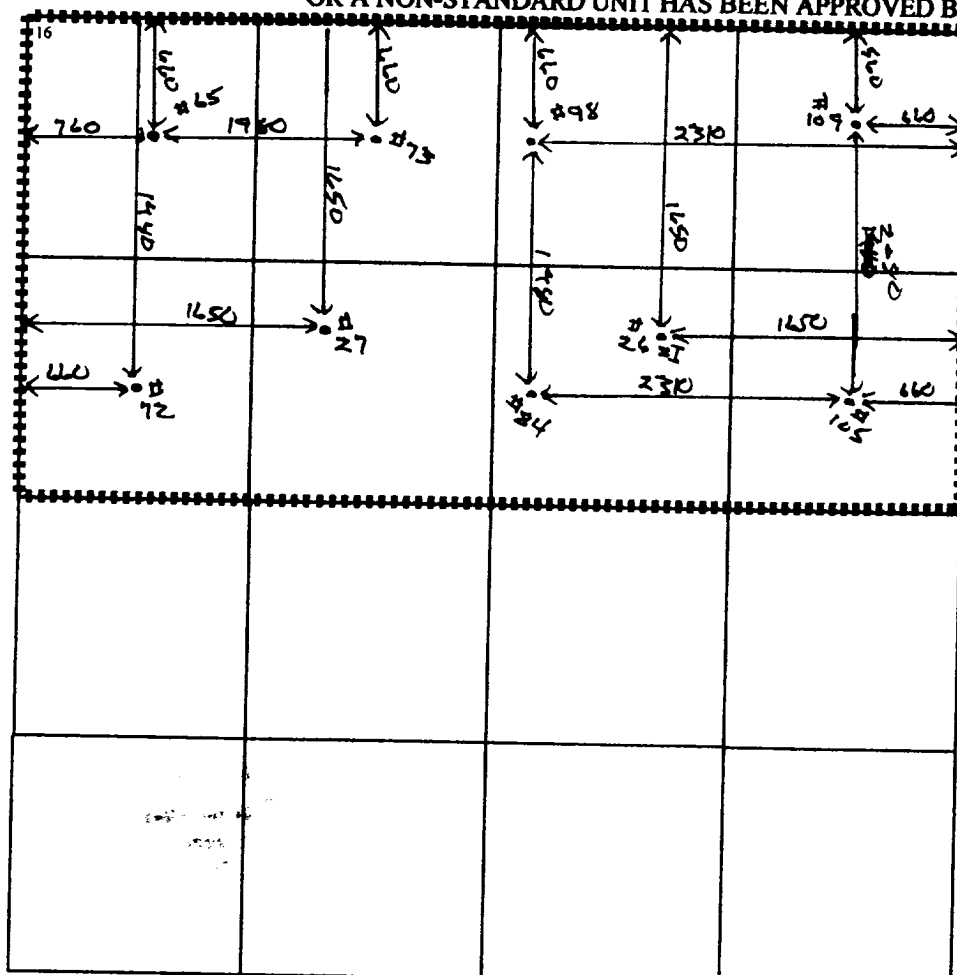

#### 17 OPERATOR CERTIFICATION

I hereby certify that the information contained herein is true and complete to the best of my knowledge and belief

*Bill R. Keathly*  
Signature

Bill R. Keathly  
Printed Name

Regulatory Agent  
Title

4-11-00  
Date

#### 18 SURVEYOR CERTIFICATION

I hereby certify that the well location shown on this plat was plotted from field notes of actual surveys made by me or under my supervision, and that the same is true and correct to the best of my belief.

Date of Survey

Signature and Seal of Professional Surveyor:

Certificate Number

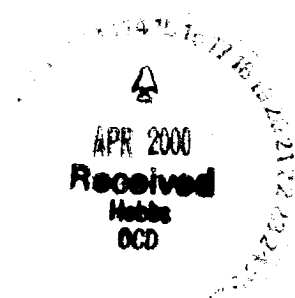

COUNTY	LEA	FIELD	Langlie-Mattix	STATE	N.M.	MAP
OPR	TEXAS PACIFIC OIL COMPANY					
	109 State of New Mexico "A" (Acct. 1)					
	Sec. 23, T-23-S, R-36-E					
	560' fr N Line & 660' fr E Line of Sec.					CU-ORD
	Spud 9-17-64					
	Comp 10-5-64					CLASS

Comp 10-5-64		CLASS			
CSG & SX - TUBING		FORMATION	DATUM	FORMATION	DATUM
7 5/8"	317'	LOG:			
4 1/2"	3670'	Anhy 1193			
	250	Yates 2885			
		7-R 3108			
		Queen 3472			
LOGS EL GR RA IND HC A					
IP Queen Perfs 3523 3620'		TD 3670'			

IP Queen Perfs 3523-3639' Flwd 164 BOPD + 640 BW. Pot. Based  
on 12 hr test of 82 BO + 320 BW thru 30/64" chk., TP 140#,  
CP 860#, GOR 1512.

Distribution limited and publication prohibited by subscribers' agreement.  
Reproduction rights reserved by Williams & Lee Scouting Service, Inc.

CONT. FWA Drlg. Co.  
DATE

PROP DEPTH 3665' TYPE

F.R. 9-17-64; Oper's Elev. 3355' Df  
PD 3665' - Queen  
Contractor - FWA Drlg. Co.  
9-21-64 Drlg. 3200',  
9-28-64 TD 3670', flwg load.  
Perf @ 3601', 3611', 3615', 3623', 3634', 3639',  
Ac. 500 gals.  
Frac 20,000 gals oil + 20,000# sd.  
Swbd & Flwd 447 BLO/20 hrs thru 20/64" chk.,  
10-5-64 TP 300#. (-137 BLO).  
TD 3670', prep to potential.  
Flwd 220 EO + 95 BW in 24 hrs thru 20/64" chk.  
from perfs 3601-3639'.  
Perf @ 3523', 3532', 3541', 3547', 3555'  
Set BP @ 3575'  
Ac. 1000 gals. (3523-55')  
10-12-64 Pulled BP @ 3575'.  
TD 3670', COMPLETED.

COUNTY	LEA	FIELD	Langlie-Mattix	STATE	NM	OWWO
OPR	TEXAS PACIFIC OIL CO.			MAP		
	109 State "A" Acct. 1					
	Sec. 23, T-23-S, R-36-E					
	560' ENL, 560' FEL of Sec.			CO-ORD		
	Re-Spd 10-31-67					
	Re-Cmp 11-16-67			CLASS <i>OWOF</i> EL <span style="background-color: black; color: black;">[REDACTED]</span>		
CSG & SX - TUBING	FORMATION	DATUM	FORMATION	DATUM		
7 5/8" 317' 250						
4 1/2" 3670' 250						
LOGS EL GR RA IND HC A						
	TD 3670'; PBD 3660';					
Queen Perfs 3420-86' - NO NEW POTENTIAL FILED						

Distribution limited and publication prohibited by subscribers' agreement.  
Reproduction rights reserved by Williams & Lee Scouting Service, Inc.

CONT.	PROP DEPTH	TYPE	NO.
DATE			

12-14-67 F.R.C. 12-11-67; OWWO  
(Orig. Cmp 10-5-64 thru perfs 3523-3639',  
OTD 3670', OFB 3660')  
TD 3670', PBD 3510', COMPLETE  
PB to 3510'  
Perf @ 3420', 3424', 3440', 3458',  
3476', 3481', 3486' w/1 SPI  
Acid (3420-86') 1000 gals.  
Frac (3420-86') 20,000 gals brine +  
15,000# sd.  
Pmpd 30 BO + 12 BW in 24 hrs (3420-86')

Submit to Appropriate  
District Office  
State Lease - 4 copies  
Fee Lease - 3 copies

State of New Mexico  
Energy, Minerals and Natural Resources Department

Form C-10.  
Revised 1-1-8.

OIL CONSERVATION DIVISION

DISTRICT I  
P.O. Box 1980, Hobbs, NM 88240

P.O. Box 2088  
Santa Fe, New Mexico 87504-2088

DISTRICT II  
P.O. Drawer DD, Artesia, NM 88210

DISTRICT III  
1000 Rio Brazos Rd., Aztec, NM 87410

WELL LOCATION AND ACREAGE DEDICATION PLAT

All Distances must be from the outer boundaries of the section

Operator Clayton Williams Energy, Inc.			Lease State A A/C 1		Well No. 109
Unit Letter A	Section 23	Township 23S	Range 36E	County NMPM	Lea
Actual Footage Location of Well: 560 feet from the North line and 660 feet from the East line					
Ground level Elev. N/A	Producing Formation Yates		Pool Jalmat Tansill Yates 7 Rivers	Dedicated Acreage: 320 Acres	

1. Outline the acreage dedicated to the subject well by colored pencil or hachure marks on the plat below.
2. If more than one lease is dedicated to the well, outline each and identify the ownership thereof (both as to working interest and royalty).
3. If more than one lease of different ownership is dedicated to the well, have the interest of all owners been consolidated by communitization, unitization, force-pooling, etc.?  
☐ Yes ☐ No If answer is "yes" type of consolidation \_\_\_\_\_  
If answer is "no" list the owners and tract descriptions which have actually been consolidated. (Use reverse side of this form if necessary). \_\_\_\_\_  
No allowable will be assigned to the well until all interests have been consolidated (by communitization, unitization, forced-pooling, or otherwise) or until a non-standard unit, eliminating such interest, has been approved by the Division.

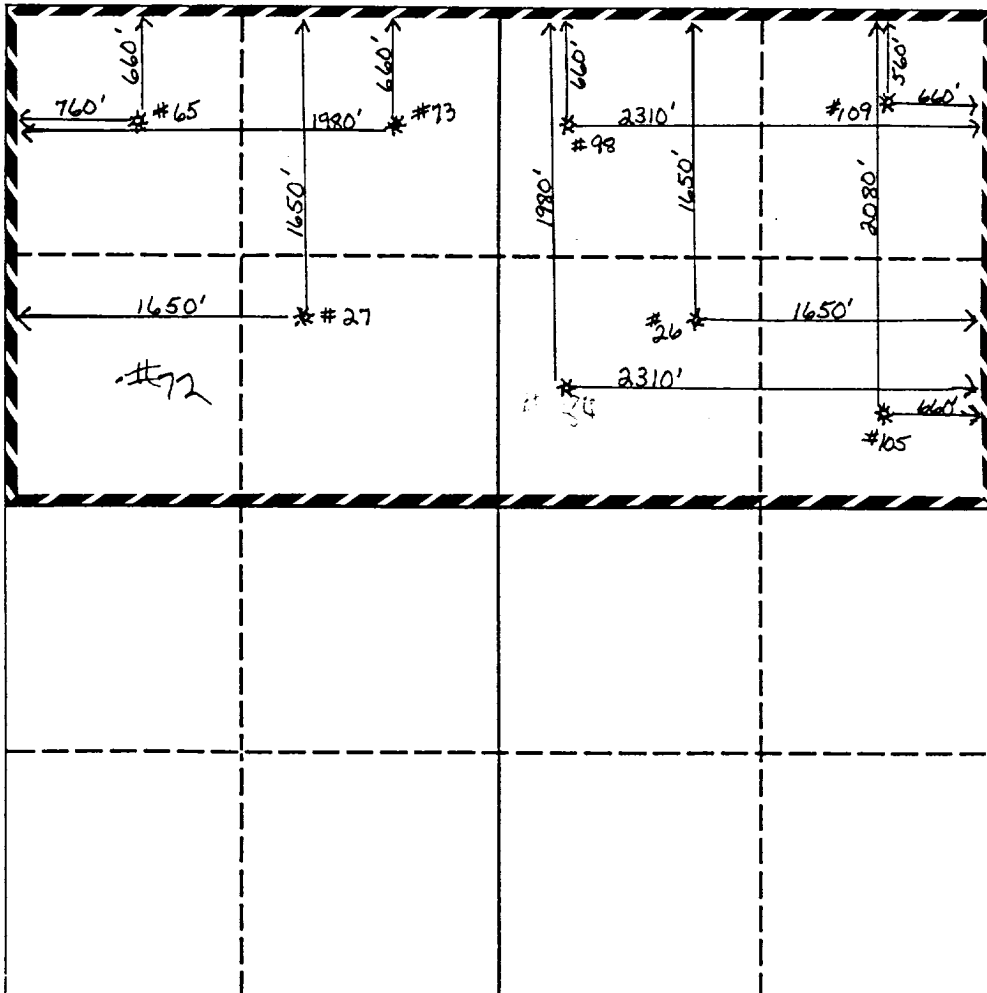

OPERATOR CERTIFICATION

I hereby certify that the information contained herein is true and complete to the best of my knowledge and belief.

Signature: *Robin S. McCarley*  
Printed Name: Robin S. McCarley  
Position: Production Analyst  
Company: Clayton Williams Energy, Inc.  
Date: 09/09/93

SURVEYOR CERTIFICATION

I hereby certify that the well location shown on this plat was plotted from field notes of actual surveys made by me or under my supervision, and that the same is true and correct to the best of my knowledge and belief.

Date Surveyed

Signature & Seal of  
Professional Surveyor

Certificate No.

NSL-3023 (SD)