

NO. OF COPIES RECEIVED		
DISTRIBUTION		
SANTA FE		
FILE		
U.S.G.S.		
LAND OFFICE		
OPERATOR		

NEW MEXICO OIL CONSERVATION COMMISSION

Form C-101
Revised 1-1-65

5A. Indicate Type of Lease
STATE ☐ FEE ☒

5. State Oil & Gas Lease No.

APPLICATION FOR PERMIT TO DRILL, DEEPEN, OR PLUG BACK

1a. Type of Work b. Type of Well OIL WELL <input checked="" type="checkbox"/> GAS WELL <input type="checkbox"/> OTHER <input type="checkbox"/> DRILL <input checked="" type="checkbox"/> DEEPEN <input type="checkbox"/> PLUG BACK <input type="checkbox"/> SINGLE ZONE <input type="checkbox"/> MULTIPLE ZONE <input checked="" type="checkbox"/>		7. Unit Agreement Name
2. Name of Operator John H. Hendrix		8. Farm or Lease Name Coezatot "A"
3. Address of Operator 316 Central Bldg., Midland, Texas 79701		9. Well No. 1
4. Location of Well UNIT LETTER H LOCATED 990 FEET FROM THE North LINE AND 2310 FEET FROM THE East LINE OF SEC. 12 TWP. 22S RGE. 37E NMPM		10. Field and Pool, or Wildcat Drinkard & Blinebry
		12. County Lee
19. Proposed Depth 7000		19A. Formation Drinkard Blinebry Rotary
20. Rotary or C.T.		
21. Elevations (Show whether DF, RT, etc.) 3355 D.F. (L.S.M.)	21A. Kind & Status Plug. Bond Travelers 1472123	22. Approx. Date Work will start Prior to Nov. 22, 1971
21B. Drilling Contractor Not Selected		

23.

PROPOSED CASING AND CEMENT PROGRAM

SIZE OF HOLE	SIZE OF CASING	WEIGHT PER FOOT	SETTING DEPTH	SACKS OF CEMENT	EST. TOP
12 1/2"	5 1/2"	20.5 & 24"	1240'	550	To Circulate
7 7/8"	5 1/2"	15.5 & 17"	7000'	450	1800'

*Paddock formation at approximately 5100' is the most shallow producing zone in Section 12, T22S, R37E. Accordingly, authority is requested to bring the cement top back to approximately 4600'.

THE COMMISSION HAS REVIEWED
24 NOV 1971
CASH.

APPROVAL VALID
FOR 90 DAYS
1-18-72

IN ABOVE SPACE DESCRIBE PROPOSED PROGRAM: IF PROPOSAL IS TO DEEPEN OR PLUG BACK, GIVE DATA ON PRESENT PRODUCTIVE ZONE AND PROPOSED NEW PRODUCTIVE ZONE. GIVE BLOWOUT PREVENTER PROGRAM, IF ANY.

I hereby certify that the information above is true and complete to the best of my knowledge and belief.

Signed John H. Hendrix Title Owner - Operator Date October 13, 1971

(This space for State Use)
C.E.G. Signed by

Joe D. Ramsey

APPROVED BY Dist. I, Supv.

CONDITIONS OF APPROVAL, IF ANY:

DATE

OCT 18 1971

RECEIVED

OCT 15 1971

OIL CONSERVATION COMM.
HOBBS, R. L.

NEW MEXICO OIL CONSERVATION COMMISSION
WELL LOCATION AND ACREAGE DEDICATION PLAT

Form C-102
Supersedes C-128
Effective 1-1-65

All distances must be from the outer boundaries of the Section.

Operator JOHN H. HENDRIX			Lease COSSATOT "A"			Well No. 1		
Unit Letter B	Section 12	Township 22 SOUTH	Range 37 EAST	County LEA				
Actual Footage Location of Well: 990 feet from the NORTH line and 2310 feet from the EAST line								
Ground Level Elev.	Producing Formation Blinebry & Drinkard		Pool Blinebry & Drinkard			Dedicated Acreage: 40 Acres		

1. Outline the acreage dedicated to the subject well by colored pencil or hachure marks on the plat below.
2. If more than one lease is dedicated to the well, outline each and identify the ownership thereof (both as to working interest and royalty).
3. If more than one lease of different ownership is dedicated to the well, have the interests of all owners been consolidated by communitization, unitization, force-pooling, etc?

☐ Yes ☐ No If answer is "yes," type of consolidation _____

If answer is "no," list the owners and tract descriptions which have actually been consolidated. (Use reverse side of this form if necessary.) _____

No allowable will be assigned to the well until all interests have been consolidated (by communitization, unitization, forced-pooling, or otherwise) or until a non-standard unit, eliminating such interests, has been approved by the Commission.

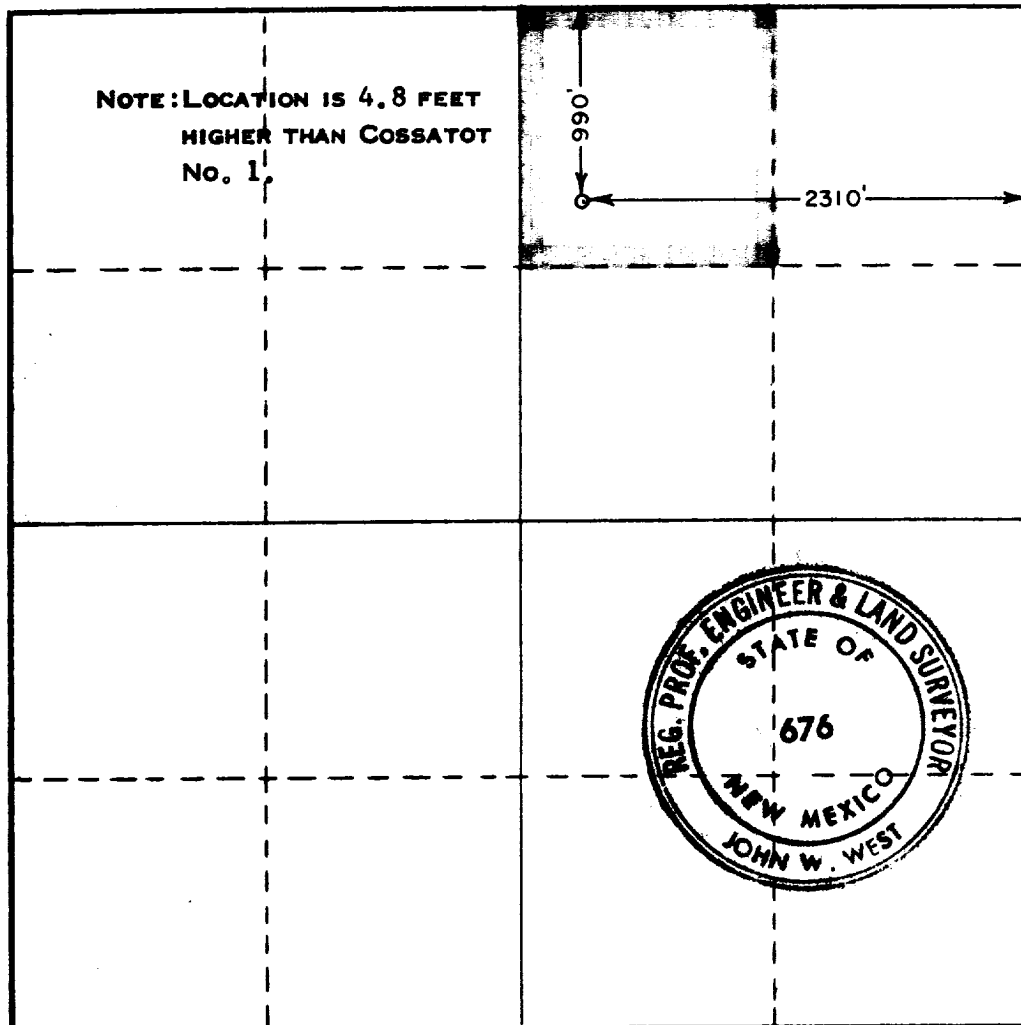

CERTIFICATION

I hereby certify that the information contained herein is true and complete to the best of my knowledge and belief.

Name
John H. Hendrix
Position
Operator

Company
John H. Hendrix

Date
October 14, 1971

I hereby certify that the well location shown on this plat was plotted from field notes of actual surveys made by me or under my supervision, and that the same is true and correct to the best of my knowledge and belief.

Date Surveyed
OCTOBER 11, 1971

Registered Professional Engineer and/or Land Surveyor

John W. West
Certificate No. **676**



FILE

RECEIVED

OCT 15 1971

OIL CONSERVATION COMM.
HOBBS, N. M.