

31 112 25367

NO. OF COPIES RECEIVED	
DISTRIBUTION	
SANTA FE	
FILE	
U.S.G.S.	
LAND OFFICE	
OPERATOR	

NEW MEXICO OIL CONSERVATION COMMISSION

Form C-101  
Revised 1-1-65

5A. Indicate Type of Lease	
STATE <input type="checkbox"/>	FEE <input checked="" type="checkbox"/>

5. State Oil & Gas Lease No.
------------------------------

APPLICATION FOR PERMIT TO DRILL, DEEPEN, OR PLUG BACK

1a. Type of Work		7. Unit Agreement Name	
b. Type of Well DRILL <input checked="" type="checkbox"/> DEEPEN <input type="checkbox"/> PLUG BACK <input type="checkbox"/> OIL WELL <input type="checkbox"/> GAS WELL <input type="checkbox"/> OTHER <input type="checkbox"/> SINGLE ZONE <input type="checkbox"/> MULTIPLE ZONE <input checked="" type="checkbox"/>		8. Form or Lease Name	
2. Name of Operator Marathon Oil Company		9. Well No. 5	
3. Address of Operator P. O. Box 2409, Hobbs, New Mexico 88240		10. Field and Prod. or Wildcat Wantz Granite Wash	
4. Location of Well UNIT LETTER P LOCATED 990 FEET FROM THE East LINE AND 990 FEET FROM THE South LINE OF SEC. 24 TWP. 22S REC. 37E NMPM		12. County Lea	
11. Proposed Depth 7700'		19A. Formation Granite Wash	20. Rotary or C.T. Rotary
21. Elevations (Show whether D.P., R.T., etc.) G. L. 3315.6'	21A. Kind & Status Plug. Bond Current	21B. Drilling Contractor Unknown	22. Approx. Date Work will start October 15, 1976

PROPOSED CASING AND CEMENT PROGRAM

SIZE OF HOLE	SIZE OF CASING	WEIGHT PER FOOT	SETTING DEPTH	SACKS OF CEMENT	EST. TOP
12-1/4"	9-5/8"	32.3#	1250'	610	Surface
8-3/4"	7"	23#	7700'*	1500	Surface

Plan to drill to approximately 7700'.

Cement and test all casing by approved methods.

Blow out equipment to be used is 900 Series, Cameron or equivalent with pipe and blank rams. Remote BOP controls will be located on derrick floor with closing unit located a minimum of 75' from the wellhead.

\*With DV tool at approximately 4500'.

APPROVAL VALID  
FOR 90 DAYS UNLESS  
DRILLING COMMENCED,  
EXPIRES Jan 6, 1977

IN ABOVE SPACE DESCRIBE PROPOSED PROGRAM: IF PROPOSAL IS TO DEEPEN OR PLUG BACK, GIVE DATA ON PRESENT PRODUCTIVE ZONE AND PROPOSED NEW PRODUCTIVE ZONE. GIVE BLOWOUT PREVENTER PROGRAM, IF ANY.

I hereby certify that the information above is true and complete to the best of my knowledge and belief.

Signed Robert J. Querschell Title Petroleum Engineer Date October 5, 1976

(This space for State Use)

APPROVED BY John W. Runyan TITLE Geologist DATE OCT 6 1976

CONDITIONS OF APPROVAL, IF ANY:

RECEIVED

1996

OF CONSTITUTIONAL COURT

1996

**NEW MEXICO OIL CONSERVATION COMMISSION**  
**WELL LOCATION AND ACREAGE DEDICATION PL.**

Form C-102  
 Supersedes C-128  
 Effective 1-1-65

All distances must be from the outer boundaries of the Section.

Operator <b>MARATHON OIL COMPANY</b>			Lease <b>J. L. Muncy</b>		Well No. <b>5</b>
Unit Letter <b>P</b>	Section <b>24</b>	Township <b>22 South</b>	Range <b>37 East</b>	County <b>Lea</b>	
Actual Footage Location of Well: <b>990</b> feet from the <b>south</b> line and <b>990</b> feet from the <b>east</b> line					
Ground Level Elev. <b>3315.6</b>	Producing Formation <b>Granite Wash</b>		Pool <b>Wantz Granite Wash</b>		Dedicated Acreage: <b>40</b> Acres

1. Outline the acreage dedicated to the subject well by colored pencil or hachure marks on the plat below.
2. If more than one lease is dedicated to the well, outline each and identify the ownership thereof (both as to working interest and royalty).
3. If more than one lease of different ownership is dedicated to the well, have the interests of all owners been consolidated by communitization, unitization, force-pooling, etc?

☐ Yes    ☐ No    If answer is "yes," type of consolidation \_\_\_\_\_

If answer is "no," list the owners and tract descriptions which have actually been consolidated. (Use reverse side of this form if necessary.) \_\_\_\_\_

No allowable will be assigned to the well until all interests have been consolidated (by communitization, unitization, forced-pooling, or otherwise) or until a non-standard unit, eliminating such interests, has been approved by the Commission.

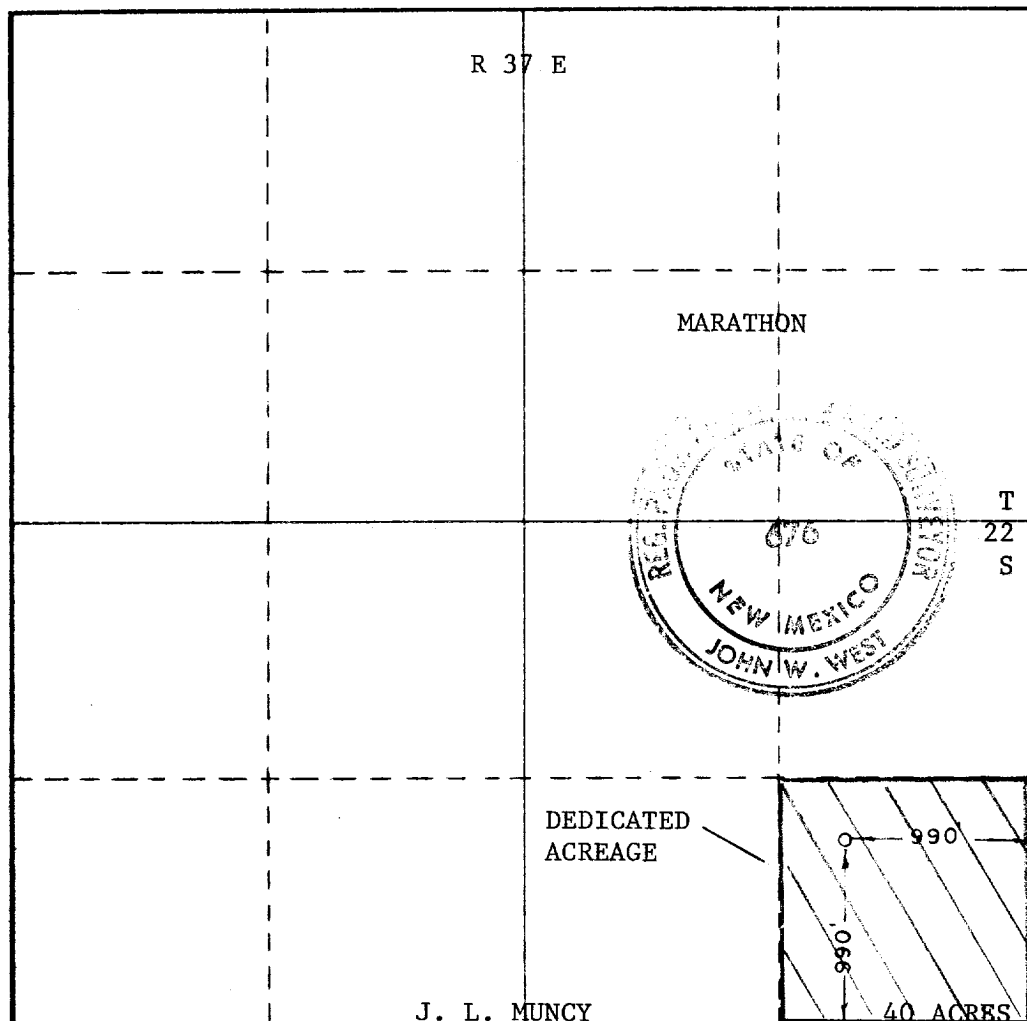

**CERTIFICATION**

I hereby certify that the information contained herein is true and complete to the best of my knowledge and belief.

*Robert J. Duenckel*

Name  
**Robert J. Duenckel**  
 Position  
**Petroleum Engineer**  
 Company  
**Marathon Oil Company**

Date  
**October 5, 1976**

I hereby certify that the well location shown on this plat was plotted from field notes of actual surveys made by me or under my supervision, and that the same is true and correct to the best of my knowledge and belief.

Date Surveyed  
**Sept. 30, 1976**  
 Registered Professional Engineer  
 and/or Land Surveyor

*John W. West*  
 Certificate No. **676**



RECEIVED

JUN 15 1976  
GIL CONSERVATION COMM.  
HOBBS, N. M.

113