

District Office

State of New Mexico
Energy, Minerals and Natural Resources Department

Form C-103
Revised 1-1-89

OIL CONSERVATION DIVISION

P.O. Box 2088

Santa Fe, New Mexico 87504-2088

DISTRICT I

P.O. Box 1980, Hobbs, NM 88240

DISTRICT II

P.O. Drawer Dd, Artesia, NM 88210

DISTRICT III

1000 Rio Brazos Rd., Aztec, Nm 87410

<p align="center">SUNDRY NOTICES AND REPORTS ON WELLS</p> <p align="center">(DO NOT USE THIS FORM FOR PROPOSALS TO DRILL OR TO DEEPEN OR PLUG BACK TO A DIFFERENT RESERVOIR. USE "APPLICATION FOR PERMIT"</p> <p align="center">(FORM C-101) FOR SUCH PROPOSALS.)</p>						<p>7. Lease Name or Unit Agreement Name</p> <p>A.L. CHRISTMAS (NCT-<i>ALC</i>)</p>	
<p>1. Type of Well:</p> <p>OIL GAS WELL <input checked="" type="checkbox"/> WELL <input type="checkbox"/> OTHER</p>							
<p>2. Name of Operator</p> <p>CHEVRON U.S.A. INC.</p>						<p>8. Well No.</p> <p>16</p>	
<p>3. Address of Operator</p> <p>P.O. BOX 1150 MIDLAND, TX 79702 ATTN: P.R. MATTHEWS</p>						<p>9. Pool name or Wildcat</p> <p>EUMONT</p>	
<p>4. Well Location</p> <p>Unit Letter <u>M</u> : <u>810</u> Feet From The <u>SOUTH</u> Line and <u>710</u> Feet From The <u>WEST</u> Line</p> <p>Section <u>18</u> Township <u>22S</u> Range <u>37E</u> NMPM LEA County</p>							
				<p>10. Elevation(Show whether DF, RKB, RT, GR, etc.)</p> <p>3461 GE</p>			

Check Appropriate Box to Indicate Nature of Notice, Report, or Other Data			
NOTICE OF INTENTION TO:		SUBSEQUENT REPORT OF:	
PERFORM REMEDIAL WORK	<input type="checkbox"/>	PLUG AND ABANDON	<input type="checkbox"/>
TEMPORARILY ABANDON	<input type="checkbox"/>	CHANGE PLANS	<input type="checkbox"/>
PULL OR ALTER CASING	<input type="checkbox"/>	REMEDIAL WORK	<input type="checkbox"/>
OTHER: _____	<input type="checkbox"/>	COMMENCE DRILLING OPNS.	<input type="checkbox"/>
		CASING TEST AND CMT JOB	<input type="checkbox"/>
		OTHER: <u>PLUG BACK AND RECOMPLETE</u>	<input checked="" type="checkbox"/>

12. Describe Proposed or Completed Operations (Clearly state all pertinent details, and give pertinent dates, including estimated date of starting any proposed work) SEE RULE 1103.

MIRU POOH W/PROD. EQUIP.
SET CIBP AT 3722'.
DUMP 40' OF CMT ON TOP OF CIBP.
PERF 3605'-3469', 22 HOLES 0 DEG PHSD.
ACDZ PENROSE W/15% NEFE. SWB/TST ZONE.
FRAC PERFS W/51,000 GALS OF GEL AND 63,000# OF SAND.
BAIL OUT SAND TO 3660'.
FLOW WELL BACK.
TIH W/ PRODUCTION EQUIPMENT.
RETURN TO PRODUCTION BACK ON PROD. 11-13-91.

I hereby certify that the information above is true and complete to the best of my knowledge and belief.

SIGNATURE *P.R. Mathan* TITLE TECH. ASSISTANT DATE: 11-18-91

TYPE OR PRINT NAME P.R. MATTHEWS TELEPHONE NO. (915)687-7812

APPROVED BY Paul Kautz TITLE _____ DATE _____

CONDITIONS OF APPROVAL, IF ANY:

34 B.L. 1.2.

Submit to Appropriate
District Office
State Lease - 6 copies
Fee Lease - 5 copies

State of New Mexico
Energy, Minerals and Natural Resources Department

Form C-101
Revised 1-1-89

OIL CONSERVATION DIVISION

P.O. Box 2088
Santa Fe, New Mexico 87504-2088

DISTRICT I
P.O. Box 1980, Hobbs, NM 88240

DISTRICT II
P.O. Drawer DD, Artesia, NM 88210

DISTRICT III
1000 Rio Brazos Rd., Aztec, NM 87410

API NO. (assigned by OCD on New Wells)
30-025-25670

5. Indicate Type of Lease
STATE ☐ FEE ☒

6. State Oil & Gas Lease No.

APPLICATION FOR PERMIT TO DRILL, DEEPEN, OR PLUG BACK

1a. Type of Work: DRILL <input type="checkbox"/> RE-ENTER <input type="checkbox"/> DEEPEN <input type="checkbox"/> PLUG BACK <input checked="" type="checkbox"/>		7. Lease Name or Unit Agreement Name A.L. CHRISTMAS (NCT-C)			
b. Type of Well: OIL WELL <input checked="" type="checkbox"/> GAS WELL <input type="checkbox"/> OTHER <input type="checkbox"/> SINGLE ZONE <input checked="" type="checkbox"/> MULTIPLE ZONE <input type="checkbox"/>		8. Well No. 16			
2. Name of Operator CHEVRON U.S.A. INC.		9. Pool name or Wildcat EUMONT Y/SR/Q			
3. Address of Operator P.O. BOX 1150 MIDLAND, TX 79702 ATTN: P.R. MATTHEWS					
4. Well Location Unit Letter M : 810 Feet From The SOUTH Line and 710 Feet From The WEST Line Section 18 Township 22S Range 37E NMPM LEA County					
10. Proposed Depth 3685		11. Formation PENROSE			
12. Rotary or C.T. ROTARY					
13. Elevations (Show whether DF, RT, GR, etc.) 3461 GL		14. Kind & Status Plug Bond UNKNOWN			
15. Drilling Contractor UNKNOWN		16. Approx. Date Work will start A.S.A.P.			
17. EXISTING PROPOSED CASING AND CEMENT PROGRAM					
SIZE OF HOLE	SIZE OF CASING	WEIGHT PER FOOT	SETTING DEPTH	SACKS OF CEMENT	EST. TOP
	3 5/8	-----	1129	500	CIRC.
	5 1/2	15.50	6669	2035	CIRC.

IT IS PROPOSED TO:

1. SET CIBP AT +/- 3700', DUMP 35' CMT ON CIBP.
2. SELECTIVELY PERF PENROSE FORMATION.
3. ACDZ PERFS, SWB/TST.
4. FRAC PERFS.
5. CO TO PBDT AT +/- 3685'.
6. RETURN TO PRODUCTION.

IN ABOVE SPACE DESCRIBE PROPOSED PROGRAM: IF PROPOSAL IS TO DEEPEN OR PLUG BACK, GIVE DATA ON PRESENT PRODUCTIVE ZONE AND PROPOSED NEW PRODUCTIVE ZONE. GIVE BLOWOUT PREVENTER PROGRAM, IF ANY.

I hereby certify that the information above is true and complete to the best of my knowledge and belief.

SIGNATURE P.R. Matthews TITLE TECHNICAL ASSISTANT DATE 8-16-91
TYPE OR PRINT NAME P.R. MATTHEWS TELEPHONE NO. 687-7812

(This space for State Use)

APPROVED BY _____ TITLE _____ DATE _____
CONDITIONS OF APPROVAL, IF ANY:

Permit Expires 6 Months From Approval
Date of last Drilling Underway.

Submit to Appropriate
District Office
State Lease - 4 copies
Fee Lease - 3 copies

State of New Mexico
Energy, Minerals and Natural Resources Department

Form C-102
Revised 1-1-89

OIL CONSERVATION DIVISION

DISTRICT I
P.O. Box 1980, Hobbs, NM 88240

P.O. Box 2088

Santa Fe, New Mexico 87504-2088

DISTRICT II
P.O. Drawer DD, Artesia, NM 88210

DISTRICT III
1000 Rio Brazos Rd., Aztec, NM 87410

WELL LOCATION AND ACREAGE DEDICATION PLAT

All Distances must be from the outer boundaries of the section

Operator CHEVRON U.S.A. INC.			Lease A.L. CHRISTMAS <i>WCT-C</i>		Well No. 16
Unit Letter M	Section 18	Township 22S	Range 37E	County LEA	
Actual Footage Location of Well: 810 feet from the SOUTH line and 710 feet from the WEST line					
Ground level Elev. 3461' GL	Producing Formation PENROSE	Pool EUMONT Y/SR/Q		Dedicated Acreage: 40 Acres	

1. Outline the acreage dedicated to the subject well by colored pencil or hatchure marks on the plat below.
2. If more than one lease is dedicated to the well, outline each and identify the ownership thereof (both as to working interest and royalty).
3. If more than one lease of different ownership is dedicated to the well, have the interest of all owners been consolidated by communitization, unitization, force-pooling, etc.?
☐ Yes ☐ No If answer is "yes" type of consolidation _____
If answer is "no" list the owners and tract descriptions which have actually been consolidated. (Use reverse side of this form if necessary.) _____
No allowable will be assigned to the well until all interests have been consolidated (by communitization, unitization, forced-pooling, or otherwise) or until a non-standard unit, eliminating such interest, has been approved by the Division.

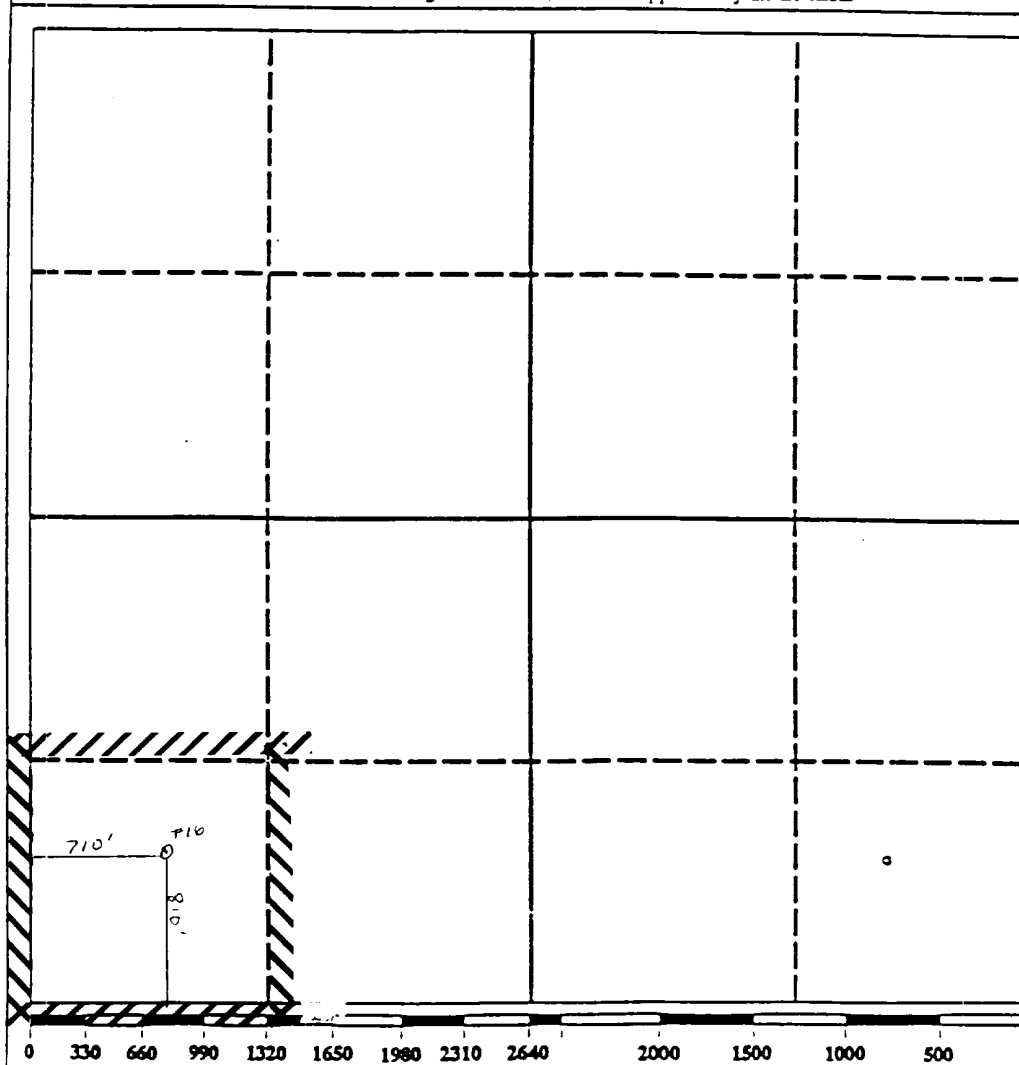

OPERATOR CERTIFICATION

I hereby certify that the information contained herein is true and complete to the best of my knowledge and belief.

Signature

P.R. Matthews

Printed Name

P.R. MATTHEWS

Position

TECHNICAL ASSISTANT

Company

CHEVRON U.S.A. INC.

Date

8-16-91

SURVEYOR CERTIFICATION

I hereby certify that the well location shown on this plat was plotted from field notes of actual surveys made by me or under my supervision, and that the same is true and correct to the best of my knowledge and belief.

Date Surveyed

Signature & Seal of
Professional Surveyor

Certificate No.