

District I
 PO Box 1980, Hobbs, NM 88241 1980
 District II
 PO Drawer DD, Artesia, NM 88211-0719
 District III
 1000 Rio Brazos Rd., Aztec, NM 87410
 District IV
 PO Box 2088, Santa Fe, NM 87504-2088

State of New Mexico
 Energy, Minerals & Natural Resources Department

OIL CONSERVATION DIVISION
 PO Box 2088
 Santa Fe, NM 87504-2088

Form C-101
 Revised February 10, 1994
 Instructions on back
 Submit to Appropriate District Office
 State Lease - 6 Copies
 Fee Lease - 5 Copies

AMENDED REPORT

APPLICATION FOR PERMIT TO DRILL, RE-ENTER, DEEPEN, PLUGBACK, OR ADD A ZONE

Operator Name and Address. Raptor Resources, Inc. 901 Rio Grande Austin, Tx. 78701		OGRID No. 162791
Property Code 24669		API Number 30 - 0 025-27962
Property Name State 'A' A/C 1		Well No. 115

' Surface Location

UL or lot no.	Section	Township	Range	Lot Idn	Feet from the	North/South line	Feet from the	East/West line	County
F	9	23S	36E		1700	North	1980	West	Lea

s Proposed Bottom Hole Location If Different From Surface

UL or lot no.	Section	Township	Range	Lot Idn	Feet from the	North/South line	Feet from the	East/West line	County
Proposed Pool 1 Jalmat, Tnsl, Yts, 7-Rivers (Pro Gas) (79240)					Proposed Pool 2				

" Work Type Code P 16 Multiple	" Well Type Code G 17 Proposed Depth	" Cable/Rotary R 18 Formation Tnsl/Yates/7 Rvrs	" Lease type Code S 19 Contractor	14 Ground Level Elevation 20 Spud Date
--------------------------------------	--	--	---	---

21 Proposed Casing and Cement Program

Hole Size	Casing Size	Casing weight/foot	Setting Depth	Sacks of Cement	Estimated TOC

Describe the proposed program. If this application is to DEEPEN or PLUG BACK give the data on the present productive zone and proposed new productive zone. Describe the blowout prevention program, if any. Use additional sheets if necessary.

Current Status: Producing in the Jalmat, Tnsl, Yts, 7-Rvrs (Oil)

PROPOSED OPERATIONS

1. Perf the Yates @ 3136-3345;
2. Acidize
3. Frac
4. POP

~~Plugging this way~~
 Plug-Back

23 I hereby certify that the information given above is true and complete to the best of my knowledge and belief.

Signature

Printed name
 Bill R. Keathly

Title
 R regulatory Agent for Raptor

Date
 10-16-99

Phone
 (915) 697-1609

OIL CONSERVATION DIVISION

Approved by: 

Title:

Approval Date: Expiration Date:

Conditions of Approval:
 Attached

3

District I
 PO Box 1980, Hobbs, NM 88241-1980
 District II
 PO Drawer DD, Artesia, NM 88211-0719
 District III
 1000 Rio Brazos Rd. Aztec, NM 87410
 District IV
 PO Box 2088, Santa Fe, NM 87504-2088

State of New Mexico
 Energy, Minerals & Natural Resources Department

Form C-

Revised February 21, 1999

OIL CONSERVATION DIVISION
 PO Box 2088
 Santa Fe, NM 87504-2088

instructions on b
 Submit to Appropriate District Of
 State Lease - 4 Cop
 Fee Lease - 3 Cop

AMENDED REPO

WELL LOCATION AND ACREAGE DEDICATION PLAT

API Number 30-025-27962		2 Pool Code 79240		3 Pool Name Jalmat, Tnsl, Yts, 7-Rivers (Pro Gas)	
4 Property Code 24669		5 Property Name State 'A' A/C 1			6 Well Number 115
7 OGRID No. 162791		8 Operator Name Raptor Resources, Inc,			9 Elevation

10 Surface Location

UL or lot no.	Section	Township	Range	Lot Idn	Feet from the	North/South line	Feet from the	East/West line	County
F	9	23S	36E		1700	North	1980	West	Lea

11 Bottom Hole Location If Different From Surface

UL or lot no.	Section	Township	Range	Lot Idn	Feet from the	North/South line	Feet from the	East/West line	County

12 Dedicated Acres 160	13 Joint or Infil	14 Consolidation Code	15 Order No. NSP-1334
---------------------------	-------------------	-----------------------	--------------------------

NO ALLOWABLE WILL BE ASSIGNED TO THIS COMPLETION UNTIL ALL INTERESTS HAVE BEEN CONSOLIDATED OR A NON-STANDARD UNIT HAS BEEN APPROVED BY THE DIVISION

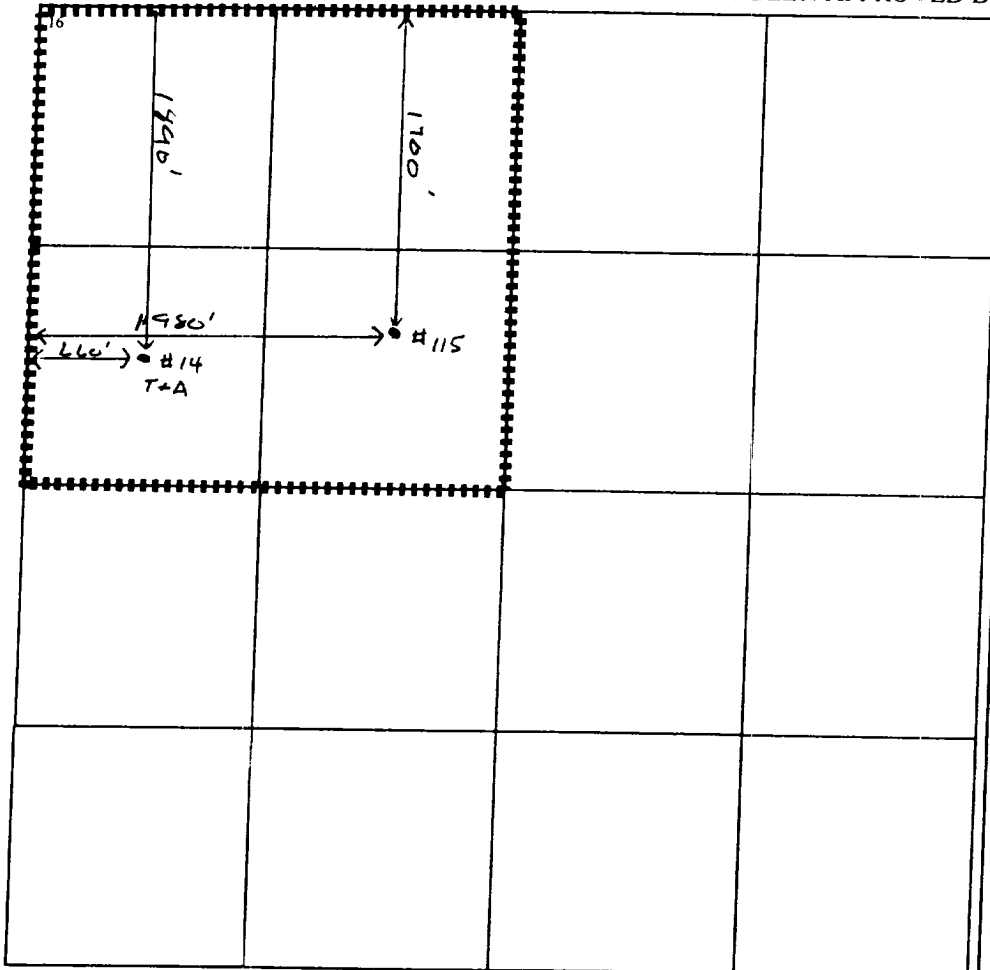

17 OPERATOR CERTIFICATION

I hereby certify that the information contained herein is true and complete to the best of my knowledge and belief

Bill R. Keathly
 Signature

Printed Name
 Bill R. Keathly

Title
 Regulatory Agent - Raptor

Date
 10-16-99

18 SURVEYOR CERTIFICATION

I hereby certify that the well location shown on this plat was plotted from field notes of actual surveys made by me or under my supervision, and that the same is true and correct to the best of my belief.

Date of Survey

Signature and Seal of Professional Surveyor:

Certificate Number