

P.O. Box 1980, Hobbs, NM 88241-1980  
 DISTRICT II  
 P.O. Box Drawer DD, Artesia, NM 88211-0719  
 DISTRICT III  
 1000 Rio Brazos Rd., Aztec, NM 87410  
 DISTRICT IV  
 P.O. Box 2088, Santa Fe, NM 87504-2088

STATE OF NEW MEXICO  
 Energy, Minerals and Natural Resources Department

**OIL CONSERVATION DIVISION**

P.O. Box 2088  
 Santa Fe, New Mexico 87504-2088

Form C-10  
 Revised February 10, 1999  
 Instructions on back  
 Submit to Appropriate District Office  
 State Lease - 6 Copies  
 Fee Lease - 5 Copies

AMENDED REPORT

**APPLICATION FOR PERMIT TO DRILL, RE-ENTER, DEEPEN, PLUGBACK, OR ADD A ZONE**

<sup>1</sup> Operator Name and Address TEXACO EXPLORATION & PRODUCTION INC. PO BOX 3109, MIDLAND, TX 79702		<sup>2</sup> OGRID Number 022351
		<sup>3</sup> API Number 3002512387
<sup>4</sup> Property Code 010926	<sup>5</sup> Property Name WEST DOLLARHIDE DRINKARD UNIT	<sup>6</sup> Well No. 88

<sup>7</sup> Surface Location									
UI or lot no	Section	Township	Range	Lot.Idn	Feet From The	North/South Line	Feet From The	East/West Line	County
A	5	25S	38E		667	NORTH	500	EAST	LEA

<sup>8</sup> Proposed Bottom Hole Location If Different From Surface									
UI or lot no	Section	Township	Range	Lot.Idn	Feet From The	North/South Line	Feet From The	East/West Line	County
B	5	25S	38E		430	NORTH	2530	EAST	LEA
<sup>9</sup> Proposed Pool 1 DOLLARHIDE DRINKARD					<sup>10</sup> Proposed Pool 2				

<sup>11</sup> Work Type Code P	<sup>12</sup> WellType Code O	<sup>13</sup> Rotary or C.T. ROTARY	<sup>14</sup> Lease Type Code S	<sup>15</sup> Ground Level Elevation 3148' KB
<sup>16</sup> Multiple No	<sup>17</sup> Proposed Depth 8680'	<sup>18</sup> Formation DRINKARD	<sup>19</sup> Contractor	<sup>20</sup> Spud Date 2/20/02

<sup>21</sup> Proposed Casing and Cement Program					
SIZE OF HOLE	SIZE OF CASING	WEIGHT PER FOOT	SETTING DEPTH	SACKS OF CEMENT	EST. TOP
NO CHANGE					

<sup>22</sup> Describe the proposed program. If this application is to DEEPEN or PLUG BACK give the data on the present productive zone and proposed new productive zone. Describe the blowout prevention program, if any. Use additional sheets if necessary.

CHEVRONTXACO INTENDS TO DRILL A HORIZONTAL LATERAL IN THE SUBJECT WELL.

KICK OFF POINT: 6318'  
 PERFS: 6397-6502'  
 TOP OF WINDOW: 6313'  
 BOTTOM OF WINDOW: 6323  
 PBTD: 6510'

Permit Expires 1 Year From Approval  
 Date Unless Drilling Underway

<sup>23</sup> I hereby certify that the rules and regulations of the Oil Conservation Division have been complied with and that the information given above is true and complete to the best of my knowledge and belief.

Signature *J. Denise Leake*

Printed Name J. Denise Leake

Title Engineering Assistant

Date 1/9/02

Telephone 915-687-7315

OIL CONSERVATION DIVISION

ORIGINAL SIGNED BY

PAUL F. KAUTZ  
 PETROLEUM ENGINEER

Approved By:

Title:

Approval Date:

Expiration Date:

Conditions of Approval:  
 Attached

MAR 06 2002

DISTRICT II

P.O. Box Drawer DD, Artesia, NM 88211-0719

# OIL CONSERVATION DIVISION

P.O. Box 2088

Revised February 10, 199

DISTRICT III

1000 Rio Brazos Rd., Aztec, NM 87410

Santa Fe, New Mexico 87504-2088

Instructions on back  
Submit to Appropriate District Office

DISTRICT IV

P.O. Box 2088, Santa Fe, NM 87504-2088

State Lease - 4 Copie

Fee Lease - 3 Copie

AMENDED REPORT

## WELL LOCATION AND ACREAGE DEDICATION PLAT

<sup>1</sup> API Number 3002512387		<sup>2</sup> Pool Code 18830		<sup>3</sup> Pool Name DOLLARHIDE TUBB DRINKARD	
<sup>4</sup> Property Code 010926		<sup>5</sup> Property Name WEST DOLLARHIDE DRINKARD UNIT			<sup>6</sup> Well No. 88
<sup>7</sup> OGRID Number 022351		<sup>8</sup> Operator Name TEXACO EXPLORATION & PRODUCTION INC.			<sup>9</sup> Elevation 3148' KB

### <sup>10</sup> Surface Location

UI or lot no	Section	Township	Range	Lot.Idn	Feet From The	North/South Line	Feet From The	East/West Line	County
A	5	25S	38E		667	NORTH	500	EAST	LEA

### <sup>11</sup> Bottom Hole Location If Different From Surface

UI or lot no	Section	Township	Range	Lot.Idn	Feet From The	North/South Line	Feet From The	East/West Line	County
B	5	25S	38E		430	NORTH	2530	EAST	LEA
<sup>12</sup> Dedicated Acre 80		<sup>13</sup> Joint or Infill No		<sup>14</sup> Consolidation Code		<sup>15</sup> Order No.			

NO ALLOWABLE WILL BE ASSIGNED TO THIS COMPLETION UNTIL ALL INTERESTS HAVE BEEN CONSOLIDATED OR A NON-STANDARD UNIT HAS BEEN APPROVED BY THE DIVISION

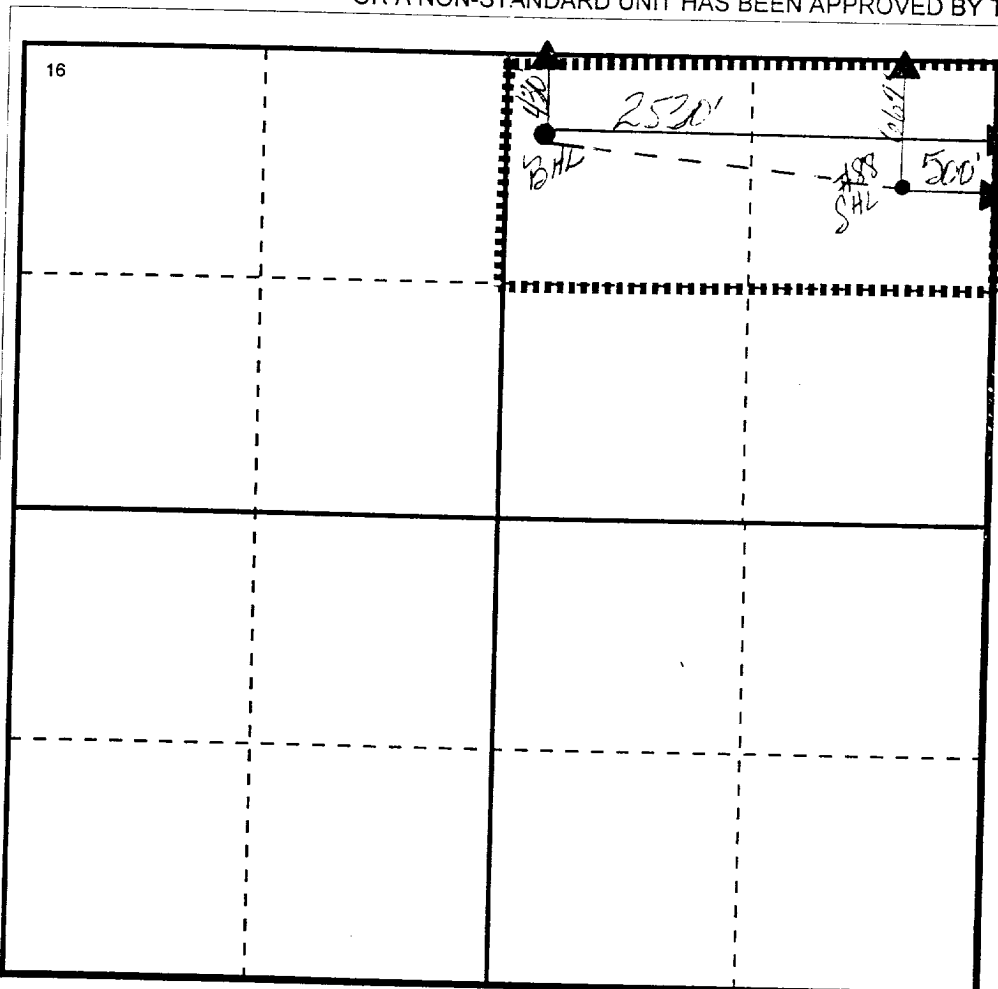

### <sup>17</sup> OPERATOR CERTIFICATION

I hereby certify that the information contained herein is true and complete to the best of my knowledge and belief

Signature

*J. Denise Leake*

Printed Name

J. Denise Leake

Positio

Engineering Assistant

Date

1/9/02

### <sup>18</sup> SURVEYOR CERTIFICATION

I hereby certify that the well location shown on this plat was plotted from field notes of actual surveys made by me or under my supervision, and that the same is true and correct to the best of my knowledge and belief.

Date Surveyed

Signature & Seal of

Professional Surveyor

Certificate No.