

DUPLICATE

NEW MEXICO
OIL CONSERVATION COMMISSION

Form C-128

Well Location and/or Gas Proration Plat

Date July 12, 1956

Operator El Paso Natural Gas Company Lease Prichard

Well No. 1 Section 15 Township 25 S Range 37 E NMPM

Located 660 Feet From South Line, 1980 Feet From West Line,

Lea County, New Mexico. G. L. Elevation 3085

Name of Producing Formation Yates Pool Jalnat Dedicated Acreage 160

(Note: All distances must be from outer boundaries of Section)

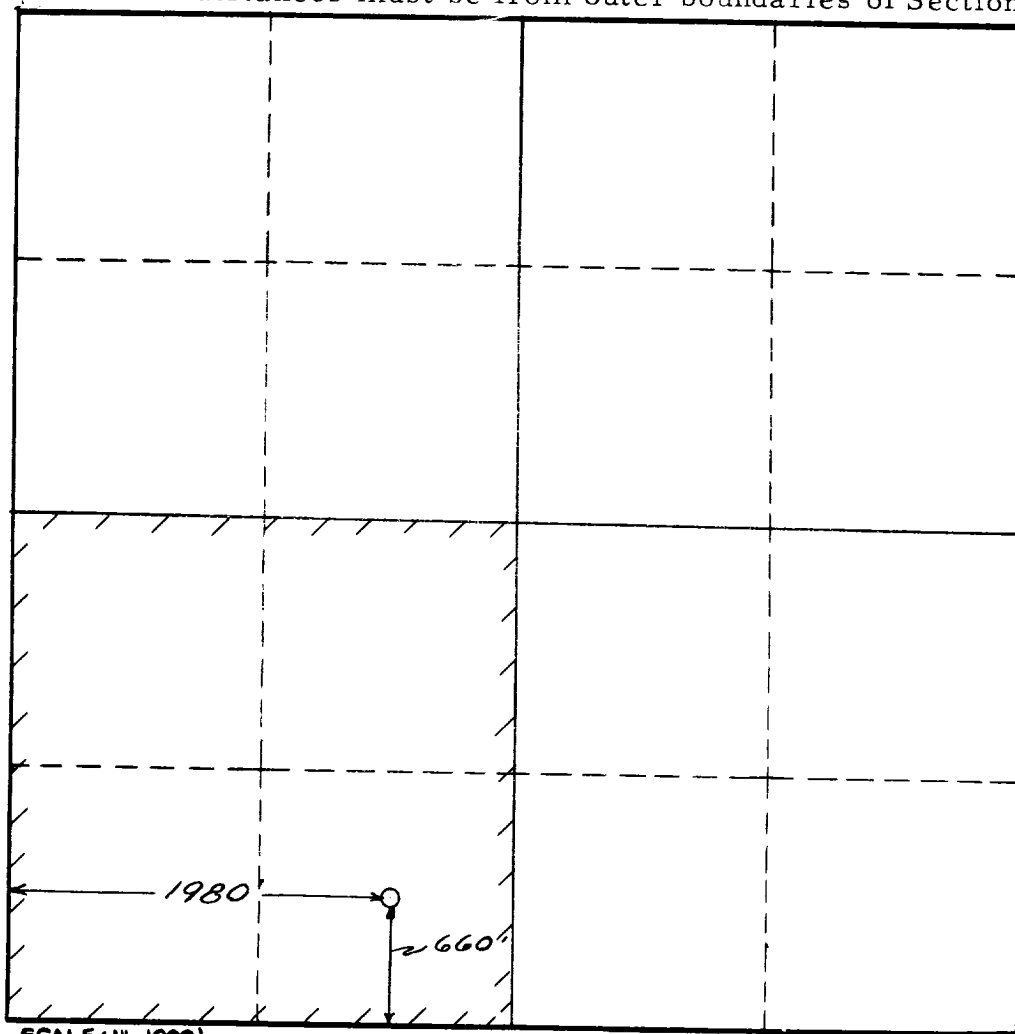

1. Is this Well a Dual Comp. ? Yes No **x**
2. If the answer to Question 1 is yes, are there any other dually completed wells within the dedicated acreage? Yes No

This is to certify that the above plat was prepared from field notes of actual surveys made by me or under my supervision and that the same are true and correct to the best of my knowledge and belief.

Name R. T. Wright
Position Petroleum Engineer
Representing El Paso Natural Gas Company
Address P. O. Box 1384, Jal, New Mexico

Date Surveyed
Registered Professional Engineer and/or
Land Surveyor