

RECEIVED: 03/04/22	REVIEWER: LRL	TYPE: NSL	APP NO: pLEL2206347537
--------------------	---------------	-----------	------------------------

ABOVE THIS TABLE FOR OCD DIVISION USE ONLY

NEW MEXICO OIL CONSERVATION DIVISION
 - Geological & Engineering Bureau -
 1220 South St. Francis Drive, Santa Fe, NM 87505



ADMINISTRATIVE APPLICATION CHECKLIST

THIS CHECKLIST IS MANDATORY FOR ALL ADMINISTRATIVE APPLICATIONS FOR EXCEPTIONS TO DIVISION RULES AND REGULATIONS WHICH REQUIRE PROCESSING AT THE DIVISION LEVEL IN SANTA FE

Applicant: EOG Resources, Inc. **OGRID Number:** 7377
Well Name: Rattlesnake 28 Fed Com 742H **API:** 30-025-48351
Pool: Sanders Tank; Upper Wolfcamp **Pool Code:** 98097

SUBMIT ACCURATE AND COMPLETE INFORMATION REQUIRED TO PROCESS THE TYPE OF APPLICATION INDICATED BELOW

- 1) **TYPE OF APPLICATION:** Check those which apply for [A]
 A. Location - Spacing Unit - Simultaneous Dedication
☒ NSL ☐ NSP (PROJECT AREA) ☐ NSP (PRORATION UNIT) ☐ SD
- B. Check one only for [I] or [II]
 [I] Commingling - Storage - Measurement
☐ DHC ☐ CTB ☐ PLC ☐ PC ☐ OLS ☐ OLM
 [II] Injection - Disposal - Pressure Increase - Enhanced Oil Recovery
☐ WFX ☐ PMX ☐ SWD ☐ IPI ☐ EOR ☐ PPR
- 2) **NOTIFICATION REQUIRED TO:** Check those which apply.
 A. ☒ Offset operators or lease holders
 B. ☐ Royalty, overriding royalty owners, revenue owners
 C. ☐ Application requires published notice
 D. ☐ Notification and/or concurrent approval by SLO
 E. ☒ Notification and/or concurrent approval by BLM
 F. ☐ Surface owner
 G. ☒ For all of the above, proof of notification or publication is attached, and/or,
 H. ☐ No notice required

FOR OCD ONLY

- ☐ Notice Complete
☐ Application Content Complete

- 3) **CERTIFICATION:** I hereby certify that the information submitted with this application for administrative approval is **accurate** and **complete** to the best of my knowledge. I also understand that **no action** will be taken on this application until the required information and notifications are submitted to the Division.

Note: Statement must be completed by an individual with managerial and/or supervisory capacity.

Jordan Kessler

Print or Type Name

Signature

3/4/22

Date

432-488-6108

Phone Number

jordan_kessler@eogresources.com

e-mail Address



Jordan Lee Kessler
Phone: (432) 488-6108
Email: jordan_kessler@eogresources.com

March 4, 2022

VIA ONLINE FILING

Adrienne Sandoval, Director
Oil Conservation Division
New Mexico Department of Energy, Minerals, and Natural Resources
1220 South St. Francis Drive
Santa Fe, New Mexico 87505

Re: Application of EOG Resources, Inc. for administrative approval of an unorthodox well location for its Rattlesnake 28 Fed Com No. 742H well in the W/2W/2 of Section 28 and the W/2NW/4 of Section 33, Township 26 South, Range 33 East, NMPM, Lea County, New Mexico.

Dear Director Sandoval,

EOG Resources, Inc. (OGRID No. 7377) seeks administrative approval of an unorthodox well location for its Rattlesnake 28 Fed Com No. 742H well (API No. 30-025-48351). The spacing unit dedicated to the well is comprised of the W/2W/2 of Section 28 and the W/2NW/4 of Section 33, Township 26 South, Range 33 East, Lea County, New Mexico and is within the Sanders Tank; Upper Wolfcamp pool.

The well has been drilled and is proposed to be completed as follows:

- The surface location is located 1075 feet from the North line, 2097 feet from the West line (Unit C) of Section 28,
- The bottom hole location is located 2446 feet from the North line, 1308 feet from the West line (Lot 4) of irregular Section 33,
- The first take point is located 100 feet from the North line, 1311 feet from the West line (Unit D) of Section 28,
- The last take point is located 2446 feet from the South line, 1308 feet from the West line (Lot 4) of irregular Section 33.

The acreage is governed by the Division's statewide rules. Accordingly, the proposed completed interval is unorthodox because it is closer than the 330 feet to the eastern boundary. It encroaches on the spacing unit in the E/2W/2 of Section 28 and the E/2NW/4 of Section 33. Approval of the

unorthodox location will allow EOG to use its preferred well spacing plan for horizontal wells, which will prevent waste. EOG intends to develop Sections 28 and 33 with 14 horizontal wells.

Exhibit A is the Form C-102 showing the location of the well, including the proposed unorthodox completed interval. The proposed completed interval encroaches on the spacing unit/tracts to the east.

Exhibit B is a plat for Sections 28 and 33 that shows the proposed Rattlesnake 28 Fed Com No. 742H well in relation to the adjoining spacing units/tracts to the east.

Ownership is diverse between the subject spacing unit and the affected spacing unit/tracts to the east. While the other working interest owner is the same, they own in a different percent in the adjacent tract. **Exhibit C** is a certification from the landman indicating that he has reviewed the tracts affected by this request. Exhibit C includes a list of the affected parties and proof that a copy of this application with all attachments has been sent by certified mail to each affected party. This notice advises affected parties that any objection must be filed in writing with the Division within 20 days from the date the Division receives the application.

Exhibit D is a statement from a petroleum engineer providing justification for the requested non-standard location.

Thank you for your attention to this matter.

Very truly yours,

A handwritten signature in blue ink, appearing to be 'J. Kessler', written over a horizontal line.

Jordan Kessler
Senior Regulatory Advisor

District I
1625 N. French Dr., Hobbs, NM 88240
Phone: (575) 393-6161 Fax: (575) 393-0720
District II
811 S. First St., Artesia, NM 88210
Phone: (575) 748-1283 Fax: (575) 748-9720
District III
1000 Rio Brazos Road, Aztec, NM 87410
Phone: (505) 334-6178 Fax: (505) 334-6170
District IV
1220 S. St. Francis Dr., Santa Fe, NM 87505
Phone: (505) 476-3460 Fax: (505) 476-3462

State of New Mexico
Energy, Minerals & Natural Resources
Department
OIL CONSERVATION DIVISION
1220 South St. Francis Dr.
Santa Fe, NM 87505

FORM C-102

Revised August 1, 2011

Submit one copy to appropriate

District Office

☐ AMENDED REPORT

WELL LOCATION AND ACREAGE DEDICATION PLAT

¹ API Number 30-025-48351		² Pool Code 98097		³ Pool Name Sanders Tank; Upper Wolfcamp	
⁴ Property Code 315293		⁵ Property Name RATTLESNAKE 28 FED COM			⁶ Well Number 742H
⁷ OGRID No. 7377		⁸ Operator Name EOG RESOURCES, INC.			⁹ Elevation 3241'
¹⁰ Surface Location					
UL or lot no. C	Section 28	Township 26-S	Range 33-E	Lot Idn -	Feet from the 1075'
		North/South line NORTH		Feet from the 2097'	
		East/West line WEST		County LEA	
¹¹ Bottom Hole Location If Different From Surface					
UL or lot no. 4	Section 33	Township 26-S	Range 33-E	Lot Idn -	Feet from the 2446'
		North/South line NORTH		Feet from the 1308'	
		East/West line WEST		County LEA	
¹² Dedicated Acres 237.13		¹³ Joint or Infill		¹⁴ Consolidation Code	
¹⁵ Order No.					

No allowable will be assigned to this completion until all interests have been consolidated or a non-standard unit has been approved by the division.

¹⁶ UPPER MOST PERF. NEW MEXICO EAST NAD 1927 X=773030.16 Y=372458.43 LAT.: N 32.0213484 LONG.: W 103.5810461 NAD 1983 X=774342 Y=372362 LAT.: N 32.0214736 LONG.: W 103.5815123		X=774350.95 Y=372461.60 AZ = 320.83° 1255.7'		21 22 28 27	
FED PERF. POINT NEW MEXICO EAST NAD 1927 X=773163 Y=371086 LAT.: N 32.0179977 LONG.: W 103.5810455 NAD 1983 X=774350 Y=371143 LAT.: N 32.0181230 LONG.: W 103.5815115		SURFACE LOCATION NEW MEXICO EAST NAD 1927 X=773947 Y=371331 LAT.: N 32.0186571 LONG.: W 103.5785096 NAD 1983 X=775135 Y=371388 LAT.: N 32.0187823 LONG.: W 103.5789755			
FED PERF. POINT NEW MEXICO EAST NAD 1927 X=773191 Y=367128 LAT.: N 32.0071189 LONG.: W 103.5810434 NAD 1983 X=774379 Y=367185 LAT.: N 32.0072443 LONG.: W 103.5815087		LOWER MOST PERF. BOTTOM HOLE LOCATION NEW MEXICO EAST NAD 1927 X=773208 Y=364682 LAT.: N 32.0003945 LONG.: W 103.5810421 NAD 1983 X=774396 Y=364739 LAT.: N 32.0005199 LONG.: W 103.5815070		27 34 33 34 NEW MEXICO TEXAS	

¹⁷OPERATOR CERTIFICATION
 I hereby certify that the information contained herein is true and complete to the best of my knowledge and belief, and that this organization either owns a working interest or unleased mineral interest in the land including the proposed bottom hole location or has a right to drill this well at this location pursuant to a contract with an owner of such a mineral or working interest, or to a voluntary pooling agreement or a compulsory pooling order heretofore entered by the division.
 Lisa Trascher 6/23/2020
 Signature Date
 Lisa Trascher
 Printed Name
 lisa_trascher@eogresources.com
 E-mail Address

¹⁸SURVEYOR CERTIFICATION
 I hereby certify that the well location shown on this plat was plotted from field notes of actual surveys made by me or under my supervision, and that the same is true to the best of my belief.
 01/21/2020
 Date of Survey
 Signature and Seal of Professional Surveyor
 RAMON A. DOMINGUEZ
 NEW MEXICO
 24508
 PROFESSIONAL SURVEYOR
 Certificate Number

Exhibit A

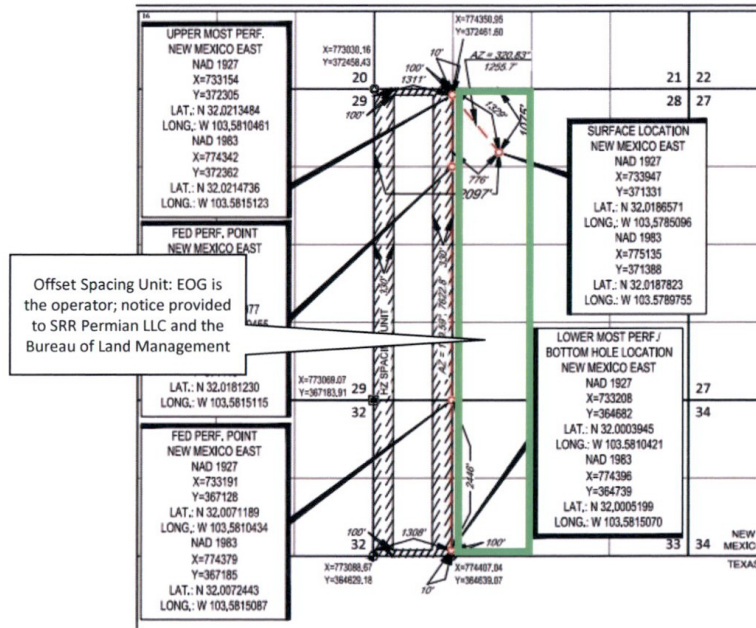

Exhibit B



P.O. Box 2267, Midland, Texas 79702
Phone: (432) 686-3600 Fax: (432) 686-3773

February 23, 2022

Certification of Ownership

I have reviewed the ownership of the oil and gas leasehold in Section 33 & 28 26S-33E, Lea County, New Mexico, for purposes of the unorthodox location for EOG's Rattlesnake 28 Fed Com #742H well located in the NE4NW4 of Section 28-26S-33H. As of the date of this letter, the affected parties are:

1. EOG Resources, Inc. - Operator
5509 Champions Dr.
Midland, TX 79706
2. SRR Permian LLC – Working Interest Owner
1751 River Run, Suite 200
Fort Worth, TX 76107
3. Bureau of Land Management – Royalty Interest Owner
301 Dinosaur Tr.
Santa Fe, NM 87508

Sincerely,

EOG Resources, Inc.

A handwritten signature in black ink, appearing to read "RC", written over a horizontal line.

Reece Cook
Senior Landman

Exhibit C



P.O. Box 2267, Midland, Texas 79702
Phone: (432) 686-3600 Fax: (432) 686-3773

February 23, 2022

Re: EOG Resources NSL Application
Rattlesnake 28 Fed Com #742H

To whom it may concern:

A non-standard location is necessary to develop the Wolfcamp formation in this section efficiently and in an economic manner. A non-standard location optimizes pressures related to the completion and production drawdown of the wells and is expected to yield a higher ultimate recovery than a standard location, thereby preventing waste and protecting correlative rights.

Sincerely,

A handwritten signature in blue ink, appearing to read "Anish Chaudhary", with a long horizontal flourish extending to the right.

EOG Resources
Anish Chaudhary
Reservoir Engineering Specialist

Exhibit D



Jordan Lee Kessler
Phone: (432) 488-6108
Email: jordan_kessler@eogresources.com

March 4, 2022

VIA CERTIFIED MAIL

TO: ALL AFFECTED PERSONS

Re: Application of EOG Resources, Inc. for administrative approval of an unorthodox well location for its Rattlesnake 28 Fed Com No. 742H well in the W/2W/2 of Section 28 and the W/2NW/4 of Section 33, Township 26 South, Range 33 East, NMPM, Lea County, New Mexico.

Ladies and Gentlemen:

Enclosed is a copy of the above-referenced application which was filed with the New Mexico Oil Conservation Division on this date. Any objection to this application must be filed in writing within twenty days from this date with the applicant and the New Mexico Oil Conservation Division, 1220 South St. Francis Drive, Santa Fe, New Mexico, 87505. If no objection is received within this twenty-day period, this application may be approved administratively by the Division.

If you have any questions about this application, please contact the following:

Reece Cook
EOG Resources, Inc.
(432) 8448-9216
Reece_cook@eogresources.com

Very truly yours,

A handwritten signature in blue ink, appearing to read "JL K", is written over a horizontal line.

Jordan Kessler
Senior Regulatory Advisor

Well Name	Date NSL Sent	Owners NSL Sent to	Certified Mail Tracking #
Rattlesnake 28 FC #742H	3/4/2022	SRR Permian LLC	7021 1970 0000 7794 1281
		Bureau of Land Management	7021 1970 0000 7794 1274

PLACE STICKER AT TOP OF ENVELOPE TO THE RIGHT
OF THE RETURN ADDRESS. FOLD AT DOTTED LINE

CERTIFIED MAIL®



7021 1970 0000 7794 1267
7021 1970 0000 7794 1267

**U.S. Postal Service™
CERTIFIED MAIL® RECEIPT
Domestic Mail Only**

For delivery information, visit our website at www.usps.com®.

OFFICIAL USE

Certified Mail Fee	
Extra Services & Fees (check box, add fee as appropriate)	
<input type="checkbox"/> Return Receipt (hardcopy)	\$ _____
<input type="checkbox"/> Return Receipt (electronic)	\$ _____
<input type="checkbox"/> Certified Mail Restricted Delivery	\$ _____
<input type="checkbox"/> Adult Signature Required	\$ _____
<input type="checkbox"/> Adult Signature Restricted Delivery	\$ _____

Postage
\$ _____

Total Postage and Fees
\$ _____

Sent to
SRP Permian LLC
Signal Cart No. of PO Box No.
195 Signal Cart No. 576 200
City, State, ZIP+4®
Fort Worth, TX 76107

PS Form 3800, April 2015 PSN 7530-02-000-9047 See Reverse for Instructions

Certified Mail service provides the following benefits:

- A receipt (this portion of the Certified Mail label).
 - A unique identifier for your mailpiece.
 - Electronic verification of delivery or attempted delivery.
 - A record of delivery (including the recipient's signature) that is retained by the Postal Service™ for a specified period.
- Important Reminders:**
- You may purchase Certified Mail service with First-Class Mail®, First-Class Package Service®, or Priority Mail® service.
 - Certified Mail service is *not* available for international mail.
 - Insurance coverage is *not* included with Certified Mail service. However, the purchase of Certified Mail service does not affect the insurance coverage automatically included with certain Priority Mail items.
 - For an additional fee, and with a proper endorsement on the mailpiece, you may request the following services:
 - Return receipt service, which provides a record of delivery (including the recipient's signature). You can request a hardcopy return receipt or an electronic version. For a hardcopy return receipt, complete PS Form 3811, Domestic Return Receipt; attach PS Form 3811 to your mailpiece; for an electronic return receipt, see a retail associate for assistance. To receive a duplicate return receipt for no additional fee, present this USPS® postmarked Certified Mail receipt to the retail associate.
 - Restricted delivery service, which provides delivery to the addressee specified by name, or to the addressee's authorized agent.
 - Adult signature service, which requires the signee to be at least 21 years of age (not available for retail).
 - Signature restricted delivery service, which requires the signee to be at least 21 years of age and delivery to the addressee specified by name, or to the addressee's authorized agent (available at retail).
- To ensure that your Certified Mail receipt is accepted as legal proof of mailing, it should bear a USPS postmark. If you would like a postmark on this Certified Mail receipt, please present your Certified Mail item at a Post Office™ for postmarking. If you don't need a postmark on this Certified Mail receipt, detach the barcoded portion of this label, affix it to the mailpiece, apply appropriate postage, and deposit the mailpiece.
- IMPORTANT: Save this receipt for your records.**

PS Form 3800, April 2015 (Reverse) PSN 7530-02-000-9047

EOG Resources, Inc.

Attn: Erin Lloyd

5509 Champions Drive

Midland, TX 79705

744H NSL

Date Sent 3-4-22

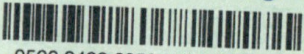
SENDER: COMPLETE THIS SECTION		COMPLETE THIS SECTION ON DELIVERY	
<ul style="list-style-type: none">■ Complete items 1, 2, and 3.■ Print your name and address on the reverse so that we can return the card to you.■ Attach this card to the back of the mailpiece, or on the front if space permits.		A. Signature X <input type="checkbox"/> Agent <input type="checkbox"/> Addressee	
1. Article Addressed to: SRR Permian LLC 1751 River Run, Ste 280 Fort Worth, TX 76107		B. Received by (Printed Name)	C. Date of Delivery
 9590 9402 6956 1104 4222 17		D. Is delivery address different from item 1? <input type="checkbox"/> Yes If YES, enter delivery address below: <input type="checkbox"/> No	
2. Article Number (Transfer from service label) 7021 1970 0000 7794 1267		3. Service Type <input type="checkbox"/> Adult Signature <input type="checkbox"/> Adult Signature Restricted Delivery <input checked="" type="checkbox"/> Certified Mail® <input type="checkbox"/> Certified Mail Restricted Delivery <input type="checkbox"/> Collect on Delivery <input type="checkbox"/> Collect on Delivery Restricted Delivery <input type="checkbox"/> Insured Mail <input type="checkbox"/> Insured Mail Restricted Delivery (over \$500) <input type="checkbox"/> Priority Mail Express® <input type="checkbox"/> Registered Mail™ <input type="checkbox"/> Registered Mail Restricted Delivery <input checked="" type="checkbox"/> Signature Confirmation™ <input type="checkbox"/> Signature Confirmation Restricted Delivery	
PS Form 3811, July 2020 PSN 7530-02-000-9053		Domestic Return Receipt	

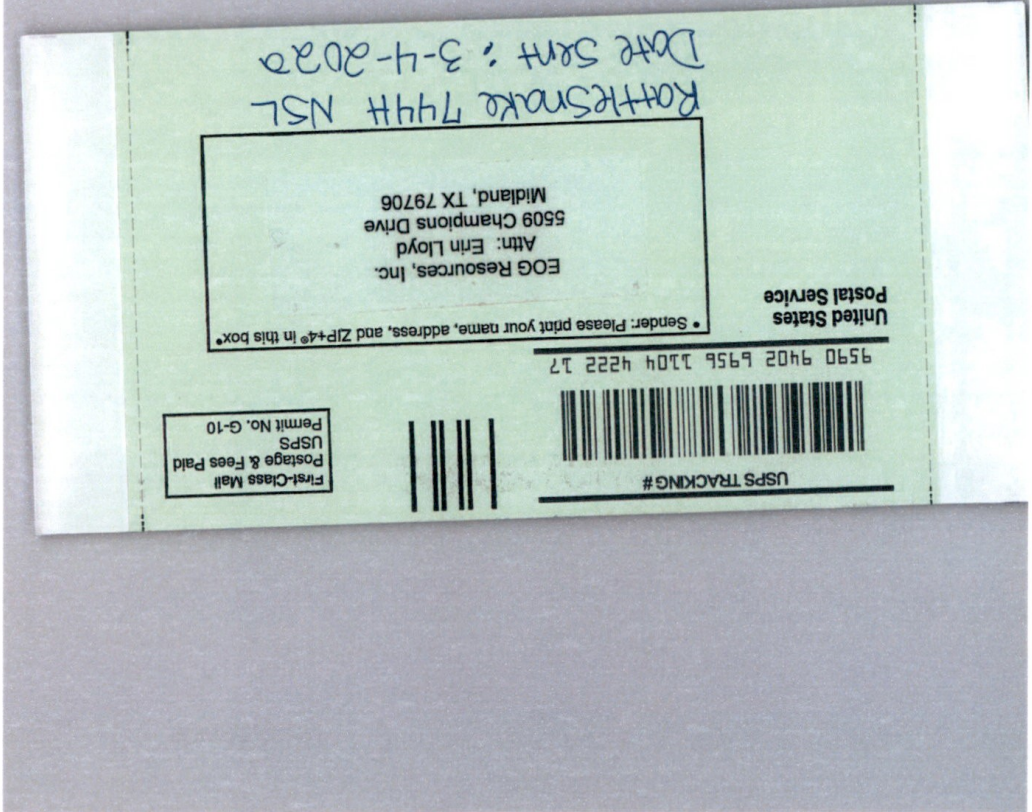

U.S. Postal Service™
CERTIFIED MAIL® RECEIPT
Domestic Mail Only

For delivery information, visit our website at www.usps.com™.

OFFICIAL USE

PLACE STICKER AT TOP OF ENVELOPE TO THE RIGHT OF THE RETURN ADDRESS. FOLD AT DOTTED LINE.

CERTIFIED MAIL®

7021 1970 0000 7794 1250
7021 1970 0000 7794 1250

Certified Mail Fee
\$

Extra Services & Fees (check box, add fee as appropriate)

<input type="checkbox"/> Return Receipt (hardcopy)	\$
<input type="checkbox"/> Return Receipt (electronic)	\$
<input type="checkbox"/> Certified Mail Restricted Delivery	\$
<input type="checkbox"/> Adult Signature Required	\$
<input type="checkbox"/> Adult Signature Restricted Delivery	\$

Postage
\$

Total Postage and Fees
\$

Sent To
Street and Apt. No., or PO Box No.
City, State, ZIP+4®

Bureau of Land Management
301 Dinosaur Trail
Santa Fe, NM 87508

PS Form 3800, April 2015 PSN 7530-02-000-1047 See Reverse for Instructions

Postmark
Here

Certified Mail service provides the following benefits:

- A receipt (this portion of the Certified Mail label).
- A unique identifier for your mailpiece.
- Electronic verification of delivery or attempted delivery.
- A record of delivery (including the recipient's signature) that is retained by the Postal Service™ for a specified period.
- Restricted delivery service, which provides delivery to the addressee specified by name, or to the addressee's authorized agent.
- Adult signature service, which requires the signee to be at least 21 years of age (not available in rural areas).

Important Reminders:

- You may purchase Certified Mail service with First-Class Mail®, First-Class Package Service®, or Priority Mail® service.
- Certified Mail service is not available for international mail.
- Insurance coverage is not available for mailpieces with Certified Mail service. However, the insurance coverage automatically included with certain Priority Mail items.
- For an additional fee, and with a proper endorsement on the mailpiece, you may request the following services:
 - Return receipt service, which provides a record of delivery (including the recipient's signature). You can request a hardcopy return receipt or an electronic version. For a hardcopy return receipt, complete PS Form 3811, Domestic Return Receipt; attach PS Form 3811 to your mailpiece; for an electronic return receipt, see a retail associate for assistance. To receive a duplicate return receipt for no additional fee, present this USPS®-postmarked Certified Mail receipt to the retail associate.
 - Restricted delivery service, which provides delivery to the addressee specified by name, or to the addressee's authorized agent.
 - Adult signature service, which requires the signee to be at least 21 years of age (not available in rural areas).
- To ensure that your Certified Mail receipt is accepted as legal proof of mailing, it should bear a USPS postmark. If you would like a postmark on this Certified Mail receipt, please present your Certified Mail item at a Post Office™ for postmarking. If you don't need a postmark on this Certified Mail receipt, detach the barcoded portion of this label, affix it to the mailpiece, apply appropriate postage, and deposit the mailpiece.

PS Form 3800, April 2015 (Reverse) PSN 7530-02-000-9047

EOG Resources, Inc.

Attn: Erin Lloyd

5509 Champions Drive

Midland, TX 79706

Rattlesnake 744H NSC

Date Sent 3-4-2022

SENDER: COMPLETE THIS SECTION		COMPLETE THIS SECTION ON DELIVERY	
<ul style="list-style-type: none">■ Complete items 1, 2, and 3.■ Print your name and address on the reverse so that we can return the card to you.■ Attach this card to the back of the mailpiece, or on the front if space permits.		A. Signature X <input type="checkbox"/> Agent <input type="checkbox"/> Addressee	
1. Article Addressed to: Bureau of Land Management 301 Dinosaur Trail Santa Fe, NM 87508		B. Received by (Printed Name)	C. Date of Delivery
 9590 9402 6956 1104 4222 24		D. Is delivery address different from item 1? <input type="checkbox"/> Yes If YES, enter delivery address below: <input type="checkbox"/> No	
2. Article Number (Transfer from service label) 7021 1970 0000 7794 1250		3. Service Type <input type="checkbox"/> Adult Signature <input type="checkbox"/> Adult Signature Restricted Delivery <input checked="" type="checkbox"/> Certified Mail® <input type="checkbox"/> Certified Mail Restricted Delivery <input type="checkbox"/> Collect on Delivery <input type="checkbox"/> Collect on Delivery Restricted Delivery <input type="checkbox"/> Insured Mail <input type="checkbox"/> Insured Mail Restricted Delivery (over \$500) <input type="checkbox"/> Priority Mail Express® <input type="checkbox"/> Registered Mail™ <input type="checkbox"/> Registered Mail Restricted Delivery <input checked="" type="checkbox"/> Signature Confirmation™ <input type="checkbox"/> Signature Confirmation Restricted Delivery	
PS Form 3811, July 2020 PSN 7530-02-000-9053		Domestic Return Receipt	

USPS TRACKING#



9590 9402 6956 1104 4222 24

United States
Postal Service

First-Class Mail
Postage & Fees Paid
USPS
Permit No. G-10

• Sender: Please print your name, address, and ZIP+4® in this box*

EOG Resources, Inc.
Attn: Erin Lloyd
5509 Champions Drive
Midland, TX 79706

Rattlesnake 744H NSL
Date Sent: 3-4-2022

District I
1625 N. French Dr., Hobbs, NM 88240
Phone:(575) 393-6161 Fax:(575) 393-0720
District II
811 S. First St., Artesia, NM 88210
Phone:(575) 748-1283 Fax:(575) 748-9720
District III
1000 Rio Brazos Rd., Aztec, NM 87410
Phone:(505) 334-6178 Fax:(505) 334-6170
District IV
1220 S. St Francis Dr., Santa Fe, NM 87505
Phone:(505) 476-3470 Fax:(505) 476-3462

State of New Mexico
Energy, Minerals and Natural Resources
Oil Conservation Division
1220 S. St Francis Dr.
Santa Fe, NM 87505

CONDITIONS

Action 87150

CONDITIONS

Operator: EOG RESOURCES INC P.O. Box 2267 Midland, TX 79702	OGRID: 7377
	Action Number: 87150
	Action Type: [UF-NSL] Non-Standard Location (NSL)

CONDITIONS

Created By	Condition	Condition Date
llowe	NSL-8333 is approved. The order can be reviewed at the OCD Imaging web site: https://ocdimage.emnrd.nm.gov/imaging/AEOrderCriteria.aspx	5/19/2022