

## NSP - 2218

ID NO. 362349

Revised March 23, 2017

RECEIVED: <b>07/09/24</b>	REVIEWER:	TYPE:	APP NO: <b>pLEL2419738608</b>
---------------------------	-----------	-------	-------------------------------

ABOVE THIS TABLE FOR OCD DIVISION USE ONLY

**NEW MEXICO OIL CONSERVATION DIVISION**  
 - Geological & Engineering Bureau -  
 1220 South St. Francis Drive, Santa Fe, NM 87505

**ADMINISTRATIVE APPLICATION CHECKLIST**

THIS CHECKLIST IS MANDATORY FOR ALL ADMINISTRATIVE APPLICATIONS FOR EXCEPTIONS TO DIVISION RULES AND REGULATIONS WHICH REQUIRE PROCESSING AT THE DIVISION LEVEL IN SANTA FE

**Applicant:** Mewbourne Oil Company **OGRID Number:** 14744  
**Well Name:** Pinta 29/27 Fed Com #711H & Pinta 29/27 Fed Com #716H **API:** Pending  
**Pool:** Wildcat Upper Wolfcamp **Pool Code:** 98241

**SUBMIT ACCURATE AND COMPLETE INFORMATION REQUIRED TO PROCESS THE TYPE OF APPLICATION INDICATED BELOW**

- 1) **TYPE OF APPLICATION:** Check those which apply for [A]  
 A. Location – Spacing Unit – Simultaneous Dedication  
☐ NSL ☐ NSP (PROJECT AREA) ☒ NSP (PRORATION UNIT) ☐ SD
- B. Check one only for [I] or [II]  
 [I] Commingling – Storage – Measurement  
☐ DHC ☐ CTB ☐ PLC ☐ PC ☐ OLS ☐ OLM  
 [II] Injection – Disposal – Pressure Increase – Enhanced Oil Recovery  
☐ WFX ☐ PMX ☐ SWD ☐ IPI ☐ EOR ☐ PPR
- 2) **NOTIFICATION REQUIRED TO:** Check those which apply.  
 A. ☒ Offset operators or lease holders  
 B. ☐ Royalty, overriding royalty owners, revenue owners  
 C. ☐ Application requires published notice  
 D. ☒ Notification and/or concurrent approval by SLO  
 E. ☒ Notification and/or concurrent approval by BLM  
 F. ☐ Surface owner  
 G. ☒ For all of the above, proof of notification or publication is attached, and/or,  
 H. ☐ No notice required

**FOR OCD ONLY**

- ☐ Notice Complete  
☐ Application Content Complete

- 3) **CERTIFICATION:** I hereby certify that the information submitted with this application for administrative approval is **accurate** and **complete** to the best of my knowledge. I also understand that **no action** will be taken on this application until the required information and notifications are submitted to the Division.

**Note:** Statement must be completed by an individual with managerial and/or supervisory capacity.

Braxton Blandford

Print or Type Name

Signature

7/8/2024

Date

432-682-3715

Phone Number

bblandford@mewbourne.com

e-mail Address

**MEWBOURNE OIL COMPANY****500 WEST TEXAS AVENUE, SUITE 1020  
MIDLAND, TEXAS 79701-4279****TELEPHONE (432) 682-3715**

July 8, 2024

*Via Certified Mail*

New Mexico Oil Conservation Division  
1220 S. St. Francis Drive  
Santa Fe, New Mexico 87505  
Attn: Mr. Leonard Lowe  
Division Director

Re: Application for Non-Standard Proration Unit  
**Pinta 29/27 Fed Com #711H (W0DA)**  
Surface Location: 1950 FNL & 205 FWL (Section 29)  
First Take Point: 660 FNL & 100 FWL (Section 29)  
Bottomhole Location/Last Take Point: 660 FNL & 100 FEL (Section 27)  
**Pinta 29/27 Fed Com #716H (W0LI)**  
Surface Location: 1990 FNL & 205 FWL (Section 29)  
First Take Point: 1850 FSL & 100 FWL (Section 29)  
Bottomhole Location/Last Take Point: 1850 FSL & 100 FEL (Section 27)  
Sections 27, 28 & 29, T-20-S, R-27-E, NMPM  
Eddy County, New Mexico

Dear Mr. Lowe:

Pursuant to Division Rule 19.15.16.15(B)(5), Mewbourne Oil Company ("Mewbourne") respectfully requests administrative approval of a non-standard proration unit for its proposed Pinta 29/27 wells listed above. These wells will be drilled as horizontal oil wells in the Wildcat, Upper Wolfcamp (Oil) pool (98241).

The Pinta 29/27 Fed Com #711H (W0DA) and Pinta 29/27 Fed Com #716H (W0LI) wells will be dedicated to a 1,920-acre proration unit comprising all of Sections 27, 28 and 29.

The affected offset acreage comprises the S/2S/2 of Sections 20, 21 and 22, SE/4SE/4 of Section 19, SW/4SW/4 of Section 23, E/2E/2 of Section 30, W/2W/2 of Section 26, NW/4NW/4 of Section 35, NE/4NE/4 of Section 31, and N/2N/2 of Sections 32, 33 and 34, all in T20S, R27E, Eddy County, New Mexico. Notice of this application is being provided to all parties listed on the attached list of affected parties.

Mewbourne is seeking approval of this NSP to eliminate the need for separate production facilities and additional administrative approvals. Therefore, reducing waste while protecting correlative rights within the referenced horizontal spacing unit.

Notice by certified mail, return receipt requested, has been given to the affected parties listed in the notification list attached.

Thank you for your consideration of this application. Should you have any questions regarding the above, please email me at [bblandford@mewbourne.com](mailto:bblandford@mewbourne.com) or call me at (432) 682-3715.

Sincerely,

**MEWBOURNE OIL COMPANY**

A handwritten signature in blue ink that reads "Braxton Blandford". The signature is fluid and cursive, with the first name "Braxton" and last name "Blandford" clearly distinguishable.

Braxton Blandford  
Landman

District I  
1625 N. French Dr., Hobbs, NM 88240  
Phone: (575) 393-6161 Fax: (575) 393-0720  
District II  
811 S. First St., Artesia, NM 88210  
Phone: (575) 748-1283 Fax: (575) 748-9720  
District III  
1000 Rio Brazos Road, Aztec, NM 87410  
Phone: (505) 334-6178 Fax: (505) 334-6170  
District IV  
1220 S. St. Francis Dr., Santa Fe, NM 87505  
Phone: (505) 476-3460 Fax: (505) 476-3462

State of New Mexico  
Energy, Minerals & Natural Resources Department  
**OIL CONSERVATION DIVISION**  
1220 South St. Francis Dr.  
Santa Fe, NM 87505

Form C-102  
Revised August 1, 2011  
Submit one copy to appropriate  
District Office

☐ AMENDED REPORT

**WELL LOCATION AND ACREAGE DEDICATION PLAT**

<sup>1</sup> API Number <b>30-015-Pending</b>		<sup>2</sup> Pool Code <b>98241</b>	<sup>3</sup> Pool Name <b>Wildcat, Upper Wolfcamp</b>
<sup>4</sup> Property Code	<sup>5</sup> Property Name <b>PINTA 29/27 FED COM</b>		<sup>6</sup> Well Number <b>711H</b>
<sup>7</sup> OGRID NO. <b>14744</b>	<sup>8</sup> Operator Name <b>MEWBOURNE OIL COMPANY</b>		<sup>9</sup> Elevation <b>3215'</b>

<sup>10</sup> Surface Location

UL or lot no.	Section	Township	Range	Lot Idn	Feet from the	North/South line	Feet From the	East/West line	County
<b>E</b>	<b>29</b>	<b>20S</b>	<b>27E</b>		<b>1950</b>	<b>NORTH</b>	<b>205</b>	<b>WEST</b>	<b>EDDY</b>

<sup>11</sup> Bottom Hole Location If Different From Surface

UL or lot no.	Section	Township	Range	Lot Idn	Feet from the	North/South line	Feet from the	East/West line	County
<b>A</b>	<b>27</b>	<b>20S</b>	<b>27E</b>		<b>660</b>	<b>NORTH</b>	<b>100</b>	<b>EAST</b>	<b>EDDY</b>

<sup>12</sup> Dedicated Acres <b>1,920</b>	<sup>13</sup> Joint or Infill	<sup>14</sup> Consolidation Code	<sup>15</sup> Order No.
---	-------------------------------	----------------------------------	-------------------------

No allowable will be assigned to this completion until all interest have been consolidated or a non-standard unit has been approved by the division.

<p><b>CORNER DATA</b> NAD 83 GRID - NM EAST</p> <p>A: FOUND BRASS CAP "1942" N: 559221.5 - E: 547863.1 J: FOUND BRASS CAP "1942" N: 559145.3 - E: 563765.8</p> <p>B: FOUND BRASS CAP "1942" N: 561873.2 - E: 547901.5 K: FOUND BRASS CAP "1942" N: 559161.8 - E: 561127.5</p> <p>C: FOUND BRASS CAP "1942" N: 564526.0 - E: 547939.6 L: FOUND BRASS CAP "1942" N: 559153.2 - E: 558477.3</p> <p>D: CALCULATED CORNER N: 564525.5 - E: 553189.8 M: FOUND BRASS CAP "1942" N: 559185.0 - E: 555823.3</p> <p>E: FOUND BRASS CAP "1942" N: 564496.2 - E: 555846.6 N: FOUND BRASS CAP "1934" N: 559216.9 - E: 553169.5</p> <p>F: FOUND BRASS CAP "1942" N: 564470.0 - E: 558504.7 O: FOUND BRASS CAP "1942" N: 559219.2 - E: 550516.0</p> <p>G: FOUND BRASS CAP "1942" N: 564416.2 - E: 561154.1 P: FOUND BRASS CAP "1942" N: 561871.2 - E: 553179.3</p> <p>H: FOUND BRASS CAP "1942" N: 564411.2 - E: 563796.1 Q: FOUND BRASS CAP "1942" N: 561826.2 - E: 558488.9</p> <p>I: FOUND BRASS CAP "1942" N: 561778.2 - E: 563779.6</p> <p><b>GEODETIC DATA</b> NAD 83 GRID - NM EAST</p> <p><b>SURFACE LOCATION</b> N: 562576.6 - E: 548116.6</p> <p>LAT: 32.5465785° N LONG: 104.3113330° W</p> <p><b>BOTTOM HOLE</b> N: 563751.6 - E: 563692.0</p> <p>LAT: 32.5497892° N LONG: 104.2607830° W</p>	<p><b><sup>17</sup> OPERATOR CERTIFICATION</b> I hereby certify that the information contained herein is true and complete to the best of my knowledge and belief, and that this organization either owns a working interest or unleased mineral interest in the land including the proposed bottom hole location or has a right to drill this well at this location pursuant to a contract with an owner of such a mineral or working interest, or to a voluntary pooling agreement or a compulsory pooling order heretofore entered by the division.</p> <p>Signature _____ Date _____</p> <p>Printed Name _____</p> <p>E-mail Address _____</p> <p><b><sup>18</sup> SURVEYOR CERTIFICATION</b> I hereby certify that the well location shown on this plat was plotted from field notes of actual surveys made by me or under my supervision, and that the same is true and correct to the best of my belief.</p> <p><b>10/25/2023</b> Date of Survey</p> <p>Signature and Seal of Professional Surveyor _____</p> <p><b>19680</b> Certificate Number</p> <p>REV: NAME CHANGE - 11/27/2023</p> <p><b>Job No.: LS23100957D</b></p>
--	---

District I  
1625 N. French Dr., Hobbs, NM 88240  
Phone: (575) 393-6161 Fax: (575) 393-0720  
District II  
811 S. First St., Artesia, NM 88210  
Phone: (575) 748-1283 Fax: (575) 748-9720  
District III  
1000 Rio Brazos Road, Aztec, NM 87410  
Phone: (505) 334-6178 Fax: (505) 334-6170  
District IV  
1220 S. St. Francis Dr., Santa Fe, NM 87505  
Phone: (505) 476-3460 Fax: (505) 476-3462

State of New Mexico  
Energy, Minerals & Natural Resources Department  
OIL CONSERVATION DIVISION  
1220 South St. Francis Dr.  
Santa Fe, NM 87505

Form C-102  
Revised August 1, 2011  
Submit one copy to appropriate  
District Office

☐ AMENDED REPORT

WELL LOCATION AND ACREAGE DEDICATION PLAT

<sup>1</sup> API Number 30-015-Pending		<sup>2</sup> Pool Code 98241		<sup>3</sup> Pool Name Wildcat, Upper Wolfcamp	
<sup>4</sup> Property Code		<sup>5</sup> Property Name PINTA 29/27 FED COM			<sup>6</sup> Well Number 716H
<sup>7</sup> OGRID NO. 14744		<sup>8</sup> Operator Name MEWBOURNE OIL COMPANY			<sup>9</sup> Elevation 3214'

<sup>10</sup> Surface Location

UL or lot no.	Section	Township	Range	Lot Idn	Feet from the	North/South line	Feet From the	East/West line	County
E	29	20S	27E		1990	NORTH	205	WEST	EDDY

<sup>11</sup> Bottom Hole Location If Different From Surface

UL or lot no.	Section	Township	Range	Lot Idn	Feet from the	North/South line	Feet from the	East/West line	County
I	27	20S	27E		1850	SOUTH	100	EAST	EDDY

<sup>12</sup> Dedicated Acres 1,920	<sup>13</sup> Joint or Infill	<sup>14</sup> Consolidation Code	<sup>15</sup> Order No.
--	-------------------------------	----------------------------------	-------------------------

No allowable will be assigned to this completion until all interest have been consolidated or a non-standard unit has been approved by the division.

<p><b>CORNER DATA</b> NAD 83 GRID - NM EAST</p> <p>A: FOUND BRASS CAP "1942" N: 559221.5 - E: 547863.1</p> <p>B: FOUND BRASS CAP "1942" N: 561873.2 - E: 547901.5</p> <p>C: FOUND BRASS CAP "1942" N: 564526.0 - E: 547939.6</p> <p>D: CALCULATED CORNER N: 564525.5 - E: 553189.8</p> <p>E: FOUND BRASS CAP "1942" N: 564496.2 - E: 555846.6</p> <p>F: FOUND BRASS CAP "1942" N: 564470.0 - E: 558504.7</p> <p>G: FOUND BRASS CAP "1942" N: 564416.2 - E: 561154.1</p> <p>H: FOUND BRASS CAP "1942" N: 564411.2 - E: 563796.1</p> <p>I: FOUND BRASS CAP "1942" N: 561778.2 - E: 563779.6</p> <p>J: FOUND BRASS CAP "1942" N: 559145.3 - E: 563765.8</p> <p>K: FOUND BRASS CAP "1942" N: 559161.8 - E: 561127.5</p> <p>L: FOUND BRASS CAP "1942" N: 559153.2 - E: 558477.3</p> <p>M: FOUND BRASS CAP "1942" N: 559185.0 - E: 555823.3</p> <p>N: FOUND BRASS CAP "1934" N: 559216.9 - E: 553169.5</p> <p>O: FOUND BRASS CAP "1942" N: 559219.2 - E: 550516.0</p> <p>P: FOUND BRASS CAP "1942" N: 561871.2 - E: 553179.3</p> <p>Q: FOUND BRASS CAP "1942" N: 561826.2 - E: 558488.9</p> <p><b>GEODETIC DATA</b> NAD 83 GRID - NM EAST</p> <p><b>SURFACE LOCATION</b> N: 562536.7 - E: 548116.0 LAT: 32.5464686° N LONG: 104.3113348° W</p> <p><b>BOTTOM HOLE</b> N: 560995.4 - E: 563675.6 LAT: 32.5422131° N LONG: 104.2608425° W</p>	<p><b><sup>17</sup> OPERATOR CERTIFICATION</b> I hereby certify that the information contained herein is true and complete to the best of my knowledge and belief, and that this organization either owns a working interest or unleased mineral interest in the land including the proposed bottom hole location or has a right to drill this well at this location pursuant to a contract with an owner of such a mineral or working interest, or to a voluntary pooling agreement or a compulsory pooling order heretofore entered by the division.</p> <p>Signature: _____ Date: _____</p> <p>Printed Name: _____</p> <p>E-mail Address: _____</p> <p><b><sup>18</sup> SURVEYOR CERTIFICATION</b> I hereby certify that the well location shown on this plat was plotted from field notes of actual surveys made by me or under my supervision, and that the same is true and correct to the best of my belief.</p> <p>10/25/2023 Date of Survey</p> <p>Signature and Seal of Professional Surveyor</p> <p>19680 Certificate Number</p> <p>REV: NAME CHANGE - 11/27/2023</p> <p>Job No.: LS23100959D</p>
--	--



**NSP Plat of Affected Tracts**  
**Nina 27/28 Pinta 28/29**

**T20S, R27E, Eddy County, New Mexico**

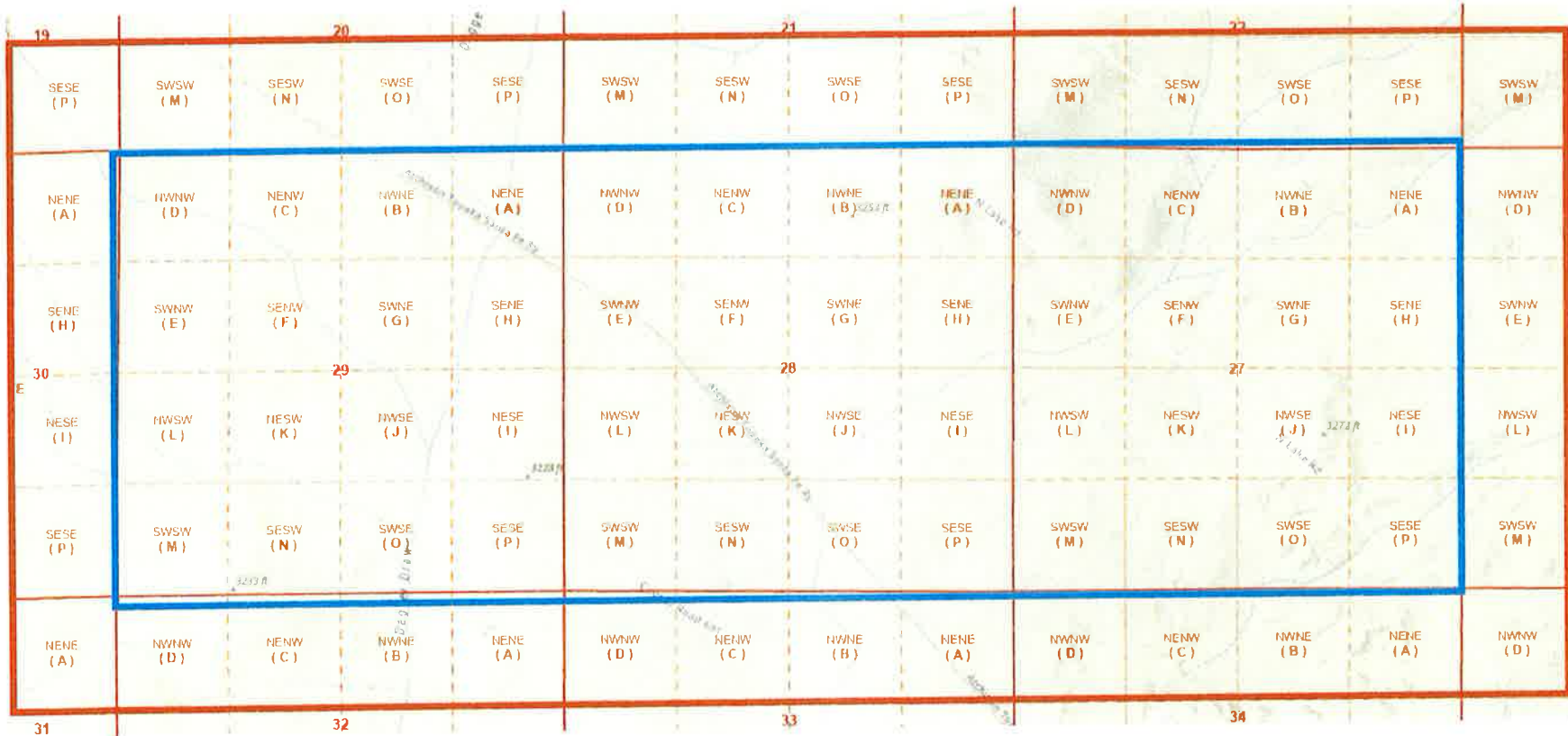

Proration Unit

Affected Tracts

**MEWBOURNE OIL COMPANY**  
500 WEST TEXAS AVENUE, SUITE 1020  
MIDLAND, TEXAS 79701-4279

TELEPHONE (432) 682-3715

July 8, 2024

Via Certified Mail

Affected Parties (See Attached List)

Re: Application for Non-Standard Proration Unit  
**Pinta 29/27 Fed Com #711H (W0DA)**  
Surface Location: 1950 FNL & 205 FWL (Section 29)  
First Take Point: 660 FNL & 100 FWL (Section 29)  
Bottomhole Location/Last Take Point: 660 FNL & 100 FEL (Section 27)  
**Pinta 29/27 Fed Com #716H (W0LI)**  
Surface Location: 1990 FNL & 205 FWL (Section 29)  
First Take Point: 1850 FSL & 100 FWL (Section 29)  
Bottomhole Location/Last Take Point: 1850 FSL & 100 FEL (Section 27)  
Sections 27, 28 & 29, T-20-S, R-27-E, NMPM  
Eddy County, New Mexico

To Whom It May Concern:

Enclosed is a copy of Mewbourne Oil Company's (MOC) Application for Non-Standard Proration Unit for the Pinta 29/27 Fed Com #711H and Pinta 29/27 Fed Com #716H wells covering all of Sections 27, 28 and 29, T-20-S, R-27-E, Eddy County, New Mexico. You are being sent a copy of this Application per OCD's requirements to notify the interest owners in the affected offset acreage. If you have any objection to this Application, notification should be given within 20 days of the date of this letter. The Application has been filed with the OCD as of this date.

MOC is seeking approval of the non-standard proration unit to eliminate the need for separate production facilities and additional administrative approvals. Therefore, reducing waste while protecting correlative rights with the referenced horizontal spacing unit.

If you have any questions regarding this application, please contact me via telephone at 432-682-3715 or via email at [bblandford@mewbourne.com](mailto:bblandford@mewbourne.com).

Sincerely,

**MEWBOURNE OIL COMPANY**



Braxton Blandford  
Landman

## Affected Parties

Type	Certified Mail Tracking Number	Location of Affected Acreage	Owners	Attn	Address Line 1	Address Line 2	City	State	Zip Code
BLM		NE/4NE/4 of Section 31, N/2N/2 of Sections 32, 33 and 34, NW/4NW/4 of Section 35, S/2SW/4 of Section 20, T20S, R27E, Eddy County, New Mexico.	Bureau of Land Management		301 Dinosaur Trail		Santa Fe	NM	87508
State		SE/4SE/4 of Section 19, E/2E/2 of Section 30, SW/4SW/4 of Section 23, W/2W/2 of Section 26, S/2S/2 of Section 22, SE/4SW/4 and S/2SE/4 of Section 21, T20S, R27E, Eddy County, New Mexico.	New Mexico State Land Office		310 Old Santa Fe Trail		Santa Fe	NM	87504-1148
Lessee of Record K0-4990-8		S/2SW/4 of Section 22, T20S, R27E, Eddy County, New Mexico.	OXY USA, Inc.	Attn: Land Department	5 Greenway Plaza	Suite 110	Houston	TX	77046
Lessee of Record VB-540-2		S/2SE/4 of Section 22, W/2SW/4 of Section 26, SE/4SW/4 and S/2SE/4 of Section 21, T20S, R27E, Eddy County, New Mexico.	Premier Oil & Gas, Inc.	Attn: Ken Jones	P.O. Box 837205		Richardson	TX	75083-7205
Lessee of Record K0-6437-3									
Lessee of Record VC-1081									
Lessee of Record L0-6865-1		SW/4SW/4 of Section 23, W/2NW/4 of Section 26, T20S, R27E, Eddy County, New Mexico.	Fasken Land and Minerals, Ltd.	Attn: Mike Wallace	6101 Holiday Hill Road		Midland	TX	79707-1631
Lessee of Record NMLC-0072015C		NW/4NW/4 of Section 35, N/2N/2 of Sections 33 and 34, T20S, R27E, Eddy County, New Mexico	COG Operating, LLC	Attn: Land Department	600 W. Illinois Ave.		Midland	TX	79701
Lessee of Record VC-820		SE/4SE/4 of Section 19, E/2E/2 of Section 30, T20S, R27E, Eddy County, New Mexico.	Tascosa Energy Partners, LLC	Attn: Land Department	901 W. Missouri Ave.		Midland	TX	79701
Lessee of Record VC-542									
Lessee of Record VC-543									
Lessee of Record NMNM 015869		N/2NE/4 of Section 32, T20S, R27E, Eddy County, New Mexico.	Blue Hill Oil & Gas Co.	Attn: Land Department	757 Williams St.		Denver	CO	80218
Lessee of Record NMNM 015869		N/2NE/4 of Section 32, T20S, R27E, Eddy County, New Mexico.	Read & Stevens, Inc.	Attn: Land Department	300 N. Marienfeld St.	Suite 1000	Midland	TX	79701
Lessee of Record NMNM 0400512		N/2NW/4 of Section 32, NE/4NE/4 of Section 31, T20S, R27E, Eddy County, New Mexico.	Kaiser-Franics Oil Co.	Attn: Land Department	P.O. Box 21468		Tulsa	OK	74121
Lessee of Record NMNM 019598		S/2SW/4 of Section 20, T20S, R27E, Eddy County, New Mexico.	Abo Petroleum, LLC	Attn: Justin McClelland	P.O. Box 900		Artesia	NM	88211-0900
Lessee of Record NMNM 019598		S/2SW/4 of Section 20, T20S, R27E, Eddy County, New Mexico.	Vladin, LLC	Attn: Travis Brown	P.O. Box 100		Artesia	NM	88211-0100
Lessee of Record NMNM 019598		S/2SW/4 of Section 20, T20S, R27E, Eddy County, New Mexico.	Los Chicos	Attn: Justin McClelland	P.O. Box 900		Artesia	NM	88211-0900
Fee Lease		S/2SE/4 of Section 20 and SW/4SW/4 of Section 21, T20S, R27E, Eddy County, New Mexico.	TD Minerals, LLC	Attn: Land Department	8111 Westchester Drive	Suite 900	Dallas	TX	75225
Fee Lease		S/2SE/4 of Section 20 and SW/4SW/4 of Section 21, T20S, R27E, Eddy County, New Mexico.	Patricia B. Young		P.O. Box 1037		Okmulgee	OK	74447-1037



**District I**  
1625 N. French Dr., Hobbs, NM 88240  
Phone:(575) 393-6161 Fax:(575) 393-0720  
**District II**  
811 S. First St., Artesia, NM 88210  
Phone:(575) 748-1283 Fax:(575) 748-9720  
**District III**  
1000 Rio Brazos Rd., Aztec, NM 87410  
Phone:(505) 334-6178 Fax:(505) 334-6170  
**District IV**  
1220 S. St Francis Dr., Santa Fe, NM 87505  
Phone:(505) 476-3470 Fax:(505) 476-3462

State of New Mexico  
Energy, Minerals and Natural Resources  
Oil Conservation Division  
1220 S. St Francis Dr.  
Santa Fe, NM 87505

CONDITIONS

Action 362349

CONDITIONS

Operator: MEWBOURNE OIL CO P.O. Box 5270 Hobbs, NM 88241	OGRID: 14744
	Action Number: 362349
	Action Type: [UF-NSP] Non-Standard Proration (NSP)

CONDITIONS

Created By	Condition	Condition Date
llowe	None	7/15/2024