



AE Order Number Banner

Report Description

This report shows an AE Order Number in Barcode format for purposes of scanning. The Barcode format is Code 39.



App Number: pGRL1011656482

X2

1RP - 2488

SOUTHERN UNION GAS COMPANY

2/12/2016

District I
1625 N. French Dr., Hobbs, NM 88240
District II
1301 W. Grand Avenue, Artesia, NM 88210
District III
1000 Rio Brazos Road, Aztec, NM 87410
District IV
1220 S. St. Francis Dr., Santa Fe, NM 87505

State of New Mexico
Energy Minerals and Natural Resources

Oil Conservation Division
1220 South St. Francis Dr.
Santa Fe, NM 87505

RECEIVED
APR 23 2010
HOBBSDO

Form C-141
Revised October 10, 2003

Submit 2 Copies to appropriate
District Office in accordance
with Rule 116 on back
side of form

Release Notification and Corrective Action

OPERATOR

☒ Initial Report ☐ Final Report

Name of Company: Southern Union Gas Services	Contact: Rose Slade	
Address P.O. Box 1226 Jal, N.M. 88252	Telephone No. 432-940-5147	
Facility Name: Lea County Field Dept.	Facility Type: 6" lateral	
Surface Owner: Gerald Doom	Mineral Owner	Lease No.

LOCATION OF RELEASE

Unit Letter	Section	Township	Range	Feet from the	North/South Line	Feet from the	East/West Line	County
L	26	24	37					Lea County

Latitude_32 11.384 Longitude_103 08.154

NATURE OF RELEASE API # 30-025-38922-00-00

Type of Release: crude oil/produced water	Volume of Release: 5 barrels	Volume Recovered: 0
Source of Release: 6" pipeline	Date and Hour of Occurrence: 4/19/2010 at 11:30 pm (not reportable at the time)	Date and Hour of Discovery: 4/20/2010 At 7:45 am
Was Immediate Notice Given? <input checked="" type="checkbox"/> Yes <input type="checkbox"/> No <input type="checkbox"/> Not Required	If YES, To Whom? Jeoffery Lecking (OCD)	
By Whom? Rose Slade	Date and Hour: 4/20/2010 at 8:58 am	
Was a Watercourse Reached? <input type="checkbox"/> Yes <input checked="" type="checkbox"/> No	If YES, Volume Impacting the Watercourse.	
If a Watercourse was Impacted, Describe Fully.* N/A		

WATER @ 200'

Describe Cause of Problem and Remedial Action Taken.*

The line had a split on the 6" steel line. They had to replace with 100 feet of poly pipe. EHS was notified and I immediately dispatched my environmental company to go to the site and remediate the site.

Describe Area Affected and Cleanup Action Taken.*

Approximately 3' x 25' of land was affected by the leak. The environmental consultant delineated & sampled the site affected and put the contaminated soil onto plastic until the analytical comes back with analysis for closure. The landowner was notified immediately by SUGS personnel. SUGS will be working closely with the NMOCD and the landowner to reach closure.

I hereby certify that the information given above is true and complete to the best of my knowledge and understand that pursuant to NMOCD rules and regulations all operators are required to report and/or file certain release notifications and perform corrective actions for releases which may endanger public health or the environment. The acceptance of a C-141 report by the NMOCD marked as "Final Report" does not relieve the operator of liability should their operations have failed to adequately investigate and remediate contamination that pose a threat to ground water, surface water, human health or the environment. In addition, NMOCD acceptance of a C-141 report does not relieve the operator of responsibility for compliance with any other federal, state, or local laws and/or regulations.

Signature: <i>Rose Slade</i>		OIL CONSERVATION DIVISION	
Printed Name: Rosa L. Slade		Approved by: ENV ENGINEER: <i>Jeoffery Lecking</i> District Supervisor	
Title: EHS Compliance Specialist	Approval Date: 04/26/10	Expiration Date: 06/28/10	
E-mail Address: rose.slade@sug.com	Conditions of Approval: SUBMIT FINAL C-141 BY 06/28/10		Attached <input type="checkbox"/>
Date: 4/23/2010	Phone: 432-940-5147	IRP-10-4-2488	

* Attach Additional Sheets If Necessary

District I
1625 N. French Dr., Hobbs, NM 88240
District II
811 S. First St., Artesia, NM 88210
District III
1000 Rio Brazos Road, Aztec, NM 87410
District IV
1220 S. St. Francis Dr., Santa Fe, NM 87505

State of New Mexico
Energy Minerals and Natural Resources

Oil Conservation Division
1220 South St. Francis Dr.
Santa Fe, NM 87505

Form C-141
Revised August 8, 2011

Submit 1 Copy to appropriate District Office in
accordance with 19.15.29 NMAC.

Release Notification and Corrective Action

OPERATOR

☐ Initial Report ☒ Final Report

Name of Company Southern Union Gas Services	Contact Rose Slade
Address 801 South Loop 464, Monahans, Texas 79756	Telephone No. 432.940.5147
Facility Name Lea County Field Dept.	Facility Type 6" Lateral

Surface Owner Gerald Doom	Mineral Owner	API No. 30-025-38822.00.00
---------------------------	---------------	----------------------------

LOCATION OF RELEASE

Unit Letter	Section	Township	Range	Feet from the	North/South Line	Feet from the	East/West Line	County
L	26	24S	37E					Lea

Latitude 32 11.384 Longitude 103 08.154

NATURE OF RELEASE

Type of Release Crude Oil/Produced Water	Volume of Release 5 barrels	Volume Recovered none
Source of Release 6 inch pipeline	Date and Hour of Occurrence 4/19/2010 at 11:30 pm (not reportable at the time)	Date and Hour of Discovery 4/20/2010 at 7:45 am
Was Immediate Notice Given? <input checked="" type="checkbox"/> Yes <input type="checkbox"/> No <input type="checkbox"/> Not Required	If YES, To Whom? Geoffrey Leking	
By Whom? Rose Slade	Date and Hour 4/20/2010 at 8:58 am	
Was a Watercourse Reached? <input type="checkbox"/> Yes <input checked="" type="checkbox"/> No	If YES, Volume Impacting the Watercourse.	

HOBBS OCD

If a Watercourse was Impacted, Describe Fully.*

DEC 12 2012

RECEIVED

Describe Cause of Problem and Remedial Action Taken.*

The line developed a split on the 6 inch steel line. Line was replaced with approximately 100 feet of poly pipe. EHS was notified and I immediately dispatched an environmental company to the site to conduct remediation activities.

Describe Area Affected and Cleanup Action Taken.* An area measuring approximately 3' x 25' was impacted by the leak. The site was excavated, soil samples were collected from the excavation and submitted to the laboratory for benzene, BTEX, TPH and chloride analysis. Laboratory results indicated benzene, BTEX, TPH, and chloride concentrations were less than the NMOCD Regulatory Guidelines. Approximately 468 cubic yards of impacted soil was transported to Doom Land Farm, LLC for disposal. The excavation was backfilled with locally obtained non-impacted soil. Please reference the NOVA Safety and Environmental Soil Remediation Summary and Site Closure Request dated November 2012 for further details.

I hereby certify that the information given above is true and complete to the best of my knowledge and understand that pursuant to NMOCD rules and regulations all operators are required to report and/or file certain release notifications and perform corrective actions for releases which may endanger public health or the environment. The acceptance of a C-141 report by the NMOCD marked as "Final Report" does not relieve the operator of liability should their operations have failed to adequately investigate and remediate contamination that pose a threat to ground water, surface water, human health or the environment. In addition, NMOCD acceptance of a C-141 report does not relieve the operator of responsibility for compliance with any other federal, state, or local laws and/or regulations.

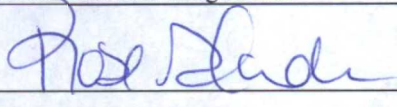
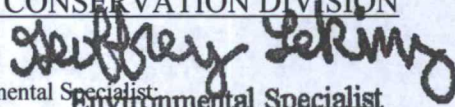
Signature: 	OIL CONSERVATION DIVISION  Approved by Environmental Specialist	
Printed Name: Rose Slade	Environmental Specialist	
Title: EH&S Specialist	Approval Date: 12/12/12	Expiration Date: -
E-mail Address: rose.slade@sug.com	Conditions of Approval: -	Attached <input type="checkbox"/>
Date: 12/13/12 Phone: 432.940.5147		1RP-10.4.2488

* Attach Additional Sheets If Necessary

District I
1625 N. French Dr., Hobbs, NM 88240
District II
811 S. First St., Artesia, NM 88210
District III
1000 Rio Brazos Road, Aztec, NM 87410
District IV
1220 S. St. Francis Dr., Santa Fe, NM 87505

State of New Mexico
Energy Minerals and Natural Resources

Oil Conservation Division
1220 South St. Francis Dr.
Santa Fe, NM 87505

Form C-141
Revised August 8, 2011

Submit 1 Copy to appropriate District Office in
accordance with 19.15.29 NMAC.

Release Notification and Corrective Action

OPERATOR

☐ Initial Report ☒ Final Report

Name of Company Southern Union Gas Services	Contact Rose Slade
Address 801 South Loop 464, Monahans, Texas 79756	Telephone No. 432.940.5147
Facility Name Lea County Field Dept.	Facility Type Trunk MB-1

Surface Owner State of New Mexico	Mineral Owner State of New Mexico	API No.
-----------------------------------	-----------------------------------	---------

LOCATION OF RELEASE

Unit Letter	Section	Township	Range	Feet from the	North/South Line	Feet from the	East/West Line	County
P	16	25S	37E					Lea

Latitude 32 07.526 Longitude 103 09.695

NATURE OF RELEASE

Type of Release Crude Oil/Natural Gas	Volume of Release 10 barrels crude oil, 40,000 mcf natural gas	Volume Recovered 3.5 barrels
Source of Release 8" natural gas pipeline	Date and Hour of Occurrence 4/17/08 at 3:00 pm	Date and Hour of Discovery 4/18/08 at 10:40 am
Was Immediate Notice Given? <input type="checkbox"/> Yes <input type="checkbox"/> No <input checked="" type="checkbox"/> Not Required	If YES, To Whom? The leak was discovered by NMOCD field inspector	
By Whom?	Date and Hour 4/23/07 at 12:55 pm	
Was a Watercourse Reached? <input type="checkbox"/> Yes <input checked="" type="checkbox"/> No	If YES, Volume Impacting the Watercourse.	

If a Watercourse was Impacted, Describe Fully.*

HOBBS OGD

DEC 12 2012

Describe Cause of Problem and Remedial Action Taken.*

A 8" natural gas gathering line operating at approximately 30 p.s.i. was damaged during a line repair on 4/17/08. The leak was discovered on 4/18/08. The damaged section of pipe was excavated and repaired. Approximately 3.5 barrels of oil was recovered during the repair.

RECEIVED

Describe Area Affected and Cleanup Action Taken.* The site was excavated, soil samples were collected from the excavation and stockpiled soil and submitted to the laboratory for benzene, BTEX, TPH and chloride analysis. Laboratory results indicated benzene, BTEX, TPH, and chloride concentrations were less than the NMOCD Regulatory Guidelines. The excavation was backfilled with the stockpiled soil. Please reference the NOVA Safety and Environmental Site Investigation Summary and Site Closure Request dated December 2012 for further details.

I hereby certify that the information given above is true and complete to the best of my knowledge and understand that pursuant to NMOCD rules and regulations all operators are required to report and/or file certain release notifications and perform corrective actions for releases which may endanger public health or the environment. The acceptance of a C-141 report by the NMOCD marked as "Final Report" does not relieve the operator of liability should their operations have failed to adequately investigate and remediate contamination that pose a threat to ground water, surface water, human health or the environment. In addition, NMOCD acceptance of a C-141 report does not relieve the operator of responsibility for compliance with any other federal, state, or local laws and/or regulations.

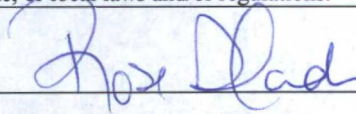
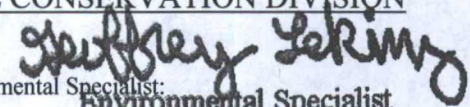
Signature: 	OIL CONSERVATION DIVISION	
Printed Name: Rose Slade	Approved by Environmental Specialist:  Environmental Specialist	
Title: EH&S Specialist	Approval Date: 12/12/12	Expiration Date: -
E-mail Address: rose.slade@sug.com	Conditions of Approval: -	Attached <input type="checkbox"/>
Date: 12/13/12 Phone: 432.940.5147	1RP-1848	

* Attach Additional Sheets If Necessary



**SOIL REMEDIATION SUMMARY
AND SITE
CLOSURE REQUEST**

**Southern Union Gas Services
6-Inch Lateral Historical Release Site
Lea County, New Mexico
UNIT LTR "L" (NW ¼ /SW ¼), Section 26, Township 24 South, Range 37 East
Latitude 32° 11.384' North, Longitude 103° 08.154' West
NMOCD Reference # 1RP-2488**



Prepared For:

**Southern Union Gas Services
801 South Loop 464
Monahans, Texas 79756**

HOBBS OCD

DEC 12 2012

Prepared By:

**NOVA Safety & Environmental
2057 Commerce
Midland, Texas 79703**



RECEIVED

November 2012

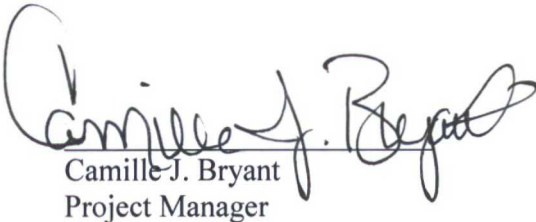
Camille J. Bryant
Project Manager



Brittan K. Byerly, P.G.
President

TABLE OF CONTENTS

1.0	INTRODUCTION	1
2.0	NMOCD SITE CLASSIFICATION.....	1
3.0	SUMMARY OF SOIL REMEDIATION ACTIVITIES.....	2
4.0	QA/QC PROCEDURES	3
4.1	Soil Sampling	3
4.2	Decontamination of Equipment	3
4.3	Laboratory Protocol	3
5.0	SITE CLOSURE REQUEST.....	4
6.0	LIMITATIONS.....	4
7.0	DISTRIBUTION.....	5

FIGURES

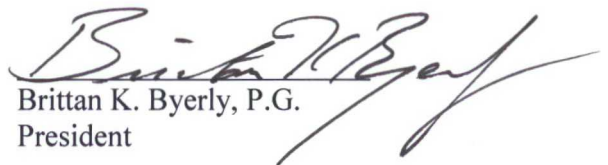
Figure 1 – Site Location Map

Figure 2 – Site Details Schematic and Confirmation Soil Sample Locations Map

TABLES

Table 1 – Concentrations of BTEX, TPH and Chlorides in Soil

APPENDICES

Appendix A – Analytical Reports

Appendix B – Photographs

Appendix C – Manifests

Appendix D – Release Notification and Corrective Action (Form-C-141)

1.0 INTRODUCTION

Nova Safety & Environmental (NOVA), on behalf of Southern Union Gas Services (SUGS), has prepared this Soil Remediation Summary and Site Closure Request for 6-Inch Lateral Historical Release Site. The legal description of the release site is Unit Letter "L" (NW ¼ SW ¼), Section 26, Township 24 South, Range 37 East, in Lea County, New Mexico. The property affected by the release is owned by Mr. Gerald Doom. The release site GPS coordinates are 32° 11.384' North and 103° 08.154' West. Please reference Figure 1 for a Site Location Map and Figure 2 for a Site Details Schematic and Confirmation Soil Sample Locations Map. The Release Notification and Corrective Action (Form C-141) is provided as Appendix D.

On April 20, 2010, SUGS discovered a release of crude oil and produced water had occurred from a six (6) inch low pressure steel pipeline. The cause of the release was attributed to failure of a segment of the steel pipeline. SUGS replaced the steel pipeline with approximately one hundred (100) feet of poly line. SUGS submitted the Release Notification and Corrective Action (Form C-141) to the New Mexico Oil Conservation Division (NMOCD) Hobbs District Office on April 23, 2012. The C-141 indicated approximately five (5) barrels of fluids were released from the pipeline, with no recovery. General photographs of the site are provided as Appendix B.

SUGS has researched and identified various historical release sites located in New Mexico. At the request of SUGS, NOVA has reviewed the historical data for these sites and conducted the necessary activities to ensure the sites meet the criteria for closure in accordance with NMOCD regulatory guidelines.

2.0 NMOCD SITE CLASSIFICATION

A search of the New Mexico Office of the State Engineer (NMOSE) database did not identify the average depth to groundwater information for Section 26, Township 24 South, Range 37 East. A reference map utilized by the NMOCD indicated depth to groundwater at the release site should be encountered at approximately fifty (50) feet below ground surface (bgs). The depth to groundwater at the 6-Inch Lateral Historical Release Site results in a score of twenty (20) points being assigned to the site, based on the NMOCD depth to groundwater criteria.

The water well database, maintained by the NMOSE, indicated there are no water wells less than 1,000 feet from the release, resulting in zero (0) points being assigned to this site as a result of this criteria.

There are no surface water bodies located within 1,000 feet of the site. Based on the NMOCD ranking system zero (0) points will be assigned to the site as a result of the criteria.

The NMOCD guidelines indicate the 6-Inch Lateral Historical Release Site has ranking score of twenty (20). Based on this score, the soil remediation levels for a site with a ranking score of twenty (20) points are as follows:

- Benzene – 10 mg/Kg (ppm)
- BTEX – 50 mg/Kg (ppm)
- TPH – 100 mg/Kg (ppm)

The NMOCD chloride cleanup level concentrations are site specific and will be determined by the NMOCD Hobbs District Office.

3.0 SUMMARY OF SOIL REMEDIATION ACTIVITIES

On August 21, 2012, NOVA at the request of SUGS, commenced remediation activities at the 6-Inch Lateral Historical Release Site. Prior to NOVA involvement, the leak source was excavated to a depth of approximately two (2) feet bgs. The excavated soil was stockpiled adjacent to the excavation. NOVA continued excavation activities in the previously excavated area. Approximately 468 cubic yards (cy) of impacted soil was excavated and stockpiled on-site, pending final disposition. The excavated soil was placed on a plastic liner to mitigate the potential leaching of contaminants into the vadose zone. The resulting excavation measured approximately fifty (50) feet in length, and ranged from approximately twenty (20) feet to forty-five (45) feet in width and ranged in depth from approximately seven (7) feet to seven and one half (7.5) feet bgs. Please reference Figure 2 for site details.

On August 22, 2012, two (2) soil samples (East Floor @ 6' and East S/W-1 @ 5') were collected from the excavation and submitted to the laboratory for determination of concentrations of benzene, toluene, ethyl-benzene, and xylene (BTEX), total petroleum hydrocarbons (TPH), and chlorides using EPA SW-846 8012b, 8015M, and E 300, respectively. The analytical results indicated benzene and BTEX concentrations were less than the appropriate laboratory method detection limits (MDL) for both soil samples. TPH concentrations ranged from less than the laboratory MDL for soil sample East S/W-1 @ 5' to 155 mg/Kg for soil sample East Floor @ 6'. Chloride concentrations ranged from 30.3 mg/Kg for soil sample East S/W-1 @ 5' to 45.5 mg/Kg for soil sample East Floor @ 6'. Based on laboratory analytical results, the area represented by soil sample East Floor @ 6' required additional excavation. Table 1 summarizes the Concentrations of BTEX, TPH, and Chlorides in Soil. Laboratory analytical reports are provided as Appendix A.

On August 23 and 24, 2012, six (6) soil samples (West S/W-1 @ 4', RP Floor @ 7', South S/W @ 6', North S/W @ 4', East S/W-2 @ 6', and East S/W-3 @ 4') were collected from the excavation and submitted to the laboratory for analysis. Laboratory analytical results indicated benzene, BTEX, and TPH concentrations were less than the appropriate laboratory MDL for all the submitted soil samples with the exception of soil sample West S/W-1 @ 4', which exhibited a TPH concentration of 20.8 mg/Kg. Chloride concentrations ranged from 1.80 mg/Kg for soil sample South S/W @ 6' to 177 mg/Kg for soil sample West S/W-1 @ 4'. A review of analytical results indicated benzene, BTEX, TPH, and chloride concentrations were less than NMOCD regulatory guidelines. Please reference Figure 2 for soil sample locations.

In addition, one (1) composite soil sample (SP-1) was collected from the stockpiled soil and submitted to the laboratory for analysis. Laboratory analytical results indicated benzene and BTEX concentrations were less than the appropriate laboratory MDL for soil sample SP-1. The soil sample exhibited a TPH concentration of 1,002.9 mg/Kg and a chloride concentration of 518 mg/Kg (Table 1).

On August 31, 2012, SUGS and NOVA representatives met with a NMOCD Hobbs District Office representative to present the results of the soil sampling event, and discuss future

remediation activities to be conducted at the release site. The NMOCD representative requested additional excavation be conducted in the area represented by soil sample East Floor @ 6'. On completion of excavation activities SUGS would collect one (1) soil sample from the area represented by soil sample East Floor @ 6'. The soil sample would be submitted to the laboratory and analyzed for TPH concentrations. On laboratory results indicating TPH concentrations less than NMOCD regulatory guidelines the impacted soil would be transported to Doom Land Farm for disposal and the excavation would be backfilled with non-impacted soil.

On October 30, 2012, excavation activities resumed at the release site. Additional excavation was conducted in the area represented by soil sample East Floor @ 6'. A soil sample (East Floor @ 7.5') was collected from the excavated area and submitted to the laboratory for analysis. Laboratory analytical results indicated a TPH concentration of less than the laboratory MDL for the soil sample. A review of analytical results indicated a TPH concentration less than NMOCD regulatory guidelines (Table1).

A total of approximately four hundred sixty-eight (468) cy yards of soil was transported to Doom Land Farm, L.L.C., (NMOCD Permit # NM-01-0033) for disposal. The excavation was backfilled with locally obtained non-impacted soil and compacted. On completion of backfilling activities the impacted area was contoured to fit the surrounding topography. Manifests documenting soil disposal are provided as Appendix C.

4.0 QA/QC PROCEDURES

4.1 Soil Sampling

Soil Samples were delivered to Permian Basin Environmental Lab, LP, of Midland, Texas for BTEX and/or TPH and/or chloride analyses using the methods described below. Soil samples were analyzed for BTEX and/or TPH and/or chloride concentrations within fourteen (14) days following the sampling event.

The soil samples were analyzed as follows:

- BTEX concentrations in accordance with EPA Method 8021B, 5030
- TPH concentrations in accordance with modified EPA Method 8015M GRO/DRO
- Chloride concentration in accordance with Method E 300.

4.2 Decontamination of Equipment

Cleaning of the sampling equipment was the responsibility of the environmental technician. Prior to use and between each sample, the sampling equipment was cleaned with Liqui-Nox® detergent and rinsed with distilled water.

4.3 Laboratory Protocol

The laboratory was responsible for proper QA/QC procedures after signing the chain-of-custody (COC) form. These procedures were either transmitted with the laboratory reports or are on file at the laboratory.

5.0 SITE CLOSURE REQUEST

Based on the analytical results of confirmation soil samples, NOVA recommends SUGS provide the NMOCD a copy of this Remediation Summary and Site Closure Request and request the NMOCD grant final closure to the 6-Inch Lateral Historical Release Site.

6.0 LIMITATIONS

NOVA Safety and Environmental has prepared this Remediation Summary and Site Closure Request to the best of its ability. No other warranty, expressed or implied, is made or intended.

NOVA Safety and Environmental has examined and relied upon documents referenced in the report and has relied on oral statements made by certain individuals. NOVA Safety and Environmental has not conducted an independent examination of the facts contained in referenced materials and statements. We have presumed the genuineness of the documents and that the information provided in documents or statements is true and accurate. NOVA Safety and Environmental has prepared this report, in a professional manner, using the degree of skill and care exercised by similar environmental consultants. NOVA Safety and Environmental also notes that the facts and conditions referenced in this report may change over time and the conclusions and recommendations set forth herein are applicable only to the facts and conditions as described at the time of this report.

This report has been prepared for the benefit of Southern Union Gas Services. The information contained in this report, including all exhibits and attachments, may not be used by any other party without the express consent of NOVA Safety and Environmental and/or Southern Union Gas.

7.0 DISTRIBUTION:

Copy 1: Geoffrey Leking
New Mexico Energy, Minerals and Natural Resources Department
Oil Conservation Division (District 1)
1625 French Drive
Hobbs, New Mexico 88240

Copy 2: Rose Slade
Southern Union Gas Services
801 South Loop 464
Monahans, Texas 79756

Copy 3: Nova Safety & Environmental
2057 Commerce Street
Midland, Texas 79703

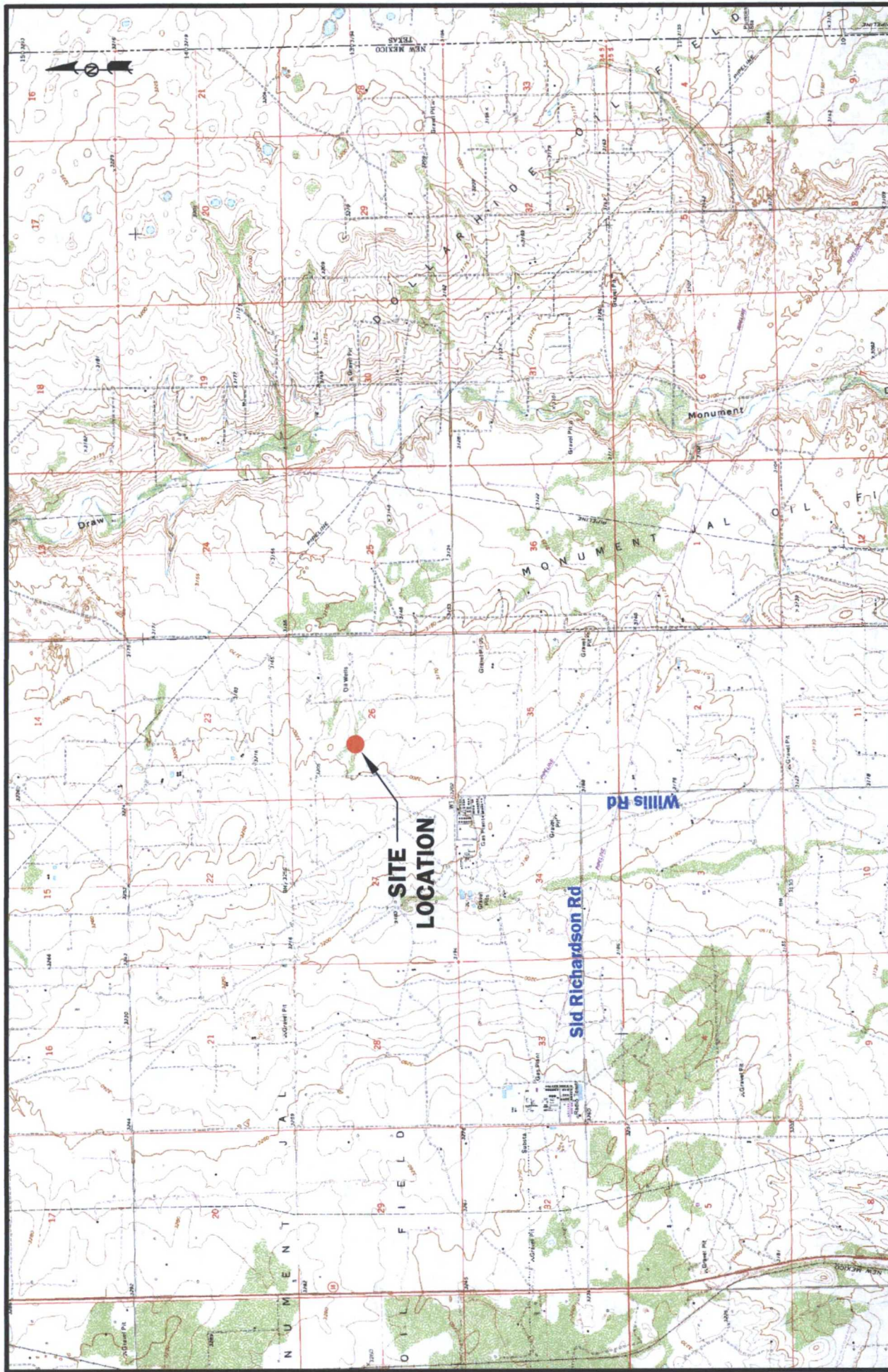

LEGEND:

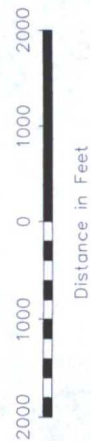

Figure 1

Site Location Map
Southern Union Gas Services
6" Lateral Line (Doom)
Lea County, NM



2057 Commerce Drive
Midland, Texas 79703
432.520.7720

www.novasafetyandenvironmental.com

August 28, 2012	Scale: 1" = 2000'	CAD By: TA	Checked By: CJB
Lat. N 32° 11' 23.04"		Long. W 103° 8' 9.24"	
1RP-2488			

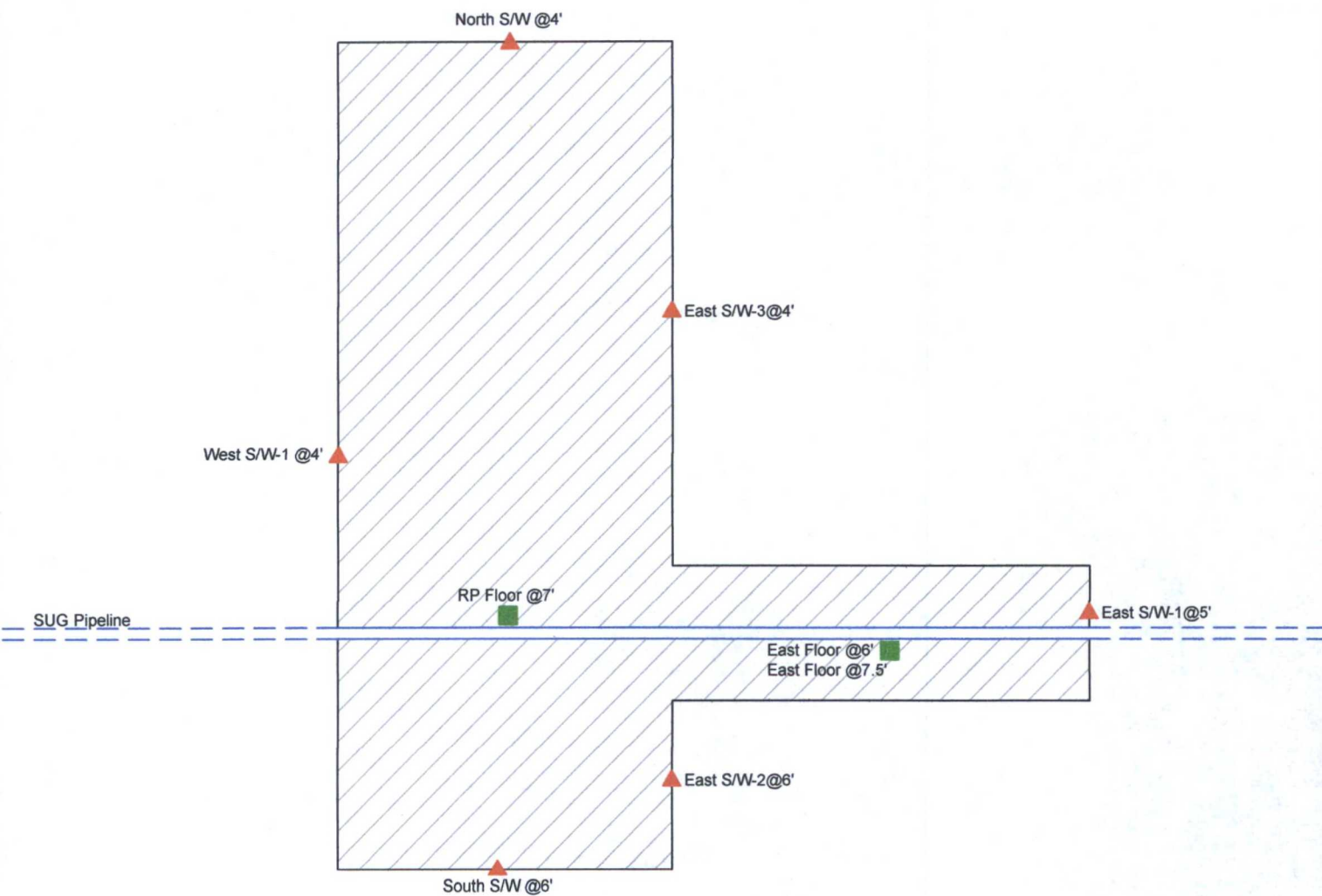

Distance in Feet

LEGEND:

-  Sidewall Soil Sample Location
-  Pipeline
-  Floor Soil Sample Location

Figure 2

Site Map
Southern Union Gas Services
6" Lateral Line (Doom)
Lea County, NM



2057 Commerce Drive
Midland, Texas 79703
432.520.7720

www.novasafetyandenvironmental.com

August 29, 2012	Scale: 1" = 10'	CAD By: TA	Checked By: CJB
Lat. N 32° 11' 23.04" Long. W 103° 8' 9.24"			1RP-2488

**PERMIAN BASIN
ENVIRONMENTAL LAB, LP
10014 SCR 1213
Midland, TX 79706**

PBELAB

Analytical Report

Prepared for:

Camille Bryant
Nova Safety & Environment
2057 Commerce
Midland, TX 79703

Project: SUG Historical 6 In Lateral IRP-2488

Project Number: [none]

Location: Lea Co, NM

Lab Order Number: 2H28002



NELAP/TCEQ # T104704156-12-1

Report Date: 08/31/12

TABLE 1

CONCENTRATIONS OF BENZENE, BTEX, TPH AND CHLORIDE IN SOIL

SOUTHERN UNION GAS SERVICES
6-INCH LATERAL HISTORICAL RELEASE
LEA COUNTY, NEW MEXICO
NMOCD 1RP-2488

All concentrations are reported in mg/kg

SAMPLE LOCATION	SAMPLE DATE	METHODS: SW 846-8021b						METHOD: SW 8015M					E 300.1 CHLORIDE
		BENZENE	TOLUENE	ETHYL-BENZENE	m, p -XYLENES	o -XYLENE	TOTAL BTEX	TPH GRO C ₆ -C ₁₂	TPH DRO C ₁₂ -C ₂₈	TPH ORO C ₂₈ -C ₃₅	TOTAL TPH C ₆ -C ₃₅		
NMOCD Regulatory Limit		10	-	-	-	-	50	-	-	-	100	-	
East Floor @ 6'	08/22/12	<0.00100	<0.00200	<0.00100	<0.00200	<0.00100	<0.00200	<16.9	155	<16.9	155	45.5	
East S/W-1 @ 5'	08/22/12	<0.00100	<0.00200	<0.00100	<0.00200	<0.00100	<0.00200	<16.9	<16.9	<16.9	<16.9	30.3	
West S/W-1 @ 4'	08/23/12	<0.00100	<0.00200	<0.00100	<0.00200	<0.00100	<0.00200	<16.0	20.8	<16.0	20.8	177	
RP Floor @ 7'	08/23/12	<0.00100	<0.00200	<0.00100	<0.00200	<0.00100	<0.00200	<16.9	<16.9	<16.9	<16.9	24.9	
South S/W @ 6'	08/23/12	<0.00100	<0.00200	<0.00100	<0.00200	<0.00100	<0.00200	<18.1	<18.1	<18.1	<18.1	1.80	
North S/W @ 4'	08/23/12	<0.00100	<0.00200	<0.00100	<0.00200	<0.00100	<0.00200	<16.9	<16.9	<16.9	<16.9	20.5	
East S/W-2 @ 6'	08/23/12	<0.00100	<0.00200	<0.00100	<0.00200	<0.00100	<0.00200	<17.0	<17.0	<17.0	<17.0	17.7	
East S/W-3 @ 4'	08/24/12	<0.00100	<0.00200	<0.00100	<0.00200	<0.00100	<0.00200	<16.7	<16.7	<16.7	<16.7	15.1	
Stockpile	08/24/12	<0.00100	<0.00200	<0.00100	<0.00200	<0.00100	<0.00200	15.9	855	132	1,002.9	518	
East Floor @ 7.5'	10/30/12	-	-	-	-	-	-	<27.2	<27.2	<27.2	<27.2	-	

Nova Safety & Environment
2057 Commerce
Midland TX, 79703

Project: SUG Historical 6 In Lateral IRP-2488
Project Number: [none]
Project Manager: Camille Bryant

Fax: (432) 520-7701

ANALYTICAL REPORT FOR SAMPLES

Sample ID	Laboratory ID	Matrix	Date Sampled	Date Received
East Floor @ 6'	2H28002-01	Solid	08/22/12 14:50	08-28-2012 14:09
East S/W-1 @ 5'	2H28002-02	Solid	08/22/12 16:55	08-28-2012 14:09
West S/W-1 @ 4'	2H28002-03	Solid	08/23/12 11:00	08-28-2012 14:09
RP Floor @ 7'	2H28002-04	Solid	08/23/12 14:00	08-28-2012 14:09
South S/W @ 6'	2H28002-05	Solid	08/23/12 14:05	08-28-2012 14:09
North S/W @ 4'	2H28002-06	Solid	08/23/12 16:05	08-28-2012 14:09
East S/W-2 @ 6'	2H28002-07	Solid	08/23/12 16:50	08-28-2012 14:09
East S/W-3 @ 4'	2H28002-08	Solid	08/24/12 11:00	08-28-2012 14:09
Stockpile	2H28002-09	Solid	08/24/12 12:50	08-28-2012 14:09

Nova Safety & Environment
2057 Commerce
Midland TX, 79703

Project: SUG Historical 6 In Lateral IRP-2488
Project Number: [none]
Project Manager: Camille Bryant

Fax: (432) 520-7701

Organics by GC
Permian Basin Environmental Lab

Analyte	Result	Reporting Limit	Units	Dilution	Batch	Prepared	Analyzed	Method	Notes
East Floor @ 6' (2H28002-01) Solid									
Benzene	ND	0.00100	mg/kg dry	1	EH23105	08/30/12	08/30/12	EPA 8021B	
Toluene	ND	0.00200	"	"	"	"	"	"	
Ethylbenzene	ND	0.00100	"	"	"	"	"	"	
Xylene (p/m)	ND	0.00200	"	"	"	"	"	"	
Xylene (o)	ND	0.00100	"	"	"	"	"	"	
Surrogate: 4-Bromofluorobenzene		100 %	75-125		"	"	"	"	
Surrogate: 1,4-Difluorobenzene		94.8 %	75-125		"	"	"	"	
C6-C12	ND	16.9	mg/kg dry	"	EH23104	08/30/12	08/30/12	EPA 8015M	
>C12-C28	155	16.9	"	"	"	"	"	"	
>C28-C35	ND	16.9	"	"	"	"	"	"	
Total Hydrocarbons	155	16.9	"	"	"	"	"	"	
Surrogate: 1-Chlorooctane		97.3 %	70-130		"	"	"	"	
Surrogate: o-Terphenyl		113 %	70-130		"	"	"	"	
East S/W-1 @ 5' (2H28002-02) Solid									
Benzene	ND	0.00100	mg/kg dry	1	EH23105	08/30/12	08/30/12	EPA 8021B	
Toluene	ND	0.00200	"	"	"	"	"	"	
Ethylbenzene	ND	0.00100	"	"	"	"	"	"	
Xylene (p/m)	ND	0.00200	"	"	"	"	"	"	
Xylene (o)	ND	0.00100	"	"	"	"	"	"	
Surrogate: 1,4-Difluorobenzene		95.5 %	75-125		"	"	"	"	
Surrogate: 4-Bromofluorobenzene		99.5 %	75-125		"	"	"	"	
C6-C12	ND	16.9	mg/kg dry	"	EH23104	08/30/12	08/30/12	EPA 8015M	
>C12-C28	ND	16.9	"	"	"	"	"	"	
>C28-C35	ND	16.9	"	"	"	"	"	"	
Total Hydrocarbons	ND	16.9	"	"	"	"	"	"	
Surrogate: 1-Chlorooctane		100 %	70-130		"	"	"	"	
Surrogate: o-Terphenyl		117 %	70-130		"	"	"	"	
West S/W-1 @ 4' (2H28002-03) Solid									
Benzene	ND	0.00100	mg/kg dry	1	EH23105	08/30/12	08/30/12	EPA 8021B	
Toluene	ND	0.00200	"	"	"	"	"	"	
Ethylbenzene	ND	0.00100	"	"	"	"	"	"	
Xylene (p/m)	ND	0.00200	"	"	"	"	"	"	
Xylene (o)	ND	0.00100	"	"	"	"	"	"	
Surrogate: 4-Bromofluorobenzene		101 %	75-125		"	"	"	"	
Surrogate: 1,4-Difluorobenzene		96.5 %	75-125		"	"	"	"	
C6-C12	ND	16.0	mg/kg dry	"	EH23104	08/30/12	08/31/12	EPA 8015M	

Permian Basin Environmental Lab

The results in this report apply to the samples analyzed in accordance with the samples received in the laboratory. This analytical report must be reproduced in its entirety, with written approval of Permian Basin Environmental Lab.

Nova Safety & Environment
2057 Commerce
Midland TX, 79703

Project: SUG Historical 6 In Lateral IRP-2488
Project Number: [none]
Project Manager: Camille Bryant

Fax: (432) 520-7701

Organics by GC
Permian Basin Environmental Lab

Analyte	Result	Reporting Limit	Units	Dilution	Batch	Prepared	Analyzed	Method	Notes
West S/W-1 @ 4' (2H28002-03) Solid									
>C12-C28	20.8	16.0	mg/kg dry	1	EH23104	08/30/12	08/31/12	EPA 8015M	
>C28-C35	ND	16.0	"	"	"	"	"	"	
Total Hydrocarbons	20.8	16.0	"	"	"	"	"	"	
Surrogate: 1-Chlorooctane		97.2 %	70-130		"	"	"	"	
Surrogate: o-Terphenyl		115 %	70-130		"	"	"	"	
RP Floor @ 7' (2H28002-04) Solid									
Benzene	ND	0.00100	mg/kg dry	1	EH23105	08/30/12	08/30/12	EPA 8021B	
Toluene	ND	0.00200	"	"	"	"	"	"	
Ethylbenzene	ND	0.00100	"	"	"	"	"	"	
Xylene (p/m)	ND	0.00200	"	"	"	"	"	"	
Xylene (o)	ND	0.00100	"	"	"	"	"	"	
Surrogate: 4-Bromofluorobenzene		105 %	75-125		"	"	"	"	
Surrogate: 1,4-Difluorobenzene		96.2 %	75-125		"	"	"	"	
C6-C12	ND	16.9	mg/kg dry	"	EH23104	08/30/12	08/31/12	EPA 8015M	
>C12-C28	ND	16.9	"	"	"	"	"	"	
>C28-C35	ND	16.9	"	"	"	"	"	"	
Total Hydrocarbons	ND	16.9	"	"	"	"	"	"	
Surrogate: 1-Chlorooctane		112 %	70-130		"	"	"	"	
Surrogate: o-Terphenyl		129 %	70-130		"	"	"	"	
South S/W @ 6' (2H28002-05) Solid									
Benzene	ND	0.00100	mg/kg dry	1	EH23105	08/30/12	08/30/12	EPA 8021B	
Toluene	ND	0.00200	"	"	"	"	"	"	
Ethylbenzene	ND	0.00100	"	"	"	"	"	"	
Xylene (p/m)	ND	0.00200	"	"	"	"	"	"	
Xylene (o)	ND	0.00100	"	"	"	"	"	"	
Surrogate: 4-Bromofluorobenzene		104 %	75-125		"	"	"	"	
Surrogate: 1,4-Difluorobenzene		97.3 %	75-125		"	"	"	"	
C6-C12	ND	18.1	mg/kg dry	"	EH23104	08/30/12	08/31/12	EPA 8015M	
>C12-C28	ND	18.1	"	"	"	"	"	"	
>C28-C35	ND	18.1	"	"	"	"	"	"	
Total Hydrocarbons	ND	18.1	"	"	"	"	"	"	
Surrogate: 1-Chlorooctane		96.7 %	70-130		"	"	"	"	
Surrogate: o-Terphenyl		113 %	70-130		"	"	"	"	

Nova Safety & Environment
2057 Commerce
Midland TX, 79703

Project: SUG Historical 6 In Lateral IRP-2488
Project Number: [none]
Project Manager: Camille Bryant

Fax: (432) 520-7701

Organics by GC
Permian Basin Environmental Lab

Analyte	Result	Reporting Limit	Units	Dilution	Batch	Prepared	Analyzed	Method	Notes
North S/W @ 4' (2H28002-06) Solid									
Benzene	ND	0.00100	mg/kg dry	1	EH23105	08/30/12	08/30/12	EPA 8021B	
Toluene	ND	0.00200	"	"	"	"	"	"	
Ethylbenzene	ND	0.00100	"	"	"	"	"	"	
Xylene (p/m)	ND	0.00200	"	"	"	"	"	"	
Xylene (o)	ND	0.00100	"	"	"	"	"	"	
<i>Surrogate: 1,4-Difluorobenzene</i>		96.3 %	75-125		"	"	"	"	
<i>Surrogate: 4-Bromofluorobenzene</i>		105 %	75-125		"	"	"	"	
C6-C12	ND	16.9	mg/kg dry	"	EH23104	08/30/12	08/31/12	EPA 8015M	
>C12-C28	ND	16.9	"	"	"	"	"	"	
>C28-C35	ND	16.9	"	"	"	"	"	"	
Total Hydrocarbons	ND	16.9	"	"	"	"	"	"	
<i>Surrogate: 1-Chlorooctane</i>		87.3 %	70-130		"	"	"	"	
<i>Surrogate: o-Terphenyl</i>		103 %	70-130		"	"	"	"	
East S/W-2 @ 6' (2H28002-07) Solid									
Benzene	ND	0.00100	mg/kg dry	1	EH23105	08/30/12	08/30/12	EPA 8021B	
Toluene	ND	0.00200	"	"	"	"	"	"	
Ethylbenzene	ND	0.00100	"	"	"	"	"	"	
Xylene (p/m)	ND	0.00200	"	"	"	"	"	"	
Xylene (o)	ND	0.00100	"	"	"	"	"	"	
<i>Surrogate: 1,4-Difluorobenzene</i>		96.0 %	75-125		"	"	"	"	
<i>Surrogate: 4-Bromofluorobenzene</i>		104 %	75-125		"	"	"	"	
C6-C12	ND	17.0	mg/kg dry	"	EH23104	08/30/12	08/31/12	EPA 8015M	
>C12-C28	ND	17.0	"	"	"	"	"	"	
>C28-C35	ND	17.0	"	"	"	"	"	"	
Total Hydrocarbons	ND	17.0	"	"	"	"	"	"	
<i>Surrogate: 1-Chlorooctane</i>		81.8 %	70-130		"	"	"	"	
<i>Surrogate: o-Terphenyl</i>		96.8 %	70-130		"	"	"	"	
East S/W-3 @ 4' (2H28002-08) Solid									
Benzene	ND	0.00100	mg/kg dry	1	EH23105	08/30/12	08/30/12	EPA 8021B	
Toluene	ND	0.00200	"	"	"	"	"	"	
Ethylbenzene	ND	0.00100	"	"	"	"	"	"	
Xylene (p/m)	ND	0.00200	"	"	"	"	"	"	
Xylene (o)	ND	0.00100	"	"	"	"	"	"	
<i>Surrogate: 4-Bromofluorobenzene</i>		101 %	75-125		"	"	"	"	
<i>Surrogate: 1,4-Difluorobenzene</i>		95.2 %	75-125		"	"	"	"	
C6-C12	ND	16.7	mg/kg dry	"	EH23104	08/30/12	08/31/12	EPA 8015M	

Permian Basin Environmental Lab

The results in this report apply to the samples analyzed in accordance with the samples received in the laboratory. This analytical report must be reproduced in its entirety, with written approval of Permian Basin Environmental Lab.

Nova Safety & Environment
2057 Commerce
Midland TX, 79703

Project: SUG Historical 6 In Lateral IRP-2488
Project Number: [none]
Project Manager: Camille Bryant

Fax: (432) 520-7701

Organics by GC
Permian Basin Environmental Lab

Analyte	Result	Reporting Limit	Units	Dilution	Batch	Prepared	Analyzed	Method	Notes
East S/W-3 @ 4' (2H28002-08) Solid									
>C12-C28	ND	16.7	mg/kg dry	1	EH23104	08/30/12	08/31/12	EPA 8015M	
>C28-C35	ND	16.7	"	"	"	"	"	"	
Total Hydrocarbons	ND	16.7	"	"	"	"	"	"	
Surrogate: 1-Chlorooctane		82.2 %	70-130		"	"	"	"	
Surrogate: o-Terphenyl		101 %	70-130		"	"	"	"	
Stockpile (2H28002-09) Solid									
Benzene	ND	0.00100	mg/kg dry	1	EH23105	08/30/12	08/30/12	EPA 8021B	
Toluene	ND	0.00200	"	"	"	"	"	"	
Ethylbenzene	ND	0.00100	"	"	"	"	"	"	
Xylene (p/m)	ND	0.00200	"	"	"	"	"	"	
Xylene (o)	ND	0.00100	"	"	"	"	"	"	
Surrogate: 4-Bromofluorobenzene		106 %	75-125		"	"	"	"	
Surrogate: 1,4-Difluorobenzene		99.5 %	75-125		"	"	"	"	
C6-C12	15.9	15.8	mg/kg dry	"	EH23104	08/30/12	08/31/12	EPA 8015M	
>C12-C28	855	15.8	"	"	"	"	"	"	
>C28-C35	132	15.8	"	"	"	"	"	"	
Total Hydrocarbons	1000	15.8	"	"	"	"	"	"	
Surrogate: 1-Chlorooctane		79.0 %	70-130		"	"	"	"	
Surrogate: o-Terphenyl		94.9 %	70-130		"	"	"	"	

Nova Safety & Environment
2057 Commerce
Midland TX, 79703

Project: SUG Historical 6 In Lateral IRP-2488
Project Number: [none]
Project Manager: Camille Bryant

Fax: (432) 520-7701

General Chemistry Parameters by EPA / Standard Methods
Permian Basin Environmental Lab

Analyte	Result	Reporting Limit	Units	Dilution	Batch	Prepared	Analyzed	Method	Notes
East Floor @ 6' (2H28002-01) Solid									
Chloride	45.5	1.12	mg/kg dry wt. dry	1	EH23004	08/29/12	08/30/12	EPA 300.0	
% Moisture	11.0	0.1	%	"	EH23001	08/29/12	08/30/12	% calculation	
East S/W-1 @ 5' (2H28002-02) Solid									
Chloride	30.3	1.12	mg/kg dry wt. dry	1	EH23103	08/30/12	08/31/12	EPA 300.0	
% Moisture	11.0	0.1	%	"	EH23001	08/29/12	08/30/12	% calculation	
West S/W-1 @ 4' (2H28002-03) Solid									
Chloride	177	1.06	mg/kg dry wt. dry	1	EH23004	08/29/12	08/30/12	EPA 300.0	
% Moisture	6.0	0.1	%	"	EH23001	08/29/12	08/30/12	% calculation	
RP Floor @ 7' (2H28002-04) Solid									
Chloride	24.9	1.12	mg/kg dry wt. dry	1	EH23004	08/29/12	08/30/12	EPA 300.0	
% Moisture	11.0	0.1	%	"	EH23001	08/29/12	08/30/12	% calculation	
South S/W @ 6' (2H28002-05) Solid									
Chloride	1.80	1.20	mg/kg dry wt. dry	1	EH23103	08/30/12	08/31/12	EPA 300.0	
% Moisture	7.0	0.1	%	"	EH23001	08/29/12	08/30/12	% calculation	
North S/W @ 4' (2H28002-06) Solid									
Chloride	20.5	1.12	mg/kg dry wt. dry	1	EH23103	08/30/12	08/31/12	EPA 300.0	
% Moisture	11.0	0.1	%	"	EH23001	08/29/12	08/30/12	% calculation	
East S/W-2 @ 6' (2H28002-07) Solid									
Chloride	17.7	1.14	mg/kg dry wt. dry	1	EH23103	08/30/12	08/31/12	EPA 300.0	
% Moisture	12.0	0.1	%	"	EH23001	08/29/12	08/30/12	% calculation	
East S/W-3 @ 4' (2H28002-08) Solid									
Chloride	15.1	1.11	mg/kg dry wt. dry	1	EH23103	08/30/12	08/31/12	EPA 300.0	
% Moisture	10.0	0.1	%	"	EH23001	08/29/12	08/30/12	% calculation	

Permian Basin Environmental Lab

The results in this report apply to the samples analyzed in accordance with the samples received in the laboratory. This analytical report must be reproduced in its entirety, with written approval of Permian Basin Environmental Lab.

Page 6 of 13

Nova Safety & Environment
2057 Commerce
Midland TX, 79703

Project: SUG Historical 6 In Lateral IRP-2488
Project Number: [none]
Project Manager: Camille Bryant

Fax: (432) 520-7701

General Chemistry Parameters by EPA / Standard Methods
Permian Basin Environmental Lab

Analyte	Result	Reporting Limit	Units	Dilution	Batch	Prepared	Analyzed	Method	Notes
Stockpile (2H28002-09) Solid									
Chloride	518	1.05	mg/kg dry wt. dry	1	EH23103	08/30/12	08/31/12	EPA 300.0	
% Moisture	5.0	0.1	%	"	EH23001	08/29/12	08/30/12	% calculation	

Nova Safety & Environment
2057 Commerce
Midland TX, 79703

Project: SUG Historical 6 In Lateral IRP-2488
Project Number: [none]
Project Manager: Camille Bryant

Fax: (432) 520-7701

Organics by GC - Quality Control
Permian Basin Environmental Lab

Analyte	Result	Reporting Limit	Units	Spike Level	Source Result	%REC	%REC Limits	RPD	RPD Limit	Notes
Batch EH23104 - 8015M										
Blank (EH23104-BLK1)				Prepared & Analyzed: 08/30/12						
C6-C12	ND	15.0	mg/kg wet							
>C12-C28	ND	15.0	"							
>C28-C35	ND	15.0	"							
Total Hydrocarbons	ND	15.0	"							
Surrogate: 1-Chlorooctane	111		"	100		111	70-130			
Surrogate: o-Terphenyl	64.0		"	50.0		128	70-130			
LCS (EH23104-BS1)				Prepared & Analyzed: 08/30/12						
C6-C12	842	15.0	mg/kg wet	1000		84.2	75-125			
>C12-C28	860	15.0	"	1000		86.0	75-125			
>C28-C35	ND	15.0	"	0.00			75-125			
Total Hydrocarbons	ND	15.0	"	0.00			75-125			
Surrogate: 1-Chlorooctane	126		"	100		126	70-130			
Surrogate: o-Terphenyl	60.0		"	50.0		120	70-130			
LCS Dup (EH23104-BSD1)				Prepared & Analyzed: 08/30/12						
C6-C12	803	15.0	mg/kg wet	1000		80.3	75-125	4.74	20	
>C12-C28	855	15.0	"	1000		85.5	75-125	0.583	20	
Total Hydrocarbons	ND	15.0	"	0.00			75-125		20	
Surrogate: 1-Chlorooctane	120		"	100		120	70-130			
Surrogate: o-Terphenyl	56.6		"	50.0		113	70-130			
Matrix Spike (EH23104-MS1)				Source: 2H28002-01		Prepared & Analyzed: 08/30/12				
C6-C12	481	16.9	mg/kg dry	393	ND	122	75-125			
>C12-C28	480	16.9	"	393	155	82.7	75-125			
>C28-C35	ND	16.9	"	0.00	ND		75-125			
Total Hydrocarbons	ND	16.9	"	0.00	155		75-125			
Surrogate: 1-Chlorooctane	123		"	112		110	70-130			
Surrogate: o-Terphenyl	58.6		"	56.2		104	70-130			

Nova Safety & Environment
2057 Commerce
Midland TX, 79703

Project: SUG Historical 6 In Lateral IRP-2488
Project Number: [none]
Project Manager: Camille Bryant

Fax: (432) 520-7701

Organics by GC - Quality Control
Permian Basin Environmental Lab

Analyte	Result	Reporting Limit	Units	Spike Level	Source Result	%REC	%REC Limits	RPD	RPD Limit	Notes
---------	--------	-----------------	-------	-------------	---------------	------	-------------	-----	-----------	-------

Batch EH23104 - 8015M

Matrix Spike Dup (EH23104-MSD1)

Source: 2H28002-01

Prepared & Analyzed: 08/30/12

C6-C12	477	16.9	mg/kg dry	393	ND	121	75-125	0.823	20	
>C12-C28	452	16.9	"	393	155	75.6	75-125	8.97	20	
Total Hydrocarbons	ND	16.9	"	0.00	155		75-125		20	
Surrogate: 1-Chlorooctane	121		"	112		108	70-130			
Surrogate: o-Terphenyl	58.4		"	56.2		104	70-130			

Batch EH23105 - General Preparation (GC)

Blank (EH23105-BLK1)

Prepared & Analyzed: 08/30/12

Benzene	ND	0.00100	mg/kg wet							
Toluene	ND	0.00200	"							
Ethylbenzene	ND	0.00100	"							
Xylene (p/m)	ND	0.00200	"							
Xylene (o)	ND	0.00100	"							
Surrogate: 1,4-Difluorobenzene	57.1		ug/kg	60.0		95.2	75-125			
Surrogate: 4-Bromofluorobenzene	60.0		"	60.0		100	75-125			

LCS (EH23105-BS1)

Prepared & Analyzed: 08/30/12

Benzene	0.0957	0.00100	mg/kg wet	0.100		95.7	80-120			
Toluene	0.104	0.00200	"	0.100		104	80-120			
Ethylbenzene	0.101	0.00100	"	0.100		101	80-120			
Xylene (p/m)	0.204	0.00200	"	0.200		102	80-120			
Xylene (o)	0.0932	0.00100	"	0.100		93.2	80-120			
Surrogate: 1,4-Difluorobenzene	57.6		ug/kg	60.0		96.0	75-125			
Surrogate: 4-Bromofluorobenzene	61.8		"	60.0		103	75-125			

LCS Dup (EH23105-BSD1)

Prepared & Analyzed: 08/30/12

Benzene	0.0969	0.00100	mg/kg wet	0.100		96.9	80-120	1.25	20	
Toluene	0.106	0.00200	"	0.100		106	80-120	1.90	20	
Ethylbenzene	0.102	0.00100	"	0.100		102	80-120	0.985	20	
Xylene (p/m)	0.207	0.00200	"	0.200		104	80-120	1.94	20	
Xylene (o)	0.0936	0.00100	"	0.100		93.6	80-120	0.428	20	
Surrogate: 1,4-Difluorobenzene	57.4		ug/kg	60.0		95.7	75-125			
Surrogate: 4-Bromofluorobenzene	62.6		"	60.0		104	75-125			

Nova Safety & Environment
2057 Commerce
Midland TX, 79703

Project: SUG Historical 6 In Lateral IRP-2488
Project Number: [none]
Project Manager: Camille Bryant

Fax: (432) 520-7701

Organics by GC - Quality Control
Permian Basin Environmental Lab

Analyte	Result	Reporting Limit	Units	Spike Level	Source Result	%REC	%REC Limits	RPD	RPD Limit	Notes
Batch EH23105 - General Preparation (GC)										
Matrix Spike (EH23105-MS1)		Source: 2H28002-01		Prepared & Analyzed: 08/30/12						
Benzene	0.0663	0.00100	mg/kg dry	0.112	ND	59.2	80-120			QM-05
Toluene	0.0708	0.00200	"	0.112	ND	63.2	80-120			QM-05
Ethylbenzene	0.0697	0.00100	"	0.112	ND	62.2	80-120			QM-05
Xylene (p/m)	0.138	0.00200	"	0.225	ND	61.3	80-120			QM-05
Xylene (o)	0.0659	0.00100	"	0.112	ND	58.8	80-120			QM-05
Surrogate: 1,4-Difluorobenzene	57.8		ug/kg	60.0		96.3	75-125			
Surrogate: 4-Bromofluorobenzene	63.4		"	60.0		106	75-125			
Matrix Spike Dup (EH23105-MSD1)		Source: 2H28002-01		Prepared & Analyzed: 08/30/12						
Benzene	0.0660	0.00100	mg/kg dry	0.112	ND	58.9	80-120	0.508	20	QM-05
Toluene	0.0693	0.00200	"	0.112	ND	61.9	80-120	2.08	20	QM-05
Ethylbenzene	0.0680	0.00100	"	0.112	ND	60.7	80-120	2.44	20	QM-05
Xylene (p/m)	0.133	0.00200	"	0.225	ND	59.1	80-120	3.65	20	QM-05
Xylene (o)	0.0636	0.00100	"	0.112	ND	56.8	80-120	3.46	20	QM-05
Surrogate: 1,4-Difluorobenzene	59.0		ug/kg	60.0		98.3	75-125			
Surrogate: 4-Bromofluorobenzene	61.6		"	60.0		103	75-125			

Nova Safety & Environment
2057 Commerce
Midland TX, 79703

Project: SUG Historical 6 In Lateral IRP-2488
Project Number: [none]
Project Manager: Camille Bryant

Fax: (432) 520-7701

General Chemistry Parameters by EPA / Standard Methods - Quality Control
Permian Basin Environmental Lab

Analyte	Result	Reporting Limit	Units	Spike Level	Source Result	%REC Limits	RPD	RPD Limit	Notes
Batch EH23001 - *** DEFAULT PREP ***									
Blank (EH23001-BLK1)				Prepared: 08/29/12 Analyzed: 08/30/12					
% Moisture	ND	0.1	%						
Duplicate (EH23001-DUP1)				Source: 2H28002-01 Prepared: 08/29/12 Analyzed: 08/30/12					
% Moisture	10.0	0.1	%		11.0		9.52	20	
Batch EH23004 - *** DEFAULT PREP ***									
Blank (EH23004-BLK1)				Prepared: 08/29/12 Analyzed: 08/30/12					
Chloride	ND	1.00	mg/kg dry wt. wet						
LCS (EH23004-BS1)				Prepared: 08/29/12 Analyzed: 08/30/12					
Chloride	9.39		mg/kg Wet	10.0		93.9	80-120		
LCS Dup (EH23004-BSD1)				Prepared: 08/29/12 Analyzed: 08/30/12					
Chloride	9.30		mg/kg Wet	10.0		93.0	80-120	0.963	20
Duplicate (EH23004-DUP1)				Source: 2H28002-01 Prepared: 08/29/12 Analyzed: 08/30/12					
Chloride	46.0	1.12	mg/kg dry wt. dry		45.5			1.09	20
Matrix Spike (EH23004-MS1)				Source: 2H28002-01 Prepared: 08/29/12 Analyzed: 08/30/12					
Chloride	166	1.12	mg/kg dry wt. dry	140	45.5	86.1	80-120		
Matrix Spike (EH23004-MS2)				Source: 2H28002-03 Prepared: 08/29/12 Analyzed: 08/30/12					
Chloride	294	1.06	mg/kg dry wt. dry	133	177	88.0	80-120		
Batch EH23103 - *** DEFAULT PREP ***									
Blank (EH23103-BLK1)				Prepared: 08/30/12 Analyzed: 08/31/12					
Chloride	ND	1.00	mg/kg dry wt. wet						

Nova Safety & Environment
2057 Commerce
Midland TX, 79703

Project: SUG Historical 6 In Lateral IRP-2488
Project Number: [none]
Project Manager: Camille Bryant

Fax: (432) 520-7701

General Chemistry Parameters by EPA / Standard Methods - Quality Control
Permian Basin Environmental Lab

Analyte	Result	Reporting Limit	Units	Spike Level	Source Result	%REC	%REC Limits	RPD	RPD Limit	Notes
Batch EH23103 - *** DEFAULT PREP ***										
LCS (EH23103-BS1)					Prepared: 08/30/12 Analyzed: 08/31/12					
Chloride	9.52		mg/kg Wet	10.0		95.2	80-120			
LCS Dup (EH23103-BSD1)					Prepared: 08/30/12 Analyzed: 08/31/12					
Chloride	9.47		mg/kg Wet	10.0		94.7	80-120	0.527	20	
Duplicate (EH23103-DUP1)					Source: 2H28002-02 Prepared: 08/30/12 Analyzed: 08/31/12					
Chloride	30.7	1.12	mg/kg dry wt. dry		30.3			1.31	20	
Matrix Spike (EH23103-MS1)					Source: 2H28002-02 Prepared: 08/30/12 Analyzed: 08/31/12					
Chloride	193	1.12	mg/kg dry wt. dry	140	30.3	116	80-120			

Nova Safety & Environment
2057 Commerce
Midland TX, 79703

Project: SUG Historical 6 In Lateral IRP-2488
Project Number: [none]
Project Manager: Camille Bryant

Fax: (432) 520-7701

Notes and Definitions

QM-05 The spike recovery was outside acceptance limits for the MS and/or MSD due to matrix interference. The LCS and/or LCSD were within acceptance limits showing that the laboratory is in control and the data is acceptable.

DET Analyte DETECTED

ND Analyte NOT DETECTED at or above the reporting limit

NR Not Reported

dry Sample results reported on a dry weight basis

RPD Relative Percent Difference

LCS Laboratory Control Spike

MS Matrix Spike

Dup Duplicate

Report Approved By:



Date:

8/31/2012

Brent Barron, Laboratory Director/Technical Director

This material is intended only for the use of the individual (s) or entity to whom it is addressed, and may contain information that is privileged and confidential.

If you have received this material in error, please notify us immediately at 432-661-4184.

Fax: (432) 520-7701

[illegible]

**PERMIAN BASIN
ENVIRONMENTAL LAB, LP
10014 SCR 1213
Midland, TX 79706**

PBELAB

Analytical Report

Prepared for:

Camille Bryant
Nova Safety & Environment
2057 Commerce
Midland, TX 79703

Project: SUG Historical 6 In Lateral 1RP-2488

Project Number: [none]

Location: Lea County, New Mexico

Lab Order Number: 2J30011



NELAP/TCEQ # T104704156-12-1

Report Date: 10/31/12

Nova Safety & Environment
2057 Commerce
Midland TX, 79703

Project: SUG Historical 6 In Lateral IRP-2488
Project Number: [none]
Project Manager: Camille Bryant

Fax: (432) 520-7701

ANALYTICAL REPORT FOR SAMPLES

Sample ID	Laboratory ID	Matrix	Date Sampled	Date Received
East Floor @ 7.5'	2J30011-01	Soil	10/30/12 14:00	10-30-2012 16:24

Nova Safety & Environment
2057 Commerce
Midland TX, 79703

Project: SUG Historical 6 In Lateral IRP-2488
Project Number: [none]
Project Manager: Camille Bryant

Fax: (432) 520-7701

East Floor @ 7.5'

2J30011-01 (Soil)

Analyte	Result	Reporting Limit	Units	Dilution	Batch	Prepared	Analyzed	Method	Notes
---------	--------	--------------------	-------	----------	-------	----------	----------	--------	-------

Permian Basin Environmental Lab

General Chemistry Parameters by EPA / Standard Methods

% Moisture	8.0	0.1	%	1	EJ23101	10/30/12	10/31/12	% calculation
------------	-----	-----	---	---	---------	----------	----------	---------------

Total Petroleum Hydrocarbons C6-C35 by EPA Method 8015M

C6-C12	ND	27.2	mg/kg dry	1	EJ23102	10/30/12	10/30/12	8015M
>C12-C28	ND	27.2	mg/kg dry	1	EJ23102	10/30/12	10/30/12	8015M
>C28-C35	ND	27.2	mg/kg dry	1	EJ23102	10/30/12	10/30/12	8015M
Surrogate: 1-Chlorooctane		79.3 %	70-130		EJ23102	10/30/12	10/30/12	8015M
Surrogate: o-Terphenyl		90.6 %	70-130		EJ23102	10/30/12	10/30/12	8015M
Total Hydrocarbon nC6-nC35	ND	25.0	mg/kg dry	1	[CALC]	10/30/12	10/30/12	8015M

Nova Safety & Environment
2057 Commerce
Midland TX, 79703

Project: SUG Historical 6 In Lateral IRP-2488
Project Number: [none]
Project Manager: Camille Bryant

Fax: (432) 520-7701

General Chemistry Parameters by EPA / Standard Methods - Quality Control

Permian Basin Environmental Lab

Analyte	Result	Reporting Limit	Units	Spike Level	Source Result	%REC Limits	RPD	RPD Limit	Notes
Batch EJ23101 - *** DEFAULT PREP ***									
Blank (EJ23101-BLK1)				Prepared: 10/30/12 Analyzed: 10/31/12					
% Moisture	ND	0.1	%						
Duplicate (EJ23101-DUP1)				Source: 2J30001-01 Prepared: 10/30/12 Analyzed: 10/31/12					
% Moisture	2.0	0.1	%		2.0		0.00	20	
Duplicate (EJ23101-DUP2)				Source: 2J30010-01 Prepared: 10/30/12 Analyzed: 10/31/12					
% Moisture	ND	0.1	%		1.0		200	20	R3

Nova Safety & Environment
2057 Commerce
Midland TX, 79703

Project: SUG Historical 6 In Lateral 1RP-2488
Project Number: [none]
Project Manager: Camille Bryant

Fax: (432) 520-7701

Total Petroleum Hydrocarbons C6-C35 by EPA Method 8015M - Quality Control

Permian Basin Environmental Lab

Analyte	Result	Reporting Limit	Units	Spike Level	Source Result	%REC	%REC Limits	RPD	RPD Limit	Notes
Batch EJ23102 - 8015M										
Blank (EJ23102-BLK1)										
Prepared & Analyzed: 10/30/12										
C6-C12	ND	25.0	mg/kg wet							
>C12-C28	ND	25.0	"							
>C28-C35	ND	25.0	"							
Surrogate: 1-Chlorooctane	101		"	100		101	70-130			
Surrogate: o-Terphenyl	55.2		"	50.0		110	70-130			
LCS (EJ23102-BS1)										
Prepared & Analyzed: 10/30/12										
C6-C12	846	25.0	mg/kg wet	1000		84.6	75-125			
>C12-C28	821	25.0	"	1000		82.1	75-125			
>C28-C35	ND	25.0	"	0.00			75-125			
Surrogate: 1-Chlorooctane	98.2		"	100		98.2	70-130			
Surrogate: o-Terphenyl	46.6		"	50.0		93.2	70-130			
LCS Dup (EJ23102-BSD1)										
Prepared & Analyzed: 10/30/12										
C6-C12	937	25.0	mg/kg wet	1000		93.7	75-125	10.1	20	
>C12-C28	835	25.0	"	1000		83.5	75-125	1.66	20	
>C28-C35	ND	25.0	"	0.00			75-125		20	
Surrogate: 1-Chlorooctane	114		"	100		114	70-130			
Surrogate: o-Terphenyl	53.2		"	50.0		106	70-130			
Matrix Spike (EJ23102-MS1)										
Source: 2J30010-01 Prepared & Analyzed: 10/30/12										
C6-C12	938	25.3	mg/kg dry	1010	ND	92.9	75-125			
>C12-C28	1430	25.3	"	1010	1380	5.10	75-125			QM-05
>C28-C35	ND	25.3	"	0.00	290		75-125			
Surrogate: 1-Chlorooctane	76.8		"	101		76.0	70-130			
Surrogate: o-Terphenyl	45.8		"	50.5		90.6	70-130			
Matrix Spike Dup (EJ23102-MSD1)										
Source: 2J30010-01 Prepared & Analyzed: 10/30/12										
C6-C12	961	25.3	mg/kg dry	1010	ND	95.1	75-125	2.38	20	
>C12-C28	1280	25.3	"	1010	1380	NR	75-125	NR	20	QM-05
>C28-C35	ND	25.3	"	0.00	290		75-125		20	
Surrogate: 1-Chlorooctane	73.6		"	101		72.8	70-130			
Surrogate: o-Terphenyl	37.5		"	50.5		74.2	70-130			

Nova Safety & Environment
2057 Commerce
Midland TX, 79703

Project: SUG Historical 6 In Lateral IRP-2488
Project Number: [none]
Project Manager: Camille Bryant

Fax: (432) 520-7701

Notes and Definitions

R3 The RPD exceeded the acceptance limit due to sample matrix effects.

QM-05 The spike recovery was outside acceptance limits for the MS and/or MSD due to matrix interference. The LCS and/or LCSD were within acceptance limits showing that the laboratory is in control and the data is acceptable.

DET Analyte DETECTED

ND Analyte NOT DETECTED at or above the reporting limit

NR Not Reported

dry Sample results reported on a dry weight basis

RPD Relative Percent Difference

LCS Laboratory Control Spike

MS Matrix Spike

Dup Duplicate

Report Approved By:



Date:

10/31/2012

Brent Barron, Laboratory Director/Technical Director

This material is intended only for the use of the individual (s) or entity to whom it is addressed, and may contain information that is privileged and confidential.

If you have received this material in error, please notify us immediately at 432-661-4184.

Permian Basin Environmental Lab, LP
10014 S. County Road 1213
Midland, Texas 79706

Phone: 432-661-4184

Project Manager: Camille Bryant

Project Name: SUG Historical 6 inch Lateral 1RP-2488

Company Name: NOVA Safety and Environmental

Project #: Lea County New Mexico

Company Address: 2057 Commerce

Project Loc: Lea County New Mexico

City/State/Zip: Midland, Texas 79703

PO #:

Telephone No: 432.520.7720

Fax No: 432.520.7701

Report Format: ☒ Standard ☐ TRRP ☐ NPDES

Sampler Signature: Camille Bryant e-mail: cbryant@novatraining.cc

(lab use only)

rose.slade@sug.com

ORDER #: 2530011

LAB # (lab use only)

FIELD CODE

East Floor @ 7.5'

Beginning Depth

Ending Depth

Date Sampled

10/30/2012

Time Sampled

14:00

Field Filtered

Total #. of Containers

1

Ice

HNO₃

HCl

H₂SO₄

NaOH

Na₂S₂O₃

None

Other (Specify)

DW=Drinking Water SL=Sludge

GW = Groundwater S=Soil/Solid

NP=Non-Potable Specify Other

Soil

X

TPH: 418.1 8015M 8015B

TPH: TX 1005 TX 1006

Cations (Ca, Mg, Na, K)

Anions (Cl, SO₄, Alkalinity)

SAR / ESP / CEC

Metals: As Ag Ba Cd Cr Pb Hg Se

Volatiles

Semivolatiles

BTEX 8021B/5030 or BTEX 8260

RCI

N.O.R.M.

RUSH TAT (Pre-Schedule) 24, 48, 72 hrs

Standard TAT

Special Instructions:

Relinquished by:

Date

Time

Received by:

Date

Time

Relinquished by:

Date

Time

Received by:

Date

Time

Relinquished by:

Date

Time

Received by:

Date

Time

Laboratory Comments:

Sample Containers Inadeq?

VOCs Free of Headspace?

Labels on Containers?

Custody seals on container(s)?

Custody seals on cooler(s)?

Sample Hand Delivered by Supplier/Client Rep.?

Temperature Upon Receipt

5.5 °C Factor NCP

Client: Southern Union Gas Services
Project Name: 6-Inch Lateral

Prepared by: NOVA
Location: Lea County, New Mexico

Photograph No. 1

Direction:
Facing East

Description:
View of the initial release
area.



Photograph No. 2

Direction:
Facing Northeast

Description:
View of initial release
area.



Client: Southern Union Gas Services
Project Name: 6-Inch Lateral

Prepared by: NOVA
Location: Lea County, New Mexico

Photograph No. 3

Direction:
Facing North

Description:
View of the excavation.



Photograph No. 4

Direction:
Facing East

Description:
View of the excavation.



Client: Southern Union Gas Services
Project Name: 6-Inch Lateral

Prepared by: NOVA
Location: Lea County, New Mexico

Photograph No. 5

Direction:
Facing East

Description:
View of backfilling
activities.



Photograph No. 6

Direction:
Facing West

Description:
View of backfilling
activities.



Client: Southern Union Gas Services
Project Name: 6-Inch Lateral

Prepared by: NOVA
Location: Lea County, New Mexico

Photograph No. 7

Direction:
Facing East

Description:
View of restored site.

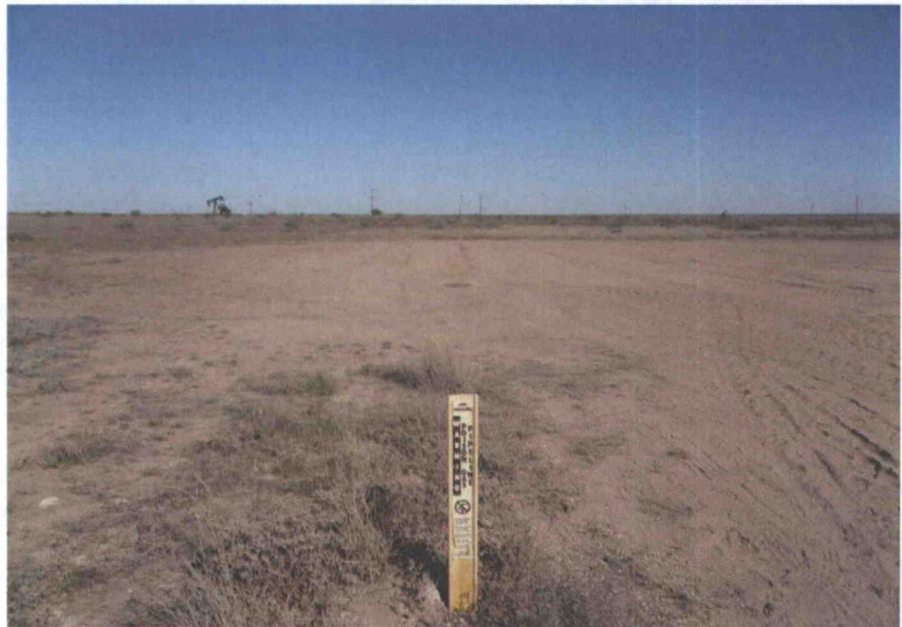

Photograph No. 8

Direction:
Facing East

Description:
View of restored site.



DOOM LAND FARM, L.L.C.
BOX 1271
JAL, N.M. 88252
575-395-3537 903-715-8491
903-715-0471

EXEMPT WASTE MANIFEST
FOR HYDROCARBON
IMPACTED SOIL
E.I.N.# 80 050 1530
PERMIT #NM-01-9033

JOB INVOICE #: _____

OIL/GAS OPERATOR: Southern Union Gas

LOCATION/LEASE:

6" lateral SEC 26 T24S R37E
TRUCKING CO. All Terrain Trucking, LLC

DRIVER Sergio Fierro DATE 10-30-12

LOADS 111 CYDS/LOAD 12 TOTAL CYDS _____

TRUCKING CO. _____

DRIVER _____ DATE _____

LOADS _____ CYDS/LOAD _____ TOTAL CYDS _____

TRUCKING CO. _____

DRIVER _____ DATE _____

LOADS _____ CYDS/LOAD _____ TOTAL CYDS _____

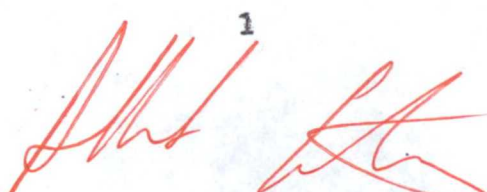

Pit Caliche 11
Top Soil 1

DOOM LAND FARM, L.L.C.
BOX 1271
JAL, N.M. 88252
575-395-3537 903-715-8491
903-715-0471

EXEMPT WASTE MANIFEST
FOR HYDROCARBON
IMPACTED SOIL
E.I.N.# 80 050 1530
PERMIT #NM 91-0033

JOB INVOICE #: _____

OIL/GAS OPERATOR: Southern Union Gas

LOCATION/LEASE: SUG 6" lateral SEC 26 T24S R37E

TRUCKING CO. M.R. McCracken #207

DRIVER Michael R McCracken DATE 10/30/2012

LOADS LH1 CYDS/LOAD 12 TOTAL CYDS 60

TRUCKING CO. _____

DRIVER _____ DATE _____

LOADS _____ CYDS/LOAD _____ TOTAL CYDS _____

TRUCKING CO. _____

DRIVER _____ DATE _____

LOADS _____ CYDS/LOAD _____ TOTAL CYDS _____

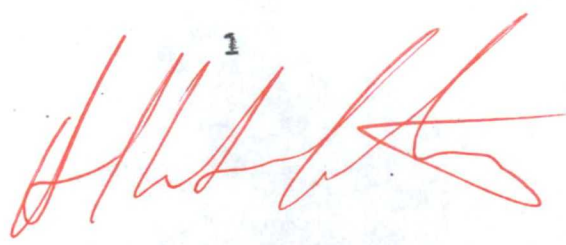
1

DOOM LAND FARM, L.L.C.
BOX 1271
JAL, N.M. 88252
575-395-3537 903-715-8491
903-715-0471

EXEMPT WASTE MANIFEST
FOR HYDROCARBON
IMPACTED SOIL
E.I.N.# 80 050 1030
PERMIT #NM-01-0033

JOB INVOICE #: _____

OIL/GAS OPERATOR: SUNCO

LOCATION/LEASE: 6" lateral SEC 26 T24S R37E

TRUCKING CO. _____

DRIVER Joe Landes DATE 10-30-12

LOADS 5 CYDS/LOAD _____ TOTAL CYDS _____

TRUCKING CO. _____

DRIVER _____ DATE _____

LOADS _____ CYDS/LOAD _____ TOTAL CYDS _____

TRUCKING CO. _____

DRIVER _____ DATE _____

LOADS _____ CYDS/LOAD _____ TOTAL CYDS _____

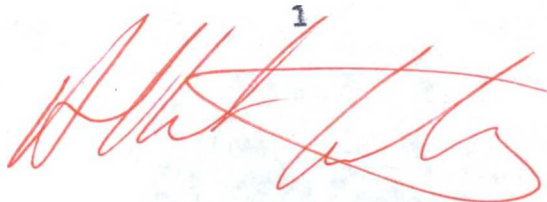
1

DOOM LAND FARM, L.L.C.
BOX 1271
JAL, N.M. 88252
575-395-3537 903-715-8491
903-715-0471

EXEMPT WASTE MANIFEST
FOR HYDROCARBON
IMPACTED SOIL
E.I.N.# 80 050 1930
PERMIT #NM-01-0033

JOB INVOICE #: _____

OIL/GAS OPERATOR: Southern Union Gas

LOCATION/LEASE:

6" Lateral SEC 26 T24S R37E
TRUCKING CO. Mendoza Transport

DRIVER Marcos E. Mendoza DATE 10/30/12

LOADS 5 CYDS/LOAD _____ TOTAL CYDS _____

TRUCKING CO. _____

DRIVER _____ DATE _____

LOADS _____ CYDS/LOAD _____ TOTAL CYDS _____

TRUCKING CO. _____

DRIVER _____ DATE _____

LOADS _____ CYDS/LOAD _____ TOTAL CYDS _____

1

DOOM LAND FARM, L.L.C.
BOX 1271
JAL, N.M. 88252
575-395-3537 903-715-8491
903-715-0471

EXEMPT WASTE MANIFEST
FOR HYDROCARBON
IMPACTED SOIL
E.I.N.# 80 050 1030
PERMIT #NM-01-0033

JOB INVOICE #: _____

OIL/GAS OPERATOR: Southern Union Gas

LOCATION/LEASE:

6" lateral SEC 26 T24S R37E
TRUCKING CO. Murillo Trucking

DRIVER Alfred Alarcon DATE 10-30-02

LOADS 5 CYDS/LOAD 12 TOTAL CYDS _____

TRUCKING CO. _____

DRIVER _____ DATE _____

LOADS _____ CYDS/LOAD _____ TOTAL CYDS _____

TRUCKING CO. _____

DRIVER _____ DATE _____

LOADS _____ CYDS/LOAD _____ TOTAL CYDS _____

Alfred Alarcon

DOOM LAND FARM, L.L.C.
BOX 1271
JAL, N.M. 88252
575-395-3537 903-715-8491
903-715-0471

EXEMPT WASTE MANIFEST
FOR HYDROCARBON
IMPACTED SOIL
E.I.N.# 80 050 1530
PERMIT #NM-01-0033

JOB INVOICE #: _____

OIL/GAS OPERATOR: Southern Union Gas

LOCATION/LEASE:

6" lateral SEC 26 T245 R37E

TRUCKING CO. Family's trucking

DRIVER Porfirio Rojas DATE 10-30-12

1 sand
LOADS 5 CYDS/LOAD 11 rubble TOTAL CYDS _____

TRUCKING CO. _____

DRIVER _____ DATE _____

LOADS _____ CYDS/LOAD _____ TOTAL CYDS _____

TRUCKING CO. _____

DRIVER _____ DATE _____

LOADS _____ CYDS/LOAD _____ TOTAL CYDS _____



DOOM LAND FARM, L.L.C.

BOX 1271

JAL, N.M. 88252

575-395-3537 903-715-8491

903-715-0471

JOB INVOICE #: _____

EXEMPT WASTE MANIFEST

FOR HYDROCARBON

IMPACTED SOIL

E.I.N.# 80 050 1530

PERMIT #NM-01-0033

OIL/GAS OPERATOR:

Southern Union Gas

LOCATION/LEASE:

6" lateral SEC 26 T24S R37E

TRUCKING CO. AZTECA TRUCKING

DRIVER ISAURO SILVA

DATE 10 / 30 / 12

LOADS 4 CYDS/LOAD _____ TOTAL CYDS _____

TRUCKING CO. _____

DRIVER _____

DATE _____

LOADS _____ CYDS/LOAD _____ TOTAL CYDS _____

TRUCKING CO. _____

DRIVER _____

DATE _____

LOADS _____ CYDS/LOAD _____ TOTAL CYDS _____



DOOM LAND FARM, L.L.C.
BOX 1271
JAL, N.M. 88252
575-395-3537 903-715-8491
903-715-0471

EXEMPT WASTE MANIFEST
FOR HYDROCARBON
IMPACTED SOIL
E.I.N.# 80 050 1530
PERMIT #NM-01-0033

JOB INVOICE #: _____

OIL/GAS OPERATOR: Southern Enterprises

LOCATION/LEASE:

6119th Ave SEC 26 T24S R37E

TRUCKING CO. _____

DRIVER Christopher Hernandez DATE 10/30/12

LOADS 6 CYDS/LOAD _____ TOTAL CYDS _____

TRUCKING CO. _____

DRIVER Christopher Hernandez DATE _____

LOADS _____ CYDS/LOAD _____ TOTAL CYDS _____

TRUCKING CO. _____

DRIVER _____ DATE _____

LOADS _____ CYDS/LOAD _____ TOTAL CYDS _____

1
