

BEFORE THE NEW MEXICO OIL CONSERVATION DIVISION

**APPLICATION OF TROVE ENERGY AND WATER,
LLC FOR APPROVAL OF A SALT WATER DISPOSAL
WELL, LEA COUNTY, NEW MEXICO.**

Case No. _____

APPLICATION

Trove Energy and Water, LLC applies for an order approving a salt water disposal well, and in support thereof, states:

1. Applicant proposes to drill the WLC South Fed. SWD Well No. 3, to be located 1768 feet from the south line and 240 feet from the east line of Section 26, Township 26 South, Range 33 East, N.M.P.M., Lea County, New Mexico.
2. Applicant proposes to dispose produced water into the Devonian formation in the well at approximate depths of 17750 – 19015 feet subsurface.
3. A Form C-108 for the subject well was attached as Exhibit A to the application filed in Case No. 20756, which is incorporated herein by reference. Attachment 1 submitted herewith describes the changes to the original application. The change of location is required by the Bureau of Land Management.
4. The granting of this application will prevent waste and protect correlative rights.

WHEREFORE, applicant requests that, after notice and hearing, the Division enter its order approving this application.

Respectfully submitted,

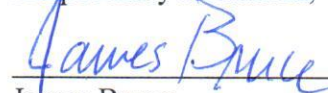

James Bruce
Post Office Box 1056
Santa Fe, New Mexico 87504
(505) 982-2043

Attorney for Trove Energy and Water, LLC



January 24, 2020

NEW MEXICO OIL CONSERVATION DIVISION
Engineering Bureau – UIC Program

Gentlemen:

Trove Energy and Water, LLC, Hobbs, New Mexico, wishes to amend the location in a previously submitted C-108 application to the New Mexico Oil Conservation Division to drill and complete for salt water disposal the WLC South Federal SWD Well No.3. The C-108 was submitted to the OCD in April 2019, presented at hearing on September 5, 2019 and remains under review. The well will remain in Section 26, Township 26 South, Range 33 East in Lea County, New Mexico.

AS A RESULT OF A RECENT ONSITE BLM INSPECTION, TROVE WILL RELOCATE THIS WELLSPOT APPROXIMATELY 400 FEET TO THE NORTH AND WEST OF THE ORIGINAL SPOT.

Old Spot: 1420' FSL x 15' FEL

NEW SPOT: 1768' FSL x 240' FEL

No other material changes are proposed for the subject application or well.

All affected parties were re-notice by letter via U.S. certified mail and a legal notice will be published on 1/25/2020 in the Hobbs News Sun in Hobbs, New Mexico.

We hereby request that the location be amended as supported by the documents included herein. Please don't hesitate to contact us if you have any questions.

Thank you for your attention in this matter.

Best regards,

Ben Stone, SOS Consulting, LLC
Agent for Trove Energy and Water, LLC

Cc: Application File

ATTACHMENT

1

WLC South Federal SWD Well No.3

C-108 - LOCATION AMENDMENT

On January 7, 2020 Trove Energy and Water accompanied BLM personnel from the Carlsbad Field Office to conduct an onsite inspection pursuant to Notice of Staking (NOS) requirements. On the ground, it was discovered that;

There is a pipeline right-of-way that was narrowly overlapped by the proposed location.

This factor forced the move of Trove's proposed SWD well spot to the north and west to accommodate the right-of-way. A site was selected based on onsite conversations with BLM personnel.

Therefore, Trove proposes moving the location from 1420' FSL x 15' FEL to **1768' FSL x 240' FEL**. ***This move does not change the AOR significantly nor does it affect any additional persons, parties or interests.*** New survey stakes were placed.

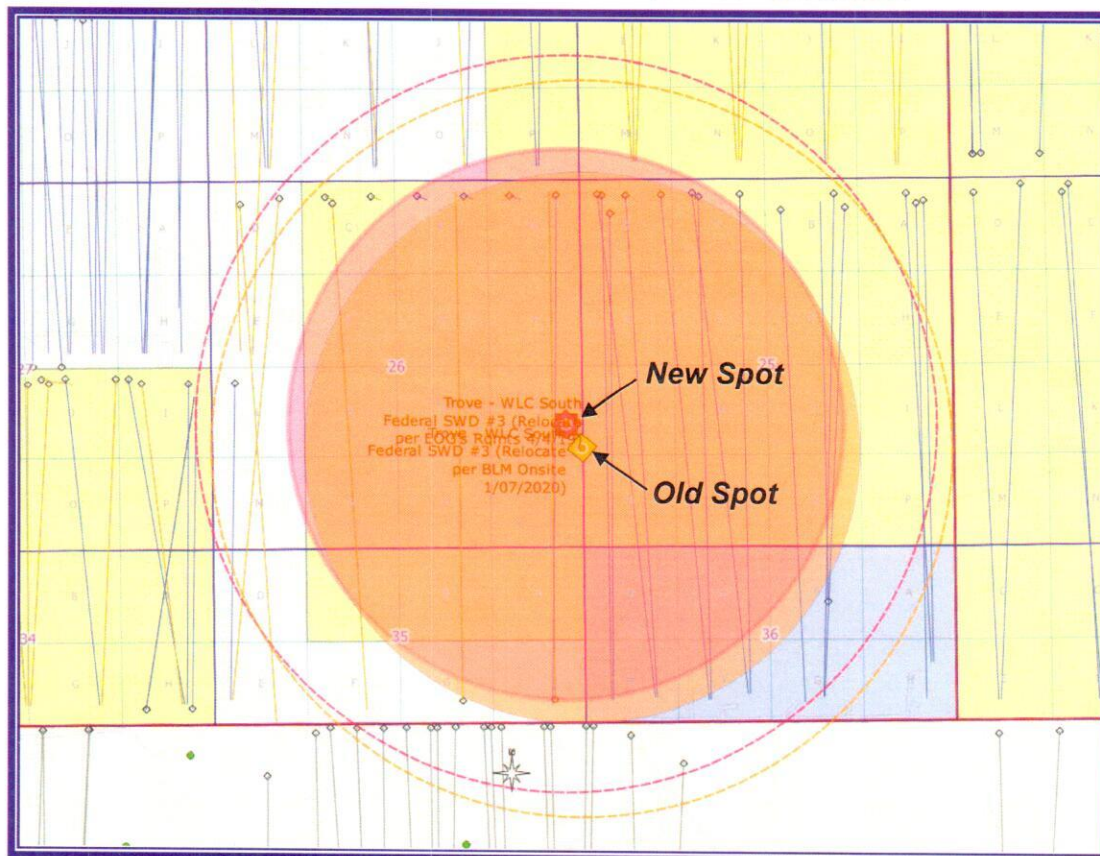

WLC South Federal SWD Well No.3 – Affected Parties Plat

(Attachment to NMOCD Form C-108, Application for Authority to Inject.)

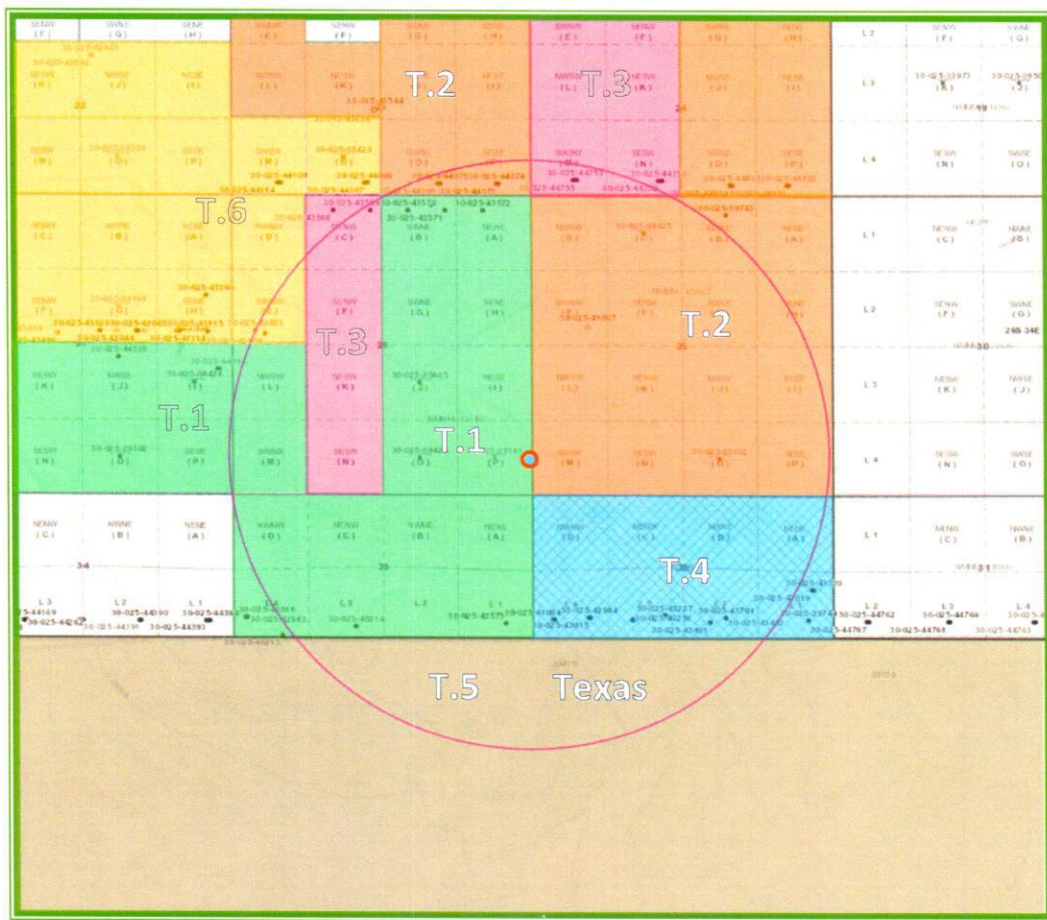

TROVE
ENERGY and WATER

LEGEND

- | | |
|--|---|
| T.1 – NMNM-121490 – EOG Resources, Inc. | T.4 – VC-0025-0001 – EOG Resources, Inc. |
| T.2 – NMNM-122622 – EOG Resources, Inc. | T.5 – Texas – Texas Railroad Commission |
| T.3 – NMNM-0002965A – ConocoPhillips Company | T.6 – NMNM-125653 – Battle Axe Ranch, LLC |

DISTRICT I

1625 N. French Dr., Hobbs, NM 88240
Phone (575) 393-6161 Fax: (575) 392-0720

DISTRICT II

811 S. First St., Artesia, NM 88210
Phone (575) 746-1253 Fax: (575) 746-0720

DISTRICT III

1000 Rio Brazos Rd., Aztec, NM 87410
Phone (505) 384-6178 Fax: (505) 384-6170

DISTRICT IV

1220 S. St. Francis Dr., Santa Fe, NM 87506
Phone (505) 478-3480 Fax: (505) 478-3482State of New Mexico
Energy, Minerals and Natural Resources Department

OIL CONSERVATION DIVISION

1220 South St. Francis Dr.
Santa Fe, New Mexico 87505

Form C-102

Revised August 1, 2011

Submit one copy to appropriate
District Office

WELL LOCATION AND ACREAGE DEDICATION PLAT

☐ AMENDED REPORT

API Number	Pool Code	Pool Name
Property Code	Property Name WLC SOUTH FEDERAL SWD	Well Number 3
OGRID No.	Operator Name TROVE ENERGY AND WATER, LLC	Elevation 3328'

Surface Location

UL or lot No.	Section	Township	Range	Lot Idn	Feet from the	North/South line	Feet from the	East/West line	County
1	26	26 S	33 E		1768	SOUTH	240	EAST	LEA

Bottom Hole Location If Different From Surface

UL or lot No.	Section	Township	Range	Lot Idn	Feet from the	North/South line	Feet from the	East/West line	County
Dedicated Acres	Joint or Infill	Consolidation Code	Order No.						

NO ALLOWABLE WILL BE ASSIGNED TO THIS COMPLETION UNTIL ALL INTERESTS HAVE BEEN CONSOLIDATED
OR A NON-STANDARD UNIT HAS BEEN APPROVED BY THE DIVISION

	<p>OPERATOR CERTIFICATION</p> <p>I hereby certify that the information contained herein is true and complete to the best of my knowledge and belief, and that this organization either owns a working interest or undivided mineral interest in the land including the proposed bottom hole location or has a right to drill this well at this location pursuant to a contract with an owner of such a mineral or working interest, or to a voluntary pooling agreement or a compulsory pooling order heretofore entered by the division.</p> <p>Signature _____ Date _____</p> <p>Printed Name _____</p> <p>Email Address _____</p>
	<p>SURVEYOR CERTIFICATION</p> <p>I hereby certify that the well location shown on this plat was plotted from field notes of actual surveys made by me or under my supervision and that the same is true and correct to the best of my belief.</p> <p>JANUARY 7, 2020</p> <p>Date Surveyed _____</p> <p>Signature & Seal of Professional Surveyor _____</p> <p>Certificate No. Gary L. Jones 7977 Basin Surveys</p> <p>0' 500' 1000' 1500' 2000'</p> <p>SCALE: 1" = 1000'</p> <p>WO Num.: 35004</p>
	<p>SURFACE LOCATION</p> <p>Lot - N 32.012036°</p> <p>Long - W 103.535370°</p> <p>NMSPCE - N 369031.1</p> <p>E 788667.7</p> <p>(NAD-83)</p>