

**STATE OF NEW MEXICO
ENERGY, MINERALS AND NATURAL RESOURCES DEPARTMENT
OIL CONSERVATION DIVISION**

**APPLICATION OF COG OPERATING LLC FOR
APPROVAL OF A NON-STANDARD OVERLAPPING
SPACING UNIT AND COMPULSORY POOLING,
LEA COUNTY, NEW MEXICO.**

CASE NO. 25441

NOTICE OF REVISED EXHIBITS

COG Operating LLC, applicant in the above-referenced case, gives notice that it is filing the attached revised exhibit packet for acceptance into the record.

COG Revised Compulsory Pooling Checklist.

COG Amended Exhibit A-2 are the draft Form C-102's.

Respectfully submitted,

HOLLAND & HART LLP

By: 

Michael H. Feldewert
Adam G. Rankin
Paula M. Vance
Post Office Box 2208
Santa Fe, NM 87504
505-988-4421
505-983-6043 Facsimile
mfeldewert@hollandhart.com
agrarkin@hollandhart.com
pmvance@hollandhart.com

ATTORNEYS FOR COG OPERATING LLC

CERTIFICATE OF SERVICE

I hereby certify that on July 28, 2025, I served a copy of the foregoing document to the following counsel of record via Electronic Mail to:

Dana S. Hardy
Jaclyn M. McLean
HARDY MCLEAN LLC
125 Lincoln Ave., Suite 223
Santa Fe, NM 87505
(505) 230-4410
dhardy@hardymclean.com
jmclean@hardymclean.com

Attorneys for Devon Energy Production Company LP



Michael H. Feldewert



COG OPERATING LLC
PowerCaster 501H, 502H & 602H Lower BS Wells
Lea County, New Mexico

Case No. 25441
BEFORE THE OIL CONSERVATION DIVISION
EXAMINER HEARING July 29, 2025



**STATE OF NEW MEXICO
ENERGY, MINERALS AND NATURAL RESOURCES DEPARTMENT
OIL CONSERVATION DIVISION**

**APPLICATIONS OF COG OPERATING LLC FOR
APPROVAL OF A NON-STANDARD OVERLAPPING
SPACING UNIT AND COMPULSORY POOLING,
LEA COUNTY, NEW MEXICO.**

CASE NOS. 25441

**HEARING PACKAGE
TABLE OF CONTENTS**

- *Revised* Compulsory Pooling Application Checklist
- Filed Application
- **COG Exhibit A:** Self-Affirmed Statement of Michael F. Monju, Landman
 - COG Exhibit A-1: Existing Bone Spring Spacing Units
 - COG *Amended* Exhibit A-2: Draft C-102s
 - COG Exhibit A-3 Land Tracts and Ownership Breakdown
 - COG Exhibit A-4: Sample Well Proposal Letter /AFEs
 - COG Exhibit A-5: Chronology of Contacts
 - COG Exhibit A-6: Offsetting Tracts
- **COG Exhibit B:** Self-Affirmed Statement of Bem Breyman, Geologist
 - COG Exhibit B-1: Location Map
 - COG Exhibit B-2: Type Log for Ownership Depth Severance
 - COG Exhibit B-3: Bone Spring Subsea Structure Map
 - COG Exhibit B-4: Wolfcamp Subsea Structure Map
 - COG Exhibit B-5: Cross Section Map
- **COG Exhibit C:** Self-Affirmed Statement of Notice
- **COG Exhibit D:** Affidavit of Publication

COMPULSORY POOLING APPLICATION CHECKLIST

ALL INFORMATION IN THE APPLICATION MUST BE SUPPORTED BY SIGNED AFFIDAVITS

Case: 25441	APPLICANT'S RESPONSE
Date	July 29, 2025
Applicant	COG Operating LLC
Designated Operator & OGRID (affiliation if applicable)	COG Operating LLC (229137)
Applicant's Counsel:	Holland & Hart LLP
Case Title:	Application of COG Operating LLC For Approval Of A Non-Standard Overlapping Spacing Unit and Compulsory Pooling, Lea County, New Mexico.
Entries of Appearance/Intervenors:	Paloma Permian AssetCo, LLC; Devon Energy Production Company LP
Well Family	PowerCaster Federal Com
Formation/Pool	
Formation Name(s) or Vertical Extent:	Lower Bone Spring formation
Primary Product (Oil or Gas):	Oil
Pooling this vertical extent:	Top of the Second Bone Spring interval, at a stratigraphic equivalent of approximately 10,290'TVD, to the base of the Third Bone Spring interval, at a stratigraphic equivalent of approximately 11,631' TVD as observed in the well log for the West Copperline 29 State Com 1H (API No. 30-025-41313).
Pool Name and Pool Code:	Antelope Ridge Bone Spring, West (2209)
Well Location Setback Rules:	Statewide setbacks
Spacing Unit	
Type (Horizontal/Vertical)	Horizontal
Size (Acres)	1280-acre, more or less
Building Blocks:	40 acres
Orientation:	north-south
Description: TRS/County	All of Sections 20 and 29, Township 23 South, Range 34 East, NMPM, Lea County, New Mexico.
Standard Horizontal Well Spacing Unit (Y/N), If No, describe and is approval of non-standard unit requested in this application?	No, approval of non-standard 1280-acre horizontal well spacing unit is requested.
Other Situations	
Depth Severance: Y/N. If yes, description	Yes. There is an ownership depth severance at the base of the First Bone Spring interval underlying this acreage
Proximity Tracts: If yes, description	No
Proximity Defining Well: if yes, description	N/A
Applicant's Ownership in Each Tract	Exhibit A-4

Well(s)	
Name & API (if assigned), surface and bottom hole location, footages, completion target, orientation, completion status (standard or non-standard)	Add wells as needed
Well #1	<u>PowerCaster Federal Com 501H (API # pending)</u> SHL: 250' FNL, 1165' FEL (Unit A), Section 20 BHL: 50' FSL, 1310' FEL (Unit P), Section 29 Completion Target: Lower Bone Spring (2nd Bone Spring interval) Well Orientation: north-south Completion Location expected to be: Standard for a non-standard unit
Well #2	<u>PowerCaster Federal Com 502H (API # pending)</u> SHL: 560' FNL, 770' FWL (Unit D), Section 20 BHL: 50' FSL, 1310' FWL (Unit M), Section 29 Completion Target: Lower Bone Spring (2nd Bone Spring interval) Well Orientation: north-south Completion Location expected to be: Standard for a non-standard unit
Well #3	<u>PowerCaster Federal Com 602H (API # pending)</u> SHL: 250' FNL, 1085' FWL (Unit A), Section 20 BHL: 50' FSL, 2630' FWL (Unit N), Section 29 Completion Target: Lower Bone Spring (3rd Bone Spring interval) Well Orientation: north-south Completion Location expected to be: Standard for a non-standard unit
Horizontal Well First and Last Take Points	Exhibit A-2
Completion Target (Formation, TVD and MD)	Exhibit A-4
AFE Capex and Operating Costs	
Drilling Supervision/Month \$	\$8,000
Production Supervision/Month \$	\$800
Justification for Supervision Costs	Exhibit A
Requested Risk Charge	200%
Notice of Hearing	
Proposed Notice of Hearing	See filed application
Proof of Mailed Notice of Hearing (20 days before hearing)	Exhibit C
Proof of Published Notice of Hearing (10 days before hearing)	Exhibit D
Ownership Determination	
Land Ownership Schematic of the Spacing Unit	Exhibit A-2
Tract List (including lease numbers and owners)	Exhibit A-3
If approval of Non-Standard Spacing Unit is requested, Tract List (including lease numbers and owners) of Tracts subject to	
Reduction of Imaging	Exhibit A-6

Pooled Parties (including ownership type)	Exhibit A-3
Unlocatable Parties to be Pooled	N/A
Ownership Depth Severance (including percentage above & below)	Exhibit A-3
Joinder	
Sample Copy of Proposal Letter	Exhibit A-4
List of Interest Owners (ie Exhibit A of JOA)	Exhibit A-3
Chronology of Contact with Non-Joined Working Interests	Exhibit A-5
Overhead Rates In Proposal Letter	Exhibit A-4
Cost Estimate to Drill and Complete	Exhibit A-4
Cost Estimate to Equip Well	Exhibit A-4
Cost Estimate for Production Facilities	Exhibit A-4
Geology	
Summary (including special considerations)	Exhibit B
Spacing Unit Schematic	Exhibit B-1
Gunbarrel/Lateral Trajectory Schematic	Exhibit B-1
Well Orientation (with rationale)	Exhibit B & B-3
Target Formation	Exhibit B & B-5
HSU Cross Section	Exhibit B-5
Depth Severance Discussion	Exhibits A and B
Forms, Figures and Tables	
C-102	Exhibit A-2
Tracts	Exhibit A-3
Summary of Interests, Unit Recapitulation (Tracts)	Exhibit A-3
General Location Map (including basin)	Exhibit B-1
Well Bore Location Map	Exhibit B-1
Structure Contour Map - Subsea Depth	Exhibit B-3
Cross Section Location Map (including wells)	Exhibit B-3
Cross Section (including Landing Zone)	Exhibit B-5
Additional Information	
Special Provisions/Stipulations	Approval of an overlapping spacing unit is requested
CERTIFICATION: I hereby certify that the information provided in this checklist is complete and accurate.	
Printed Name (Attorney or Party Representative):	Michael H. Feldewert
Signed Name (Attorney or Party Representative):	
Date:	7/28/2025

**STATE OF NEW MEXICO
ENERGY, MINERALS AND NATURAL RESOURCES DEPARTMENT
OIL CONSERVATION DIVISION**

**APPLICATION OF COG OPERATING LLC FOR
APPROVAL OF A NON-STANDARD OVERLAPPING
SPACING UNIT AND COMPULSORY POOLING,
LEA COUNTY, NEW MEXICO.**

CASE NO. 25441

APPLICATION

COG Operating LLC (“COG” or “Applicant”) (OGRID No. 229137), through its undersigned attorneys, files this application with the Oil Conservation Division pursuant to the provisions of NMSA 1978, § 70-2-17, for an order (a) approving a non-standard 1280-acre, more or less, overlapping horizontal well spacing unit in an interval of the Bone Spring formation underlying Sections 20 and 29, Township 23 South, Range 34 East, NMPM, Lea County, New Mexico, and (b) pooling the uncommitted mineral owners in this acreage. In support of this application, COG states:

1. Applicant is a working interest owner in the proposed horizontal spacing unit and has the right to drill thereon.
2. To address an ownership depth severance that exists in the Bone Spring formation underlying the subject acreage, Applicant seeks to form a spacing unit and pool the uncommitted interests in an interval of the Bone Spring formation defined as the top of the Second Bone Spring interval, at a stratigraphic equivalent of approximately 10,290’TVD, to the base of the Third Bone Spring interval, at a stratigraphic equivalent of approximately 11,631’ TVD as observed in the well log for the West Copperline 29 State Com 1H (API No. 30-025-41313).

3. Applicant seeks to initially dedicate the above-referenced horizontal spacing unit to the following proposed wells to be horizontally drilled from a surface location in the N2N2 of Section 20:

- **PowerCaster Federal Com 501H**, with a first take point in the NE4NE4 (Unit A) of Section 20 and a last take point in the SE4SE4 (Unit P) of Section 29;
- **PowerCaster Federal Com 502H**, with a first take point in the NW4NW4 (Unit D) of Section 20 and a last take point in the SW4SW4 (Unit M) of Section 29; and
- **PowerCaster Federal Com 602H**, with a first take point in the NE4NW4 (Unit C) of Section 20 and a last take point in the SE4SW4 (Unit N) of Section 29.

4. Due to the nature and configuration of the federal leases in the subject area, the Bureau of Land Management (“BLM”) will not approve the commingling of production at central facilities if the subject area is developed using standard horizontal well spacing units. See, e.g., 43 CFR 3173.14 (addressing authorized commingling). However, if the proposed non-standard spacing unit is approved by the Division, the BLM will issue a corresponding Communitization Agreement for the federal leases within the subject area to allow commingling and the corresponding reduction of the necessary surface facilities.

5. Approval of a non-standard unit will allow Applicant to efficiently locate surface facilities for the recovery of oil and gas underlying the subject lands, reduce surface disturbance, lower operating costs and allow for efficient well spacing.

6. This proposed horizontal well spacing unit will overlap the following existing or proposed spacing units in the Bone Spring formation (Antelope Ridge Bone Spring, West Pool (Cost 2209)):

- A 160-acre spacing unit comprised of the E2E2 of Section 20, dedicated to the Stratocaster 20 Federal 4H (API No. 30-025-27051), operated by COG Operating;
- A 160-acre spacing unit comprised of the W2E2 of Section 20, dedicated to the Stratocaster 20 Federal 3H (API No. 30-025-41447) operated by COG Operating;
- A 160-acre spacing unit comprised of the E2W2 of Section 20, dedicated to the Stratocaster 20 Federal 2H (API No. 30-025-41381), operated by COG Operating;
- A 160-acre spacing unit comprised of the W2W2 of Section 20, dedicated to the Stratocaster 20 Federal 1H (API No. 30-025-37295), operated by COG Operating;
- A 160-acre spacing unit comprised of the E2E2 of Section 29, dedicated to the Broadcaster 29 Federal 4H (API No. 30-025-42954) operated by COG Operating;
- A 160-acre spacing unit comprised of the W2E2 of Section 29, dedicated to the Broadcaster 29 Federal 3H (API No. 30-025-41909) operated by COG Operating;
- A 160-acre spacing unit comprised of the E2W2 of Section 29, dedicated to the West Copperline 29 Fed State Com 1H (API No. 30-025-41313) and West Copperline 29 Fed State Com 3H (API No. 30-025-41536), operated by Paloma Permian Asset Co, LLC;
- A 160-acre spacing unit comprised of the W2W2 of Section 29, dedicated to the West Copperline 29 Fed State Com 2H (API No. 30-025-41640) and West Copperline 29 Fed State Com 4H (API No. 30-025-41802), operated by Paloma Permian Asset Co, LLC; and

- A proposed 1280-acre spacing unit in a shallower interval of the Bone Spring formation underlying Sections 20 and 29 to be dedicated to Applicant's proposed PowerCaster Federal Com 301H, 302H, 303H, 401H, 402H, 403H, 404H wells targeting this shallower interval.

7. Applicant has sought and been unable to obtain voluntary agreement for the development of these lands from all interest owners in the subject spacing unit.

8. Approval of this non-standard overlapping horizontal well spacing unit and the pooling of interests therein will allow Applicant to obtain a just and fair share of the oil and gas underlying the subject lands, avoid the drilling of unnecessary wells, will prevent waste, and will protect correlative rights.

WHEREFORE, Applicant requests that this application be set for hearing before an Examiner of the Oil Conservation Division on July 10, 2025, and, after notice and hearing as required by law, the Division enter an order:

- A. Approving the proposed non-standard overlapping horizontal well spacing unit and pooling the uncommitted mineral owners therein;
- B. Designating Applicant as operator of this spacing unit and the horizontal wells to be drilled thereon;
- C. Authorizing Applicant to recover its costs of drilling, completing, and equipping the wells;
- D. Approving the actual operating charges and costs of supervision while drilling and after completion, together with a provision adjusting the rates pursuant to the COPAS accounting procedures; and

E. Imposing a 200% charge for the risk assumed by Applicant in drilling and completing the well against any working interest owner who does not voluntarily participate in the drilling of the well.

Respectfully submitted,

HOLLAND & HART LLP

By: 

Michael H. Feldewert

Adam G. Rankin

Paula M. Vance

Post Office Box 2208

Santa Fe, New Mexico 87504-2208

(505) 988-4421

(505) 983-6043 Facsimile

mfeldewert@hollandhart.com

agrarkin@hollandhart.com

pmvance@hollandhart.com

ATTORNEYS FOR COG OPERATING LLC

CASE _____: Application of COG Operating LLC for Approval of a Non-Standard Overlapping Horizontal Well Spacing Unit and Compulsory Pooling, Lea County, New Mexico. Applicant in the above-styled cause seeks an order (a) approving a non-standard 1280-acre, more or less, overlapping horizontal well spacing unit in an interval of the Bone Spring formation underlying Sections 20 and 29, Township 23 South, Range 34 East, NMPM, Lea County, New Mexico, and (b) pooling the uncommitted mineral owners in this acreage. To address an ownership depth severance in the Bone Spring, Applicant seeks to create a spacing unit and pool uncommitted interests in an interval of the Bone Spring formation defined as the top of the Second Bone Spring interval, at a stratigraphic equivalent of approximately 10,290' TVD, to the base of the Third Bone Spring interval, at a stratigraphic equivalent of approximately 11,631' TVD as observed in the well log for the West Copperline 29 State Com 1H (API No. 30-025-41313). Applicant seeks to initially dedicate the above-referenced horizontal spacing unit to the following proposed wells:

- PowerCaster Federal Com 501H, with a first take point in the NE4NE4 (Unit A) of Section 20 and a last take point in the SE4SE4 (Unit P) of Section 29;
- PowerCaster Federal Com 502H, with a first take point in the NW4NW4 (Unit D) of Section 20 and a last take point in the SW4SW4 (Unit M) of Section 29; and
- PowerCaster Federal Com 602H, with a first take point in the NE4NW4 (Unit C) of Section 20 and a last take point in the SE4SW4 (Unit N) of Section 29.

This proposed non-standard horizontal well spacing unit will overlap the following existing or proposed spacing units in the Bone Spring formation:

- A 160-acre spacing unit comprised of the E2E2 of Section 20, dedicated to the Stratocaster 20 Federal 4H (API No. 30-025-27051), operated by COG Operating;
- A 160-acre spacing unit comprised of the W2E2 of Section 20, dedicated to the Stratocaster 20 Federal 3H (API No. 30-025-41447) operated by COG Operating;
- A 160-acre spacing unit comprised of the E2W2 of Section 20, dedicated to the Stratocaster 20 Federal 2H (API No. 30-025-41381), operated by COG Operating;
- A 160-acre spacing unit comprised of the W2W2 of Section 20, dedicated to the Stratocaster 20 Federal 1H (API No. 30-025-37295), operated by COG Operating;
- A 160-acre spacing unit comprised of the E2E2 of Section 29, dedicated to the Broadcaster 29 Federal 4H (API No. 30-025-42954) operated by COG Operating;
- A 160-acre spacing unit comprised of the W2E2 of Section 29, dedicated to the Broadcaster 29 Federal 3H (API No. 30-025-41909) operated by COG Operating;

- A 160-acre spacing unit comprised of the E2W2 of Section 29, dedicated to the West Copperline 29 Fed State Com 1H (API No. 30-025-41313) and West Copperline 29 Fed State Com 3H (API No. 30-025-41536), operated by Paloma Permian Asset Co, LLC;
- A 160-acre spacing unit comprised of the W2W2 of Section 29, dedicated to the West Copperline 29 Fed State Com 2H (API No. 30-025-41640) and West Copperline 29 Fed State Com 4H (API No. 30-025-41802), operated by Paloma Permian Asset Co, LLC;
- A proposed non-standard 1280-acre spacing unit in a shallower interval of the Bone Spring formation underlying Sections 20 and 29 to be dedicated to Applicant's proposed PowerCaster Federal Com 301H, 302H, 303H, 401H, 402H, 403H, 404H wells targeting this shallower interval.

Also to be considered will be the cost of drilling and completing the wells and the allocation of the cost thereof, actual operating costs and charges for supervision, designation of Applicant as operator of the wells, and a 200% charge for risk involved in drilling the wells. The subject area is located approximately 20 miles northeast of Jal, New Mexico.

**STATE OF NEW MEXICO
ENERGY, MINERALS AND NATURAL RESOURCES DEPARTMENT
OIL CONSERVATION DIVISION**

**APPLICATIONS OF COG OPERATING LLC FOR
APPROVAL OF A NON-STANDARD OVERLAPPING
SPACING UNIT AND COMPULSORY POOLING,
LEA COUNTY, NEW MEXICO.**

CASE NOS. 25440-25441

**APPLICATIONS OF COG OPERATING LLC
FOR COMPULSORY POOLING,
LEA COUNTY, NEW MEXICO.**

CASE NOS. 25442-25443

SELF-AFFIRMED STATEMENT OF MICHAEL F. MONJU

1. My name is Michael F. Monju, and I am a Landman with COG Operating LLC (“COG”), now a wholly owned subsidiary of ConocoPhillips Company.

2. My credentials as an expert in petroleum land matters have previously been accepted by the Division and made a matter of record, though I have not actually testified before the New Mexico Oil Conservation Division (“Division”).

3. I am familiar with the applications filed in these consolidated cases and the status of the lands in the subject area.

The Bone Spring Formation Under Sections 20 and 29

4. COG currently operates four Bone Spring spacing units covering Section 20 and two Bone Spring spacing units covering the E2 of Section 29 in Township 23 South, Range 34 East, Lea County, New Mexico. There are also two existing Bone Spring spacing units in the W2 of Section 29 that are operated by Paloma Permian Asset Co, LLC (“Paloma”). **Exhibit**

**BEFORE THE OIL CONSERVATION DIVISION
Santa Fe, New Mexico
Exhibit No. A
Submitted by: COG Operating LLC
Hearing Date: July 29, 2025
Case No. 25441**

A-1 depicts these existing spacing units and the existing Bone Spring development in these two sections.

5. There is an ownership depth severance in the Bone Spring formation under Sections 20 and 29, creating differing ownership above and below the base of the First Bone Spring interval.

6. To address this differing ownership, to accommodate the existing development in Sections 20 and 29, and to continue development of the Bone Spring formation in these two sections, COG seeks to create and pool horizontal well spacing units for proposed 2-mile wells in the Bone Spring formation as follows:

- Under **Case 25440**, COG seeks to create and pool a non-standard 1280-acre, more or less, overlapping horizontal well spacing unit in an interval of the Bone Spring formation underlying Sections 20 and 29 defined as the top of the Bone Spring formation, at a stratigraphic equivalent of 8,653' TVD to the base of the First Bone Spring interval at a stratigraphic equivalent of approximately 10,289' TVD, as observed in the well log for the West Copperline 29 State Com 1H well (API No. 30-025-41313). COG seeks to initially dedicate this spacing unit to the following proposed wells:
 - **PowerCaster Federal Com 301H and 401H** wells, with first take points in the NE4NE4 (Unit A) of Section 20 and last take points in the SE4SE4 (Unit P) of Section 29;
 - **PowerCaster Federal Com 302H and 402H** wells, with first take points in the NW4NE4 (Unit B) of Section 20 and last take points in the SW4SE4 (Unit O) of Section 29;

- **PowerCaster Federal Com 403H** well, with a first take point in the NE4NW4 (Unit C) of Section 20 and a last take point in the SE4SW4 (Unit N) of Section 29; and
- **PowerCaster Federal Com 303H and 404H** wells, with first take points in the NW4NW4 (Unit D) of Section 20 and last take points in the SW4SW4 (Unit M) of Section 29.

This proposed will overlap the following existing or proposed spacing units in the Bone Spring formation:

- A 160-acre spacing unit comprised of the E2E2 of Section 20, dedicated to the Stratocaster 20 Federal 4H (API No. 30-025-27051), operated by COG Operating;
- A 160-acre spacing unit comprised of the W2E2 of Section 20, dedicated to the Stratocaster 20 Federal 3H (API No. 30-025-41447) operated by COG Operating;
- A 160-acre spacing unit comprised of the E2W2 of Section 20, dedicated to the Stratocaster 20 Federal 2H (API No. 30-025-41381), operated by COG Operating;
- A 160-acre spacing unit comprised of the W2W2 of Section 20, dedicated to the Stratocaster 20 Federal 1H (API No. 30-025-37295), operated by COG Operating;
- A 160-acre spacing unit comprised of the E2E2 of Section 29, dedicated to the Broadcaster 29 Federal 4H (API No. 30-025-42954) operated by COG Operating;

- A 160-acre spacing unit comprised of the W2E2 of Section 29, dedicated to the Broadcaster 29 Federal 3H (API No. 30-025-41909) operated by COG Operating;
- A 160-acre spacing unit comprised of the E2W2 of Section 29, dedicated to the West Copperline 29 Fed State Com 1H (API No. 30-025-41313) and West Copperline 29 Fed State Com 3H (API No. 30-025-41536), operated by Paloma Permian Asset Co, LLC;
- A 160-acre spacing unit comprised of the W2W2 of Section 29, dedicated to the West Copperline 29 Fed State Com 2H (API No. 30-025-41640) and West Copperline 29 Fed State Com 4H (API No. 30-025-41802), operated by Paloma Permian Asset Co, LLC;
- A proposed non-standard 1280-acre spacing unit in a lower interval of the Bone Spring formation underlying Sections 20 and 29 to be dedicated to Applicant's proposed PowerCaster Federal Com 501H, 502H and 602H wells targeting this lower interval.
- Under **Case 25441**, COG seeks to create and pool a non-standard 1280-acre, more or less, overlapping horizontal well spacing unit in an interval of the Bone Spring formation underlying Sections 20 and 29 defined as the top of the Second Bone Spring interval, at a stratigraphic equivalent of approximately 10,290'TVD, to the base of the Third Bone Spring interval, at a stratigraphic equivalent of approximately 11,631' TVD as observed in the well log for the West Copperline 29 State Com 1H (API No. 30-025-41313).

COG seeks to initially dedicate this spacing unit to the following proposed wells:

- **PowerCaster Federal Com 501H**, with a first take point in the NE4NE4 (Unit A) of Section 20 and a last take point in the SE4SE4 (Unit P) of Section 29;
- **PowerCaster Federal Com 502H**, with a first take point in the NW4NW4 (Unit D) of Section 20 and a last take point in the SW4SW4 (Unit M) of Section 29; and
- **PowerCaster Federal Com 602H**, with a first take point in the NE4NW4 (Unit C) of Section 20 and a last take point in the SE4SW4 (Unit N) of Section 29.

This proposed non-standard horizontal unit will overlap the following existing or proposed spacing units in the Bone Spring formation:

- A 160-acre spacing unit comprised of the E2E2 of Section 20, dedicated to the Stratocaster 20 Federal 4H (API No. 30-025-27051), operated by COG Operating;
- A 160-acre spacing unit comprised of the W2E2 of Section 20, dedicated to the Stratocaster 20 Federal 3H (API No. 30-025-41447) operated by COG Operating;
- A 160-acre spacing unit comprised of the E2W2 of Section 20, dedicated to the Stratocaster 20 Federal 2H (API No. 30-025-41381), operated by COG Operating;

- A 160-acre spacing unit comprised of the W2W2 of Section 20, dedicated to the Stratocaster 20 Federal 1H (API No. 30-025-37295), operated by COG Operating;
- A 160-acre spacing unit comprised of the E2E2 of Section 29, dedicated to the Broadcaster 29 Federal 4H (API No. 30-025-42954) operated by COG Operating;
- A 160-acre spacing unit comprised of the W2E2 of Section 29, dedicated to the Broadcaster 29 Federal 3H (API No. 30-025-41909) operated by COG Operating;
- A 160-acre spacing unit comprised of the E2W2 of Section 29, dedicated to the West Copperline 29 Fed State Com 1H (API No. 30-025-41313) and West Copperline 29 Fed State Com 3H (API No. 30-025-41536), operated by Paloma Permian Asset Co, LLC;
- A 160-acre spacing unit comprised of the W2W2 of Section 29, dedicated to the West Copperline 29 Fed State Com 2H (API No. 30-025-41640) and West Copperline 29 Fed State Com 4H (API No. 30-025-41802), operated by Paloma Permian Asset Co, LLC;
- A proposed non-standard 1280-acre spacing unit in a shallower interval of the Bone Spring formation underlying Sections 20 and 29 to be dedicated to Applicant's proposed PowerCaster Federal Com 301H, 302H, 303H, 401H, 402H, 403H, 404H wells targeting this shallower interval.

7. Approval of these non-standard spacing units in the Bone Spring formation will not only address the ownership depth severance but allow COG to implement efficient well spacing and to reduce surface facilities.

8. To commence development of the Wolfcamp formation under Sections 20 and 29, COG has proposed the following standard spacing units:

- Under **Case 25442**, COG seeks to pool a standard 640-acre, more or less, horizontal well spacing unit Wolfcamp formation underlying the E2 of Sections 20 and 29. Applicant seeks to initially dedicate this spacing unit to the proposed **PowerCaster Federal Com 601H** well, to be drilled from the N2N2 of Section 20, with a first take point in the NE4NE4 (Unit A) of Section 20 and a last take point in the SE4SE4 (Unit P) of Section 29. The completed interval of this well is expected to remain within 330 feet of the offsetting quarter-quarter sections or equivalent tracts to allow inclusion of this acreage in a standard horizontal well spacing unit.
- Under **Case 25443**, COG seeks to pool a standard 640-acre, more or less, horizontal well spacing unit Wolfcamp formation underlying the W2 of Sections 20 and 29. Applicant seeks to initially dedicate this spacing unit to the proposed **PowerCaster Federal Com 603H** well, to be drilled from the N2N2 of Section 20, with a first take point in the NW4NW4 (Unit D) of Section 20 and a last take point in the SW4SW4 (Unit M) of Section 29. The completed interval of this well is expected to remain within 330 feet of the offsetting quarter-quarter sections or equivalent tracts to allow inclusion of this acreage in a standard horizontal well spacing unit.

9. **COG Exhibit A-2** contains the draft Form C-102's for COG's proposed well.

10. **COG Exhibit A-3** identifies the tracts of land comprising COG's proposed horizontal well spacing units, the ownership interests in each tract, and the ownership interests on

a spacing unit based on depth. The subject acreage is comprised of federal and state lands. The parties COG seeks to pool are highlighted in yellow.

11. **COG Exhibit A-4** contains a sample of the well proposal letter and AFEs sent to the working interest owners. The costs reflected in the AFEs are consistent with what COG and other operators have incurred for drilling similar horizontal wells in the area in these formations.

12. COG requests that the overhead and administrative costs for drilling and producing the proposed wells be set at \$8,000 per month while drilling and \$800 per month while producing. These costs are consistent with what other operators are charging in this area for similar wells.

13. **COG Exhibit A-5** contains a general summary of the contacts with the uncommitted interest owners. As indicated in the exhibit, COG has made a good faith effort to locate, communicate and reach agreement with the parties that it seeks to pool. In my opinion, COG has undertaken good faith efforts to reach an agreement with the uncommitted interest owners.

14. **COG Exhibit A-6** identifies the offsetting tracts affected by COG's request for non-standard spacing units in the Bone Spring formation and the operator or working interest owners in these affected tracts.

15. COG has provided the law firm of Holland & Hart LLP with the names and addresses of the parties that COG seeks to pool, and the parties affected by the non-standard overlapping spacing units in the Bone Spring formation. COG has instructed that these parties be notified of this hearing. COG has conducted a diligent search of all public records in the county where the property is located, reviewed telephone directories, and conducted computer searches to locate contact information for each interest owner.

16. **COG Exhibit A-1 through A-6** were either prepared by me or compiled under my direction and supervision.

17. I affirm under penalty of perjury under the laws of the State of New Mexico that the foregoing statements are true and correct. I understand that this self-affirmed statement will be used as written testimony in this case. This statement is made on the date next to my signature below.

MF Monju

Michael Monju

7/22/2025

Date

POWERCASTER FED COM: overlapping spacing units

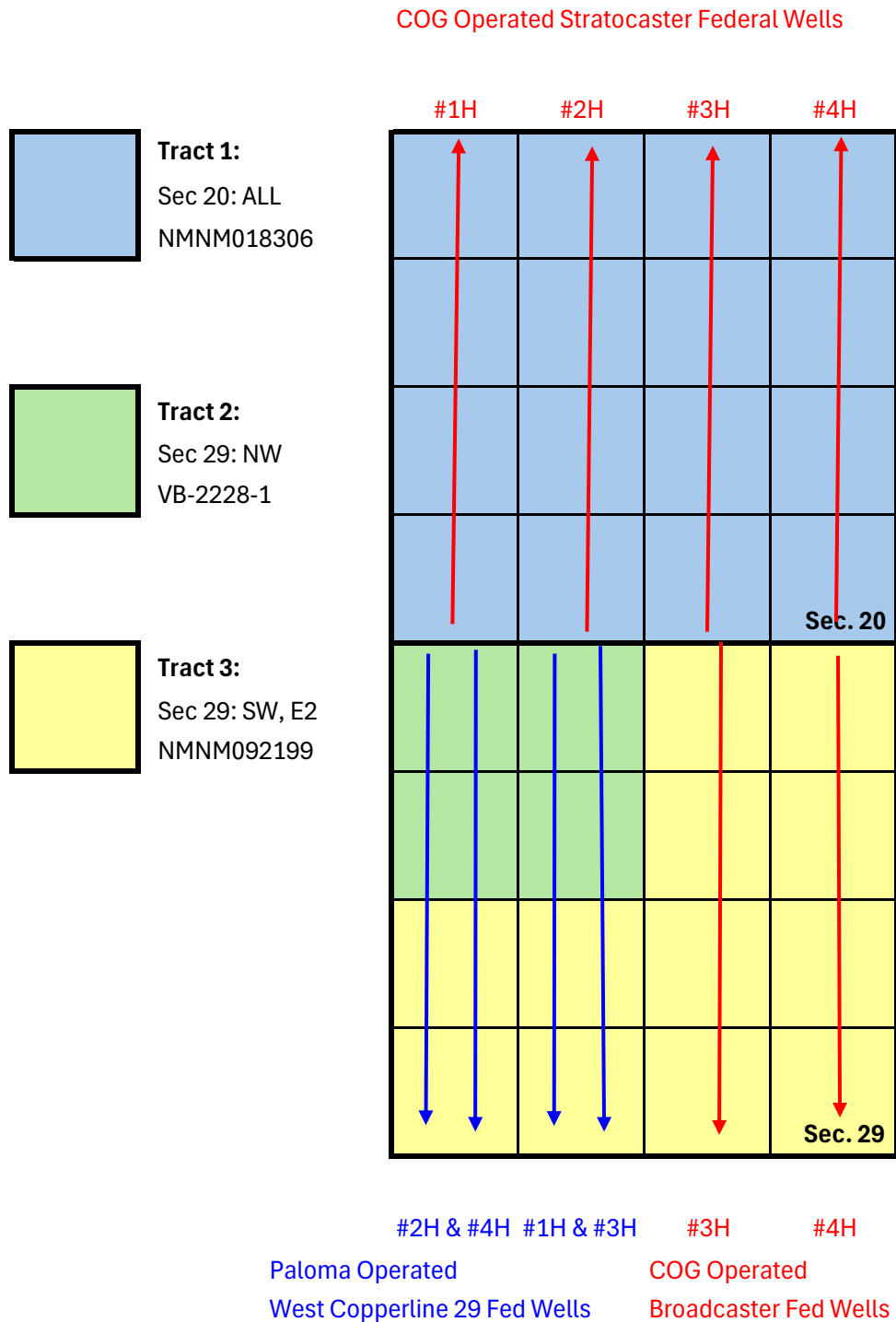

C-102 Submit Electronically Via OCD Permitting	State of New Mexico Energy, Minerals & Natural Resources Department OIL CONSERVATION DIVISION	Revised July 9, 2024	
		Submittal Type:	<input type="checkbox"/> Initial Submittal
			<input type="checkbox"/> Amended Report
		<input type="checkbox"/> As Drilled	

WELL LOCATION INFORMATION

API Number	Pool Code	Pool Name
Property Code	Property Name POWERCASTER FEDERAL COM	Well Number 501H
OGRID No.	Operator Name COG OPERATING LLC	Ground Level Elevation
Surface Owner: <input type="checkbox"/> State <input type="checkbox"/> Fee <input type="checkbox"/> Tribal <input type="checkbox"/> Federal		Mineral Owner: <input type="checkbox"/> State <input type="checkbox"/> Fee <input type="checkbox"/> Tribal <input type="checkbox"/> Federal

Surface Location

UL	Section	Township	Range	Lot	Ft. from N/S	Ft. from E/W	Latitude	Longitude	County
A	20	23-S	34-E		250 FNL	1165 FEL	32.296681°N	103.487328°W	LEA

Bottom Hole Location

UL	Section	Township	Range	Lot	Ft. from N/S	Ft. from E/W	Latitude	Longitude	County
P	29	23-S	34-E		50 FSL	1310 FEL	32.268479°N	103.487758°W	LEA

Dedicated Acres	Infill or Defining Well	Defining Well API	Overlapping Spacing Unit (Y/N)	Consolidation Code
Order Numbers.			Well setbacks are under Common Ownership: <input type="checkbox"/> Yes <input type="checkbox"/> No	

Kick Off Point (KOP)

UL	Section	Township	Range	Lot	Ft. from N/S	Ft. from E/W	Latitude	Longitude	County
A	20	23-S	34-E		250 FNL	1165 FEL	32.296681°N	103.487328°W	LEA

First Take Point (FTP)

UL	Section	Township	Range	Lot	Ft. from N/S	Ft. from E/W	Latitude	Longitude	County
A	20	23-S	34-E		100 FNL	1310 FEL	32.297094°N	103.487797°W	LEA

Last Take Point (LTP)

UL	Section	Township	Range	Lot	Ft. from N/S	Ft. from E/W	Latitude	Longitude	County
P	29	23-S	34-E		100 FSL	1310 FEL	32.268616°N	103.487758°W	LEA

Unitized Area or Area of Uniform Interest	Spacing Unit Type <input type="checkbox"/> Horizontal <input type="checkbox"/> Vertical	Ground Floor Elevation:
---	---	-------------------------

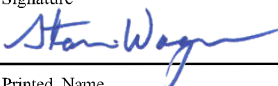
OPERATOR CERTIFICATIONS <i>I hereby certify that the information contained herein is true and complete to the best of my knowledge and belief, and, if the well is a vertical or directional well, that this organization either owns a working interest or unleased mineral interest in the land including the proposed bottom hole location or has a right to drill this well at this location pursuant to a contract with an owner of a working interest or unleased mineral interest, or to a voluntary pooling agreement or a compulsory pooling order heretofore entered by the division.</i> <i>If this well is a horizontal well, I further certify that this organization has received the consent of at least one lessee or owner of a working interest or unleased mineral interest in each tract (in the target pool or formation) in which any part of the well's completed interval will be located or obtained a compulsory pooling order from the division.</i>		SURVEYOR CERTIFICATIONS <i>I hereby certify that the well location shown on this plat was plotted from field notes of actual surveys made by me or under my supervision, and that the same is true and correct to the best of my belief.</i>	
Signature 		Signature and Seal of Professional Surveyor	
Date 7/28/25			
Printed Name Stan Wagner		Certificate Number 17777	Date of Survey
Email Address			W.O.#25-879
		DRAWN BY: WN	
		PAGE 1 OF 2	

Note: No allowable will be assigned to this completion until all interests have been consolidated or a non-standard unit has been approved by the division.

This grid represents a standard section. You may superimpose a non-standard section, or larger area, over this grid. Operators must outline the dedicated acreage in a red box, clearly show the well surface location and bottom hole location, if it is directionally drilled, with the dimensions from the section lines in the cardinal directions. If this is a horizontal wellbore show on this plat the location of the First Take Point and Last Take Point, and the point within the Completed interval (other than the First Take Point or Last Take Point) that is closest to any outer boundary of the tract.

Surveyors shall use the latest United States government survey or dependent resurvey. Well locations will be in reference to the New Mexico Principal Meridian. If the land is not surveyed, contact the OCD Engineering Bureau. Independent subdivision surveys will not be acceptable.

NAD 83 NME
SURFACE LOCATION & KOP
Y=472696.5 N
X=802745.3 E
LAT.=32.296681° N
LONG.=103.487328° W

POINT LEGEND	
1	Y=472834.4 N X=801287.6 E
2	Y=467654.4 N X=801316.5 E
3	Y=462376.5 N X=801369.8 E
4	Y=462396.1 N X=804003.6 E
5	Y=465036.3 N X=803980.0 E
6	Y=467676.4 N X=803955.3 E
7	Y=470316.3 N X=803931.6 E
8	Y=472856.0 N X=803908.1 E

NAD 83 NME
BOTTOM
HOLE LOCATION
Y=462435.4 N
X=802693.2 E
LAT.=32.268479° N
LONG.=103.487758° W

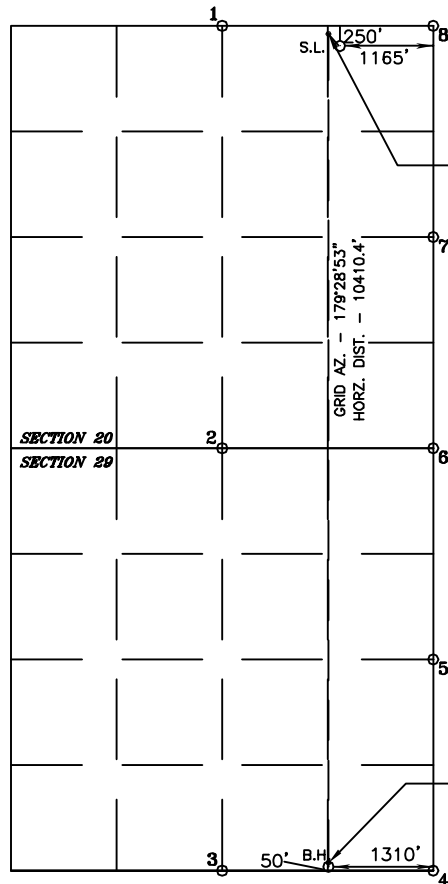

FTP/PPP1
100' FNL & 1310' FEL
Y=472845.3 N
X=802599.0 E
LAT.=32.297094° N
LONG.=103.487797° W
GRID AZ. TO FTP
315°28'50"

LTP
100' FSL & 1310' FEL
Y=462485.4 N
X=802692.8 E
LAT.=32.268616° N
LONG.=103.487758° W

C-102 Submit Electronically Via OCD Permitting	State of New Mexico Energy, Minerals & Natural Resources Department OIL CONSERVATION DIVISION	Revised July 9, 2024	
		Submittal Type:	<input type="checkbox"/> Initial Submittal
			<input type="checkbox"/> Amended Report
		<input type="checkbox"/> As Drilled	

WELL LOCATION INFORMATION

API Number	Pool Code	Pool Name
Property Code	Property Name POWERCASTER FEDERAL COM	Well Number 502H
OGRID No.	Operator Name COG OPERATING LLC	Ground Level Elevation
Surface Owner: <input type="checkbox"/> State <input type="checkbox"/> Fee <input type="checkbox"/> Tribal <input type="checkbox"/> Federal		Mineral Owner: <input type="checkbox"/> State <input type="checkbox"/> Fee <input type="checkbox"/> Tribal <input type="checkbox"/> Federal

Surface Location

UL	Section	Township	Range	Lot	Ft. from N/S	Ft. from E/W	Latitude	Longitude	County
D	20	23-S	34-E		560 FNL	770 FWL	32.295825°N	103.498155°W	LEA

Bottom Hole Location

UL	Section	Township	Range	Lot	Ft. from N/S	Ft. from E/W	Latitude	Longitude	County
M	29	23-S	34-E		50 FSL	1310 FWL	32.268485°N	103.496359°W	LEA

Dedicated Acres	Infill or Defining Well	Defining Well API	Overlapping Spacing Unit (Y/N)	Consolidation Code
Order Numbers.			Well setbacks are under Common Ownership: <input type="checkbox"/> Yes <input type="checkbox"/> No	

Kick Off Point (KOP)

UL	Section	Township	Range	Lot	Ft. from N/S	Ft. from E/W	Latitude	Longitude	County
D	20	23-S	34-E		560 FNL	770 FWL	32.295825°N	103.498155°W	LEA

First Take Point (FTP)

UL	Section	Township	Range	Lot	Ft. from N/S	Ft. from E/W	Latitude	Longitude	County
D	20	23-S	34-E		100 FNL	1310 FWL	32.297090°N	103.496410°W	LEA

Last Take Point (LTP)

UL	Section	Township	Range	Lot	Ft. from N/S	Ft. from E/W	Latitude	Longitude	County
M	29	23-S	34-E		100 FSL	1310 FWL	32.268622°N	103.496359°W	LEA

Unitized Area or Area of Uniform Interest	Spacing Unit Type <input type="checkbox"/> Horizontal <input type="checkbox"/> Vertical	Ground Floor Elevation:
---	---	-------------------------

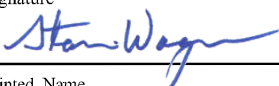
OPERATOR CERTIFICATIONS <i>I hereby certify that the information contained herein is true and complete to the best of my knowledge and belief, and, if the well is a vertical or directional well, that this organization either owns a working interest or unleased mineral interest in the land including the proposed bottom hole location or has a right to drill this well at this location pursuant to a contract with an owner of a working interest or unleased mineral interest, or to a voluntary pooling agreement or a compulsory pooling order heretofore entered by the division.</i> <i>If this well is a horizontal well, I further certify that this organization has received the consent of at least one lessee or owner of a working interest or unleased mineral interest in each tract (in the target pool or formation) in which any part of the well's completed interval will be located or obtained a compulsory pooling order from the division.</i>		SURVEYOR CERTIFICATIONS <i>I hereby certify that the well location shown on this plat was plotted from field notes of actual surveys made by me or under my supervision, and that the same is true and correct to the best of my belief.</i>				
Signature 	Date 7/28/25	Signature and Seal of Professional Surveyor				
Printed Name Stan Wagner	Email Address	Certificate Number 17777	Date of Survey <table><tr><td>W.O.#25-885</td><td>DRAWN BY: WN</td><td>PAGE 1 OF 2</td></tr></table>	W.O.#25-885	DRAWN BY: WN	PAGE 1 OF 2
W.O.#25-885	DRAWN BY: WN	PAGE 1 OF 2				

Note: No allowable will be assigned to this completion until all interests have been consolidated or a non-standard unit has been approved by the division.

Surveyors shall use the latest United States government survey or dependent resurvey. Well locations will be in reference to the New Mexico Principal Meridian. If the land is not surveyed, contact the OCD Engineering Bureau. Independent subdivision surveys will not be acceptable.

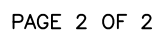

C-102 Submit Electronically Via OCD Permitting	State of New Mexico Energy, Minerals & Natural Resources Department OIL CONSERVATION DIVISION	Revised July 9, 2024	
		Submittal Type:	<input type="checkbox"/> Initial Submittal
			<input type="checkbox"/> Amended Report
		<input type="checkbox"/> As Drilled	

WELL LOCATION INFORMATION

API Number	Pool Code	Pool Name
Property Code	Property Name POWERCASTER FEDERAL COM	Well Number 602H
OGRID No.	Operator Name COG OPERATING LLC	Ground Level Elevation
Surface Owner: <input type="checkbox"/> State <input type="checkbox"/> Fee <input type="checkbox"/> Tribal <input type="checkbox"/> Federal		Mineral Owner: <input type="checkbox"/> State <input type="checkbox"/> Fee <input type="checkbox"/> Tribal <input type="checkbox"/> Federal

Surface Location

UL	Section	Township	Range	Lot	Ft. from N/S	Ft. from E/W	Latitude	Longitude	County
A	20	23-S	34-E		250 FNL	1085 FEL	32.296682°N	103.487069°W	LEA

Bottom Hole Location

UL	Section	Township	Range	Lot	Ft. from N/S	Ft. from E/W	Latitude	Longitude	County
N	29	23-S	34-E		50 FSL	2630 FWL	32.268481°N	103.492088°W	LEA

Dedicated Acres	Infill or Defining Well	Defining Well API	Overlapping Spacing Unit (Y/N)	Consolidation Code
Order Numbers.			Well setbacks are under Common Ownership: <input type="checkbox"/> Yes <input type="checkbox"/> No	

Kick Off Point (KOP)

UL	Section	Township	Range	Lot	Ft. from N/S	Ft. from E/W	Latitude	Longitude	County
A	20	23-S	34-E		250 FNL	1085 FEL	32.296682°N	103.487069°W	LEA

First Take Point (FTP)

UL	Section	Township	Range	Lot	Ft. from N/S	Ft. from E/W	Latitude	Longitude	County
C	20	23-S	34-E		100 FNL	2630 FWL	32.297092°N	103.492138°W	LEA

Last Take Point (LTP)

UL	Section	Township	Range	Lot	Ft. from N/S	Ft. from E/W	Latitude	Longitude	County
N	29	23-S	34-E		100 FSL	2630 FWL	32.268618°N	103.492089°W	LEA

Unitized Area or Area of Uniform Interest	Spacing Unit Type <input type="checkbox"/> Horizontal <input type="checkbox"/> Vertical	Ground Floor Elevation:
---	---	-------------------------

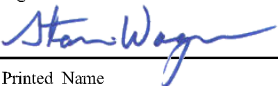
OPERATOR CERTIFICATIONS <i>I hereby certify that the information contained herein is true and complete to the best of my knowledge and belief, and, if the well is a vertical or directional well, that this organization either owns a working interest or unleased mineral interest in the land including the proposed bottom hole location or has a right to drill this well at this location pursuant to a contract with an owner of a working interest or unleased mineral interest, or to a voluntary pooling agreement or a compulsory pooling order heretofore entered by the division.</i> <i>If this well is a horizontal well, I further certify that this organization has received the consent of at least one lessee or owner of a working interest or unleased mineral interest in each tract (in the target pool or formation) in which any part of the well's completed interval will be located or obtained a compulsory pooling order from the division.</i>		SURVEYOR CERTIFICATIONS <i>I hereby certify that the well location shown on this plat was plotted from field notes of actual surveys made by me or under my supervision, and that the same is true and correct to the best of my belief.</i>	
Signature 	Date 7/28/25	Signature and Seal of Professional Surveyor	
Printed Name Stan Wagner	Email Address	Certificate Number 17777	Date of Survey W.O.#25-883 DRAWN BY: WN PAGE 1 OF 2

Note: No allowable will be assigned to this completion until all interests have been consolidated or a non-standard unit has been approved by the division.

This grid represents a standard section. You may superimpose a non-standard section, or larger area, over this grid. Operators must outline the dedicated acreage in a red box, clearly show the well surface location and bottom hole location, if it is directionally drilled, with the dimensions from the section lines in the cardinal directions. If this is a horizontal wellbore show on this plat the location of the First Take Point and Last Take Point, and the point within the Completed interval (other than the First Take Point or Last Take Point) that is closest to any outer boundary of the tract.

Surveyors shall use the latest United States government survey or dependent resurvey. Well locations will be in reference to the New Mexico Principal Meridian. If the land is not surveyed, contact the OCD Engineering Bureau. Independent subdivision surveys will not be acceptable.

NAD 83 NME
SURFACE LOCATION & KOP
Y=472697.2 N
X=802825.3 E
LAT.=32.296682° N
LONG.=103.487069° W

POINT LEGEND	
1	Y=472834.4 N X=801287.6 E
2	Y=467654.4 N X=801316.5 E
3	Y=462376.5 N X=801369.8 E
4	Y=462357.8 N X=798725.2 E
5	Y=464595.3 N X=798700.9 E
6	Y=467632.9 N X=798676.6 E
7	Y=470273.0 N X=798651.5 E
8	Y=472812.3 N X=798626.7 E

NAD 83 NME
BOTTOM
HOLE LOCATION
Y=462425.4 N
X=801354.7 E
LAT.=32.268481° N
LONG.=103.492088° W

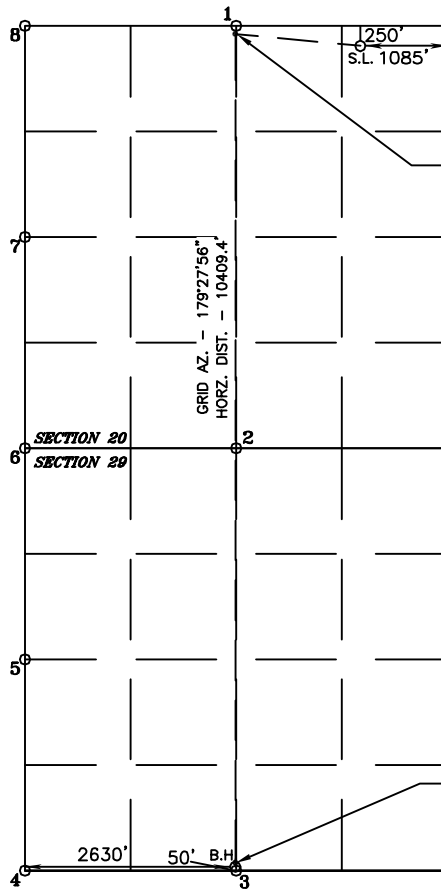

FTP/PPP1
100' FNL & 2630' FWL
Y=472834.3 N
X=801257.6 E
LAT.=32.297092° N
LONG.=103.492138° W
GRID AZ. TO FTP
275°00'02"

LTP
100' FSL & 2630' FWL
Y=462475.4 N
X=801354.2 E
LAT.=32.268618° N
LONG.=103.492089° W

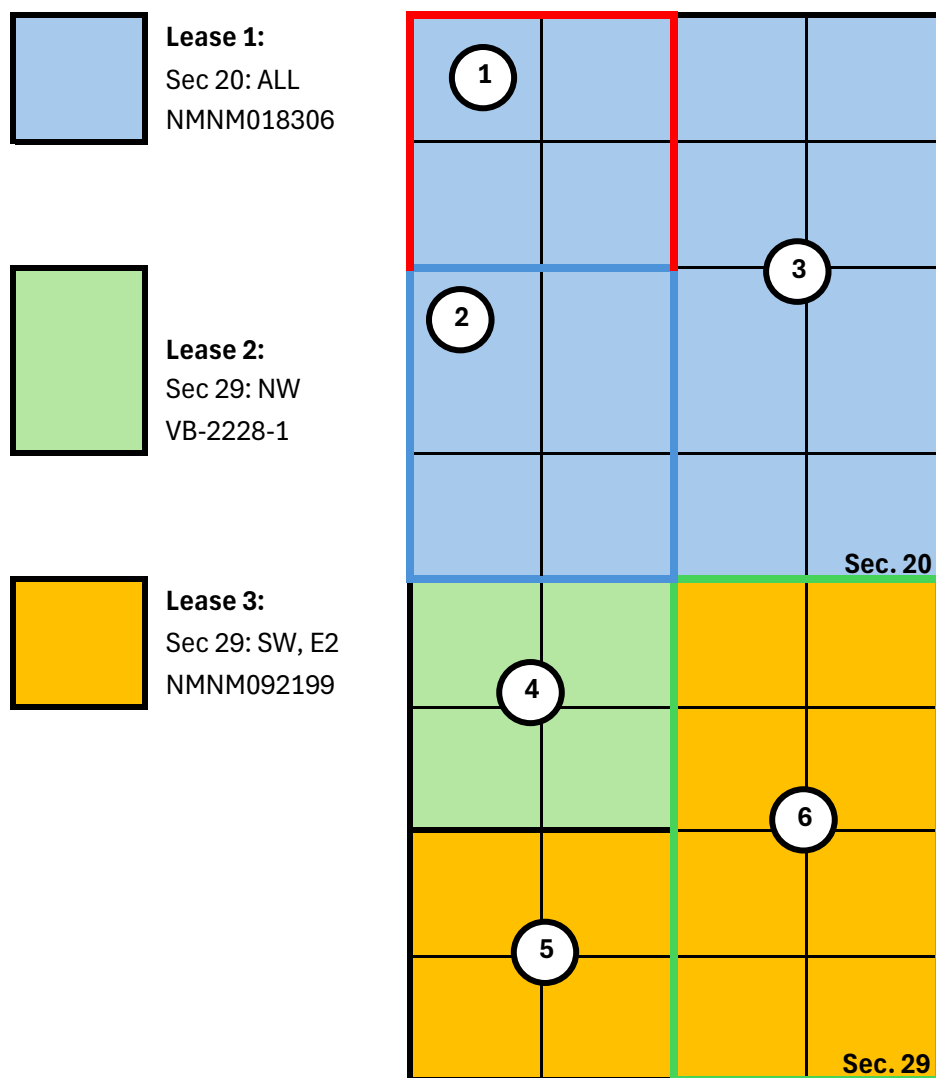
POWERCASTER FED COM: Avalon and 1st Bonespring Ownership

POWERCASTER - Avalon and 1st BS Formation
 1280 ACRES, ALL OF SECTIONS 20 AND 29-T23S-R34E
 Allocation based on SURFACE ACREAGE

Tract 1 - NW4 SEC 20	WI BPO
COG OPERATING LLC	0.10937500
DEVON ENERGY PRODUCTION CO LP	0.01562500
Totals	0.12500000

Tract 2 - SW4 SEC 20	WI BPO
COG OPERATING LLC	0.10937500
DEVON ENERGY PRODUCTION CO LP	0.01562500
Totals	0.12500000

Tract 3 -E2 SEC 20	WI BPO
COG OPERATING LLC	0.25000000
Totals	0.25000000

Tract 4 - NW4 SEC 29	WI BPO
FIRST ROSWELL COMPANY	0.00390625
CHEVRON USA INC	0.01562500
COG OPERATING LLC	0.10546875
Totals	0.12500000

Tract 5 - SW4 SEC 29	WI BPO
FIRST ROSWELL COMPANY	0.00390625
CHEVRON USA INC	0.01562500
COG OPERATING LLC	0.10546875
Totals	0.12500000

Tract 6 - E2 Sec 29	WI BPO
CHEVRON USA INC	0.06250000
FIRST ROSWELL COMPANY	0.01562500
PALOMA PERMIAN ASSETCO LLC	0.06250000
COG OPERATING LLC	0.10937500
	0.25000000

TOTALS	WI BPO
DEVON ENERGY PRODUCTION CO LP	3.12500000%
CHEVRON USA INC	9.37500000%
PALOMA PERMIAN ASSETCO LLC	6.25000000%
FIRST ROSWELL COMPANY	2.34375000%

COG OPERATING LLC	78.90625000%
TOTALS	100.00000000%

POWERCASTER FED COM: 2nd & 3rd Bonespring Ownership

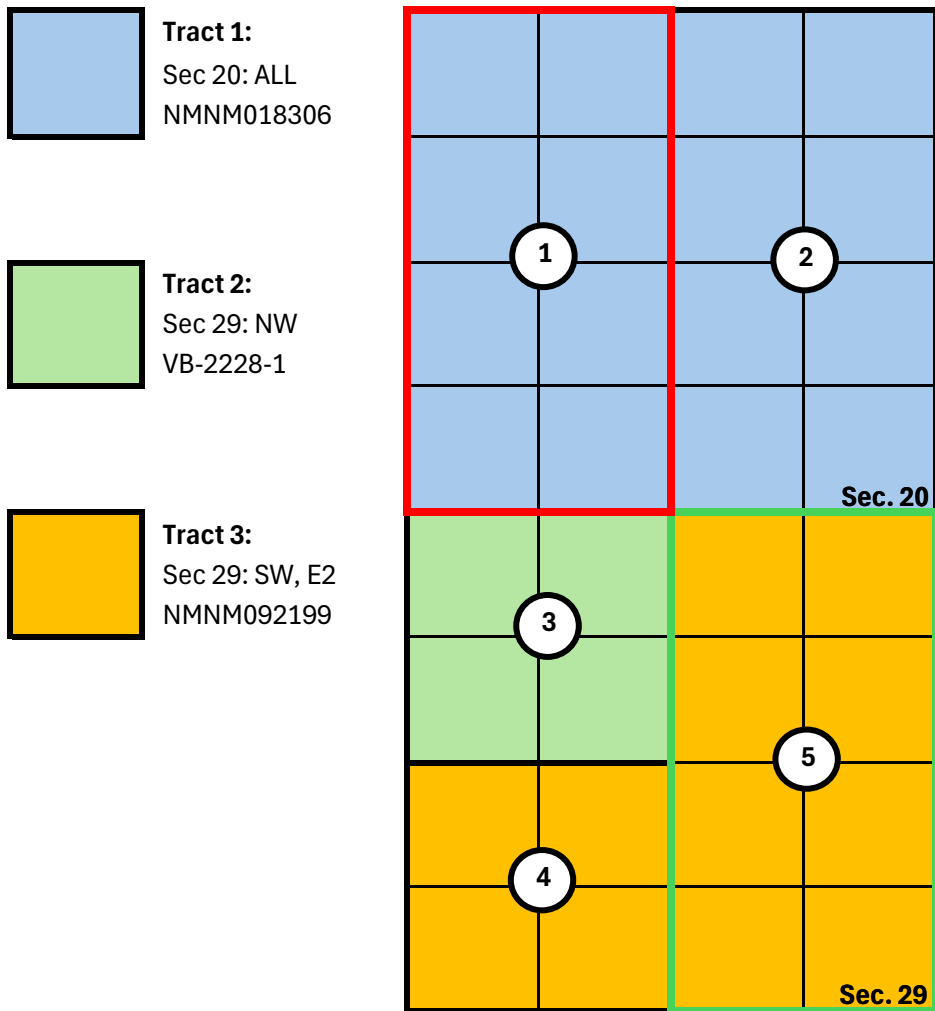

POWERCASTER - 2ND AND 3RD BONESPRING FORMATIONS

1280 ACRES, ALL OF SECTIONS 20 & 29-T23S-R34E

Allocation based on SURFACE ACREAGE

Tract 1 - W2 SEC 20	WI BPO
COG OPERATING LLC	0.21875000
DEVON ENERGY PRODUCTION CO LP	0.03125000
Totals	0.25000000

Tract 2 -E2 SEC 20	WI BPO
COG OPERATING LLC	0.25000000
Totals	0.25000000

Tract 3 - NW4 SEC 29	WI BPO
FIRST ROSWELL COMPANY	0.00390625
CHEVRON USA INC	0.01562500
PALOMA PERMIAN ASSETCO LLC	0.07812500
COG OPERATING LLC	0.02734375
Totals	0.12500000

Tract 4 - SW4 SEC 29	WI BPO
FIRST ROSWELL COMPANY	0.00390625
CHEVRON USA INC	0.01562500
PALOMA PERMIAN ASSETCO LLC	0.07812500
COG OPERATING LLC	0.02734375
Totals	0.12500000

Tract 5 - E2 Sec 29	WI BPO
CHEVRON USA INC	0.06250000
FIRST ROSWELL COMPANY	0.01562500
PALOMA PERMIAN ASSETCO LLC	0.06250000
COG OPERATING LLC	0.10937500
Totals	0.25000000

TOTALS	WI BPO
DEVON ENERGY PRODUCTION CO LP	3.12500000%
CHEVRON USA INC	9.37500000%
PALOMA PERMIAN ASSETCO LLC	21.87500000%
FIRST ROSWELL COMPANY	2.34375000%
COG OPERATING LLC	63.28125000%
TOTALS	100.00000000%

POWERCASTER FED COM: E2 Wolfcamp Ownership

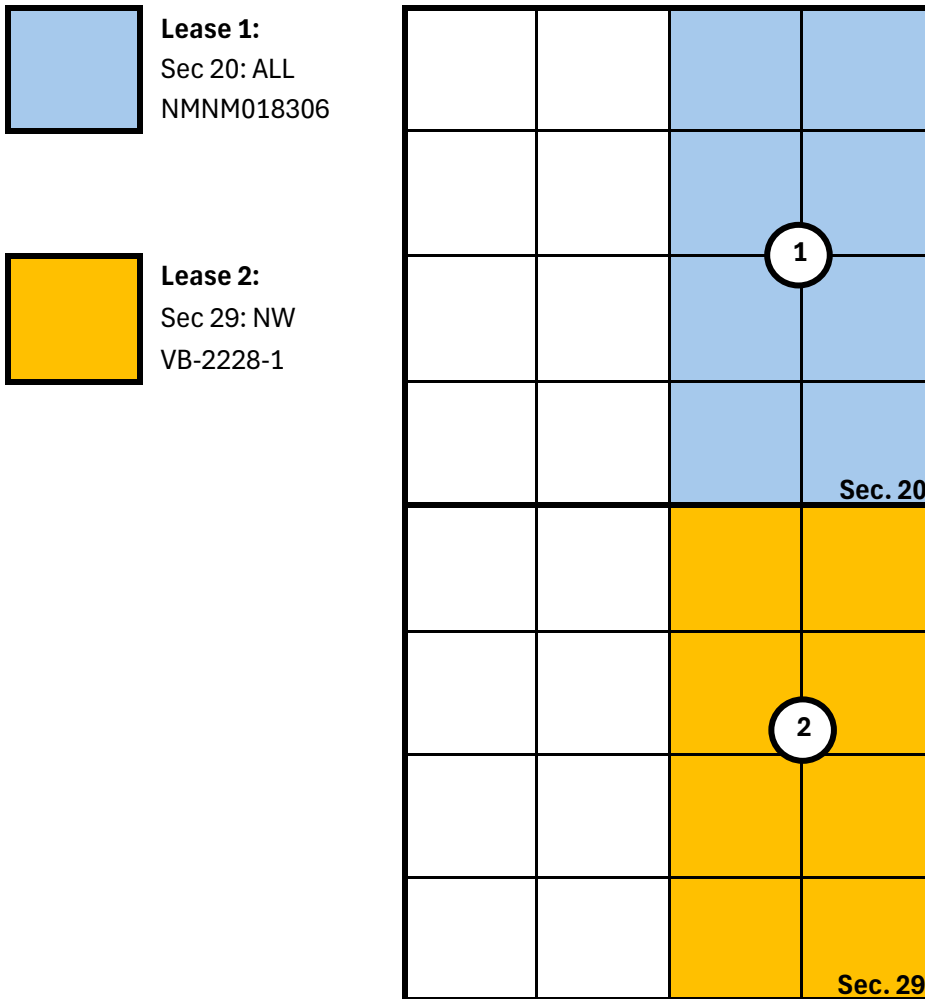

POWERCASTER - WC FORMATION - E2
640 ACRES, E2 OF SECTIONS 20 & 29-T23S-R34E

Tract 1 - E2 SEC 20	WI BPO
COG OPERATING LLC	0.50000000
Totals	0.50000000

Tract 2 - E2 Sec 29	WI BPO
CHEVRON USA INC	0.12500000
FIRST ROSWELL COMPANY	0.03125000
DEVON ENERGY PRODUCT	0.12500000
COG OPERATING LLC	0.21875000
Totals	0.50000000

TOTALS	WI BPO
CHEVRON USA INC	12.50000000%
DEVON ENERGY PRODUCT	12.50000000%
FIRST ROSWELL COMPANY	3.12500000%
COG OPERATING LLC	71.87500000%
TOTALS	100.00000000%

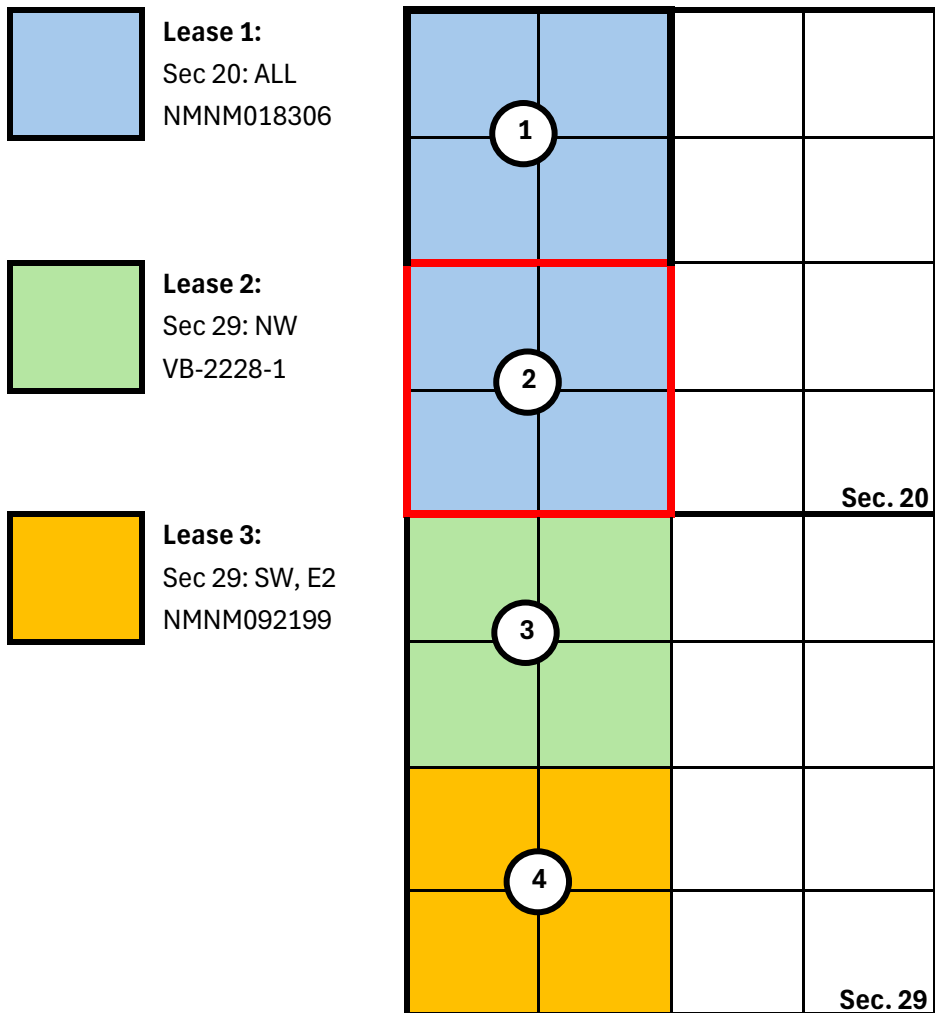
POWERCASTER FED COM: 2nd & 3rd Bonespring Ownership

POWERCASTER WC FORMATION - W2
640 ACRES - W2 OF SECTIONS 20 & 29-T23S-R34E

Tract 1 - NW4 SEC 20	WI BPO
COG OPERATING LLC	0.0625
DEVON ENERGY PRODUCT	0.09375000
CHEVRON USA IN.	0.08906250
PALOMA PERMIAN ASSETC	0.00468750
Totals	0.25000000

Tract 2 - SW4 SEC 20	WI BPO
COG OPERATING LLC	0.06250000
DEVON ENERGY PRODUCT	0.09375000
CHEVRON USA IN.	0.08906250
PALOMA PERMIAN ASSETC	0.00468750
Totals	0.25000000

Tract 3 - NW4 SEC 29	WI BPO
PALOMA PERMIAN ASSETC	0.25000000
Totals	0.25000000

Tract 4 - SW4 SEC 29	WI BPO
FIRST ROSWELL COMPANY	0.01562500
CHEVRON USA INC	0.06250000
DEVON ENERGY PRODUCT	0.06250000
COG OPERATING LLC	0.10937500
Totals	0.25000000

TOTALS	WI BPO
DEVON ENERGY PRODUCT	25.00000000%
CHEVRON USA INC	24.06250000%
PALOMA PERMIAN ASSETC	25.93750000%
FIRST ROSWELL COMPANY	1.56250000%
COG OPERATING LLC	23.43750000%
TOTALS	100.00000000%



ConocoPhillips
600 W. Illinois Ave.
Midland, TX 79701
www.conocophillips.com

5/6/2025

Via FedEx

PALOMA PERMIAN ASSETCO LLC
1100 Louisiana St, Ste 5100
Houston, TX 77002

Re: **Well Proposal**
POWERCASTER FED COM
Township 23 South, Range 34 East, N.M.P.M.
Section 20: ALL
Section 29: ALL
Lea County, New Mexico
1280.00 Acres
Avalon, Bone Spring and Wolfcamp Formations

To Whom It May Concern:

COG Operating LLC, a wholly owned subsidiary of ConocoPhillips, as Operator, ("COG") hereby proposes the drilling of the following horizontal wells with productive laterals located in Section 20, T23S-R34E and Section 29, T23S-R34E Lea County, New Mexico (collectively, the "Operation"). The surface and bottom hole locations, and first and last take points, are to be located as follows:

Well Name and Number	PowerCaster Fed Com 301H
TVD	8950 (Avalon)
Surface Hole Location	A legal location in N2N2 of Section 20, 23S-34E
First Take Point	100' FNL, 1000' FEL of Section 20, 23S-34E
Last Take Point	100' FSL, 1000' FEL of Section 29, 23S-34E
Bottom Hole Location	50' FSL, 1000' FEL of Section 29, 23S-34E
Dedicated Hz Spacing Unit	All of Sections 20 and 29-T23S-R34E comprising 1280 acres
Estimated Well Cost	\$9,706,438.67, see attached Authority for Expenditure ("AFE")

Well Name and Number	PowerCaster Fed Com 302H
TVD	8950 (Avalon)
Surface Hole Location	A legal location in N2N2 of Section 20, 23S-34E
First Take Point	100' FNL, 2640' FEL of Section 20, 23S-34E
Last Take Point	100' FSL, 2640' FEL of Section 29, 23S-34E
Bottom Hole Location	50' FSL, 2640' FEL of Section 29, 23S-34E
Dedicated Hz Spacing Unit	All of Sections 20 and 29-T23S-R34E comprising 1280 acres
Estimated Well Cost	\$9,706,438.67, see attached Authority for Expenditure ("AFE")

BEFORE THE OIL CONSERVATION DIVISION
Santa Fe, New Mexico
Exhibit No. A-4
Submitted by: COG Operating LLC
Hearing Date: July 29, 2025
Case No. 25441

Well Name and Number	PowerCaster Fed Com 303H
TVD	8950 (Avalon)
Surface Hole Location	A legal location in N2N2 of Section 20, 23S-34E
First Take Point	100' FNL, 4280' FEL of Section 20, 23S-34E
Last Take Point	100' FSL, 4280' FEL of Section 29, 23S-34E
Bottom Hole Location	50' FSL, 4280' FEL of Section 29, 23S-34E
Dedicated Hz Spacing Unit	All of Sections 20 and 29-T23S-R34E comprising 1280 acres
Estimated Well Cost	\$9,706,438.67, see attached Authority for Expenditure (“AFE”)

Well Name and Number	PowerCaster Fed Com 401H
TVD	9720 (1st Bone Spring Sand)
Surface Hole Location	A legal location in N2N2 of Section 20, 23S-34E
First Take Point	100' FNL, 330' FEL of Section 20, 23S-34E
Last Take Point	100' FSL, 330' FEL of Section 29, 23S-34E
Bottom Hole Location	50' FSL, 330' FEL of Section 29, 23S-34E
Dedicated Hz Spacing Unit	All of Sections 20 and 29-T23S-R34E comprising 1280 acres
Estimated Well Cost	\$9,706,438.67, see attached Authority for Expenditure (“AFE”)

Well Name and Number	PowerCaster Fed Com 402H
TVD	10050 (1st Bone Spring Shale)
Surface Hole Location	A legal location in N2N2 of Section 20, 23S-34E
First Take Point	100' FNL, 1650' FEL of Section 20, 23S-34E
Last Take Point	100' FSL, 1650' FEL of Section 29, 23S-34E
Bottom Hole Location	50' FSL, 1650' FEL of Section 29, 23S-34E
Dedicated Hz Spacing Unit	All of Sections 20 and 29-T23S-R34E comprising 1280 acres
Estimated Well Cost	\$9,706,438.67, see attached Authority for Expenditure (“AFE”)

Well Name and Number	PowerCaster Fed Com 403H
TVD	9720 (1st Bone Spring Sand)
Surface Hole Location	A legal location in Section 20, 23S-34E
First Take Point	100' FNL, 2970' FEL of Section 20, 23S-34E
Last Take Point	100' FSL, 2970' FEL of Section 29, 23S-34E
Bottom Hole Location	50' FSL, 2970' FEL of Section 29, 23S-34E
Dedicated Hz Spacing Unit	All of Sections 20 and 29-T23S-R34E comprising 1280 acres
Estimated Well Cost	\$9,706,438.67, see attached Authority for Expenditure (“AFE”)

Well Name and Number	PowerCaster Fed Com 404H
TVD	9720 (1st Bone Spring Sand)
Surface Hole Location	A legal location in N2N2 of Section 20, 23S-34E
First Take Point	100' FNL, 2970' FEL of Section 20, 23S-34E
Last Take Point	100' FSL, 2970' FEL of Section 29, 23S-34E
Bottom Hole Location	50' FSL, 2970' FEL of Section 29, 23S-34E
Dedicated Hz Spacing Unit	All of Sections 20 and 29-T23S-R34E comprising 1280 acres
Estimated Well Cost	\$9,706,438.67, see attached Authority for Expenditure ("AFE")

Well Name and Number	PowerCaster Fed Com 501H
TVD	10050 (1st Bone Spring Shale)
Surface Hole Location	A legal location in N2N2 of Section 20, 23S-34E
First Take Point	100' FNL, 4290' FEL of Section 20, 23S-34E
Last Take Point	100' FSL, 4290' FEL of Section 29, 23S-34E
Bottom Hole Location	50' FSL, 4290' FEL of Section 29, 23S-34E
Dedicated Hz Spacing Unit	All of Sections 20 and 29-T23S-R34E comprising 1280 acres
Estimated Well Cost	\$9,706,438.67, see attached Authority for Expenditure ("AFE")

Well Name and Number	PowerCaster Fed Com 502H
TVD	10500 (2nd Bone Spring Sand)
Surface Hole Location	A legal location in N2N2 of Section 20, 23S-34E
First Take Point	100' FNL, 3960' FEL of Section 20, 23S-34E
Last Take Point	100' FSL, 3960' FEL of Section 29, 23S-34E
Bottom Hole Location	50' FSL, 3960' FEL of Section 29, 23S-34E
Dedicated Hz Spacing Unit	All of Sections 20 and 29-T23S-R34E comprising 1280 acres
Estimated Well Cost	\$9,706,438.67, see attached Authority for Expenditure ("AFE")

Well Name and Number	PowerCaster Fed Com 601H
TVD	11570 (Wolfcamp Sand)
Surface Hole Location	A legal location in N2N2 of Section 20, 23S-34E
First Take Point	100' FNL, 1320' FEL of Section 20, 23S-34E
Last Take Point	100' FSL, 1320' FEL of Section 29, 23S-34E
Bottom Hole Location	50' FSL, 1320' FEL of Section 29, 23S-34E
Dedicated Hz Spacing Unit	E2 of Sections 20 and 29-T23S-R34E comprising 640 acres
Estimated Well Cost	\$10,256,762, see attached Authority for Expenditure ("AFE")

Well Name and Number	PowerCaster Fed Com 602H
TVD	11450 (3rd Bone Spring Sand)
Surface Hole Location	A legal location in N2N2 of Section 20, 23S-34E
First Take Point	100' FNL, 2640' FEL of Section 20, 23S-34E
Last Take Point	100' FSL, 2640' FEL of Section 29, 23S-34E
Bottom Hole Location	50' FSL, 2640' FEL of Section 29, 23S-34E
Dedicated Hz Spacing Unit	All of Sections 20 and 29-T23S-R34E comprising 1280 acres
Estimated Well Cost	\$10,256,762, see attached Authority for Expenditure ("AFE")

Well Name and Number	PowerCaster Fed Com 603H
TVD	11570 (Wolfcamp Sand)
Surface Hole Location	A legal location in N2N2 of Section 20, 23S-34E
First Take Point	100' FNL, 3960' FEL of Section 20, 23S-34E
Last Take Point	100' FSL, 3960' FEL of Section 29, 23S-34E
Bottom Hole Location	50' FSL, 3960' FEL of Section 29, 23S-34E
Dedicated Hz Spacing Unit	W2 of Sections 20 and 29-T23S-R34E comprising 640 acres
Estimated Well Cost	\$10,256,762, see attached Authority for Expenditure ("AFE")

*Approximate location

COG is proposing these wells under the terms of a newly proposed Operating Agreement which is included for your review and approval.

If you do not wish to participate in the Operation, COG would be open to discussing terms for the acquisition of your interest by COG, either by Assignment or Term Assignment, with an Overriding Royalty Interest reserved unto assignor of the positive difference (if any) between existing burdens of record and 25%.

In the interest of time, if we do not receive an indication of your intent to participate in the Operation within 30 days of the date of this letter, COG will apply to the New Mexico Oil Conservation Division for compulsory pooling of your interest into the horizontal spacing units set out above for the proposed wells.

Please indicate your elections in the spaces provided below, sign, and return this letter, along with a signed copy of the enclosed AFEs and a copy of your geologic requirements, to my attention at the letterhead address or by email.

If you have any questions, please do not hesitate to contact me at 432-685-4397.

Sincerely,
COG Operating LLC

MF Monju

Michael F. Monju, CPL
Staff Land Negotiator
(432) 685-4397
Michael.F.Monju@conocophillips.com

Proposed Well Elections

PALOMA PERMIAN ASSETCO LLC hereby elects to:

PowerCaster Fed Com 301H ("301H Well")

_____ Participate in the drilling, completion, and equipping of the 301H well

_____ **NOT** participate in the drilling, completion, and equipping of the 301H well

PowerCaster Fed Com 302H ("302H Well")

_____ Participate in the drilling, completion, and equipping of the 302H well

_____ **NOT** participate in the drilling, completion, and equipping of the 302H well

PowerCaster Fed Com 303H ("303H Well")

_____ Participate in the drilling, completion, and equipping of the 303H well

_____ **NOT** participate in the drilling, completion, and equipping of the 303H well

PowerCaster Fed Com 401H ("401H Well")

_____ Participate in the drilling, completion, and equipping of the 401H well

_____ **NOT** participate in the drilling, completion, and equipping of the 401H well

PowerCaster Fed Com 402H ("402H Well")

_____ Participate in the drilling, completion, and equipping of the 402H well

_____ **NOT** participate in the drilling, completion, and equipping of the 402H well

PowerCaster Fed Com 403H ("403H Well")

_____ Participate in the drilling, completion, and equipping of the 403H well

_____ **NOT** participate in the drilling, completion, and equipping of the 403H well

PowerCaster Fed Com 404H ("404H Well")

_____ Participate in the drilling, completion, and equipping of the 404H well

_____ **NOT** participate in the drilling, completion, and equipping of the 404H well

PowerCaster Fed Com 501H ("501H Well")

_____ Participate in the drilling, completion, and equipping of the 501H well

_____ **NOT** participate in the drilling, completion, and equipping of the 501H well

PowerCaster Fed Com 502H ("502H Well")

_____ Participate in the drilling, completion, and equipping of the 502H well

_____ **NOT** participate in the drilling, completion, and equipping of the 502H well

PowerCaster Fed Com 601H ("601H Well")

_____ Participate in the drilling, completion, and equipping of the 601H well

_____ **NOT** participate in the drilling, completion, and equipping of the 601H well

PowerCaster Fed Com 602H ("602H Well")

_____ Participate in the drilling, completion, and equipping of the 602H well

_____ **NOT** participate in the drilling, completion, and equipping of the 602H well

PowerCaster Fed Com 603H ("603H Well")

_____ Participate in the drilling, completion, and equipping of the 603H well

_____ **NOT** participate in the drilling, completion, and equipping of the 603H well

PALOMA PERMIAN ASSETCO LLC

By: _____

Name: _____

Title: _____

Date: _____



Project Cost Summary

This document contains proposed and estimated project cost information which is proprietary and confidential to ConocoPhillips.

Well Name

POWERCASTER FED COM 301H

Job Type

Drill and Complete

State

New Mexico - 30

County/Parish

Lea - 025

Authorization Number

Cost Feature Group	Grand Total			
	Drilling	Completions	Pumping Equipment	Facilities
A000: CASING & TUBING	\$706,000.00			\$150,000.00
B000: WELLHEAD, XMAS TREE, AND ASST EQUIPT	\$65,000.00	\$60,000.00		\$100,000.00
C000: COMPLETION EQUIPMENT & OTHER			\$763,430.00	\$243,000.00
D000: LOCATION (WELLSITE RELATED)	\$82,000.00	\$12,500.00	\$36,071.00	\$15,000.00
E000: RIGS & RIG RELATED	\$893,666.67			\$19,000.00
F000: DRILLING & COMPLETION UTILITIES (ALL)	\$234,000.00	\$667,000.00		
G000: FLUID AND CHEMICALS SERVICES	\$263,200.00	\$42,000.00		
H000: DIRECTIONAL DRILLING / MWD / LWD	\$262,000.00			
J000: CEMENTING MATERIALS, SERVICES, AND CSG ACCS	\$304,000.00			
K000: FORMATION EVALUATION	\$36,000.00			
M000: COMPLETION & TESTING		\$15,000.00		
N000: FORMATION STIMULATION & TREATING		\$1,034,000.00		
O000: CERTIFICATION, INSPECT, CONTROL & TEST				
P000: TRANSPORTATION SUPPLY & DISPOSAL	\$93,000.00	\$45,000.00		\$20,000.00
Q000: DRLG TOOLS & EQPT RNTAL W/WO OPR	\$288,000.00	\$586,000.00		\$12,000.00
R000: BITS & MILLS	\$86,000.00	\$4,000.00		
S000: SPECIAL SERVICES	\$137,000.00	\$295,000.00		\$17,000.00
T000: MISCELLANEOUS	\$317,500.00	\$120,000.00	\$70,857.00	\$36,000.00
U000: PERFORATING & SLICKLINE SERVICES		\$315,000.00		\$9,000.00
V000: ENG & CONSTRUCTION(E&C), CONSLT, R&D			\$22,857.00	\$0.00
W000: GENERAL FEES	\$42,500.00	\$5,000.00		
X000: CONOCOPHILLIPS LABOR & OVERHEAD	\$6,000.00	\$22,000.00	\$22,857.00	\$8,000.00
Y000: TOTALS, CONTINGENCY & MISCELLANEOUS		\$1,123,000.00		
Grand Total	\$3,815,866.67	\$4,345,500.00	\$916,072.00	\$629,000.00

Grand Total (\$)9,706,438.67

Approved By:

Date

Last Edited By

Achilders

Approved By

Achilders

Last Edited Date

May 05, 2025

Approved Date

May 5, 2025

Project Cost Summary

This document contains proposed and estimated project cost information which is proprietary and confidential to ConocoPhillips.



Well Name

POWERCASTER FED COM 302H

Job Type

Drill and Complete

State

New Mexico - 30

County/Parish

Lea - 025

Authorization Number

Cost Feature Group	Grand Total			
	Drilling	Completions	Pumping Equipment	Facilities
A000: CASING & TUBING	\$706,000.00			\$150,000.00
B000: WELLHEAD, XMAS TREE, AND ASST EQUIPT	\$65,000.00	\$60,000.00		\$100,000.00
C000: COMPLETION EQUIPMENT & OTHER			\$763,430.00	\$243,000.00
D000: LOCATION (WELLSITE RELATED)	\$82,000.00	\$12,500.00	\$36,071.00	\$15,000.00
E000: RIGS & RIG RELATED	\$893,666.67			\$19,000.00
F000: DRILLING & COMPLETION UTILITIES (ALL)	\$234,000.00	\$667,000.00		
G000: FLUID AND CHEMICALS SERVICES	\$263,200.00	\$42,000.00		
H000: DIRECTIONAL DRILLING / MWD / LWD	\$262,000.00			
J000: CEMENTING MATERIALS, SERVICES, AND CSG ACCS	\$304,000.00			
K000: FORMATION EVALUATION	\$36,000.00			
M000: COMPLETION & TESTING		\$15,000.00		
N000: FORMATION STIMULATION & TREATING		\$1,034,000.00		
O000: CERTIFICATION, INSPECT, CONTROL & TEST				
P000: TRANSPORTATION SUPPLY & DISPOSAL	\$93,000.00	\$45,000.00		\$20,000.00
Q000: DRLG TOOLS & EQPT RNTAL W/WO OPR	\$288,000.00	\$586,000.00		\$12,000.00
R000: BITS & MILLS	\$86,000.00	\$4,000.00		
S000: SPECIAL SERVICES	\$137,000.00	\$295,000.00		\$17,000.00
T000: MISCELLANEOUS	\$317,500.00	\$120,000.00	\$70,857.00	\$36,000.00
U000: PERFORATING & SLICKLINE SERVICES		\$315,000.00		\$9,000.00
V000: ENG & CONSTRUCTION(E&C), CONSLT, R&D			\$22,857.00	\$0.00
W000: GENERAL FEES	\$42,500.00	\$5,000.00		
X000: CONOCOPHILLIPS LABOR & OVERHEAD	\$6,000.00	\$22,000.00	\$22,857.00	\$8,000.00
Y000: TOTALS, CONTINGENCY & MISCELLANEOUS		\$1,123,000.00		
Grand Total	\$3,815,866.67	\$4,345,500.00	\$916,072.00	\$629,000.00

Grand Total (\$) 9,706,438.67

Approved By:

Date

Last Edited By

Achilders

Approved By

Achilders

Last Edited Date

May 05, 2025

Approved Date

May 5, 2025

Project Cost Summary



This document contains proposed and estimated project cost information which is proprietary and confidential to ConocoPhillips.

Well Name

POWERCASTER FED COM 303H

Job Type

Drill and Complete

State

New Mexico - 30

County/Parish

Lea - 025

Authorization Number

Cost Feature Group	Grand Total			
	Drilling	Completions	Pumping Equipment	Facilities
A000: CASING & TUBING	\$706,000.00			\$150,000.00
B000: WELLHEAD, XMAS TREE, AND ASST EQUIPT	\$65,000.00	\$60,000.00		\$100,000.00
C000: COMPLETION EQUIPMENT & OTHER			\$763,430.00	\$243,000.00
D000: LOCATION (WELLSITE RELATED)	\$82,000.00	\$12,500.00	\$36,071.00	\$15,000.00
E000: RIGS & RIG RELATED	\$893,666.67			\$19,000.00
F000: DRILLING & COMPLETION UTILITIES (ALL)	\$234,000.00	\$667,000.00		
G000: FLUID AND CHEMICALS SERVICES	\$263,200.00	\$42,000.00		
H000: DIRECTIONAL DRILLING / MWD / LWD	\$262,000.00			
J000: CEMENTING MATERIALS, SERVICES, AND CSG ACCS	\$304,000.00			
K000: FORMATION EVALUATION	\$36,000.00			
M000: COMPLETION & TESTING		\$15,000.00		
N000: FORMATION STIMULATION & TREATING		\$1,034,000.00		
O000: CERTIFICATION, INSPECT, CONTROL & TEST				
P000: TRANSPORTATION SUPPLY & DISPOSAL	\$93,000.00	\$45,000.00		\$20,000.00
Q000: DRLG TOOLS & EQPT RNTAL W/WO OPR	\$288,000.00	\$586,000.00		\$12,000.00
R000: BITS & MILLS	\$86,000.00	\$4,000.00		
S000: SPECIAL SERVICES	\$137,000.00	\$295,000.00		\$17,000.00
T000: MISCELLANEOUS	\$317,500.00	\$120,000.00	\$70,857.00	\$36,000.00
U000: PERFORATING & SLICKLINE SERVICES		\$315,000.00		\$9,000.00
V000: ENG & CONSTRUCTION(E&C), CONSLT, R&D			\$22,857.00	\$0.00
W000: GENERAL FEES	\$42,500.00	\$5,000.00		
X000: CONOCOPHILLIPS LABOR & OVERHEAD	\$6,000.00	\$22,000.00	\$22,857.00	\$8,000.00
Y000: TOTALS, CONTINGENCY & MISCELLANEOUS		\$1,123,000.00		
Grand Total	\$3,815,866.67	\$4,345,500.00	\$916,072.00	\$629,000.00

Grand Total (\$)9,706,438.67

Approved By:

Date

Last Edited By

Achilders

Approved By

Achilders

Last Edited Date

May 05, 2025

Approved Date

May 5, 2025

Project Cost Summary



This document contains proposed and estimated project cost information which is proprietary and confidential to ConocoPhillips.

Well Name

POWERCASTER FED COM 401H

Job Type

Drill and Complete

State

New Mexico - 30

County/Parish

Lea - 025

Authorization Number

Cost Feature Group	Grand Total			
	Drilling	Completions	Pumping Equipment	Facilities
A000: CASING & TUBING	\$706,000.00			\$150,000.00
B000: WELLHEAD, XMAS TREE, AND ASST EQUIPT	\$65,000.00	\$60,000.00		\$100,000.00
C000: COMPLETION EQUIPMENT & OTHER			\$763,430.00	\$243,000.00
D000: LOCATION (WELLSITE RELATED)	\$82,000.00	\$12,500.00	\$36,071.00	\$15,000.00
E000: RIGS & RIG RELATED	\$893,666.67			\$19,000.00
F000: DRILLING & COMPLETION UTILITIES (ALL)	\$234,000.00	\$667,000.00		
G000: FLUID AND CHEMICALS SERVICES	\$263,200.00	\$42,000.00		
H000: DIRECTIONAL DRILLING / MWD / LWD	\$262,000.00			
J000: CEMENTING MATERIALS, SERVICES, AND CSG ACCS	\$304,000.00			
K000: FORMATION EVALUATION	\$36,000.00			
M000: COMPLETION & TESTING		\$15,000.00		
N000: FORMATION STIMULATION & TREATING		\$1,034,000.00		
O000: CERTIFICATION, INSPECT, CONTROL & TEST				
P000: TRANSPORTATION SUPPLY & DISPOSAL	\$93,000.00	\$45,000.00		\$20,000.00
Q000: DRLG TOOLS & EQPT RNTAL W/WO OPR	\$288,000.00	\$586,000.00		\$12,000.00
R000: BITS & MILLS	\$86,000.00	\$4,000.00		
S000: SPECIAL SERVICES	\$137,000.00	\$295,000.00		\$17,000.00
T000: MISCELLANEOUS	\$317,500.00	\$120,000.00	\$70,857.00	\$36,000.00
U000: PERFORATING & SLICKLINE SERVICES		\$315,000.00		\$9,000.00
V000: ENG & CONSTRUCTION(E&C), CONSLT, R&D			\$22,857.00	\$0.00
W000: GENERAL FEES	\$42,500.00	\$5,000.00		
X000: CONOCOPHILLIPS LABOR & OVERHEAD	\$6,000.00	\$22,000.00	\$22,857.00	\$8,000.00
Y000: TOTALS, CONTINGENCY & MISCELLANEOUS		\$1,123,000.00		
Grand Total	\$3,815,866.67	\$4,345,500.00	\$916,072.00	\$629,000.00

Grand Total (\$)9,706,438.67

Approved By:

Date

Last Edited By

Achilders

Approved By

Achilders

Last Edited Date

May 05, 2025

Approved Date

May 5, 2025



Project Cost Summary

This document contains proposed and estimated project cost information which is proprietary and confidential to ConocoPhillips.

Well Name

POWERCASTER FED COM 402H

Job Type

Drill and Complete

State

New Mexico - 30

County/Parish

Lea - 025

Authorization Number

Cost Feature Group	Grand Total			
	Drilling	Completions	Pumping Equipment	Facilities
A000: CASING & TUBING	\$706,000.00			\$150,000.00
B000: WELLHEAD, XMAS TREE, AND ASST EQUIPT	\$65,000.00	\$60,000.00		\$100,000.00
C000: COMPLETION EQUIPMENT & OTHER			\$763,430.00	\$243,000.00
D000: LOCATION (WELLSITE RELATED)	\$82,000.00	\$12,500.00	\$36,071.00	\$15,000.00
E000: RIGS & RIG RELATED	\$893,666.67			\$19,000.00
F000: DRILLING & COMPLETION UTILITIES (ALL)	\$234,000.00	\$667,000.00		
G000: FLUID AND CHEMICALS SERVICES	\$263,200.00	\$42,000.00		
H000: DIRECTIONAL DRILLING / MWD / LWD	\$262,000.00			
J000: CEMENTING MATERIALS, SERVICES, AND CSG ACCS	\$304,000.00			
K000: FORMATION EVALUATION	\$36,000.00			
M000: COMPLETION & TESTING		\$15,000.00		
N000: FORMATION STIMULATION & TREATING		\$1,034,000.00		
O000: CERTIFICATION, INSPECT, CONTROL & TEST				
P000: TRANSPORTATION SUPPLY & DISPOSAL	\$93,000.00	\$45,000.00		\$20,000.00
Q000: DRLG TOOLS & EQPT RNTAL W/WO OPR	\$288,000.00	\$586,000.00		\$12,000.00
R000: BITS & MILLS	\$86,000.00	\$4,000.00		
S000: SPECIAL SERVICES	\$137,000.00	\$295,000.00		\$17,000.00
T000: MISCELLANEOUS	\$317,500.00	\$120,000.00	\$70,857.00	\$36,000.00
U000: PERFORATING & SLICKLINE SERVICES		\$315,000.00		\$9,000.00
V000: ENG & CONSTRUCTION(E&C), CONSLT, R&D			\$22,857.00	\$0.00
W000: GENERAL FEES	\$42,500.00	\$5,000.00		
X000: CONOCOPHILLIPS LABOR & OVERHEAD	\$6,000.00	\$22,000.00	\$22,857.00	\$8,000.00
Y000: TOTALS, CONTINGENCY & MISCELLANEOUS		\$1,123,000.00		
Grand Total	\$3,815,866.67	\$4,345,500.00	\$916,072.00	\$629,000.00

Grand Total (\$)9,706,438.67

Approved By:

Date

Last Edited By

Achilders

Approved By

Achilders

Last Edited Date

May 05, 2025

Approved Date

May 5, 2025



Project Cost Summary

This document contains proposed and estimated project cost information which is proprietary and confidential to ConocoPhillips.

Well Name

POWERCASTER FED COM 403H

Job Type

Drill and Complete

State

New Mexico - 30

County/Parish

Lea - 025

Authorization Number

Cost Feature Group	Grand Total			
	Drilling	Completions	Pumping Equipment	Facilities
A000: CASING & TUBING	\$706,000.00			\$150,000.00
B000: WELLHEAD, XMAS TREE, AND ASST EQUIPT	\$65,000.00	\$60,000.00		\$100,000.00
C000: COMPLETION EQUIPMENT & OTHER			\$763,430.00	\$243,000.00
D000: LOCATION (WELLSITE RELATED)	\$82,000.00	\$12,500.00	\$36,071.00	\$15,000.00
E000: RIGS & RIG RELATED	\$893,666.67			\$19,000.00
F000: DRILLING & COMPLETION UTILITIES (ALL)	\$234,000.00	\$667,000.00		
G000: FLUID AND CHEMICALS SERVICES	\$263,200.00	\$42,000.00		
H000: DIRECTIONAL DRILLING / MWD / LWD	\$262,000.00			
J000: CEMENTING MATERIALS, SERVICES, AND CSG ACCS	\$304,000.00			
K000: FORMATION EVALUATION	\$36,000.00			
M000: COMPLETION & TESTING		\$15,000.00		
N000: FORMATION STIMULATION & TREATING		\$1,034,000.00		
O000: CERTIFICATION, INSPECT, CONTROL & TEST				
P000: TRANSPORTATION SUPPLY & DISPOSAL	\$93,000.00	\$45,000.00		\$20,000.00
Q000: DRLG TOOLS & EQPT RNTAL W/WO OPR	\$288,000.00	\$586,000.00		\$12,000.00
R000: BITS & MILLS	\$86,000.00	\$4,000.00		
S000: SPECIAL SERVICES	\$137,000.00	\$295,000.00		\$17,000.00
T000: MISCELLANEOUS	\$317,500.00	\$120,000.00	\$70,857.00	\$36,000.00
U000: PERFORATING & SLICKLINE SERVICES		\$315,000.00		\$9,000.00
V000: ENG & CONSTRUCTION(E&C), CONSLT, R&D			\$22,857.00	\$0.00
W000: GENERAL FEES	\$42,500.00	\$5,000.00		
X000: CONOCOPHILLIPS LABOR & OVERHEAD	\$6,000.00	\$22,000.00	\$22,857.00	\$8,000.00
Y000: TOTALS, CONTINGENCY & MISCELLANEOUS		\$1,123,000.00		
Grand Total	\$3,815,866.67	\$4,345,500.00	\$916,072.00	\$629,000.00

Grand Total (\$)9,706,438.67

Approved By:

Date

Last Edited By

Achilders

Approved By

Achilders

Last Edited Date

May 05, 2025

Approved Date

May 5, 2025

Project Cost Summary

This document contains proposed and estimated project cost information which is proprietary and confidential to ConocoPhillips.



Well Name

POWERCASTER FED COM 404H

Job Type

Drill and Complete

State

New Mexico - 30

County/Parish

Lea - 025

Authorization Number

Cost Feature Group	Grand Total			
	Drilling	Completions	Pumping Equipment	Facilities
A000: CASING & TUBING	\$706,000.00			\$150,000.00
B000: WELLHEAD, XMAS TREE, AND ASST EQUIPT	\$65,000.00	\$60,000.00		\$100,000.00
C000: COMPLETION EQUIPMENT & OTHER			\$763,430.00	\$243,000.00
D000: LOCATION (WELLSITE RELATED)	\$82,000.00	\$12,500.00	\$36,071.00	\$15,000.00
E000: RIGS & RIG RELATED	\$893,666.67			\$19,000.00
F000: DRILLING & COMPLETION UTILITIES (ALL)	\$234,000.00	\$667,000.00		
G000: FLUID AND CHEMICALS SERVICES	\$263,200.00	\$42,000.00		
H000: DIRECTIONAL DRILLING / MWD / LWD	\$262,000.00			
J000: CEMENTING MATERIALS, SERVICES, AND CSG ACCS	\$304,000.00			
K000: FORMATION EVALUATION	\$36,000.00			
M000: COMPLETION & TESTING		\$15,000.00		
N000: FORMATION STIMULATION & TREATING		\$1,034,000.00		
O000: CERTIFICATION, INSPECT, CONTROL & TEST				
P000: TRANSPORTATION SUPPLY & DISPOSAL	\$93,000.00	\$45,000.00		\$20,000.00
Q000: DRLG TOOLS & EQPT RNTAL W/WO OPR	\$288,000.00	\$586,000.00		\$12,000.00
R000: BITS & MILLS	\$86,000.00	\$4,000.00		
S000: SPECIAL SERVICES	\$137,000.00	\$295,000.00		\$17,000.00
T000: MISCELLANEOUS	\$317,500.00	\$120,000.00	\$70,857.00	\$36,000.00
U000: PERFORATING & SLICKLINE SERVICES		\$315,000.00		\$9,000.00
V000: ENG & CONSTRUCTION(E&C), CONSLT, R&D			\$22,857.00	\$0.00
W000: GENERAL FEES	\$42,500.00	\$5,000.00		
X000: CONOCOPHILLIPS LABOR & OVERHEAD	\$6,000.00	\$22,000.00	\$22,857.00	\$8,000.00
Y000: TOTALS, CONTINGENCY & MISCELLANEOUS		\$1,123,000.00		
Grand Total	\$3,815,866.67	\$4,345,500.00	\$916,072.00	\$629,000.00

Grand Total (\$)9,706,438.67

Approved By:

Date

Last Edited By

Achilders

Approved By

Achilders

Last Edited Date

May 05, 2025

Approved Date

May 5, 2025

Project Cost Summary

This document contains proposed and estimated project cost information which is proprietary and confidential to ConocoPhillips.



Well Name

POWERCASTER FED COM 501H

Job Type

Drill and Complete

State

New Mexico - 30

County/Parish

Lea - 025

Authorization Number

Cost Feature Group	Grand Total			
	Drilling	Completions	Pumping Equipment	Facilities
A000: CASING & TUBING	\$706,000.00			\$150,000.00
B000: WELLHEAD, XMAS TREE, AND ASST EQUIPT	\$65,000.00	\$60,000.00		\$100,000.00
C000: COMPLETION EQUIPMENT & OTHER			\$763,430.00	\$243,000.00
D000: LOCATION (WELLSITE RELATED)	\$82,000.00	\$12,500.00	\$36,071.00	\$15,000.00
E000: RIGS & RIG RELATED	\$893,666.67			\$19,000.00
F000: DRILLING & COMPLETION UTILITIES (ALL)	\$234,000.00	\$667,000.00		
G000: FLUID AND CHEMICALS SERVICES	\$263,200.00	\$42,000.00		
H000: DIRECTIONAL DRILLING / MWD / LWD	\$262,000.00			
J000: CEMENTING MATERIALS, SERVICES, AND CSG ACCS	\$304,000.00			
K000: FORMATION EVALUATION	\$36,000.00			
M000: COMPLETION & TESTING		\$15,000.00		
N000: FORMATION STIMULATION & TREATING		\$1,034,000.00		
O000: CERTIFICATION, INSPECT, CONTROL & TEST				
P000: TRANSPORTATION SUPPLY & DISPOSAL	\$93,000.00	\$45,000.00		\$20,000.00
Q000: DRLG TOOLS & EQPT RNTAL W/WO OPR	\$288,000.00	\$586,000.00		\$12,000.00
R000: BITS & MILLS	\$86,000.00	\$4,000.00		
S000: SPECIAL SERVICES	\$137,000.00	\$295,000.00		\$17,000.00
T000: MISCELLANEOUS	\$317,500.00	\$120,000.00	\$70,857.00	\$36,000.00
U000: PERFORATING & SLICKLINE SERVICES		\$315,000.00		\$9,000.00
V000: ENG & CONSTRUCTION(E&C), CONSLT, R&D			\$22,857.00	\$0.00
W000: GENERAL FEES	\$42,500.00	\$5,000.00		
X000: CONOCOPHILLIPS LABOR & OVERHEAD	\$6,000.00	\$22,000.00	\$22,857.00	\$8,000.00
Y000: TOTALS, CONTINGENCY & MISCELLANEOUS		\$1,123,000.00		
Grand Total	\$3,815,866.67	\$4,345,500.00	\$916,072.00	\$629,000.00

Grand Total (\$)9,706,438.67

Approved By:

Date

Last Edited By

Achilders

Approved By

Achilders

Last Edited Date

May 05, 2025

Approved Date

May 5, 2025

Project Cost Summary



This document contains proposed and estimated project cost information which is proprietary and confidential to ConocoPhillips.

Well Name

POWERCASTER FED COM 502H

Job Type

Drill and Complete

State

New Mexico - 30

County/Parish

Lea - 025

Authorization Number

Cost Feature Group	Grand Total			
	Drilling	Completions	Pumping Equipment	Facilities
A000: CASING & TUBING	\$706,000.00			\$150,000.00
B000: WELLHEAD, XMAS TREE, AND ASST EQUIPT	\$65,000.00	\$60,000.00		\$100,000.00
C000: COMPLETION EQUIPMENT & OTHER			\$763,430.00	\$243,000.00
D000: LOCATION (WELLSITE RELATED)	\$82,000.00	\$12,500.00	\$36,071.00	\$15,000.00
E000: RIGS & RIG RELATED	\$893,666.67			\$19,000.00
F000: DRILLING & COMPLETION UTILITIES (ALL)	\$234,000.00	\$667,000.00		
G000: FLUID AND CHEMICALS SERVICES	\$263,200.00	\$42,000.00		
H000: DIRECTIONAL DRILLING / MWD / LWD	\$262,000.00			
J000: CEMENTING MATERIALS, SERVICES, AND CSG ACCS	\$304,000.00			
K000: FORMATION EVALUATION	\$36,000.00			
M000: COMPLETION & TESTING		\$15,000.00		
N000: FORMATION STIMULATION & TREATING		\$1,034,000.00		
O000: CERTIFICATION, INSPECT, CONTROL & TEST				
P000: TRANSPORTATION SUPPLY & DISPOSAL	\$93,000.00	\$45,000.00		\$20,000.00
Q000: DRLG TOOLS & EQPT RNTAL W/WO OPR	\$288,000.00	\$586,000.00		\$12,000.00
R000: BITS & MILLS	\$86,000.00	\$4,000.00		
S000: SPECIAL SERVICES	\$137,000.00	\$295,000.00		\$17,000.00
T000: MISCELLANEOUS	\$317,500.00	\$120,000.00	\$70,857.00	\$36,000.00
U000: PERFORATING & SLICKLINE SERVICES		\$315,000.00		\$9,000.00
V000: ENG & CONSTRUCTION(E&C), CONSLT, R&D			\$22,857.00	\$0.00
W000: GENERAL FEES	\$42,500.00	\$5,000.00		
X000: CONOCOPHILLIPS LABOR & OVERHEAD	\$6,000.00	\$22,000.00	\$22,857.00	\$8,000.00
Y000: TOTALS, CONTINGENCY & MISCELLANEOUS		\$1,123,000.00		
Grand Total	\$3,815,866.67	\$4,345,500.00	\$916,072.00	\$629,000.00

Grand Total (\$)

9,706,438.67

Approved By:

Date

Last Edited By

Achilders

Approved By

Achilders

Last Edited Date

May 05, 2025

Approved Date

May 5, 2025

Project Cost Summary



This document contains proposed and estimated project cost information which is proprietary and confidential to ConocoPhillips.

Well Name

POWERCASTER FED COM 601H

Job Type

Drill and Complete

State

New Mexico - 30

County/Parish

Lea - 025

Authorization Number

Cost Feature Group	Grand Total			
	Drilling	Completions	Pumping Equipment	Facilities
A000: CASING & TUBING	\$845,000.00			\$150,000.00
B000: WELLHEAD, XMAS TREE, AND ASST EQUIPT	\$65,000.00	\$60,000.00		\$100,000.00
C000: COMPLETION EQUIPMENT & OTHER			\$763,430.00	\$243,000.00
D000: LOCATION (WELLSITE RELATED)	\$63,250.00	\$12,500.00	\$36,071.00	\$15,000.00
E000: RIGS & RIG RELATED	\$900,000.00			\$19,000.00
F000: DRILLING & COMPLETION UTILITIES (ALL)	\$247,300.00	\$702,000.00		
G000: FLUID AND CHEMICALS SERVICES	\$282,940.00	\$42,000.00		
H000: DIRECTIONAL DRILLING / MWD / LWD	\$287,000.00			
J000: CEMENTING MATERIALS, SERVICES, AND CSG ACCS	\$321,475.00			
K000: FORMATION EVALUATION	\$42,000.00			
M000: COMPLETION & TESTING		\$15,000.00		
N000: FORMATION STIMULATION & TREATING		\$1,139,000.00		
O000: CERTIFICATION, INSPECT, CONTROL & TEST				
P000: TRANSPORTATION SUPPLY & DISPOSAL	\$99,975.00	\$45,000.00		\$20,000.00
Q000: DRLG TOOLS & EQPT RNTAL W/WO OPR	\$302,400.00	\$716,000.00		\$12,000.00
R000: BITS & MILLS	\$101,000.00	\$4,000.00		
S000: SPECIAL SERVICES	\$137,000.00	\$295,000.00		\$17,000.00
T000: MISCELLANEOUS	\$335,050.00	\$132,000.00	\$70,857.00	\$36,000.00
U000: PERFORATING & SLICKLINE SERVICES		\$322,000.00		\$9,000.00
V000: ENG & CONSTRUCTION(E&C), CONSLT, R&D			\$22,857.00	
W000: GENERAL FEES	\$42,500.00	\$5,000.00		
X000: CONOCOPHILLIPS LABOR & OVERHEAD	\$6,300.00	\$22,000.00	\$22,857.00	\$8,000.00
Y000: TOTALS, CONTINGENCY & MISCELLANEOUS		\$1,122,000.00		
Grand Total	\$4,078,190.00	\$4,633,500.00	\$916,072.00	\$629,000.00

Grand Total (\$)10,256,762.00

Approved By:

Date

Last Edited By

Achilders

Approved By

Achilders

Last Edited Date

May 05, 2025

Approved Date

May 5, 2025



Project Cost Summary

This document contains proposed and estimated project cost information which is proprietary and confidential to ConocoPhillips.

Well Name

POWERCASTER FED COM 602H

Job Type

Drill and Complete

State

New Mexico - 30

County/Parish

Lea - 025

Authorization Number

Cost Feature Group	Grand Total			
	Drilling	Completions	Pumping Equipment	Facilities
A000: CASING & TUBING	\$845,000.00			\$150,000.00
B000: WELLHEAD, XMAS TREE, AND ASST EQUIPT	\$65,000.00	\$60,000.00		\$100,000.00
C000: COMPLETION EQUIPMENT & OTHER			\$763,430.00	\$243,000.00
D000: LOCATION (WELLSITE RELATED)	\$63,250.00	\$12,500.00	\$36,071.00	\$15,000.00
E000: RIGS & RIG RELATED	\$900,000.00			\$19,000.00
F000: DRILLING & COMPLETION UTILITIES (ALL)	\$247,300.00	\$702,000.00		
G000: FLUID AND CHEMICALS SERVICES	\$282,940.00	\$42,000.00		
H000: DIRECTIONAL DRILLING / MWD / LWD	\$287,000.00			
J000: CEMENTING MATERIALS, SERVICES, AND CSG ACCS	\$321,475.00			
K000: FORMATION EVALUATION	\$42,000.00			
M000: COMPLETION & TESTING		\$15,000.00		
N000: FORMATION STIMULATION & TREATING		\$1,139,000.00		
O000: CERTIFICATION, INSPECT, CONTROL & TEST				
P000: TRANSPORTATION SUPPLY & DISPOSAL	\$99,975.00	\$45,000.00		\$20,000.00
Q000: DRLG TOOLS & EQPT RNTAL W/WO OPR	\$302,400.00	\$716,000.00		\$12,000.00
R000: BITS & MILLS	\$101,000.00	\$4,000.00		
S000: SPECIAL SERVICES	\$137,000.00	\$295,000.00		\$17,000.00
T000: MISCELLANEOUS	\$335,050.00	\$132,000.00	\$70,857.00	\$36,000.00
U000: PERFORATING & SLICKLINE SERVICES		\$322,000.00		\$9,000.00
V000: ENG & CONSTRUCTION(E&C), CONSLT, R&D			\$22,857.00	
W000: GENERAL FEES	\$42,500.00	\$5,000.00		
X000: CONOCOPHILLIPS LABOR & OVERHEAD	\$6,300.00	\$22,000.00	\$22,857.00	\$8,000.00
Y000: TOTALS, CONTINGENCY & MISCELLANEOUS		\$1,122,000.00		
Grand Total	\$4,078,190.00	\$4,633,500.00	\$916,072.00	\$629,000.00

Grand Total (\$)10,256,762.00

Approved By:

Date

Last Edited By

Achilders

Approved By

Achilders

Last Edited Date

May 05, 2025

Approved Date

May 5, 2025



Project Cost Summary

This document contains proposed and estimated project cost information which is proprietary and confidential to ConocoPhillips.

Well Name

POWERCASTER FED COM 603H

Job Type

Drill and Complete

State

New Mexico - 30

County/Parish

Lea - 025

Authorization Number

Cost Feature Group	Grand Total			
	Drilling	Completions	Pumping Equipment	Facilities
A000: CASING & TUBING	\$845,000.00			\$150,000.00
B000: WELLHEAD, XMAS TREE, AND ASST EQUIPT	\$65,000.00	\$60,000.00		\$100,000.00
C000: COMPLETION EQUIPMENT & OTHER			\$763,430.00	\$243,000.00
D000: LOCATION (WELLSITE RELATED)	\$63,250.00	\$12,500.00	\$36,071.00	\$15,000.00
E000: RIGS & RIG RELATED	\$900,000.00			\$19,000.00
F000: DRILLING & COMPLETION UTILITIES (ALL)	\$247,300.00	\$702,000.00		
G000: FLUID AND CHEMICALS SERVICES	\$282,940.00	\$42,000.00		
H000: DIRECTIONAL DRILLING / MWD / LWD	\$287,000.00			
J000: CEMENTING MATERIALS, SERVICES, AND CSG ACCS	\$321,475.00			
K000: FORMATION EVALUATION	\$42,000.00			
M000: COMPLETION & TESTING		\$15,000.00		
N000: FORMATION STIMULATION & TREATING		\$1,139,000.00		
O000: CERTIFICATION, INSPECT, CONTROL & TEST				
P000: TRANSPORTATION SUPPLY & DISPOSAL	\$99,975.00	\$45,000.00		\$20,000.00
Q000: DRLG TOOLS & EQPT RNTAL W/WO OPR	\$302,400.00	\$716,000.00		\$12,000.00
R000: BITS & MILLS	\$101,000.00	\$4,000.00		
S000: SPECIAL SERVICES	\$137,000.00	\$295,000.00		\$17,000.00
T000: MISCELLANEOUS	\$335,050.00	\$132,000.00	\$70,857.00	\$36,000.00
U000: PERFORATING & SLICKLINE SERVICES		\$322,000.00		\$9,000.00
V000: ENG & CONSTRUCTION(E&C), CONSLT, R&D			\$22,857.00	
W000: GENERAL FEES	\$42,500.00	\$5,000.00		
X000: CONOCOPHILLIPS LABOR & OVERHEAD	\$6,300.00	\$22,000.00	\$22,857.00	\$8,000.00
Y000: TOTALS, CONTINGENCY & MISCELLANEOUS		\$1,122,000.00		
Grand Total	\$4,078,190.00	\$4,633,500.00	\$916,072.00	\$629,000.00

Grand Total (\$)10,256,762.00

Approved By:

Date

Last Edited By

Achilders

Approved By

Achilders

Last Edited Date

May 05, 2025

Approved Date

May 5, 2025

[illegible]

	Operator	Interest Owners
Tract 1	S/2 of Section 17 T23S-R34E LC-65194	Devon Energy Production Co.
Tract 2	SE/4SE/4 of Section 18 T23S-R34E LC-065194	BTA Oil Producers, LLC SRR Permian LLC Chevron USA Ray and Karen Westall MRC Permian Co. Devon Energy Production Co
Tract 3	E/2E/2 of Section 19 T23S-R34E NM-68820	BTA Oil Producers, LLC SRR Permian LLC Chevron USA Ray and Karen Westall MRC Permian Co. Devon Energy Production Co Mid-Continent Energy Inc. LaTex Petroleum Corp Kerry Petroleum Co
Tract 4	E/2E/2 of Section 30 T23S-R34E NM-068821	COG Operating
Tract 5	NE/4NE/4 of Section 31 and N/2NW/4 of Section 32 T23S-R34E E0-5896	Javelina Partnership Kaiser-Francis Oil Co Chevron USA Devon Energy Production Co GBK Investments, LLC
Tract 6	N/2NE/4 of Section 32 T23S-R34E E0-1937	OXY USA WTP LP
Tract 7	NW/4NW/4 of Section 33 T23S-R34E K0-280	OXY USA WTP LP Endeavor Energy Resources LP
Tract 8	W/2W/2 of Section 28 T23S-R34E LC-067715	OXY USA WTP LP Endeavor Energy Resources LP Chevron USA Inc
Tract 9	SW4 of Section 21 T23S-R34E VB-8241	Mewbournes Oil Co Chevron USA Inc. Wildcat Energy, LLC
Tract 10	NW4 of Section 21 T23S-R34E VB-8241	COG Operating Mewbournes Oil Co Chevron USA Inc. Wildcat Energy, LLC
Tract 11	SW/4SW/4 of Section 16 T23S-R34E VB-141	COG Operating

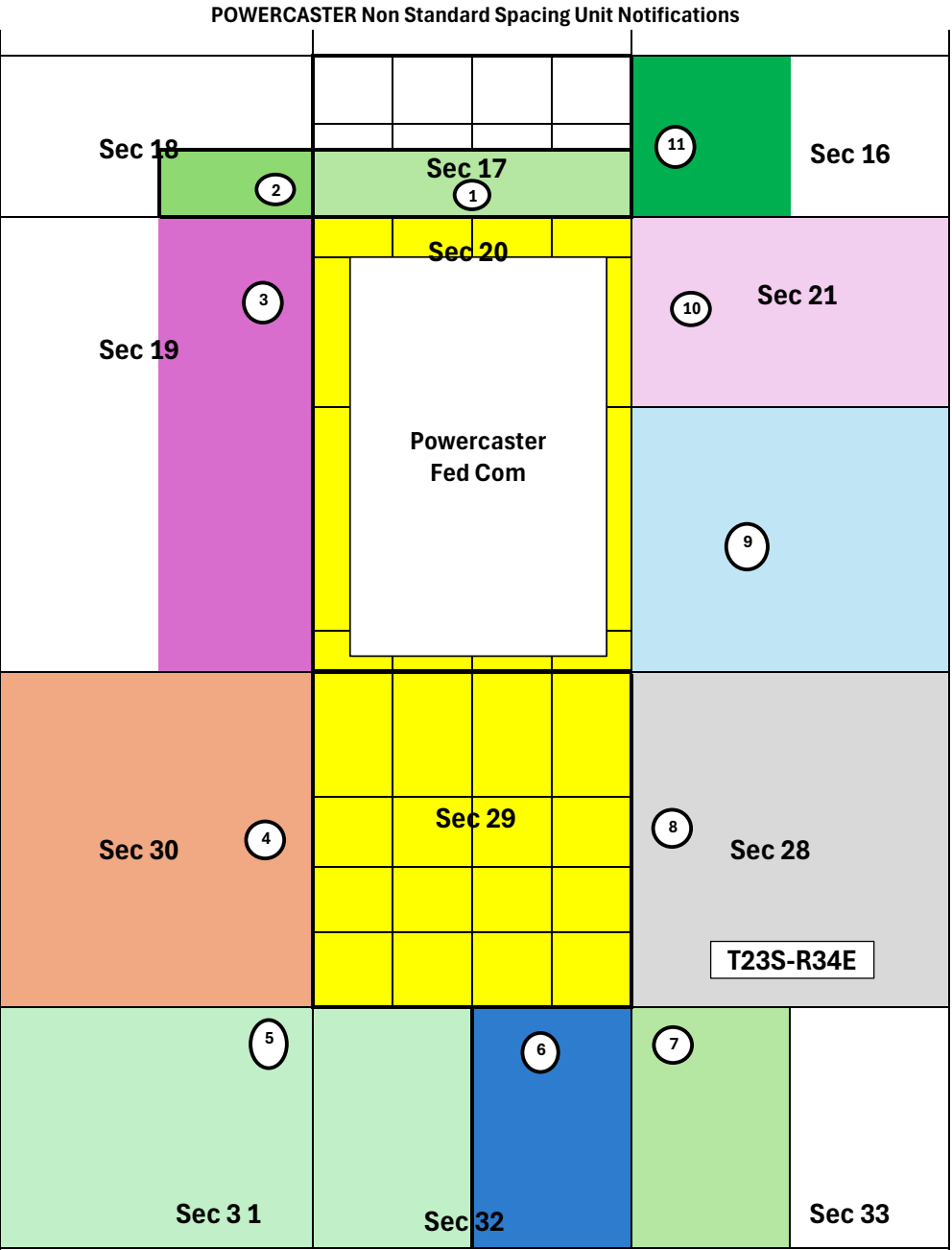

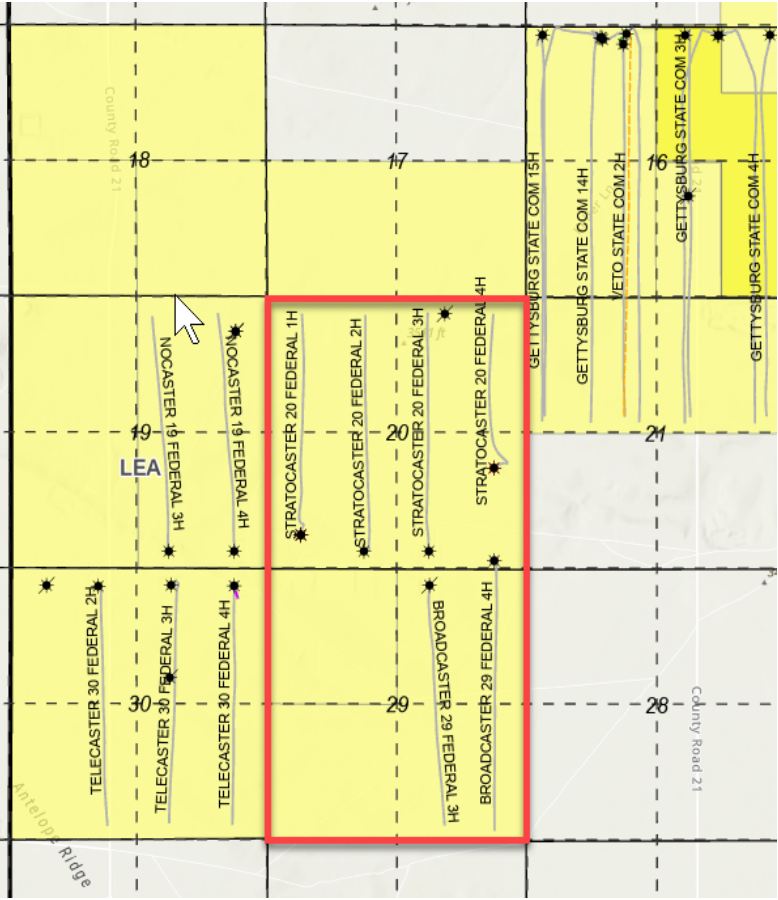

**STATE OF NEW MEXICO
ENERGY, MINERALS AND NATURAL RESOURCES DEPARTMENT
OIL CONSERVATION DIVISION**

**APPLICATIONS OF COG OPERATING LLC FOR
APPROVAL OF A NON-STANDARD OVERLAPPING
SPACING UNIT AND COMPULSORY POOLING,
LEA COUNTY, NEW MEXICO.**

CASE NOS. 25440-25441

**APPLICATIONS OF COG OPERATING LLC
FOR COMPULSORY POOLING,
LEA COUNTY, NEW MEXICO.**

CASE NOS. 25442-25443

SELF-AFFIRMED STATEMENT OF BEN BREYMAN, GEOLOGIST

1. My name is Ben Breyman, and I am employed as a geologist by COG Operating LLC ("COG"), now a wholly owned subsidiary of ConocoPhillips Company. I am familiar with the application filed in this matter and I have conducted a geologic study of the lands in the subject area.

2. I have previously testified before the New Mexico Oil Conservation Division as an expert witness in petroleum geology and my credential have been accepted and made a matter of public record.

3. **COG Exhibit B-1** is an area map showing the general location of COG's proposed spacing units outlined in red with lines depicting the orientation and general location of COG's initial wells targeting the Bone Spring and Wolfcamp formations. This map also shows the existing wells in the surrounding sections that are completed in the Bone Spring and Wolfcamp formations.

**BEFORE THE OIL CONSERVATION DIVISION
Santa Fe, New Mexico
Exhibit No. B
Submitted by: COG Operating LLC
Hearing Date: July 29, 2025
Case No. 25441**

4. The initial targets for the proposed wells are the Avalon, BS1S, BS1SH, BS2S & BS3S intervals of the Bone Spring formation and the Wolfcamp Sand interval of the Wolfcamp formation.

5. The Bone Spring formation in the subject area contains an ownership depth severance at 10,289' TVD, as observed in the well log for the West Copperline 29 State Com 1H well (API No. 30-025-41313), which is at the base of the First Bone Spring interval. COG therefore seeks to create and pool two separate spacing units in the Bone Spring formation: The first being from the top of the Bone Spring formation at a stratigraphic equivalent of 8,653' TVD to the base of the First Bone Spring interval at a stratigraphic equivalent of approximately 10,289' TVD, as observed in the well log for the West Copperline 29 State Com 1H well, and the second being from the top of the Second Bone Spring interval, at a stratigraphic equivalent of approximately 10,290' TVD, to the base of the Third Bone Spring interval, at a stratigraphic equivalent of approximately 11,631' TVD as observed in the well log for the West Copperline 29 State Com 1H well.

6. **COG Exhibit B-2** contains the type log for the West Copperline 29 State Com 1H well on which I have bracketed the two stratigraphic intervals that COG seeks to separately pool in the Bone Spring formation.

7. **COG Exhibit B-3** is subsea structure map that I prepared for the base of the Bone Spring formation with contour intervals of 50 feet. COG's proposed spacing units are outlined on this map in red. This exhibit demonstrates that the structure of the Bone Spring formation is consistent across the proposed spacing unit and dips gently to

the southeast. I do not observe any faulting, pinch outs, or other geologic impediments to developing this formation in this area with horizontal wells.

8. **COG Exhibit B-4** is subsea structure map that I prepared for the top of the Wolfcamp formation with contour intervals of 50 feet. COG's proposed spacing units are again outlined on this map in red. This exhibit demonstrates that the structure of the Wolfcamp formation is consistent across the proposed spacing unit and dips gently to the southeast. I do not observe any faulting, pinch outs, or other geologic impediments to developing this formation in this area with horizontal wells.

9. COG Exhibits B-3 and B-4 also depict a line of cross section through COG's proposed spacing units from A to A'. I chose the logs from these wells to create a structural cross section because they penetrate the targeted interval and are of good quality. In my opinion, these well logs are representative of the geology in the subject area.

10. **COG Exhibit B-5** is a structural cross section that I prepared using the logs from the representative wells shown on Exhibits B-3 and B-4. Each well on the cross-section contains gamma ray, resistivity, and porosity logs. The target intervals for the initially proposed wells in the Bone Spring and Wolfcamp formations are identified on the exhibit with the target name and bracket. The cross-section demonstrates that the targeted intervals in each formation are continuous and relatively uniform across the proposed spacing units.

11. My geologic study indicates the Boen Spring and Wolfcamp formations underlying the subject area are suitable for development by horizontal wells and the acreage comprising the proposed horizontal spacing units will be productive and contribute proportionately to the production from the wells.

12. As reflected in Exhibit B-1, the primary orientation for the existing wells targeting the Bone Spring and Wolfcamp formations in this area are standup. In my opinion the standup orientation of COG's proposed wells is consistent with existing development and appropriate for the stress orientation in the Bone Spring and Wolfcamp formations in this area.

13. In my opinion, approval of this application is in the best interest of conservation, the prevention of waste, and protection of correlative rights.

14. **COG Exhibits B-1 through B-5** were either prepared by me or compiled under my direction and supervision.

15. I affirm under penalty of perjury under the laws of the State of New Mexico that the foregoing statements are true and correct. I understand that this self-affirmed statement will be used as written testimony in these cases. This statement is made on the date next to my signature below.

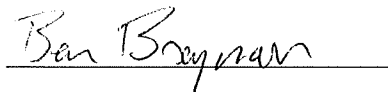

Ben Breyman

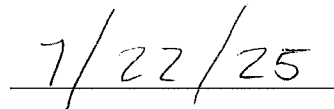





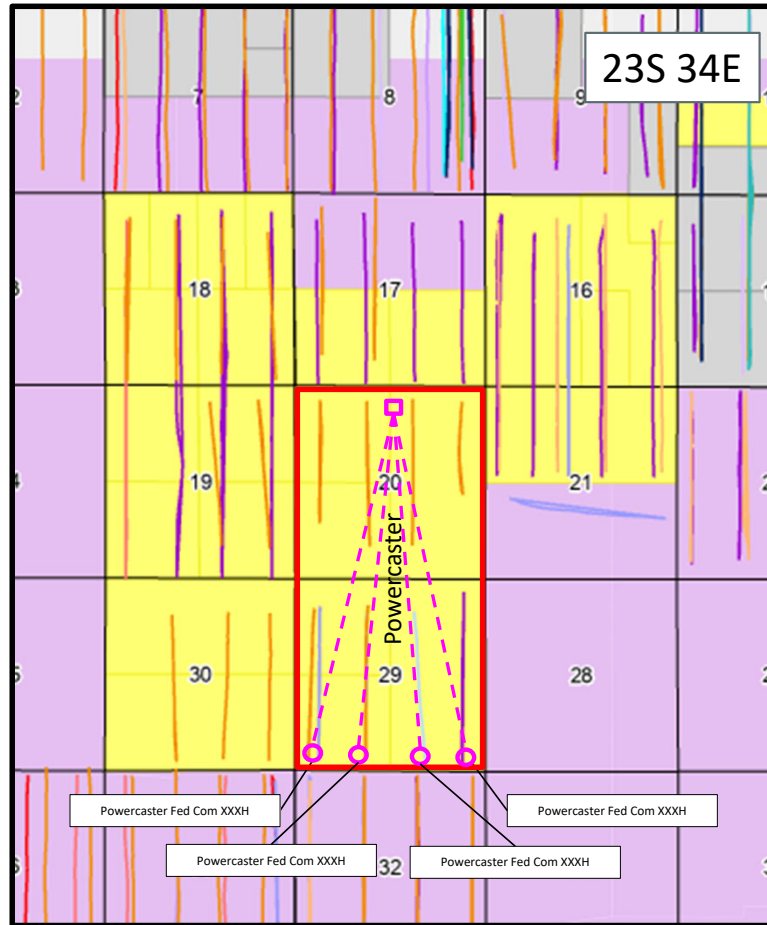





Date

Case No. 25440-25443: Powercaster Fed Com

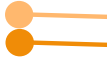

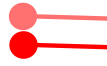
Map Legend

-   COG - Horizontal Location
-   COG - Horizontal Location
-  Producing Avalon Wells
-  Producing BS1S/SH Wells
-  Producing BS2S Wells
-  Producing BS3S Wells
-  Producing Wolfcamp Sand Wells
-  Producing Wolfcamp A Wells
-  COG Acreage

COG Exhibit B-2

PALOMA PERMIAN ASSETCO LLC
COPPERLINE WEST 29 STATE COM 1H PH
TWP: 23 S - Range: 34 E - Sec. 29

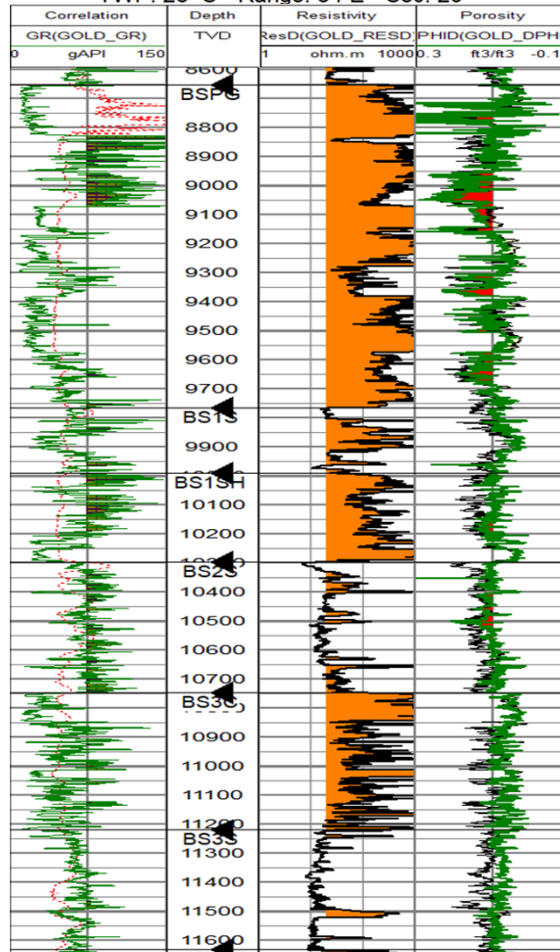

First Bone Spring
Ownership depth
severance

Second Bone Spring
Ownership depth
severance

Bone Spring Base Subsea Structure Map

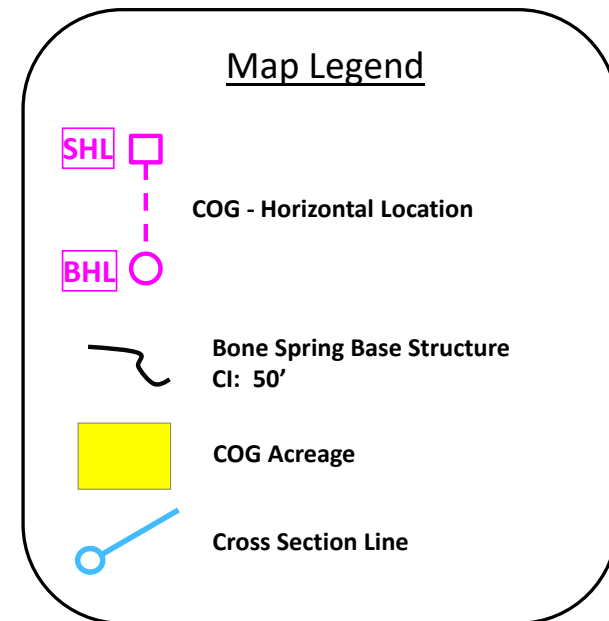
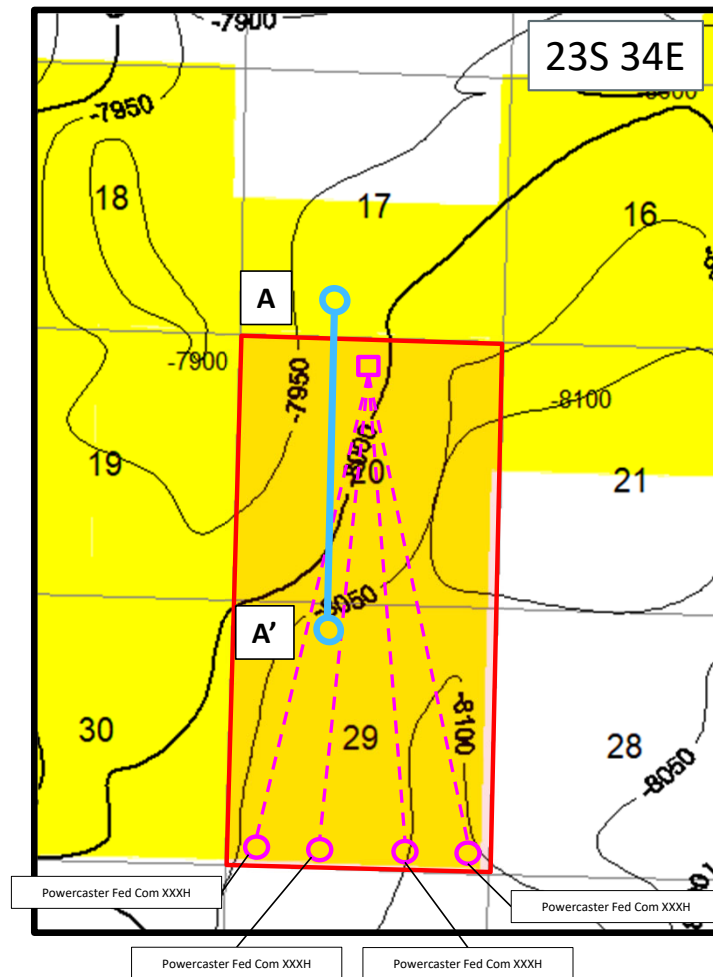

Wolfcamp Subsea Structure Map

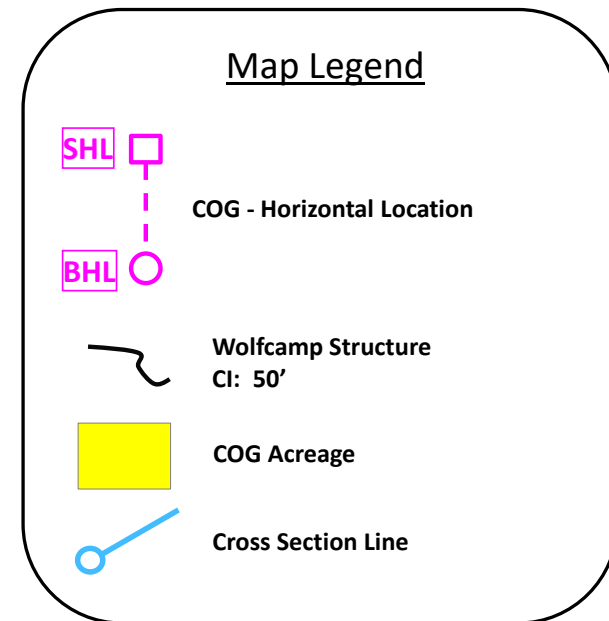
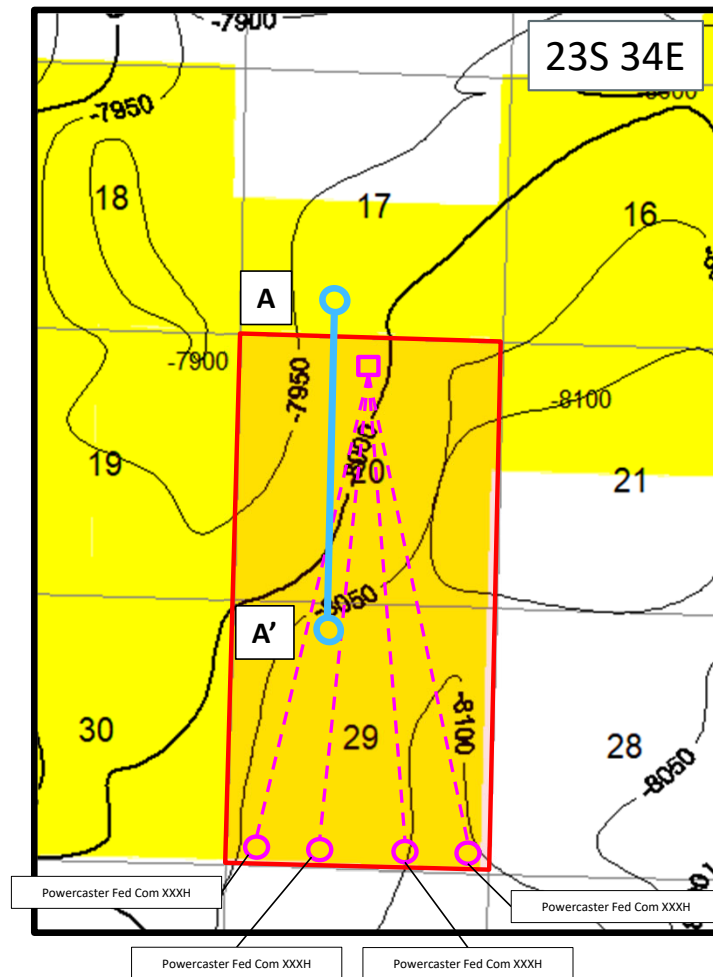

Case No. 25440-25443 : Powercaster Fed Com Section A-A'

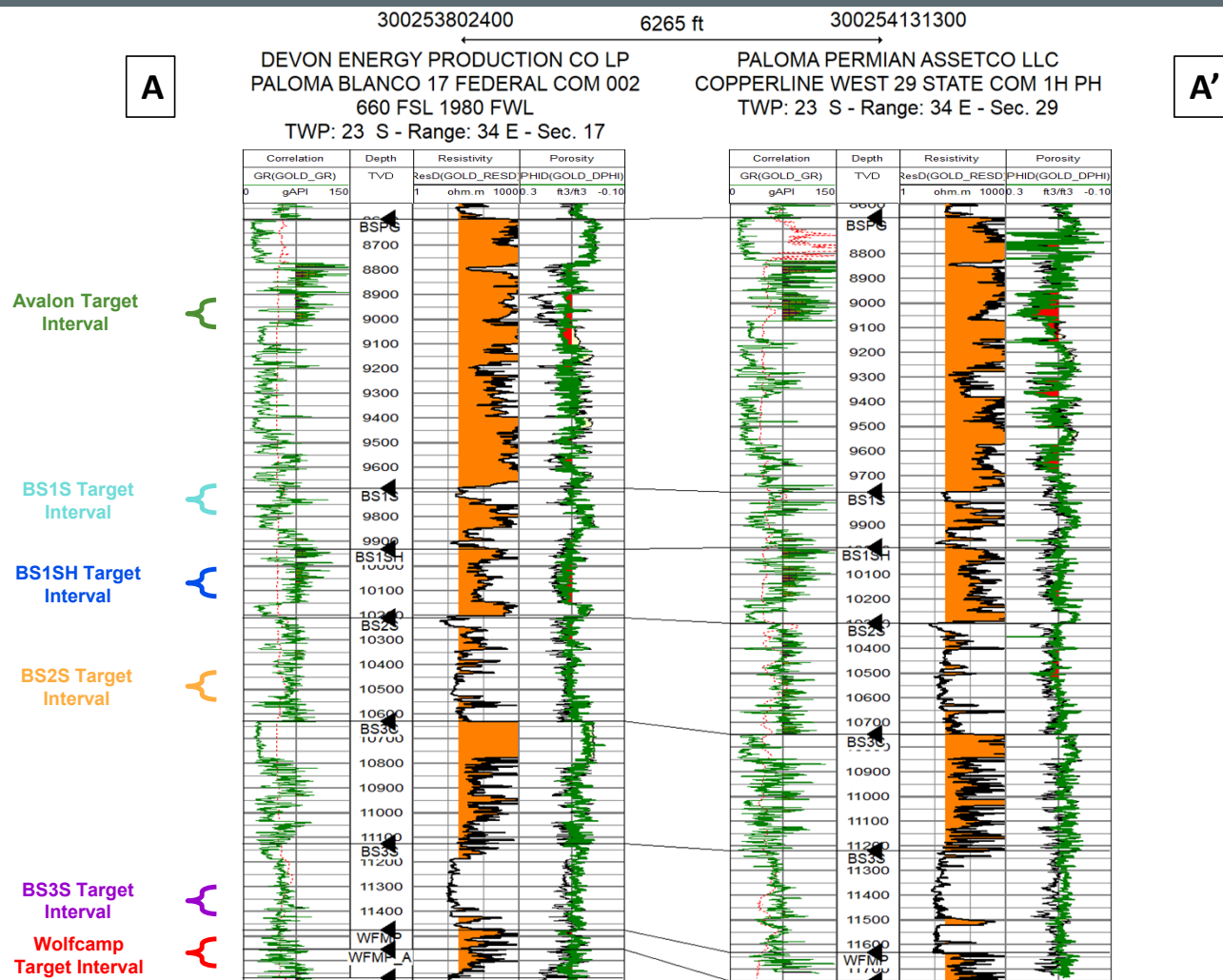

**STATE OF NEW MEXICO
ENERGY, MINERALS AND NATURAL RESOURCES DEPARTMENT
OIL CONSERVATION DIVISION**

**APPLICATIONS OF COG OPERATING LLC FOR
APPROVAL OF A NON-STANDARD OVERLAPPING
SPACING UNIT AND COMPULSORY POOLING,
LEA COUNTY, NEW MEXICO.**

CASE NO. 25441

**SELF-AFFIRMED STATEMENT OF
MICHAEL H. FELDEWERT**

1. I am attorney in fact and authorized representative of COG Operating LLC (“COG”), the Applicant herein. I have personal knowledge of this matter addressed herein and am competent to provide this self-affirmed statement.

2. The above-referenced application and notice of the hearing on this application was sent by certified mail to the affected parties on the date set forth in the letter attached hereto.

3. The spreadsheet attached hereto contains the names of the parties to whom notice was provided.

4. The spreadsheet attached hereto contains the information provided by the United States Postal Service on the status of the delivery of this notice as of July 21, 2025.

5. I caused a notice to be published to all parties subject to these proceedings. An affidavit of publication from the publication’s legal clerk with a copy of the notice publication is attached herein.

6. I affirm under penalty of perjury under the laws of the State of New Mexico that the foregoing statement are true and correct. I understand that this self-affirmed statement will be used as written testimony in this case. This statement is made on the date next to my signature below.

**BEFORE THE OIL CONSERVATION DIVISION
Santa Fe, New Mexico
Exhibit No. C
Submitted by: COG Operating LLC
Hearing Date: July 29, 2025
Case No. 25441**



Michael H. Feldewert

07/22/25

Date



Michael H. Feldewert
Partner
Phone (505) 988-4421
mfeldewert@hollandhart.com

June 20, 2025

VIA CERTIFIED MAIL
CERTIFIED RECEIPT REQUESTED

TO: ALL AFFECTED INTEREST OWNERS

Re: Application of COG Operating LLC for Approval of a Non-standard Overlapping Horizontal Well Spacing Unit and Compulsory Pooling, Lea County, New Mexico: PowerCaster Federal Com 501H, 502H and 602H wells

Ladies & Gentlemen:

This letter is to advise you that COG Operating LLC has filed the enclosed application with the New Mexico Oil Conservation Division. A hearing has been requested before a Division Examiner on July 10, 2025, and the status of the hearing can be monitored through the Division's website at <https://www.emnrd.nm.gov/ocd/>.

It is anticipated that hearings will be held in a hybrid format with both in-person and virtual participation options. The meeting will be held in the Pecos Hall Hearing Room at the Wendall Chino Building, 1st Floor, 1220 South St. Francis Dr., Santa Fe, New Mexico. To participate virtually in the hearing, see the instructions posted on the OCD Hearings website: <https://www.emnrd.nm.gov/ocd/hearing-info/>.

You are not required to attend this hearing, but as an owner of an interest that may be affected by this application, you may appear and present testimony. Failure to appear at that time and become a party of record will preclude you from challenging the matter at a later date. Parties appearing in cases are required to file a Pre-hearing Statement four business days in advance of a scheduled hearing that complies with the provisions of NMAC 19.15.4.13.B.

If you have any questions about this matter, please contact Michael Monju at (432) 685-4397 or at Michael.F.Monju@conocophillips.com.

Sincerely,

A handwritten signature in blue ink, appearing to read 'Michael H. Feldewert'.

Michael H. Feldewert
ATTORNEY FOR COG OPERATING LLC

Location
110 North Guadalupe, Suite 1
Santa Fe, NM 87501-1849

Mailing Address
P.O. Box 2208
Santa Fe, NM 87504-2208

Contact
p: 505.988.4421 | f: 505.983.6043
www.hollandhart.com

Holland & Hart LLP Anchorage Aspen Billings Boise Boulder Cheyenne Denver Jackson Hole Las Vegas Reno Salt Lake City Santa Fe Washington, D.C.

COG - Powercaster 501H, 502H and 602H Lower BS wells - Case no. 25441
Postal Delivery Report

9414811898765440671692	Brian Ahern	6221 SE 17th Ave	Portland	OR	97202-5305	Your package will arrive later than expected, but is still on its way. It is currently in transit to the next facility.
9414811898765440671685	BTA Oil Producers LLC	104 S Pecos St	Midland	TX	79701-5021	Your item was picked up at a postal facility at 7:37 am on June 27, 2025 in MIDLAND, TX 79701.
9414811898765440671111	Caza Petroleum, Inc.	200 N Loraine St Ste 1550	Midland	TX	79701-4765	Your item was delivered to an individual at the address at 8:23 am on June 26, 2025 in MIDLAND, TX 79701.
9414811898765440671166	Chevron USA Inc	1400 Smith St	Houston	TX	77002-7311	Your item has been delivered to an agent. The item was picked up at USPS at 7:09 am on June 27, 2025 in HOUSTON, TX 77002.
9414811898765440671128	Chevron USA Inc	6301 Deauville	Midland	TX	79706-2964	Your item was delivered to an individual at the address at 12:31 pm on June 26, 2025 in MIDLAND, TX 79706.
9414811898765440671104	Claire Ahern Massimo	185 Hersey St	Hingham	MA	02043-2705	Your item was delivered to an individual at the address at 10:45 am on June 27, 2025 in HINGHAM, MA 02043.
9414811898765440671197	COG Operating LLC	600 W Illinois Ave	Midland	TX	79701-4882	Your item was picked up at a postal facility at 7:46 am on June 27, 2025 in MIDLAND, TX 79701.
9414811898765440671142	Curry Services LLLP	13107 SW Ascension Dr	Tigard	OR	97223-5685	Your item was delivered to an individual at the address at 12:32 pm on June 24, 2025 in PORTLAND, OR 97223.
9414811898765440671180	Devon Energy Production Co LP	333 W Sheridan Ave	Oklahoma City	OK	73102-5010	Your item was picked up at a postal facility at 7:25 am on June 25, 2025 in OKLAHOMA CITY, OK 73102.

COG - Powercaster 501H, 502H and 602H Lower BS wells - Case no. 25441
Postal Delivery Report

9414811898765440671135	Devon Energy Production Co LP	PO Box 843559	Dallas	TX	75284-3559	Your item has been delivered and is available at a PO Box at 8:16 pm on June 24, 2025 in DALLAS, TX 75284.
9414811898765440671173	Dorchester Minerals LP	3838 Oak Lawn Ave Ste 300	Dallas	TX	75219-4541	Your item was delivered to the front desk, reception area, or mail room at 4:15 pm on June 24, 2025 in DALLAS, TX 75219.
9414811898765440671364	Endeavor Energy Resources LP	110 N Marienfeld St Ste 200	Midland	TX	79701-4412	Your item was picked up at a postal facility at 8:12 am on June 26, 2025 in MIDLAND, TX 79701.
9414811898765440671326	GBK Investments, LLC	PO Box 21468	Tulsa	OK	74121-1468	Your item was delivered to an individual at the address at 5:50 am on June 25, 2025 in TULSA, OK 74103.
9414811898765440671302	Hillman Royalties LP	1415 S Voss Rd Ste 110 105	Houston	TX	77057-1086	Your item was delivered to an individual at the address at 4:07 pm on June 25, 2025 in HOUSTON, TX 77057.
9414811898765440671340	ICA Energy Inc	PO Box 233	Odessa	TX	79760-0233	Your item was picked up at a postal facility at 11:43 am on June 24, 2025 in STARKVILLE, MS 39760.
9414811898765440671388	James Berry Stapler	603 E Briarwood Ln	Harker Heights	TX	76548-1663	Your item was delivered to an individual at the address at 2:45 pm on June 24, 2025 in HARKER HEIGHTS, TX 76548.
9414811898765440671333	Javelina Partnership	616 S Texas Ave	Oklahoma City	OK	73130	Your item has been delivered to the original sender at 10:02 am on July 3, 2025 in SANTA FE, NM 87501.
9414811898765440671371	John L. Thoma	PO Box 17656	Golden	CO	80402-6027	Your item has been delivered to the original sender at 11:03 am on June 30, 2025 in SANTA FE, NM 87501.

COG - Powercaster 501H, 502H and 602H Lower BS wells - Case no. 25441
Postal Delivery Report

9414811898765440671050	John William Stapler	926 Bridget Ln	Dallas	TX	75218-2803	Your item was delivered to an individual at the address at 9:03 am on June 26, 2025 in DALLAS, TX 75218.
9414811898765440671067	Kaiser-Francis Oil Company	PO Box 21468	Tulsa	OK	74121-1468	Your item was delivered to an individual at the address at 5:50 am on June 25, 2025 in TULSA, OK 74103.
9414811898765440671005	Kerry Petroleum Company, Inc.	PO Box 9460	Midland	TX	79708-9460	Your item was picked up at a postal facility at 2:40 pm on June 30, 2025 in MIDLAND, TX 79708.
9414811898765440671098	LaTex Petroleum Corporation	PO Box 702343	Tulsa	OK	74170-2343	Your item has been delivered to the original sender at 10:36 am on July 11, 2025 in SANTA FE, NM 87501.
9414811898765440671043	Lois G Williamson Estate	PO Box 16	Midland	TX	79702-0016	Your item was picked up at a postal facility at 2:29 pm on June 26, 2025 in MIDLAND, TX 79701.
9414811898765440671081	Lois G. Williamson, Trustee of JC Williamson Testamentary Trust	PO Box 16	Midland	TX	79702-0016	Your item was picked up at a postal facility at 2:29 pm on June 26, 2025 in MIDLAND, TX 79701.
9414811898765440671074	Mewbourne Oil Company	PO Box 5270	Hobbs	NM	88241-5270	Your item was picked up at the post office at 2:31 pm on June 24, 2025 in HOBBS, NM 88240.
9414811898765440671418	Michael G Metcalf	PO Box 51743	Midland	TX	79710-1743	Your item was picked up at a postal facility at 11:54 am on June 25, 2025 in MIDLAND, TX 79705.
9414811898765440671463	Mid-Continent Energy, Inc.	100 W 5th St Ste 450	Tulsa	OK	74103-4254	Your item was delivered to an individual at the address at 6:09 am on June 25, 2025 in TULSA, OK 74103.
9414811898765440671401	MRC Permian Company	5400 Lbj Fwy Ste 1500 One Lincoln Centre	Dallas	TX	75240-1017	Your item was delivered to an individual at the address at 9:07 am on June 27, 2025 in DALLAS, TX 75240.

COG - Powercaster 501H, 502H and 602H Lower BS wells - Case no. 25441
Postal Delivery Report

9414811898765440671487	MSH Family Real Estate Partnership II LLC	4143 Maple Ave Ste 500	Dallas	TX	75219-3294	Your item was delivered to an individual at the address at 1:40 pm on June 25, 2025 in DALLAS, TX 75219.
9414811898765440671432	Oxy USA WTP LP	5 Greenway Plz Ste 110	Midland	TX	79706	Your item arrived at our MIDLAND TX DISTRIBUTION CENTER destination facility on July 20, 2025 at 12:06 pm. The item is currently in transit to the destination.
9414811898765440671470	Paloma Permian Assetco LLC	1100 Louisiana St Ste 5100	Houston	TX	77002-5220	Your package will arrive later than expected, but is still on its way. It is currently in transit to the next facility.
9414811898765440671517	Pegasus Resources LLC	PO Box 733980	Dallas	TX	75373-3980	Your item has been delivered and is available at a PO Box at 6:20 pm on June 24, 2025 in DALLAS, TX 75373.
9414811898765440671555	Philip L White	PO Box 25968	Albuquerque	NM	87125-0968	Your item was picked up at the post office at 4:58 pm on June 23, 2025 in ALBUQUERQUE, NM 87101.
9414811898765440671524	Pivotal Royalties Partners LP DBA PRP Delaware Basin LLC	2021 McKinney Ave Ste 1250	Dallas	TX	75201-7625	Your item was delivered to an individual at the address at 10:59 am on June 24, 2025 in DALLAS, TX 75201.
9414811898765440671593	Ray and Karen Westall	PO Box 4	Loco Hills	NM	88255-0004	Your item was picked up at a postal facility at 10:23 am on June 30, 2025 in LOCO HILLS, NM 88255.
9414811898765440671586	Ray Westall Operating Inc	PO Box 4	Loco Hills	NM	88255-0004	Your item was picked up at a postal facility at 10:23 am on June 30, 2025 in LOCO HILLS, NM 88255.
9414811898765440671531	Robert H Frazier Royalty LLC	PO Box 50264	Midland	TX	79710-0264	This is a reminder to please pick up your item at the MIDLAND, TX 79710 Post Office.

COG - Powercaster 501H, 502H and 602H Lower BS wells - Case no. 25441
Postal Delivery Report

9414811898765440671579	Roger Quarles Ttee Quarels Income Trust	3704 E 99th St S	Tulsa	OK	74136	Your item has been delivered to the original sender at 10:02 am on July 3, 2025 in SANTA FE, NM 87501.
9414811898765440699252	Rosemary Ahern	PO Box 15	Copake Falls	NY	12517-0015	Your item was picked up at a postal facility at 3:14 pm on June 24, 2025 in COPAKE FALLS, NY 12517.
9414811898765440699269	SMP Sidecar Titan Mineral Holdings LP	4143 Maple Ave Ste 500	Dallas	TX	75219-3294	Your item was delivered to an individual at the address at 12:34 pm on June 24, 2025 in DALLAS, TX 75219.
9414811898765440699207	SMP Titan Flex LP	4143 Maple Ave Ste 500	Dallas	TX	75219-3294	Your item was delivered to an individual at the address at 12:34 pm on June 24, 2025 in DALLAS, TX 75219.
9414811898765440699290	SMP Titan Mineral Holdings LP	4143 Maple Ave Ste 500	Dallas	TX	75219-3294	Your item was delivered to an individual at the address at 12:34 pm on June 24, 2025 in DALLAS, TX 75219.
9414811898765440699245	SRR Permian, LLC	1701 River Run Ste 902	Fort Worth	TX	76107-6553	Your item was delivered to an individual at the address at 11:25 am on June 26, 2025 in FORT WORTH, TX 76107.
9414811898765440699283	Stonestreet Family Trust 6 1 93 Hardeman L Stonestreet Jr	4460 S Snowmass Ct	Millcreek	UT	84124-2681	Your item was delivered to an individual at the address at 12:47 pm on June 24, 2025 in SALT LAKE CITY, UT 84124.
9414811898765440699238	Susan Margaret Cabral	6101 Garwood Cir	Flower Mound	TX	75028-2358	Your item was delivered to an individual at the address at 10:15 am on July 15, 2025 in FLOWER MOUND, TX 75028.
9414811898765440699276	Teresa Stapler Staub	1603 N K St	Midland	TX	79701-4039	Your item was picked up at the post office at 9:02 am on July 1, 2025 in MIDLAND, TX 79701.
9414811898765440699818	Thomas E Jennings	PO Box 1797	Roswell	NM	88202-1797	Your item was picked up at the post office at 10:21 am on June 27, 2025 in ROSWELL, NM 88201.

COG - Powercaster 501H, 502H and 602H Lower BS wells - Case no. 25441
Postal Delivery Report

9414811898765440699856	Wildcat Energy, LLC	PO Box 13323	Odessa	TX	79768-3323	Your item was picked up at the post office at 11:33 am on June 24, 2025 in ODESSA, TX 79762.
9414811898765440699863	Wing Resources VII LLC S&J Land Svcs LLC Agent	2100 McKinney Ave Ste 1540	Dallas	TX	75201-2140	Your item was delivered to an individual at the address at 10:14 am on June 24, 2025 in DALLAS, TX 75201.

Affidavit of Publication

STATE OF NEW MEXICO
COUNTY OF LEA

I, Daniel Russell, Publisher of the Hobbs News-Sun, a newspaper published at Hobbs, New Mexico, solemnly swear that the clipping attached hereto was published in the regular and entire issue of said newspaper, and not a supplement thereof for a period of 1 issue(s).

Beginning with the issue dated
June 25, 2025
and ending with the issue dated
June 25, 2025.



Publisher

Sworn and subscribed to before me this
25th day of June 2025.



Business Manager

My commission expires

January 29, 2027 NEW MEXICO

(Seal)

NOTARY PUBLIC

GUSSIE RUTH BLACK

COMMISSION # 1087526

COMMISSION EXPIRES 01/29/2027

This newspaper is duly qualified to publish legal notices or advertisements within the meaning of Section 3, Chapter 167, Laws of 1937 and payment of fees for said publication has been made.

LEGAL NOTICE
June 25, 2025

Case No. 25441: Application of COG Operating LLC for Approval of a Non-Standard Overlapping Horizontal Well Spacing Unit and Compulsory Pooling, Lea County, New Mexico. Notice to all affected interest owners, including all heirs, devisees and successors of: Brian Ahern; BTA Oil Producers LLC; Caza Petroleum, Inc.; Chevron USA Inc.; Claire Ahern Massimo; COG Operating LLC; Curry Services LLLP; Devon Energy Production Co LP; Devon Energy Production Co LP; Dorchester Minerals LP; Endeavor Energy Resources LP; GBK Investments, LLC; Hillman Royalties LP; ICA Energy Inc; James Berry Stapler; Javelina Partnership; John L. Thoma; John William Stapler; Kaiser-Francis Oil Company; Kerry Petroleum Company, Inc.; LaTex Petroleum Corporation; Lois G. Williamson Estate; Lois G. Williamson, Trustee of JC Williamson Testamentary Trust; Mewbourne Oil Company; Michael G. Metcalf; Mid-Continent Energy, Inc.; MRC Permian Company; MSH Family Real Estate Partnership II LLC; Oxy USA WTP LP; Paloma Permian Assetco LLC; Pegasus Resources LLC; Philip L. White; Pivotal Royalties Partners LP DBA PRP Delaware Basin LLC; Ray and Karen Westall; Ray Westall Operating Inc.; Robert H. Frazier Royalty LLC; Roger Quarles Tee Quarles Income Trust; Rosemary Ahern; SMP Sidercar Titan Mineral Holdings LP; SMP Titan Flex LP; SMP Titan Mineral Holdings LP; SRR Permian, LLC; Stonestreet Family Trust 6 1 93 Hardeman L. Stonestreet Jr.; Susan Margaret Cabral; Teresa Stapler Staub; Thomas E. Jennings; Wildcat Energy, LLC; and Wing Resources VII LLC S&J Land Svcs LLC Agent. The State of New Mexico, Energy Minerals and Natural Resources Department, Oil Conservation Division ("Division") hereby gives notice that the Division will hold public hearing 8:30 a.m. on July 10, 2025, to consider this application. The hearing will be conducted in a hybrid fashion, both in-person at the Energy, Minerals, Natural Resources Department, Wendell Chino Building, Pecos Hall, 1220 South St. Francis Drive, 1st Floor, Santa Fe, NM 87505 and via the WebEx virtual meeting platform. To participate in the hearings electronically, see the instructions posted on the docket for the hearing date: <https://www.emnrd.nm.gov/ocd/hearing-info/> or contact Freya Tschantz at Freya.Tschantz@emnrd.nm.gov. Applicant in the above-styled cause seeks an order (a) approving a non-standard 1280-acre, more or less, overlapping horizontal well spacing unit in an interval of the Bone Spring formation underlying Sections 20 and 29, Township 23 South, Range 34 East, NMPM, Lea County, New Mexico, and (b) pooling the uncommitted mineral owners in this acreage. To address an ownership depth severance in the Bone Spring, Applicant seeks to create a spacing unit and pool uncommitted interests in an interval of the Bone Spring formation defined as the top of the Second Bone Spring interval, at a stratigraphic equivalent of approximately 10,290' TVD, to the base of the Third Bone Spring interval, at a stratigraphic equivalent of approximately 11,631' TVD as observed in the well log for the West Copperline 29 State Com 1H (API No. 30-025-41313). Applicant seeks to initially dedicate the above-referenced horizontal spacing unit to the following proposed wells:

- PowerCaster Federal Com 501H, with a first take point in the NE4NE4 (Unit A) of Section 20 and a last take point in the SE4SE4 (Unit P) of Section 29;
- PowerCaster Federal Com 502H, with a first take point in the NW4NW4 (Unit D) of Section 20 and a last take point in the SW4SW4 (Unit M) of Section 29; and
- PowerCaster Federal Com 602H, with a first take point in the NE4NW4 (Unit C) of Section 20 and a last take point in the SE4SW4 (Unit N) of Section 29.

This proposed non-standard horizontal well spacing unit will overlap the following existing or proposed spacing units in the Bone Spring formation:

- A 160-acre spacing unit comprised of the E2E2 of Section 20, dedicated to the Stratocaster 20 Federal 4H (API No. 30-025-27051), operated by COG Operating;
- A 160-acre spacing unit comprised of the W2E2 of Section 20, dedicated to the Stratocaster 20 Federal 3H (API No. 30-025-41447) operated by COG Operating;
- A 160-acre spacing unit comprised of the E2W2 of Section 20, dedicated to the Stratocaster 20 Federal 2H (API No. 30-025-41381), operated by COG Operating;
- A 160-acre spacing unit comprised of the W2W2 of Section 20, dedicated to the Stratocaster 20 Federal 1H (API No. 30-025-37295), operated by COG Operating;
- A 160-acre spacing unit comprised of the E2E2 of Section 29, dedicated to the Broadcaster 29 Federal 4H (API No. 30-025-42954) operated by COG Operating;
- A 160-acre spacing unit comprised of the W2E2 of Section 29, dedicated to the Broadcaster 29 Federal 3H (API No. 30-025-41909) operated by COG Operating;
- A 160-acre spacing unit comprised of the E2W2 of Section 29, dedicated to the West Copperline 29 Fed State Com 1H (API No. 30-025-41313) and West Copperline 29 Fed State Com 3H (API No. 30-025-41536), operated by Paloma Permian Asset Co, LLC;
- A 160-acre spacing unit comprised of the W2W2 of Section 29, dedicated to the West Copperline 29 Fed State Com 2H (API No. 30-025-41640) and West Copperline 29 Fed State Com 4H (API No. 30-025-41802), operated by Paloma Permian Asset Co, LLC;
- A proposed non-standard 1280-acre spacing unit in a shallower interval of the Bone Spring formation underlying Sections 20 and 29 to be dedicated to Applicant's proposed PowerCaster Federal Com 301H, 302H, 303H, 401H, 402H, 403H, 404H wells targeting this shallower interval.

Also to be considered will be the cost of drilling and completing the wells and the allocation of the cost thereof, actual operating costs and charges for supervision, designation of Applicant as operator of the wells, and a 200% charge for risk involved in drilling the wells. The subject area is located approximately 20 miles northeast of Jal, New Mexico.
#00302031

67100754

00302031

HOLLAND & HART LLC
110 N GUADALUPE ST., STE. 1
SANTA FE, NM 87501

BEFORE THE OIL CONSERVATION DIVISION
Santa Fe, New Mexico
Exhibit No. D
Submitted by: COG Operating LLC
Hearing Date: July 29, 2025
Case No. 25441