

**STATE OF NEW MEXICO
DEPARTMENT OF ENERGY, MINERALS AND NATURAL RESOURCES
OIL CONSERVATION DIVISION**

**APPLICATION OF TASCOSA ENERGY
PARTNERS, LLC FOR COMPULSORY
POOLING, EDDY COUNTY, NEW MEXICO.**

CASE NO. 25619

EXHIBIT INDEX

Compulsory Pooling Checklist

Exhibit A	Self-Affirmed Statement of John Shoberg
A-1	Application & Proposed Notice of Hearing
A-2	C-102
A-3	Plat of Tracts, Tract Ownership, Applicable Lease Numbers, Unit Recapitulation, Pooled Parties
A-4	Sample Well Proposal Letter & AFE
A-5	Chronology of Contact
Exhibit B	Self-Affirmed Statement of Helder Alvarez
B-1	Regional Locator Map
B-2	Cross-Section Location Map
B-3	Subsea Structure Map
B-4	Structural Cross-Section
B-5	Stratigraphic Cross-Section
B-6	Gun Barrel Diagram
Exhibit C	Self-Affirmed Statement of Jaclyn M. McLean
C-1	Notice Letter to All Interested Parties Sent September 17, 2025
C-2	Postal Delivery Report
C-3	Electronic Return Receipts
C-4	Affidavit of Publication for September 23, 2025

COMPULSORY POOLING APPLICATION CHECKLIST	
ALL INFORMATION IN THE APPLICATION MUST BE SUPPORTED BY SIGNED AFFIDAVITS	
Case: 25619	APPLICANT'S RESPONSE
Hearing Date: October 9, 2025	
Applicant	Tascosa Energy Partners, LLC
Designated Operator & OGRID (affiliation if applicable)	Tascosa Energy Partners, LLC (OGRID No. 329748)
Applicant's Counsel:	Hardy McLean LLC
Case Title:	Application of Tascosa Energy Partners, LLC for Compulsory Pooling, Eddy County, New Mexico.
Entries of Appearance/Intervenors:	N/A
Well Family	Anna
Formation/Pool	
Formation Name(s) or Vertical Extent:	Bone Spring
Primary Product (Oil or Gas):	Oil
Pooling this vertical extent:	Bone Spring
Pool Name and Pool Code:	WC 20S26E6; BONE SPRING Pool (Code 98380)
Well Location Setback Rules:	Statewide
Spacing Unit	
Type (Horizontal/Vertical)	Horizontal
Size (Acres)	720-acres
Building Blocks:	quarter-quarter
Orientation:	West to East
Description: TRS/County	S/2 NE/4 and N/2 SE/4 of Section 7, the N/2 S/2 and S/2 N/2 of Section 8, and the S/2 NW/4, N/2 SW/4, SW/4 NE/4 and NW/4 SE/4 of Section 9, Township 20 South, Range 26 East, Eddy County.
Standard Horizontal Well Spacing Unit (Y/N), If No, describe <u>and</u> is approval of non-standard unit requested in this application?	Yes.
Other Situations	
Depth Severance: Y/N. If yes, description	N/A
Proximity Tracts: If yes, description	Yes, the completed interval of the Anna 79 Fee #203H well will be located within 330' of the quarter-quarter section line separating the S/2 N/2 and N/2 S/2 of Sections 7, 8, and 9 to allow for the creation of a 720-acre standard horizontal spacing unit.
Proximity Defining Well: if yes, description	Anna 79 Fee #203H
Applicant's Ownership in Each Tract	Exhibit A-3
Well(s)	
Name & API (if assigned), surface and bottom hole location, footages, completion target, orientation, completion status (standard or non-standard)	Add wells as needed
Well #1	Anna 79 Fee #203H (API No. Pending) SHL: 2,250' FSL & 1,771' FWL (Unit K), Section 7, T20S-R26E BHL: 2,648' FNL & 1,429' FEL (Unit J), Section 9, T20S-R26E Completion Target: Second Bone Spring (Approx. 5,900' TVD)
APE Capex and Operating Costs	
Drilling Supervision/Month \$	\$9,800
Production Supervision/Month \$	\$980
Justification for Supervision Costs	Exhibit A-4
Requested Risk Charge	200%
Notice of Hearing	
Proposed Notice of Hearing	Exhibit A-1
Proof of Mailed Notice of Hearing (20 days before hearing)	Exhibits C-1, C-2, C-3
Proof of Published Notice of Hearing (10 days before hearing)	Exhibit C-4
Ownership Determination	
Land Ownership Schematic of the Spacing Unit	Exhibit A-3
Tract List (including lease numbers and owners)	Exhibit A-3
If approval of Non-Standard Spacing Unit is requested, Tract List (including lease numbers and owners) of Tracts subject to notice requirements.	N/A
Pooled Parties (including ownership type)	Exhibit A-3
Unlocatable Parties to be Pooled	N/A

Ownership Depth Severance (including percentage above & below)	N/A
Joinder	
Sample Copy of Proposal Letter	Exhibit A-4
List of Interest Owners (ie Exhibit A of JOA)	Exhibit A-3
Chronology of Contact with Non-Joined Working Interests	Exhibit A-5
Overhead Rates In Proposal Letter	Exhibit A-4
Cost Estimate to Drill and Complete	Exhibit A-4
Cost Estimate to Equip Well	Exhibit A-4
Cost Estimate for Production Facilities	Exhibit A-4
Geology	
Summary (including special considerations)	Exhibit B
Spacing Unit Schematic	Exhibit B-1
Gunbarrel/Lateral Trajectory Schematic	Exhibit B-6
Well Orientation (with rationale)	Exhibit B
Target Formation	Exhibit B
HSU Cross Section	Exhibit B-2
Depth Severance Discussion	N/A
Forms, Figures and Tables	
C-102	Exhibit A-2
Tracts	Exhibit A-3
Summary of Interests, Unit Recapitulation (Tracts)	Exhibit A-3
General Location Map (including basin)	Exhibit B-1
Well Bore Location Map	Exhibit B-2
Structure Contour Map - Subsea Depth	Exhibit B-3
Cross Section Location Map (including wells)	Exhibit B-4
Cross Section (including Landing Zone)	Exhibit B-5
Additional Information	
Special Provisions/Stipulations	N/A
CERTIFICATION: I hereby certify that the information provided in this checklist is complete and accurate.	
Printed Name (Attorney or Party Representative):	Dana S. Hardy
Signed Name (Attorney or Party Representative):	/s/ Dana S. Hardy
Date:	10/2/2025

**STATE OF NEW MEXICO
DEPARTMENT OF ENERGY, MINERALS AND NATURAL RESOURCES
OIL CONSERVATION DIVISION**

**APPLICATION OF TASCOSA ENERGY PARTNERS,
LLC FOR COMPULSORY POOLING,
EDDY COUNTY, NEW MEXICO.**

CASE NO. 25619

**SELF-AFFIRMED STATEMENT
OF JOHN SHOBERG**

1. I am a Landman for Tascosa Energy Partners, LLC ("Tascosa") and am over 18 years of age. I have personal knowledge of the matters addressed herein, and am competent to provide this Self-Affirmed Statement. I have previously testified before the New Mexico Oil Conservation Division ("Division") and my credentials as an expert in petroleum land matters were accepted and made a matter of record.

2. Copies of Tascosa's application and proposed hearing notice are attached as **Exhibit A-1**.

3. None of the parties proposed to be pooled in this case indicated opposition to this matter proceeding by affidavit; therefore I do not expect any opposition at hearing.

4. Tascosa seeks to pool all uncommitted interests in the Bone Spring formation underlying a 720-acre, more or less, standard horizontal spacing unit comprised of the S/2 NE/4 and N/2 SE/4 of Section 7, the N/2 S/2 and S/2 N/2 of Section 8, and the S/2 NW/4, N/2 SW/4, SW/4 NE/4 and NW/4 SE/4 of Section 9, Township 20 South, Range 26 East, Eddy County, New Mexico ("Unit").

5. The Unit will be dedicated to the **Anna 79 Fee #203H** well ("Well"), which will be drilled from a surface hole location in the NE/4 SW/4 (Unit K) of Section 7 to a bottom hole location in the NW/4 SE/4 (Unit J) of Section 9.

6. The completed interval of the Well will be orthodox.

**Tascosa Energy Partners, LLC
Case No. 25619
Exhibit A**

7. **Exhibit A-2** contains the C-102 for the Well.
8. The completed interval of the Well will be located within 330' of the quarter-quarter section line separating the S/2 N/2 and N/2 S/2 of Sections 7, 8, and 9 to allow for the creation of a 720-acre standard horizontal spacing unit.
9. **Exhibit A-3** contains a plat identifying ownership by tract in the Unit. This exhibit also includes any applicable lease numbers, a unit recapitulation, and the interests Tascosa seeks to pool highlighted in yellow.
10. Tascosa has conducted a diligent search of all county public records, including phone directories and computer databases, as well as internet searches, to locate the interest owners it seeks to pool.
11. **Exhibit A-4** contains a sample well proposal letter and AFE sent to working interest owners for the Well. The estimated costs reflected on the AFE are fair and reasonable and comparable to the cost of other wells of similar depth and length drilled in the subject formation in the area.
12. In my opinion, Tascosa made a good-faith effort to reach voluntary joinder of uncommitted interests in the Well as indicated by the chronology of contact described in **Exhibit A-5**.
13. As operator of the Unit and the Well, Tascosa requests overhead and administrative rates of \$9,800 per month while the Well is being drilled and \$980 per month while the Well is producing. These rates are fair and are comparable to the rates charged by Tascosa and other operators in the vicinity.
14. The attached exhibits were either prepared by me or under my supervision or were compiled from company business records.

15. In my opinion, the granting of Tascosa's application would serve the interests of conservation, the protection of correlative rights, and the prevention of waste.

16. I understand this Self-Affirmed Statement will be used as written testimony in this case. I affirm that my testimony above is true and correct and is made under penalty of perjury under the laws of the State of New Mexico. My testimony is made as of the date next to my electronic signature below.

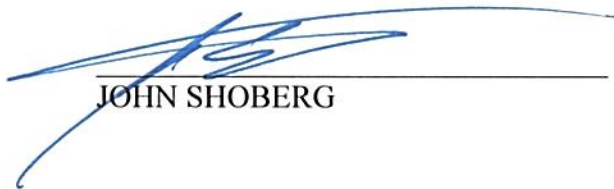

JOHN SHOBERG



Date

**STATE OF NEW MEXICO
DEPARTMENT OF ENERGY, MINERALS AND NATURAL RESOURCES
OIL CONSERVATION DIVISION**

**APPLICATION OF TASCOSA ENERGY PARTNERS,
LLC FOR COMPULSORY POOLING,
EDDY COUNTY, NEW MEXICO.**

CASE NO. 25619

APPLICATION

Pursuant to NMSA 1978, Section 70-2-17, Tascosa Energy Partners, LLC (OGRID No. 329748) (“Tascosa” or “Applicant”) applies for an order pooling all uncommitted interests in the Bone Spring formation underlying a 720-acre, more or less, standard horizontal spacing unit comprised of the S/2 NE/4 and N/2 SE/4 of Section 7, the N/2 S/2 and S/2 N/2 of Section 8, and the S/2 NW/4, N/2 SW/4, SW/4 NE/4 and NW/4 SE/4 of Section 9, Township 20 South, Range 26 East, Eddy County, New Mexico (“Unit”). In support of this application, Tascosa states the following:

1. Applicant is a working interest owner in the Unit and has the right to drill wells thereon.
2. The Unit will be dedicated to the **Anna 79 Fee #203H** well (“Well”), which will be drilled from a surface hole location in the NE/4 SW/4 (Unit K) of Section 7 to a bottom hole location in the NW/4 SE/4 (Unit J) of Section 9.
3. The completed interval of the Well will be orthodox.
4. The completed interval of the Well will be located within 330’ of the quarter-quarter section line separating the S/2 N/2 and N/2 S/2 of Sections 7, 8, and 9 to allow for the creation of a 720-acre standard horizontal spacing unit.

**Tascosa Energy Partners, LLC
Case No. 25619
Exhibit A-1**

5. Applicant has undertaken diligent, good-faith efforts to obtain voluntary agreements from all interest owners to participate in the drilling of the Well but has been unable to obtain voluntary agreements from all interest owners.

6. The pooling of uncommitted interests will avoid the drilling of unnecessary wells, prevent waste, and protect correlative rights.

7. In order to allow Applicant to obtain its just and fair share of the oil and gas underlying the subject lands, all uncommitted interests in the Unit should be pooled and Applicant should be designated as the operator of the Well and Unit.

WHEREFORE, Applicant requests that this application be set for hearing before an Examiner of the Oil Conservation Division on October 9, 2025, and, after notice and hearing as required by law, the Division enter an order:

- A. Pooling all uncommitted interests in the Unit;
- B. Approving the Well in the Unit;
- C. Designating Applicant as operator of the Unit and the Well to be drilled thereon;
- D. Authorizing Applicant to recover its costs of drilling, equipping and completing the Well;
- E. Approving the actual operating charges and costs of supervision while drilling and after completion, together with a provision adjusting the rates pursuant to the COPAS accounting procedures; and
- F. Imposing a 200% penalty for the risk assumed by Applicant in drilling and completing the Well against any working interest owner who does not voluntarily participate in the drilling of the Well.

Respectfully submitted,

HARDY McLEAN LLC

/s/ Dana S. Hardy

Dana S. Hardy

Jaclyn M. McLean

Jaime R. Kennedy

125 Lincoln Ave, Ste. 223

Santa Fe, NM 87501

Phone: (505) 230-4410

dhardy@hardymclean.com

jmclean@hardymclean.com

jkennedy@hardymclean.com

COUNSEL FOR TASCOSA ENERGY PARTNERS, LLC

Application of Tascosa Energy Partners, LLC for Compulsory Pooling, Eddy County, New Mexico. Applicant seeks an order pooling all uncommitted interests in the Bone Spring formation underlying 720-acre, more or less, standard horizontal spacing unit comprised of the S/2 NE/4 and N/2 SE/4 of Section 7, the N/2 S/2 and S/2 N/2 of Section 8, and the S/2 NW/4, N/2 SW/4, SW/4 NE/4 and NW/4 SE/4 of Section 9, Township 20 South, Range 26 East, Eddy County, New Mexico (“Unit”). The Unit will be dedicated to the **Anna 79 Fee #203H** well (“Well”), which will be drilled from a surface hole location in the NE/4 SW/4 (Unit K) of Section 7 to a bottom hole location in the NW/4 SE/4 (Unit J) of Section 9. The completed interval of the Well will be orthodox. The completed interval of the Well will be located within 330’ of the quarter-quarter section line separating the S/2 N/2 and N/2 S/2 of Sections 7, 8, and 9 to allow for the creation of a 720-acre standard horizontal spacing unit. Also to be considered will be the cost of drilling and completing the Well and the allocation of the cost, the designation of Applicant as operator of the Well, and a 200% charge for the risk involved in drilling and completing the Well. The Well is located approximately 12 miles from Carlsbad, New Mexico.

Note: No allowable will be assigned to this completion until all interests have been consolidated or a non-standard unit has been approved by the division.

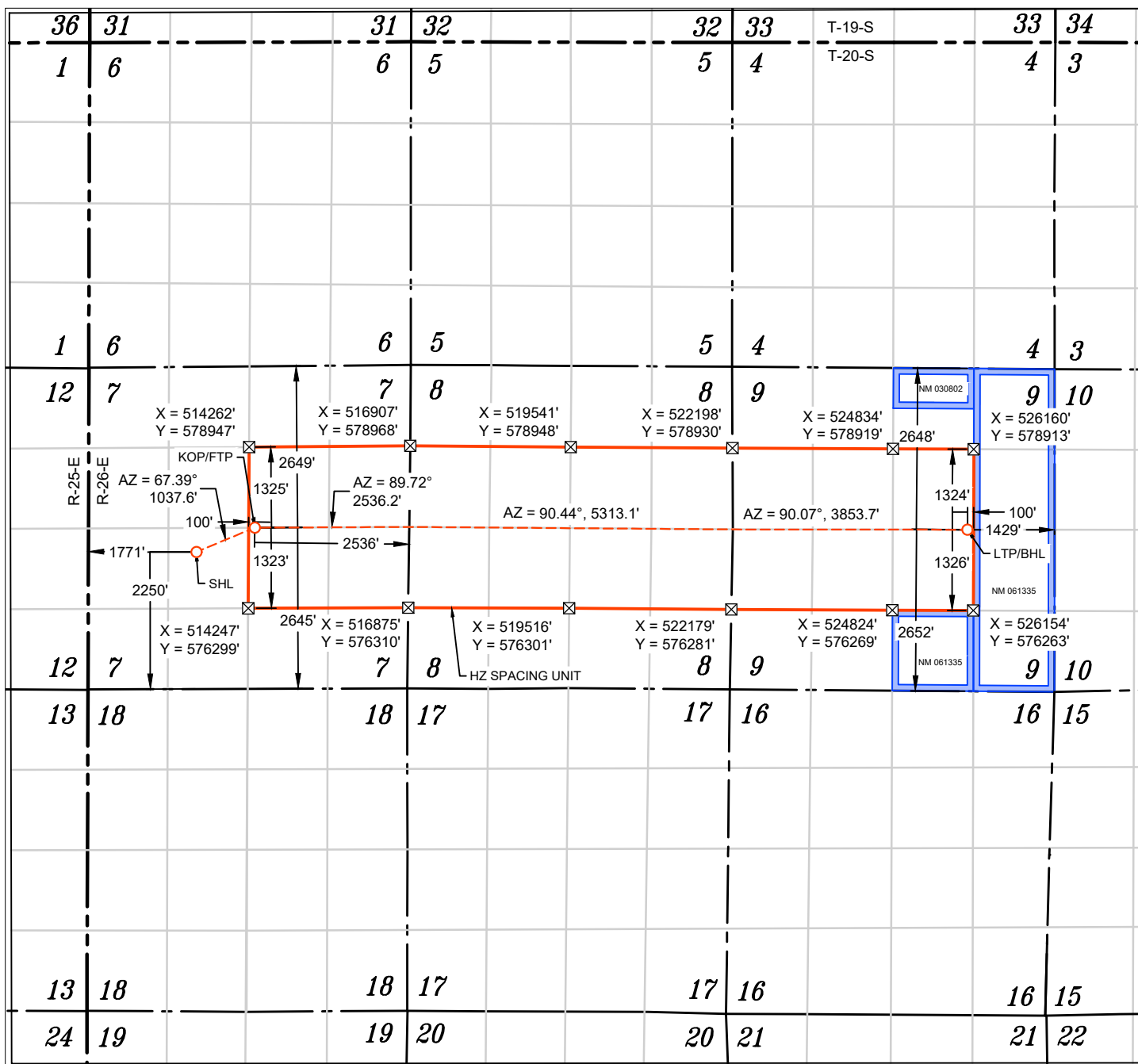

WELL NAME: ANNA 79 FEE #303H
ELEVATION: 3308'

NAD 83 (SHL) 2250' FSL & 1771' FWL
LATITUDE = 32.586809°
LONGITUDE = -104.424051°
NAD 27 (SHL)
LATITUDE = 32.586695°
LONGITUDE = -104.423533°
STATE PLANE NAD 83 (N.M. EAST)
N: 577223.67' E: 513396.71'
STATE PLANE NAD 27 (N.M. EAST)
N: 577163.14' E: 472217.93'

NAD 83 (KOP/FTP) 2645' FSL & 2536' FEL
LATITUDE = 32.587908°
LONGITUDE = -104.420942°
NAD 27 (KOP/FTP)
LATITUDE = 32.587794°
LONGITUDE = -104.420425°
STATE PLANE NAD 83 (N.M. EAST)
N: 577622.63' E: 514354.59'
STATE PLANE NAD 27 (N.M. EAST)
N: 577562.07' E: 473175.81'

NAD 83 (LTP/BHL) 2648' FNL & 1429' FEL
LATITUDE = 32.587837°
LONGITUDE = -104.382945°
NAD 27 (LTP/BHL)
LATITUDE = 32.587723°
LONGITUDE = -104.382429°
STATE PLANE NAD 83 (N.M. EAST)
N: 577589.40' E: 526057.39'
STATE PLANE NAD 27 (N.M. EAST)
N: 577528.67' E: 484878.54'

APPROXIMATE WELL BORE DISTANCE FROM FTP TO LTP	
SECTION 7	2,536.19'
SECTION 8	5,313.08'
SECTION 9	3,853.72'
TOTAL	11,702.99'

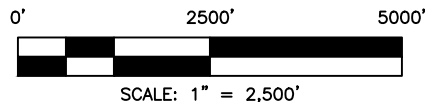

- ⊙ FOUND MONUMENT
- ⊠ CALC. CORNER
- SHL/ KOP/ FTP / PPP/ LTP / BHL
- WELLBORE
- HORIZONTAL SPACING UNIT
- STATE OIL & GAS LEASE
- BLM OIL & GAS LEASE

NOTES

- ALL COORDINATES, BEARINGS, AND DISTANCES CONTAINED HEREIN ARE GRID, BASED UPON THE NEW MEXICO STATE PLANE COORDINATES SYSTEM, NORTH AMERICAN DATUM 83, NEW MEXICO EAST (3001).
- THIS DOCUMENT IS BASED UPON AN ON THE GROUND SURVEY PERFORMED DURING JULY, 2025. CERTIFICATION OF THIS DOCUMENT IS ONLY TO THE LOCATION OF THIS EASEMENT IN RELATION TO RECORDED MONUMENT OF DEEDS PROVIDED BY THE CLIENT.
- ELEVATIONS MSL, DERIVED FROM G.N.S.S. OBSERVATION AND DERIVED FROM SAID ON-THE-GROUND SURVEY.

Anna 79 Fee Unit
S/2NE/4 & N/2SE/4 of Section 7, Township 20 South, Range 26 East
S/2N/2 & N/2S/2 of Section 8, Township 20 South, Range 26 East
S/2NW/4, N/2SW/4, SW/4NE/4 & NE/4SW/4 of Section 9, Township 20 South, Range 26 East

Eddy County, New Mexico

T20S/R26E Section 7: S/2NE/4 & N/2SE/4				T20S/R26E Section 8: S/2N/2 & N/2S/2				T20S/R26E Section 9: S/2NW/4, N/2SW/4, SW/4NE/4 & NE/4SW/4			
		Tract 1 Fee				Tract 4 Fee			Tract 6 Fee		
		Tract 2 Fee	Tract 3 Fee		Tract 5 Fee						

Tascosa Energy Partners, LLC
Case No. 25619
Exhibit A-3

Anna 79 Fee #203 Unit
S/2NE/4 & N/2SE/4 of Section 7, N/2S/2 & S/2N/2 of Section 8, & S/2NW/4, N/2SW/4, SW/4NE/4 & NW/4SE/4 of Section 9, Township 20 South, Range 26 East, Eddy County, New Mexico

Unit Working Interest – Unit Recapitulation

***Parties seeking to pool are highlighted in yellow.**

El Jugo Grande, LLC	28.1648%
Promontory Exploration, LP	8.6138%
Abo Petroleum, LLC	6.6800%
Estate of J.B. Cochran, deceased	5.5556%
Louise Bates Griffith a/k/a Louse Bates Harder	5.5556%
Cynthia Harper	5.5556%
El Jugo Grande, LLC	5.0000%
Seven Rivers Farms, Inc.	4.6296%
McCombs Exploration LLC	3.3333%
Sharbro Energy, LLC	3.0043%
Hanagan Petroleum Corporation	2.8541%
Longboat Energy Partners, LLC	2.2759%
Hutchings Oil Company	2.0029%
Tascosa Energy Partners, LLC	2.0000%
BAK Oil and Gas, LLC	1.6690%
801, LLC	1.5021%
Worrall Investment Corporation	1.4300%
Robert D. Henson	0.9259%
Chi Energy, Inc.	0.6700%
Hat Mesa Oil Company	0.6676%
Bursake, LLC	0.6612%

Axis Energy Corporation	0.6009%
Richard Forrest, Jr. & Susan Forrest Rev. Trust	0.6009%
Chi Energy Inc.	0.5556%
SCW Interiors, LLC	0.5007%
Estate of Irene Graham, Deceased	0.4630%
Hope McShaw	0.4630%
Coldwater Resources Company	0.4630%
John Lee Fuqua	0.4630%
Rhea Resources, LLC	0.4531%
Paleozoic, LLC	0.3338%
Bane Bigbie, Inc.	0.3004%
Catheryn Isabella Fenn Trust	0.3004%
Gannaway Oil, LLC	0.3004%
SR Primo Holdings	0.3004%
Wade Petroleum Corporation	0.2253%
Nancy Lee Mauk English	0.2055%
Bowtie Slash Energy, Inc.	0.1502%
Breedyk Enterprises, LLC	0.1502%
Flying W Resources, LLC	0.1226%
Glenn Humphrys	0.1005%
Donald Eugene Renfro	0.0769%
AmericaWest Resources, LLC	0.0256%
Dog Tired Investments LLC	0.0256%
Lani Investments, LLC	0.0256%
Carl Homer Blankenship	0.0036%
Frank Blankenship	0.0036%
Harold Haley	0.0036%
Mardella Greathouse	0.0036%

Mary M. Wheeler	0.0036%
Mike Wayner	0.0036%
Paul Haley	0.0036%
Pauline Rose	0.0036%
Ramona Jennings	0.0036%
Robert Hirohama	0.0036%
Rozeta Greenfield	0.0036%
Debra L. Smith	0.0009%
Frances Colleen Smith	0.0009%
William Powell	<u>0.0009%</u>
Total	100.0000%

Tract 1 - S/2NE/4 of Section 7-T20S-R26E

Cynthia Harper	50.0000%
Seven Rivers Farms, Inc.	41.6667%
Irene Graham, Deceased	4.1667%
Hope McShaw	<u>4.1667%</u>
Total	100.0000%

Tract 2 - NW/4SE/4 Section 7-T20S-R26E

Longboat Energy Partners, LLC	40.9668%
Robert D. Henson	16.6667%
El Jugo Grande, LLC (Arroyo Minerals)	16.6667%
Coldwater Resources Company	8.3333%
John Lee Fuqua	8.3333%
Nancy Lee Mauk English	3.6983%
Glenn Humphrys	1.8087%
Donald Eugene Renfro	1.3834%

AmericaWest Resources, LLC	0.4611%
Dog Tired Investments LLC	0.4611%
Lani Investments, LLC	0.4611%
Carl Homer Blankenship	0.0646%
Frank Blankenship	0.0646%
Harold Haley	0.0646%
Mardella Greathouse	0.0646%
Mary M. Wheeler	0.0646%
Mike Wayner	0.0646%
Paul Haley	0.0646%
Pauline Rose	0.0646%
Ramona Jennings	0.0646%
Robert Hirohama	0.0646%
Rozeta Greenfield	0.0646%
Debra L. Smith	0.0163%
Frances Colleen Smith	0.0163%
William Powell	<u>0.0163%</u>
Total	100.0000%

Tract 3 - NE/4SE/4 Section 7-T20S-R26E

El Jugo Grande, LLC	90.0000%
Chie Energy, Inc.	<u>10.0000%</u>
Total	100.0000%

Tract 4 – S/2N/2, NW/4SW/4 & N/2SE/4 Section 8-T20S-R26E**S/2NW/4, NW/4SW/4 & NE/4SE/4 Section 9-T20S-R26E**

El Jugo Grande, LLC	41.8583%
---------------------	----------

Promontory Exploration, LP	12.9207%
Abo Petroleum, LLC	10.0200%
McCombs Exploration LLC	5.0000%
Sharbro Energy, LLC	4.5064%
Hanagan Petroleum Corporation	4.2811%
Hutchings Oil Company	3.0043%
BAK Oil and Gas, LLC	2.5036%
801, LLC	2.2532%
Worrall Investment Corporation	2.1450%
Tascosa Energy Partners, LLC	2.0000%
Chi Energy, Inc.	1.0050%
Hat Mesa Oil Company	1.0014%
Bursake, LLC	0.9918%
Axis Energy Corporation	0.9013%
Richard Forrest, Jr. & Susan Forrest Rev. Trust	0.9013%
SCW Interiors, LLC	0.7511%
Rhea Resources, LLC	0.6796%
Paleozoic, LLC	0.5007%
Bane Bigbie, Inc.	0.4506%
Catheryn Isabella Fenn Trust	0.4506%
Gannaway Oil, LLC	0.4506%
SR Primo Holdings	0.4506%
Wade Petroleum Corporation	0.3380%
Bowtie Slash Energy, Inc.	0.2253%
Breedyk Enterprises, LLC	0.2253%
Flying W Resources, LLC	<u>0.1839%</u>
Total	100.0000%

Tract 5 - NE/4SW/4 Section 8-T20S-R26E

Estate of J.B. Cochran	<u>100.0000%</u>
------------------------	------------------

Total	100.0000%
--------------	------------------

Tract 6 - NE/4SE/4 & SW/4NE/4Section 9-T20S-R26E

Louise Bates Griffith a/k/a Louse Bates Harder	50.0000%
--	----------

El Jugo Grande, LLC	20.9292%
---------------------	----------

Promontory Exploration, LP	6.4604%
----------------------------	---------

Abo Petroleum, LLC	5.0100%
--------------------	---------

McCombs Exploration LLC	2.5000%
-------------------------	---------

Sharbro Energy, LLC	2.2532%
---------------------	---------

Hanagan Petroleum Corporation	2.1406%
-------------------------------	---------

Hutchings Oil Company	1.5021%
-----------------------	---------

BAK Oil and Gas, LLC	1.2518%
----------------------	---------

801, LLC	1.1266%
----------	---------

Worrall Investment Corporation	1.0725%
--------------------------------	---------

Tascosa Energy Partners, LLC	1.0000%
------------------------------	---------

Chi Energy, Inc.	0.5025%
------------------	---------

Hat Mesa Oil Company	0.5007%
----------------------	---------

Bursake, LLC	0.4959%
--------------	---------

Axis Energy Corporation	0.4506%
-------------------------	---------

Richard Forrest, Jr. & Susan Forrest Rev. Trust	0.4506%
---	---------

SCW Interiors, LLC	0.3755%
--------------------	---------

Rhea Resources, LLC	0.3398%
---------------------	---------

Paleozoic, LLC	0.2504%
----------------	---------

Bane Bigbie, Inc.	0.2253%
-------------------	---------

Catheryn Isabella Fenn Trust	0.2253%
------------------------------	---------

GANNAWAY OIL, LLC	0.2253%
SR Primo Holdings	0.2253%
Wade Petroleum Corporation	0.1690%
Bowtie Slash Energy, Inc.	0.1127%
Breedyk Enterprises, LLC	0.1127%
Flying W Resources, LLC	<u>0.0920%</u>
Total	100.0000%

El Jugo Grande

901 W. Missouri Ave.
Midland, TX 79701
(432) 695-6970

209 W. 2nd St., Suite 150
Fort Worth, TX 76102
(817) 715-9094

August 7, 2025

VIA CERTIFIED MAIL, RETURN RECEIPT
ARTICLE # 9589071052700695571837

801, LLC
Attn: Justin McClelland
P.O. Box 900
Artesia, NM 88211-0900

RE: WELL PROPOSAL

Anna 79 Fee #203H

S/2NE/4 & N/2SE/4 of Section 7, N/2S/2 & S/2N/2 of Section 8 & S/2NW/4,
N/2SW/4, SW/4NE/4 & NW/4SE/4 of Section 9, Township 20 South, Range 26
East, Eddy County, New Mexico

Dear Working Interest Owner,

El Jugo Grande, LLC (herein referred to as "EJG"), we would like to inform you that EJG proposes to drill the following well located in the referenced sections in order to sufficiently and effectively test the 2nd Bone Spring formation. Further, the details and specifications of the herein proposed 2nd Bone Spring well are as follows:

Well Name:	Anna 79 #203H
Approx. Surface Location:	2,250' FSL & 1,771' FWL (K-7-20S-26E)
Approx. Terminus:	2,640' FSL & 1,420' FEL (J-9-20S-26E)
Objective:	2 nd Bone Springs formation
Approx. Total Vertical Depth:	5,900'
Approx. Total Measured Depth:	17,700'
Dry Hole Costs:	\$3,133,837.00
Completed Well Costs:	\$7,010,441.00
Total Well Costs:	\$10,144,279 (Includes total CTB Expansion)

Enclosed, please find in duplicate our detailed AFE for your review. Should you wish to participate in EJG's proposed test, please signify your acceptance by returning (1) copy of each executed election ballot and (1) copy of each executed AFE, along with your well information requirements. If you do not wish to participate in the proposed wells, EJG is

Tascosa Energy Partners, LLC
Case No. 25619
Exhibit A-4

willing to discuss an acquisition of your interest, subject to final management approval and contingent on reaching mutually satisfactory terms.

Should you have any further questions, please contact me at 432-695-6970 or jshoberg@tascosaep.com.

Sincerely,

A handwritten signature in blue ink, consisting of several overlapping, sweeping strokes that form a stylized representation of the name John Shoberg.

John Shoberg
Land Manager

WELL PROPOSAL

Anna 79 Fee #203H

**T20S-R26E, Eddy County, New Mexico
S/2NE/4 & N/2SE/4 Section 7, N/2S/2 & S/2N/2 of Section 8 and S/2NW/4,
N/2SW/4, SW/4NE/4 & NW/4SE/4 of Section 9**

_____ Elects to participate in the drilling and completion of the well.

OR

_____ Does NOT elect to participate in the drilling and completion of the well.

By: _____

Printed Name: _____

Company Name (if applicable): _____

Date: _____

Email Address: _____

WELL PROPOSAL

Anna 79 Fee #203H

**T20S-R26E, Eddy County, New Mexico
S/2NE/4 & N/2SE/4 Section 7, N/2S/2 & S/2N/2 of Section 8 and S/2NW/4,
N/2SW/4, SW/4NE/4 & NW/4SE/4 of Section 9**

_____ Elects to participate in the drilling and completion of the well.

OR

_____ Does NOT elect to participate in the drilling and completion of the well.

By: _____

Printed Name: _____

Company Name (if applicable): _____

Date: _____

Email Address: _____

Tascosa Energy Partners, LLC.

AUTHORIZATION FOR EXPENDITURE

7/31/2025

AFE Title/Number

Well Name & No: Anna 79 Fee #203H

Field: Avalon Bone Spring

State: New Mexico

County: Eddy

Exploratory: Development: X Oil: X GAS

Proposed Formation: 2nd BS (2.25 mile) Proj TD: ± 17,700' MD; ± 5,900' TVD

Description:

INTANGIBLE COSTS	BCP Dry Hole	ACP Completion	TOTAL COST
TITLE OPINION/CURATIVE/LAND/LEGAL	\$27,500	\$0	\$27,500
SURVEYING / STAKE LOCATION	\$20,000	\$0	\$20,000
CONTRACT SERVICES & EQUIPMENT	\$0	\$185,000	\$185,000
ROADS, LOCATION, PITS, LINERS, DAMAGES	\$200,000	\$20,000	\$220,000
DRILLING - FOOTAGE or TURNKEY	\$0		\$0
DRILLING/COMPLETION - DAYWORK	\$600,000	\$0	\$600,000
MIRU/RDMO	\$375,000		\$375,000
DRILLING MUD, CHEMICALS,COMPLETION FLUID	\$282,000	\$413,000	\$695,000
WATER	\$28,500	\$479,614	\$508,114
BITS	\$80,000	\$0	\$80,000
DIRECTIONAL DRILLING SERVICES	\$306,000	\$0	\$306,000
FUEL	\$100,000	\$64,000	\$164,000
CEMENT-MISCELLANEOUS	\$0	\$0	\$0
CEMENTING SURFACE	\$60,000		\$60,000
CEMENTING INTERMEDIATE	\$30,000		\$30,000
CEMENTING PRODUCTION	\$0	\$150,000	\$150,000
TUBULAR SERVICES INSPECT AND TOOLS	\$45,000	\$10,000	\$55,000
CASING CREWS / PU LD MACHINE	\$20,000	\$40,000	\$60,000
TESTING; DST & COMPLETION	\$0		\$0
OPEN HOLE LOGGING / CORES	\$15,000		\$15,000
MUD LOGGING	\$20,400		\$20,400
WELDING _ CONTRACT LABOR	\$30,000	\$127,200	\$157,200
EQUIPMENT RENTAL	\$190,500	\$182,000	\$372,500
CLOSED LOOP MUD SYSTEM	\$68,000		\$68,000
TRUCKING, TRANSPORTATION, FORKLIFT	\$35,000	\$51,000	\$86,000
COMPLETION UNIT/REVERSE PKG/Snubbing unit		\$198,000	\$198,000
FORMATION STIMULATION		\$1,888,000	\$1,888,000
WIRELINE SERVICES	\$0	\$295,000	\$295,000
GEOLOGIC / ENGINEERING/SERVICES	\$0	\$15,000	\$15,000
WELL SITE CONSULTANT	\$90,000	\$108,000	\$198,000
INSURANCE	\$5,000	\$0	\$5,000
MISCELLANEOUS	\$26,000	\$0	\$26,000
MUD DISPOSAL/HAULOFF	\$51,000	\$50,000	\$101,000
PLUGGING		\$0	\$0
SPECIAL SERVICES	\$21,000	\$1,200	\$22,200
PERMANENT PACKER/CASING PACKERS		\$0	\$0
ADMINISTRATIVE OVERHEAD	\$9,800	\$9,800	\$19,600
CONTINGENCY 7%	\$191,499	\$300,077	\$491,576
TOTAL INTANGIBLES	\$2,927,199	\$4,586,891	\$7,514,090

TANGIBLE COSTS	BCP	ACP	
CONDUCTOR CASING	\$26,500		\$26,500
SURFACE CASING	\$58,620		\$58,620
ELECTRIFYING WELL	\$0	\$300,000	\$300,000
INTERMEDIATE CASING	\$73,000	\$0	\$73,000
LINER HANGER & ACCESSORIES	\$0	\$0	\$0
COMPRESSOR		\$20,000	\$20,000
CONSTRUCTION LABOR CAPITALIZED		\$0	\$0
PRODUCTION CASING / LINER		\$451,350	\$451,350
METER STATION _Metering equipment_ LACT		\$40,000	\$40,000
TUBING		\$38,750	\$38,750
WELLHEAD EQUIPMENT	\$20,000	\$25,000	\$45,000
SURFACE LIFT & PRIME MOVER & Engines		\$10,000	\$10,000
RODS AND PUMP-subsurface equipment		\$200,000	\$200,000
PACKERS, BP'S, DOWNHOLE EQUIPMENT "Sales"	\$0	\$68,400	\$68,400
GAS PRODUCTION EQUIPMENT		\$0	\$0
SEPARATOR, Free Wtr KO		\$43,000	\$43,000
VALVES, CONNECTIONS	\$5,000	\$0	\$5,000
TANKS (Water and Production)		\$172,000	\$172,000
DEHYDRATORS/COALESCERS		\$0	\$0
PIPELINES OIL, WTR, GAS & FLOWLINES		\$510,000	\$510,000
MISCELLANEOUS EQUIPMENT	\$0	\$276,500	\$276,500
TREE & PUMPING TEE EQUIPMENT		\$15,000	\$15,000
HEATER/HTRTRTR/COMBUSTER		\$45,000	\$45,000
Float Equipment, Casing Hardware, ECP, Stg tools	\$10,000	\$50,000	\$60,000
CONTINGENCY (7%)	\$13,518	\$158,550	\$172,068
TOTAL TANGIBLES	\$206,638	\$2,423,550	\$2,630,188
SINGLE HZ WELL + CTB	\$3,133,837	\$7,010,441	\$10,144,279
D&C ONLY			\$8,426,929
CTB & PIPELINES TOTAL			\$1,717,350

Extra Expense: Insurance

☐

I elect to be covered under the operator's well control insurance and pay my proportionate share of the premium.

☐

I elect to purchase my own well control insurance.

Tascosa Energy Partners, LLC

We approve / disapprove:

Company:

By:

Printed Name:

Company	Date Mailed	Date Signed	30 Days	Participate	Non-Consent	Non-Participating	Comments
Cynthia Harper, SSP 5616 Doliver Drive Houston, TX 77056	8/12/2025	8/21/2025	9/11/2025			✓	Negotiating a lease
Seven Rivers Farms, LLC P.O. Box 1598 Carlsbad, NM 88221							In Process of Leasing
Irene Graham, Dec'd c/o H. Gil Moutray 1401 Lera Circle Carlsbad, NM 88220	8/12/2025	8/16/2025	9/11/2025				
Hope Mashaw c/o H. Gil Moutray 1401 Lera Circle Carlsbad, NM 88220	8/12/2025	Returned - Unable To Forward	9/11/2025				
Promontory Exploration, LP 400 W. Wall St, Suite 300 Midland, TX 79701	8/12/2025	No Date - Signed For By Cathy Pearce	9/11/2025				Reviewing proposal
801, LLC P.O. Box 900 Artesia, NM 88211-0900	8/12/2025	8/18/2025	9/11/2025	✓			
Axis Energy Corporation P.O. Box 2107 Rowsett, NM 88202-2107	8/12/2025	8/19/2025	9/11/2025				Reviewing proposal
Bane Bigbie, Inc P.O. Box 998 Ardmore, OK 73402	8/12/2025	No Date - Signed For By Bane Bigbie	9/11/2025				Reviewing proposal
Bowtie Slash Energy, Inc 3410 Kessler Place Roswell, NM 88201	8/12/2025	8/18/2025	9/11/2025	✓			
Breedyk Enterprises, LLC P.O. Box 2844 Rowsett, NM 88202-2844	8/12/2025	8/20/2025	9/11/2025				Reviewing proposal
Catheryn Isabella Fenn Trust P.O. Box 1757 Rowsett, NM 88202-1757	8/12/2025	8/19/2025	9/11/2025				Reviewing proposal
CH Energy, Inc P.O. Box 1700 Midland, TX 79702							Acquired portion of this interest. Will likely participate in the remainder.
Gannaway Oil, LLC P.O. Box 417 Rowsett, NM 88201	8/12/2025	8/18/2025	9/11/2025				Reviewing proposal
Hanagan Petroleum Corporation P.O. Box 1737 Roswell, NM 88202-1737	8/12/2025	8/18/2025	9/11/2025				Reviewing proposal
Richard J Forrest & Susan Forrest Revocable Trust 208 Dickson Land Carlsbad, NM 88220	8/12/2025		9/11/2025				
Sharbro Energy, LLC P.O. Box 840 Artesia, NM 88211-0840	8/12/2025	No Date - Signed For By Alyssa M.	9/11/2025				Reviewing proposal
Sierra-Golf Investments, LLC 3402 Monte Vista Dr. Austin, TX 76791		No Date - Signed For By David Goodman	9/11/2025				
199 Stoney Creek Dr. Houston, TX 77024	8/12/2025				✓		Acquired this interest
SR Primo Holdings, LLC 1002 Camino Del Llano Artesia, NM 88210-9366	8/12/2025	8/16/2025	9/11/2025				Reviewing proposal
Wade Petroleum Corporation 9 Broken Arrow Place Sandia Park, NM 87047	8/12/2025	8/18/2025	9/11/2025				Reviewing proposal
Worrall Investment Corporation P.O. Box 1834 Roswell, NM 88202-1834	8/12/2025	8/18/2025	9/11/2025				Reviewing proposal
Abo Petroleum, LLC P.O. Box 900 Artesia, NM 88211-0900	8/12/2025	8/18/2025	9/11/2025	✓			Reviewing proposal
BAK Oil & Gas, LLC P.O. Box 560430 The Colony, TX 750156-0430	8/12/2025	8/19/2025	9/11/2025	✓			Reviewing proposal
Bursake, LLC P.O. Box 51407 Midland, TX 79710	8/12/2025	Has Not Responded	9/11/2025				Reviewing proposal
Flying W Resources, LLC P.O. Box 50546 Midland, TX 79710	8/12/2025	Has Not Responded	9/11/2025				Reviewing proposal
Hat Mesa Oil Company P.O. Box 20339 Albuquerque, NM 87154	8/12/2025	8/18/2025	9/11/2025				Reviewing proposal
Hutchings Oil Company P.O. Box 20339 Albuquerque, NM 87154	8/12/2025	8/25/2025	9/11/2025				Reviewing proposal
McCombs Exploration, LLC 755 E. Mulberry Ave, Ste 600 San Antonio, TX 78212	8/12/2025	8/18/2025	9/11/2025	✓			
Paleozoic, LLC 3608 Meadowridge Lane Midland, TX 79707	8/12/2025	8/14/2025	9/11/2025				Reviewing proposal
Rhea Resources, LLC P.O. Box 3624 Midland, TX 79702	8/12/2025	8/20/2025	9/12/2025				Reviewing proposal
SCW Interiors, LLC P.O. Box 20339 Albuquerque, NM 87154	8/12/2025	8/18/2025	9/11/2025				Reviewing proposal
Longboat Energy Partners, LLC 2101 W. Wadley St., Suite 202 Midland, TX 79705	8/12/2025	No Date - Can't Read Signature	9/11/2025				Negotiating a lease
AmericaWest Resources, LLC P.O. Box 3383 Midland, TX 79705	8/12/2025	No Date - Signed For By Francis Woodard	9/11/2025				
Coldwater Resources Company P.O. Box 50593 Midland, TX 79710	8/12/2025	8/15/2025	9/11/2025				Negotiating a lease
Dog Tired Investments LLC 1118 Breckenridge Drive Midland, TX 79705	8/12/2025		9/11/2025				Negotiating a lease
Donald Eugene Rentro P.O. Box 53 Austin, Nevada 89310	8/12/2025	Returned - Unable To Forward	9/11/2025				
John Lee Fuqua 6023 County Road 210 Poncha Springs, Colorado 81201	8/12/2025	9/3/2025 Julie Sinclair	9/11/2025				Receieved call and wil negotiate a leas
Lani Investments, LLC P.O. Box 10458 Midland, TX 79702	8/12/2025	No Date & No Signature	9/11/2025				Negotiating a lease
Nancy Lee Mauk English 9301 Winston Avenue Lubbock, TX 79494	8/12/2025	No Date - Signed For By Nancy English	9/11/2025				
Louise Bates Griffith (Louise Bates Harder) 2825 Kirkham St. San Francisco, CA 94122	8/12/2025		9/11/2025				unable to locate

**STATE OF NEW MEXICO
DEPARTMENT OF ENERGY, MINERALS AND NATURAL RESOURCES
OIL CONSERVATION DIVISION**

**APPLICATION OF TASCOSA ENERGY PARTNERS,
LLC FOR COMPULSORY POOLING,
EDDY COUNTY, NEW MEXICO.**

CASE NO. 25619

**SELF-AFFIRMED STATEMENT
OF HELDER ALVAREZ**

1. I am a Geological Consultant with Tascosa Energy Partners, LLC (“Tascosa”), and am over 18 years of age. I have personal knowledge of the matters addressed herein, and am competent to provide this Self-Affirmed Statement. I have previously testified before the New Mexico Oil Conservation Division (“Division”) and my credentials as an expert in petroleum geology were accepted and made a matter of record.

2. I am familiar with the geological matters that pertain to the above-referenced case.

3. **Exhibit B-1** is a regional locator map that identifies the Anna project area for the Bone Spring horizontal spacing unit that is the subject of this application.

4. **Exhibit B-2** is a cross-section location map for the proposed horizontal spacing units within the Bone Spring formation. The approximate wellbore path for the **Anna 79 Fee #203H** proposed well (“Well”) is represented by a dashed line. Existing producing wells in the targeted interval are represented by solid orange lines. This map identifies the cross-section running from A-A’ and includes the cross-section well names.

5. **Exhibit B-3** is a Subsea Structure map of the Bone Spring formation in TVD subsea with a contour interval of 50 ft. The map identifies the approximate wellbore path for the proposed Well with an orange line. It also identifies the location of the cross-section running from A-A’ in proximity to the proposed Well. The data points are indicated by red triangles. The map

**Tascosa Energy Partners, LLC
Case No. 25619
Exhibit B**

demonstrates the formation is gently dipping to the southwest in this area. I do not observe any faulting, pinch-outs, or geologic impediments to developing the targeted intervals with horizontal wells.

6. **Exhibit B-4** is a structural cross-section that identifies two wells penetrating the targeted interval, which I used to construct a structural cross-section from A to A'. The structural cross section from north to south shows the regional dip to the East-Southeast for the Bone Spring. I used these well logs because they penetrate the targeted interval, are of good quality, and are representative of the geology in the area. The target zone for the proposed Well is the 2nd Bone Spring Sand interval of the Bone Spring formation, which is consistent across the unit. The approximate well-path for the proposed Well is indicated by a dashed line to be drilled from west to east across the units.

7. **Exhibit B-5** is a stratigraphic cross-section from A to A' using the representative wells identified on Exhibit B-4. It contains gamma ray, resistivity, and porosity logs. The cross section is oriented from north to south and is hung on the top of the 3rd Bone Spring formation. The proposed landing zone for the Well is labeled on the exhibit. The approximate well-path for the proposed Well is indicated by a dashed orange line to be drilled from west to east across the units. This cross-section demonstrates the target interval is continuous across the Unit.

8. **Exhibit B-6** is a gun barrel diagram that shows the proposed Well in the Bone Spring formation. The spacing unit is defined by a purple box and is labeled with the well number.

9. In my opinion, a laydown orientation for the Well is appropriate to properly develop the subject acreage because of consistent rock properties throughout the Unit and the preferred fracture orientation in this portion of the trend.

10. Based on my geologic study of the area, the targeted interval underlying the Unit is suitable for development by horizontal wells and the tracts comprising the Unit will contribute more or less equally to the production of the Well.

11. In my opinion, the granting of Tascosa's application will serve the interests of conservation, the protection of correlative rights, and the prevention of waste.

12. The exhibits attached hereto were either prepared by me or under my supervision or were compiled from company business records.

13. I understand this Self-Affirmed Statement will be used as written testimony in this case. I affirm my testimony above is true and correct and is made under penalty of perjury under the laws of the State of New Mexico. My testimony is made as of the date identified next to my signature below.



HELDER ALVAREZ



Date

Regional Locator Map

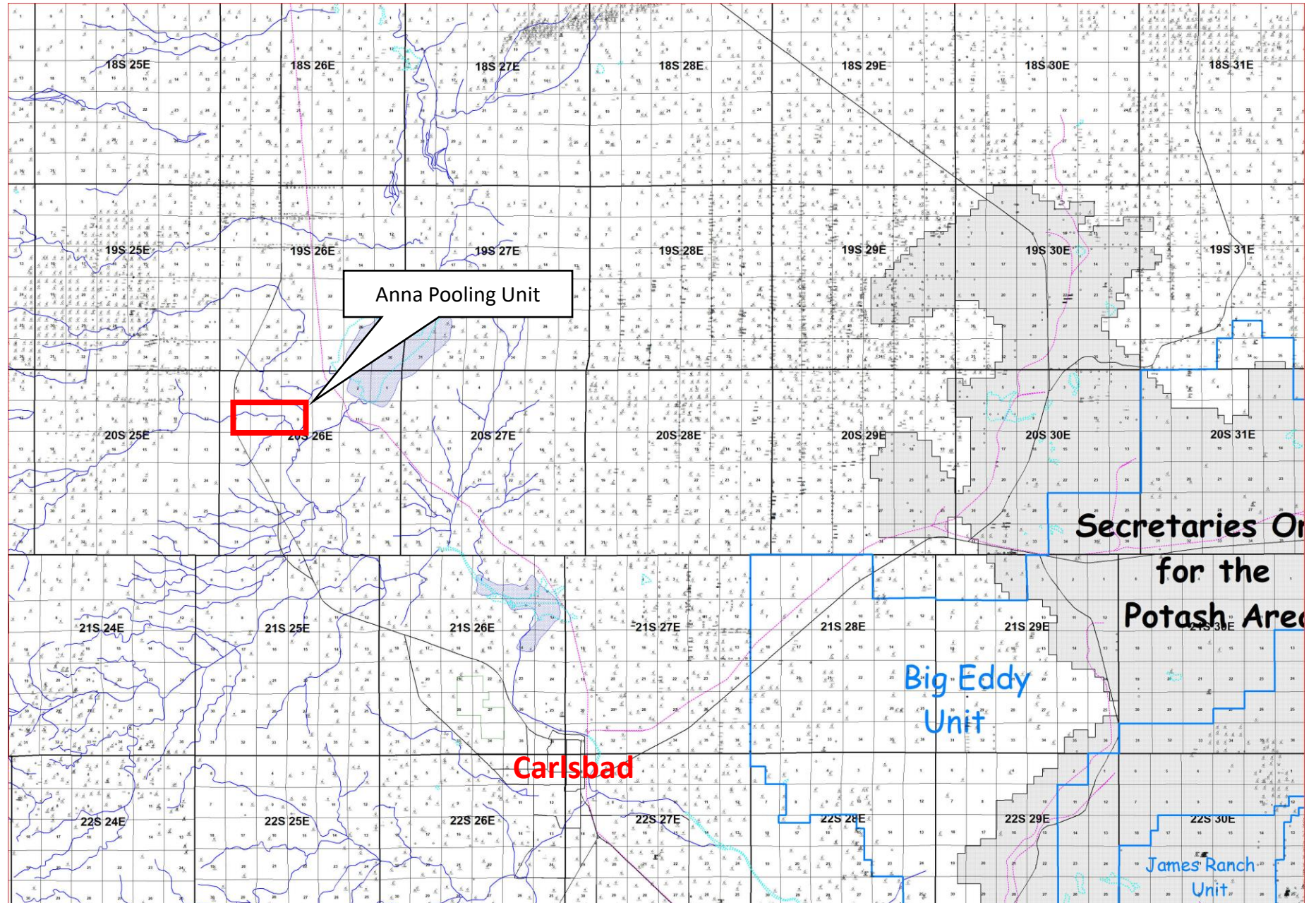

Tascosa Energy Partners, LLC
Case No. 25619
Exhibit B-1

Cross Section Locator Map

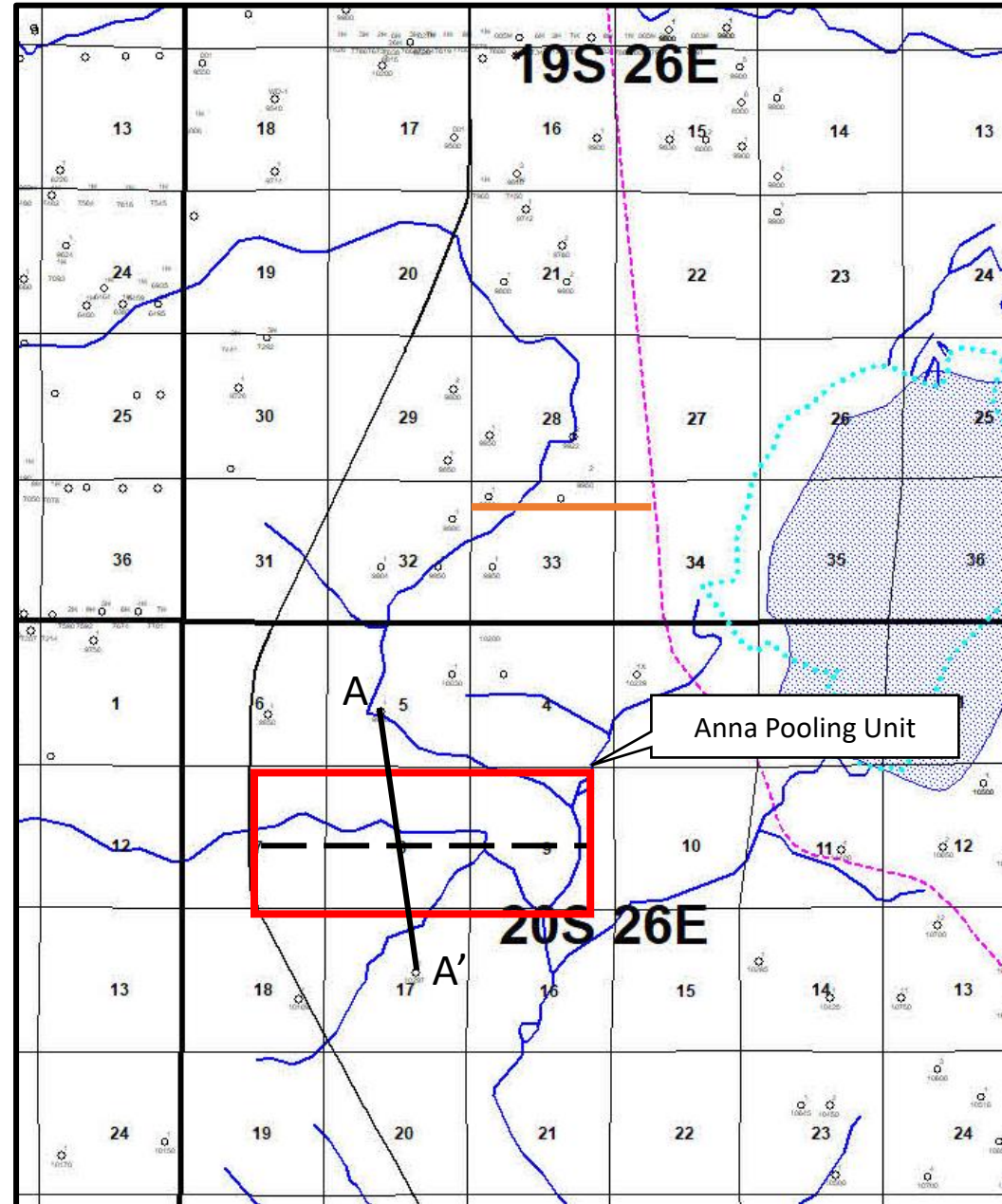

Tascosa Energy Partners, LLC
Case No. 25619
Exhibit B-2

3rd Bone Spring Carbonate Structure Map

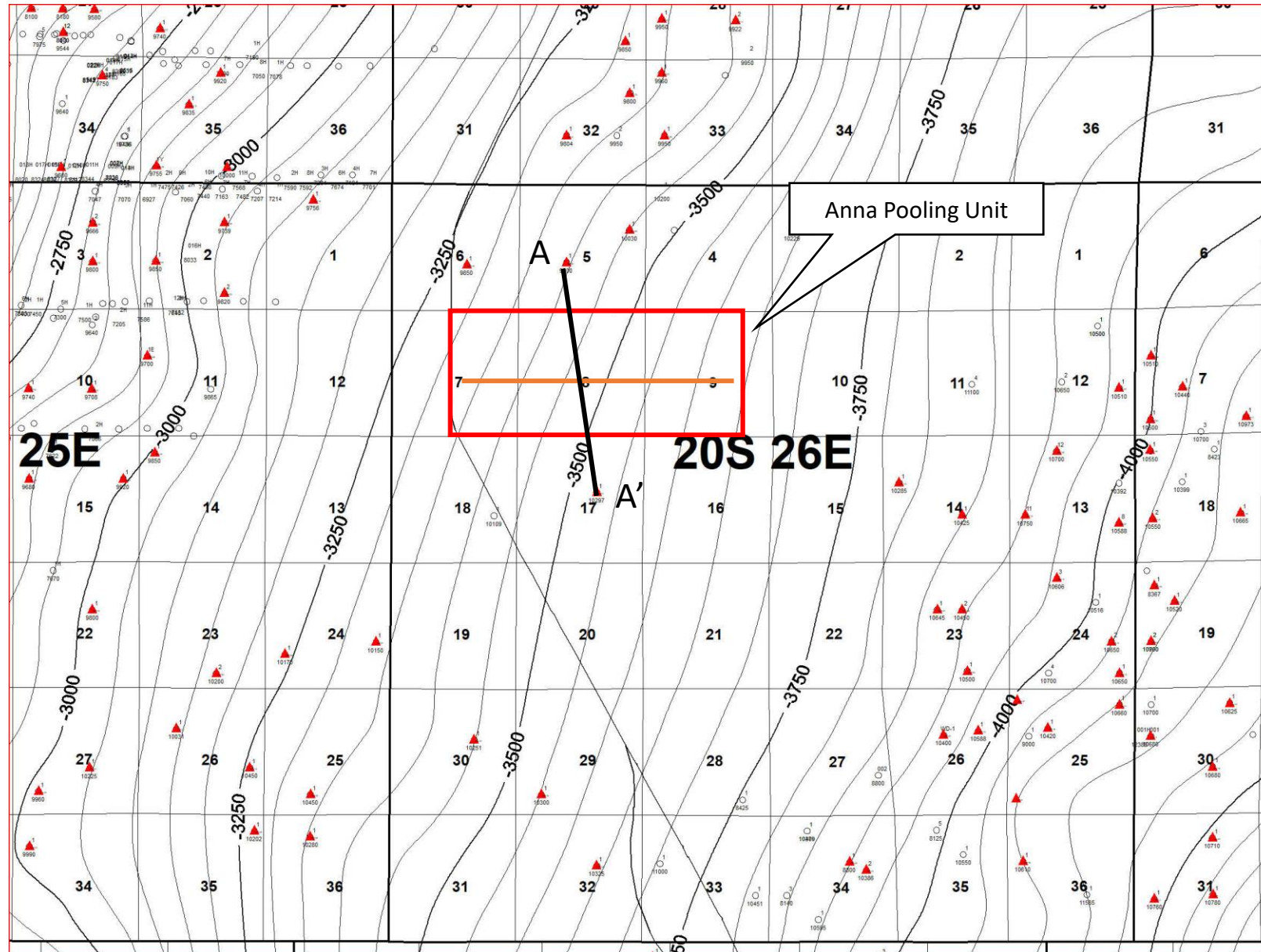

Tascosa Energy Partners, LLC
Case No. 25619
Exhibit B-3

Structural Cross Section A - A'

Structural Cross Section



Tascosa Energy Partners, LLC
Case No. 25619
Exhibit B-4

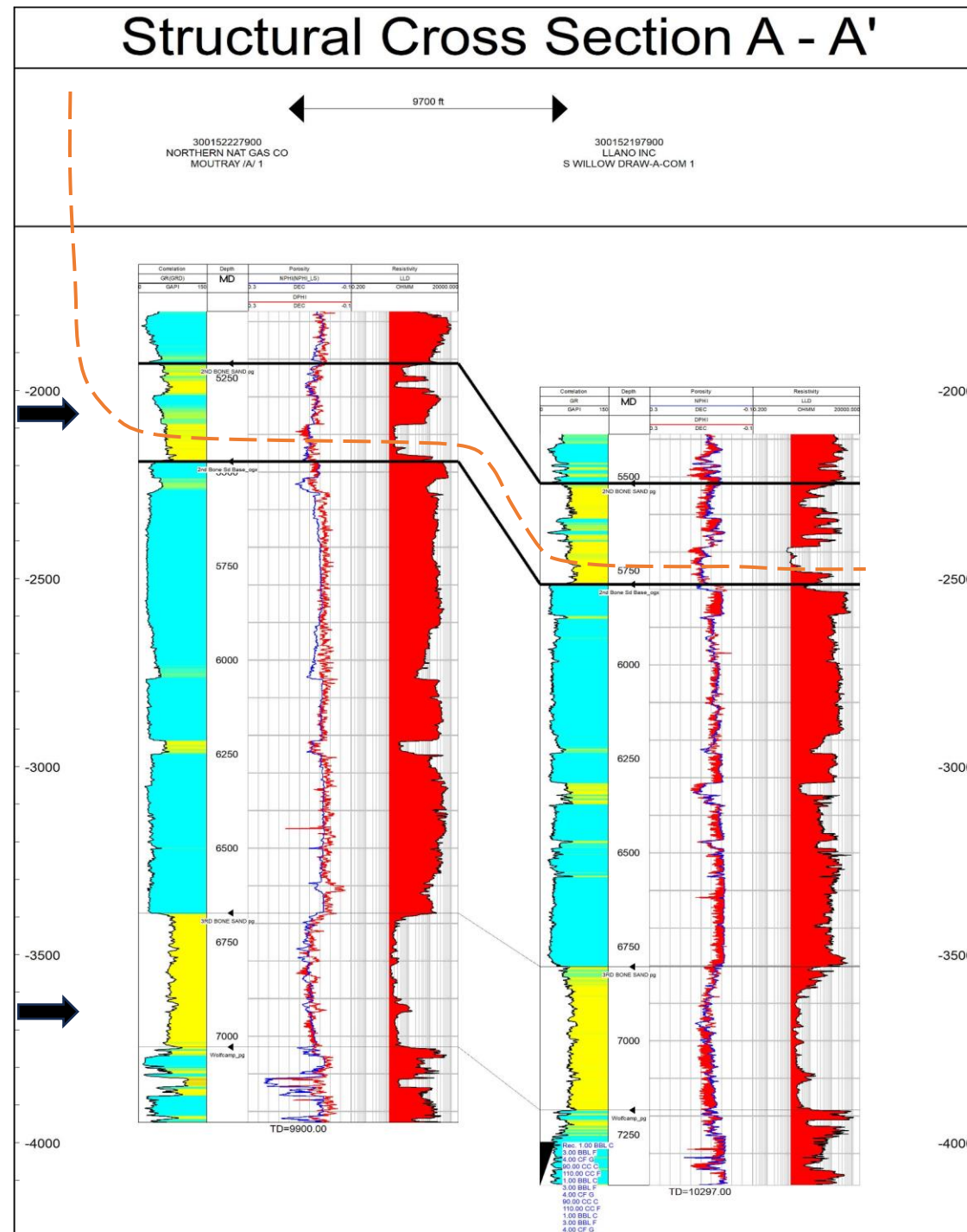

Structural Cross Section A - A'

Stratigraphic Cross Section

2nd Bone Spring Sand

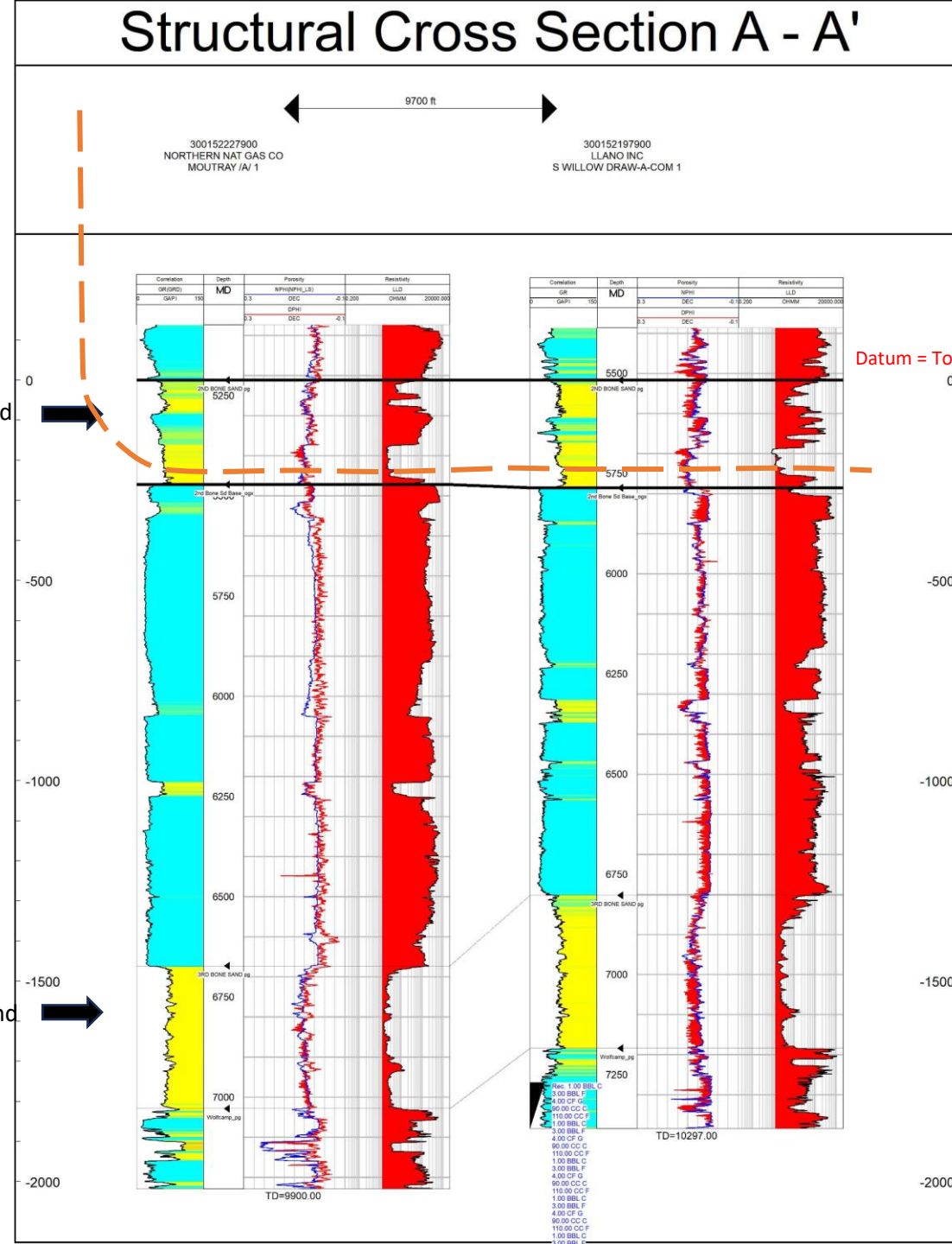

3rd Bone Spring Sand

Tascosa Energy Partners, LLC
Case No. 25619
Exhibit B-5

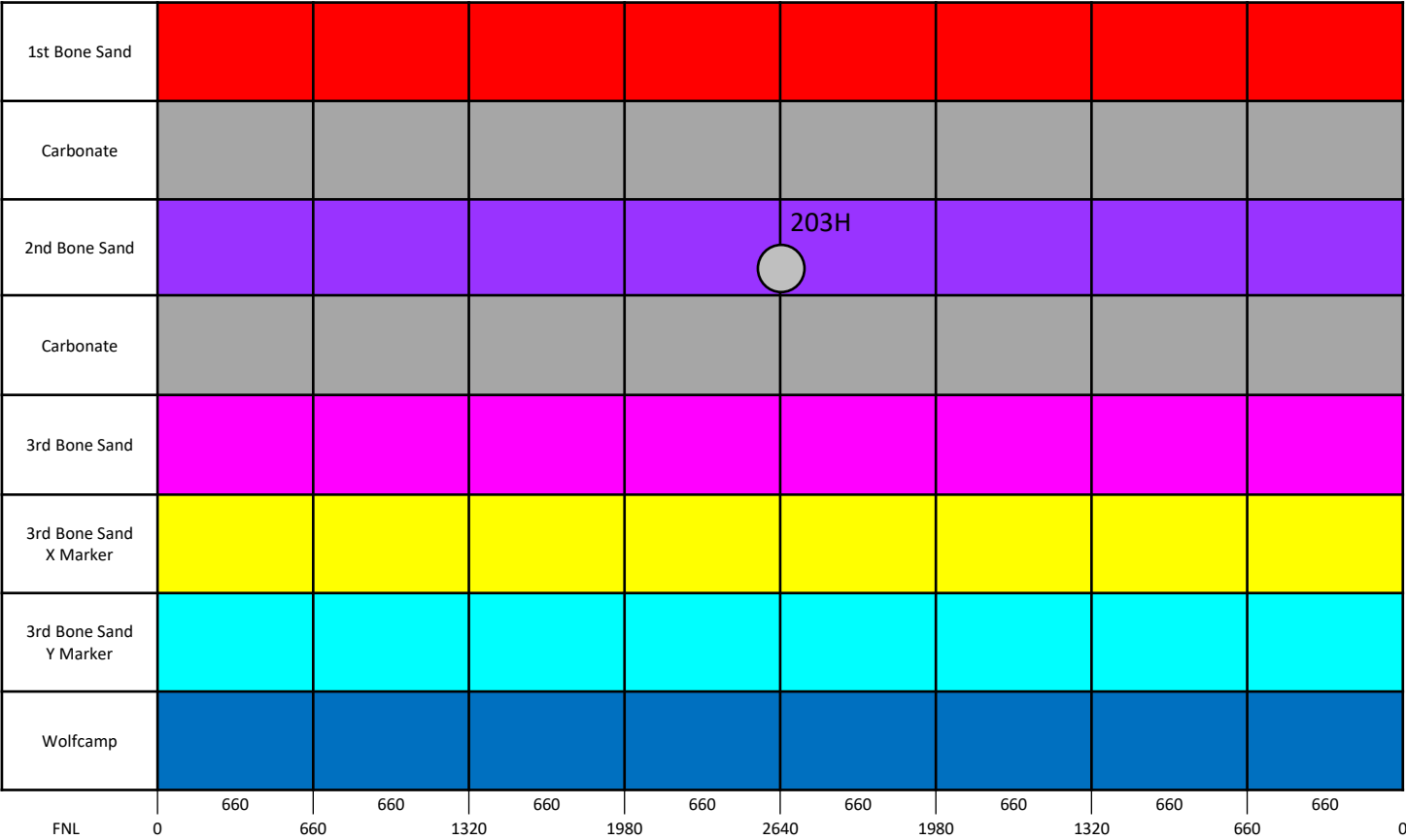

Gun Barrel Diagram



Well Spud 	Not Spud 
--	---

Tascosa Energy Partners, LLC
Case No. 25619
Exhibit B-6

**STATE OF NEW MEXICO
DEPARTMENT OF ENERGY, MINERALS AND NATURAL RESOURCES
OIL CONSERVATION DIVISION**

**APPLICATION OF TASCOSA ENERGY PARTNERS,
LLC FOR COMPULSORY POOLING,
EDDY COUNTY, NEW MEXICO.**

CASE NO. 25619

**SELF-AFFIRMED STATEMENT
OF JACLYN M. MCLEAN**

1. I am attorney in fact and authorized representative of Tascosa Energy Partners, LLC ("Tascosa") the Applicant herein.
2. I am familiar with the Notice Letter attached as **Exhibit C-1**, and caused the Notice Letter, along with the Application in this case, to be sent to the parties listed in the Postal Delivery Report attached as **Exhibit C-2**.
3. Exhibit C-2 also provides the date the Notice Letter was sent, along with the delivery status of each.
4. Electronic return receipts are attached as **Exhibit C-3** as supporting documentation for proof of mailing and the information provided on Exhibit C-2.
5. On September 23, 2025, I caused a notice to be published in the Carlsbad Current-Argus. An Affidavit of Publication from the legal clerk of the Carlsbad Current-Argus along with a copy of the Notice Publication, is attached as **Exhibit C-4**.
6. I understand this Self-Affirmed Statement will be used as written testimony in the subject case. I affirm that my testimony above is true and correct and is made under penalty of perjury under the laws of the State of New Mexico. My testimony is made as of the date handwritten next to my signature below.

/s/Jaclyn M. McLean
Jaclyn M. McLean

October 1, 2025
Date

**Tascosa Energy Partners, LLC
Case No. 25619
Exhibit C**



September 17, 2025

VIA CERTIFIED MAIL
RETURN RECEIPT REQUESTED

TO: ALL PARTIES ENTITLED TO NOTICE

Re: Case Nos. 25619 - Application of Tascosa Energy Partners, LLC, for Compulsory Pooling, Eddy County, New Mexico.

To whom it may concern:

This letter is to advise you that the enclosed application was filed with the New Mexico Oil Conservation Division. The hearing will be conducted on **October 9, 2025** beginning at 9:00 a.m.

The hearing will be conducted in a hybrid fashion, both virtually and in-person at the Energy, Minerals, Natural Resources Department, Wendell Chino Building, Pecos Hall, 1220 South St. Francis Drive, 1st Floor, Santa Fe, NM 87505. The hearing may be held only virtually at the discretion of the Division. To confirm the manner in which the hearing will be held, and to participate virtually, please visit the OCD Hearings website at the following link: <https://www.emnrd.nm.gov/oed/hearing-info/>. You are not required to attend this hearing, but as an owner of an interest that may be affected by these applications, you may appear and present testimony. Failure to appear at that time and become a party of record will preclude you from challenging the matter at a later date.

Pursuant to Division Rule 19.15.4.13.B, a party who intends to present evidence at the hearing shall file a pre-hearing statement and serve copies on other parties, or the attorneys of parties who are represented by counsel, at least four business days prior to the scheduled hearing, but in no event later than 5:00 p.m. Mountain Time, on the Thursday preceding the scheduled hearing date. If you are not registered with the OCD's E-Permitting system, you must submit the statement via e-mail to ocd.hearings@emnrd.nm.gov and should include: the names of the parties; whether or not the parties are represented by counsel; a concise statement of the case; the names of witnesses anticipated to be called to testify at the hearing; the approximate amount of time needed to present the case; and an identification of any procedural matters that are to be resolved prior to the hearing.

If you have any questions about this applications, please contact John Shoberg, Landman for Tascosa Energy Partners, LLC, at jshoberg@tascosaep.com or 432-695-6970

Sincerely,
/s/ Jaclyn M. McLean
Jaclyn M. McLean

125 Lincoln Avenue, Suite 223
Santa Fe, NM 87501
505-230-4410

HardyMcClean.com

Writer:
Jaclyn M. McLean
Managing Partner
jmcclean@hardymcclean.com

Tascosa Energy Partners, LLC
Case No. 25619
Exhibit C-1

Postal Delivery Report

Tascosa Anna - Case No. 25619

Recipient	Date Mailed	USPS Tracking Number	Date Received	Status
Irene Graham, Dec'd	9/17/2025	9414836208551287960015	9/22/2025	Delivered, Left with Individual
Hope Mashaw c/o Gil Moutray	9/17/2025	9414836208551287960022	9/22/2025	Delivered, Left with Individual
Seven Rivers Farms, LLC	9/17/2025	9414836208551287960008	9/24/2025	Delivered, Individual Picked Up at Post Office CARLSBAD, NM 88220
Cynthia Harper, SSP	9/17/2025	9414836208551287959996	9/24/2025	Delivered, Individual Picked Up at Postal Facility
Promontory Exploration, LP	9/17/2025	9414836208551287960039	9/22/2025	Delivered, Left with Individual

Tascosa Energy Partners, LLC
Case No. 25619
Exhibit C-2

Axis Energy Corporation	9/17/2025	9414836208551287960053	9/22/2025	Delivered, Individual Picked Up at Post Office ROSWELL, NM 88201
Bane Bigbie, Inc	9/17/2025	9414836208551287960060	9/22/2025	Delivered, PO Box
801, LLC	9/17/2025	9414836208551287960046	9/22/2025	Delivered, Individual Picked Up at Post Office ARTESIA, NM 88210

Breedyk Enterprises, LLC	9/17/2025	9414836208551287960084	9/23/2025	Delivered, Individual Picked Up at Post Office ROSWELL, NM 88201
Catheryn Isabella Fenn Trust	9/17/2025	9414836208551287960091	9/23/2025	Delivered, Individual Picked Up at Postal Facility
Gannaway Oil, LLC	9/17/2025	9414836208551287960107	9/23/2025	Delivered, Individual Picked Up at Post Office

				Delivered, Individual Picked Up at Post Office ARTESIA, NM 88210
Sharbro Energy, LLC	9/17/2025	9414836208551287960121	9/22/2025	
				Delivered, Individual Picked Up at Post Office ROSWELL, NM 88201
Hanagan Petroleum Corporation	9/17/2025	9414836208551287960114	9/22/2025	
				Delivered, Individual Picked Up at Post Office ARTESIA, NM 88210
Abo Petroleum, LLC	9/17/2025	9414836208551287960138	9/22/2025	

Wade Petroleum Corporation	9/17/2025	9414836208551287960145	9/22/2025	Delivered, Individual Picked Up at Post Office
SR Primo Holdings, LLC	9/17/2025	9414836208551287960152	N/A	Reminder to Schedule Redelivery of your item
BAK Oil & Gas, LLC	9/17/2025	9414836208551287960176	9/24/2025	Delivered, Individual Picked Up at Post Office
Richard J Forrest &	9/17/2025	9414836208551287960169	9/22/2025	Delivered, Left with Individual
Worrall Investment Corporation	9/17/2025	9414836208551287960183	9/22/2025	Delivered, Individual Picked Up at Post Office ROSWELL, NM 88201

Bursake, LLC	9/17/2025	9414836208551287960190	9/26/2025	Delivered, Individual Picked Up at Postal Facility MIDLAND, TX 79705
Hat Mesa Oil Company	9/17/2025	9414836208551287960213	9/23/2025	Delivered, Individual Picked Up at Postal Facility ALBUQUERQUE, NM 87111
McCombs Exploration, LLC	9/17/2025	9414836208551287960206	9/22/2025	Delivered, Left with Individual

Rhea Resources, LLC	9/17/2025	9414836208551287960220	9/30/2025	Delivered, Individual Picked Up at Post Office MIDLAND, TX 79701
Hutchings Oil Company	9/17/2025	9414836208551287960244	9/23/2025	Delivered, Individual Picked Up at Postal Facility ALBUQUERQUE, NM 87111
SCW Interiors, LLC	9/17/2025	9414836208551287960268	N/A	Reminder to pick up your item
Flying W Resources, LLC	9/17/2025	9414836208551287960237	N/A	Reminder to pick up your item
Paleozoic, LLC	9/17/2025	9414836208551287960251	9/22/2025	Delivered, Left with Individual
Longboat Energy Partners, LLC	9/17/2025	9414836208551287960275	9/22/2025	Delivered, Left with Individual

Coldwater Resources Company	9/17/2025	9414836208551287960282	9/24/2025	Delivered, Individual Picked Up at Postal Facility MIDLAND, TX 79705
Lani Investments, LLC	9/17/2025	9414836208551287960305	N/A	In Transit to Next Facility, Arriving Late
Donald Eugene Renfro	9/17/2025	9414836208551287960299	N/A	In Transit to Next Facility, Arriving Late
AmericaWest Resources, LLC	9/17/2025	9414836208551287960329	9/30/2025	Delivered, Individual Picked Up at Post Office MIDLAND, TX 79701
Dog Tired Investments LLC	9/17/2025	9414836208551287960336	9/22/2025	Delivered, Left with Individual

Nancy Lee Mauk English	9/17/2025	9414836208551287960343	9/26/2025	Delivered, Individual Picked Up at Post Office LUBBOCK, TX 79464
John Lee Fuqua	9/17/2025	9414836208551287960350	9/23/2025	Delivered, Individual Picked Up at Post Office SALIDA, CO 81201
Hilcorp Energy I, LP	9/17/2025	9414836208551287964457	9/22/2025	Delivered, Left with Individual
Oxy Y-1 C0	9/17/2025	9414836208551287964570	9/22/2025	Delivered to Agent, Front Desk/Reception/ Mail Room
XTO Holdings, LLC	9/17/2025	9414836208551287964686	N/A	In Transit to Next Facility, Arriving Late



September 22, 2025

Dear Simple Certified:

The following is in response to your request for proof of delivery on your item with the tracking number:
9414 8362 0855 1287 9600 15.

Item Details

Status:	Delivered, Left with Individual
Status Date / Time:	September 22, 2025, 2:32 pm
Location:	CARLSBAD, NM 88220
Postal Product:	First-Class Mail®
Extra Services:	Certified Mail™ Return Receipt Electronic
Recipient Name:	Irene Graham Dec d

Recipient Signature

Signature of Recipient:

1401 LERA CIR, CARLSBAD, NM
88220

Address of Recipient:

Note: Scanned image may reflect a different destination address due to Intended Recipient's delivery instructions on file.

Thank you for selecting the United States Postal Service® for your mailing needs. If you require additional assistance, please contact your local Post Office™ or a Postal representative at 1-800-222-1811.

Sincerely,
United States Postal Service®
475 L'Enfant Plaza SW
Washington, D.C. 20260-0004

Irene Graham, Dec'd
c/o H. Gil Moutray
1401 Lera Circle
Carlsbad, NM 88220
Reference #: Tascosa Anna 25619
Item ID: Tascosa Anna 25619

Tascosa Energy Partners, LLC
Case No. 25619
Exhibit C-3



September 22, 2025

Dear Simple Certified:

The following is in response to your request for proof of delivery on your item with the tracking number:
9414 8362 0855 1287 9600 22.

Item Details

Status:	Delivered, Left with Individual
Status Date / Time:	September 22, 2025, 2:32 pm
Location:	CARLSBAD, NM 88220
Postal Product:	First-Class Mail®
Extra Services:	Certified Mail™ Return Receipt Electronic
Recipient Name:	c o H Gil Moutray

Recipient Signature

Signature of Recipient:

1401 LERA CIR, CARLSBAD, NM
88220

Address of Recipient:

Note: Scanned image may reflect a different destination address due to Intended Recipient's delivery instructions on file.

Thank you for selecting the United States Postal Service® for your mailing needs. If you require additional assistance, please contact your local Post Office™ or a Postal representative at 1-800-222-1811.

Sincerely,
United States Postal Service®
475 L'Enfant Plaza SW
Washington, D.C. 20260-0004

c/o H. Gil Moutray
1401 Lera Circle
Carlsbad, NM 88220
Reference #: Tascosa Anna 25619
Item ID: Tascosa Anna 25619



September 24, 2025

Dear Simple Certified:

The following is in response to your request for proof of delivery on your item with the tracking number:
9414 8362 0855 1287 9600 08.

Item Details

Status:	Delivered, Individual Picked Up at Post Office
Status Date / Time:	September 24, 2025, 2:04 pm
Location:	CARLSBAD, NM 88220
Postal Product:	First-Class Mail®
Extra Services:	Certified Mail™ Return Receipt Electronic
Recipient Name:	Seven Rivers Farms LLC

Recipient Signature

Signature of Recipient:

PO BOX 1598

Address of Recipient:

CARLSBAD, NM 88221-1598

Note: Scanned image may reflect a different destination address due to Intended Recipient's delivery instructions on file.

Thank you for selecting the United States Postal Service® for your mailing needs. If you require additional assistance, please contact your local Post Office™ or a Postal representative at 1-800-222-1811.

Sincerely,
United States Postal Service®
475 L'Enfant Plaza SW
Washington, D.C. 20260-0004

Seven Rivers Farms, LLC
P.O. Box 1598
Carlsbad, NM 88221
Reference #: Tascosa Anna 25619
Item ID: Tascosa Anna 25619



September 24, 2025

Dear Simple Certified:

The following is in response to your request for proof of delivery on your item with the tracking number:
9414 8362 0855 1287 9599 96.

Item Details

Status:	Delivered, Individual Picked Up at Postal Facility
Status Date / Time:	September 24, 2025, 12:08 pm
Location:	HOUSTON, TX 77056
Postal Product:	First-Class Mail®
Extra Services:	Certified Mail™ Return Receipt Electronic
Recipient Name:	Cynthia Harper SSP

Recipient Signature

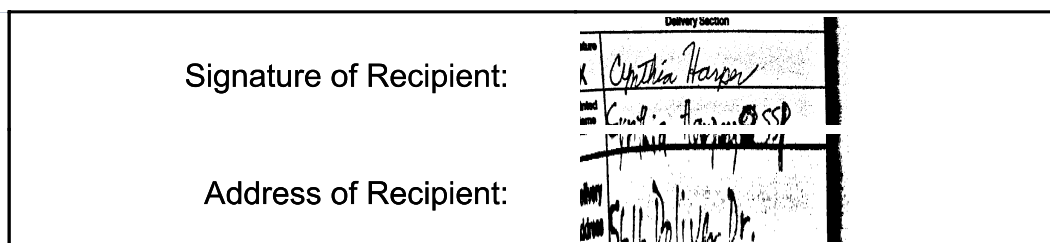

Note: Scanned image may reflect a different destination address due to Intended Recipient's delivery instructions on file.

Thank you for selecting the United States Postal Service® for your mailing needs. If you require additional assistance, please contact your local Post Office™ or a Postal representative at 1-800-222-1811.

Sincerely,
United States Postal Service®
475 L'Enfant Plaza SW
Washington, D.C. 20260-0004

Cynthia Harper, SSP
5616 Doliver Drive
Houston, TX 77056
Reference #: Tascosa Anna 25619
Item ID: Tascosa Anna 25619



September 22, 2025

Dear Simple Certified:

The following is in response to your request for proof of delivery on your item with the tracking number:
9414 8362 0855 1287 9600 39.

Item Details

Status:	Delivered, Left with Individual
Status Date / Time:	September 22, 2025, 4:40 pm
Location:	MIDLAND, TX 79701
Postal Product:	First-Class Mail®
Extra Services:	Certified Mail™ Return Receipt Electronic
Recipient Name:	Promontory Exploration LP

Recipient Signature

Signature of Recipient:

Address of Recipient:

Note: Scanned image may reflect a different destination address due to Intended Recipient's delivery instructions on file.

Thank you for selecting the United States Postal Service® for your mailing needs. If you require additional assistance, please contact your local Post Office™ or a Postal representative at 1-800-222-1811.

Sincerely,
United States Postal Service®
475 L'Enfant Plaza SW
Washington, D.C. 20260-0004

Promontory Exploration, LP
400 W. Wall St
Suite 300
Midland, TX 79701
Reference #: Tascosa Anna 25619
Item ID: Tascosa Anna 25619



September 22, 2025

Dear Simple Certified:

The following is in response to your request for proof of delivery on your item with the tracking number:
9414 8362 0855 1287 9600 53.

Item Details

Status:	Delivered, Individual Picked Up at Post Office
Status Date / Time:	September 22, 2025, 2:20 pm
Location:	ROSWELL, NM 88201
Postal Product:	First-Class Mail®
Extra Services:	Certified Mail™ Return Receipt Electronic
Recipient Name:	Axis Energy Corporation

Recipient Signature

Signature of Recipient:

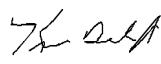
BARBE

PO BOX 2107

Address of Recipient:

ROSWELL, NM 88202-2107

Note: Scanned image may reflect a different destination address due to Intended Recipient's delivery instructions on file.

Thank you for selecting the United States Postal Service® for your mailing needs. If you require additional assistance, please contact your local Post Office™ or a Postal representative at 1-800-222-1811.

Sincerely,
United States Postal Service®
475 L'Enfant Plaza SW
Washington, D.C. 20260-0004

Axis Energy Corporation
P.O. Box 2107
Roswell, NM 88202
Reference #: Tascosa Anna 25619
Item ID: Tascosa Anna 25619



September 22, 2025

Dear Simple Certified:

The following is in response to your request for proof of delivery on your item with the tracking number:
9414 8362 0855 1287 9600 60.

Item Details

Status: Delivered, PO Box
Status Date / Time: September 22, 2025, 10:29 am
Location: ARDMORE, OK 73402
Postal Product: First-Class Mail®
Extra Services: Certified Mail™
Return Receipt Electronic
Recipient Name: Bane Bigbie Inc

Recipient Signature

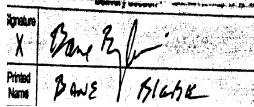
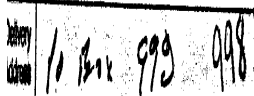
Signature of Recipient:	
Address of Recipient:	

Note: Scanned image may reflect a different destination address due to Intended Recipient's delivery instructions on file.

Thank you for selecting the United States Postal Service® for your mailing needs. If you require additional assistance, please contact your local Post Office™ or a Postal representative at 1-800-222-1811.

Sincerely,
United States Postal Service®
475 L'Enfant Plaza SW
Washington, D.C. 20260-0004

Bane Bigbie, Inc
P.O. Box 998
Ardmore, OK 73402
Reference #: Tascosa Anna 25619
Item ID: Tascosa Anna 25619



September 22, 2025

Dear Simple Certified:

The following is in response to your request for proof of delivery on your item with the tracking number:
9414 8362 0855 1287 9600 46.

Item Details

Status:	Delivered, Individual Picked Up at Post Office
Status Date / Time:	September 22, 2025, 10:51 am
Location:	ARTESIA, NM 88210
Postal Product:	First-Class Mail®
Extra Services:	Certified Mail™ Return Receipt Electronic
Recipient Name:	801 LLC

Recipient Signature

Signature of Recipient:

PO BOX 900

Address of Recipient:

ARTESIA, NM 88211-0900

Note: Scanned image may reflect a different destination address due to Intended Recipient's delivery instructions on file.

Thank you for selecting the United States Postal Service® for your mailing needs. If you require additional assistance, please contact your local Post Office™ or a Postal representative at 1-800-222-1811.

Sincerely,
United States Postal Service®
475 L'Enfant Plaza SW
Washington, D.C. 20260-0004

801, LLC
P.O. Box 900
Artesia, NM 88211
Reference #: Tascosa Anna 25619
Item ID: Tascosa Anna 25619



September 23, 2025

Dear Simple Certified:

The following is in response to your request for proof of delivery on your item with the tracking number:
9414 8362 0855 1287 9600 84.

Item Details

Status:	Delivered, Individual Picked Up at Post Office
Status Date / Time:	September 23, 2025, 10:03 am
Location:	ROSWELL, NM 88201
Postal Product:	First-Class Mail®
Extra Services:	Certified Mail™ Return Receipt Electronic
Recipient Name:	Breedyk Enterprises LLC

Recipient Signature

Signature of Recipient:

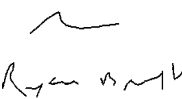

PO BOX 2844

Address of Recipient:

ROSWELL, NM 88202-2844

Note: Scanned image may reflect a different destination address due to Intended Recipient's delivery instructions on file.

Thank you for selecting the United States Postal Service® for your mailing needs. If you require additional assistance, please contact your local Post Office™ or a Postal representative at 1-800-222-1811.

Sincerely,
United States Postal Service®
475 L'Enfant Plaza SW
Washington, D.C. 20260-0004

Breedyk Enterprises, LLC
P.O. Box 2844
Roswell, NM 88202
Reference #: Tascosa Anna 25619
Item ID: Tascosa Anna 25619



September 23, 2025

Dear Simple Certified:

The following is in response to your request for proof of delivery on your item with the tracking number:
9414 8362 0855 1287 9600 91.

Item Details

Status:	Delivered, Individual Picked Up at Postal Facility
Status Date / Time:	September 23, 2025, 9:52 am
Location:	ROSWELL, NM 88202
Postal Product:	First-Class Mail®
Extra Services:	Certified Mail™ Return Receipt Electronic
Recipient Name:	Catheryn Isabella Fenn Trust

Recipient Signature

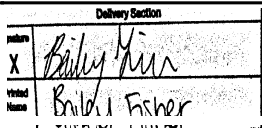
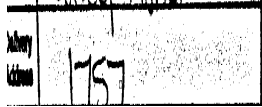
Signature of Recipient:	
Address of Recipient:	

Note: Scanned image may reflect a different destination address due to Intended Recipient's delivery instructions on file.

Thank you for selecting the United States Postal Service® for your mailing needs. If you require additional assistance, please contact your local Post Office™ or a Postal representative at 1-800-222-1811.

Sincerely,
United States Postal Service®
475 L'Enfant Plaza SW
Washington, D.C. 20260-0004

Catheryn Isabella Fenn Trust
P.O. Box 1757
Roswell, NM 88202
Reference #: Tascosa Anna 25619
Item ID: Tascosa Anna 25619



September 23, 2025

Dear Simple Certified:

The following is in response to your request for proof of delivery on your item with the tracking number:
9414 8362 0855 1287 9601 07.

Item Details

Status:	Delivered, Individual Picked Up at Post Office
Status Date / Time:	September 23, 2025, 4:54 pm
Location:	ROSWELL, NM 88201
Postal Product:	First-Class Mail®
Extra Services:	Certified Mail™ Return Receipt Electronic
Recipient Name:	Gannaway Oil LLC

Recipient Signature

Signature of Recipient:

PO BOX 417

Address of Recipient:

ROSWELL, NM 88202-0417

Note: Scanned image may reflect a different destination address due to Intended Recipient's delivery instructions on file.

Thank you for selecting the United States Postal Service® for your mailing needs. If you require additional assistance, please contact your local Post Office™ or a Postal representative at 1-800-222-1811.

Sincerely,
United States Postal Service®
475 L'Enfant Plaza SW
Washington, D.C. 20260-0004

Gannaway Oil, LLC
P.O. Box 417
Roswell, NM 88201
Reference #: Tascosa Anna 25619
Item ID: Tascosa Anna 25619



September 22, 2025

Dear Simple Certified:

The following is in response to your request for proof of delivery on your item with the tracking number:
9414 8362 0855 1287 9601 21.

Item Details

Status:	Delivered, Individual Picked Up at Post Office
Status Date / Time:	September 22, 2025, 10:55 am
Location:	ARTESIA, NM 88210
Postal Product:	First-Class Mail®
Extra Services:	Certified Mail™ Return Receipt Electronic
Recipient Name:	Sharbro Energy LLC

Recipient Signature

Signature of Recipient:

Address of Recipient:

PO BOX 840

ARTESIA, NM 88211-0840

Note: Scanned image may reflect a different destination address due to Intended Recipient's delivery instructions on file.

Thank you for selecting the United States Postal Service® for your mailing needs. If you require additional assistance, please contact your local Post Office™ or a Postal representative at 1-800-222-1811.

Sincerely,
United States Postal Service®
475 L'Enfant Plaza SW
Washington, D.C. 20260-0004

Sharbro Energy, LLC
Revocable Trust
P.O. Box 840
Artesia, NM 88211
Reference #: Tascosa Anna 25619
Item ID: Tascosa Anna 25619



September 22, 2025

Dear Simple Certified:

The following is in response to your request for proof of delivery on your item with the tracking number:
9414 8362 0855 1287 9601 14.

Item Details

Status:	Delivered, Individual Picked Up at Post Office
Status Date / Time:	September 22, 2025, 3:41 pm
Location:	ROSWELL, NM 88201
Postal Product:	First-Class Mail®
Extra Services:	Certified Mail™ Return Receipt Electronic
Recipient Name:	Hanagan Petroleum Corporation

Recipient Signature

Signature of Recipient:

PO BOX 1737

Address of Recipient:

ROSWELL, NM 88202-1737

Note: Scanned image may reflect a different destination address due to Intended Recipient's delivery instructions on file.

Thank you for selecting the United States Postal Service® for your mailing needs. If you require additional assistance, please contact your local Post Office™ or a Postal representative at 1-800-222-1811.

Sincerely,
United States Postal Service®
475 L'Enfant Plaza SW
Washington, D.C. 20260-0004

Hanagan Petroleum Corporation
P.O. Box 1737
Roswell, NM 88202
Reference #: Tascosa Anna 25619
Item ID: Tascosa Anna 25619



September 22, 2025

Dear Simple Certified:

The following is in response to your request for proof of delivery on your item with the tracking number:
9414 8362 0855 1287 9601 38.

Item Details

Status:	Delivered, Individual Picked Up at Post Office
Status Date / Time:	September 22, 2025, 10:51 am
Location:	ARTESIA, NM 88210
Postal Product:	First-Class Mail®
Extra Services:	Certified Mail™ Return Receipt Electronic
Recipient Name:	Abo Petroleum LLC

Recipient Signature

Signature of Recipient:

PO BOX 900

Address of Recipient:

ARTESIA, NM 88211-0900

Note: Scanned image may reflect a different destination address due to Intended Recipient's delivery instructions on file.

Thank you for selecting the United States Postal Service® for your mailing needs. If you require additional assistance, please contact your local Post Office™ or a Postal representative at 1-800-222-1811.

Sincerely,
United States Postal Service®
475 L'Enfant Plaza SW
Washington, D.C. 20260-0004

Abo Petroleum, LLC
P.O. Box 900
Artesia, NM 88211
Reference #: Tascosa Anna 25619
Item ID: Tascosa Anna 25619



September 22, 2025

Dear Simple Certified:

The following is in response to your request for proof of delivery on your item with the tracking number:
9414 8362 0855 1287 9601 45.

Item Details

Status:	Delivered, Individual Picked Up at Post Office
Status Date / Time:	September 22, 2025, 8:51 am
Location:	SANDIA PARK, NM 87047
Postal Product:	First-Class Mail®
Extra Services:	Certified Mail™ Return Receipt Electronic
Recipient Name:	Wade Petroleum Corporation

Recipient Signature

Signature of Recipient:

9 BROKEN ARROW F

SANDIA PARK, NM 87047 8548

Address of Recipient:

Note: Scanned image may reflect a different destination address due to Intended Recipient's delivery instructions on file.

Thank you for selecting the United States Postal Service® for your mailing needs. If you require additional assistance, please contact your local Post Office™ or a Postal representative at 1-800-222-1811.

Sincerely,
United States Postal Service®
475 L'Enfant Plaza SW
Washington, D.C. 20260-0004

Wade Petroleum Corporation
9 Broken Arrow Place
Sandia Park, NM 87047
Reference #: Tascosa Anna 25619
Item ID: Tascosa Anna 25619



September 24, 2025

Dear Simple Certified:

The following is in response to your request for proof of delivery on your item with the tracking number:
9414 8362 0855 1287 9601 76.

Item Details

Status:	Delivered, Individual Picked Up at Post Office
Status Date / Time:	September 24, 2025, 12:48 pm
Location:	THE COLONY, TX 75056
Postal Product:	First-Class Mail®
Extra Services:	Certified Mail™ Return Receipt Electronic
Recipient Name:	BAK Oil Gas LLC

Recipient Signature

Signature of Recipient:

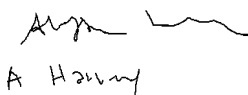

Address of Recipient:

PO BOX 560430
THE COLONY, TX 75056-0430

Note: Scanned image may reflect a different destination address due to Intended Recipient's delivery instructions on file.

Thank you for selecting the United States Postal Service® for your mailing needs. If you require additional assistance, please contact your local Post Office™ or a Postal representative at 1-800-222-1811.

Sincerely,
United States Postal Service®
475 L'Enfant Plaza SW
Washington, D.C. 20260-0004

BAK Oil & Gas, LLC
P.O. Box 560430
The Colony, TX 75056
Reference #: Tascosa Anna 25619
Item ID: Tascosa Anna 25619



September 22, 2025

Dear Simple Certified:

The following is in response to your request for proof of delivery on your item with the tracking number:
9414 8362 0855 1287 9601 69.

Item Details

Status:	Delivered, Left with Individual
Status Date / Time:	September 22, 2025, 10:26 am
Location:	CARLSBAD, NM 88220
Postal Product:	First-Class Mail®
Extra Services:	Certified Mail™ Return Receipt Electronic
Recipient Name:	Richard J Forrest

Recipient Signature

Signature of Recipient:

208 DICKSON LN, CARLSBAD,
NM 88220

Address of Recipient:

Note: Scanned image may reflect a different destination address due to Intended Recipient's delivery instructions on file.

Thank you for selecting the United States Postal Service® for your mailing needs. If you require additional assistance, please contact your local Post Office™ or a Postal representative at 1-800-222-1811.

Sincerely,
United States Postal Service®
475 L'Enfant Plaza SW
Washington, D.C. 20260-0004

Richard J Forrest &
Susan Forrest
208 Dickson Land +E6:G6
Carlsbad, NM 88220
Reference #: Tascosa Anna 25619
Item ID: Tascosa Anna 25619



September 22, 2025

Dear Simple Certified:

The following is in response to your request for proof of delivery on your item with the tracking number:
9414 8362 0855 1287 9601 83.

Item Details

Status:	Delivered, Individual Picked Up at Post Office
Status Date / Time:	September 22, 2025, 3:40 pm
Location:	ROSWELL, NM 88201
Postal Product:	First-Class Mail®
Extra Services:	Certified Mail™ Return Receipt Electronic
Recipient Name:	Worrall Investment Corporation

Recipient Signature

Signature of Recipient:

PO BOX 1834

Address of Recipient:

ROSWELL, NM 88202-1834

Note: Scanned image may reflect a different destination address due to Intended Recipient's delivery instructions on file.

Thank you for selecting the United States Postal Service® for your mailing needs. If you require additional assistance, please contact your local Post Office™ or a Postal representative at 1-800-222-1811.

Sincerely,
United States Postal Service®
475 L'Enfant Plaza SW
Washington, D.C. 20260-0004

Worrall Investment Corporation
P.O. Box 1834 Roswell, NM 88202-1834
Roswell, NM 88202
Reference #: Tascosa Anna 25619
Item ID: Tascosa Anna 25619



September 26, 2025

Dear Simple Certified:

The following is in response to your request for proof of delivery on your item with the tracking number:
9414 8362 0855 1287 9601 90.

Item Details

Status:	Delivered, Individual Picked Up at Postal Facility
Status Date / Time:	September 26, 2025, 10:17 am
Location:	MIDLAND, TX 79705
Postal Product:	First-Class Mail®
Extra Services:	Certified Mail™ Return Receipt Electronic
Recipient Name:	Bursake LLC

Recipient Signature

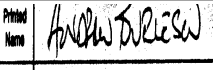
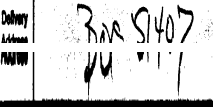
Signature of Recipient:	
Address of Recipient:	



Note: Scanned image may reflect a different destination address due to Intended Recipient's delivery instructions on file.

Thank you for selecting the United States Postal Service® for your mailing needs. If you require additional assistance, please contact your local Post Office™ or a Postal representative at 1-800-222-1811.

Sincerely,
United States Postal Service®
475 L'Enfant Plaza SW
Washington, D.C. 20260-0004

Bursake, LLC
P.O. Box 51407
Midland, TX 79710
Reference #: Tascosa Anna 25619
Item ID: Tascosa Anna 25619



September 23, 2025

Dear Simple Certified:

The following is in response to your request for proof of delivery on your item with the tracking number:
9414 8362 0855 1287 9602 13.

Item Details

Status:	Delivered, Individual Picked Up at Postal Facility
Status Date / Time:	September 23, 2025, 4:31 pm
Location:	ALBUQUERQUE, NM 87111
Postal Product:	First-Class Mail®
Extra Services:	Certified Mail™ Return Receipt Electronic
Recipient Name:	Hat Mesa Oil Company

Recipient Signature

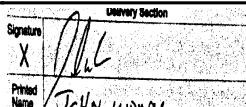
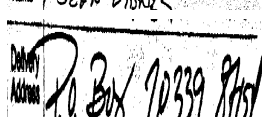
Signature of Recipient:	
Address of Recipient:	

Note: Scanned image may reflect a different destination address due to Intended Recipient's delivery instructions on file.

Thank you for selecting the United States Postal Service® for your mailing needs. If you require additional assistance, please contact your local Post Office™ or a Postal representative at 1-800-222-1811.

Sincerely,
United States Postal Service®
475 L'Enfant Plaza SW
Washington, D.C. 20260-0004

Hat Mesa Oil Company
P.O. Box 20339
Albuquerque, NM 87154
Reference #: Tascosa Anna 25619
Item ID: Tascosa Anna 25619



September 22, 2025

Dear Simple Certified:

The following is in response to your request for proof of delivery on your item with the tracking number:
9414 8362 0855 1287 9602 06.

Item Details

Status:	Delivered, Left with Individual
Status Date / Time:	September 22, 2025, 1:29 pm
Location:	SAN ANTONIO, TX 78212
Postal Product:	First-Class Mail®
Extra Services:	Certified Mail™ Return Receipt Electronic
Recipient Name:	McCombs Exploration LLC

Recipient Signature

Signature of Recipient:

Address of Recipient:

Note: Scanned image may reflect a different destination address due to Intended Recipient's delivery instructions on file.

Thank you for selecting the United States Postal Service® for your mailing needs. If you require additional assistance, please contact your local Post Office™ or a Postal representative at 1-800-222-1811.

Sincerely,
United States Postal Service®
475 L'Enfant Plaza SW
Washington, D.C. 20260-0004

McCombs Exploration, LLC
755 E. Mulberry Ave
Suite 600
San Antonio, TX 78212
Reference #: Tascosa Anna 25619
Item ID: Tascosa Anna 25619



September 30, 2025

Dear Simple Certified:

The following is in response to your request for proof of delivery on your item with the tracking number:
9414 8362 0855 1287 9602 20.

Item Details

Status:	Delivered, Individual Picked Up at Post Office
Status Date / Time:	September 30, 2025, 2:13 pm
Location:	MIDLAND, TX 79701
Postal Product:	First-Class Mail®
Extra Services:	Certified Mail™ Return Receipt Electronic
Recipient Name:	Rhea Resources LLC

Recipient Signature

Signature of Recipient:

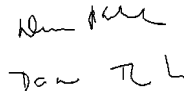

Address of Recipient:

PO BOX 3624
MIDLAND, TX 79702-3624

Note: Scanned image may reflect a different destination address due to Intended Recipient's delivery instructions on file.

Thank you for selecting the United States Postal Service® for your mailing needs. If you require additional assistance, please contact your local Post Office™ or a Postal representative at 1-800-222-1811.

Sincerely,
United States Postal Service®
475 L'Enfant Plaza SW
Washington, D.C. 20260-0004

Rhea Resources, LLC
P.O. Box 3624
Midland, TX 79702
Reference #: Tascosa Anna 25619
Item ID: Tascosa Anna 25619



September 23, 2025

Dear Simple Certified:

The following is in response to your request for proof of delivery on your item with the tracking number:
9414 8362 0855 1287 9602 44.

Item Details

Status:	Delivered, Individual Picked Up at Postal Facility
Status Date / Time:	September 23, 2025, 4:30 pm
Location:	ALBUQUERQUE, NM 87111
Postal Product:	First-Class Mail®
Extra Services:	Certified Mail™ Return Receipt Electronic
Recipient Name:	Hutchings Oil Company

Recipient Signature

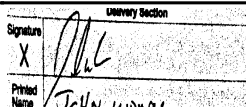
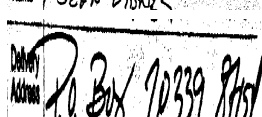
Signature of Recipient:	
Address of Recipient:	

Note: Scanned image may reflect a different destination address due to Intended Recipient's delivery instructions on file.

Thank you for selecting the United States Postal Service® for your mailing needs. If you require additional assistance, please contact your local Post Office™ or a Postal representative at 1-800-222-1811.

Sincerely,
United States Postal Service®
475 L'Enfant Plaza SW
Washington, D.C. 20260-0004

Hutchings Oil Company
P.O. Box 20339
Albuquerque, NM 87154
Reference #: Tascosa Anna 25619
Item ID: Tascosa Anna 25619



September 22, 2025

Dear Simple Certified:

The following is in response to your request for proof of delivery on your item with the tracking number:
9414 8362 0855 1287 9602 51.

Item Details

Status:	Delivered, Left with Individual
Status Date / Time:	September 22, 2025, 12:47 pm
Location:	MIDLAND, TX 79707
Postal Product:	First-Class Mail®
Extra Services:	Certified Mail™ Return Receipt Electronic
Recipient Name:	Paleozoic LLC

Recipient Signature

Signature of Recipient:

Address of Recipient:

Note: Scanned image may reflect a different destination address due to Intended Recipient's delivery instructions on file.

Thank you for selecting the United States Postal Service® for your mailing needs. If you require additional assistance, please contact your local Post Office™ or a Postal representative at 1-800-222-1811.

Sincerely,
United States Postal Service®
475 L'Enfant Plaza SW
Washington, D.C. 20260-0004

Paleozoic, LLC
3608 Meadowridge Lane
Midland, TX 79707
Reference #: Tascosa Anna 25619
Item ID: Tascosa Anna 25619



September 22, 2025

Dear Simple Certified:

The following is in response to your request for proof of delivery on your item with the tracking number:
9414 8362 0855 1287 9602 75.

Item Details

Status:	Delivered, Left with Individual
Status Date / Time:	September 22, 2025, 9:56 am
Location:	MIDLAND, TX 79705
Postal Product:	First-Class Mail®
Extra Services:	Certified Mail™ Return Receipt Electronic
Recipient Name:	Longboat Energy Partners LLC

Recipient Signature

Signature of Recipient:



2101 W WADLEY AVE STE 202,
MIDLAND, TX 79705

Address of Recipient:

Note: Scanned image may reflect a different destination address due to Intended Recipient's delivery instructions on file.

Thank you for selecting the United States Postal Service® for your mailing needs. If you require additional assistance, please contact your local Post Office™ or a Postal representative at 1-800-222-1811.

Sincerely,
United States Postal Service®
475 L'Enfant Plaza SW
Washington, D.C. 20260-0004

Longboat Energy Partners, LLC
2101 W. Wadley St., Suite 202
Suite 202
Midland, TX 79705
Reference #: Tascosa Anna 25619
Item ID: Tascosa Anna 25619



September 24, 2025



Dear Simple Certified:

The following is in response to your request for proof of delivery on your item with the tracking number:
9414 8362 0855 1287 9602 82.

Item Details

Status: Delivered, Individual Picked Up at Postal Facility
Status Date / Time: September 24, 2025, 11:57 am
Location: MIDLAND, TX 79705
Postal Product: First-Class Mail®
Extra Services: Certified Mail™
Return Receipt Electronic
Recipient Name: Coldwater Resources Company

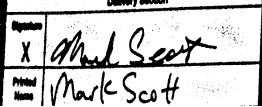
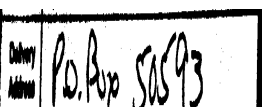
Recipient Signature

Signature of Recipient:	
	
Address of Recipient:	

Note: Scanned image may reflect a different destination address due to Intended Recipient's delivery instructions on file.

Thank you for selecting the United States Postal Service® for your mailing needs. If you require additional assistance, please contact your local Post Office™ or a Postal representative at 1-800-222-1811.

Sincerely,
United States Postal Service®
475 L'Enfant Plaza SW
Washington, D.C. 20260-0004

Coldwater Resources Company
P.O. Box 50593
Midland, TX 79710
Reference #: Tascosa Anna 25619
Item ID: Tascosa Anna 25619



September 30, 2025

Dear Simple Certified:

The following is in response to your request for proof of delivery on your item with the tracking number:
9414 8362 0855 1287 9603 29.

Item Details

Status:	Delivered, Individual Picked Up at Post Office
Status Date / Time:	September 30, 2025, 11:20 am
Location:	MIDLAND, TX 79701
Postal Product:	First-Class Mail®
Extra Services:	Certified Mail™ Return Receipt Electronic
Recipient Name:	AmericaWest Resources LLC

Recipient Signature

Signature of Recipient:

Tascosa Anna
AmericaWest Resources

PO BOX 1743

Address of Recipient:

MIDLAND, TX 79702-1743

Note: Scanned image may reflect a different destination address due to Intended Recipient's delivery instructions on file.

Thank you for selecting the United States Postal Service® for your mailing needs. If you require additional assistance, please contact your local Post Office™ or a Postal representative at 1-800-222-1811.

Sincerely,
United States Postal Service®
475 L'Enfant Plaza SW
Washington, D.C. 20260-0004

AmericaWest Resources, LLC
P.O. Box 3383
Midland, TX 79705
Reference #: Tascosa Anna 25619
Item ID: Tascosa Anna 25619



September 22, 2025

Dear Simple Certified:

The following is in response to your request for proof of delivery on your item with the tracking number:
9414 8362 0855 1287 9603 36.

Item Details

Status:	Delivered, Left with Individual
Status Date / Time:	September 22, 2025, 9:44 am
Location:	MIDLAND, TX 79705
Postal Product:	First-Class Mail®
Extra Services:	Certified Mail™ Return Receipt Electronic
Recipient Name:	Dog Tired Investments LLC

Recipient Signature

Signature of Recipient:

Address of Recipient:

Note: Scanned image may reflect a different destination address due to Intended Recipient's delivery instructions on file.

Thank you for selecting the United States Postal Service® for your mailing needs. If you require additional assistance, please contact your local Post Office™ or a Postal representative at 1-800-222-1811.

Sincerely,
United States Postal Service®
475 L'Enfant Plaza SW
Washington, D.C. 20260-0004

Dog Tired Investments LLC
1118 Breckenridge Drive
Midland, TX 79705
Reference #: Tascosa Anna 25619
Item ID: Tascosa Anna 25619



September 26, 2025

Dear Simple Certified:

The following is in response to your request for proof of delivery on your item with the tracking number:
9414 8362 0855 1287 9603 43.

Item Details

Status:	Delivered, Individual Picked Up at Post Office
Status Date / Time:	September 26, 2025, 1:13 pm
Location:	LUBBOCK, TX 79464
Postal Product:	First-Class Mail®
Extra Services:	Certified Mail™ Return Receipt Electronic
Recipient Name:	Nancy Lee Mauk English

Recipient Signature

Signature of Recipient:

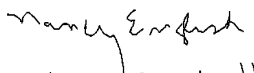
Nancy Lee Mauk English
9301 WINSTON AVE
LUBBOCK, TX 79424-4850

Address of Recipient:

Note: Scanned image may reflect a different destination address due to Intended Recipient's delivery instructions on file.

Thank you for selecting the United States Postal Service® for your mailing needs. If you require additional assistance, please contact your local Post Office™ or a Postal representative at 1-800-222-1811.

Sincerely,
United States Postal Service®
475 L'Enfant Plaza SW
Washington, D.C. 20260-0004

Nancy Lee Mauk English
9301 Winston Avenue
Lubbock, TX 79424
Reference #: Tascosa Anna 25619
Item ID: Tascosa Anna 25619



September 23, 2025

Dear Simple Certified:

The following is in response to your request for proof of delivery on your item with the tracking number:
9414 8362 0855 1287 9603 50.

Item Details

Status:	Delivered, Individual Picked Up at Post Office
Status Date / Time:	September 23, 2025, 2:00 pm
Location:	SALIDA, CO 81201
Postal Product:	First-Class Mail®
Extra Services:	Certified Mail™ Return Receipt Electronic
Recipient Name:	John Lee Fuqua

Recipient Signature

Signature of Recipient:

Address of Recipient:

6023 COUNTY ROAD 210
PONCHA SPRINGS, CO 81201-9419

Note: Scanned image may reflect a different destination address due to Intended Recipient's delivery instructions on file.

Thank you for selecting the United States Postal Service® for your mailing needs. If you require additional assistance, please contact your local Post Office™ or a Postal representative at 1-800-222-1811.

Sincerely,
United States Postal Service®
475 L'Enfant Plaza SW
Washington, D.C. 20260-0004

John Lee Fuqua
6023 County Road 210
Poncha Springs, CO 81201
Reference #: Tascosa Anna 25619
Item ID: Tascosa Anna 25619

Affidavit of Publication**Copy of Publication:**No. 64440

State of New Mexico

Publisher

County of Eddy:

Adrian Hedden

being duly sworn, says that he is the

Publisher

of the Carlsbad Current Argus, a weekly newspaper of

general circulation, published in English at Carlsbad,

said county and state, and that the hereto attached

Legal Ad

was published in a regular and entire issue of the said

Carlsbad Current Argus, a weekly newspaper duly qualified

for that purpose within the meaning of Chapter 167 of

the 1937 Session Laws of the state of New Mexico for

1 Consecutive weeks/day on the same

day as follows:

First Publication September 23, 2025

Second Publication _____

Third Publication _____

Fourth Publication _____

Fifth Publication _____

Sixth Publication _____

Seventh Publication _____

Eighth Publication _____

Subscribed and sworn before me this

23rd day of September 2025

LATISHA ROMINE
Notary Public, State of New Mexico
Commission No. 1076338
My Commission Expires
05-12-2027

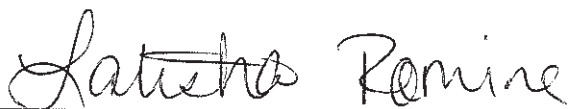

Latisha Romine

Notary Public, Eddy County, New Mexico

This is to notify all interested parties, including; Cynthia Harper, SSP; Seven Rivers Farms, LLC; Irene Graham, Decd c/o H. Gil Moutray; Hope Mashaw c/o H. Gil Moutray; Promontory Exploration, LP; 801, LLC; Axis Energy Corporation; Bane Biggie, Inc.; Bowtie Slash Energy, Inc.; Breedyk Enterprises, LLC; Catheryn Isabella Fenn Trust; Gannaway Oil, LLC; Hanagan Petroleum Corporation; Richard J Forest and Susan Forrest Revocable Trust; Sharbo Energy, LLC; SR Primo Holdings, LLC; Wade Petroleum Corporation; Worrall Investment Corporation; Abo Petroleum; Bak Oil & Gas, LLC; Flying W Resources, LLC; Hat Mesa Oil Company; Hutchings Oil Company; McCombs Exploration, LLC; Rhea Resources, LLC; SCW Interiors, LLC; Longboat Energy Partners, LLC; AmericaWest Resources; Coldwater Resources Company; Dog Tired Investments LLC; Donald Eugene Renfro; John Lee Fuqua; Lani Investments, LLC; Nancy Lee Mauk English; and their successors and assigns; that the New Mexico Oil Conservation Division will conduct a hearing on the application submitted by Tascosa Energy Partners LLC (Applicant) for Case No. 25619. The hearing will be conducted on October 9, 2025, in a hybrid fashion, both virtually and in person at the Energy, Minerals, Natural Resources Department, 1st Floor, Santa Fe, NM 87505. To participate virtually, see the instructions posted on the OCD website: <https://www.emnrd.nm.gov/ocd/hearing-info/>. In Case No. 25619, Applicant seeks an order pooling all uncommitted interests in the Bone Spring formation underlying 720-acre, more or less, standard horizontal spacing unit comprised of the S/2 NE/4 and N/2 SE/4 of Section 7, the N/2 S/2 and S/2 N/2 of Section 8, and the S/2 NW/4, N/2 SW/4, SW/4 NE/4 and NW/4 SE/4 of Section 9, Township 20 South, Range 26 East, Eddy County, New Mexico (Unit). The Unit will be dedicated to the Anna 79 Fee #203H well (Well), which will be drilled from a surface hole location in the NE/4 SW/4 (Unit K) of Section 7 to a bottom hole location in the NW/4 SE/4 (Unit J) of Section 9. The completed interval of the Well will be orthodox. The completed interval of the Well will be located within 330 of the quarter-quarter section line separating the S/2 N/2 and N/2 S/2 of Sections 7, 8, and 9 to allow for the creation of a 720-acre standard horizontal spacing unit. Also to be considered will be the cost of drilling and completing the Well and the allocation of the cost, the designation of Applicant as operator of the Well, and a 200% charge for the risk involved in drilling and completing the Well. The Well is located approximately 12 miles from Carlsbad, New Mexico.

64440-Published in Carlsbad Current Argus Sept. 23, 2025.

Tascosa Energy Partners, LLC
Case No. 25619
Exhibit C-4