



February 26, 2026

Certified Tracking #: **9214 8969 0099 9790 1854 0199 17**

Attn: Kyle Paradis
Bureau of Land Management
301 Dinosaur Trail
Santa Fe, NM 87508

Attn: Commissioner of Public Lands
New Mexico State Land Office
P.O Box 1148
Santa Fe, NM 87504

**New Mexico Oil Conservation Division
1220 S. Saint Francis Drive
Santa Fe, NM 87505**

Re: 2026 Plan of Development
San Juan 28-4 Unit (NMNM078410X)
Rio Arriba County, New Mexico

Ladies & Gentleman:

Hilcorp Energy Company, as Operator, hereby tenders the enclosed 2026 Plan of Development ("POD") and 2025 summary/review of operations for your review along with accompanying well status lists and participating area production graphs.

In accordance with the subject Unit Agreement, please signify your approval and/or consent by executing and returning a copy of the attached approval page to the undersigned.

If you have any questions or concerns regarding this matter, please do not hesitate to contact me at the email or number provided in the footer below.

Sincerely,

A handwritten signature in blue ink that reads 'Gatewood D. Brown'.

Gatewood D. Brown
Senior Landman – New Mexico

1111 Travis Street, Houston, TX 77002
Phone: (713) 289-2767 gabrown@hilcorp.com



**San Juan 28-4 Unit (NMNM078410X)
2026 PLAN OF DEVELOPMENT APPROVALS**

Bureau of Land Management

Date

New Mexico Oil Conservation Division

Date

New Mexico Commissioner of Public Lands

Date

1111 Travis Street, Houston, TX 77002
Phone: (713) 289-2767 gabrown@hilcorp.com

San Juan 28-4 Unit
2026 Plan of Development

**2026 PLAN OF DEVELOPMENT
SAN JUAN 28-4 UNIT
NMNM-078410X
RIO ARRIBA COUNTY, NEW MEXICO**

Previous Year Operations:

Drilling: Hilcorp Energy Company (“Hilcorp”) did not drill any new wells in 2025.

Recompletions: Hilcorp did not execute any recompletions in 2025.

Plug Back: Hilcorp did not plug back any wells in 2025.

Conversions: Hilcorp did not convert any wells in 2025.

Plug & Abandonment: Hilcorp did not plug & abandon any wells in 2025.

Participating Areas

Paying Well Determination: Hilcorp did not submit any well for paying determination in 2025.

PA Application Submitted or Approved: Hilcorp did not submit a PA Application in 2025.

Surface Disturbing Activities: Hilcorp did not create any new surface disturbances in 2025.

Water Use:

Fresh Water:

Drilling: N/A

Completion: N/A

Fresh Water Storage:

Drilling: N/A

Completion: N/A

Water Transfer:

Drilling: N/A

Completion: N/A

Produced Water:

Drilling: N/A

Completion: N/A

Disposal:

SWD Well Name	API Number	Legal Description
N/A	N/A	N/A

San Juan 28-4 Unit
 2026 Plan of Development

2025 Water Disposal Data

Facility	Total (BBL)	Daily Avg (BPD)	Mode of Transport (Piped, Trucked, Both)
N/A	N/A	N/A	N/A

Planned Year Operations:

Drilling: Hilcorp does not anticipate any drilling projects in the San Juan 28-4 Unit during 2026.

Recompletions: Hilcorp does not anticipate any recompletes in 2026.

Sidetrack/Reentry: Hilcorp does not anticipate any sidetrack/reentry projects in the San Juan 28-4 Unit during 2026.

Plug Back Program: Hilcorp does not anticipate any plug-back projects in the San Juan 28-4 Unit during 2026.

Conversion Program: Hilcorp does not anticipate any conversion projects in the San Juan 28-4 Unit during 2026.

Plugging & Abandonment Program: Hilcorp does not anticipate any P&A projects in the San Juan 28-4 Unit during 2026.

Participating Areas

Paying Well Determination Planned: Hilcorp does not anticipate submitting any paying well determinations in 2026.

PA Application Planned: Hilcorp does not anticipate submitting any PA applications in 2026.

Other: any Surface Disturbing Activities: Hilcorp does not anticipate submitting any additional surface disturbing activities in 2026.

Water Use: Hilcorp does not anticipate any recompletions in 2026.

Fresh Water

Drilling: N/A

Completion: N/A

Fresh Water Storage

Drilling: N/A

Completion: N/A

Water Transfer: N/A

San Juan 28-4 Unit
2026 Plan of Development

Disposal:

2026 Water Disposal Estimate (based on 2025)

Facility	Total (BBL)	Daily Avg (BPD)	Mode of Transport (Piped, Trucked, Both)
N/A	N/A	N/A	N/A

**HILCORP ENERGY COMPANY - OPERATOR
EXHIBIT A
WELLS ASSOCIATED WITH THE SAN JUAN 28-4 UNIT
RIO ARRIBA COUNTY, NEW MEXICO**

Well Name	Well No.	API	State Well Classification	Well Status	Reservoir	OCD Lease Type	Reporting Serial
SAN JUAN 28-4 UNIT	1	3003907443	Gas	PROD	MESAVERDE	Federal	MV PA - NMNM78410A
SAN JUAN 28-4 UNIT	16R	3003927820	Gas	PROD	DAKOTA	Federal	Lease Basis - NMNM03862
SAN JUAN 28-4 UNIT	16R	3003927820	Gas	PROD	MESAVERDE	Federal	MV PA - NMNM78410A
SAN JUAN 28-4 UNIT	1A	3003926465	Gas	PROD	MESAVERDE	Federal	MV PA - NMNM78410A
SAN JUAN 28-4 UNIT	1B	3003930730	Gas	PROD	MESAVERDE	Federal	MV PA - NMNM78410A
SAN JUAN 28-4 UNIT	20	3003907281	Gas	PROD	MESAVERDE	Federal	MV PA - NMNM78410A
SAN JUAN 28-4 UNIT	201	3003925431	Gas	PROD	PICTURED CLIFFS	Federal	Lease Basis - NMNM03862
SAN JUAN 28-4 UNIT	201	3003925431	Gas	PROD	FRUITLAND COAL	Federal	Lease Basis - NMNM03862
SAN JUAN 28-4 UNIT	26	3003907420	Gas	PROD	MESAVERDE	Federal	MV PA - NMNM78410A
SAN JUAN 28-4 UNIT	26A	3003927636	Gas	PROD	MESAVERDE	Federal	MV PA - NMNM78410A
SAN JUAN 28-4 UNIT	27	3003907359	Gas	PROD	MESAVERDE	Federal	MV PA - NMNM78410A
SAN JUAN 28-4 UNIT	27A	3003926785	Gas	PROD	MESAVERDE	Federal	MV PA - NMNM78410A
SAN JUAN 28-4 UNIT	27A	3003926785	Gas	PROD	DAKOTA	Federal	Lease Basis - NMNM03862
SAN JUAN 28-4 UNIT	27M	3003930378	Gas	PROD	DAKOTA	Federal	Lease Basis - NMNM03862
SAN JUAN 28-4 UNIT	27M	3003930378	Gas	PROD	MESAVERDE	Federal	MV PA - NMNM78410A
SAN JUAN 28-4 UNIT	28	3003907388	Gas	PROD	MESAVERDE	Federal	MV PA - NMNM78410A
SAN JUAN 28-4 UNIT	28A	3003927626	Gas	PROD	MESAVERDE	Federal	MV PA - NMNM78410A
SAN JUAN 28-4 UNIT	28A	3003927626	Gas	PROD	DAKOTA	Federal	Lease Basis - NMNM03862
SAN JUAN 28-4 UNIT	34	3003920489	Gas	PROD	DAKOTA	Federal	DK PA - NMNM78410C
SAN JUAN 28-4 UNIT	34M	3003927610	Gas	PROD	DAKOTA	Federal	DK PA - NMNM78410C

Well Name	Well No.	API	State Well Classification	Well Status	Reservoir	OCD Lease Type	Reporting Serial
SAN JUAN 28-4 UNIT	34M	3003927610	Gas	PROD	MESAVERDE	Federal	MV PA - NMNM78410A
SAN JUAN 28-4 UNIT	14A	3003927627	Gas	PROD	MESAVERDE	Federal	MV PA - NMNM78410A
SAN JUAN 28-4 UNIT	36	3003920674	Gas	PROD	DAKOTA	Federal	DK PA - NMNM78410C
SAN JUAN 28-4 UNIT	36	3003920674	Gas	PROD	MESAVERDE	Federal	MV PA - NMNM78410A
SAN JUAN 28-4 UNIT	37	3003920673	Gas	PROD	MESAVERDE	Federal	MV PA - NMNM78410A
SAN JUAN 28-4 UNIT	37	3003920673	Gas	PROD	DAKOTA	Federal	DK PA - NMNM78410C
SAN JUAN 28-4 UNIT	37M	3003930377	Gas	PROD	DAKOTA	Federal	DK PA - NMNM78410C
SAN JUAN 28-4 UNIT	37M	3003930377	Gas	PROD	MESAVERDE	Federal	MV PA - NMNM78410A
SAN JUAN 28-4 UNIT	37N	3003930361	Gas	PROD	DAKOTA	Federal	DK PA - NMNM78410C
SAN JUAN 28-4 UNIT	37N	3003930361	Gas	PROD	MESAVERDE	Federal	MV PA - NMNM78410A
SAN JUAN 28-4 UNIT	8	3003907218	Gas	PROD	MESAVERDE	Federal	MV PA - NMNM78410A
SAN JUAN 28-4 UNIT	21	3003907462	Gas	PROD	MESAVERDE	Federal	MV PA - NMNM78410A
SAN JUAN 28-4 UNIT	13	3003907357	Gas	PROD	MESAVERDE	Federal	MV PA - NMNM78410A
SAN JUAN 28-4 UNIT	17A	3003930619	Gas	PROD	MESAVERDE	Federal	MV PA - NMNM78410A
SAN JUAN 28-4 UNIT	17M	3003930382	Gas	PROD	MESAVERDE	Federal	MV PA - NMNM78410A
SAN JUAN 28-4 UNIT	17M	3003930382	Gas	PROD	DAKOTA	Federal	Lease Basis - NMSF079729
SAN JUAN 28-4 UNIT	2	3003907419	Gas	PROD	MESAVERDE	Federal	MV PA - NMNM78410A
SAN JUAN 28-4 UNIT	12	3003907245	Gas	PROD	MESAVERDE	Federal	MV PA - NMNM78410A
SAN JUAN 28-4 UNIT	31	3003920084	Gas	PROD	MESAVERDE	Federal	MV PA - NMNM78410A
SAN JUAN 28-4 UNIT	31	3003920084	Gas	PROD	DAKOTA	Federal	DK PA - NMNM78410C
SAN JUAN 28-4 UNIT	31M	3003925921	Gas	PROD	MESAVERDE	Federal	MV PA - NMNM78410A
SAN JUAN 28-4 UNIT	31M	3003925921	Gas	PROD	DAKOTA	Federal	DK PA - NMNM78410C
SAN JUAN 28-4 UNIT	32M	3003926009	Gas	PROD	MESAVERDE	Federal	MV PA - NMNM78410A
SAN JUAN 28-4 UNIT	32M	3003926009	Gas	PROD	DAKOTA	Federal	DK PA - NMNM78410C
SAN JUAN 28-4 UNIT	32N	3003926596	Gas	PROD	DAKOTA	Federal	DK PA - NMNM78410C
SAN JUAN 28-4 UNIT	32N	3003926596	Gas	PROD	MESAVERDE	Federal	MV PA - NMNM78410A
SAN JUAN 28-4 UNIT	35B	3003926473	Gas	PROD	MESAVERDE	Federal	MV PA - NMNM78410A

Well Name	Well No.	API	State Well Classification	Well Status	Reservoir	OCD Lease Type	Reporting Serial
SAN JUAN 28-4 UNIT	35M	3003925949	Gas	PROD	MESAVERDE	Federal	MV PA - NMNM78410A
SAN JUAN 28-4 UNIT	35M	3003925949	Gas	PROD	DAKOTA	Federal	DK PA - NMNM78410C
SAN JUAN 28-4 UNIT	5	3003907255	Gas	PROD	MESAVERDE	Federal	MV PA - NMNM78410A
SAN JUAN 28-4 UNIT	5B	3003926289	Gas	PROD	MESAVERDE	Federal	MV PA - NMNM78410A
SAN JUAN 28-4 UNIT	5C	3003926288	Gas	PROD	MESAVERDE	Federal	MV PA - NMNM78410A
SAN JUAN 28-4 UNIT	9	3003907233	Gas	PROD	MESAVERDE	Federal	MV PA - NMNM78410A
SAN JUAN 28-4 UNIT	33E	3003929370	Gas	PROD	MESAVERDE	Federal	MV PA - NMNM78410A
SAN JUAN 28-4 UNIT	33E	3003929370	Gas	PROD	DAKOTA	Federal	DK PA - NMNM78410C
SAN JUAN 28-4 UNIT	11	3003907256	Gas	PROD	MESAVERDE	Federal	MV PA - NMNM78410A
SAN JUAN 28-4 UNIT	18	3003907225	Gas	PROD	MESAVERDE	Federal	MV PA - NMNM78410A
SAN JUAN 28-4 UNIT	29	3003920070	Gas	PROD	MESAVERDE	Federal	DK PA - NMNM78410C
SAN JUAN 28-4 UNIT	29	3003920070	Gas	PROD	DAKOTA	Federal	DK PA - NMNM78410C
SAN JUAN 28-4 UNIT	30M	3003925945	Gas	PROD	DAKOTA	Federal	DK PA - NMNM78410C
SAN JUAN 28-4 UNIT	30M	3003925945	Gas	PROD	MESAVERDE	Federal	MV PA - NMNM78410A
SAN JUAN 28-4 UNIT NP	225	3003925311	Gas	PROD	PICTURED CLIFFS	Federal	Lease Basis - NMSF079727
SAN JUAN 28-4 UNIT NP	225	3003925311	Gas	PROD	FRUITLAND COAL	Federal	Lease Basis - NMSF079727
SAN JUAN 28-4 UNIT NP	226	3003925286	Gas	PROD	PICTURED CLIFFS	Federal	Lease Basis - NMSF079729
SAN JUAN 28-4 UNIT NP	226	3003925286	Gas	PROD	FRUITLAND COAL	Federal	Lease Basis - NMSF079729

Monthly Production

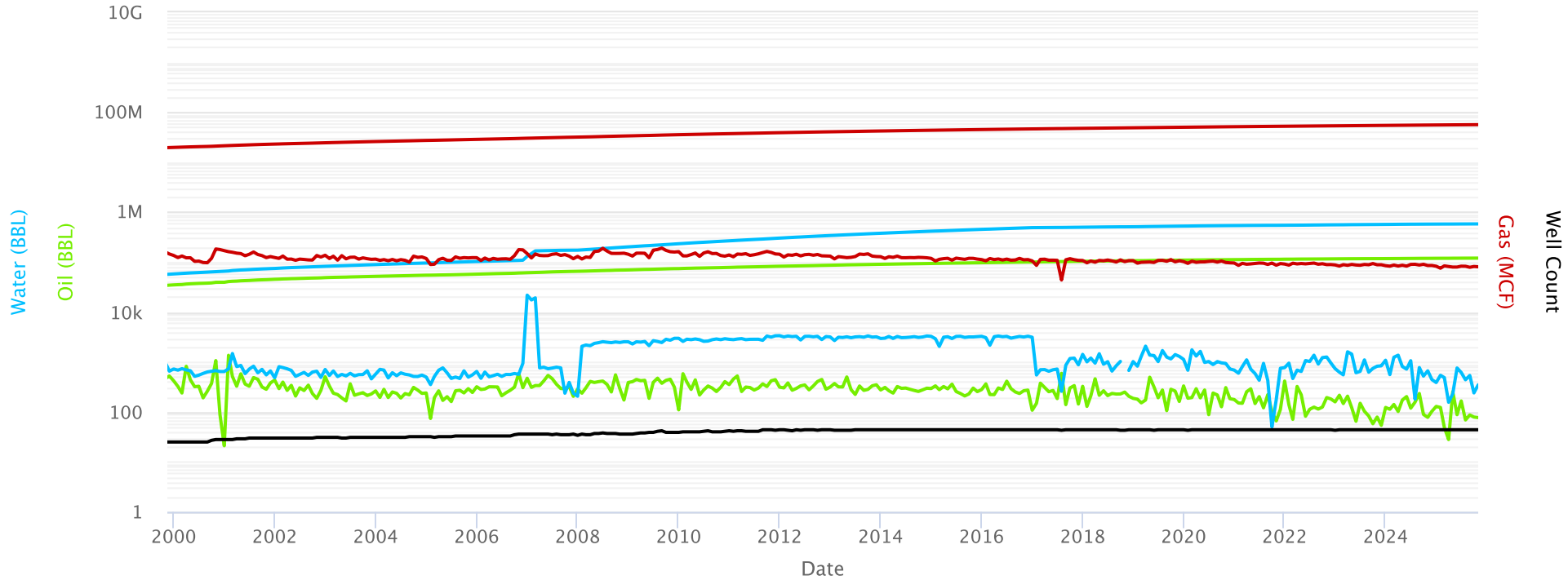

San Juan 28-4 Unit NMNM 078410A MV

Mesaverde PA - 13th Revision

Monthly Production

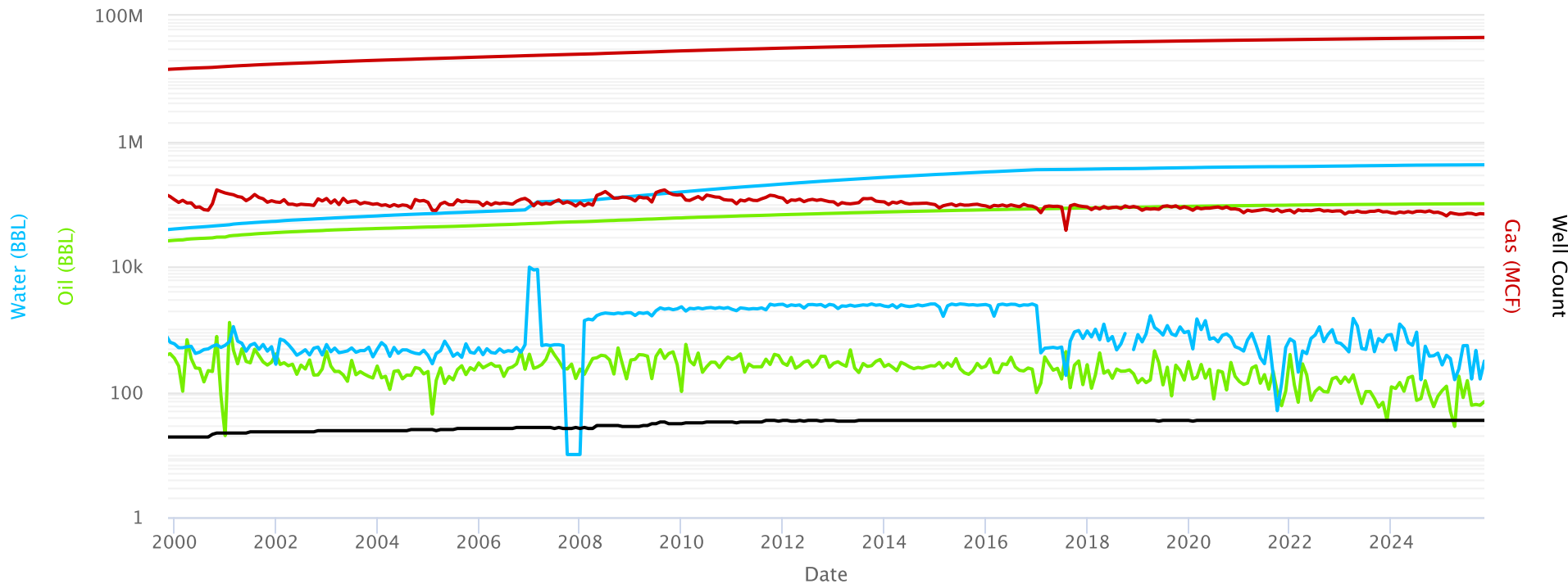

San Juan 28-4 Unit NMNM 078410B PC

Pictured Cliffs PA - 1st Revision



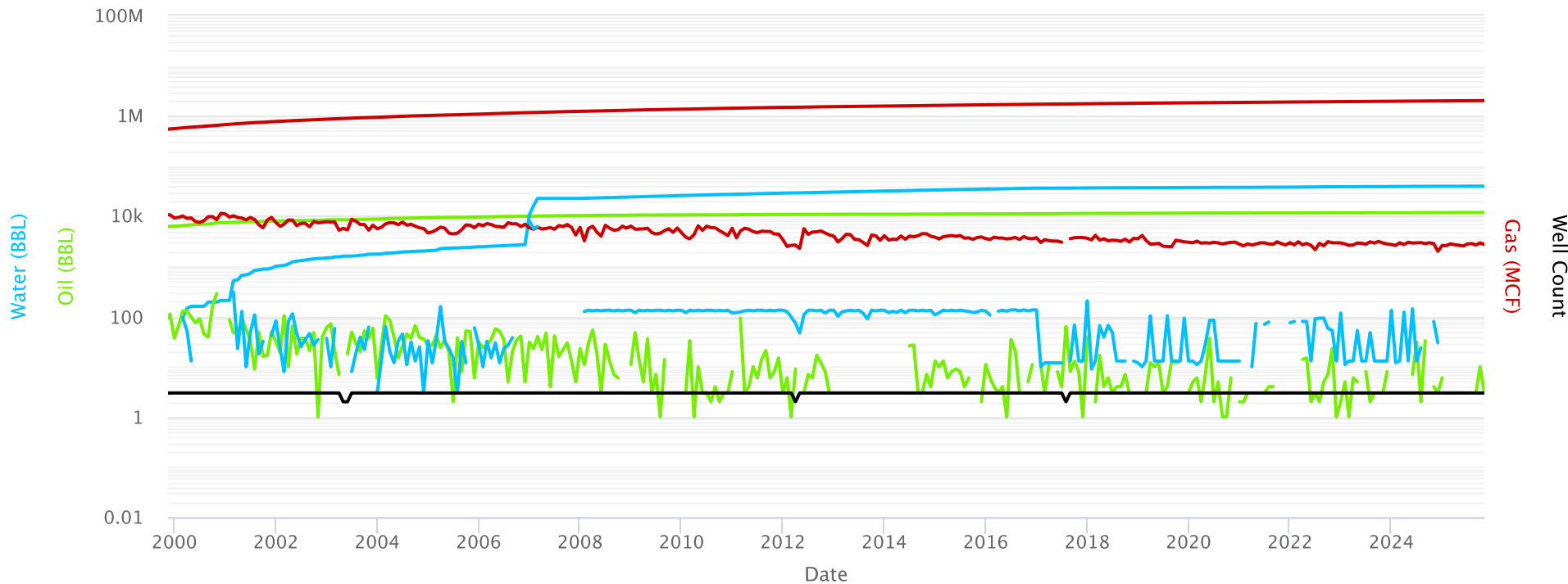

Monthly Production

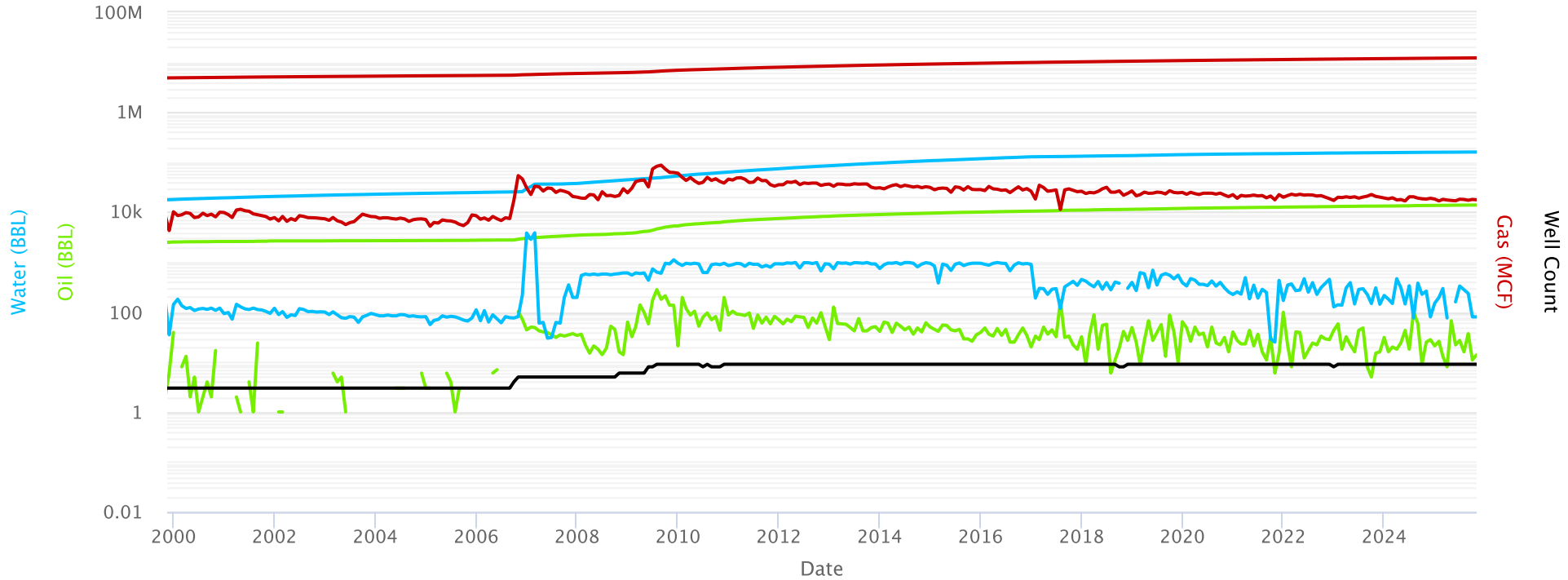

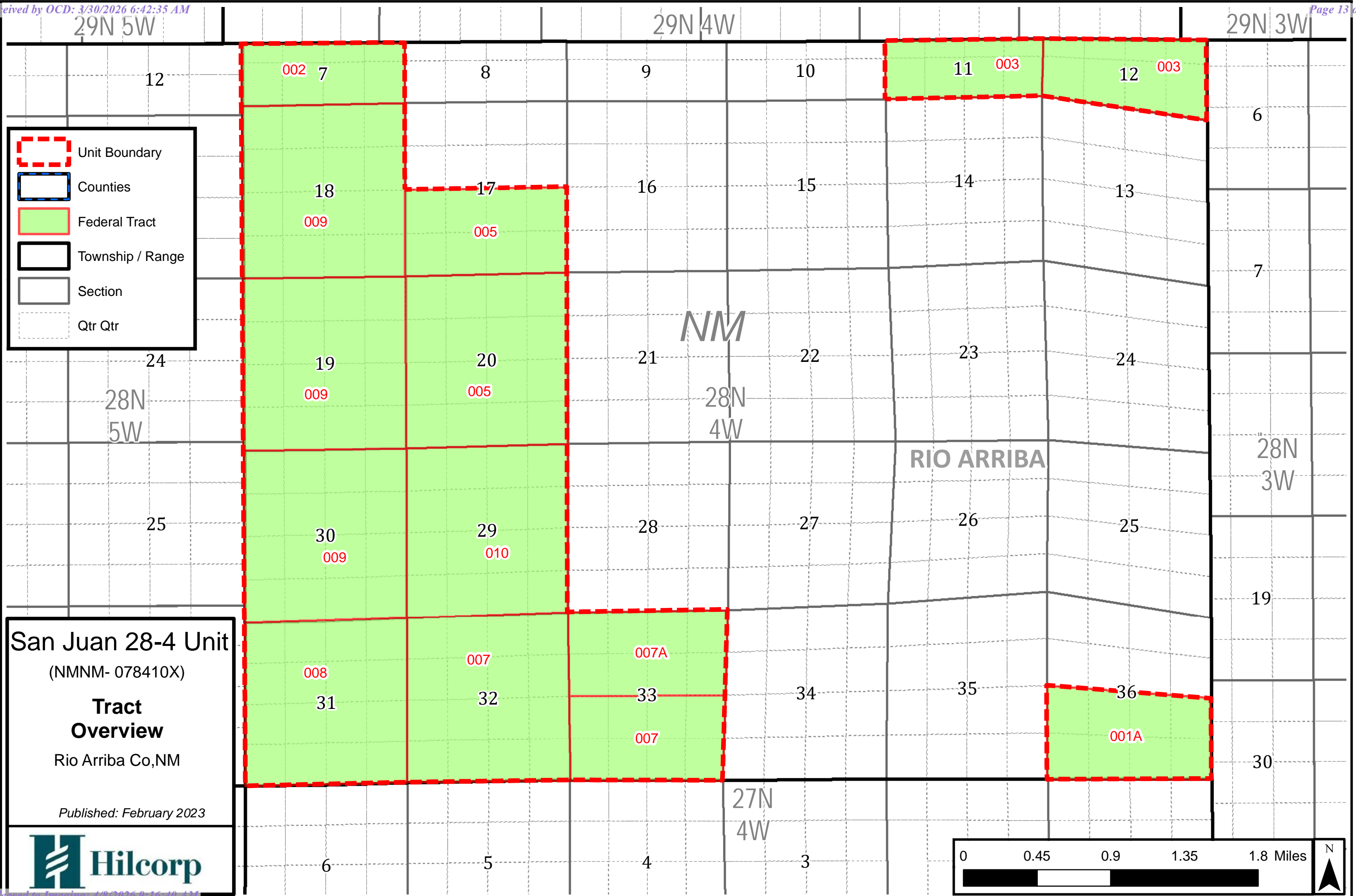
Dakota PA - 7th Revision
Monthly Production



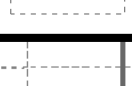

-  Unit Boundary
-  Counties
-  Federal Tract
-  Township / Range
-  Section
-  Qtr Qtr

San Juan 28-4 Unit
 (NMNM- 078410X)

Tract Overview
 Rio Arriba Co, NM

Published: February 2023



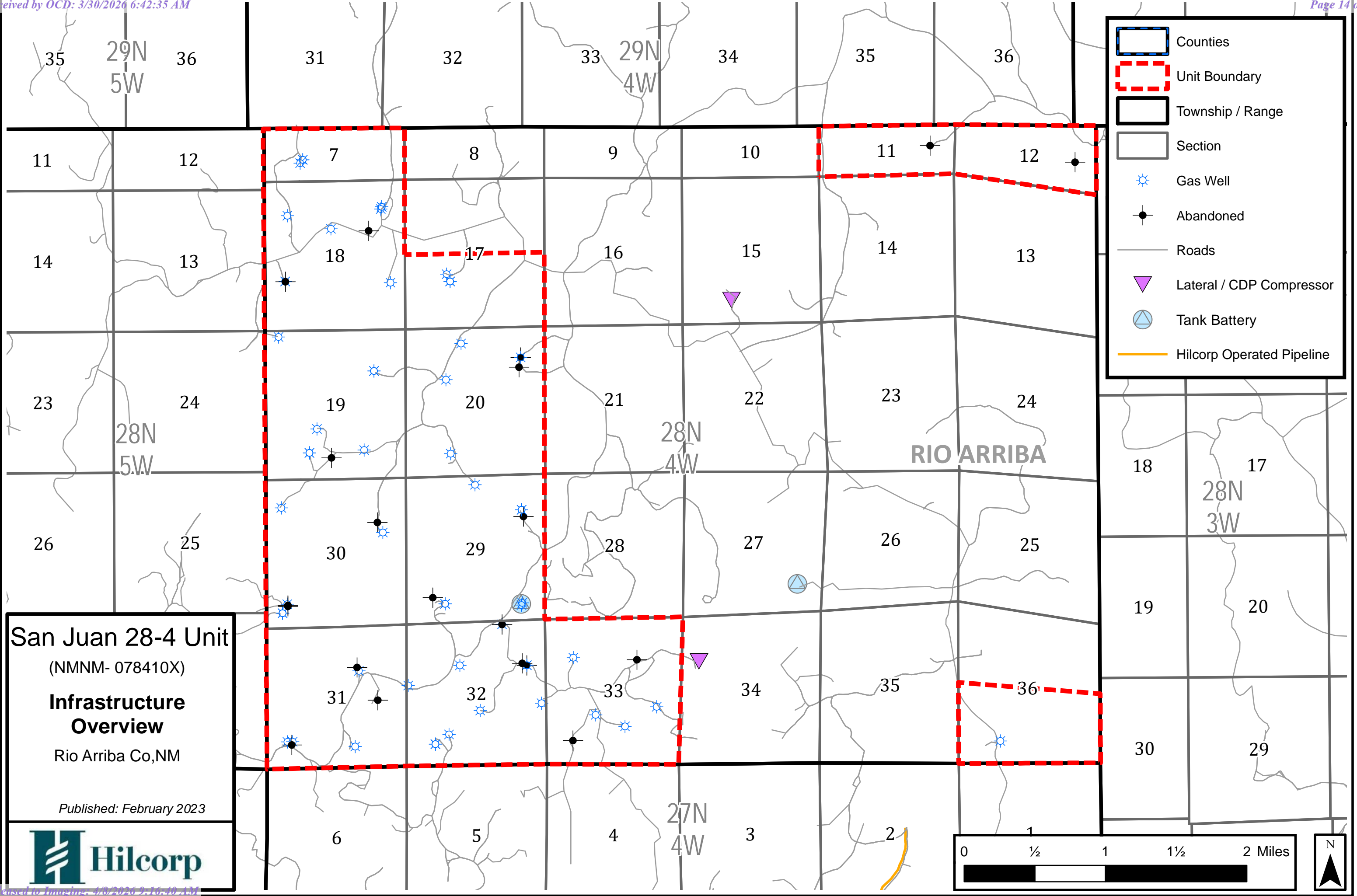





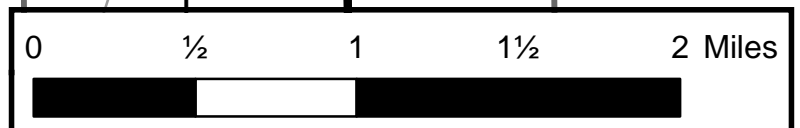

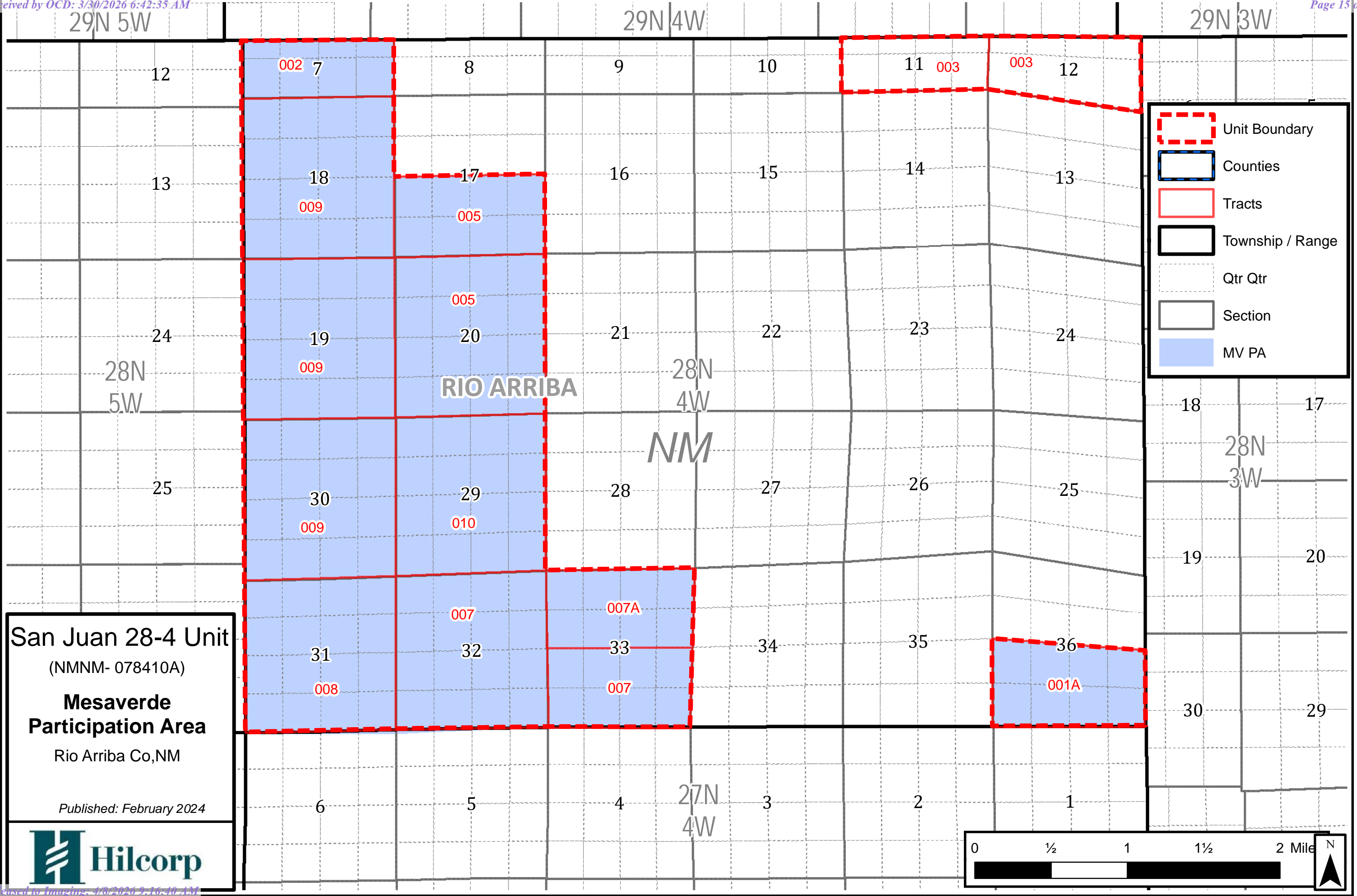

	Counties
	Unit Boundary
	Township / Range
	Section
	Gas Well
	Abandoned
	Roads
	Lateral / CDP Compressor
	Tank Battery
	Hilcorp Operated Pipeline

San Juan 28-4 Unit
 (NMNM- 078410X)
Infrastructure Overview
 Rio Arriba Co, NM
 Published: February 2023





-  Unit Boundary
-  Counties
-  Tracts
-  Township / Range
-  Qtr Qtr
-  Section
-  MV PA





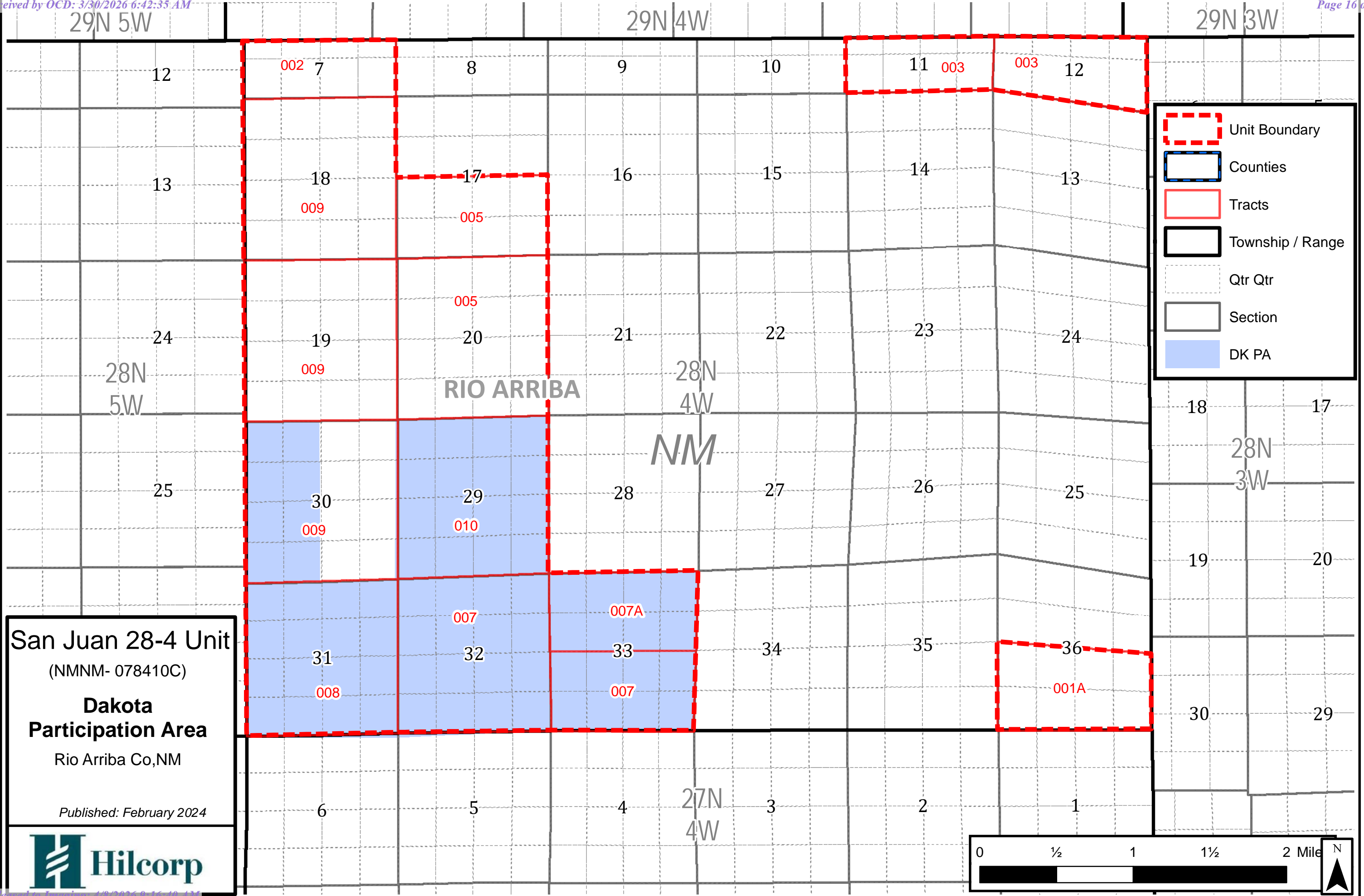

San Juan 28-4 Unit
 (NMNM- 078410A)

Mesaverde Participation Area
 Rio Arriba Co, NM

Published: February 2024











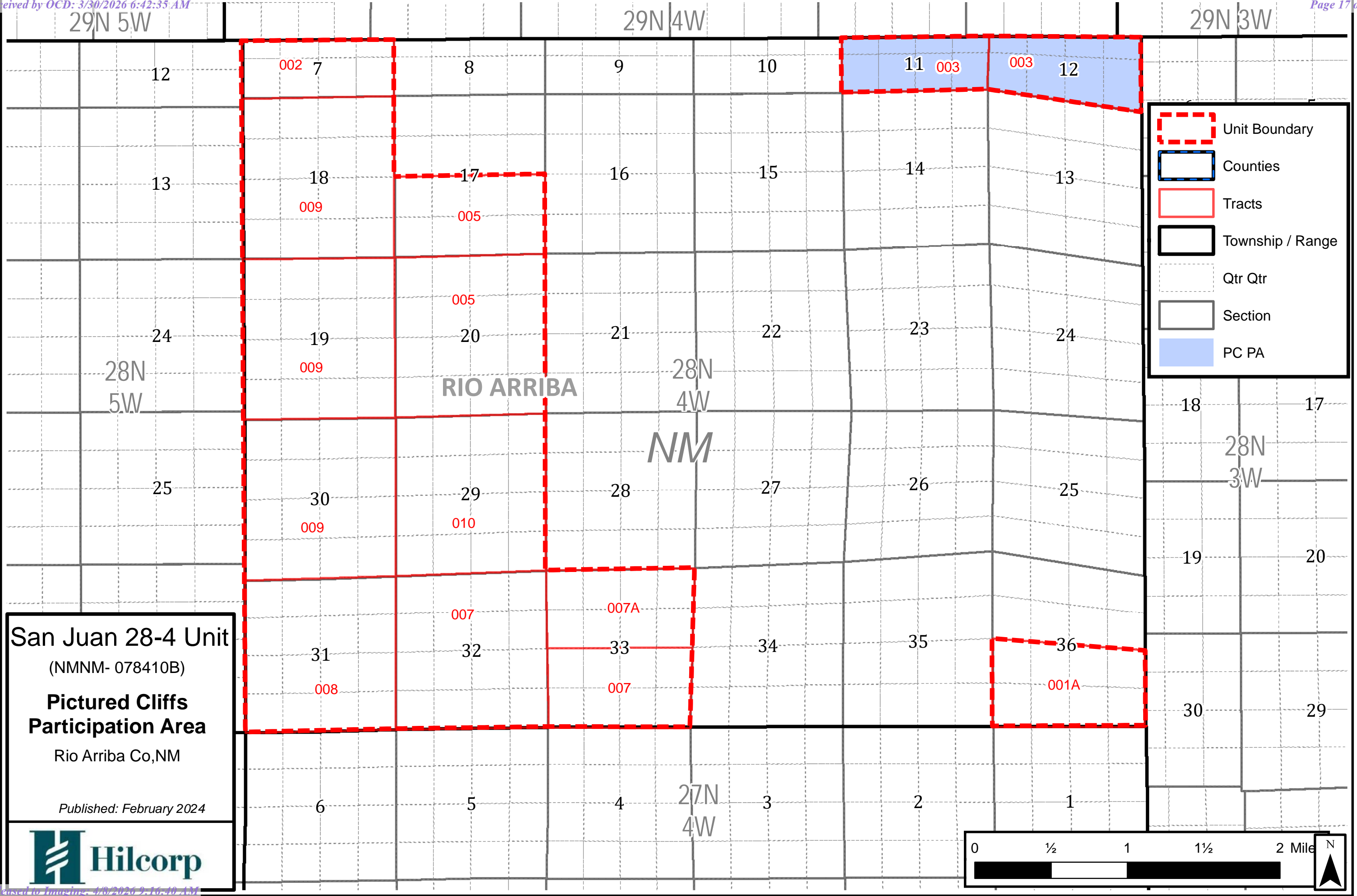

-  Unit Boundary
-  Counties
-  Tracts
-  Township / Range
-  Qtr Qtr
-  Section
-  DK PA

San Juan 28-4 Unit
 (NMNM- 078410C)
Dakota Participation Area
 Rio Arriba Co, NM
 Published: February 2024





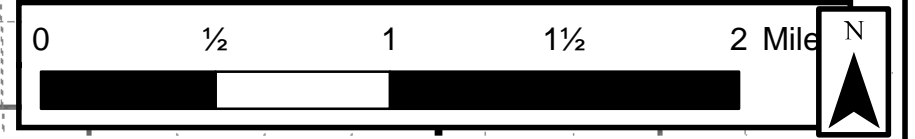

-  Unit Boundary
-  Counties
-  Tracts
-  Township / Range
-  Qtr Qtr
-  Section
-  PC PA

San Juan 28-4 Unit
 (NMNM- 078410B)
Pictured Cliffs
Participation Area
 Rio Arriba Co, NM
 Published: February 2024











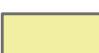
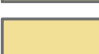

Hilcorp Energy Company

-  **FEDERAL UNITS**
-  **TOWNSHIPS**
-  **SECTIONS**

MESAVERDE_ISOPACH

-  280 - 500
-  501 - 750
-  751 - 1,000
-  1,001 - 1,250
-  1,251 - 1,500
-  1,501 - 1,750
-  1,751 - 2,000
-  2,001 - 2,250
-  2,251 - 2,500

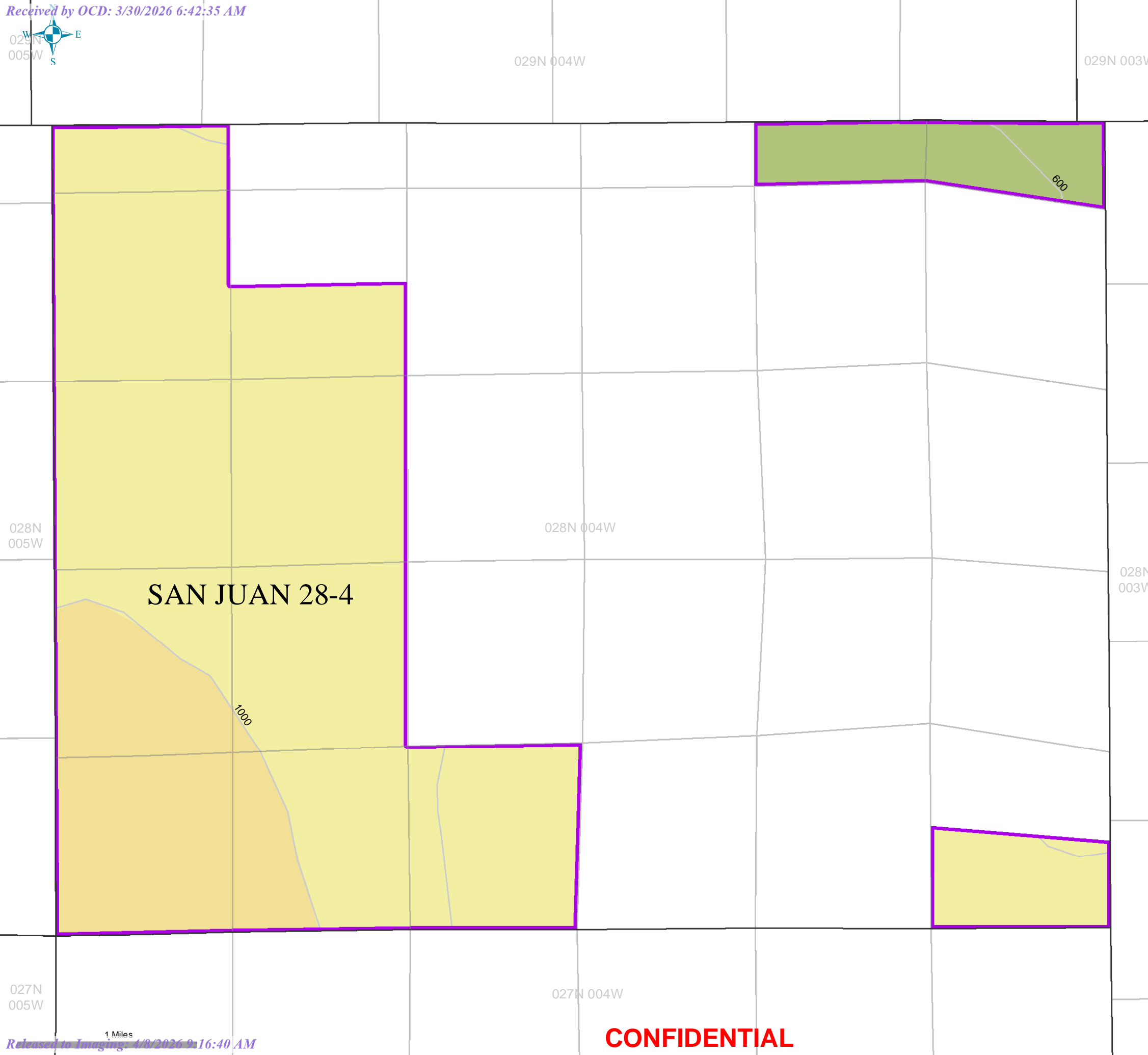

1 Miles













CONFIDENTIAL

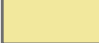
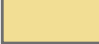

Hilcorp Energy Company

-  **FEDERAL UNITS**
-  **TOWNSHIPS**
-  **SECTIONS**

MESAVERDE_STRUCTURE

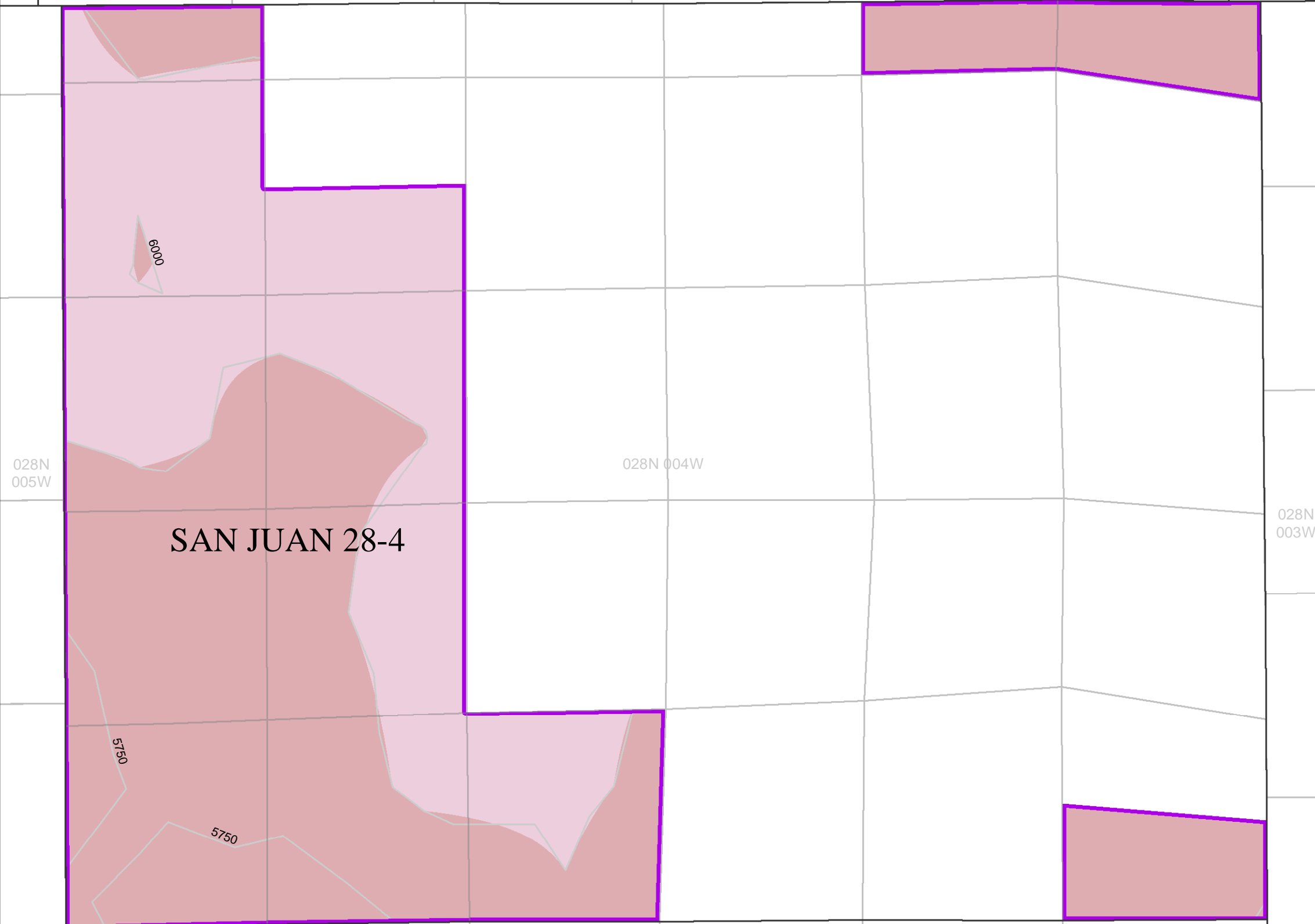

-  22 - 500
-  501 - 1,000
-  1,001 - 1,500
-  1,501 - 2,000
-  2,001 - 2,500
-  2,501 - 3,000
-  3,001 - 3,500
-  3,501 - 4,000
-  4,001 - 4,500
-  4,501 - 5,000
-  5,001 - 5,500
-  5,501 - 6,000
-  6,001 - 6,500
-  6,501 - 7,000











CONFIDENTIAL

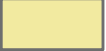

Hilcorp Energy Company

-  FEDERAL UNITS
-  TOWNSHIPS
-  SECTIONS

DAKOTA_ISOPACH

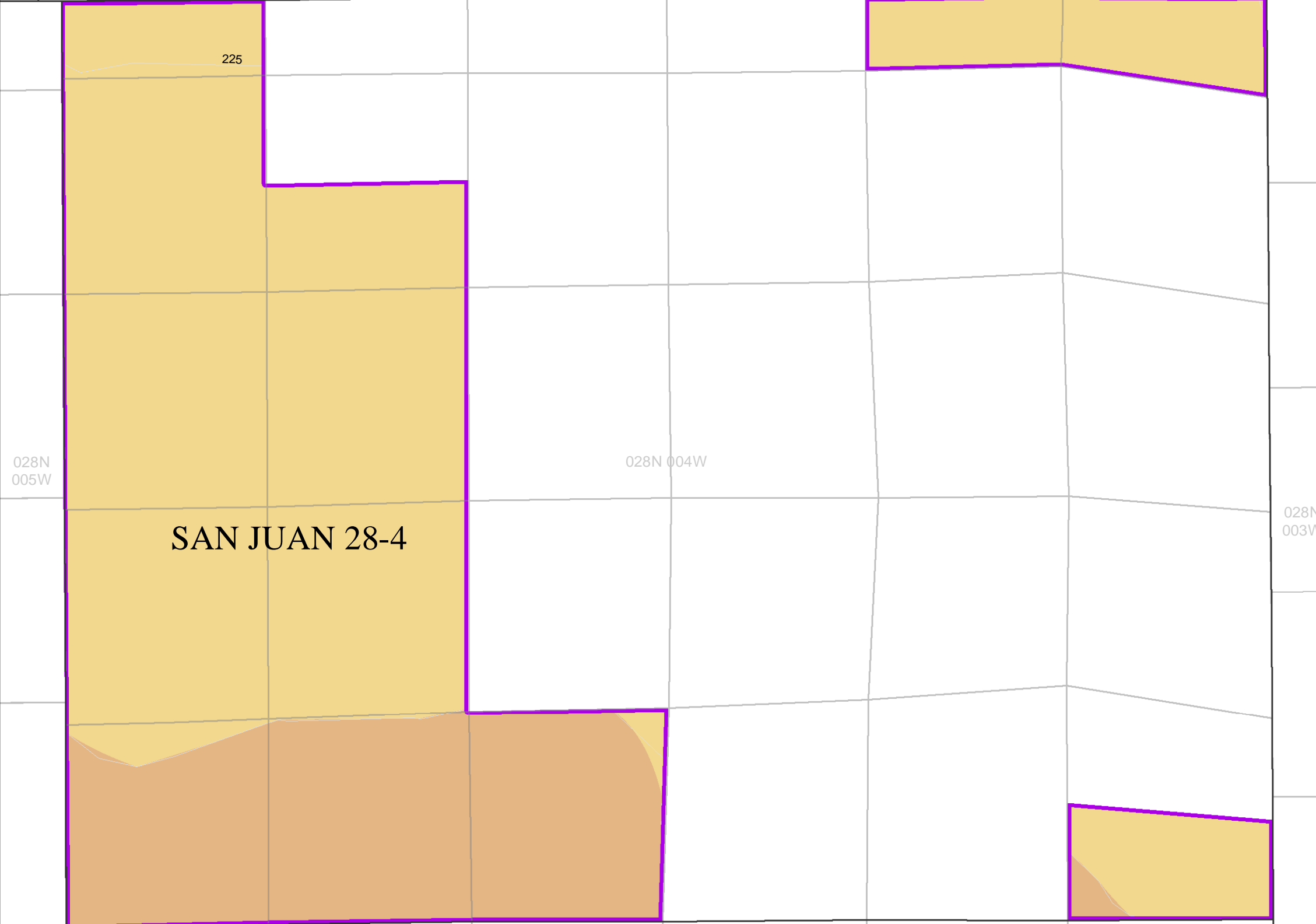

-  96 - 100
-  101 - 150
-  151 - 200
-  201 - 250
-  251 - 300
-  301 - 350
-  351 - 400
-  401 - 450



















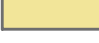

CONFIDENTIAL



Hilcorp Energy Company

-  **FEDERAL UNITS**
-  **TOWNSHIPS**
-  **SECTIONS**

DAKOTA_STRUCTURE

-  8 - 500
-  501 - 1,000
-  1,001 - 1,500
-  1,501 - 2,000
-  2,001 - 2,500
-  2,501 - 3,000
-  3,001 - 3,500
-  3,501 - 4,000
-  4,001 - 4,500
-  4,501 - 5,000
-  5,001 - 5,500
-  5,501 - 6,000
-  6,001 - 6,500
-  6,501 - 7,000
-  7,001 - 7,500
-  7,501 - 8,000
-  8,001 - 8,500
-  8,501 - 9,000
-  9,001 - 9,500



029N
005W

029N 004W

029N 003W

028N
005W

028N 004W

028N
003W

SAN JUAN 28-4

8200

8300

8400

8400

8300

8200

8500

8500

027N
005W



027N 004W

1 Miles







CONFIDENTIAL

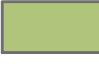
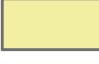

Hilcorp Energy Company

-  **FEDERAL UNITS**
-  **TOWNSHIPS**
-  **SECTIONS**

PICTUREDCLIFFS_ISOPACH

-  30 - 90
-  91 - 150
-  151 - 209
-  210 - 269
-  270 - 329
-  330 - 389
-  390 - 448
-  449 - 508
-  509 - 568



029N
005W

029N 004W

029N 003W

028N
005W

028N 004W

028N
003W

SAN JUAN 28-4

100

100

027N
005W



027N 004W

1 Miles









CONFIDENTIAL

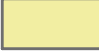

Hilcorp Energy Company

-  **FEDERAL UNITS**
-  **TOWNSHIPS**
-  **SECTIONS**

PICTUREDCLIFFS_STRUCTURE

-  -646 - -24
-  -23 - 597
-  598 - 1,219
-  1,220 - 1,841
-  1,842 - 2,463
-  2,464 - 3,085
-  3,086 - 3,707
-  3,708 - 4,329
-  4,330 - 4,951

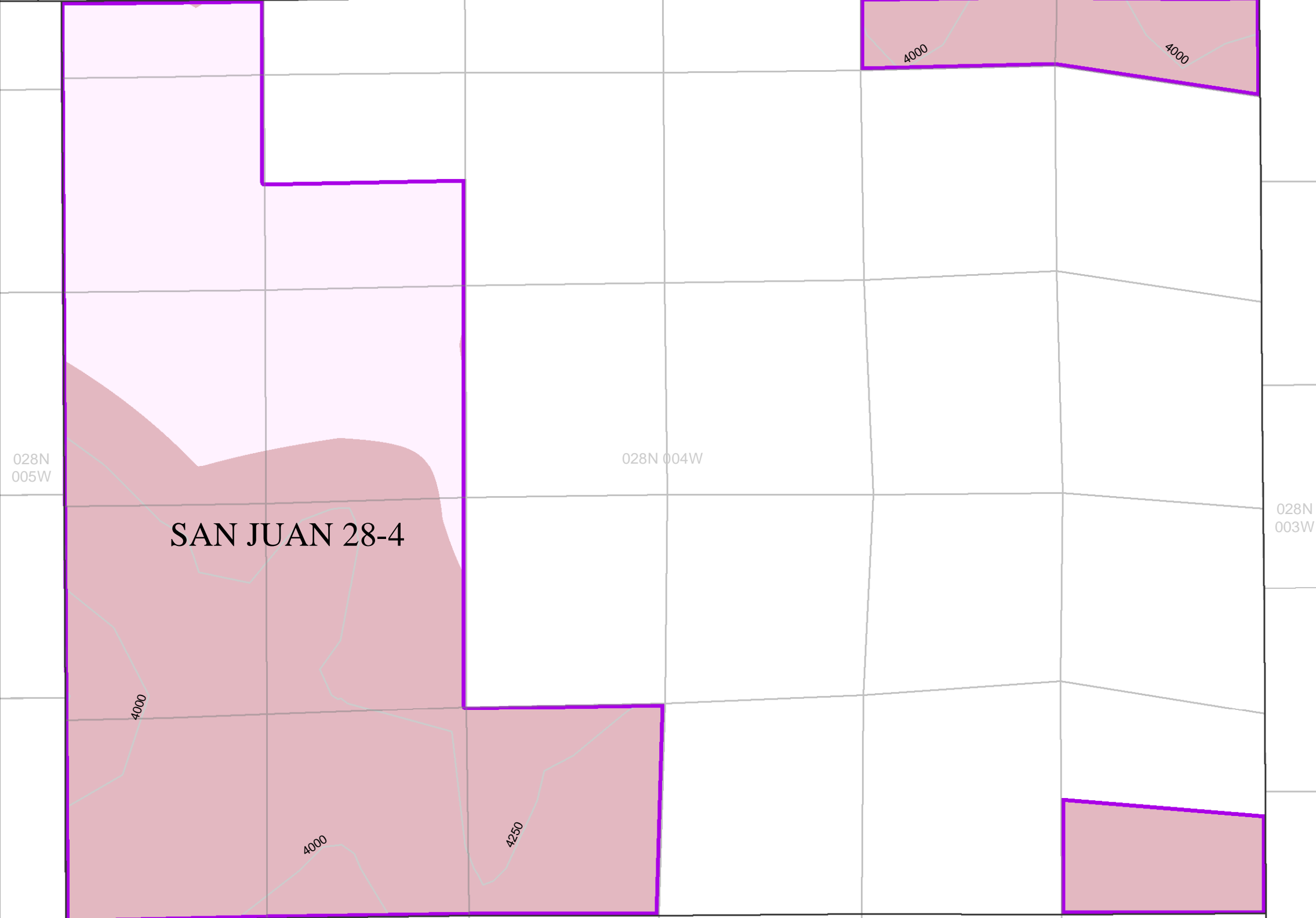

027N 005W

027N 004W

1 Miles

CONFIDENTIAL

Sante Fe Main Office
Phone: (505) 476-3441

General Information
Phone: (505) 629-6116

Online Phone Directory
<https://www.emnrd.nm.gov/ocd/contact-us>

State of New Mexico
Energy, Minerals and Natural Resources
Oil Conservation Division
1220 S. St Francis Dr.
Santa Fe, NM 87505

CONDITIONS

Action 568680

CONDITIONS

Operator: HILCORP ENERGY COMPANY 1111 Travis Street Houston, TX 77002	OGRID: 372171
	Action Number: 568680
	Action Type: [HEAR] Order Compliance/Progress Report (ORDER COMPLIANCE REPORT)

CONDITIONS

Created By	Condition	Condition Date
dmcclure	ACCEPTED FOR RECORD	4/8/2026