

CASE 4525: Application of WOLFSON  
OIL CO. FOR A NON-STANDARD GAS  
PRORATION UNIT, LEA COUNTY, N.M.

Case Number

4525

Application

Transcripts

Small Exhibits

ETC.

dearnley-meier reporting service, inc.

SPECIALIZING IN: DEPOSITIONS, HEARINGS, STATEMENTS, EXPERT TESTIMONY, DAILY COPY, CONVENTIONS

209 SIMMS BLDG. • P.O. BOX 1092 • PHONE 243-6691 • ALBUQUERQUE, NEW MEXICO



BEFORE THE  
NEW MEXICO OIL CONSERVATION COMMISSION  
Santa Fe, New Mexico  
April 28, 1971

EXAMINER HEARING

-----)  
IN THE MATTER OF: )  
 )  
Application of Wolfson ) Case No. 4525  
Oil Company for a )  
non-standard gas proration )  
unit, Lea County, New Mexico )  
 )  
-----)

BEFORE: Elvin A. Utz, Examiner

TRANSCRIPT OF PROCEEDINGS

dearnley-meier

SPECIALIZING IN: DEPOSITIONS, HEARINGS, STATEMENTS, EXPERT TESTIMONY, DAILY COPY, CONVENTIONS  
 209 SIMMS BLDG. P.O. BOX 1092 • PHONE 243-6691 • ALBUQUERQUE, NEW MEXICO 87103  
 FIRST NATIONAL BANK BLDG. EAST • ALBUQUERQUE, NEW MEXICO 87108

1 MR. UTZ: Case 4525.

2 MR. HATCH: Case 4525, application of Wolfson Oil  
 3 Company for a non-standard gas proration unit, Lea County,  
 4 New Mexico.

5 MR. KELLAHIN: If the Examiner please,  
 6 Jason Kellahin, Kellahin and Fox, Santa Fe, appearing for  
 7 the Applicant.

8 We have one witness I would like to have  
 9 sworn.

10 (Witness sworn.)

11 (Whereupon, Applicant's  
 12 Exhibits One and Two were  
 marked for identification.)

13 MR. UTZ: Are there other appearances?

14 HAROLD G. FREIDMAN

15 called as a witness, having first been duly sworn, was  
 16 examined and testified as follows:

17 DIRECT EXAMINATION

18 BY MR. KELLAHIN:

19 Q Would you state your name, please?

20 A My name is Harold G. Freidman.

21 Q By whom are you employed and in what position,  
 22 Mr. Freidman?

23 A I am a petroleum engineer with Wolfson Oil  
 24 Company.

25 Q All right; have you ever testified before the

1 Oil Conservation Commission of New Mexico and made your  
2 qualifications as an engineer a matter of record?

3 A Yes sir, I have.

4 MR. KELLAHIN: Are the witness' qualifications  
5 acceptable?

6 MR. UTZ: Yes sir, they are.

7 Q (By Mr. Kellahin) Mr. Freidman, are you  
8 familiar with the application of Wolfson Oil Company in  
9 Case 4525?

10 A Yes, sir.

11 Q Briefly, what does the applicant propose in this  
12 case?

13 A The applicant desires a non-standard gas  
14 proration unit. The well was originally drilled as a  
15 South Eunice field well, and extensive testing in the  
16 South Eunice field zone proved unsuccessful. Subsequent  
17 testing of the Jalmat Oil proved unsuccessful, and the  
18 well was put back on Jalmat as a gas well.

19 Q And it is now completed as a Jalmat gas  
20 well?

21 A Yes, sir.

22 Q Was the well originally projected to the Queen  
23 Formation?

24 A Yes, sir.

25 Q And what is the location of the well?

dearnley-meier

SPECIALIZING IN: DEPOSITIONS, HEARINGS, STATEMENTS, EXPERT TESTIMONY, DAILY COPY, CONVENTIONS

209 SIMMS BLDG. • P.O. BOX 1092 • PHONE 243-6691 • ALBUQUERQUE, NEW MEXICO 87103  
FIRST NATIONAL BANK BLDG. EAST • ALBUQUERQUE, NEW MEXICO 87108

dearnley-meier

SPECIALIZING IN: DEPOSITIONS, HEARINGS, STATEMENTS, EXPERT TESTIMONY, DAILY COPY, CONVERSIONS  
 209 SIMMS BLDG. • P.O. BOX 1092 • PHONE 243-6691 • ALBUQUERQUE, NEW MEXICO 87103  
 FIRST NATIONAL BANK BLDG. EAST • ALBUQUERQUE, NEW MEXICO 87108

1 A The well is 330 from the west line and 310 from  
 2 the south line of Section 20, 22 South, 36 East.

3 Q Referring to what has been marked as the  
 4 Applicant's Exhibit Number One, is that a plat showing  
 5 the area in which this well is located?

6 A Yes, sir.

7 Q Have you outlined on that the proposed non-  
 8 standard unit?

9 A Yes sir, I have.

10 Q And what does it consist of?

11 A It consists of 280 acres, with the exception  
 12 of the northwest of the northwest quarter. It's 320 from  
 13 the northwest and northwest quarter.

14 Q In other words, actually, it's a half section  
 15 with one-quarter deleted from it?

16 A Yes, sir.

17 Q And who is the operator of that?

18 A Cities Service.

19 Q And is there a well located on that acreage?

20 A Yes sir, there is a Jalmat oil well on that  
 21 acreage.

22 Q And they declined to commit their acreage to  
 23 your gas well, is that correct?

24 A Yes, sir.

25 Q And is that the reason you are unable to form a

dearnley-meier

SPECIALIZING IN: DEPOSITIONS, HEARINGS, STATEMENTS, EXPERT TESTIMONY, DAILY COPY, CONVENTIONS  
 209 SIMMS BLDG. • P.O. BOX 1092 • PHONE 243-6691 • ALBUQUERQUE, NEW MEXICO 87103  
 FIRST NATIONAL BANK BLDG. EAST • ALBUQUERQUE, NEW MEXICO 87108

1 non-standard 320 acre unit?

2 A Yes sir, that's correct.

3 Q And now referring to what has been marked as  
 4 Exhibit Number Two, would you identify that exhibit?

5 A Number Two is a structural map on top of the  
 6 Yates.

7 Q No, that's Number One --

8 A Oh --

9 Q Go ahead, excuse me, that's the structural map --

10 A This structural map indicates the Yates to be  
 11 productive throughout that half section.

12 Q And that structure is on top of the Yates, is that  
 13 correct?

14 A Yes sir, it is.

15 Q Now, Exhibit Number Two, is that a log of the  
 16 subject well?

17 A That is a log of the well showing the perforations  
 18 in the South Eunice Queen Zone and the subsequent bridge  
 19 plugs and the perforations and testing in the Jalmat oil,  
 20 subsequent bridge plug.

21 Q Did you set a bridge plug above the Jalmat oil  
 22 zone?

23 A Yes sir, we did.

24 Q And does it show the perforations in the Jalmat  
 25 gas zone?

dearnley-meier

SPECIALIZING IN: DEPOSITIONS, HEARINGS, STATEMENTS, EXPERT TESTIMONY, DAILY COPY, CONVENTIONS  
 209 5<sup>TH</sup> FLOOR BLDG. • P.O. BOX 1092 • PHONE 243-6691 • ALBUQUERQUE, NEW MEXICO 87103  
 FIRST NATIONAL BANK BLDG. EAST • ALBUQUERQUE, NEW MEXICO 87108

1 A Yes sir, it does.

2 Q And does it give the footagelocations of those  
 3 perforations?

4 A Yes sir, it does.

5 Q There is another well shown on your Exhibit  
 6 Number One in the proposed unit. What is that well?

7 A That well is the Cities Service well. The  
 8 whole 320 acres was formerly dedicated to that well  
 9 until the water broke on the well and it has not produced  
 10 since 1964. It was a Jalmat gas well.

11 Q Does the fact that water broke into that well  
 12 indicate that all that acreage is non-productive of gas  
 13 in the Jalmat?

14 A No sir, it does not, in my opinion.

15 Q What do you think occasioned the water encroachment  
 16 at that time?

17 A I believe it came from the lower South Eunice  
 18 Zone. The well that was originally completed there  
 19 in the South Eunice Queen Zone has an extensive water  
 20 drive and high pressure water, and I believe it broke  
 21 through.

22 Q You do not think it was Jalmat gas Zone water  
 23 then, is that correct?

24 A No sir, I don't.

25 Q Were exhibits One and Two prepared by you or under



dearnley-meier

SPECIALIZING IN: DEPOSITIONS, HEARINGS, STATEMENTS, EXPERT TESTIMONY, DAILY COPY, CONVENTIONS  
 209 SIMMS BLDG. • P.O. BOX 1092 • PHONE 243-6691 • ALBUQUERQUE, NEW MEXICO 87103  
 FIRST NATIONAL BANK BLDG. EAST • ALBUQUERQUE, NEW MEXICO 87108

1 your supervision?

2 A Yes, sir.

3 Q In your opinion, will the approval of this  
 4 application result in the prevention of waste and give  
 5 Wolfson Oil Company an opportunity to produce its share  
 6 of the gas underlying this acreage?

7 A Yes, sir.

8 MR. KELLAHIN: At this time, I'd like to offer  
 9 in evidence Exhibits One and Two.

10 MR. UTZ: Without objection, Exhibits One and  
 11 Two will be entered into the record of this case.

(Whereupon, Applicant's  
 Exhibits One and Two were  
 received in evidence.)

14 MR. UTZ: Mr. Kellahin, was this an exhibit --

15 A It's identical with the other exhibit, except  
 16 it does not have the contours on it.

17 MR. UTZ: I see.

18 CROSS EXAMINATION

19 BY MR. UTZ:

20 Q Mr. Wolfson, up in Section 17 in the southwest  
 21 quarter of the well, noted as Number Five plus 395, that's  
 22 plus 395 above the Yates datum, I presume. Is that a  
 23 Jalmat gas well?

24 A Will you repeat that, sir? I didn't have it in  
 25 front of me.

dearnley-meier

SPECIALIZING IN: DEPOSITIONS, HEARINGS, STATEMENTS, EXPERT TESTIMONY, DAILY COPY, CONVENTIONS  
 209 SIMMS BLDG. • P. O. BOX 1092 • PHONE 243-6691 • ALBUQUERQUE, NEW MEXICO 87103  
 FIRST NATIONAL BANK BLDG. EAST • ALBUQUERQUE, NEW MEXICO 87108

- 1 Q In Section --
- 2 A Oh, Section Five --
- 3 Q Seventeen.
- 4 A Yes sir, it was at one time.
- 5 Q Section 17, we're looking at the same --
- 6 A Yes.
- 7 Q -- Number Five well?
- 8 A Yes, sir.
- 9 Q It's not producing any longer?
- 10 A Not to my knowledge, sir.
- 11 Q Is there any wells producing to the east of
- 12 this unit?
- 13 A Yes sir, there's Cities Service directly east.
- 14 Q Yes.
- 15 A Not in the Section 20, sir.
- 16 Q Is there any wells producing on the plus four
- 17 contour?
- 18 A I believe there are further south, sir, that
- 19 Continental has one located in the section south that
- 20 I believe is still producing. In fact, they have two
- 21 in the section south of 20.
- 22 Q You may have stated this, but I don't recall.
- 23 Is this an old well or recompletion or what?
- 24 A No sir, this is a new well.
- 25 Q A new well?

dearnley-meier

SPECIALIZING IN: DEPOSITIONS, HEARINGS, STATEMENTS, EXPERT TESTIMONY, DAILY COPY, CONVENTIONS  
209 SIMMS BLDG. • P.O. BOX 1092 • PHONE 243-6691 • ALBUQUERQUE, NEW MEXICO 87103  
FIRST NATIONAL BANK BLDG. EAST • ALBUQUERQUE, NEW MEXICO 87108

1 A Yes, sir.

2 Q When was the well completed?

3 A February 21st of this year.

4 Q You drilled on down to the South Eunice, is that

5 correct?

6 A Yes, sir.

7 Q And plugged it back at Jalmat?

8 A Yes, sir.

9 MR. UTZ: Questions of the witness?

10 The witness may be excused.

11 (Witness excused.)

12 MR. UTZ: Statements?

13 The case will be taken under advisement.

14

15

16

17

18

19

20

21

22

23

24

25

dearnley-meier

SPECIALIZING IN: DEPOSITIONS, HEARINGS, STATEMENTS, EXPERT TESTIMONY, DAILY COPY, CONVENTIONS  
209 SIMMS BLDG. • P. O. BOX 1092 • PHONE 243-6691 • ALBUQUERQUE, NEW MEXICO 87103  
FIRST NATIONAL BANK BLDG. EAST • ALBUQUERQUE, NEW MEXICO 87108

1  
2  
3  
4  
5  
6  
7  
8  
9  
10  
11  
12  
13  
14  
15  
16  
17  
18  
19  
20  
21  
22  
23  
24  
25

I N D E X

WITNESS

PAGE

HAROLD G. FREIDMAN

Direct Examination by Mr. Kellahin

2

Cross Examination by Mr. Utz

7

EXHIBIT

MARKED

OFFERED AND RECEIVED

Applicant's  
1 and 2

2

7





BEFORE THE OIL CONSERVATION COMMISSION  
OF THE STATE OF NEW MEXICO

IN THE MATTER OF THE HEARING  
CALLED BY THE OIL CONSERVATION  
COMMISSION OF NEW MEXICO FOR  
THE PURPOSE OF CONSIDERING:

CASE NO. 4525  
Order No. R-4139

APPLICATION OF WOLFSON OIL  
COMPANY FOR A NON-STANDARD GAS  
PRORATION UNIT, LEA COUNTY, NEW  
MEXICO.

ORDER OF THE COMMISSION

BY THE COMMISSION:

This cause came on for hearing at 9 a.m. on April 28, 1971, at Santa Fe, New Mexico, before Examiner Elvis A. Utz.

NOW, on this 6th day of May, 1971, the Commission, a quorum being present, having considered the testimony, the record, and the recommendations of the Examiner, and being fully advised in the premises,

FINDS:

(1) That due public notice having been given as required by law, the Commission has jurisdiction of this cause and the subject matter thereof.

(2) That the applicant, Wolfson Oil Company, seeks approval of a 280-acre non-standard gas proration unit comprising the SW/4, S/2 NW/4 and NE/4 NW/4 of Section 20, Township 22 South, Range 36 East, NMPM, Lea County, New Mexico, to be dedicated to its Cities-Federal Well No. 1 located 2310 feet from the South line and 330 feet from the West line of said Section 20.

(3) That the entire non-standard proration unit is productive of gas from the Jalmat Gas Pool and that the entire non-standard proration unit can be efficiently and economically drained and developed by said Cities-Federal Well No. 1.

(4) That approval of the subject application will afford the applicant the opportunity to produce its just and equitable share of the gas in the Jalmat Gas Pool, will prevent the economic loss caused by the drilling of unnecessary wells, avoid the

-2-

CASE NO. 4525  
Order No. R-4139

augmentation of risk arising from the drilling of an excessive number of wells, and will otherwise prevent waste and protect correlative rights.

IT IS THEREFORE ORDERED:

(1) That a 280-acre non-standard gas proration unit in the Jalmat Gas Pool comprising the SW/4, S/2 NW/4 and NE/4 NW/4 of Section 20, Township 22 South, Range 36 East, NMPM, Lea County, New Mexico, is hereby established and dedicated to the Wolfson Oil Company Cities-Federal Well No. 1, located 2310 feet from the South line and 330 feet from the West line of said Section 20.

(2) That jurisdiction of this cause is retained for the entry of such further orders as the Commission may deem necessary.

DONE at Santa Fe, New Mexico, on the day and year hereinabove designated.

STATE OF NEW MEXICO  
OIL CONSERVATION COMMISSION

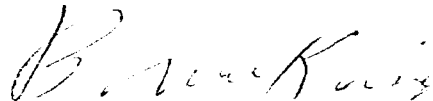
  
BRUCE KING, Chairman

  
ALEX J. ARMIJO, Member

  
A. L. PORTER, Jr., Member & Secretary

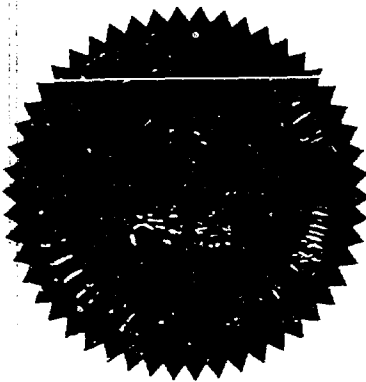

dx/



Case 4525

Recd 4-28-71

Recd 5-3-71

Grant Nelson oil Comp. request  
for a 250 Ac. NSP in Federal  
Gas Pool. Unit to consist of  
22S-36E.

Sec. 20 NE 1/4 NW 1/4, SW 1/4 NW 1/4,  
SW 1/4. 250 Ac.

Unit to be dedicated to these  
Cities. - Fed. #1, 2310/S, 338/W lines

of Sec. 20.  
Make unit effective May 1 1971.

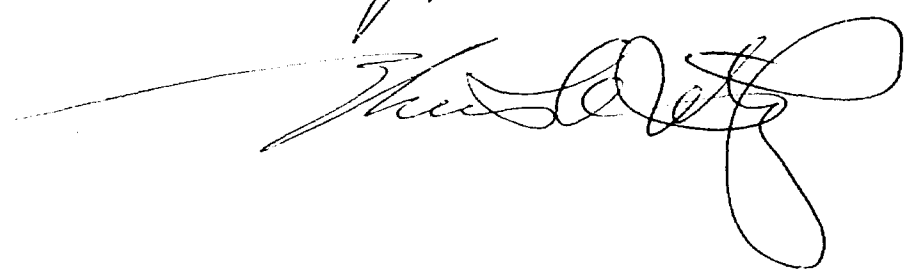

OIL CONSERVATION COMMISSION

P. O. BOX 2088

SANTA FE, NEW MEXICO 87501

March 23, 1971

*From 4.5-2.5*

C  
O  
P  
Y

Wolfson Oil Company  
311 Midland National Bank Building  
Midland, Texas

**DOCKET MAILED**

*4-16-71*

Attention: Mr. H. G. Freedman

~~Date~~

Re: Cities - Federal Well No. 1  
located 2310 FSL oil 330 FWL  
of Section 20, Township 22  
South, Range 36 East, NMPM,  
Jalmat Gas Pool, Lea County,  
New Mexico

Gentlemen:

In response to your request of March 19, 1971,  
your application for a non-standard proration unit  
will be amended to dedicate 280 acres.

Very truly yours,

GEORGE M. HATCH  
Attorney

GMH/dr

cc: Oil Conservation Commission  
P. O. Box 1980  
Hobbs, New Mexico

# Memo

From  
Melba  
~~XXXXXXXXXX~~

Deputy Oil & Gas Inspector

To George Hatch

Please note attached revision in  
proposed non-standard unit.  
Can you get it changed for the  
April hearing?

*Case 4525*

WOLFSON OIL COMPANY

OIL PRODUCERS

3200 REPUBLIC NATIONAL BANK TOWER  
DALLAS, TEXAS 75201

311 MIDLAND NATIONAL BANK BUILDING  
MIDLAND, TEXAS

March 19, 1971

Oil Conservation Commission  
Box 1980  
Hobbs, New

*Case 2-25*  
Re: Citicor-Federal No. 1  
2310' FSL 330' FWL 20-22-36  
Lea Co., New Mexico

Attn: Mr. Joe Ramsey

Dear Mr. Ramsey;

In our letter of March 3, 1971 we submitted a plat dedicating 160 acres to the above captioned well.

We wish to submit an amended plat dedicating 280 acres to our Jalnat gas well.

Yours very truly,

Wolfson Oil Company

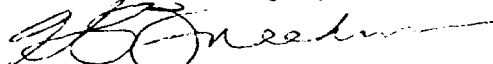
  
H.G. Freedman

Case 4-5-2-5

WOLFSON OIL COMPANY  
OIL PRODUCERS  
6000 REPUBLIC NATIONAL BANK TOWER  
DALLAS, TEXAS 75201

R-36-E

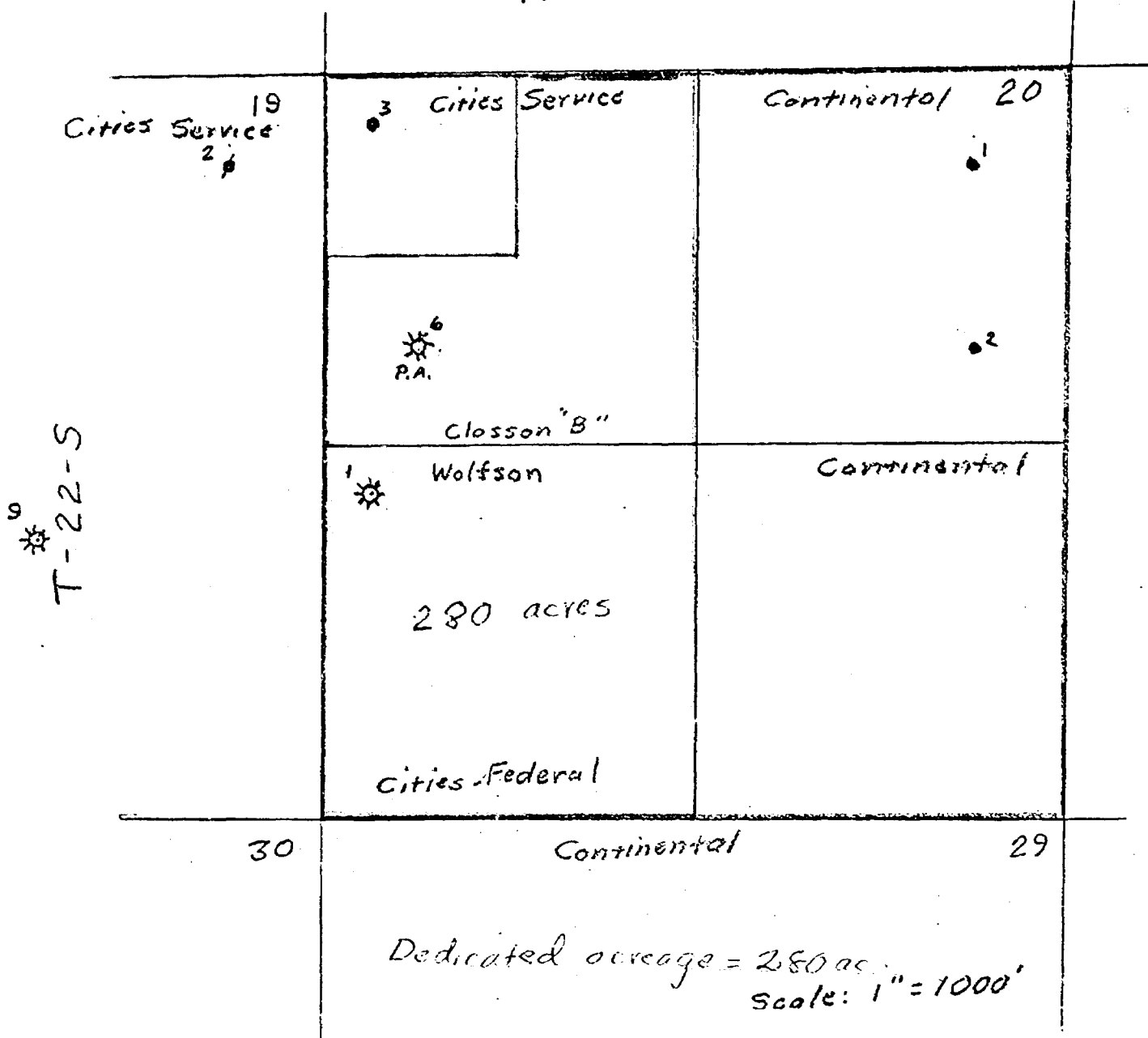

OIL CONSERVATION COMMISSION

P. O. BOX 2088

SANTA FE, NEW MEXICO 87501

March 19, 1971

*Case 4525*

C  
O  
P  
Y

Wolfson Oil Company  
311 Midland National Bank Building  
Midland, Texas

Attention: Mr. H. G. Freedman

Re: 160-acre non-standard proration unit  
comprising the SW/4 of Section 20,  
Township 22 South, Range 36 East,  
Jalmat Gas Pool, Lea County, New Mexico

Gentlemen:

As the Wolfson Oil Company Cities-Federal Well No. 1  
is located closer than 660 - 660 feet to the nearest  
boundary lines of the proposed gas unit, it will be nec-  
essary for the matter to be set for hearing before an  
examiner on April 28, 1971, in Santa Fe, New Mexico.

Very truly yours,

GEORGE M. HATCH  
Attorney

GMB/esr

cc: Oil Conservation Commission  
P. O. Box 1980  
Hobbs, New Mexico

DOCKET: EXAMINER HEARING - BUREAU OF LANDS - APRIL 23, 1971

9 A.M. - OIL CONSERVATION COMMISSION CONFERENCE ROOM,  
STATE LAND OFFICE BUILDING, SANTA FE, NEW MEXICO

The following cases will be heard before Elias A. Utz, Examiner, or Daniel S. Nutter, Alternate Examiner:

CASE 4352: (Reopened) Continued from the April 14, 1971 hearing. This case will again be continued - to the May 19, 1971 hearing.

In the matter of Case 4352 being reopened by the Oil Conservation Commission upon its own motion to give all interested persons an opportunity to appear and present evidence as to whether the Double L-Queen and Suble-Queen Pools, Chaves County, New Mexico, are in fact separate reservoirs or one common reservoir. Further, in the event it is found that the two pools comprise one common reservoir, the Commission will consider the adoption of special rules and regulations to provide for the classification of oil and gas wells, spacing and well location requirements for oil and gas wells, and an allocation formula for withdrawals from the gas wells and oil wells.

CASE 4523: Application of Texas Pacific Oil Company, Inc., for the re-dedication of acreage, Lea County, New Mexico. Applicant, in the above-styled cause, seeks the rededication of a 160-acre non-standard gas proration unit in the Jalmat Gas Pool comprising the SE/4 of Section 31, Township 25 South, Range 37 East, Lea County, New Mexico, to its Legal Wells Nos. 1 and 2, located, respectively, in Units P and I of said Section 31. Applicant further seeks authority to produce the allowable assigned to said unit from either of said wells in any proportion.

CASE 4524: Application of Texaco Inc. for reinstatement of cancelled underproduction, Lea County, New Mexico. Applicant, in the above-styled cause, seeks an exception to the general rules and regulations for the prorated gas pools of Southeastern New Mexico to permit the reinstatement of accumulated underproduction cancelled for its Blinbry "A" Federal (NCT-1) Well No. 2 located in Unit I, Section 31, Township 23 South, Range 37 East, Jalmat Gas Pool Lea County, New Mexico.

CASE 4525: Application of Wolfson Oil Company for a non-standard gas proration unit, Lea County, New Mexico. Applicant, in the above-styled cause, seeks approval for a 280-acre non-standard gas proration unit comprising the SW/4, S/2 NW/4, and NE/4 NW/4 of Section 20, Township 22 South, Range 36 East, Jalmat Gas Pool, Lea County, New Mexico, to be dedicated to its

Cities-Federal Well No. 1 located 2310 feet from the South line and 330 feet from the West line of said Section 20.

- CASE 4526: Application of Pennzoil United, Inc., for the creation of a new pool and promulgation of special pool rules, Roosevelt County, New Mexico. Applicant, in the above-styled cause, seeks the creation of a new pool for the production of gas from the San Andres formation for its Superior State Well No. 1 located in Unit L of Section 8, Township 7 South, Range 35 East, Roosevelt County, New Mexico, and for the promulgation of special rules therefor, including a provision for 320-acre spacing units.
- CASE 4527: Application of Big "6" Drilling Company for salt water disposal, Lea County, New Mexico. Applicant, in the above-styled cause, seeks authority to dispose of produced salt water into the Bone Springs formation in the interval from 10,062 feet to 10,119 feet in its Ora Jackson "A" Well No. 1 located in Unit M of Section 5, Township 19 South, Range 35 East, Scharb-Bone Springs Pool, Lea County, New Mexico.
- CASE 4528: Application of Franklin, Aston & Fair, Inc., for an exception to Order No. R-3221, as amended, Eddy County, New Mexico. Applicant, in the above-styled cause, seeks an exception to Order No. R-3221, as amended, to dispose of water produced by its Coppedge Well No. 1-C located in Unit H of Section 5, Township 18 South, Range 30 East, Loco Hills-Grayburg-San Andres Pool, Eddy County, New Mexico, in an unlined pit in the vicinity of said well.
- CASE 4529: Application of El Paso Natural Gas Company for 320-acre spacing, Eddy County, New Mexico. Applicant, in the above-styled cause, seeks 320-acre spacing for the Grayburg-Atoka Gas Pool, Eddy County, New Mexico. Said pool was created prior to June 1, 1964, and therefore is not automatically eligible for 320-acre spacing. In the absence of evidence to the contrary, 320-acre spacing will be established for the pool.
- CASE 4530: Application of Amoco Production Company for down-hole commingling, Lea County, New Mexico. Applicant, in the above-styled cause, seeks authority to commingle oil production from the Blinebry and Drinkard Pools in the well-bore of its Southland Royalty "A" Well No. 2, a triple completion, located in Unit B of Section 9, Township 21 South, Range 37 East, Lea County, New Mexico.





WOLFSON OIL COMPANY

OIL PRODUCERS

6906 REPUBLIC NATIONAL BANK TOWER

DALLAS, TEXAS 75201

R-36-E

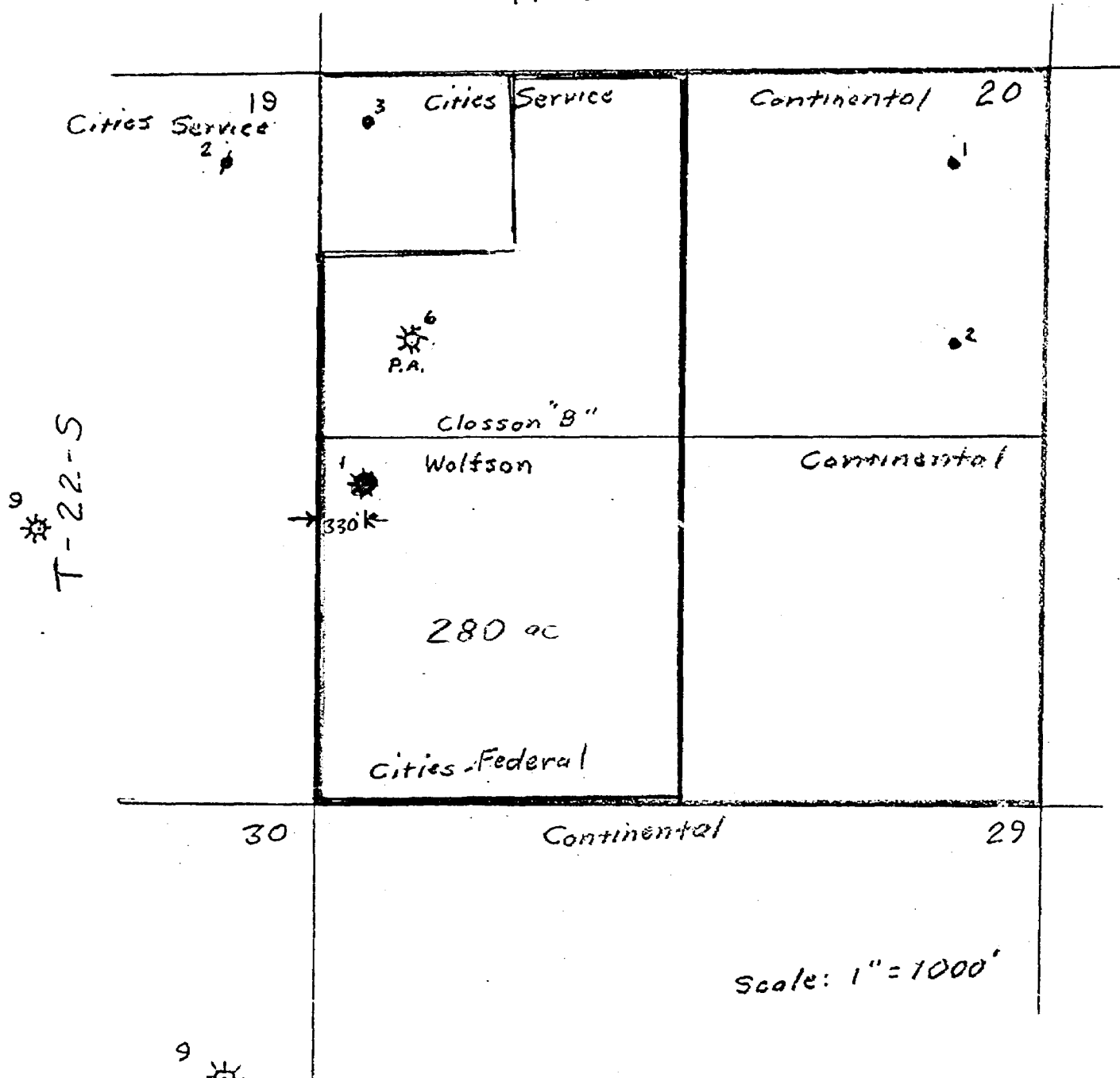

*WSP -  
Set for hearing as  
the rule is only a 330-330  
location.*

**WOLFSON OIL COMPANY**  
OIL PRODUCERS  
3206 REPUBLIC NATIONAL BANK TOWER  
DALLAS, TEXAS 75201

10  
11  
12  
13  
14  
15  
16  
17  
18  
19  
20  
21  
22  
23  
24  
25  
26  
27  
28  
29  
30  
31  
32  
33  
34  
35  
36  
37  
38  
39  
40  
41  
42  
43  
44  
45  
46  
47  
48  
49  
50  
51  
52  
53  
54  
55  
56  
57  
58  
59  
60  
61  
62  
63  
64  
65  
66  
67  
68  
69  
70  
71  
72  
73  
74  
75  
76  
77  
78  
79  
80  
81  
82  
83  
84  
85  
86  
87  
88  
89  
90  
91  
92  
93  
94  
95  
96  
97  
98  
99  
100  
101  
102  
103  
104  
105  
106  
107  
108  
109  
110  
111  
112  
113  
114  
115  
116  
117  
118  
119  
120  
121  
122  
123  
124  
125  
126  
127  
128  
129  
130  
131  
132  
133  
134  
135  
136  
137  
138  
139  
140  
141  
142  
143  
144  
145  
146  
147  
148  
149  
150  
151  
152  
153  
154  
155  
156  
157  
158  
159  
160  
161  
162  
163  
164  
165  
166  
167  
168  
169  
170  
171  
172  
173  
174  
175  
176  
177  
178  
179  
180  
181  
182  
183  
184  
185  
186  
187  
188  
189  
190  
191  
192  
193  
194  
195  
196  
197  
198  
199  
200  
201  
202  
203  
204  
205  
206  
207  
208  
209  
210  
211  
212  
213  
214  
215  
216  
217  
218  
219  
220  
221  
222  
223  
224  
225  
226  
227  
228  
229  
230  
231  
232  
233  
234  
235  
236  
237  
238  
239  
240  
241  
242  
243  
244  
245  
246  
247  
248  
249  
250  
251  
252  
253  
254  
255  
256  
257  
258  
259  
260  
261  
262  
263  
264  
265  
266  
267  
268  
269  
270  
271  
272  
273  
274  
275  
276  
277  
278  
279  
280  
281  
282  
283  
284  
285  
286  
287  
288  
289  
290  
291  
292  
293  
294  
295  
296  
297  
298  
299  
300  
301  
302  
303  
304  
305  
306  
307  
308  
309  
310  
311  
312  
313  
314  
315  
316  
317  
318  
319  
320  
321  
322  
323  
324  
325  
326  
327  
328  
329  
330  
331  
332  
333  
334  
335  
336  
337  
338  
339  
340  
341  
342  
343  
344  
345  
346  
347  
348  
349  
350  
351  
352  
353  
354  
355  
356  
357  
358  
359  
360  
361  
362  
363  
364  
365  
366  
367  
368  
369  
370  
371  
372  
373  
374  
375  
376  
377  
378  
379  
380  
381  
382  
383  
384  
385  
386  
387  
388  
389  
390  
391  
392  
393  
394  
395  
396  
397  
398  
399  
400  
401  
402  
403  
404  
405  
406  
407  
408  
409  
410  
411  
412  
413  
414  
415  
416  
417  
418  
419  
420  
421  
422  
423  
424  
425  
426  
427  
428  
429  
430  
431  
432  
433  
434  
435  
436  
437  
438  
439  
440  
441  
442  
443  
444  
445  
446  
447  
448  
449  
450  
451  
452  
453  
454  
455  
456  
457  
458  
459  
460  
461  
462  
463  
464  
465  
466  
467  
468  
469  
470  
471  
472  
473  
474  
475  
476  
477  
478  
479  
480  
481  
482  
483  
484  
485  
486  
487  
488  
489  
490  
491  
492  
493  
494  
495  
496  
497  
498  
499  
500  
501  
502  
503  
504  
505  
506  
507  
508  
509  
510  
511  
512  
513  
514  
515  
516  
517  
518  
519  
520  
521  
522  
523  
524  
525  
526  
527  
528  
529  
530  
531  
532  
533  
534  
535  
536  
537  
538  
539  
540  
541  
542  
543  
544  
545  
546  
547  
548  
549  
550  
551  
552  
553  
554  
555  
556  
557  
558  
559  
560  
561  
562  
563  
564  
565  
566  
567  
568  
569  
570  
571  
572  
573  
574  
575  
576  
577  
578  
579  
580  
581  
582  
583  
584  
585  
586  
587  
588  
589  
590  
591  
592  
593  
594  
595  
596  
597  
598  
599  
600  
601  
602  
603  
604  
605  
606  
607  
608  
609  
610  
611  
612  
613  
614  
615  
616  
617  
618  
619  
620  
621  
622  
623  
624  
625  
626  
627  
628  
629  
630  
631  
632  
633  
634  
635  
636  
637  
638  
639  
640  
641  
642  
643  
644  
645  
646  
647  
648  
649  
650  
651  
652  
653  
654  
655  
656  
657  
658  
659  
660  
661  
662  
663  
664  
665  
666  
667  
668  
669  
670  
671  
672  
673  
674  
675  
676  
677  
678  
679  
680  
681  
682  
683  
684  
685  
686  
687  
688  
689  
690  
691  
692  
693  
694  
695  
696  
697  
698  
699  
700  
701  
702  
703  
704  
705  
706  
707  
708  
709  
710  
711  
712  
713  
714  
715  
716  
717  
718  
719  
720  
721  
722  
723  
724  
725  
726  
727  
728  
729  
730  
731  
732  
733  
734  
735  
736  
737  
738  
739  
740  
741  
742  
743  
744  
745  
746  
747  
748  
749  
750  
751  
752  
753  
754  
755  
756  
757  
758  
759  
760  
761  
762  
763  
764  
765  
766  
767  
768  
769  
770  
771  
772  
773  
774  
775  
776  
777  
778  
779  
780  
781  
782  
783  
784  
785  
786  
787  
788  
789  
790  
791  
792  
793  
794  
795  
796  
797  
798  
799  
800  
801  
802  
803  
804  
805  
806  
807  
808  
809  
810  
811  
812  
813  
814  
815  
816  
817  
818  
819  
820  
821  
822  
823  
824  
825  
826  
827  
828  
829  
830  
831  
832  
833  
834  
835  
836  
837  
838  
839  
840  
841  
842  
843  
844  
845  
846  
847  
848  
849  
850  
851  
852  
853  
854  
855  
856  
857  
858  
859  
860  
861  
862  
863  
864  
865  
866  
867  
868  
869  
870  
871  
872  
873  
874  
875  
876  
877  
878  
879  
880  
881  
882  
883  
884  
885  
886  
887  
888  
889  
890  
891  
892  
893  
894  
895  
896  
897  
898  
899  
900  
901  
902  
903  
904  
905  
906  
907  
908  
909  
910  
911  
912  
913  
914  
915  
916  
917  
918  
919  
920  
921  
922  
923  
924  
925  
926  
927  
928  
929  
930  
931  
932  
933  
934  
935  
936  
937  
938  
939  
940  
941  
942  
943  
944  
945  
946  
947  
948  
949  
950  
951  
952  
953  
954  
955  
956  
957  
958  
959  
960  
961  
962  
963  
964  
965  
966  
967  
968  
969  
970  
971  
972  
973  
974  
975  
976  
977  
978  
979  
980  
981  
982  
983  
984  
985  
986  
987  
988  
989  
990  
991  
992  
993  
994  
995  
996  
997  
998  
999  
1000

March 3, 1971

Oil Conservation Commission  
Box 1980  
Hobbs, New Mexico

*Case 4575*

Re: Cities - Federal No. 1  
2310' FSL 330' FWL Section 20-22S-36E,  
S/Eunice (7-Rivers Queen) Field  
Lea County, New Mexico

ATTN: Mr. Joe Ramey

Dear Mr. Ramey:

The above captioned well was filed in the Eunice, South, Seven Rivers, Queen Field and was drilled to a total depth of 3800 feet.

Possible producing zones in the Eunice, South Field from 3767 - 3790 were perforated, acidized, and found non-productive.

Possible producing zones in the Jalmat oil zone from 3498-3508 were perforated, acidized, and found non-productive.

The well was plugged back to the Jalmat gas zone and perforated from 3222 - 3442 and completed as a gas well. In as much as the location is only 330' from the West line, we respectfully request an approval for a non-standard gas location.

Yours very truly,

WOLFSON OIL COMPANY

*H. G. Freedman*  
H. G. Freedman

CC: Continental Oil - Hobbs, New Mexico  
Cities Service Oil Corporation - Midland, Texas

HGF/hbh

4525

WOLFSON OIL COMPANY  
OIL PRODUCERS  
3206 REPUBLIC NATIONAL BANK TOWER  
DALLAS, TEXAS 75201

R-36-E

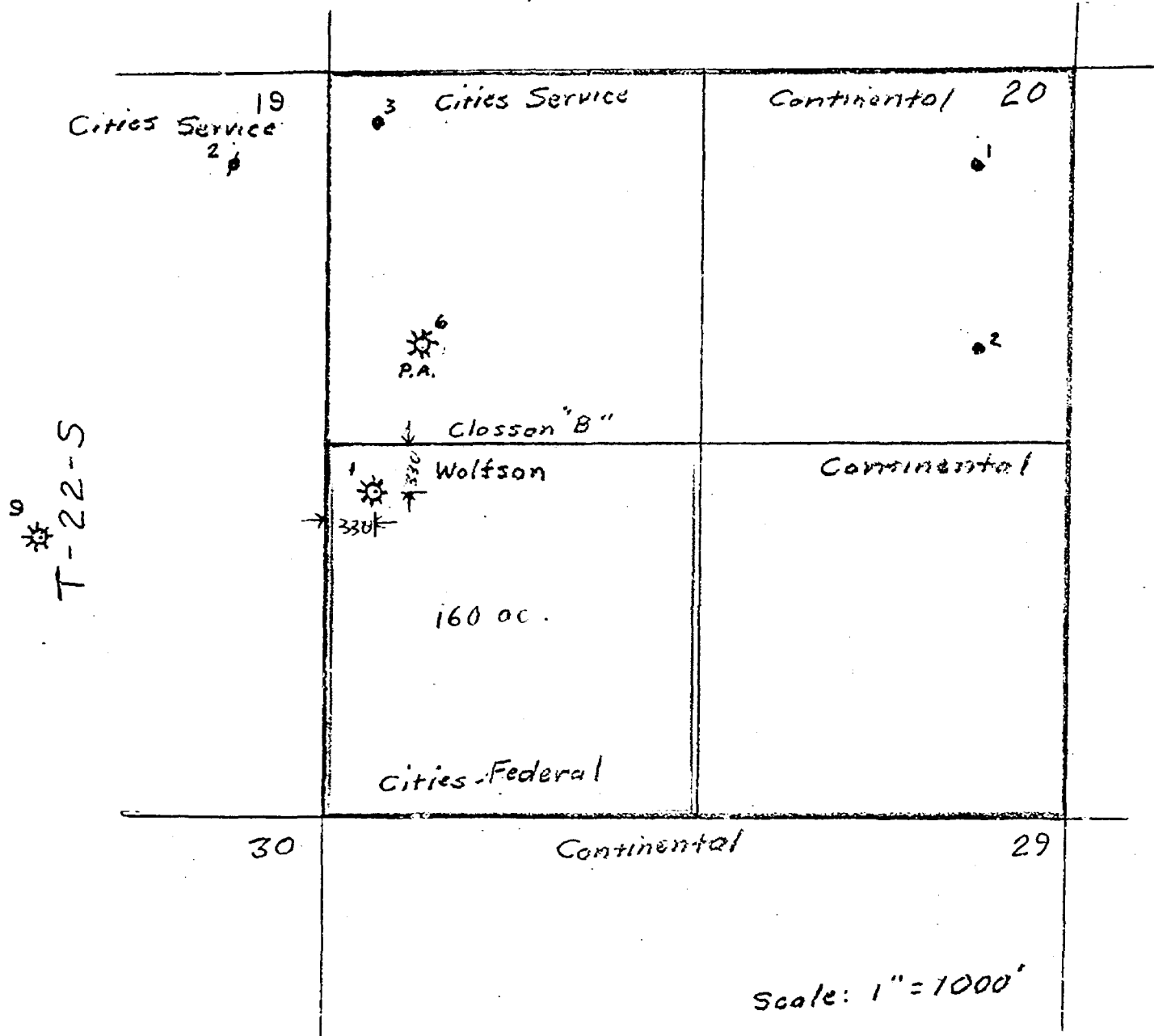

9  
Sun symbol

DRAFT

GMH/dr

BEFORE THE OIL CONSERVATION COMMISSION  
OF THE STATE OF NEW MEXICO

IN THE MATTER OF THE HEARING  
CALLED BY THE OIL CONSERVATION  
COMMISSION OF NEW MEXICO FOR  
THE PURPOSE OF CONSIDERING:

CASE No. 4525

Order No. R- 4129

APPLICATION OF WOLFSON OIL COMPANY  
FOR A NON-STANDARD GAS PRORATION UNIT,  
LEA COUNTY, NEW MEXICO.

ORDER OF THE COMMISSION

BY THE COMMISSION:

This cause came on for hearing at 9 a.m. on April 28, 1971,  
at Santa Fe, New Mexico, before Examiner Elvis A. Utz.

NOW, on this \_\_\_\_\_ day of May, 1971, the Commission, a  
quorum being present, having considered the testimony, the record,  
and the recommendations of the Examiner, and being fully advised  
in the premises,

FINDS:

(1) That due public notice having been given as required by  
law, the Commission has jurisdiction of this cause and the subject  
matter thereof.

(2) That the applicant, Wolfson Oil Company, seeks approval  
of a 280-acre non-standard gas proration unit comprising the

SW/4, S/2 NW/4 and NE/4 NW/4 of Section 20, Township 22 South,

Range 36 East, NMPM, Lea County, New Mexico, to be dedicated to its  
Cities-Federal Well No. 1 located 1650 feet from the north line  
of said

~~Section 20.~~

and 330 feet from the west line of said  
Section 20.

-2-

CASE NO. 4525

Order No. R-

(3) That the entire non-standard proration unit is productive of gas from the Jalmat Gas Pool formation and that the entire non-standard proration unit can be efficiently and economically drained and developed by said Cities-Federal Well No. 1.

(4) That approval of the subject application will afford the applicant the opportunity to produce its just and equitable share of the gas in the Jalmat Gas Pool, will prevent the economic loss caused by the drilling of unnecessary wells, avoid the augmentation of risk arising from the drilling of an excessive number of wells, and will otherwise prevent waste and protect correlative rights.

IT IS THEREFORE ORDERED:

(1) That a 280-acre non-standard gas proration unit in the Jalmat Gas Pool comprising the SW/4, S/2 NW/4 and NE/4 NW/4 of Section 20, Township 22 South, Range 36 East, NMPM, Lea County, New Mexico, is hereby established and dedicated to the Wolfson Oil Company Cities-Federal Well No. 1, located in Unit <sup>930 feet from the</sup> ~~in Unit~~ <sub>South north line and 330 feet from the west line</sub> of said Section 20.

(2) That jurisdiction of this cause is retained for the entry of such further orders as the Commission may deem necessary.

DONE at Santa Fe, New Mexico, on the day and year hereinabove designated.