

Case No
1806

Large Exhibits

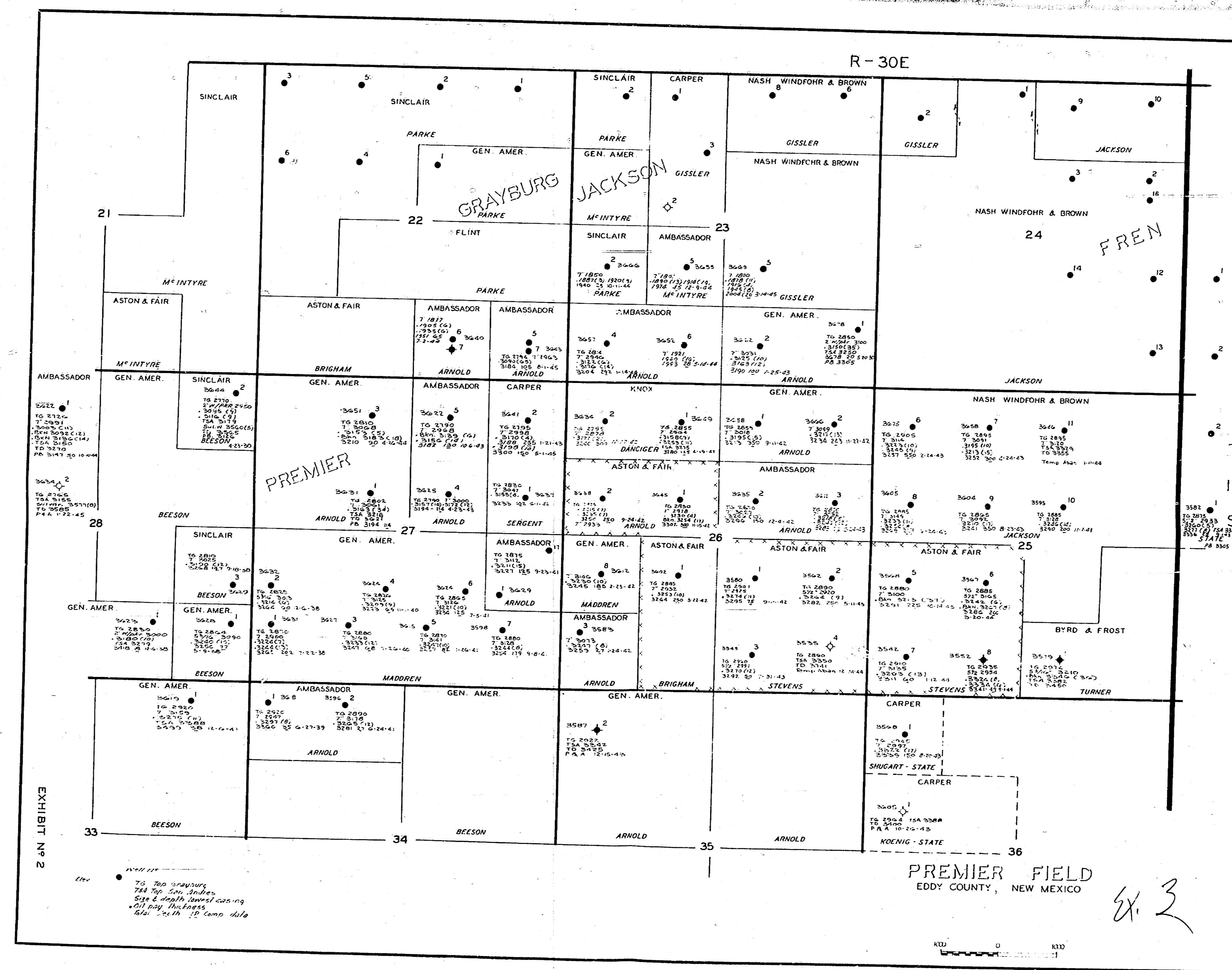

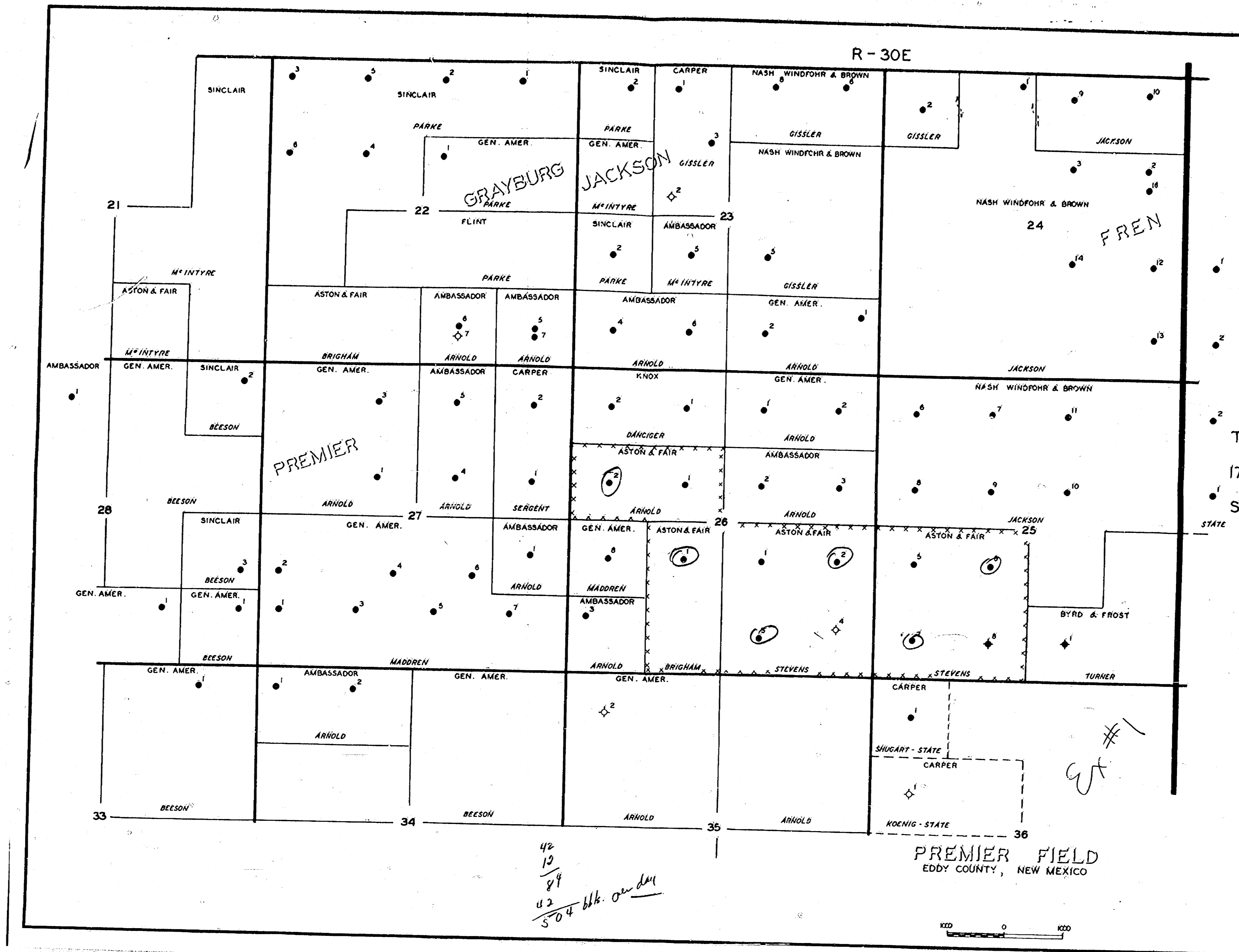

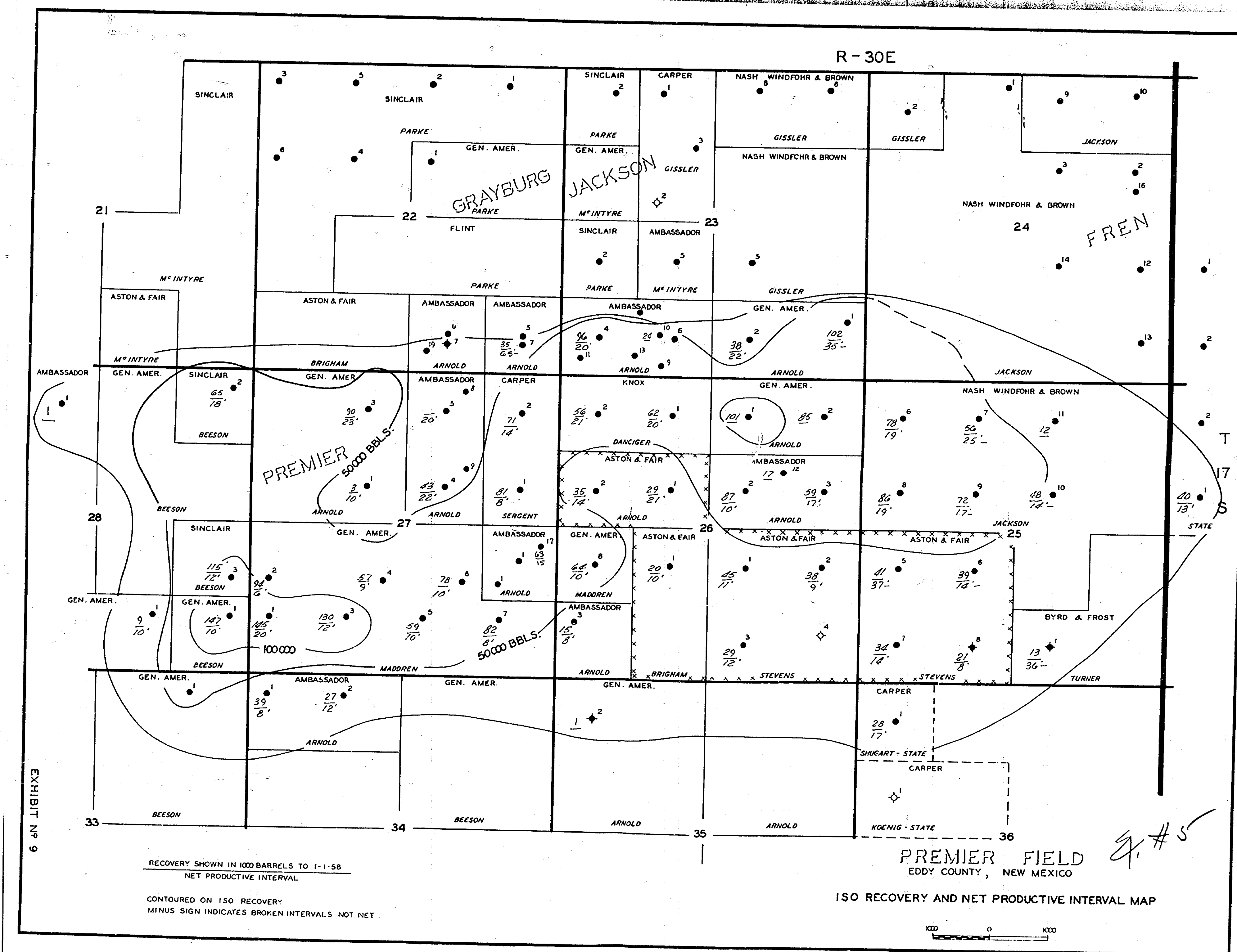
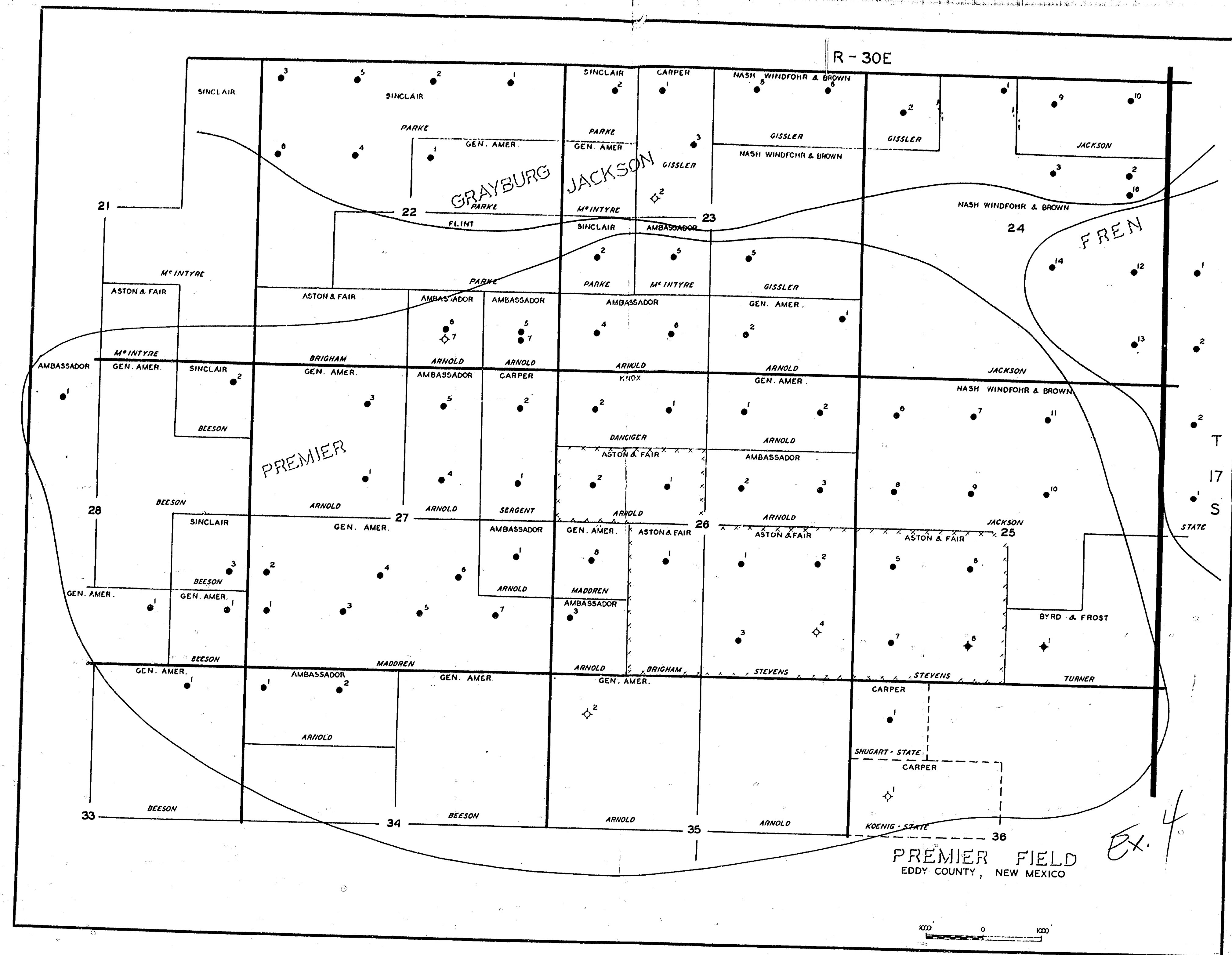
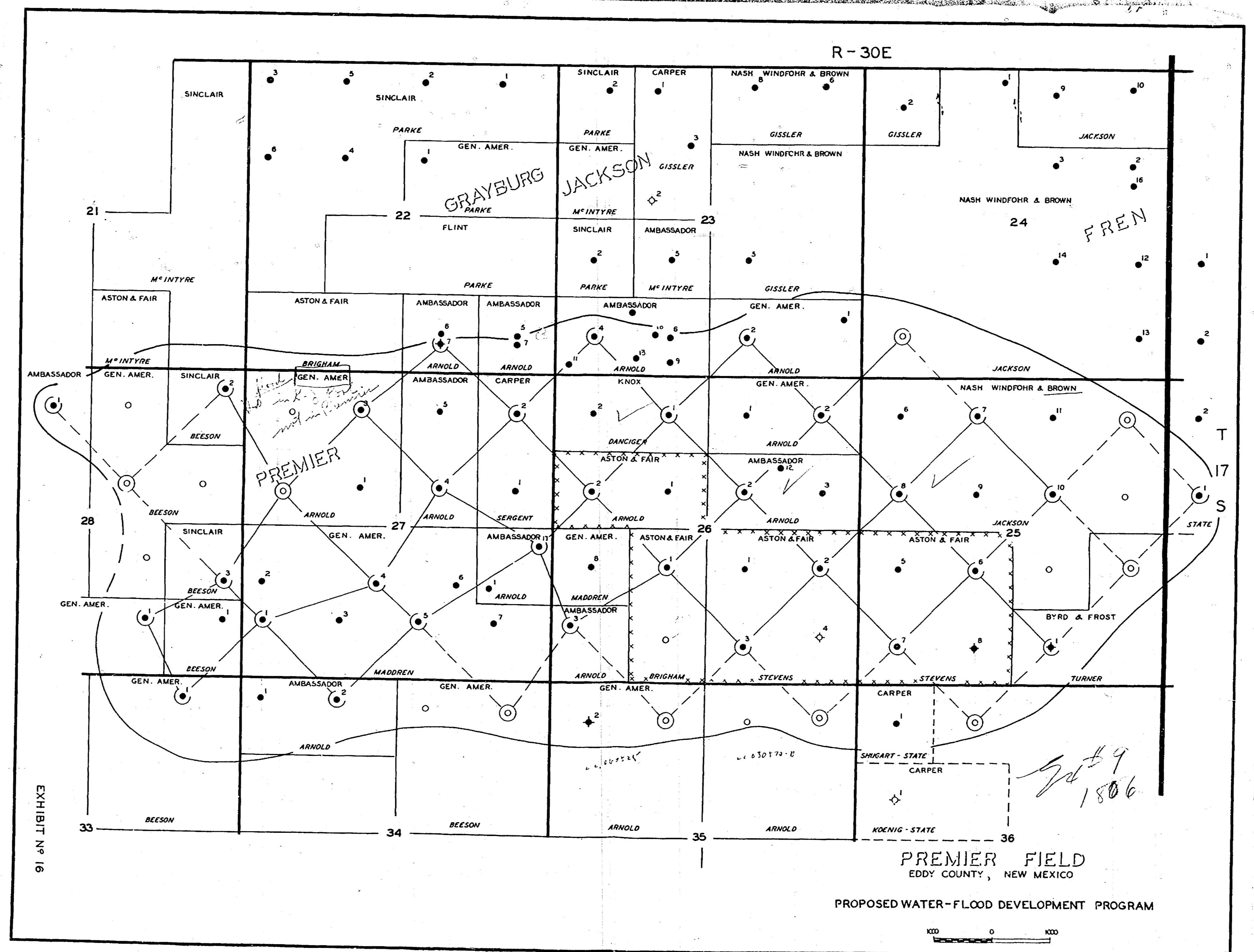
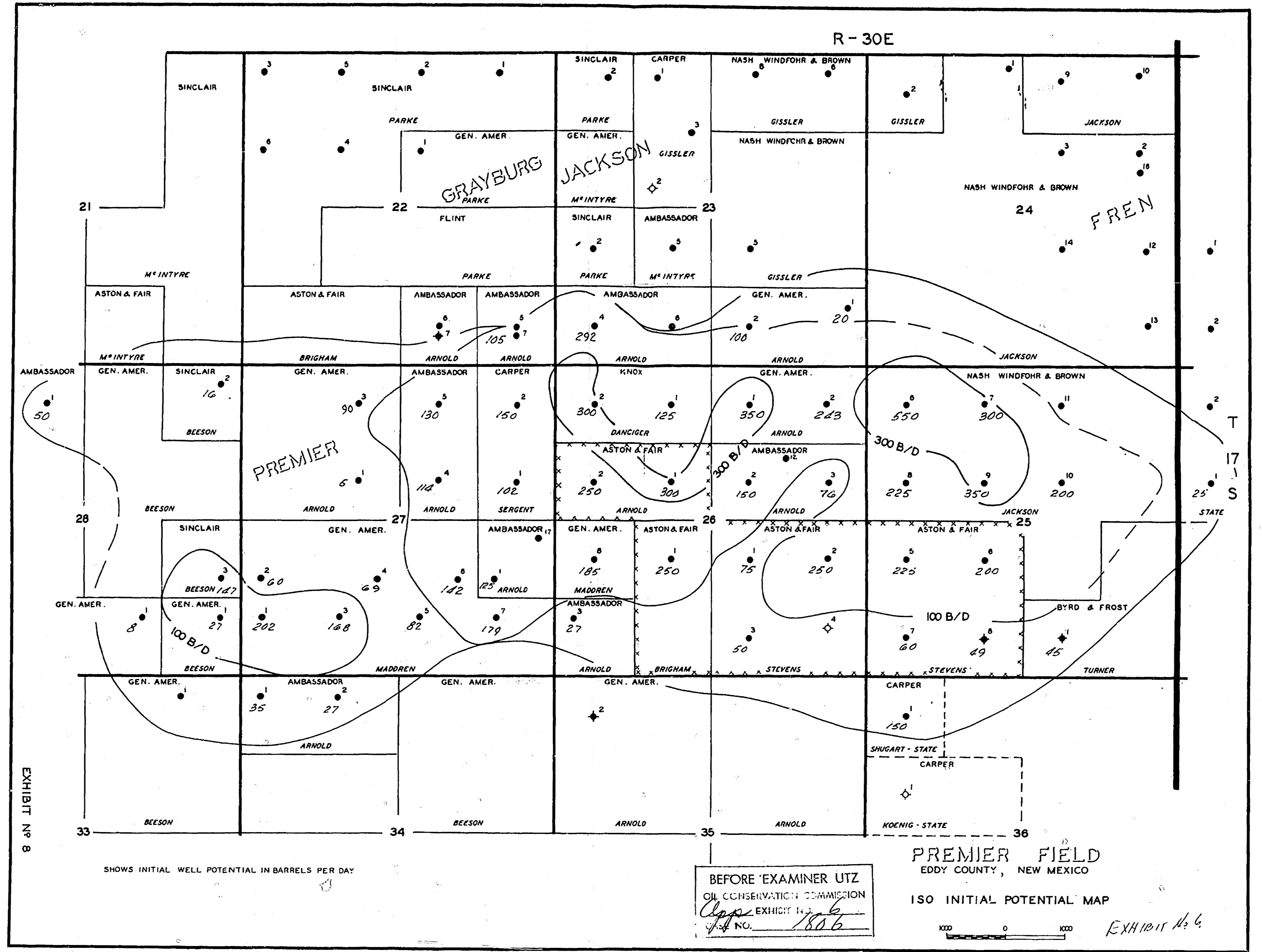

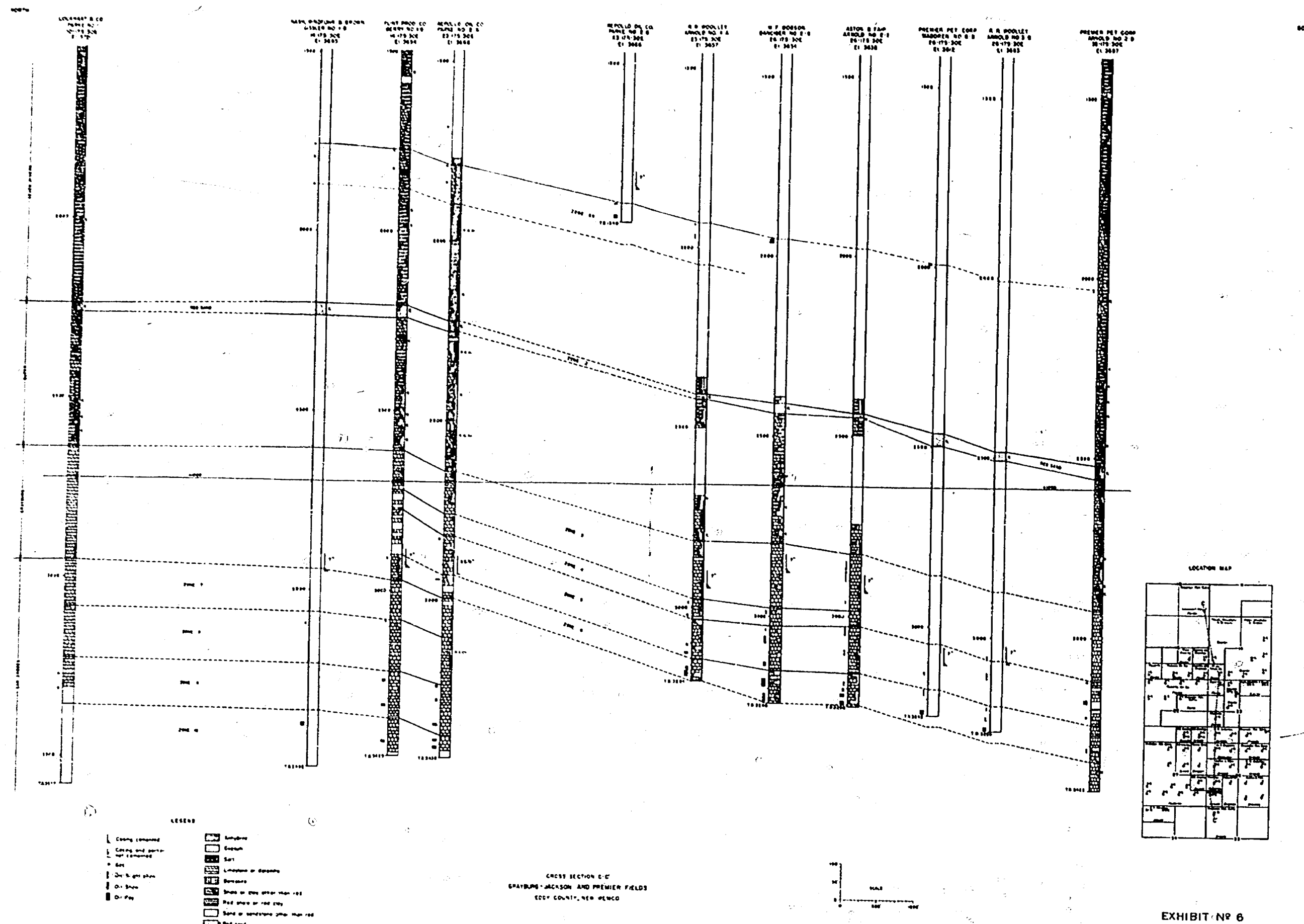

LEASE	WELL NO.	LOCATION	ELEVATION	STATUS	MAY 1959		COMPLETION DATE	INITIAL PRODUCTION		CASING	STIMULATION			WELL DATA						
					BOVDYTY BALANCE	GRAV. FACT		BEFORE STIM.	AFTER STIM.		TOTAL DEPTH	DATE	TYPE	AMOUNT	OPPR AND RESULTS	CUMULATIVE PRODUCTION TO DATE	TOP PRODUCE	LOGIC DATA TOP OF C. WICKOFF		
Stevens	1-8	J-26-17-30	3580	Pumping	80	35	5/11/42	75/	25/	8-5/8/350/350x	17/292/1000x	3295	5/13/42	Fract	90 lbs. 194'	2 800 to 32 810	14552	2597	6	3214(11)
Stevens	2-8	L-26-17-30	3559	Pumping	77	35	4/29/43	100/	95/	7/322/350x	5-4/29/5/1000x	3282	5/2/43	Fract	50 lbs. 194'	2 800 to 32 810	17602	2590	6	3214(5)
Stevens	3-8	L-26-17-30	3555	Pumping	50	35	7/30/43	8/	50/	8-5/8/350/350x	5-4/29/5/1000x	3291	5/2/43	Fract	10 lbs. 194'	2 800 to 32 810	2891	2560	6	3214(12)
Stevens	4-8	L-26-17-30	3555	PLA (Dry Hole)	-	-	6/1/44	0/	0/	8-5/8/ / 350x	-	3290	6/15/44	Fract	200 lbs. 194'	3000-3500	14560	2550	6	3214(13)
Stevens	5-8	L-26-17-30	3555	Pumping	50	35	10/12/43	125/	105/	8-5/8/350/350x	7/311/1000x	3290	10/16/43	Fract	120 lbs. 194'	3000-3500	14560	2550	6	3214(14)
Stevens	6-8	L-26-17-30	3551	Pumping	16	35	3/9/44	100/	200/	8-5/8/350/350x	5-4/311/1000x	3290	3/11/44	Fract	180 lbs. 194'	3 800 to 32 810	26429	2550	6	3214(15) OR 3214(16)
Stevens	7-8	L-26-17-30	3552	Pumping	50	35	12/29/43	60/	60/	8-5/8/350/350x	7/313/1000x	3311	11/17/55	Fract	10 lbs. 194'	2 800 to 32 810	33110	2510	6	3214(14)
Stevens	8-8	L-26-17-30	3552	PLA (8/15/51)	-	-	8/7/44	19/21	19/21	8-5/8/350/350x	5-4/29/5/1000x	3311	11/2/44	Fract	60 lbs. 194'	3000-3500	28953	2535	6	3214(15) OR 3214(16)
Arnold	1	F-26-17-30	3585	T.A.	68	35	9/27/42	300/	300/	8-5/8/350/350x	7/292/1000x	3308	11/6/42	Fract	180 lbs. 194'	3100-3500	28520	2525	6	3214(17) OR 3214(18)
Arnold	2	E-26-17-30	3588	Pumping	116	35	9/24/42	75/	250/	8-5/8/350/350x	7/292/1000x	3289	11/12/55	Fract	10 lbs. 194'	2 800 to 32 810	32929	2520	6	3214(1) OR 3214(17)
Brigham	1	K-26-17-30	3602	T.A.	-	-	3/14/42	55/	250/	8-5/8/350/350x	7/283/1000x	3284	3/16/42	Fract	50 lbs. 194'	3000-3500	14660	2555	6	3214(10)

BEFORE EXAMINER UTZ
 OIL CONSERVATION COMMISSION
 EXHIBIT NO. 6
 CASE NO. 1806

EXHIBIT NO. 8

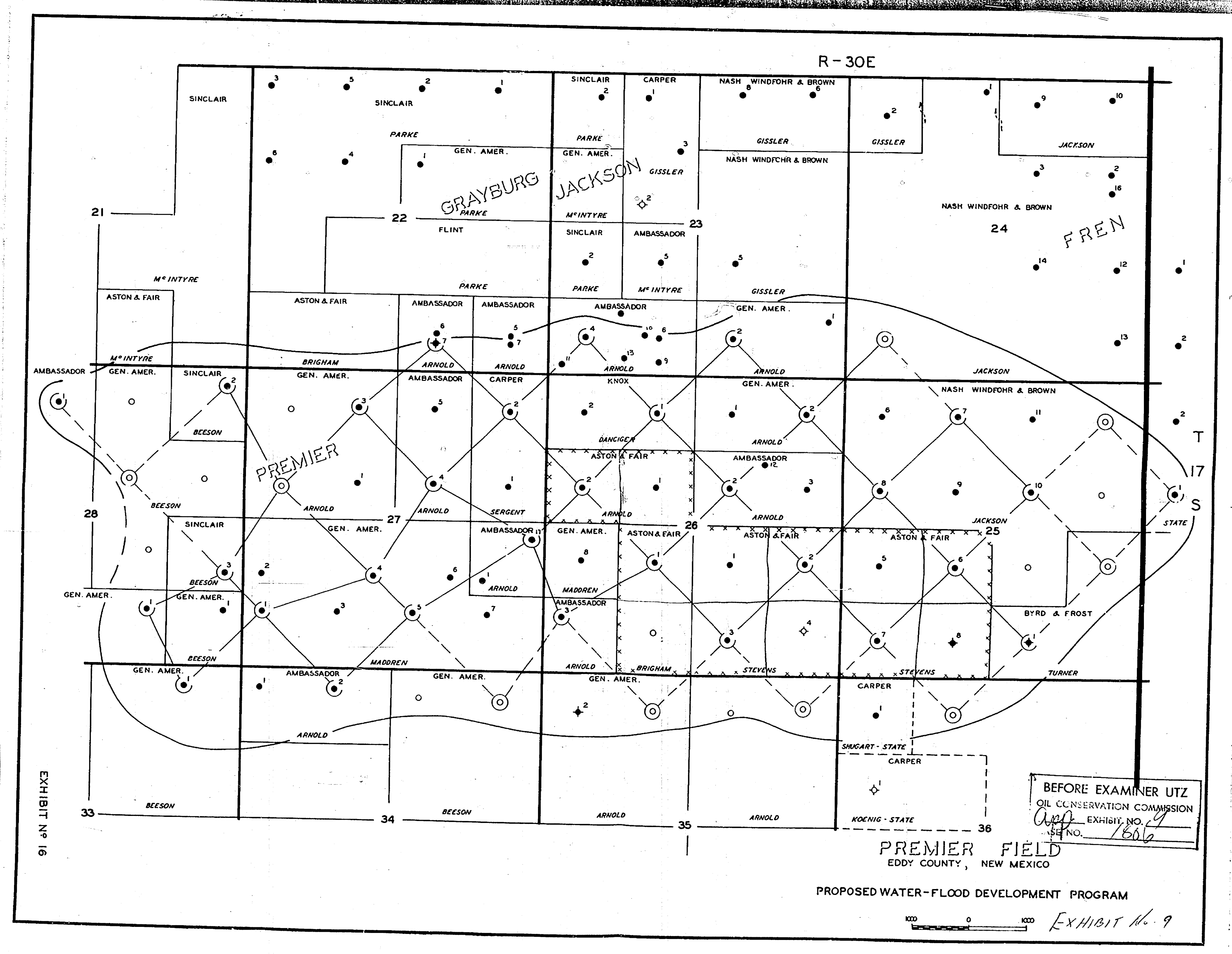

BEFORE EXAMINER UTZ
 OIL CONSERVATION COMMISSION
 EXHIBIT NO. 9
 CASE NO. 1806