

Case No.
2265

Application, Transcript,
and Exhibits, Etc.

BEFORE THE NEW MEXICO OIL CONSERVATION COMMISSION

SANTA FE, NEW MEXICO

RE. APPLICATION OF NASH, WINDFOHR & BROWN
FOR APPROVAL OF AN UNORTHODOX WELL LOCATION
IN SECTION 24, TOWNSHIP 17 SOUTH, RANGE 30
EAST, N.M.P.M., IN THE UNDESIGNATED FIELD.

Case No. 1226-5

A P P L I C A T I O N

COMES NOW Nash, Windfohr and Brown, a partnership, by its attorneys, Watson and Watson, of Artesia, New Mexico, and makes application to the New Mexico Oil Conservation Commission, for approval of an unorthodox well location, and states:

1. That there is attached hereto, marked Exhibit "A" and made a part hereof, a Notice of Intention to Drill, which shows the location of, said well, and the information with respect to the drilling of the well. That said well is the Nash, Windfohr and Brown - Jackson 23-B well on Federal Oil and Gas Lease Las Cruces 055264, in Unit J (NW $\frac{1}{4}$ SE $\frac{1}{4}$) of Section 24, Township 17 South, Range 30 East, N.M.P.M., in Eddy County, New Mexico. That said lands are in an undesigned field as to the formation to be tested.

2. That said well is proposed to be drilled to a total depth of 7,050 feet beneath the surface of the land, to test the Abo Formation.

3. That Nash, Windfohr and Brown are the owners of all of the oil and gas leasehold estates within a radius of 660 feet of the proposed location and, further, that Nash, Windfohr and Brown are the owners of Government Oil and Gas Lease Las Cruces 055264, which covers all of said Section 24, Township 17 South, Range 30 East, N.M.P.M., and also covers the N $\frac{1}{2}$ of Section 25, Township 17 South, Range 30 East, N.M.P.M., and are also the owners of the oil and gas leasehold estate covering All of Section 13, Township 17 South, Range 30 East, N.M.P.M., and all of the E $\frac{1}{2}$ of Section 23 in said Township and Range, except the S $\frac{1}{2}$ SE $\frac{1}{4}$ of said Section 23.

4. factious only
4. That application is made for approval of said unorthodox location, by reason of the fact the Abo Formation in the area is very narrow and said location is recommended on the basis of the available information, as being the location most likely to be productive of oil in said subdivision.

5. That said location has been approved for drilling by the United States Geological Survey.

6. That there is attached hereto and marked Exhibit "B", a plat showing the proposed location and the formation.

WHEREFORE, applicant prays that the drilling of said Nash, Windfohr and Brown - Jackson 23-B Well at the location above set forth be granted and that all necessary and proper Orders and Notices be made and issued in the premises.

NASH, WINDFOHR AND BROWN

by

Neil B. Watson
Neil B. Watson,
Watson and Watson,
Attorneys for Applicant,
P. O. Drawer E,
Artesia, New Mexico.

EXHIBIT "A"

(SUBMIT IN TRIPLICATE)

UNITED STATES
DEPARTMENT OF THE INTERIOR
GEOLOGICAL SURVEY

Land Office

Las Cruces

Tract No.

055264

Unit

Jackson B

SUNDRY NOTICES AND REPORTS ON WELLS

NOTICE OF INTENTION TO DRILL

NOTICE OF INTENTION TO CHANGE PLANS

NOTICE OF INTENTION TO TEST WATER SHUT-OFF

NOTICE OF INTENTION TO RE-DRILL OR REPAIR WELL

NOTICE OF INTENTION TO SHOOT OR ACIDIZE

NOTICE OF INTENTION TO PUMP OR ALTER CASING

NOTICE OF INTENTION TO ABANDON WELL

SUBSEQUENT REPORT OF WATER SHUT-OFF

CONSEQUENT REPORT OF SHOOTING OR ACIDIZING

SUBSEQUENT REPORT OF ALTERING CASING

SUBSEQUENT REPORT OF RE-DRILLING OR REPAIR

SUBSEQUENT REPORT OF ABANDONMENT

SUPPLEMENTARY WELL HISTORY

INDICATE ABOVE BY CHECKS MARKING DATE OF REPORT, NOTICE, OR OTHER DATA

March 21

19 61

Well No. **23-B** is located **1420** ft. from **N** line and **1980** ft. from **E** line of sec. **24****1/4 Sec. 4**

(1/4 Sec. and Sec. No.)

17E-30E

(Twp.)

(Range)

28N

(Meridian)

Cedar Lake Abo ?

(Field)

140y

(County or Subdivision)

New Mexico

(State or Territory)

The elevation of the derrick floor above sea level is _____ ft.

DETAILS OF WORK

(State names of and expected depths to objective sands; show sizes, weights, and lengths of proposed casings; indicate mudlogging jobs, cementing points, and all other important proposed work)

We request approval to drill Jackson 23-B to approximately 7,050 feet to test the Abo. We propose to set 1,650 feet of 5-5/8" 24#, cementing to surface, and propose to set 4-1/2" casing on bottom at 7,000-7,050 and cement it with 700 sacks. The well will be drilled with rotary, and the contractor will be Great Western Drilling Company, Midland, Texas.

NOTE: You will notice this well is an unorthodox location made solely for the purpose of attempting to locate crest of reef. Formal application for approval of this location has been made to Mr. Porter of the Conservation Commission at Santa Fe, and Mr. Oliver Fain has replied that we may proceed with the drilling of the well, but that no allowance shall be assigned the well until our application has been formally acted upon. No property rights are involved since the working interest on all adjoining 40s are owned by Nash, Windfohr and Brown and since all of the royalty is owned by the United States of America and since there are no overriding royalty owners.

I understand that this plan of work must receive approval in writing by the Geological Survey before operations may be commenced.

Company **Nash, Windfohr and Brown**Address **1107 Continental Life Building****Fort Worth, Texas**By Title **K. F. Windfohr, Partner**

EXHIBIT "B"

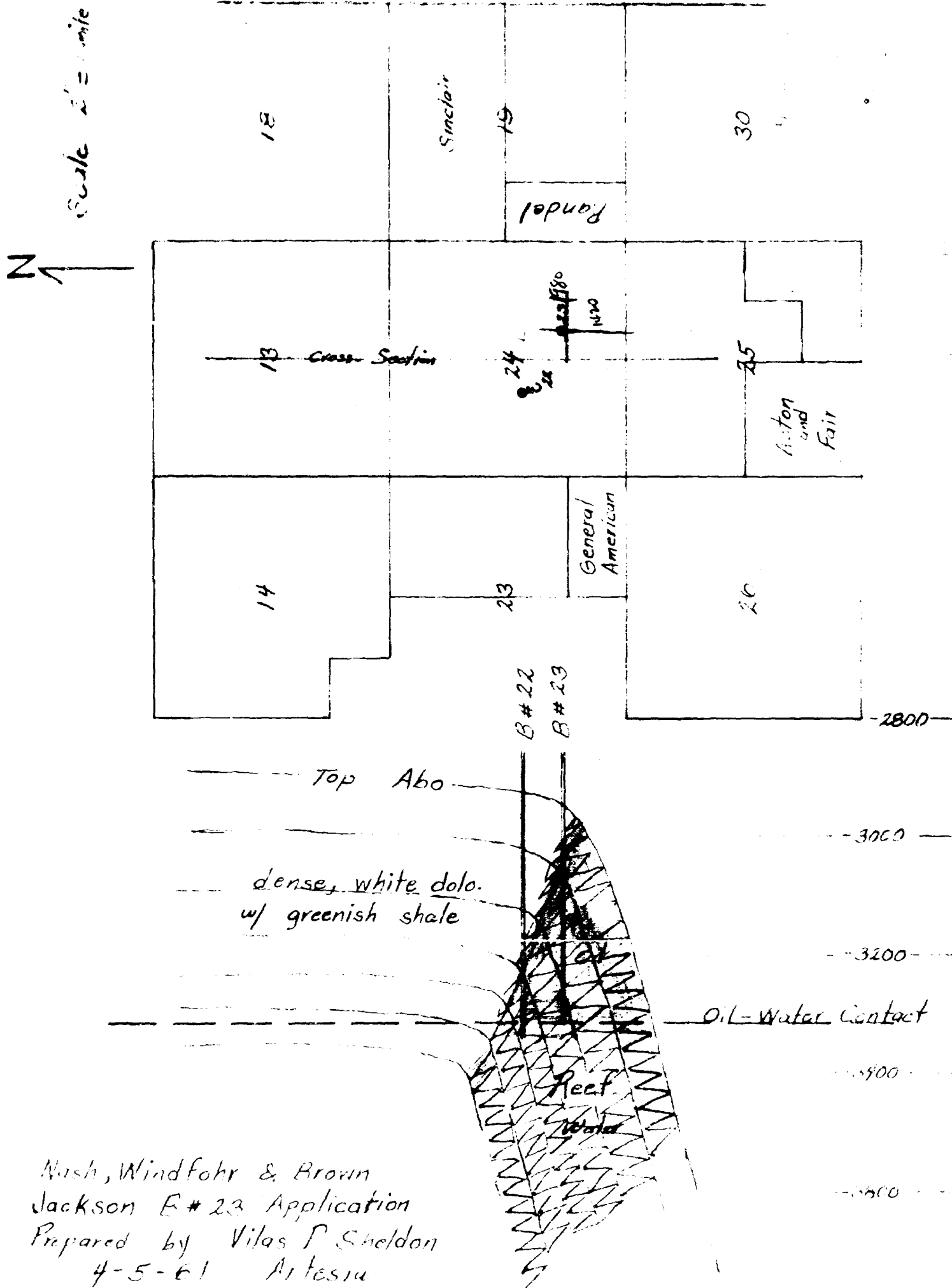

NEIL B. WATSON
FRED A. WATSON

LAW OFFICES
WATSON & WATSON
CAREER BUILDING - P.O. BOX 1000
ARTESIA, NEW MEXICO

Drawer E

TELEPHONE
CHEROKEE 2-4151

April 8, 1961

Oil Conservation Commission,
P. O. Box 871,
Santa Fe, New Mexico.

Attention: Mr. Oliver E. Payne

Dear Mr. Payne:

Re: Nash, Windfohr and Brown - Jackson
23-B Well, Unorthodox Location,
Section 24, Township 17 South, Range
30 East, N.M.P.M.

As provided by the Regulations, I am enclosing, in triplicate, an Application for the unorthodox well location, and trust that you find the Application satisfactory.

Will you please issue and publish the required Notice and, as I understand it, the matter can be set for hearing at Santa Fe on May 4, 1961. I would appreciate it if you would confirm the date and advise if the Application is satisfactory. If there is anything else you need, please let me know so that I will have time to get anything additional to your office by April 14, 1961.

Thank you very much for your cooperation.

Yours very truly,

Neil B. Watson
Neil B. Watson.

NBW:lve
enc.

cc :Nash, Windfohr and Brown

*Looked
at
2/11/61
H. J.*

*set for
hearing*

DOCKET: EXAMINER HEARING - THURSDAY, MAY 1, 1961

9 A.M. - OIL CONSERVATION COMMISSION CONFERENCE ROOM
STATE LAND OFFICE BUILDING, SANTA FE, NEW MEXICO

The following cases will be heard before Daniel S. Nuttner, Examiner, or Elvis A. Utz, as alternate examiner.

CONTINUED CASE

CASE 2234: Application of Kay Kameit for an order force-pooling a 320-acre gas proration unit in the Basin-Dakota Pool. Applicant, in the above styled cause, seeks an order force-pooling all mineral interests in the Basin-Dakota Pool in the E/2 of Section 21, Township 29 North, Range 11 West, San Juan County, New Mexico, including those of Roy L. Cook as lessee and various other parties as lessors in the E/2 NW/4 NE/4 of said Section 21.

NEW CASES

CASE 2261: Application of Continental Oil Company for two non-standard gas proration units. Applicant, in the above-styled cause, seeks the establishment of a 480-acre non-standard gas proration unit in the Eumont Gas Pool consisting of the S/2 and the NE/4 of Section 24, Township 20 South, Range 37 East, Lea County, New Mexico. Said unit is to be dedicated to the SEMU Eumont Well No. 67, located 1980 feet from the South and West lines of said Section 24.

Applicant further seeks the establishment of a 480-acre non-standard gas proration unit in the Eumont Gas Pool consisting of the NW/4 of Section 21, and the SE/4, the SW/4 NE/4, the S/2 SW/4 and the NW/4 SW/4 of Section 13, all in Township 20 South, Range 37 East, Lea County, New Mexico. Said unit is to be dedicated to the SEMU Eumont Well No. 69, located 1980 feet from the North and West lines of said Section 24.

CASE 2262: Application of V. S. Welch for an unorthodox oil well location. Applicant, in the above styled cause, seeks approval of an unorthodox oil well location in the Culwin-Yates Pool for a well to be drilled at a point 350 feet from the South line and 190 feet from the West line of Section 29, Township 16 South, Range 31 East, Eddy County, New Mexico.

CASE 2263: Application of Collier Drilling Company for an exception to Rule 309 (a) Applicant, in the above-styled cause, seeks an exception to Rule 309 (a) to permit the transportation of oil from the Western Yates Lease, comprising the SE/4 NW/4 of Section 20, Township 18 South, Range 28 East, Eddy County, New Mexico, to a separate tank battery located on its Amerada Lease, comprising the NE/4 NW/4 of said Section 20.

CASE 2264: Application of United States Smelting Refining and Mining Company for an oil-gas dual completion and for permission to commingle the production from two separate pools. Applicant, in the above-styled cause, seeks authorization to dually complete its Federal 11-20-34 Well No. 1, located 1980 feet from the North line and 2130 feet from the West line of Section 11, Township 20 South, Range 34 East, Lea County, New Mexico, in such a manner as to permit the production of oil from the Bone Springs formation adjacent to the Lea-Bone Springs Pool and the production of gas from an undesignated Pennsylvanian pool through parallel strings of 2-inch tubing.

Applicant further proposes to commingle the production from both of said pools in said well after metering only the Pennsylvanian pool production.

CASE 2265: Application of Nash, Windfohr and Brown for an unorthodox well location. Applicant, in the above-styled cause, seeks approval of an unorthodox location in an undesignated Abo pool for its Jackson Federal Well No. 23-B, located 1420 feet from the South line and 1980 feet from the East line of Section 24, Township 17 South, Range 30 East, Eddy County, New Mexico.

CASE 2266: Application of Nearburg & Ingram for permission to commingle the production from two separate leases, and from two separate pools. Applicant, in the above-styled cause, seeks permission to commingle, after separate measurement, the Southwest Gladiola-Pennsylvanian Pool production from all wells on its Keating lease, comprising the NE/4 of Section 34 with Southwest Gladiola-Pennsylvanian and Southwest Gladiola-Devonian production from all wells on its Midhurst Lease, comprising the NW/4 of Section 35, all in Township 12 South, Range 37 East, Lea County, New Mexico.

- CASE 2267: Application of Byard Bennett for permission to institute a waterflood project in the Caprock-Queen Pool, Chaves County, New Mexico. Applicant, in the above-styled cause, seeks permission to institute a waterflood project in the Caprock-Queen Pool in an area comprising the E/2 SE/4 of Section 20 and the SW/4 of Section 21, all in Township 14 South, Range 31 East, Chaves County, New Mexico, by the injection of water into the Stella Zimmerman Well No. 2, located in the SE/4 SE/4 of said Section 20.
- CASE 2268: Application of Humble Oil & Refining Company for an exception to Rule 303 (a). Applicant, in the above-styled cause, seeks an exception to Rule 303 (a) to permit commingling, without separate measurement, of the production from the Paddock, Penrose-Skelly and Drinkard Pools on the J. L. Greenwood Lease, comprising the S/2 of Section 9, Township 22 South, Range 37 East, Lea County, New Mexico.
- CASE 2269: Application of Great Western Drilling Company for an oil-salt water dual completion. Applicant, in the above-styled cause, seeks authorization to dually complete its Federal MM Well No. 2, located in the SE/4 NW/4 of Section 8, Township 9 South, Range 37 East, Lea County, New Mexico, in such a manner as to permit the production of oil from the Bough C formation adjacent to the East Allison-Pennsylvanian Pool and the injection of salt water into the San Andres formation.
- CASE 2270: Application of Pan American Petroleum Corporation for an oil-oil dual completion. Applicant, in the above-styled cause, seeks authorization to dually complete its Greenwood Unit Well No. 3, located in Unit II, Section 27, Township 18 South, Range 31 East, Eddy County, New Mexico, in such a manner as to permit the production of oil from an undesignated Bone Springs pool and the production of oil from an undesignated Wolfcamp pool through parallel strings of 2-inch tubing.
- CASE 2271: Application of Pan American Petroleum Corporation for two non-standard oil proration units and for an unorthodox oil well location. Applicant, in the above-styled cause, seeks the establishment of a 70.58-acre non-standard oil proration unit in the Cha Cha-Gallup Oil Pool consisting of Lots 8 and 9 and the S/2 of that portion of the San Juan River channel lying in the S/2 NE/4, all in Section 18,

CASE 2271 (Cont.)

Township 29 North, Range 14 West, San Juan County, New Mexico, said unit to be dedicated to the Navajo Tribal "G" Well No. 7, at an unorthodox location 2545 feet from the North line and 1670 feet from the East line of said Section 18, and of a 46.75-acre non-standard oil proration unit in said pool consisting of Lot 6 and the S/2 of that portion of the San Juan River channel lying in the SE/4, all in Section 16, Township 29 North, Range 14 West, San Juan County, New Mexico, said unit to be dedicated to the Navajo Tribal "E" Well No. 10, located 660 feet from the South line and 1980 feet from the East line of said Section 16.

CASE 2272:

Application of Pan American Petroleum Corporation for two non-standard oil proration units and for two unorthodox oil well locations. Applicant, in the above-styled cause, seeks the establishment of an 89.62-acre non-standard oil proration unit in the Cha Cha-Gallup Oil Pool consisting of Lots 2, 3 and 4 of Section 8, Township 28 North, Range 13 West, San Juan County, New Mexico, said unit to be dedicated to the C. J. Holder Well No. 11, at an unorthodox location 493 feet from the North line and 660 feet from the West line of said Section 8, and of an 89.22-acre non-standard oil proration unit in said pool consisting of Lot 1 of Section 8 and Lots 3 and 4 of Section 9, all in Township 28 North, Range 13 West, San Juan County, New Mexico, said unit to be dedicated to the C. J. Holder Well No. 12, at an unorthodox location 493 feet from the North line and 660 feet from the West line of said Section 9.

CASE 2273:

Application of El Paso Natural Gas Company for an exception to Rule 309 (a). Applicant, in the above-styled cause, seeks an exception to Rule 309 (a) to permit the transportation of oil produced on Federal Lease LC-064198-A, comprising the SE/4 of Section 18, prior to measurement, to tank batteries located on Federal Lease No. 025566, comprising the E/2 of Section 19, all in Township 19 South, Range 32 East, Lea County, New Mexico.

CASE 2274: Application of El Paso Natural Gas Company for an oil-gas dual completion. Applicant, in the above-styled cause, seeks an order authorizing the dual completion of its Lusk Deep Unit Well No. 2, located in Unit O, Section 18, Township 19 South, Range 32 East, Lea County, New Mexico, in such a manner as to permit the production of oil from the Strawn formation adjacent to the Lusk-Strawn Pool and the production of gas from the Morrow formation in an undesignated pool through parallel strings of 2 3/8-inch tubing.

**BEFORE THE OIL CONSERVATION COMMISSION
OF THE STATE OF NEW MEXICO**

**IN THE MATTER OF THE HEARING
CALLED BY THE OIL CONSERVATION
COMMISSION OF NEW MEXICO FOR
THE PURPOSE OF CONSIDERING:**

**CASE No. 2265
Order No. R-1965**

**APPLICATION OF NASH, WINDFOHR
AND BROWN FOR AN UNORTHODOX
WELL LOCATION, EDDY COUNTY,
NEW MEXICO.**

ORDER OF THE COMMISSION

BY THE COMMISSION:

This cause came on for hearing at 9 o'clock a.m. on May 4, 1961, at Santa Fe, New Mexico, before Daniel S. Nutter, Examiner duly appointed by the Oil Conservation Commission of New Mexico, hereinafter referred to as the "Commission," in accordance with Rule 1214 of the Commission Rules and Regulations.

NOW, on this 11th day of May, 1961, the Commission, a quorum being present, having considered the application, the evidence adduced, and the recommendations of the Examiner, Daniel S. Nutter, and being fully advised in the premises,

FINDS:

(1) That due public notice having been given as required by law, the Commission has jurisdiction of this cause and the subject matter thereof.

(2) That the applicant, Nash, Windfohr and Brown, seeks approval of an unorthodox location in an undesignated Abo pool for its Jackson Federal Well No. 23-B, located 1420 feet from the South line and 1980 feet from the East line of Section 24, Township 17 South, Range 30 East, NMPM, Eddy County, New Mexico.

(3) That a directional survey taken on the subject well at a depth of 4057 feet indicates that due to a relatively constant angle and direction of drift, the hole will be bottomed in the Abo formation well within the NW/4 SE/4 of Section 24.

(4) That inasmuch as applicant owns all of the acreage immediately offsetting the subject well, approval of the unorthodox location should be granted.

IT IS THEREFORE ORDERED:

(1) That the applicant, Nash, Windfohr and Brown, is hereby

-2-

CASE No. 2265

Order No. R-1965

authorized to locate its Jackson Federal Well No. 23-B at an unorthodox location in an undesignated Abo pool at a point 1420 feet from the South line and 1980 feet from the East line of Section 24, Township 17 South, Range 30 East, NMPL, Eddy County, New Mexico.

(2) That jurisdiction of this cause is retained for the entry of such further orders as the Commission may deem necessary.

DONE at Santa Fe, New Mexico, on the day and year hereinabove designated.

STATE OF NEW MEXICO
OIL CONSERVATION COMMISSION



[Signature]

EDWIN L. MECHEM, Chairman

[Signature]
E. S. WALKER, Member

[Signature]
A. L. PORTER, Jr., Member & Secretary

esr/

GOVERNOR
EDWIN L. MECHEM
CHAIRMAN

State of New Mexico
Oil Conservation Commission

LAND COMMISSIONER
E. S. JOHNNY WALKER
MEMBER

STATE GEOLOGIST
A. L. PORTER, JR.
SECRETARY - DIRECTOR

P. O. BOX 871
SANTA FE

May 11, 1961

Watson & Watson
Attorneys at Law
Carper Building
Artesia, New Mexico

Re: Case No. 2265
Order No. R-1965
Applicant:
Nash, Windfohr and Brown

Dear Sir:

Enclosed herewith are two copies of the above-referenced Commission order recently entered in the subject case.

Very truly yours,

A. L. Porter, Jr.
A. L. PORTER, Jr.
Secretary-Director

ir/

Carbon copy of order also sent to:

Hobbs OCC x
Artesia OCC x
Aztec OCC

OTHER

NEIL B. WATSON
FRED A. WATSON

LAW OFFICES
WATSON & WATSON
CARPER BUILDING - P.O. DRAWER E
ARTESIA, NEW MEXICO

TELEPHONE
SHERWOOD 6-4151

June 13, 1961

Mr. Dick Morris, Attorney,
Oil Conservation Commission,
Box 871,
Santa Fe, New Mexico.

Dear Mr. Morris:

Re: Case 2265, Order R-1965,
Nash, Windfohr & Brown.

At the time the hearing was held with reference to the application for an unorthodox well location, you asked Mr. Sheldon if we would be willing to furnish a survey report, upon completion of the well, and we stated that we would certainly do so if requested.

There was no requirement set forth in the Order, but an Eastman survey was made and, for your information and the information of the Commission, we are enclosing a copy of the Eastman report on the Nash, Windfohr & Brown - Jackson 23-B Well. You will notice that the report shows the bottom of the hole to be 422 feet north and 30° east of the surface location, which is in accordance with Mr. Sheldon's testimony as to the expected drift.

Yours very truly,



Neil B. Watson.

NBW:lve
enc.

cc :Nash, Windfohr & Brown

**REPORT
and
PLAN
of
SUB-SURFACE
M A G N E T I C
SURVEY**

WASH, WINDFOHR & BROWN

JACKSON NO. B - 23

LOCO HILLS, NEW MEXICO

JOB NO. WT 13061 A

DATE 5-16-1

EASTMAN OIL WELL SURVEY COMPANY

DENVER, COLORADO

LONG BEACH, CALIFORNIA

HOUSTON, TEXAS

SURVEY BY

OFFICE



RECORD OF SURVEY

CHECKED BY

JOB NO. WT 43061

DATE 5-16-61

STATION NO.	MEASURED DEPTH	DRIFT ANGLE	TRUE VERTICAL DEPTH	VERTICAL SECTION	COURSE DEVIATION	DRIFT DIRECTION	RECTANGULAR COORDINATES			
							NORTH	SOUTH	EAST	WEST
46	4200 00	6° 00'			11 32	N 18 W	151 29		24 13	
47	4290 00	7° 00'			10 97	N 18 W	161 72		20 74	
48	4379 00	7° 45'			12 00	N 18 W	173 13		17 03	
49	4469 00	8° 15'			12 91	N 22 W	185 10		12 19	
50	4559 00	8° 15'	4549 35		12 91	N 24 W	196 89		6 94	
51	4650 00	6° 15'			10 70	N 25 W	206 59		2 42	
52	4741 00	6° 15'			9 91	N 25 W	215 57			1 77
53	4831 00	6° 30'			10 19	N 21 W	225 08			5 42
54	4922 00	4° 15'			7 54	N 21 W	232 12			8 12
55	5013 00	4° 00'	5001 07		6 35	N 06 W	238 44			8 78
56	5103 00	3° 45'			5 39	N 12 E	244 20			7 56
57	5194 00	4° 00'			6 35	N 09 E	250 47			6 57
58	5284 00	3° 15'			5 39	N 10 E	256 27			5 55
59	5374 00	4° 00'			6 28	N 08 E	262 49			4 63
60	5465 00	4° 00'	5452 03		6 35	N 15 E	268 62			3 04
61	5556 00	4° 15'			6 74	N 12 E	275 21			1 64
62	5647 00	4° 45'			7 54	N 15 E	282 49		31	
63	5737 00	5° 15'			8 24	N 12 E	290 55		2 02	
64	5827 00	5° 00'			7 84	N 10 E	298 27		3 38	
65	5917 00	5° 00'	5902 41		7 84	N 08 E	306 03		4 47	
66	6008 00	5° 15'			8 33	N 06 E	314 31		5 34	
67	6097 00	5° 30'			8 55	N 07 E	322 80		6 38	
68	6187 00	6° 15'			9 80	N 11 E	332 42		8 25	
69	6277 00	6° 45'			10 58	N 16 E	342 59		11 17	
70	6368 00	7° 30'	6350 69		11 88	N 15 E	354 06		14 24	



RECORD OF SURVEY

CHECKED BY

JOB NO. WT 43061 A

DATE 5-16-61

STATION NUMBER	MEASURED DEPTH		DRIFT ANGLE	TRUE VERTICAL DEPTH	VERTICAL SECTION	COURSE DEVIATION	DRIFT DIRECTION	RECTANGULAR COORDINATES				
								NORTH	SOUTH	EAST	WEST	
71	6459	00	7° 00'			11 09	N 13 E	364 87		16 74		
72	6549	00	7° 00'			10 97	North	375 84				
73	6641	00	6° 45'			10 81	North	386 65				
74	6731	00	6° 45'			10 58	N 09 E	397 10		18 39		
75	6822	00	6° 30'	6801 50		10 30	N 09 E	407 27		20 00		
76	6913	00	6° 30'			10 30	N 10 E	417 11		21 79		
77	6948	00	6° 30'	6926 70		3 96	N 09 E	421 32		22 41		
CLOSURE								421.91'	NORTH	3° 3'	EAST	

BEFORE EXAMINED NUTTER
CLERK OF DISTRICT COURT
App. _____
CASE NO. 2265

Nash, Windfohr & Brown
Jackson B#23 Application
Prepared by Vilas P. Sheldon
4-5-61 Artesia

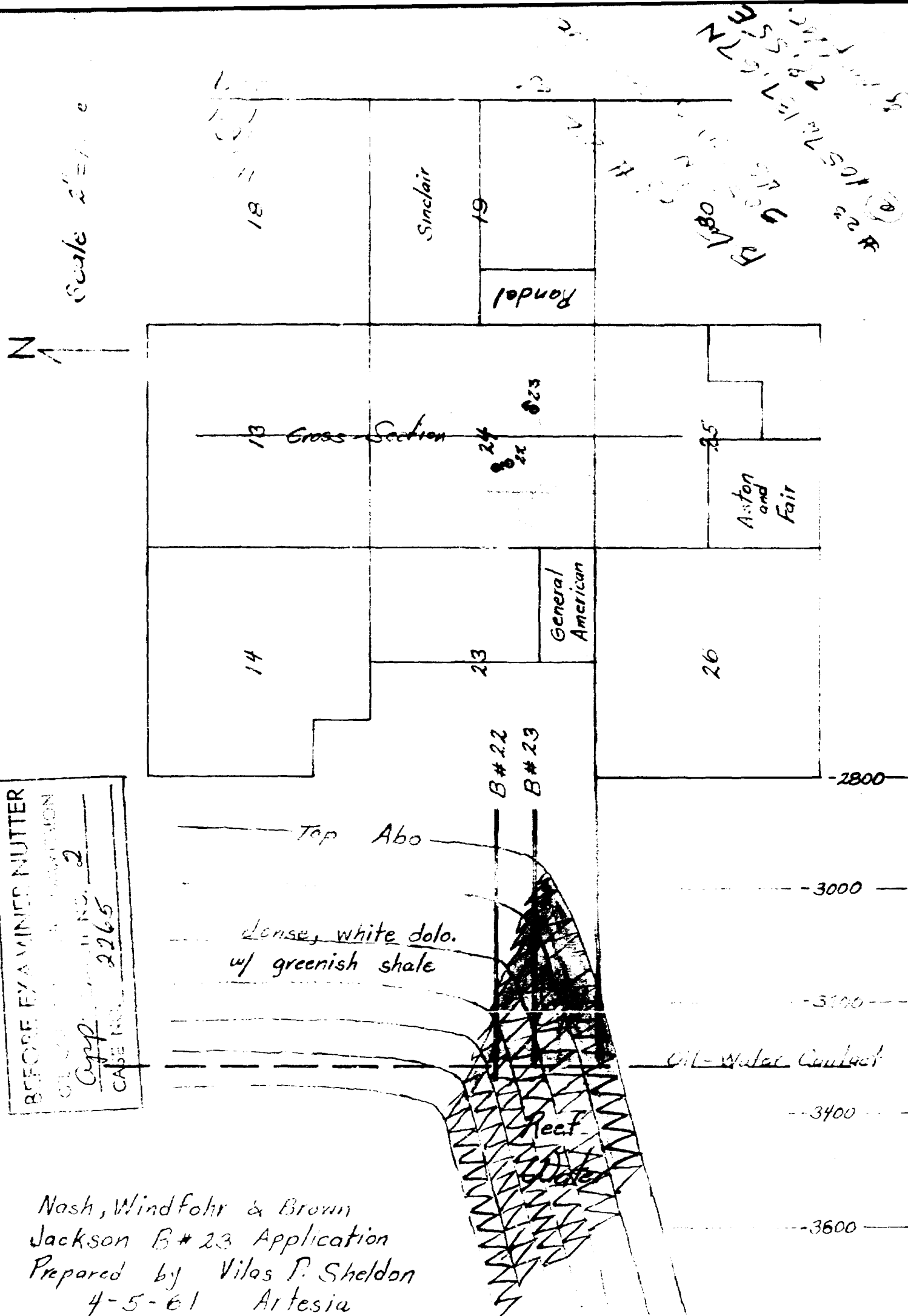

UNION. TEL.
OIL CONSERVATION COMMISSION
ONTARIO, CANADA
MAY 4, 1961

EXAMINER HEARING

IN THE MATTER OF:

CASE 2267

TRANSCRIPT OF HEARING

REGIONAL TITLE
OF ORIGINATION COMMISSION
NEW MEXICO
MAY 4, 1961

EXAMINEE RECORD

IN THE MATTER OF:

CASE 2264 Application of Nash, Windfohr and Brown for
an unorthodox well location. Applicant, in
the above-styled cause, seeks approval of
an unorthodox location in an undesignated
the pool for its Jackson Federal Well No.
22-E, located 1420 feet from the South line
and 1980 feet from the East line of Section
24, Township 17 South, Range 30 West, Eddy
County, New Mexico.

BEFORE:

Daniel S. Mutter, Examiner.

TRANSCRIPT OF PROCEEDINGS

MR. MUTTER: We will take Case 2264.

MR. MORRIS: Case 2264. Application of Nash, Windfohr
and Brown for an unorthodox well location.

MR. WATSON: I am Mr. Watson, Watson & Watson, Artesia,
New Mexico, attorney for the applicant. We have a witness, Mr.
V. P. Sheldon, to be sworn.

(Witness sworn)

(Whereupon, Applicant's Exhibits
Nos. 1 and 2 were marked for
identification)



VILAS SHELTON,

called as a witness, having been first duly sworn, testified as follows:

DIRECT EXAMINATION

BY MR. WATSON:

Q State your name, please.

A Vilas Sheldon.

Q What is your profession, Mr. Sheldon?

A Geologist.

Q Have you testified previously before the Oil Conservation Commission of New Mexico and given your qualifications?

A Yes, sir, I have.

MR. WATSON: Does the Commission recognize Mr. Sheldon's qualifications?

MR. TUTTLE: Yes, sir. Please proceed.

Q (By Mr. Watson) Mr. Sheldon, are you at the present time and have been for some time recently employed by Nash, Windfohr and Brown as a consulting geologist with reference to operations on their Jackson E lease?

A Yes, sir, I am so employed.

Q I'll hand you that has been marked Applicant's Exhibit No. 1, and ask you to state what that is, please?

A It is a blueprint of the map of the general area, showing ownership of the acreage for several miles around the Nash, Windfohr and Brown block of acreage.



Q Are the Nash, Windfobn and Brown leases in that area leasehold interests on that area outlined in any particular manner?

A Yes. The Nash, Windfobn and Brown leases are colored by the use of yellow.

Q On Applicant's Exhibit 1, you have indicated a location of the Jackson 22-E Well, is that right?

A Yes.

Q And you have also indicated the location of the well for which we seek approval here, the 22-B?

A Yes, sir.

Q And they're so designated on this map?

A They are.

Q From what formation is the Jackson 22-B Well producing?

A Jackson 22-B is the discovery well in the Abo formation.

Q Is any part of the Nash, Windfobn and Brown lease in a designated the field at this time?

A I don't think so. Yet, I'm not for sure. The last I knew, it hadn't been placed in any field.

Q Well, there's only the one producing well?

A There's just the one producing well.

Q And the 22-B well has been commenced, is that correct?

A Yes, it has. Mr. Windfobn wanted to start drilling it, so he started drilling it.

Q Is any approval obtained from the U.S.G.B. subject to obtaining approval of this another location?

Q. Yes, the U.S.G.S. may have well for it. It's up to the U.S.G.S. to grant approval or disapproval. Insofar as the U.S.G.S., they were happy.

Q. There has been in this immediate area only this one well drilled previously, the Jackson 211.

Q. Yes, in the immediate area. It's about two miles each direction.

Q. The proposed unorthodox location, who owns the offset 40-acre leasehold interest?

A. Mr. Shelden and Mrs. Shelden.

Q. All of them?

A. All of them.

Q. Will you state, Mr. Shelden, the reasons for the request to drill the well at the proposed location?

A. Yes.

Q. All right.

Q. Mr. Shelden wanted to drill the well approximately a half a normal location south of the Jackson 211 well, based on past pure geology. The geology found through this portion of El Paso County, we think, is going to be very good, probably one location certainly not over half a mile. It was very curious to have from the U.S.G.S. the office well. It was very curious.

Q. Now, Mr. Shelden, what is the location of the well?

A. It is located approximately 1/2 mile south of the Jackson 211 well, in the same general area as the Jackson 211 well.



of a limestone unit. We had hoped to hit the reef on the rear coast, but the hope wasn't quite fulfilled. We drilled a slightly back reef well. We were some 300 feet into the sho before we found porosity. There was considerable green shale; in fact, there was a tiny bit of red shale, which is quite, as far as I'm concerned, it was definite proof that we were on the back side of the reef, to some, not a terribly lot, but the Cedar Lake No. 2 field two miles east is a very narrow situation, and the Woolly Well and the Texas-Pacific well about two miles west, is on a very narrow situation. Mr. Winiford and I, too, for that matter, were quite concerned that if we moved a full location we might jump clear over and get on the front side of the reef. This we did not want to do.

Q Referring to Applicant's Exhibit 2, did you prepare this Exhibit?

A Yes, I prepared the Exhibit.

Q Just does the Exhibit show with respect to where you anticipate the No. 2 location will be found in this particular area?

A Well, the Exhibit, of course, consists of a small sketch map showing the Nash, Winiford and No. 2 wells across with the surface locations, and then a cross section section; our interpretation of what we think the No. 2 reef is going to look like, showing the oil-bearing part.

Q Now, this is based on information obtained in connection with the No. 2 well?

It's based on what we knew at the time, and what we learned in drilling --

Go ahead, Mr. Sheldon.

There is another factor, I think, that should be entered. It is generally thought that most wells drilled in the area are drifting to the north and in the case of the Jackson 2-22 Mr. Windfelm had an eastern directional survey taken, and, of course, the well --

Have you examined that survey?

Yes. I have a copy of it and have examined it. The well wound up 30 feet north and 45 feet west of the surface location.

What is the reason for that, Mr. Sheldon --

Oh, wells --

-- can you give any reason?

Rotary wells tend to drift to structure. I don't know why. In the Jackson 2-22 at a depth of 4,166 feet, a directional survey was taken to find out where we were going, and at that point it was 111 feet north and 20 feet east of the surface location, which at that point placed it 333 feet north of the unit line. If it continues to drift the next 2,000 feet, it should be 333 feet from the unit line, anyway.

That's the No. 1.

That's the No. 1.

That's the No. 1.



... 7 feet. It is ... feet ... feet.

... : Off the surface location.

... off the surface location. The location was deliberately ... exactly where it is, trying to follow the hole, that's about ... feet north of the unit line.

(Mr. Nelson) Mr. Sheldon, it is correct, is it not, that the working interest and the royalty interest under the Jackson Lease are identical?

Yes, they are identical.

I believe we have already heard it out that Nash, Windohr and Brown all own the in-some offsets --

Yes, they do.

-- to this proposed location?

In every direction.

Do you have anything else you want to add, Mr. Sheldon, about your reasons for recommending this location?

No, I believe not. I'll be glad to answer any questions. He simply, Mr. Windohr and myself didn't want to straddle the reef on this exploratory well, trying to hit it on the top.

As you pointed out, Mr. Sheldon, it is true, isn't it, that the reef location is very narrow in places --

In places, yes.

-- in every direction?

Yes, it is.

... places and ... reef location ... is

100

that correct, an entire 40-acre tract?

That is probably correct, yes.

MR. MATSON: I have no further questions at this time.

MR. TUTTLE: Any questions of Mr. Sheldon?

MR. MORRIS: Yes, sir.

MR. TUTTLE: Mr. Morris.

CROSS-EXAMINATION

BY MR. MORRIS:

Q Mr. Sheldon, your proposed location is unorthodox here in that it is only 100 feet north of the quarter-quarter section line, rather than 330, as required?

A Yes.

Q Assuming that your application is granted, and that you obtain a productive well in No. 23, would any further wells be drilled in the southwest quarter of the southeast quarter, the 40 directly south of the 40 we're in?

A Mr. Morris, if this well is not too far structural on the reef south, for instance, if we hit near the crest of the reef, I'm sure the operator will wish to drill a well in the south 40, the one you just described.

Q Now, you are aware, are you not, of our rule, the Commission's rule requiring that wells be 15 feet apart? That might necessitate your coming back for another location to be 15 feet from the well for which you are seeking approval here today. In other words, to have a second location in the southwest quarter,



you would have to be 150 feet from the north boundary of the quarter-quarter section line?

Q Yes, sir, and I do not anticipate that we'll have to ease back, because if the wells are going to shift off 150 feet, we're going to be quite -- we would be very reluctant to spud the well any less than 150 feet from the unit line, so I don't think 160 is going to be a factor. I'm positive Mr. Windfohr will want to go 160 feet to keep under the geographic limit. He has already run two Eastman surveys; someone might ask him to run another one.

Q In other words, you are of the opinion that if the unorthodox location that you are seeking today is granted, it will not necessitate another unorthodox location application at a later date?

A Not on the 40 acres that you discussed. We might want to do the same thing, say, in the southwest of the southwest of 24, but answering your question as I think you meant it, this unorthodox location will not directly cause another request.

Q Yes, that was my question. Mr. Sheldon, if there's some question about where the bottom hole location of this well might be, would Wash, Windfohr and Brown be willing to run a bottom hole survey on this well?

A Well, it has been run at 1,16 feet already. Yes, answering your question, yes.

THE COURT: I have no further questions. Thank you.

W. H. WILSON:

DE ARVIDE-MEIER REPORTING SERVICE, Inc.

PHONE CH 3-6691

1000 BUREAU, NEW YORK

Q. Now, Sheldon, how long was the directional survey that was run on the No. 23, please?

A. Yes.

Q. When this survey was run, you had approximately 2,000 more feet to drill, is that right?

A. Yes.

Q. 2,000 more feet. At the time the survey was run, the drift was in the neighborhood of 4, 5 or 6 degrees?

A. Four and three-quarters, something in that order, and the hole is off at 600, the hole was still off 4 degrees.

Q. Was there any noticeable change in the drift on the last 2,000 feet on the No. 2 Well?

A. No, it straightened up some. Here, it happens to be here at 4200. At 46, it was 4 degrees, at 51 it was 4 degrees and fifteen minutes, at 56, 4 degrees, at 6,000, 4 1/4, at 6 3/4, at 7,000, 3 1/2.

Q. So the drift was relatively constant, it straightened up to a constant rate of drift?

A. Yes.

Q. At the present time your No. 23 Well has moved 137 feet north of the survey's location.

A. Yes.

Q. Now, Sheldon, indicate on the map how the hole is located directly to the south of the survey on which this well is located.

A. Yes, sir.



Is their royalty considered under that the same?

Yes.

MR. TUTTER: Any further questions? He may be excused.

(Witness excused)

MR. TUTTER: Do you have anything further, Mr. Watson?

MR. WATSON: No, sir, that's all we have.

MR. TUTTER: These exhibits haven't been offered.

MR. WATSON: Yes, I would like to offer Applicant's Exhibits 1 and 2.

MR. TUTTER: Applicant's Exhibits 1 and 2 will be entered in evidence.

(Whereupon, Applicant's Exhibits Nos. 1 and 2 were received in evidence)

MR. TUTTER: Does anyone have anything they wish to offer in Case No. 1? We'll take the case under advisement, and take a recess.

DEARNLEY-VEIER REPORTING SERVICE, Inc.

PHONE CH 1-1231

ALBUQUERQUE, NEW MEXICO

COUNTY OF BERNALILLO)
COUNTY OF BERNALILLO)

I, WILLIAM H. DEARNLEY, County Reporter, in and for the County of Bernalillo, State of New Mexico, do hereby certify that the foregoing and attached Transcript of Proceedings before the New Mexico Oil Conservation Commission was reported by me in machine shorthand and reduced to typewritten transcript under my personal supervision, and that the same is a true and correct record to the best of my knowledge, skill and ability.

GIVEN My Hand and Seal this, the 17th day of May, 1961, in the City of Albuquerque, County of Bernalillo, State of New Mexico.

William H. Dearnley
COUNTY REPORTER

My Commission expires:

June 16, 1963

I do hereby certify that the foregoing is a true and correct record of the proceedings in the New Mexico Oil Conservation Commission Case No. 226-5 heard on 3-4, 1961.

William H. Dearnley, Examiner
New Mexico Oil Conservation Commission



CASE 2265: Application of NASH,
WINDFOHR & BROWN for an unorthodox
well location. (Jackson Fed. Well #
23-B).