

CASE 5733: YATES PETROLEUM CORP.
FOR AN UNORTHODOX LOCATION,
EDDY COUNTY, NEW MEXICO

CASE NO.

~~5733~~

APPLICATION,
TRANSCRIPTS,
SMALL EXHIBITS,
ETC.

BEFORE THE
NEW MEXICO OIL CONSERVATION COMMISSION
Santa Fe, New Mexico
August 18, 1976

EXAMINER HEARING

IN THE MATTER OF:

Application of Yates Petroleum Corpora-) CASE
tion for an unorthodox location,) 5733
Eddy County, New Mexico.)

BEFORE: Richard L. Stamets, Examiner

TRANSCRIPT OF HEARING

A P P E A R A N C E S

For the New Mexico Oil Conservation Commission: William F. Carr, Esq.
Legal Counsel for the Commission
State Land Office Building
Santa Fe, New Mexico

For the Applicant: Joel M. Carson, Esq.
LOSEE & CARSON, P.A.
Attorneys at Law
300 American Home Building
Artesia, New Mexico

sid morrish reporting service
General Court Reporting Service
825 Calle Mojia, No. 122, Santa Fe, New Mexico 87501
Phone (505) 982-9212

I N D E X

	<u>Page</u>
<u>RAY BECK</u>	
Direct Examination by Mr. Carson	3
Cross Examination by Mr. Stamets	7

EXHIBIT INDEX

	<u>Offered</u>	<u>Admitted</u>
Applicant's Exhibit One, Land Plat	4	7
Applicant's Exhibit Two, Map	5	7
Applicant's Exhibit Three, Cross Section	6	7

sid morrish reporting service

General Court Reporting Service
825 Calle Mejia, No. 122, Santa Fe, New Mexico 87501
Phone (505) 982-9212

1 MR. STAMETS: We will call next Case 5733.

2 MR. CARR: Case 5733, application of Yates
3 Petroleum Corporation for an unorthodox location, Eddy County,
4 New Mexico.

5 MR. CARSON: Mr. Hearing Officer, my name is Joel
6 Carson, Losee and Carson, P.A., Artesia, representing the
7 applicant, Yates Petroleum Corporation, I have one witness,
8 Mr. Ray Beck, who has previously been sworn.

9 MR. STAMETS: Let the record reflect that this
10 witness has been sworn.

11
12 RAY BECK

13 called as a witness, having been previously sworn, was
14 examined and testified as follows:

15
16 DIRECT EXAMINATION

17 BY MR. CARSON:

18 Q Would you state your name, please?

19 A Ray Beck.

20 Q Mr. Beck, you are the same person who previously
21 testified in Case 5732, are you not?

22 A Yes.

23 Q And your address is Artesia, New Mexico,

24 A That is correct.

25 Q You have previously testified before the Commission

sid morrish reporting service

General Court Reporting Service
825 Calle Mejia, No. 122, Santa Fe, New Mexico 87501
Phone (505) 982-9212

1 and your credentials have been admitted?

2 A. That's right.

3 MR. CARSON: Is the witness satisfactory for this
4 case?

5 MR. STAMETS: Yes.

6 Q. (Mr. Carson continuing.) Would you please state
7 the purpose of your application, Mr. Beck?

8 A. In Case 5733 Yates Petroleum Corporation seeks
9 approval of the unorthodox Morrow gas well location of the
10 No. 1 Jackson GM to be drilled six hundred and sixty feet
11 from the south and sixteen hundred and fifty feet from the
12 west line of Section 24, Township 17 South, Range 25 East,
13 Eddy County, New Mexico. The west half of said Section 24
14 would be dedicated to the well.

15 Q. Mr. Beck, would you refer to Applicant's Exhibit
16 Number One and explain that to the Hearing Officer, please?

17 A. Exhibit Number one is a land plat showing the
18 proposed location and its relationship to the surrounding
19 acreage and it outlines the west half of Section 24.

20 Q. Was this exhibit prepared by you or under your
21 supervision?

22 A. It was prepared by me.

23 Q. I refer you to Applicant's Exhibit Number Two and
24 ask if this map was prepared by you or under your supervision?

25 A. Exhibit Number Two was prepared by me.

sid morrish reporting service

General Court Reporting Service
825 Calle Mejia, No. 122, Santa Fe, New Mexico 87501
Phone (505) 982-9212

1 Q Would you explain to the Hearing Officer what that
2 exhibit purports to show?

3 A Exhibit Number Two is a map showing with solid
4 contours the varying thickness of the interval between the top
5 of the Morrow clastics and the Post-Chester limestone
6 unconformity. The Post-Chester limestone unconformity lies
7 above the Chester limestone except in those areas where erosion
8 has cut down to the Chester limestone.

9 The solid contour thicks indicate areas of greater
10 erosion prior to the deposition of Morrow clastics in this
11 area near the Morrow sub-crop. It is also within these thicks
12 that are found the thicker more productive Morrow channel
13 sands.

14 The Yates Arco EC No. 1 in the north half of Section
15 36, of 17, 25 lies within the thick and they encountered
16 thirty-nine feet of Morrow channel sand which yielded initial
17 production of fifteen million cubic feet of gas per day.

18 To the north-northeast, the Yates Jackson EM in the
19 southwest of the southeast of Section 25, 17-25 lies even more
20 actually within the thick and encountered eighty-eight feet of
21 Morrow channel sand which yielded an IP of eleven point five
22 million some few months after the Arco EC was put on
23 production.

24 The Western Oil Flint No. 2 in the southeast of
25 the southwest of the same section lies just on the edge of

sid morrish reporting service
General Court Reporting Service
825 Calle Mejia, No. 122, Santa Fe, New Mexico 87501
Phone (505) 982-9212

1 the thick and encountered only twenty or twenty-five feet of
2 tight, dirty channel edge sand.

3 To the north the Yates Akins-Fry in Section 13
4 of 17-25 lies in or close to the thick but this well near
5 the sub-crop edge found only tight, dirty sand.

6 A number of other wells lying outside of the thick
7 have not encountered Morrow channel sand.

8 The proposed location of the Jackson GM is positioned
9 where we now interpret the thick to cross the west half of
10 Section 24 and thereby has the best chance of encountering
11 the more productive, efficient Morrow channel sand.

12 Also shown on Exhibit Two are dotted contours
13 showing the structural configuration of the top of the
14 Morrow clastics in the location of cross section AA prime.

15 Q Referring to Applicant's Exhibit Number Three,
16 was this exhibit prepared by you or under your supervision?

17 A It was prepared by me.

18 Q Would you please explain to the Hearing Examiner
19 what this exhibit would purport to show?

20 A Exhibit Number Three is a cross section hung on
21 the top of the Morrow clastics, showing in transverse
22 section the map interval of the previous exhibit, the
23 pertinent correlations and the depth dimension to the
24 previous exhibit.

25 Q Mr. Beck, in your opinion would the granting of

sid morrish reporting service

General Court Reporting Service
825 Calle Mejia, No. 122, Santa Fe, New Mexico 87501
Phone (505) 982-9212

1 this application afford the applicant the opportunity to
2 produce his just and equitable share of gas, prevent
3 economic loss caused by the drilling of unnecessary wells,
4 avoid the augmentation of risk from the drilling of unnecessary
5 wells and otherwise protect correlative rights and prevent
6 waste?

7 A. I do.

8 MR. CARSON: Mr. Examiner, I would like to move
9 the introduction of these three exhibits.

10 MR. STAMETS: These exhibits will be admitted.

11 (THEREUPON, Applicant's Exhibits One
12 through Three were admitted into evidence.)

13 MR. CARSON: I have no further questions of this
14 witness.

15
16 CROSS EXAMINATION

17 BY MR. STAMETS:

18 Q. Mr. Beck, why is it necessary to locate this
19 Jackson GM at an unorthodox location instead of an orthodox
20 location?

21 A. Well, the lesson of the Yates Akins-Fry in
22 Section 13, it seems that in that well there we encountered
23 a thick but the sands were dirty and tight so we are trying
24 to stay away from this phenomenon which seemed to occur near
25 the sub-crop edge and get closer to channel production that

1 has been established to the south.

2 MR. STAMETS: Any other questions of the witness?

3 He may be excused.

4 (THEREUPON, the witness was excused.)

5 MR. STAMETS: Anything further in this case? We
6 will take the case under advisement.

7

8

9

10

11

12

13

14

15

16

17

18

19

20

21

22

23

24

25

sid morrish reporting service
General Court Reporting Service
825 Calle Mejia, No. 122, Santa Fe, New Mexico 87501
Phone (505) 982-9212

REPORTER'S CERTIFICATE

I, SIDNEY F. MORRISH, a Certified Shorthand Reporter,
do hereby certify that the foregoing and attached Transcript
of Hearing before the New Mexico Oil Conservation Commission
was reported by me, and the same is a true and correct record
of the said proceedings to the best of my knowledge, skill and
ability.

Sidney F. Morrish, C.S.R.

sid morrish reporting service
General Court Reporting Service
825 Calle Mejia, No. 122, Santa Fe, New Mexico 87501
Phone (505) 982-9212

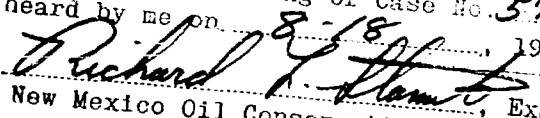
I do hereby certify that the foregoing is
a complete record of the proceedings in
the Examiner hearing of Case No. 5733
heard by me on 8-18, 1976.

Richard F. Hamt, Examiner
New Mexico Oil Conservation Commission

Other _____

BEFORE THE OIL CONSERVATION COMMISSION
OF THE STATE OF NEW MEXICO

IN THE MATTER OF THE HEARING
CALLED BY THE OIL CONSERVATION
COMMISSION OF NEW MEXICO FOR
THE PURPOSE OF CONSIDERING:

CASE NO. 5733
Order No. R-5267

APPLICATION OF YATES PETROLEUM
CORPORATION FOR AN UNORTHODOX GAS
WELL LOCATION, EDDY COUNTY,
NEW MEXICO.

ORDER OF THE COMMISSION

BY THE COMMISSION:

This cause came on for hearing at 9 a.m. on August 18, 1976, at Santa Fe, New Mexico, before Examiner Richard L. Stamets.

NOW, on this 31st day of August, 1976, the Commission, a quorum being present, having considered the testimony, the record, and the recommendations of the Examiner, and being fully advised in the premises,

FINDS:

- (1) That due public notice having been given as required by law, the Commission has jurisdiction of this cause and the subject matter thereof.
- (2) That the applicant, Yates Petroleum Corporation, seeks approval of an unorthodox gas well location for its Jackson GM Well No. 1 to be drilled 660 feet from the South line and 1650 feet from the West line of Section 24, Township 17 South, Range 25 East, NMPM, to test the Morrow formation, Eddy County, New Mexico.
- (3) That the W/2 of said Section 24 is to be dedicated to the well.
- (4) That a well at said unorthodox location will better enable applicant to produce the gas underlying the proration unit.
- (5) That no offset operator objected to the proposed unorthodox location.
- (6) That approval of the subject application will afford the applicant the opportunity to produce its just and equitable share of the gas in the subject pool, will prevent the economic loss caused by the drilling of unnecessary wells, avoid the augmentation of risk arising from the drilling of an excessive number of wells, and will otherwise prevent waste and protect correlative rights.

-2-
Case No. 5733
Order No. R-5267

IT IS THEREFORE ORDERED:

(1) That an unorthodox gas well location for the Morrow formation is hereby approved for the Yates Petroleum Corporation Jackson GM Well No. 1, to be located at a point 660 feet from the South line and 1650 feet from the West line of Section 24, Township 17 South, Range 25 East, NMPM, Eddy County, New Mexico.

(2) That the W/2 of said Section 24 shall be dedicated to the above-described well.

(3) That jurisdiction of this cause is retained for the entry of such further orders as the Commission may deem necessary.

DONE at Santa Fe, New Mexico, on the day and year hereinabove designated.

STATE OF NEW MEXICO
OIL CONSERVATION COMMISSION

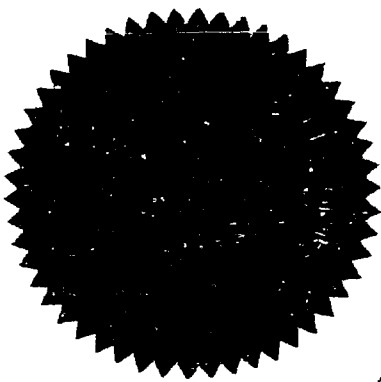
Phil R. Lucero
PHIL R. LUCERO, Chairman

EMERY C. ARNOLD, Member

Joe D. Ramey
JOE D. RAMEY, Member & Secretary

S E A L

dr/

Dockets Nos. 24-76 and 25-76 are tentatively set for hearing on September 1 and 15, 1976. Applications for hearing must be filed at least 22 days in advance of hearing date.

DOCKET: EXAMINER HEARING - WEDNESDAY - AUGUST 18, 1976

9 A.M. - OIL CONSERVATION COMMISSION CONFERENCE ROOM,
STATE LAND OFFICE BUILDING, SANTA FE, NEW MEXICO

The following cases will be heard before Richard L. Stamets, Examiner, or Daniel S. Rutter, Alternate Examiner:

- ALLOWABLE: (1) Consideration of the allowable production of gas for September, 1976, from seventeen prorated pools in Lea, Eddy, Chaves, and Roosevelt Counties, New Mexico.
- (2) Consideration of the allowable production of gas for September, 1976, from four prorated pools in San Juan, Rio Arriba, and Sandoval Counties, New Mexico.

CASE 5731: Application of Texaco, Inc. for downhole commingling, Lea County, New Mexico. Applicant, in the above-styled cause, seeks authority to commingle Blinbry, Drinkard, and Tubb production in the wellbore of its C. H. Lockhart Federal Well No. 6 located in Unit G of Section 18, Township 22 South, Range 38 East, Lea County, New Mexico.

CASE 5725: Application of General American Oil Company for extension of time for temporary abandonment, Eddy County, New Mexico. Applicant, in the above-styled cause, seeks extension of time for temporary abandonment of certain wells in Eddy County, New Mexico, said wells being described as follows:

Township 16 South, Range 29 East:

Brewer Nos. 19 and 28 in Section 12; Brewer Nos. 11, 12, 14, 24, and 25 in Section 13; Brewer Nos. 3, 4, 5, 17, 18, 20, 21, 23, and 27 and Bosworth Nos. 1, 2, 3, and 4 in Section 14; and Runlee Nos. 4, 5, and 6 in Section 35;

Township 16 South, Range 30 East:

Sivley No. 3 in Section 8;

Township 17 South, Range 29 East:

Keely "C" Nos. 10, 12, 18, 20, 25, and 37 in Section 25; Grayburg D. U. No. 5 in Section 25; Keely "B" No. 15 in Section 26; Green "A" Nos. 1 and 4 in Section 29; and State B1778 Nos. 1 and 3 and State B4458 No. 2 in Section 36;

Township 17 South, Range 30 East:

Burch "A" Nos. 23 and 24 in Section 19; Dexter "E" No. 2 in Section 20; Parke "E" No. 2 in Section 22; Maddren "B" Nos. 6 and 9 in Section 27; Beeson A No. 2 in Section 28; Beeson "F" No. 9 in Section 29; Grayburg D. U. Nos. 4 and 6 in Section 30; Beeson "F" Nos. 1, 3, 4, 5, 6, 12, 13, 14, and 16 in Section 31; State B4108 No. 1 in Section 32; and Arnold "D" Nos. 8 and 9 in Section 34.

Three of the above wells are undesignated and the others are variously located in the High Lonesome, West Square Lake, Grayburg Jackson, Loco Hills, and West Henshaw Premier Pools.

CASE 5732: Application of Yates Petroleum Corporation for downhole commingling, Eddy County, New Mexico. Applicant, in the above-styled cause, seeks authority to commingle Morrow and Strawn production in the wellbore of its Roden Federal GD Well No. 1 located in Unit I of Section 23, Township 19 South, Range 24 East, Eddy County, New Mexico.

CASE 5733: Application of Yates Petroleum Corporation for an unorthodox location, Eddy County, New Mexico. Applicant, in the above-styled cause, seeks approval for the unorthodox gas well location of its Jackson GM Well No. 1 to be drilled at a point 660 feet from the South line and 1650 feet from the West line of Section 24, Township 17 South, Range 25 East, Eddy County, New Mexico, to test the Morrow formation, the W/2 of said Section 24 to be dedicated to the well.

CASE 5734: Application of Yates Petroleum Corporation for an unorthodox location, Eddy County, New Mexico. Applicant, in the above-styled cause, seeks approval for the unorthodox gas well location of its Federal GL Well No. 1 to be drilled at a point 660 feet from the South and West lines of Section 33, Township 17 South, Range 25 East, Eddy County, New Mexico, to test the Morrow formation, the S/2 of said Section 33 to be dedicated to the well.

CASE 5724: Application of Yates Petroleum Corporation for an oil treating plant permit, Eddy County, New Mexico. Applicant, in the above-styled cause, seeks authority for the construction and operation of an oil treating plant for the purposes of treating and reclaiming sediment oil at a site in the SE/4 of Section 25, Township 18 South, Range 25 East, Eddy County, New Mexico.

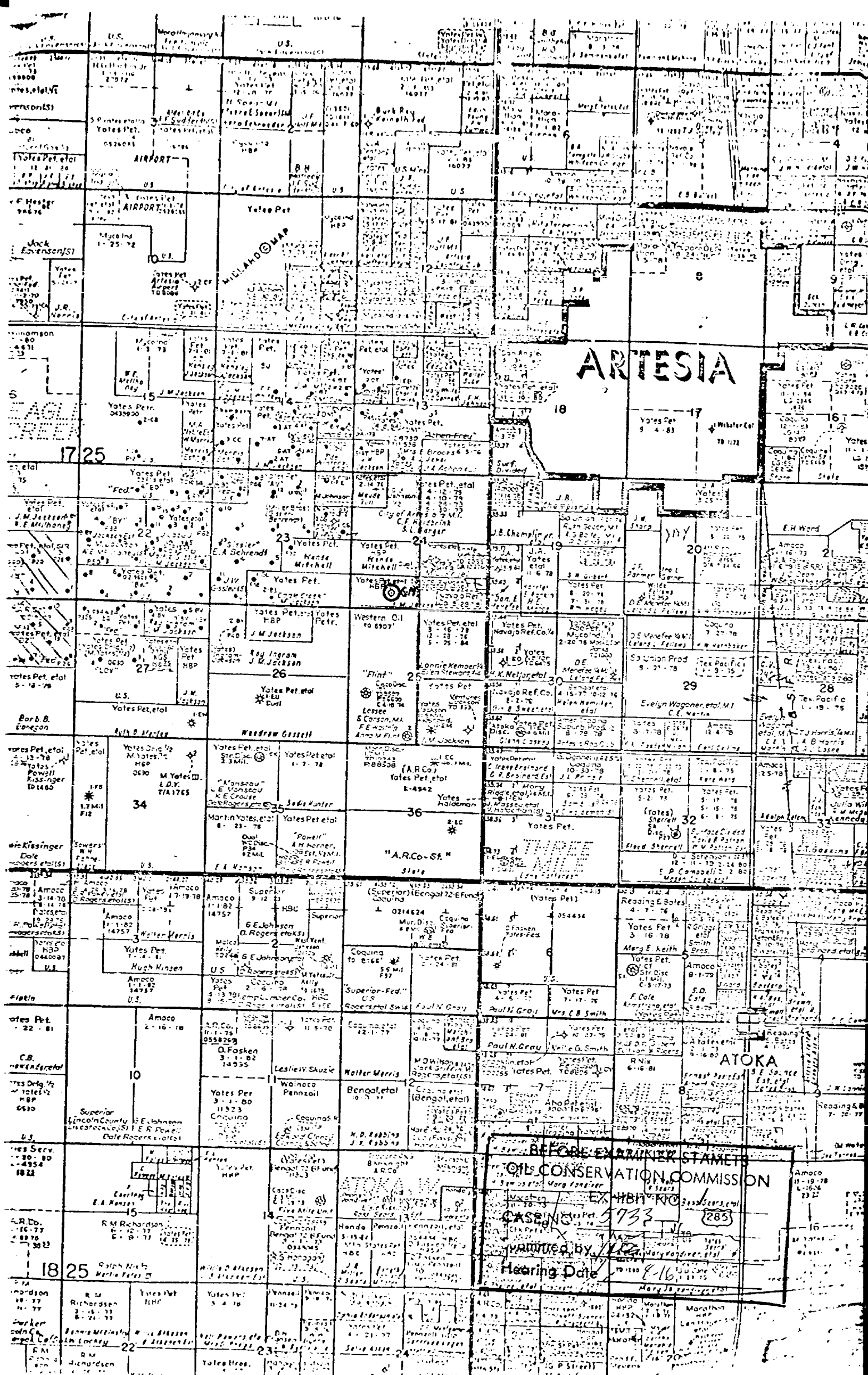

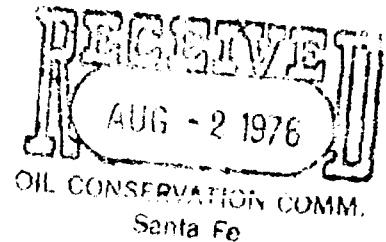

BEFORE THE OIL CONSERVATION COMMISSION

STATE OF NEW MEXICO

IN THE MATTER OF THE APPLICATION OF :
YATES PETROLEUM CORPORATION FOR AN :
UNORTHODOX GAS WELL LOCATION, EDDY : CASE NO. 5733
COUNTY, NEW MEXICO. :

APPLICATION

COMES NOW YATES PETROLEUM CORPORATION, by its attorneys,
and in support hereof, respectfully states:

1. That applicant is the operator of the Pennsylvanian
formation underlying:

Township 17 South, Range 25 East, N.M.P.M.

Section 24: W/2,

and proposes to drill its Jackson "GM" No. 1 well located 660 feet
from the South line and 1,650 feet from the West line of said
Section 24.

2. That applicant seeks an exception to the well
location requirements of Rule 104-C II(a) of the Oil Conservation
Commission to permit the drilling of the well at the above men-
tioned unorthodox location to a depth sufficient to adequately
test the Morrow formation in the Pennsylvanian system.

3. That a standard 320-acre gas proration unit com-
prising the W/2 of said Section 24 should be dedicated to such
well or such lesser portion thereof as is reasonably shown to be
productive of gas.

4. That the approval of this application will afford applicant the opportunity to produce its just and equitable share of gas, will prevent economic loss caused by the drilling of unnecessary wells, avoid the augmentation of risk from the drilling of an excessive number of wells, and will otherwise prevent waste and protect correlative rights.

WHEREFORE, applicant prays:

A. That this application be set for hearing before an examiner and that notice of said hearing be given as required by law.

B. That upon hearing the Commission enter its order granting to applicant permission to drill a well 660 feet from the South line and 1,650 feet from the West line of said Section 24, and to dedicate that portion of the W/2 of said Section 24 which is reasonably presumed to be productive of gas.

C. And for such other relief as may be just in the premises.

YATES PETROLEUM CORPORATION

By: 

LOSEE & CARSON, P.A.
P. O. Drawer 239
Artesia, New Mexico 88210

Attorneys for Applicant

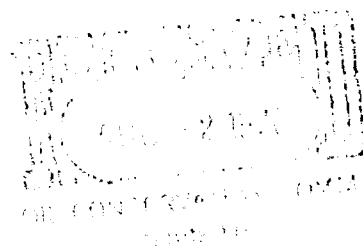

BEFORE THE OIL CONSERVATION COMMISSION

STATE OF NEW MEXICO

IN THE MATTER OF THE APPLICATION OF
YATES PETROLEUM CORPORATION FOR AN
UNORTHODOX GAS WELL LOCATION, EDDY
COUNTY, NEW MEXICO.

CASE NO. 5733

APPLICATION

COMES NOW YATES PETROLEUM CORPORATION, by its attorneys,
and in support hereof, respectfully states:

1. That applicant is the operator of the Pennsylvanian
formation underlying:

Township 17 South, Range 25 East, N.M.P.M.

Section 24: W/2,

and proposes to drill its Jackson "GM" No. 1 well located 660 feet
from the South line and 1,650 feet from the West line of said
Section 24.

2. That applicant seeks an exception to the well
location requirements of Rule 104-C II(a) of the Oil Conservation
Commission to permit the drilling of the well at the above men-
tioned unorthodox location to a depth sufficient to adequately
test the Morrow formation in the Pennsylvanian system.

3. That a standard 320-acre gas proration unit com-
prising the W/2 of said Section 24 should be dedicated to such
well or such lesser portion thereof as is reasonably shown to be
productive of gas.

4. That the approval of this application will afford applicant the opportunity to produce its just and equitable share of gas, will prevent economic loss caused by the drilling of unnecessary wells, avoid the augmentation of risk from the drilling of an excessive number of wells, and will otherwise prevent waste and protect correlative rights.

WHEREFORE, applicant prays:

A. That this application be set for hearing before an examiner and that notice of said hearing be given as required by law.

B. That upon hearing the Commission enter its order granting to applicant permission to drill a well 660 feet from the South line and 1,650 feet from the West line of said Section 24, and to dedicate that portion of the W/2 of said Section 24 which is reasonably presumed to be productive of gas.

C. And for such other relief as may be just in the premises.

YATES PETROLEUM CORPORATION

By: 

LOSEE & CARSON, P.A.
P. O. Drawer 239
Artesia, New Mexico 88210

Attorneys for Applicant

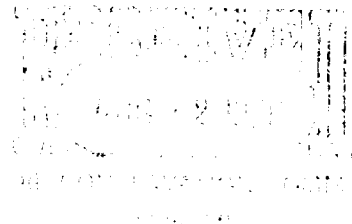

BEFORE THE OIL CONSERVATION COMMISSION

STATE OF NEW MEXICO

IN THE MATTER OF THE APPLICATION OF
YATES PETROLEUM CORPORATION FOR AN
UNORTHODOX GAS WELL LOCATION, EDDY
COUNTY, NEW MEXICO.

CASE NO. 5733

APPLICATION

COMES NOW YATES PETROLEUM CORPORATION, by its attorneys,
and in support hereof, respectfully states:

1. That applicant is the operator of the Pennsylvanian
formation underlying:

Township 17 South, Range 25 East, N.M.P.M.

Section 24: W/2,

and proposes to drill its Jackson "GM" No. 1 well located 660 feet
from the South line and 1,650 feet from the West line of said
Section 24.

2. That applicant seeks an exception to the well
location requirements of Rule 104-C II(a) of the Oil Conservation
Commission to permit the drilling of the well at the above men-
tioned unorthodox location to a depth sufficient to adequately
test the Morrow formation in the Pennsylvanian system.

3. That a standard 320-acre gas proration unit com-
prising the W/2 of said Section 24 should be dedicated to such
well or such lesser portion thereof as is reasonably shown to be
productive of gas.

4. That the approval of this application will afford applicant the opportunity to produce its just and equitable share of gas, will prevent economic loss caused by the drilling of unnecessary wells, avoid the augmentation of risk from the drilling of an excessive number of wells, and will otherwise prevent waste and protect correlative rights.

WHEREFORE, applicant prays:

A. That this application be set for hearing before an examiner and that notice of said hearing be given as required by law.

B. That upon hearing the Commission enter its order granting to applicant permission to drill a well 660 feet from the South line and 1,650 feet from the West line of said Section 24, and to dedicate that portion of the W/2 of said Section 24 which is reasonably presumed to be productive of gas.

C. And for such other relief as may be just in the premises.

YATES PETROLEUM CORPORATION

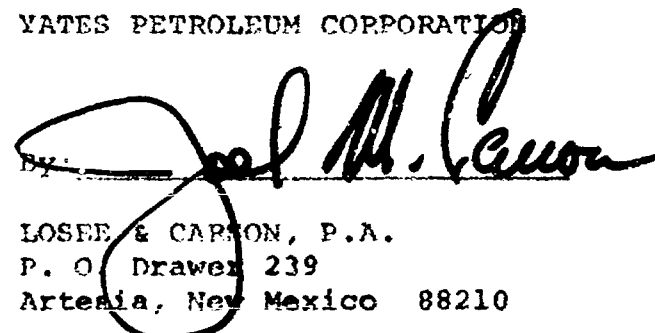
By: 
LOSEE & CARSON, P.A.
P. O. Drawer 239
Artesia, New Mexico 88210

Attorneys for Applicant

dr/ *Y*

BEFORE THE OIL CONSERVATION COMMISSION
OF THE STATE OF NEW MEXICO

IN THE MATTER OF THE HEARING
CALLED BY THE OIL CONSERVATION
COMMISSION OF NEW MEXICO FOR
THE PURPOSE OF CONSIDERING:

CASE NO. 5733

Order No. R- 5267

APPLICATION OF YATES PETROLEUM CORPORATION
FOR AN UNORTHODOX GAS WELL LOCATION,
EDDY COUNTY, NEW MEXICO.

Handwritten signatures

ORDER OF THE COMMISSION

RLS

BY THE COMMISSION:

This cause came on for hearing at 9 a.m. on August 18, 1976,
at Santa Fe, New Mexico, before Examiner Richard L. Stamets.

NOW, on this August day of August, 1976, the Commission,
a quorum being present, having considered the testimony, the record, and
the recommendations of the Examiner, and being fully advised in the premises,

FINDS:

(1) That due public notice having been given as required by law, the
Commission has jurisdiction of this cause and the subject matter thereof.

(2) That the applicant, Yates Petroleum Corporation, seeks
~~for~~ its Jackson GM Well No. 1 to be drilled
approval of an unorthodox gas well location / 660 feet from the South
line and 1650 feet from the West line of Section 24, Township
17 South, Range 25 East, NMPM, to test the
Morrow formation, Port,
Eddy County, New Mexico.

(3) That the W/2 of said Section 24 is to be dedicated to the
well.

(4) That a well at said unorthodox location will better enable
applicant to produce the gas underlying the proration unit.

(5) That no offset operator objected to the proposed unorthodox
location.

-2-

Case No. _____

Order No. R- _____

(6) That approval of the subject application will afford the applicant the opportunity to produce its just and equitable share of the gas in the subject pool, will prevent the economic loss caused by the drilling of unnecessary wells, avoid the augmentation of risk arising from the drilling of an excessive number of wells, and will otherwise prevent waste and protect correlative rights.

IT IS THEREFORE ORDERED:

(1) That an unorthodox gas well location for the Morrow
~~the Yates Petroleum Corporation~~ Jackson GM Well No. 1,
formation is hereby approved for ~~Maxwell~~ to be located at a point 660
feet from the South line and 1650 feet from the West
line of Section 24, Township 17 South, Range 25 East,
NMPM, _____ Pool, Eddy County,
New Mexico.

(2) That the W/2 of said Section 24 shall be dedicated to
the above-described well.

(3) That jurisdiction of this cause is retained for the entry of such
further orders as the Commission may deem necessary.

DONE at Santa Fe, New Mexico, on the day and year hereinabove designated.

Yates Petroleum Corporation

unorthodox location

Sec 24 17S 28E

1650 FWL

660 FSL

Jackson GM #1

Morrow Test

W/2

W/2

Case 5733