

CASE 575<sup>1</sup>: BETTIS, BOYLE &  
STOVALL FOR A SPECIAL ALLOWABLE,  
LEA COUNTY, NEW MEXICO

CASE NO.

5752

APPLICATION,  
TRANSCRIPTS,  
SMALL EXHIBITS,  
ETC.

BEFORE THE  
NEW MEXICO OIL CONSERVATION COMMISSION  
Santa Fe, New Mexico  
September 1, 1976

EXAMINER HEARING

IN THE MATTER OF:

Application of Bettis, Boyle & Stovall ) CASE  
for a special allowable, Lea County, ) 5752  
New Mexico. )

BEFORE: Daniel S. Nutter, Examiner

TRANSCRIPT OF HEARING

A P P E A R A N C E S

For the New Mexico Oil Conservation Commission: William F. Carr, Esq.  
Legal Counsel for the Commission  
State Land Office Building  
Santa Fe, New Mexico

For the Applicant: Owen M. Lopez, Esq.  
MONTGOMERY, FEDERICI, ANDREWS  
& HANNAHS  
Attorneys at Law  
P. O. Box 2307  
Santa Fe, New Mexico

sid morrish reporting service

General Court Reporting Service  
825 Calle Mejia, No. 122, Santa Fe, New Mexico 87501  
Phone (505) 982-9212

I N D E X

Page

LARRY O. HULSEY

Direct Examination by Mr. Lopez

3

Cross Examination by Mr. Nutter

7

EXHIBIT INDEX

Offered      Admitted

Bettis' Exhibit One, Plat

4

7

Bettis' Exhibit Two, Sketch

5

7

Bettis' Exhibit Three, Log

5

7

Bettis' Exhibit Four, Production Report

5

7

Bettis' Exhibit Five, Production Report

5

7

Bettis' Exhibit Six, Production Report

6

7

**sid morrish reporting service**  
General Court Reporting Service  
825 Calle Mejia, No. 122, Santa Fe, New Mexico 87501  
Phone (505) 982-9212

**sid morrish reporting service**  
*General Court Reporting Service*  
 825 Calle Mejia, No. 122, Santa Fe, New Mexico 87501  
 Phone (505) 982-9212

1 MR. NUTTER: The hearing will come to order please.  
 2 The first case now will be Case Number 5752.

3 MR. CARR: Case 5752, application of Bettis, Boyle  
 4 & Stovall for a special allowable, Lea County, New Mexico.

5 MR. LOPEZ: If the Examiner please, my name is Owen  
 6 Lopez of the firm of Montgomery, Federici, Andrews and Hannahs  
 7 appearing on behalf of the applicant. I have one witness to  
 8 be sworn.

9 (THEREUPON, the witness was duly sworn.)

10  
 11 LARRY O. HULSEY  
 12 called as a witness, having been first duly sworn, was  
 13 examined and testified as follows:

14  
 15 DIRECT EXAMINATION

16 BY MR. LOPEZ:

17 Q Would you please state your name, residence, by  
 18 whom you are employed and in what capacity?

19 A Larry O. Hulsey, Graham, Texas. I'm employed as  
 20 a petroleum engineer for Bettis, Boyle & Stovall who is an  
 21 independent producer in Graham.

22 Q Have you previously testified before the Commission?

23 A No, I haven't.

24 Q Could you give us a brief explanation of your  
 25 educational background and employment experience?

**sid morrish reporting service**  
General Court Reporting Service  
825 Calle Mejia, No. 122, Santa Fe, New Mexico 87501  
Phone (505) 982-9212

1 A I have a B.S. degree from the University of  
2 Oklahoma and have approximately ten years of experience as  
3 a petroleum engineer working for major and independent oil  
4 companies and I am a registered professional engineer.

5 Q Do your employment duties with Bettis, Boyle &  
6 Stovall involve New Mexico operations?

7 A Yes, they do.

8 Q Are you familiar with the application of Bettis,  
9 Boyle & Stovall in Case 5752?

10 A Yes, I am.

11 MR. LOPEZ: Are his qualifications acceptable?

12 MR. NUTTER: Yes, they are.

13 Q (Mr. Lopez continuing.) What does the applicant  
14 in this case seek to obtain?

15 A We are seeking to obtain a capacity allowable for  
16 the V. H. Justis Well No. 2 located in Unit D of Section 20,  
17 Township 25 South, Range 37 East in Lea County, New Mexico.

18 Q And this well is located in the Jalmat Oil Pool?

19 A Yes, it is.

20 Q Turning to Exhibit Number One would you please  
21 identify it and explain what it means?

22 A Exhibit Number One is a plat of the subject area  
23 involved in the Section 20 and in the northwest quarter is  
24 our V. H. Justis Well No. 2. Directly offsetting our well  
25 is an injection well. Directly north and then back to the

1 west is a producer, Well No. 25, and another injection Well 24.

2 Q Now, these injection wells, No. 24 and 26, are part  
3 of a waterflood project, is that true?

4 A Yes, they are.

5 Q And who is the operator of the waterflood?

6 A Reserve Oil Company is the operator of this  
7 waterflood.

8 Q Now, turning to Exhibit Number Two, will you  
9 identify it and explain what it means?

10 A Exhibit Number Two is a sketch of our well, the  
11 way it's completed, where the perforations are in the Seven  
12 Rivers and where our pipe is set.

13 Q And Exhibit Number Three, would you identify it and  
14 explain what it represents?

15 A Yes, sir. Exhibit Number Three is a copy of the  
16 gamma ray neutron log on the V. H. Justis Well No. 2.

17 Q All right, Exhibit Number Four, would you identify  
18 it and explain what it represents? I think you should  
19 identify it and explain it in connection with Exhibit  
20 Number Five, as well.

21 A Exhibit Number Four is a monthly operator's report  
22 prepared by Reserve Oil and Gas that is sent to the Commission  
23 and on January of '75, I have marked on the second page in  
24 yellow what the production was for Well No. 25, and in January  
25 of '75 the actual barrels of oil produced for this well was

**sid morrish reporting service**  
General Court Reporting Service  
825 Calle Mejia, No. 122, Santa Fe, New Mexico 87501  
Phone (505) 982-5212

1 approximately one barrel of oil a day and no barrels of  
2 water a day.

3 Exhibit Number Five for Reserve Oil Company is in  
4 June of '76 and I have also depicted Well No. 25 in yellow  
5 and this shows that the subject well is averaging over a  
6 hundred barrels of oil a day and in excess of fifty barrels  
7 of water a day.

8 Q Now, this increase in the production capacity of  
9 the well, is it in your opinion due to the stimulation of the  
10 waterflood project?

11 A Yes, in my opinion it is.

12 Q Turning to Exhibit Number Six would you explain  
13 what it is?

14 A Exhibit Number Six depicts our V. H. Justis Well No.  
15 2 in a report that we file with the New Mexico Oil Conservation  
16 Commission and I have shown our well in yellow again, whereby  
17 our well is making eight barrels of oil a day in May of '75,  
18 and attached to it is our report in July of '76 where our  
19 well is capable of making eighty barrels of oil a day.

20 Q If I understand you correctly, then this Exhibit  
21 Number Six indicates a similar stimulation affecting your  
22 well as it affected the Reserve Well No. 25?

23 A That is correct.

24 Q Am I also to understand that you feel that if your  
25 application is not granted that it will not be in the interests

**sid morrish reporting service**

General Court Reporting Service  
825 Calle Mejia, No. 122, Santa Fe, New Mexico 87501  
Phone (505) 982-9212



1 of the prevention of waste and the protection of correlative  
2 rights?

3 A. Yes.

4 Q. Were Exhibits One and Two prepared by you or under  
5 your supervision?

6 A. Yes, they were.

7 MR. LOPEZ: And Exhibits Three through Six, I believe  
8 are self-explanatory, the Examiner can take judicial  
9 recognition if he so chooses, since the last three exhibits  
10 are out of the Oil Conservation Commission and the log report  
11 speaks for itself, so at this time I would like to introduce  
12 Exhibits One through Six.

13 MR. NUTTER: Bettis' Exhibits One through Six will  
14 be admitted into evidence.

15 (THEREUPON, Bettis' Exhibits One through  
16 Six were admitted into evidence.)

17

18

CROSS EXAMINATION

19 BY MR. NUTTER:

20 Q. Mr. Hulsey, is it?

21 A. Yes, sir.

22 Q. Mr. Hulsey, in looking at your Exhibit Number Six,  
23 in seeing that the well has gone from eight barrels a day in  
24 1975 to eighty barrels a day in 1976, is this well a flowing  
25 well?

**sid morrish reporting service**  
General Court Reporting Service  
825 Calle Mejia, No. 122, Santa Fe, New Mexico 87501  
Phone (505) 982-9212

**sid morrish reporting service**  
General Court Reporting Service  
825 Calle Mejia, No. 122, Santa Fe, New Mexico 87501  
Phone (505) 982-9212

1 A. No, sir, it is not, it's a pumping well.

2 Q. Has there been any change in the pumping equipment on  
3 the well?

4 A. During the past two months we have had to change  
5 the pumping equipment because of the increased fluid coming  
6 into the wellbore.

7 Q. The well pumping equipment didn't have the capacity?

8 A. Right, it wouldn't pump the well down.

9 Q. Now, if you would have had your new, larger pumping  
10 equipment in the well back here in 1975 would it have made  
11 eighty barrels?

12 A. No, this increase happened about the same time as  
13 our offset operator, it has been just a gradual increase  
14 during the last six months.

15 Q. In other words, the equipment that was installed  
16 in 1975 was adequate to pump the well down?

17 A. Right.

18 Q. Now, I notice also that there has been a rather  
19 dramatic change in the GOR on this well, to what do you  
20 attribute that?

21 A. I would attribute that to the increased influx of  
22 new oil.

23 Q. In other words, that is also a reflection of the  
24 water injection?

25 A. Right.

1 Q Now, do you know how much water they are injecting  
2 in this Well No. 26 to your north?

3 A In their application they specified that they would  
4 inject three hundred and fifty barrels a day in both of those  
5 particular wells.

6 Q But you haven't examined the records of either that  
7 company or the Commission to determine how much water they are  
8 actively injecting?

9 A Not recently, no, I haven't.

10 MR. NUTTER: Mr. Lopez, with your consent we will  
11 take administrative notice of the injection records that  
12 Reserve has filed with the Commission.

13 MR. LOPEZ: That will be fine, Mr. Examiner.

14 Q (Mr. Nutter continuing.) Are there any other  
15 injection wells on this lease, Mr. Hulsey?

16 A Yes, there are. Those were the two main injection  
17 wells that I chose to pick but there are other injection wells  
18 and you can see from Exhibit Number Five, June of '76, and  
19 just from the well status column on the first page, I see  
20 two, three, four, five, six, seven, eight, nine, ten, eleven,  
21 twelve, thirteen -- I see thirteen injection wells. Those  
22 are the closest ones to our particular well.

23 Q Apparently according to your Exhibit Number Five,  
24 the well immediately north of No. 26, this No. 22, is also an  
25 injection well and the well east of that, the No. 23 is an

**sid morrish reporting service**

General Court Reporting Service  
825 Calle Mejia, No. 122, Santa Fe, New Mexico 87501  
Phone (505) 982-9212

1 injection well. No, the one directly north is a producer.

2 A. Right.

3 Q. The one northeast of 26 is an injection well?

4 A. Right.

5 MR. NUTTER: Are there any further questions of  
6 Mr. Hulsey? He may be excused.

7 (THEREUPON, the witness was excused.)

8 MR. NUTTER: Is there anything further, Mr. Lopez?

9 MR. LOPEZ: No, sir.

10 MR. NUTTER: Does anyone have anything they wish to  
11 offer in Case 5752? We will take the case under advisement.

12

13

14

15

16

17

18

19

20

21

22

23

24

25

**sid morrish reporting service**  
General Court Reporting Service  
825 Calle Mejia, No. 122, Santa Fe, New Mexico 87501  
Phone (505) 982-9212

REPORTER'S CERTIFICATE

I, SIDNEY F. MORRISH, a Certified Shorthand Reporter,  
do hereby certify that the foregoing and attached Transcript  
of Hearing before the New Mexico Oil Conservation Commission  
was reported by me, and the same is a true and correct record  
of the said proceedings to the best of my knowledge, skill and  
ability.

  
Sidney F. Morrish, C.S.R.

sid morrish reporting service  
General Court Reporting Service  
825 Calle Mejia, No. 122, Santa Fe, New Mexico 87501  
Phone (505) 982-9212

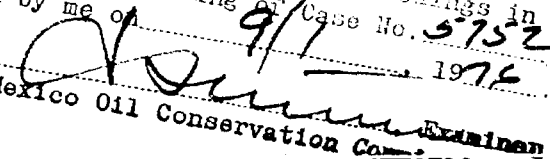
I do hereby certify that the foregoing is  
a complete record of the proceedings in  
the Examiner hearing of Case No. 5752  
heard by me on 9/1/1976  
  
New Mexico Oil Conservation Commission

Other \_\_\_\_\_

BEFORE THE OIL CONSERVATION COMMISSION  
OF THE STATE OF NEW MEXICO

IN THE MATTER OF THE HEARING  
CALLED BY THE OIL CONSERVATION  
COMMISSION OF NEW MEXICO FOR  
THE PURPOSE OF CONSIDERING:

CASE NO. 5752  
Order No. R-5281

APPLICATION OF BETTIS, BOYLE &  
STOVALL FOR A SPECIAL ALLOWABLE,  
LEA COUNTY, NEW MEXICO.

ORDER OF THE COMMISSION

BY THE COMMISSION:

This cause came on for hearing at 9 a.m. on September 1, 1976, at Santa Fe, New Mexico, before Examiner Daniel S. Nutter.

NOW, on this 16th day of September, 1976, the Commission, a quorum being present, having considered the testimony, the record, and the recommendations of the Examiner, and being fully advised in the premises,

FINDS:

(1) That due public notice having been given as required by law, the Commission has jurisdiction of this cause and the subject matter thereof.

(2) That the applicant, Bettis, Boyle & Stovall, is the owner and operator of the V. H. Justis Well No. 2 located in Unit D of Section 20, Township 25 South, Range 37 East, NMPM, Jalmat Pool, Lea County, New Mexico.

(3) That said well is offset to the North by a water injection well in an active waterflood project in said Jalmat Pool.

(4) That said well has received a response to the injection of water into the Seven Rivers formation in the offsetting waterflood project.

(5) That if applicant's said V. H. Justis Well No. 2 is not permitted to produce at capacity, oil may be swept from under said V. H. Justis Lease across lease lines onto other producing leases in the area.

(6) That to prevent waste and protect correlative rights, the NW/4 NW/4 of Section 20, Township 25 South, Range 37 East, NMPM, should be designated a Waterflood Buffer Zone in the

-2-

Case No. 5752  
Order No. R-5281

Jalmat Pool, Lea County, New Mexico and applicant's V. H. Justis Well No. 2 located on said 40-acre tract should be permitted to produce at capacity.

(7) That the subject application should be approved and that monthly buffer zone project reports should be filed with the Commission on Form C-120.

IT IS THEREFORE ORDERED:

(1) That the NW/4 NW/4 of Section 20, Township 25 South, Range 37 East, NMPM, Jalmat Pool, Lea County, New Mexico, is hereby designated a Waterflood Buffer Zone, and the Bettis, Boyle & Stovall V. H. Justis Well No. 2 located thereon is authorized an allowable equal to its ability to produce.

(2) That the applicant herein shall file a Buffer Zone Project report monthly with the Hobbs District Office of the Commission on Commission Form C-120 setting forth thereon production data concerning the above-described well.

(3) That such Buffer Zone Project report shall be filed commencing with the month of assignment to the subject well of allowable in excess of the pool top unit allowable.

(4) That jurisdiction of this cause is retained for the entry of such further orders as the Commission may deem necessary.

DONE at Santa Fe, New Mexico, on the day and year hereinabove designated.

STATE OF NEW MEXICO  
OIL CONSERVATION COMMISSION

PHIL R. LUCERO, Chairman

EMERY C. ARNOLD, Member

JOE D. RAMEY, Member & Secretary

S E A L

dr/



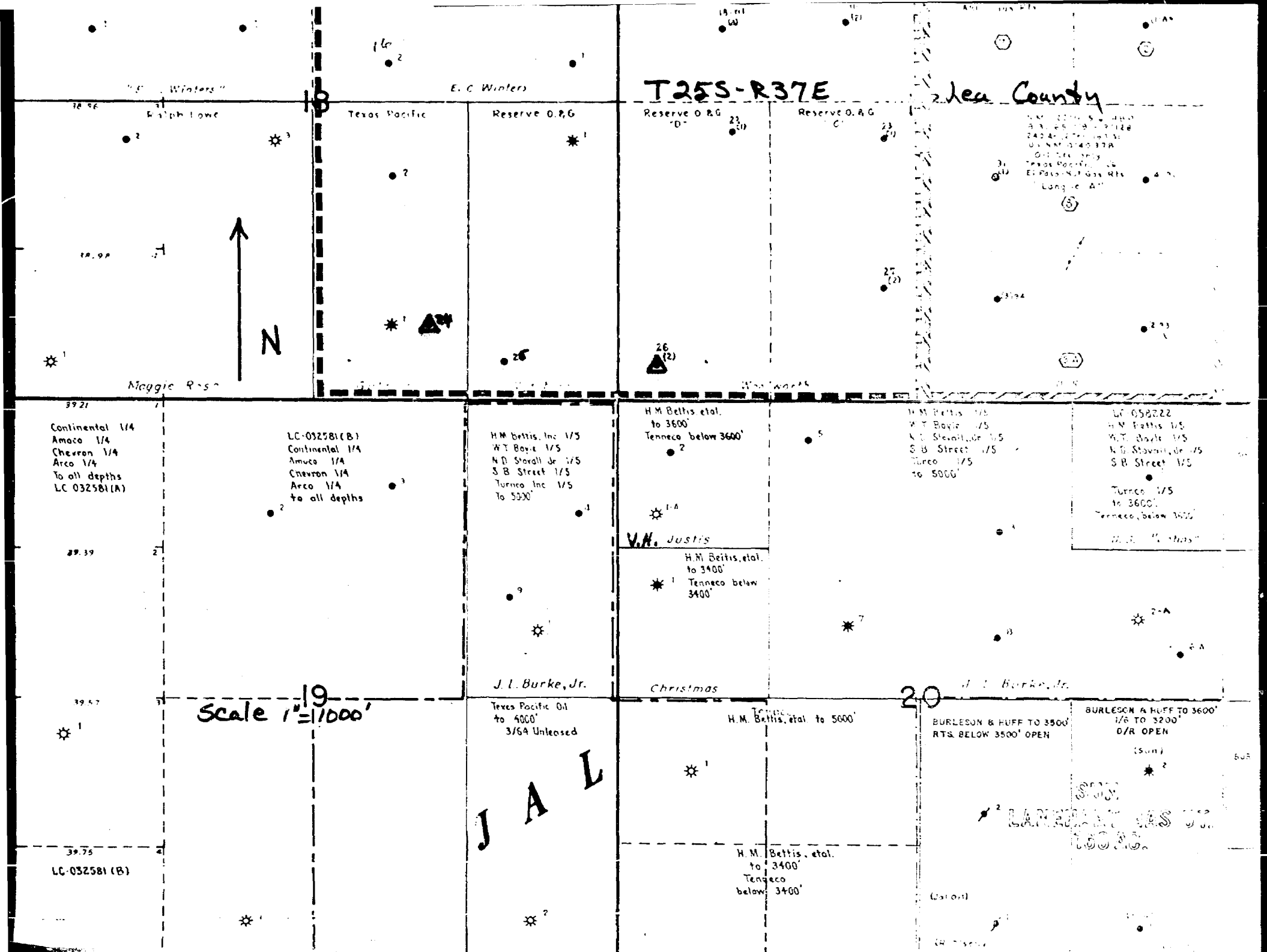

T25S-R37E

Lea County

Winters

E. C. Winters

Ralph Lowe

Texas Pacific

Reserve O. & G.

Reserve O. & G.

Reserve O. & G.

W. H. H. S. & Co.  
P.O. Box 128  
El Paso, Texas  
Oil & Gas  
Texas Pacific  
El Paso & Gulf  
Longhorn

Maggie Ross

H. M. Bettis et al.  
to 3600'  
Tenneco below 3600'

H. M. Bettis 1/5  
W. T. Boyle 1/5  
N. D. Stovall Jr. 1/5  
S. B. Street 1/5  
Turnco 1/5  
to 5000'

LC 032522  
H. M. Bettis 1/5  
W. T. Boyle 1/5  
N. D. Stovall Jr. 1/5  
S. B. Street 1/5  
Turnco 1/5  
to 3600'  
Tenneco below 3600'  
H. M. Bettis

H. M. Bettis, Inc. 1/5  
W. T. Boyle 1/5  
N. D. Stovall Jr. 1/5  
S. B. Street 1/5  
Turnco, Inc. 1/5  
to 5000'

V. H. Justice  
H. M. Bettis, et al.  
to 3400'  
Tenneco below 3400'

J. L. Burke, Jr.

Christmas

J. L. Burke, Jr.

Texas Pacific Oil  
to 4000'  
3/64 Unleased

H. M. Bettis, et al. to 5000'

BURLESON & HUFF TO 3500'  
RTS. BELOW 3500' OPEN

BURLESON & HUFF TO 3600'  
1/8 TO 3200'  
D/R OPEN

Scale 1"=1000'

J A L

LANE & CO. OIL CO.

Continental 1/4  
Amoco 1/4  
Chevron 1/4  
Arco 1/4  
To all depths  
LC 032581(A)

LC-032581(B)  
Continental 1/4  
Amoco 1/4  
Chevron 1/4  
Arco 1/4  
to all depths

LC-032581(B)

D.H. Justice #2  
370' FNL, 420' FWL,  
Sec. 20-25S-37E  
Lea Co. New Mexico

8-7-26  
Elevation: -308'

Completed: 12-10-53

SEVEN RIVERS

Perforations:

3076'-96'

Open Hole: 3256'  
to  
3337'

✓ ← 9-5/8" 28# csg. set  
@ 317' w/160SX(circ)

✓ ← 7" 20# csg. set @ 3256'  
w/275SX (Formation pkr.  
shoe)

T.D. - 3335' →

BEFORE EXAMINER NUTTER  
OIL CONSERVATION COMMISSION  
Re His, et al EXHIBIT NO. 2  
CASE NO. 5752

Recorded By  
West Texas Electrical Log Service  
1000 S. 10th St.  
Fort Worth, Texas

REFERENCE N° A 2775 -D

| SHELLMILNER WELL SURVEYING CORPORATION  |   |
|---|---|
| WELL LOG  |   |
| COUNTY <b>Lea</b>   | COMPANY <b>LEONARD OIL CO.</b>                                      |
| FIELD <b>Langlie-Mattix</b>   | WELL <b>JUSTIS # 2</b>  |
| LOCATION <b>SEC. 20-255-31E</b>   | LOCATION OF WELL<br>370' E. N.L.<br>470' E. N.L.<br>Sec. 20-255-31E |
| COUNTY <b>LEA</b>   | GRN   |
| STATE <b>NEW MEXICO</b>   | Elevation D.F. 3084<br>K.B.<br>or O.I.                              |
| FILING No.  |   |
| RUN No. <b>1</b><br>Date <b>12-6-53</b><br>First Reading <b>3334</b><br>Last Reading <b>100</b><br>Feet Measured <b>3234</b><br>Csg. Schlum. <b>321</b><br>Csg. Driller <b>317</b><br>Depth Reached <b>3335</b><br>Bottom Driller <b>3337</b><br>Depth Datum <b>KB 11' Apy. GL</b><br>Mud Mat. <b>Salt Gr</b><br>Density <b>10.7</b><br>Viscosity <b>38</b><br>Resist. <b>08650</b><br>Res. BHI <b>05694</b><br>pH <b>6</b><br>Wtr. Loss <b>6 CC 30 min</b><br>Max. Temp. <b>94</b><br>Bit Size <b>8 3/4" - 3335</b><br><b>9 5/8" Csg. 321 in 121" hole</b><br>Opr. Rig Time <b>2 Hrs.</b><br>Truck No. <b>1760-Hobbs</b><br>Recorded By <b>Kellenberger</b><br>Witness By <b>Quans</b> |   |
| REMARKS   |   |
| COMBINATION<br>GAMMA RAY      NEUTRON<br>Radioactivity Increases →<br>Casing Collars Recorded<br>12' too deep, but they are<br>shown at corrected depth<br>in depth track.<br>SCALE OF NEUTRON LOG<br>NORMALIZED COUNTS PER SEC.<br>Csg. - 5180 230 cps - 100 - 400<br>Cased hole - Sensitivity 280 from 100 to 400<br>Uncased hole - Sensitivity 400 from 100 to 400<br>Sensitivity Change is noted on log<br>GAMMA RAY SCALE<br>Micrograms Radium Eq./Ton<br>of formation   |   |

BEFORE TO THE NUTTER  
OIL COMPANY OF COMMISSION  
R.H.'s RECORD NO. 3  
CASE NO. 5752

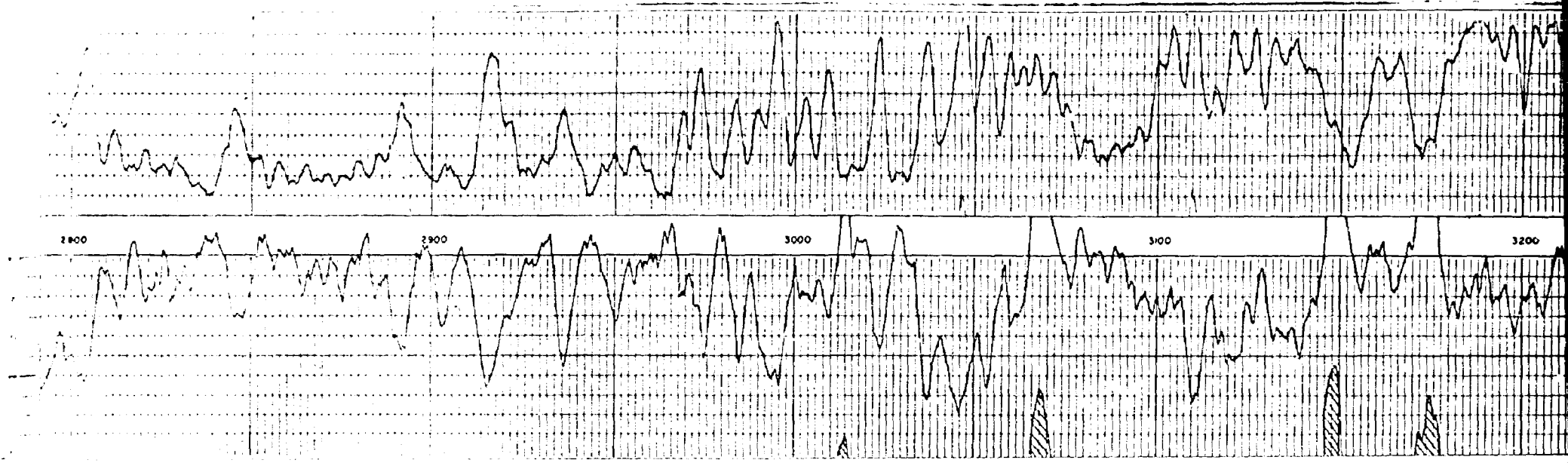

BEFORE EXAMINER NOTED  
OIL CORRELATION & LOCATION  
CASE NO. \_\_\_\_\_  
DATE & TIME \_\_\_\_\_

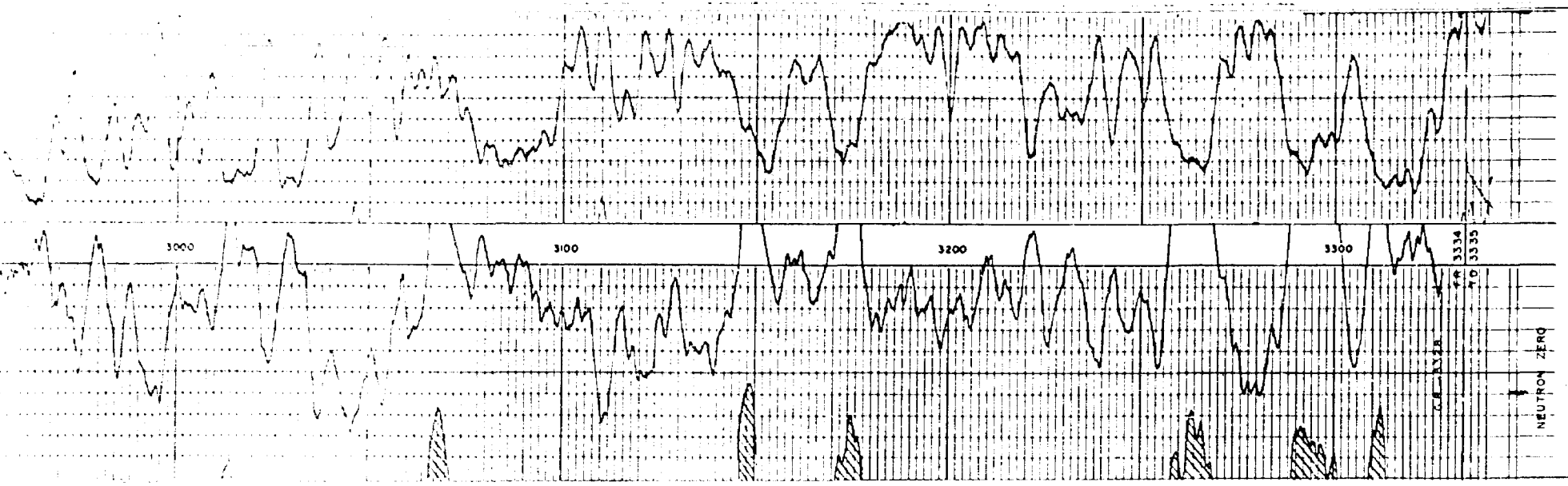

LEONARD OIL CO.  
JUSTIS # 2

BEFORE EXAMINED MUTTER  
OIL CORPORATION OF AMERICA  
EXAMINER NO. \_\_\_\_\_  
CASE NO. \_\_\_\_\_

# NEW MEXICO OIL CONSERVATION COMMISSION

BOX 871 SANTA FE, NEW MEXICO

## OPERATOR'S MONTHLY REPORT

STATEWIDE FORM C-112 REV. 10-1-61  
SUBMIT ORIGINAL TO OCC SANTA FE  
ONE COPY TO OCC DIST. OFFICE  
ONE COPY TO TRANSPORTER

Operator: Reserve Oil and Gas Company

First Savings Bldg., Midland, Texas FOR MONTH OF January 1975 1-12

| WELL NO.   | UNIT | SEC. | TWP. | RND. | WELL STATUS | TOTAL LIQUIDS PRODUCED |                         |                           | GAS PRODUCED MCF | DAYS PROD. | DISPOSITION OF GAS |               |      |        |       | DISPOSITION OF OIL |                           |                         |       |         |              |                          |     |  |
|--|------|------|------|------|-------------|------------------------|-------------------------|---------------------------|------------------|------------|--------------------|---------------|------|--------|-------|--------------------|---------------------------|-------------------------|-------|---------|--------------|--------------------------|-----|--|
|  |      |      |      |      |             | MONTHLY OIL ALLOWABLE  | ACTUAL BARRELS PRODUCED | BARRELS OF WATER PRODUCED |                  |            | VENTED             | USED ON LEASE | SOLD | PURCH. | OTHER | C O D E            | OIL ON HAND BEG. OF MONTH | BARRELS TO TRANS-PORTER | OTHER | C O D E | TRANS-PORTER | OIL ON HAND END OF MONTH |     |  |
| POOL NAME (UNDERLINE)  |      |      |      |      |             |                        |                         |                           |                  |            |                    |               |      |        |       |                    |                           |                         |       |         |              |                          |     |  |
| LEASE NAME AND STATE LAND LEASE NUMBER OR FEDERAL LEASE NUMBER |      |      |      |      |             |                        |                         |                           |                  |            |                    |               |      |        |       |                    |                           |                         |       |         |              |                          |     |  |
| <u>JALMAT OIL POOL</u>   |      |      |      |      |             |                        |                         |                           |                  |            |                    |               |      |        |       |                    |                           |                         |       |         |              |                          |     |  |
| <u>South Langlie Jal Unit (Waterflood Project)</u>             |      |      |      |      |             |                        |                         |                           |                  |            |                    |               |      |        |       |                    |                           |                         |       |         |              |                          |     |  |
| 1  | G    | 7    | 25   | 37   | I           | -                      |                         |                           |                  | 31         |                    |               |      |        |       |                    |                           |                         |       |         |              |                          |     |  |
| 2  | K    | 7    | 25   | 37   | I           | -                      |                         |                           |                  | 31         |                    |               |      |        |       |                    |                           |                         |       |         |              |                          |     |  |
| 3  | J    | 7    | 25   | 37   | P           | 1550                   | 1766                    | 2155                      | 1595             | 31         |                    | 21            | 1574 | EPG    |       |                    |                           |                         |       |         |              |                          | SHL |  |
| 4  | I    | 7    | 25   | 37   | I           | -                      |                         |                           |                  | 31         |                    |               |      |        |       |                    |                           |                         |       |         |              |                          |     |  |
| 5  | L    | 8    | 25   | 37   | S           | 93                     |                         |                           |                  |            |                    |               |      | EPG    |       |                    |                           |                         |       |         |              |                          | SHL |  |
| 6  | K    | 8    | 25   | 37   | P           | 93                     | 30                      | 0                         | 26               | 31         |                    | 1             | 25   | EPG    |       |                    |                           |                         |       |         |              |                          | SHL |  |
| 7  | N    | 7    | 25   | 37   | P           | 2170                   | 1137                    | 4010                      | 827              | 24         |                    | 11            | 816  | EPG    |       |                    |                           |                         |       |         |              |                          | SHL |  |
| 8  | O    | 7    | 25   | 37   | I           | -                      |                         |                           |                  | 31         |                    |               |      |        |       |                    |                           |                         |       |         |              |                          |     |  |
| 9  | P    | 7    | 25   | 37   | P           | 9300                   | 7781                    | 3681                      | 4043             | 31         |                    | 53            | 3970 | EPG    |       |                    |                           |                         |       |         |              |                          | SHL |  |
| 10   | M    | 8    | 25   | 37   | I           | -                      |                         |                           |                  | 31         |                    |               |      |        |       |                    |                           |                         |       |         |              |                          |     |  |
| 11   | N    | 8    | 25   | 37   | P           | 186                    | 120                     | 0                         | 200              | 31         |                    | 3             | 197  | EPG    |       |                    |                           |                         |       |         |              |                          | SHL |  |
| 12   | B    | 18   | 25   | 37   | P           | 4960                   | 3112                    | 1736                      | 2587             | 31         |                    | 34            | 2553 | EPG    |       |                    |                           |                         |       |         |              |                          | SHL |  |
| 13   | A    | 18   | 25   | 37   | I           | -                      |                         |                           |                  | 31         |                    |               |      |        |       |                    |                           |                         |       |         |              |                          |     |  |
| 14   | D    | 17   | 25   | 37   | P           | 930                    | 299                     | 4190                      | 155              | 31         |                    | 2             | 153  | EPG    |       |                    |                           |                         |       |         |              |                          | SHL |  |
| 15   | C    | 17   | 25   | 37   | I           | -                      |                         |                           |                  | 31         |                    |               |      |        |       |                    |                           |                         |       |         |              |                          |     |  |

STATUS CODE  
F - FLOWING  
P - PUMPING  
G - GAS LIFT  
L - LOST (NOF ESTIMATED)  
A - TEMP. ABANDONED  
I - INJECTION

"OTHER" GAS DISPOSITION CODE  
L - USED OFF LEASE  
D - USED FOR DRILLING  
G - GAS LIFT  
L - LOST (NOF ESTIMATED)  
E - EXPLANATION ATTACHED  
R - REPRESSURING OR PRESSURE MAINTENANCE  
(DESTINATION MUST BE SHOWN ON FORM C-111)

"OTHER" OIL DISPOSITION CODE  
C - CIRCULATING OIL  
L - LOST  
S - SEDIMENTATION (BS&M)  
E - EXPLANATION ATTACHED

I HEREBY CERTIFY THAT THE INFORMATION GIVEN IS TRUE AND COMPLETE TO THE BEST OF MY KNOWLEDGE.

(SIGNATURE)  
District Clerk

(POSITION)

2-21-75  
(DATE)

STATE OF FORM C-115 REV. 10-1-84  
SUBMIT: ORIGINAL TO OCC SANTA FE  
ONE COPY TO OCC DIST. OFFICE  
ONE COPY TO TRANSPORTER

(Address) First Savings Bldg., Midland, Texas FOR MONTH OF \_\_\_\_\_

2. FOR MONTH OF January 1975 pgs. 2, 12

(POSITION)

## NEW MEXICO OIL CONSERVATION COMMISSION

BOX 871 SANTA FE, NEW MEXICO

## OPERATOR'S MONTHLY REPORT

STATEWIDE FORM C-113 REV. 10-1-69  
SUBMIT ORIGINAL TO OCC SANTA FE  
ONE COPY TO OCC DIST. OFFICE  
ONE COPY TO TRANSPORTERCompany or  
Operator

Reserve Oil and Gas Company

(Address)

First Savings Bldg., Midland, Texas

FOR MONTH OF

June 1976 Page 1 of 13

| WELL NO.   | UNIT | SEC. | TWP. | RNG. | WELL STATUS | TOTAL LIQUIDS PRODUCED |                         |                           | GAS PRODUCED MCF | DAYS PROD. | DISPOSITION OF GAS |               |      |        |       | C O D E | DISPOSITION OF OIL        |                         |       |  |  | C O D E | TRANS-PORTER | OIL ON HAND END OF MONTH |     |  |  |
|--|------|------|------|------|-------------|------------------------|-------------------------|---------------------------|------------------|------------|--------------------|---------------|------|--------|-------|---------|---------------------------|-------------------------|-------|--|--|---------|--------------|--------------------------|-----|--|--|
|  |      |      |      |      |             | MONTHLY OIL ALLOWABLE  | ACTUAL BARRELS PRODUCED | BARRELS OF WATER PRODUCED |                  |            | VENTED             | USED ON LEASE | SOLD | PURCH. | OTHER |         | OIL ON HAND BEG. OF MONTH | BARRELS TO TRANS-PORTER | OTHER |  |  |         |              |                          |     |  |  |
| LEASE NAME AND STATE LAND LEASE NUMBER OR FEDERAL LEASE NUMBER |      |      |      |      |             |                        |                         |                           |                  |            |                    |               |      |        |       |         |                           |                         |       |  |  |         |              |                          |     |  |  |
| JALMAT OIL POOL  |      |      |      |      |             |                        |                         |                           |                  |            |                    |               |      |        |       |         |                           |                         |       |  |  |         |              |                          |     |  |  |
| South Langlie Jal Unit (Waterflood Project)                    |      |      |      |      |             |                        |                         |                           |                  |            |                    |               |      |        |       |         |                           |                         |       |  |  |         |              |                          |     |  |  |
| 1  | G    | 7    | 25   | 37   | I           |                        |                         |                           |                  | 30.0       |                    |               |      |        |       |         |                           |                         |       |  |  |         |              |                          |     |  |  |
| 2  | K    | 7    | 25   | 37   | I           |                        |                         |                           |                  | 30.0       |                    |               |      |        |       |         |                           |                         |       |  |  |         |              |                          |     |  |  |
| 3  | J    | 7    | 25   | 37   | P           | 1500                   | 1109                    | 5053                      | 1003             | 30.0       |                    | 10            | 993  | EPG    |       |         |                           |                         |       |  |  |         |              |                          | SHL |  |  |
| 4  | I    | 7    | 25   | 37   | I           |                        |                         |                           |                  | 30.0       |                    |               |      |        |       |         |                           |                         |       |  |  |         |              |                          |     |  |  |
| 5  | L    | 8    | 25   | 37   | S           | 90                     | —                       |                           |                  | —          |                    |               |      | EPG    |       |         |                           |                         |       |  |  |         |              |                          | SHL |  |  |
| 6  | K    | 8    | 25   | 37   | P           | 90                     | 770                     | 1602                      | 1392             | 30.0       |                    | 14            | 1378 | EPG    |       |         |                           |                         |       |  |  |         |              |                          | SHL |  |  |
| 7  | N    | 7    | 25   | 37   | P           | 2,100                  | 401                     | 3697                      | 1132             | 30.0       |                    | 11            | 1121 | EPG    |       |         |                           |                         |       |  |  |         |              |                          | SHL |  |  |
| 8  | O    | 7    | 25   | 37   | I           |                        |                         |                           |                  | 30.0       |                    |               |      |        |       |         |                           |                         |       |  |  |         |              |                          |     |  |  |
| 9  | P    | 7    | 25   | 37   | P           | 9000                   | 2804                    | 10599                     | 1267             | 30.0       |                    | 12            | 1255 | EPG    |       |         |                           |                         |       |  |  |         |              |                          | SHL |  |  |
| 10   | M    | 8    | 25   | 37   | I           |                        |                         |                           |                  | 30.0       |                    |               |      |        |       |         |                           |                         |       |  |  |         |              |                          |     |  |  |
| 11   | N    | 8    | 25   | 37   | P           | 180                    | 401                     | —                         | 1087             | 30.0       |                    | 11            | 1076 | EPG    |       |         |                           |                         |       |  |  |         |              |                          | SHL |  |  |
| 12   | B    | 18   | 25   | 37   | P           | 4800                   | 924                     | 4252                      | 1983             | 30.0       |                    | 19            | 1964 | EPG    |       |         |                           |                         |       |  |  |         |              |                          | SHL |  |  |
| 13   | A    | 18   | 25   | 37   | I           |                        |                         |                           |                  | 30.0       |                    |               |      |        |       |         |                           |                         |       |  |  |         |              |                          |     |  |  |
| 14   | D    | 17   | 25   | 37   | P           | 900                    | 370                     | 3882                      | 377              | 30.0       |                    | 4             | 373  | EPG    |       |         |                           |                         |       |  |  |         |              |                          | SHL |  |  |
| 15   | C    | 17   | 25   | 37   | I           |                        |                         |                           |                  | 30.0       |                    |               |      |        |       |         |                           |                         |       |  |  |         |              |                          |     |  |  |

## STATUS CODE

F-----FLOWING  
P-----PUMPING  
G-----GAS LIFT  
S-----SHUT IN  
T-----TEMP ABANDONED  
I-----INJECTION

## "OTHER" GAS DISPOSITION CODE

X-----USED OFF LEASE  
D-----USED FOR DRILLING } (DESTINATION MUST BE SHOWN ON FORM C-111)  
G-----GAS LIFT  
L-----LOST (MCF ESTIMATED)  
E-----EXPLANATION ATTACHED  
=-----REPRESSURING OR PRESSURE MAINTENANCE

## "OTHER" OIL DISPOSITION CODE

C-----CIRCULATING OIL  
L-----LOST  
S-----SEDIMENTATION (B324W)  
E-----EXPLANATION ATTACHED

I HEREBY CERTIFY THAT THE INFORMATION GIVEN IS TRUE AND COMPLETE TO THE BEST OF MY KNOWLEDGE.

(SIGNATURE)

District Clerk

(POSITION)

(DATE)



## NEW MEXICO OIL CONSERVATION COMMISSION

BOX 871 SANTA FE, NEW MEXICO

## OPERATOR'S MONTHLY REPORT

STATEBIDE FORM C-115 REV. 10-1-61  
SUBMIT: ORIGINAL TO OCC SANTA FE  
ONE COPY TO OCC DIST. OFFICE  
ONE COPY TO TRANSPORTER

Reserve Oil and Gas Company

First Savings Bldg., Midland, Texas

FOR MONTH OF

June 1976 Page 2 of 13

| WELL NO. UNIT SEC. TWP. RMO.                                   | WELL STATUS | TOTAL LIQUIDS PRODUCED |                         |                           | GAS PRODUCED MCF | DATE PROD. | DISPOSITION OF GAS |               |       |        |       | DISPOSITION OF OIL |                           |                         |       |         |              |                          |
|--|-------------|------------------------|-------------------------|---------------------------|------------------|------------|--------------------|---------------|-------|--------|-------|--------------------|---------------------------|-------------------------|-------|---------|--------------|--------------------------|
|  |             | MONTHLY OIL ALLOWABLE  | ACTUAL BARRELS PRODUCED | BARRELS OF WATER PRODUCED |                  |            | VENTED             | USED ON LEASE | SOLD  | PURCH. | OTHER | C O D E            | OIL ON HAND BEG. OF MONTH | BARRELS TO TRANS-PORTER | OTHER | C O D E | TRANS-PORTER | OIL ON HAND END OF MONTH |
| LEASE NAME AND STATE LAND LEASE NUMBER OR FEDERAL LEASE NUMBER |             |                        |                         |                           |                  |            |                    |               |       |        |       |                    |                           |                         |       |         |              |                          |
| JALMAT OIL POOL  |             |                        |                         |                           |                  |            |                    |               |       |        |       |                    |                           |                         |       |         |              |                          |
| South Langlie Jal Unit   |             |                        |                         |                           |                  |            |                    |               |       |        |       |                    |                           |                         |       |         |              |                          |
| 16 G 18 25 37  | I           |                        |                         |                           |                  | 30.0       |                    |               |       |        |       |                    |                           |                         |       |         |              |                          |
| 17 H 18 25 37  | P           | 2550                   | 1664                    | 2372                      | 940              | 30.0       |                    | 9             | 931   | EPG    |       |                    |                           |                         |       |         | SHL          |                          |
| 18 E 17 25 37  | F           |                        |                         |                           |                  | 30.0       |                    |               |       |        |       |                    |                           |                         |       |         |              |                          |
| 19 F 17 25 37  | P           | 180                    | 246                     | 2126                      | 223              | 30.0       |                    | 2             | 221   | EPG    |       |                    |                           |                         |       |         | SHL          |                          |
| 20 J 18 25 37  | P           | 60                     | 462                     | —                         | 1201             | 30.0       |                    | 12            | 1189  | EPG    |       |                    |                           |                         |       |         | SHL          |                          |
| 21 I 18 25 37  | I           |                        |                         |                           |                  | 30.0       |                    |               |       |        |       |                    |                           |                         |       |         |              |                          |
| 22 L 17 25 37  | P           | 600                    | 830                     | 583                       | 842              | 30.0       |                    | 8             | 834   | EPG    |       |                    |                           |                         |       |         | SHL          |                          |
| 23 K 17 25 37  | I           |                        |                         |                           |                  | 30.0       |                    |               |       |        |       |                    |                           |                         |       |         |              |                          |
| 24 O 18 25 37  | I           |                        |                         |                           |                  | 30.0       |                    |               |       |        |       |                    |                           |                         |       |         |              |                          |
| 25 P 18 25 37  | P           | 180                    | 3235                    | 1602                      | 2556             | 30.0       |                    | 25            | 2531  | EPG    |       |                    |                           |                         |       |         | SHL          |                          |
| 26 M 17 25 37  | I           |                        |                         |                           |                  | 30.0       |                    |               |       |        |       |                    |                           |                         |       |         |              |                          |
| 27 N 17 25 37  | P           | 360                    | 246                     | —                         | 583              | 30.0       |                    | 6             | 577   | EPG    |       |                    |                           |                         |       |         | SHL          |                          |
|  |             | 22590                  | 13462                   | 35768                     | 14586            |            |                    | 143           | 14443 | EPG    |       |                    | 248                       | 13094                   |       |         | SHL          | 616                      |

## STATUS CODE

F --- FLOWING  
 P --- PUMPING  
 G --- GAS LIFT  
 S --- SURFACE  
 T --- TEMP. ABANDONED  
 I --- INJECTION

## "OTHER" GAS DISPOSITION CODE

X --- USED OFF LEASE  
 D --- USED FOR DRILLING  
 G --- GAS LIFT  
 L --- LOST (MCF ESTIMATED)  
 E --- EXPLANATION ATTACHED  
 R --- REPRESSURING OR PRESSURE MAINTENANCE

## "OTHER" OIL DISPOSITION CODE

C --- CIRCULATING OIL  
 L --- LOST  
 S --- SEQUESTRATION (BS&W)  
 E --- EXPLANATION ATTACHED

I HEREBY CERTIFY THAT THE INFORMATION GIVEN IS TRUE AND COMPLETE TO THE BEST OF MY KNOWLEDGE.

 (SIGNATURE)  
 District Clerk

(POSITION)

 7-23-76  
 (DATE)

*9001 Special  
4-28-75 67075*

NEW MEXICO OIL CONSERVATION COMMISSION  
GAS-OIL RATIO TESTS

*9001-26-250*

Leaseholder: Bettis, Boyle & Stovall  
Address: Box 1168, Graham, Texas 76046  
Operator: Jalmat Yates Seven Rivers Tansill  
Lea  
TYPE OF TEST: (X) XX

| LEASE NAME      | WELL NO. | LOCATION |    |     |     | DATE OF TEST | CHOKE SIZE | T.B.G. PRESS. | DAILY ALLOWABLE | INSTRUMENT | PROD. DURING TEST |           |          |          | GAS-OIL RATIO (CU FT. GAS / CU BBL. OIL) |
|-----------------|----------|----------|----|-----|-----|--------------|------------|---------------|-----------------|------------|-------------------|-----------|----------|----------|--|
|                 |          | U        | S  | T   | R   |              |            |               |                 |            | WATER BBL.        | GRAV. OIL | OIL BBL. | GAS MCF. |  |
| Johns-Federal   | 1        | A        | 20 | 25S | 37E | 4-30-75      | P 2"       | 20#           | 15              | 24         | --                | 12        | 26       | 475      | 2885 3750                                |
|                 | 2        | H        | 20 | "   | "   | 4-28-75      | P 2"       | 20#           | 3               | "          | --                |           | 2        | TSTM     | ----                                     |
|                 | 6        | H        | 20 | "   | "   | 4-28-75      | P 2"       | 20#           | 3               | "          | --                |           | 3        | TSTM     | ----                                     |
| B.M. Justis "A" | 3        | D        | 20 | "   | "   | 4-28-75      | P 2"       | 18#           | 3               | "          | 1                 |           | 4        | 30       | 7500                                     |
|                 | ①        | H        | 19 | "   | "   | 4-28-75      | F 2"       | 25#           | "               | "          | ---               |           | 1        | 40       | 40,000                                   |
|                 | 4        | A        | 19 | "   | "   | 4-29-75      | P 2"       | 15#           | 4               | "          | ---               |           | 5        | 50       | 10,000                                   |
|                 | ⑦        | F        | 20 | "   | "   | 4-29-75      | F 2"       | 25#           | "               | "          | ---               |           | 2        | 200      | 40,000                                   |
|                 | 8        | G        | 20 | "   | "   | 4-29-75      | P 2"       | 20#           | 5               | "          | ---               |           | 6        | 50       | 8,333                                    |
| B.M. Justis "B" | 9        | H        | 19 | "   | "   |              | S          |               |                 |            |                   |           |          |          |  |
|                 | 5        | C        | 20 | "   | "   | 4-30-75      | P 2"       | 18#           | 6               | "          | ---               |           | 7        | 25       | 3,571                                    |
| V.H. Justis     | 2        | D        | 20 | "   | "   | 5-1-75       | P 2"       | 20#           | 8               | "          | ---               |           | 8        | 40       | 5,000                                    |
|                 | 1        | G        | 21 | "   | "   | 4-27-75      | F 10/64    | 25#           | 3               | "          | ---               |           | 3        | 30       | 10,000                                   |
| Lanehart        | 2        | F        | 21 | "   | "   | 4-27-75      | P 2"       | 15#           | 10              | "          | ---               |           | 10       | 75       | 7,500                                    |
|                 | 3        | C        | 21 | "   | "   | 4-27-75      | P 2"       | 20#           | 6               | "          | ---               |           | 8        | 35       | 4,375                                    |
|                 | ④        | B        | 21 | "   | "   | 4-27-75      | F 11/64    | 15#           | 2               | "          | ---               |           | 2        | 25       | 12,500                                   |
| Christmas       | ⑤        | G        | 21 | "   | "   | 4-27-75      | F 2"       | 30#           |                 | "          | ---               |           | 7        | 260      | 37,142                                   |
|                 | 1        | E        | 20 | "   | "   |              | S          |               |                 |            |                   |           |          |          |  |
| State O         | 1        | A        | 16 | "   | "   | 5-1-75       | F 32.64    | 25#           | 3               | "          | ---               |           | 3        | 50       | 16,667                                   |
|                 | ①        | L        | 20 | "   | "   | 5-2-75       | F 2"       | 30#           |                 | "          | ---               |           | 2        | 75       | 37,500                                   |
| Yates           | ⑧        | M        | 14 | 26S | "   | 5-1-75       | F 2"       | 30#           |                 | "          | ---               |           | 4        | 150      | 37,500                                   |
| Leonard-Federal |          |          |    |     |     |              |            |               |                 |            |                   |           |          |          |  |

1. No well shall be assigned an allowable greater than that determined by the official test.

2. In the event of a gas-oil ratio test, the well shall be tested at a pressure not exceeding the top unit allowable for the pool in which well is located. The operator shall be allowed to take advantage of this 25 percent tolerance in order that well can be assigned increased allowables when authorized by the Commission.

3. Gas volumes must be reported in MCF measured at a pressure base of 15.025 psia and a temperature of 60° F. Specific gravity base will be 0.60.

4. Report casing pressure in lieu of tubing pressure for any well producing through casing.

5. Mail original and one copy of this report to the district office of the New Mexico Oil Conservation Commission in accordance with Rule 301 and appropriate pool rules.

I hereby certify that the above information is true and complete to the best of my knowledge and belief.

Signature: Larry O. Hulsey, Petro. Eng.  
Date: May 30, 1975

NEW MEXICO OIL CONSERVATION COMMISSION  
GAS-OIL RATIO TESTS

C-116  
Revised 1-1-65

|  |  |  |  |   |  |                                     |  |                                  |  |  |  |  |  |
|--|--|--|--|---|--|-------------------------------------|--|----------------------------------|--|--|--|--|--|
| Operator<br><b>Bettis, Boyle and Stovall</b>   |  | Pool<br><b>Jalmat Yates Seven Rivers Tansill</b> |  |   |  |                                     |  | County<br><b>Lea</b>             |  |  |  |  |  |
| Address<br><b>Box 1168 Graham, Texas 76046</b> |  | TYPE OF TEST - (X)                               |  | Scheduled <input checked="" type="checkbox"/> |  | Completion <input type="checkbox"/> |  | Special <input type="checkbox"/> |  |  |  |  |  |

| LEASE NAME                                       | WELL NO. | LOCATION |    |     |     | DATE OF TEST | STATUS | CHOKE SIZE | T.B.G. PRESS. | DAILY ALLOWABLE | LENGTH OF TEST HOURS | PROD. DURING TEST |           |           |            | GAS - OIL RATIO CU.FT/BBL |
|--|----------|----------|----|-----|-----|--------------|--------|------------|---------------|-----------------|----------------------|-------------------|-----------|-----------|------------|---------------------------|
|  |          | U        | S  | T   | R   |              |        |            |               |                 |                      | WATER BBLs.       | GRAV. OIL | OIL BBLs. | GAS M.C.F. |                           |
| Johns Federal<br>B.M. Justice "A"                | 1        | A        | 20 | 25S | 37E | 7-22-76      | P      | 2"         | 20#           | 26              | 24                   | ---               |           | 15        | 50         | 3333                      |
|  | 2        | H        | 20 | 25S | 37E | 7-22-76      | P      | 2"         | 20#           | 1               | 24                   | ---               |           | 5         | TSTM       | ----                      |
|  | 6        | H        | 20 | 25S | 37E | 7-22-76      | P      | 2"         | 20#           | 1               | 24                   | ---               |           | 6         | TSTM       | ----                      |
| B.M. Justice "B"                                 | 3        | B        | 20 | 25S | 37E | 7-22-76      | P      | 2"         | 18#           | 4               | 24                   | 1                 |           | 4         | 27         | 6750                      |
|  | 1        | H        | 19 | 25S | 37E | 7-22-76      | F      | 2"         | 25#           |                 | 24                   | ---               |           | 1         | 9          | 9000                      |
|  | 4        | A        | 19 | 25S | 37E | 7-22-76      | P      | 2"         | 15#           | 25              | 24                   | ---               |           | 20        | 50         | 2500                      |
|  | 7        | F        | 20 | 25S | 37E | 7-22-76      | F      | 2"         | 25#           | 2               | 24                   | ---               |           | 2         | 126        | 63000                     |
| B.M. Justice "C"<br>V.H. Justice<br>Lanehart     | 8        | G        | 20 | 25S | 37E | 7-22-76      | P      | 2"         | 20#           | 8               | 24                   | ---               |           | 8         | 122        | 15250                     |
|  | 9        | H        | 19 | 25S | 37E |              | S      |            |               |                 |                      |                   |           |           |            |                           |
|  | 5        | C        | 20 | 25S | 37E | 7-22-76      | P      | 2"         | 18#           | 20              | 24                   | ---               |           | 15        | 25         | 1667                      |
|  | 2        | D        | 20 | 25S | 37E | 7-22-76      | P      | 2"         | 20#           | 80              | 24                   | ---               |           | 80        | 75         | 938                       |
| Christmas<br>State O<br>Bates<br>Leonard Federal | 1        | G        | 21 | 25S | 37E | 7-22-76      | F      | 2"         | 25#           | 3               | 24                   | ---               |           | 2         | 20         | 10000                     |
|  | 2        | F        | 21 | 25S | 37E | 7-22-76      | P      | 2"         | 15#           | 10              | 24                   | ---               |           | 10        | 36         | 3600                      |
|  | 3        | C        | 21 | 25S | 37E | 7-22-76      | P      | 2"         | 20#           | 10              | 24                   | ---               |           | 10        | 20         | 10000                     |
|  | 4        | B        | 21 | 25S | 37E | 7-22-76      | F      | 2"         | 15#           | 2               | 24                   | ---               |           | 3         | 12         | 4000                      |
|  | 5        | G        | 21 | 25S | 37E | 7-22-76      | F      | 2"         | 30#           | 15              | 24                   | ---               |           | 15        | 470        | 31333                     |
|  | 1        | E        | 20 | 25S | 37E |              | S      |            |               |                 |                      |                   |           |           |            |                           |
|  | 1        | A        | 16 | 25S | 37E | 7-22-76      | P      | 2"         | 25#           | 6               | 24                   | ---               |           | 5         | 50         | 10000                     |
|  | 1        | L        | 20 | 25S | 37E | 7-22-76      | F      | 2"         | 30#           | 2               | 24                   | ---               |           | 2         | 45         | 22500                     |
|  | 8        | M        | 14 | 26S | 37E | 7-22-76      | P      | 2"         | 30#           | 8               | 24                   | ---               |           | 6         | 200        | 33333                     |

No well will be assigned an allowable greater than the amount of oil produced on the official test.

During gas-oil ratio test, each well shall be produced at a rate not exceeding the top unit allowable for the pool in which well is located by more than 25 percent. Operator is encouraged to take advantage of this 25 percent tolerance in order that well can be assigned increased allowables when authorized by the Commission.

Gas volumes must be reported in MCF measured at a pressure base of 15.025 psia and a temperature of 60° F. Specific gravity base will be 0.60.

Report casing pressure in lieu of tubing pressure for any well producing through casing.

Mail original and one copy of this report to the district office of the New Mexico Oil Conservation Commission in accordance with Rule 301 and appropriate pool rules.

I hereby certify that the above information is true and complete to the best of my knowledge and belief.

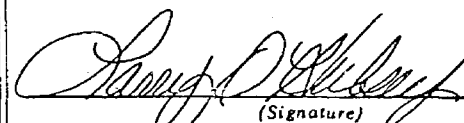
  
(Signature)

Larry O. Hulsey Petr. Eng.  
(Title)

July 23, 1976  
(Date)

BEFORE THE NEW MEXICO  
OIL CONSERVATION COMMISSION

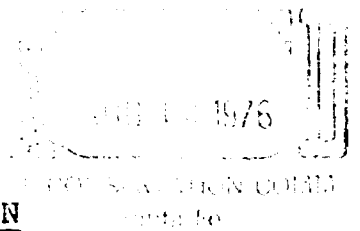

APPLICATION FOR EXCEPTION TO  
POOL ALLOWABLE FOR THE JALMAT OIL  
POOL, SECTION 20, T25S, R37E, LEA  
COUNTY, NEW MEXICO.

Case No. 5752

A P P L I C A T I O N

Comes now Bettis, Boyle & Stovall by and through their attorneys, Montgomery, Federici, Andrews & Hannahs, and in support of their application for an exception to the pool allowable for the Jalmat Oil Pool, Lea County, New Mexico, state:

(1) Applicant is the operator of the V. H. Justis #2 Well located in the NW/4 NW/4 NW/4 of Section 20, T 25 S, R 37 E, Lea County, New Mexico.

(2) Prior to July 12, 1976, the V. H. Justis #2 Well was producing substantially less than the pool allowable for the Jalmat Oil Pool which allowable is set at 80 barrels of oil per day.

(3) As a result of Reserve Oil & Gas Company's Langlie Jal Unit Waterflood Project to the north of the subject well, and specifically as a result of injection into the South Langlie Jal Unit No. 26 which directly off-sets the subject well, the subject well has experienced considerable response allowing it to produce in excess of the pool allowable.

(4) If applicant's request for an exception to the pool allowable for the V. H. Justis #2 is not granted, the waterflood project of Reserve Oil & Gas Company will cause the oil which applicant would otherwise have recovered to be swept by, contrary to the interests of the prevention of waste and the protection of correlative rights.

(5) If applicant's request is not granted, the waterflood project of Reserve Oil & Gas shall cause the V. H. Justis #2

to water out prematurely, contrary to the interests of the prevention of waste and the protection of correlative rights.

WHEREFORE, applicant requests that this matter be set before the Commission or one of its examiners and that the granting of the application shall prevent waste and protect correlative rights.

Respectfully submitted,

MONTCOMERY, FEDERICI, ANDREWS  
& HANNAHS

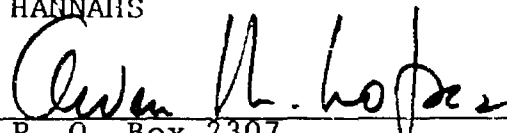
By   
P. O. Box 2307  
Santa Fe, New Mexico 87501

Attorneys for Applicant

DRAFT

dr/

BEFORE THE OIL CONSERVATION COMMISSION  
OF THE STATE OF NEW MEXICO

IN THE MATTER OF THE HEARING  
CALLED BY THE OIL CONSERVATION  
COMMISSION OF NEW MEXICO FOR  
THE PURPOSE OF CONSIDERING:

CASE NO. 5752

Order No. R- 5281

APPLICATION OF BETTIS, BOYLE &  
STOVALL FOR A SPECIAL ALLOWABLE,  
LEA COUNTY, NEW MEXICO.

ORDER OF THE COMMISSION

BY THE COMMISSION:

This cause came on for hearing at 9 a.m. on September 1,  
19 76, at Santa Fe, New Mexico, before Examiner Daniel S. Nutter.

NOW, on this        day of September, 19 76, the Commission,  
a quorum being present, having considered the testimony, the record,  
and the recommendations of the Examiner, and being fully advised  
in the premises,

FINDS:

(1) That due public notice having been given as required by  
law, the Commission has jurisdiction of this cause and the subject  
matter thereof.

(2) That the applicant, Bettis, Boyle & Stovall, is the  
owner and operator of the V. H. Justis Well No. 2 located in  
Unit D of Section 20, Township 25 South, Range 37 East, NMPM,  
Jalmat Pool, Lea County, New Mexico.

(3) That said well is offset to the North by a water injection well in an active waterflood project in said Jalmat Pool.

(4) That said well has received a response to the injection of water into the Seven Rivers formation in the offsetting waterflood project.

(5) That if applicant's said V. H. Justis Well No. 2 is not permitted to produce at capacity, oil may be swept from under said V. H. Justis Lease across lease lines onto other producing leases in the area.

(6) That to prevent waste and protect correlative rights, the NW/4 NW/4 of Section 20, Township 25 South, Range 37 East, NMPM, should be designated a Waterflood Buffer Zone in the Jalmat Pool, Lea County, New Mexico and applicant's Well No. 2 located on said 40-acre tract should be permitted to produce at capacity.

(7) That the subject application should be approved and that monthly Buffer Zone project reports should be filed with the Commission on Form C-120.

IT IS THEREFORE ORDERED:

(1) That the NW/4 NW/4 of Section 20, Township 25 South, Range 37 East, NMPM, Jalmat Pool, Lea County, New Mexico, is hereby designated a Waterflood Buffer Zone, and the Bettis, Boyle & Stovall V. H. Justis Well No. 2 located thereon is authorized an allowable equal to its ability to produce.

(2) That the applicant herein shall file a Buffer Zone Project report monthly with the Hobbs District Office of the Commission on Commission Form C-120 setting forth thereon production data concerning the above-described well.

-3-

Case No. 5752

Order No. R-

(3) That such Buffer Zone Project report shall be filed commencing with the month of assignment to the subject well of allowable in excess of the pool top unit allowable.

(4) That jurisdiction of this cause is retained for the entry of such further orders as the Commission may deem necessary.

DONE at Santa Fe, New Mexico, on the day and year hereinabove designated.



- (2) That the applicant, Bettis, Bayle & Stovall, is the owner and operator of the V.H. Justis Well No. 2 located in Unit D of Section 20 Township 25 South, Range 37 East, NMPM, Jalmat Pool, Lea County, New Mexico.
- (3) That said well is subject to the \* North ~~and East~~ seawater injection wells in an active waterflood project in said Jalmat Pool.
- (4) That said well has received a response to the injection of water into the Seven Rivers Formation in the offsetting waterflood project.
- (5) That if applicant's said V.H. Justis Well No. 2 is not permitted to produce at capacity, oil may be swept from under said V.H. Justis Lease across lease lines onto other producing leases <sup>in the area</sup> ~~and~~ ~~undrilled acreage to the~~
- (6) That to prevent waste and protect correlative rights, <sup>the NW 1/4 of Section 20 Township 25 South Range 37 East, NMPM, well no. 2</sup> ~~applicant's~~ <sup>applicant's well no. 2 located on said acreage, project</sup> should be designated a waterflood buffer zone in the Jalmat Pool, Lea County, New Mexico, and should be permitted to produce at capacity.
- (7) That the subject application should be approved and that monthly Buffer Zone Project reports should be filed with the Commission on Form C-120.

IT IS THEREFORE ORDERED:

- (1) That the NW $\frac{1}{4}$  NW $\frac{1}{4}$  of Section 20, Township 25 South, Range 37 East, NM PM, Jalmat Pool, Lea County, New Mexico, is hereby designated a Waterflood Buffer Zone and the Bettis, Boyle & Stovall V.H. Justis Well No. 2 located thereon is authorized an allowable equal to its ability to produce.
- (2) That the applicant herein shall file a Buffer Zone Project report monthly with the Hobbs District Office of the Commission on Commission Form C-120 setting forth thereon production data concerning the above-described well.
- (3) That such Buffer Zone Project report shall be filed commencing with the month of assignment of allowance in excess of the pool top unit allowance. To the subject well
- (4) Jurisdiction