

CASE 5788: SOUTHEASTERN NEW
MEXICO NOMENCLATURE CASE FOR
OCTOBER, 1976

CASE 110.

5788

Application,

Transcripts,

Small Exhibits

ETC.

OK - CU

NOMENCLATURE ADVERTISEMENT FOR OCTOBER, 1976
CASE NO. 5788

In the matter of the application of the Oil Conservation Commission of New Mexico upon its own motion for an order for the creation of new pools in Eddy, Lea and Roosevelt Counties, New Mexico, the abolishment of certain existing pools in Eddy and Lea Counties, New Mexico, the contraction of the vertical limits of an existing pool in Lea County, New Mexico, and the extension of the vertical and horizontal limits of certain existing pools in Eddy, Lea and Roosevelt Counties, New Mexico, and giving notice to all persons and parties interested in the subject matter thereof to appear and show cause why such creations, abolishments, contractions, and extensions should not be made.

- ✓(a) CREATE a new pool in Eddy County, New Mexico, classified as a gas pool for Morrow production and designated as the Angell Ranch-Morrow Gas Pool. The discovery well is Penroc Oil Corporation Wright Federal Well No. 1 located in Unit O of Section 6, Township 20 South, Range 28 East, NMPM. Said pool would comprise:

TOWNSHIP 20 SOUTH, RANGE 28 EAST, NMPM
Section 6: All

- ✓(b) CREATE a new pool in Eddy County, New Mexico, classified as a gas pool for Strawn production and designated as the West Burton Flat-Strawn Gas Pool. The discovery well is David Fasken El Paso Federal Well No. 3 located in Unit H of Section 1, Township 21 South, Range 26 East, NMPM. Said pool would comprise:

TOWNSHIP 21 SOUTH, RANGE 26 EAST, NMPM
Section 1: Lots 1 through 8

- ✓(c) CREATE a new pool in Roosevelt County, New Mexico, classified as a gas pool for Canyon production and designated as the North Chaveroo-Canyon Gas Pool. The discovery well is Union Oil Company of California Roberts Well No. 1 located in Unit D of Section 9, Township 7 South, Range 33 East, NMPM. Said pool would comprise:

TOWNSHIP 7 SOUTH, RANGE 33 EAST, NMPM
Section 9: W/2

- ✓(d) CREATE a new pool in Eddy County, New Mexico, classified as a gas pool for Morrow production and designated as the Foster Ranch-Morrow Gas Pool. The discovery well is Mark Production Company Foster Well No. 1 located in Unit J of Section 21, Township 20 South, Range 24 East, NMPM. Said pool would comprise:

TOWNSHIP 20 SOUTH, RANGE 24 EAST, NMPM
Section 21: E/2

- ~~✓(e) CREATE a new pool in Lea County, New Mexico, classified as an oil pool for Cisco production and designated as the East Kemnitz-Cisco Pool. The discovery well is Phillips Petroleum Company Michel Well No. 1 located in Unit C of Section 13, Township 16 South, Range 33 East, NMPM. Said pool would comprise:~~

~~TOWNSHIP 16 SOUTH, RANGE 33 EAST, NMPM
Section 13: N/2 & SE/4~~

- ✓(e) CREATE a new pool in Eddy County, New Mexico, classified as an oil pool for Cherry Canyon production and designated as the Nash Draw Cherry-Canyon Pool. The discovery well is Mesa Petroleum Company Nash Unit Well No. 4 located in Unit A of Section 13, Township 23 South, Range 29 East, NMPM. Said pool would comprise:

TOWNSHIP 23 SOUTH, RANGE 29 EAST, NMPM
Section 13: NE/4

-2-
Nomenclature Advertisement October, 1976

- ✓ (f) CREATE a new pool in Lea County, New Mexico, classified as a gas pool for Strawn production and designated as the Ojo Chiso-Strawn Gas Pool. The discovery well is American Quasar Petroleum Company of New Mexico Ojo Chiso Unit Well No. 1 located in Unit E of Section 23, Township 22 South, Range 34 East, NMPM. Said pool would comprise:

TOWNSHIP 22 SOUTH, RANGE 34 EAST, NMPM
Section 23: W/2

- ✓ (g) CREATE a new pool in Lea County, New Mexico, classified as a gas pool for Cisco production and designated as the North Vacuum-Cisco Gas Pool. The discovery well is Marathon Oil Company State Section 7 Com Well No. 1 located in Unit G of Section 7, Township 17 South, Range 35 East, NMPM. Said pool would comprise:

TOWNSHIP 17 SOUTH, RANGE 35 EAST, NMPM
Section 7: E/2

- ✓ (i) ~~ABOLISH THE Kemnitz-Pennsylvanian Pool in Lea County, New Mexico, described as:~~

~~TOWNSHIP 16 SOUTH, RANGE 33 EAST, NMPM~~
~~Section 13: SE/4~~

- ✓ (j) ~~ABOLISH the East Shugart-Queen Pool in Lea County, New Mexico, described as:~~

~~TOWNSHIP 19 SOUTH, RANGE 32 EAST, NMPM~~
~~Section 6: NE/4~~

- ✓ (k) ~~ABOLISH the Watkins-Seven Rivers Pool in Eddy and Lea Counties, New Mexico, described as:~~

~~TOWNSHIP 18 SOUTH, RANGE 31 EAST, NMPM~~
~~Section 36: E/2~~

~~TOWNSHIP 18 SOUTH, RANGE 32 EAST, NMPM~~
~~Section 31: All~~

~~TOWNSHIP 19 SOUTH, RANGE 32 EAST, NMPM~~
~~Section 6: N/2~~

- ✓ (l) ~~CONTRACT the vertical limits of the Sombreno-Pennsylvanian Gas Pool in Lea County, New Mexico, to include Atoka formation only, and redesignate said pool as the Sombreno-Atoka Gas Pool.~~

- ✓ (m) ~~EXTEND the vertical limits of the Watkins-Grayburg Pool in Lea County, New Mexico, to include the Yates, Seven Rivers, and Queen formations, and redesignate said pool as Watkins-Yates, Seven Rivers, Queen, Grayburg Pool.~~

- ✓ (n) EXTEND the Blinebry Oil and Gas Pool in Lea County, New Mexico, to include therein:

TOWNSHIP 22 SOUTH, RANGE 38 EAST, NMPM
Section 18: SE/4

- ✓ (h) CONTRACT the vertical limits of the Kemnitz-Pennsylvanian Pool in Lea County, New Mexico, to the Cisco formation only, redesignating said pool the Kemnitz-Cisco Pool and extending redefining said pool to include

Township 16 South, Range 33 East NMPM
Section 13: N/2 and SE/4

SE +
Sombreno
Atoka

Ext
Watkins
24/3

(6) CONTRACT the vertical limits of the Sombbrero-Pennsylvanian gas Pool in Lea County, New Mexico, to the Atoka formation only, redesignating said pool the Sombbrero-Atoka gas Pool and redefining said pool to comprise:

Township 16 South, Range 33 East NMPM

Section 12: W/2

Section 13: W/2 and SE/4

(7) EXTEND the vertical limits of the Watkins-Krayburg Pool in Lea County New Mexico, to include the Yates, Seven Rivers, and Queen formations, redesignating said pool the Watkins Yates-Seven Rivers-Queen-Krayburg Pool and redefining said pool to comprise:

Township 18 South, Range 31 East, NMPM

Section 31: NW/4 and S/2

Township 19 South, Range 32 East, NMPM

Section 6: N/2

-4-

Nomenclature Advertisement October, 1976

- ✓(x) EXTEND the Red Lake-Queen, Grayburg, San Andres Pool in Eddy County, New Mexico, to include therein:

TOWNSHIP 17 SOUTH, RANGE 27 EAST, NMPM
Section 13: SE/4 SE/4
Section 24: NE/4

- ✓(g) EXTEND the Sawyer-San Andres Gas Pool in Lea County, New Mexico, to include therein:

TOWNSHIP 9 SOUTH, RANGE 37 EAST, NMPM
Section 13: SW/4

- ✓(Z) EXTEND the Shugart Pool in Eddy County, New Mexico, to include therein:

TOWNSHIP 18 SOUTH, RANGE 31 EAST, NMPM
Section 26: NW/4
Section 27: NE/4

- ✓(bb) ~~EXTEND the Sombrero Atoka Gas Pool in Lea County, New Mexico, to include therein:~~

~~TOWNSHIP 16 SOUTH, RANGE 33 EAST, NMPM~~
~~Section 13: SE/4~~

- ✓(aa) EXTEND the Vacuum-Queen Gas Pool in Lea County, New Mexico, to include therein:

TOWNSHIP 17 SOUTH, RANGE 34 EAST, NMPM
Section 2: SW/4
Section 3: SE/4

CASE NO. 5788 (a) CREATION OF A NEW GAS POOL

COUNTY Eddy POOL Angell Ranch-Morrow Gas

TOWNSHIP	20S	RANGE	28E	NMPM
6	5	4	3	2
7	8	9	10	11
18	17	16	15	14
19	20	21	22	23
30	29	28	27	26
31	32	33	34	35
				36

Purpose: Two completed gas wells capable of producing.

Disc. well: Penroc Oil Corp., Wright Federal #1-O 6-20-28
Comp. 8-26-75 through Morrow perfs from 10828-894.

Proposed pool boundary outlined in blue.
Section 6: All

CASE NO. 5783 (b) CREATION OF A NEW GAS POOL
West Burt

Eddy

POOL

West Burton Flat-Surf

21S

RANGE

26E

INMPM

COUNTY Eddy

TOWNSHIP 21S

RANGE 26E

NMPM

1

2

3

4

5

6

7

8

9

10

11

12

13

14

15

16

17

18

19

20

21

22

23

24

25

26

27

28

29

30

31

32

33

34

35

36

Completed gas well capable of producing.

[illegible]

Purpose: One complete

Disc. well: David Fasken, El Paso Federal #3-H, 1-21-26

Comp. 7-15-76 through Strawn perfs from 9971-89.

Proposed pool boundary outlined in blue.
Section 1: lots 1 through 8.

CASE NO. 5788 (c) CREATION OF A NEW GAS POOL

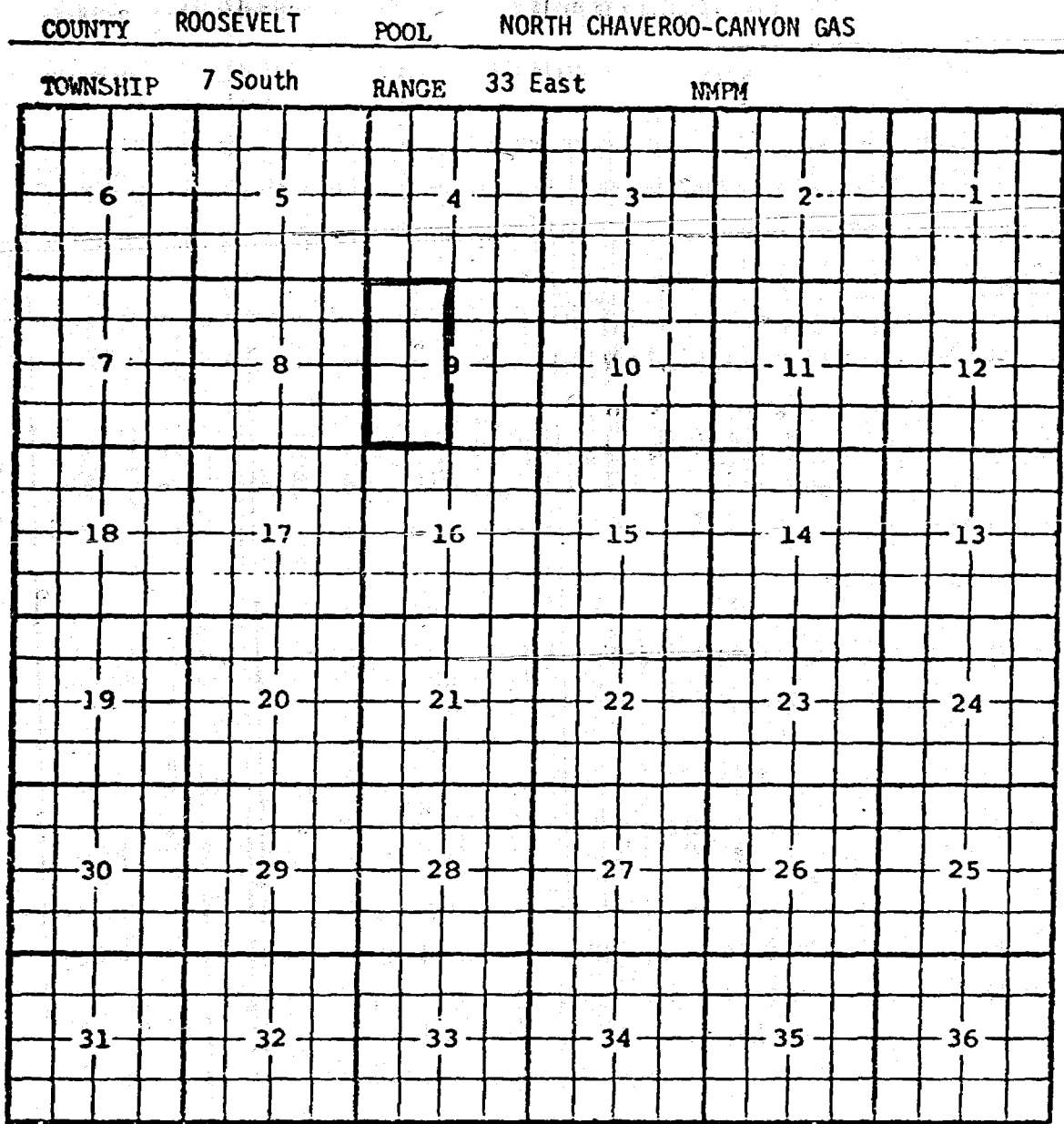

Purpose: One completed gas well capable of producing.

DISCOVERY WELL: Union Oil Company of Calif. Roberts Well #1 located in Unit D of Sec. 9, Township 7 South, Range 33 East. Completed June 2, 1976, in the Lower Canyon formation. Top of the perforations is 8903 feet.

Proposed pool boundary outlined in red. SECTION 9: W/2

CASE NO. 5733 (d) CREATION OF A NEW GAS POOL

COUNTY	Eddy	POOL	Foster Ranch-Morrow Gas
TOWNSHIP	20S	RANGE	24E NMFM
6	5	4	3 2 1
7	8	9	10 11 12
18	17	16	15 14 13
19	20	21	22 23 24
30	29	28	27 26 25
31	32	33	34 35 36

Purpose: One completed gas well capable of producing.

Disc. well: Mark Production Co. Foster #1-J, 21-20-24
 Comp. 5-13-75 through Morrow perfs from 8875-8998.

Proposed pool boundary outlined in blue.

Section 21: E/2

CASE NO. 5768 (e) CREATION OF A NEW OIL POOL

COUNTY Eddy POOL Nash Draw-Cherry Canyon

TOWNSHIP	23S	RANGE	29E	NMPM
6	5	4	3	2
7	8	9	10	11
18	17	16	15	14
19	20	21	22	23
30	29	28	27	26
31	32	33	34	35

Purpose: One completed oil well capable of producing.

Disc. well: Mesa Petroleum Co. Nash Unit #4-A, 13-23-29.

Comp. 6-2-76 through Cherry Canyon perfs from 4785-88.

Proposed pool boundary outlined in blue.

Section 13: NE/4

CASE NO. 5788 (f)

CREATION OF A NEW GAS POOL

COUNTY LEA

POOL OJO CHISO-STRAWN GAS

TOWNSHIP 22 South

RANGE 34 East

NMPM

6	5	4	3	2	1
7	8	9	10	11	12
18	17	16	15	14	13
19	20	21	22	23	24
30	29	28	27	26	25
31	32	33	34	35	36

PURPOSE: One completed gas well capable of producing.

DISCOVERY WELL: American Quasar Petroleum Co. of New Mexico Ojo Chiso Unit #1-E

Sec. 23, T22S, R34E. Completed on June 27, 1976, in the Strawn formation.

Top of the perforations is 11,727'.

Proposed pool boundary outlined in red: SECTION 23: W/2

CASE No. 5788 (g) CREATION OF A NEW GAS POOL

COUNTY LEA POOL NORTH VACUUM CISCO GAS

TOWNSHIP 17 South RANGE 35 East NMPM

6	5	4	3	2	1
7	8	9	10	11	12
18	17	16	15	14	13
19	20	21	22	23	24
30	29	28	27	26	25
31	32	33	34	35	36

PURPOSE: One completed gas well capable of producing.

DISCOVERY WELL: Marathon Oil Company State Sec. 7 Com Well #1-G in Sec. 7, T17S, R35E. Completed July 31, 1976 in the Atoka Formation. Top of the perforations is 12,078 feet.

Proposed pool boundary outlined in red: SECTION 7: E/2

TO BE DISMISSED PENDING FURTHER STUDY.

CASE NO. 5788 (h) CONTRACTION OF VERTICAL LIMITS AND REDESIGNATION OF POOL

COUNTY LEA POOL KEMNITZ-PENNSYLVANIAN to WEST KEMNITZ-CISCO

TOWNSHIP 16 South RANGE 33 East NMPM

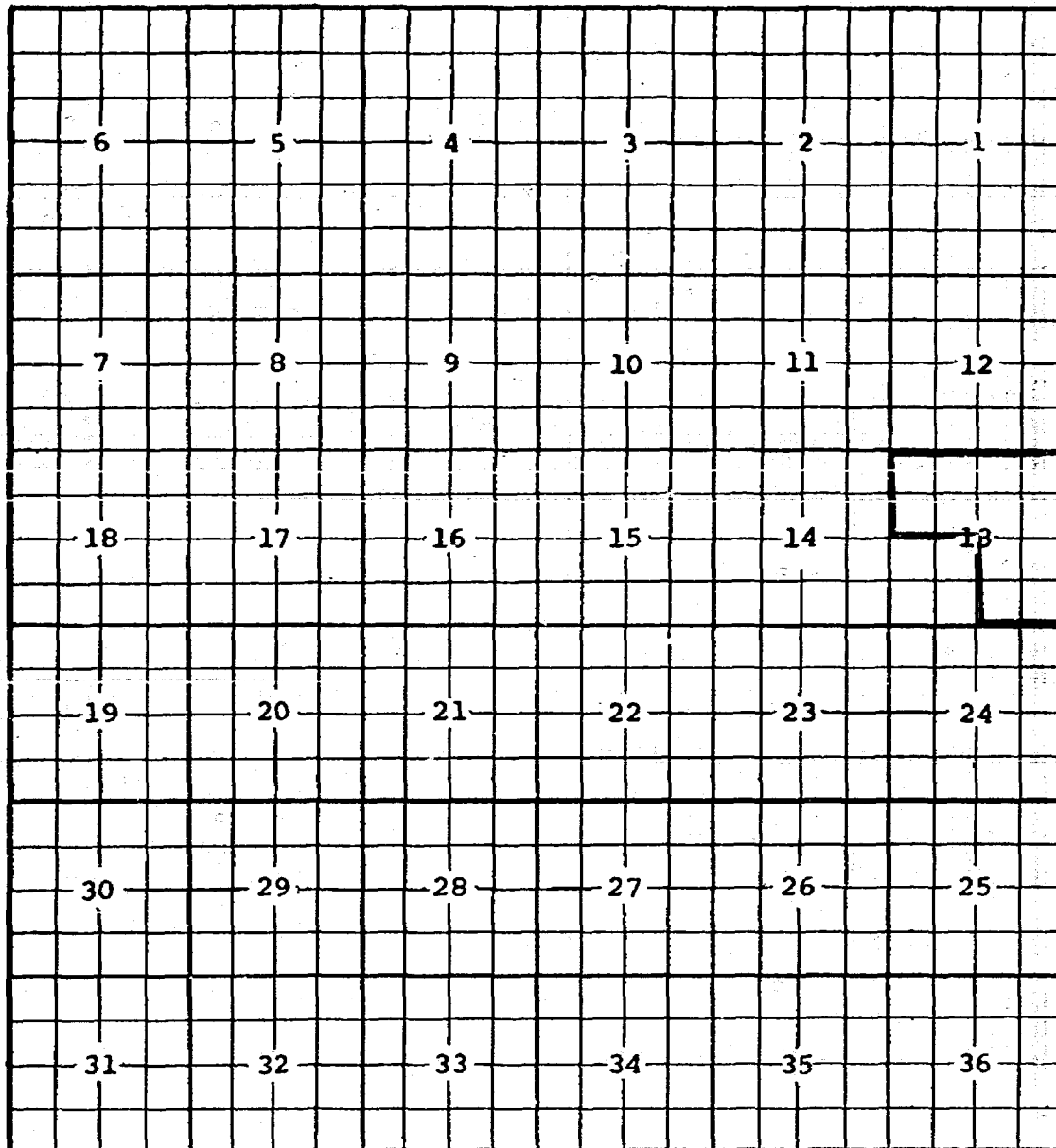

PURPOSE: To contract the vertical limits of the Kemnitz-Pennsylvanian Pool to the Cisco formation only and redesignate said pool as the West Kemnitz-Cisco Pool and extending horizontal limits to include Phillips Petroleum Company Michel Well #1-C in Section 13, T16S, R33E, completed on February 16, 1976, in the Cisco formation. Top of perfs 11,207 feet.

Redefined pool boundary outlined in red. SECTION 13: N/2 and SE/4

CASE NO. 5788 (i) CONTRACTION OF VERTICAL LIMITS & REDESIGNATION OF POOL NAME

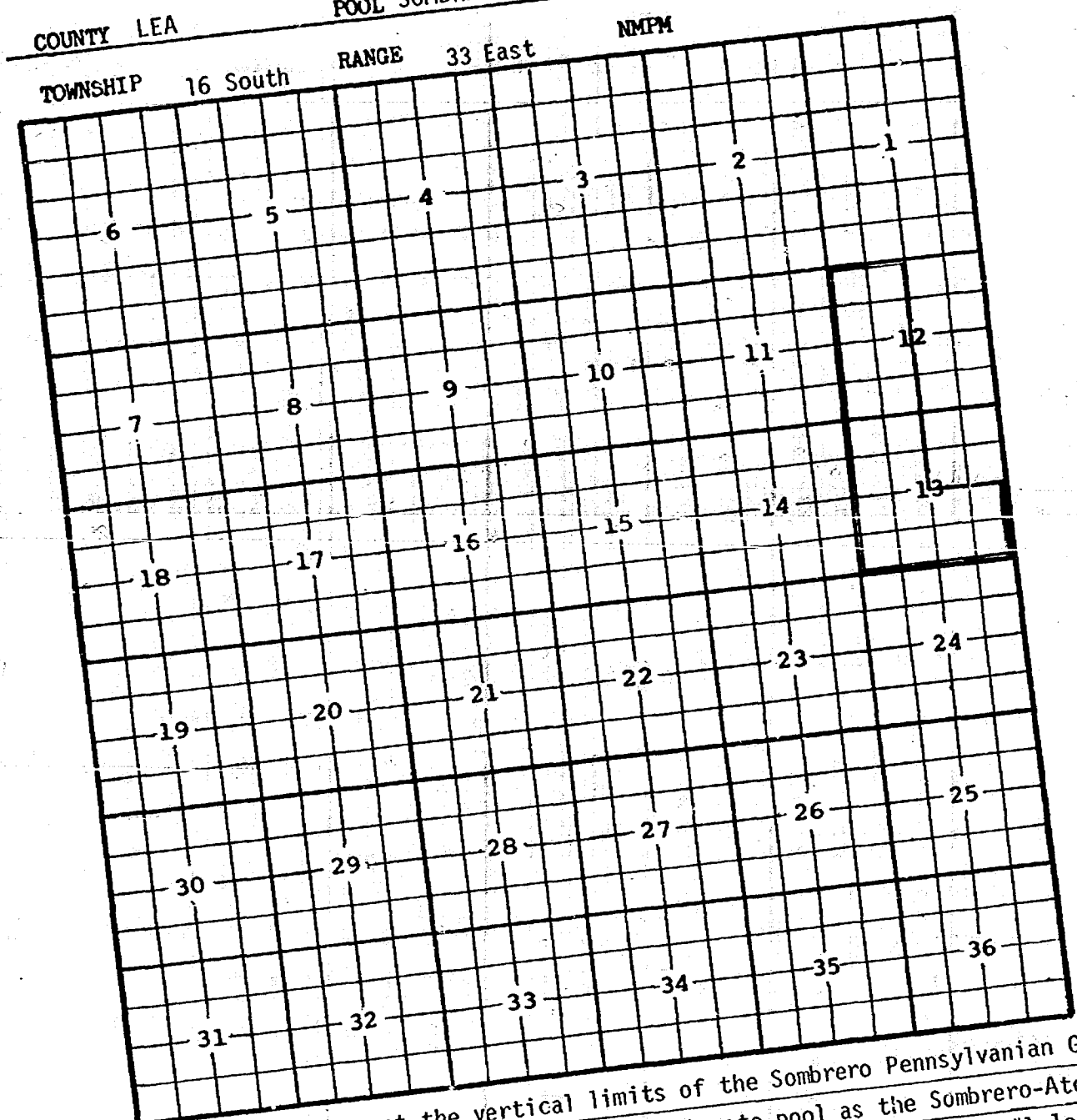

PURPOSE: To contract the vertical limits of the Sombbrero Pennsylvanian Gas Pool to the Atoka formation only and redesignate pool as the Sombbrero-Atoka Gas Pool to include Great Western Drilling Company State "13" Well #1 located in Unit P of Section 13, T16S, R33E. Completed in the Atoka formation on November 12, 1975. Top of perforations 12,660'.

Redefined pool boundary outlined in red. SECTION 12: W/2
 Section 13: W/2 & SE/4

CASE NO. 5788 (j) ABOLISHMENT OF AN EXISTING OIL POOL

COUNTY LEA POOL EAST SHUGART-QUEEN

TOWNSHIP 19 South RANGE 32 East NMPM

A 6x6 grid with numbers 1 through 36. The numbers are arranged in a standard 6x6 grid pattern, starting from 1 in the top-right corner and increasing row by row to 36 in the bottom-right corner. A 2x2 square is drawn in the top-left corner, covering the cells containing numbers 6, 5, 7, and 8.

PURPOSE: To abolish pool.

Acreage will go into Watkins-Yates-Seven Rivers-Queen-Grayburg Pool.

Pool abolishment outlined in blue. SECTION 6: NE/4

CASE NO. 5788 (k) ABOLISHMENT OF AN EXISTING OIL POOL

Page 1

COUNTY EDDY

POOL WATKINS SEVEN RIVERS

TOWNSHIP

18 South

RANGE

31 East

NMPM

6	5	4	3	2	1
7	8	9	10	11	12
18	17	16	15	14	13
19	20	21	22	23	24
30	29	28	27	26	25
31	32	33	34	35	36

PURPOSE: To abolish pool.

This acreage is included in the Shugart Y-SR-Q-G Pool.

Pool abolishment outlined in blue. SECTION 36: E/2

COUNTY	LEA	POOL	WATKINS-SEVEN RIVERS		
TOWNSHIP	18South	RANGE	32 East	NMPM	
6	5	4	3	2	1
7	8	9	10	11	12
18	17	16	15	14	13
19	20	21	22	23	24
30	29	28	27	26	25
31	32	33	34	35	36

Purpose: To abolish pool.

Acreage will go into Watkins-Yates-Seven Rivers-Queen Grayburg Pool.

Pool abolishment outlined in blue. SECTION 31: All

COUNTY	LEA	POOL	WATKINS-SEVEN RIVERS		
TOWNSHIP	19 South	RANGE	32 East	NMPM	
6	5	4	3	2	1
7	8	9	10	11	12
18	17	16	15	14	13
19	20	21	22	23	24
30	29	28	27	26	25
31	32	33	34	35	36

Purpose: To abolish pool.

Acreage will go into Watkins-Yates-Seven Rivers-Queen Grayburg Pool.

Pool abolishment outlined in blue. SECTION 6: N/2

CASE NO. 5788 (1) Page 2

COUNTY IEA POOL WATKINS-GRAYBURG to WATKINS-YATES-SEVEN RIVERS-QUEEN-GRAYBURG POOL
TOWNSHIP 19 South RANGE 32 East NMFM

6	5	4	3	2	1	
7	8	9	10	11	12	
18	17	16	15	14	13	
19	20	21	22	23	24	
30	29	28	27	26	25	
31	32	33	34	35	36	

Purpose: See page 1 of this paragraph exhibit.

Redefined pool boundary outlined in red: SECTION 6: N/2

CASE NO. 5788 (m)

EXTENSION OF AN EXISTING OIL & GAS POOL

Page 1

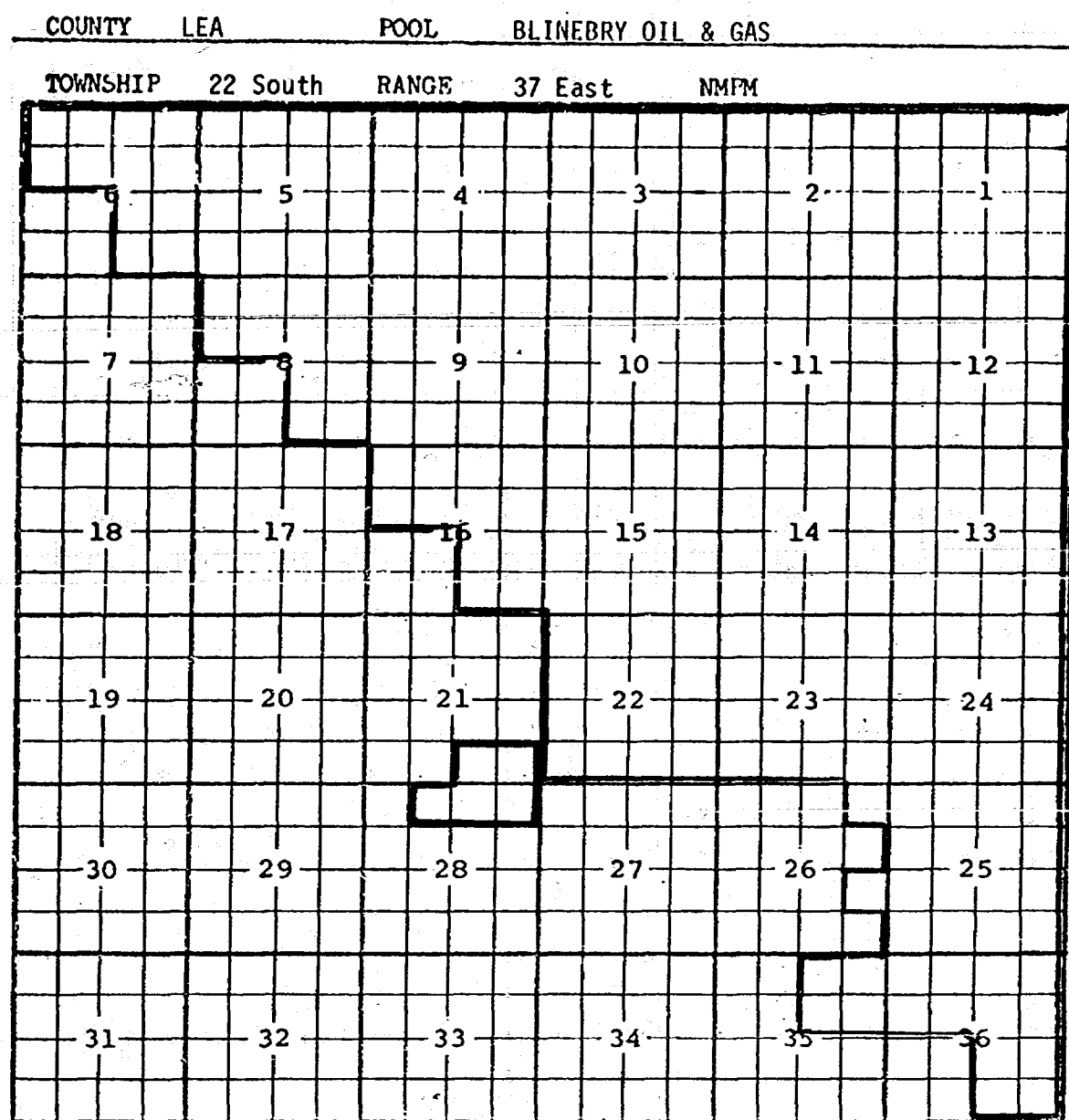

Purpose: One completed oil well capable of producing.
 Gulf Oil Corporation, Manda B Tract C Well #1 in Unit C, Sec. 28, T22S, R37E.
 Completed September 16, 1976 in the Blinebry formation. Top of perforations
 5462 feet.

Pool boundary outlined in red.

ADDITION -- Proposed pool extension outlined in green. SECTION 21: S/2 SE/4
 ADDITION -- SECTION 28: N/2 NE/4 & NE/4 NW/4

CASE NO. 5788 (m)

EXTENSION OF AN EXISTING OIL & GAS POOL

Page 2

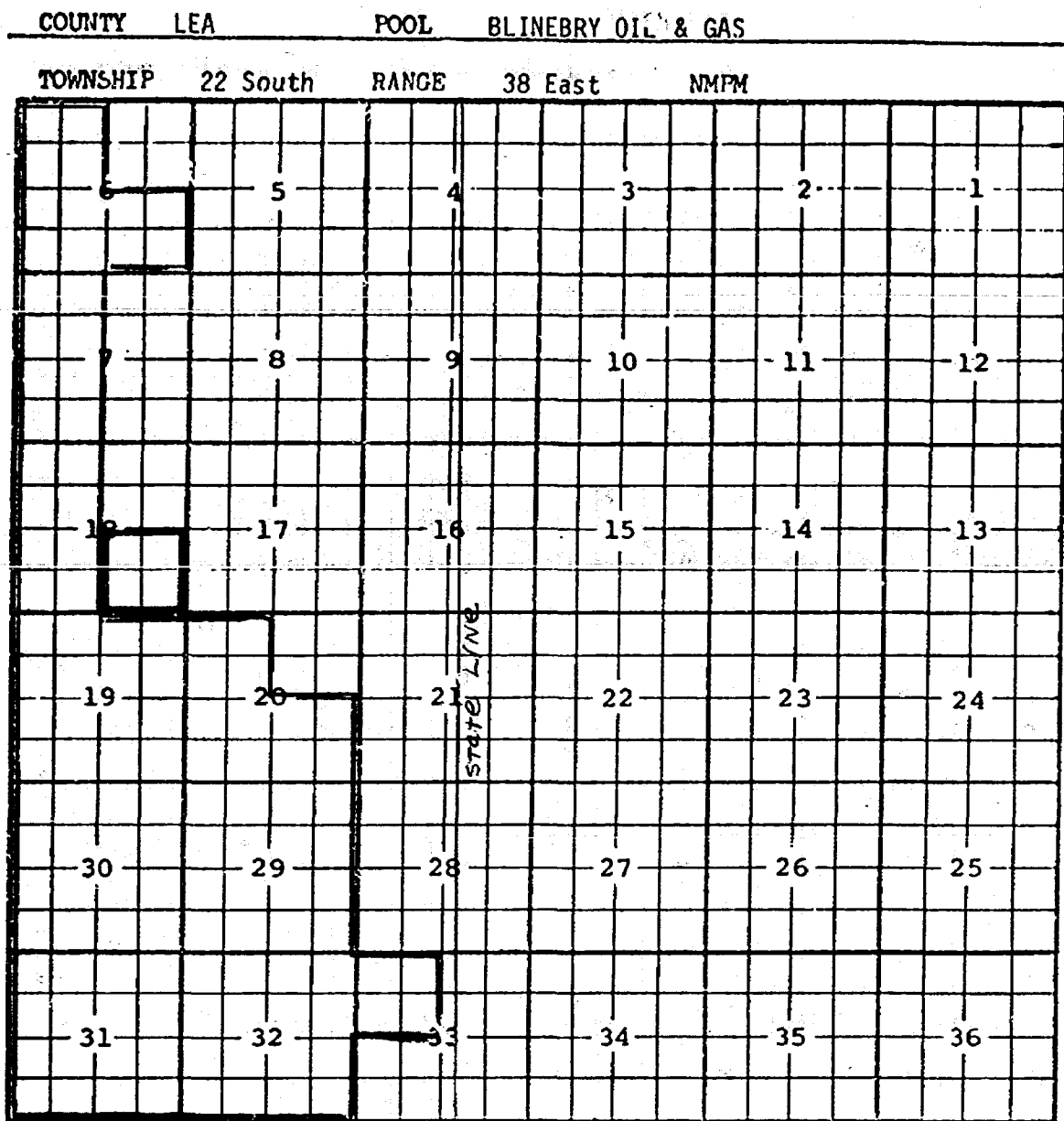

Purpose: One completed oil well capable of producing.
 Texaco Inc. C.H. Lockhart Federal NCT-1 Well #4-J in Sec. 18, T22S. R38E.
 Completed August 27, 1976 in the Blinebry formation. Top of perforations
 is at 5597'.

Pool boundary outlined in red.
 Proposed pool extension outlined in green. SECTION 18: SE/4

CASE NO. 5733 (n) EXTENSION OF AN EXISTING GAS POOL

COUNTY	Eddy	POOL	Burton Flat-Morrow Gas
TOWNSHIP	21S	RANGE	26E
NMPM			
6	5	4	3
7	8	9	10
18	17	16	15
19	20	21	22
30	29	28	27
31	32	33	34

Purpose: One completed gas well capable of producing.

Operator	Lease	#&Ut.	S.T.R.	Comp.	Form.	TOP
Inexco Oil Co.	Avalon 1	Fed.	1-X	1-21-26	7-10-76	Morrow 11028'

Pool boundary outlined in red.

Proposed extension outlined in blue.

Sec. 1: S/2

CASE NO. 5788 (c) EXTENSION OF AN EXISTING GAS POOL

COUNTY Eddy POOL North Burton Flats-Wolfcamp Gas

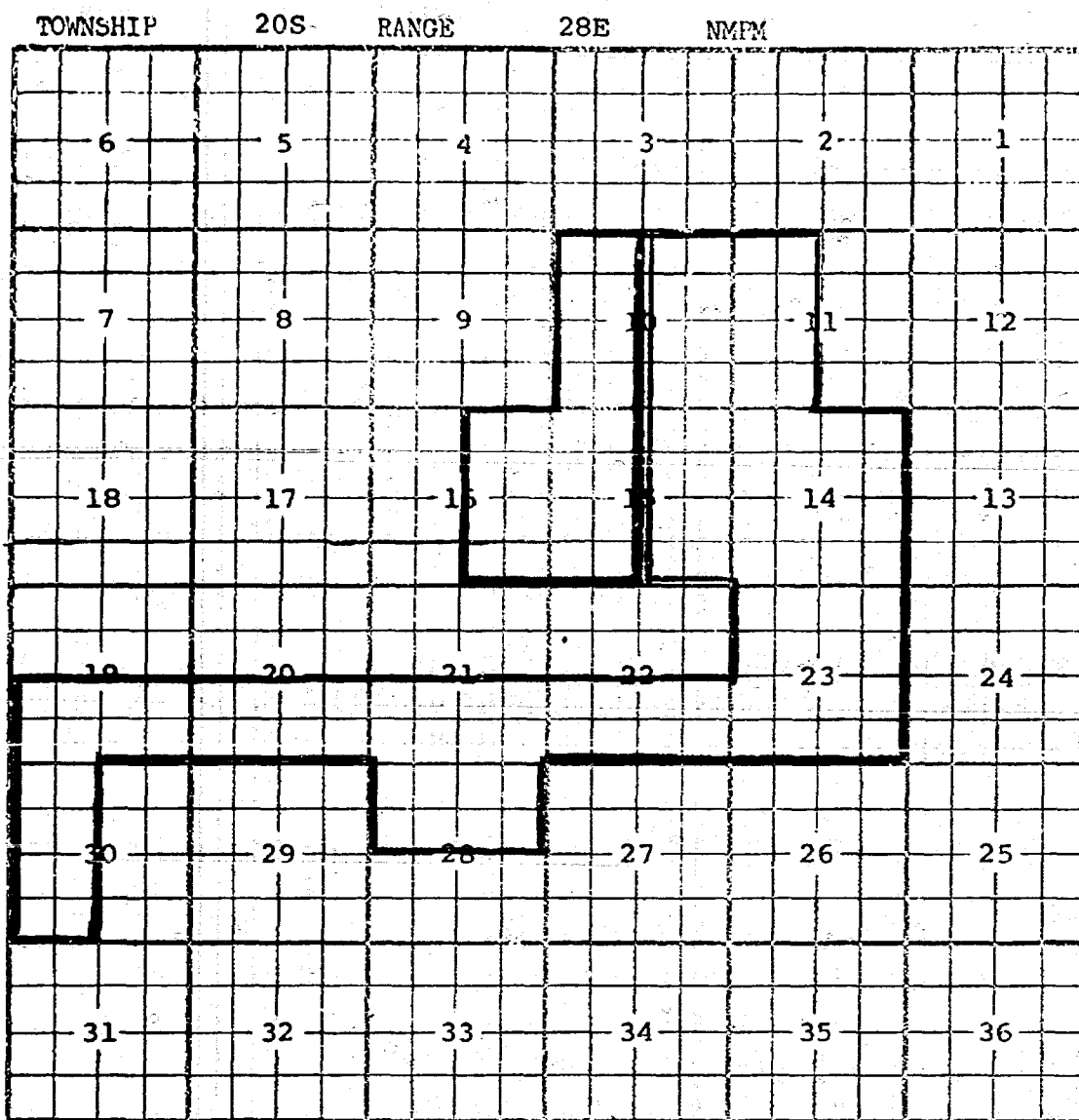

Purpose: Two completed gas wells capable of producing.

Operator	Lease	#&Ut.	S.T.R.	Comp.	Form.	TOP
Cities Service	Government AB	3-K	10-20-28	6-29-76	Wolfcamp	9096'
"	State CT Com	1-I	16-20-28	5-16-76	"	9499'

Pool boundary outlined in red.

Proposed extension outlined in blue.

Section 10: W/2

Section 15: W/2

Section 16: E/2

COUNTY Eddy POOL South Carlsbad-Morrow Gas

TOWNSHIP 22S RANGE 27E NMPM

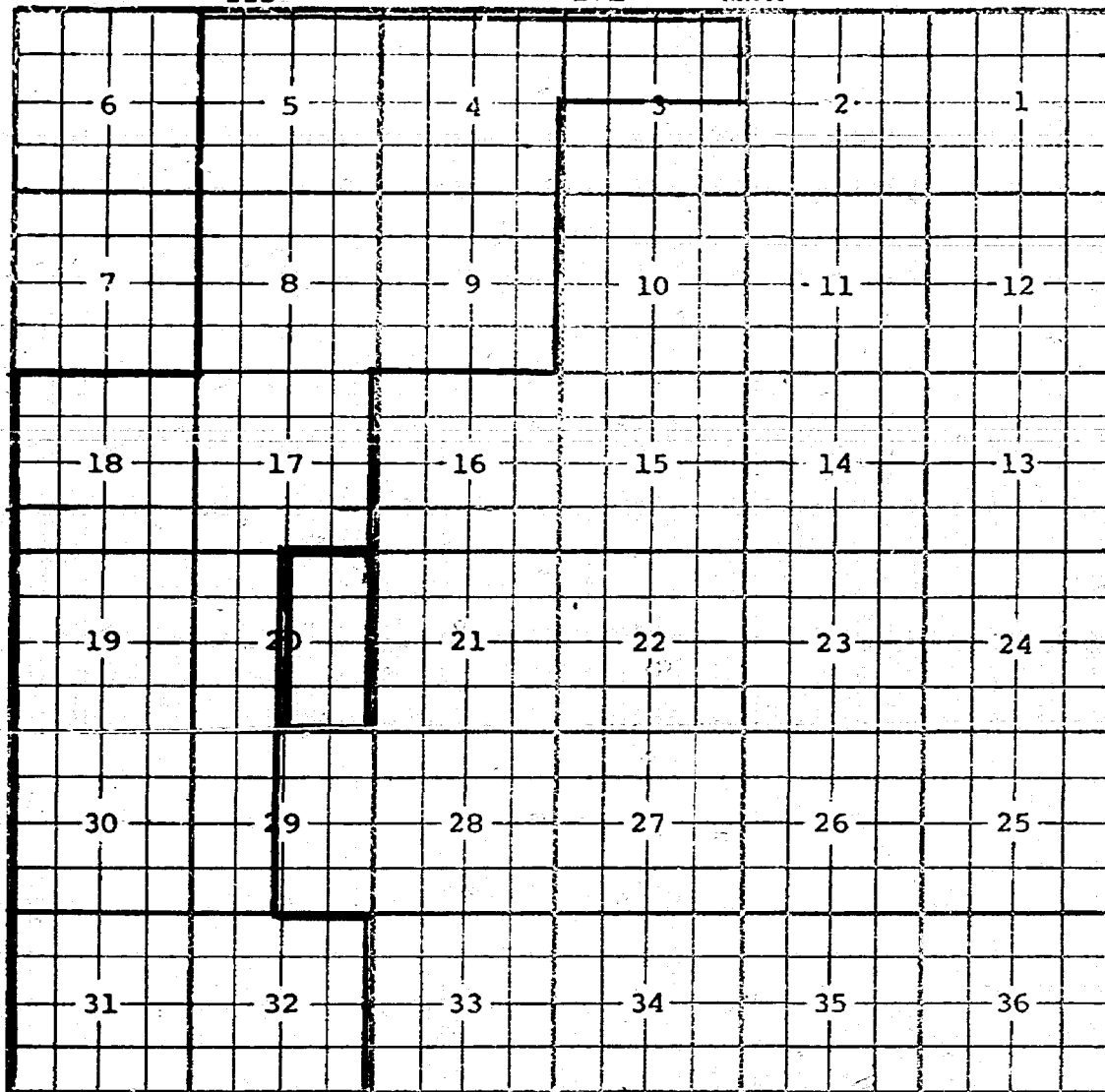

Purpose: One completed gas well capable of producing.

Operator	Lease	#&Ut.	S.T.R.	Comp.	Form.	TOP
Morris R. Antweil	XL	1-J	20-22-27	3-15-76	Morrow	11360'

Pool boundary outlined in red.

Proposed extension outlined in blue.

Section 20: E/2

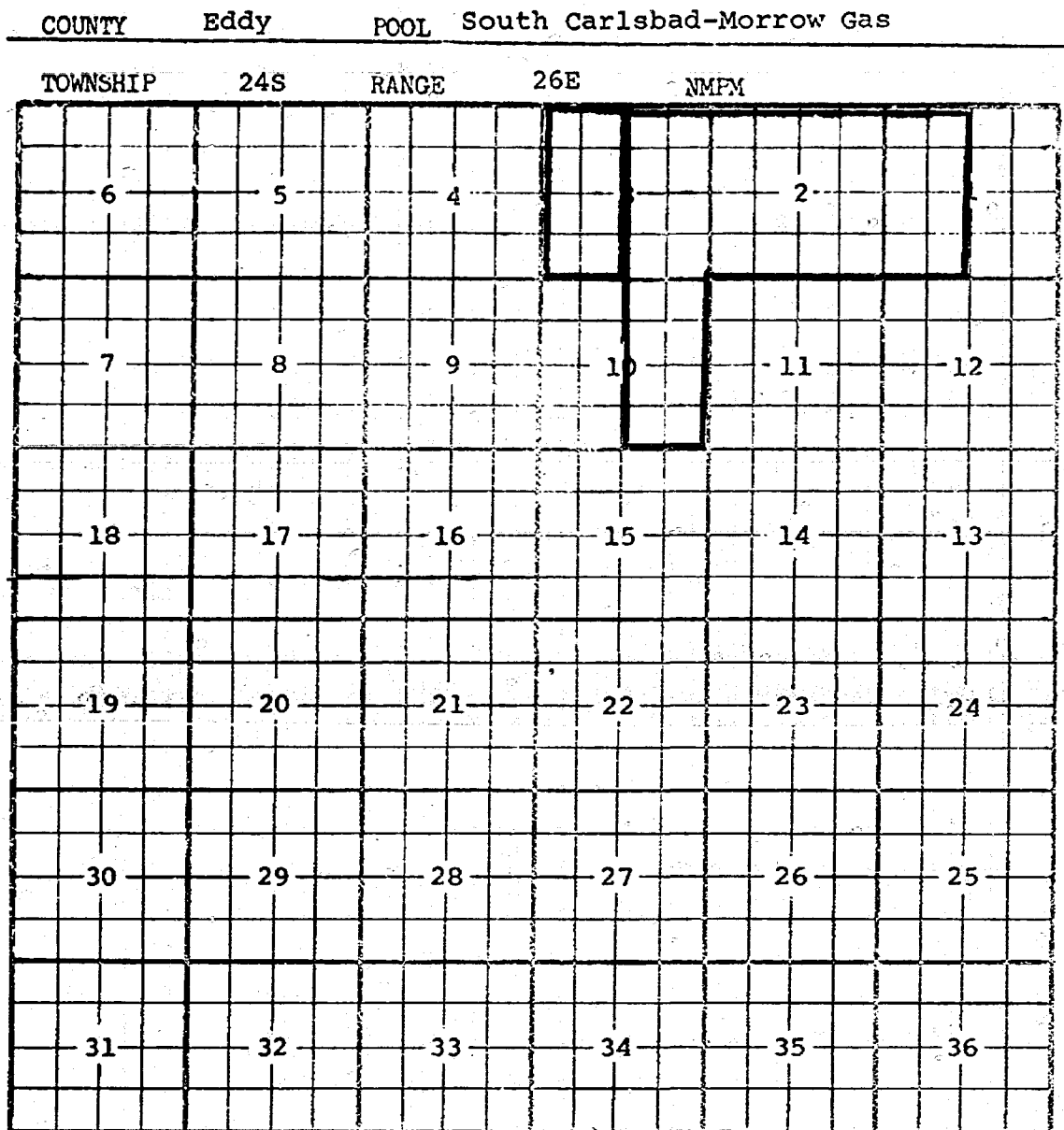

Purpose: One completed gas well capable of producing.

Operator	Lease	#&Ut.	S.T.R.	Comp.	Form.	TOP
C & K Petr.Inc.	Allied Chemical Fed.	2-E	3-24-26	7-1-76	Morrow	11566'

Pool boundary outlined in red.

Proposed extension outlined in blue.

Section 3: W/2

CASE NO. 5788 (q) EXTENSION OF AN EXISTING OIL POOL

COUNTY Eddy POOL North Dagger Draw-Upper Penn.

TOWNSHIP 19S RANGE 25E NMPM

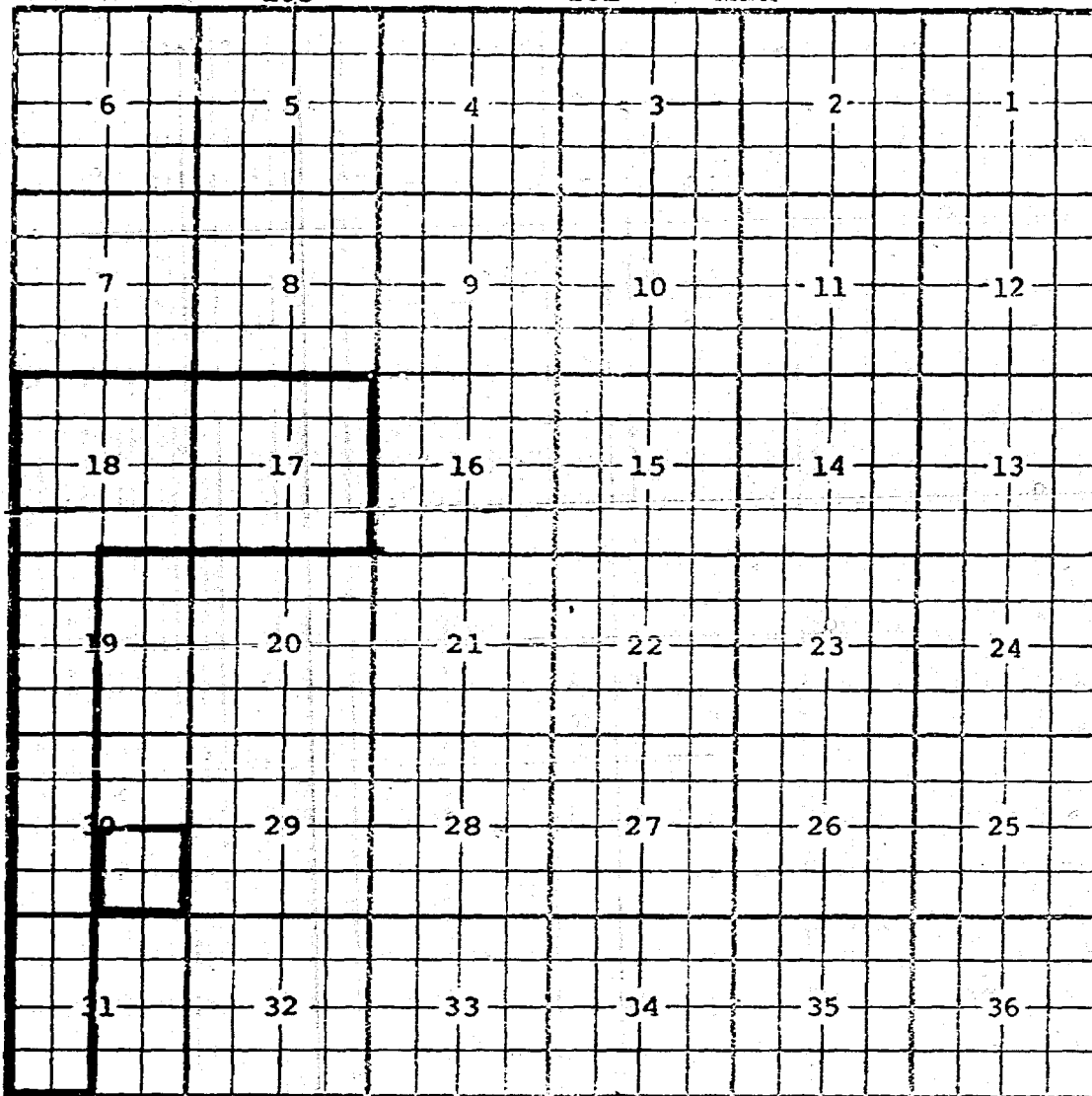

Purpose: One completed oil well capable of producing.

Operator	Lease	#&Ut.	S.T.R.	Comp.	Form.	TOP
Roger C.Hanks	Dagger Draw	2-I	30-19-25	5-21-76	Upper Penn	7632'

Pool boundary outlined in red.

Proposed extension outlined in blue.

Section 30: SE/4

CASE NO. 5788 (r) EXTENSION OF AN EXISTING OIL POOL

COUNTY Eddy POOL Dayton-San Andres

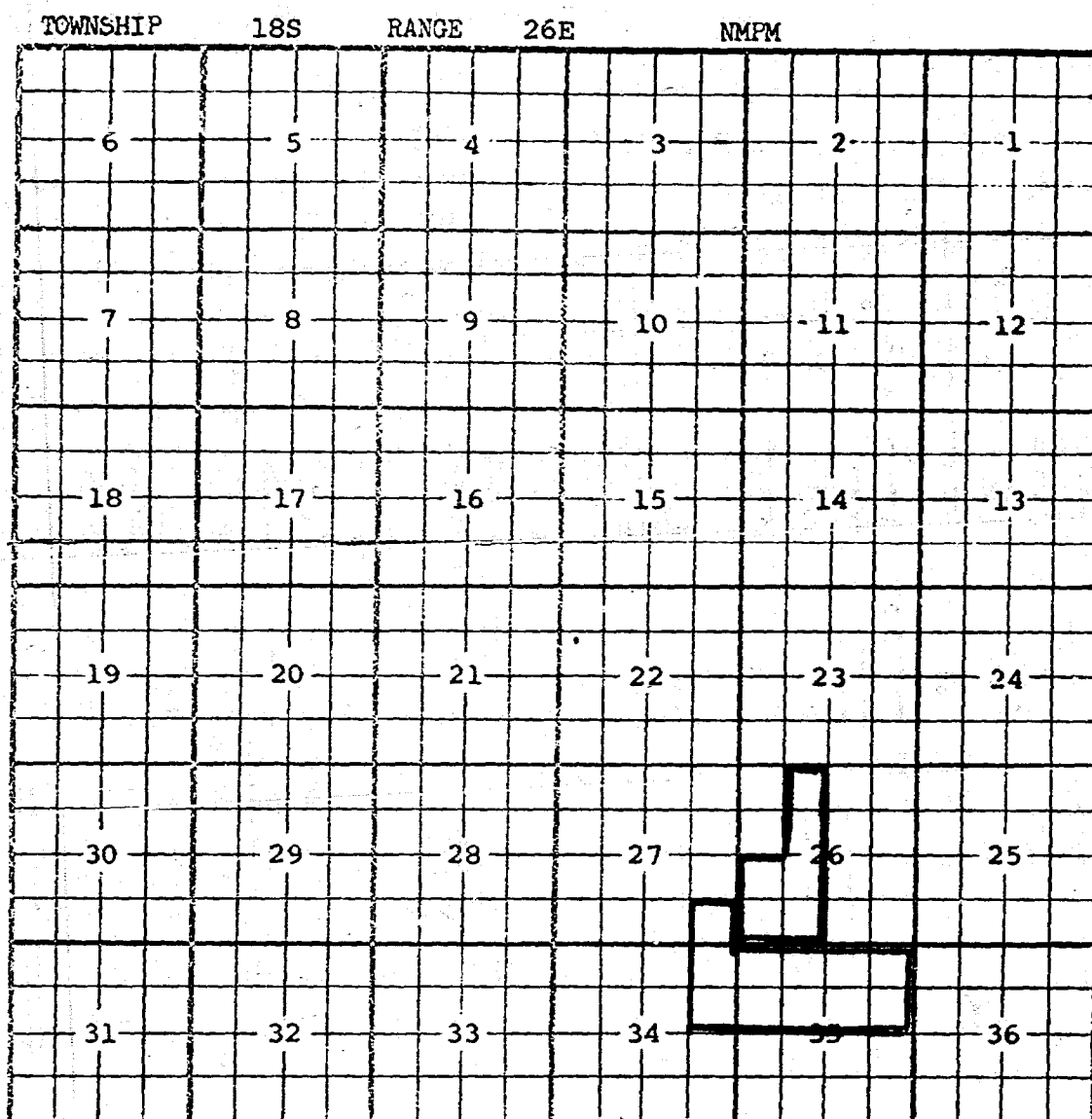

Purpose: Two completed oil wells capable of producing.

Operator	Lease #&Ut.	S.T.R.	Comp.	Form.	TOP
Featherstone Dev. Corp.	Platt 2-K	26-18-26	5-20-76	SA	1662'
C.E. LaRue & E. N. Maney, Jr.	Crozier 1-C	26-18-26	9-14-76	SA	1728

ADDITION

Pool boundary outlined in red.

Proposed extension outlined in blue.

Section 26: SW/4

ADDITION

Section 26: E/2 NW/4

CASE NO. 5788 (s) EXTENSION OF AN EXISTING OIL POOL

COUNTY Eggy POOL East Empire Yates-Seven Rivers

TOWNSHIP 17S RANGE 28E NMPM

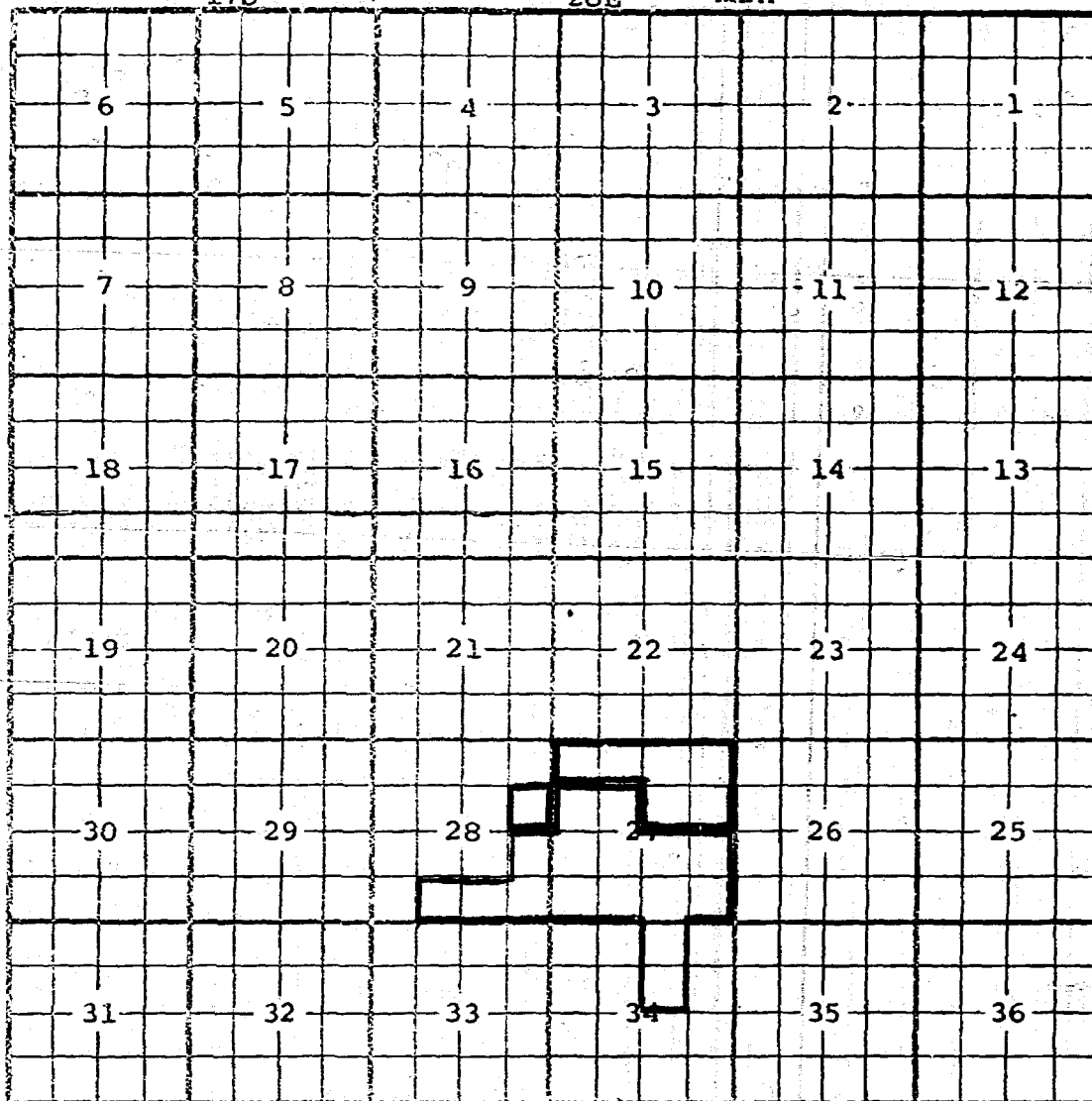

Purpose: Four completed oil wells capable of producing.

Operator	Lease	#&Ut.	S.T.R.	Comp.	Form.	TOP
David C. Collier	Gillespie State	1-D	27-17-28	8-27-76	SR	763'
"	"	2-C	27-17-28	8-1-76	"	764'
Marbob Energy Corp.	N.G. Phillips	St. 18-G	27-17-28	6-18-76	"	801'
<u>ADDITION</u> Kersey & Co.	Williams A	3-H	28-17-28	3-18-75	"	751'

Pool boundary outlined in red.

Proposed extension outlined in blue.

Section 27: NE/4 & N/2 NW/4

ADDITION

Section 28: SE/4 NE/4

CASE NO. 5788 (t) EXTENSION OF AN EXISTING GAS POOL

COUNTY Eddy POOL Hoag Tank-Morrow Gas

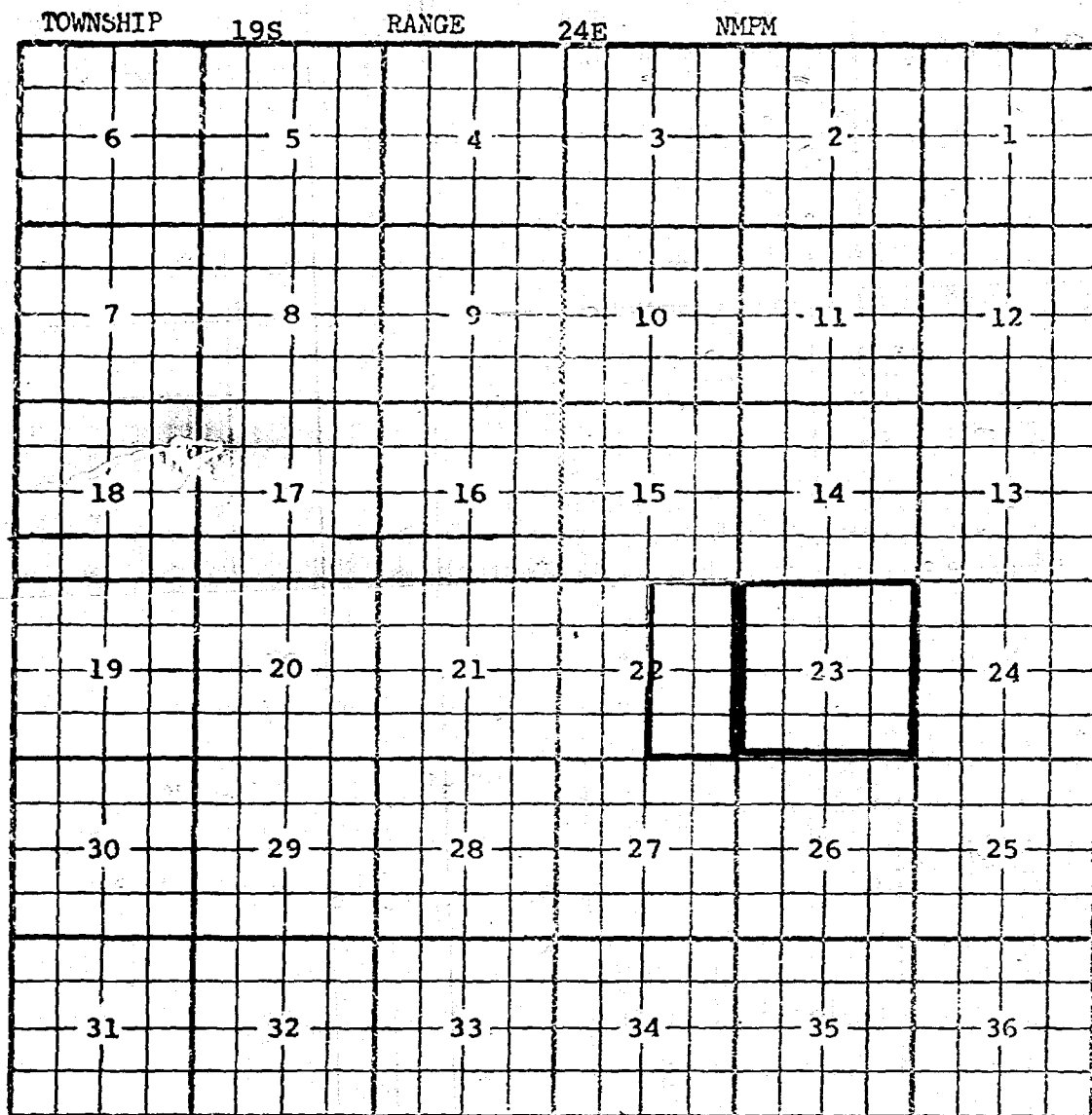

Purpose: One completed gas well capable of producing.

Operator	Lease	#&Ut.	S.T.R.	Comp.	Form.	TOP
Yates Pet. Corp.	Roden Fed. GD	1-I	23-19-24	7-2-76	Morrow	8883'

Pool boundary outlined in red.

Proposed extension outlined in blue.

Section 23: ALL

CASE NO. 5788 (u) EXTENSION OF AN EXISTING OIL POOL

COUNTY LEA POOL MIDDLE LYNCH-YATES, SEVEN RIVERS

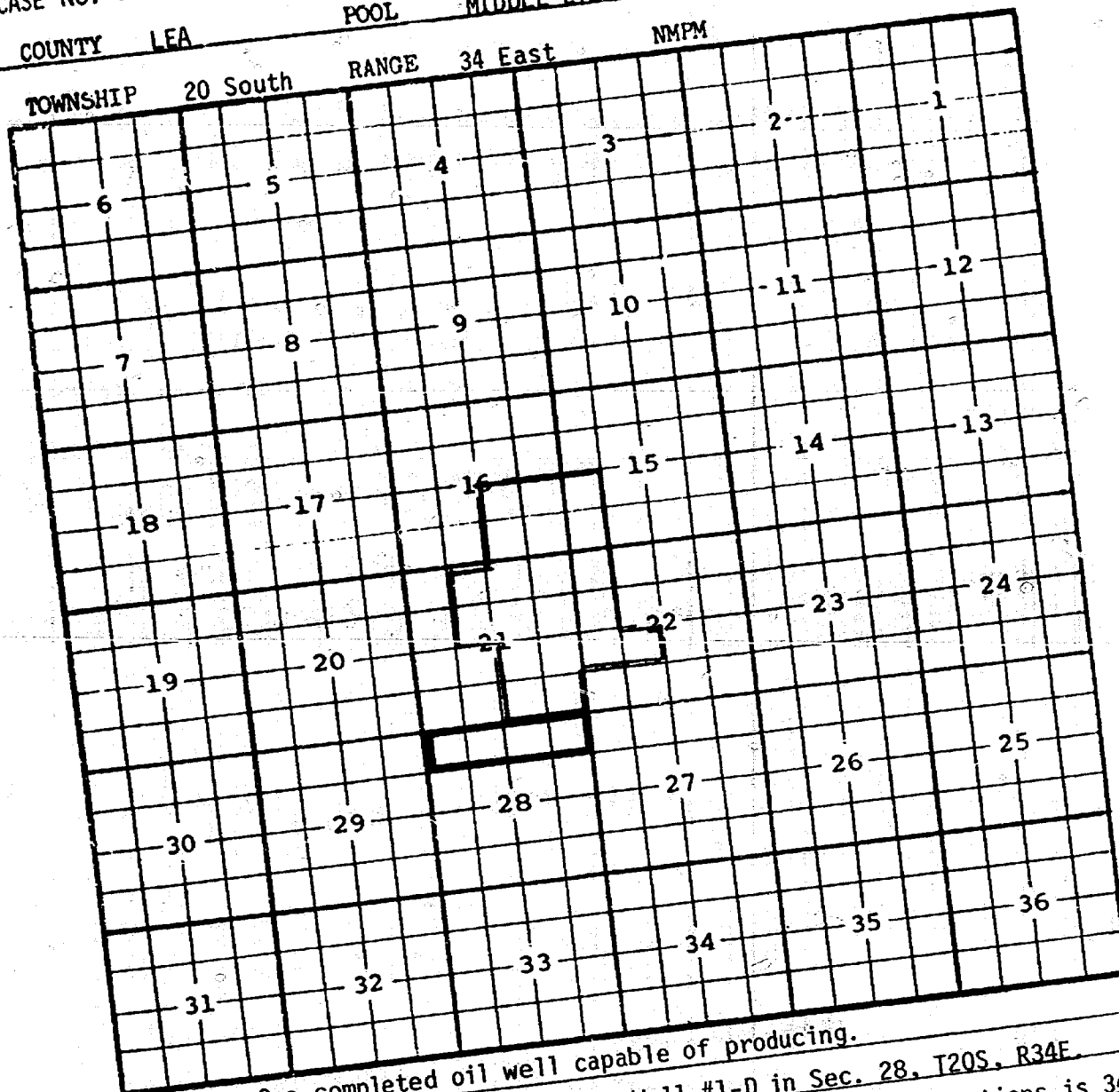

Purpose: One completed oil well capable of producing.
Wallen Production Company Wallen Fee Well #1-D in Sec. 28, T20S, R34E.
Completed May 27, 1976 in the Yates formation. Top of perforations is 3492'.

Pool boundary outlined in red.
Proposed pool extension outlined in green. SECTION 28: N/2 N/2

CASE NO. 5788 (v) EXTENSION OF AN EXISTING OIL POOL

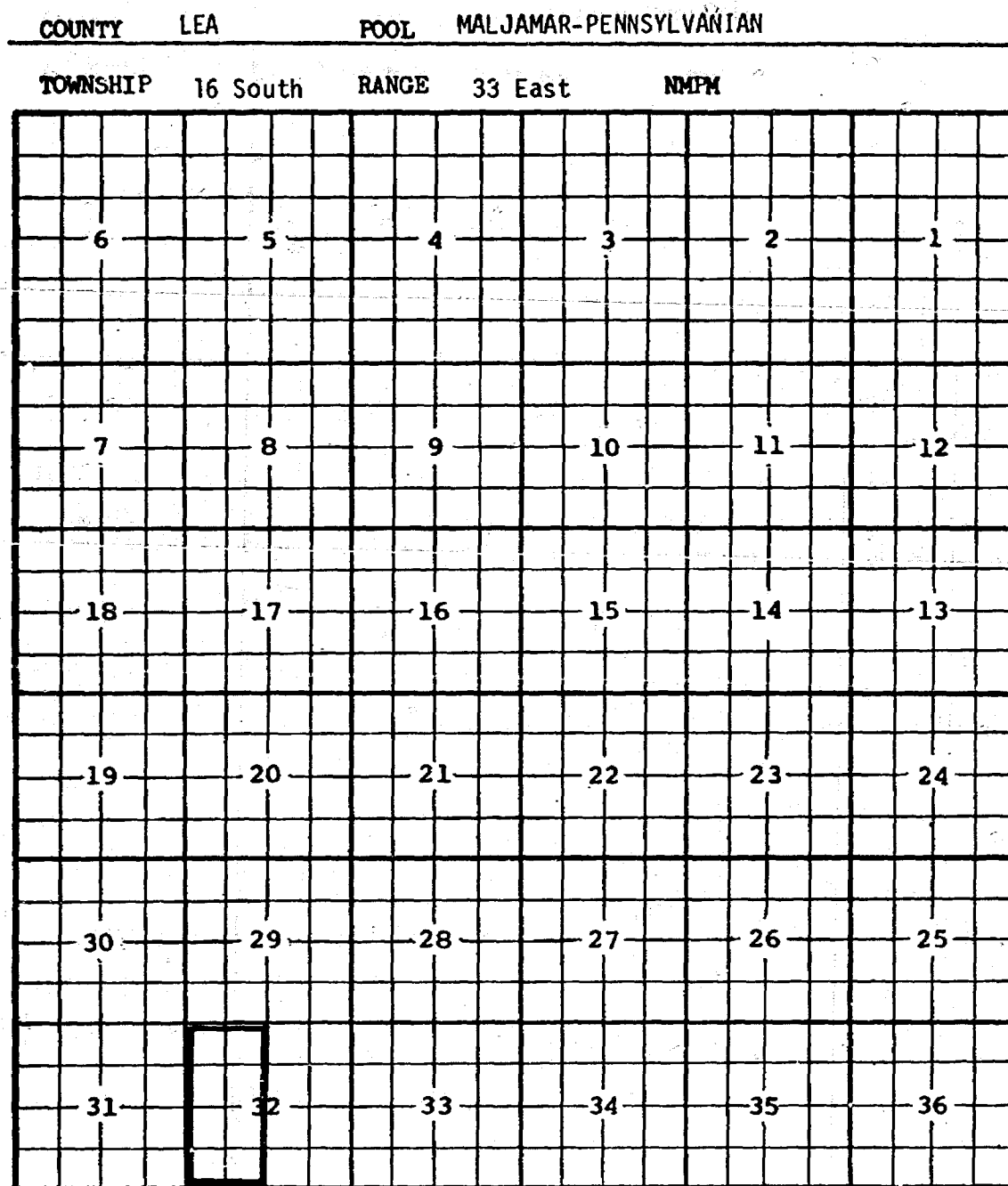

PURPOSE: One completed oil well capable of producing.
 Western Oil Producers, Inc. Union State Well #1-E in Sec. 32, T16S, R33E.
 Completed August 10, 1976, in the Pennsylvanian formation. Top of the
 perforations is 11,509 feet.

Pool boundary outlined in red.

Proposed pool extension outlined in green. SECTION 32: W/2

TO BE DISMISSED BECAUSE PROPOSED EXTENSION
 INCLUDED IN PROVISIONS OF ORDER NO. R-5296

CASE NO. 5788 (w) EXTENSION TO AN EXISTING ASSOCIATED POOL

COUNTY ROOSEVELT POOL PETERSON-PENNSYLVANIAN ASSOCIATED

TOWNSHIP 5 South RANGE 33 East NMPM

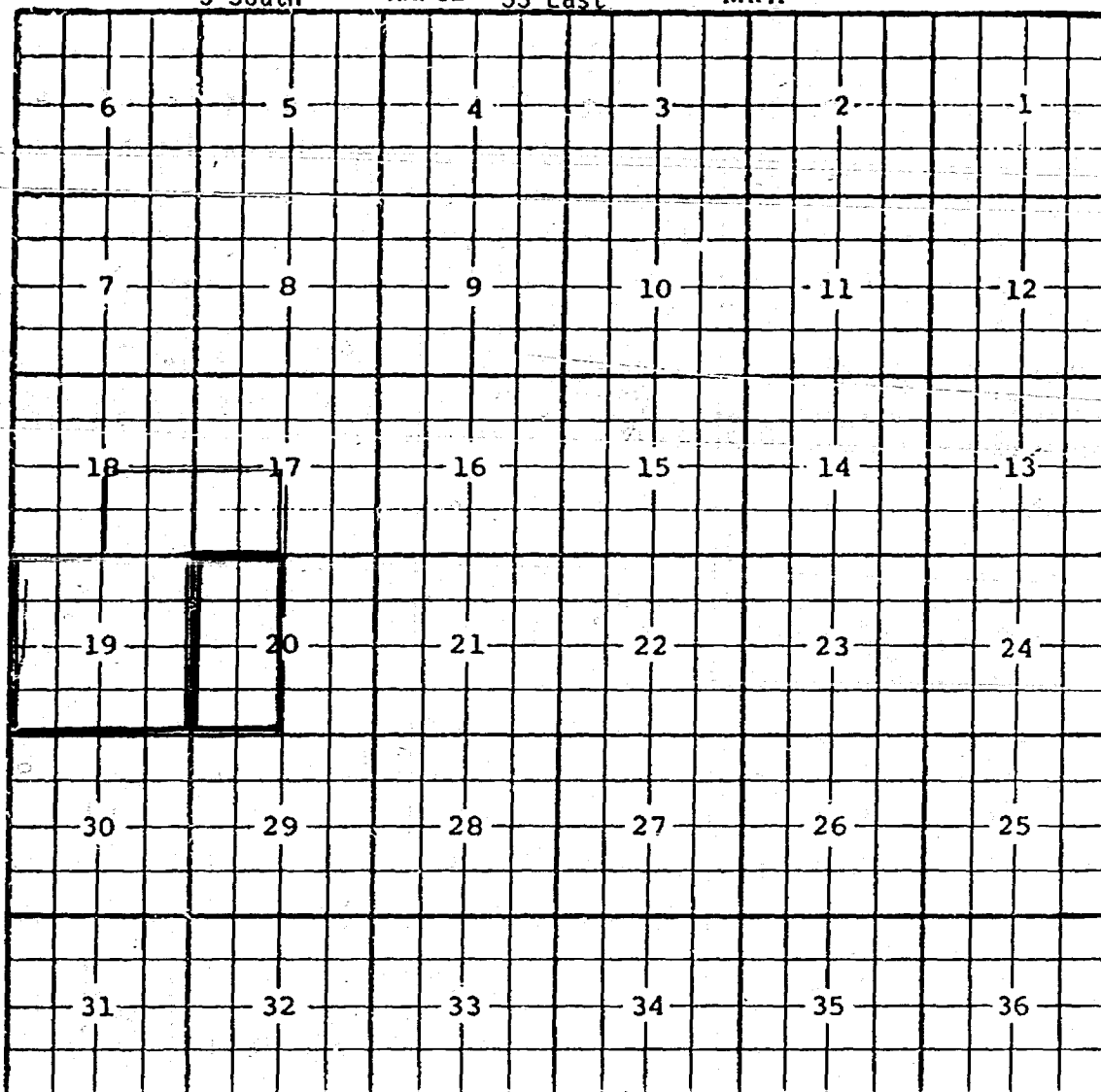

PURPOSE: Two completed oil wells capable of producing.

Amoco Production Company Swearingen "B" Well #3-L Sec. 20-5-33. Completed in the Pennsylvanian formation on April 2, 1976. Top of perf 7740 feet.

ADDITION----- Amoco Production Co. Swearingen "B" #4-E Sec. 20-5-33. Completed in the Pennsylvanian formation on September 28, 1976. Top of perfs 7756 feet.

Pool boundary outlined in red.

Proposed pool extensions outlined in green. SECTION 20: SW/4

ADDITION ----- SECTION 20: NW/4

CASE NO. 5788 (x) EXTENSION OF AN EXISTING OIL POOL

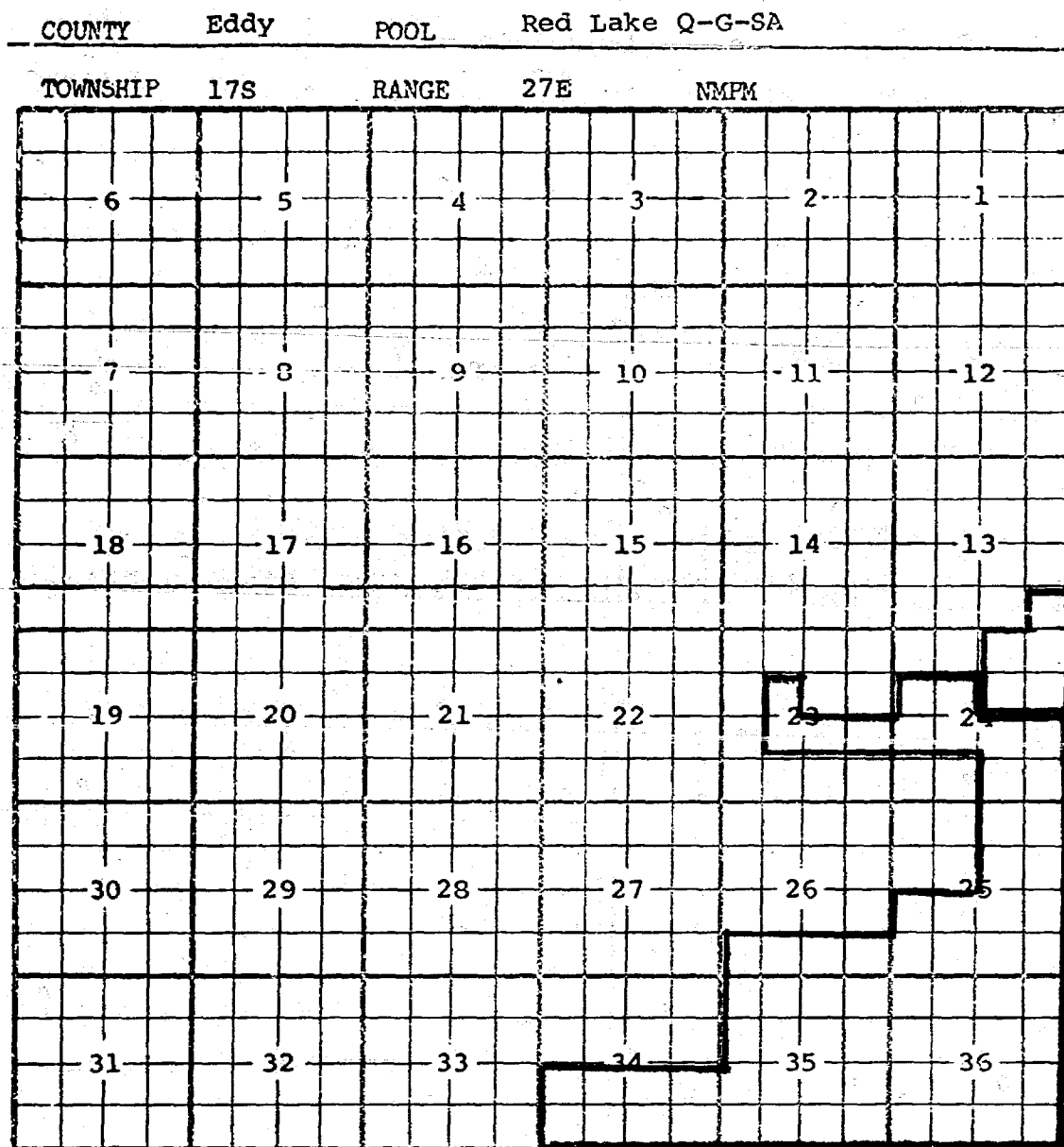

Purpose: One completed oil well capable of producing.

Operator	Lease	#&Ut.	S.T.R.	Comp.	Form.	TOP
C.E.LaRue & B.N.Muncy, Jr.	Saunders	9-P	13-17-27	6-25-76	Gb.	1638'

Pool boundary outlined in red.

Proposed extension outlined in blue.

Section 13: SE/4 SE/4

Section 24: NE/4

CASE NO. 5788 (y) EXTENSION OF AN EXISTING GAS POOL

COUNTY LEA POOL SAWYER-SAN ANDRES GAS

TOWNSHIP 9 South RANGE 37 East NMPM

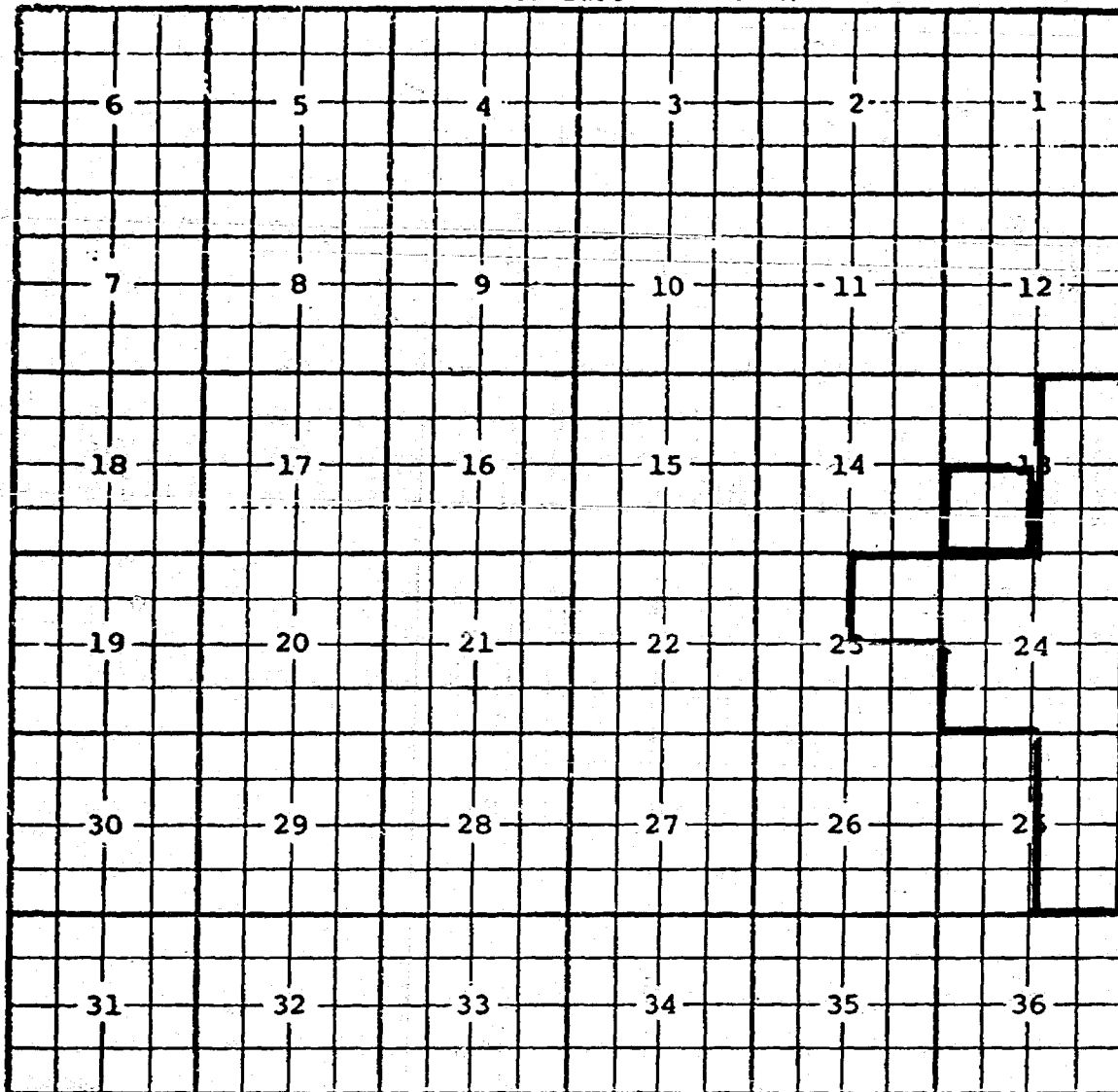

PURPOSE: One completed oil located in a gas pool capable of producing. Flag-Redfern Oil Company Brown "84" well #2-M in Section 13, T9S, R37E. Completed August 25, 1976, in the San Andres formation. Top of perforations is 4914 feet.

Pool boundary outlined in red.

Proposed pool extension outlined in green. SECTION 13: SW/4

CASE NO. 5788 (z) EXTENSION OF AN EXISTING OIL POOL

COUNTY Eddy POOL Shugart Y-SR-Q-G

TOWNSHIP 18S RANGE 31E NMFM

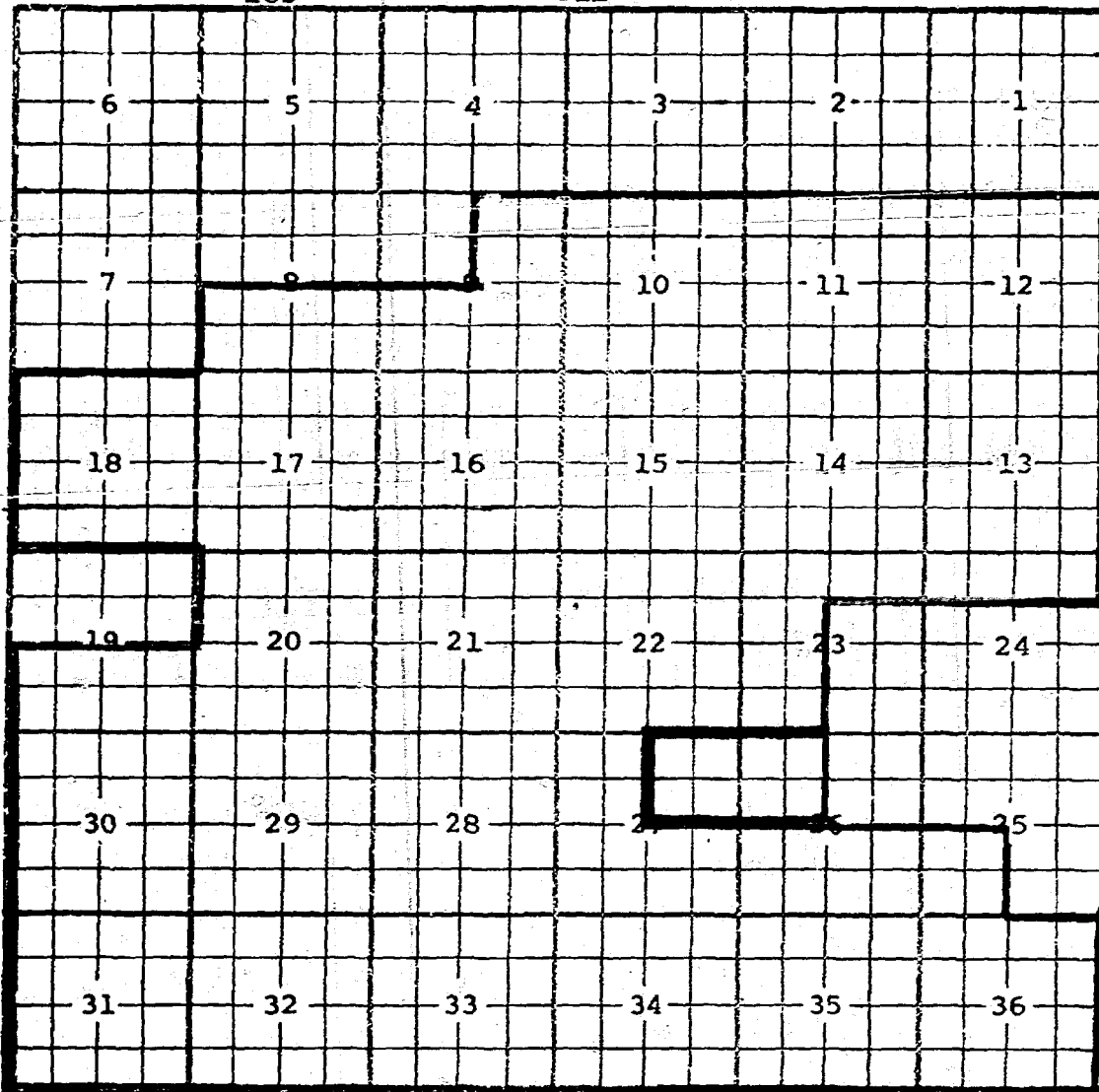

Purpose: One completed oil well capable of producing.

Operator	Lease	#&Ut.	S.T.R.	Comp.	Form.	TOP
Westall-Mask	Hinkle B Fed.	8-D	26-18-31	5-20-76	Queen	3280'

Pool boundary outlined in red.

Proposed extension outlined in blue.

Section 26: NW/4

Section 27: NE/4

CASE NO. 5788 (aa) EXTENSION OF AN EXISTING GAS POOL

COUNTY LEA POOL VACUUM-QUEEN GAS

TOWNSHIP 17 South RANGE 34 East NMPM

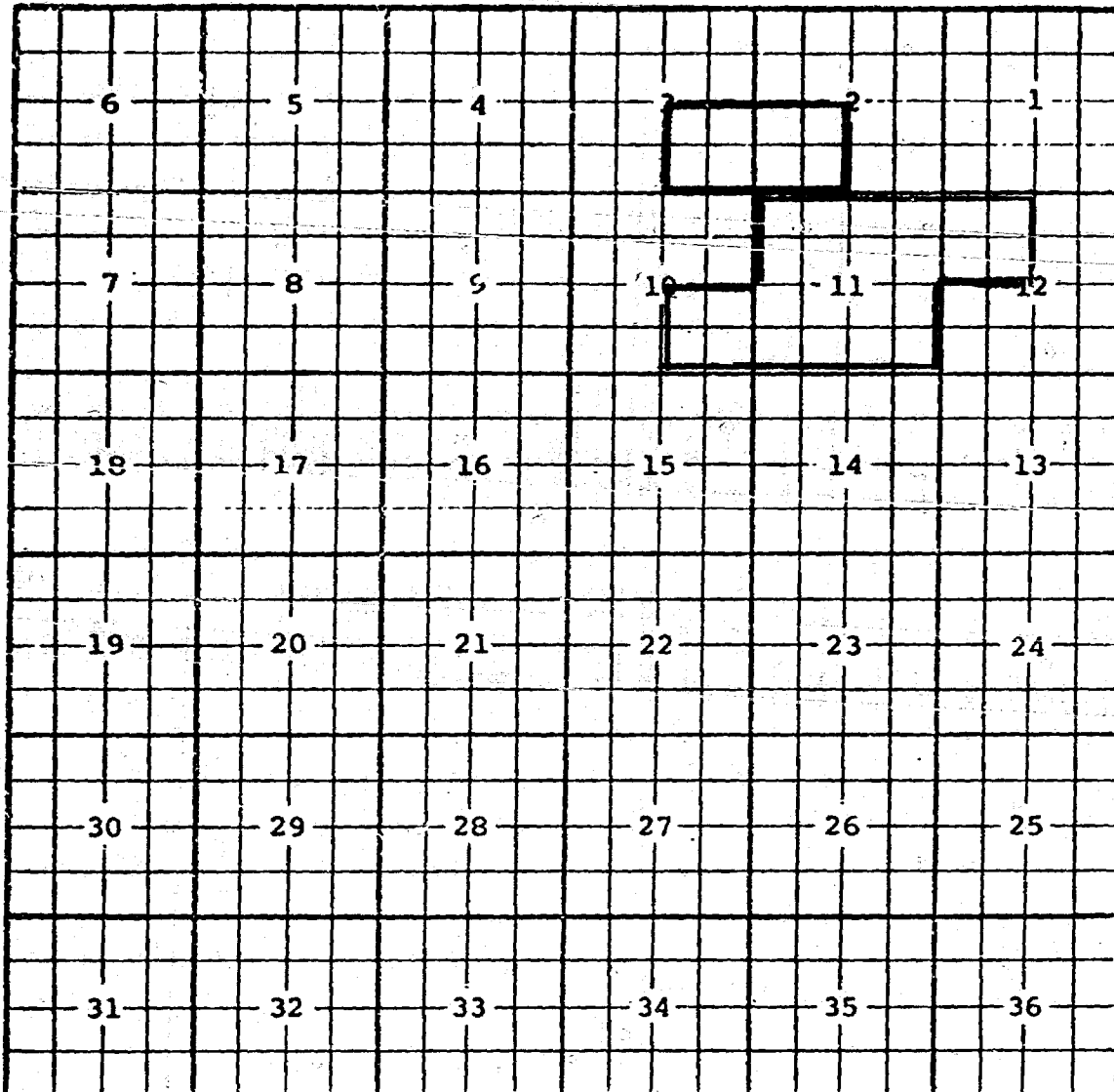

Purpose: One completed gas well capable of producing.
 Mobil Oil Corporation Bridges State Well #86-P in Sec. 3, T17S, R34E.
 Completed April 19, 1976, in the Queen formation. Top of perforations is
 3902 feet.

Pool boundary outlined in red.
 Proposed pool extension outlined in green. SECTION 2: SW/4
 SECTION 3: SE/4

sid morish reporting service

General Court Reporting Service
825 Calle Mejia, No. 122, Santa Fe, New Mexico 87501
Phone (305) 982-9212

Page 1

BEFORE THE
NEW MEXICO OIL CONSERVATION COMMISSION
Santa Fe, New Mexico
October 13, 1976

EXAMINER HEARING

IN THE MATTER OF:

Southeastern New Mexico nomenclature
case calling for the creation, contrac-
tion, extension and abolishment of
certain pools in Lea, Eddy and
Roosevelt Counties, New Mexico.

CASE
5788

BEFORE: Richard L. Stamets, Examiner

TRANSCRIPT OF HEARING

A P P E A R A N C E S

For the New Mexico Oil
Conservation Commission:

Lynn Teschendorf
Law Clerk for the Commission
State Land Office Building
Santa Fe, New Mexico

sid morrison reporting service
General Court Reporting Service
825 Calle Mejia, No. 122, Santa Fe, New Mexico 87501
Phone (505) 982-9212

Page 2

I N D E X

Page

1
2
3
4
5
6
7
8
9
10
11
12
13
14
15
16
17
18
19
20
21
22
23
24
25

CARL ULVOG

3

Direct Examination by Mr. Stamets

EXHIBIT INDEX

Offered

Admitted

OCC Exhibit A, Series of Plats

4

5

1 MR. STAMETS: We will call at this time Case 5788.

2 MS. TESCHENDORF: Case 5788, Southeastern New Mexico
3 nomenclature case calling for the creation, contraction,
4 extension and abolishment of certain pools in Lea, Eddy and
5 Roosevelt Counties, New Mexico.

6 MR. STAMETS: Call for appearances in this case.

7 MR. ULVOG: Carl Ulvog, Senior Geologist for the
8 Oil Conservation Commission located here in Santa Fe.

9 MR. STAMETS: The record will reflect that Mr. Ulvog
10 has previously been sworn and is still sworn in this case.

11
12 CARL ULVOG
13 called as a witness, having been previously sworn, was
14 examined and testified as follows:

15
16 DIRECT EXAMINATION

17 BY MR. STAMETS:

18 Q Mr. Ulvog, are part of your duties with the Oil
19 Conservation Commission to present proposals for
20 creations and extensions of pools within the State of
21 New Mexico?

22 A That is correct and I also would add abolishments.

23 Q Thank you. Would you please proceed with your
24 testimony in this case?

25 A Yes, sir. We have here a proposal for creations,

1 abolishments, extensions and contractions of pools as listed
2 by the docket and as previously advertised.

3 We have an exhibit which describes the proposed
4 actions which consists of plats identified in accordance with
5 the paragraphs shown on the docket, letters (a) through
6 (z) and (aa).

7 There is only one exception to what is proposed by
8 the docket and what was proposed in the advertisement and what
9 we are proposing today and that is in the case of paragraph (h)
10 where we are proposing to eliminate that paragraph from our
11 recommendation, which is: Contract the vertical limits of
12 the Kemnitz-Pennsylvanian Pool in Lea County, New Mexico to
13 the Cisco formation only, redesignating said pool the
14 Kemnitz-Cisco Pool and redefining said pool to comprise, and
15 so on.

16 We are proposing the elimination of that paragraph
17 due to a typographical error which occurred in both the
18 advertisement and the docket. It will be readvertised.

19 MR. STAMETS: Let's go off the record a second.

20 (THEREUPON, a discussion was held
21 off the record.)

22 A. So we are also proposing to eliminate paragraph (v)
23 which is: Extend the Maljamar-Pennsylvanian Pool in Lea
24 County, New Mexico to include, and so on.

25 Otherwise there are no changes.

sid morrish reporting service

General Court Reporting Service
825 Calle Mejia, No. 122, Santa Fe, New Mexico 87501
Phone (505) 982-9212

1 Q (Mr. Stamets continuing.) For purposes of the
2 record then, you have an exhibit which you have identified
3 as Exhibit A which sets forth the creations, extensions,
4 contractions and abolishments and this exhibit is in the form
5 or sets out the same acreage as shown on the docket of this
6 case, with two exceptions that you have noted, paragraphs (h)
7 and (v)?

8 A That is correct.

9 Q And you wish to submit that exhibit?

10 A That's right.

11 MR. STAMETS: It will be admitted into the record.

12 (THEREUPON, Oil Conservation Commission
13 Exhibit A was admitted into evidence.)

14 MR. STAMETS: Are there any questions of the
15 witness? He may be excused.

16 (THEREUPON, the witness was excused.)

17 MR. STAMETS: Is there anything further in this
18 case? The case will be taken under advisement and the hearing
19 is adjourned.

20 (THEREUPON, the hearing was adjourned.)
21
22
23
24
25

sid morrison reporting service

General Court Reporting Service
825 Calle Mejia, No. 122, Santa Fe, New Mexico 87501
Phone (505) 982-9212

REPORTER'S CERTIFICATE

I, SIDNEY F. MORRISH, a Certified Shorthand Reporter,
do hereby certify that the foregoing and attached Transcript
of Hearing before the New Mexico Oil Conservation Commission
was reported by me, and the same is a true and correct record
of the said proceedings to the best of my knowledge, skill and
ability.

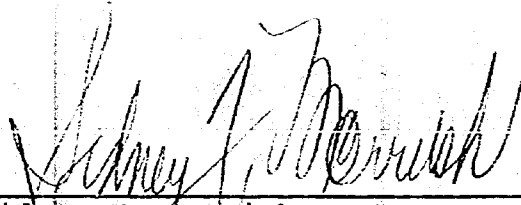
Sidney F. Morrish, C.S.R.

sid morrish reporting service
General Court Reporting Service
825 Calle Mejia, No. 122, Santa Fe, New Mexico 87501
Phone (505) 982-9212

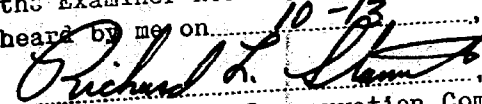
I do hereby certify that the foregoing is
a complete record of the proceedings in
the Examiner hearing of Case No. 5788
heard by me on 10-13, 1976.
 Examiner
New Mexico Oil Conservation Commission

BEFORE THE OIL CONSERVATION COMMISSION
OF THE STATE OF NEW MEXICO

IN THE MATTER OF THE HEARING
CALLED BY THE OIL CONSERVATION
COMMISSION OF NEW MEXICO FOR
THE PURPOSE OF CONSIDERING:

CASE NO. 5788
Order No. R-5309

THE APPLICATION OF THE OIL CONSERVATION
COMMISSION UPON ITS OWN MOTION FOR AN ORDER
CREATING, ABOLISHING, CONTRACTING VERTICAL
LIMITS, AND EXTENDING VERTICAL AND HORIZONTAL
LIMITS OF CERTAIN POOLS IN EDDY, LEA AND
ROOSEVELT COUNTIES, NEW MEXICO.

ORDER OF THE COMMISSION

BY THE COMMISSION:

This cause came on for hearing at 9:00 a.m. on October 13, 1976, at Santa Fe, New Mexico, before Examiner Richard L. Stamets.

NOW, on this 27th day of October, 1976, the Commission, a quorum being present, having considered the testimony, the record, and the recommendations of the Examiner, and being fully advised in the premises,

FINDS:

(1) That due public notice having been given as required by law, the Commission has jurisdiction of this cause and the subject matter thereof.

(2) That there is need for the creation of a new gas pool in Eddy County, New Mexico, for the production of gas from the Morrow formation, said pool to bear the designation of Angell Ranch-Morrow Gas Pool. Said Angell Ranch-Morrow Gas Pool was discovered by Penroc Oil Corporation Wright Federal Well No. 1, located in Unit O of Section 6, Township 20 South, Range 28 East, NMPM. It was completed in the Morrow formation on August 26, 1975. The top of the perforations is at 10,828 feet.

(3) That there is need for the creation of a new gas pool in Eddy County, New Mexico, for the production of gas from the Strawn formation, said pool to bear the designation of West Burton Flat-Strawn Gas Pool. Said West Burton Flat-Strawn Gas Pool was discovered by David Fasken El Paso Federal Well No. 3, located in Unit H of Section 1, Township 21 South, Range 26 East, NMPM. It was completed in the Strawn formation on July 15, 1976. The top of the perforations is at 9,971 feet.

(4) That there is need for the creation of a new gas pool in Roosevelt County, New Mexico, for the production of gas from the Canyon formation, said pool to bear the designation of North Chaveroo-Canyon Gas Pool. Said North Chaveroo-Canyon Gas Pool was discovered by Union Oil Company of California Roberts Well No. 1, located in Unit D of Section 9, Township 7 South, Range 33 East, NMPM. It was completed in the Canyon formation on June 2, 1976. The top of the perforations is at 8,903 feet.

(5) That there is need for the creation of a new gas pool in Eddy County, New Mexico, for the production of gas from the Morrow formation, said pool to bear the designation of Foster Ranch-Morrow Gas Pool. Said Foster Ranch-Morrow Gas Pool was discovered by Mark Production Company Foster Well No. 1, located in Unit J of Section 21, Township 20 South, Range 24 East, NMPM. It was completed in the Morrow formation on May 13, 1975. The top of the perforations is at 8,875 feet.

(6) That there is need for the creation of a new oil pool in Eddy County, New Mexico, for the production of oil from the Cherry Canyon formation, said pool to bear the designation of Nash Draw-Cherry Canyon Pool. Said Nash Draw-Cherry Canyon Pool was discovered by Mesa Petroleum Company Nash Unit Well No. 4, located in Unit A of Section 13, Township 23 South, Range 29 East, NMPM. It was completed in the Cherry Canyon formation on June 2, 1976. The top of the perforations is at 4,785 feet.

(7) That there is need for the creation of a new gas pool in Lea County, New Mexico, for the production of gas from the Strawn formation, said pool to bear the designation of Ojo Chiso-Strawn Gas Pool. Said Ojo Chiso-Strawn Gas Pool was discovered by American Quasar Petroleum Company of New Mexico Ojo Chiso Unit Well No. 1, located in Unit E of Section 23, Township 22 South, Range 34 East. It was completed in the Strawn formation on June 27, 1976. The top of the perforations is at 11,727 feet.

(8) That the proposed creation of a new gas pool in Lea County, New Mexico, for the production of gas from the Cisco formation, said pool to bear the designation of North Vacuum-Cisco Gas Pool, should be dismissed pending further study.

(9) That the proposed contraction of the vertical limits of the Kemnitz-Pennsylvanian Pool in Lea County, New Mexico, to the Cisco formation only, should be dismissed due to an error in advertising.

(10) That there is need for the contraction of the vertical limits of the Sombrero-Pennsylvanian Gas Pool in Lea County, New Mexico, to include only the Atoka formation, redesignating said Sombrero-Pennsylvanian Gas Pool as the Sombrero-Atoka Gas Pool, and redefining the horizontal limits of said pool to include Great Western Drilling Company State "13" Well No. 1, located in Unit P

-3-

Case No. 5788
Order No. R-5309

of Section 13, Township 16 South, Range 33 East, NMPM. It was completed in the Atoka formation on November 12, 1975. The top of the perforations is at 12,660 feet.

(11) That there is need for the abolishment of the East Shugart-Queen Pool in Lea County, New Mexico, acreage will be included in the Watkins Yates - Seven Rivers-Queen-Grayburg Pool.

(12) That there is need for the abolishment of the Watkins-Seven Rivers Pool in Eddy and Lea Counties, New Mexico, acreage in Eddy County, New Mexico will be included in the Shugart Yates-Seven Rivers-Queen-Grayburg Pool, and the acreage in Lea County, New Mexico will be included in the Watkins Yates-Seven Rivers-Queen-Grayburg Pool.

(13) That there is need for the extension of the vertical limits of the Watkins-Grayburg Pool in Lea County, New Mexico, to include the Yates, Seven Rivers and Queen formations, redesignating said pool the Watkins Yates-Seven Rivers-Queen-Grayburg Pool and redefining the horizontal limits of said pool.

(14) That there is need for certain extensions to the Burton Flat-Morrow Gas Pool, the North Burton Flat-Wolfcamp Gas Pool, the South Carlsbad-Morrow Gas Pool, the North Dagger Draw-Upper Pennsylvanian Pool, the Dayton-San Andres Pool, the East Empire Yates-Seven Rivers Pool, the Hoag Tank-Morrow Gas Pool, the Red Lake Queen-Grayburg-San Andres Pool, and the Shugart Yates-Seven Rivers-Queen-Grayburg Pool, all in Eddy County, New Mexico, the Blinebry Oil and Gas Pool, the Middle Lynch Yates-Seven Rivers Pool, the Sawyer-San Andres Gas Pool, and the Vacuum-Queen Gas Pool, all in Lea County, New Mexico, and the Peterson-Pennsylvanian Associated Pool in Roosevelt County, New Mexico.

(15) That the proposed extension to the Maljamar-Pennsylvanian Pool in Lea County, New Mexico, should be dismissed due to previous action by Oil Conservation Commission Order No. R-5296.

IT IS THEREFORE ORDERED:

(a) That a new pool in Eddy County, New Mexico, classified as a gas pool for Morrow production, is hereby created and designated as the Angell Ranch-Morrow Gas Pool, consisting of the following described area:

TOWNSHIP 20 SOUTH, RANGE 28 EAST, NMPM
Section 6: All

(b) That a new pool in Eddy County, New Mexico, classified as a gas pool for Strawn production, is hereby created and designated as the West Burton Flat-Strawn Gas Pool, consisting of the following described area:

TOWNSHIP 21 SOUTH, RANGE 26 EAST, NMPM
Section 1: Lots 1 through 8

-4-

Case No. 5788
Order No. R-5309

(c) That a new pool in Roosevelt County, New Mexico, classified as a gas pool for Canyon production, is hereby created and designated as the North Chaveroo-Canyon Gas Pool, consisting of the following described area:

TOWNSHIP 7 SOUTH, RANGE 33 EAST, NMPM
Section 9: W/2

(d) That a new pool in Eddy County, New Mexico, classified as a gas pool for Morrow production, is hereby created and designated as the Foster Ranch-Morrow Gas Pool, consisting of the following described area:

TOWNSHIP 20 SOUTH, RANGE 24 EAST, NMPM
Section 21: E/2

(e) That a new pool in Eddy County, New Mexico, classified as an oil pool for Cherry Canyon production, is hereby created and designated as the Nash Draw-Cherry Canyon Pool, consisting of the following described area:

TOWNSHIP 23 SOUTH, RANGE 29 EAST, NMPM
Section 13: NE/4

(f) That a new pool in Lea County, New Mexico, classified as a gas pool for Strawn production, is hereby created and designated as the Ojo Chiso-Strawn Gas Pool, consisting of the following described area:

TOWNSHIP 22 SOUTH, RANGE 34 EAST, NMPM
Section 23: W/2

(g) That the proposed creation of a new gas pool in Lea County, New Mexico, for Cisco production is hereby dismissed.

(h) That the proposed contraction of the vertical limits of the Kemnitz-Pennsylvanian Pool in Lea County, New Mexico, is hereby dismissed.

(i) That the vertical limits of the Sombrero-Pennsylvanian Gas Pool in Lea County, New Mexico, are hereby contracted to include only the Atoka formation and said Sombrero-Pennsylvanian Gas Pool is hereby redesignated the Sombrero-Atoka Gas Pool, consisting of the following described area:

TOWNSHIP 16 SOUTH, RANGE 33 EAST, NMPM
Section 12: W/2
Section 13: W/2 and SE/4

(j) That the East Shugart-Queen Pool in Lea County, New Mexico, consisting of the following described area:

TOWNSHIP 19 SOUTH, RANGE 32 EAST, NMPM
Section 6: NE/4

-5-
Case No. 5788
Order No. R-5309

is hereby abolished.

(k) That the Watkins-Seven Rivers Pool in Eddy and Lea Counties, New Mexico, consisting of the following described area:

TOWNSHIP 18 SOUTH, RANGE 31 EAST, NMPM
Section 36: E/2

TOWNSHIP 18 SOUTH, RANGE 32 EAST, NMPM
Section 31: All

TOWNSHIP 19 SOUTH, RANGE 32 EAST, NMPM
Section 6: N/2

is hereby abolished.

(l) That the vertical limits of the Watkins-Grayburg Pool in Lea County, New Mexico, are hereby extended to include the Yates, Seven Rivers, and Queen formations and said Watkins-Grayburg Pool is redesignated the Watkins Yates-Seven Rivers-Queen-Grayburg Pool, consisting of the following described area:

TOWNSHIP 18 SOUTH, RANGE 32 EAST, NMPM
Section 31: NW/4 and S/2

TOWNSHIP 19 SOUTH, RANGE 32 EAST, NMPM
Section 6: N/2

(m) That the Blinebry Oil and Gas Pool in Lea County, New Mexico, as heretofore classified, defined, and described, is hereby extended to include therein:

TOWNSHIP 22 SOUTH, RANGE 37 EAST, NMPM
Section 21: S/2 SE/4
Section 28: N/2 NE/4 and NE/4 NW/4

TOWNSHIP 22 SOUTH, RANGE 38 EAST, NMPM
Section 18: SE/4

(n) That the Burton Flat-Morrow Gas Pool in Eddy County, New Mexico, as heretofore classified, defined, and described, is hereby extended to include therein:

TOWNSHIP 21 SOUTH, RANGE 26 EAST, NMPM
Section 1: S/2

(o) That the North Burton Flats-Wolfcamp Gas Pool in Eddy County, New Mexico, as heretofore classified, defined, and described, is hereby extended to include therein:

TOWNSHIP 20 SOUTH, RANGE 28 EAST, NMPM
Section 10: W/2
Section 15: W/2
Section 16: E/2

-6-

Case No. 5788
Order No. R-5309

(p) That the South Carlsbad-Morrow Gas Pool in Eddy County, New Mexico, as heretofore classified, defined, and described, is hereby extended to include therein:

TOWNSHIP 22 SOUTH, RANGE 27 EAST, NMPM
Section 20: E/2

TOWNSHIP 24 SOUTH, RANGE 26 EAST, NMPM
Section 3: W/2

(q) That the North Dagger Draw-Upper Pennsylvanian Pool in Eddy County, New Mexico, as heretofore classified, defined, and described, is hereby extended to include therein:

TOWNSHIP 19 SOUTH, RANGE 25 EAST, NMPM
Section 30: SE/4

(r) That the Dayton-San Andres Pool in Eddy County, New Mexico, as heretofore classified, defined, and described, is hereby extended to include therein:

TOWNSHIP 18 SOUTH, RANGE 26 EAST, NMPM
Section 26: SW/4 and E/2 NW/4

(s) That the East Empire Yates-Seven Rivers Pool in Eddy County, New Mexico, as heretofore classified, defined, and described, is hereby extended to include therein:

TOWNSHIP 17 SOUTH, RANGE 28 EAST, NMPM
Section 27: NE/4 and N/2 NW/4
Section 28: SE/4 NE/4

(t) That the Hoag Tank-Morrow Gas Pool in Eddy County, New Mexico, as heretofore classified, defined, and described, is hereby extended to include therein:

TOWNSHIP 19 SOUTH, RANGE 24 EAST, NMPM
Section 23: All

(u) That the Middle Lynch Yates-Seven Rivers Pool in Lea County, New Mexico, as heretofore classified, defined, and described, is hereby extended to include therein:

TOWNSHIP 20 SOUTH, RANGE 34 EAST, NMPM
Section 28: N/2 N/2

(v) That the proposed extension to the Maljamar-Pennsylvanian Pool in Lea County, New Mexico, is hereby dismissed.

(w) That the Peterson-Pennsylvanian Associated Pool in Roosevelt County, New Mexico, as heretofore classified, defined, and described, is hereby extended to include therein:

-7-
Case No. 5788
Order No. R-5309

TOWNSHIP 5 SOUTH, RANGE 33 EAST, NMPM
Section 20: W/2

(x) That the Red Lake Queen-Grayburg-San Andres Pool in Eddy County, New Mexico, as heretofore classified, defined, and described, is hereby extended to include therein:

TOWNSHIP 17 SOUTH, RANGE 27 EAST, NMPM
Section 13: SE/4 SE/4
Section 24: NE/4

(y) That the Sawyer-San Andres Gas Pool in Lea County, New Mexico, as heretofore classified, defined, and described is hereby extended to include therein:

TOWNSHIP 9 SOUTH, RANGE 37 EAST, NMPM
Section 13: SW/4

(z) That the Shugart Pool in Eddy County, New Mexico, as heretofore classified, defined, and described is hereby extended to include therein:

TOWNSHIP 18 SOUTH, RANGE 31 EAST, NMPM
Section 26: NW/4
Section 27: NE/4

(aa) That the Vacuum-Queen Gas Pool in Lea County, New Mexico, as heretofore classified, defined, and described is hereby extended to include therein:

TOWNSHIP 17 SOUTH, RANGE 34 EAST, NMPM
Section 2: SW/4
Section 3: SE/4

IT IS FURTHER ORDERED:

(1) That, pursuant to Section 65-3-14.5, NMSA 1953, contained in Chapter 271, Laws of 1969, any well which, by virtue of any of the above pool extensions, is subject to pool rules providing for spacing or proration units larger than the one which is presently dedicated thereto, shall have 60 days from the effective date of this order in which to file new Forms C-102 dedicating a standard unit for the pool to said well, or to obtain a non-standard unit approved by the Commission. Pending such compliance, the well shall receive a maximum allowable in the same proportion to a standard allowable for the pool that the acreage dedicated to the well bears to a standard unit for the pool. Failure to file Form C-102 dedicating a standard unit to the well or to obtain a non-standard unit approved by the Commission within said 60-day period shall subject the well to cancellation of allowable.

-8-

Case No. 5788
Order No. R-5309

(2) That the effective date of this order and all creations, contractions, abolishments, and extensions included herein shall be November 1, 1976.

DONE at Santa Fe, New Mexico, on the day and year hereinabove designated.

STATE OF NEW MEXICO
OIL CONSERVATION COMMISSION

PHIL R. LUCERO, Chairman



EMERY C. ARNOLD, Member

JOE D. RAMEY, Member & Secretary

S E A L

jr/

Docket No. 27-76

Dockets Nos. 29-76 and 30-76 are tentatively set for hearing on October 27 and November 10, 1976. Applications for hearing must be filed at least 22 days in advance of hearing date.

DOCKET: EXAMINER HEARING - WEDNESDAY - OCTOBER 13, 1976

9 A.M. - OIL CONSERVATION COMMISSION CONFERENCE ROOM,
STATE LAND OFFICE BUILDING, SANTA FE, NEW MEXICO

The following cases will be heard before Richard L. Stamets, Examiner, or Daniel S. Rutter, Alternate Examiner:

- ALLOWABLE: (1) Consideration of the allowable production of gas for November, 1976, from seventeen prorated pools in Lea, Eddy, Chaves, and Roosevelt Counties, New Mexico.
- (2) Consideration of the allowable production of gas for November, 1976, from four prorated pools in San Juan, Rio Arriba, and Sandoval Counties, New Mexico.

CASE 5773: (Continued from September 29, 1976, Examiner Hearing)

Application of Yates Petroleum Corporation for a unit agreement, Eddy County, New Mexico. Applicant, in the above-styled cause, seeks approval for the North Millman Unit Area comprising 2,017 acres, more or less, of State lands in Township 19 South, Range 28 East, Eddy County, New Mexico.

CASE 5783: Application of Palmer Oil and Gas Company for an unorthodox gas well location and a non-standard proration unit, Rio Arriba County, New Mexico. Applicant, in the above-styled cause, seeks approval for a 335.66-acre non-standard proration unit, comprising all of Sections 6 and 7, Township 26 North, Range 2 West, Blanco Mesa Verde Pool, Rio Arriba County, New Mexico, to be dedicated to a well to be drilled at an unorthodox location 1850 feet from the South line and 700 feet from the West line of said Section 7.

CASE 5784: Application of Atlantic Richfield Company for four unorthodox locations and simultaneous dedication, Lea County, New Mexico. Applicant, in the above-styled cause, seeks authority to simultaneously dedicate a previously approved 320-acre Jalmat gas proration unit comprising the NW/4, SW/4 NE/4, E/2 NE/4, NE/4 SE/4 of Section 35, Township 23 South, Range 36 East, Jalmat Gas Pool, Lea County, New Mexico, to its John P. Combest Wells Nos. 1, 2, 3, and 4 located at unorthodox locations in Units H, G, A, and E, respectively, of said Section 35.

CASE 5785: Application of Doyle Hartman for compulsory pooling, Lea County, New Mexico. Applicant, in the above-styled cause, seeks an order pooling all mineral interests in the Seven Rivers-Queen formation underlying the NE/4 NE/4, NW/4 NE/4, SW/4 NE/4, and SE/4 NE/4 of Section 19, Township 24 South, Range 37 East, Langlie-Mattix Pool, Lea County, New Mexico, to form four 40-acre proration units to be dedicated to four oil wells to be drilled at standard locations on said tracts. Also to be considered will be the cost of drilling and completing said wells and the allocation of the cost thereof, as well as actual operating costs and charges for supervision. Also to be considered will be the designation of applicant as operator of the wells and a charge for risk involved in drilling said wells.

CASE 5786: Application of Texaco Inc. for a waterflood project, Lea County, New Mexico. Applicant, in the above-styled cause, seeks authority to institute a waterflood project on its New Mexico "BZ" State Lease, Langlie-Mattix Pool, Lea County, New Mexico, by the injection of water into the Seven Rivers-Queen formation through seven injection wells located in Unit L of Section 15 and Units B, D, F, H, J, and P of Section 16, Township 23 South, Range 37 East.

CASE 5787: Application of Boyd Operating Company for a waterflood project, Eddy County, New Mexico. Applicant, in the above-styled cause, seeks authority to institute a waterflood project in the Grayburg-Jackson Pool, Eddy County, New Mexico, by the injection of water into the Grayburg-San Andres formation through its Robinson Well No. 8 located in Unit N of Section 25 and its Brinson Wells Nos. 2 and 3 located, respectively, in Units A and G of Section 36, Township 16 South, Range 31 East, Eddy County, New Mexico. Applicant further seeks an administrative procedure for expansion of the project by approval of additional injection and production wells at orthodox and unorthodox locations.

CASE 5574: (Reopened)

In the matter of Case 5574, being reopened pursuant to the provisions of Order No. R-5118 which order established a temporary special depth bracket allowable of 750 barrels of oil per day for the Eagle Mesa-Entrada Oil Pool, Sandoval County, New Mexico. All interested parties may appear and show cause why said special depth bracket allowable should not be rescinded.

CASE 5780: In the matter of the hearing called by the Oil Conservation Commission on its own motion to permit Northwest Production Corporation, Federal Insurance Company, and all other interested parties to appear and show cause why the Blanco 30-12 Well No. 1, located in Unit A of Section 4, Township 30 North, Range 12 West, San Juan County, New Mexico, should not be plugged and abandoned in accordance with a Commission-approved plugging program.

CASE 5781: In the matter of the hearing called by the Oil Conservation Commission on its own motion to permit Petroleum Development Corporation, American Employers Insurance Company, and all other interested parties to appear and show cause why the San Luis Federal Well No. 1, located in Unit J of Section 21, Township 18 North, Range 3 West, Sandoval County, New Mexico, should not be plugged and abandoned in accordance with a Commission-approved plugging program.

CASE 5782: In the matter of the hearing called by the Oil Conservation Commission on its own motion to permit U. S. Frigidice, Inc., Fireman's Fund Indemnity Company, and all other interested parties to appear and show cause why the U. S. Frigidice Well No. 1, Clyde Berlier (Kayser), located in Unit A of Section 14, Township 19 North, Range 21 East, Mora County, New Mexico, should not be plugged and abandoned in accordance with a Commission-approved plugging program.

CASE 5788: Southeastern New Mexico nomenclature case calling for the creation, contraction, extension and abolishment of certain pools in Lea, Eddy, and Roosevelt Counties, New Mexico:

a) CREATE a new pool in Eddy County, New Mexico, classified as a gas pool for Morrow production and designated as the Angell Ranch-Morrow Gas Pool. The discovery well is the Penroc Oil Corporation Wright Federal Well No. 1 located in Unit O of Section 6, Township 20 South, Range 28 East, NMPM. Said pool would comprise:

TOWNSHIP 20 SOUTH, RANGE 28 EAST, NMPM
Section 6: All

b) CREATE a new pool in Eddy County, New Mexico, classified as a gas pool for Strawn production and designated as the West Burton Flat-Strawn Gas Pool. The discovery well is the David Fasken El Paso Federal Well No. 3 located in Unit H of Section 1, Township 21 South, Range 26 East, NMPM. Said pool would comprise:

TOWNSHIP 21 SOUTH, RANGE 26 EAST, NMPM
Section 1: Lots 1 through 8

c) CREATE a new pool in Roosevelt County, New Mexico, classified as a gas pool for Canyon production and designated as the North Chaveroo-Canyon Gas Pool. The discovery well is the Union Oil Company of California Roberts Well No. 1, located in Unit D of Section 9, Township 7 South, Range 33 East, NMPM. Said pool would comprise:

TOWNSHIP 7 SOUTH, RANGE 33 EAST, NMPM
Section 9: W/2

d) CREATE a new pool in Eddy County, New Mexico, classified as a gas pool for Morrow production and designated as the Foster Ranch-Morrow Gas Pool. The discovery well is the Mark Production Company Foster Well No. 1 located in Unit J of Section 21, Township 20 South, Range 24 East, NMPM. Said pool would comprise:

TOWNSHIP 20 SOUTH, RANGE 24 EAST, NMPM
Section 21: E/2

e) CREATE a new pool in Eddy County, New Mexico, classified as an oil pool for Cherry Canyon production and designated as the Nash Draw Cherry-Canyon Pool. The discovery well is the Mesa Petroleum Company Nash Unit Well No. 4 located in Unit A of Section 13, Township 23 South, Range 29 East, NMPM. Said pool would comprise:

TOWNSHIP 23 SOUTH, RANGE 29 EAST, NMPM
Section 13: NE/4

f) CREATE a new pool in Lea County, New Mexico, classified as a gas pool for Strawn production and designated as the Ojo Chiso-Strawn Gas Pool. The discovery well is the American Quasar Petroleum Company of New Mexico Ojo Chiso Unit Well No. 1, located in Unit E of Section 23, Township 22 South, Range 34 East, NMPM. Said pool would comprise:

TOWNSHIP 22 SOUTH, RANGE 34 EAST, NMPM
Section 23: W/2

g) CREATE a new pool in Lea County, New Mexico, classified as a gas pool for Cisco production and designated as the North Vacuum-Cisco Gas Pool. The discovery well is the Marathon Oil

Company State Section 7 Com Well No. 1, located in Unit G of Section-7, Township 17 South, Range 35 East, NMPM. Said pool would comprise:

TOWNSHIP 17 SOUTH, RANGE 35 EAST, NMPM
Section 7: E/2

h) CONTRACT the vertical limits of the Kemnitz-Pennsylvanian Pool in Lea County, New Mexico, to the Cisco formation only, redesignating said pool the Kemnitz-Cisco Pool and redefining said pool to comprise:

TOWNSHIP 16 SOUTH, RANGE 33 EAST, NMPM
Section 13: N/2 and SE/4

i) CONTRACT the vertical limits of the Sombbrero-Pennsylvanian Gas Pool in Lea County, New Mexico, to the Atoka formation only, redesignating said pool the Sombbrero-Atoka Gas Pool and redefining said pool to comprise:

TOWNSHIP 16 SOUTH, RANGE 33 EAST, NMPM
Section 12: W/2
Section 13: W/2 and SE/4

j) ABOLISH the East Shugart-Queen Pool in Lea County, New Mexico, described as:

TOWNSHIP 19 SOUTH, RANGE 32 EAST, NMPM
Section 6: NE/4

k) ABOLISH the Watkins-Seven Rivers Pool in Eddy and Lea Counties, New Mexico, described as:

TOWNSHIP 18 SOUTH, RANGE 31 EAST, NMPM
Section 36: E/2

TOWNSHIP 18 SOUTH, RANGE 32 EAST, NMPM
Section 31: All

TOWNSHIP 19 SOUTH, RANGE 32 EAST, NMPM
Section 6: N/2

l) EXTEND the vertical limits of the Watkins-Grayburg Pool in Lea County, New Mexico, to include the Yates, Seven Rivers, and Queen formations, redesignating said pool the Watkins Yates-Seven Rivers-Queen-Grayburg Pool and redefining said pool to comprise:

TOWNSHIP 18 SOUTH, RANGE 31 EAST, NMPM
Section 31: NW/4 and S/2

TOWNSHIP 19 SOUTH, RANGE 32 EAST, NMPM
Section 6: N/2

m) EXTEND the Blinebry Oil and Gas Pool in Lea County, New Mexico, to include therein:

TOWNSHIP 22 SOUTH, RANGE 38 EAST, NMPM
Section 18: SE/4

n) EXTEND the Burton Flat-Morrow Gas Pool in Eddy County, New Mexico, to include therein:

TOWNSHIP 21 SOUTH, RANGE 26 EAST, NMPM
Section 1: S/2

o) EXTEND the North Burton Flats-Wolfcamp Gas Pool in Eddy County, New Mexico, to include therein:

TOWNSHIP 20 SOUTH, RANGE 28 EAST, NMPM
Section 10: W/2
Section 15: W/2
Section 16: E/2

p) EXTEND the South Carlsbad-Morrow Gas Pool in Eddy County, New Mexico, to include therein:

TOWNSHIP 22 SOUTH, RANGE 27 EAST, NMPM
Section 20: E/2

TOWNSHIP 24 SOUTH, RANGE 26 EAST, NMPM
Section 3: W/2

- q) EXTEND the North Dagger Draw-Upper Pennsylvanian Pool in Eddy County, New Mexico, to include therein:

TOWNSHIP 19 SOUTH, RANGE 25 EAST, NMPM
Section 30: SE/4

- r) EXTEND the Dayton-San Andres Pool in Eddy County, New Mexico, to include therein:

TOWNSHIP 18 SOUTH, RANGE 26 EAST, NMPM
Section 26: SW/4

- s) EXTEND the East Empire Yates-Seven Rivers Pool in Eddy County, New Mexico, to include therein:

TOWNSHIP 17 SOUTH, RANGE 28 EAST, NMPM
Section 27: NE/4 and N/2 NW/4

- t) EXTEND the Hoag Tank-Morrow Gas Pool in Eddy County, New Mexico, to include therein:

TOWNSHIP 19 SOUTH, RANGE 24 EAST, NMPM
Section 23: All

- u) EXTEND the Middle Lynch Yates -Seven Rivers Pool in Lea County, New Mexico, to include therein:

TOWNSHIP 20 SOUTH, RANGE 34 EAST, NMPM
Section 28: N/2 N/2

- v) EXTEND the Maljamar-Pennsylvanian Pool in Lea County, New Mexico, to include therein:

TOWNSHIP 16 SOUTH, RANGE 33 EAST, NMPM
Section 32: W/2

- w) EXTEND the Peterson-Pennsylvanian Associated Pool in Roosevelt County, New Mexico, to include therein:

TOWNSHIP 5 SOUTH, RANGE 33 EAST, NMPM
Section 20: SW/4

- x) EXTEND the Red Lake Queen - Grayburg - San Andres Pool in Eddy County, New Mexico, to include therein:

TOWNSHIP 17 SOUTH, RANGE 27 EAST, NMPM
Section 13: SE/4 SE/4
Section 24: NE/4

- y) EXTEND the Sawyer-San Andres Gas Pool in Lea County, New Mexico, to include therein:

TOWNSHIP 9 SOUTH, RANGE 37 EAST, NMPM
Section 13: SW/4

- z) EXTEND the Shugart Pool in Eddy County, New Mexico, to include therein:

TOWNSHIP 18 SOUTH, RANGE 31 EAST, NMPM
Section 26: NW/4
Section 27: NE/4

- aa) EXTEND the Vacuum-Queen Gas Pool in Lea County, New Mexico, to include therein:

TOWNSHIP 17 SOUTH, RANGE 34 EAST, NMPM
Section 2: SW/4
Section 3: SE/4

750
2000

Case 5788

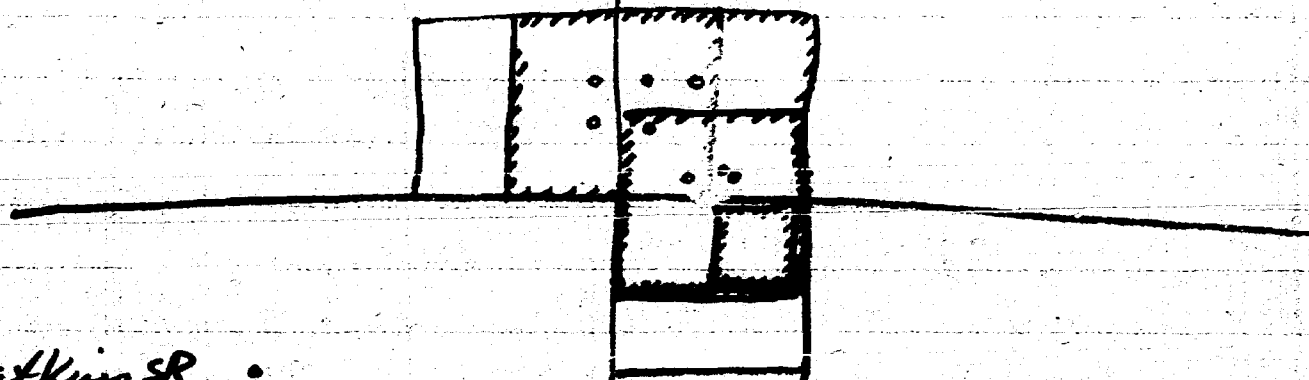

Watkins SR •

Watkins extend
to NB/4

E Shugart Que

Name
Address
Remarks:

Old Sombraero
Ph.
Penny Gas
Pool

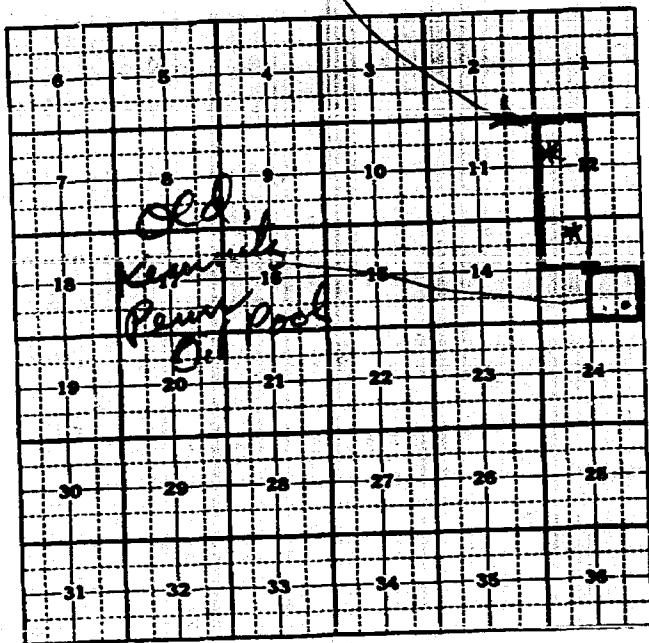

State

Name
Address
Remarks:

New
Sombraero
Atoka Gas Pool
Ph.

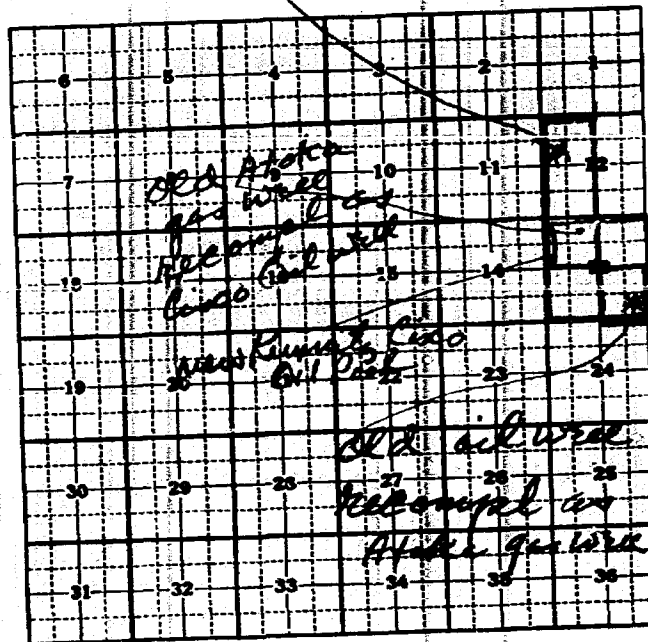

State

BEFORE THE OIL CONSERVATION COMMISSION
OF THE STATE OF NEW MEXICO

IN THE MATTER OF THE HEARING
CALLED BY THE OIL CONSERVATION
COMMISSION OF NEW MEXICO FOR
THE PURPOSE OF CONSIDERING:

CASE NO. 5788
ORDER NO. R-5309

THE APPLICATION OF THE OIL CONSERVATION
COMMISSION UPON ITS OWN MOTION FOR AN ORDER
CREATING, ABOLISHING, CONTRACTING VERTICAL
LIMITS, AND EXTENDING VERTICAL AND HORIZONTAL
LIMITS OF CERTAIN POOLS IN EDDY, LEA AND
ROOSEVELT COUNTIES, NEW MEXICO.

ORDER OF THE COMMISSION

BY THE COMMISSION:

This cause came on for hearing at 9:00 a.m. on October 13, 1976, at Santa Fe, New Mexico, before Examiner Richard L. Stanets.

NOW, on this _____ day of October, 1976, the Commission, a quorum being present, having considered the testimony, the record, and the recommendations of the Examiner, and being fully advised in the premises,

FINDS:

(1) That due public notice having been given as required by law, the Commission has jurisdiction of this cause and the subject matter thereof.

✓ (2) That there is need for the creation of a new gas pool in Eddy County, New Mexico, for the production of gas from the Morrow formation, said pool to bear the designation of Angell Ranch-Morrow Gas Pool. Said Angell Ranch-Morrow Gas Pool was discovered by Penroc Oil Corporation Wright Federal Well No. 1, located in Unit O of Section 6, Township 20 South, Range 28 East, NMPM. It was completed in the Morrow formation on August 26, 1975. The top of the perforations is at 10,828 feet.

✓ (3) That there is need for the creation of a new gas pool in Eddy County, New Mexico, for the production of gas from the Strawn formation, said pool to bear the designation of West Burton Flat-Strawn Gas Pool. Said West Burton Flat-Strawn Gas Pool was discovered by David Fasken El Paso Federal Well No. 3, located in Unit H of Section 1, Township 21 South, Range 26 East, NMPM. It was completed in the Strawn formation on July 15, 1976. The top of the perforations is at 9,971 feet.

✓ (4) That there is need for the creation of a new gas pool in Roosevelt County, New Mexico, for the production of gas from the Canyon formation, said pool to bear the designation of North Chaveroo-Canyon Gas Pool. Said North Chaveroo-Canyon Gas Pool was discovered by Union Oil Company of California Roberts Well No. 1, located in Unit D of Section 9, Township 7 South, Range 33 East, NMPM. It was completed in the Canyon formation on June 2, 1976. The top of the perforations is at 8,903 feet.

✓ (5) That there is need for the creation of a new gas pool in Eddy County, New Mexico, for the production of gas from the Morrow formation, said pool to bear the designation of Foster Ranch-Morrow Gas Pool. Said Foster Ranch-Morrow Gas Pool was discovered by Mark Production Company Foster Well No. 1, located in Unit J of Section 21, Township 20 South, Range 24 East, NMPM. It was completed in the Morrow formation on May 13, 1975. The top of the perforations is at 8,875 feet.

✓ (6) That there is need for the creation of a new oil pool in Eddy County, New Mexico, for the production of oil from the Cherry Canyon formation, said pool to bear the designation of Nash Draw-Cherry Canyon Pool. Said Nash Draw-Cherry Canyon Pool was discovered by Mesa Petroleum Company Nash Unit Well No. 4, located in Unit A of Section 13, Township 23 South, Range 29 East, NMPM. It was completed in the Cherry Canyon formation on June 2, 1976. The top of the perforations is at 4,785 feet.

✓ (7) That there is need for the creation of a new gas pool in Lea County, New Mexico, for the production of gas from the Strawn formation, said pool to bear the designation of Ojo Chiso-Strawn Gas Pool. Said Ojo Chiso-Strawn Gas Pool was discovered by American Quasar Petroleum Company of New Mexico Ojo Chiso Unit Well No. 1, located in Unit E of Section 23, Township 22 South, Range 34 East. It was completed in the Strawn formation on June 27, 1976. The top of the perforations is at 11,727 feet.

- (8) That the proposed creation of a new gas pool in Lea County, New Mexico, for the production of gas from the Cisco formation, said pool to bear the designation of North Vacuum - Cisco Gas Pool, should be dismissed pending further study.
- (9) That the proposed contraction of the vertical limits of the ^{Kennedy-}~~Kennedy~~ Pennsylvanian Pool in Lea County, New Mexico, to the Cisco formation only, should be dismissed due to an error in advertising.

East, NMPM. It was completed in the Atoka formation on November 12, 1975. The top of the perforations is at 12,660 feet.

- ✓ (11) That there is need for the abolishment of the East Shugart-Queen Pool in Lea County, New Mexico, acreage will be included in the Watkins Yates - Seven Rivers - Queen - Grayburg Pool.
- ✓ (12) That there is need for the abolishment of the Watkins-Seven Rivers Pool in Eddy and Lea Counties, New Mexico, acreage in Eddy County, New Mexico will be included in the Shugart Yates - Seven Rivers - Queen - Grayburg Pool, and the acreage in Lea County, New Mexico will be included in the Watkins Yates - Seven Rivers - Queen - Grayburg Pool.
- ✓ (13) That there is need for the extension of the vertical limits of the Watkins-Grayburg Pool in Lea County, New Mexico, to include the Yates, Seven Rivers and Queen formations, redesignating said pool the Watkins Yates - Seven Rivers - Queen - Grayburg Pool and redefining the horizontal limits of said pool.
- (14) That there is need for certain extensions to the Burton Flat-Morrow Gas Pool, the North Burton Flat-Wolfcamp Gas Pool, the South Carlsbad-Morrow Gas Pool, the North Dagger Draw-Upper Pennsylvanian Pool, the Dayton-San Andres Pool, the East Empire Yates-Seven Rivers Pool, the Hoag Tank-Morrow Gas Pool, the Red Lake Queen-Grayburg-San Andres Pool, and the Shugart-Yates-Seven Rivers-Queen-Grayburg Pool, all in Eddy County, New Mexico, the Blinebry Oil and Gas Pool, the Middle Lynch-Yates-Seven Rivers Pool, ~~the Maljamar-Pennsylvanian Pool~~, the Sawyer-San Andres Gas Pool, and the Vacuum-Queen Gas Pool, all in Lea County, New Mexico, and the Peterson-Pennsylvanian Associated Pool in Roosevelt County, New Mexico.

(15) That the proposed extension to the Maljamar-Pennsylvanian Pool in Lea County, New Mexico, should be dismissed due to previous action by Oil Conservation Commission Order No. R-5296.

Str
Gas

TOWNSHIP 21 SOUTH, RANGE 26 EAST, NMPM
Section 1: Lots 1 through 8

(c) That a new pool in Roosevelt County, New Mexico, classified as a gas pool for Canyon production, is hereby created and designated as the North Chaveroo-Canyon Gas Pool, consisting of the following described area:

TOWNSHIP 7 SOUTH, RANGE 33 EAST, NMPM
Section 9: W/2

✓ (d) That a new pool in Eddy County, New Mexico, classified as a gas pool for Morrow production, is hereby created and designated as the Foster Ranch-Morrow Gas Pool, consisting of the following described area:

TOWNSHIP 20 SOUTH, RANGE 24 EAST, NMPM
Section 21: E/2

✓ (e) That a new pool in Eddy County, New Mexico, classified as an oil pool for Cherry Canyon production, is hereby created and designated as the Nash Draw-Cherry Canyon Pool, consisting of the following described area:

TOWNSHIP 23 SOUTH, RANGE 29 EAST, NMPM
Section 13: NE/4

✓ (f) That a new pool in Lea County, New Mexico, classified as a gas pool for Strawn production, is hereby created and designated as the Ojo Chiso-Strawn Gas Pool, consisting of the following described area:

TOWNSHIP 22 SOUTH, RANGE 34 EAST, NMPM
Section 23: W/2

(g) That the proposed creation of a new gas pool in Lea County, New Mexico, for Cinco production is hereby dismissed.

II (h) That the proposed contraction of the vertical limits of the Kermity-Pennsylvanian Pool in Lea County, New Mexico, is hereby dismissed.

TOWNSHIP 16 SOUTH, RANGE 33 EAST, NMPM
Section 13: N/2 and SE/4

✓ (i) That the vertical limits of the Sombrero-Pennsylvanian Gas Pool in Lea County, New Mexico, are hereby contracted to include only the Atoka formation and said Sombrero-Pennsylvanian Gas Pool is hereby redesignated the Sombrero-Atoka Gas Pool, consisting of the following described area:

TOWNSHIP 16 SOUTH, RANGE 33 EAST, NMPM
Section 12: W/2
Section 13: W/2 and SE/4

✓ (j) That the East Shugart-Queen Pool in Lea County, New Mexico, consisting of the following described area:

TOWNSHIP 19 SOUTH, RANGE 32 EAST, NMPM
Section 6: NE/4

is hereby abolished.

✓ (k) That the Watkins-Seven Rivers Pool in Eddy and Lea Counties, New Mexico, consisting of the following described area:

TOWNSHIP 18 SOUTH, RANGE 31 EAST, NMPM
Section 36: E/2

TOWNSHIP 18 SOUTH, RANGE 32 EAST, NMPM
Section 31: All

TOWNSHIP 19 SOUTH, RANGE 32 EAST, NMPM
Section 6: N/2

is hereby abolished.

✓ (l) That the vertical limits of the Watkins-Grayburg Pool in Lea County, New Mexico, are hereby extended to include the Yates, Seven Rivers, and Queen formations and said Watkins-Grayburg Pool is redesignated the Watkins Yates-Seven Rivers-Queen-Grayburg Pool, consisting of the following described area:

TOWNSHIP 18 SOUTH, RANGE 32 EAST, NMPM
Section 31: NW/4 and S/2

TOWNSHIP 19 SOUTH, RANGE 32 EAST, NMPM
Section 6: N/2

CASE NO. 5788
ORDER NO. _____

(m) That the Blinbry Oil and Gas Pool in Lea County, New Mexico, as heretofore classified, defined, and described, is hereby extended to include therein:

TOWNSHIP 22 SOUTH, RANGE 37 EAST, NMPM
Section 21: S/2 SE/4
Section 28: N/2 NE/4 and NE/4 NW/4

TOWNSHIP 22 SOUTH, RANGE 38 EAST, NMPM
Section 18: SE/4

(n) That the Burton Flat-Morrow Gas Pool in Eddy County, New Mexico, as heretofore classified, defined, and described, is hereby extended to include therein:

TOWNSHIP 21 SOUTH, RANGE 26 EAST, NMPM
Section 1: S/2

(o) That the North Burton Flats-Wolfcamp Gas Pool in Eddy County, New Mexico, as heretofore classified, defined, and described, is hereby extended to include therein:

TOWNSHIP 20 SOUTH, RANGE 28 EAST, NMPM
Section 10: W/2
Section 15: W/2
Section 16: E/2

(p) That the South Carlsbad-Morrow Gas Pool in Eddy County, New Mexico, as heretofore classified, defined, and described, is hereby extended to include therein:

TOWNSHIP 22 SOUTH, RANGE 27 EAST, NMPM
Section 20: E/2

TOWNSHIP 24 SOUTH, RANGE 26 EAST, NMPM
Section 3: W/2

(q) That the North Dagger Draw-Upper Pennsylvanian Pool in Eddy County, New Mexico, as heretofore classified, defined, and described, is hereby extended to include therein:

TOWNSHIP 19 SOUTH, RANGE 25 EAST, NMPM
Section 30: SE/4

(r) That the Dayton-San Andres Pool in Eddy County, New Mexico, as heretofore classified, defined, and described, is hereby extended to include therein:

TOWNSHIP 18 SOUTH, RANGE 26 EAST, NMPM
Section 26: SW/4 and E/2 NW/4

(s) That the East Empire-Yates-Seven Rivers Pool in Eddy County, New Mexico, as heretofore classified, defined, and described, is hereby extended to include therein:

TOWNSHIP 17 SOUTH, RANGE 28 EAST, NMPM
Section 27: NE/4 and N/2 NW/4
Section 28: SE/4 NE/4

(t) That the Hoag Tank-Morrow Gas Pool in Eddy County, New Mexico, as heretofore classified, defined, and described, is hereby extended to include therein:

TOWNSHIP 19 SOUTH, RANGE 24 EAST, NMPM
Section 23: All

(u) That the Middle Lynch Yates-Seven Rivers Pool in Lea County, New Mexico, as heretofore classified, defined, and described, is hereby extended to include therein:

TOWNSHIP 20 SOUTH, RANGE 34 EAST, NMPM
Section 28: N/2 N/2

proposed extension to the
(v) That the ~~Maljamar-Pennsylvanian Pool in Lea County, New Mexico, as heretofore~~
~~classified, defined, and described, is hereby extended to include therein:~~

dismissed.
TOWNSHIP 16 SOUTH, RANGE 33 EAST, NMPM
Section 32: W/2

TO BE
DISMISSED

-5-
CASE NO. 5788
ORDER NO. _____

(w) That the Peterson-Pennsylvanian Associated Pool in Roosevelt County, New Mexico, as heretofore classified, defined, and described, is hereby extended to include therein:

TOWNSHIP 5 SOUTH, RANGE 33 EAST, NMPM
Section 20: W/2

(x) That the Red Lake Queen-Grayburg-San Andres Pool in Eddy County, New Mexico, as heretofore classified, defined, and described, is hereby extended to include therein:

TOWNSHIP 17 SOUTH, RANGE 27 EAST, NMPM
Section 13: SE/4 SE/4
Section 24: NE/4

(y) That the Sawyer-San Andres Gas Pool in Lea County, New Mexico, as heretofore classified, defined, and described is hereby extended to include therein:

TOWNSHIP 9 SOUTH, RANGE 37 EAST, NMPM
Section 13: SW/4

(z) That the Shugart Pool in Eddy County, New Mexico, as heretofore classified, defined, and described is hereby extended to include therein:

TOWNSHIP 18 SOUTH, RANGE 31 EAST, NMPM
Section 26: NW/4
Section 27: NE/4

(aa) That the Vacuum-Queen Gas Pool in Lea County, New Mexico, as heretofore classified, defined, and described is hereby extended to include therein:

TOWNSHIP 17 SOUTH, RANGE 34 EAST, NMPM
Section 2: SW/4
Section 3: SE/4

IT IS FURTHER ORDERED:

(1) That, pursuant to Section 65-3-14.5, NMSA 1953, contained in Chapter 271, Laws of 1969, any well which, by virtue of any of the above pool extensions, is subject to pool rules providing for spacing or proration units larger than the one which is presently dedicated thereto, shall have 60 days from the effective date of this order in which to file new Forms C-102 dedicating a standard unit for the pool to said well, or to obtain a non-standard unit approved by the Commission. Pending such compliance, the well shall receive a maximum allowable in the same proportion to a standard allowable for the pool that the acreage dedicated to the well bears to a standard unit for the pool. Failure to file Form C-102 dedicating a standard unit to the well or to obtain a non-standard unit approved by the Commission within said 60-day period shall subject the well to cancellation of allowable.

(2) That the effective date of this order and all creations, contractions, abolishments, and extensions included herein shall be November 1, 1976.

DONE at Santa Fe, New Mexico, on the day and year hereinabove designated.

STATE OF NEW MEXICO
OIL CONSERVATION COMMISSION

PHIL R. LUCERO, Chairman

EMERY C. ARNOLD, Member

JOE D. RAMEY, Member & Secretary

S E A L