

CASE 2661: Application of PAN AMER.
for a triple completion of its
SOUTHLAND ROYALTY "A" WELL NO. 2.

-asa//o.

2661

plication, Transcript,
and Exhibits, Etc.

DRAFT

JMD/esr
October 19, 1962

BEFORE THE OIL CONSERVATION COMMISSION
OF THE STATE OF NEW MEXICO

IN THE MATTER OF THE HEARING
CALLED BY THE OIL CONSERVATION
COMMISSION OF NEW MEXICO FOR
THE PURPOSE OF CONSIDERING:

CASE No. 2661

Order No. R-2343

APPLICATION OF PAN AMERICAN PETROLEUM
CORPORATION FOR A TRIPLE COMPLETION,
LEA COUNTY, NEW MEXICO.

ORDER OF THE COMMISSION

BY THE COMMISSION:

This cause came on for hearing at 9 o'clock a.m. on
October 10, 1962, at Santa Fe, New Mexico, before Daniel S. Nutter,
Examiner duly appointed by the Oil Conservation Commission of New
Mexico, hereinafter referred to as the "Commission," in accordance
with Rule 1214 of the Commission Rules and Regulations.

NOW, on this _____ day of October, 1962, the Commission,
a quorum being present, having considered the application, the
evidence adduced, and the recommendations of the Examiner,
Daniel S. Nutter, and being fully advised in the premises,

FINDS:

(1) That due public notice having been given as required by
law, the Commission has jurisdiction of this cause and the subject
matter thereof.

(2) That the applicant, Pan American Petroleum Corporation,
is the owner and operator of the Southland Royalty "A" Well No. 2,
located in Unit B of Section 9, Township 21 South, Range 37 East,
NMPM, Lea County, New Mexico.

(3) That the applicant seeks permission to complete said
Southland Royalty "A" Well No. 2 as a triple completion (conven-
tional) ~~in the Drinkard Oil Pool, Blinebry Oil Pool, and Tubb Gas~~
~~Pool~~ in such a manner as to produce oil from the Drinkard ^{oil Pool} forma-
~~tion~~ and from the Blinebry ^{oil Pool} formation through 2 3/8-inch OD tubing
and 2.0-inch OD tubing, respectively, and to produce gas from
the Tubb Gas Pool through 2.0-inch OD tubing.

(4) That the mechanics of the proposed triple completion
are feasible and in accord with good conservation practices.

(5) That approval of the subject application will neither cause waste nor impair correlative rights.

IT IS THEREFORE ORDERED:

(1) That the applicant, Pan American Petroleum Corporation, is hereby authorized to complete its Southland Royalty "A" Well No. 2, located in Unit B of Section 9, Township 21 South, Range 37 East, NMPM, Lea County, New Mexico, as a triple completion (conventional) ~~in the Drinkard Oil Pool, Blinebry Oil Pool, and Tubb Gas Pool~~ in such a manner as to produce oil from the Drinkard ^{Oil Pool} ~~forma-~~ ^{Oil Pool} ~~tion~~ and from the Blinebry ~~formation~~ through 2 3/8-inch OD tubing, and 2.0-inch tubing, respectively, and to produce gas from the Tubb Gas Pool through 2.0-inch OD tubing.

PROVIDED HOWEVER, That the applicant shall complete, operate, and produce said well in accordance with the provisions of Rule 112-A of the Commission Rules and Regulations.

PROVIDED FURTHER, That the operator shall take packer-leakage tests upon completion and annually thereafter during the Gas-Oil Ratio Test Period for the Drinkard Oil Pool, and at such other times as the Secretary-Director of the Commission may prescribe.

(2) That jurisdiction of this cause is retained for the entry of such further orders as the Commission may deem necessary.

DONE at Santa Fe, New Mexico, on the day and year hereinabove designated.

PAN AMERICAN PETROLEUM CORPORATION

10 P. O. Box 268
Lubbock, Texas
September 11, 1962

Case 2661

File: WJS-3452-986.510.1

Subject: Application For Permission To
Triple Complete The Pan American
Petroleum Corporation -
Southland Royalty "A" Well No. 2
In The Drinkard (Oil)-Tubb (Gas)-
Blinebry (Oil) Pools Of Lea
County, New Mexico

Mr. A. L. Porter, Jr.
Secretary Director
New Mexico Oil Conservation Commission
P. O. Box 871
Santa Fe, New Mexico

Dear Sir:

In accordance with the provisions in Statewide Rule No. 112, Pan American Petroleum Corporation respectfully requests that you schedule for an early docket a hearing to consider its application for permission to triple complete the subject well in the pools specified above. As shown on the attached plat, this well is located in Unit "B" of Section 9, T-21-S, R-37-E, Lea County, ~~New~~ Mexico.

Southland Royalty "A" No. 2 is presently completed as a dual Drinkard (Oil)-Tubb (Gas) well. Authority to dual complete in these zones was granted by the Commission's Order No. DC-59 dated January 22, 1954. Pan American now proposes to also complete this well in the Blinebry (Oil) zone. This completion will be a "conventional" completion utilizing separate strings of tubing to produce each of the three horizons. The well presently has 7-inch casing set at 6740'. Packers will be utilized to effect separation of the three zones in the well bore.

In support of this application we enclose herewith three copies of State Form "Application For Multiple Completion", and a plat showing the location of the well.

DOCKET MAILED

Date 9/28/62 *QR*

Mr. A. L. Porter, Jr.

-2-

File: WJS-3452-986.510.1

The Southland Royalty "A" Lease is offset by properties operated by Continental Oil Company, Western Oil Fields, Inc., Texaco, Inc., Shell Oil Company, and Humble Oil and Refining Company. Copies of this application are being furnished these operators.

By separate correspondence Pan American is applying for permission to triple complete its South Mattix Unit No. 14 in the Fowler Paddock (Gas)-Fowler Blinbry (Oil) and Tubb (Gas) Undesignated Pools. We request that both of these applications be scheduled on the same examiner hearing docket in order that they may be handled at the same hearing.

Yours very truly,

A. J. Inderrieden
A. J. Inderrieden
District Engineer

WJS:lm

Enclosures

cc: Continental Oil Company
Western Oil Fields, Inc.
Texaco, Inc.
Shell Oil Company
Humble Oil and Refining Company

NEW MEXICO OIL CONSERVATION COMMISSION

SANTA FE, NEW MEXICO

5-1-61

APPLICATION FOR MULTIPLE COMPLETION

Operator Pan American Petroleum Corporation		County Lea	Date September 11, 1962
Address Box 268, Lubbock, Texas		Lease Southland Royalty "A"	Well No. 2
Location of Well	Unit "B"	Section 9	Township 21 South
			Range 37 East

1. Has the New Mexico Oil Conservation Commission heretofore authorized the multiple completion of a well in these same pools or in the same zones within one mile of the subject well? YES _____ NO X
2. If answer is yes, identify one such instance: Order No. _____; Operator, Lease, and Well No.:

3. The following facts are submitted:	Upper Zone	Intermediate Zone	Lower Zone
a. Name of Pool and Formation	Blinebry	Tubb	Drinkard
b. Top and Bottom of Pay Section (Perforations)	To be selected after log is run.	6330-6495	6595-6730
c. Type of production (Oil or Gas)	Oil Anticipated	Gas	Oil
d. Method of Production (Flowing or Artificial Lift)	Flow	Flow	Flow

4. The following are attached. (Please mark YES or NO)

- No a. Diagrammatic Sketch of the Multiple Completion, showing all casing strings, including diameters and setting depths, centralizers and/or turbolizers and location thereof, quantities used and top of cement, perforated intervals, tubing strings, including diameters and setting depth, location and type of packers and side door chokes, and such other information as may be pertinent.
- Yes b. Plat showing the location of all wells on applicant's lease, all offset wells on offset leases, and the names and addresses of operators of all leases offsetting applicant's lease.
- No c. Waivers consenting to such multiple completion from each offset operator, or in lieu thereof, evidence that said offset operators have been furnished copies of the application.*
- No d. Electrical log of the well or other acceptable log with tops and bottoms of producing zones and intervals of perforation indicated thereon. (If such log is not available at the time application is filed, it shall be submitted as provided by Rule 112-A.)

5. List all offset operators to the lease on which this well is located together with their correct mailing address.

Continental Oil Co., Attn: Mr. W. A. Mead, 825 Petroleum Bldg., Roswell, New Mexico

Western Oil Fields, Inc., Attn: Mr. R. H. Swarthout, Box 1147, Hobbs, New Mexico

Texaco, Inc., Attn: Mr. W. C. Lentz, Box 3109, Midland, Texas

Shell Oil Company, Attn: Mr. R. L. Rankin, Box 845, Roswell, New Mexico

Humble Oil and Refining Co., Attn: Mr. H. L. Hensley, Box 1600, Midland, Texas

6. Were all operators listed in Item 5 above notified and furnished a copy of this application? YES X NO _____. If answer is yes, give date of such notification Sept. 11, 1962.

CERTIFICATE: I, the undersigned, state that I am the Dist. Engineer of the Lubbock Dist., Pan American Petroleum Corporation (company), and that I am authorized by said company to make this report; and that this report was prepared under my supervision and direction and that the facts stated therein are true, correct and complete to the best of my knowledge.

A. J. Inderrieden Signature

- * Should waivers from all offset operators not accompany an application for administrative approval, the New Mexico Oil Conservation Commission will hold the application for a period of twenty (20) days from date of receipt by the Commission's Santa Fe office. If, after said twenty-day period, no protest nor request for hearing is received by the Santa Fe office, the application will then be processed.
- NOTE: If the proposed multiple completion will result in an unorthodox well location and/or a non-standard perforation unit in either or both of the producing zones, then separate application for approval of the same should be filed simultaneously with this application.

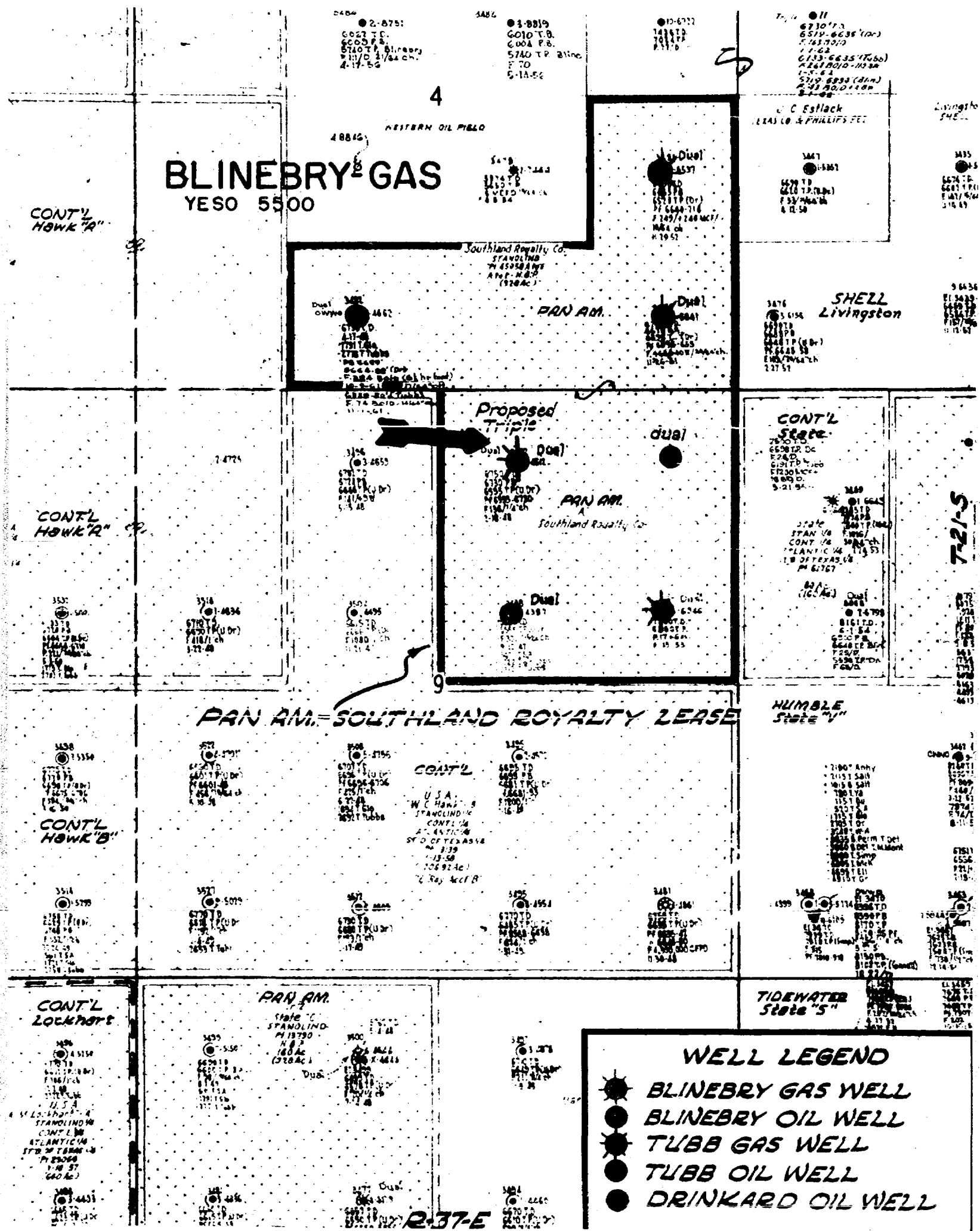

NEW MEXICO OIL CONSERVATION COMMISSION

SANTA FE, NEW MEXICO

5-1-61

APPLICATION FOR MULTIPLE COMPLETION

Operator Pan American Petroleum Corporation		County Lee		Date September 11, 1962
Address Box 268, Lubbock, Texas		Lease Southland Royalty "A"		Well No. 2
Location of Well	Unit "g"	Section 9	Township 21 South	Range 37 East

1. Has the New Mexico Oil Conservation Commission heretofore authorized the multiple completion of a well in these same pools or in the same zones within one mile of the subject well? YES _____ NO X
2. If answer is yes, identify one such instance: Order No. _____ ; Operator, Lease, and Well No.:

3. The following facts are submitted:	Upper Zone	Intermediate Zone	Lower Zone
a. Name of Pool and Formation	Blinberry	Tubb	Brinkard
b. Top and Bottom of Pay Section (Perforations)	To be selected after log is run.	6330-6495	6595-6730
c. Type of production (Oil or Gas)	Oil Anticipated	Gas	Oil
d. Method of Production (Flowing or Artificial Lift)	Flow	Flow	Flow

4. The following are attached. (Please mark YES or NO)

- No a. Diagrammatic Sketch of the Multiple Completion, showing all casing strings, including diameters and setting depths, centralizers and/or turbolizers and location thereof, quantities used and top of cement, perforated intervals, tubing strings, including diameters and setting depth, location and type of packers and side door chokes, and such other information as may be pertinent.
- Yes b. Plat showing the location of all wells on applicant's lease, all offset wells on offset leases, and the names and addresses of operators of all leases offsetting applicant's lease.
- No c. Waivers consenting to such multiple completion from each offset operator, or in lieu thereof, evidence that said offset operators have been furnished copies of the application.*
- No d. Electrical log of the well or other acceptable log with tops and bottoms of producing zones and intervals of perforation indicated thereon. (If such log is not available at the time application is filed, it shall be submitted as provided by Rule 112-A.)

5. List all offset operators to the lease on which this well is located together with their correct mailing address.

Continental Oil Co., Attn: Mr. W. A. Mead, 825 Petroleum Bldg., Roswell, New Mexico

Western Oil Fields, Inc., Attn: Mr. R. E. Swarthout, Box 1147, Hobbs, New Mexico

Tenneco, Inc., Attn: Mr. W. G. Lantz, Box 3109, Midland, Texas

Shell Oil Company, Attn: Mr. R. L. Zankin, Box 845, Roswell, New Mexico

Humble Oil and Refining Co., Attn: Mr. H. L. Hensley, Box 1600, Midland, Texas

6. Were all operators listed in Item 5 above notified and furnished a copy of this application? YES X NO ____ . If answer is yes, give date of such notification **Sept. 11, 1962**

CERTIFICATE: I, the undersigned, state that I am the **Dist. Engineer** of the **Lubbock Dist., Pan American Petroleum Corporation** (company), and that I am authorized by said company to make this report; and that this report was prepared under my supervision and direction and that the facts stated therein are true, correct and complete to the best of my knowledge.

A. J. Indurrieden
A. J. Indurrieden Signature

- * Should waivers from all offset operators not accompany an application for administrative approval, the New Mexico Oil Conservation Commission will hold the application for a period of twenty (20) days from date of receipt by the Commission's Santa Fe office. If, after said twenty-day period, no protest nor request for hearing is received by the Santa Fe office, the application will then be processed.
- NOTE: If the proposed multiple completion will result in an unorthodox well location and/or a non-standard proration unit in either or both of the producing zones, then separate application for approval of the same should be filed simultaneously with this application.

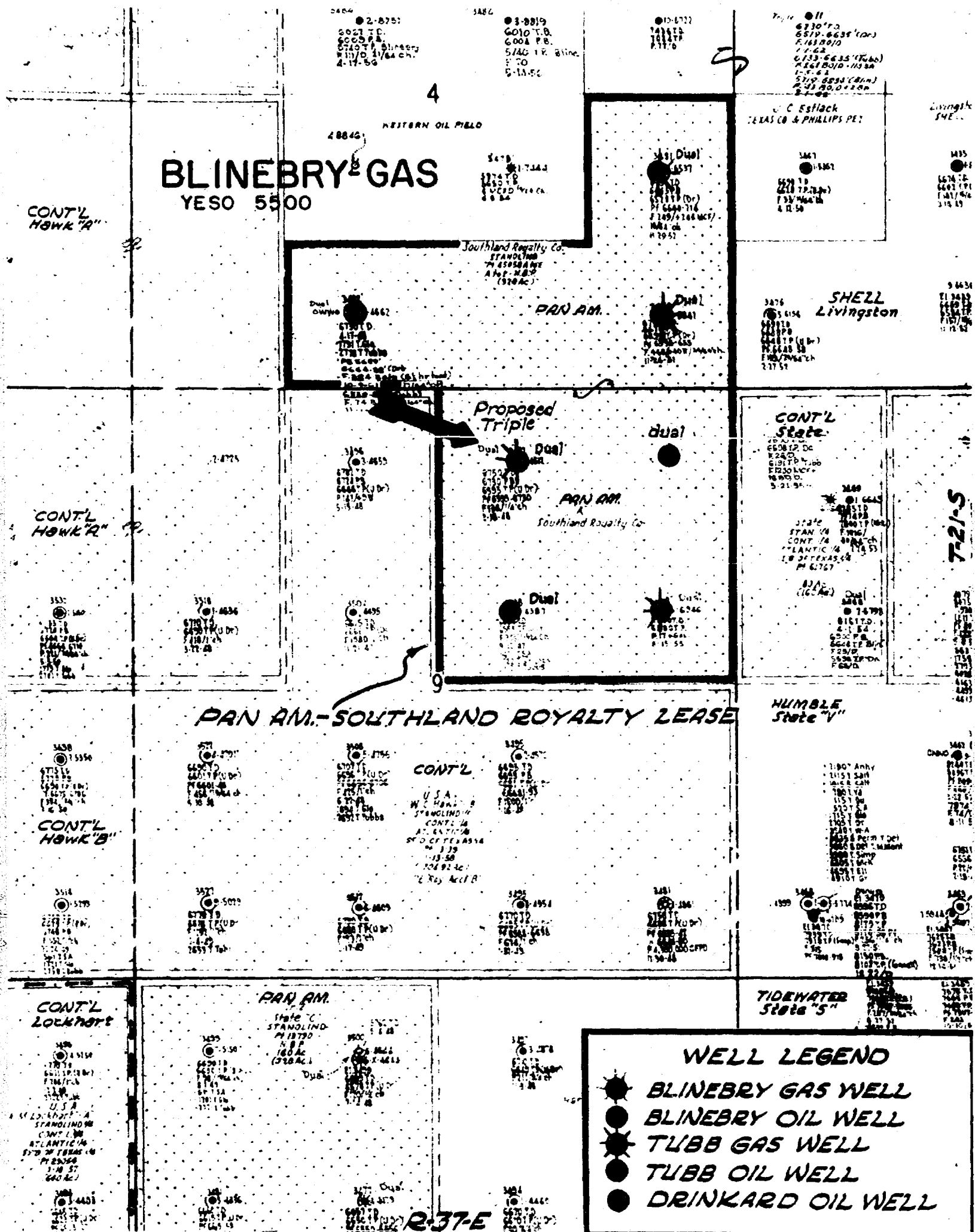

NEW MEXICO OIL CONSERVATION COMMISSION

SANTA FE, NEW MEXICO

5-1-61

APPLICATION FOR MULTIPLE COMPLETION

Operator Pan American Petroleum Corporation		County Lee		Date September 11, 1962
Address Box 268, Lubbock, Texas		Lease Southland Royalty "A"		Well No. 2
Location of Well	Unit "H"	Section 9	Township 21 South	Range 37 East

1. Has the New Mexico Oil Conservation Commission heretofore authorized the multiple completion of a well in these same pools or in the same zones within one mile of the subject well? YES _____ NO X
2. If answer is yes, identify one such instance: Order No. _____; Operator, Lease, and Well No.:

3. The following facts are submitted:	Upper Zone	Intermediate Zone	Lower Zone
a. Name of Pool and Formation	Blinobry	Tubb	Driskard
b. Top and Bottom of Pay Section (Perforations)	To be selected after log is run.	6330-6495	6395-6730
c. Type of production (Oil or Gas)	Oil Anticipated	Gas	Oil
d. Method of Production (Flowing or Artificial Lift)	Flow	Flow	Flow

4. The following are attached. (Please mark YES or NO)

- No a. Diagrammatic Sketch of the Multiple Completion, showing all casing strings, including diameters and setting depths, centralizers and/or turbolizers and location thereof, quantities used and top of cement, perforated intervals, tubing strings, including diameters and setting depth, location and type of packers and side door chokes, and such other information as may be pertinent.
- Yes b. Plat showing the location of all wells on applicant's lease, all offset wells on offset leases, and the names and addresses of operators of all leases offsetting applicant's lease.
- No c. Waivers consenting to such multiple completion from each offset operator, or in lieu thereof, evidence that said offset operators have been furnished copies of the application.*
- No d. Electrical log of the well or other acceptable log with tops and bottoms of producing zones and intervals of perforation indicated thereon. (If such log is not available at the time application is filed, it shall be submitted as provided by Rule 112-A.)

5. List all offset operators to the lease on which this well is located together with their correct mailing address.

Continental Oil Co., Attn: Mr. W. A. Mead, 825 Petroleum Bldg., Roswell, New Mexico

Western Oil Fields, Inc., Attn: Mr. R. H. Swerthout, Box 1147, Hobbs, New Mexico

Tamco, Inc., Attn: Mr. W. C. Lantz, Box 3109, Midland, Texas

Shell Oil Company, Attn: Mr. E. L. Rankin, Box 845, Roswell, New Mexico

Humble Oil and Refining Co., Attn: Mr. E. L. Hensley, Box 1600, Midland, Texas

6. Were all operators listed in Item 5 above notified and furnished a copy of this application? YES X NO _____. If answer is yes, give date of such notification **Sept. 11, 1962**.

CERTIFICATE: I, the undersigned, state that I am the **Dist. Engineer** of the **Lubbock Dist., Pan American Petroleum Corporation** (company), and that I am authorized by said company to make this report; and that this report was prepared under my supervision and direction and that the facts stated therein are true, correct and complete to the best of my knowledge.

A. J. Indurich
A. J. Indurich Signature

- * Should waivers from all offset operators not accompany an application for administrative approval, the New Mexico Oil Conservation Commission will hold the application for a period of twenty (20) days from date of receipt by the Commission's Santa Fe office. If, after said twenty-day period, no protest nor request for hearing is received by the Santa Fe office, the application will then be processed.
- NOTE: If the proposed multiple completion will result in an unorthodox well location and/or a non-standard perforation unit in either or both of the producing zones, then separate application for approval of the same should be filed simultaneously with this application.

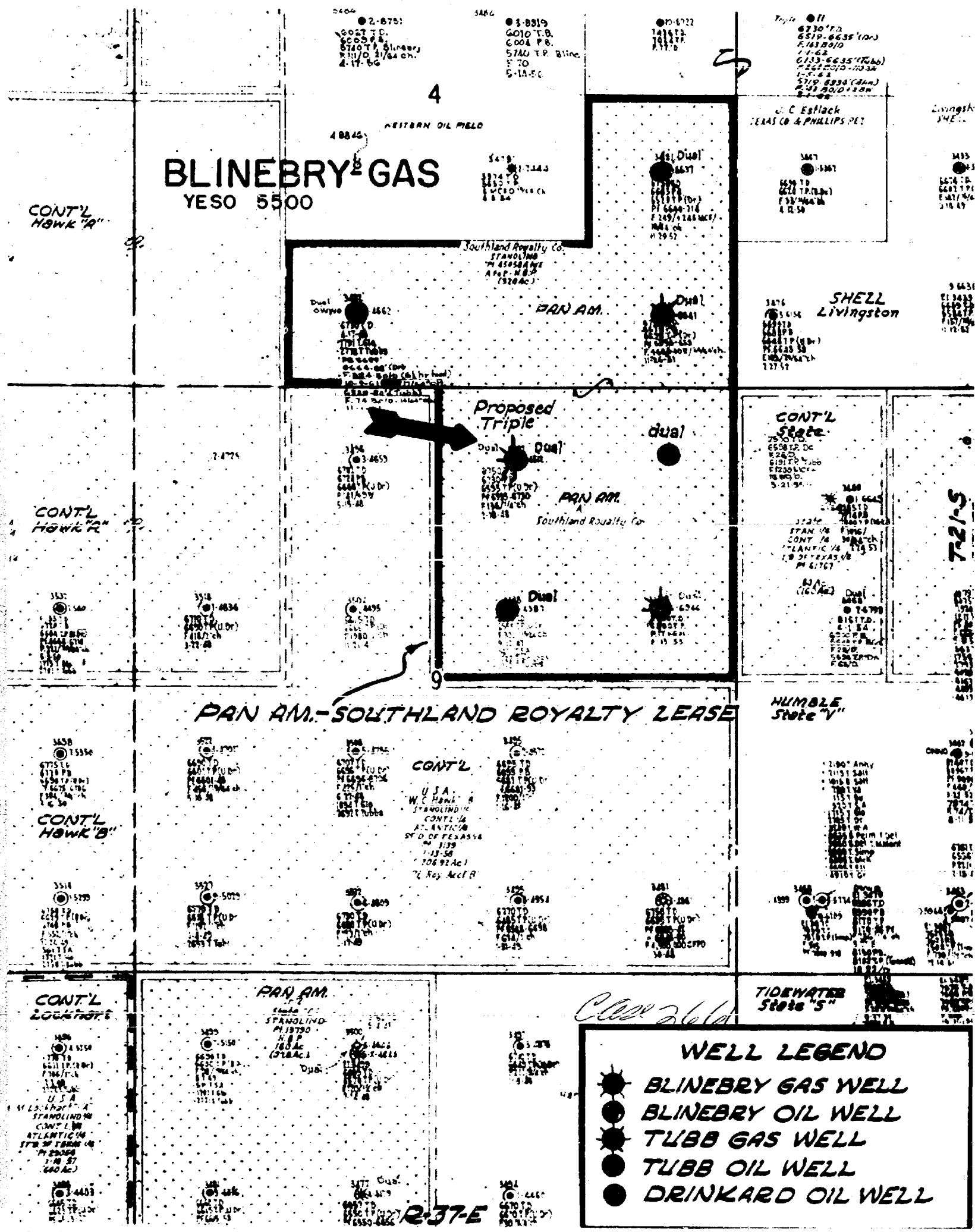

WELL LEGEND

- BLINEBRY GAS WELL
- BLINEBRY OIL WELL
- TUBB GAS WELL
- TUBB OIL WELL
- DRINKARD OIL WELL

No. 29-62

DOCKET: EXAMINER HEARING - WEDNESDAY - OCTOBER 10, 1962

9 A.M. - OIL CONSERVATION COMMISSION CONFERENCE ROOM
STATE LAND OFFICE BUILDING, SANTA FE, NEW MEXICO

The following cases will be heard before Daniel S. Nutter, Examiner or
Elvis A. Utz, alternate examiner:

CASE 2647: (Continued)

Application of Carper Drilling Company for a tubingless completion, Chaves County, New Mexico. Applicant, in the above-styled cause, seeks authority to complete its Baetz Well No. 1, located in the SE/4 SW/4 of Section 35, Township 14 South, Range 27 East, Chaves County, New Mexico, as a tubingless gas well completion producing through perforations from 8182-8270' in 2 7/8 inch casing.

CASE 2654:

Application of Carper Drilling Company for the creation of a new gas pool and for temporary special rules and regulations, Chaves County, New Mexico. Applicant, in the above-styled cause, seeks the creation of a new gas pool to be designated the Buffalo Valley-Pennsylvanian Gas Pool for its Baetz Well No. 1, located in the SE/4 SW/4 of Section 35, Township 14 South, Range 27 East, Chaves County, New Mexico. Applicant, further seeks the establishment of temporary special rules and regulations governing said pool, including provisions for 320-acre gas units.

CASE 2655:

Application of Martin Yates III and S. P. Yates for compulsory pooling, Lea County, New Mexico. Applicant, in the above-styled cause, seeks an order force pooling all mineral interests in the Lusk-Strawn Pool to form a 160-acre oil proration unit comprising the NE/4 of Section 30, Township 19 South, Range 32 East, Lea County, New Mexico, to be dedicated to a well to be drilled in the NE/4 NE/4 of said Section 30.

CASE 2656:

Application of Western Development Company for a secondary recovery project, East Millman Queen-Grayburg Field, Eddy County, New Mexico. Applicant, in the above-styled cause, seeks permission to institute a secondary recovery project in the East Millman Queen-Grayburg Field, with the injection of water into the Queen and Grayburg formations initially to be through 16 wells, located in Sections 11, 14, 15, 22 and 23, Township 19 South, Range 28 East, Eddy County, New Mexico, said project to be governed by the provisions of Rule 701.

-2-

Docket No. 29-62

Examiner Hearing - Wednesday October 10, 1962

- CASE 2657: Application of Odessa Natural Gasoline Company for a non-standard gas proration unit, Lea County, New Mexico. Applicant, in the above-styled cause, seeks establishment of a 320-acre non-standard gas proration unit comprising the SE/4 of Section 23 and the NE/4 of Section 26, Township 25 South, Range 37 East, Justis Gas Pool, Lea County, New Mexico, to be dedicated to its Carlson "A" Well No. 1 located in Unit P of said Section 23.
- CASE 2658: Application of Cabot Corporation for temporary special rules and regulations, Lea County, New Mexico. Applicant, in the above-styled cause, seeks an order promulgating temporary special rules and regulations for the North Bagley-Pennsylvanian Pool, Lea County, New Mexico, including provisions for 80-acre proration units.
- CASE 2659: Application of Cabot Corporation for the creation of a new oil pool and the establishment of temporary rules and regulations, Lea County, New Mexico. Applicant, in the above-styled cause, seeks the creation of a new oil pool to be designated the North Bagley-Wolfcamp Pool for its Humble State Well No. 1, located in the NW/4 NW/4 of Section 23, Township 11 South, Range 33 East, Lea County, New Mexico. Applicant further seeks establishment of temporary rules and regulations governing said pool including provisions for 80-acre proration units.
- CASE 2660: Application of Midwest Oil Corporation for the creation of a new oil pool and for the establishment of temporary special rules and regulations, Lea County, New Mexico. Applicant, in the above-styled cause, seeks the creation of a new oil pool for Pennsylvanian production in the vicinity of its LLE State Well No. 1, located in the NW/4 SW/4 of Section 14, Township 10 South, Range 33 East, Lea County, New Mexico. Applicant further seeks the promulgation of temporary special rules and regulations governing said pool to include provisions for 80-acre proration units and fixed well location requirements.
- CASE 2661: Application of Pan American Petroleum Corporation for a triple completion, Lea County, New Mexico. Applicant, in the above-styled cause, seeks an order authorizing the triple completion (conventional) of its Southland Royalty "A" Well No. 2, located in Unit B of Section 9, Township 21 South, Range 37 East, Lea County, New Mexico, in such a manner as to produce

-3-

Docket No. 29-62

Examiner Hearing - Wednesday October 10, 1962

oil from the Drinkard and Blinebry formations and gas from the Tubb formation through parallel strings of tubing.

CASE 2662:

Application of Pan American Petroleum Corporation for a triple completion, Lea County, New Mexico. Applicant, in the above-styled cause, seeks an order authorizing the triple completion (conventional) of its South Mattix Unit Well No. 14, located in Unit K of Section 15, Township 24 South, Range 37 East, Lea County, New Mexico, in such a manner as to produce gas from the Fowler Paddock and an undesignated Tubb pool, and oil from an undesignated Blinebry pool through parallel strings of tubing.

CASE 2663:

Application of Arnold H. Bruner for permission to directionally drill, Lea County, New Mexico. Applicant, in the above-styled cause, seeks permission to directionally drill his Federal Intex Well No. 1, the surface location of which is in the center of the NW/4 SE/4 of Section 8, Township 9 South, Range 37 East, Allison Pennsylvanian Pool (extension), Lea County, New Mexico. Target for said directionally drilled well would be 100 feet from the North and West lines of the NW/4 SE/4 of said Section 8.

CASE 2664:

Application of Southwest Production Company for a dual completion, San Juan County, New Mexico. Applicant, in the above-styled cause, seeks authority to complete its Davis Federal Well No. 1, located in Unit L of Section 24, Township 26 North, Range 11 West, San Juan County, New Mexico, as a dual completion with production of oil from the Gallup zone and production of gas from the Dakota zone to be through parallel strings of 1 1/4-inch tubing.

iqg/

OIL CONSERVATION COMMISSION
SANTA FE, NEW MEXICO

Date Oct 15

CASE 2661

Hearing Date 9am Oct 10

DSN @ SF

My recommendations for an order in the above numbered cases are as follows:

Enter an order approving the
triple completion requested by Pan
Am in this case.

(Drinkard oil) (Phineby oil) (Tub gas)
2 3/8" 80.0 tby 2.0" 00 tby 2.0" 00 tby

Backer leakage tests upon
completion & annually thereafter
during Drinkard GOR test period.

PAN AMERICAN PETROLEUM CORPORATION

NOTED 10 AM
P.O. Box 268
Lubbock, Texas
October 12, 1962

File: WJS-3564-400.1

Subject: Transmittal Revised Attachment III
to Exhibit I Case 2661 - Pan American
Petroleum Corporation's Application for
Permission To Triple Complete
Southland Royalty "A" No. 2

Mr. Dan Nutter, Chief Engineer
New Mexico Oil Conservation Commission
Box 871
Santa Fe, New Mexico

Dear Sir:

Attached is revised Attachment III to Exhibit I of the subject case, being a copy of Electric Log of this well showing the Blinebry Marker and Base of Blinebry, which was inadvertently omitted from the log (Attachment III) presented in evidence. Also, as requested, we have shown the probable perforating intervals in the Blinebry based on the log from Attachment III. As stated in testimony the exact intervals will be chosen after obtaining an additional log on this well during recompletion operations.

Yours very truly,

A. J. Inderrieden
A. J. Inderrieden

RES:lm

Attachment

GOVERNOR
EDWIN L. MECHEM
CHAIRMAN

State of New Mexico
Oil Conservation Commission



LAND COMMISSIONER
E. S. JOHNNY WALKER
MEMBER

STATE GEOLOGIST
A. L. PORTER, JR.
SECRETARY - DIRECTOR

P. O. BOX 971
SANTA FE

October 23, 1962

Mr. Charles Malone
Atwood & Malone
Attorneys at Law
P. O. Drawer 700
Roswell, New Mexico

Re: Case No. 2661
Order No. 22343
Applicant:
Pan American Petroleum Corporation

Dear Sir:

Enclosed herewith are two copies of the above-referenced
Commission order recently entered in the subject case.

Very truly yours,

A. L. Porter, Jr.

A. L. PORTER, Jr.
Secretary-Director

ir/

Carbon copy of order also sent to:

Hobbs OCC X

Artesia OCC

Aztec OCC

OTHER Mr. Guy Buell

BEFORE THE OIL CONSERVATION COMMISSION
OF THE STATE OF NEW MEXICO

IN THE MATTER OF THE HEARING
CALLED BY THE OIL CONSERVATION
COMMISSION OF NEW MEXICO FOR
THE PURPOSE OF CONSIDERING:

CASE No. 2661
Order No. R-2343

APPLICATION OF PAN AMERICAN PETROLEUM
CORPORATION FOR A TRIPLE COMPLETION,
LEA COUNTY, NEW MEXICO.

ORDER OF THE COMMISSION

BY THE COMMISSION:

This cause came on for hearing at 9 o'clock a.m. on October 10, 1962, at Santa Fe, New Mexico, before Daniel S. Nutter, Examiner duly appointed by the Oil Conservation Commission of New Mexico, hereinafter referred to as the "Commission," in accordance with Rule 1214 of the Commission Rules and Regulations.

NOW, on this 22nd day of October, 1962, the Commission, a quorum being present, having considered the application, the evidence adduced, and the recommendations of the Examiner, Daniel S. Nutter, and being fully advised in the premises,

FINDS:

(1) That due public notice having been given as required by law, the Commission has jurisdiction of this cause and the subject matter thereof.

(2) That the applicant, Pan American Petroleum Corporation, is the owner and operator of the Southland Royalty "A" Well No. 2, located in Unit B of Section 9, Township 21 South, Range 37 East, NEPM, Lea County, New Mexico.

(3) That the applicant seeks permission to complete said Southland Royalty "A" Well No. 2 as a triple completion (conventional) in such a manner as to produce oil from the Drinkard Oil Pool and from the Blinbry Oil Pool through 2 3/8-inch OD tubing and 2.0-inch OD tubing, respectively, and to produce gas from the Tubb Gas Pool through 2.0-inch OD tubing.

(4) That the mechanics of the proposed triple completion are feasible and in accord with good conservation practices.

(5) That approval of the subject application will neither cause waste nor impair correlative rights.

-2-

CASE No. 2661
Order No. R-2343

IT IS THEREFORE ORDERED:

(1) That the applicant, Pan American Petroleum Corporation, is hereby authorized to complete its Southland Royalty "A" Well No. 2, located in Unit B of Section 9, Township 21 South, Range 37 East, NMPM, Lea County, New Mexico, as a triple completion (conventional) in such a manner as to produce oil from the Drinkard Oil Pool and from the Blinbry Oil Pool through 2 3/8-inch OD tubing and 2.0-inch tubing, respectively, and to produce gas from the Tubb Gas Pool through 2.0-inch OD tubing.

PROVIDED HOWEVER, That the applicant shall complete, operate, and produce said well in accordance with the provisions of Rule 112-A of the Commission Rules and Regulations.

PROVIDED FURTHER, That the operator shall take packer-leakage tests upon completion and annually thereafter during the Gas-Oil Ratio Test Period for the Drinkard Oil Pool, and at such other times as the Secretary-Director of the Commission may prescribe.

(2) That jurisdiction of this cause is retained for the entry of such further orders as the Commission may deem necessary.

DONE at Santa Fe, New Mexico, on the day and year hereinabove designated.

STATE OF NEW MEXICO
OIL CONSERVATION COMMISSION



EDWIN L. MECHEM, Chairman



E. S. WALKER, Member

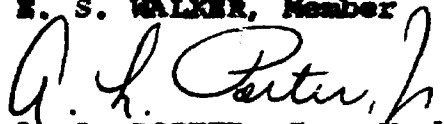

A. L. PORTER, Jr., Member & Secretary

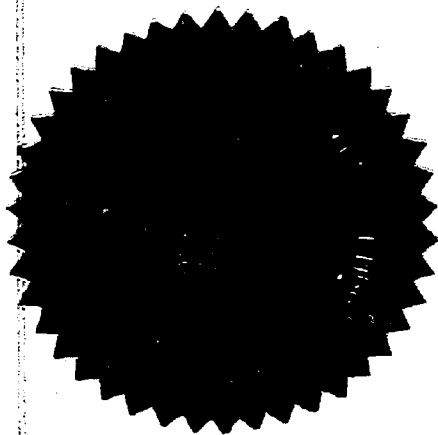

esr/

BEFORE THE
OIL CONSERVATION COMMISSION
Santa Fe, New Mexico
October 11, 1962

EXAMINER HEARING

IN THE MATTER OF:

Application of Pan American Petroleum Corporation
for a triple completion, Lea County, New Mexico.
Applicant, in the above-styled cause, seeks an
order authorizing the triple completion
(conventional) of its Southland Royalty "A" Well
No. 2, located in Unit B of Section 9, Township
21 South, Range 37 East, Lea County, New Mexico,
in such a manner as to produce oil from the
Drinkard and Blinberry formations and gas from the
Tubb formation through parallel strings of tubing.)

CASE
2661

BEFORE: Daniel S. Nutter, Examiner

TRANSCRIPT OF HEARING

MR. NUTTER: Call Case 2661.

MR. DURRETT: Application of Pan American Petroleum
Corporation for a triple completion, Lea County, New Mexico.

(Whereupon, Applicant's Exhibit
No. 1 marked for identification.)

MR. MALONE: May it please the Examiner, Charley
Malone for the Applicant, Pan American Petroleum Corporation. We
have one witness and one exhibit.

(Witness sworn.)

ROBERT E. SMITH

called as a witness, having been first duly sworn on oath, testi-
fied as follows:

DEARNLEY-MEIER REPORTING SERVICE, Inc.

FARMINGTON, N. M.
PHONE 325-1182

ALBUQUERQUE, N. M.
PHONE 243-6591



DIRECT EXAMINATION

BY MR. MALONE:

Q Would you state your name and address, please?

A Robert E. Smith, 4303 - 39th Street, Lubbock, Texas.

Q Your occupation?

A I'm a petroleum engineer, senior grade, Pan American Petroleum Corporation.

Q You have not testified before this Commission previously, have you?

A I have not.

Q Would you state your college education and the degree and the year of that degree?

A I received a degree in Bachelor of Science, Electrical Engineering, University of Texas, 1960.

Q Would you state your background and experience in Petroleum Engineering, please?

A I went to work for Stanolind Oil and Gas Company, now Pan American, in 1961, roustabout trainee, and worked in several offices in Midland, Odessa, Andrews, Fort Worth; and I have just recently been transferred to Lubbock, in which case I have been Operations Engineer and Reservoir Engineer and Evaluation Engineer.

Q Does the Lubbock office of Pan American have control and jurisdiction over the area with which this application deals?

A It does.

Q Was Exhibit No. 1 prepared by you?

DEARNLEY-MEIER REPORTING SERVICE, Inc.

FARMINGTON, N. M.
PHONE 325-1182

SANTA FE, N. M.
PHONE 983-3971

ALBUQUERQUE, N. M.
PHONE 243-6691



DEARNLEY-MEIER REPORTING SERVICE, Inc.

FARMINGTON, N. M.
PHONE 325-1162

SANTA FE, N. M.
PHONE 983-3971

ALBUQUERQUE, N. M.
PHONE 243-6691

A Yes, under my supervision.

Q And under your supervision?

A Yes.

Q And do you, as senior grade petroleum engineer, have jurisdiction over the area described in this application?

A I'm responsible for the reporting of operation to management in this area, yes.

MR. MALONE: Would the qualifications of this witness be satisfactory to the Examiner?

MR. NUTTER: Yes, sir. Please proceed.

Q (By Mr. Malone) Would you state in a summary form what Pan American requests in this application?

A We are requesting permission to triply complete an existing dual well in the Drinkard oil and Tubb gas pools of Lea County, with the Blinebry oil pool of Lea County. The subject well was dually completed in 1954 and is now an existing dual.

Q In other words, this is a work-over to include by triple completion the production of oil from the Blinebry?

A That is right.

Q Now then, where does the Blinebry lie with respect to the Drinkard and Tubb?

A The Blinebry lies immediately above the Tubb formation. Exhibit 3, or attachment 3 of Exhibit 1 is an electrical log of the subject well with the top of the Glorieta marked -- I'm sorry, the top of the -- I beg your pardon, we have mis-marked this log.



DEARNLEY-MEIER REPORTING SERVICE, Inc.

FARMINGTON, N. M.
PHONE 325-1192

SANTA FE, N. M.
PHONE 983-3971

ALBUQUERQUE, N. M.
PHONE 243-6691

This log should show top of Blinebry and base of Blinebry. This was certainly an oversight.

Q Now then, is this well, the Soutland Royalty "A" No. 2 Well, within the defined limits of pools designated for the production of these hydrocarbons?

A It is.

Q In all three zones?

A Yes.

Q Attached to your application there was a map showing the offset operators, was there not?

A That is right.

Q Was notice to those offset operators given by Pan American?

A It was given by Pan American in letter of application, attachment of the application showing the offset operators shown as Attachment 4..

Q In other words, the letter to the Commission dated September 11, 1962, which made this application, was forwarded to all offset operators on that date with a copy of the printed form required by the Commission attached to it, is that correct?

A That is right.

Q And that printed form appears as the last entry in Exhibit 1?

A That is correct.

Q Would you briefly discuss the proposed triple?



DEARNLEY-MEIER REPORTING SERVICE, Inc.

FARMINGTON, N. M.
PHONE 325-1182

SANTA FE, N. M.
PHONE 983-3971

ALBUQUERQUE, N. M.
PHONE 243-6691

A If you will refer to Attachment 2, it shows a schematic of the proposed triple.

Q Schematic drawing?

A Yes, schematic drawing. This well was drilled in 1947, completed in February of 1948, as a Drinkard single. 7-inch casing was set at a depth of 6740, cemented with 3,000 sacks. Perforations are shown, three sets. It was completed there and produced there until 1954, until which time we received permission to dual it in the Tubb. A Baker Model "D" Packer was set at 6550 feet. We now propose to perforate the Blinebry in an interval to be selected after running another set of logs from somewhere between 5816 and 5956 feet. We will set a second packer; actually we have shown setting a new packer and abandoning the old packer. This will be done after pulling the seal elements, and if they are in such condition that we feel the bottom packer will not hold, we'll run a new packer.

We will then set a packer in between the Tubb and the Blinebry and run three strings of tubing, as shown.

Q So that if the application were granted and this mechanism installed, you would produce the Blinebry oil from the top zone in the new perforations, the Tubb gas from the middle zone, and the Drinkard oil from the lowest zone, is that correct?

A That is correct.

Q Is there anything further with respect to this schematic drawing?



DEARNLEY-MEIER REPORTING SERVICE, Inc.

FARMINGTON, N. M.
PHONE 325-1182

SANTA FE, N. M.
PHONE 983-3971

ALBUQUERQUE, N. M.
PHONE 243-6691

A Nothing other than to elaborate that this well was completed using three strings of casing originally with 9-5/8 inch casing set at 1409 and cemented with 700 sacks of cement, and surface set at 200 feet. Both the upper strings, our records are vague on whether cement actually circulated on the intermediate string or not. Checking the drilling reports indicated that they cleaned and completed the sealers as though they received cement to the surface.

Q This would be a conventional triple completion through the use of three strings of 2-inch tubing, is that correct?

A That is correct.

Q Going to Attachment No. 3, you've stated that this is a log of the well and that you would like to correct one of the markings in it?

A That is correct.

Q Which one is that?

A The top and bottom Glorieta should be marked top and bottom Blinebry.

Q In other words, all you would like to do is substitute the word "Blinebry" on that log wherever the word "Glorieta" appears, is that correct, or am I incorrect?

A May I check something here to be sure?

Q Yes.

A That was an oversight. What has happened here, in copying the data off the completion report, we show the top of



DEARNLEY-MEIER REPORTING SERVICE, Inc.

FARMINGTON, N. M.
PHONE 325-1182

SANTA FE, N. M.
PHONE 983-3971

ALBUQUERQUE, N. M.
PHONE 243-6691

PAGE 7

the Glorieta as correct. We inadvertently left out the Blinebry and I do not have the Blinebry top marked on this log, which I will have to put on there. Without another log to correlate it with right now, I do not have that exact top.

Q Are you willing, upon your return to Lubbock, to mail a letter to the Commission showing the tops on the Blinebry?

A I am.

MR. NUTTER: With the perforated interval.

A Yes. That was certainly an oversight. I don't know how it happened.

Q With respect to Attachment No. 4 in Exhibit 1, this is the information required by the Commission through its printed form, is that correct?

A That is correct.

Q With respect to correlative rights, Mr. Smith, in your opinion would the correlative rights of any offset owner be adversely affected if the Commission granted the right to triply complete in the manner requested?

A They would not.

Q With respect to the correlative rights of the Applicant, Pan American, would those rights be protected by the granting of the application?

A Yes, they would. Pan American would be entitled to recover their fair share of hydrocarbon.

Q That necessarily brings into play the question of



DEARNLEY-MEIER REPORTING SERVICE, Inc.

FARMINGTON, N. M.
PHONE 325-1182

SANTA FE, N. M.
PHONE 983-3971

ALBUQUERQUE, N. M.
PHONE 243-6691

economic waste. Would economic waste be prevented by the granting of this application?

A Yes. Economic waste would be prevented. We would be permitted to triply complete in lieu of having to drill additional wells to develop this Blinebry oil.

Q It would be obviously true that the cost of a triple in this well would only be a fraction of the cost of another well?

A That is right.

Q Do you have anything further to offer to the Commission in your testimony as to this application, Mr. Smith?

A No, I do not.

MR. MALONE: That completes our direct examination, Mr. Examiner.

MR. NUTTER: Does anyone have any questions of Mr. Smith?

CROSS EXAMINATION

BY MR. NUTTER:

Q I note that Blinebry oil will be produced through 1.67 I.D. tubing. Will it be possible artificially to lift the Blinebry if that becomes necessary?

A It may not be. I believe, though, that if it becomes necessary that some method of gas lift or other means will be devised to run a macaroni string or one-inch string of some nature down there to artificially lift it.

Q Now the old Model "D" packer that's set at 6550, that



DEARNLEY-MEIER REPORTING SERVICE, Inc.

FARMINGTON, N. M.
PHONE 325-1182

SANTA FE, N. M.
PHONE 983-3971

ALBUQUERQUE, N. M.
PHONE 243-6691

PAGE 9

may be used or may not, depending on the condition of the seals?

A True. This was prepared to show what it would look like if we abandoned that old packer, yes.

Q What is the Otis type "WA" Packer?

A This is a permanent type packer, a competitive packer with the Model "D".

Q You stated you didn't know whether the cement had circulated on the two upper strings of pipe. Do you have the top of the cement on the seven-inch?

A No, sir. In cementing this seven-inch casing, it was actually stage cementing with some difficulty. We ran a Baker multiplex collar at about 5395 and attempted to cement, stage cement, and in doing so it appeared that the wiper plug opened this staging tool and we did not get initial cement. We went back in, then, with 400 sacks of cement. They didn't follow the plug down all the way initially, because they were afraid of cutting out this seat in the staging tool; they didn't know how far it had got, but we went ahead and re-cemented again, in which case it looks like we put away about 330 sacks on the second cement of this lower interval. We then ran the go-devil and tried to open the pours, they didn't open. We ran a temperature survey, we couldn't tell for sure where the top of the cement was, and they perforated then immediately at 5400 feet and attempted to break circulation and could not, and a closer re-examination of the temperature survey indicated that there was a temperature



DEARNLEY-MEIER REPORTING SERVICE, Inc.

FARMINGTON, N. M.
PHONE 325-1182SANTA FE, N. M.
PHONE 983-3971ALBUQUERQUE, N. M.
PHONE 243-6691

gradient break at 4575, and a second at 3,080. We then assumed that we had cement up above the interval, which was at that time the Drinkard, and went ahead to try and tie this in to cover up into the salt. We ran 2600 sacks of cement, at which time they got the plug down to 100 feet above the perforated interval. I beg your pardon, we perforated at 3,075 then and we stopped it. At that time it had circulated out about 25 sacks of cement. There's a possibility of a slight void in here; however, on packer leakage test and everything of the Tubb and Drinkard, we had no indication that we had a bad cement job. We feel like that the cement adequately covers the Blinebry formation.

Q Is it your opinion that the Blinebry and the Tubb is separated by cement behind the plug?

A Yes, sir. Of course, after we go in and test we'll know for sure, but right now we believe it is adequately protected based on temperature survey, which did indicate that we received cement up to 4525 feet at least.

Q Has the Blinebry actually been perforated as yet?

A No, it has not. One other thing in closing I failed to mention was that the Blinebry at this location is currently committed to our Southland Royalty "A" No. 6 for gas, in which case if the well is successfully completed as a Blinebry oil, this 40 acres of course will be removed from the proration unit.

Q Well, on this 160-acre lease, you already have two Blinebry oil wells?



DEARNLEY-MEIER REPORTING SERVICE, Inc.

FARMINGTON, N. M.
PHONE 325-1182

SANTA FE, N. M.
PHONE 983-3971

ALBUQUERQUE, N. M.
PHONE 243-6691

A That's right, yes, sir. This Blinebry oil in No. 6 or the Blinebry gas in No. 6 approaches but not quite a Blinebry oil classification of the 51 degree gravity oil, and less than 32 cubic feet per barrel ratio.

MR. NUTTER: Any further questions of Mr. Smith? He may be excused.

(Witness excused.)

MR. NUTTER: Do you have anything further in this case Mr. Malone?

MR. MALONE: We have nothing further.

MR. NUTTER: Does anyone have anything they wish to offer in Case 2661? We will take the case under advisement.

* * * *

STATE OF NEW MEXICO)
COUNTY OF BERNALILLO) ss

I, ADA DEARNLEY, Notary Public in and for the County of Bernalillo, State of New Mexico, do hereby certify that the foregoing and attached Transcript of Hearing was reported by me in stenotype, and that the same is a true and correct record of said proceedings, to the best of my knowledge, skill and ability.

WITNESS my Hand and Seal this 29th day of October, 1962, in the City of Albuquerque, County of Bernalillo, State of New Mexico.

My Commission Expires the foregoing is
do hereby certify that the proceedings in
complete record of the proceedings in
June 16, 1963, of Case No. 2661
the Examiner's hearing of Case No. 2661
heard by me on 10/11, 1962.

Ada Dearnley
NOTARY PUBLIC

[Signature] Examined
New Mexico Oil Conservation Commission



DISCUSSION

Pan American Petroleum Corporation respectfully requests that the New Mexico Oil Conservation Commission grant permission to triple complete its Southland Royalty "A" No. 2, an existing dual well in the Drinkard (oil), Tubb (gas) Pools with the Blinebry (oil) Pool of Lea County, New Mexico.

The Southland Royalty "A" No. 2 is located 660 feet from the north line and 1980 feet from the east line, Section 9, T-21-S, R-37-E, which is approximately four miles north of Eunice, New Mexico.

This well is located in a multipay area as indicated by Attachment I, a plat of the area. The east offset and south offset to the Southland Royalty "A" No. 2 are Pan American's Southland Royalty "A" Nos. 7 and 1, respectively, both dual Blinebry-Drinkard (oil) wells. The well offset is the Continental USA-W. C. Hawk E-9 Well No. 3, a Tubb (gas)-Drinkard dual. Blinebry (gas) for the subject well is currently committed to the Pan American Southland Royalty "A" No. 6, a diagonal southeast offset. Subject acreage is to be removed from the proration Unit Well No. 6 if the Southland Royalty "A" No. 2 is successfully triply completed in the Blinebry (oil).

Attachment II is a diagrammatic sketch showing the mechanical aspects of the proposed triple completion. This is a "conventional" triple completion utilizing separate tubing strings to produce each zone separately and packers to maintain separation in the well bore. This installation will permit safe and efficient production of oil from these three reservoirs.

Attachment III is an Electrical Log of the Southland Royalty "A" No. 2 with top and bottom of the producing zones and the perforated intervals marked in red.

For convenience, Attachment IV is a copy of Pan American's application for multiple completion of the Southland Royalty "A" No. 2. A copy of the application was furnished each offset operator.

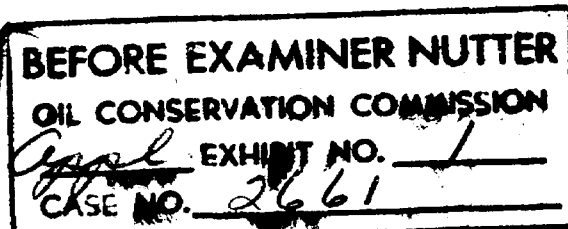

EXHIBIT
PAN AMERICAN PETROLEUM CORPORATION
APPLICATION FOR PERMISSION TO TRIPLE
COMPLETE ITS SOUTHLAND ROYALTY "A" NO. 2
UNIT "B", SECTION 9, T-21-S, R-37-E,
LEA COUNTY, NEW MEXICO, IN THE DRINKARD
(OIL), TUBB (GAS), AND BLINEBRY (OIL)
POOLS IN LEA COUNTY.

CASE 2661
October 10, 1962

BLINEBRY GAS YESO 5500

CONT'L
Hawk "A"

PAN AM.

SHELL
Livingston

Proposed
Triple

Pan Am.

CONT'L
State

CONT'L
Hawk "A"

PAN AM. - SOUTHLAND ROYALTY LEASE

Humble
State "V"

CONT'L
Hawk "B"

CONT'L

3470
3472
3474
3476
3478
3480
3482
3484
3486
3488
3490
3492
3494
3496
3498
3500
3502
3504
3506
3508
3510
3512
3514
3516
3518
3520
3522
3524
3526
3528
3530
3532
3534
3536
3538
3540
3542
3544
3546
3548
3550
3552
3554
3556
3558
3560
3562
3564
3566
3568
3570
3572
3574
3576
3578
3580
3582
3584
3586
3588
3590
3592
3594
3596
3598
3600
3602
3604
3606
3608
3610
3612
3614
3616
3618
3620
3622
3624
3626
3628
3630
3632
3634
3636
3638
3640
3642
3644
3646
3648
3650
3652
3654
3656
3658
3660
3662
3664
3666
3668
3670
3672
3674
3676
3678
3680
3682
3684
3686
3688
3690
3692
3694
3696
3698
3700
3702
3704
3706
3708
3710
3712
3714
3716
3718
3720
3722
3724
3726
3728
3730
3732
3734
3736
3738
3740
3742
3744
3746
3748
3750
3752
3754
3756
3758
3760
3762
3764
3766
3768
3770
3772
3774
3776
3778
3780
3782
3784
3786
3788
3790
3792
3794
3796
3798
3800
3802
3804
3806
3808
3810
3812
3814
3816
3818
3820
3822
3824
3826
3828
3830
3832
3834
3836
3838
3840
3842
3844
3846
3848
3850
3852
3854
3856
3858
3860
3862
3864
3866
3868
3870
3872
3874
3876
3878
3880
3882
3884
3886
3888
3890
3892
3894
3896
3898
3900
3902
3904
3906
3908
3910
3912
3914
3916
3918
3920
3922
3924
3926
3928
3930
3932
3934
3936
3938
3940
3942
3944
3946
3948
3950
3952
3954
3956
3958
3960
3962
3964
3966
3968
3970
3972
3974
3976
3978
3980
3982
3984
3986
3988
3990
3992
3994
3996
3998
4000
4002
4004
4006
4008
4010
4012
4014
4016
4018
4020
4022
4024
4026
4028
4030
4032
4034
4036
4038
4040
4042
4044
4046
4048
4050
4052
4054
4056
4058
4060
4062
4064
4066
4068
4070
4072
4074
4076
4078
4080
4082
4084
4086
4088
4090
4092
4094
4096
4098
4100
4102
4104
4106
4108
4110
4112
4114
4116
4118
4120
4122
4124
4126
4128
4130
4132
4134
4136
4138
4140
4142
4144
4146
4148
4150
4152
4154
4156
4158
4160
4162
4164
4166
4168
4170
4172
4174
4176
4178
4180
4182
4184
4186
4188
4190
4192
4194
4196
4198
4200
4202
4204
4206
4208
4210
4212
4214
4216
4218
4220
4222
4224
4226
4228
4230
4232
4234
4236
4238
4240
4242
4244
4246
4248
4250
4252
4254
4256
4258
4260
4262
4264
4266
4268
4270
4272
4274
4276
4278
4280
4282
4284
4286
4288
4290
4292
4294
4296
4298
4300
4302
4304
4306
4308
4310
4312
4314
4316
4318
4320
4322
4324
4326
4328
4330
4332
4334
4336
4338
4340
4342
4344
4346
4348
4350
4352
4354
4356
4358
4360
4362
4364
4366
4368
4370
4372
4374
4376
4378
4380
4382
4384
4386
4388
4390
4392
4394
4396
4398
4400
4402
4404
4406
4408
4410
4412
4414
4416
4418
4420
4422
4424
4426
4428
4430
4432
4434
4436
4438
4440
4442
4444
4446
4448
4450
4452
4454
4456
4458
4460
4462
4464
4466
4468
4470
4472
4474
4476
4478
4480
4482
4484
4486
4488
4490
4492
4494
4496
4498
4500
4502
4504
4506
4508
4510
4512
4514
4516
4518
4520
4522
4524
4526
4528
4530
4532
4534
4536
4538
4540
4542
4544
4546
4548
4550
4552
4554
4556
4558
4560
4562
4564
4566
4568
4570
4572
4574
4576
4578
4580
4582
4584
4586
4588
4590
4592
4594
4596
4598
4600
4602
4604
4606
4608
4610
4612
4614
4616
4618
4620
4622
4624
4626
4628
4630
4632
4634
4636
4638
4640
4642
4644
4646
4648
4650
4652
4654
4656
4658
4660
4662
4664
4666
4668
4670
4672
4674
4676
4678
4680
4682
4684
4686
4688
4690
4692
4694
4696
4698
4700
4702
4704
4706
4708
4710
4712
4714
4716
4718
4720
4722
4724
4726
4728
4730
4732
4734
4736
4738
4740
4742
4744
4746
4748
4750
4752
4754
4756
4758
4760
4762
4764
4766
4768
4770
4772
4774
4776
4778
4780
4782
4784
4786
4788
4790
4792
4794
4796
4798
4800
4802
4804
4806
4808
4810
4812
4814
4816
4818
4820
4822
4824
4826
4828
4830
4832
4834
4836
4838
4840
4842
4844
4846
4848
4850
4852
4854
4856
4858
4860
4862
4864
4866
4868
4870
4872
4874
4876
4878
4880
4882
4884
4886
4888
4890
4892
4894
4896
4898
4900
4902
4904
4906
4908
4910
4912
4914
4916
4918
4920
4922
4924
4926
4928
4930
4932
4934
4936
4938
4940
4942
4944
4946
4948
4950
4952
4954
4956
4958
4960
4962
4964
4966
4968
4970
4972
4974
4976
4978
4980
4982
4984
4986
4988
4990
4992
4994
4996
4998
5000
5002
5004
5006
5008
5010
5012
5014
5016
5018
5020
5022
5024
5026
5028
5030
5032
5034
5036
5038
5040
5042
5044
5046
5048
5050
5052
5054
5056
5058
5060
5062
5064
5066
5068
5070
5072
5074
5076
5078
5080
5082
5084
5086
5088
5090
5092
5094
5096
5098
5100
5102
5104
5106
5108
5110
5112
5114
5116
5118
5120
5122
5124
5126
5128
5130
5132
5134
5136
5138
5140
5142
5144
5146
5148
5150
5152
5154
5156
5158
5160
5162
5164
5166
5168
5170
5172
5174
5176
5178
5180
5182
5184
5186
5188
5190
5192
5194
5196
5198
5200
5202
5204
5206
5208
5210
5212
5214
5216
5218
5220
5222
5224
5226
5228
5230
5232
5234
5236
5238
5240
5242
5244
5246
5248
5250
5252
5254
5256
5258
5260
5262
5264
5266
5268
5270
5272
5274
5276
5278
5280
5282
5284
5286
5288
5290
5292
5294
5296
5298
5300
5302
5304
5306
5308
5310
5312
5314
5316
5318
5320
5322
5324
5326
5328
5330
5332
5334
5336
5338
5340
5342
5344
5346
5348
5350
5352
5354
5356
5358
5360
5362
5364
5366
5368
5370
5372
5374
5376
5378
5380
5382
5384
5386
5388
5390
5392
5394
5396
5398
5400
5402
5404
5406
5408
5410
5412
5414
5416
5418
5420
5422
5424
5426
5428
5430
5432
5434
5436
5438
5440
5442
5444
5446
5448
5450
5452
5454
5456
5458
5460
5462
5464
5466
5468
5470
5472
5474
5476
5478
5480
5482
5484
5486
5488
5490
5492
5494
5496
5498
5500
5502
5504
5506
5508
5510
5512
5514
5516
5518
5520
5522
5524
5526
5528
5530
5532
5534
5536
5538
5540
5542
5544
5546
5548
5550
5552
5554
5556
5558
5560
5562
5564
5566
5568
5570
5572
5574
5576
5578
5580
5582
5584
5586
5588
5590
5592
5594
5596
5598
5600
5602
5604
5606
5608
5610
5612
5614
5616
5618
5620
5622
5624
5626
5628
5630
5632
5634
5636
5638
5640
5642
5644
5646
5648
5650
5652
5654
5656
5658
5660
5662
5664
5666
5668
5670
5672
5674
5676
5678
5680
5682
5684
5686
5688
5690
5692
5694
5696
5698
5700
5702
5704
5706
5708
5710
5712
5714
5716
5718
5720
5722
5724
5726
5728
5730
5732
5734
5736
5738
5740
5742
5744
5746
5748
5750
5752
5754
5756
5758
5760
5762
5764
5766
5768
5770
5772
5774
5776
5778
5780
5782
5784
5786
5788
5790
5792
5794
5796
5798
5800
5802
5804
5806
5808
5810
5812
5814
5816
5818
5820
5822
5824
5826
5828
5830
5832
5834
5836
5838
5840
5842
5844
5846
5848
5850
5852
5854
5856
5858
5860
5862
5864
5866
5868
5870
5872
5874
5876
5878
5880
5882
5884
5886
5888
5890
5892
5894
5896
5898
5900
5902
5904
5906
5908
5910
5912
5914
5916
5918
5920
5922
5924
5926
5928
5930
5932
5934
5936
5938
5940
5942
5944
5946
5948
5950
5952
5954
5956
5958
5960
5962
5964
5966
5968
5970
5972
5974
5976
5978
5980
5982
5984
5986
5988
5990
5992
5994
5996
5998
6000
6002
6004
6006
6008
6010
6012
6014
6016
6018
6020
6022
6024
6026
6028
6030
6032
6034
6036
6038
6040
6042
6044
6046
6048
6050
6052
6054
6056
6058
6060
6062
6064
6066
6068
6070
6072
6074
6076
6078
6080
6082
6084
6086
6088
6090
6092
6094
6096
6098
6100
6102
6104
6106
6108
6110
6112
6114
6116
6118
6120
6122
6124
6126
6128
6130
6132
6134
6136
6138
6140
6142
6144
6146
6148
6150
6152
6154
6156
6158
6160
6162
6164
6166
6168
6170
6172
6174
6176
6178
6180
6182
6184
6186
6188
6190
6192
6194
6196
6198
6200
6202
6204
6206
6208
6210
6212
6214
6216
6218
6220
6222
6224
6226
6228
6230
6232
6234
6236
6238
6240
6242
6244
6246
6248
6250
6252
6254
6256
6258
6260
6262
6264
6266
6268
6270
6272
6274
6276
6278
6280
6282
6284
6286
6288
6290
6292
6294
6296
6298
6300
6302
6304
6306
6308
6310
6312
6314
6316
6318
6320
6322
6324
6326
6328
6330
6332
6334
6336
6338
6340
6342
6344
6346
6348
6350
6352
6354
6356
6358
6360
6362
6364
6366
6368
6370
6372
6374
6376
6378
6380
6382
6384
6386
6388
6390
6392
6394
6396
6398
6400
6402
6404
6406
6408
6410
6412
6414
6416
6418
6420
6422
6424
6426
6428
6430
6432
6434
6436
6438
6440
6442
6444
6446
6448
6450
6452
6454
6456
6458
6460
6462
6464
6466
6468
6470
6472
6474
6476
6478
6480
6482
6484
6486
6488
6490
6492
6494
6496
6498
6500
6502
6504
6506
6508
6510
6512
6514
6516
6518
6520
6522
6524
6526
6528
6530
6532
6534
6536
6538
6540
6542
6544
6546
6548
6550
6552
6554
6556
6558
6560
6562
6564
6566
6568
6570
6572
6574
6576
6578
6580
6582
6584
6586
6588
6590
6592
6594
6596
6598
6600
6602
6604
6606
6608
6610
6612
6614
6616
6618
6620
6622
6624
6626
6628
6630
6632
6634
6636
6638
6640
6642
6644
6646
6648
6650
6652
6654
6656
6658
6660
6662
6664
6666
6668
6670
6672
6674
6676
6678
6680
6682
6684
6686
6688
6690
6692
6694
6696
6698
6700
6702
6704
6706
6708
6710
6712
6714
6716
6718
6720
6722
6724
6726
6728
6730
6732
6734
6736
6738
6740
6742
6744
6746
6748
6750
6752
6754
6756
6758
6760
6762
6764
6766
6768
6770
6772
6774
6776
6778
6780
6782
6784
6786
6788
6790
6792
6794
6796
6798
6800
6802
6804
6806
6808
6810
6812
6814
6816
6818
6820
6822
6824
6826
6828
6830
6832
6834
6836
6838
6840
6842
6844
6846
6848
6850
6852
6854
6856
6858
6860
6862
6864
6866
6868
6870
6872
6874
6876
6878
6880
6882
6884
6886
6888
6890
6892
6894
6896
6898
6900
6902
6904
6906
6908
6910
6912
6914
6916
6918
6920
6922
6924
6926
6928
6930
6932
6934
6936
6938
6940
6942
6944
6946
6948
6950
6952
6954
6956
6958
6960
6962
6964
6966
6968
6970
6972
6974
6976
6978
6980
6982
6984
6986
6988
6990
6992
6994
6996
6998
7000
7002
7004
7006
7008
7010
7012
7014
7016
7018
7020
7022
7024
7026
7028
7030
7032
7034
7036
7038
7040
7042
7044
7046
7048
7050
7052
7054
7056
7058
7060
7062
7064
7066
7068
7070
7072
7074
7076
7078
7080
7082
7084
7086
7088
7090
7092
7094
7096
7098
7100
7102
7104
7106
7108
7110
7112
7114
7116
7118
7120
7122
7124
7126
7128
7130
7132
7134
7136
7138
7140
7142
7144
7146
7148
7150
7152
7154
7156
7158
7160
7162
7164
7166
7168
7170
7172
7174
7176
7178
7180
7182
7184
7186
7188
7190
7192
7194
7196
7198
7200
7202
7204
7206
7208
7210
7212
7214
7216
7218
7220
7222
7224
7226
7228
7230
7232
7234
7236
7238
7240
7242
7244
7246
7248
7250
7252
7254
7256
7258
7260
7262
7264
7266
7268
7270
7272
7274
7276
7278
7280
7282
7284
7286
7288
7290
7292
7294
7296
7298
7300
7302
7304
7306
7308
7310
7312
7314
7316
7318
7320
7322
7324
7326
7328
7330
7332
7334
7336
7338
7340
7342
7344
7346
7348
7350
7352
7354
7356
7358
7360
7362
7364
7366
7368
7370
7372
7374
7376
7378
7380
7382
7384
7386
7388
7390
7392
7394
7396
7398
7400
7402
7404
7406
7408
7410

Elev. 3482' D.F.

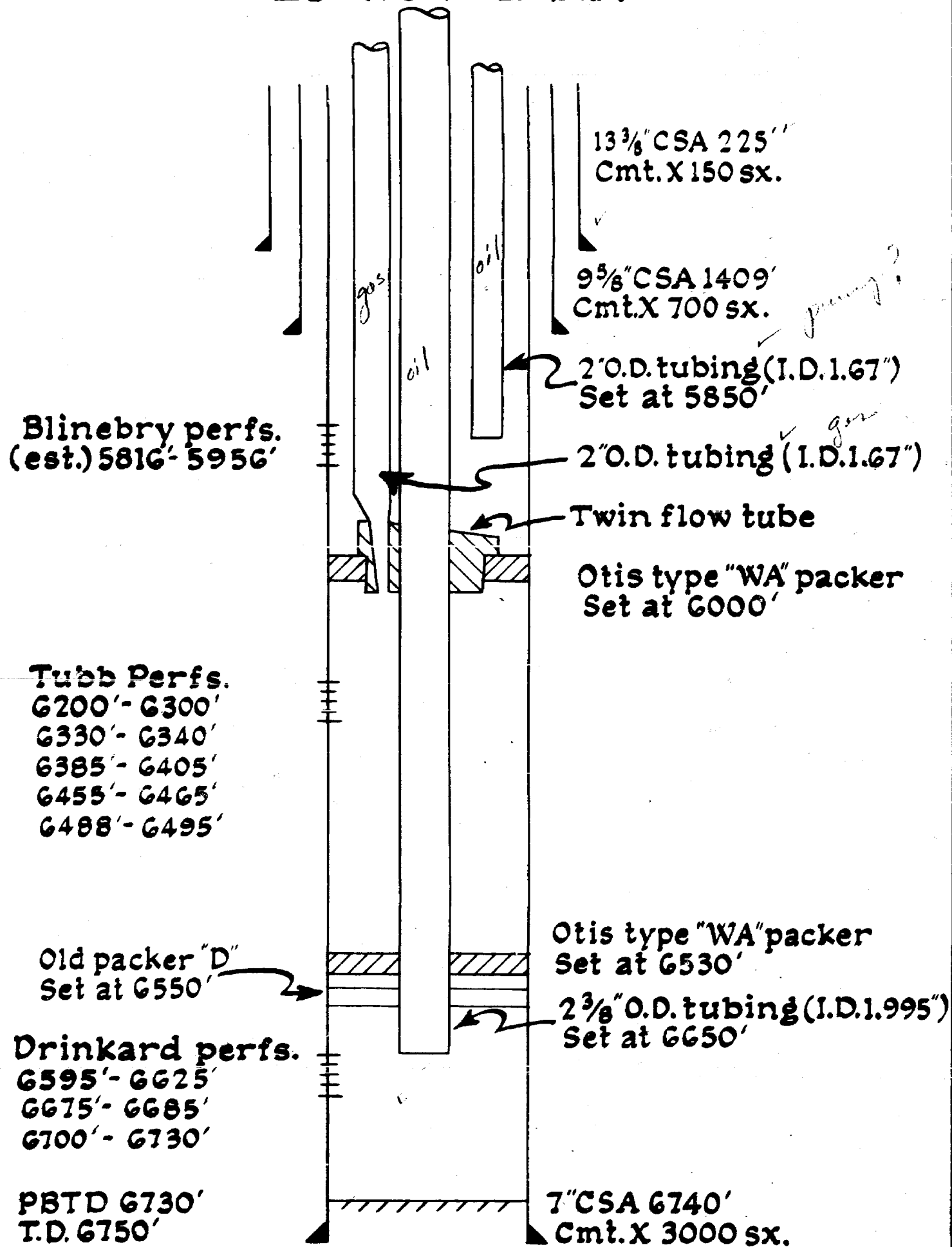

Southland Royalty

"A" No. 2

no scale —

Attachment II

NEW MEXICO OIL CONSERVATION COMMISSION

SANTA FE, NEW MEXICO

5-1-61

APPLICATION FOR MULTIPLE COMPLETION

Operator Pan American Petroleum Corporation		County Lea	Date September 11, 1962
Address Box 268, Lubbock, Texas		Lease Southland Royalty "A"	Well No. 2
Location of Well "B"	Unit "B"	Section 9	Township 21 South
		Range 37 East	

1. Has the New Mexico Oil Conservation Commission heretofore authorized the multiple completion of a well in these same pools or in the same zones within one mile of the subject well? YES _____ NO X
2. If answer is yes, identify one such instance: Order No. _____; Operator, Lease, and Well No.:

3. The following facts are submitted:	Upper Zone	Intermediate Zone	Lower Zone
a. Name of Pool and Formation	Blinobry	Tubb	Drinkard
b. Top and Bottom of Pay Section (Perforations)	To be selected after log is run	6330-6495	6595-6730
c. Type of production (Oil or Gas)	Oil Anticipated	Gas	Oil
d. Method of Production (Flowing or Artificial Lift)	Flow	Flow	Flow

4. The following are attached. (Please mark YES or NO)

- No a. Diagrammatic Sketch of the Multiple Completion, showing all casing strings, including diameters and setting depths, centralizers and/or turbolizers and location thereof, quantities used and top of cement, perforated intervals, tubing strings, including diameters and setting depth, location and type of packers and side door chokes, and such other information as may be pertinent.
- Yes b. Plat showing the location of all wells on applicant's lease, all offset wells on offset leases, and the names and addresses of operators of all leases offsetting applicant's lease.
- No c. Waivers consenting to such multiple completion from each offset operator, or in lieu thereof, evidence that said offset operators have been furnished copies of the application.*
- No d. Electrical log of the well or other acceptable log with tops and bottoms of producing zones and intervals of perforation indicated thereon. (If such log is not available at the time application is filed, it shall be submitted as provided by Rule 112-A.)

5. List all offset operators to the lease on which this well is located together with their correct mailing address.

Continental Oil Co., Attn: Mr. W. A. Mead, 825 Petroleum Bldg., Roswell, New Mexico

Western Oil Fields, Inc., Attn: Mr. R. H. Swarthout, Box 1147, Hobbs, New Mexico

Texaco, Inc., Attn: Mr. W. C. Lentz, Box 3109, Midland, Texas

Shell Oil Company, Attn: Mr. R. L. Rankin, Box 845, Roswell, New Mexico

Humble Oil and Refining Co., Attn: Mr. H. L. Hensley, Box 1600, Midland, Texas

6. Were all operators listed in Item 5 above notified and furnished a copy of this application? YES X NO _____. If answer is yes, give date of such notification **Sept. 11, 1962**

CERTIFICATE: I, the undersigned, state that I am the **Dist. Engineer** of the **Lubbock Dist., Pan American Petroleum Corporation** (company), and that I am authorized by said company to make this report; and that this report was prepared under my supervision and direction and that the facts stated therein are true, correct and complete to the best of my knowledge.

Original
A. J. Inderrieden
Signature

- * Should waivers from all offset operators not accompany an application for administrative approval, the New Mexico Oil Conservation Commission will hold the application for a period of twenty (20) days from date of receipt by the Commission's Santa Fe office. If, after said twenty-day period, no protest nor request for hearing is received by the Santa Fe office, the application will then be processed.
- NOTE: If the proposed multiple completion will result in an unorthodox well location and/or a non-standard production unit in either or both of the producing zones, then separate application for approval of the same should be filed simultaneously with this application.

Attachment IV