

CASE 3220:

SOUTHEASTERN NEW MEXICO
NOMENCLATURE

CASE NO.

APPLICATION,
TRANSCRIPTS,
SMALL Exhibits
ETC.

BEFORE THE OIL CONSERVATION COMMISSION
OF THE STATE OF NEW MEXICO

IN THE MATTER OF THE HEARING
CALLED BY THE OIL CONSERVATION
COMMISSION OF THE STATE OF
NEW MEXICO FOR THE PURPOSE OF
CONSIDERING:

CASE NO. 3220
Order No. R-2879

THE APPLICATION OF THE OIL
CONSERVATION COMMISSION UPON
ITS OWN MOTION FOR AN ORDER
CREATING, CONTRACTING VERTICAL
LIMITS, AND EXTENDING CERTAIN
POOLS IN CHAVES, LEA, AND
ROOSEVELT COUNTIES, NEW MEXICO.

ORDER OF THE COMMISSION

BY THE COMMISSION:

This cause came on for hearing at 9 o'clock a.m. on March 17, 1965, at Santa Fe, New Mexico, before the Oil Conservation Commission of New Mexico, hereinafter referred to as the "Commission."

NOW, on this 25th day of March, 1965, the Commission, a quorum being present, having considered the testimony presented and the exhibits received at said hearing, and being fully advised in the premises,

FINDS:

(1) That due public notice having been given as required by law, the Commission has jurisdiction of this cause and subject matter thereof.

(2) That there is need for the creation of a new pool in Lea County, New Mexico, for the production of gas from the Morrow formation, said pool to bear the designation of Berry-Morrow Gas Pool. Said Berry-Morrow Gas Pool was discovered by Texaco Inc., Berry Unit No. 1, located in Unit B of Section 7, Township 21 South, Range 34 East, NMPM. It was completed in Morrow on June 6, 1964. The top of perforations is 13,908 feet.

- 2 -

CASE NO. 3220

Order No. R-2879

(3) That there is need for the creation of a new pool in Lea County, New Mexico, for the production of gas from the Morrow formation, said pool to bear the designation of Osudo-Morrow Gas Pool. Said Osudo-Morrow Gas Pool was discovered by The British American Oil Producing Company, North Wilson Deep Unit No. 1, located in Unit O of Section 31, Township 20 South, Range 36 East, NMPM. It was completed in Morrow on November 22, 1964. The top of perforations is 11,353 feet.

(4) That there is need for the creation of a new pool in Lea County, New Mexico, for the production of gas from the Pennsylvanian formation, said pool to bear the designation of South Wilson-Pennsylvanian Gas Pool. Said South Wilson-Pennsylvanian Gas Pool was discovered by Sinclair Oil & Gas Company, South Wilson Deep Unit No. 1, located in Unit L of Section 23, Township 21 South, Range 34 East, NMPM. It was completed in Morrow on March 4, 1964. The top of perforations is 12,642 feet.

(5) That there is need for the contraction of the vertical limits of the South Tulk-Wolfcamp Pool in Lea County, New Mexico, to include only the Upper Wolfcamp formation with special vertical limits designated as being from 9,610 feet to 10,240 feet on the log of the Great Western Town No. 1, located 660 feet from the North line and 1980 feet from the West line of Section 18, Township 15 South, Range 35 East, NMPM. Further, to redesignate said pool as the South Tulk-Upper Wolfcamp Pool.

(6) That there is need for certain extensions to the Caprock-Queen Pool in Chaves County, New Mexico, the North Bagley-Upper Pennsylvanian Pool, the Blinebry Oil Pool, the East Caprock-Devonian Pool, the Drinkard Pool, the Goodwin-Drinkard Pool, the Inbe-Pennsylvanian Pool, the West Kennitz-Lower Wolfcamp Pool, the Mesalero-San Andres Pool, the Monument-Tubb Pool, the Sawyer-San Andres Gas Pool, the Tubb Gas Pool, and the Vacuum-Yates Gas Pool, all in Lea County, New Mexico, and the Bluit-San Andres Gas Pool in Roosevelt County, New Mexico.

IT IS THEREFORE ORDERED:

(a) That a new pool in Lea County, New Mexico, classified as a gas pool for Morrow production, is hereby created and designated as the Berry-Morrow Gas Pool, consisting of the following described area:

TOWNSHIP 21 SOUTH, RANGE 34 EAST, NMPM
SECTION 7: S/2

- 3 -

CASE NO. 3220

Order No. R-2879

(b) That a new pool in Lea County, New Mexico, classified as a gas pool for Morrow production, is hereby created and designated as the Osudo-Morrow Gas Pool, consisting of the following described area:

TOWNSHIP 20 SOUTH, RANGE 36 EAST, NMPM
SECTION 31: E/2

(c) That a new pool in Lea County, New Mexico, classified as a gas pool for Pennsylvanian production, is hereby created and designated as the South Wilson-Pennsylvanian Gas Pool, consisting of the following described area:

TOWNSHIP 21 SOUTH, RANGE 34 EAST, NMPM
SECTION 23: W/2

(d) That the North Bagley-Upper Pennsylvanian Pool in Lea County, New Mexico, as heretofore classified, defined, and described, is hereby extended to include therein:

TOWNSHIP 11 SOUTH, RANGE 33 EAST, NMPM
SECTION 3: S/2 SW/4
SECTION 22: NW/4 and S/2 SE/4
SECTION 27: NE/4

(e) That the Blinebry Oil Pool in Lea County, New Mexico, as heretofore classified, defined, and described, is hereby extended to include therein:

TOWNSHIP 22 SOUTH, RANGE 38 EAST, NMPM
SECTION 20: NW/4

(f) That the Bluitt-San Andres Gas Pool in Roosevelt County, New Mexico, as heretofore classified, defined, and described, is hereby extended to include therein:

TOWNSHIP 3 SOUTH, RANGE 37 EAST, NMPM
SECTION 9: N/2
SECTION 10: N/2
SECTION 11: NW/4

(g) That the East Caprock-Devonian Pool in Lea County, New Mexico, as heretofore classified, defined, and described, is hereby extended to include therein:

TOWNSHIP 12 SOUTH, RANGE 32 EAST, NMPM
SECTION 23: NW/4

- 4 -

CASE NO. 3220
Order No. R-2879

(h) That the Caprock-Queen Pool in Chaves County, New Mexico, as heretofore classified, defined, and described, is hereby extended to include therein:

TOWNSHIP 15 SOUTH, RANGE 31 EAST, NMPM
SECTION 3: SE/4 and E/2 SW/4

(i) That the Drinkard Pool in Lea County, New Mexico, as heretofore classified, defined, and described, is hereby extended to include therein:

TOWNSHIP 21 SOUTH, RANGE 37 EAST, NMPM
SECTION 19: N/2 NW/4

(j) That the Goodwin-Drinkard Pool in Lea County, New Mexico, as heretofore classified, defined, and described, is hereby extended to include therein:

TOWNSHIP 18 SOUTH, RANGE 37 EAST, NMPM
SECTION 30: SW/4

(k) That the Inbe-Pennsylvanian Pool in Lea County, New Mexico, as heretofore classified, defined, and described, is hereby extended to include therein:

TOWNSHIP 11 SOUTH, RANGE 33 EAST, NMPM
SECTION 1: SE/4
SECTION 12: NW/4

(l) That the West Kemnitz-Lower Wolfcamp Pool in Lea County, New Mexico, as heretofore classified, defined, and described, is hereby extended to include therein:

TOWNSHIP 16 SOUTH, RANGE 33 EAST, NMPM
SECTION 31: W/2 NW/4

(m) That the Mescalero-San Andres Pool in Lea County, New Mexico, as heretofore classified, defined, and described, is hereby extended to include therein:

TOWNSHIP 10 SOUTH, RANGE 32 EAST, NMPM
SECTION 26: NW/4
SECTION 27: E/2

(n) That the Monument-Tubb Pool in Lea County, New Mexico, as heretofore classified, defined, and described, is hereby extended to include therein:

- 6 -

CASE NO. 3220
Order No. R-2879

DONE at Santa Fe, New Mexico, on the day and year herein-
above designated.

STATE OF NEW MEXICO
OIL CONSERVATION COMMISSION

Jack M. Campbell

JACK M. CAMPBELL, Chairman

Guyton B. Hays

GUYTON B. HAYS, Member

A. L. Porter, Jr.

A. L. PORTER, JR., Member & Secretary

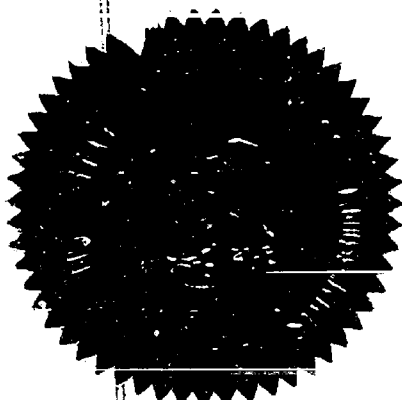

CASE 3220: (a) CREATION OF A NEW GAS POOL

COUNTY LEA POOL BERRY-MORROW GAS

TOWNSHIP 21 South RANGE 34 East NMIM

6	5	4	3	2	1
7	8	9	10	11	12
18	17	16	15	14	13
19	20	21	22	23	24
30	29	28	27	26	25
31	32	33	34	35	36

PURPOSE: One completed gas well capable of producing.

TEXACO, INC. - Berry Unit #1 in Unit N of Section 7-21-34. Completed in Morrow on June 6, 1964. Top of Perforations 13,908'.

Proposed pool boundary colored in red. SECTION 7: S/2

CASE 3220: (b) CREATION OF A NEW GAS POOL

COUNTY LEA POOL OSUDO-MORROW GAS

TOWNSHIP 20 South			RANGE 36 East			NMPM		
6	5	4	3	2	1			
7	8	9	10	11	12			
16	17	16	15	14	13			
19	20	21	22	23	24			
30	29	28	27	26	25			
31	32	33	34	35	36			

PURPOSE: One completed gas well capable of producing.

THE BRITISH AMERICAN OIL PRODUCING COMPANY - North Wilson Deep Unit #1
in Unit 0 of Section 31-20-36. Completed in Morrow on November 22, 1964.
Top of Perforations 11,353'.

Proposed pool boundary colored in red. SECTION 31: E/2

CASE 3220: (c) CREATION OF A NEW GAS POOL

COUNTY LEA POOL SOUTH WILSON-PENNSYLVANIAN GAS

TOWNSHIP 21 South RANGE 34 East NM 1M

A 6x6 grid with numbers 1 through 36. The numbers are arranged in a boustrophedon pattern, starting from the top right (1) and ending at the bottom left (36). A 2x2 square of cells is highlighted with a thicker border, containing the numbers 23, 24, 27, and 26. The grid is composed of 36 small squares arranged in 6 rows and 6 columns. The numbers are placed in the center of each square. The highlighted square is located in the third row from the top and the fourth column from the left. The numbers in the highlighted square are 23, 24, 27, and 26. The numbers in the grid are: Row 1: 6, 5, 4, 3, 2, 1; Row 2: 7, 8, 9, 10, 11, 12; Row 3: 18, 17, 16, 15, 14, 13; Row 4: 19, 20, 21, 22, 23, 24; Row 5: 30, 29, 28, 27, 26, 25; Row 6: 31, 32, 33, 34, 35, 36. The highlighted square contains the numbers 23, 24, 27, and 26.

PURPOSE: One completed gas well capable of producing.

SINCLAIR OIL & GAS COMPANY - South Wilson Deep Unit #1 in Unit L of
Section 23-21-34. Completed in Morrow on March 4, 1961. Top of Perfora-
tions 12,642'.

Proposed pool boundary colored in red. SECTION 23: W/2

COUNTY	LEA	POOL	NORTH BAGLEY-UPPER PENNSYLVANIAN
--------	-----	------	----------------------------------

PURPOSE: Two completed oil wells capable of producing.

DEANE H. STOLTZ - State NBF #1 in Unit F of Section 22-11-33. Completed in Upper Pennsylvanian on December 13, 1964. Top of Perforations 9102'.

H. L. BROWN, JR. & W. J. HEATH - M.P.C. State #1 in Unit H of Section 27-11-33. Completed in Upper Pennsylvanian on December 18, 1964. Top of Perforations 9397½'.

ADDITION--CHARLES B. GILLESPIE, JR. - State "A" #1 in Unit N of Section 3-11-33. Completed in Upper Pennsylvanian on February 14, 1965. Top of Perforations 9552'.

Pool boundary colored in red.

Proposed pool extensions colored in green. SECTION 22: NW/4 and S/2 SE
SECTION 27: NE/4

ADDITION----SECTION 3: S/2 SW/4

CASE 3220: (e) EXTENSION OF AN EXISTING OIL POOL

COUNTY LEA POOL BLINEBRY OIL
TOWNSHIP 22 South RANGE 38 East NMPM

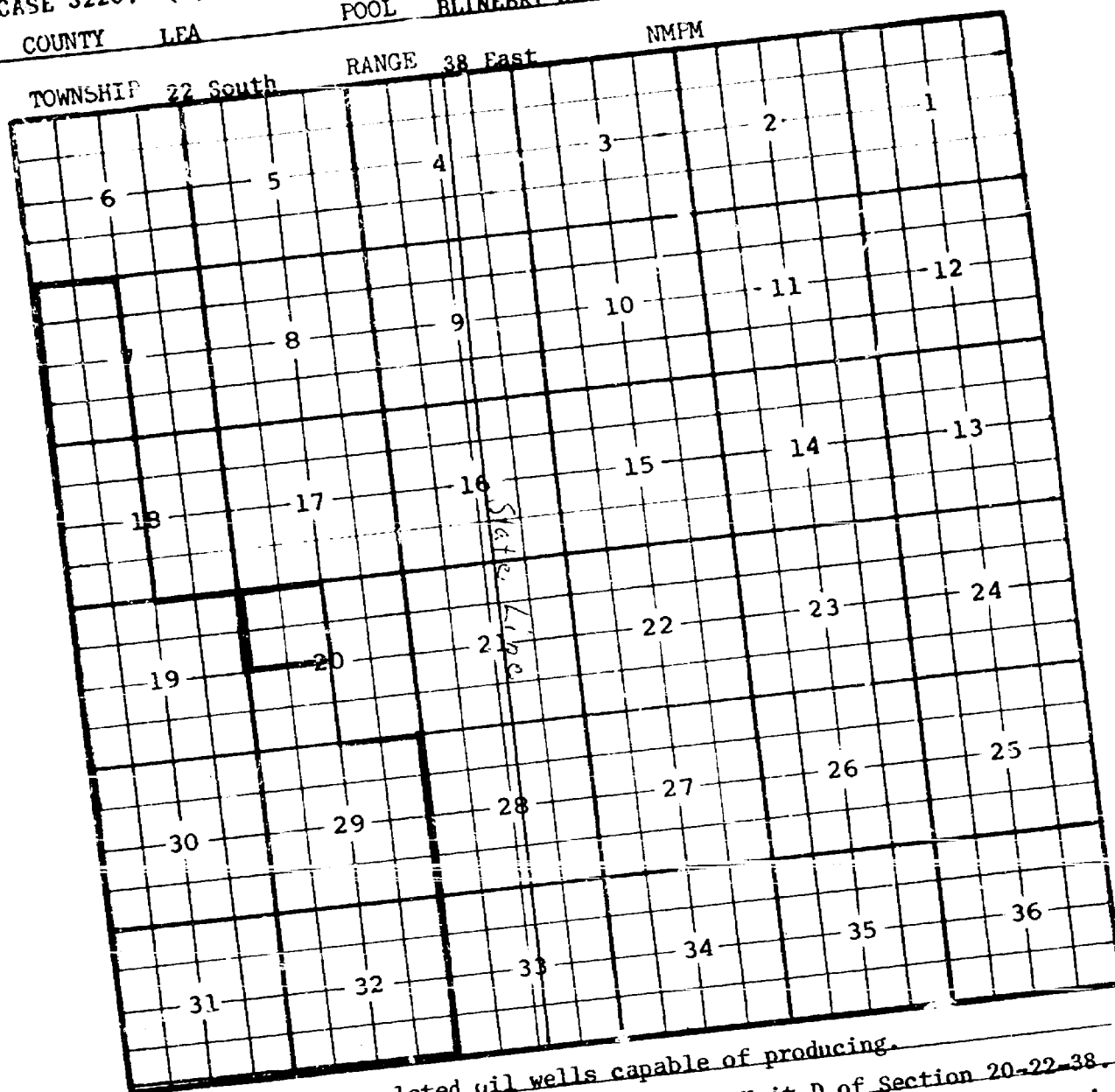

PURPOSE: Two completed oil wells capable of producing.
TEXACO, INC. - A. H. Blinebry NCT-1 #10 in Unit D of Section 20-22-38.
Completed in Blinebry on January 23, 1965. Top of Perforations 5659'.
TEXACO, INC. - A. H. Blinebry NCT-1 #20 in Unit E of Section 20-22-38.
Completed in Blinebry on January 5, 1965. Top of Perforations 5644'.
Pool boundary colored in red.
Proposed pool extension colored in green. SECTION 20: NW/4

CASE 3220: (f) EXTENSION OF AN EXISTING GAS POOL
COUNTY ROOSEVELT POOL BLUETT-SAN ANDRES GAS

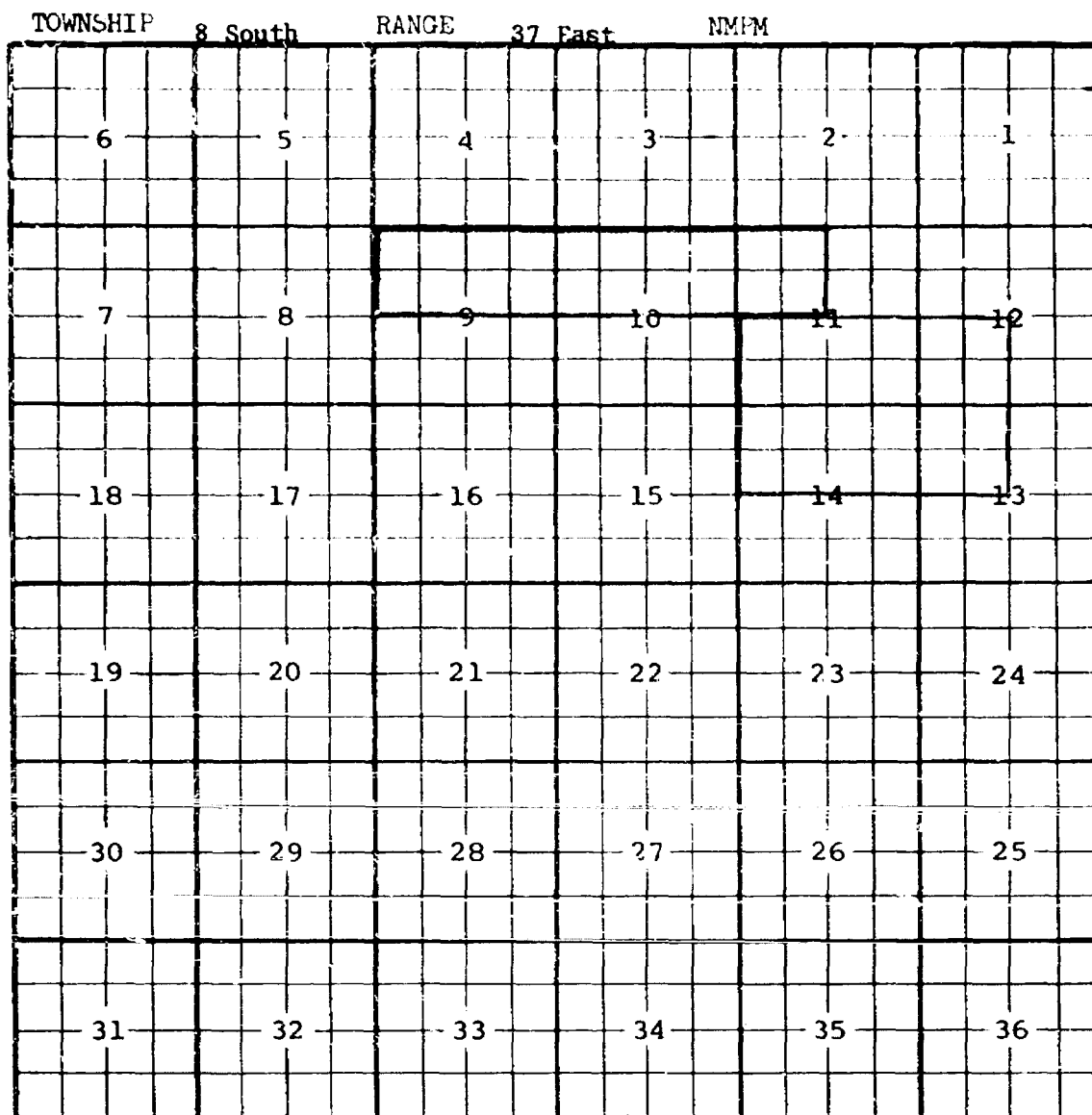

PURPOSE: Two completed gas wells capable of producing.

BTA OIL PRODUCERS - Belmont C Ltd. #1 in Unit C of Section 9-8-37. Completed in San Andres on July 17, 1964. Top of Perforations 4410'.

BTA OIL PRODUCERS - Perkins #1 in Unit F of Section 10-8-37. Completed in San Andres on May 4, 1964. Top of Perforations 4425'.

Pool boundary colored in red.

Proposed pool extensions colored in green. SECTION 9: N/2

SECTION 10: N/2

SECTION 11: NW/4

CASE 3220: (g) EXTENSION OF AN EXISTING OIL POOL
COUNTY LEA POOL EAST CARPCK-DEVONIAN

TOWNSHIP 12 South			RANGE 32 East			NMPM		
6	5	4	3	2	1			
7	8	9	10	11	12			
18	17	16	15	14	13			
19	20	21	22	23	24			
30	29	28	27	26	25			
31	32	33	34	35	36			

PURPOSE: One completed oil well capable of producing.

CARPER DRILLING COMPANY, INC. - Soldier Hill State "AE" #1 in Unit C of
Section 23-12-32. Completed in Devonian on May 15, 1964. Top of Perfor-
rations 11,224'.

Pool boundary colored in red.

Proposed pool extension colored in green. SECTION 23: NW/4

CASE 3220: (h) EXTENSION OF AN EXISTING OIL POOL

COUNTY CHAVES

POOL CAPROCK-QUEEN

TOWNSHIP

15 South

RANGE 31 East

NMPM

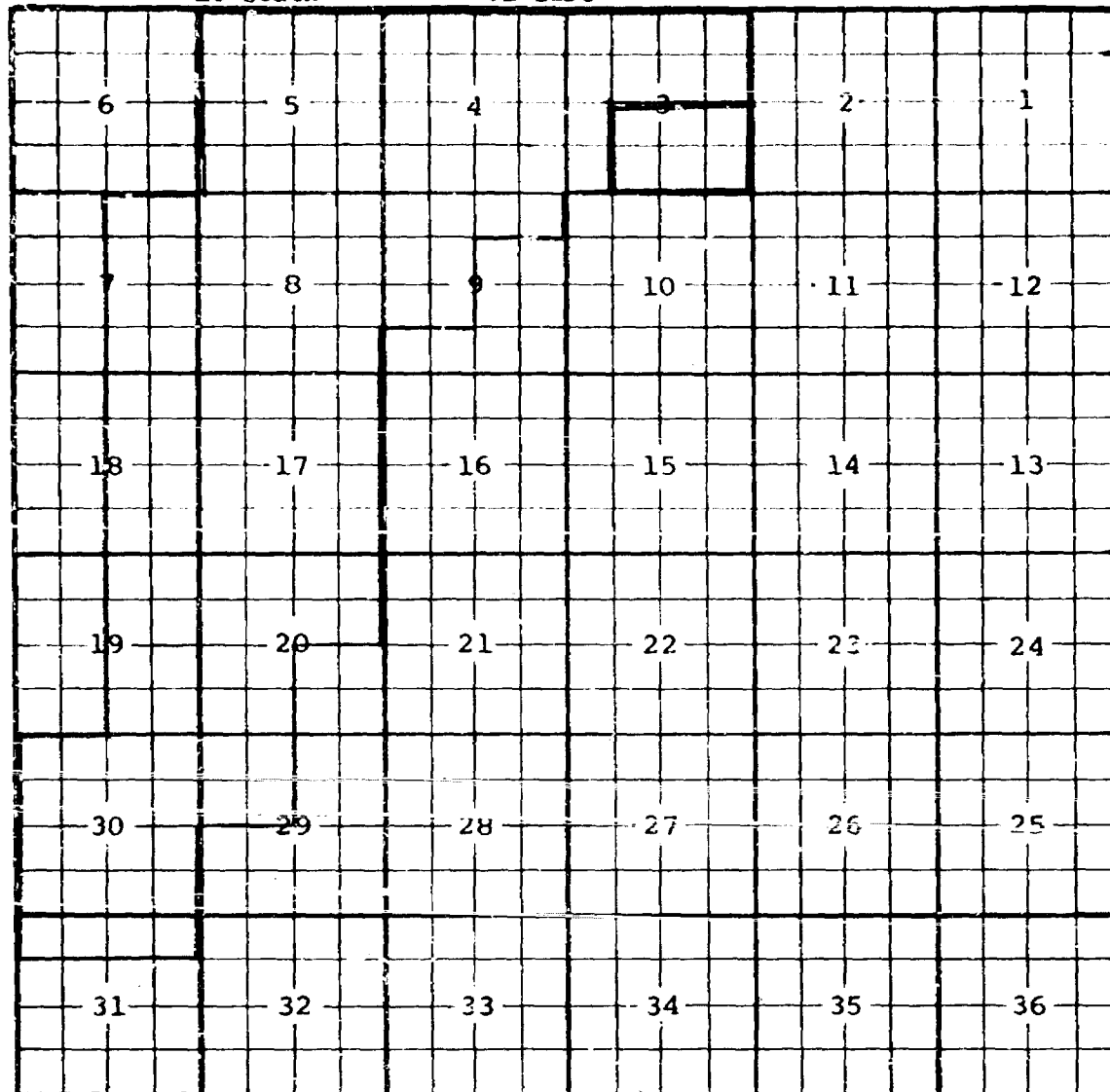

PURPOSE: Two completed oil wells capable of producing.

TENNECO OIL COMPANY - USA Reno Oil Company #3 in Unit K of Section 3-15-31. Completed in Queen on January 21, 1965. Top of Perforations 3154'.

TENNECO OIL COMPANY - USA Reno Oil Company #4 in Unit N of Section 3-15-31. Completed in Queen on January 31, 1965. Top of Perforations 3160'. Pool boundary colored in red.

Proposed pool extensions colored in green. SECTION 3: SE/4 and E/2 SW/4

CASE 3220: (i) EXTENSION OF AN EXISTING OIL POOL

COUNTY LEA POOL DRINKARD

TOWNSHIP 21 South RANGE 37 East NMFM

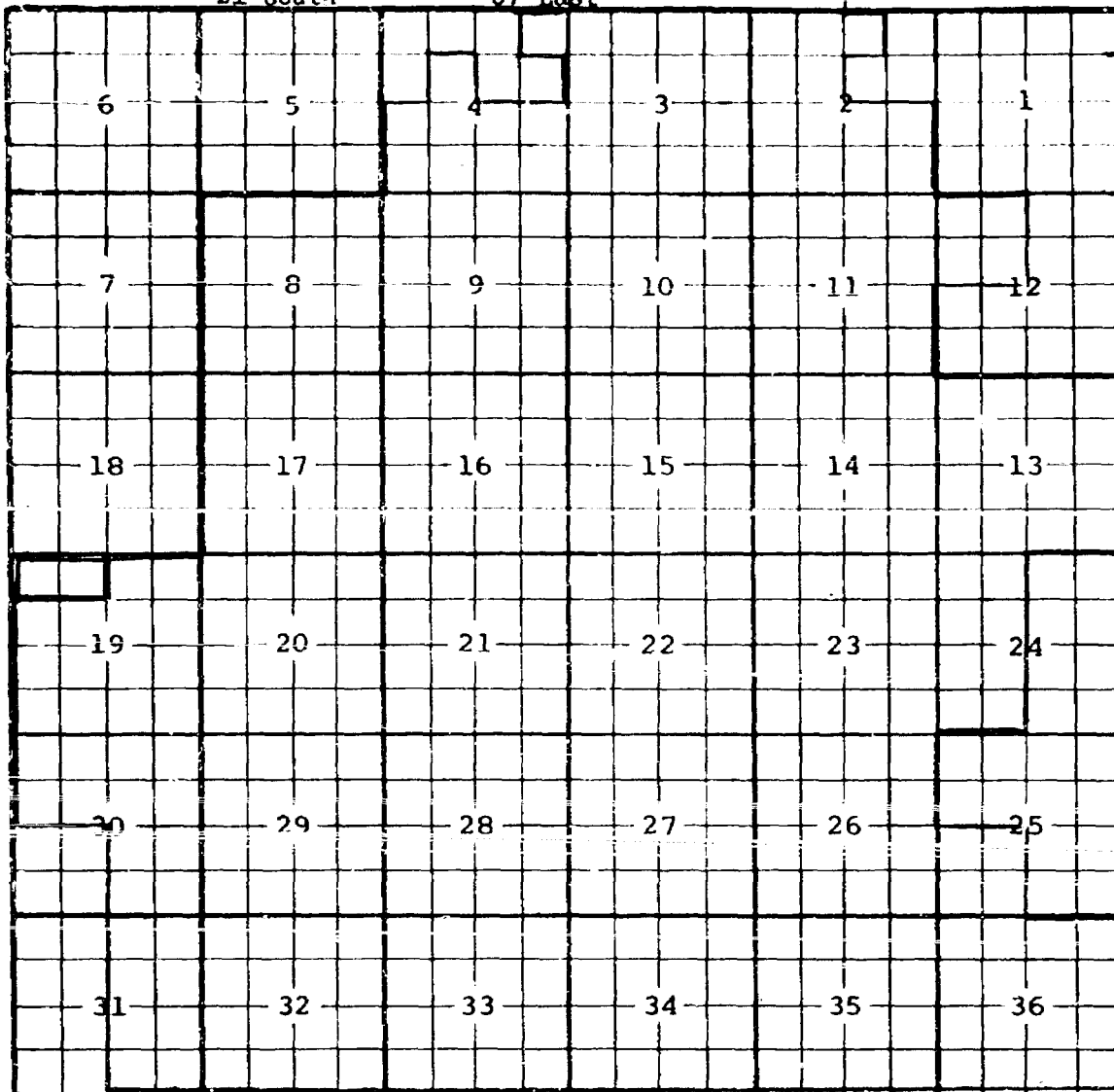

PURPOSE: One completed oil well capable of producing.

PENROSE PRODUCTION COMPANY - Sunshine State #1 in Unit C of Section 19-21-37. Completed in Drinkard on June 8, 1964. Top of Perforations 6658 $\frac{1}{2}$ '.

Pool boundary colored in red.

Proposed pool extension colored in green. SECTION 19: N/2 NW/4

CASE 3220: (j) EXTENSION OF AN EXISTING OIL POOL
COUNTY LEA POOL GOODWIN-DRINKARD

TOWNSHIP 18 South RANGE 37 East NMFM

6	5	4	3	2	1
7	8	9	10	11	12
18	17	16	15	14	13
19	20	21	22	23	24
30	29	28	27	26	25
31	32	33	34	35	36

PURPOSE: One completed oil well capable of producing.

CONTINENTAL OIL COMPANY - State GG-30 #3 in Unit N of Section 30-18-37.

Completed in Drinkard on January 3, 1965. Top of Perforations 6982'.

Pool boundary colored in red.

Proposed pool extension colored in green. SECTION 30: SW/4

CASE 3220: (k) EXTENSION OF AN EXISTING OIL POOL

COUNTY LEA POOL INDE-PAENSYLVANIAN

TOWNSHIP 11 South RANGE 33 East NMFM

6	5	4	3	2		
7	8	9	10	11	12	
18	17	16	15	14	13	
19	20	21	22	23	24	
30	29	28	27	26	25	
31	32	33	34	35	36	

PURPOSE: Two completed oil wells capable of producing.

SAM BOREN - Southern Natural Gas Company #1 in Unit I of Section 1-11-33.

Completed in Bough C on February 4, 1965. Top of Perforations 9690'.

SOUTHLAND ROYALTY COMPANY - Federal McKinley #1 in Unit O of Section 1-

11-33. Completed in Bough C on January 17, 1964. Top of Perforations

9704'.

ADDITION--SOUTHLAND ROYALTY COMPANY - J. D. Guye #4 in Unit F of Section

12-11-33. Completed in Bough C on February 18, 1965. Top of

Perforations 9699'.

Pool boundary colored in red.

Proposed pool extensions colored in green. SECTION 1: SE/4

ADDITION--SECTION 12: NW/4

CASE 3220: (1) EXTENSION OF AN EXISTING OIL POOL

COUNTY LEA POOL WEST KEMNITZ-LOWER WOLFCAMP

TOWNSHIP 16 South			RANGE 33 East			NM1M		
6	5	4	3	2	1			
7	8	9	10	11	12			
18	17	16	15	14	13			
19	20	21	22	23	24			
30	29	28	27	26	25			
31	32	33	34	35	36			

PURPOSE: One completed oil well capable of producing.

DELAWARE APACHE CORPORATION - Maljamar North Unit #4 in Unit E of

Section 31-16-33. Completed in Lower Wolfcamp on December 2, 1954.

Top of Perforations 10,741'.

Pool boundary colored in red.

Proposed pool extension colored in green. SECTION 31: W/2 NW/4

CASE 3220: (m) EXTENSION OF AN EXISTING OIL POOL

COUNTY LEA POOL MESCALERO-SAN ANDRES

TOWNSHIP 10 South RANGE 32 East NMFM

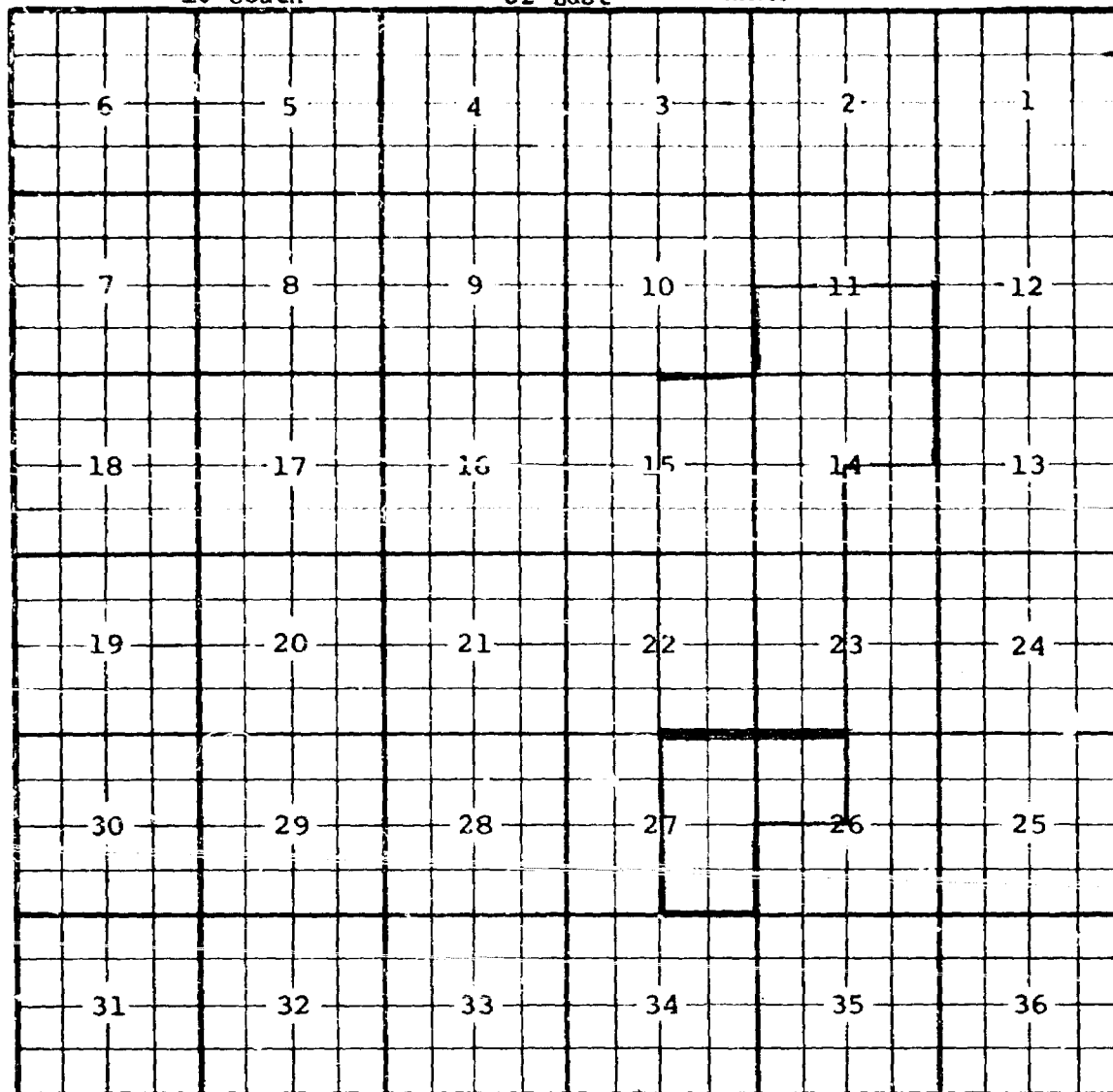

PURPOSE: Four completed oil wells capable of producing.

SUN OIL COMPANY - St. of New Mexico "E" #1 in Unit D of Section 26-10-32. Completed in San Andres on January 1, 1965. Top of Perforations 4074'.

SUN OIL COMPANY - St. of New Mexico "E" #2 in Unit E of Section 26-10-32. Completed in San Andres on January 19, 1965. Top of Perforations 4188'.

SUN OIL COMPANY - St. of New Mexico "E" #3 in Unit C of Section 26-10-32. Completed in San Andres on February 4, 1965. Top of Perforations 4124'.

SUN OIL COMPANY - St. of New Mexico "E" #4 in Unit F of Section 26-10-32. Completed in San Andres on February 26, 1965. Top of Perforations 4159'.

ADDITION--HUMBLE OIL & REG. CO. - New Mexico St. #3 in Unit J of Section 27-10-32. Completed in San Andres on January 10, 1965. Top of Perforations 4050'.

road boundary, colored in red

Proposed pool extensions colored in green. SECTION 26: NW/4

ADDITION---SECTION 27: E/2

CASE 3220: (n) EXTENSION OF AN EXISTING OIL POOL

COUNTY LEA POOL MONUMENT-TUBB

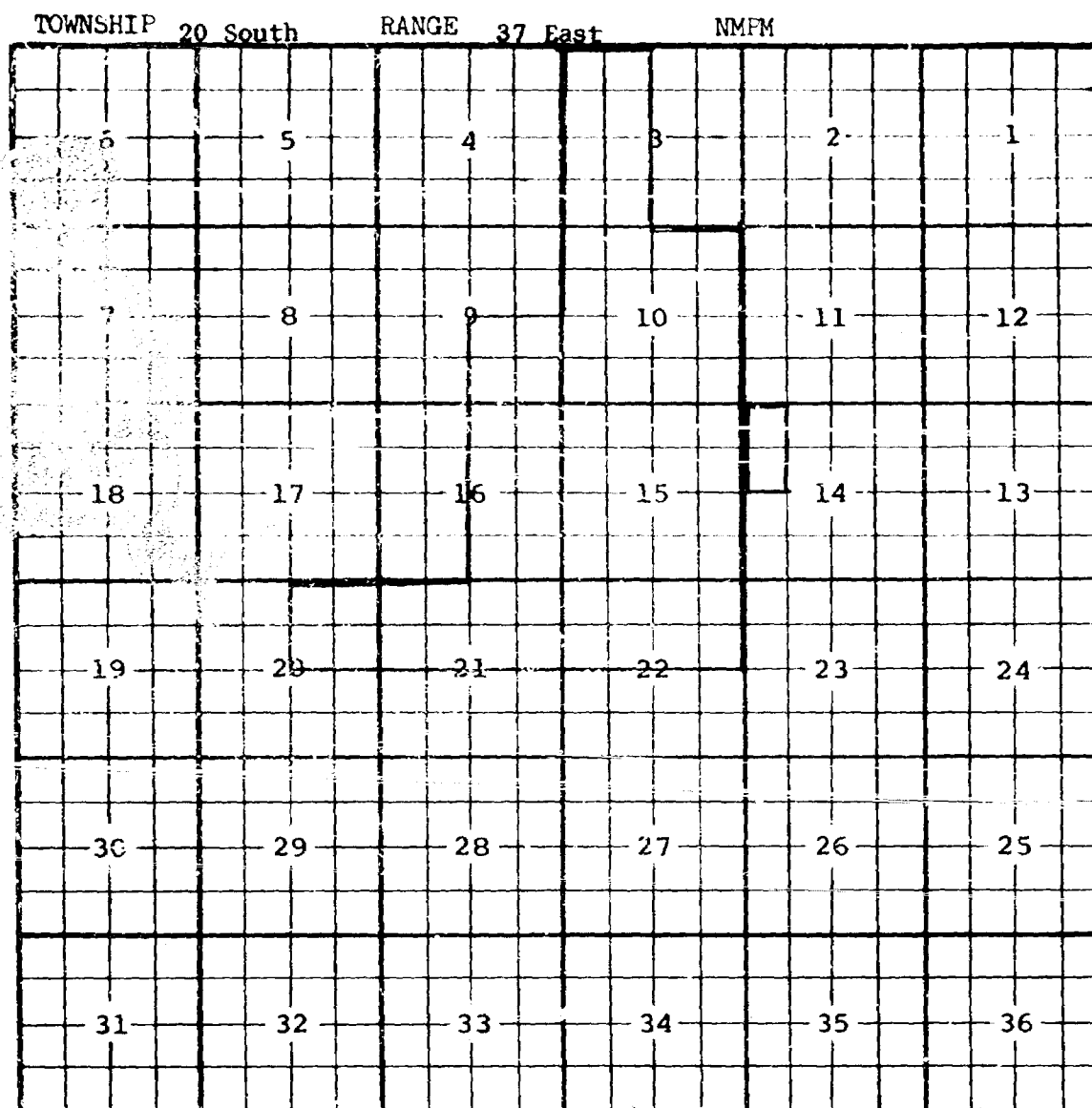

PURPOSE: One completed oil well capable of producing.

CONTINENTAL OIL COMPANY - SEMU Tubb #86 in Unit D of Section 14-20-37.

Completed in Tubb on December 23, 1964. Top of Perforations 6488'.

Pool boundary colored in red.

Proposed pool extension colored in green. SECTION 14: W/2 NW/4

CASE 3220: (o) EXTENSION OF AN EXISTING GAS POOL (Continued on next page)

COUNTY LEA POOL SAWYER-SAN ANDRES GAS

TOWNSHIP 9 South RANGE 37 East NMFM

6	5	4	3	2	1
7	8	9	10	11	12
18	17	16	15	14	13
19	20	21	22	23	24
30	29	28	27	26	25
31	32	33	34	35	36

PURPOSE: Two completed gas wells and two completed oil wells capable of producing.

WESTERN DRILLING COMPANY - Toles Federal #1 in Unit H of Section 13-9-37.

Completed in San Andres on July 16, 1961. Top of Perforations 4918'.

Pool boundary colored in red.

Proposed pool extension colored in green. SECTION 13: E/2

CASE 3220: (o) EXTENSION OF AN EXISTING GAS POOL (Continued)

COUNTY LEA POOL SAWYER-SAN ANDRES GAS

TOWNSHIP 9 South RANGE 38 East NMIM

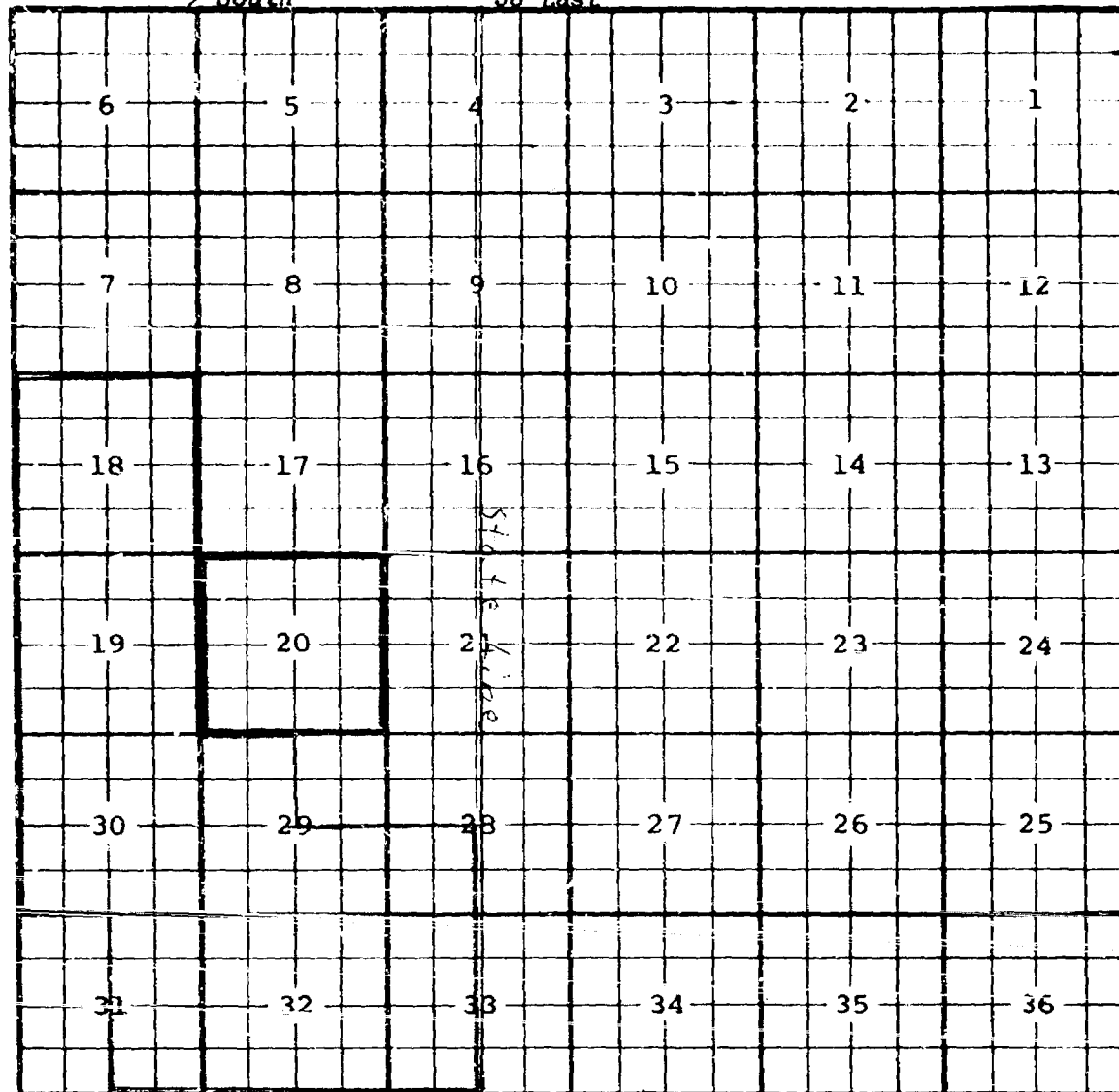

PURPOSE: As stated on preceding page, paragraph (o), Exhibit I

SOCONY MOBIL OIL COMPANY, INC. - Bell Federal #1 in Unit G of Section 20-9-38. Completed in San Andres on January 17, 1961. Top of Perforations 4910'.

SOCONY MOBIL OIL COMPANY, INC. - Bell Federal #2 in Unit P of Section 20-9-38. Completed in San Andres on January 4, 1961. Top of Perforations 4877'.

SOCONY MOBIL OIL COMPANY, INC. - Bell Federal #3 in Unit N of Section 20-9-38. Completed in San Andres on January 22, 1961. Top of Perforations 4917'.

Pool boundary colored in red.

Proposed pool extension colored in green. SECTION 20: All

CASE 3220: (p) EXTENSION OF AN EXISTING GAS POOL

COUNTY LEA POOL TUBB GAS

TOWNSHIP 22 South RANGE 38 East NMFM

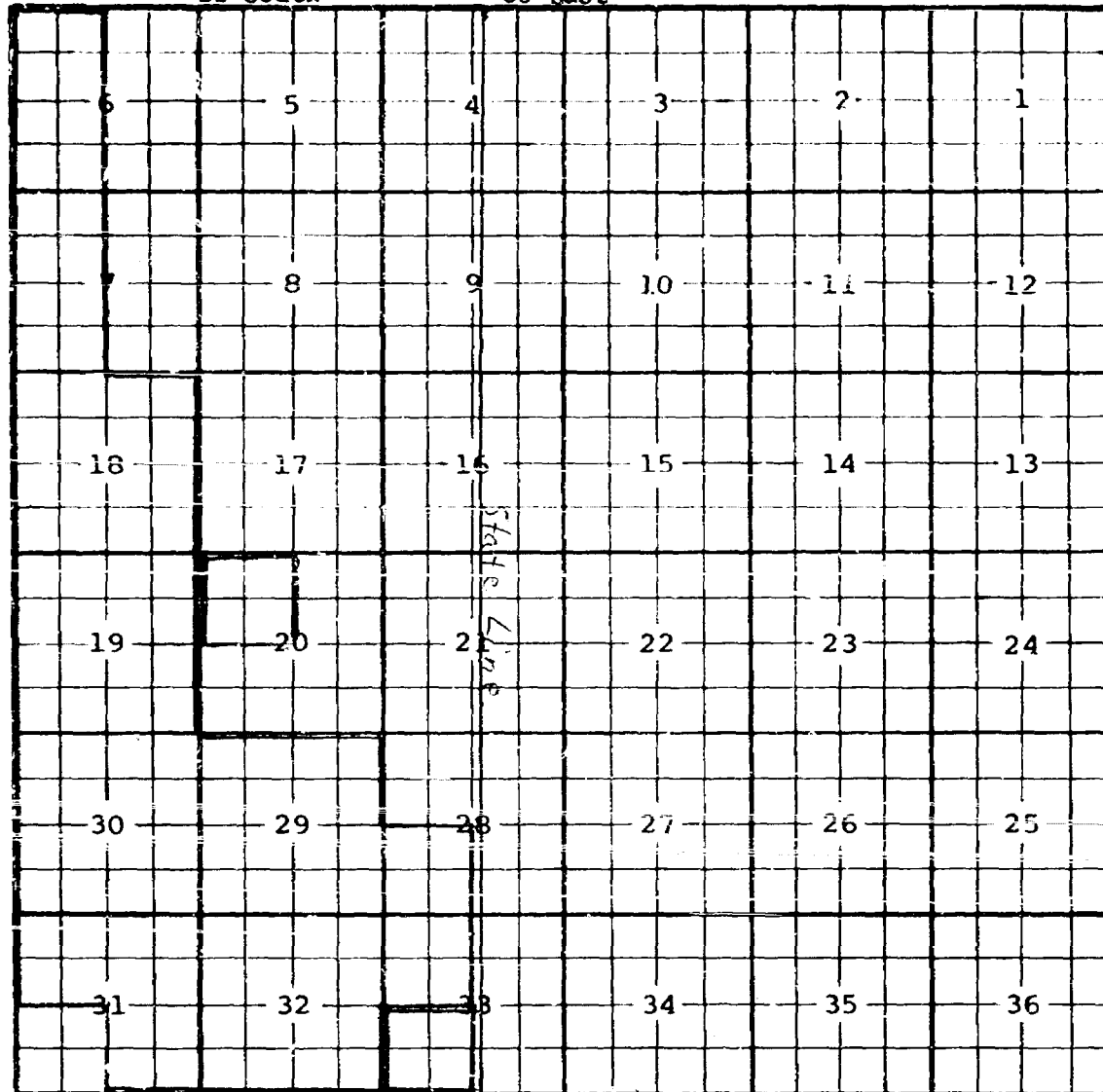

PURPOSE: One completed oil well capable of producing.

TEXACO, INC. - A. H. Blinebry NCT-1 #20 in Unit E of Section 20-22-38.

Completed in Tubb on January 5, 1965. Top of Perforations 6204'.

ADDITION--TEXACO, INC. - A. H. Blinebry NCT-1 #16 in Unit L of Section 33-22-38. Completed in Tubb on April 27, 1964. Top of Perforations 6151'.

Pool boundary colored in red.

Proposed pool extensions colored in green. SECTION 20: NW/4

ADDITION---SECTION 33: SW/4

CASE 3220: (q) EXTENSION OF AN EXISTING GAS POOL

COUNTY LEA POOL VACUUM-YATES GAS

TOWNSHIP 17 South RANGE 34 East NMIM

6	5	4	3	2	1
7	8	9	10	11	12
18	17	16	15	14	13
19	20	21	22	23	24
30	29	28	27	26	25
31	32	33	34	35	36

PURPOSE: One completed gas well capable of producing.

PHILLIPS PETROLEUM COMPANY - M. E. Hale #11 in Unit K of Section 35-17-

34. Completed in Yates on August 1, 1964. Top of Perforations 2997'.

Pool boundary colored in red.

Proposed pool extension colored in green. SECTION 35: SW/4

NONEXCLUSIVE ADVERTISEMENT FOR MARCH, 1965

CASE 57720

In the matter of the application of the Oil Conservation Commission of New Mexico upon its own motion for an order for the creation of new pools in Lea County, New Mexico, and extensions of certain existing pools in Chaves, Lea, and Roosevelt Counties, New Mexico, and giving notice to all persons and parties interested in the subject matter thereof to appear and show cause why such creations and extensions should not be made.

a) CREATE A new ~~pool in Lea County, New Mexico, classified as a~~ gas pool for Morrow production, designated as the Berry-Morrow Gas Pool, and described as:

✓ TOWNSHIP 21 SOUTH, RANGE 34 EAST, NMPM
SECTION 7: S/2

b) CREATE A new ~~pool in Lea County, New Mexico, classified as a~~ gas pool for Morrow production, designated as the Osudo-Morrow Gas Pool, and described as:

✓ TOWNSHIP 20 SOUTH, RANGE 36 EAST, NMPM
SECTION 31: E/2

c) CREATE A new ~~pool in Lea County, New Mexico, classified as a~~ gas pool for Pennsylvanian production, designated as the South Wilson-Pennsylvanian Gas Pool, and described as:

✓ TOWNSHIP 21 SOUTH, RANGE 34 EAST, NMPM
SECTION 23: W/2

d) EXTEND the North Bagley-Upper Pennsylvanian Pool ~~in Lea County, New Mexico, to include therein:~~

✓ TOWNSHIP 11 SOUTH, RANGE 33 EAST, NMPM
SECTION 22: NW/4 and S/2 SE/4
SECTION 27: NE/4

e) EXTEND the Blinebry Oil Pool ~~in Lea County, New Mexico, to include therein:~~

✓ TOWNSHIP 22 SOUTH, RANGE 38 EAST, NMPM
SECTION 20: NW/4

f) EXTEND the Bluitt-San Andres Gas Pool ~~in Roosevelt County, New Mexico, to include therein:~~

✓ TOWNSHIP 8 SOUTH, RANGE 37 EAST, NMPM
SECTION 9: N/2
SECTION 10: N/2
SECTION 11: NW/4

g) EXTEND the East Caprock-Devonian Pool ~~in Lea County, New Mexico, to include therein:~~

✓ TOWNSHIP 12 SOUTH, RANGE 32 EAST, NMPM
SECTION 23: NW/4

h) EXTEND the Caprock-Queen Pool ~~in Chaves County, New Mexico~~, to include ~~therein~~.

✓ TOWNSHIP 15 SOUTH, RANGE 31 EAST, NMPM
SECTION 3: SE/4 and 1/2 SW/4

i) EXTEND the Drinkard Pool ~~in Lea County, New Mexico~~, to include ~~therein~~.

✓ TOWNSHIP 21 SOUTH, RANGE 37 EAST, NMPM
SECTION 19: N/2 NW/4

j) EXTEND the Goodwin-Drinkard Pool ~~in Lea County, New Mexico~~, to include ~~therein~~.

✓ TOWNSHIP 18 SOUTH, RANGE 37 EAST, NMPM
SECTION 30: SW/4

k) EXTEND the Inbe-Pennsylvanian Pool ~~in Lea County, New Mexico~~, to include ~~therein~~.

✓ TOWNSHIP 11 SOUTH, RANGE 33 EAST, NMPM
SECTION 1: SE/4

l) EXTEND the West Kemnitz-Lower Wolfcamp Pool ~~in Lea County, New Mexico~~, to include ~~therein~~.

✓ TOWNSHIP 16 SOUTH, RANGE 33 EAST, NMPM
SECTION 31: W/2 NW/4

m) EXTEND the Mescalero-San Andres Pool ~~in Lea County, New Mexico~~, to include ~~therein~~.

✓ TOWNSHIP 10 SOUTH, RANGE 32 EAST, NMPM
SECTION 26: NW/4

n) EXTEND the Monument-Tubb Pool ~~in Lea County, New Mexico~~, to include ~~therein~~.

✓ TOWNSHIP 20 SOUTH, RANGE 37 EAST, NMPM
SECTION 14: W/2 NW/4

o) EXTEND the Sawyer-San Andres Gas Pool ~~in Lea County, New Mexico~~, to include ~~therein~~.

✓ TOWNSHIP 9 SOUTH, RANGE 37 EAST, NMPM
SECTION 13: E/2

✓ TOWNSHIP 9 SOUTH, RANGE 38 EAST, NMPM
SECTION 20: All

p) EXTEND the Tubb Gas Pool ~~in Lea County, New Mexico~~, to include ~~therein~~.

✓ TOWNSHIP 22 SOUTH, RANGE 38 EAST, NMPM
SECTION 20: NW/4

-3- March, 1965 Nomenclature

q) EXTEND the Vacuum-Yates Gas Pool in ~~Lee County, New Mexico~~, to include therein:

✓ TOWNSHIP 17 SOUTH, RANGE 34 EAST, NMPM
SECTION 35: SW/4

r) Contract the vertical limits of the South Tule-Wolfcamp Pool in ~~Lee County, New Mexico~~; to include only the upper Wolfcamp formation from 9,610 feet to 10,240 feet on the log of the Great Western Town Well No 1, located 660 feet from the north line and 1980 feet from the west line of Section 18, Township 15 South, Range 35 East, Lee County, New Mexico. Further, to redesignate said pool as the South Tule-Upper Wolfcamp Pool.

dearnley-meier reporting service inc.

SPECIALIZING IN: DEPOSITIONS, HEARINGS, STATEMENTS, EXPERT TESTIMONY, DAILY COPY, CONVENTIONS

1120 SIMMS BLDG. • P. O. BOX 1092 • PHONE 243-6691 • ALBUQUERQUE, NEW MEXICO



PAGE 1

BEFORE THE
NEW MEXICO OIL CONSERVATION COMMISSION
Santa Fe, New Mexico
March 17, 1965

REGULAR HEARING

IN THE MATTER OF:

Southeastern New Mexico nomenclature
case calling for an order for the
creation, extension and contraction of
certain pools in Lea, Chaves and
Roosevelt Counties, New Mexico.

Case No. 3220

BEFORE: Honorable Jack M. Campbell
 Mr. A. L. "Pete" Porter
 Mr. Guyton B. Hays

TRANSCRIPT OF HEARING

dearnley-meier reporting service, inc.

SPECIALIZING IN: DEPOSITIONS, HEARINGS, STATEMENTS, EXPERT TESTIMONY, DAILY COPY, CONVENTIONS

1120 SIMMS BLDG. • P. O. BOX 1092 • PHONE 243-6691 • ALBUQUERQUE, NEW MEXICO



MR. PORTER: The hearing will come to order, please.
The Commission will take the nomenclature case first this morning. Case 3220.

MR. DURRETT: Southeastern New Mexico nomenclature case.

(Witness sworn.)

JOE D. RAMEY

called as a witness, having been first duly sworn, was examined and testified as follows:

DIRECT EXAMINATION

BY MR. DURRETT:

Q Will you please state your name and position for the record?

A Joe D. Ramey, supervisor, District I, New Mexico Oil Conservation Commission.

Q Are you the same Joe Ramey that is the author of the article that recently appeared in the World Oil?

A Yes. I'm sorry I didn't bring a copy along, I would have read it.

Q Mr. Ramey, are you prepared to make a recommendation to the Commission concerning the creation, extension and contraction of certain pools in Lea, Chaves and Roosevelt Counties, New Mexico?

A Yes.

Q Have you prepared your recommendation in the form of an exhibit?

A Yes, I have.

(Whereupon, Southeastern New Mexico nomenclature Exhibit 1 was marked for identification.)

Q How is that marked?

A Southeastern New Mexico nomenclature Exhibit 1, paragraphs (a) through (r).

Q Is that substantially similar to the docket that has been prepared and distributed here today, Mr. Ramey?

A Yes, sir, with the exceptions of paragraphs (d), (k), (m) and (p).

Q Would you please point out the discrepancies or differences?

A In paragraph (d) we have an addition in Township 11 South, Range 33 East, Section 3, South Half of the Southwest Quarter. Paragraph (k) the addition is in Township 11 South, Range 33 East, Section 12, Northwest Quarter. Paragraph (m), Township 10 South, Range 32 East, Section 27, the East Half, and in paragraph (p), Township 22 South, Range 38 East, Section 33, the Southwest Quarter. The remainder is as indicated on the docket.

Q Would it be your recommendation that the creation and extension and contraction of the pools as shown on Exhibit 1

be adopted by the Commission?

A Yes, sir.

Q Was Exhibit 1 prepared by you or under your supervision?

A Yes, sir.

MR. DURRETT: If the Commission please, I move the introduction of Exhibit 1 and that will conclude my examination.

MR. PORTER: Without objection the exhibit will be admitted.

(Whereupon, Exhibit No. 1 was offered and admitted in evidence.)

MR. PORTER: Does anyone else have a question of Mr. Ramey? The witness may be excused.

(Witness excused.)

MR. PORTER: The Commission will take the case under advisement.



I N D E X

<u>WITNESS</u>		<u>PAGE</u>
JOE D. RAMEY		
Direct Examination by Mr. Durrett		2
<u>EXHIBIT</u>	<u>MARKED</u>	<u>OFFERED AND ADMITTED</u>
Southeastern New Mexico nomenclature No. 1	3	4

dearnley-meier reporting service, inc.

SPECIALIZING IN: DEPOSITIONS, HEARINGS, STATEMENTS, EXPERT TESTIMONY, DAILY COPY, CONVENTIONS

STATE OF NEW MEXICO)
COUNTY OF BERNALILLO) ss

I, ADA DEARNLEY, Notary Public in and for the County of Bernalillo, State of New Mexico, do hereby certify that the foregoing and attached Transcript of Hearing before the New Mexico Oil Conservation Commission was reported by me; and that the same is a true and correct record of the said proceedings, to the best of my knowledge, skill and ability.

Witness my Hand and Seal this 30th day of March, 1965.

Ada Dearnley
NOTARY PUBLIC

My Commission Expires:
June 19, 1967.

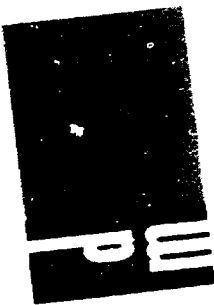

NEW MEXICO OIL CONSERVATION COMMISSION

REGULAR HEARING

SANTA FE, NEW MEXICO

REGISTERHEARING DATE MARCH 17, 1965 TIME: 9 A.M.

NAME:	REPRESENTING:	LOCATION:
George H. Hunkeler	Tobelman and Gager	Roswell, N. M.
L. L. Thompson	Pan American Ref Corp.	Midland
H. Clark Schuman	Shell Oil Co	Los Angeles
Jack Booker	Citico Service Ref	Midland
Norman R. Briff	The Permian Corp.	" "
W. J. Shirley	Amoco Oil Co.	" "
R. L. Denton	Mobil Oil Co	" "
J. F. Westerman	Texas Inc.	Midland, Texas
Ed. Whire	Gulf Oil Corp.	Midland, Tex
Gerry Hickson	El Paso Refining & Dist.	El Paso, Tex.
Joe O. Ramey	NM O C C	Hobbs NM
Donald E. Fry	Verell Schuman &	Tulsa Okla
John D. Russell	Saul Yager	Roswell
S. G. Buell	Saul Yager	Smith, Id.
Richard S. Morris	Lith. & Ind. Co.	Hobbs
Victor T. Lyon	Continental Oil Co	Hobbs
German R. Koder	Continental Oil Co	Hobbs