

**CASE 3862: Application of GULF
FOR A DUAL COMPLETION, LEA COUNTY,
NEW MEXICO.**

Case Number

3862

Application
Transcripts.

Small Exhibits

ETC.

State of New Mexico
Oil Conservation Commission



P. O. BOX 2000
SANTA FE

October 2, 1968

Re: Case No. 3862
Order No. R-3512
Applicant:
Gulf Oil Corporation

Enclosed herewith are two copies of the above-referenced Commission order recently entered in the subject case.

A. L. Porter, Jr.
A. L. PORTER, Jr.
Secretary-Director

Hobbs OCC x
Artesia OCC
Aztec OCC
Other

BEFORE THE OIL CONSERVATION COMMISSION
OF THE STATE OF NEW MEXICO

IN THE MATTER OF THE HEARING
CALLED BY THE OIL CONSERVATION
COMMISSION OF NEW MEXICO FOR
THE PURPOSE OF CONSIDERING:

CASE No. 3862
Order No. R-3512

APPLICATION OF GULF OIL CORPORATION
FOR A DUAL COMPLETION, LEA COUNTY,
NEW MEXICO.

ORDER OF THE COMMISSION

BY THE COMMISSION:

This cause came on for hearing at 9 a.m. on September 25, 1968, at Santa Fe, New Mexico, before Examiner Daniel S. Nutter.

NOW, on this 2nd day of October, 1968, the Commission, a quorum being present, having considered the testimony, the record, and the recommendations of the Examiner, and being fully advised in the premises,

FINDS:

(1) That due public notice having been given as required by law, the Commission has jurisdiction of this cause and the subject matter thereof.

(2) That the applicant, Gulf Oil Corporation, seeks authority to complete its W. D. Grimes (NCT-A) Well No. 16, located in Unit D of Section 32, Township 18 South, Range 38 East, NMPM, Lea County, New Mexico, as a dual completion (conventional) to produce oil from undesignated Paddock and Blinbry oil pools through parallel strings of 2 3/8-inch tubing, with separation of the zones by means of a packer set at approximately 5840 feet.

(3) That the mechanics of the proposed dual completion are feasible and in accord with good conservation practices.

(4) That approval of the subject application will prevent waste and protect correlative rights.

-2-

CASE No. 3862

Order No. R-3512

IT IS THEREFORE ORDERED:

(1) That the applicant, Gulf Oil Corporation, is hereby authorized to complete its W. D. Grimes (NCT-A) Well No. 16, located in Unit D of Section 32, Township 18 South, Range 38 East, NMPM, Lea County, New Mexico, as a dual completion (conventional) to produce oil from undesignated Paddock and Blinebry oil pools through parallel strings of 2 3/8-inch tubing, with separation of the zones by means of a packer set at approximately 5840 feet;

PROVIDED HOWEVER, that the applicant shall complete, operate, and produce said well in accordance with the provisions of Rule 112-A of the Commission Rules and Regulations insofar as said rule is not inconsistent with this order;

PROVIDED FURTHER, that the applicant shall take packer-leakage tests upon completion and annually thereafter during the Annual Gas-Oil Ratio Test Period for the undesignated Blinebry pool.

(2) That jurisdiction of this cause is retained for the entry of such further orders as the Commission may deem necessary.

DONE at Santa Fe, New Mexico, on the day and year hereinabove designated.

STATE OF NEW MEXICO
OIL CONSERVATION COMMISSION

DAVID F. CARGO, Chairman

GILTON B. HAYS, Member

A. L. PORTER, Jr., Member & Secretary

esr/

DOCKET: EXAMINER HEARING - WEDNESDAY - SEPTEMBER 25, 1968

9 A.M. - OIL CONSERVATION COMMISSION CONFERENCE ROOM,
STATE LAND OFFICE BUILDING, SANTA FE, NEW MEXICO

The following cases will be heard before Daniel S. Nutter, Examiner, or
Elvis A. Utz, Alternate Examiner:

CASE 3778: (Continued from the August 7, 1968, Examiner Hearing)

Application of Atlantic Richfield Company for a dual completion and salt water disposal, Lea County, New Mexico. Applicant, in the above-styled cause, seeks authority to dually complete its State BH Well No. 1 located 660 feet from the North and West lines of Section 13, Township 19 South, Range 34 East, Quail-Queen Pool, Lea County, New Mexico, in such a manner as to permit production of oil from 5080 feet to 5136 feet in the lower Queen formation through tubing and the disposal of produced salt water into the upper Queen formation through the casing-tubing annulus in the perforated interval from 4820 feet to 4830 feet.

CASE 3862: Application of Gulf Oil Company - U. S. for a dual completion, Lea County, New Mexico. Applicant, in the above-styled cause, seeks approval for the dual completion (conventional) of its W. D. Grimes (NCT-A) Well No. 16, located in Unit D of Section 32, Township 18 South, Range 38 East, Lea County, New Mexico, to produce oil from undesignated Paddock and Blinbry oil pools through parallel strings of tubing.

CASE 3863: Application of Pan American Petroleum Corporation for a unit agreement, Eddy County, New Mexico. Applicant, in the above-styled cause, seeks approval of the North Crow Flats Unit Area comprising 6,419 acres, more or less, of Federal, State and Fee lands in Township 16 South, Range 28 East, Eddy County, New Mexico.

CASE 3864: Application of Pubco Petroleum Corporation for salt water disposal, Lea County, New Mexico. Applicant, in the above-styled cause, seeks authority to dispose of produced salt water into the Wolfcamp formation in the perforated interval from approximately 10,756 feet to 10,834 feet in the Sinclair 668 State Well No. 1 located in Unit E of Section 27, Township 16 South, Range 34 East, Kemnitz-Wolfcamp Pool, Lea County, New Mexico.

Gulf Oil Company - U.S.

EXPLORATION AND PRODUCTION DEPARTMENT
ROS WELL DISTRICT

T. W. Kidd
DISTRICT MANAGER
M. I. Taylor
DISTRICT PRODUCTION
MANAGER
P. E. Wyche
DISTRICT EXPLORATION
MANAGER
H. A. Rankin
DISTRICT SERVICE MANAGER

P. O. Drawer 1938
Roswell, New Mexico 88201

August 30, 1968

Case 3862

Oil Conservation Commission
State of New Mexico
Post Office Box 2088
Santa Fe, New Mexico 87501

Attention: Mr. A. L. Porter, Jr.

Re: Application of Gulf Oil Company-U.S. for a Dual
Completion Conventional, Undesignated Paddock
and Blinbry Oil Pools, Lea County, New Mexico

Gentlemen:

Gulf Oil Company-U.S. respectfully requests an examiner hearing for approval of a dual completion conventional for the W. D. Grimes (NCT-A) Well No. 16, located 800 feet from the north line and 700 feet from the west line of Section 32, T-18S, R-38E, Undesignated Paddock and Blinbry Oil Pools, Lea County, New Mexico.

Attached is completed Form C-107, Application for Multiple Completion. Also attached is a lease plat showing the W. D. Grimes (NCT-A) Lease outlined in red and Well No. 16 circled and colored in red.

Respectfully submitted,

GULF OIL COMPANY-U.S.
A DIVISION OF GULF OIL CORPORATION

M. I. Taylor
M. I. Taylor

Attachments
JHH:ers

cc: New Mexico Oil Conservation Commission
Post Office Box 1980
Hobbs, New Mexico 88240

Offset Operators
See Page 2



A DIVISION OF GULF OIL CORPORATION

DOCKET MAILED

Date 9-13-68

Offset Operators:

Humble Oil & Refining Company
Post Office Box 2100
Hobbs, New Mexico 88240

Continental Oil Company
Post Office Box 460
Hobbs, New Mexico 88240

Amerada Petroleum Corporation
Post Office Box 668
Hobbs, New Mexico 88240

Marathon Oil Company
Post Office Box 220
Hobbs, New Mexico 88240

Sun Oil Company
Post Office Box 1205
Hobbs, New Mexico 88240

Pan American Petroleum Corporation
Post Office Box 68
Hobbs, New Mexico 88240

Atlantic Richfield Company
Post Office Box 1710
Hobbs, New Mexico 88240

Shell Oil Company
Post Office Box 1509
Midland, Texas 79701

Cities Service Oil Company
Post Office Box 69
Hobbs, New Mexico 88240

NEW MEXICO OIL CONSERVATION COMMISSION
SANTA FE, NEW MEXICO
APPLICATION FOR MULTIPLE COMPLETION

Form C-107
5-1-61

Case 3862

| | | | |
|---|-------------------|--------------------------------------|------------------------|
| Operator Gulf Oil Company - U. S. | | County Lea | Date 8-27-68 |
| Address Box 1938, Roswell, New Mexico 88201 | | Lease W. D. Grimes (NCT-A) | Well No. 16 |
| Location of Well D | Unit 32 | Township 18S | Range 38E |

1. Has the New Mexico Oil Conservation Commission heretofore authorized the multiple completion of a well in these same pools or in the same zones within one mile of the subject well? YES _____ NO **X**
2. If answer is yes, identify one such instance: Order No. _____; Operator Lease, and Well No.: _____

| 3. The following facts are submitted: | Upper Zone | Intermediate Zone | Lower Zone |
|--|-----------------------------|-------------------|-----------------------------|
| a. Name of Pool and Formation | Undesignated Paddock | | Undesignated Blinbry |
| b. Top and Bottom of Pay Section (Perforations) | 5389-91' | | 5871-6083' |
| c. Type of production (Oil or Gas) | Oil | | Oil |
| d. Method of Production (Flowing or Artificial Lift) | Artificial Lift | | Artificial Lift |

4. The following are attached. (Please check YES or NO)

| Yes | No | |
|-------------------------------------|-------------------------------------|---|
| <input checked="" type="checkbox"/> | <input type="checkbox"/> | a. Diagrammatic Sketch of the Multiple Completion, showing all casing strings, including diameters and setting depths, centralizers and/or turbolizers and location thereof, quantities used and top of cement, perforated intervals, tubing strings, including diameters and setting depth, location and type of packers and side door chokes, and such other information as may be pertinent. |
| <input checked="" type="checkbox"/> | <input type="checkbox"/> | b. Plat showing the location of all wells on applicant's lease, all offset wells on offset leases, and the names and addresses of operators of all leases offsetting applicant's lease. |
| <input type="checkbox"/> | <input checked="" type="checkbox"/> | c. Waivers consenting to such multiple completion from each offset operator, or in lieu thereof, evidence that said offset operators have been furnished copies of the application.* |
| <input type="checkbox"/> | <input checked="" type="checkbox"/> | d. Electrical log of the well or other acceptable log with tops and bottoms of producing zones and intervals of perforation indicated thereon. (If such log is not available at the time application is filed it shall be submitted as provided by Rule 112-A.) |

5. List all offset operators to the lease on which this well is located together with their correct mailing address.

Humble Oil & Refining Co., Box 2100, Hobbs, N.M.
Continental Oil Co., Box 460, Hobbs, N.M.
Amarada Petroleum Corp., Box 668, Hobbs, N.M.
Marathon Oil Co., Box 220, Hobbs, N.M.
Sun Oil Company, Box 1205, Hobbs, N.M.
Pan American Petr. Corp., Box 68, Hobbs, N.M.
Atlantic Richfield, Box 1710, Hobbs, N.M.
Shell Oil Co., Box 1509, Midland, Texas
Cities Service Oil Co., Box 69, Hobbs, N.M.

6. Were all operators listed in Item 5 above notified and furnished a copy of this application? YES **X** NO _____. If answer is yes, give date of such notification **August 30, 1968**

CERTIFICATE: I, the undersigned, state that I am the **District Production Mgr.** of the **Gulf Oil Company-U.S.** (company), and that I am authorized by said company to make this report; and that this report was prepared under my supervision and direction and that the facts stated therein are true, correct and complete to the best of my knowledge.

M. J. Taylor
Signature

*Should waivers from all offset operators not accompany an application for administrative approval, the New Mexico Oil Conservation Commission will hold the application for a period of twenty (20) days from date of receipt by the Commission's Santa Fe office. If, after said twenty-day period, no protest nor request for hearing is received by the Santa Fe office, the application will then be processed.

NOTE: If the proposed multiple completion will result in an unorthodox well location and/or a non-standard perforation unit in one or more of the producing zones, then separate application for approval of the same should be filed simultaneously with this application.

KB - GL = 12.8'

9-5/8" 36# J-55

1497' cemented with
575 sacks, circulated

See Page 2 for Dual Completion Detail

7" 23# N-80 & J-55

PBTD 7002'

TD 7050'

7039' cemented first stage 850 sacks (circulated 25 sacks after opening DV); 2nd stage 2075 sacks DV at 3039'. DID NOT CIRCULATE.

GULF OIL COMPANY - U.S.
W. D. GRIMES (NCT-A) NO. 16
800' FNL 700' FWL Section 32-18S-38E
Lea County, New Mexico

Chce 3862

2-3/8" slim hole
J-55 4.6#, special
clearance couplings

2-3/8" 4.7# J-55
EUE Tubing

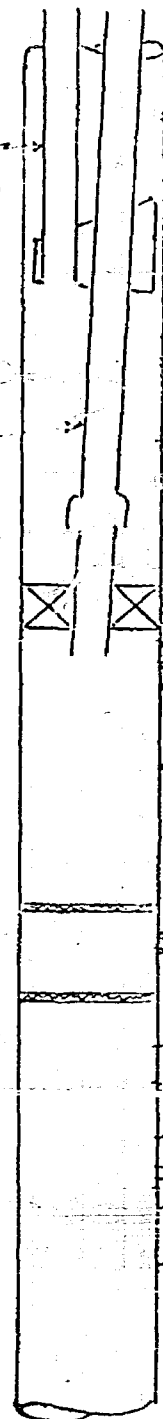

Lower San Andres

4964-4966', Squeezed, 32 sx, 3000 psi

PARALLEL STRING ANCHOR AT APPROXIMATELY 5360'

Paddock

5389-5391'

5434-5436'

5513-5515'

Squeezed, 42 sacks, 3100 psi

ON-OFF TOOL

PERMANENT PACKER AT APPROXIMATELY 5840'

Blinebry

5871-5873'

5905-5907'

5941-5943'

6081-6083'

HOWCO EZ DRILL RETAINER AT 6350'

6381-6383'

6395-6397'

HOWCO EZ DRILL RETAINER AT 6470'

6556'

Tubb-Drinkard, squeezed 179 sacks, 2250 psi

6625'

6636'

6728'

6774'

6780'

6792'

6845'

6941'

GULF OIL COMPANY - U.S.
W. D. GRIMES (NCT-A) NO. 16
Dual Completion Equipment
Undesignated Paddock - Blinebry

Case 3862

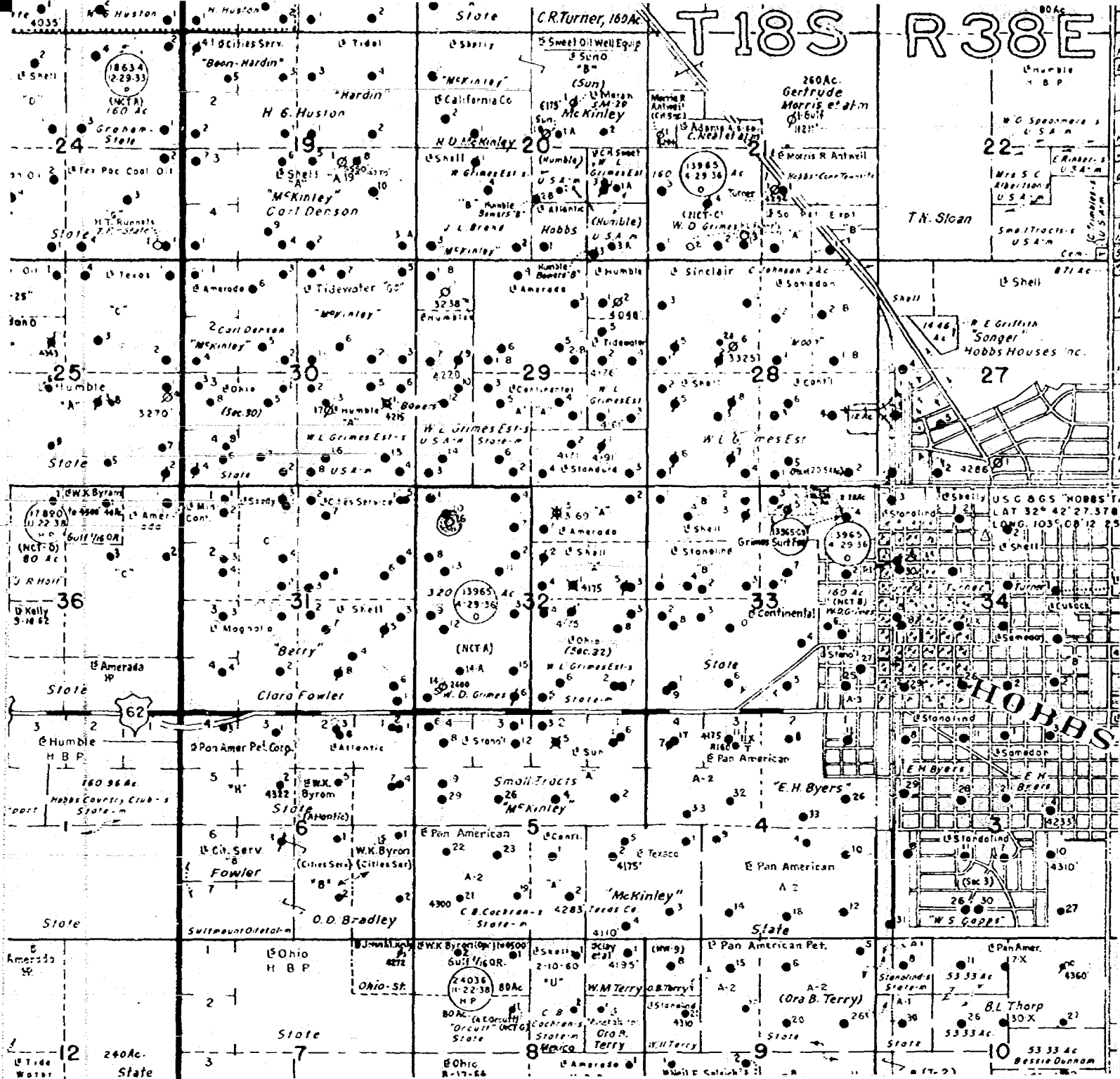

PLAT
W. D. GRIMES (NCT-A) LEASE
UNDESIGNATED PADDOCK AND BLINEBRY OIL POOLS
LEA COUNTY, NEW MEXICO

- LEGEND -

- PERTINENT LEASE
- PERTINENT WELL

Case 3862

dearnley-meier reporting service, inc.

SPECIALIZING IN: DEPOSITIONS, HEARINGS, STATEMENTS, EXPERT TESTIMONY, DAILY COPY, CONVENTIONS

1120 SIMAS BLDG. • P. O. BOX 1092 • PHONE 243-4491 • ALBUQUERQUE, NEW MEXICO

BEFORE THE
NEW MEXICO OIL CONSERVATION COMMISSION
Santa Fe, New Mexico
September 25, 1968

EXAMINER HEARING

IN THE MATTER OF:

Application of Gulf Oil Company -)
U.S. for a dual completion, Lea)
County, New Mexico.)

Case No. 3862

BEFORE: Daniel S. Nutter, Examiner

TRANSCRIPT OF HEARING

MR. KASTLER: Our exhibits have already been marked with the case number and exhibit numbers being placed on them.

MR. NUTTER: We'll call the next case, 3862.

MR. HATCH: Case 3862. Application of Gulf Oil Company - U.S. for a dual completion, Lea County, New Mexico.

MR. KASTLER: Mr. Examiner, my name is Bill Kastler, and I'm an attorney for Gulf from Roswell, and at the outset of this case, I'd like to make the observation that Gulf Oil Corporation has formed an administrative operating company which is not legally chartered and the name of this is Gulf Oil Company, U.S., a Division of Gulf Oil Corporation.

This diversifies all of the United States domestic marketing, refining and production activities, and their central office is Houston. But there is no legal character change and, in the future, our applications before this Board, as in the case of the Texas Railroad Commission, will be made in the name of Gulf Oil Corporation.

MR. NUTTER: In other words, this application was filed by Gulf Oil Company, United States, and so advertised, but you prefer that the company be known to the Commission and in the Commission operations as Gulf Oil Corporation, is that correct?

MR. KASTLER: Yes, sir.

MR. NUTTER: The application is amended, then, to read: Gulf Oil Corporation, and we'll call you Gulf Oil Corporation from here on out.

MR. KASTLER: Thank you, sir. Our witness this morning is Mr. John H. Hoover.

(Witness sworn.)

(Whereupon, Applicant's Exhibits 1-3 were marked for identification.)

JOHN H. HOOVER

called as a witness, having been first duly sworn, was examined and testified as follows:

DIRECT EXAMINATION

BY MR. KASTLER:

Q Will you please state your name, by whom you are employed, and in what position?

A John Hoover, employed by Gulf Oil Corporation, District Production Engineer, Roswell, New Mexico.

MR. KASTLER: Mr. Hoover's qualifications are well-known. Are they satisfactory to you?

MR. NUTTER: Yes, they are.

Q What is Gulf seeking in this application?

A We are asking for a dual completion, conventional, for the W.D. Grimes (NCT-A) Well No. 16 in undesignated Paddock and Blinbry oil pools, Lea County, New Mexico.

Q What is Exhibit Number 1, and explain what it shows.

please?

A Exhibit Number 1 is a plat showing the W.D. Grimes NCT-A lease outlined in red, and it's described as the west half of Section 32, Township 18 South, Range 38 East. Well No. 16 is circled and colored in red, and it is located 800 feet from the north line and 700 feet from the west line of this Section 32.

Q Unit D?

A Unit D.

Q Is Exhibit Number 2 a log of Well No. 16, and if so, please explain what's shown there.

A Yes. It is a log of our W.D. Grimes NCT-A Well No. 16. On this log, we have shown the top and bottom of the producing formations, the top of the Glorieta is shown at 5343 feet. The base of the Glorieta, top of the Blinebry, at 5665 feet, and the base of the Blinebry at 6427 feet.

We have also shown on this log, the perforations for the Paddock, the upper set being 5389 to 5391 feet. The middle set, 5434 to 5436 feet. Those perforations have been squeezed and 5513 feet to 5515 feet, those perforations have also been squeezed. The Blinebry perforations are shown in the interval, 5871 feet to 6,083 feet.

Q Will you now refer to what is labeled as Exhibit

Number 3, explain what it is and go through it?

A Yes. Exhibit Number 3 is the schematic diagram of our proposed dual sompletion. This exhibit is divided in two parts. On the first page, we have the casing program and then on the second page is a detail of the dual completion. We have nine and five-eighths inch casing set at 1497 feet. It was cemented with 575 sacks, and the cement was circulated. Seven-inch casing was set at 7,039 feet. It was cemented in two stages; the first stage, 850 sacks, and we circulated 25 sacks after opening the D.V. tool. The second stage was cemented with 2,075 sacks with the D.V. tool at 3.039 feet. The cement did not circulate. The cement was estimated to bring it back to the surface, and by the differential pressure, when we were cementing, indicated that it almost circulated, so we believe that the top of the cement is up in the surface pipe. Although it is not necessary to circulate it, we do feel it's probably up in the surface pipe. The well was drilled to a total depth of 7.050 feet. The plug-back total depth is 7,002 feet.

On the second page is the proposed dual completion equipment, as well as the perforations for the other sections in the well. We have the lower San Andres. The San Andres was perforated 4964 to 4966 feet and it was squeeze-cemented.

The Paddock perforations are shown on here. I have previously given them to you off the log. These are the same as I gave on the log; likewise, the Blinebry perforations are the same.

The lower Brinebry was also perforated at 6,381 feet to 6,397 feet. These were squeezed off and the cement retainer, during the squeezing operation, was left in place so that zone is sealed off. The Tubb-Drinkard was perforated 6,556 feet to 6,941 feet. It, too, was squeezed off and the cement retainer left at 6470 feet.

In our dual completion, we will have two strings of tubing, two and three-eighths inch tubing, the upper string will be set in a parallel string anchor at approximately 5360 feet. We will have a permanent production packer set at approximately 5,840 feet and the long string of two and three-eighths will be set in the packer.

Q Is this -- pardon me.

A Yes. I believe that covers that exhibit.

Q Is this proposed method of dual completing, the conventional or standard?

A Yes, it is. It utilizes the equipment used in many vehicles.

Q Do you have any bottom hole pressure information?

A No, we did not take any bottom hole pressures. The

zones were swab tested and we anticipate that both zones will be pumping; therefore, the need of a bottom hole pressure was not thought necessary.

The Paddock zone is now pumping as a single zone and we anticipate that the Blinebry will also be pumping. We do not have the Blinebry open. It's still sealed off. It will be below. We'll have a cement retainer set at 5409 feet when we squeeze off the lower set of the Paddock perforations. This is the seal that has the Blinebry blanked off.

Q Do you have any production test information?

A The Blinebry zone swab tested before we temporarily plugged off and it produced 272 barrels of oil per day, based on 51 barrels in four and a half hours, 128 barrels of load water per day based on the four and a half hour test. The gravity of the oil was 33 degrees, API corrected. The closed-in tubing pressure was 375 psig. The Paddock swab tested 281 barrels of oil per day based on 117 barrels in ten hours and 96 barrels of water per day based on the ten-hour test. The gravity of the Paddock was 29.5 degrees, API corrected. Current production is about 45 barrels of oil per day in the Paddock, and approximately 120 barrels of water. The gas volume is too small to measure.

Q Do you have drilling and completing cost figures

comparing the dual completion to the single well completion?

A Yes. We estimate a single zone Paddock well at \$77,000 for drilling and completion. For the Blinebry, 90,000, which would be a total of \$167,000.00 for two single wells. We estimate dual cost on this well at \$135,000 with a saving of approximately 32,000.

Q Is this a discovery well in both the Blinebry and the Paddock zones?

A Yes, it is, and we have made application to the Commission for new pool designation and discovery allowable.

Q What are you calling it?

A The recommended names are the Hobbs, Hobbs Paddock and Hobbs Blinebry, since this is a Hobbs pool.

Q Is this application in the interest of conservation and prevention of waste?

A Yes, it is.

Q Do you have anything further to add in this case?

A No, sir.

MR. KASTLER: At this point, I'd like to move that the exhibits, 1, 2, and 3 be entered into evidence.

MR. NUTTER: Gulf Oil Corporation's Exhibits 1 through 3 will be admitted in evidence.

(Whereupon, Applicant's Exhibits Numbers 1 through 3 were admitted in evidence.)

MR. NUTTER: Does anyone have any questions of the witness? He may be excused. Do you have anything further, Mr. Kastler?

MR. KASTLER: Nothing further.

MR. NUTTER: Does anyone have anything they wish to offer in case 3862? The case will be taken under advisement.

I N D E XWITNESS

JOHN H. HOOVER

Direct Examination by Mr. Kastler

PAGE

3

EXHIBITApplicant's Exhibits
1 through 3MARKED

3

OFFERED AND
ADMITTED

8

STATE OF NEW MEXICO)
) ss
 COUNTY OF BERNALILLO)

I, CHARLOTTE MACIAS, Court Reporter in and for the County of Bernalillo, State of New Mexico, do hereby certify that the foregoing and attached Transcript of Hearing before the New Mexico Oil Conservation Commission was reported by me; and that the same is a true and correct record of the said proceedings, to the best of my knowledge, skill and ability.

Charlotte Macias
 Court Reporter

I do hereby certify that the foregoing is
 a complete record of the proceedings in
 the hearing of Case No. 3862
 held by me on 9/25, 1968.
Adrian
 New Mexico Oil Conservation Commission

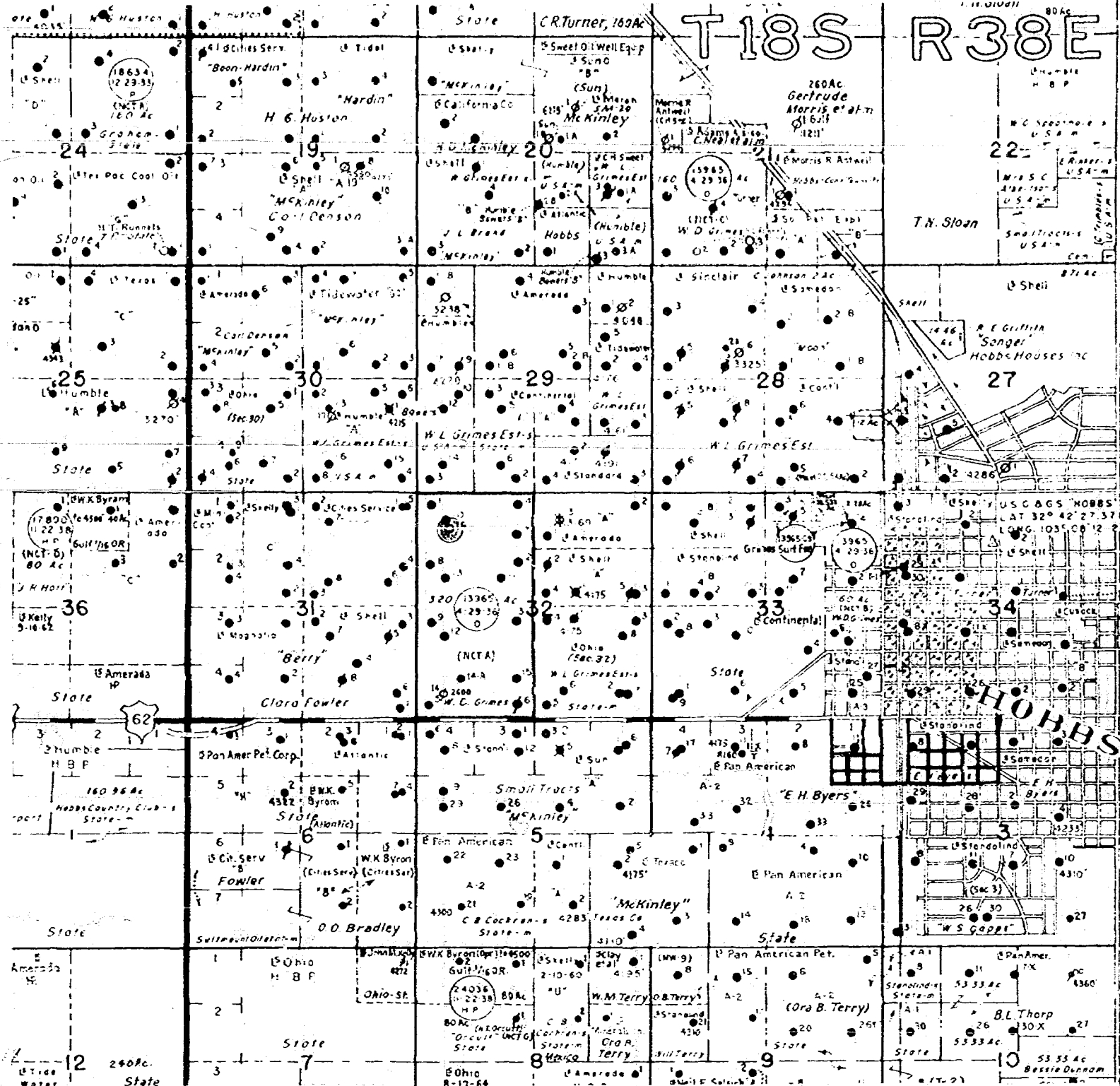

BEFORE EXAMINER NUTTER
 OIL CONSERVATION COMMISSION
 EXHIBIT NO. 3862
 CASE NO. 3862

PLAT
 W. D. GRIMES (NCT-A) LEASE
 UNDESIGNATED PADDOCK AND BLINEBRY OIL POOLS
 LEA COUNTY, NEW MEXICO

- LEGEND -
 [] PERTINENT LEASE
 [] PERTINENT WELL

Case No. 3862
 Exhibit No. 1
 September 25, 1968

KB - GI, = 12.8'

9-5/8" 36# J-55

1497' cemented with
575 sacks, circulated

See Page 2 for Dual Completion Detail

7" 23# N-80 & J-55

PBTD 7002'

TD 7050'

7039' cemented first stage 850 sacks (circulated 25 sacks after opening DV); 2nd stage 2075 sacks DV at 3039'. DID NOT CIRCULATE. *wellbore did come back into surface and*

GULF OIL COMPANY - U.S.
W. D. GRIMES (NCT-A) NO. 16
800' FNL 700' FNL Section 32-18S-38E
Lea County, New Mexico

BEFORE EXAMINER NUTTER

OIL CONSERVATION COMMISSION

EXHIBIT NO. 3

CASE NO. 3862

CASE NO. 3862

EXHIBIT NO. 3

September 25, 1950

2-3/8" slim hole
J-55 4.6#, special
clearance couplings

2-3/8" 4.7# J-55
EUE Tubing

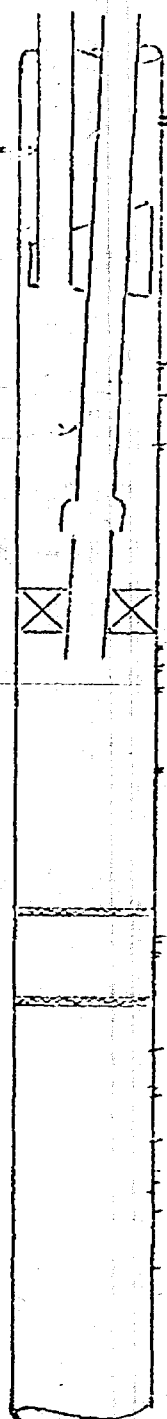

Lower San Andres

4964-4966', Squeezed, 32 sx, 3000 psi

PARALLEL STRING ANCHOR AT APPROXIMATELY 5360'

Paddock

5339-5391' open

5434-5436'

5513-5515'

Squeezed, 42 sacks, 3100 psi

ON-OFF TOOL

PERMANENT PACKER AT APPROXIMATELY 5840'

Blinebry

5871-5873'

5905-5907'

5941-5943'

6081-6083'

*Swab tested
272 BOPD*

HOMCO EZ DRILL RETAINER AT 6350'

6381-6383'

6395-6397'

Lower Blinebry, squeezed 79 sacks, 1750 psi

HOMCO EZ DRILL RETAINER AT 6470'

6556'

Tubb-Drinkard, squeezed 179 sacks, 2250 psi

6625'

6636'

6728'

6774'

6780'

6792'

6845'

6941'

*5000 psi
281 BOPD
105 BOPD
120 BOPD
current prod.*

*no BHP info.
GOR 29.5 BOPD
Draw 29.5 BOPD 33°BI*

GULF OIL COMPANY - U.S.
W. D. GRIMES (NCT-A) NO. 16
Dual Completion Equipment
Undesignated Paddock - Blinebry