

CASE 6740: HONDO OIL AND GAS COMPANY
FOR AN UNORTHODOX GAS WELL LOCATION,
EDDY COUNTY, NEW MEXICO

Case No.

6740

Application

Transcripts.

Small Exhibits

ETC.



POST OFFICE BOX 2088
STATE LAND OFFICE BUILDING
SANTA FE, NEW MEXICO 87501
(505) 827-2434

January 10, 1980

Re: CASE NO. 6740
ORDER NO. R-6236

Applicant:

Hondo Oil and Gas Company

Enclosed herewith are two copies of the above-referenced Division order recently entered in the subject case.

Yours very truly,

JOE D. RAMEY
Director

JDR/fd

Copy of order also sent to:

Hobbs OCD	x
Artesia OCD	x
Aztec OCD	

Other

STATE OF NEW MEXICO
ENERGY AND MINERALS DEPARTMENT
OIL CONSERVATION DIVISION

IN THE MATTER OF THE HEARING
CALLED BY THE OIL CONSERVATION
DIVISION FOR THE PURPOSE OF
CONSIDERING:

CASE NO. 6740
Order No. R-6236

APPLICATION OF HONDO OIL AND GAS
COMPANY FOR AN UNORTHODOX GAS WELL
LOCATION, EDDY COUNTY, NEW MEXICO.

ORDER OF THE DIVISION

BY THE DIVISION:

This cause came on for hearing at 9 a.m. on November 28, 1979, at Santa Fe, New Mexico, before Examiner Richard L. Stamets.

NOW, on this 3th day of January, 1980, the Division Director, having considered the testimony, the record, and the recommendations of the Examiner, and being fully advised in the premises,

FINDS:

(1) That due public notice having been given as required by law, the Division has jurisdiction of this cause and the subject matter thereof.

(2) That the applicant, Hondo Oil and Gas Company, seeks approval of an unorthodox gas well location for its Federal 10 Well No. 1 to be located 1550 feet from the North line and 660 feet from the West line of Section 10, Township 18 South, Range 28 East, NMPM, to test the Pennsylvanian formation, Eddy County, New Mexico.

(3) That the N/2 of said Section 10 is to be dedicated to the well.

(4) That a well at said unorthodox location will not enable applicant to efficiently and effectively drain the dedicated proration unit.

(5) That dedication of the W/2 of said Section 10 would be more appropriate.

-2-

Case No. 6740
Order No. R-6236

(6) That the subject application should be denied.

IT IS THEREFORE ORDERED:

(1) That the application of Hondo Oil and Gas Company for an unorthodox gas well location for its Federal 10 Well No. 1 to be located at a point 1550 feet from the North line and 660 feet from the West line of Section 10, Township 18 South, Range 28 East, NMPM, Eddy County, New Mexico, is hereby denied.

(2) That jurisdiction of this cause is retained for the entry of such further orders as the Division may deem necessary.

DONE at Santa Fe, New Mexico, on the day and year herein-
above designated.

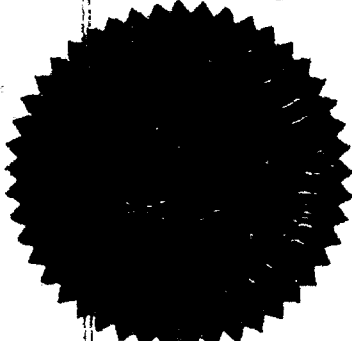

S E A L

STATE OF NEW MEXICO
OIL CONSERVATION DIVISION

Joe D. Ramey
JOE D. RAMEY
Director

fd/

STATE OF NEW MEXICO
ENERGY AND MINERALS DEPARTMENT
OIL CONSERVATION DIVISION
STATE LAND OFFICE BLDG.
SANTA FE, NEW MEXICO
28 November 1979

EXAMINER HEARING

IN THE MATTER OF:

Application of Hondo Oil and Gas) CASE
Company for an unorthodox gas) 6740
well location, Eddy County, New)
Mexico.)

BEFORE: Richard L. Stamets

TRANSCRIPT OF HEARING

A P P E A R A N C E S

For the Oil Conservation Division: Ernest L. Padilla, Esq.
Legal Counsel for the Division
State Land Office Bldg.
Santa Fe, New Mexico 87501

For the Applicant: Conrad Coffield, Esq.
HINKLE LAW FIRM
P. O. Box 3580
Midland, Texas

SALLY WALTON BOYD
CERTIFIED SHORTHAND REPORTER
3020 1/2 Ave. B, Santa Fe, New Mexico 87501
505-424-2462

I N D E X

1
2
3
4
5
6
7
8
9
10
11
12
13
14
15
16
17
18
19
20
21
22
23
24
25

MIKE N. WHITE

Direct Examination by Mr. Coffield 3

Cross Examination by Mr. Stamets 9

E X H I B I T S

Applicant Exhibit One, C-102 5

Applicant Exhibit Two, Plat 6

Applicant Exhibit Three, Map 7

Applicant Exhibit Four, Cross Section 7

Applicant Exhibit Five, Isopach 8

SALLY WALTON BOYD
CERTIFIED SHORTHAND REPORTER
3030 Plaza Blanca (SOS) 471-2462
Santa Fe, New Mexico 87501

SALLY WALTON BOYD
CERTIFIED SHORTHAND REPORTER
2010 Plaza Blanca (995) 471-2482
Santa Fe, New Mexico 87501

1 MR. STAMETS: We'll call now Case 6740.

2 MR. PADILLA: Application of Hondo Oil and
3 Gas Company for an unorthodox gas well location, Eddy County,
4 New Mexico.

5 MR. COFFIELD: Conrad Coffield, with the
6 Hinkle Law Firm in Midland, Texas, appearing on behalf of
7 Hondo Oil and Gas Company, and I have one witness to be
8 sworn.

9 MR. STAMETS: Any other appearances in
10 this case?

11 I'd like to have the witness stand and be
12 sworn, please.

13
14 (Witness sworn.)

15
16 MIKE N. WHITE
17 being called as a witness and having been duly sworn upon his
18 oath, testified as follows, to-wit:

19
20 DIRECT EXAMINATION

21 BY MR. COFFIELD:

22 Q Mr. White, would you please state your
23 name, address, occupation, and employer?

24 A My name is Mike N. White and I reside in
25 Midland, Texas, and I'm employed by Hondo Oil and Gas Company

SALLY WALTON BOYD
CERTIFIED SHORTHAND REPORTER
3030 Plaza Blanca (505) 471-2462
Santa Fe, New Mexico 87501

1 Q And what is your position?

2 A Petroleum Engineer.

3 Q Have you previously testified before the

4 Division as a petroleum engineer, Mr. White?

5 A No, I have not.

6 Q Would you please tell the Examiner briefly

7 what your educational background is and work experience as

8 a petroleum engineer?

9 A I received a BS in petroleum engineering

10 from the University of Kansas. I've worked approximately a

11 year and a half since then for Hondo Oil and Gas Company, one

12 year in Tulsa, Oklahoma, and the last five months working in

13 the Eddy County area.

14 Q Mr. White, are you familiar with Hondo's

15 application in this particular case?

16 A Yes, I am.

17 Q Are you familiar with the property involved

18 and the proposed well location?

19 A Yes.

20 MR. COFFIELD: Mr. Examiner, is the witness

21 considered qualified?

22 MR. STAMETS: Yes.

23 Q Mr. White, what is it that Hondo Oil and

24 Gas Company seeks by this application?

25 A We seek approval of an unorthodox well

SALLY WALTON BOYD
CERTIFIED SHORTHAND REPORTER
3028 Plaza Blanca (665) 471-2462
Santa Fe, New Mexico 87501

1 location for our Federal 10 No. 1 Well to be drilled at a
2 point 1550 feet from the north line and 660 feet from the
3 west line of Section 10, Township 18 South, Range 28 East,
4 New Mexico Prime Meridian, Eddy County, New Mexico, to test
5 the Wolfcamp and Pennsylvanian formations with dedication of
6 the north half of Section 10 to the well.

7 Q Mr. White, what is the general basis on
8 which Hondo believes the proposed location is more desirable
9 than the standard location?

10 A We believe it will enable us to maximize
11 recovery of gas reserves from the given proration unit.

12 Q Refer to what we've marked as Exhibit One
13 and explain that exhibit and tell the Examiner what it re-
14 presents.

15 A This is New Mexico Oil Conservation Com-
16 mission Well Location and Acreage Dedication Plat, Form C-102.
17 This is used here to illustrate the position of the well in
18 relation to section lines and also to show its position rela-
19 tive to what a standard location, such as 1980 feet from the
20 north line and 1980 feet from the west line, would be.

21 Q So a standard well location would be
22 located closer to which boundary?

23 A It would be located closer to the east
24 section line.

25 Q Is Hondo the proposed operator on this

SALLY WALTON BOYD
CERTIFIED SHORTHAND REPORTER
3030 Plaza Blanca (505) 471-2462
Santa Fe, New Mexico 87501

1 property?

2 A. Hondo is the proposed operator, yes.

3 Q. Is Hondo also the leasehold owner in this
4 particular case?

5 A. They are the principal leaseholder. They
6 share ownership of the proration unit with Depco, Huskie,
7 and Yates Oil Companies.

8 Q. Okay, Mr. White, that leads us to Exhibit
9 Number Two. Would you please refer to Exhibit Number Two
10 and explain that to the Examiner?

11 A. Exhibit Number Two is a plat showing the
12 offset operators to the proposed Federal 10 No. 1 Well.

13 Q. Do you have waivers from any of these off-
14 set operators?

15 A. Yes. We have obtained waivers from Yates,
16 also from Aminoil, American Petrofina, and there's one more.
17 And Huskie Oil Company.

18 Q. So far as you know, has anybody voiced any
19 objection?

20 A. No, they have not. When we prepared the
21 proposed location I contacted Depco, Huskie, and Yates by
22 telephone, representatives from those companies, and they all
23 gave verbal agreement to the location. As I said, we have
24 received the waiver from Huskie.

25 Q. Okay, Mr. White, go on to what we have

SALLY WALTON BOYD
CERTIFIED SHORTHAND REPORTER
3030 Plaza Blanca (955) 471-2482
Santa Fe, New Mexico 87501

1 marked as Exhibit Three and explain that exhibit to the Exa-
2 miner, please.

3 A. Exhibit Number Three is a generalized
4 channel sand trend map of our main pay objective, the Cycle
5 Two section of the Morrow Sand. It is also referred to as
6 the Middle Morrow.

7 This plat is derived from geological and
8 geophysical data and shows what we believe to be the main
9 channels of this deltaic sand deposit.

10 We further believe the middle channel to
11 be the thicker -- to be thicker than the flag channels on
12 either side, and this is the basis for the position of our
13 proposed location.

14 Q. With reference to this Exhibit Three, Mr.
15 White, what problems do you believe would ensue if Hondo
16 drilled the proposed well in a standard location?

17 A. Well, as can be seen from this exhibit, if
18 you move in an easterly direction, you're moving out of what
19 we believe to be the main sand channel; therefore, that would
20 make a standard location a more risky and less productive
21 proposition.

22 Q. Go on now to what we've marked as Exhibit
23 Four, if you would, please, Mr. White, and explain that ex-
24 hibit to the Examiner.

25 A. I'd like to use Exhibit Four to support the

SALLY WALTON BOYD
CERTIFIED SHORTHAND REPORTER
3026 Plaza Blanca (595) 471-2482
Santa Fe, New Mexico 87501

1 previous exhibit. If you will note the location of the Exxon
2 State No. 1 and 2 Wells, you can see from Exhibit Three that
3 the No. 1 Well appears to be located in the center of our
4 postulated flank channel, while the No. 2 location would ap-
5 pear to be closer to the edge, and I believe this is borne
6 out by the cross section of the No. 1 and 2 Wells, where a
7 thicker, more clean section as shown in the No. 1 Well than
8 the No. 2 Well by the logs on the cross section.

9 Q This index map on the right, then, corre-
10 sponds with the axis on which your cross section is constructed,
11 is that correct?

12 A Yes, it is.

13 Q Now, Mr. White, go on to what we've marked
14 as Exhibit Five and explain that for the Examiner, if you
15 would, please.

16 A All right. Exhibit Five is an Isopachous
17 map contoured on 10-foot intervals for the gross sand thick-
18 ness of the Cycle Two section, and this is opposed to the
19 generalized sand trend map, which is -- shows the main chan-
20 nels. The Isopach map would also include cross channels.

21 Q Do you have anything further to add in con-
22 nection with this particular matter, Mr. White, any addi-
23 tional comments that you'd like to make with respect to this
24 application?

25 A Not unless the Examiner has any further

SALLY WALTON BOYD
CERTIFIED SHORTHAND REPORTER
3020 Plaza Blanca (666) 471-2402
San Antonio, New Mexico 87501

1 questions.

2 Q Okay, Mr. White, have these Exhibits One
3 through Five been prepared by you or under your supervision?

4 A Yes, they were.

5 Q And in your opinion will the approval of
6 the application be in the interest of conservation and the
7 prevention of waste and the protection of correlative rights?

8 A Yes.

9 MR. COFFIELD: Mr. Examiner, I move the
10 admission of Exhibits One through Five.

11 MR. STAMETS: These exhibits will be ad-
12 mitted.

13 MR. COFFIELD: I have no additional ques-
14 tions of Mr. White.

15

16 CROSS EXAMINATION

17 BY MR. STAMETS:

18 Q Mr. White, why didn't Hondo dedicate the
19 west half of Section 10?

20 A If I could, I would like to consult my
21 attorney and someone from my company before I answer that
22 question.

23 MR. STAMETS: Feel free.

24 A Okay. Yes, sir, Mr. Examiner, the reason
25 we did not dedicate the west half to the proposed location is

SALLY WALTON BOYD
CERTIFIED SHORTHAND REPORTER
2030 Plaza Blanca (905) 471-2462
Santa Fe, New Mexico 87501

1 that we want to maximize recovery from the section and we
2 believe that further drilling in the south half of the west
3 proration unit will enable us to do that, and we could not
4 do that if we had a west half proration unit.

5 Q You could have infill drilling.

6 A I believe we'd have to reduce the spacing
7 in the proration unit to do that, wouldn't we?

8 Q No. As far as I know, you could infill
9 drill in there on 160 and simply dedicate the same proration
10 unit to the well, just as I would assume that eventually you
11 are going to want to drill in that channel that runs down
12 the west side -- or the east side of Section 10.

13 A That is a possibility.

14 Q And likewise, you feel that this would give
15 you the best chance for developing this section.

16 A That is correct. This is what we believe
17 to be the best first step.

18 Q One minor problem that you may have noted
19 here, I see your application was for Wolfcamp and Pennsyl-
20 vanian, but I see the docket says Pennsylvanian, which leads
21 me to believe that perhaps the advertisement said just
22 Pennsylvanian. If this should have happened to have been
23 limited to the Pennsylvanian by the advertisement, is that
24 any real problem?

25 A We would naturally like to leave the pos-

1 sibility of the Wolfcamp open, and I don't anticipate any
2 problem with that, no.

3 Q Okay, I'll check that out and see what the
4 advertisement says and we'll do what we can in this case.

5 A Thank you, sir.

6 MR. STAMETS: Any other questions of the
7 witness? He may be excused.

8 Anything further in this case?

9 The case will be taken under advisement.

10
11 (Witness excused.)
12
13
14
15
16
17
18
19
20
21
22
23
24
25

SALLY WALTON BOYD
CERTIFIED SHORTHAND REPORTER
3030 Plaza Blanca (995) 471-2462
San Antonio, New Mexico 87501

REPORTER'S CERTIFICATE

I, SALLY W. BOYD, a Certified Shorthand Reporter,
DO HEREBY CERTIFY that the foregoing and attached Transcript
of Hearing before the Oil Conservation Division was reported
by me; that the said transcript is a full, true, and correct
record of the hearing, prepared by me to the best of my
ability from my notes taken at the time of the hearing.

Sally W. Boyd C.S.R.
Sally W. Boyd, C.S.R.

I do hereby certify that the foregoing is
a complete record of the proceedings in
the Examiner hearing of Case No. 6746
heard by me on 11-28 1977.
Richard W. [Signature] Examiner
Oil Conservation Division

SALLY WALTON BOYD
CERTIFIED SHORTHAND REPORTER
3020 Plaza Blanca (SOS) 471-2432
Santa Fe, New Mexico 87501

STATE OF NEW MEXICO
ENERGY AND MINERALS DEPARTMENT
OIL CONSERVATION DIVISION
STATE LAND OFFICE BLDG.
SANTA FE, NEW MEXICO
28 November 1979

EXAMINER HEARING

IN THE MATTER OF:

Application of Hondo Oil and Gas) CASE
Company for an unorthodox gas) 6740
well location, Eddy County, New)
Mexico.)

BEFORE: Richard L. Stamets

TRANSCRIPT OF HEARING

A P P E A R A N C E S

For the Oil Conservation Division: Ernest L. Padilla, Esq.
Legal Counsel for the Division
State Land Office Bldg.
Santa Fe, New Mexico 87501

For the Applicant: Conrad Coffield, Esq.
HINKLE LAW FIRM
P. O. Box 3580
Midland, Texas

General Court Reporting Service
Santa Fe, New Mexico 87501
Phone (505) 424-1111

I N D E X

MIKE N. WHITE

Direct Examination by Mr. Coffield 3

Cross Examination by Mr. Stamets 9

E X H I B I T S

Applicant Exhibit One, C-102 5

Applicant Exhibit Two, Plat 6

Applicant Exhibit Three, Map 7

Applicant Exhibit Four, Cross Section 7

Applicant Exhibit Five, Isopach 8

reporting service
General Court Reporting Service
San Francisco, California 94104
Phone (415) 774-1111

reporting service
General Court Reporting Service
Santa Fe, New Mexico 87501
Phone (505) 833-1111

1 MR. STAMETS: We'll call now Case 6740.

2 MR. PADILLA: Application of Hondo Oil and
3 Gas Company for an unorthodox gas well location, Eddy County,
4 New Mexico.

5 MR. COFFIELD: Conrad Coffield, with the
6 Hinkle Law Firm in Midland, Texas, appearing on behalf of
7 Hondo Oil and Gas Company, and I have one witness to be
8 sworn.

9 MR. STAMETS: Any other appearances in
10 this case?

11 I'd like to have the witness stand and be
12 sworn, please.

13
14 (Witness sworn.)

15
16 MIKE N. WHITE
17 being called as a witness and having been duly sworn upon his
18 oath, testified as follows, to-wit:

19
20 DIRECT EXAMINATION

21 BY MR. COFFIELD:

22 Q Mr. White, would you please state your
23 name, address, occupation, and employer?

24 A My name is Mike N. White and I reside in
25 Midland, Texas, and I'm employed by Hondo Oil and Gas Company.

reporting service
General Court Reporting Service
Santa Fe, New Mexico 87501
Phone (505) 424-1111

1
2
3
4
5
6
7
8
9
10
11
12
13
14
15
16
17
18
19
20
21
22
23
24
25

Q And what is your position?

A Petroleum Engineer.

Q Have you previously testified before the Division as a petroleum engineer, Mr. White?

A No, I have not.

Q Would you please tell the Examiner briefly what your educational background is and work experience as a petroleum engineer?

A I received a BS in petroleum engineering from the University of Kansas. I've worked approximately a year and a half since then for Hondo Oil and Gas Company, one year in Tulsa, Oklahoma, and the last five months working in the Eddy County area.

Q Mr. White, are you familiar with Hondo's application in this particular case?

A Yes, I am.

Q Are you familiar with the property involved and the proposed well location?

A Yes.

MR. COFFIELD: Mr. Examiner, is the witness considered qualified?

MR. STAMETS: Yes.

Q Mr. White, what is it that Hondo Oil and Gas Company seeks by this application?

A We seek approval of an unorthodox well

1 location for our Federal 10 No. 1 Well to be drilled at a
2 point 1550 feet from the north line and 660 feet from the
3 west line of Section 10, Township 18 South, Range 28 East,
4 New Mexico Prime Meridian, Eddy County, New Mexico, to test
5 the Wolfcamp and Pennsylvanian formations with dedication of
6 the north half of Section 10 to the well.

7 Q Mr. White, what is the general basis on
8 which Hondo believes the proposed location is more desirable
9 than the standard location?

10 A We believe it will enable us to maximize
11 recovery of gas reserves from the given proration unit.

12 Q Refer to what we've marked as Exhibit One
13 and explain that exhibit and tell the Examiner what it re-
14 presents.

15 A This is New Mexico Oil Conservation Com-
16 mission Well Location and Acreage Dedication Plat, Form C-102.
17 This is used here to illustrate the position of the well in
18 relation to section lines and also to show its position rela-
19 tive to what a standard location, such as 1980 feet from the
20 north line and 1980 feet from the west line, would be.

21 Q So a standard well location would be
22 located closer to which boundary?

23 A It would be located closer to the east
24 section line.

25 Q Is Hondo the proposed operator on this

oil and gas reporting service
General Court Reporting Service
Santa Fe, New Mexico 87501
Phone (505) 424-1111

reporting service
 General Court Reporting Service
 Santa Fe, New Mexico 87501
 Phone (505) 824-1111

1 property?

2 A. Hondo is the proposed operator, yes.

3 Q. Is Hondo also the leasehold owner in this

4 particular case?

5 A. They are the principal leaseholder. They

6 share ownership of the proration unit with Depco, Huskie,

7 and Yates Oil Companies.

8 Q. Okay, Mr. White, that leads us to Exhibit

9 Number Two. Would you please refer to Exhibit Number Two

10 and explain that to the Examiner?

11 A. Exhibit Number Two is a plat showing the

12 offset operators to the proposed Federal 10 No. 1 Well.

13 Q. Do you have waivers from any of these off-

14 set operators?

15 A. Yes. We have obtained waivers from Yates,

16 also from Aminoil, American Petrofina, and there's one more.

17 And Huskie Oil Company.

18 Q. So far as you know, has anybody voiced any

19 objection?

20 A. No, they have not. When we prepared the

21 proposed location I contacted Depco, Huskie, and Yates by

22 telephone, representatives from those companies, and they all

23 gave verbal agreement to the location. As I said, we have

24 received the waiver from Huskie.

25 Q. Okay, Mr. White, go on to what we have

1 marked as Exhibit Three and explain that exhibit to the Exa-
2 miner, please.

3 A Exhibit Number Three is a generalized
4 channel sand trend map of our main pay objective, the Cycle
5 Two section of the Morrow Sand. It is also referred to as
6 the Middle Morrow.

7 This plat is derived from geological and
8 geophysical data and shows what we believe to be the main
9 channels of this deltaic sand deposit.

10 We further believe the middle channel to
11 be the thicker -- to be thicker than the flag channels on
12 either side, and this is the basis for the position of our
13 proposed location.

14 Q With reference to this Exhibit Three, Mr.
15 White, what problems do you believe would ensue if Mondo
16 drilled the proposed well in a standard location?

17 A Well, as can be seen from this exhibit, if
18 you move in an easterly direction, you're moving out of what
19 we believe to be the main sand channel; therefore, that would
20 make a standard location a more risky and less productive
21 proposition.

22 Q Go on now to what we've marked as Exhibit
23 Four, if you would, please, Mr. White, and explain that ex-
24 hibit to the Examiner.

25 A I'd like to use Exhibit Four to support the

reporting service
General Court Reporting Service
San Antonio, Texas 78201
New Mexico 87501

1 previous exhibit. If you will note the location of the Exxon
2 State No. 1 and 2 Wells, you can see from Exhibit Three that
3 the No. 1 Well appears to be located in the center of our
4 postulated flank channel, while the No. 2 location would ap-
5 pear to be closer to the edge, and I believe this is borne
6 out by the cross section of the No. 1 and 2 Wells, where a
7 thicker, more clean section as shown in the No. 1 Well than
8 the No. 2 Well by the logs on the cross section.

9 Q This index map on the right, then, corre-
10 sponds with the axis on which your cross section is constructed,
11 is that correct?

12 A Yes, it is.

13 Q Now, Mr. White, go on to what we've marked
14 as Exhibit Five and explain that for the Examiner, if you
15 would, please.

16 A All right. Exhibit Five is an Isopachous
17 map contoured on 10-foot intervals for the gross sand thick-
18 ness of the Cycle Two section, and this is opposed to the
19 generalized sand trend map, which is -- shows the main chan-
20 nels. The Isopach map would also include cross channels.

21 Q Do you have anything further to add in con-
22 nection with this particular matter, Mr. White, any addi-
23 tional comments that you'd like to make with respect to this
24 application?

25 A Not unless the Examiner has any further

reporting service
General Court Reporting Service
Santa Fe, New Mexico 87501

reporting service
General Court Reporting Service
San Francisco, New Mexico 87501

1 questions.

2 Q Okay, Mr. White, have these Exhibits One
3 through Five been prepared by you or under your supervision?

4 A Yes, they were.

5 Q And in your opinion will the approval of
6 the application be in the interest of conservation and the
7 prevention of waste and the protection of correlative rights?

8 A Yes.

9 MR. COFFIELD: Mr. Examiner, I move the
10 admission of Exhibits One through Five.

11 MR. STAMETS: These exhibits will be ad-
12 mitted.

13 MR. COFFIELD: I have no additional ques-
14 tions of Mr. White.

15
16 CROSS EXAMINATION

17 BY MR. STAMETS:

18 Q Mr. White, why didn't Hondo dedicate the
19 west half of Section 10?

20 A If I could, I would like to consult my
21 attorney and someone from my company before I answer that
22 question.

23 MR. STAMETS: Feel free.

24 A Okay. Yes, sir, Mr. Examiner, the reason
25 we did not dedicate the west half to the proposed location is

1 that we want to maximize recovery from the section and we
2 believe that further drilling in the south half of the west
3 proration unit will enable us to do that, and we could not
4 do that if we had a west half proration unit.

5 Q You could have infill drilling.

6 A I believe we'd have to reduce the spacing
7 in the proration unit to do that, wouldn't we?

8 Q No. As far as I know, you could infill
9 drill in there on 160 and simply dedicate the same proration
10 unit to the well, just as I would assume that eventually you
11 are going to want to drill in that channel that runs down
12 the west side -- or the east side of Section 10.

13 A That is a possibility.

14 Q And likewise, you feel that this would give
15 you the best chance for developing this section.

16 A That is correct. This is what we believe
17 to be the best first step.

18 Q One minor problem that you may have noted
19 here, I see your application was for Wolfcamp and Pennsyl-
20 vanian, but I see the docket says Pennsylvanian, which leads
21 me to believe that perhaps the advertisement said just
22 Pennsylvanian. If this should have happened to have been
23 limited to the Pennsylvanian by the advertisement, is that
24 any real problem?

25 A We would naturally like to leave the pos-

reporting service
General Court Reporting Service
Santa Fe, New Mexico 87501

1 sibility of the Wolfcamp open, and I don't anticipate any
2 problem with that, no.

3 Q Okay, I'll check that out and see what the
4 advertisement says and we'll do what we can in this case.

5 A Thank you, sir.

6 MR. STAMETS: Any other questions of the
7 witness? He may be excused.

8 Anything further in this case?

9 The case will be taken under advisement.

10
11 (Witness excused.)
12
13
14
15
16
17
18
19
20
21
22
23
24
25

reporting service
General Court Reporting Service
San Antonio, Texas 78201

REPORTER'S CERTIFICATE

I, SALLY W. BOYD, a Certified Shorthand Reporter,
DO HEREBY CERTIFY that the foregoing and attached Transcript
of Hearing before the Oil Conservation Division was reported
by me; that the said transcript is a full, true, and correct
record of the hearing, prepared by me to the best of my
ability from my notes taken at the time of the hearing.

Sally W. Boyd, C.S.R.

I do hereby certify that the foregoing is
a complete record of the proceedings in
the Examiner hearing of Case No. _____,
heard by me on _____ 19____.

_____, Examiner
Oil Conservation Division

Attorneys' reporting service
General Court Reporting Service
 6000 Santa Fe, New Mexico 87501
 (505) 261-0000

NEW MEXICO OIL CONSERVATION COMMISSION
WELL LOCATION AND ACREAGE DECLARATION PLAT

Form O-172
Supplemental
Plate No. 1

All sections of land to be from the corner boundaries of the Section

Hondo Oil & Gas Co.		Federal 10		1	
Well Name	Section	Range	Block	Twp	
E	10	18 South	28 East	Ledy	
Section 10, Twp 18 S, R. 28 E, Ledy					
1550	1000	North	660	West	
3643.3	Horizontal Feet	Vertical Feet	Post	Undesignated	370

- Outline the acreage dedicated to the subject well by colored pencil or lacquer marks on the plat below.
- If more than one lease is dedicated to the well, outline each and identify the ownership thereof (both as to working interest and royalty).
- If more than one lease of different ownership is dedicated to the well, have the interests of all owners been consolidated by communitization, unitization, lease-pooling, etc?

☐ Yes ☐ No If answer is "yes," type of consolidation _____

If answer is "no," list the owners and tract descriptions which have actually been consolidated (Use reverse side of this form if necessary.) _____

No allowable will be assigned to the well until all interests have been consolidated (by communitization, unitization, lease-pooling, or otherwise) or until a non-standard unit, eliminating such interests, has been approved by the Commission.

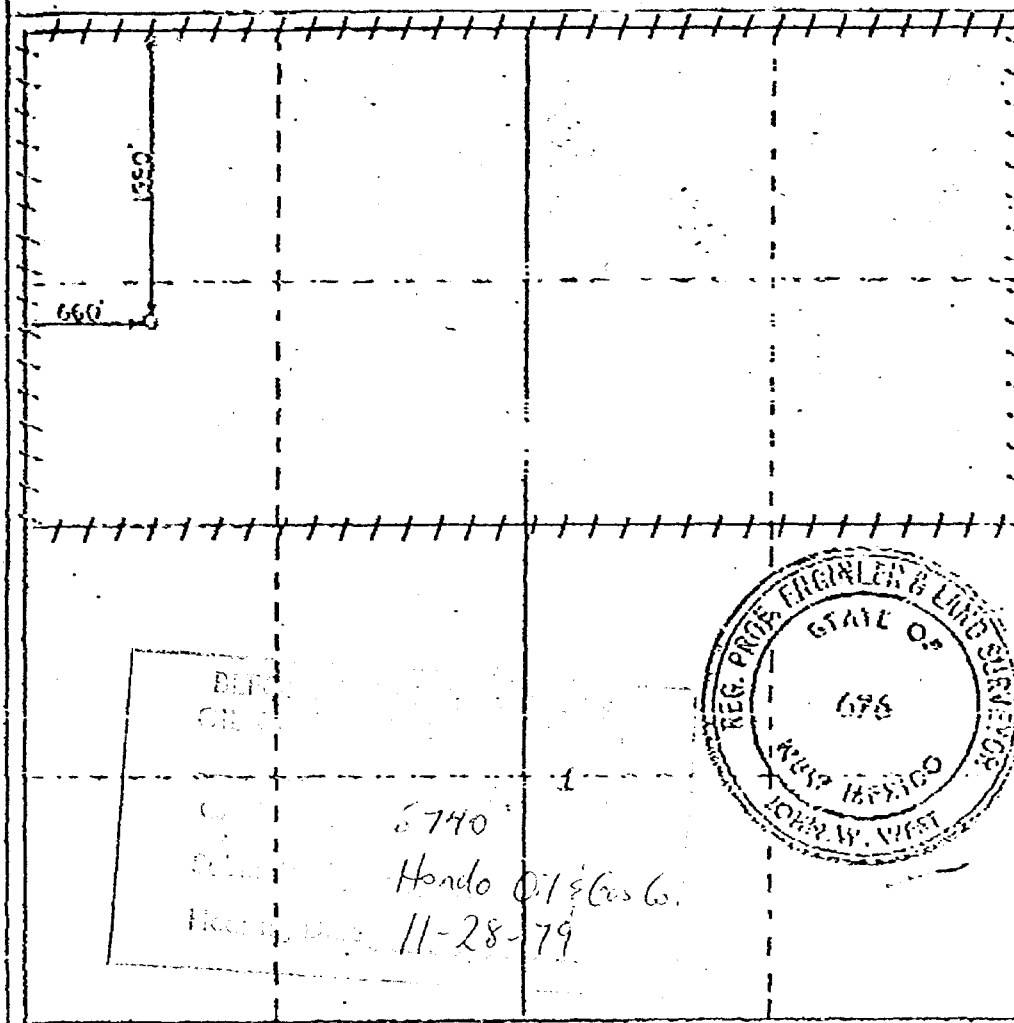

CERTIFICATION

I hereby certify that the information furnished herein is true and complete to the best of my knowledge and belief.

[Signature]

Position

Dist Brig Supt

Company

Hondo Oil & Gas Company

Date

11/21/79

I hereby certify that the well location shown on this plat was plotted from field notes of actual surveys made by me or under my supervision and that the same is true and correct to the best of my knowledge and belief.

Date

November 10, 1979

Signature of Registered Professional Engineer and Land Surveyor

[Signature]

Commissioner, NEW MEXICO OIL CONSERVATION COMMISSION
JAMES S. LEECH, JR.

OFFSET OPERATORS TO
PROPOSED FEDERAL "10" NO. 1

(HDH&Y-HONDO, DEPCO, HUSKY, & YATES)

2

6740

Handwritten: *Handwritten: 11-28-79 4*
Hondo Oil & Gas Co. R28E

American Petrofina	AMOCO CITIES SERVICE	HDH&Y	HDH&Y	HDH&Y	FEATHER- STONE FARMS
AMOCO	AMOCO	HDH&Y	DEPCO	DEPCO	FEATHER- STONE FARMS
AMOCO	YATES	AM. PETRO.	DEPCO	DEPCO	FEATHER- STONE FARMS
AM. PETRO.	ARCO	HDH&Y	DEPCO	DEPCO	FEATHER- STONE FARMS
HDH&Y	AM. PETRO.	AMINOIL	HDH&Y	HDH&Y	HDH&Y
CITIES SERVICE & MARATHON	EXXON	AMINOIL	HDH&Y	HDH&Y	HDH&Y
EXXON	HDH&Y	AMINOIL	HDH&Y	HDH&Y	HDH&Y
YATES	DEPCO	HDH&Y	W.E. JEFFERS	HOLLY ENERGY	HOLLY ENERGY
GULF	ARCO	W.E. JEFFERS	W.E. JEFFERS	HOLLY ENERGY	HOLLY ENERGY
TEXACO	ELK OIL	W.E. JEFFERS	W.E. JEFFERS	HOLLY ENERGY	HOLLY ENERGY

T
18
S

A.R.Co.
Empire St. No. 1-33
EL. 3691 KB
TD. 10498

R - 28 - E

500

510

520

11-28-79

2 3

6740

Hondo Oil & Gas Co.
Hearing 11-28-79

Hondo
EXXON-St. No. 2
EL. 3635
TD. 10506

Proposed Location

HONDO
EXXON-St. No. 1
EL.
TD. 10548

130

130

150

170

1590

1600

170

170

180

1800

1800

560

570

ARCO Oil and Gas Company
Division of Atlantic Richfield Company
Permian District Midland, Texas

GEN. CHANNEL
SAND TREND MAP
Morrow Cycle 2

Scale: 1"=2000'

By P. LINDQUIST	Drawn By LR	Date 11-79
Date 11-79	Revised By	Date
Dept.	Eng. No.	

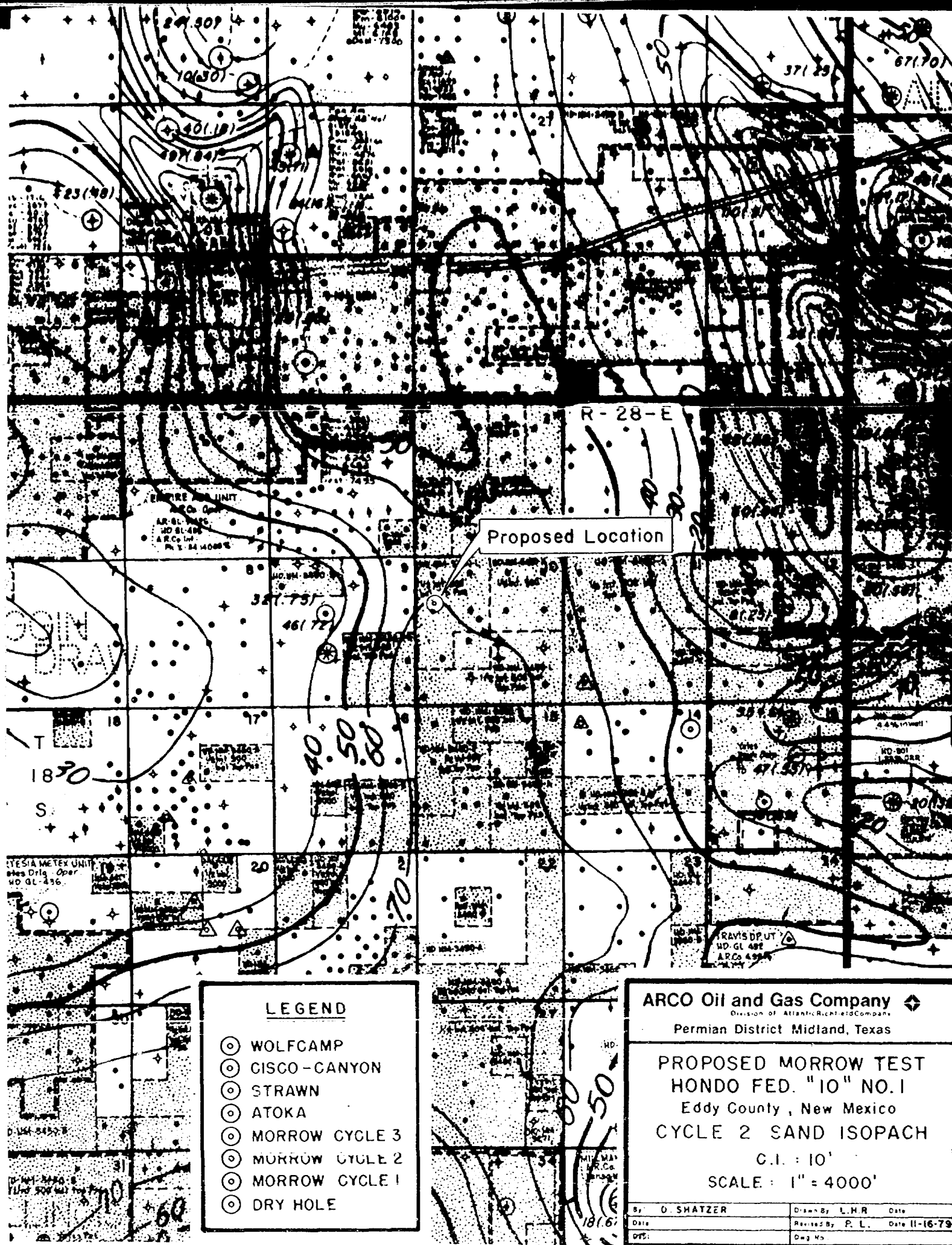

LEGEND

- WOLFCAMP
- CISCO-CANYON
- STRAWN
- ATOKA
- MORROW CYCLE 3
- MORROW CYCLE 2
- MORROW CYCLE 1
- DRY HOLE

ARCO Oil and Gas Company
Division of Atlantic Richfield Company
Permian District Midland, Texas

PROPOSED MORROW TEST
HONDO FED. "10" NO.1
Eddy County, New Mexico
CYCLE 2 SAND ISOPACH
C.I. : 10'
SCALE : 1" = 4000'

By: D. SHATZER	Drawn By: L.H.R.	Date:
Date:	Revised By: P. L.	Date: 11-16-79
DTS:	Dwg No:	

NEW MEXICO OIL CONSERVATION COMMISSION
WELL LOCATION AND ACREAGE DEDICATION PLAT

Case No. 12
September 11
1979

All distances given to line the corner boundaries of the Section

Hondo Oil & Gas Co.		Federal 10	
Well Name	Section	Range	County
E	10	18 South	28 East
Twp. 10 N. R. 28 E. S. 10			
Section	Distance from the North	Distance from the West	Distance from the East
3643.3	660	660	320
Producing Formation	Producing Formation	Producing Formation	Producing Formation
Harrow Gas	Harrow Gas	Undesignated	Undesignated

- Outline the acreage dedicated to the subject well by colored pencil or brochure marks on the plat below.
- If more than one lease is dedicated to the well, outline each and identify the ownership thereof (both as to working interest and royalty).
- If more than one lease of different ownership is dedicated to the well, have the interests of all owners been consolidated by communitization, unitization, leasepooling, etc?

☐ Yes ☐ No If answer is "yes," type of consolidation

If answer is "no," list the owners and tract descriptions which have actually been consolidated (the reverse side of this form if necessary).

No allowance will be assigned to the well until all interests have been consolidated (by communitization, unitization, leasepooling, or otherwise) or until a nonstandard unit, eliminating such interests, has been approved by the Commission.

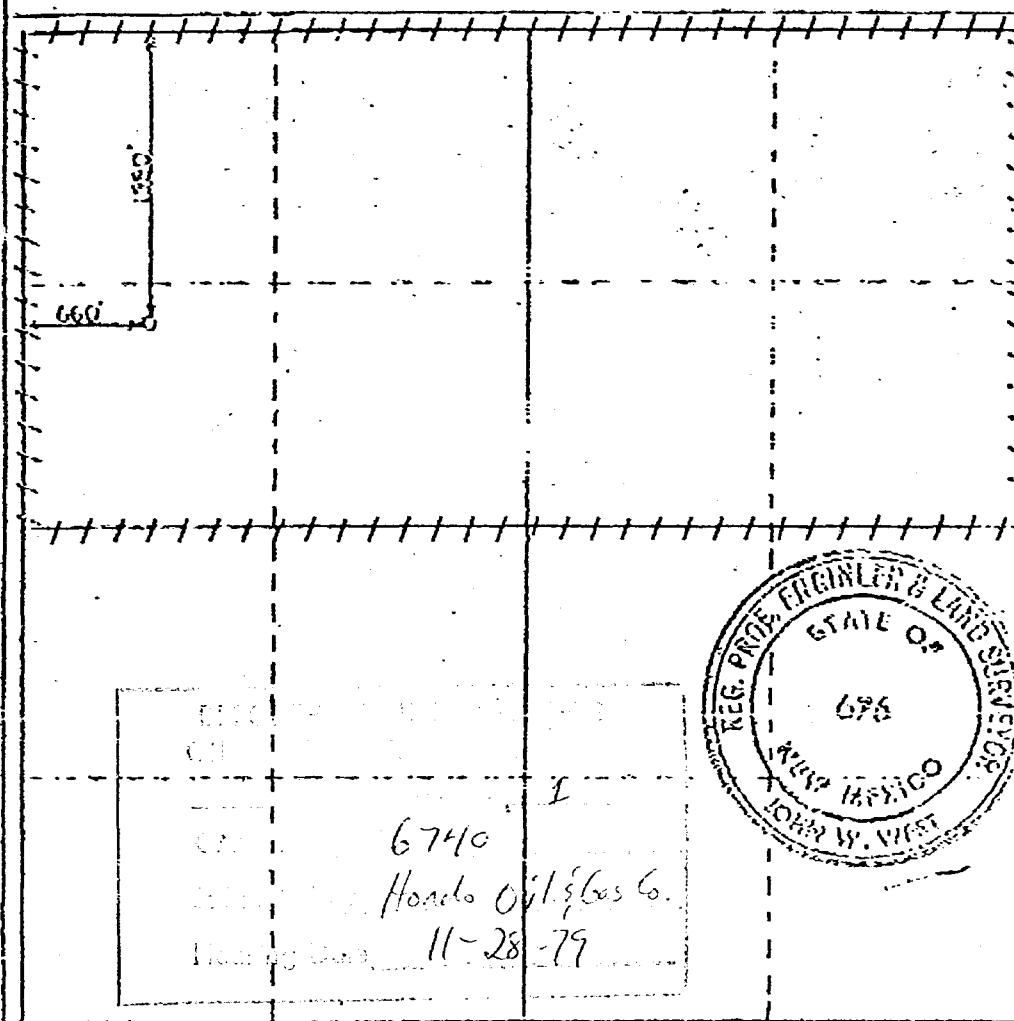

CERTIFICATION

I hereby certify that the information submitted herein is true and correct to the best of my knowledge and belief.

[Signature]

Dist. Dir. Supt.

Hondo Oil & Gas Company

11/21/79

I hereby certify that the well location shown on this plat was plotted from field notes of actual surveys made by me or under my supervision and that the same is true and correct to the best of my knowledge and belief.

November 10, 1979

[Signature]

Producing Formation

Producing Formation

Producing Formation

Producing Formation

Producing Formation

Producing Formation

Producing Formation

Producing Formation

Producing Formation

Producing Formation

Producing Formation

Producing Formation

Producing Formation

Producing Formation

Producing Formation

Producing Formation

Producing Formation

Producing Formation

Producing Formation

Producing Formation

Producing Formation

Producing Formation

Producing Formation

Producing Formation

Producing Formation

Producing Formation

Producing Formation

OFFSET OPERATORS TO
PROPOSED FEDERAL "10" NO. 1

(HDS&Y-HONDO, DEPCO, HUSKY, YATES)

6740
Hondo Oil & Gas Co.
Hearing Date 11-28-79

R28E

American Petrofina	AMOCO	CITIES SERVICE	HDS&Y	HDS&Y	HDS&Y
AMOCO	YATES	AM. PETRO.	DEPCO	DEPCO	FEATHER-STONE FARMS
AM. PETRO.	ARCO	HDS&Y	DEPCO	FEATHER-STONE FARMS	CITIES SERVICE
HDS&Y	AM. PETRO.	CITIES SERVICE & MARATHON	EXXON	HDS&Y	HDS&Y
EXXON	HDS&Y	AMINOIL	HDS&Y	HDS&Y	HDS&Y
YATES	DEPCO	HDS&Y	W.E. JEFFERS	HDS&Y	HDS&Y
GULF	ARCO	HDS&Y	W.E. JEFFERS	HDS&Y	HDS&Y
TEXACO	ELK OIL	W.E. JEFFERS	W.E. JEFFERS	HDS&Y	HDS&Y

⊙ PROPOSED LOCATION

AMINOIL

HDS&Y

HDS&Y

W.E. JEFFERS

W.E. JEFFERS

W.E. JEFFERS

HOLLY ENERGY

HDS&Y

HOLLY ENERGY

A.R. Co.
Empire St. No. 1-33
EL. 3691 KB
TD. 10498

R - 28 - E

500

510

520

2 3

6740

Hondo Oil & Gas Co.

Hearing Date 11-28-79

Hondo
EXXON-St No. 2
EL. 3635
TD. 10506

Proposed Location

HONDO
EXXON-St No. 1
EL.
TD. 10548

T
18
S

ARCO Oil and Gas Company
Division of Atlantic Richfield Company
Permian District Midland, Texas

GEN. CHANNEL
SAND TREND MAP
Morrow Cycle 2

Scale: 1"=2000'

By P. LINDQUIST	Drawn By LR	Date 11-79
Date 11-79	Revised By	Date
Dept.	Dep. No.	

CASE 6736: Application of Doyle Hartman for compulsory pooling and a non-standard gas proration unit, Lea County, New Mexico. Applicant, in the above-styled cause, seeks an order pooling all mineral interests in the Jalmat Gas Pool to form a 360-acre non-standard gas proration unit comprising the S/2 SE/4 of Section 36, Township 24 South, Range 36 East; SW/4 of Section 31, Township 24 South, Range 37 East; and the N/2 NW/4 and NW/4 NE/4 of Section 6, Township 25 South, Range 37 East, to be dedicated to a well to be drilled 660 feet from the South line and 990 feet from the West line of said Section 31. Also to be considered will be the cost of drilling and completing said well and the allocation of the cost thereof as well as actual operating costs and charges for supervision. Also to be considered will be the designation of applicant as operator of the well and a charge for risk involved in drilling said well.

CASE 6707: (Continued from November 14, 1979, Examiner Hearing)

Application of Gulf Oil Corporation for a unit agreement, San Juan County, New Mexico. Applicant, in the above-styled cause, seeks approval for the Southeast Bisti Unit Area, comprising 7,048 acres, more or less, of State and Federal lands in Townships 24 and 25 North, Range 10 West.

CASE 6737: Application of Gulf Oil Corporation for compulsory pooling, Lea County, New Mexico. Applicant, in the above-styled cause, seeks an order pooling all mineral interests in the Pennsylvanian formation underlying the W/2 of Section 4, Township 19 South, Range 32 East, North Lusk-Morrow Gas Pool, to be dedicated to a well to be drilled at a standard location thereon. Also to be considered will be the cost of drilling and completing said well and the allocation of the cost thereof as well as actual operating costs and charges for supervision. Also to be considered will be the designation of applicant as operator of the well and a charge for risk involved in drilling said well.

CASE 6739: Application of Mobil Oil Corporation for downhole commingling, Rio Arriba County, New Mexico. Applicant, in the above-styled cause, seeks approval for the downhole commingling of Gavilan-Pictured Cliffs and Blanco Mesaverde production in the wellbore of its Jicarilla D Well No. 1 located in Unit N of Section 24, Township 26 North, Range 3 West. Applicant further seeks the establishment of an administrative procedure for approval of downhole commingling of the aforesaid pools in others of its wells in Sections 7, 8, 17, 18, and 19, Township 26 North, Range 2 West, Sections 1, 2, 11 thru 14, 23, and 24, Township 26 North, Range 3 West, and Sections 11 thru 15, 22 thru 27, 35, and 36, Township 27 North, Range 3 West.

CASE 6740: Application of Hondo Oil and Gas Company for an unorthodox gas well location, Eddy County, New Mexico. Applicant, in the above-styled cause, seeks approval for the unorthodox location of a Pennsylvanian test well to be drilled 1550 feet from the North line and 660 feet from the West line of Section 10, Township 18 South, Range 28 East, the N/2 of said Section 10 to be dedicated to the well.

CASE 6741: Application of ARCO Oil and Gas Company for an amendment to Order No. R-6054, Eddy County, New Mexico. Applicant, in the above-styled cause, seeks the amendment of Order No. R-6054 to amend the findings in said order to make said findings more specific as to the necessity for the drilling of infill wells in the Empire Abo Unit in order to recover additional gas pursuant to the Natural Gas Policy Act of 1978; further to amend said order to make such findings applicable to present and future drilling operations including the drilling of horizontal drainholes.

CASE 6720: (Continued from November 14, 1979, Examiner Hearing)

Application of ARCO Oil and Gas Company to drill a horizontal drainhole, Eddy County, New Mexico. Applicant, in the above-styled cause, seeks approval to drill and complete its Empire Abo Unit Well No. J-213, located in Unit E of Section 6, Township 18 South, Range 28 East, Empire-Abo Pool, with a single horizontal drainhole of about 200 feet in length in the Abo formation.

CASE 6742: Application of ARCO Oil and Gas Company for an administrative procedure, Eddy County, New Mexico. Applicant, in the above-styled cause, seeks the establishment of an administrative procedure for approval of the drilling of horizontal drainholes in the Empire Abo Unit, Empire-Abo Pool.

CASE 6743: (This case will be dismissed.)

Application of Exxon Corporation for an exception to Order No. R-3221, Eddy County, New Mexico. Applicant, in the above-styled cause, seeks an exception to Order No. R-3221 to permit disposal of produced brine in several unlined surface pits located on its Laguna Grande Unit Area in Sections 16, 21, 28, 29, 32, and 33, Township 23 South, Range 29 East.

CASE 6744: Application of Texas Oil & Gas Corporation for special pool rules, Eddy County, New Mexico. Applicant, in the above-styled cause, seeks the promulgation of special pool rules for the Riverside-Morrow Gas Pool to provide for 320-acre spacing rather than 160 acres. In the absence of objection, this pool will be placed on the standard 320-acre spacing for Pennsylvanian gas pools rather than the present 160-acre spacing.

LEWIS C. COX, JR.
PAUL W. EATON, JR.
CONRAD E. COFFIELD
HAROLD L. HENSLEY, JR.
STUART D. SHANOR
C. D. MARTIN
PAUL J. KELLY, JR.
JAMES H. BOZARTH

DOUGLAS L. LUNSFORD
PAUL M. BOHANNON
J. DOUGLAS FOSTER
K. DOUGLAS PERRIN
C. RAY ALLEN
JACQUELINE W. ALLEN
T. CALDER EZZELL, JR.
WILLIAM S. BURFORD
JOHN S. NELSON
RICHARD E. OLSON

LAW OFFICES
HINKLE, COX, EATON, COFFIELD & HENSLEY

1000 FIRST NATIONAL BANK TOWER
POST OFFICE BOX 3580
MIDLAND, TEXAS 79702
(915) 683-4691

OF COUNSEL
CLARENCE E. HINKLE

W. E. BONDURANT, JR. (1914-1973)

ROSWELL, NEW MEXICO OFFICE
600 HINKLE BUILDING
(505) 622-6510

ONLY ATTYS. COFFIELD, MARTIN, BOZARTH,
BOHANNON, FOSTER, ALLEN, ALLEN & BURFORD
LICENSED IN TEXAS

November 7, 1979

Case 6740

Mr. Dan Nutter
Chief Engineer
Oil Conservation Division
Post Office Box 2088
Santa Fe, New Mexico 87501

Dear Dan:

Transmitted herewith you will find triplicate executed copies of an Application of Hondo Oil & Gas Company for an unorthodox gas well location in Section 10, Township 18 South, Range 28 East, N.M.P.M., Eddy County, New Mexico.

It is my understanding that the docket setting for November 28, 1979 is still available for this matter, and accordingly, we request that it be heard on that date.

I trust that the enclosed copies of the Application are all that is needed in order for this to be set for the November 28, 1979 hearing. However, if anything is needed in addition, please let me know.

Very truly yours,

HINKLE, COX, EATON,
COFFIELD & HENSLEY

Conrad E. Coffield

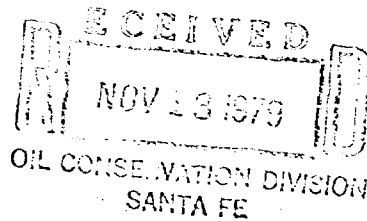

CEC:rh
Enclosures

xc: Mr. Jerry Tweed
Hondo Oil & Gas Company
Post Office Box 1610
Midland, Texas 79702

BEFORE THE OIL CONSERVATION DIVISION OF
THE DEPARTMENT OF ENERGY AND MINERALS
STATE OF NEW MEXICO

APPLICATION OF HONDO OIL &
GAS COMPANY FOR AN UNORTHODOX
WELL LOCATION, EDDY COUNTY,
NEW MEXICO

)
)
)
)

Case 6740

APPLICATION

Hondo Oil & Gas Company hereby makes application for approval of an unorthodox gas well location and states:

1. Applicant seeks approval of an unorthodox gas well location for its Federal "10" No. 1 Well to be drilled at a point 1550 feet from the North line and 660 feet from the West line of Section 10, Township 18 South, Range 28 East, N.M.P.M., Eddy County, New Mexico, to test the Wolfcamp and Pennsylvanian formations.

2. That the N½ of Section 10 is to be dedicated to the well.

3. Approval of the unorthodox location will be in the interest of conservation, prevention of waste and protection of correlative rights.

4. Applicant requests that this matter be heard at the November 28, 1979 Examiner's hearing.

HINKLE, COX, EATON,
COFFIELD & HENSLEY

By:



Conrad E. Coffield
Post Office Box 3580
Midland, Texas 79702
Attorneys for Hondo Oil &
Gas Company

RECEIVED
OIL CONSERVATION DIVISION
SANTA FE

BEFORE THE OIL CONSERVATION DIVISION OF
THE DEPARTMENT OF ENERGY AND MINERALS
STATE OF NEW MEXICO

APPLICATION OF HONDO OIL &
GAS COMPANY FOR AN UNORTHODOX
WELL LOCATION, EDDY COUNTY,
NEW MEXICO

)
)
)
)

Case 6740

APPLICATION

Hondo Oil & Gas Company hereby makes application for approval of an unorthodox gas well location and states:

1. Applicant seeks approval of an unorthodox gas well location for its Federal "10" No. 1 Well to be drilled at a point 1550 feet from the North line and 560 feet from the West line of Section 10, Township 18 South, Range 28 East, N.M.P.M., Eddy County, New Mexico, to test the Wolfcamp and Pennsylvanian formations.

2. That the N½ of Section 10 is to be dedicated to the well.

3. Approval of the unorthodox location will be in the interest of conservation, prevention of waste and protection of correlative rights.

4. Applicant requests that this matter be heard at the November 28, 1979 Examiner's hearing.

HINKLE, COX, EATON,
COFFIELD & HENSLEY

By:

Conrad E. Coffield
Post Office Box 3580
Midland, Texas 79702
Attorneys for Hondo Oil &
Gas Company

RECEIVED
OIL CONSERVATION DIVISION
SANTA FE

BEFORE THE OIL CONSERVATION DIVISION OF
THE DEPARTMENT OF ENERGY AND MINERALS
STATE OF NEW MEXICO

APPLICATION OF HONDO OIL &)
GAS COMPANY FOR AN UNORTHODOX)
WELL LOCATION, EDDY COUNTY,)
NEW MEXICO)

Case 6740

APPLICATION

Hondo Oil & Gas Company hereby makes application for approval of an unorthodox gas well location and states:

1. Applicant seeks approval of an unorthodox gas well location for its Federal "10" No. 1 Well to be drilled at a point 1550 feet from the North line and 660 feet from the West line of Section 10, Township 18 South, Range 28 East, N.M.P.M., Eddy County, New Mexico, to test the Wolfcamp and Pennsylvanian formations.

2. That the N $\frac{1}{2}$ of Section 10 is to be dedicated to the well.

3. Approval of the unorthodox location will be in the interest of conservation, prevention of waste and protection of correlative rights.

4. Applicant requests that this matter be heard at the November 28, 1979 Examiner's hearing.

HINKLE, COX, EATON,
COFFIELD & HENSLEY

By: 
Conrad E. Coffield
Post Office Box 3580
Midland, Texas 79702
Attorneys for Hondo Oil &
Gas Company

Memo

From

FLORENE DAVIDSON
ADMINISTRATIVE SECRETARY

To

Called in by Conrad
Coffield 11/2/29

Hondo Oil & Gas Company

Unorthodox gas well
location

Fed. 10 #1

1550/N + 660/W

Section 10, T18S, R28E

N/2 dedicated

Pennsylvanian gas test

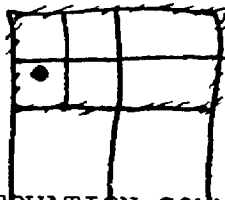

OIL CONSERVATION COMMISSION-SANTA FE

$dr/$

IN THE MATTER OF THE HEARING
CALLED BY THE OIL CONSERVATION
DIVISION FOR THE PURPOSE OF
CONSIDERING:

ORDER NO. R- 6238

FOR AN UNORTHODOX GAS WELL LOCATION,
EDDY COUNTY, NEW MEXICO.

BY THE DIVISION:

NOW, on this _____ day of _____, 19 79, the Division Director, having considered the testimony, the record, and the recommendations of the Examiner, and being fully advised in the premises,

(1) That due public notice having been given as required by law, the Division has jurisdiction of this cause and the subject matter thereof.

(2) That the applicant, Hondo Oil and Gas Company,
for its Federal 10 Well No. 1 to be located
 seeks approval of an unorthodox gas well location/ 1550
 feet from the North line and 660 feet from the
West line of Section 10, Township 18 South
 Range 28 East, NMPM, to test the Pennsylvanian
 formation, Box 1, Eddy
 County, New Mexico.

(3) That the N/2 of said Section 10 is to be dedicated to the well.

(4) That a well at said unorthodox location will ~~enable~~^{efficiently and effectively drain} enable applicant to produce the gas underlying the ^{dedicated} proration unit.

~~(5) That no offset operator objected to the proposed unorthodox location.~~

(5) That ~~and~~ dedication of the w/2 of said Section 10 would be more appropriate

(6) That the subject application should be denied.

IT IS THEREFORE ORDERED

(1) That the application of Hondo Oil and Gas Company for an unorthodox gas well location for its Federal 10 Well No. 1 to be located at a point 1550

feet from the North line and 660 feet from the West
line of Section 10, Township 18 South, Range 28 East
NMPM, Doña Ana, Eddy County,
New Mexico. is hereby denied.

~~_____~~
~~_____~~

(3) That jurisdiction of this cause is retained for the entry of such further orders as the Division may deem necessary.

DONE at Santa Fe, New Mexico, on the day and year hereinabove designated.