

Case 1963: MORRIS R. ANNEIL FOR AN
PRODUCTION GAS WELL LOCATION, EDDY
COUNTY, NEW MEXICO

Case No.

6963

Application

Transcripts

Small Exhibits

ETC



POST OFFICE BOX 1000
STATE LAND OFFICE BUILDING
SANTA FE, NEW MEXICO 87501
CEN 1-7-6434

August 6, 1980

Re: CASE NO. 6963
ORDER NO. R-6412

Mr. Donald G. Stevens
Attorney at Law
Post Office Box 2203
Roswell, New Mexico 88201

Applicant:

Morris R. Antweil

Dear Sir:

Enclosed herewith are two copies of the above-referenced Division order recently entered in the subject case.

Yours very truly,

JOE D. RAMEY
Director

JDR/ed

Copy of order also sent to:

| | |
|-------------|---|
| Hobbs OCD | x |
| Artesia OCD | x |
| Aztec OCD | |

Other

STATE OF NEW MEXICO
ENERGY AND MINERALS DEPARTMENT
OIL CONSERVATION DIVISION

IN THE MATTER OF THE HEARING
CALLED BY THE OIL CONSERVATION
DIVISION FOR THE PURPOSE OF
CONSIDERING:

CASE NO. 6963
Order No. R-6412

APPLICATION OF MORRIS R. ANTWEIL
FOR AN UNORTHODOX GAS WELL LOCATION,
EDDY COUNTY, NEW MEXICO.

ORDER OF THE DIVISION

BY THE DIVISION:

This cause came on for hearing at 9 a.m. on July 9, 1980,
at Santa Fe, New Mexico, before Examiner Daniel S. Nutter.

NOW, on this 5th day of August, 1980, the Division
Director, having considered the testimony, the record, and the
recommendations of the Examiner, and being fully advised in the
premises,

FINDS:

(1) That due public notice having been given as required
by law, the Division has jurisdiction of this cause and the
subject matter thereof.

(2) That the applicant, Morris R. Antweil, seeks approval
of an unorthodox gas well location 660 feet from the North line
and 1980 feet from the East line of Section 30, Township 19 South,
Range 30 East, NMPN, to test the Morrow formation, HG-Morrow Gas
Pool, Eddy County, New Mexico.

(3) That the E/2 of said Section 30 is to be dedicated to
the well.

(4) That a well at said unorthodox location will better
enable applicant to produce the gas underlying the proration unit.

(5) That no offset operator objected to the proposed un-
orthodox location.

-2-
Case No. 6963
Order No. R-6412

(6) That approval of the subject application will afford the applicant the opportunity to produce its just and equitable share of the gas in the subject pool, will prevent the economic loss caused by the drilling of unnecessary wells, avoid the augmentation of risk arising from the drilling of an excessive number of wells, and will otherwise prevent waste and protect correlative rights.

IT IS THEREFORE ORDERED:

(1) That an unorthodox gas well location for the Morrow formation is hereby approved for a well to be located at a point 660 feet from the North line and 1980 feet from the East line of Section 30, Township 19 South, Range 30 East, NMPN, HG-Morrow Gas Pool, Eddy County, New Mexico.

(2) That the E/2 of said Section 30 shall be dedicated to the above-described well.

(3) That jurisdiction of this cause is retained for the entry of such further orders as the Division may deem necessary.

DONE at Santa Fe, New Mexico, on the day and year herein-
above designated.

STATE OF NEW MEXICO
OIL CONSERVATION DIVISION

JOE D. RAMEY
Director

S E A L

STATE OF NEW MEXICO
ENERGY AND MINERALS DEPARTMENT
OIL CONSERVATION DIVISION
STATE LAND OFFICE BLDG.
SANTA FE, NEW MEXICO
9 July 1980

EXAMINER HEARING

IN THE MATTER OF:

Application of Morris R. Antweil for
an unorthodox gas well location, Eddy
County, New Mexico.

CASE
6963

BEFORE: Daniel S. Nutter

TRANSCRIPT OF HEARING

A P P E A R A N C E S

For the Oil Conservation
Division:

Ernest L. Padilla, Esq.
Legal Counsel to the Division
State Land Office Bldg.
Santa Fe, New Mexico 87501

For the Applicant:

Donald G. Stevens, Esq.
P. O. Box 2203
Roswell, New Mexico

SALLY W. BOYD, C.S.R.

Rt. 1 Box 193-B
Santa Fe, New Mexico 87501
Phone (505) 455-7409

INDEX

R. M. WILLIAMS

Direct Examination by Mr. Stevens

Cross Examination by Mr. Nutter

EXHIBITS

Applicant Exhibit One, Plat

Applicant Exhibit Two, Tabulation

Applicant Exhibit Three, Structure Map

Applicant Exhibit Four, Isopach

SALLY W. BOYD, C.S.R.
Rt. 1 Box 193-B
Santa Fe, New Mexico 87501
Phone (505) 455-7409

1 MR. NUTTER: We'll call next Case Number
2 6963.

3 MR. PADILLA: Application of Morris R.
4 Antweil for an unorthodox gas well location, Eddy County, New
5 Mexico.

6 MR. STEVENS: Mr. Examiner, I'm Don
7 Stevens, Attorney, from Roswell, New Mexico, representing the
8 applicant in this case.

9 We have one witness to be sworn.

10
11 (Witness sworn.)

12
13 R. M. WILLIAMS
14 being called as a witness and having been duly sworn upon his
15 oath, testified as follows, to-wit:

16
17 DIRECT EXAMINATION

18 BY MR. STEVENS:

19 Q Would you state your name, your address,
20 relationship to the applicant, and your occupation, please?

21 A R. M. Williams, Hobbs, New Mexico. I'm
22 an engineer for Morris R. Antweil.

23 Q Have you previously testified before this
24 Division and had your qualifications accepted by them?

25 A Yes, I have.

SALLY W. BOYD, C.S.R.

Rt. 1 Box 193-B
Santa Fe, New Mexico 87501
Phone (505) 455-7409

1 MR. STEVENS: Are the witness' qualifi-
2 cations acceptable, Mr. Examiner?

3 MR. NUTTER: Yes, they are.

4 Q Will you state what the applicant seeks
5 in this case, Mr. Williams?

6 A We seek approval of an unorthodox location
7 for a well to be drilled 660 feet from the north line and
8 1980 feet from the east line of Section 30, Township 19 South
9 Range 30 East, and with the east half of said Section 30 to
10 be dedicated to the well.

11 Q Showing you what has been marked as Ex-
12 hibit One, would you explain it?

13 A Yes. Exhibit One is a land map in the
14 vicinity of the proposed location. On this map the proposed
15 location is indicated by the open circle.

16 The proposed gas spacing proration unit
17 being the east half of Section 30, indicated -- is colored
18 yellow.

19 The Morrow gas completion in Section 24
20 is indicated by a red circle and two dry or non-commercial
21 Morrow tests in the area have been indicated by a blue spot.

22 Q Would an orthodox location in this east
23 half of Section 30 be in the south half of northeast or north
24 half of the southeast?

25 A Yes.

SALLY W. BOYD, C.S.R.
Rt. 1 Box 193-B
Santa Fe, New Mexico 87501
Phone (505) 455-7409

SALLY W. BOYD, C.S.R.

Rt. Box 193-B

Santa Fe, New Mexico 87501

Phone (505) 455-7419

1 Q And this well, then, would be in the north
2 half of the northeast, meaning it would be unorthodox, is that
3 correct?

4 A It would be in the northwest northeast,
5 yes, unorthodox.

6 Q Refer then to Exhibit Number Two, would
7 you explain that, please?

8 A Exhibit Number Two is a tabulation of the
9 offsetting operators to the north and -- and west of the pro-
10 posed location.

11 Q And Exhibit Number Three?

12 A Exhibit Number Three is a structure map
13 in the vicinity of the proposed location, contoured on the
14 Morrow marker, 100-foot contours, showing the general -- the
15 regional northwest to southeast dip.

16 Q In your opinion does this structure affect
17 the accumulation of gas in this area?

18 A No, we don't see any control of the struc-
19 ture on the gas accumulation.

20 Q Referring then to Exhibit Number Four,
21 would you explain that?

22 A Exhibit Number Four is an Isopach of the
23 gross Morrow sand encountered by the wells in this vicinity.
24 It's contoured on a thickness interval of 20 feet. Generally
25 it shows a fingering of thicker Morrow sand development

1 trending from the northwest to the southeast. Two very well
2 indicated fingers of thicker sand development, and a inter-
3 pretive finger of sand development, which we anticipate would
4 be encountered by the proposed well.

5 Q Will that proposed location, as indicated
6 by the isopachous map, allow the applicant a greater chance
7 to recover the hydrocarbons under the north half of the north-
8 east of Section 30?

9 A Yes, if the sand development is as we
10 anticipate, this would be the most favorable location for
11 development of this 320 acres.

12 Q If the well were drilled at a standard
13 location in the east half of Section 30, what would be the
14 effect upon the applicant's rights to recover hydrocarbons
15 under the north half northeast?

16 A We would anticipate that less sand devel-
17 opment would be encountered and it would be a higher risk,
18 venture.

19 Q Are you requesting this application and
20 this unorthodox location without a penalty?

21 A That's correct.

22 Q What's your basis therefor, sir?

23 A We do not feel that we're -- would be
24 violating correlative rights of any other parties in the
25 area.

SALLY V. BOYD, C.S.R.

Rt. 1 Box 193-B

Sanita R., New Mexico 87501

Phone (505) 455-7409

SALLY W. BOYD, C.S.R.
 Rt. 1 Box 193-B
 Santa Fe, New Mexico 87501
 Phone (505) 455-7409

Q In your opinion, then, the granting of this application would tend to protect correlative rights and prevent waste?

A Yes, give us the opportunity to recover the gas under our 320-acre proration unit.

Q Do you have any further testimony regarding these exhibits?

A No.

Q Were Exhibits One through Four prepared by you or under your direction?

A they were.

MR. STEVENS: Mr. Examiner, we move at this time to introduce Exhibits One through Four into evidence.

MR. NUTTER: Exhibits One through Four will be admitted in evidence.

MR. STEVENS: No further questions at this time.

CROSS EXAMINATION

BY MR. NUTTER:

Q Mr. Williams, what is the status of this blue well in the southeast quarter of Section 30?

A That well was drilled in 1970 by H. L. Brown. It's called the No. 1 Yates Federal. It was com-

1 pleted in the Morrow and recovered a cumulative of 100-million
2 feet of gas, and was plugged and abandoned.

3 Q When was it P&A'd? Or when did it quit
4 producing?

5 A I have that information. It was rela-
6 tively soon after original completion. It was P&A'd in April,
7 '72.

8 Q And then this well over here in Section
9 25 that's indicated as a Morrow well?

10 A It was -- it was an unsuccessful Morrow
11 test. They tested, drilled through the Morrow, production
12 tested two intervals of the Morrow, and small volumes of gas
13 were recovered. The well was plugged back and completed from
14 an Upper Pennsylvanian interval.

15 Q As an oil well?

16 A What's that?

17 Q As an oil well?

18 A I think, yes.

19 Q The symbol here would be for an oil well,
20 I think. It's a solid black dot.

21 A Anyway, it was completed from the Strawn
22 of the, what is it, Canyon, and I'm not certain what type of
23 completion it was, but I know -- was just interested in the
24 Morrow and know it was unsuccessful in the Morrow.
25

MR. NUTTER: Okay. Are there any further

SALLY W. BOYD, C.S.R.

Rt. 1 Box 193-B
Santa Fe, New Mexico 87501
Phone (505) 435-7401

1 questions of Mr. Williams? He may be excused.

2 Do you have anything further, Mr. Stevens?

3 MR. STEVENS: Nothing further, Mr. Exam-
4 iner.

5 MR. NUTTER: Does anyone have anything
6 to offer in Case Number 6963?

7 We'll take the case under advisement.

8
9 (Hearing concluded.)
10
11
12
13
14
15
16
17
18
19
20
21
22
23
24
25

SALLY W. BOYD, C.S.R.

Rt. 1 Box 193-B
Santa Fe, New Mexico 87501
Phone (505) 455-7469

C E R T I F I C A T E

I, SALLY W. BOYD, C.S.R., DO HEREBY CERTIFY that
the foregoing Transcript of Hearing before the Oil Conserva-
tion Division was reported by me; that the said transcript
is a full, true, and correct record of the hearing, prepared
by me to the best of my ability.

Sally W. Boyd C.S.R.

I do hereby certify that the foregoing is
a complete record of the proceedings in
the Examiner hearing of Case No. 6723
heard by me on 7/9 1980.

[Signature] Examiner
Oil Conservation Division

SALLY W. BOYD, C.S.R.

Rt. 1 Box 153-B
Santa Fe, New Mexico 87501
Phone (505) 435-7409

STATE OF NEW MEXICO
ENERGY AND MINERALS DEPARTMENT
OIL CONSERVATION DIVISION
STATE LAND OFFICE BLDG.
SANTA FE, NEW MEXICO
9 July 1980

EXAMINER HEARING

IN THE MATTER OF:

Application of Morris R. Antweil for
an unorthodox gas well location, Eddy
County, New Mexico.

CASE
6963

BEFORE: Daniel S. Nutter

TRANSCRIPT OF HEARING

A P P E A R A N C E S

For the Oil Conservation
Division:

Ernest L. Padilla, Esq.
Legal Counsel to the Division
State Land Office Bldg.
Santa Fe, New Mexico 87501

For the Applicant:

Donald G. Stevens, Esq.
P. O. Box 2203
Roswell, New Mexico

SALLY W. BOYD, C.S.R.

Rt. 1 Box 193-B
Santa Fe, New Mexico 87501
Phone (505) 455-7409

INDEX

R. M. WILLIAMS

Direct Examination by Mr. Stevens 3

Cross Examination by Mr. Nutter 7

EXHIBITS

Applicant Exhibit One, Plat 4

Applicant Exhibit Two, Tabulation 5

Applicant Exhibit Three, Structure Map 5

Applicant Exhibit Four, Isopach 5

SALLY W. BOYD, C.S.R.

Rt. 1 Box 193-B
Santa Fe, New Mexico 87501
Phone (505) 457-7409

SALLY W. BOYD, C.S.R.
Rt. 1 Box 193-B
Santa Fe, New Mexico 87501
Phone (505) 455-7409

1
2
3
4
5
6
7
8
9
10
11
12
13
14
15
16
17
18
19
20
21
22
23
24
25

MR. NUTTER: We'll call next Case Number 6963.

MR. PADILLA: Application of Morris R. Antweil for an unorthodox gas well location, Eddy County, New Mexico.

MR. STEVENS: Mr. Examiner, I'm Don Stevens, Attorney, from Roswell, New Mexico, representing the applicant in this case.

We have one witness to be sworn.

(Witness sworn.)

R. M. WILLIAMS

being called as a witness and having been duly sworn upon his oath, testified as follows, to-wit:

DIRECT EXAMINATION

BY MR. STEVENS:

Q Would you state your name, your address, relationship to the applicant, and your occupation, please?

A R. M. Williams, Hobbs, New Mexico. I'm an engineer for Morris R. Antweil.

Q Have you previously testified before this Division and had your qualifications accepted by them?

A Yes, I have.

1 MR. STEVENS: Are the witness' qualifi-
2 cations acceptable, Mr. Examiner?

3 MR. NUTTER: Yes, they are.

4 Q Will you state what the applicant seeks
5 in this case, Mr. Williams?

6 A We seek approval of an unorthodox location
7 for a well to be drilled 660 feet from the north line and
8 1980 feet from the east line of Section 30, Township 19 South,
9 Range 30 East, and with the east half of said Section 30 to
10 be dedicated to the well.

11 Q Showing you what has been marked as Ex-
12 hibit One, would you explain it?

13 A Yes. Exhibit One is a land map in the
14 vicinity of the proposed location. On this map the proposed
15 location is indicated by the open circle.

16 The proposed gas spacing proration unit
17 being the east half of Section 30, indicated -- is colored
18 yellow.

19 The Morrow gas completion in Section 30
20 is indicated by a red circle and two dry or non-commercial
21 Morrow tests in the area have been indicated by a blue spot.

22 Q Would an orthodox location in this east
23 half of Section 30 be in the south half of northeast or north
24 half of the southeast?

25 A Yes.

SALLY W. BOYD, C.S.R.
Rt. 1 Box 193-B
Santa Fe, New Mexico 87501
Phone (505) 455-7409

1 Q And this well, then, would be in the north
2 half of the northeast, meaning it would be unorthodox, is that
3 correct?

4 A It would be in the northwest northeast,
5 yes, unorthodox.

6 Q Referring then to Exhibit Number Two, would
7 you explain that, please?

8 A Exhibit Number Two is a tabulation of the
9 offsetting operators to the north and -- and west of the pro-
10 posed location.

11 Q And Exhibit Number Three?

12 A Exhibit Number Three is a structure map
13 in the vicinity of the proposed location, contoured on the
14 Morrow marker, 100-foot contours, showing the general -- the
15 regional northwest to southeast dip.

16 Q In your opinion does this structure affect
17 the accumulation of gas in this area?

18 A No, we don't see any control of the struc-
19 ture on the gas accumulation.

20 Q Referring then to Exhibit Number Four,
21 would you explain that?

22 A Exhibit Number Four is an Isopach of the
23 gross Morrow sand encountered by the wells in this vicinity.
24 It's contoured on a thickness interval of 20 feet. Generally
25 it shows a fingering of thicker Morrow sand development

SALLY W. BOYD, C.S.R.

Rt. 1 Box 193-B

Santa Fe, New Mexico 87501

Phone (505) 455-7409

1 trending from the northwest to the southeast. Two very well
2 indicated fingers of thicker sand development, and a inter-
3 pretive finger of sand development, which we anticipate would
4 be encountered by the proposed well.

5 Q Will that proposed location, as indicated
6 by the Isopachous map, allow the applicant a greater chance
7 to recover the hydrocarbons under the north half of the north-
8 east of Section 30?

9 A Yes, if the sand development is as we
10 anticipate, this would be the most favorable location for
11 development of this 320 acres.

12 Q If the well were drilled at a standard
13 location in the east half of Section 30, what would be the
14 effect upon the applicant's rights to recover hydrocarbons
15 under the north half northeast?

16 A We would anticipate that less sand devel-
17 opment would be encountered and it would be a higher risk,
18 venture.

19 Q Are you requesting this application and
20 this unorthodox location without a penalty?

21 A That's correct.

22 Q What's your basis therefor, sir?

23 A We do not feel that we're -- would be
24 violating correlative rights of any other parties in the
25 area.

SALLY W. BOYD, C.S.R.

Rt. 1 Box 193-B
Santa Fe, New Mexico 87501
Phone (505) 435-7409

1 Q In your opinion, then, the granting of
2 this application would tend to protect correlative rights and
3 prevent waste?

4 A Yes, give us the opportunity to recover
5 the gas under our 320-acre proration unit.

6 Q Do you have any further testimony re-
7 garding these exhibits?

8 A No.

9 Q Were Exhibits One through Four prepared
10 by you or under your direction?

11 A they were.

12 MR. STEVENS: Mr. Examiner, we move at
13 this time to introduce Exhibits One through Four into evi-
14 dence.

15 MR. NUTTER: Exhibits One through Four
16 will be admitted in evidence.

17 MR. STEVENS: No further questions at this
18 time.
19

20 CROSS EXAMINATION

21 BY MR. NUTTER:

22 Q Mr. Williams, what is the status of this
23 blue well in the southeast quarter of Section 30?

24 A That well was drilled in 1970 by H. L.
25 Brown. It's called the No. 1 Yates Federal. It was com-

SALLY W. BOYD, C.S.R.
Rt. 1 Box 193-B
Santa Fe, New Mexico 87501
Phone (505) 455-7409

1 pleted in the Morrow and recovered a cumulative of 100-million
2 feet of gas, and was plugged and abandoned.

3 Q When was it P&A'd? Or when did it quit
4 producing?

5 A I have that information. It was rela-
6 tively soon after original completion. It was P&A'd in April,
7 '72.

8 Q And then this well over here in Section
9 25 that's indicated as a Morrow well?

10 A It was -- it was an unsuccessful Morrow
11 test. They tested, drilled through the Morrow, production
12 tested two intervals of the Morrow, and small volumes of gas
13 were recovered. The well was plugged back and completed from
14 an Upper Pennsylvanian interval.

15 Q As an oil well?

16 A What's that?

17 Q As an oil well?

18 A I think, yes.

19 Q The symbol here would be for an oil well
20 I think. It's a solid black dot.

21 A Anyway, it was completed from the Strawn
22 of the, what is it, Canyon, and I'm not certain what type of
23 completion it was, but I know -- was just interested in the
24 Morrow and know it was unsuccessful in the Morrow.

25 MR. NUTTER: Okay. Are there any further

SALLY W. BOYD, C.S.R.

RT. 1 Box 153-B
Santa Fe, New Mexico 87501
Phone (505) 433-7400

1 questions of Mr. Williams? He may be excused.

2 Do you have anything further, Mr. Stevens?

3 MR. STEVENS: Nothing further, Mr. Exam-
4 iner.

5 MR. NUTTER: Does anyone have anything
6 to offer in Case Number 69637

7 We'll take the case under advisement.

8
9 (Hearing concluded.)
10

SALLY W. BOYD, C.S.R.
Rt. 1 Box 193-B
Santa Fe, New Mexico 87501
Phone (505) 455-7409

11
12
13
14
15
16
17
18
19
20
21
22
23
24
25

C E R T I F I C A T E

I, SALLY W. BOYD, C.S.R., DO HEREBY CERTIFY that
the foregoing Transcript of Hearing before the Oil Conserva-
tion Division was reported by me; that the said transcript
is a full, true, and correct record of the hearing, prepared
by me to the best of my ability.

SALLY W. BOYD, C.S.R.
Rt. 1 Box 193-B
Santa Fe, New Mexico 87501
Phone (505) 455-7409

I do hereby certify that the foregoing is
a complete record of the proceedings in
the Examiner hearing of Case No. 683,
heard by me on 7/9 1955.
, Examiner
Oil Conservation Division

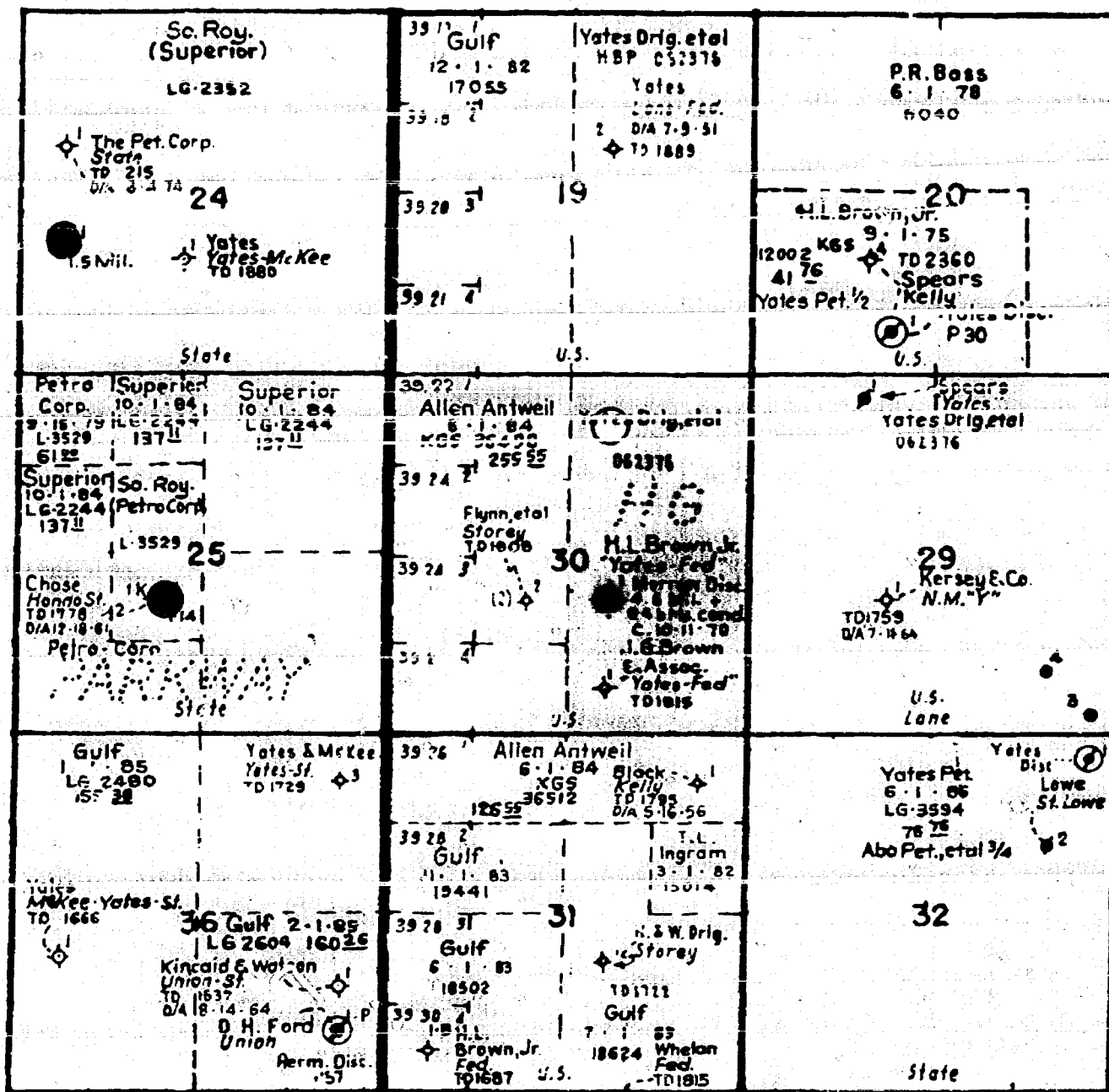

MORRIS R. ANTWEIL
CASE NO. 6963

- ☐ Proposed Location - 660 FNL & 1980 FEL Sec. 30
- ☒ Morrow Gas Completion
- ☒ Dry or Non-Commercial Morrow Test

☐ Gas Spacing & Proration Unit

BEFORE EXAMINER NUTTER

OIL CONSERVATION DIVISION

App. EXHIBIT NO. 1

CASE NO. 6963

Exhibit 1

TABULATION OF OFFSET OPERATORS

Section 19 - Yates Drilling Company
207 South 4th
Artesia, New Mexico 88210

Section 19 - Gulf Energy & Minerals Company
P. O. Box 670
Hobbs, New Mexico 88240

Section 30 - Alan Antweil
P. O. Box 2010
Hobbs, New Mexico 88240

MORRIS R. ANTWEIL
CASE NO. 6963
Exhibit No. 2

BEFORE EXAMINER NUTTER
OIL CONSERVATION DIVISION
Am. EXHIBIT NO. 2
CASE NO. 6963

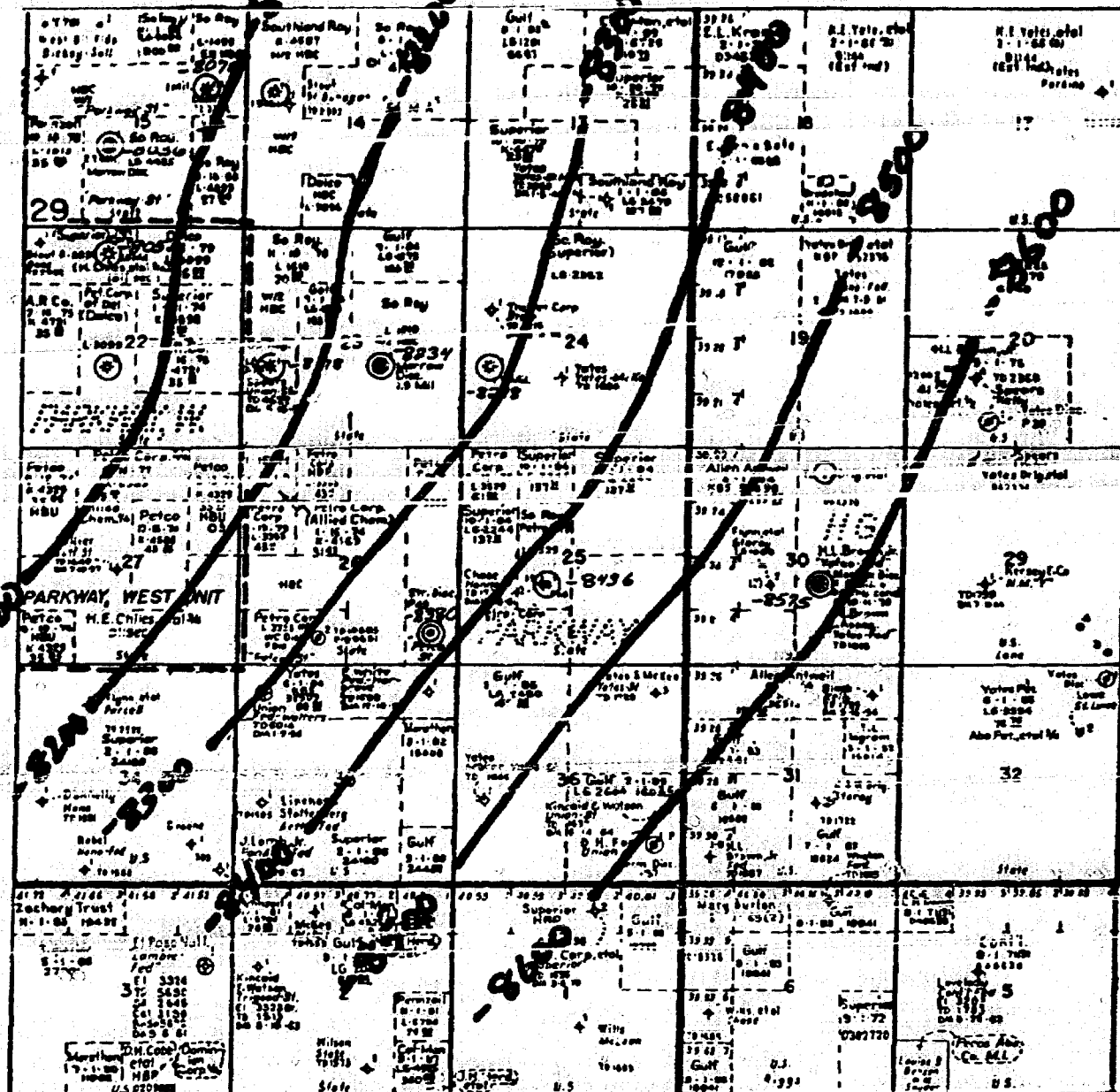

MORRIS R. ANIWEILL
CASE NO. 6963

STRUCTURE MAP
100-foot Contours - Morrow Marker

BEFORE EXAMINER NUTTER
OIL CONSERVATION DIVISION
Appl. EXHIBIT NO. 3
CASE NO. 6963

Exhibit No. 3

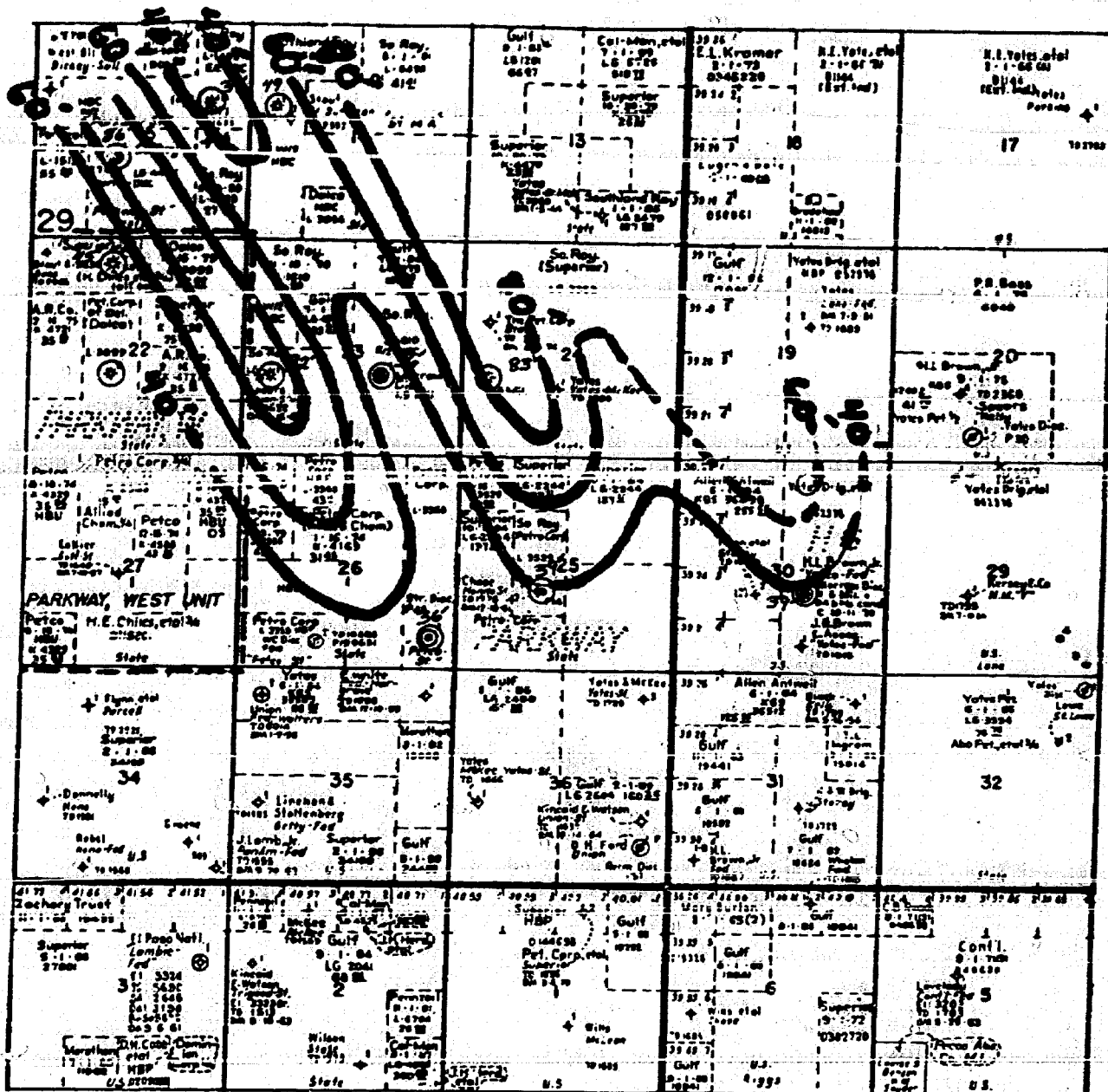

MORRIS R. ANTWEIL
CASE NO. 6963

GROSS MORROW SAND ISOPACH MAP

C.I. = 20'

BEFORE EXAMINER NUTTER

OIL CONSERVATION DIVISION

App. EXHIBIT NO. 4

CASE NO. 6963

Exhibit No. 4

TABULATION OF OFFSET OPERATORS

Section 19

-

Yates Drilling Company
207 South 4th
Artesia, New Mexico 88210

Section 19

-

Gulf Energy & Minerals Company
P. O. Box 670
Hobbs, New Mexico 88240

Section 30

-

Alan Antweil
P. O. Box 2010
Hobbs, New Mexico 88240

MORRIS R. ANTWEIL
CASE NO. 6963
Exhibit No. 2

BEFORE EXAMINER "NUTTER"
OIL CONSERVATION DIVISION
Appl. EXHIBIT NO. 2
CASE NO. 6963

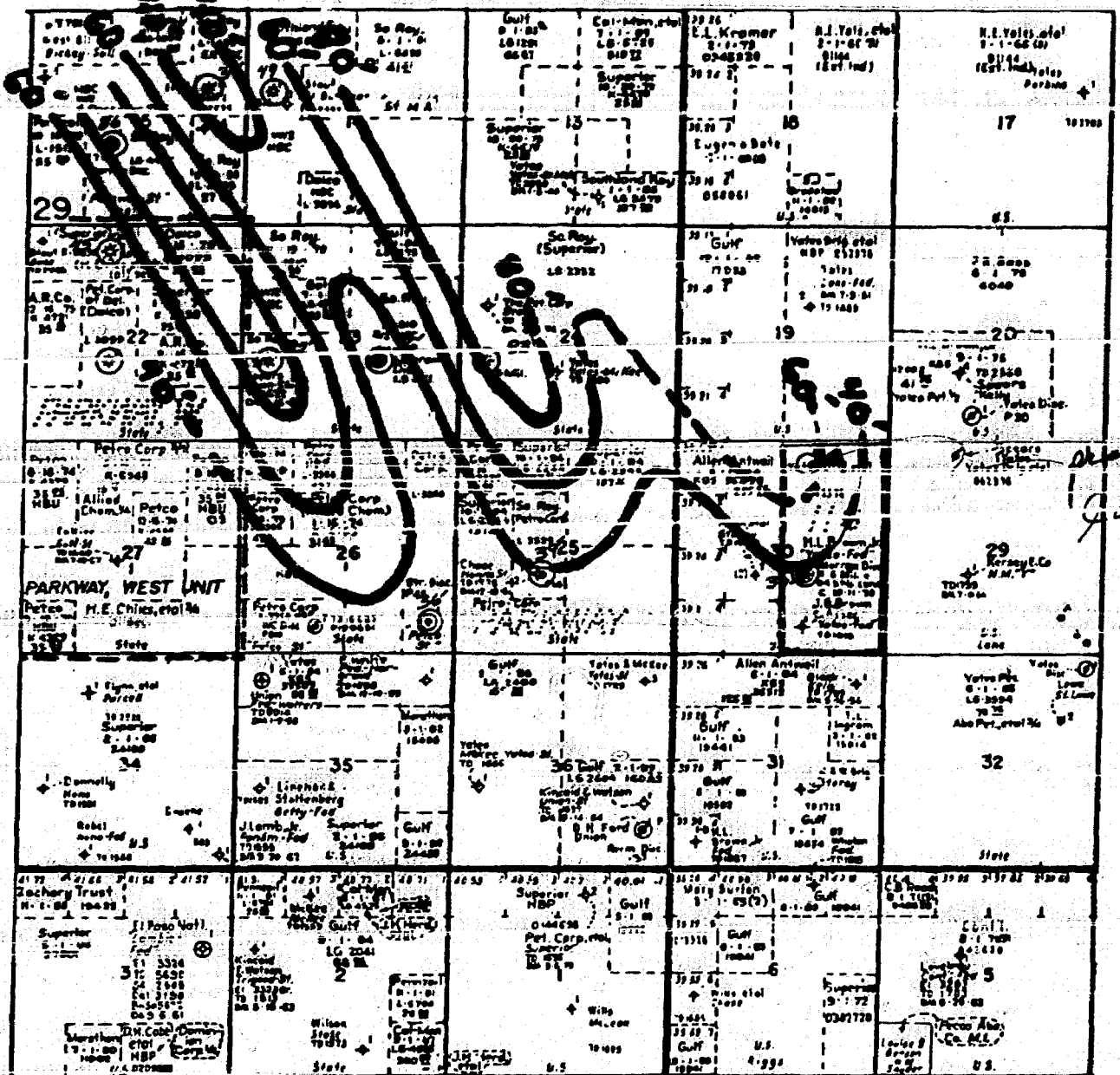

MORRIS R. ANIWEIL
CASE NO. 6963

GROSS MORROW SAND ISOPACH MAP

C.I. = 20'

| | |
|---------------------------|---------------|
| BEFORE EXAMINER NUTTER | |
| OIL CONSERVATION DIVISION | |
| Appl. | EXHIBIT NO. 4 |
| CASE NO. | 6963 |

Exhibit No. 4

CASE 6943: (Continued from June 25, 1980, Examiner Hearing)

Application of Benson-Montin-Greer Drilling Corporation for a unit agreement, Rio Arriba County, New Mexico. Applicant, in the above styled cause, seeks approval for the East Puerto Chiquito-Mancos Unit Area, comprising 9,769 acres, more or less, of Federal, Indian, and fee lands in Townships 26 and 27 North, Ranges 1 East and 1 West.

CASE 6944: (Continued from June 25, 1980, Examiner Hearing)

Application of Benson-Montin-Greer Drilling Corporation for a pressure maintenance project, Rio Arriba County, New Mexico. Applicant, in the above-styled cause, seeks authority to institute a pressure maintenance project by the injection of gas, air, LPG, water, or chemicals into the Mancos formation thru 7 wells on its East Puerto Chiquito-Mancos Unit Area.

CASE 6963:

Application of Morris R. Antweil for an unorthodox gas well location, Eddy County, New Mexico. Applicant, in the above-styled cause, seeks approval for the unorthodox location of a well to be drilled 660 feet from the North line and 1980 feet from the East line of Section 30, Township 19 South, Range 30 East, HG-Morrow Gas Pool, the E/2 of said Section 30 to be dedicated to the well.

CASE 6964:

Application of Morris R. Antweil for an unorthodox gas well location and simultaneous dedication, Eddy County, New Mexico. Applicant, in the above-styled cause, seeks approval for the unorthodox location of its Rio Com. Well No. 2, to be drilled 660 feet from the North and West lines of Section 29, Township 18 South, Range 25 East, Penasco Draw-Morrow Gas Pool, to be simultaneously dedicated with its Rio Com. Well No. 1 in Unit C to the N/2 of said Section 29.

Docket No. 21-80

DOCKET: EXAMINER HEARING - WEDNESDAY - JULY 16, 1980

9 A.M. - OIL CONSERVATION DIVISION CONFERENCE ROOM,
STATE LAND OFFICE BUILDING, SANTA FE, NEW MEXICO

The following cases will be heard before Richard L. Stamets, Examiner, or Daniel S. Nutter, Alternate Examiner:

- ALLOWABLE:
- (1) Consideration of the allowable production of gas for August, 1980, from fifteen prorated pools in Lea, Eddy, and Chaves Counties, New Mexico.
 - (2) Consideration of the allowable production of gas for August, 1980, from four prorated pools in San Juan, Rio Arriba, and Sandoval Counties, New Mexico.

Morris R. Antweil
OIL OPERATOR
P. O. Box 2010
HOBBS, NEW MEXICO 88240
June 12, 1980

RECEIVED
JUN 13 1980
OIL CONSERVATION DIVISION
SANTA FE

New Mexico Oil Conservation Division
Box 2088
Santa Fe, New Mexico 87501
Attn: Mr. Joe D. Ramsey

Page 6963

RE: Request for Unorthodox Location Hearing
E/2 Section 30-T19S-R30E
Eddy County, New Mexico

Gentlemen:

Morris R. Antweil has obtained operating rights on the E/2 of Section 30-T19S-R30E, Eddy County, and proposes to drill a 12,000 foot Morrow test at a location 660' FNL & 1980' FEL of said Section 30. Applicant seeks an exception to the well location requirements of Oil Conservation Division Rule 104-B-I-(a) to permit the drilling of a well at the above-mentioned unorthodox location to test the Morrow Formation in the Pennsylvanian System. Applicant proposes that the standard 320-acre gas spacing and proration unit comprising the E/2 of said Section 30 be dedicated to the proposed well.

Morris R. Antweil therefore requests that this application be set for hearing before the duly appointed Examiner of the Oil Conservation Division on 9 July 80, that notice be given as required by law and the Rules of the Division, that the Division enter its Order granting the Applicant permission to drill the proposed well at a location 660' FNL & 1980' FEL of said Section 30, and that the E/2 of said Section 30 be dedicated to the proposed well.

Respectively Submitted,

MORRIS R. ANTWEIL

R M Williams

R. M. Williams

RMW:pa

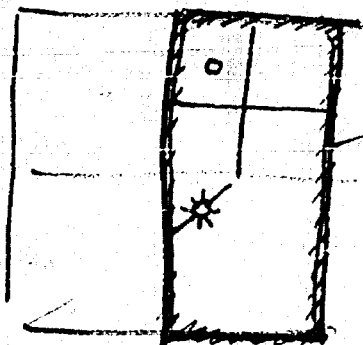

HG Morrow Gas Pool
(E/2 30-T19-30)

DRAFT

dr/

STATE OF NEW MEXICO
ENERGY AND MINERALS DEPARTMENT
OIL CONSERVATION DIVISION

IN THE MATTER OF THE HEARING
CALLED BY THE OIL CONSERVATION
DIVISION FOR THE PURPOSE OF
CONSIDERING:

CASE NO. 6963

ORDER NO. R- 6412

APPLICATION OF MORRIS R. ANTWEIL

FOR AN UNORTHODOX GAS WELL LOCATION,

EDDY COUNTY, NEW MEXICO.

ORDER OF THE DIVISION

BY THE DIVISION:

This cause came on for hearing at 9 a.m. on July 9,
19 80, at Santa Fe, New Mexico, before Examiner Daniel S. Nutter.

NOW, on this day of July, 19 80, the Division
Director, having considered the testimony, the record, and the
recommendations of the Examiner, and being fully advised in the
premises,

FINDS:

(1) That due public notice having been given as required by
law, the Division has jurisdiction of this cause and the subject
matter thereof.

(2) That the applicant, Morris R. Antweil,
seeks approval of an unorthodox gas well location 660
feet from the North line and 1980 feet from the
East line of Section 30, Township 19 South,
Range 30 East, NMPM, to test the Morrow
formation, HG-Morrow Gas Pool, Eddy
County, New Mexico.

(3) That the E/2 of said Section 30 is to be
dedicated to the well.

(4) That a well at said unorthodox location will better
enable applicant to produce the gas underlying the proration unit.

(5) That no offset operator objected to the proposed unorthodox
location.

-2-

Case No. _____

Order No. R- _____

(6) That approval of the subject application will afford the applicant the opportunity to produce its just and equitable share of the gas in the subject pool, will prevent the economic loss caused by the drilling of unnecessary wells, avoid the augmentation of risk arising from the drilling of an excessive number of wells, and will otherwise prevent waste and protect correlative rights.

IT IS THEREFORE ORDERED:

(1) That an unorthodox gas well location for the Morrow formation is hereby approved for a well to be located at a point 660 feet from the North line and 1980 feet from the East line of Section 30, Township 19 South, Range 30 East NMPM, HG-Morrow Gas Pool, Eddy County, New Mexico.

(2) That the E/2 of said Section 30 shall be dedicated to the above-described well.

(3) That jurisdiction of this cause is retained for the entry of such further orders as the Division may deem necessary.

DONE at Santa Fe, New Mexico, on the day and year hereinabove designated.