

CASE NO.

7143

APPLICATION,
TRANSCRIPTS,
SMALL EXHIBITS,
ETC.

Memo

From

FLORENE DAVIDSON
ADMINISTRATIVE SECRETARY

To

Called in by Bill Carr
11/7/81

Morris R. Antweil

Unorthodox Gas Well
Location

660/5 + W

28-185-25E

Eddy County

Morrow test

W/2 to be dedicated

OIL CONSERVATION COMMISSION-SANTA FE

STATE OF NEW MEXICO
ENERGY AND MINERALS DEPARTMENT
OIL CONSERVATION DIVISION
STATE LAND OFFICE BLDG.
SANTA FE, NEW MEXICO
28 January 1981

EXAMINER HEARING

IN THE MATTER OF:

Application of Morris R. Antweil
for an unorthodox gas well location,
Eddy County, New Mexico.

CASE
7143

BEFORE: Daniel S. Nutter

TRANSCRIPT OF HEARING

A P P E A R A N C E S

For the Oil Conservation
Division:

Ernest L. Padilla, Esq.
Legal Counsel to the Division
State Land Office Bldg.
Santa Fe, New Mexico 87501

For the Applicant:

William F. Carr, Esq.
CAMPBELL, BYRD, & BLACK P. A.
Jefferson Place
Santa Fe, New Mexico 87501

1
2
3
4
5
6
7
8
9
10
11
12
13
14
15
16
17
18
19
20
21
22
23
24
25

2

I N D E X

R. M. WILLIAMS

Direct Examination by Mr. Carr

3

Cross Examination by Mr. Nutter

6

E X H I B I T S

Applicant Exhibit One, Plat

4

Applicant Exhibit Two, Map

5

Applicant Exhibit Three, Map

5

1
2 MR. NUTTER: We'll call next Case Number
3 7143.

4 MR. PADILLA: Application of Morris R.
5 Antweil for an unorthodox gas well location, Eddy County, New
6 Mexico.

7 MR. CARR: May it please the Examiner,
8 my name is William F. Carr, with the law firm of Campbell,
9 Byrd, and Black, Santa Fe, New Mexico, and I have one witness
10 who needs to be sworn.

11
12 (Witness sworn.)

13
14 R. M. WILLIAMS
15 being called as a witness and being duly sworn upon his oath,
16 testified as follows, to-wit:

17
18 DIRECT EXAMINATION

19 BY MR. CARR:

20 Q Will you state your name and place of
21 residence?

22 A R. M. Williams. Hobbs, New Mexico.

23 Q By whom are you employed and in what
24 capacity?

25 A Employed by Morris R. Antweil as an

1
2 engineer.

3 Q Have you previously testified before
4 this Commission and had your credentials as an engineer ac-
5 cepted and made a matter of record?

6 A Yes, I have.

7 Q Are you familiar with the application
8 which has been filed in this case and the subject lease?

9 A Yes.

10 MR. CARR: Are the witness' qualifications
11 acceptable?

12 MR. NUTTER: They are.

13 Q Will you briefly state what Morris R.
14 Antweil seeks with this application?

15 A We seek the approval of an unorthodox
16 location for a Morrow gas well to be located 660 feet from
17 the south line and 660 feet from the west line of Section 28,
18 Township 18 South, Range 25 East, Eddy County, with the west
19 half of said Section 28 to be dedicated as the gas proration
20 and spacing unit for the proposed well.

21 Q Will you please refer to what has been
22 marked for identification as Antweil Exhibit Number One and
23 explain to the Examiner what it is and what it shows?

24 A Exhibit Number One is a land plat. It
25 shows the proposed location of the well at the unorthodox

1
2 location and the proposed proration unit to be dedicated to
3 that well. Also, the other, the existing wells in the vicinity
4 of the proposed well are shown on the map.

5 Q Have the offsetting operators been notified
6 of your application today?

7 A Yes. The offsetting operators are Morris
8 R. Antweil has two wells to the west and northwest. The
9 Yates Petroleum Corporation has a well to the south and west.
10 And ARCO has acreage in the area but no producers. ARCO and
11 Yates Petroleum were both notified of this case.

12 Q Mr. Williams, will you now refer to
13 Antweil Exhibit Number Two and review this for the Examiner?

14 A Exhibit Two is the same area as the land
15 map with the structure of the Morrow formation shown on this
16 map. The proposed location and proration unit are also designated.
17

18 Q Is structure very useful in determining
19 whether or not you have a good Morrow location?

20 A No. Our experience in this area has
21 indicated that structure is not critical to the production
22 or nonproduction of the wells.

23 Q Will you now refer to Antweil Exhibit
24 Number Three?

25 A Exhibit Three is an Isopach of the gross

1 sand thickness of the clean Morrow sand in the vicinity of
2 the application, showing here a channel of thicker Morrow
3 sand deposition trending from the northwest to the southeast
4 through this area. And I think this exhibit depicts our
5 reason for seeking to move our well to the southwestern
6 location on the proposed proration unit, to -- in our antici-
7 pation of encountering thicker Morrow sand deposition at
8 this location.
9

10 Q Mr. Williams, in your opinion will
11 granting this application be in the best interest of conser-
12 vation, the prevention of waste, and the protection of cor-
13 relative rights?

14 A Yes, it will.

15 Q Were Exhibits One through Three prepared
16 by you?

17 A Yes, they were.

18 MR. CARR: At this time, Mr. Nutter,
19 we would offer Antweil Exhibits One through Three.

20 MR. NUTTER: Exhibits One through Three
21 will be admitted in evidence.

22
23 CROSS EXAMINATION

24 BY MR. NUTTER:

25 Q Mr. Williams, what is the status of the

1
2
3
4
5
6
7
8
9
10
11
12
13
14
15
16
17
18
19
20
21
22
23
24
25

No. 1 Well in the southwest quarter of Section 28?

A. The -- this is our No. 1 Dinkus Well.
It is an Atoka completion and is producing as a limited capacity Atoka well.

Q And the well you're proposing is a Morrow well?

A Yes. We intend to test the Morrow.

Q Okay, so there's no simultaneous dedication in two zones.

A No.

MR. NUTTER: Are there any other questions of Mr. Williams? He may be excused.

Do you have anything further, Mr. Carr?

MR. CARR: Nothing further.

MR. NUTTER: Does anyone have anything further they wish to offer in Case Number 7143?

We'll take the case under advisement.

(Hearing concluded.)

C E R T I F I C A T E

I, SALLY W. BOYD, C.S.R., DO HEREBY CERTIFY that
the foregoing Transcript of Hearing before the Oil Conserva-
tion Division was reported by me; that the said transcript
is a full, true, and correct record of the hearing, prepared
by me to the best of my ability.

Sally W. Boyd C.S.R.

SALLY W. BOYD, C.S.R.
Rt. 1 Box 193-B
Santa Fe, New Mexico 87501
Phone (505) 855-7409

I do hereby certify that the foregoing is
a complete and correct transcript of the proceedings in
the Examiner hearing of case No. 7143
heard by me on 1/28 1981.

[Signature], Examiner
Oil Conservation Division

STATE OF NEW MEXICO
ENERGY AND MINERALS DEPARTMENT
OIL CONSERVATION DIVISION
STATE LAND OFFICE BLDG.
SANTA FE, NEW MEXICO
28 January 1981

EXAMINER HEARING

IN THE MATTER OF:

Application of Morris R. Antweil
for an unorthodox gas well location,
Eddy County, New Mexico.

CASE
7143

BEFORE: Daniel S. Nutter

TRANSCRIPT OF HEARING

A P P E A R A N C E S

For the Oil Conservation
Division:

Ernest L. Padilla, Esq.
Legal Counsel to the Division
State Land Office Bldg.
Santa Fe, New Mexico 87501

For the Applicant:

William F. Carr, Esq.
CAMPBELL, BYRD, & BLACK P. A.
Jefferson Place
Santa Fe, New Mexico 87501

1
2
3
4
5
6
7
8
9
10
11
12
13
14
15
16
17
18
19
20
21
22
23
24
25

2

I N D E X

R. M. WILLIAMS

Direct Examination by Mr. Carr	3
Cross Examination by Mr. Nutter	6

E X H I B I T S

Applicant Exhibit One, Plat	4
Applicant Exhibit Two, Map	5
Applicant Exhibit Three, Map	5

1
2
3
4
5
6
7
8
9
10
11
12
13
14
15
16
17
18
19
20
21
22
23
24
25

MR. NUTTER: We'll call next Case Number
7143.

MR. PADILLA: Application of Morris R.
Antweil for an unorthodox gas well location, Eddy County, New
Mexico.

MR. CARR: May it please the Examiner,
my name is William F. Carr, with the law firm of Campbell,
Byrd, and Black, Santa Fe, New Mexico, and I have one witness
who needs to be sworn.

(Witness sworn.)

R. M. WILLIAMS
being called as a witness and being duly sworn upon his oath,
testified as follows, to-wit:

DIRECT EXAMINATION

BY MR. CARR:

Q Will you state your name and place of
residence?

A R. M. Williams. Hobbs, New Mexico.

Q By whom are you employed and in what
capacity?

A Employed by Morris R. Antweil as an

1
2 engineer.

3 Q Have you previously testified before
4 this Commission and had your credentials as an engineer ac-
5 cepted and made a matter of record?

6 A Yes, I have.

7 Q Are you familiar with the application
8 which has been filed in this case and the subject lease?

9 A Yes.

10 MR. CARR: Are the witness' qualifications
11 acceptable?

12 MR. NUTTER: They are.

13 Q Will you briefly state what Morris R.
14 Antweil seeks with this application?

15 A We seek the approval of an unorthodox
16 location for a Morrow gas well to be located 660 feet from
17 the south line and 660 feet from the west line of Section 28,
18 Township 18 South, Range 25 East, Eddy County, with the west
19 half of said Section 28 to be dedicated as the gas proration
20 and spacing unit for the proposed well.

21 Q Will you please refer to what has been
22 marked for identification as Antweil Exhibit Number One and
23 explain to the Examiner what it is and what it shows?

24 A Exhibit Number One is a land plat. It
25 shows the proposed location of the well at the unorthodox

1
2 location and the proposed proration unit to be dedicated to
3 that well. Also, the other, the existing wells in the vicinity
4 of the proposed well are shown on the map.

5 Q Have the offsetting operators been notified
6 of your application today?

7 A Yes. The offsetting operators are Morris
8 R. Antweil has two wells to the west and northwest. The
9 Yates Petroleum Corporation has a well to the south and west.
10 And ARCO has acreage in the area but no producers. ARCO and
11 Yates Petroleum were both notified of this case.

12 Q Mr. Williams, will you now refer to
13 Antweil Exhibit Number Two and review this for the Examiner?

14 A Exhibit Two is the same area as the land
15 map with the structure of the Morrow formation shown on this
16 map. The proposed location and proration unit are also designated.
17

18 Q Is structure very useful in determining
19 whether or not you have a good Morrow location?

20 A No. Our experience in this area has
21 indicated that structure is not critical to the production
22 or nonproduction of the wells.

23 Q Will you now refer to Antweil Exhibit
24 Number Three?

25 A Exhibit Three is an Isopach of the gross

6

1
2 sand thickness of the clean Morrow sand in the vicinity of
3 the application, showing here a channel of thicker Morrow
4 sand deposition trending from the northwest to the southeast
5 through this area. And I think this exhibit depicts our
6 reason for seeking to move our well to the southwestern
7 location on the proposed proration unit, to -- in our antici-
8 pation of encountering thicker Morrow sand deposition at
9 this location.

10 Q Mr. Williams, in your opinion will
11 granting this application be in the best interest of conser-
12 vation, the prevention of waste, and the protection of cor-
13 relative rights?

14 A Yes, it will.

15 Q Were Exhibits One through Three prepared
16 by you?

17 A Yes, they were.

18 MR. CARR: At this time, Mr. Nutter,
19 we would offer Antweil Exhibits One through Three.

20 MR. NUTTER: Exhibits One through Three
21 will be admitted in evidence.

22
23 CROSS EXAMINATION

24 BY MR. NUTTER:

25 Q Mr. Williams, what is the status of the

1
2 No. 1 Well in the southwest quarter of Section 28?

3 A. The -- this is our No. 1 Dinkus Well.
4 It is an Atoka completion and is producing as a limited capa-
5 city Atoka well.

6 Q And the well you're proposing is a Mor-
7 row well?

8 A Yes. We intend to test the Morrow.

9 Q Okay, so there's no simultaneous dedi-
10 cation in two zones.

11 A No.

12 MR. NUTTER: Are there any other ques-
13 tions of Mr. Williams? He may be excused.

14 Do you have anything further, Mr. Carr?

15 MR. CARR: Nothing further.

16 MR. NUTTER: Does anyone have anything
17 further they wish to offer in Case Number 7143?

18 We'll take the case under advisement.

19
20 (Hearing concluded.)
21
22
23
24
25

C E R T I F I C A T E

I, SALLY W. BOYD, C.S.R., DO HEREPY CERTIFY that
the foregoing Transcript of Hearing before the Oil Conserva-
tion Division was reported by me; that the said transcript
is a full, true, and correct record of the hearing, prepared
by me to the best of my ability.

SALLY W. BOYD, C.S.R.

Rt. 1 Box 193-B
Santa Fe, New Mexico 87501
Phone (505) 455-7409

I do hereby certify that the foregoing is
a complete and correct transcript of the proceedings in
the Examiner hearing of case No. 7143
heard by me on 1/28 1984.

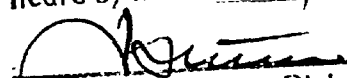
 , Examiner
Oil Conservation Division



STATE OF NEW MEXICO
ENERGY AND MINERALS DEPARTMENT
OIL CONSERVATION DIVISION

BRUCE KING
GOVERNOR
LARRY KEHOE
SECRETARY

POST OFFICE BOX 2088
STATE LAND OFFICE BUILDING
SANTA FE, NEW MEXICO 87501
(505) 827-2434

February 13, 1981

Mr. William F. Carr
Campbell and Black
Attorneys at Law
Post Office Box 2208
Santa Fe, New Mexico

Re: CASE NO. 7143
ORDER NO. R-6592

Applicant:

Morris R. Antweil

Dear Sir:

Enclosed herewith are two copies of the above-referenced Division order recently entered in the subject case.

Yours very truly,

JOE D. RAMEY
Director

JDR/fd

Copy of order also sent to:

Hobbs OCD	
Artesia OCD	X
Aztec OCD	

Other _____

STATE OF NEW MEXICO
ENERGY AND MINERALS DEPARTMENT
OIL CONSERVATION DIVISION

IN THE MATTER OF THE HEARING
CALLED BY THE OIL CONSERVATION
DIVISION FOR THE PURPOSE OF
CONSIDERING:

CASE NO. 7143
Order No. R-6392

APPLICATION OF MORRIS R. ANTWEIL
FOR AN UNORTHODOX GAS WELL LOCATION,
EDDY COUNTY, NEW MEXICO.

ORDER OF THE DIVISION

BY THE DIVISION:

This cause came on for hearing at 9 a.m. on January 28, 1981, at Santa Fe, New Mexico, before Examiner Daniel S. Nutter.

NOW, on this 12th day of February, 1981, the Division Director, having considered the testimony, the record, and the recommendations of the Examiner, and being fully advised in the premises,

FINDS:

- (1) That due public notice having been given as required by law, the Division has jurisdiction of this cause and the subject matter thereof.
- (2) That the applicant, Morris R. Antweil, seeks approval of an unorthodox gas well location 660 feet from the South line and 660 feet from the West line of Section 28, Township 18 South, Range 25 East, NMPM, to test the Morrow formation, Penasco Draw-Morrow Gas Pool, Eddy County, New Mexico.
- (3) That the W/2 of said Section 28 is to be dedicated to the well.
- (4) That a well at said unorthodox location will better enable applicant to produce the gas underlying the proration unit.
- (5) That no offset operator objected to the proposed unorthodox location.

-2-

Case No. 7143
Order No. R-6592

(6) That approval of the subject application will afford the applicant the opportunity to produce its just and equitable share of the gas in the subject pool, will prevent the economic loss caused by the drilling of unnecessary wells, avoid the augmentation of risk arising from the drilling of an excessive number of wells, and will otherwise prevent waste and protect correlative rights.

IT IS THEREFORE ORDERED:

(1) That an unorthodox gas well location for the Morrow formation is hereby approved for Morris R. Antweil to drill a well to be located at a point 660 feet from the South line and 660 feet from the West line of Section 28, Township 18 South, Range 25 East, NMPM, Pecos Draw-Morrow Gas Pool, Eddy County, New Mexico.

(2) That the W/2 of said Section 28 shall be dedicated to the above-described well.

(3) That jurisdiction of this cause is retained for the entry of such further orders as the Division may deem necessary.

DONE at Santa Fe, New Mexico, on the day and year hereinabove designated.

STATE OF NEW MEXICO
OIL CONSERVATION DIVISION



JOE D. RAMEY
Director

S E A L

rd/

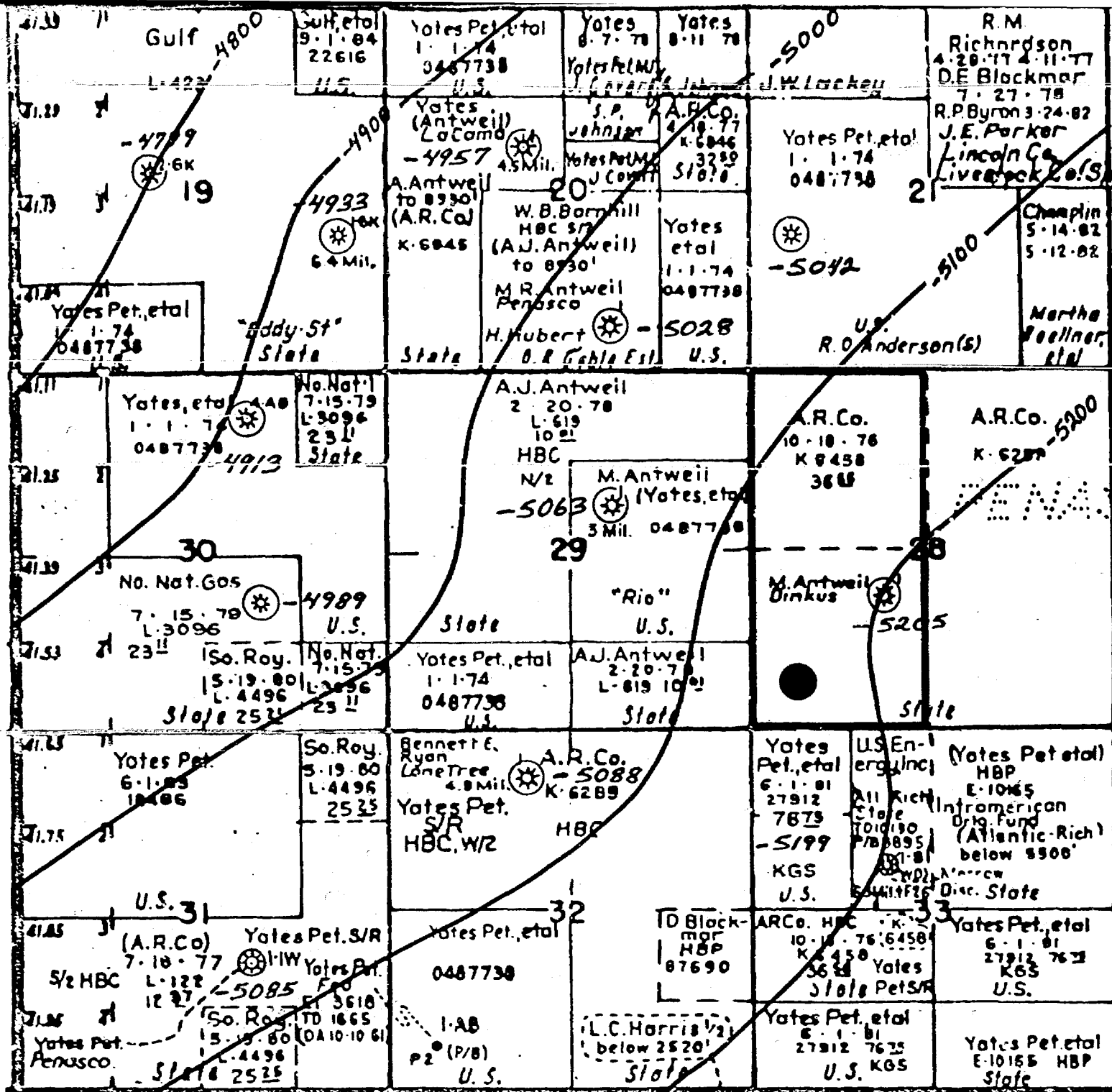
Scale 1"=2000'

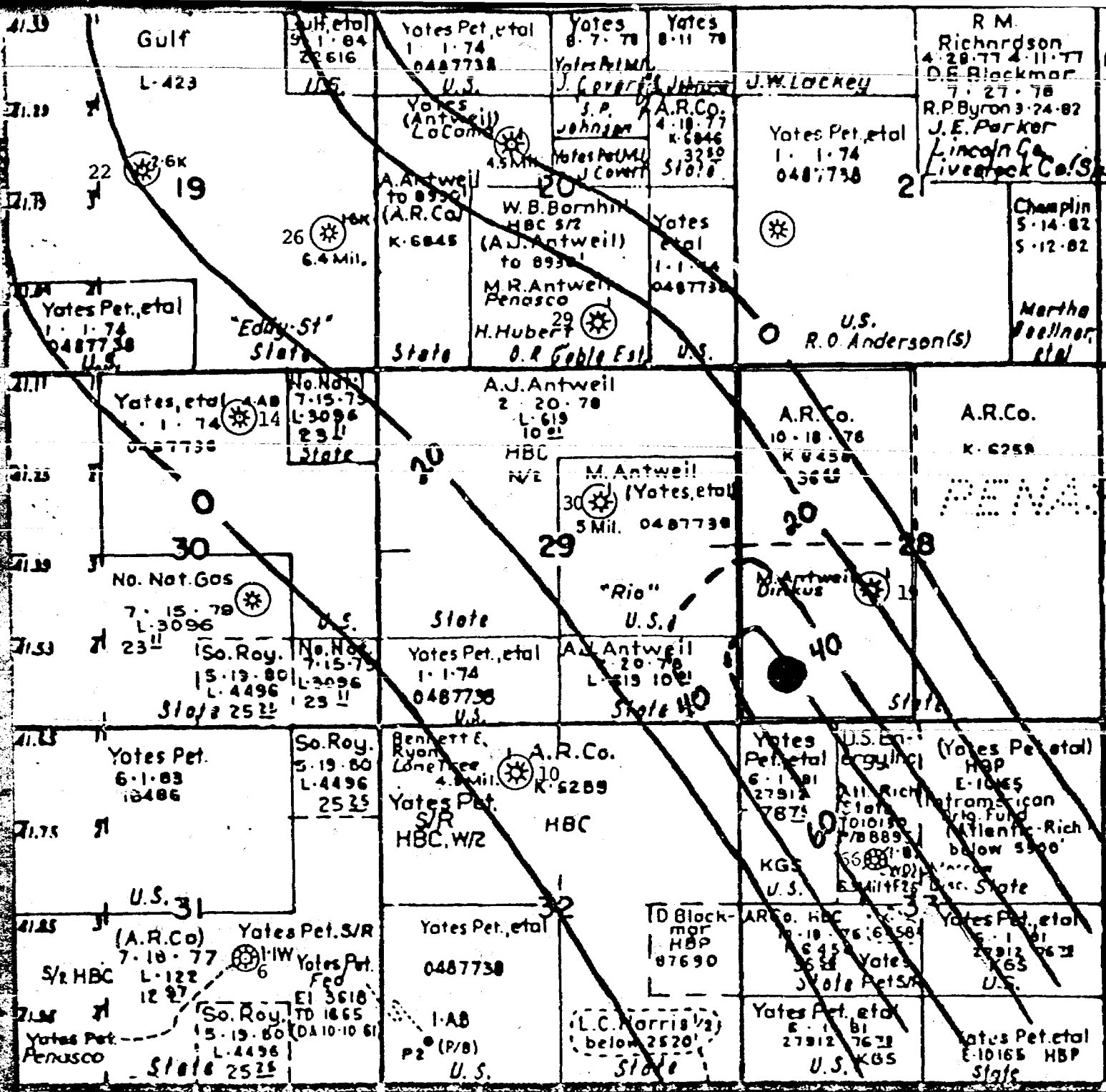



Isolith Contour

Gross Feet of Clean Morrow Sand
(GR Below 50 API Units)



Proposed Location



Proposed Proration Unit
BEFORE EXAMINER NUTTER
OIL CONSERVATION DIVISION

App. EXHIBIT NO. 3
CASE NO. 7143

MORRIS R. ANTWEIL
Hobbs, New Mexico

PENASCO DRAW MORROW

Isolith Map

Eddy County, New Mexico

C.I.=20' Scale 1"=2000'

Scale 1"=2000'

Dockets Nos. 5-81 and 6-81 are tentatively set for February 11 and 25, 1981. Applications for hearing must be filed at least 22 days in advance of hearing date.

DOCKET: EXAMINER HEARING - WEDNESDAY - JANUARY 28, 1981

9 A.M. - OIL CONSERVATION DIVISION CONFERENCE ROOM,
STATE LAND OFFICE BUILDING, SANTA FE, NEW MEXICO

The following cases will be heard before Daniel S. Nutter, Examiner, or Richard L. Stamets, Alternate Examiner:

- CASE 7135: Application of Celeste C. Cryenberg for a unit agreement, Eddy County, New Mexico. Applicant, in the above-styled cause, seeks approval for the Cottonwood Draw Unit Area, comprising 2555 acres, more or less, of State lands in Township 16 South, Range 24 East.
- CASE 7119: (Continued from January 14, 1981, Examiner Hearing)
Application of Shell Oil Company for a unit agreement, Bernalillo and Sandoval Counties, New Mexico. Applicant, in the above-styled cause, seeks approval for the West Mesa Unit Area, comprising 26,722 acres, more or less, of State, Federal, and fee lands in Townships 10, 11, and 12 North, Ranges 1 and 2 East.
- CASE 7136: Application of Hanson Oil Corporation for amendment of R-111-A, Eddy County, New Mexico. Applicant, in the above-styled cause, seeks the elimination of the NE/4 of Section 26, Township 18 South, Range 30 East, from the Potash-Oil Area as defined by Order No. R-111-A as amended. In the alternative, applicant seeks an exception to the casing and cementing rules of R-111-A for its wells to be drilled within the NE/4 of said Section 26.
- CASE 7137: Application of Caulkins Oil Company for downhole commingling, Rio Arriba County, New Mexico. Applicant, in the above-styled cause, seeks approval for the downhole commingling of Chacra and Blanco Mesaverde production in the wellbores of its wells located in: Sections 1 thru 5, and 7, 8, 21, 22, 24, and 25 in Township 26 North, Range 6 West; Sections 13, 14, 23, 24, and 26 in Township 26 North, Range 7 West; and Sections 33 thru 35 in Township 27 North, Range 6 West.
- CASE 7138: Application of Wiser Oil Company for a special gas-oil ratio limitation, Lea County, New Mexico. Applicant, in the above-styled cause, seeks a special gas-oil ratio limitation of 6000 to one, retroactive to May 1, 1980, for the Hardy-Drinkard Pool.
- CASE 7051: (Continued from December 30, 1980, Examiner Hearing)
Application of Petro Lewis Corporation for downhole commingling, Lea County, New Mexico. Applicant, in the above-styled cause, seeks approval for the downhole commingling of Blinberry and Drinkard production in the wellbore of its L. G. Warlick "B" Well No. 2 located in Unit G of Section 19, Township 21 South, Range 37 East.
- CASE 7139: Application of Yates Petroleum Corporation for amendment of Division Order No. R-6367, Chaves County, New Mexico. Applicant, in the above-styled cause, seeks the amendment of Order No. R-6367 to designate Yates Petroleum Corporation as the operator of the two proration units pooled by said order, replacing McClellan Oil Corporation as operator.
- CASE 7140: Application of Yates Petroleum Corporation for compulsory pooling and an unorthodox location, Eddy County, New Mexico. Applicant, in the above-styled cause, seeks an order pooling all mineral interests in the Morrow formation underlying the N/2 of Section 26, Township 21 South, Range 26 East, to be dedicated to a well to be drilled at an unorthodox location 660 feet from the North line and 1650 feet from the East line of said Section 26. Also to be considered will be the cost of drilling and completing said well and the allocation of the cost thereof as well as actual operating costs and charges for supervision, designation of applicant as operator of the well, and a charge for risk involved in drilling said well.
- CASE 7100: (Continued from January 14, 1981, Examiner Hearing)
Application of Harvey E. Yates Company for downhole commingling, Eddy County, New Mexico. Applicant, in the above-styled cause, seeks approval for the downhole commingling of Atoka and Morrow production in the wellbore of its Travis 24 State Com Well No. 1 in Unit H of Section 24, Township 18 South, Range 28 East.
- CASE 7141: Application of P & O Oil Field Service for an oil treating plant permit, Lea County, New Mexico. Applicant, in the above-styled cause, seeks authority for the construction and operation of an oil treating plant for the purpose of treating and reclaiming sediment oil at a site in the SW/4 NW/4 of Section 25, Township 25 South, Range 36 East.

CASE 7142: Application of Getty Oil Company for downhole commingling, Rio Arriba County, New Mexico. Applicant, in the above-styled cause, seeks approval for the downhole commingling of Otero-Gallup and Basin-Dakota production in the wellbores of its Farming "E" Wells No. 1 in Unit I and No. 3 in Unit E of Section 2, Township 24 North, Range 6 West.

CASE 7143: Application of Morris R. Antweil for an unorthodox gas well location, Eddy County, New Mexico. Applicant, in the above-styled cause, seeks approval for the unorthodox location of a Morrow test well to be drilled 660 feet from the South and West lines of Section 28, Township 18 South, Range 25 East, the W/2 of said Section 28 to be dedicated to the well.

CASE 7144: Application of Morris R. Antweil for compulsory pooling, Lea County, New Mexico. Applicant, in the above-styled cause, seeks an order pooling all mineral interests in the San Andres formation underlying the NW/4 SE/4 and in the Wolfcamp thru Mississippian formations underlying the S/2 of Section 10, Township 13 South, Range 38 East, to be dedicated to an existing well located in the NW/4 SE/4 of said Section 10. Also to be considered will be the cost of drilling and completing said well and the allocation of the cost thereof as well as actual operating costs and charges for supervision, designation of applicant as operator of the well, and a charge for risk involved in drilling said well.

CASE 7129: (Continued from January 14, 1981, Examiner Hearing)

Application of Koch Exploration Company for compulsory pooling, San Juan County, New Mexico. Applicant, in the above-styled cause, seeks an order pooling all mineral interests in the Dakota formation underlying the NW/4 SE/4 of Section 28, Township 28 North, Range 8 West, to be dedicated to a well to be drilled at a standard location thereon. Also to be considered will be the cost of drilling and completing said well and the allocation of the cost thereof as well as actual operating costs and charges for supervision, designation of applicant as operator of the well, and a charge for risk involved in drilling said well.

CASE 6940: (Continued from January 14, 1981, Examiner Hearing)

Application of Adobe Oil Company for compulsory pooling, Lea County, New Mexico. Applicant, in the above-styled cause, seeks an order pooling all mineral interests down through the Wolfcamp formation underlying the NW/4 SE/4 for oil and the SE/4 for gas, Section 23, Township 20 South, Range 38 East, to be dedicated to a well to be drilled at a standard location thereon. Also to be considered will be the cost of drilling and completing said well and the allocation of the cost thereof as well as actual operating costs and charges for supervision, designation of applicant as operator of the well, and a charge for risk involved in drilling said well.

CASE 7145: In the matter of the hearing called by the Oil Conservation Division on its own motion for an order creating, contracting vertical limits, and extending horizontal limits of certain pools in Chaves, Eddy, Lea, and Roosevelt Counties, New Mexico:

(a) CREATE a new pool in Lea County, New Mexico, classified as a gas pool for Morrow production and designated as the North Berry-Morrow Gas Pool. The discovery well is Getty Oil Company Getty 6 State Com Well No. 1 located in Unit K of Section 6, Township 21 South, Range 34 East, NMPM. Said pool would comprise:

TOWNSHIP 21 SOUTH, RANGE 34 EAST, NMPM
Section 6: Lots 9, 10, 11, 12, 13,
14, 15, and 16

(b) CREATE a new pool in Lea County, New Mexico, classified as a gas pool for Santa Rosa production and designated as the Cooper-Santa Rosa Gas Pool. The discovery well is O. H. Berry J. L. Isbell Well No. 5Y located in Unit A of Section 15, Township 24 South, Range 36 East, NMPM. Said pool would comprise:

TOWNSHIP 24 SOUTH, RANGE 36 EAST, NMPM
Section 15: NE/4

(c) CREATE a new pool in Lea County, New Mexico, classified as an oil pool for Bone Springs production and designated as the South Corbin-Bone Springs Pool. The discovery well is Southland Royalty Company Federal 21 Com Well No. 1 located in Unit L of Section 21, Township 18 South, Range 33 East, NMPM. Said pool would comprise:

TOWNSHIP 18 SOUTH, RANGE 33 EAST, NMPM
Section 21: SW/4

(d) CREATE a new pool in Lea County, New Mexico, classified as a gas pool for Morrow production and designated as the West Lynch-Morrow Gas Pool. The discovery well is The Superior Oil Company West Lynch Deep Unit Well No. 1 located in Unit O of Section 28, Township 20 South, Range 34 East, NMPM. Said pool would comprise:

TOWNSHIP 20 SOUTH, RANGE 34 EAST, NMPM
Section 28: S/2

(e) CREATE a new pool in Lea County, New Mexico, classified as an oil pool for Blinbry production and designated as the West Nadica-Blinbry Pool. The discovery well is Tamarack Petroleum Company, Inc. Speight Well No. 1 located in Unit D of Section 9, Township 20 South, Range 38 East, NMPM. Said pool would comprise:

TOWNSHIP 20 SOUTH, RANGE 38 EAST, NMPM
Section 9: NW/4

(f) CREATE a new pool in Lea County, New Mexico, classified as a gas pool for Atoka-Morrow production and designated as the Nonombre Atoka-Morrow Gas Pool. The discovery well is Amoco Production Company State FO Well No. 3 located in Unit F of Section 32, Township 13 South, Range 34 East, NMPM. Said pool would comprise:

TOWNSHIP 13 SOUTH, RANGE 34 EAST, NMPM
Section 32: W/2

(g) CREATE a new pool in Eddy County, New Mexico, classified as a gas pool for Atoka production and designated as the Southwest Quahada Ridge-Atoka Gas Pool. The discovery well is Perry F. Bass Big Eddy Unit Well No. 71 located in Unit F of Section 7, Township 22 South, Range 29 East, NMPM. Said pool would comprise:

TOWNSHIP 22 SOUTH, RANGE 29 EAST, NMPM
Section 7: N/2

(h) CREATE a new pool in Lea County, New Mexico, classified as a gas pool for Abo production and designated as the Skaggs-Abo Gas Pool. The discovery well is Conoco, Inc. Britt B Well No. 27 located in Unit G of Section 15, Township 20 South, Range 37 East, NMPM. Said pool would comprise:

TOWNSHIP 20 SOUTH, RANGE 37 EAST, NMPM
Section 15: NE/4

(i) CREATE a new pool in Roosevelt County, New Mexico, classified as an oil pool for Granite Wash production and designated as the Tanneyhill-Granite Wash Pool. The discovery well is Energy Reserves Group, Inc. Bledsoe Well No. 1 located in Unit H of Section 11, Township 6 South, Range 33 East, NMPM. Said pool would comprise:

TOWNSHIP 6 SOUTH, RANGE 33 EAST, NMPM
Section 11: NE/4

(j) CONTRACT the vertical limits of the Nonombre-Pennsylvanian Pool in Lea County, New Mexico, to the Cisco, Canyon, and Strawn formations only and redesignate said Nonombre-Pennsylvanian Pool to Nonombre-Upper Pennsylvanian Pool. (All wells in said pool are producing from the Upper Penn formation and a gas well has been completed in the Atoka-Morrow formations for which a new Atoka-Morrow gas pool is being created.)

(k) EXTEND the Antelope Ridge-Atoka Gas Pool in Lea County, New Mexico, to include therein:

TOWNSHIP 23 SOUTH, RANGE 34 EAST, NMPM
Section 14: W/2

(l) EXTEND the Antelope Ridge-Morrow Gas Pool in Lea County, New Mexico, to include therein:

TOWNSHIP 23 SOUTH, RANGE 34 EAST, NMPM
Section 14: All

- (m) EXTEND the Atoka-Pennsylvanian Gas Pool in Eddy County, New Mexico, to include therein:

TOWNSHIP 18 SOUTH, RANGE 26 EAST, NMPM
Section 9: All
Section 10: W/2

- (n) EXTEND the Atoka-Yeso Pool in Eddy County, New Mexico, to include therein:

TOWNSHIP 18 SOUTH, RANGE 26 EAST, NMPM
Section 26: SW/4 SW/4
Section 27: S/2 S/2

- (o) EXTEND the Avalon-Delaware Pool in Eddy County, New Mexico, to include therein:

TOWNSHIP 20 SOUTH, RANGE 27 EAST, NMPM
Section 36: N/2 SE/4

- (p) EXTEND the Boyd-Morrow Gas Pool in Eddy County, New Mexico, to include therein:

TOWNSHIP 18 SOUTH, RANGE 25 EAST, NMPM
Section 35: W/2

- (q) EXTEND the East Burton Flat-Atoka Gas Pool in Eddy County, New Mexico, to include therein:

TOWNSHIP 20 SOUTH, RANGE 29 EAST, NMPM
Section 8: N/2
Section 9: W/2

- (r) EXTEND the Burton Flat-Morrow Gas Pool in Eddy County, New Mexico, to include therein:

TOWNSHIP 20 SOUTH, RANGE 27 EAST, NMPM
Section 25: E/2

TOWNSHIP 21 SOUTH, RANGE 26 EAST, NMPM
Section 1: Lots 9, 10, 11, 12, 13,
14, 15, and 16

- (s) EXTEND the Burton Flat-Strawn Gas Pool in Eddy County, New Mexico, to include therein:

TOWNSHIP 21 SOUTH, RANGE 27 EAST, NMPM
Section 9: S/2

- (t) EXTEND the Comanche Stateline Tansill-Yates-Seven Rivers Pool in Lea County, New Mexico, to include therein:

TOWNSHIP 26 SOUTH, RANGE 36 EAST, NMPM
Section 21: E/2

- (u) EXTEND the Crooked Creek-Morrow Gas Pool in Eddy County, New Mexico, to include therein:

TOWNSHIP 24 SOUTH, RANGE 24 EAST, NMPM
Section 10: S/2

- (v) EXTEND the South Culebra Bluff-Atoka Gas Pool in Eddy County, New Mexico, to include therein:

TOWNSHIP 23 SOUTH, RANGE 28 EAST, NMPM
Section 13: W/2

- (w) EXTEND the Dollarhide Tubb-Drinkard Pool in Lea County, New Mexico, to include therein:

TOWNSHIP 24 SOUTH, RANGE 38 EAST, NMPM
Section 18: SW/4

- (x) EXTEND the South Empire-Morrow Gas Pool in Eddy County, New Mexico, to include therein:

TOWNSHIP 17 SOUTH, RANGE 28 EAST, NMPM
Section 24: S/2

TOWNSHIP 18 SOUTH, RANGE 28 EAST, NMPM
Section 14: E/2

- (y) EXTEND the Esperanza-Delaware Pool in Eddy County, New Mexico, to include therein:

TOWNSHIP 22 SOUTH, RANGE 27 EAST, NMPM
Section 10: S/2 NE/4

- (z) EXTEND the Eunice Monument Grayburg-San Andres Pool in Lea County, New Mexico, to include therein:

TOWNSHIP 20 SOUTH, RANGE 36 EAST, NMPM
Section 27: SW/4

- (aa) EXTEND the East Grama Ridge-Lower Bone Springs Pool in Lea County, New Mexico, to include therein:

TOWNSHIP 22 SOUTH, RANGE 34 EAST, NMPM
Section 2: NW/4
Section 3: NE/4

- (bb) EXTEND the East Grama Ridge-Morrow Gas Pool in Lea County, New Mexico, to include therein:

TOWNSHIP 22 SOUTH, RANGE 34 EAST, NMPM
Section 1: E/2

TOWNSHIP 22 SOUTH, RANGE 35 EAST, NMPM
Section 6: All

- (cc) EXTEND the Hat Mesa-Morrow Gas Pool in Lea County, New Mexico, to include therein:

TOWNSHIP 21 SOUTH, RANGE 32 EAST, NMPM
Section 13: N/2

- (dd) EXTEND the Hoag Tank-Morrow Gas Pool in Eddy County, New Mexico, to include therein:

TOWNSHIP 19 SOUTH, RANGE 24 EAST, NMPM
Section 27: All

- (ee) EXTEND the Northeast Lovington-Pennsylvanian Pool in Lea County, New Mexico, to include therein:

TOWNSHIP 16 SOUTH, RANGE 36 EAST, NMPM
Section 13: SE/4
Section 24: NE/4

- (ff) EXTEND the North Lusk-Morrow Gas Pool in Lea County, New Mexico, to include therein:

TOWNSHIP 19 SOUTH, RANGE 32 EAST, NMPM
Section 5: E/2

- (gg) EXTEND the Malaga-Atoka Gas Pool in Eddy County, New Mexico, to include therein:

TOWNSHIP 24 SOUTH, RANGE 28 EAST, NMPM
Section 3: W/2

- (hh) EXTEND the West Malaga-Atoka Gas Pool in Eddy County, New Mexico, to include therein:

TOWNSHIP 24 SOUTH, RANGE 28 EAST, NMPM
Section 9: N/2

- (ii) EXTEND the Maljamar Grayburg-San Andres Pool in Lea County, New Mexico, to include therein:

TOWNSHIP 17 SOUTH, RANGE 33 EAST, NMPM
Section 24: NE/4

- (jj) EXTEND the Maljamar-Morrow Gas Pool in Lea County, New Mexico, to include therein:

TOWNSHIP 16 SOUTH, RANGE 33 EAST, NMPM
Section 28: W/2

- (kk) EXTEND the East Millman Queen-Grayburg Pool in Eddy County, New Mexico, to include therein:

TOWNSHIP 19 SOUTH, RANGE 28 EAST, NMPM
Section 24: NW/4 NE/4

- (ll) EXTEND the Nadine Drinkard-Abo Pool in Lea County, New Mexico, to include therein:

TOWNSHIP 19 SOUTH, RANGE 38 EAST, NMPM
Section 27: NE/4

- (mm) EXTEND the North Osudo-Morrow Gas Pool in Lea County, New Mexico, to include therein:

TOWNSHIP 19 SOUTH, RANGE 36 EAST, NMPM
Section 31: E/2
Section 32: All

TOWNSHIP 20 SOUTH, RANGE 36 EAST, NMPM
Section 16: All

- (nn) EXTEND the Penasco Draw San Andres-Yeso Associated Pool in Eddy County, New Mexico, to include therein:

TOWNSHIP 18 SOUTH, RANGE 25 EAST, NMPM
Section 24: N/2 SE/4

- (oo) EXTEND the South Peterson-Pennsylvanian Pool in Roosevelt County, New Mexico, to include therein:

TOWNSHIP 6 SOUTH, RANGE 33 EAST, NMPM
Section 2: Lots 1 and 2

- (pp) EXTEND the North Quail Ridge-Morrow Gas Pool in Lea County, New Mexico, to include therein:

TOWNSHIP 19 SOUTH, RANGE 33 EAST, NMPM
Section 1: E/2

- (q) EXTEND the Runyan Ranch-Abo Gas Pool in Eddy County, New Mexico, to include therein:

TOWNSHIP 19 SOUTH, RANGE 33 EAST, NMPM
Section 8: S/2
Section 9: SE/4

- (rr) EXTEND the Sioux Tansill-Yates-Seven Rivers Pool in Lea County, New Mexico, to include therein:

TOWNSHIP 26 SOUTH, RANGE 35 EAST, NMPM
Section 17: E/2

- (ss) EXTEND the Skaggs-Drinkard Pool in Lea County, New Mexico, to include therein:

TOWNSHIP 20 SOUTH, RANGE 38 EAST, NMPM
Section 9: W/2
Section 16: NW/4
Section 17: N/2

- (tt) EXTEND the Teas-Pennsylvanian Gas Pool in Lea County, New Mexico, to include therein:

TOWNSHIP 20 SOUTH, RANGE 33 EAST, NMPM
Section 11: N/2

- (uu) EXTEND the Tomahawk-San Andres Pool in Chaves County, New Mexico, to include therein:

TOWNSHIP 7 SOUTH, RANGE 31 EAST, NMPM
Section 25: SW/4

- (vv) EXTEND the Travis-Upper Pennsylvanian Gas Pool in Eddy County, New Mexico, to include therein:

TOWNSHIP 18 SOUTH, RANGE 28 EAST, NMPM
Section 14: SE/4

- (ww) EXTEND the Turkey Track-Atoka Gas Pool in Eddy County, New Mexico, to include therein:

TOWNSHIP 19 SOUTH, RANGE 29 EAST, NMPM
Section 10: W/2

(xx) EXTEND the Turkey Track-Morrow Gas Pool in Eddy County, New Mexico, to include therein:

TOWNSHIP 19 SOUTH, RANGE 29 EAST, NMPH
Section 10: All.

(yy) EXTEND the North Turkey Track-Morrow Gas Pool in Eddy County, New Mexico, to include therein:

TOWNSHIP 18 SOUTH, RANGE 29 EAST, NMPH
Section 20: E/2
Section 33: S/2
Section 34: S/2

(zz) EXTEND the Turkey Track Seven Rivers-Queen-Deerburg Pool in Eddy County, New Mexico, to include therein:

TOWNSHIP 18 SOUTH, RANGE 29 EAST, NMPH
Section 27: E/2 NW/4

CAMPBELL AND BLACK, P.A.

LAWYERS

JACK M. CAMPBELL
BRUCE D. BLACK
MICHAEL B. CAMPBELL
WILLIAM F. CARR

POST OFFICE BOX 2208
JEFFERSON PLACE
SANTA FE, NEW MEXICO 87501
TELEPHONE (505) 988-4421

January 13, 1981

JAN 14 1981

OIL CONSERVATION DIVISION
SANTA FE

Mr. Joe D. Ramey
Division Director
Oil Conservation Division
New Mexico Department of
Energy and Minerals
Post Office Box 2088
Santa Fe, New Mexico 87501

Case 7143

Re: Application of Morris R. Antweil for
an Unorthodox Gas Well Location, Eddy
County, New Mexico

Dear Mr. Ramey:

Enclosed in triplicate is the application of Morris R.
Antweil in the above-referenced matter.

The applicant requests that this matter be included on
the docket for the examiner hearing scheduled to be held
on January 28, 1981.

Very truly yours,

William F. Carr

WFC:lr

Enclosures

cc: Mr. Rob Williams

BEFORE THE
OIL CONSERVATION DIVISION
NEW MEXICO DEPARTMENT OF ENERGY AND MINERALS

JAN 1 1931
OIL CONSERVATION DIVISION

IN THE MATTER OF THE APPLICATION
OF MORRIS R. ANTWEIL FOR AN
UNORTHODOX GAS WELL LOCATION,
EDDY COUNTY, NEW MEXICO.

Case 7143

APPLICATION

Comes now MORRIS R. ANTWEIL, by his undersigned attorneys,
and hereby makes application to the Oil Conservation Division
for an unorthodox gas well location and in support thereof
respectfully states:

1. Applicant is the operator of the W/2 of Section 28,
Township 18 South, Range 25 East, N.M.P.M., Eddy County,
New Mexico.
2. Applicant proposes to drill a well at a point 660
feet from the South and West lines of said Section 28 to
test the Morrow formation at a depth of approximately
9000 feet.
3. Applicant seeks an exception to the well location
requirements of Oil Conservation Division Rule 104 B,
I, (a).
4. That a standard 320 acre proration unit comprising
the W/2 of said Section 28 should be dedicated to such
well.
5. That approval of this application will afford appli-
cant the opportunity to produce its just and equitable

share of gas in the Morrow formation and will protect correlative rights.

WHEREFORE, Morris R. Antweil requests that this application be set for hearing before a duly appointed examiner of the Oil Conservation Division on January 28, 1980, that notice be given as required by law and the rules of the Division, that the Division enter its order granting the applicant an exception to the provisions of Rule 104 B, I, (a) and dedicating the W/2 of said Section 28 to this well.

Respectfully submitted,

CAMPBELL, BYRD AND BLACK, P.A.

By

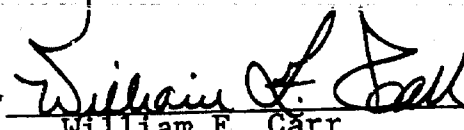

William F. Carr

Post Office Box 2208

Santa Fe, New Mexico 87501

Attorneys for Applicant

BEFORE THE
OIL CONSERVATION DIVISION
NEW MEXICO DEPARTMENT OF ENERGY AND MINERALS

JAN 15 1981
OIL CONSERVATION DIVISION
NEW MEXICO

IN THE MATTER OF THE APPLICATION
OF MORRIS R. ANTWEIL FOR AN
UNORTHODOX GAS WELL LOCATION,
EDDY COUNTY, NEW MEXICO.

Case 7143

APPLICATION

Comes now MORRIS R. ANTWEIL, by his undersigned attorneys,
and hereby makes application to the Oil Conservation Division
for an unorthodox gas well location and in support thereof
respectfully states:

1. Applicant is the operator of the W/2 of Section 28,
Township 18 South, Range 25 East, N.M.P.M., Eddy County,
New Mexico.
2. Applicant proposes to drill a well at a point 660
feet from the South and West lines of said Section 28 to
test the Morrow formation at a depth of approximately
9000 feet.
3. Applicant seeks an exception to the well location
requirements of Oil Conservation Division Rule 104 B,
I, (a).
4. That a standard 320 acre proration unit comprising
the W/2 of said Section 28 should be dedicated to such
well.
5. That approval of this application will afford appli-
cant the opportunity to produce its just and equitable

share of gas in the Morrow formation and will protect correlative rights.

WHEREFORE, Morris R. Antweil requests that this application be set for hearing before a duly appointed examiner of the Oil Conservation Division on January 28, 1980, that notice be given as required by law and the rules of the Division, that the Division enter its order granting the applicant an exception to the provisions of Rule 104 B, I, (a) and dedicating the W/2 of said Section 28 to this well.

Respectfully submitted,

CAMPBELL, BYRD AND BLACK, P.A.

By

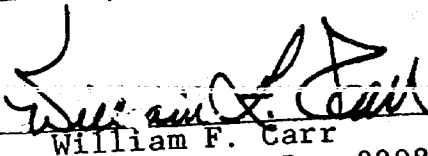
William F. Carr
Post Office Box 2208
Santa Fe, New Mexico 87501
Attorneys for Applicant

BEFORE THE

JAN 14 1981

OIL CONSERVATION DIVISION
SANTA FE

NEW MEXICO DEPARTMENT OF ENERGY AND MINERALS

IN THE MATTER OF THE APPLICATION
OF MORRIS R. ANTWEIL FOR AN
UNORTHODOX GAS WELL LOCATION,
EDDY COUNTY, NEW MEXICO.

Case 7143

APPLICATION

Comes now MORRIS R. ANTWEIL, by his undersigned attorneys,
and hereby makes application to the Oil Conservation Division
for an unorthodox gas well location and in support thereof
respectfully states:

1. Applicant is the operator of the W/2 of Section 28,
Township 18 South, Range 25 East, N.M.P.M., Eddy County,
New Mexico.
2. Applicant proposes to drill a well at a point 660
feet from the South and West lines of said Section 28 to
test the Morrow formation at a depth of approximately
9000 feet.
3. Applicant seeks an exception to the well location
requirements of Oil Conservation Division Rule 104 B,
I, (a).
4. That a standard 320 acre proration unit comprising
the W/2 of said Section 28 should be dedicated to such
well.
5. That approval of this application will afford appli-
cant the opportunity to produce its just and equitable

share of gas in the Morrow formation and will protect correlative rights.

WHEREFORE, Morris R. Antweil requests that this application be set for hearing before a duly appointed examiner of the Oil Conservation Division on January 28, 1980, that notice be given as required by law and the rules of the Division, that the Division enter its order granting the applicant an exception to the provisions of Rule 104 B, I, (a) and dedicating the W/2 of said Section 28 to this well.

Respectfully submitted,

CAMPBELL, BYRD AND BLACK, P.A.

By

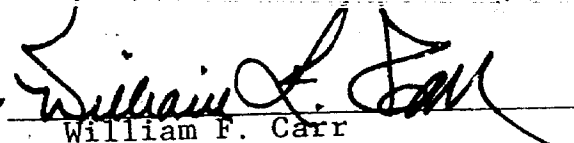
William F. Carr
Post Office Box 2208
Santa Fe, New Mexico 87501
Attorneys for Applicant

DRAFT

dr/

STATE OF NEW MEXICO
ENERGY AND MINERALS DEPARTMENT
OIL CONSERVATION DIVISION

IN THE MATTER OF THE HEARING
CALLED BY THE OIL CONSERVATION
DIVISION FOR THE PURPOSE OF
CONSIDERING:

CASE NO. 7143

ORDER NO. R- 6592

APPLICATION OF MORRIS R. ANTWEIL

FOR AN UNORTHODOX GAS WELL LOCATION,

EDDY COUNTY, NEW MEXICO.

ORDER OF THE DIVISION

BY THE DIVISION:

This cause came on for hearing at 9 a.m. on January 28,
19 81, at Santa Fe, New Mexico, before Examiner Daniel S. Nutter.

NOW, on this day of February, 19 81, the Division
Director, having considered the testimony, the record, and the
recommendations of the Examiner, and being fully advised in the
premises,

FINDS:

(1) That due public notice having been given as required by
law, the Division has jurisdiction of this cause and the subject
matter thereof.

(2) That the applicant, Morris R. Antweil,
seeks approval of an unorthodox gas well location 660
feet from the South line and 660 feet from the
West line of Section 28, Township 18 South
Range 25 East, NMPM, to test the Morrow
formation, Penasco Draw-Morrow Gas Pool, Eddy
County, New Mexico.

(3) That the W/2 of said Section 28 is to be
dedicated to the well.

(4) That a well at said unorthodox location will better
enable applicant to produce the gas underlying the proration unit.

(5) That no offset operator objected to the proposed unorthodox
location.

-2-

Case No. _____
Order No. R- _____

(6) That approval of the subject application will afford the applicant the opportunity to produce its just and equitable share of the gas in the subject pool, will prevent the economic loss caused by the drilling of unnecessary wells, avoid the augmentation of risk arising from the drilling of an excessive number of wells, and will otherwise prevent waste and protect correlative rights.

IT IS THEREFORE ORDERED:

(1) That an unorthodox gas well location for the Morrow formation is hereby approved for a well to be located at a point 660 feet from the South line and 660 feet from the West line of Section 28, Township 18 South, Range 25 East NMPM, Panasco Draw-Morrow gas Pool, Eddy County, New Mexico.

(2) That the 1/4 of said Section 28 shall be dedicated to the above-described well.

(3) That jurisdiction of this cause is retained for the entry of such further orders as the Division may deem necessary.

DONE at Santa Fe, New Mexico, on the day and year hereinabove designated.