

2RP-3871
REMEDIATION REPORT
Nash Draw Tank Battery #36
Eddy County, New Mexico

LAI Project No. 16-0108-06

March 24, 2017

Prepared for:

XTO Energy, Inc.
500 W. Illinois Ave., Suite 100
Midland, Texas 79707

Prepared by:

Larson & Associates, Inc.
507 North Marienfeld Street, Suite 205
Midland, Texas 79701



Mark J. Larson, P.G.

Certified Professional Geologist #10490

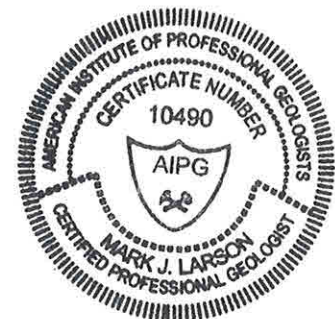

This Page Intentionally Left Blank

Table of Contents

1.0	INTRODUCTION	1
1.1	Background.....	1
1.2	Physical Setting.....	1
1.3	Recommended Remediation Action Levels.....	2
2.0	REMEDICATION	2
3.0	CONCLUSIONS	2

Tables

Table 1	Assessment Soil Sample Analytical Data Summary
Table 2	Confirmation Soil Sample Analytical Data Summary

Figures

Figure 1	Topographic Map
Figure 2	Aerial Map
Figure 3	Site Map Showing Excavations and Depths

Appendices

Appendix A	OCD Approval
Appendix B	Laboratory Reports
Appendix C	Photographs
Appendix D	Waste Manifests
Appendix E	Initial and Final C-141

1.0 INTRODUCTION

Larson & Associates, Inc. (LAI) has prepared this report on behalf of XTO Energy, Inc. (XTO) for submittal to the New Mexico Oil Conservation Division (OCD) District 2, in Artesia, New Mexico and U.S. Bureau of Land Management (BLM) in Carlsbad, New Mexico, to document soil remediation at the Nash Draw #36 tank battery (Site). The Site is located in Unit K (NW/4, SW/4), Section 12, Township 23 South, Range 29 East in Eddy County, New Mexico. The geodetic position is North 32° 19' 0.67452" and West 103° 56' 29.70311". Figure 1 presents a topographic map. Figure 2 presents an aerial map.

1.1 Background

On June 22, 2016, LAI personnel used a Terraprobe® direct-push rig to collect soil samples at four (4) locations (DP-06-01 through DP-06-04). Soil samples were collected between ground surface and approximately four (4) feet below ground surface (bgs). A background sample was not collected due to close proximity to the playa lake (Salt Lake). The laboratory analysis and initial C-141 were submitted to OCD which assigned remediation permit number 2RP-3871, on September 8, 2016.

On November 7, 2016, LAI, on behalf of XTO, submitted a plan OCD District 2 and BLM for approval to remediate impacts to soil based on laboratory analysis of soil samples collected on June 22, 2016. On November 10, 2016, OCD District 2 approved the remediation plan. Appendix A presents the OCD approval.

1.2 Physical Setting

The physical setting is as follows:

- Elevation is approximately 2,984 feet above mean sea level (AMSL);
- Surface drainage is to the west towards a playa lake (Salt Lake) located immediately north and east of the Site;
- The nearest surface water feature is a playa lake (Salt Lake) that is located adjacent to the west side of the Site;
- Surface geology is comprised of unconsolidated Holocene to mid- Pleistocene-age eolian and piedmont-slope deposits that are approximately 80 feet thick according to a log from a nearby well;
- The Triassic-age Chinle formation of the Dockum group underlies the unconsolidated deposits and is comprised of interbedded sand, clay, and mudstone;
- According to State of New Mexico Office of the State Engineer (NMOSE) records a fresh water well is located about 2.0 miles south in Unit J (NW/4, SE/4), Section 24, Township 23 South, Range 29 East with groundwater reported at about 54 feet bgs.

1.3 Recommended Remediation Action Levels

Recommended remediation action levels (RRAL) were calculated for benzene, BTEX and TPH based on the following criteria established by the OCD in "Guidelines for Remediation of Leaks, Spills and Releases, August 13, 1993":

2RP-3871
Remediation Report
Nash Draw Tank Battery #36
March 24, 2017

Criteria	Result	Score
Depth-to-Groundwater	50 - 99 feet	10
Wellhead Protection Area	No	0
Distance to Surface Water Body	<200 Horizontal Feet	20

The following RRAL apply to the release for ranking score: 30

- Benzene 10 mg/Kg
- BTEX 50 mg/Kg
- TPH 100 mg/Kg

2.0 REMEDIATION

Soil remediation was performed between December 1 and 8, 2016, according to the plan approved by OCD District 2 on November 10, 2016. SDR, under supervision from LAI, excavated soil from the area of DP-06-01 measuring about 15 x 20 feet to about 1 foot bgs. The excavation was filled with caliche.

SDR excavated soil from the area of DP-06-03 measuring about 20 x 45 feet to about 6 feet bgs. Soil samples were collected from the excavation sidewalls and analyzed by Permian Basin Environmental Lab (PBEL) for benzene, toluene, ethylbenzene and xylenes (BTEX) by EPA SW-846 Method 8020B and TPH by EPA SW-846 Method 8015 including GRO (C6 – C12), DRO (>C12 – C28) and ORO (>C28 – C35). BTEX and TPH were below the method reporting limit (RL) in the sidewall samples from excavation DP-06-03. A 20 mil thickness polyethylene liner was placed in the bottom of the excavation at approximately 4 feet bgs. The remainder of the excavation above the liner was filled with caliche.

SDR excavated soil from the area of DP-06-04 measuring about 20 x 35 feet to about 1 foot bgs. The excavations were filled with caliche.

Approximately 493 cubic yards of contaminated soil was disposed at Lea Land Landfill, LLC. Table 2 presents the confirmation soil sample analytical data summary. Figure 3 presents the remediation areas. Appendix B presents the confirmation sample laboratory reports. Appendix C presents photographs. Appendix D presents the waste manifests. Appendix E presents the initial and final C-141.

3.0 CONCLUSIONS

Soil was remediated according to the remediation plans approved by OCD District 2. XTO requests no further action for 2RP-3871.

Tables

Table 1
2RP-3871
Investigation Soil Sample Analytical Data Summary
XTO Energy, Inc., Nash Draw Tank Battery 36
Unit K (NW/4, SW/4), Section 12, Township 23 South, Range 29 East
Eddy County, New Mexico

Location	Depth (Feet)	Collection Date	Status	C6 - C12 (mg/Kg)	>C12 - C28 (mg/Kg)	>C28 - C35 (mg/Kg)	TPH (mg/Kg)
OCD RRAL: 100							
DP-06-01	0 - 1	6/22/2016	Excavated	40.3	203	31.6	273.9
DP-06-02	0 - 1	6/22/2016	In-Situ	40.2	<30.1	<30.1	40.2
	1 - 2	6/22/2016	In-Situ	--	--	--	--
DP-06-03	0 - 1	6/22/2016	Excavated	693	2,360	367	3,420
	1 - 2	6/22/2016	Excavated	41.8	71.7	113.5	227
	2 - 3	6/22/2016	Excavated	306	883	125	1,310
	3 - 4	6/22/2016	Excavated	--	--	--	--
DP-06-04	0 - 1	6/22/2016	Excavated	171	4,300	893	5,364
	1 - 2	6/22/2016	In-Situ	<28.7	<28.7	<28.7	<28.7
	2 - 3	6/22/2016	In-Situ	<30.1	<30.1	<30.1	<30.1
	3 - 4	6/22/2016	In-Situ	--	--	--	--

Notes: laboratory analysis performed by Permian Basin Environmental Lab, Midland, Texas, by EPA SW-846 method 8015M (TPH)

Depth in feet below ground surface (bgs)

mg/Kg: milligrams per kilogram equivalent to parts per million (ppm)

RRAL: Remediation action level calculated from OCD guidance document (August 13, 1993)

P: analysis pending

Table 2
2RP-3871
Confirmation Soil Sample Analytical Data Summary
XTO Energy, Inc., Nash Draw Tank Battery 36
Unit K (NE/4, SW/4), Section 12, Township 23 South, Range 29 East
Eddy County, New Mexico

Location	Sidewall	Depth (Feet)	Collection Date	Status	Benzene (mg/Kg)	BTEX (mg/Kg)	C6 - C12 (mg/Kg)	>C12 - C28 (mg/Kg)	>C28 - C35 (mg/Kg)	TPH (mg/Kg)
OCD RRAL: 10 50 100										
DP-06-03	North	2	11/30/2016	In-Situ	<0.00116	<0.00814	<29.1	<29.1	<29.1	<29.1
	East	2	11/30/2016	In-Situ	<0.00116	<0.00814	<29.1	<29.1	<29.1	<29.1
	South	2	11/30/2016	In-Situ	<0.00118	<0.00824	<29.4	<29.4	<29.4	<29.4
	West	2	11/30/2016	In-Situ	<0.00116	<0.00814	<29.1	<29.1	<29.1	<29.1
DP-06-04	Bottom	3	12/1/2016	In-Situ	0.00210	0.00778	<29.8	<29.8	<29.8	<29.8

Notes: laboratory analysis performed by Permian Basin Environmental Lab, Midland, Texas, by EPA SW-846 Methods 8021B (BTEX) and 8015M (TPH)

Depth in feet below ground surface (bgs)

mg/Kg: milligrams per kilogram equivalent to parts per million (ppm)

RRAL: Remediation action level calculated from OCD guidance document (August 13, 1993)

P: Denotes laboratory results pending

Figures

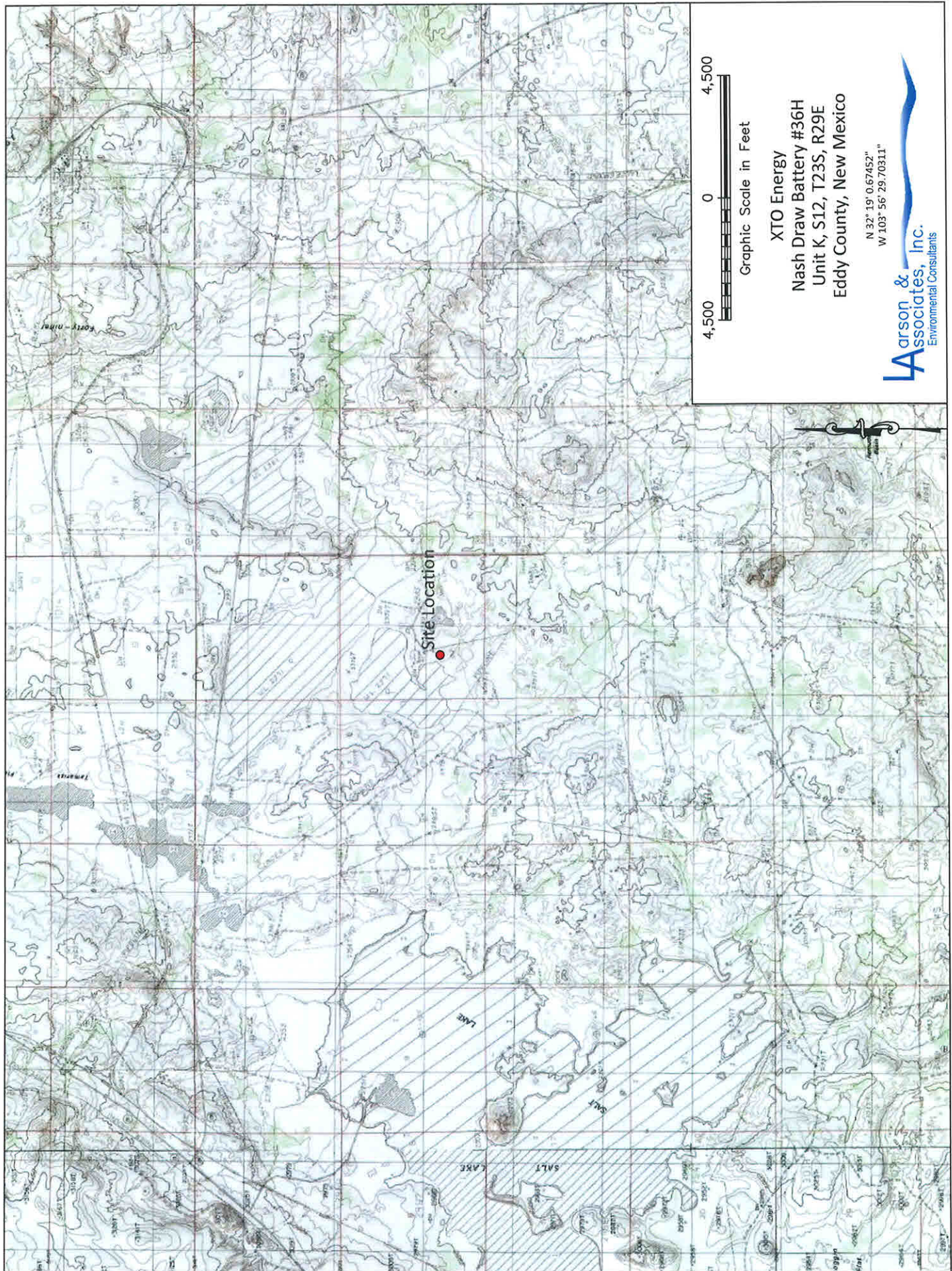

Figure 1 - Topographic Map

11" x 8.5"



Figure 2 - Aerial Map

11" x 8.5"

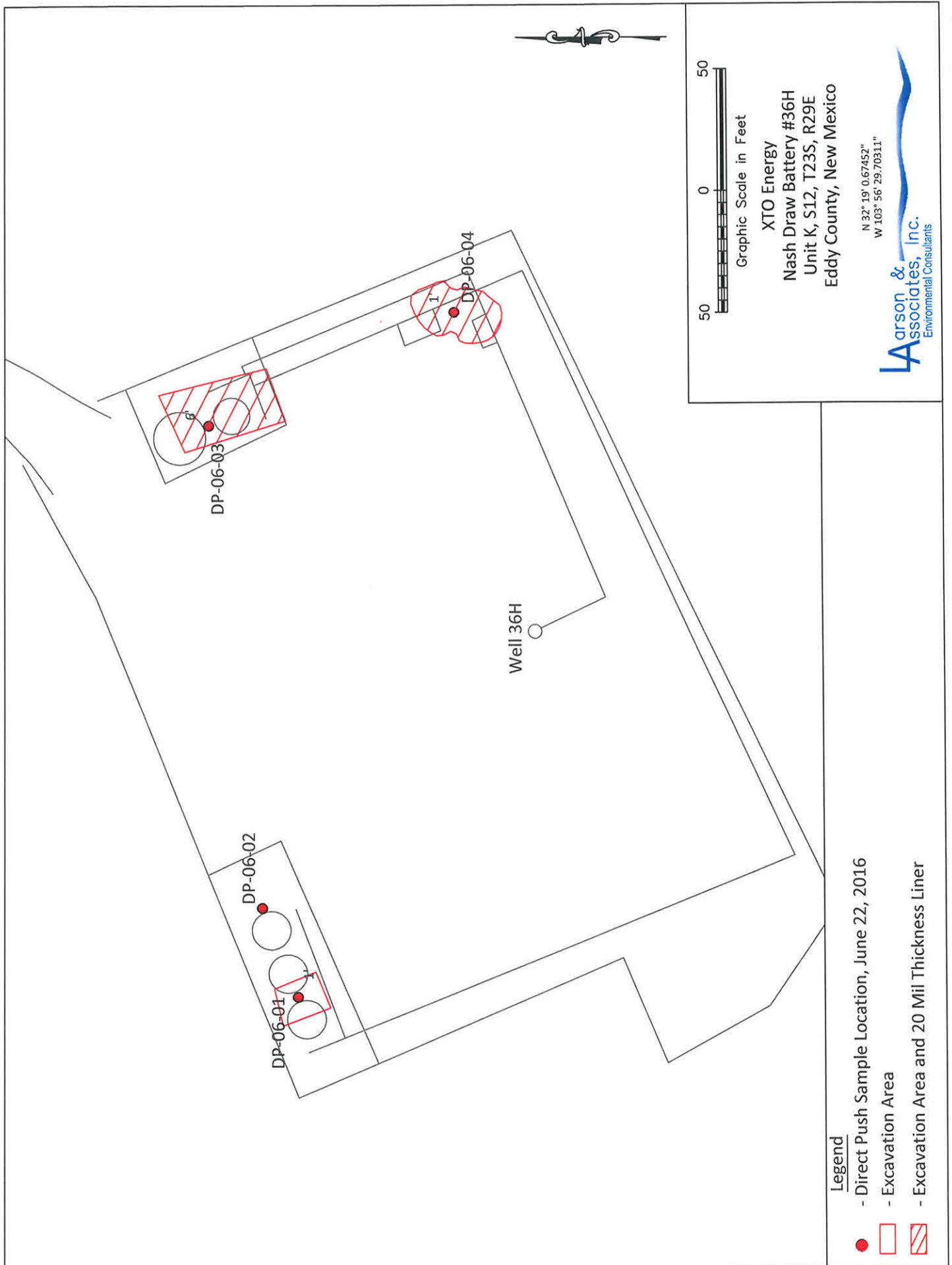

Figure 3 - Site Map Showing Excavation Area and Sample Locations

11" x 8.5"

Appendix A
Remediation Plan Approval

Appendix B
Laboratory Reports

**PERMIAN BASIN
ENVIRONMENTAL LAB, LP
1400 Rankin Hwy
Midland, TX 79701**



Analytical Report

Prepared for:

Mark Larson
Larson & Associates, Inc.
P.O. Box 50685
Midland, TX 79710

Project: Nash Draw #36
Project Number: 16-0108-06
Location: New Mexico
Lab Order Number: 6L05002



NELAP/TCEQ # T104704156-13-3

Report Date: 12/05/16

Larson & Associates, Inc.
P.O. Box 50685
Midland TX, 79710

Project: Nash Draw #36
Project Number: 16-0108-06
Project Manager: Mark Larson

Fax: (432) 687-0456

ANALYTICAL REPORT FOR SAMPLES

Sample ID	Laboratory ID	Matrix	Date Sampled	Date Received
DP-06-04 B3	6L05002-01	Soil	12/01/16 11:30	12-05-2016 09:25

Larson & Associates, Inc.
P.O. Box 50685
Midland TX, 79710

Project: Nash Draw #36
Project Number: 16-0108-06
Project Manager: Mark Larson

Fax: (432) 687-0456

DP-06-04 B3
6L05002-01 (Soil)

Analyte	Result	Reporting Limit	Units	Dilution	Batch	Prepared	Analyzed	Method	Notes
---------	--------	--------------------	-------	----------	-------	----------	----------	--------	-------

Permian Basin Environmental Lab, L.P.

Organics by GC

Benzene	0.00210	0.00119	mg/kg dry	1	P6L0502	12/05/16	12/05/16	EPA 8021B	
Toluene	ND	0.00238	mg/kg dry	1	P6L0502	12/05/16	12/05/16	EPA 8021B	
Ethylbenzene	0.00195	0.00119	mg/kg dry	1	P6L0502	12/05/16	12/05/16	EPA 8021B	
Xylene (p/m)	0.00373	0.00238	mg/kg dry	1	P6L0502	12/05/16	12/05/16	EPA 8021B	
Xylene (o)	ND	0.00119	mg/kg dry	1	P6L0502	12/05/16	12/05/16	EPA 8021B	
Surrogate: 4-Bromofluorobenzene		85.1 %		75-125	P6L0502	12/05/16	12/05/16	EPA 8021B	
Surrogate: 1,4-Difluorobenzene		85.2 %		75-125	P6L0502	12/05/16	12/05/16	EPA 8021B	

General Chemistry Parameters by EPA / Standard Methods

% Moisture	16.0	0.1	%	1	P6L0507	12/05/16	12/05/16	% calculation	
------------	------	-----	---	---	---------	----------	----------	---------------	--

Total Petroleum Hydrocarbons C6-C35 by EPA Method 8015M

C6-C12	ND	29.8	mg/kg dry	1	P6L0508	12/05/16	12/05/16	TPH 8015M	
>C12-C28	ND	29.8	mg/kg dry	1	P6L0508	12/05/16	12/05/16	TPH 8015M	
>C28-C35	ND	29.8	mg/kg dry	1	P6L0508	12/05/16	12/05/16	TPH 8015M	
Surrogate: 1-Chlorooctane		73.1 %		70-130	P6L0508	12/05/16	12/05/16	TPH 8015M	
Surrogate: o-Terphenyl		80.8 %		70-130	P6L0508	12/05/16	12/05/16	TPH 8015M	
Total Petroleum Hydrocarbon C6-C35	ND	29.8	mg/kg dry	1	[CALC]	12/05/16	12/05/16	calc	

Permian Basin Environmental Lab, L.P.

The results in this report apply to the samples analyzed in accordance with the samples received in the laboratory. This analytical report must be reproduced in its entirety, with written approval of Permian Basin Environmental Lab.

1400 Rankin HWY Midland, TX 79701 432-686-7235

Larson & Associates, Inc.	Project: Nash Draw #36	Fax: (432) 687-0456
P.O. Box 50685	Project Number: 16-0108-06	
Midland TX, 79710	Project Manager: Mark Larson	

Organics by GC - Quality Control
Permian Basin Environmental Lab, L.P.

Analyte	Result	Reporting Limit	Units	Spike Level	Source Result	%REC	%REC Limits	RPD	RPD Limit	Notes
---------	--------	-----------------	-------	-------------	---------------	------	-------------	-----	-----------	-------

Batch P6L0502 - General Preparation (GC)

Blank (P6L0502-BLK1)

Prepared & Analyzed: 12/05/16

Benzene	ND	0.00100	mg/kg wet							
Toluene	ND	0.00200	"							
Ethylbenzene	ND	0.00100	"							
Xylene (p/m)	ND	0.00200	"							
Xylene (o)	ND	0.00100	"							
Surrogate: 1,4-Difluorobenzene	0.0593		"	0.0600		98.9	75-125			
Surrogate: 4-Bromofluorobenzene	0.0600		"	0.0600		100	75-125			

LCS (P6L0502-BS1)

Prepared & Analyzed: 12/05/16

Benzene	0.0883	0.00100	mg/kg wet	0.100		88.3	70-130			
Toluene	0.0902	0.00200	"	0.100		90.2	70-130			
Ethylbenzene	0.105	0.00100	"	0.100		105	70-130			
Xylene (p/m)	0.193	0.00200	"	0.200		96.3	70-130			
Xylene (o)	0.0949	0.00100	"	0.100		94.9	70-130			
Surrogate: 1,4-Difluorobenzene	0.0619		"	0.0600		103	75-125			
Surrogate: 4-Bromofluorobenzene	0.0658		"	0.0600		110	75-125			

LCS Dup (P6L0502-BSD1)

Prepared & Analyzed: 12/05/16

Benzene	0.0857	0.00100	mg/kg wet	0.100		85.7	70-130	2.93	20	
Toluene	0.0906	0.00200	"	0.100		90.6	70-130	0.409	20	
Ethylbenzene	0.107	0.00100	"	0.100		107	70-130	1.93	20	
Xylene (p/m)	0.189	0.00200	"	0.200		94.5	70-130	1.85	20	
Xylene (o)	0.0933	0.00100	"	0.100		93.3	70-130	1.75	20	
Surrogate: 1,4-Difluorobenzene	0.0609		"	0.0600		102	75-125			
Surrogate: 4-Bromofluorobenzene	0.0635		"	0.0600		106	75-125			

Permian Basin Environmental Lab, L.P.

The results in this report apply to the samples analyzed in accordance with the samples received in the laboratory. This analytical report must be reproduced in its entirety, with written approval of Permian Basin Environmental Lab.

1400 Rankin HWY Midland, TX 79701 432-686-7235

Page 4 of 8

Larson & Associates, Inc.
P.O. Box 50685
Midland TX, 79710

Project: Nash Draw #36
Project Number: 16-0108-06
Project Manager: Mark Larson

Fax: (432) 687-0456

General Chemistry Parameters by EPA / Standard Methods - Quality Control

Permian Basin Environmental Lab, L.P.

Analyte	Result	Reporting Limit	Units	Spike Level	Source Result	%REC	%REC Limits	RPD	RPD Limit	Notes
---------	--------	--------------------	-------	----------------	------------------	------	----------------	-----	--------------	-------

Batch P6L0507 - *** DEFAULT PREP ***

Blank (P6L0507-BLK1)

Prepared & Analyzed: 12/05/16

% Moisture	ND	0.1	%
------------	----	-----	---

Duplicate (P6L0507-DUP1)

Source: 6L05002-01

Prepared & Analyzed: 12/05/16

% Moisture	16.0	0.1	%	16.0	0.00	20
------------	------	-----	---	------	------	----

Permian Basin Environmental Lab, L.P.

The results in this report apply to the samples analyzed in accordance with the samples received in the laboratory. This analytical report must be reproduced in its entirety, with written approval of Permian Basin Environmental Lab.

1400 Rankin HWY Midland, TX 79701 432-686-7235

Page 5 of 8

Larson & Associates, Inc.	Project: Nash Draw #36	Fax: (432) 687-0456
P.O. Box 50685	Project Number: 16-0108-06	
Midland TX, 79710	Project Manager: Mark Larson	

Total Petroleum Hydrocarbons C6-C35 by EPA Method 8015M - Quality Control

Permian Basin Environmental Lab, L.P.

Analyte	Result	Reporting Limit	Units	Spike Level	Source Result	%REC	%REC Limits	RPD	RPD Limit	Notes
Batch P6L0508 - TX 1005										
Blank (P6L0508-BLK1)				Prepared & Analyzed: 12/05/16						
C6-C12	ND	25.0	mg/kg wet							
>C12-C28	ND	25.0	"							
>C28-C35	ND	25.0	"							
Surrogate: 1-Chlorooctane	65.9		"	80.0		82.4	70-130			
Surrogate: o-Terphenyl	32.7		"	40.0		81.7	70-130			
LCS (P6L0508-BS1)				Prepared & Analyzed: 12/05/16						
C6-C12	1130	25.0	mg/kg wet	1000		113	75-125			
>C12-C28	1110	25.0	"	1000		111	75-125			
Surrogate: 1-Chlorooctane	68.1		"	100		68.1	70-130			S-GC
Surrogate: o-Terphenyl	41.8		"	50.0		83.6	70-130			
LCS Dup (P6L0508-BSD1)				Prepared & Analyzed: 12/05/16						
C6-C12	1020	25.0	mg/kg wet	1000		102	75-125	9.97	20	
>C12-C28	1070	25.0	"	1000		107	75-125	3.96	20	
Surrogate: 1-Chlorooctane	110		"	100		110	70-130			
Surrogate: o-Terphenyl	40.6		"	50.0		81.1	70-130			

Permian Basin Environmental Lab, L.P.

The results in this report apply to the samples analyzed in accordance with the samples received in the laboratory. This analytical report must be reproduced in its entirety, with written approval of Permian Basin Environmental Lab.

1400 Rankin HWY Midland, TX 79701 432-686-7235

Page 6 of 8

Larson & Associates, Inc.
P.O. Box 50685
Midland TX, 79710

Project: Nash Draw #36
Project Number: 16-0108-06
Project Manager: Mark Larson

Fax: (432) 687-0456

Notes and Definitions

S-GC Surrogate recovery outside of control limits. The data was accepted based on valid recovery of the remaining surrogate.

BULK Samples received in Bulk soil containers

DET Analyte DETECTED

ND Analyte NOT DETECTED at or above the reporting limit

NR Not Reported

dry Sample results reported on a dry weight basis

RPD Relative Percent Difference

LCS Laboratory Control Spike

MS Matrix Spike

Dup Duplicate

Report Approved By: _____



Date: 12/5/2016

Brent Barron, Laboratory Director/Technical Director

This material is intended only for the use of the individual (s) or entity to whom it is addressed, and may contain information that is privileged and confidential.

If you have received this material in error, please notify us immediately at 432-686-7235.

Permian Basin Environmental Lab, L.P.

The results in this report apply to the samples analyzed in accordance with the samples received in the laboratory. This analytical report must be reproduced in its entirety, with written approval of Permian Basin Environmental Lab.

1400 Rankin HWY Midland, TX 79701 432-686-7235

Page 7 of 8

Parson & Associates, Inc.

Environmental Consultants

507 N. Merientfield, Ste. 200
Midland, TX 79701
432-687-0901

DATE: 12-05-2016

PO #: 16-0108-06

PROJECT LOCATION OR NAME: Nash New Battery # 36

LAI PROJECT #: 16-0108-06

RELINQUISHED BY: (Signature) [Signature] DATE/TIME 12/05/16

RELINQUISHED BY: (Signature) DATE/TIME

RELINQUISHED BY: (Signature) DATE/TIME

RECEIVED BY: (Signature) [Signature] DATE/TIME 12-5-16 9:25

RECEIVED BY: (Signature) DATE/TIME

RECEIVED BY: (Signature) DATE/TIME

TRRP report? ☐ Yes ☒ No

TIME ZONE: Mtn / NM

Field Sample I.D. 118-06-04 b3

Lab # 12/01/16 Date 11:30 Time 5 Matrix 1

of Containers 1

HCl ✓ HNO₃ ✓ H₂SO₄ ☐ NaOH ☐ ICE ☐ UNPRESERVED ☐

S-SOIL ☐ W-WATER ☐ A-AIR ☐ P-PAINT ☐ SL-SLUDGE ☐ OT-OTHER ☐

PRESCRIPTION

ANALYSES

BTEX ☐ MTBE ☐ TPH 418.1 ☐ TPH 1005 ☐ TPH 1006 ☐

GASOLINE MOD 8015 ☐ DIESEL - MOD 8015 ☐ VOC 8260 ☐ SVOC 8270 ☐ PAH 8270 ☐ HOLDPAH ☐

8081 PESTICIDES ☐ 8082 PCBs ☐ TCLP - METALS (RCRA) ☐ TCLP - PEST ☐ HERB ☐ Semi-VOC ☐

TOTAL METALS (RCRA) ☐ LEAD - TOTAL ☐ RO ☐ TOX ☐ FLASHPOINT ☐ TDS ☐ TSS ☐ % MOISTURE ☐ CYANIDE ☐

PH ☐ HEXAVALENT CHROMIUM ☐ EXPLOSIVES ☐ PCHLORATE ☐ CHLORIDE ☐ ANIONS ☐ ALKALINITY ☐

TURN AROUND TIME

NORMAL ☐ 1 DAY ☒ 2 DAY ☐ OTHER ☐ rush

LABORATORY USE ONLY:

RECEIVING TEMP: 11 THERM #: 11

CUSTODY SEALS - ☐ BROKEN ☒ INTACT ☐ NOT USED

☒ CARRIER BILL # 11

☒ HAND DELIVERED

FIELD NOTES

CHAIN-OF-CUSTODY

PAGE 1 OF 1

Page 8 of 8

Appendix C
Photographs

Remediation Report
XTO Energy, Inc.
Nash Draw Battery #36



Location Sign



Location Viewing East Prior to Remediation, February 3, 2016

Remediation Report
XTO Energy, Inc.
Nash Draw Battery #36



Location Viewing East Prior to Remediation, February 3, 2016



Location Viewing West Prior to Remediation, February 3, 2016

Remediation Report
XTO Energy, Inc.
Nash Draw Battery #36



Expanded Excavation at DP-06-04 Viewing North, December 1, 2016



Excavation at DP-06-01 Viewing West, November 30, 2016

Remediation Report
XTO Energy, Inc.
Nash Draw Battery #36



Liner Installed in Excavation (4 feet) DP-06-04 Viewing North, December 7, 2016



Released to Imaging: 2/20/2023 8:13:41 AM Excavation (4 feet) DP-06-03 Viewing West, December 7, 2016

Remediation Report
XTO Energy, Inc.
Nash Draw Battery #36



Liner Installed in Excavation (4 feet) DP-06-03 Viewing Southeast, December 7, 2016



Backfilling Excavation at DP-06-03 Viewing Southeast, December 8, 2016

Remediation Report
XTO Energy, Inc.
Nash Draw Battery #36



Completed Remediation at DP-06-03 and DP-06-04 Viewing Southeast, December 15, 2016



Completed Remediation at DP-06-01 Viewing West, December 8, 2016

Appendix D
Waste Manifests

LEA LAND DISPOSAL SITE NEW MEXICO

MILE MARKER #64 US HWY 62/180 • 30 MILES EAST OF CARLSBAD, NM • PHONE (575) 887-4048

LEA LAND, LLC

1300 WEST MAIN STREET • OKLAHOMA CITY, OK 73106 • PHONE (405) 236-4257

NON-HAZARDOUS WASTE MANIFEST

NO

116380

1. PAGE ___ OF ___

2. TRAILER NO. **017****G**

3. COMPANY NAME

4. ADDRESS

5. PICK-UP DATE

E

PHONE NO.

CITY

STATE

ZIP

6. TNRCC I.D. NO.

N

7. NAME OR DESCRIPTION OF WASTE SHIPPED:

8. CONTAINERS

No.

Type

9. TOTAL

QUANTITY

10. UNIT

Wt/Vol.

11. TEXAS

WASTE ID #

E

a.

b.

c.

R

d.

A

12. COMMENTS OR SPECIAL INSTRUCTIONS:

13. WASTE PROFILE NO.

T

14.

IN CASE OF EMERGENCY OR SPILL, CONTACT

NAME

PHONE NO.

24-HOUR EMERGENCY NO.

O

15. GENERATOR'S CERTIFICATION: I Hereby declare that the contents of this consignment are fully and accurately described above by proper shipping name and are classified, packed, marked, and labeled, and are in all respects in proper condition for transport by highway according to applicable international and national government regulations, including applicable state regulations, and are the same materials previously approved by LEA LAND, LLC

R

PRINTED/TYPED NAME

SIGNATURE

DATE

T

16.

TRANSPORTER (1)

17.

TRANSPORTER (2)

NAME:

NAME:

TEXAS I.D. NO.

TEXAS I.D. NO.

IN CASE OF EMERGENCY CONTACT:

IN CASE OF EMERGENCY CONTACT:

EMERGENCY PHONE:

EMERGENCY PHONE:

R18. **TRANSPORTER (1):** Acknowledgment of receipt of material19. **TRANSPORTER (2):** Acknowledgment of receipt of material

PRINTED/TYPED NAME

PRINTED/TYPED NAME

SIGNATURE

DATE

SIGNATURE

DATE

D**F****I****A****S****C****P****I****O****L****S****I****A****T**

PERMIT NO.

WM-01-035 - New Mexico

ADDRESS:

Mile Marker 64, U.S. Hwy 62/180,
30 Miles East of Carlsbad, NM

PHONE:

575-887-4048

21. DISPOSAL FACILITY'S CERTIFICATION: I Hereby certify that the above described wastes were delivered to this facility, that the facility is authorized and permitted to receive such wastes.

AUTHORIZED SIGNATURE

CELL NO.

DATE

TIME

GENERATOR: COPIES 1 & 6

DISPOSAL SITE: COPIES 2 & 3

TRANSPORTERS: COPIES 4 & 5

COPY 4

MILE MARKER #64 US HWY 62/180 • 30 MILES EAST OF CARLSBAD, NM • PHONE (575) 887-4048

1300 WEST MAIN STREET • OKLAHOMA CITY, OK 73106 • PHONE (405) 236-4257

2. TRAILER NO.

TRANSPORTERS: COPIES 4 & 5

Released to Imaging: 2/20/2023 8:13:41 AM

LEA LAND DISPOSAL SITE NEW MEXICO

MILE MARKER #64 US HWY 62/180 • 30 MILES EAST OF CARLSBAD, NM • PHONE (575) 887-4048

LEA LAND, LLC

1300 WEST MAIN STREET • OKLAHOMA CITY, OK 73106 • PHONE (405) 236-4257

NON-HAZARDOUS WASTE MANIFEST

NO **116419**

1. PAGE OF

2. TRAILER NO.

G

3. COMPANY NAME

4. ADDRESS

5. PICK-UP DATE

E

PHONE NO.

CITY

STATE

ZIP

6. TNRC I.D. NO.

N

7. NAME OR DESCRIPTION OF WASTE SHIPPED:

8. CONTAINERS
No. Type

9. TOTAL
QUANTITY

10. UNIT
Wt/Vol

11. TEXAS
WASTE ID #

E

a.

b.

c.

R

d.

A

12. COMMENTS OR SPECIAL INSTRUCTIONS:

13. WASTE PROFILE NO.

T

14.

IN CASE OF EMERGENCY OR SPILL, CONTACT

NAME

PHONE NO

24-HOUR EMERGENCY NO.

O

15. **GENERATOR'S CERTIFICATION:** I hereby declare that the contents of this consignment are fully and accurately described above by proper shipping name and are classified, packed, marked, and labeled, and are in all respects in proper condition for transport by highway according to applicable international and national government regulations, including applicable state regulations, and are the same materials previously approved by LEA LAND, LLC

R

PRINTED/TYPED NAME

SIGNATURE

DATE

T

16. **TRANSPORTER (1)**

17. **TRANSPORTER (2)**

NAME:

NAME:

TEXAS I.D. NO.

TEXAS I.D. NO.

IN CASE OF EMERGENCY CONTACT:

IN CASE OF EMERGENCY CONTACT:

EMERGENCY PHONE:

EMERGENCY PHONE:

S

18. **TRANSPORTER (1):** Acknowledgment of receipt of material

19. **TRANSPORTER (2):** Acknowledgment of receipt of material

PRINTED/TYPED NAME

PRINTED/TYPED NAME

SIGNATURE

DATE

SIGNATURE

DATE

D

Lea Land, LLC

ADDRESS:

Mile Marker 64, U.S. Hwy 62/180,
30 Miles East of Carlsbad, NM

PHONE:

575-887-4048

F

PERMIT NO.

WM-01-035 - New Mexico

20. COMMENTS

S

21. **DISPOSAL FACILITY'S CERTIFICATION:** I hereby certify that the above described wastes were delivered to this facility, that the facility is authorized and permitted to receive such wastes.

A

AUTHORIZED SIGNATURE

CELL NO.

DATE

TIME

GENERATOR: COPIES 1 & 6

DISPOSAL SITE: COPIES 2 & 3

TRANSPORTERS: COPIES 4 & 5

COPY 4

LEA LAND DISPOSAL SITE NEW MEXICO

MILE MARKER #64 US HWY 62/180 • 30 MILES EAST OF CARLSBAD, NM • PHONE (575) 887-4048

LEA LAND, LLC

1300 WEST MAIN STREET • OKLAHOMA CITY, OK 73106 • PHONE (405) 236-4257

NON-HAZARDOUS WASTE MANIFESTNO **116423**

1. PAGE ___ OF ___

2. TRAILER NO.:

G

3. COMPANY NAME

4. ADDRESS

5. PICK-UP DATE

E

PHONE NO.

CITY

STATE

ZIP

6. TNRCC I.D. NO.

N

7. NAME OR DESCRIPTION OF WASTE SHIPPED:

8. CONTAINERS
No. Type9. TOTAL
QUANTITY10. UNIT
Wt/Vol.11. TEXAS
WASTE ID #**E**

a.

b.

c.

R

d.

A

12. COMMENTS OR SPECIAL INSTRUCTIONS:

13. WASTE PROFILE NO.

T

14.

IN CASE OF EMERGENCY OR SPILL, CONTACT

NAME

PHONE NO.

24-HOUR EMERGENCY NO.

O15. **GENERATOR'S CERTIFICATION:** I Hereby declare that the contents of this consignment are fully and accurately described above by proper shipping name and are classified, packed, marked, and labeled, and are in all respects in proper condition for transport by highway according to applicable international and national government regulations, including applicable state regulations, and are the same materials previously approved by LEA LAND, LLC**R**

PRINTED/TYPED NAME

SIGNATURE

DATE

T

16.

TRANSPORTER (1)

17.

TRANSPORTER (2)

NAME:

NAME:

TEXAS I.D. NO.

TEXAS I.D. NO.

IN CASE OF EMERGENCY CONTACT:

IN CASE OF EMERGENCY CONTACT:

EMERGENCY PHONE:

EMERGENCY PHONE:

R18. **TRANSPORTER (1):** Acknowledgment of receipt of material19. **TRANSPORTER (2):** Acknowledgment of receipt of material

PRINTED/TYPED NAME

PRINTED/TYPED NAME

SIGNATURE

DATE

SIGNATURE

DATE

D

16.

Lea Land, LLC

ADDRESS:

Mile Marker 64, U.S. Hwy 62/180,
30 Miles East of Carlsbad, NM

PHONE:

575-887-4048

I

PERMIT NO.

WM-01-035 - New Mexico

20. COMMENTS

S21. **DISPOSAL FACILITY'S CERTIFICATION:** I Hereby certify that the above described wastes were delivered to this facility, that the facility is authorized and permitted to receive such wastes.**L**

AUTHORIZED SIGNATURE

CELL NO.

DATE

TIME

GENERATOR: COPIES 1 & 6

DISPOSAL SITE: COPIES 2 & 3

TRANSPORTERS: COPIES 4 & 5

COPY 4

LEA LAND DISPOSAL SITE NEW MEXICO

MILE MARKER #64 US HWY 62/180 • 30 MILES EAST OF CARLSBAD, NM • PHONE (575) 887-4048

LEA LAND, LLC

1300 WEST MAIN STREET • OKLAHOMA CITY, OK 73106 • PHONE (405) 236-4257

NON-HAZARDOUS WASTE MANIFESTNO **116435**1. PAGE OF 2. TRAILER NO. **G**

3. COMPANY NAME

4. ADDRESS

5. PICK-UP DATE

E

PHONE NO.

CITY

STATE

ZIP

6. TNRCC I.D. NO.

N

7. NAME OR DESCRIPTION OF WASTE SHIPPED:

8. CONTAINERS
No. Type9. TOTAL
QUANTITY10. UNIT
Wt/Vol.11. TEXAS
WASTE ID #**E**

a.

b.

c.

R

d.

A

12. COMMENTS OR SPECIAL INSTRUCTIONS:

13. WASTE PROFILE NO.

T

14.

IN CASE OF EMERGENCY OR SPILL, CONTACT

NAME

PHONE NO.

24-HOUR EMERGENCY NO.

O

15. GENERATOR'S CERTIFICATION: I Hereby declare that the contents of this consignment are fully and accurately described above by proper shipping name and are classified, packed, marked, and labeled, and are in all respects in proper condition for transport by highway according to applicable international and national government regulations, including applicable state regulations, and are the same materials previously approved by LEA LAND, LLC

R

PRINTED/TYPED NAME

SIGNATURE

DATE

T

16.

TRANSPORTER (1)

17.

TRANSPORTER (2)

NAME:

NAME:

TEXAS I.D. NO.

TEXAS I.D. NO.

IN CASE OF EMERGENCY CONTACT:

IN CASE OF EMERGENCY CONTACT:

EMERGENCY PHONE:

EMERGENCY PHONE:

R18. **TRANSPORTER (1):** Acknowledgment of receipt of material19. **TRANSPORTER (2):** Acknowledgment of receipt of material

PRINTED/TYPED NAME

PRINTED/TYPED NAME

SIGNATURE

DATE

SIGNATURE

DATE

D

Lea Land, LLC

ADDRESS:

Mile Marker 64, U.S. Hwy 62/180,
30 Miles East of Carlsbad, NM

PHONE:

575-887-4048

I

PERMIT NO.

WM-01-035 - New Mexico

20. COMMENTS

S

21. DISPOSAL FACILITY'S CERTIFICATION: I Hereby certify that the above described wastes were delivered to this facility, that the facility is authorized and permitted to receive such wastes.

A

AUTHORIZED SIGNATURE

CELL NO.

DATE

TIME

GENERATOR: COPIES 1 & 6

DISPOSAL SITE: COPIES 2 & 3

TRANSPORTERS: COPIES 4 & 5

COPY 4

LEA LAND DISPOSAL SITE NEW MEXICO

MILE MARKER #64 US HWY 62/180 • 30 MILES EAST OF CARLSBAD, NM • PHONE (575) 887-4048

LEA LAND, LLC

1300 WEST MAIN STREET • OKLAHOMA CITY, OK 73106 • PHONE (405) 236-4257

NON-HAZARDOUS WASTE MANIFESTNO **116436**

1. PAGE ___ OF ___

2. TRAILER NO. **YX6****G**

3. COMPANY NAME

4. ADDRESS

5. PICK-UP DATE

E

PHONE NO.

CITY

STATE

ZIP

6. TNRC I.D. NO.

N

7. NAME OR DESCRIPTION OF WASTE SHIPPED:

8. CONTAINERS
No. Type9. TOTAL
QUANTITY10. UNIT
Wt/Vol.11. TEXAS
WASTE ID #**E**

a.

b.

c.

R

d.

A

12. COMMENTS OR SPECIAL INSTRUCTIONS:

13. WASTE PROFILE NO.

T

14.

IN CASE OF EMERGENCY OR SPILL, CONTACT

NAME

PHONE NO.

24-HOUR EMERGENCY NO.

O15. **GENERATOR'S CERTIFICATION:** I Hereby declare that the contents of this consignment are fully and accurately described above by proper shipping name and are classified, packed, marked, and labeled, and are in all respects in proper condition for transport by highway according to applicable international and national government regulations, including applicable state regulations, and are the same materials previously approved by LEA LAND, LLC**R**

PRINTED/TYPED NAME

SIGNATURE

DATE

T

16.

TRANSPORTER (1)

17.

TRANSPORTER (2)

NAME:

NAME:

TEXAS I.D. NO.

TEXAS I.D. NO.

IN CASE OF EMERGENCY CONTACT:

IN CASE OF EMERGENCY CONTACT:

EMERGENCY PHONE:

EMERGENCY PHONE:

R18. **TRANSPORTER (1):** Acknowledgment of receipt of material19. **TRANSPORTER (2):** Acknowledgment of receipt of material

PRINTED/TYPED NAME

PRINTED/TYPED NAME

SIGNATURE

DATE

SIGNATURE

DATE

D

Lea Land, LLC

ADDRESS:

Mile Marker 64, U.S. Hwy 62/180,
30 Miles East of Carlsbad, NM

PHONE:

575-887-4048

I

PERMIT NO.

WM-01-035 - New Mexico

20. COMMENTS

P**I****S****I****A****T****L****Y**21. **DISPOSAL FACILITY'S CERTIFICATION:** I Hereby certify that the above described wastes were delivered to this facility, that the facility is authorized and permitted to receive such wastes.

AUTHORIZED SIGNATURE

CELL NO.

DATE

TIME

GENERATOR: COPIES 1 & 6

DISPOSAL SITE: COPIES 2 & 3

TRANSPORTERS: COPIES 4 & 5

COPY 4

LEA LAND DISPOSAL SITE NEW MEXICO

MILE MARKER #64 US HWY 62/180 • 30 MILES EAST OF CARLSBAD, NM • PHONE (575) 887-4048

LEA LAND, LLC

1300 WEST MAIN STREET • OKLAHOMA CITY, OK 73106 • PHONE (405) 236-4257

NON-HAZARDOUS WASTE MANIFEST

NO **116437**

1. PAGE OF

2. TRAILER NO.

G

3. COMPANY NAME

4. ADDRESS

5. PICK-UP DATE

E

PHONE NO.

CITY

STATE

ZIP

6. TNRCC I.D. NO.

N

7. NAME OR DESCRIPTION OF WASTE SHIPPED:

8. CONTAINERS
No. Type

9. TOTAL
QUANTITY

10. UNIT
Wt/Vol

11. TEXAS
WASTE ID #

E

a.

b.

c.

R

d.

12. COMMENTS OR SPECIAL INSTRUCTIONS:

13. WASTE PROFILE NO.

A

14.

IN CASE OF EMERGENCY OR SPILL, CONTACT

NAME

PHONE NO

24-HOUR EMERGENCY NO.

T

O

15. **GENERATOR'S CERTIFICATION:** I hereby declare that the contents of this consignment are fully and accurately described above by proper shipping name and are classified, packed, marked, and labeled, and are in all respects in proper condition for transport by highway according to applicable international and national government regulations, including applicable state regulations, and are the same materials previously approved by LEA LAND, LLC

R

PRINTED/TYPED NAME

SIGNATURE

DATE

T

16.

TRANSPORTER (1)

17.

TRANSPORTER (2)

NAME:

NAME:

TEXAS I.D. NO.

TEXAS I.D. NO.

IN CASE OF EMERGENCY CONTACT:

IN CASE OF EMERGENCY CONTACT:

EMERGENCY PHONE:

EMERGENCY PHONE:

R

18. **TRANSPORTER (1):** Acknowledgment of receipt of material

19. **TRANSPORTER (2):** Acknowledgment of receipt of material

PRINTED/TYPED NAME

PRINTED/TYPED NAME

SIGNATURE

DATE

SIGNATURE

DATE

D

Lea Land, LLC

ADDRESS:

Mile Marker 64, U.S. Hwy 62/180,
30 Miles East of Carlsbad, NM

PHONE:

575-887-4048

F

PERMIT NO.

WM-01-035 - New Mexico

20. COMMENTS

I

S

C

P

O

L

S

I

A

T

21. **DISPOSAL FACILITY'S CERTIFICATION:** I hereby certify that the above described wastes were delivered to this facility, that the facility is authorized and permitted to receive such wastes.

AUTHORIZED SIGNATURE

CELL NO.

DATE

TIME

GENERATOR: COPIES 1 & 6

DISPOSAL SITE: COPIES 2 & 3

TRANSPORTERS: COPIES 4 & 5

COPY 4

Appendix E
Initial and Final C-141

District I
1625 N. French Dr., Hobbs, NM 88240
District II
811 S. First St., Artesia, NM 88210
District III
1000 Rio Brazos Road, Aztec, NM 87410
District IV
1220 S. St. Francis Dr., Santa Fe, NM 87505

State of New Mexico
Energy Minerals and Natural Resources
Oil Conservation Division
1220 South St. Francis Dr.
Santa Fe, NM 87505

NM OIL CONSERVATION

ARTESIA DISTRICT

Form C-141

Revised August 8, 2011

SEP 07 2016

Submit 1 Copy to appropriate District Office in accordance with 19.15.29 NMAC.

RECEIVED

Release Notification and Corrective Action

NA B1625327393 **5380** **OPERATOR** ☒ Initial Report ☐ Final Report

Name of Company: XTO Energy, Inc.	Contact: Dudley McMinn
Address: 500 W. Illinois Ave., Suite 100, Midland, TX 70701	Telephone No.: (432) 682-8873
Facility Name: Nash Draw Unit Battery #36	Facility Type: Tank Battery (Equipment Removed)



Surface Owner: Federal	Mineral Owner: Federal	API No. 30-015-30176
------------------------	------------------------	----------------------

LOCATION OF RELEASE

Unit Letter	Section	Township	Range	Feet from the	North/South Line	Feet from the	East/West Line	County: Eddy
K	12	23S	29E	1460	South	1585	West	

Latitude 32.316944 Longitude -103.941667

NATURE OF RELEASE

Type of Release: Crude Oil	Volume of Release: Unknown	Volume Recovered: None
Source of Release: Spills	Date and Hour of Occurrence: Unknown	Date and Hour of Discovery: 07-20-2016
Was Immediate Notice Given? <input type="checkbox"/> Yes <input type="checkbox"/> No <input checked="" type="checkbox"/> Not Required	If YES, To Whom?	
By Whom?	Date and Hour	
Was a Watercourse Reached? <input type="checkbox"/> Yes <input checked="" type="checkbox"/> No	If YES, Volume Impacting the Watercourse.	
If a Watercourse was Impacted, Describe Fully.*		
Describe Cause of Problem and Remedial Action Taken.* Hydrocarbons in soil due to historic use of tank battery reported in soil samples by laboratory following removal of tanks and equipment. Will remediate to OCD and BLM requirements.		
Describe Area Affected and Cleanup Action Taken.* Affected soil to be excavated, treated onsite treatment or disposed offsite at OCD approved facility. Refer to attached analytical data summary.		
I hereby certify that the information given above is true and complete to the best of my knowledge and understand that pursuant to NMOC rules and regulations all operators are required to report and/or file certain release notifications and perform corrective actions for releases which may endanger public health or the environment. The acceptance of a C-141 report by the NMOC marked as "Final Report" does not relieve the operator of liability should their operations have failed to adequately investigate and remediate contamination that pose a threat to ground water, surface water, human health or the environment. In addition, NMOC acceptance of a C-141 report does not relieve the operator of responsibility for compliance with any other federal, state, or local laws and/or regulations.		
Signature: 	OIL CONSERVATION DIVISION	
Printed Name: Luke Williams	Approved by Environmental Specialist: 	
Title: EH&S Coordinator	Approval Date: 9/8/16	Expiration Date: N/A
E-mail Address: Luke.Williams@xtoenergy.com	Conditions of Approval: Remediation per O.C.D. Rules & Guidelines <input type="checkbox"/>	
Date: 09-07-2016 Phone: (432) 683-8873	SUBMIT REMEDIATION PROPOSAL NO LATER THAN: 10/9/16	

* Attach Additional Sheets If Necessary

2RP-3871

Patterson, Heather, EMNRD

From: Mark Larson <Mark@laenvironmental.com>
Sent: Wednesday, September 07, 2016 4:54 PM
To: Patterson, Heather, EMNRD
Cc: McMinn, Dudley; Williams, Luke
Subject: Re: Initial C-141s for XTO Energy, Inc., Nash Draw Unit Tank Batteries (8), Eddy County, New Mexico
Attachments: Initial C-141, XTO Energy, Inc., Nash Draw unit Battery 1 & 6, September 7, 2016.pdf; Initial C-141, XTO Energy, Inc., Nash Draw Unit Battery 10, September 7, 2016.pdf; Initial C-141, XTO Energy, Inc., Nash Draw Unit Battery 9, September 7, 2016.pdf; Initial C-141, XTO Energy, Inc., Nash Draw Unit Battery 15 & 33, September 7, 2016.pdf; Initial C-141, XTO Energy, Inc., Nash Draw Unit Battery 24, September 7, 2016.pdf; Initial C-141, XTO Energy, Inc., Nash Draw Unit Battery 36, September 7, 2016.pdf; Initial C-141, XTO Energy, Inc., Nash Draw Unit Battery 19 & 34, September 7, 2016.pdf; Initial C-141, XTO Energy, Inc., Nash Draw Unit Battery 38, September 7, 2016.pdf

Dear Heather,

The attached C-141s and supporting documentation are submitted on behalf of XTO Energy, Inc., for eight (8) tank batteries located in the Nash Draw Unit, Eddy County, New Mexico. Please contact Dudley McMinn with XTO Energy, Inc. at (432) 682-8873 or me if you have questions.

Respectfully,

Mark J. Larson

From: Mark Larson
Sent: Wednesday, September 07, 2016 10:59 AM
To: 'heather.patterson@state.nm.us'
Cc: 'McMinn, Dudley'; 'Luke_Williams@xtoenergy.com'
Subject: Re: Meeting Confirmation

Dear Heather,

This message is to confirm our meeting at your office on September 15, 2016 at 10:00 AM (Mountain Time). Please contact me if you have questions. See you then!

Respectfully,

Mark J. Larson, P.G.
President/Sr. Project Manager
507 N. Marienfeld St., Suite 205
Midland, Texas 79701
(432) 687-0901 (O)
(432) 556-8656 (C)



www.LAEnvironmental.com

"Serving the Permian Basin Since 2000"

From: Patterson, Heather, EMNRD [Heather.Patterson@state.nm.us]
Sent: Thursday, November 10, 2016 2:34 PM
To: Mark Larson; Bratcher, Mike, EMNRD; Weaver, Crystal, EMNRD; hprice@blm.gov
Cc: McMinn, Dudley; Williams, Luke
Subject: RE: 2RP-3871, Remediation Plan, Nash Draw Tank Battery #36, November 2, 2016

RE: XTO * Nash Draw Battery #36 * 30-015-30176 * 2RP-3871

Mark,

Your proposed remediation for the above referenced site is approved.

OCD approval does not relieve the operator of liability should their operations fail to adequately investigate and remediate contamination that may pose a threat to ground water, surface water, human health or the environment. In addition, OCD approval does not relieve the operator of responsibility for compliance with any other federal, state, local laws and/or regulations.

If you have any questions or concerns, and for notification, please contact me.

Heather Patterson
Environmental Specialist
NMOCD District II
Office (575)748-1283 ext.101
Cell (575)703-0228

From: Mark Larson [<mailto:Mark@laenvironmental.com>]
Sent: Monday, November 07, 2016 6:32 PM
To: Patterson, Heather, EMNRD; Bratcher, Mike, EMNRD; Weaver, Crystal, EMNRD; hprice@blm.gov
Cc: McMinn, Dudley; Williams, Luke
Subject: Re: 2RP-3871, Remediation Plan, Nash Draw Tank Battery #36, November 2, 2016

All,

Please find attached remediation plan for the Nash Draw Tank Battery #38. The plan was revised to include BTEX in excavation samples, where applicable, and the laboratory report for samples collected on September 29, 2016. Remediation will commence on Tuesday, November 8, 2016, per our verbal discussion and approval yesterday. Please contact Dudley McMinn with XTO at (432) 682-8873 or me if you have questions.

Respectfully,

Mark J. Larson, P.G.
President/Sr. Project Manager
507 N. Marienfeld St., Suite 205
Midland, Texas 79701
Office – 432-687-0901
Cell – 432- 556-8656
Fax – 432-687-0456
mark@laenvironmental.com

District I
1625 N. French Dr., Hobbs, NM 88240
District II
811 S. First St., Artesia, NM 88210
District III
1000 Rio Brazos Road, Aztec, NM 87410
District IV
1220 S. St. Francis Dr., Santa Fe, NM 87505

State of New Mexico
Energy Minerals and Natural Resources
Oil Conservation Division
1220 South St. Francis Dr.
Santa Fe, NM 87505

Form C-141
Revised August 8, 2011

Submit 1 Copy to appropriate District Office in
accordance with 19.15.29 NMAC.

Release Notification and Corrective Action

OPERATOR

☐ Initial Report ☒ Final Report

Name of Company: XTO Energy, Inc.	Contact: Dudley McMinn
Address: 500 W. Illinois Ave., Suite 100, Midland, TX 70701	Telephone No.: (432) 682-8873
Facility Name: Nash Draw Unit Battery #36	Facility Type: Tank Battery (Equipment Removed)
Surface Owner: Federal	Mineral Owner: Federal
API No. 30-015-30176	

LOCATION OF RELEASE

Unit Letter K	Section 12	Township 23S	Range 29E	Feet from the 1460	North/South Line South	Feet from the 1585	East/West Line West	County: Eddy
------------------	---------------	-----------------	--------------	-----------------------	---------------------------	-----------------------	------------------------	--------------

Latitude 32.316944 Longitude -103.941667

NATURE OF RELEASE

Type of Release: Crude Oil	Volume of Release: Unknown	Volume Recovered: None
Source of Release: Spills	Date and Hour of Occurrence Unknown	Date and Hour of Discovery 07-20-2016
Was Immediate Notice Given? <input type="checkbox"/> Yes <input type="checkbox"/> No <input checked="" type="checkbox"/> Not Required	If YES, To Whom?	
By Whom?	Date and Hour	
Was a Watercourse Reached? <input type="checkbox"/> Yes <input checked="" type="checkbox"/> No	If YES, Volume Impacting the Watercourse.	
If a Watercourse was Impacted, Describe Fully.*		
Describe Cause of Problem and Remedial Action Taken.* Hydrocarbons in soil due to historic use of tank battery reported in soil samples by laboratory following removal of tanks and equipment. Will remediate to OCD and BLM requirements.		
Describe Area Affected and Cleanup Action Taken.* Soil was excavated to 1 foot in area of DP-06-01 and DP-06-04 over areas measuring approximately 15 x 20 feet and 20 x 35 feet, respectively. Location DP-06-03 was excavated to maximum depth of 6 feet bgs over area measuring about 20 x 45 feet. Laboratory results of confirmation soil samples from the excavation sidewalls confirmed BTEX and TPH below the RRALs. A 20-mil thickness liner poly liner was placed in the bottom of the excavations at DP-06-03 and DP-04-04 at 4 feet bgs. All excavations were backfilled with caliche. Approximately 493 cubic yards of contaminated soil was disposed at Lea Land Landfill, LLC.		
I hereby certify that the information given above is true and complete to the best of my knowledge and understand that pursuant to NMOC rules and regulations all operators are required to report and/or file certain release notifications and perform corrective actions for releases which may endanger public health or the environment. The acceptance of a C-141 report by the NMOC marked as "Final Report" does not relieve the operator of liability should their operations have failed to adequately investigate and remediate contamination that pose a threat to ground water, surface water, human health or the environment. In addition, NMOC acceptance of a C-141 report does not relieve the operator of responsibility for compliance with any other federal, state, or local laws and/or regulations.		
Signature:		OIL CONSERVATION DIVISION
Printed Name: Luke Williams		Approved by Environmental Specialist:
Title: EH&S Coordinator	Approval Date:	Expiration Date:
E-mail Address: Luke.Williams@xtoenergy.com	Conditions of Approval:	Attached <input type="checkbox"/>
Date: 03-24-2016	Phone: (432) 683-8873	

* Attach Additional Sheets If Necessary

District I
1625 N. French Dr., Hobbs, NM 88240
Phone:(575) 393-6161 Fax:(575) 393-0720
District II
811 S. First St., Artesia, NM 88210
Phone:(575) 748-1283 Fax:(575) 748-9720
District III
1000 Rio Brazos Rd., Aztec, NM 87410
Phone:(505) 334-6178 Fax:(505) 334-6170
District IV
1220 S. St Francis Dr., Santa Fe, NM 87505
Phone:(505) 476-3470 Fax:(505) 476-3462

State of New Mexico
Energy, Minerals and Natural Resources
Oil Conservation Division
1220 S. St Francis Dr.
Santa Fe, NM 87505

CONDITIONS

Action 187592

CONDITIONS

Operator: XTO ENERGY, INC 6401 Holiday Hill Road Midland, TX 79707	OGRID: 5380
	Action Number: 187592
	Action Type: [IM-SD] Incident File Support Doc (ENV) (IM-BNF)

CONDITIONS

Created By	Condition	Condition Date
bhall	Closure previously approved for this incident. New application was created in order to include the Remediation Report in the incident file.	2/20/2023