



HESS CORPORATION
1501 McKinney
Houston, TX 77010

Brian Epperson
Director, EHS
Phone: (713) 496-7296
E-Mail: bepperson@hess.com

March 31, 2025

Mr. Michael Buchanan
New Mexico Oil Conservation District
1220 South St. Francis Drive
Santa Fe, NM 87505
VIA: Electronic Submittal Only

**Re: 2024 Annual Site Update
Former State G 4 Tank Battery, 1R-4863
Sec 18, T-19S, R-37E, Lea County**

Dear Mr. Buchanan:

Enclosed please find the Annual Site Update for 1R-4863, Former State G 4 Tank Battery, located in Monument, New Mexico. The report summarizes the remedial efforts and sampling results for 2024. As a result of LPH thicknesses continue to decrease in all monitoring wells, Hess is requesting No Further Action/Closure for 1R-4863, Former G State Battery. Finally, we would like to schedule a meeting with you at your office to discuss our proposed No Further Action.

If you should have any further questions or require additional information, please feel free to contact the undersigned at 713-496-7296.

Sincerely,

A handwritten signature in blue ink, appearing to read "Brian Epperson", written in a cursive style.

Brian Epperson
Director, EHS

cc: Brad Freeman, Axis Environmental Management

FORMER STATE G 4 TANK BATTERY 1R-4863

SECTION 18, TOWNSHIP 19 SOUTH, RANGE 37 EAST
MONUMENT, LEA COUNTY, NEW MEXICO

SITE UPDATE

Prepared for:



Hess Corporation

1501 McKinney
Houston, TX 77010

Prepared by:

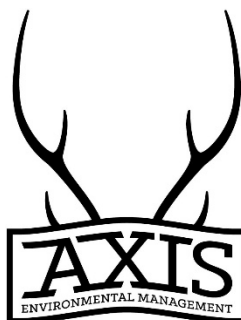

TABLE OF CONTENTS

1.0 INTRODUCTION.....2

2.0 GROUNDWATER ACTIVITIES.....4

3.0 LPH RECOVERY ACTIVITIES.....5

4.0 RECOMMENDATIONS.....6

LIST OF TABLES

TABLE 1	SUMMARY OF GROUNDWATER GAUGING DATA
TABLE 2A	SUMMARY OF GROUNDWATER MONITORING RESULTS: BTEX, TPH, CHLORIDE, AND TDS
TABLE 2B	SUMMARY OF GROUNDWATER MONITORING RESULTS: PAHs
TABLE 3	SOLAR SIPPER RECOVERY SUMMARY
TABLE 4	SUMMARY OF SOLAR SIPPER RECOVERY

LIST OF FIGURES

FIGURE 1	SITE LOCATION MAP
FIGURE 2	GROUNDWATER POTENTIOMETRIC MAP (AUGUST 2024)
FIGURE 3	GROUNDWATER POTENTIOMETRIC MAP (DECEMBER 2024)
FIGURE 4	GROUNDWATER ANALYTICAL MAP

ATTACHMENTS

ATTACHMENT 1	LABORATORY REPORTS
ATTACHMENT 2	LPH THICKNESS GRAPH

1.0 INTRODUCTION

The Former State G 4 Tank Battery (State G 4 or the Site) is located northwest of Monument, New Mexico in southern Lea County. The legal description of the site is Section 18, Township 19 South, and Range 37 East. The Site latitude is 32° 39' 24.1" and longitude is 103° 17' 47.4". The Site was formerly a tank battery that was dismantled at an unknown date. A regional location map showing the site location is included as **Figure 1**. No known environmental incidents have occurred at the Site; however, the Site is under investigation due to its historical use as a former tank battery. On December 5, 2005, the New Mexico Oil Conservation Division (NMOCD) approved a general work plan submitted by Hess Corporation (Hess) to investigate and remediate locations within the North Monument Grayburg San Andres Unit (NMGSAU) that have historical contamination. A C-141 form was submitted and approved by NMOCD on November 29, 2017, and remediation case number 1R-4863 was assigned.

BBC International (BBC) initiated the investigation of the former tank battery on June 30 and July 1, 2015 by advancing nine soil borings to depths as great as 55 feet below ground surface (bgs). The locations of these borings are shown on the Site Map in **Figure 2**. Soils were analyzed for Benzene, Toluene, Ethylbenzene, Total Xylenes (BTEX), Chloride, Total Petroleum Hydrocarbons Gasoline Range Organics (TPH-GRO), and Total Petroleum Hydrocarbons Diesel Range Organics (TPH-DRO). Chloride concentrations were above the NMOCD Standard in soil boring SP1 to a depth of 25 feet, SP2 at depths of 15 feet and 45 feet, and SP6 to a depth of 20 feet. Total TPH concentrations were above the NMOCD Standard in soil borings SP1, SP2, and SP7 to a depth of 55 feet in each location, as well as SP6 to a depth of 20 feet. Concentrations for Benzene or Total BTEX were not above the NMOCD Standard in any of the soil borings.

A monitoring well, MW-1, was installed by BBC during the initial investigation in July 2015. The presence of Liquid Phase Hydrocarbon (LPH) was observed in the monitoring well, and no groundwater sample was collected at that time. GeoMonitoring Services (GMS) gauged MW-1 three times in 2016 in August, October, and December. No measurable LPH was observed during these three events, and groundwater samples were collected and analyzed for

BTEX, TPH-GRO, TPH-DRO, and Chlorides. Polynuclear Aromatic Hydrocarbons (PAHs) were also analyzed during the December 2016 sampling event. Only Chloride concentrations exceeded the New Mexico Water Quality Control Commission (NM WQCC) Standard of 250 milligrams per liter (mg/L) in October 2016 with a concentration of 850 mg/L and December 2016 with a concentration of 640 mg/L.

GMS utilized the information gathered during the initial investigation conducted by BBC International to further delineate the soil and groundwater impacts. GMS installed four additional monitoring wells and three soil borings in November 2016. An additional five soil borings were advanced and temporary wells were installed in November 2017. Analysis of soil samples demonstrated Total TPH concentrations in excess of the NMOCD Standards of 1,000 mg/kg to depths up to 60 feet in MW-2, 60 feet in MW-5, 50 feet in SB-10, 50 feet in SB-11, and 50 feet in SB-12. Soil borings SB-13 through SB-17 and MW-3 and MW-4 did not have any detections for Total TPH in excess of the NMOCD Standards. Chloride concentrations did not exceed the NMOCD Standard in any of the sample points. Groundwater samples did not have concentrations of BTEX or TPH above the NM WQCC Standards, with the exception of a Benzene detection in monitoring well MW-5 with a concentration of 32 µg/L. Chloride concentrations exceeded the NM WQCC standard in monitoring wells MW-1, MW-3, MW-4, and soil boring SB-14. The total dissolved solids (TDS) concentration in soil boring SB-14 exceeded the NM WQCC Standard. A Site Assessment Report further detailing the above investigation was submitted on July 25, 2018. In that report, Hess proposed excavating the areas with elevated TPH to a depth of four feet, installing a polyethylene liner, and backfilling with clean soil.

During a meeting at the NMOCD office on October 2, 2018, NMOCD expressed interest in Hess evaluating the viability of an air sparge and vapor extraction (AS/VE) system instead of the proposed excavation. On March 3, 2019, Hess submitted a Sparge Test Work Plan, which proposed installing one test point and one observation point. On June 19, 2019, Hess performed gamma and conductivity logs in the five monitoring wells to begin evaluating AS/VE viability. During this event, LPH was observed in the most upgradient monitoring well, MW-5, with a thickness of 3.5 feet. LPH thicknesses in monitoring wells MW-1 and MW-2 had also increased

to greater than 6 feet. A Site Update dated November 12, 2020, noted that LPH samples were subsequently collected from MW-1, MW-2, and MW-5, and the analysis concluded the LPH in all three wells came from the same source and/or release. The update also discussed baildown tests conducted on MW-1 and MW-5, and noted that after 8 hours, MW-1 returned to 57% of its pretest thickness, and MW-5 returned to 70% of its pretest thickness. The update concluded that Hess planned to install three additional monitoring wells immediately south of the road, upgradient of MW-5. Monitoring wells, MW-6, MW-7, and MW-8 were installed on March 23, 2021.

On November 16, 2021, Hess submitted a Site Update and Remedial Work Plan that summarized the additional monitoring wells installed in March 2021 as well as liquid phase hydrocarbon (LPH) recovery efforts. It also included a proposal from Hess to excavate soil in the areas with elevated Total Petroleum Hydrocarbons (TPH) to a depth of four feet below ground surface, line the excavation with a polyethylene liner, and backfill with clean soil. The proposed scope of work was approved by the New Mexico Oil Conservation Division (NMOCD) on November 29, 2021, and implementation of the approved scope of work began on December 2, 2021. A Site Update summarizing the excavation and liner installation was submitted on January 28, 2022. In that update, Hess committed to continued LPH removal with solar sippers, conducting monthly vacuum events on the three monitor wells with LPH, sampling the monitoring wells without measurable LPH on a semiannual basis, and to provide annual site status updates. Below is a summary of the activities that occurred during 2024.

2.0 Groundwater Activities

Monitoring wells MW-4, MW-6, MW-7, and MW-8 were sampled on July 30, 2024 and December 19, 2024. Monitoring wells MW-1, MW-2, MW-3, and MW-5 were not sampled in July and December 2024 due to the presence of LPH. All monitoring wells were gauged prior to sampling on July 30, 2024 and December 18, 2024. Monitoring wells MW-1, MW-2, and MW-5 have historically had measurable LPH. MW-3 had a measurable LPH thickness of 0.01 feet during both 2024 gauging events. The groundwater potentiometric maps for July 2024 and December 2024 are provided in **Figure 2** and **Figure 3**, respectively. The groundwater gradient

was to the northeast during both sampling events. Historical groundwater gradients have been to the north.

Groundwater samples were collected and analyzed for benzene, toluene, ethylbenzene, total xylenes (BTEX), total petroleum hydrocarbons gasoline range organics (TPH-GRO), total petroleum hydrocarbons diesel range organics (TPH-DRO), total petroleum hydrocarbons extended diesel range organics (TPH EXT-DRO), chloride, and PAHs. Purging was completed by bailing three well volumes, and three field measurements were recorded for pH, conductivity, temperature, dissolved oxygen, and oxygen redox potential (ORP). The samples were transferred from the bailers into dedicated laboratory-supplied Teflon™-capped glassware. The groundwater samples were preserved with hydrochloric acid, placed into a cooler, and maintained at a temperature of less than 4°C for transportation to Cardinal.

None of the groundwater samples collected in July or December 2024 had detected concentrations for BTEX, TPH-GRO, TPH-DRO, TPH Ext-DRO or PAHs above the NM WQCC Standards. Monitoring wells MW-7 and MW-8 had Chloride concentrations above the NM WQCC Standard of 250 mg/L. Concentrations exceeding the NM WQCC Standard in July 2024 were 376 mg/L in MW-7 and 360 mg/L in MW-8. Chloride concentrations exceeding the NM WQCC Standard in December 2024 were 340 mg/L in MW-7 and MW-8. A summary of groundwater monitoring results is found in **Tables 2A and 2B** and is shown in **Figure 4**. The laboratory report is found in **Attachment 1**.

3.0 LPH Recovery Activities

In an effort to remove LPH from the monitoring wells, solar sippers operated in monitoring wells MW-1, MW-2, and MW-5 throughout 2024. The solar sippers in MW-1 and MW-2 are plumbed to discharge into an adjacent drum, which is stored in an overpack. The solar sipper installed in MW-5 is plumbed to discharge into a 300-gallon double wall tank. The recovery containers were gauged weekly in order to monitor the recovery progress. During 2024, approximately 34.02 gallons of LPH and 191.49 gallons of water were recovered from MW-1. MW-2 recovered approximately 187.44 gallons of LPH and 229.68 gallons of water during 2024. MW-5 recovered approximately 118.13 gallons of LPH and 173.56 gallons of water during 2024. A summary of the solar sipper recovery is shown in **Table 3**.

In addition, monthly vacuum events were conducted for MW-1, MW-2, and MW-5 throughout 2024. The LPH thickness was measured in each well before and after the vacuum event. **Table 4** shows the pre and post LPH thicknesses for each monthly vacuum event. Between the January 27, 2024 vacuum event and the December 29, 2024 vacuum event, the LPH thickness in MW-1 ranged from 3.87 feet on July, 27, 2024 to 0.02 feet on December 29, 2024, the LPH thickness in MW-2 ranged from 4.30 feet on December 29, 2024 to 0.75 feet on October 26, 2024, and the LPH thickness in MW-5 ranged from 6.20 feet on September 28, 2024 and 2.60 feet on March 30, 2024. The LPH Thickness Graph found in **Attachment 2** illustrates the overall LPH thicknesses in MW-1, MW-2, and MW-5 since March 2022. LPH thicknesses have continued to trend down since March 2022.

LPH was first measured in monitoring well MW-3 during the December 2023 gauging event, and an absorbent sock was subsequently installed. The LPH thickness did not exceed 0.01 feet during 2024.

4.0 Recommendations

As discussed in the 2023 Site Update, the groundwater samples collected in December 2023 from monitoring wells MW-1, MW-2, and MW-5 below the LPH resulted in only benzene exceeding the NM WQCC Standard of 10 µg/L in monitoring well MW-5 (15 µg/L) and chlorides exceeding the NM WQCC Standard of 250 mg/L in monitoring well MW-2 (460 mg/L). As such, the LPH present in the wells is having a minimum impact on contacted groundwater. Since 2021, none of the groundwater samples collected from monitoring wells without LPH have had detected concentrations for BTEX, TPH-GRO, TPH-DRO, TPH Ext-DRO or PAHs above the NM WQCC Standards. LPH thicknesses continue to show a decreasing trend since beginning the use of solar sippers and monthly vacuum events in 2022. **As a result of LPH thicknesses continue to decrease in all monitoring wells, Hess is requesting No Further Action/Closure for 1R-4863, Former G State Battery.**

Tables

Table 1
Summary of Groundwater Gauging Data
Texaco NM State G 4 Battery

Well No.	Casing Diameter (inches)	Top of Casing Elevation (feet)	Date	Top of Casing to LPH (feet)	Top of Casing to Water (feet)	LPH Thickness (feet)	Groundwater Elevation (feet)
MW-1	2	3707.36	7/30/2024	64.22	69.57	5.35	3642.07
			12/18/2024	64.82	65.47	0.65	3642.41
MW-2	2	3706.78	7/30/2024	63.57	65.70	2.13	3642.78
			12/18/2024	63.96	67.02	3.06	3642.21
MW-3	2	3709.31	7/30/2024	65.29	65.30	0.01	3644.02
			12/18/2024	65.75	65.76	0.01	3643.56
MW-4	2	3707.01	7/30/2024	NE	63.87	0.00	3643.14
			12/18/2024	NE	64.36	0.00	3642.65
MW-5	2	3706.57	7/30/2024	62.89	68.10	5.21	3642.64
			12/18/2024	63.93	66.44	2.51	3642.14
MW-6	2	3708.91	7/30/2024	NE	65.04	0.00	3643.87
			12/18/2024	NE	66.20	0.00	3642.71
MW-7	2	3708.83	7/30/2024	NE	65.07	0.00	3643.76
			12/18/2024	NE	65.91	0.00	3642.92
MW-8	2	3707.36	7/30/2024	NE	63.75	0.00	3643.61
			12/18/2024	NE	64.34	0.00	3643.02

Note:

LPH - Liquid Phase Hydrocarbon

NM - Not Measured

NE - Not Encountered

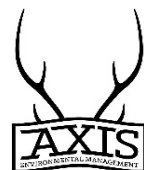

Table 2A
Summary of Groundwater Monitoring Results
BTEX, TPH, Chloride
Texaco NM State G 4 Battery

Sample Identification	Date Sampled	Benzene (µg/L)	Toluene (µg/L)	Ethylbenzene (µg/L)	Xylenes (µg/L)	TPH-GRO (C6-C10) (mg/L)	TPH-DRO (C10-C28) (mg/L)	TPH EXT-DRO (C28-C36) (mg/L)	Chloride (mg/L)	TDS (mg/L)
NM WQCC Standards:		10	750	750	620	NONE	NONE	NONE	250	1000
MW-1	8/9/2016	<1	<1	<1	<3	NA	NA	NA	NA	NA
	3/30/2021	NOT SAMPLED								
	6/30/2022	NOT SAMPLED								
	12/8/2022	NOT SAMPLED								
	7/20/2023	NOT SAMPLED								
	12/5/2023	3.0	2.0	8.0	10.0	1.18	15.9	3.2	188.0	NA
	7/30/2024	NOT SAMPLED								
	12/19/2024	NOT SAMPLED								
MW-2	12/21/2016	NOT SAMPLED								
	3/30/2021	NOT SAMPLED								
	6/30/2022	NOT SAMPLED								
	12/8/2022	NOT SAMPLED								
	7/20/2023	NOT SAMPLED								
	12/5/2023	9.0	3.0	7.0	27.0	1.93	7.70	<1	460.0	NA
	7/30/2024	NOT SAMPLED								
	12/19/2024	NOT SAMPLED								
MW-3	12/21/2016	0.7	<0.5	<0.5	<2	<1	<1	NA	264	NA
	3/30/2021	<0.5	<0.5	<0.5	<0.5	<1	<1	<1	252	1084
	6/30/2022	<1	<1	<1	<3	<1	<1	<1	272	NA
	12/9/2022	<1	<1	<1	<2	<1	<1	<1	280	NA
	7/20/2023	<1	<1	<1	<3	<1	<1	<1	304	NA
	12/5/2023	5.0	<1	<1	5	4.46	44.9	9.28	332	NA
	7/30/2024	NOT SAMPLED								
	12/19/2024	NOT SAMPLED								
MW-4	12/21/2016	4.0	<0.5	<0.5	12	<1	1.58	NA	268	NA
	3/30/2021	2.0	<0.5	<0.5	2	<1	1.20	<1	340	1552
	6/30/2022	<1	<1	<1	<3	<1	<1	<1	600	NA
	12/9/2022	6.0	<1	<1	2	<1	<1	<1	348	NA
	7/20/2023	4.0	<1	<1	<3	<1	<1	<1	180	NA
	12/5/2023	8.0	2	2	6	<1	<1	<1	132	NA
	7/30/2024	6.0	<1	4	4	<1	<1	<1	192	NA
	12/19/2024	3.0	<1	<1	<3	<1	<1	<1	164	NA
MW-5	12/21/2016	32	<0.5	16	110	4.68	13.2	NA	104	NA
	3/30/2021	NOT SAMPLED								
	6/30/2022	NOT SAMPLED								
	12/9/2022	NOT SAMPLED								
	7/20/2023	NOT SAMPLED								
	12/5/2023	15.0	4.0	17.0	53.0	5.55	22.4	3.14	108.0	
	7/30/2024	NOT SAMPLED								
	12/19/2024	NOT SAMPLED								
MW-6	3/30/2021	<0.5	<0.5	<0.5	<0.5	<1	<1	<1	48	826
	6/30/2022	<1	<1	<1	<3	<1	<1	<1	124	NA
	12/8/2022	<1	<1	<1	<2	<1	<1	<1	140	
	7/20/2023	<1	<1	<1	<3	<1	<1	<1	72	NA
	12/5/2023	<1	<1	<1	<3	<1	<1	<1	96	NA
	7/30/2024	<1	<1	<1	<3	<1	<1	<1	100	NA
	12/18/2024	<1	<1	<1	<3	<1	<1	<1	68	NA
	3/30/2021	<0.5	<0.5	<0.5	<0.5	<1	<1	<1	380	1464
MW-7	6/30/2022	<1	<1	<1	<3	<1	<1	<1	472	NA
	12/8/2022	<1	<1	<1	<2	<1	<1	<1	480	NA
	7/20/2023	<1	<1	<1	<3	<1	<1	<1	340	NA
	12/5/2023	<1	<1	<1	<3	<1	<1	<1	328	NA
	7/30/2024	<1	<1	<1	<3	<1	<1	<1	376	NA
	12/19/2024	<1	<1	<1	<3	<1	<1	<1	340	NA
	3/30/2021	<0.5	<0.5	<0.5	<0.5	<1	<1	<1	368	1526
	6/30/2022	<1	<1	<1	<3	<1	<1	<1	408	NA
MW-8	12/8/2022	<1	<1	<1	<2	<1	<1	<1	408	NA
	7/20/2023	<1	<1	<1	<3	<1	<1	<1	372	NA
	12/5/2023	<1	<1	<1	<3	<1	<1	<1	348	NA
	7/30/2024	<1	<1	<1	<3	<1	<1	<1	360	NA
	12/19/2024	<1	<1	<1	<3	<1	<1	<1	340	NA
	11/30/2017	<0.5	<0.5	<1	<2	<1	<1	NA	224	974
	SB-14	11/30/2017	<0.5	<0.5	<1	<2	2.44	NA	320	1220
	SB-15	11/30/2017	<0.5	<0.5	1	20	4.19	19.6	72	730
SB-16	11/30/2017	<0.5	<0.5	<1	<2	1.66	2.45	NA	72	664
	SB-17	11/30/2017	<0.5	<0.5	<1	<2	<1	NA	80	600

NOTE:

BTEX = Benzene, Toluene, Ethylbenzene, Total Xylenes

TPH = Total Petroleum Hydrocarbons

TPH-GRO = Total Petroleum Hydrocarbons Gasoline Range Organics

TPH-DRO = Total Petroleum Hydrocarbons Diesel Range Organics

TPH EXT-DRO = Total Petroleum Hydrocarbons Extended Diesel Range Organics

NM WQCC = New Mexico Water Quality Control Commission

NA=not analyzed

µg/L = micrograms per Liter

mg/L = milligrams per Liter

NONE = no NM WQCC Standard for this constituent

BOLD values exceed NM WQCC standards

Sample Identification	Date Sampled	Naphthalene (mg/L)	2-Methylnaphthalene (mg/L)	1-Methylnaphthalene (mg/L)	Acenaphthylene (mg/L)	Acenaphthene (mg/L)	Fluorene (mg/L)	Phenanthrene (mg/L)	Anthracene (mg/L)	Carbazole (mg/L)	Fluoranthene (mg/L)	Pyrene (mg/L)	Benz[a]anthracene (mg/L)	Chrysene (mg/L)	Benz[b]fluoranthene (mg/L)	Benz[k]fluoranthene (mg/L)	Benz[a]pyrene (mg/L)	Indeno[1,2,3-cd]pyrene (mg/L)	Dibenz[a,h]anthracene (mg/L)	Benz[g,h,i]perylene (mg/L)
NM WQCC Standards:																				
MW-1	12/21/2016	<0.002	0.0	0.0	<0.002	0.003	0.002	0.008	0.008	<0.003	<0.002	<0.002	0.003	0.003	<0.004	<0.006	0.0	<0.002	0.002	<0.004
	3/30/2021										NOT SAMPLED									
	6/30/2022										NOT SAMPLED									
	12/8/2022										NOT SAMPLED									
	7/20/2023										NOT SAMPLED									
	12/5/2023	0.002	0.006	0.009	<0.001	<0.001	0.002	0.003	<0.001	<0.001	<0.001	<0.001	<0.001	<0.001	<0.001	<0.001	<0.002	<0.001	<0.001	<0.001
	7/30/2024										NOT SAMPLED									
	12/19/2024										NOT SAMPLED									
	MW-2	12/21/2016										NOT SAMPLED								
3/30/2021											NOT SAMPLED									
6/30/2022											NOT SAMPLED									
12/8/2022											NOT SAMPLED									
7/20/2023											NOT SAMPLED									
12/5/2023		0.009	0.018	0.021	<0.001	<0.001	0.003	0.004	<0.001	0.001	<0.001	<0.001	<0.001	<0.001	<0.001	<0.002	<0.001	<0.001	<0.001	<0.001
7/30/2024											NOT SAMPLED									
12/19/2024											NOT SAMPLED									
MW-3		12/21/2016	<0.0002	<0.0002	<0.0009	<0.0002	<0.0002	<0.0002	<0.0002	<0.0002	<0.0003	<0.0002	<0.0002	<0.0002	<0.0002	<0.0005	<0.0007	<0.0002	<0.0002	<0.0002
	3/30/2021	<0.001	<0.001	<0.0005	<0.001	<0.001	<0.001	<0.001	<0.001	<0.001	<0.001	<0.001	<0.001	<0.001	<0.001	<0.001	<0.001	<0.001	<0.001	<0.001
	6/30/2022	<0.001	<0.001	<0.0005	<0.001	<0.001	<0.001	<0.001	<0.001	<0.001	<0.001	<0.001	<0.001	<0.001	<0.001	<0.001	<0.001	<0.001	<0.001	<0.001
	12/8/2022	<0.001	<0.001	<0.0005	<0.001	<0.001	<0.001	<0.001	<0.001	<0.001	<0.001	<0.001	<0.001	<0.001	<0.001	<0.001	<0.001	<0.001	<0.001	<0.001
	7/20/2023	<0.001	<0.001	<0.0005	<0.001	<0.001	<0.001	<0.001	<0.001	<0.001	<0.001	<0.001	<0.001	<0.001	<0.001	<0.001	<0.001	<0.001	<0.001	<0.001
	12/5/2023	<0.001	<0.001	<0.001	<0.001	<0.001	<0.001	<0.001	<0.001	<0.001	<0.001	<0.001	<0.001	<0.001	<0.001	<0.001	<0.001	<0.001	<0.001	<0.001
	12/5/2023	0.0	0.012	0.015	<0.001	<0.001	0.007	0.0	<0.001	<0.001	<0.001	<0.001	<0.001	0.0	<0.001	<0.001	<0.001	<0.001	<0.001	<0.001

Table 3
Solar Sipper Recovery Summary
Texaco NM State G 4 Battery

Well ID	Date	Amount of LPH (gallons)	Amount of Water (gallons)	Total Fluid (gallons)
MW-1	1/27/2024	3.87	6.11	9.98
	2/24/2024	3.06	10.19	13.25
	3/30/2024	3.46	26.48	29.94
	4/27/2024	3.26	17.31	20.57
	5/25/2024	3.26	18.13	21.39
	6/29/2024	3.46	17.93	21.39
	7/27/2024	1.83	8.35	10.18
	8/31/2024	2.24	20.17	22.41
	9/28/2024	1.43	15.89	17.32
	10/26/2024	1.02	15.28	16.30
	11/30/2024	2.44	17.93	20.37
	12/29/2024	4.69	17.72	22.41
	Year Total	34.02	191.49	225.51
MW-2	1/27/2024	25.08	5.28	30.36
	2/24/2024	17.16	17.16	34.32
	3/30/2024	17.16	27.72	44.88
	4/27/2024	13.20	23.76	36.96
	5/25/2024	14.52	7.92	22.44
	6/29/2024	14.52	26.40	40.92
	7/27/2024	11.88	30.36	42.24
	8/31/2024	0.00	0.00	0.00
	9/28/2024	10.56	10.56	21.12
	10/26/2024	9.24	18.48	27.72
	11/30/2024	13.20	14.52	27.72
	12/29/2024	40.92	47.52	88.44
	Year Total	187.44	229.68	417.12
MW-5	1/27/2024	26.07	4.89	30.96
	2/24/2024	24.44	0.00	24.44
	3/30/2024	20.37	19.35	39.72
	4/27/2024	13.65	17.52	31.17
	5/25/2024	14.46	16.30	30.76
	6/29/2024	13.85	20.78	34.63
	7/27/2024	0.00	0.00	0.00
	8/31/2024	0.00	2.04	2.04
	9/28/2024	0.00	0.00	0.00
	10/26/2024	4.07	31.57	35.64
	11/30/2024	0.20	56.22	56.42
	12/29/2024	1.02	4.89	5.91
	Year Total	118.13	173.56	291.69



Table 4
Monthly Well Vacuuming Summary
Texaco NM State G 4 Battery

Well	Date	Initial Depth to Product (feet)	Initial Depth to Water (feet)	LPH Thickness (feet)	Depth to Product After Vacuuming (feet)	Depth to Water After Vacuuming (feet)	LPH Thickness (feet)
MW-1	1/27/2024	63.90	64.46	0.56	64.05	64.05	0
	2/24/2024	63.83	66.63	2.80	64.22	64.22	0
	3/30/2024	64.17	65.00	0.83	64.35	64.35	0
	4/27/2024	64.02	65.00	0.98	64.2	64.2	0
	5/25/2024	64.05	64.90	0.85	64.2	64.2	0
	6/29/2024	64.00	66.35	2.35	64.4	64.4	0
	7/27/2024	63.87	67.74	3.87	64.45	64.45	0
	8/31/2024	64.10	66.80	2.70	64.5	64.5	0
	9/28/2024	64.92	65.63	0.71	65.1	65.1	0
	10/26/2024	65.55	65.65	0.10	65.7	65.7	0
	11/30/2024	64.18	66.70	2.52	64.5	64.5	0
	12/29/2024	65.48	65.5	0.02	65.5	65.5	0
MW-2	1/27/2024	63.1	65.69	2.59	63.95	63.95	0
	2/24/2024	63.36	65.80	2.44	63.88	63.88	0
	3/30/2024	63.59	65.55	1.96	63.85	63.85	0
	4/27/2024	63.32	65.77	2.45	63.95	63.95	0
	5/25/2024	63.39	65.64	2.25	64	64	0
	6/29/2024	63.4	65.60	2.20	64.05	64.05	0
	7/27/2024	63.61	66.00	2.39	63.1	63.1	0
	8/31/2024	63.03	70.80	7.77	64.2	64.2	0
	9/28/2024	64.4	65.62	1.22	64.9	64.9	0
	10/26/2024	65	65.75	0.75	65.15	65.15	0
	11/30/2024	63.82	65.75	1.93	64.45	64.45	0
	12/29/2024	64.70	69.00	4.30	65.2	65.2	0
MW-5	1/27/2024	62.88	65.89	3.01	63.35	63.35	0.00
	2/24/2024	62.96	65.80	2.84	63.6	63.6	0.00
	3/30/2024	63.20	65.80	2.60	63.6	63.6	0.00
	4/27/2024	63.00	65.95	2.95	63.6	63.6	0.00
	5/25/2024	63.05	65.86	2.81	63.05	63.05	0.00
	6/29/2024	62.95	67.80	4.85	63.8	63.8	0.00
	7/27/2024	62.85	68.83	5.98	63.6	63.6	0.00
	8/31/2024	62.87	68.95	6.08	63.53	63.53	0.00
	9/28/2024	63.70	69.90	6.20	64.1	64.1	0.00
	10/26/2024	64.52	68.33	3.81	65.1	65.1	0.00
	11/30/2024	63.40	66.65	3.25	63.7	63.7	0.00
	12/29/2024	64.7	67.4	2.7	63.7	63.7	0



Figures



Received by OCD: 9/9/2025 9:12:08 AM
Released to Imaging: 9/16/2025 3:33:23 PM

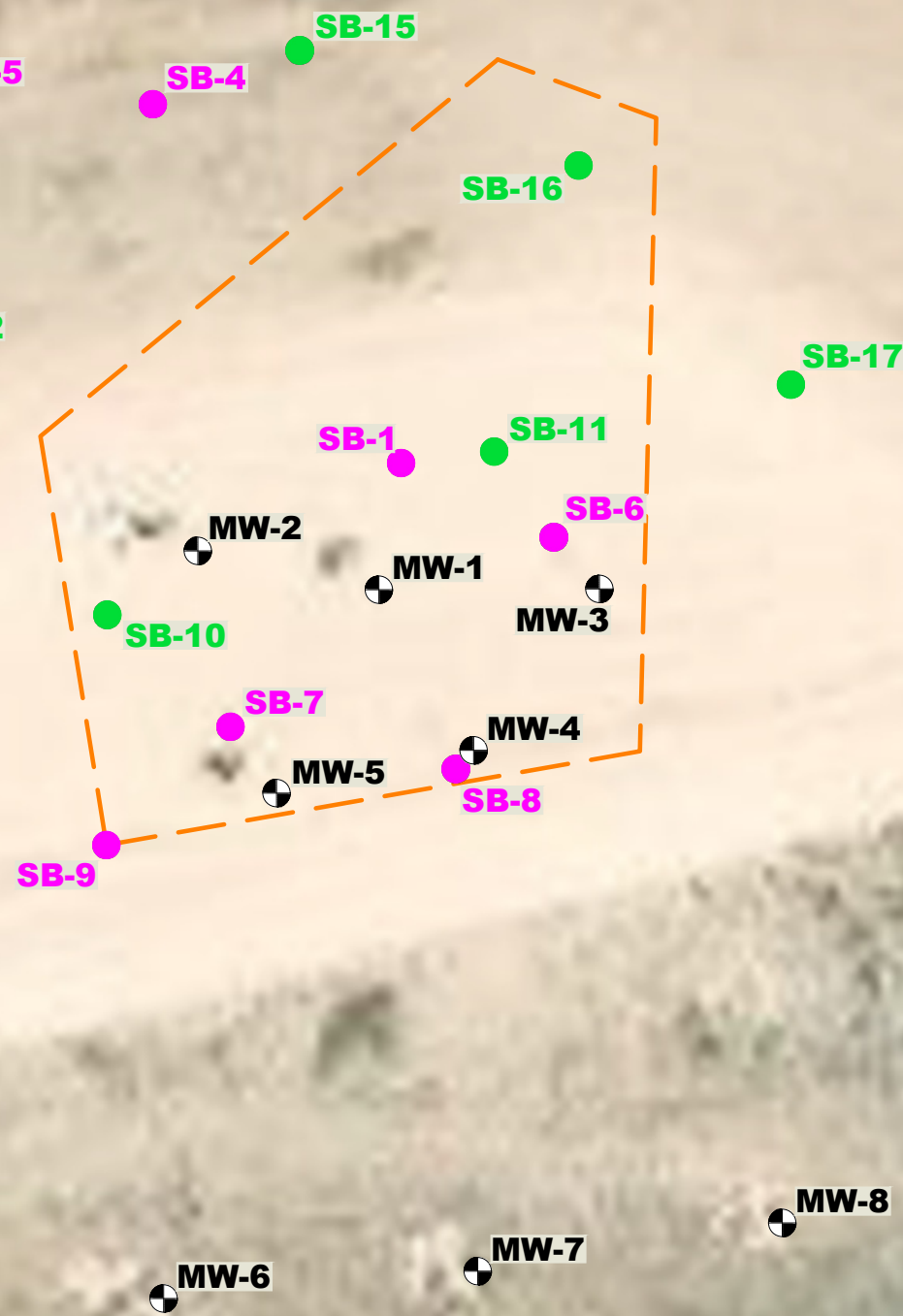
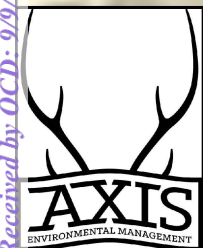

LEGEND

- MONITORING WELL LOCATION
- SOIL BORING LOCATION
- INITIAL SOIL BORING LOCATION
- EXISTING PIT BOUNDARY

NOTES:

- AERIAL SOURCE - ESRI

FIGURE 1
SITE MAP
TEXACO NM STATE G STATE 4 BATTERY
LEA COUNTY, NEW MEXICO
SECTION 18, TOWNSHIP 19 SOUTH, RANGE 37 EAST
PROJ: HESS E & P | DATE: 3/18/2025 | DRAWN BY: JFLAKE

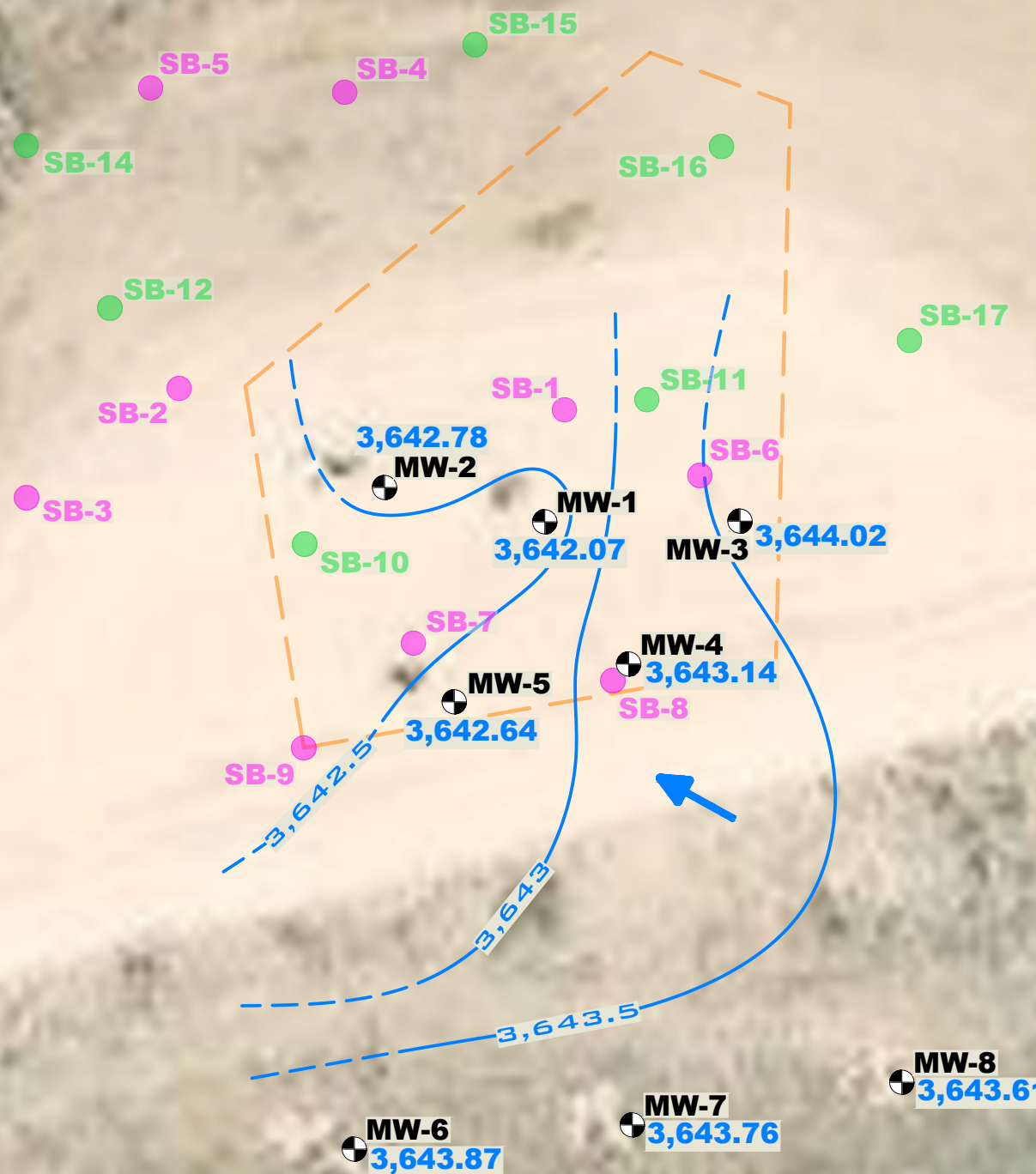

LEGEND

- MONITORING WELL LOCATION
- SOIL BORING LOCATION
- INITIAL SOIL BORING LOCATION
- EXISTING PIT BOUNDARY
- GROUNDWATER ELEVATION
- GROUNDWATER FLOW DIRECTION
- GROUNDWATER CONTOUR LINE
- INFERRED GROUNDWATER CONTOUR LINE

NOTES:
- AERIAL SOURCE - ESRI
- ELEVATION DATA IS DISPLAYED IN FEET ABOVE MEAN SEA LEVEL

FIGURE 2
GROUNDWATER POTENTIOMETRIC MAP
AUGUST 2024
TEXACO NM STATE G STATE 4 BATTERY
LEA COUNTY, NEW MEXICO
SECTION 18, TOWNSHIP 19 SOUTH, RANGE 37 EAST
PROJ: HESS E & P | DATE: 3/19/2025 | DRAWN BY: JFLAKE





LEGEND

- MONITORING WELL LOCATION
- SOIL BORING LOCATION
- INITIAL SOIL BORING LOCATION
- EXISTING PIT BOUNDARY
- GROUNDWATER ELEVATION
- GROUNDWATER FLOW DIRECTION
- GROUNDWATER CONTOUR LINE
- INFERRED GROUNDWATER CONTOUR LINE

NOTES:
- AERIAL SOURCE - ESRI
- ELEVATION DATA IS DISPLAYED IN FEET ABOVE MEAN SEA LEVEL

FIGURE 3
GROUNDWATER POTENTIOMETRIC MAP
DECEMBER 2024
TEXACO NM STATE G STATE 4 BATTERY
LEA COUNTY, NEW MEXICO
SECTION 18, TOWNSHIP 19 SOUTH, RANGE 37 EAST
PROJ: HESS E & P DATE: 3/19/2025 DRAWN BY: JFLAKE

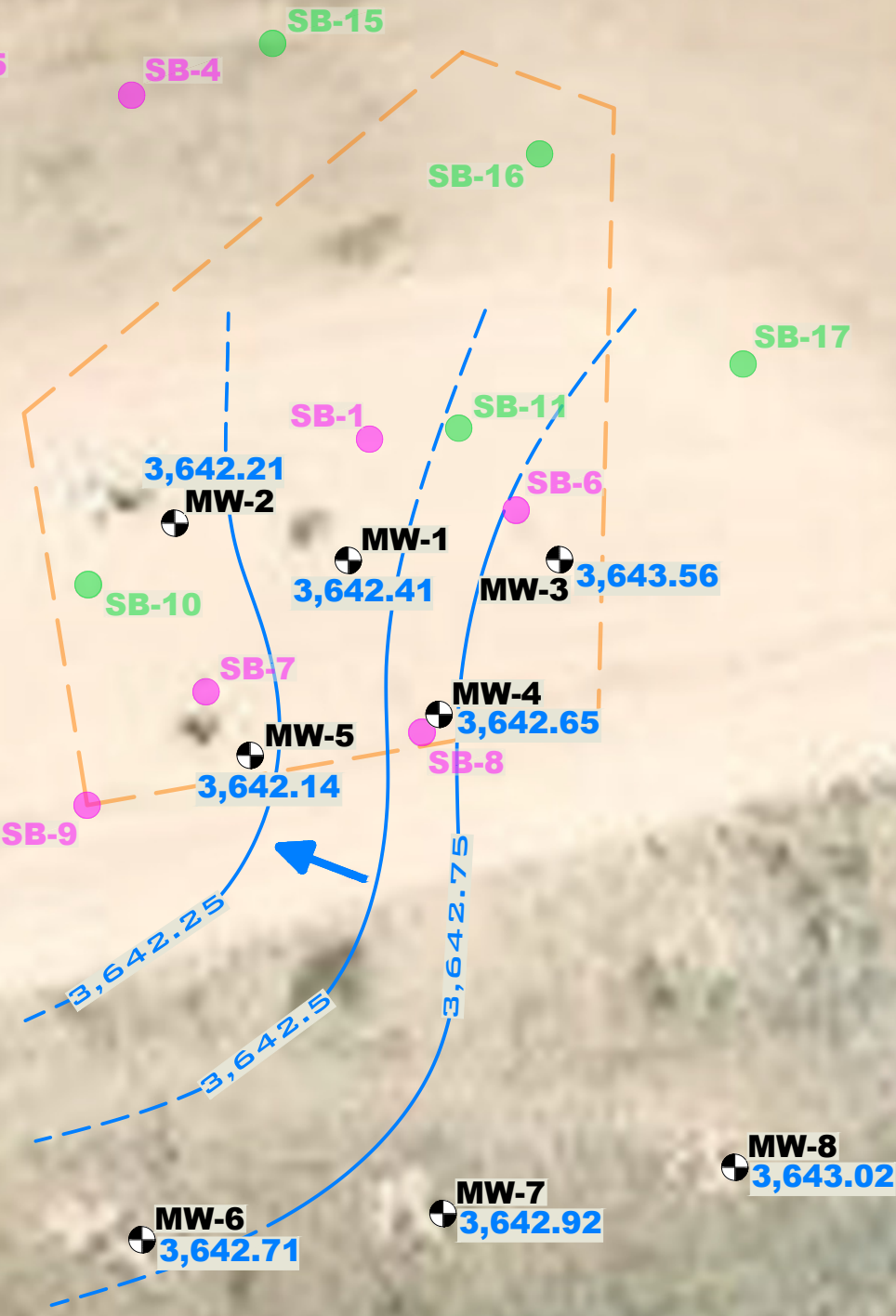

Received by OCD: 9/9/2025 9:12:08 AM

Page 18 of 61

Released to Imaging: 9/16/2025 3:33:23 PM

Page 19 of 61
Received by OCD: 9/9/2025 9:12:08 AM
Released to Imaging: 9/10/2025 3:33:23 PM

New Mexico Water Quality Control Commission Standards	
Benzene in µg/L	10
Toluene in µg/L	750
Ethylbenzene in µg/L	750
Xylenes in µg/L	620
TPH-GRO (C6-C10) in mg/L	None
TPH-DRO (C10-C28) in mg/L	None
TPH EXT-DRO (C28-C36) in mg/L	None
Chloride in mg/L	250
Total Dissolved Solids in mg/L	1,000
1-Methylnaphthalene in mg/L	None
Indeno(1,2,3-cd)pyrene in mg/L	None



WELL ID	MW-2	
SAMPLE DATE	7/30/2024	12/19/2024
No Sample Collected - LPH Present in Well		

WELL ID	MW-1	
SAMPLE DATE	7/30/2024	12/19/2024
No Sample Collected - LPH Present in Well		

WELL ID	MW-3	
SAMPLE DATE	7/30/2024	12/19/2024
No Sample Collected - LPH Present in Well		

WELL ID	MW-5	
SAMPLE DATE	7/30/2024	12/19/2024
No Sample Collected - LPH Present in Well		

WELL ID	MW-4	
SAMPLE DATE	7/30/2024	12/19/2024
Benzene in µg/L	6.0	3.0
Toluene in µg/L	<1	<1
Ethylbenzene in µg/L	4.0	<1
Xylenes in µg/L	4.0	<3
TPH-GRO (C6-C10) in mg/L	<1	<1
TPH-DRO (C10-C28) in mg/L	<1	<1
TPH EXT-DRO (C28-C36) in mg/L	<1	<1
Chloride in mg/L	192	164
Total Dissolved Solids in mg/L	NA	NA
1-Methylnaphthalene in mg/L	0.003	<0.0005
Indeno(1,2,3-cd)pyrene in mg/L	<0.001	0.002

WELL ID	MW-7	
SAMPLE DATE	7/30/2024	12/19/2024
Benzene in µg/L	<1	<1
Toluene in µg/L	<1	<1
Ethylbenzene in µg/L	<1	<1
Xylenes in µg/L	<3	<3
TPH-GRO (C6-C10) in mg/L	<1	<1
TPH-DRO (C10-C28) in mg/L	<1	<1
TPH EXT-DRO (C28-C36) in mg/L	<1	<1
Chloride in mg/L	376	340
Total Dissolved Solids in mg/L	NA	NA

WELL ID	MW-6	
SAMPLE DATE	7/30/2024	12/18/2024
Benzene in µg/L	<1	<1
Toluene in µg/L	<1	<1
Ethylbenzene in µg/L	<1	<1
Xylenes in µg/L	<3	<3
TPH-GRO (C6-C10) in mg/L	<1	<1
TPH-DRO (C10-C28) in mg/L	<1	<1
TPH EXT-DRO (C28-C36) in mg/L	<1	<1
Chloride in mg/L	100	68
Total Dissolved Solids in mg/L	NA	NA

WELL ID	MW-8	
SAMPLE DATE	7/30/2024	12/19/2024
Benzene in µg/L	<1	<1
Toluene in µg/L	<1	<1
Ethylbenzene in µg/L	<1	<1
Xylenes in µg/L	<3	<3
TPH-GRO (C6-C10) in mg/L	<1	<1
TPH-DRO (C10-C28) in mg/L	<1	<1
TPH EXT-DRO (C28-C36) in mg/L	<1	<1
Chloride in mg/L	360	340
Total Dissolved Solids in mg/L	NA	NA

LEGEND

MONITORING WELL LOCATION

SOIL BORING LOCATION

INITIAL SOIL BORING LOCATION

EXISTING PIT BOUNDARY

NOT ANALYZED

LIQUID PHASE HYDROCARBON

NOTES:
- AERIAL SOURCE - ESRI
- FOR EACH SAMPLE COLLECTED. BTEX, TPH, CHLORIDE, AND TOTAL DISSOLVED SOLIDS DATA IS DISPLAYED. FOR PAH's, ONLY CONSTITUENTS WHICH WERE DETECTED ARE DISPLAYED.

FIGURE 4
GROUNDWATER ANALYTICAL MAP - 2024
TEXACO NM STATE G STATE 4 BATTERY
LEA COUNTY, NEW MEXICO
SECTION 18, TOWNSHIP 19 SOUTH, RANGE 37 EAST
PROJ: HESS E & P DATE: 3/19/2025 DRAWN BY: JFLAKE



Attachment 1

Laboratory Analytical Report



PHONE (575) 393-2326 ° 101 E. MARLAND ° HOBBS, NM 88240

August 12, 2024

BRAD FREEMAN

AXIS ENVIROMENTAL

121 INDIAN RIDGE RD

BELTON, TX 76513

RE: G STATE 4

Enclosed are the results of analyses for samples received by the laboratory on 07/30/24 10:50.

Cardinal Laboratories is accredited through Texas NELAP under certificate number TX-C24-00112. Accreditation applies to drinking water, non-potable water and solid and chemical materials. All accredited analytes are denoted by an asterisk (*). For a complete list of accredited analytes and matrices visit the TCEQ website at

www.tceq.texas.gov/field/ga/lab_accred_certif.html.

Cardinal Laboratories is accredited through the State of Colorado Department of Public Health and Environment for:

Method EPA 552.2	Total Haloacetic Acids (HAA-5)
Method EPA 524.2	Total Trihalomethanes (TTHM)
Method EPA 524.4	Regulated VOCs (V1, V2, V3)

Cardinal Laboratories is accredited through the State of New Mexico Environment Department for:

Method SM 9223-B	Total Coliform and E. coli (Colilert MMO-MUG)
Method EPA 524.2	Regulated VOCs and Total Trihalomethanes (TTHM)
Method EPA 552.2	Total Haloacetic Acids (HAA-5)

Accreditation applies to public drinking water matrices for State of Colorado and New Mexico.

This report meets NELAP requirements and is made up of a cover page, analytical results, and a copy of the original chain-of-custody. If you have any questions concerning this report, please feel free to contact me.

Sincerely,

A handwritten signature in black ink that reads "Celey D. Keene".

Celey D. Keene

Lab Director/Quality Manager



PHONE (575) 393-2326 ° 101 E. MARLAND ° HOBBS, NM 88240

Analytical Results For:AXIS ENVIROMENTAL
121 INDIAN RIDGE RD
BELTON TX, 76513Project: G STATE 4
Project Number: NONE GIVEN
Project Manager: BRAD FREEMAN
Fax To:Reported:
12-Aug-24 13:24

Sample ID	Laboratory ID	Matrix	Date Sampled	Date Received
MW 4	H244522-01	Water	30-Jul-24 08:40	30-Jul-24 10:50
MW 6	H244522-02	Water	30-Jul-24 06:15	30-Jul-24 10:50
MW 7	H244522-03	Water	30-Jul-24 07:05	30-Jul-24 10:50
MW 8	H244522-04	Water	30-Jul-24 07:50	30-Jul-24 10:50

Cardinal Laboratories

*=Accredited Analyte

PLEASE NOTE: Liability and Damages. Cardinal's liability and client's exclusive remedy for any claim arising, whether based in contract or tort, shall be limited to the amount paid by client for analyses. All claims, including those for negligence or any other cause whatsoever shall be deemed waived unless made in writing and received by Cardinal within thirty (30) days after completion of the applicable service. In no event shall Cardinal be liable for incidental or consequential damage including, without limitation, business interruptions, loss of use, or loss of profits incurred by client, its subsidiaries, affiliates or successors arising out of or related to the performance of the services hereunder by Cardinal, regardless of whether such claim is based upon any of the above stated reasons or otherwise. Results relate only to the samples identified above. This report shall not be reproduced except in full with written approval of Cardinal Laboratories.

Celey D. Keene, Lab Director/Quality Manager



PHONE (575) 393-2326 ° 101 E. MARLAND ° HOBBS, NM 88240

Analytical Results For:

AXIS ENVIROMENTAL
121 INDIAN RIDGE RD
BELTON TX, 76513

Project: G STATE 4
Project Number: NONE GIVEN
Project Manager: BRAD FREEMAN
Fax To:

Reported:
12-Aug-24 13:24

MW 4
H244522-01 (Water)

Analyte	Result	MDL	Reporting Limit	Units	Dilution	Batch	Analyst	Analyzed	Method	Notes
---------	--------	-----	-----------------	-------	----------	-------	---------	----------	--------	-------

Cardinal Laboratories**Inorganic Compounds**

Chloride*	192		4.00	mg/L	1	4072601	AC	30-Jul-24	4500-Cl-B	
------------------	------------	--	------	------	---	---------	----	-----------	-----------	--

Volatile Organic Compounds by EPA Method 8021

Benzene*	0.006		0.001	mg/L	1	4072622	JH	30-Jul-24	8021B	
Toluene*	<0.001		0.001	mg/L	1	4072622	JH	30-Jul-24	8021B	GC-NC
Ethylbenzene*	0.004		0.001	mg/L	1	4072622	JH	30-Jul-24	8021B	
Total Xylenes*	0.004		0.003	mg/L	1	4072622	JH	30-Jul-24	8021B	GC-NC1
Total BTEX	0.014		0.006	mg/L	1	4072622	JH	30-Jul-24	8021B	GC-NC1

Surrogate: 4-Bromofluorobenzene (PID) 116 % 77.5-125 4072622 JH 30-Jul-24 8021B

Petroleum Hydrocarbons by GC FID

GRO C6-C10*	<1.00		1.00	mg/L	0.1	4073006	MS	03-Aug-24	8015B	
DRO >C10-C28*	<1.00		1.00	mg/L	0.1	4073006	MS	04-Aug-24	8015B	
EXT DRO >C28-C36	<1.00		1.00	mg/L	0.1	4073006	MS	03-Aug-24	8015B	

Surrogate: 1-Chlorooctane 60.2 % 52.1-131 4073006 MS 03-Aug-24 8015B

Surrogate: 1-Chlorooctadecane 78.0 % 44.6-140 4073006 MS 04-Aug-24 8015B

Polynuclear Aromatic Compounds by GC/MS

Naphthalene*	<0.001		0.001	mg/L	1.03	4073020	MS	09-Aug-24	8270C	
2-Methylnaphthalene*	<0.001		0.001	mg/L	1.03	4073020	MS	09-Aug-24	8270C	
1-Methylnaphthalene	0.003		0.0005	mg/L	1.03	4073020	MS	09-Aug-24	8270C	
Acenaphthylene*	<0.001		0.001	mg/L	1.03	4073020	MS	09-Aug-24	8270C	
Acenaphthene*	<0.001		0.001	mg/L	1.03	4073020	MS	09-Aug-24	8270C	
Fluorene*	<0.001		0.001	mg/L	1.03	4073020	MS	09-Aug-24	8270C	
Phenanthrene*	<0.001		0.001	mg/L	1.03	4073020	MS	09-Aug-24	8270C	
Anthracene*	<0.001		0.001	mg/L	1.03	4073020	MS	09-Aug-24	8270C	
Carbazole*	<0.001		0.001	mg/L	1.03	4073020	MS	09-Aug-24	8270C	
Fluoranthene*	<0.001		0.001	mg/L	1.03	4073020	MS	09-Aug-24	8270C	
Pyrene*	<0.001		0.001	mg/L	1.03	4073020	MS	09-Aug-24	8270C	

Cardinal Laboratories

*=Accredited Analyte

PLEASE NOTE: Liability and Damages. Cardinal's liability and client's exclusive remedy for any claim arising, whether based in contract or tort, shall be limited to the amount paid by client for analyses. All claims, including those for negligence or any other cause whatsoever shall be deemed waived unless made in writing and received by Cardinal within thirty (30) days after completion of the applicable service. In no event shall Cardinal be liable for incidental or consequential damage including, without limitation, business interruptions, loss of use, or loss of profits incurred by client, its subsidiaries, affiliates or successors arising out of or related to the performance of the services hereunder by Cardinal, regardless of whether such claim is based upon any of the above stated reasons or otherwise. Results relate only to the samples identified above. This report shall not be reproduced except in full with written approval of Cardinal Laboratories.

Celey D. Keene, Lab Director/Quality Manager



PHONE (575) 393-2326 ° 101 E. MARLAND ° HOBBS, NM 88240

Analytical Results For:

AXIS ENVIROMENTAL
121 INDIAN RIDGE RD
BELTON TX, 76513

Project: G STATE 4
Project Number: NONE GIVEN
Project Manager: BRAD FREEMAN
Fax To:

Reported:
12-Aug-24 13:24

MW 4**H244522-01 (Water)**

Analyte	Result	MDL	Reporting Limit	Units	Dilution	Batch	Analyst	Analyzed	Method	Notes
---------	--------	-----	-----------------	-------	----------	-------	---------	----------	--------	-------

Cardinal Laboratories**Polynuclear Aromatic Compounds by GC/MS**

Benzo[a]anthracene*	<0.001		0.001	mg/L	1.03	4073020	MS	09-Aug-24	8270C	
Chrysene*	<0.001		0.001	mg/L	1.03	4073020	MS	09-Aug-24	8270C	
Benzo[b]flouranthene*	<0.001		0.001	mg/L	1.03	4073020	MS	09-Aug-24	8270C	
Benzo[k]flouranthene*	<0.001		0.001	mg/L	1.03	4073020	MS	09-Aug-24	8270C	
Benzo[a]pyrene*	<0.0002		0.0002	mg/L	1.03	4073020	MS	09-Aug-24	8270C	
Indeno[1,2,3-cd]pyrene*	<0.001		0.001	mg/L	1.03	4073020	MS	09-Aug-24	8270C	
Dibenz[a,h]anthracene*	<0.001		0.001	mg/L	1.03	4073020	MS	09-Aug-24	8270C	
Benzo[g,h,i]perylene*	<0.001		0.001	mg/L	1.03	4073020	MS	09-Aug-24	8270C	
Surrogate: Nitrobenzene-d5			66.2 %	5.17-184		4073020	MS	09-Aug-24	8270C	
Surrogate: 2-Fluorobiphenyl			51.2 %	7.39-192		4073020	MS	09-Aug-24	8270C	
Surrogate: Terphenyl-d14			59.5 %	27.5-139		4073020	MS	09-Aug-24	8270C	

Cardinal Laboratories

*=Accredited Analyte

PLEASE NOTE: Liability and Damages. Cardinal's liability and client's exclusive remedy for any claim arising, whether based in contract or tort, shall be limited to the amount paid by client for analyses. All claims, including those for negligence or any other cause whatsoever shall be deemed waived unless made in writing and received by Cardinal within thirty (30) days after completion of the applicable service. In no event shall Cardinal be liable for incidental or consequential damage including, without limitation, business interruptions, loss of use, or loss of profits incurred by client, its subsidiaries, affiliates or successors arising out of or related to the performance of the services hereunder by Cardinal, regardless of whether such claim is based upon any of the above stated reasons or otherwise. Results relate only to the samples identified above. This report shall not be reproduced except in full with written approval of Cardinal Laboratories.

Celey D. Keene, Lab Director/Quality Manager



PHONE (575) 393-2326 ° 101 E. MARLAND ° HOBBS, NM 88240

Analytical Results For:

AXIS ENVIROMENTAL
121 INDIAN RIDGE RD
BELTON TX, 76513

Project: G STATE 4
Project Number: NONE GIVEN
Project Manager: BRAD FREEMAN
Fax To:

Reported:
12-Aug-24 13:24

MW 6**H244522-02 (Water)**

Analyte	Result	MDL	Reporting Limit	Units	Dilution	Batch	Analyst	Analyzed	Method	Notes
---------	--------	-----	-----------------	-------	----------	-------	---------	----------	--------	-------

Cardinal Laboratories**Inorganic Compounds**

Chloride*	100		4.00	mg/L	1	4073017	AC	30-Jul-24	4500-Cl-B	
-----------	-----	--	------	------	---	---------	----	-----------	-----------	--

Volatile Organic Compounds by EPA Method 8021

Benzene*	<0.001		0.001	mg/L	1	4072622	JH	30-Jul-24	8021B	
Toluene*	<0.001		0.001	mg/L	1	4072622	JH	30-Jul-24	8021B	
Ethylbenzene*	<0.001		0.001	mg/L	1	4072622	JH	30-Jul-24	8021B	
Total Xylenes*	<0.003		0.003	mg/L	1	4072622	JH	30-Jul-24	8021B	
Total BTEX	<0.006		0.006	mg/L	1	4072622	JH	30-Jul-24	8021B	

Surrogate: 4-Bromofluorobenzene (PID) 112 % 77.5-125 4072622 JH 30-Jul-24 8021B

Petroleum Hydrocarbons by GC FID

GRO C6-C10*	<1.00		1.00	mg/L	0.1	4073006	MS	03-Aug-24	8015B	
DRO >C10-C28*	<1.00		1.00	mg/L	0.1	4073006	MS	03-Aug-24	8015B	
EXT DRO >C28-C36	<1.00		1.00	mg/L	0.1	4073006	MS	03-Aug-24	8015B	

Surrogate: 1-Chlorooctane 67.3 % 52.1-131 4073006 MS 03-Aug-24 8015B

Surrogate: 1-Chlorooctadecane 80.0 % 44.6-140 4073006 MS 03-Aug-24 8015B

Polynuclear Aromatic Compounds by GC/MS

Naphthalene*	<0.001		0.001	mg/L	0.99	4073020	MS	09-Aug-24	8270C	
2-Methylnaphthalene*	<0.001		0.001	mg/L	0.99	4073020	MS	09-Aug-24	8270C	
1-Methylnaphthalene	<0.0005		0.0005	mg/L	0.99	4073020	MS	09-Aug-24	8270C	
Acenaphthylene*	<0.001		0.001	mg/L	0.99	4073020	MS	09-Aug-24	8270C	
Acenaphthene*	<0.001		0.001	mg/L	0.99	4073020	MS	09-Aug-24	8270C	
Fluorene*	<0.001		0.001	mg/L	0.99	4073020	MS	09-Aug-24	8270C	
Phenanthrene*	<0.001		0.001	mg/L	0.99	4073020	MS	09-Aug-24	8270C	
Anthracene*	<0.001		0.001	mg/L	0.99	4073020	MS	09-Aug-24	8270C	
Carbazole*	<0.001		0.001	mg/L	0.99	4073020	MS	09-Aug-24	8270C	
Fluoranthene*	<0.001		0.001	mg/L	0.99	4073020	MS	09-Aug-24	8270C	
Pyrene*	<0.001		0.001	mg/L	0.99	4073020	MS	09-Aug-24	8270C	
Benzo[a]anthracene*	<0.001		0.001	mg/L	0.99	4073020	MS	09-Aug-24	8270C	

Cardinal Laboratories

*=Accredited Analyte

PLEASE NOTE: Liability and Damages. Cardinal's liability and client's exclusive remedy for any claim arising, whether based in contract or tort, shall be limited to the amount paid by client for analyses. All claims, including those for negligence or any other cause whatsoever shall be deemed waived unless made in writing and received by Cardinal within thirty (30) days after completion of the applicable service. In no event shall Cardinal be liable for incidental or consequential damage including, without limitation, business interruptions, loss of use, or loss of profits incurred by client, its subsidiaries, affiliates or successors arising out of or related to the performance of the services hereunder by Cardinal, regardless of whether such claim is based upon any of the above stated reasons or otherwise. Results relate only to the samples identified above. This report shall not be reproduced except in full with written approval of Cardinal Laboratories.

Celey D. Keene, Lab Director/Quality Manager



PHONE (575) 393-2326 ° 101 E. MARLAND ° HOBBS, NM 88240

Analytical Results For:

AXIS ENVIROMENTAL
121 INDIAN RIDGE RD
BELTON TX, 76513

Project: G STATE 4
Project Number: NONE GIVEN
Project Manager: BRAD FREEMAN
Fax To:

Reported:
12-Aug-24 13:24

MW 6**H244522-02 (Water)**

Analyte	Result	MDL	Reporting Limit	Units	Dilution	Batch	Analyst	Analyzed	Method	Notes
---------	--------	-----	-----------------	-------	----------	-------	---------	----------	--------	-------

Cardinal Laboratories**Polynuclear Aromatic Compounds by GC/MS**

Chrysene*	<0.001		0.001	mg/L	0.99	4073020	MS	09-Aug-24	8270C	
Benzo[b]flouranthene*	<0.001		0.001	mg/L	0.99	4073020	MS	09-Aug-24	8270C	
Benzo[k]flouranthene*	<0.001		0.001	mg/L	0.99	4073020	MS	09-Aug-24	8270C	
Benzo[a]pyrene*	<0.0002		0.0002	mg/L	0.99	4073020	MS	09-Aug-24	8270C	
Indeno[1,2,3-cd]pyrene*	<0.001		0.001	mg/L	0.99	4073020	MS	09-Aug-24	8270C	
Dibenz[a,h]anthracene*	<0.001		0.001	mg/L	0.99	4073020	MS	09-Aug-24	8270C	
Benzo[g,h,i]perylene*	<0.001		0.001	mg/L	0.99	4073020	MS	09-Aug-24	8270C	
Surrogate: Nitrobenzene-d5			55.8 %	5.17-184		4073020	MS	09-Aug-24	8270C	
Surrogate: 2-Fluorobiphenyl			49.7 %	7.39-192		4073020	MS	09-Aug-24	8270C	
Surrogate: Terphenyl-d14			57.6 %	27.5-139		4073020	MS	09-Aug-24	8270C	

Cardinal Laboratories

*=Accredited Analyte

PLEASE NOTE: Liability and Damages. Cardinal's liability and client's exclusive remedy for any claim arising, whether based in contract or tort, shall be limited to the amount paid by client for analyses. All claims, including those for negligence or any other cause whatsoever shall be deemed waived unless made in writing and received by Cardinal within thirty (30) days after completion of the applicable service. In no event shall Cardinal be liable for incidental or consequential damage including, without limitation, business interruptions, loss of use, or loss of profits incurred by client, its subsidiaries, affiliates or successors arising out of or related to the performance of the services hereunder by Cardinal, regardless of whether such claim is based upon any of the above stated reasons or otherwise. Results relate only to the samples identified above. This report shall not be reproduced except in full with written approval of Cardinal Laboratories.

Celey D. Keene, Lab Director/Quality Manager



PHONE (575) 393-2326 ° 101 E. MARLAND ° HOBBS, NM 88240

Analytical Results For:

AXIS ENVIROMENTAL
121 INDIAN RIDGE RD
BELTON TX, 76513

Project: G STATE 4
Project Number: NONE GIVEN
Project Manager: BRAD FREEMAN
Fax To:

Reported:
12-Aug-24 13:24

MW 7**H244522-03 (Water)**

Analyte	Result	MDL	Reporting Limit	Units	Dilution	Batch	Analyst	Analyzed	Method	Notes
---------	--------	-----	-----------------	-------	----------	-------	---------	----------	--------	-------

Cardinal Laboratories**Inorganic Compounds**

Chloride*	376		4.00	mg/L	1	4073017	AC	30-Jul-24	4500-Cl-B	
-----------	-----	--	------	------	---	---------	----	-----------	-----------	--

Volatile Organic Compounds by EPA Method 8021

Benzene*	<0.001		0.001	mg/L	1	4072622	JH	30-Jul-24	8021B	
Toluene*	<0.001		0.001	mg/L	1	4072622	JH	30-Jul-24	8021B	
Ethylbenzene*	<0.001		0.001	mg/L	1	4072622	JH	30-Jul-24	8021B	
Total Xylenes*	<0.003		0.003	mg/L	1	4072622	JH	30-Jul-24	8021B	
Total BTEX	<0.006		0.006	mg/L	1	4072622	JH	30-Jul-24	8021B	

Surrogate: 4-Bromofluorobenzene (PID) 110 % 77.5-125 4072622 JH 30-Jul-24 8021B

Petroleum Hydrocarbons by GC FID

GRO C6-C10*	<1.00		1.00	mg/L	0.1	4073006	MS	12-Aug-24	8015B	
DRO >C10-C28*	<1.00		1.00	mg/L	0.1	4073006	MS	12-Aug-24	8015B	
EXT DRO >C28-C36	<1.00		1.00	mg/L	0.1	4073006	MS	12-Aug-24	8015B	

Surrogate: 1-Chlorooctane 86.3 % 52.1-131 4073006 MS 12-Aug-24 8015B

Surrogate: 1-Chlorooctadecane 103 % 44.6-140 4073006 MS 12-Aug-24 8015B

Polynuclear Aromatic Compounds by GC/MS

Naphthalene*	<0.001		0.001	mg/L	0.98	4073020	MS	09-Aug-24	8270C	
2-Methylnaphthalene*	<0.001		0.001	mg/L	0.98	4073020	MS	09-Aug-24	8270C	
1-Methylnaphthalene	<0.0005		0.0005	mg/L	0.98	4073020	MS	09-Aug-24	8270C	
Acenaphthylene*	<0.001		0.001	mg/L	0.98	4073020	MS	09-Aug-24	8270C	
Acenaphthene*	<0.001		0.001	mg/L	0.98	4073020	MS	09-Aug-24	8270C	
Fluorene*	<0.001		0.001	mg/L	0.98	4073020	MS	09-Aug-24	8270C	
Phenanthrene*	<0.001		0.001	mg/L	0.98	4073020	MS	09-Aug-24	8270C	
Anthracene*	<0.001		0.001	mg/L	0.98	4073020	MS	09-Aug-24	8270C	
Carbazole*	<0.001		0.001	mg/L	0.98	4073020	MS	09-Aug-24	8270C	
Fluoranthene*	<0.001		0.001	mg/L	0.98	4073020	MS	09-Aug-24	8270C	
Pyrene*	<0.001		0.001	mg/L	0.98	4073020	MS	09-Aug-24	8270C	
Benzo[a]anthracene*	<0.001		0.001	mg/L	0.98	4073020	MS	09-Aug-24	8270C	

Cardinal Laboratories

*=Accredited Analyte

PLEASE NOTE: Liability and Damages. Cardinal's liability and client's exclusive remedy for any claim arising, whether based in contract or tort, shall be limited to the amount paid by client for analyses. All claims, including those for negligence or any other cause whatsoever shall be deemed waived unless made in writing and received by Cardinal within thirty (30) days after completion of the applicable service. In no event shall Cardinal be liable for incidental or consequential damage including, without limitation, business interruptions, loss of use, or loss of profits incurred by client, its subsidiaries, affiliates or successors arising out of or related to the performance of the services hereunder by Cardinal, regardless of whether such claim is based upon any of the above stated reasons or otherwise. Results relate only to the samples identified above. This report shall not be reproduced except in full with written approval of Cardinal Laboratories.

Celey D. Keene, Lab Director/Quality Manager



PHONE (575) 393-2326 ° 101 E. MARLAND ° HOBBS, NM 88240

Analytical Results For:

AXIS ENVIROMENTAL
121 INDIAN RIDGE RD
BELTON TX, 76513

Project: G STATE 4
Project Number: NONE GIVEN
Project Manager: BRAD FREEMAN
Fax To:

Reported:
12-Aug-24 13:24

MW 7**H244522-03 (Water)**

Analyte	Result	MDL	Reporting Limit	Units	Dilution	Batch	Analyst	Analyzed	Method	Notes
---------	--------	-----	-----------------	-------	----------	-------	---------	----------	--------	-------

Cardinal Laboratories**Polynuclear Aromatic Compounds by GC/MS**

Chrysene*	<0.001		0.001	mg/L	0.98	4073020	MS	09-Aug-24	8270C	
Benzo[b]flouranthene*	<0.001		0.001	mg/L	0.98	4073020	MS	09-Aug-24	8270C	
Benzo[k]flouranthene*	<0.001		0.001	mg/L	0.98	4073020	MS	09-Aug-24	8270C	
Benzo[a]pyrene*	<0.0002		0.0002	mg/L	0.98	4073020	MS	09-Aug-24	8270C	
Indeno[1,2,3-cd]pyrene*	<0.001		0.001	mg/L	0.98	4073020	MS	09-Aug-24	8270C	
Dibenz[a,h]anthracene*	<0.001		0.001	mg/L	0.98	4073020	MS	09-Aug-24	8270C	
Benzo[g,h,i]perylene*	<0.001		0.001	mg/L	0.98	4073020	MS	09-Aug-24	8270C	
Surrogate: Nitrobenzene-d5			68.1 %	5.17-184		4073020	MS	09-Aug-24	8270C	
Surrogate: 2-Fluorobiphenyl			63.6 %	7.39-192		4073020	MS	09-Aug-24	8270C	
Surrogate: Terphenyl-d14			78.1 %	27.5-139		4073020	MS	09-Aug-24	8270C	

Cardinal Laboratories

*=Accredited Analyte

PLEASE NOTE: Liability and Damages. Cardinal's liability and client's exclusive remedy for any claim arising, whether based in contract or tort, shall be limited to the amount paid by client for analyses. All claims, including those for negligence or any other cause whatsoever shall be deemed waived unless made in writing and received by Cardinal within thirty (30) days after completion of the applicable service. In no event shall Cardinal be liable for incidental or consequential damage including, without limitation, business interruptions, loss of use, or loss of profits incurred by client, its subsidiaries, affiliates or successors arising out of or related to the performance of the services hereunder by Cardinal, regardless of whether such claim is based upon any of the above stated reasons or otherwise. Results relate only to the samples identified above. This report shall not be reproduced except in full with written approval of Cardinal Laboratories.

Celey D. Keene, Lab Director/Quality Manager



PHONE (575) 393-2326 ° 101 E. MARLAND ° HOBBS, NM 88240

Analytical Results For:

AXIS ENVIROMENTAL
121 INDIAN RIDGE RD
BELTON TX, 76513

Project: G STATE 4
Project Number: NONE GIVEN
Project Manager: BRAD FREEMAN
Fax To:

Reported:
12-Aug-24 13:24

MW 8**H244522-04 (Water)**

Analyte	Result	MDL	Reporting Limit	Units	Dilution	Batch	Analyst	Analyzed	Method	Notes
---------	--------	-----	-----------------	-------	----------	-------	---------	----------	--------	-------

Cardinal Laboratories**Inorganic Compounds**

Chloride*	360		4.00	mg/L	1	4073017	AC	30-Jul-24	4500-Cl-B	
-----------	-----	--	------	------	---	---------	----	-----------	-----------	--

Volatile Organic Compounds by EPA Method 8021

Benzene*	<0.001		0.001	mg/L	1	4072622	JH	30-Jul-24	8021B	
Toluene*	<0.001		0.001	mg/L	1	4072622	JH	30-Jul-24	8021B	
Ethylbenzene*	<0.001		0.001	mg/L	1	4072622	JH	30-Jul-24	8021B	
Total Xylenes*	<0.003		0.003	mg/L	1	4072622	JH	30-Jul-24	8021B	
Total BTEX	<0.006		0.006	mg/L	1	4072622	JH	30-Jul-24	8021B	

Surrogate: 4-Bromofluorobenzene (PID) 109 % 77.5-125 4072622 JH 30-Jul-24 8021B

Petroleum Hydrocarbons by GC FID

GRO C6-C10*	<1.00		1.00	mg/L	0.1	4073006	MS	03-Aug-24	8015B	
DRO >C10-C28*	<1.00		1.00	mg/L	0.1	4073006	MS	03-Aug-24	8015B	
EXT DRO >C28-C36	<1.00		1.00	mg/L	0.1	4073006	MS	03-Aug-24	8015B	

Surrogate: 1-Chlorooctane 70.1 % 52.1-131 4073006 MS 03-Aug-24 8015B

Surrogate: 1-Chlorooctadecane 83.2 % 44.6-140 4073006 MS 03-Aug-24 8015B

Polynuclear Aromatic Compounds by GC/MS

Naphthalene*	<0.001		0.001	mg/L	1.01	4073020	MS	09-Aug-24	8270C	
2-Methylnaphthalene*	<0.001		0.001	mg/L	1.01	4073020	MS	09-Aug-24	8270C	
1-Methylnaphthalene	<0.0005		0.0005	mg/L	1.01	4073020	MS	09-Aug-24	8270C	
Acenaphthylene*	<0.001		0.001	mg/L	1.01	4073020	MS	09-Aug-24	8270C	
Acenaphthene*	<0.001		0.001	mg/L	1.01	4073020	MS	09-Aug-24	8270C	
Fluorene*	<0.001		0.001	mg/L	1.01	4073020	MS	09-Aug-24	8270C	
Phenanthrene*	<0.001		0.001	mg/L	1.01	4073020	MS	09-Aug-24	8270C	
Anthracene*	<0.001		0.001	mg/L	1.01	4073020	MS	09-Aug-24	8270C	
Carbazole*	<0.001		0.001	mg/L	1.01	4073020	MS	09-Aug-24	8270C	
Fluoranthene*	<0.001		0.001	mg/L	1.01	4073020	MS	09-Aug-24	8270C	
Pyrene*	<0.001		0.001	mg/L	1.01	4073020	MS	09-Aug-24	8270C	
Benzo[a]anthracene*	<0.001		0.001	mg/L	1.01	4073020	MS	09-Aug-24	8270C	

Cardinal Laboratories

*=Accredited Analyte

PLEASE NOTE: Liability and Damages. Cardinal's liability and client's exclusive remedy for any claim arising, whether based in contract or tort, shall be limited to the amount paid by client for analyses. All claims, including those for negligence or any other cause whatsoever shall be deemed waived unless made in writing and received by Cardinal within thirty (30) days after completion of the applicable service. In no event shall Cardinal be liable for incidental or consequential damage including, without limitation, business interruptions, loss of use, or loss of profits incurred by client, its subsidiaries, affiliates or successors arising out of or related to the performance of the services hereunder by Cardinal, regardless of whether such claim is based upon any of the above stated reasons or otherwise. Results relate only to the samples identified above. This report shall not be reproduced except in full with written approval of Cardinal Laboratories.

Celey D. Keene, Lab Director/Quality Manager



PHONE (575) 393-2326 ° 101 E. MARLAND ° HOBBS, NM 88240

Analytical Results For:

AXIS ENVIROMENTAL
121 INDIAN RIDGE RD
BELTON TX, 76513

Project: G STATE 4
Project Number: NONE GIVEN
Project Manager: BRAD FREEMAN
Fax To:

Reported:
12-Aug-24 13:24

MW 8**H244522-04 (Water)**

Analyte	Result	MDL	Reporting Limit	Units	Dilution	Batch	Analyst	Analyzed	Method	Notes
---------	--------	-----	-----------------	-------	----------	-------	---------	----------	--------	-------

Cardinal Laboratories**Polynuclear Aromatic Compounds by GC/MS**

Chrysene*	<0.001		0.001	mg/L	1.01	4073020	MS	09-Aug-24	8270C	
Benzo[b]flouranthene*	<0.001		0.001	mg/L	1.01	4073020	MS	09-Aug-24	8270C	
Benzo[k]flouranthene*	<0.001		0.001	mg/L	1.01	4073020	MS	09-Aug-24	8270C	
Benzo[a]pyrene*	<0.0002		0.0002	mg/L	1.01	4073020	MS	09-Aug-24	8270C	
Indeno[1,2,3-cd]pyrene*	<0.001		0.001	mg/L	1.01	4073020	MS	09-Aug-24	8270C	
Dibenz[a,h]anthracene*	<0.001		0.001	mg/L	1.01	4073020	MS	09-Aug-24	8270C	
Benzo[g,h,i]perylene*	<0.001		0.001	mg/L	1.01	4073020	MS	09-Aug-24	8270C	
Surrogate: Nitrobenzene-d5			61.9 %	5.17-184		4073020	MS	09-Aug-24	8270C	
Surrogate: 2-Fluorobiphenyl			52.0 %	7.39-192		4073020	MS	09-Aug-24	8270C	
Surrogate: Terphenyl-d14			56.6 %	27.5-139		4073020	MS	09-Aug-24	8270C	

Cardinal Laboratories

*=Accredited Analyte

PLEASE NOTE: Liability and Damages. Cardinal's liability and client's exclusive remedy for any claim arising, whether based in contract or tort, shall be limited to the amount paid by client for analyses. All claims, including those for negligence or any other cause whatsoever shall be deemed waived unless made in writing and received by Cardinal within thirty (30) days after completion of the applicable service. In no event shall Cardinal be liable for incidental or consequential damage including, without limitation, business interruptions, loss of use, or loss of profits incurred by client, its subsidiaries, affiliates or successors arising out of or related to the performance of the services hereunder by Cardinal, regardless of whether such claim is based upon any of the above stated reasons or otherwise. Results relate only to the samples identified above. This report shall not be reproduced except in full with written approval of Cardinal Laboratories.

Celey D. Keene, Lab Director/Quality Manager



PHONE (575) 393-2326 ° 101 E. MARLAND ° HOBBS, NM 88240

Analytical Results For:

AXIS ENVIROMENTAL
121 INDIAN RIDGE RD
BELTON TX, 76513

Project: G STATE 4
Project Number: NONE GIVEN
Project Manager: BRAD FREEMAN
Fax To:

Reported:
12-Aug-24 13:24

Inorganic Compounds - Quality Control**Cardinal Laboratories**

Analyte	Result	Reporting Limit	Units	Spike Level	Source Result	%REC Limits	RPD	RPD Limit	Notes
---------	--------	--------------------	-------	----------------	------------------	----------------	-----	--------------	-------

Batch 4072601 - General Prep - Wet Chem**Blank (4072601-BLK1)**

Prepared & Analyzed: 26-Jul-24

Chloride	ND	4.00	mg/L
----------	----	------	------

LCS (4072601-BS1)

Prepared & Analyzed: 26-Jul-24

Chloride	104	4.00	mg/L	100	104	80-120
----------	-----	------	------	-----	-----	--------

LCS Dup (4072601-BSD1)

Prepared & Analyzed: 26-Jul-24

Chloride	108	4.00	mg/L	100	108	80-120	3.77	20
----------	-----	------	------	-----	-----	--------	------	----

Batch 4073017 - General Prep - Wet Chem**Blank (4073017-BLK1)**

Prepared & Analyzed: 30-Jul-24

Chloride	ND	4.00	mg/L
----------	----	------	------

LCS (4073017-BS1)

Prepared & Analyzed: 30-Jul-24

Chloride	108	4.00	mg/L	100	108	80-120
----------	-----	------	------	-----	-----	--------

LCS Dup (4073017-BSD1)

Prepared & Analyzed: 30-Jul-24

Chloride	104	4.00	mg/L	100	104	80-120	3.77	20
----------	-----	------	------	-----	-----	--------	------	----

Cardinal Laboratories

*=Accredited Analyte

PLEASE NOTE: Liability and Damages. Cardinal's liability and client's exclusive remedy for any claim arising, whether based in contract or tort, shall be limited to the amount paid by client for analyses. All claims, including those for negligence or any other cause whatsoever shall be deemed waived unless made in writing and received by Cardinal within thirty (30) days after completion of the applicable service. In no event shall Cardinal be liable for incidental or consequential damage including, without limitation, business interruptions, loss of use, or loss of profits incurred by client, its subsidiaries, affiliates or successors arising out of or related to the performance of the services hereunder by Cardinal, regardless of whether such claim is based upon any of the above stated reasons or otherwise. Results relate only to the samples identified above. This report shall not be reproduced except in full with written approval of Cardinal Laboratories.

Celey D. Keene, Lab Director/Quality Manager



PHONE (575) 393-2326 ° 101 E. MARLAND ° HOBBS, NM 88240

Analytical Results For:

AXIS ENVIROMENTAL
121 INDIAN RIDGE RD
BELTON TX, 76513

Project: G STATE 4
Project Number: NONE GIVEN
Project Manager: BRAD FREEMAN
Fax To:

Reported:
12-Aug-24 13:24

Volatile Organic Compounds by EPA Method 8021 - Quality Control**Cardinal Laboratories**

Analyte	Result	Reporting Limit	Units	Spike Level	Source Result	%REC Limits	RPD	RPD Limit	Notes
---------	--------	--------------------	-------	----------------	------------------	----------------	-----	--------------	-------

Batch 4072622 - Volatiles**Blank (4072622-BLK1)**

Prepared: 26-Jul-24 Analyzed: 30-Jul-24

Benzene	ND	0.001	mg/L						
Toluene	ND	0.001	mg/L						
Ethylbenzene	ND	0.001	mg/L						
Total Xylenes	ND	0.003	mg/L						
Total BTEX	ND	0.006	mg/L						
Surrogate: 4-Bromofluorobenzene (PID)	0.0528		mg/L	0.0500		106	77.5-125		

LCS (4072622-BS1)

Prepared: 26-Jul-24 Analyzed: 30-Jul-24

Benzene	0.020	0.001	mg/L	0.0200		100	80.8-112		
Toluene	0.020	0.001	mg/L	0.0200		101	78.7-114		
Ethylbenzene	0.020	0.001	mg/L	0.0200		102	70.9-120		
m,p-Xylene	0.045	0.002	mg/L	0.0400		111	76.9-119		
o-Xylene	0.021	0.001	mg/L	0.0200		104	71.7-120		
Total Xylenes	0.065	0.003	mg/L	0.0600		109	75.6-119		
Surrogate: 4-Bromofluorobenzene (PID)	0.0525		mg/L	0.0500		105	77.5-125		

LCS Dup (4072622-BSD1)

Prepared: 26-Jul-24 Analyzed: 30-Jul-24

Benzene	0.020	0.001	mg/L	0.0200		99.8	80.8-112	0.589	8.26
Toluene	0.020	0.001	mg/L	0.0200		100	78.7-114	0.931	9.03
Ethylbenzene	0.020	0.001	mg/L	0.0200		100	70.9-120	1.38	11.9
m,p-Xylene	0.044	0.002	mg/L	0.0400		110	76.9-119	1.07	11
o-Xylene	0.021	0.001	mg/L	0.0200		103	71.7-120	1.01	15
Total Xylenes	0.065	0.003	mg/L	0.0600		108	75.6-119	1.05	12.2
Surrogate: 4-Bromofluorobenzene (PID)	0.0519		mg/L	0.0500		104	77.5-125		

Cardinal Laboratories

*=Accredited Analyte

PLEASE NOTE: Liability and Damages. Cardinal's liability and client's exclusive remedy for any claim arising, whether based in contract or tort, shall be limited to the amount paid by client for analyses. All claims, including those for negligence or any other cause whatsoever shall be deemed waived unless made in writing and received by Cardinal within thirty (30) days after completion of the applicable service. In no event shall Cardinal be liable for incidental or consequential damage including, without limitation, business interruptions, loss of use, or loss of profits incurred by client, its subsidiaries, affiliates or successors arising out of or related to the performance of the services hereunder by Cardinal, regardless of whether such claim is based upon any of the above stated reasons or otherwise. Results relate only to the samples identified above. This report shall not be reproduced except in full with written approval of Cardinal Laboratories.

Celey D. Keene, Lab Director/Quality Manager



PHONE (575) 393-2326 • 101 E. MARLAND • HOBBS, NM 88240

Analytical Results For:

AXIS ENVIROMENTAL
121 INDIAN RIDGE RD
BELTON TX, 76513

Project: G STATE 4
Project Number: NONE GIVEN
Project Manager: BRAD FREEMAN
Fax To:

Reported:
12-Aug-24 13:24

Petroleum Hydrocarbons by GC FID - Quality Control**Cardinal Laboratories**

Analyte	Result	Reporting Limit	Units	Spike Level	Source Result	%REC Limits	RPD	RPD Limit	Notes
---------	--------	--------------------	-------	----------------	------------------	----------------	-----	--------------	-------

Batch 4073006 - General Prep - Organics**Blank (4073006-BLK1)**

Prepared: 30-Jul-24 Analyzed: 03-Aug-24

GRO C6-C10	ND	1.00	mg/L						
DRO >C10-C28	ND	1.00	mg/L						
EXT DRO >C28-C36	ND	1.00	mg/L						
Surrogate: 1-Chlorooctane	3.67		mg/L	5.00		73.4	71.5-140		
Surrogate: 1-Chlorooctadecane	4.34		mg/L	5.00		86.8	60.4-151		

LCS (4073006-BS1)

Prepared: 30-Jul-24 Analyzed: 03-Aug-24

GRO C6-C10	48.5	1.00	mg/L	50.0		96.9	72.6-121		
DRO >C10-C28	49.4	1.00	mg/L	50.0		98.8	76-119		
Surrogate: 1-Chlorooctane	4.41		mg/L	5.00		88.2	71.5-140		
Surrogate: 1-Chlorooctadecane	4.96		mg/L	5.00		99.3	60.4-151		

LCS Dup (4073006-BS1)

Prepared: 30-Jul-24 Analyzed: 03-Aug-24

GRO C6-C10	46.3	1.00	mg/L	50.0		92.6	72.6-121	4.53	16.8
DRO >C10-C28	47.8	1.00	mg/L	50.0		95.6	76-119	3.25	20.4
Surrogate: 1-Chlorooctane	4.23		mg/L	5.00		84.6	71.5-140		
Surrogate: 1-Chlorooctadecane	4.78		mg/L	5.00		95.6	60.4-151		

Cardinal Laboratories

*=Accredited Analyte

PLEASE NOTE: Liability and Damages. Cardinal's liability and client's exclusive remedy for any claim arising, whether based in contract or tort, shall be limited to the amount paid by client for analyses. All claims, including those for negligence or any other cause whatsoever shall be deemed waived unless made in writing and received by Cardinal within thirty (30) days after completion of the applicable service. In no event shall Cardinal be liable for incidental or consequential damage including, without limitation, business interruptions, loss of use, or loss of profits incurred by client, its subsidiaries, affiliates or successors arising out of or related to the performance of the services hereunder by Cardinal, regardless of whether such claim is based upon any of the above stated reasons or otherwise. Results relate only to the samples identified above. This report shall not be reproduced except in full with written approval of Cardinal Laboratories.

Celey D. Keene, Lab Director/Quality Manager



PHONE (575) 393-2326 ° 101 E. MARLAND ° HOBBS, NM 88240

Analytical Results For:

AXIS ENVIROMENTAL
121 INDIAN RIDGE RD
BELTON TX, 76513

Project: G STATE 4
Project Number: NONE GIVEN
Project Manager: BRAD FREEMAN
Fax To:

Reported:
12-Aug-24 13:24

Polynuclear Aromatic Compounds by GC/MS - Quality Control**Cardinal Laboratories**

Analyte	Result	Reporting Limit	Units	Spike Level	Source Result	%REC	%REC Limits	RPD	RPD Limit	Notes
---------	--------	-----------------	-------	-------------	---------------	------	-------------	-----	-----------	-------

Batch 4073020 - SW846-3510**Blank (4073020-BLK1)**

Prepared: 30-Jul-24 Analyzed: 09-Aug-24

Naphthalene	ND	0.001	mg/L							
2-Methylnaphthalene	ND	0.001	mg/L							
1-Methylnaphthalene	ND	0.0005	mg/L							
Acenaphthylene	ND	0.001	mg/L							
Acenaphthene	ND	0.001	mg/L							
Fluorene	ND	0.001	mg/L							
Phenanthrene	ND	0.001	mg/L							
Anthracene	ND	0.001	mg/L							
Carbazole	ND	0.001	mg/L							
Fluoranthene	ND	0.001	mg/L							
Pyrene	ND	0.001	mg/L							
Benzo[a]anthracene	ND	0.001	mg/L							
Chrysene	ND	0.001	mg/L							
Benzo[b]fluoranthene	ND	0.001	mg/L							
Benzo[k]fluoranthene	ND	0.001	mg/L							
Benzo[a]pyrene	ND	0.0002	mg/L							
Indeno[1,2,3-cd]pyrene	ND	0.001	mg/L							
Dibenz[a,h]anthracene	ND	0.001	mg/L							
Benzo[g,h,i]perylene	ND	0.001	mg/L							
Surrogate: Nitrobenzene-d5	0.0312		mg/L	0.0500		62.4	5.17-184			
Surrogate: 2-Fluorobiphenyl	0.0263		mg/L	0.0500		52.6	7.39-192			
Surrogate: Terphenyl-d14	0.0355		mg/L	0.0500		71.0	27.5-139			

LCS (4073020-BS1)

Prepared: 30-Jul-24 Analyzed: 09-Aug-24

Naphthalene	0.007	0.001	mg/L	0.0100		72.7	46.9-122			
2-Methylnaphthalene	0.006	0.001	mg/L	0.0100		65.0	48.1-126			
1-Methylnaphthalene	0.007	0.0005	mg/L	0.0100		66.4	47.6-126			
Acenaphthylene	0.008	0.001	mg/L	0.0100		79.8	50.2-124			
Acenaphthene	0.008	0.001	mg/L	0.0100		75.5	49.4-119			
Fluorene	0.007	0.001	mg/L	0.0100		74.0	50.1-126			
Phenanthrene	0.009	0.001	mg/L	0.0100		86.2	53.6-120			
Anthracene	0.008	0.001	mg/L	0.0100		85.0	51.9-120			

Cardinal Laboratories

*=Accredited Analyte

PLEASE NOTE: Liability and Damages. Cardinal's liability and client's exclusive remedy for any claim arising, whether based in contract or tort, shall be limited to the amount paid by client for analyses. All claims, including those for negligence or any other cause whatsoever shall be deemed waived unless made in writing and received by Cardinal within thirty (30) days after completion of the applicable service. In no event shall Cardinal be liable for incidental or consequential damage including, without limitation, business interruptions, loss of use, or loss of profits incurred by client, its subsidiaries, affiliates or successors arising out of or related to the performance of the services hereunder by Cardinal, regardless of whether such claim is based upon any of the above stated reasons or otherwise. Results relate only to the samples identified above. This report shall not be reproduced except in full with written approval of Cardinal Laboratories.

Celey D. Keene, Lab Director/Quality Manager



PHONE (575) 393-2326 • 101 E. MARLAND • HOBBS, NM 88240

Analytical Results For:

AXIS ENVIROMENTAL
121 INDIAN RIDGE RD
BELTON TX, 76513

Project: G STATE 4
Project Number: NONE GIVEN
Project Manager: BRAD FREEMAN
Fax To:

Reported:
12-Aug-24 13:24

Polynuclear Aromatic Compounds by GC/MS - Quality Control**Cardinal Laboratories**

Analyte	Result	Reporting Limit	Units	Spike Level	Source Result	%REC	%REC Limits	RPD	RPD Limit	Notes
---------	--------	-----------------	-------	-------------	---------------	------	-------------	-----	-----------	-------

Batch 4073020 - SW846-3510**LCS (4073020-BS1)**

Prepared: 30-Jul-24 Analyzed: 09-Aug-24

Carbazole	0.009	0.001	mg/L	0.0100		92.4	54-123			
Fluoranthene	0.008	0.001	mg/L	0.0100		79.3	54.9-126			
Pyrene	0.009	0.001	mg/L	0.0100		87.8	50.2-124			
Benzo[a]anthracene	0.008	0.001	mg/L	0.0100		79.3	49.9-123			
Chrysene	0.008	0.001	mg/L	0.0100		79.5	50.1-125			
Benzo[b]fluoranthene	0.009	0.001	mg/L	0.0100		86.0	52.1-125			
Benzo[k]fluoranthene	0.009	0.001	mg/L	0.0100		85.6	49.3-131			
Benzo[a]pyrene	0.008	0.0002	mg/L	0.0100		84.5	52.9-126			
Indeno[1,2,3-cd]pyrene	0.008	0.001	mg/L	0.0100		80.3	50-132			
Dibenz[a,h]anthracene	0.008	0.001	mg/L	0.0100		81.9	51.7-129			
Benzo[g,h,i]perylene	0.009	0.001	mg/L	0.0100		85.7	50.7-130			
Surrogate: Nitrobenzene-d5	0.0366		mg/L	0.0500		73.3	5.17-184			
Surrogate: 2-Fluorobiphenyl	0.0336		mg/L	0.0500		67.2	7.39-192			
Surrogate: Terphenyl-d14	0.0434		mg/L	0.0500		86.8	27.5-139			

LCS Dup (4073020-BSD1)

Prepared: 30-Jul-24 Analyzed: 09-Aug-24

Naphthalene	0.007	0.001	mg/L	0.0100		74.2	46.9-122	2.04	3.46	
2-Methylnaphthalene	0.007	0.001	mg/L	0.0100		67.1	48.1-126	3.18	4.47	
1-Methylnaphthalene	0.007	0.0005	mg/L	0.0100		66.7	47.6-126	0.451	4.3	
Acenaphthylene	0.008	0.001	mg/L	0.0100		80.0	50.2-124	0.250	3.88	
Acenaphthene	0.008	0.001	mg/L	0.0100		80.6	49.4-119	6.53	3.77	QR-04
Fluorene	0.007	0.001	mg/L	0.0100		71.7	50.1-126	3.16	4.31	
Phenanthrene	0.008	0.001	mg/L	0.0100		84.9	53.6-120	1.52	5.04	
Anthracene	0.008	0.001	mg/L	0.0100		84.6	51.9-120	0.472	4.49	
Carbazole	0.009	0.001	mg/L	0.0100		91.9	54-123	0.543	4.78	
Fluoranthene	0.008	0.001	mg/L	0.0100		80.8	54.9-126	1.87	6.19	
Pyrene	0.009	0.001	mg/L	0.0100		86.7	50.2-124	1.26	7.75	
Benzo[a]anthracene	0.008	0.001	mg/L	0.0100		84.1	49.9-123	5.88	3.03	QR-04
Chrysene	0.008	0.001	mg/L	0.0100		76.2	50.1-125	4.24	3.42	QR-04
Benzo[b]fluoranthene	0.008	0.001	mg/L	0.0100		85.0	52.1-125	1.17	6.95	
Benzo[k]fluoranthene	0.009	0.001	mg/L	0.0100		85.3	49.3-131	0.351	8.16	
Benzo[a]pyrene	0.008	0.0002	mg/L	0.0100		83.6	52.9-126	1.07	3.27	

Cardinal Laboratories

*=Accredited Analyte

PLEASE NOTE: Liability and Damages. Cardinal's liability and client's exclusive remedy for any claim arising, whether based in contract or tort, shall be limited to the amount paid by client for analyses. All claims, including those for negligence or any other cause whatsoever shall be deemed waived unless made in writing and received by Cardinal within thirty (30) days after completion of the applicable service. In no event shall Cardinal be liable for incidental or consequential damage including, without limitation, business interruptions, loss of use, or loss of profits incurred by client, its subsidiaries, affiliates or successors arising out of or related to the performance of the services hereunder by Cardinal, regardless of whether such claim is based upon any of the above stated reasons or otherwise. Results relate only to the samples identified above. This report shall not be reproduced except in full with written approval of Cardinal Laboratories.

Celey D. Keene, Lab Director/Quality Manager



PHONE (575) 393-2326 ° 101 E. MARLAND ° HOBBS, NM 88240

Analytical Results For:

AXIS ENVIROMENTAL
121 INDIAN RIDGE RD
BELTON TX, 76513

Project: G STATE 4
Project Number: NONE GIVEN
Project Manager: BRAD FREEMAN
Fax To:

Reported:
12-Aug-24 13:24

Polynuclear Aromatic Compounds by GC/MS - Quality Control**Cardinal Laboratories**

Analyte	Result	Reporting Limit	Units	Spike Level	Source Result	%REC	%REC Limits	RPD	RPD Limit	Notes
---------	--------	--------------------	-------	----------------	------------------	------	----------------	-----	--------------	-------

Batch 4073020 - SW846-3510**LCS Dup (4073020-BSD1)**

Prepared: 30-Jul-24 Analyzed: 09-Aug-24

Indeno[1,2,3-cd]pyrene	0.008	0.001	mg/L	0.0100		80.5	50-132	0.249	4.11	
Dibenz[a,h]anthracene	0.008	0.001	mg/L	0.0100		80.5	51.7-129	1.72	4.77	
Benzo[g,h,i]perylene	0.008	0.001	mg/L	0.0100		83.3	50.7-130	2.84	6.35	
Surrogate: Nitrobenzene-d5	0.0374		mg/L	0.0500		74.8	5.17-184			
Surrogate: 2-Fluorobiphenyl	0.0338		mg/L	0.0500		67.7	7.39-192			
Surrogate: Terphenyl-d14	0.0426		mg/L	0.0500		85.2	27.5-139			

Cardinal Laboratories

*=Accredited Analyte

PLEASE NOTE: Liability and Damages. Cardinal's liability and client's exclusive remedy for any claim arising, whether based in contract or tort, shall be limited to the amount paid by client for analyses. All claims, including those for negligence or any other cause whatsoever shall be deemed waived unless made in writing and received by Cardinal within thirty (30) days after completion of the applicable service. In no event shall Cardinal be liable for incidental or consequential damage including, without limitation, business interruptions, loss of use, or loss of profits incurred by client, its subsidiaries, affiliates or successors arising out of or related to the performance of the services hereunder by Cardinal, regardless of whether such claim is based upon any of the above stated reasons or otherwise. Results relate only to the samples identified above. This report shall not be reproduced except in full with written approval of Cardinal Laboratories.

Celey D. Keene, Lab Director/Quality Manager



PHONE (575) 393-2326 ° 101 E. MARLAND ° HOBBS, NM 88240

Notes and Definitions

QR-04	The RPD for the BS/BSD was outside of historical limits.
GC-NC1	8260 confirmation analysis was performed; initial GC results were not supported by GC/MS analysis and are biased high with interfering compounds.
GC-NC	8260 confirmation analysis was performed; initial GC results were not supported by GC/MS analysis and are reported as ND.
ND	Analyte NOT DETECTED at or above the reporting limit
RPD	Relative Percent Difference
**	Samples not received at proper temperature of 6°C or below.
***	Insufficient time to reach temperature.
-	Chloride by SM4500Cl-B does not require samples be received at or below 6°C Samples reported on an as received basis (wet) unless otherwise noted on report

Cardinal Laboratories

*=Accredited Analyte

PLEASE NOTE: Liability and Damages. Cardinal's liability and client's exclusive remedy for any claim arising, whether based in contract or tort, shall be limited to the amount paid by client for analyses. All claims, including those for negligence or any other cause whatsoever shall be deemed waived unless made in writing and received by Cardinal within thirty (30) days after completion of the applicable service. In no event shall Cardinal be liable for incidental or consequential damage including, without limitation, business interruptions, loss of use, or loss of profits incurred by client, its subsidiaries, affiliates or successors arising out of or related to the performance of the services hereunder by Cardinal, regardless of whether such claim is based upon any of the above stated reasons or otherwise. Results relate only to the samples identified above. This report shall not be reproduced except in full with written approval of Cardinal Laboratories.

Celey D. Keene, Lab Director/Quality Manager



101 East Marland, Hobbs, NM 88240
(575) 393-2326 FAX (575) 393-2476

CHAIN-OF-CUSTODY AND ANALYSIS REQUEST

Company Name: Axis EM Project Manager: Brad Freeman Address: City: State: Zip: Phone #: 713-419-6141 Fax #: Project #: Project Name: G State 4 Project Location: Sample Name:		BILL TO P.O. #: G State 4 Company: Axis EM Attn: Address: b.freeman@axis-em.com City: State: Zip: Phone #: 713-419-6141 Fax #:		ANALYSIS REQUEST	
FOR LAB USE ONLY Lab I.D. H44532 Sample I.D. MW4 MW5 MW6 MW7 MW8		MATRIX (G)RAB OR (C)OMP. # CONTAINERS GROUNDWATER WASTEWATER SOIL OIL SLUDGE OTHER : ACID/BASE: ICE / COOL OTHER :		PRESERV SAMPLING DATE TIME 7/30 0840 7/30 0815 7/30 0705 7/30 0750	
Relinquished By: [Signature] Relinquished Date: 7/30/24 Time: 1050 Date: Received By: [Signature] Received Date: Time:		Sample Condition Cool Intact <input checked="" type="checkbox"/> Yes <input type="checkbox"/> No Sample Intact <input checked="" type="checkbox"/> Yes <input type="checkbox"/> No Checked By: [Signature]		Turnaround Time: Standard <input checked="" type="checkbox"/> Rush <input type="checkbox"/> Thermometer ID #140 Correction Factor 0°C Bacteria (only) Sample Condition Cool Intact <input type="checkbox"/> Yes <input type="checkbox"/> No Observed Temp. °C Corrected Temp. °C	
REMARKS: Verbal Result: <input type="checkbox"/> Yes <input type="checkbox"/> No <input type="checkbox"/> Add'l Phone #: All Results are emailed. Please provide Email address:					

† Cardinal cannot accept verbal changes. Please email changes to celey.keene@cardinallabsnm.com



PHONE (575) 393-2326 ° 101 E. MARLAND ° HOBBS, NM 88240

January 08, 2025

BRAD FREEMAN

AXIS ENVIROMENTAL

121 INDIAN RIDGE RD

BELTON, TX 76513

RE: G STATE 4

Enclosed are the results of analyses for samples received by the laboratory on 12/19/24 10:00.

Cardinal Laboratories is accredited through Texas NELAP under certificate number TX-C24-00112. Accreditation applies to drinking water, non-potable water and solid and chemical materials. All accredited analytes are denoted by an asterisk (*). For a complete list of accredited analytes and matrices visit the TCEQ website at

www.tceq.texas.gov/field/ga/lab_accred_certif.html.

Cardinal Laboratories is accredited through the State of Colorado Department of Public Health and Environment for:

Method EPA 552.2	Total Haloacetic Acids (HAA-5)
Method EPA 524.2	Total Trihalomethanes (TTHM)
Method EPA 524.4	Regulated VOCs (V1, V2, V3)

Cardinal Laboratories is accredited through the State of New Mexico Environment Department for:

Method SM 9223-B	Total Coliform and E. coli (Colilert MMO-MUG)
Method EPA 524.2	Regulated VOCs and Total Trihalomethanes (TTHM)
Method EPA 552.2	Total Haloacetic Acids (HAA-5)

Accreditation applies to public drinking water matrices for State of Colorado and New Mexico.

This report meets NELAP requirements and is made up of a cover page, analytical results, and a copy of the original chain-of-custody. If you have any questions concerning this report, please feel free to contact me.

Sincerely,

A handwritten signature in black ink that reads "Celey D. Keene".

Celey D. Keene

Lab Director/Quality Manager



PHONE (575) 393-2326 ° 101 E. MARLAND ° HOBBS, NM 88240

Analytical Results For:AXIS ENVIROMENTAL
121 INDIAN RIDGE RD
BELTON TX, 76513Project: G STATE 4
Project Number: NONE GIVEN
Project Manager: BRAD FREEMAN
Fax To:Reported:
08-Jan-25 14:15

Sample ID	Laboratory ID	Matrix	Date Sampled	Date Received
MW 6	H247666-01	Water	18-Dec-24 16:30	19-Dec-24 10:00
MW 7	H247666-02	Water	19-Dec-24 07:25	19-Dec-24 10:00
MW 8	H247666-03	Water	19-Dec-24 08:10	19-Dec-24 10:00
MW 4	H247666-04	Water	19-Dec-24 08:50	19-Dec-24 10:00

Cardinal Laboratories

*=Accredited Analyte

PLEASE NOTE: Liability and Damages. Cardinal's liability and client's exclusive remedy for any claim arising, whether based in contract or tort, shall be limited to the amount paid by client for analyses. All claims, including those for negligence or any other cause whatsoever shall be deemed waived unless made in writing and received by Cardinal within thirty (30) days after completion of the applicable service. In no event shall Cardinal be liable for incidental or consequential damage including, without limitation, business interruptions, loss of use, or loss of profits incurred by client, its subsidiaries, affiliates or successors arising out of or related to the performance of the services hereunder by Cardinal, regardless of whether such claim is based upon any of the above stated reasons or otherwise. Results relate only to the samples identified above. This report shall not be reproduced except in full with written approval of Cardinal Laboratories.

Celey D. Keene, Lab Director/Quality Manager



PHONE (575) 393-2326 ° 101 E. MARLAND ° HOBBS, NM 88240

Analytical Results For:

AXIS ENVIROMENTAL
121 INDIAN RIDGE RD
BELTON TX, 76513

Project: G STATE 4
Project Number: NONE GIVEN
Project Manager: BRAD FREEMAN
Fax To:

Reported:
08-Jan-25 14:15

MW 6**H247666-01 (Water)**

Analyte	Result	MDL	Reporting Limit	Units	Dilution	Batch	Analyst	Analyzed	Method	Notes
---------	--------	-----	-----------------	-------	----------	-------	---------	----------	--------	-------

Cardinal Laboratories**Inorganic Compounds**

Chloride*	68.0		4.00	mg/L	1	4122004	AC	20-Dec-24	4500-Cl-B	
-----------	------	--	------	------	---	---------	----	-----------	-----------	--

Volatile Organic Compounds by EPA Method 8021

Benzene*	<0.001		0.001	mg/L	1	4121825	JH	23-Dec-24	8021B	
Toluene*	<0.001		0.001	mg/L	1	4121825	JH	23-Dec-24	8021B	
Ethylbenzene*	<0.001		0.001	mg/L	1	4121825	JH	23-Dec-24	8021B	
Total Xylenes*	<0.003		0.003	mg/L	1	4121825	JH	23-Dec-24	8021B	
Total BTEX	<0.006		0.006	mg/L	1	4121825	JH	23-Dec-24	8021B	

Surrogate: 4-Bromofluorobenzene (PID) 101 % 77.5-125 4121825 JH 23-Dec-24 8021B

Petroleum Hydrocarbons by GC FID

GRO C6-C10*	<1.00		1.00	mg/L	0.1	4121716	MS	21-Dec-24	8015B	
DRO >C10-C28*	<1.00		1.00	mg/L	0.1	4121716	MS	21-Dec-24	8015B	
EXT DRO >C28-C36	<1.00		1.00	mg/L	0.1	4121716	MS	21-Dec-24	8015B	

Surrogate: 1-Chlorooctane 86.5 % 68.3-140 4121716 MS 21-Dec-24 8015B

Surrogate: 1-Chlorooctadecane 87.4 % 56.7-151 4121716 MS 21-Dec-24 8015B

Polynuclear Aromatic Compounds by GC/MS

Naphthalene*	<0.001		0.001	mg/L	1.02	4122017	SK	30-Dec-24	8270C	
2-Methylnaphthalene*	<0.001		0.001	mg/L	1.02	4122017	SK	30-Dec-24	8270C	
1-Methylnaphthalene	<0.0005		0.0005	mg/L	1.02	4122017	SK	30-Dec-24	8270C	
Acenaphthylene*	<0.001		0.001	mg/L	1.02	4122017	SK	30-Dec-24	8270C	
Acenaphthene*	<0.001		0.001	mg/L	1.02	4122017	SK	30-Dec-24	8270C	
Fluorene*	<0.001		0.001	mg/L	1.02	4122017	SK	30-Dec-24	8270C	
Phenanthrene*	<0.001		0.001	mg/L	1.02	4122017	SK	30-Dec-24	8270C	
Anthracene*	<0.001		0.001	mg/L	1.02	4122017	SK	30-Dec-24	8270C	
Carbazole*	<0.001		0.001	mg/L	1.02	4122017	SK	30-Dec-24	8270C	
Fluoranthene*	<0.001		0.001	mg/L	1.02	4122017	SK	30-Dec-24	8270C	
Pyrene*	<0.001		0.001	mg/L	1.02	4122017	SK	30-Dec-24	8270C	

Cardinal Laboratories

*=Accredited Analyte

PLEASE NOTE: Liability and Damages. Cardinal's liability and client's exclusive remedy for any claim arising, whether based in contract or tort, shall be limited to the amount paid by client for analyses. All claims, including those for negligence or any other cause whatsoever shall be deemed waived unless made in writing and received by Cardinal within thirty (30) days after completion of the applicable service. In no event shall Cardinal be liable for incidental or consequential damage including, without limitation, business interruptions, loss of use, or loss of profits incurred by client, its subsidiaries, affiliates or successors arising out of or related to the performance of the services hereunder by Cardinal, regardless of whether such claim is based upon any of the above stated reasons or otherwise. Results relate only to the samples identified above. This report shall not be reproduced except in full with written approval of Cardinal Laboratories.

Celey D. Keene, Lab Director/Quality Manager



PHONE (575) 393-2326 ° 101 E. MARLAND ° HOBBS, NM 88240

Analytical Results For:

AXIS ENVIROMENTAL
121 INDIAN RIDGE RD
BELTON TX, 76513

Project: G STATE 4
Project Number: NONE GIVEN
Project Manager: BRAD FREEMAN
Fax To:

Reported:
08-Jan-25 14:15

MW 6**H247666-01 (Water)**

Analyte	Result	MDL	Reporting Limit	Units	Dilution	Batch	Analyst	Analyzed	Method	Notes
---------	--------	-----	-----------------	-------	----------	-------	---------	----------	--------	-------

Cardinal Laboratories**Polynuclear Aromatic Compounds by GC/MS**

Benzo[a]anthracene*	<0.001		0.001	mg/L	1.02	4122017	SK	30-Dec-24	8270C	
Chrysene*	<0.001		0.001	mg/L	1.02	4122017	SK	30-Dec-24	8270C	
Benzo[b]flouranthene*	<0.001		0.001	mg/L	1.02	4122017	SK	30-Dec-24	8270C	
Benzo[k]flouranthene*	<0.001		0.001	mg/L	1.02	4122017	SK	30-Dec-24	8270C	
Benzo[a]pyrene*	<0.0002		0.0002	mg/L	1.02	4122017	SK	30-Dec-24	8270C	
Indeno[1,2,3-cd]pyrene*	<0.001		0.001	mg/L	1.02	4122017	SK	30-Dec-24	8270C	
Dibenz[a,h]anthracene*	<0.001		0.001	mg/L	1.02	4122017	SK	30-Dec-24	8270C	
Benzo[g,h,i]perylene*	<0.001		0.001	mg/L	1.02	4122017	SK	30-Dec-24	8270C	
Surrogate: Nitrobenzene-d5			55.4 %	5.17-184		4122017	SK	30-Dec-24	8270C	
Surrogate: 2-Fluorobiphenyl			34.3 %	7.39-192		4122017	SK	30-Dec-24	8270C	
Surrogate: Terphenyl-d14			42.3 %	27.5-139		4122017	SK	30-Dec-24	8270C	

Cardinal Laboratories

*=Accredited Analyte

PLEASE NOTE: Liability and Damages. Cardinal's liability and client's exclusive remedy for any claim arising, whether based in contract or tort, shall be limited to the amount paid by client for analyses. All claims, including those for negligence or any other cause whatsoever shall be deemed waived unless made in writing and received by Cardinal within thirty (30) days after completion of the applicable service. In no event shall Cardinal be liable for incidental or consequential damage including, without limitation, business interruptions, loss of use, or loss of profits incurred by client, its subsidiaries, affiliates or successors arising out of or related to the performance of the services hereunder by Cardinal, regardless of whether such claim is based upon any of the above stated reasons or otherwise. Results relate only to the samples identified above. This report shall not be reproduced except in full with written approval of Cardinal Laboratories.

Celey D. Keene, Lab Director/Quality Manager



PHONE (575) 393-2326 ° 101 E. MARLAND ° HOBBS, NM 88240

Analytical Results For:

AXIS ENVIROMENTAL
121 INDIAN RIDGE RD
BELTON TX, 76513

Project: G STATE 4
Project Number: NONE GIVEN
Project Manager: BRAD FREEMAN
Fax To:

Reported:
08-Jan-25 14:15

MW 7**H247666-02 (Water)**

Analyte	Result	MDL	Reporting Limit	Units	Dilution	Batch	Analyst	Analyzed	Method	Notes
---------	--------	-----	-----------------	-------	----------	-------	---------	----------	--------	-------

Cardinal Laboratories**Inorganic Compounds**

Chloride*	340		4.00	mg/L	1	4122004	AC	20-Dec-24	4500-Cl-B	
-----------	-----	--	------	------	---	---------	----	-----------	-----------	--

Volatile Organic Compounds by EPA Method 8021

Benzene*	<0.001		0.001	mg/L	1	4121825	JH	23-Dec-24	8021B	
Toluene*	<0.001		0.001	mg/L	1	4121825	JH	23-Dec-24	8021B	
Ethylbenzene*	<0.001		0.001	mg/L	1	4121825	JH	23-Dec-24	8021B	
Total Xylenes*	<0.003		0.003	mg/L	1	4121825	JH	23-Dec-24	8021B	
Total BTEX	<0.006		0.006	mg/L	1	4121825	JH	23-Dec-24	8021B	

Surrogate: 4-Bromofluorobenzene (PID)	100 %		77.5-125			4121825	JH	23-Dec-24	8021B	
---------------------------------------	-------	--	----------	--	--	---------	----	-----------	-------	--

Petroleum Hydrocarbons by GC FID

GRO C6-C10*	<1.00		1.00	mg/L	0.1	4121716	MS	21-Dec-24	8015B	
DRO >C10-C28*	<1.00		1.00	mg/L	0.1	4121716	MS	21-Dec-24	8015B	
EXT DRO >C28-C36	<1.00		1.00	mg/L	0.1	4121716	MS	21-Dec-24	8015B	

Surrogate: 1-Chlorooctane	84.3 %		68.3-140			4121716	MS	21-Dec-24	8015B	
---------------------------	--------	--	----------	--	--	---------	----	-----------	-------	--

Surrogate: 1-Chlorooctadecane	85.0 %		56.7-151			4121716	MS	21-Dec-24	8015B	
-------------------------------	--------	--	----------	--	--	---------	----	-----------	-------	--

Polynuclear Aromatic Compounds by GC/MS

Naphthalene*	<0.001		0.001	mg/L	1.03	4122602	SK	07-Jan-25	8270C	
2-Methylnaphthalene*	<0.001		0.001	mg/L	1.03	4122602	SK	07-Jan-25	8270C	
1-Methylnaphthalene	<0.0005		0.0005	mg/L	1.03	4122602	SK	07-Jan-25	8270C	
Acenaphthylene*	<0.001		0.001	mg/L	1.03	4122602	SK	07-Jan-25	8270C	
Acenaphthene*	<0.001		0.001	mg/L	1.03	4122602	SK	07-Jan-25	8270C	
Fluorene*	<0.001		0.001	mg/L	1.03	4122602	SK	07-Jan-25	8270C	
Phenanthrene*	<0.001		0.001	mg/L	1.03	4122602	SK	07-Jan-25	8270C	
Anthracene*	<0.001		0.001	mg/L	1.03	4122602	SK	07-Jan-25	8270C	
Carbazole*	<0.001		0.001	mg/L	1.03	4122602	SK	07-Jan-25	8270C	
Fluoranthene*	<0.001		0.001	mg/L	1.03	4122602	SK	07-Jan-25	8270C	
Pyrene*	<0.001		0.001	mg/L	1.03	4122602	SK	07-Jan-25	8270C	
Benzo[a]anthracene*	<0.001		0.001	mg/L	1.03	4122602	SK	07-Jan-25	8270C	

Cardinal Laboratories

*=Accredited Analyte

PLEASE NOTE: Liability and Damages. Cardinal's liability and client's exclusive remedy for any claim arising, whether based in contract or tort, shall be limited to the amount paid by client for analyses. All claims, including those for negligence or any other cause whatsoever shall be deemed waived unless made in writing and received by Cardinal within thirty (30) days after completion of the applicable service. In no event shall Cardinal be liable for incidental or consequential damage including, without limitation, business interruptions, loss of use, or loss of profits incurred by client, its subsidiaries, affiliates or successors arising out of or related to the performance of the services hereunder by Cardinal, regardless of whether such claim is based upon any of the above stated reasons or otherwise. Results relate only to the samples identified above. This report shall not be reproduced except in full with written approval of Cardinal Laboratories.

Celey D. Keene, Lab Director/Quality Manager



PHONE (575) 393-2326 ° 101 E. MARLAND ° HOBBS, NM 88240

Analytical Results For:

AXIS ENVIROMENTAL
121 INDIAN RIDGE RD
BELTON TX, 76513

Project: G STATE 4
Project Number: NONE GIVEN
Project Manager: BRAD FREEMAN
Fax To:

Reported:
08-Jan-25 14:15

MW 7**H247666-02 (Water)**

Analyte	Result	MDL	Reporting Limit	Units	Dilution	Batch	Analyst	Analyzed	Method	Notes
---------	--------	-----	-----------------	-------	----------	-------	---------	----------	--------	-------

Cardinal Laboratories**Polynuclear Aromatic Compounds by GC/MS**

Chrysene*	<0.001		0.001	mg/L	1.03	4122602	SK	07-Jan-25	8270C	
Benzo[b]flouranthene*	<0.001		0.001	mg/L	1.03	4122602	SK	07-Jan-25	8270C	
Benzo[k]flouranthene*	<0.001		0.001	mg/L	1.03	4122602	SK	07-Jan-25	8270C	
Benzo[a]pyrene*	<0.0002		0.0002	mg/L	1.03	4122602	SK	07-Jan-25	8270C	
Indeno[1,2,3-cd]pyrene*	<0.001		0.001	mg/L	1.03	4122602	SK	07-Jan-25	8270C	
Dibenz[a,h]anthracene*	<0.001		0.001	mg/L	1.03	4122602	SK	07-Jan-25	8270C	
Benzo[g,h,i]perylene*	<0.001		0.001	mg/L	1.03	4122602	SK	07-Jan-25	8270C	
Surrogate: Nitrobenzene-d5			61.5 %	5.17-184		4122602	SK	07-Jan-25	8270C	
Surrogate: 2-Fluorobiphenyl			54.8 %	7.39-192		4122602	SK	07-Jan-25	8270C	
Surrogate: Terphenyl-d14			63.7 %	27.5-139		4122602	SK	07-Jan-25	8270C	

Cardinal Laboratories

*=Accredited Analyte

PLEASE NOTE: Liability and Damages. Cardinal's liability and client's exclusive remedy for any claim arising, whether based in contract or tort, shall be limited to the amount paid by client for analyses. All claims, including those for negligence or any other cause whatsoever shall be deemed waived unless made in writing and received by Cardinal within thirty (30) days after completion of the applicable service. In no event shall Cardinal be liable for incidental or consequential damage including, without limitation, business interruptions, loss of use, or loss of profits incurred by client, its subsidiaries, affiliates or successors arising out of or related to the performance of the services hereunder by Cardinal, regardless of whether such claim is based upon any of the above stated reasons or otherwise. Results relate only to the samples identified above. This report shall not be reproduced except in full with written approval of Cardinal Laboratories.

Celey D. Keene, Lab Director/Quality Manager



PHONE (575) 393-2326 ° 101 E. MARLAND ° HOBBS, NM 88240

Analytical Results For:

AXIS ENVIROMENTAL
121 INDIAN RIDGE RD
BELTON TX, 76513

Project: G STATE 4
Project Number: NONE GIVEN
Project Manager: BRAD FREEMAN
Fax To:

Reported:
08-Jan-25 14:15

MW 8**H247666-03 (Water)**

Analyte	Result	MDL	Reporting Limit	Units	Dilution	Batch	Analyst	Analyzed	Method	Notes
---------	--------	-----	-----------------	-------	----------	-------	---------	----------	--------	-------

Cardinal Laboratories**Inorganic Compounds**

Chloride*	340		4.00	mg/L	1	4122004	AC	20-Dec-24	4500-Cl-B	
------------------	------------	--	------	------	---	---------	----	-----------	-----------	--

Volatile Organic Compounds by EPA Method 8021

Benzene*	<0.001		0.001	mg/L	1	4121825	JH	23-Dec-24	8021B	
Toluene*	<0.001		0.001	mg/L	1	4121825	JH	23-Dec-24	8021B	
Ethylbenzene*	<0.001		0.001	mg/L	1	4121825	JH	23-Dec-24	8021B	
Total Xylenes*	<0.003		0.003	mg/L	1	4121825	JH	23-Dec-24	8021B	
Total BTEX	<0.006		0.006	mg/L	1	4121825	JH	23-Dec-24	8021B	

Surrogate: 4-Bromofluorobenzene (PID)			101 %	77.5-125		4121825	JH	23-Dec-24	8021B	
---------------------------------------	--	--	-------	----------	--	---------	----	-----------	-------	--

Petroleum Hydrocarbons by GC FID

GRO C6-C10*	<1.00		1.00	mg/L	0.1	4121716	MS	21-Dec-24	8015B	
DRO >C10-C28*	<1.00		1.00	mg/L	0.1	4121716	MS	21-Dec-24	8015B	
EXT DRO >C28-C36	<1.00		1.00	mg/L	0.1	4121716	MS	21-Dec-24	8015B	

Surrogate: 1-Chlorooctane			105 %	68.3-140		4121716	MS	21-Dec-24	8015B	
---------------------------	--	--	-------	----------	--	---------	----	-----------	-------	--

Surrogate: 1-Chlorooctadecane			107 %	56.7-151		4121716	MS	21-Dec-24	8015B	
-------------------------------	--	--	-------	----------	--	---------	----	-----------	-------	--

Polynuclear Aromatic Compounds by GC/MS

Naphthalene*	<0.001		0.001	mg/L	1	4122602	SK	07-Jan-25	8270C	
2-Methylnaphthalene*	<0.001		0.001	mg/L	1	4122602	SK	07-Jan-25	8270C	
1-Methylnaphthalene	<0.0005		0.0005	mg/L	1	4122602	SK	07-Jan-25	8270C	
Acenaphthylene*	<0.001		0.001	mg/L	1	4122602	SK	07-Jan-25	8270C	
Acenaphthene*	<0.001		0.001	mg/L	1	4122602	SK	07-Jan-25	8270C	
Fluorene*	<0.001		0.001	mg/L	1	4122602	SK	07-Jan-25	8270C	
Phenanthrene*	<0.001		0.001	mg/L	1	4122602	SK	07-Jan-25	8270C	
Anthracene*	<0.001		0.001	mg/L	1	4122602	SK	07-Jan-25	8270C	
Carbazole*	<0.001		0.001	mg/L	1	4122602	SK	07-Jan-25	8270C	
Fluoranthene*	<0.001		0.001	mg/L	1	4122602	SK	07-Jan-25	8270C	
Pyrene*	<0.001		0.001	mg/L	1	4122602	SK	07-Jan-25	8270C	
Benzo[a]anthracene*	<0.001		0.001	mg/L	1	4122602	SK	07-Jan-25	8270C	

Cardinal Laboratories

*=Accredited Analyte

PLEASE NOTE: Liability and Damages. Cardinal's liability and client's exclusive remedy for any claim arising, whether based in contract or tort, shall be limited to the amount paid by client for analyses. All claims, including those for negligence or any other cause whatsoever shall be deemed waived unless made in writing and received by Cardinal within thirty (30) days after completion of the applicable service. In no event shall Cardinal be liable for incidental or consequential damage including, without limitation, business interruptions, loss of use, or loss of profits incurred by client, its subsidiaries, affiliates or successors arising out of or related to the performance of the services hereunder by Cardinal, regardless of whether such claim is based upon any of the above stated reasons or otherwise. Results relate only to the samples identified above. This report shall not be reproduced except in full with written approval of Cardinal Laboratories.

Celey D. Keene, Lab Director/Quality Manager



PHONE (575) 393-2326 ° 101 E. MARLAND ° HOBBS, NM 88240

Analytical Results For:

AXIS ENVIROMENTAL
121 INDIAN RIDGE RD
BELTON TX, 76513

Project: G STATE 4
Project Number: NONE GIVEN
Project Manager: BRAD FREEMAN
Fax To:

Reported:
08-Jan-25 14:15

MW 8**H247666-03 (Water)**

Analyte	Result	MDL	Reporting Limit	Units	Dilution	Batch	Analyst	Analyzed	Method	Notes
---------	--------	-----	-----------------	-------	----------	-------	---------	----------	--------	-------

Cardinal Laboratories**Polynuclear Aromatic Compounds by GC/MS**

Chrysene*	<0.001		0.001	mg/L	1	4122602	SK	07-Jan-25	8270C	
Benzo[b]flouranthene*	<0.001		0.001	mg/L	1	4122602	SK	07-Jan-25	8270C	
Benzo[k]flouranthene*	<0.001		0.001	mg/L	1	4122602	SK	07-Jan-25	8270C	
Benzo[a]pyrene*	<0.0002		0.0002	mg/L	1	4122602	SK	07-Jan-25	8270C	
Indeno[1,2,3-cd]pyrene*	<0.001		0.001	mg/L	1	4122602	SK	07-Jan-25	8270C	
Dibenz[a,h]anthracene*	<0.001		0.001	mg/L	1	4122602	SK	07-Jan-25	8270C	
Benzo[g,h,i]perylene*	<0.001		0.001	mg/L	1	4122602	SK	07-Jan-25	8270C	
Surrogate: Nitrobenzene-d5			77.1 %	5.17-184		4122602	SK	07-Jan-25	8270C	
Surrogate: 2-Fluorobiphenyl			67.3 %	7.39-192		4122602	SK	07-Jan-25	8270C	
Surrogate: Terphenyl-d14			76.3 %	27.5-139		4122602	SK	07-Jan-25	8270C	

Cardinal Laboratories

*=Accredited Analyte

PLEASE NOTE: Liability and Damages. Cardinal's liability and client's exclusive remedy for any claim arising, whether based in contract or tort, shall be limited to the amount paid by client for analyses. All claims, including those for negligence or any other cause whatsoever shall be deemed waived unless made in writing and received by Cardinal within thirty (30) days after completion of the applicable service. In no event shall Cardinal be liable for incidental or consequential damage including, without limitation, business interruptions, loss of use, or loss of profits incurred by client, its subsidiaries, affiliates or successors arising out of or related to the performance of the services hereunder by Cardinal, regardless of whether such claim is based upon any of the above stated reasons or otherwise. Results relate only to the samples identified above. This report shall not be reproduced except in full with written approval of Cardinal Laboratories.

Celey D. Keene, Lab Director/Quality Manager



PHONE (575) 393-2326 ° 101 E. MARLAND ° HOBBS, NM 88240

Analytical Results For:

AXIS ENVIROMENTAL
121 INDIAN RIDGE RD
BELTON TX, 76513

Project: G STATE 4
Project Number: NONE GIVEN
Project Manager: BRAD FREEMAN
Fax To:

Reported:
08-Jan-25 14:15

MW 4**H247666-04 (Water)**

Analyte	Result	MDL	Reporting Limit	Units	Dilution	Batch	Analyst	Analyzed	Method	Notes
---------	--------	-----	-----------------	-------	----------	-------	---------	----------	--------	-------

Cardinal Laboratories**Inorganic Compounds**

Chloride*	164		4.00	mg/L	1	4122004	AC	20-Dec-24	4500-Cl-B	
------------------	------------	--	------	------	---	---------	----	-----------	-----------	--

Volatile Organic Compounds by EPA Method 8021

Benzene*	0.003		0.001	mg/L	1	4121825	JH	23-Dec-24	8021B	
Toluene*	<0.001		0.001	mg/L	1	4121825	JH	23-Dec-24	8021B	
Ethylbenzene*	<0.001		0.001	mg/L	1	4121825	JH	23-Dec-24	8021B	GC-NC
Total Xylenes*	<0.003		0.003	mg/L	1	4121825	JH	23-Dec-24	8021B	
Total BTEX	<0.006		0.006	mg/L	1	4121825	JH	23-Dec-24	8021B	

Surrogate: 4-Bromofluorobenzene (PID) 110 % 77.5-125 4121825 JH 23-Dec-24 8021B

Petroleum Hydrocarbons by GC FID

GRO C6-C10*	<1.00		1.00	mg/L	0.1	4121716	MS	21-Dec-24	8015B	
DRO >C10-C28*	<1.00		1.00	mg/L	0.1	4121716	MS	21-Dec-24	8015B	
EXT DRO >C28-C36	<1.00		1.00	mg/L	0.1	4121716	MS	21-Dec-24	8015B	

Surrogate: 1-Chlorooctane 89.7 % 68.3-140 4121716 MS 21-Dec-24 8015B

Surrogate: 1-Chlorooctadecane 91.2 % 56.7-151 4121716 MS 21-Dec-24 8015B

Polynuclear Aromatic Compounds by GC/MS

Naphthalene*	<0.001		0.001	mg/L	0.99	4122602	SK	07-Jan-25	8270C	
2-Methylnaphthalene*	<0.001		0.001	mg/L	0.99	4122602	SK	07-Jan-25	8270C	
1-Methylnaphthalene	<0.0005		0.0005	mg/L	0.99	4122602	SK	07-Jan-25	8270C	
Acenaphthylene*	<0.001		0.001	mg/L	0.99	4122602	SK	07-Jan-25	8270C	
Acenaphthene*	<0.001		0.001	mg/L	0.99	4122602	SK	07-Jan-25	8270C	
Fluorene*	<0.001		0.001	mg/L	0.99	4122602	SK	07-Jan-25	8270C	
Phenanthrene*	<0.001		0.001	mg/L	0.99	4122602	SK	07-Jan-25	8270C	
Anthracene*	<0.001		0.001	mg/L	0.99	4122602	SK	07-Jan-25	8270C	
Carbazole*	<0.001		0.001	mg/L	0.99	4122602	SK	07-Jan-25	8270C	
Fluoranthene*	<0.001		0.001	mg/L	0.99	4122602	SK	07-Jan-25	8270C	
Pyrene*	<0.001		0.001	mg/L	0.99	4122602	SK	07-Jan-25	8270C	
Benzo[a]anthracene*	<0.001		0.001	mg/L	0.99	4122602	SK	07-Jan-25	8270C	

Cardinal Laboratories

*=Accredited Analyte

PLEASE NOTE: Liability and Damages. Cardinal's liability and client's exclusive remedy for any claim arising, whether based in contract or tort, shall be limited to the amount paid by client for analyses. All claims, including those for negligence or any other cause whatsoever shall be deemed waived unless made in writing and received by Cardinal within thirty (30) days after completion of the applicable service. In no event shall Cardinal be liable for incidental or consequential damage including, without limitation, business interruptions, loss of use, or loss of profits incurred by client, its subsidiaries, affiliates or successors arising out of or related to the performance of the services hereunder by Cardinal, regardless of whether such claim is based upon any of the above stated reasons or otherwise. Results relate only to the samples identified above. This report shall not be reproduced except in full with written approval of Cardinal Laboratories.

Celey D. Keene, Lab Director/Quality Manager



PHONE (575) 393-2326 ° 101 E. MARLAND ° HOBBS, NM 88240

Analytical Results For:

AXIS ENVIROMENTAL
121 INDIAN RIDGE RD
BELTON TX, 76513

Project: G STATE 4
Project Number: NONE GIVEN
Project Manager: BRAD FREEMAN
Fax To:

Reported:
08-Jan-25 14:15

MW 4**H247666-04 (Water)**

Analyte	Result	MDL	Reporting Limit	Units	Dilution	Batch	Analyst	Analyzed	Method	Notes
---------	--------	-----	-----------------	-------	----------	-------	---------	----------	--------	-------

Cardinal Laboratories**Polynuclear Aromatic Compounds by GC/MS**

Chrysene*	<0.001		0.001	mg/L	0.99	4122602	SK	07-Jan-25	8270C	
Benzo[b]flouranthene*	<0.001		0.001	mg/L	0.99	4122602	SK	07-Jan-25	8270C	
Benzo[k]flouranthene*	<0.001		0.001	mg/L	0.99	4122602	SK	07-Jan-25	8270C	
Benzo[a]pyrene*	<0.0002		0.0002	mg/L	0.99	4122602	SK	07-Jan-25	8270C	
Indeno[1,2,3-cd]pyrene*	0.002		0.001	mg/L	0.99	4122602	SK	07-Jan-25	8270C	
Dibenz[a,h]anthracene*	<0.001		0.001	mg/L	0.99	4122602	SK	07-Jan-25	8270C	
Benzo[g,h,i]perylene*	<0.001		0.001	mg/L	0.99	4122602	SK	07-Jan-25	8270C	
Surrogate: Nitrobenzene-d5			64.9 %	5.17-184		4122602	SK	07-Jan-25	8270C	
Surrogate: 2-Fluorobiphenyl			47.8 %	7.39-192		4122602	SK	07-Jan-25	8270C	
Surrogate: Terphenyl-d14			54.7 %	27.5-139		4122602	SK	07-Jan-25	8270C	

Cardinal Laboratories

*=Accredited Analyte

PLEASE NOTE: Liability and Damages. Cardinal's liability and client's exclusive remedy for any claim arising, whether based in contract or tort, shall be limited to the amount paid by client for analyses. All claims, including those for negligence or any other cause whatsoever shall be deemed waived unless made in writing and received by Cardinal within thirty (30) days after completion of the applicable service. In no event shall Cardinal be liable for incidental or consequential damage including, without limitation, business interruptions, loss of use, or loss of profits incurred by client, its subsidiaries, affiliates or successors arising out of or related to the performance of the services hereunder by Cardinal, regardless of whether such claim is based upon any of the above stated reasons or otherwise. Results relate only to the samples identified above. This report shall not be reproduced except in full with written approval of Cardinal Laboratories.

Celey D. Keene, Lab Director/Quality Manager



PHONE (575) 393-2326 ° 101 E. MARLAND ° HOBBS, NM 88240

Analytical Results For:

AXIS ENVIROMENTAL
121 INDIAN RIDGE RD
BELTON TX, 76513

Project: G STATE 4
Project Number: NONE GIVEN
Project Manager: BRAD FREEMAN
Fax To:

Reported:
08-Jan-25 14:15

Inorganic Compounds - Quality Control**Cardinal Laboratories**

Analyte	Result	Reporting Limit	Units	Spike Level	Source Result	%REC Limits	RPD	RPD Limit	Notes
Batch 4122004 - General Prep - Wet Chem									
Blank (4122004-BLK1)				Prepared & Analyzed: 20-Dec-24					
Chloride	ND	4.00	mg/L						
LCS (4122004-BS1)				Prepared & Analyzed: 20-Dec-24					
Chloride	100	4.00	mg/L	100		100	80-120		
LCS Dup (4122004-BSD1)				Prepared & Analyzed: 20-Dec-24					
Chloride	104	4.00	mg/L	100		104	80-120	3.92	20

Cardinal Laboratories

*=Accredited Analyte

PLEASE NOTE: Liability and Damages. Cardinal's liability and client's exclusive remedy for any claim arising, whether based in contract or tort, shall be limited to the amount paid by client for analyses. All claims, including those for negligence or any other cause whatsoever shall be deemed waived unless made in writing and received by Cardinal within thirty (30) days after completion of the applicable service. In no event shall Cardinal be liable for incidental or consequential damage including, without limitation, business interruptions, loss of use, or loss of profits incurred by client, its subsidiaries, affiliates or successors arising out of or related to the performance of the services hereunder by Cardinal, regardless of whether such claim is based upon any of the above stated reasons or otherwise. Results relate only to the samples identified above. This report shall not be reproduced except in full with written approval of Cardinal Laboratories.

Celey D. Keene, Lab Director/Quality Manager



PHONE (575) 393-2326 ° 101 E. MARLAND ° HOBBS, NM 88240

Analytical Results For:

AXIS ENVIROMENTAL
121 INDIAN RIDGE RD
BELTON TX, 76513

Project: G STATE 4
Project Number: NONE GIVEN
Project Manager: BRAD FREEMAN
Fax To:

Reported:
08-Jan-25 14:15

Volatile Organic Compounds by EPA Method 8021 - Quality Control**Cardinal Laboratories**

Analyte	Result	Reporting Limit	Units	Spike Level	Source Result	%REC	%REC Limits	RPD	RPD Limit	Notes
---------	--------	-----------------	-------	-------------	---------------	------	-------------	-----	-----------	-------

Batch 4121825 - Volatiles**Blank (4121825-BLK1)**

Prepared: 18-Dec-24 Analyzed: 23-Dec-24

Benzene	ND	0.001	mg/L							
Toluene	ND	0.001	mg/L							
Ethylbenzene	ND	0.001	mg/L							
Total Xylenes	ND	0.003	mg/L							
Total BTEX	ND	0.006	mg/L							
Surrogate: 4-Bromofluorobenzene (PID)	0.0507		mg/L	0.0500		101	77.5-125			

LCS (4121825-BS1)

Prepared: 18-Dec-24 Analyzed: 23-Dec-24

Benzene	0.020	0.001	mg/L	0.0200		102	80.8-112			
Toluene	0.021	0.001	mg/L	0.0200		106	78.7-114			
Ethylbenzene	0.021	0.001	mg/L	0.0200		105	70.9-120			
m,p-Xylene	0.040	0.002	mg/L	0.0400		100	76.9-119			
o-Xylene	0.021	0.001	mg/L	0.0200		104	71.7-120			
Total Xylenes	0.061	0.003	mg/L	0.0600		101	75.6-119			
Surrogate: 4-Bromofluorobenzene (PID)	0.0504		mg/L	0.0500		101	77.5-125			

LCS Dup (4121825-BS1)

Prepared: 18-Dec-24 Analyzed: 23-Dec-24

Benzene	0.021	0.001	mg/L	0.0200		104	80.8-112	2.78	8.26	
Toluene	0.021	0.001	mg/L	0.0200		107	78.7-114	1.36	9.03	
Ethylbenzene	0.021	0.001	mg/L	0.0200		106	70.9-120	1.29	11.9	
m,p-Xylene	0.041	0.002	mg/L	0.0400		102	76.9-119	1.42	11	
o-Xylene	0.021	0.001	mg/L	0.0200		105	71.7-120	1.58	15	
Total Xylenes	0.062	0.003	mg/L	0.0600		103	75.6-119	1.48	12.2	
Surrogate: 4-Bromofluorobenzene (PID)	0.0501		mg/L	0.0500		100	77.5-125			

Cardinal Laboratories

*=Accredited Analyte

PLEASE NOTE: Liability and Damages. Cardinal's liability and client's exclusive remedy for any claim arising, whether based in contract or tort, shall be limited to the amount paid by client for analyses. All claims, including those for negligence or any other cause whatsoever shall be deemed waived unless made in writing and received by Cardinal within thirty (30) days after completion of the applicable service. In no event shall Cardinal be liable for incidental or consequential damage including, without limitation, business interruptions, loss of use, or loss of profits incurred by client, its subsidiaries, affiliates or successors arising out of or related to the performance of the services hereunder by Cardinal, regardless of whether such claim is based upon any of the above stated reasons or otherwise. Results relate only to the samples identified above. This report shall not be reproduced except in full with written approval of Cardinal Laboratories.

Celey D. Keene, Lab Director/Quality Manager



PHONE (575) 393-2326 ° 101 E. MARLAND ° HOBBS, NM 88240

Analytical Results For:

AXIS ENVIROMENTAL
121 INDIAN RIDGE RD
BELTON TX, 76513

Project: G STATE 4
Project Number: NONE GIVEN
Project Manager: BRAD FREEMAN
Fax To:

Reported:
08-Jan-25 14:15

Petroleum Hydrocarbons by GC FID - Quality Control**Cardinal Laboratories**

Analyte	Result	Reporting Limit	Units	Spike Level	Source Result	%REC	%REC Limits	RPD	RPD Limit	Notes
---------	--------	--------------------	-------	----------------	------------------	------	----------------	-----	--------------	-------

Batch 4121716 - General Prep - Organics**Blank (4121716-BLK1)**

Prepared: 17-Dec-24 Analyzed: 21-Dec-24

GRO C6-C10	ND	1.00	mg/L							
DRO >C10-C28	ND	1.00	mg/L							
EXT DRO >C28-C36	ND	1.00	mg/L							
Surrogate: 1-Chlorooctane	4.00		mg/L	5.00		79.9	68.3-140			
Surrogate: 1-Chlorooctadecane	4.06		mg/L	5.00		81.3	56.7-151			

LCS (4121716-BS1)

Prepared: 17-Dec-24 Analyzed: 21-Dec-24

GRO C6-C10	54.0	1.00	mg/L	50.0		108	69.4-116			
DRO >C10-C28	51.5	1.00	mg/L	50.0		103	52.9-151			
Surrogate: 1-Chlorooctane	5.39		mg/L	5.00		108	68.3-140			
Surrogate: 1-Chlorooctadecane	4.76		mg/L	5.00		95.2	56.7-151			

LCS Dup (4121716-BSD1)

Prepared: 17-Dec-24 Analyzed: 21-Dec-24

GRO C6-C10	54.2	1.00	mg/L	50.0		108	69.4-116	0.418	18.9	
DRO >C10-C28	51.8	1.00	mg/L	50.0		104	52.9-151	0.573	21.9	
Surrogate: 1-Chlorooctane	5.47		mg/L	5.00		109	68.3-140			
Surrogate: 1-Chlorooctadecane	4.78		mg/L	5.00		95.6	56.7-151			

Cardinal Laboratories

*=Accredited Analyte

PLEASE NOTE: Liability and Damages. Cardinal's liability and client's exclusive remedy for any claim arising, whether based in contract or tort, shall be limited to the amount paid by client for analyses. All claims, including those for negligence or any other cause whatsoever shall be deemed waived unless made in writing and received by Cardinal within thirty (30) days after completion of the applicable service. In no event shall Cardinal be liable for incidental or consequential damage including, without limitation, business interruptions, loss of use, or loss of profits incurred by client, its subsidiaries, affiliates or successors arising out of or related to the performance of the services hereunder by Cardinal, regardless of whether such claim is based upon any of the above stated reasons or otherwise. Results relate only to the samples identified above. This report shall not be reproduced except in full with written approval of Cardinal Laboratories.

Celey D. Keene, Lab Director/Quality Manager



PHONE (575) 393-2326 ° 101 E. MARLAND ° HOBBS, NM 88240

Analytical Results For:

AXIS ENVIROMENTAL
121 INDIAN RIDGE RD
BELTON TX, 76513

Project: G STATE 4
Project Number: NONE GIVEN
Project Manager: BRAD FREEMAN
Fax To:

Reported:
08-Jan-25 14:15

Polynuclear Aromatic Compounds by GC/MS - Quality Control**Cardinal Laboratories**

Analyte	Result	Reporting Limit	Units	Spike Level	Source Result	%REC	%REC Limits	RPD	RPD Limit	Notes
---------	--------	-----------------	-------	-------------	---------------	------	-------------	-----	-----------	-------

Batch 4122017 - SW846-3510**Blank (4122017-BLK1)**

Prepared: 20-Dec-24 Analyzed: 30-Dec-24

Naphthalene	ND	0.001	mg/L							
2-Methylnaphthalene	ND	0.001	mg/L							
1-Methylnaphthalene	ND	0.0005	mg/L							
Acenaphthylene	ND	0.001	mg/L							
Acenaphthene	ND	0.001	mg/L							
Fluorene	ND	0.001	mg/L							
Phenanthrene	ND	0.001	mg/L							
Anthracene	ND	0.001	mg/L							
Carbazole	ND	0.001	mg/L							
Fluoranthene	ND	0.001	mg/L							
Pyrene	ND	0.001	mg/L							
Benzo[a]anthracene	ND	0.001	mg/L							
Chrysene	ND	0.001	mg/L							
Benzo[b]fluoranthene	ND	0.001	mg/L							
Benzo[k]fluoranthene	ND	0.001	mg/L							
Benzo[a]pyrene	ND	0.0002	mg/L							
Indeno[1,2,3-cd]pyrene	ND	0.001	mg/L							
Dibenz[a,h]anthracene	ND	0.001	mg/L							
Benzo[g,h,i]perylene	ND	0.001	mg/L							
Surrogate: Nitrobenzene-d5	0.0494		mg/L	0.0500		98.9	5.17-184			
Surrogate: 2-Fluorobiphenyl	0.0348		mg/L	0.0500		69.5	7.39-192			
Surrogate: Terphenyl-d14	0.0429		mg/L	0.0500		85.7	27.5-139			

LCS (4122017-BS1)

Prepared: 20-Dec-24 Analyzed: 30-Dec-24

Naphthalene	0.008	0.001	mg/L	0.0100		81.4	46.9-122			
2-Methylnaphthalene	0.007	0.001	mg/L	0.0100		70.5	48.1-126			
1-Methylnaphthalene	0.008	0.0005	mg/L	0.0100		82.6	47.6-126			
Acenaphthylene	0.007	0.001	mg/L	0.0100		71.3	50.2-124			
Acenaphthene	0.006	0.001	mg/L	0.0100		55.2	49.4-119			
Fluorene	0.007	0.001	mg/L	0.0100		68.8	50.1-126			
Phenanthrene	0.008	0.001	mg/L	0.0100		83.1	53.6-120			
Anthracene	0.008	0.001	mg/L	0.0100		83.0	51.9-120			

Cardinal Laboratories

*=Accredited Analyte

PLEASE NOTE: Liability and Damages. Cardinal's liability and client's exclusive remedy for any claim arising, whether based in contract or tort, shall be limited to the amount paid by client for analyses. All claims, including those for negligence or any other cause whatsoever shall be deemed waived unless made in writing and received by Cardinal within thirty (30) days after completion of the applicable service. In no event shall Cardinal be liable for incidental or consequential damage including, without limitation, business interruptions, loss of use, or loss of profits incurred by client, its subsidiaries, affiliates or successors arising out of or related to the performance of the services hereunder by Cardinal, regardless of whether such claim is based upon any of the above stated reasons or otherwise. Results relate only to the samples identified above. This report shall not be reproduced except in full with written approval of Cardinal Laboratories.

Celey D. Keene, Lab Director/Quality Manager



PHONE (575) 393-2326 • 101 E. MARLAND • HOBBS, NM 88240

Analytical Results For:

AXIS ENVIROMENTAL
121 INDIAN RIDGE RD
BELTON TX, 76513

Project: G STATE 4
Project Number: NONE GIVEN
Project Manager: BRAD FREEMAN
Fax To:

Reported:
08-Jan-25 14:15

Polynuclear Aromatic Compounds by GC/MS - Quality Control**Cardinal Laboratories**

Analyte	Result	Reporting Limit	Units	Spike Level	Source Result	%REC	%REC Limits	RPD	RPD Limit	Notes
---------	--------	-----------------	-------	-------------	---------------	------	-------------	-----	-----------	-------

Batch 4122017 - SW846-3510**LCS (4122017-BS1)**

Prepared: 20-Dec-24 Analyzed: 30-Dec-24

Carbazole	0.008	0.001	mg/L	0.0100		83.1	54-123			
Fluoranthene	0.008	0.001	mg/L	0.0100		81.7	54.9-126			
Pyrene	0.009	0.001	mg/L	0.0100		94.0	50.2-124			
Benzo[a]anthracene	0.008	0.001	mg/L	0.0100		78.9	49.9-123			
Chrysene	0.009	0.001	mg/L	0.0100		92.6	50.1-125			
Benzo[b]fluoranthene	0.008	0.001	mg/L	0.0100		83.0	52.1-125			
Benzo[k]fluoranthene	0.009	0.001	mg/L	0.0100		92.3	49.3-131			
Benzo[a]pyrene	0.009	0.0002	mg/L	0.0100		87.4	52.9-126			
Indeno[1,2,3-cd]pyrene	0.013	0.001	mg/L	0.0100		126	50-132			
Dibenz[a,h]anthracene	0.012	0.001	mg/L	0.0100		121	51.7-129			
Benzo[g,h,i]perylene	0.013	0.001	mg/L	0.0100		131	50.7-130			BS1
Surrogate: Nitrobenzene-d5	0.0435		mg/L	0.0500		87.0	5.17-184			
Surrogate: 2-Fluorobiphenyl	0.0309		mg/L	0.0500		61.9	7.39-192			
Surrogate: Terphenyl-d14	0.0402		mg/L	0.0500		80.4	27.5-139			

LCS Dup (4122017-BSD1)

Prepared: 20-Dec-24 Analyzed: 30-Dec-24

Naphthalene	0.009	0.001	mg/L	0.0100		89.3	46.9-122	9.26	3.46	QR-04
2-Methylnaphthalene	0.007	0.001	mg/L	0.0100		74.2	48.1-126	5.11	4.47	QR-04
1-Methylnaphthalene	0.007	0.0005	mg/L	0.0100		72.9	47.6-126	12.5	4.3	QR-04
Acenaphthylene	0.007	0.001	mg/L	0.0100		73.6	50.2-124	3.17	3.88	
Acenaphthene	0.007	0.001	mg/L	0.0100		70.8	49.4-119	24.8	3.77	QR-04
Fluorene	0.007	0.001	mg/L	0.0100		68.9	50.1-126	0.145	4.31	
Phenanthrene	0.008	0.001	mg/L	0.0100		79.7	53.6-120	4.18	5.04	
Anthracene	0.009	0.001	mg/L	0.0100		90.3	51.9-120	8.42	4.49	QR-04
Carbazole	0.009	0.001	mg/L	0.0100		91.2	54-123	9.29	4.78	QR-04
Fluoranthene	0.009	0.001	mg/L	0.0100		91.1	54.9-126	10.9	6.19	QR-04
Pyrene	0.009	0.001	mg/L	0.0100		87.2	50.2-124	7.51	7.75	
Benzo[a]anthracene	0.009	0.001	mg/L	0.0100		88.5	49.9-123	11.5	3.03	QR-04
Chrysene	0.010	0.001	mg/L	0.0100		96.4	50.1-125	4.02	3.42	QR-04
Benzo[b]fluoranthene	0.010	0.001	mg/L	0.0100		97.6	52.1-125	16.2	6.95	QR-04
Benzo[k]fluoranthene	0.010	0.001	mg/L	0.0100		96.5	49.3-131	4.45	8.16	
Benzo[a]pyrene	0.010	0.0002	mg/L	0.0100		95.1	52.9-126	8.44	3.27	QR-04

Cardinal Laboratories

*=Accredited Analyte

PLEASE NOTE: Liability and Damages. Cardinal's liability and client's exclusive remedy for any claim arising, whether based in contract or tort, shall be limited to the amount paid by client for analyses. All claims, including those for negligence or any other cause whatsoever shall be deemed waived unless made in writing and received by Cardinal within thirty (30) days after completion of the applicable service. In no event shall Cardinal be liable for incidental or consequential damage including, without limitation, business interruptions, loss of use, or loss of profits incurred by client, its subsidiaries, affiliates or successors arising out of or related to the performance of the services hereunder by Cardinal, regardless of whether such claim is based upon any of the above stated reasons or otherwise. Results relate only to the samples identified above. This report shall not be reproduced except in full with written approval of Cardinal Laboratories.

Celey D. Keene, Lab Director/Quality Manager



PHONE (575) 393-2326 ° 101 E. MARLAND ° HOBBS, NM 88240

Analytical Results For:

AXIS ENVIROMENTAL
121 INDIAN RIDGE RD
BELTON TX, 76513

Project: G STATE 4
Project Number: NONE GIVEN
Project Manager: BRAD FREEMAN
Fax To:

Reported:
08-Jan-25 14:15

Polynuclear Aromatic Compounds by GC/MS - Quality Control**Cardinal Laboratories**

Analyte	Result	Reporting Limit	Units	Spike Level	Source Result	%REC	%REC Limits	RPD	RPD Limit	Notes
---------	--------	-----------------	-------	-------------	---------------	------	-------------	-----	-----------	-------

Batch 4122017 - SW846-3510**LCS Dup (4122017-BSD1)**

Prepared: 20-Dec-24 Analyzed: 30-Dec-24

Indeno[1,2,3-cd]pyrene	0.013	0.001	mg/L	0.0100		134	50-132	5.69	4.11	BS1, QR-04
Dibenz[a,h]anthracene	0.013	0.001	mg/L	0.0100		128	51.7-129	6.02	4.77	QR-04
Benzo[g,h,i]perylene	0.013	0.001	mg/L	0.0100		131	50.7-130	0.534	6.35	BS1
Surrogate: Nitrobenzene-d5	0.0534		mg/L	0.0500		107	5.17-184			
Surrogate: 2-Fluorobiphenyl	0.0340		mg/L	0.0500		68.0	7.39-192			
Surrogate: Terphenyl-dl4	0.0388		mg/L	0.0500		77.7	27.5-139			

Batch 4122602 - SW846-3510**Blank (4122602-BLK1)**

Prepared: 26-Dec-24 Analyzed: 07-Jan-25

Naphthalene	ND	0.001	mg/L							
2-Methylnaphthalene	ND	0.001	mg/L							
1-Methylnaphthalene	ND	0.0005	mg/L							
Acenaphthylene	ND	0.001	mg/L							
Acenaphthene	ND	0.001	mg/L							
Fluorene	ND	0.001	mg/L							
Phenanthrene	ND	0.001	mg/L							
Anthracene	ND	0.001	mg/L							
Carbazole	ND	0.001	mg/L							
Fluoranthene	ND	0.001	mg/L							
Pyrene	ND	0.001	mg/L							
Benzo[a]anthracene	ND	0.001	mg/L							
Chrysene	ND	0.001	mg/L							
Benzo[b]fluoranthene	ND	0.001	mg/L							
Benzo[k]fluoranthene	ND	0.001	mg/L							
Benzo[a]pyrene	ND	0.0002	mg/L							
Indeno[1,2,3-cd]pyrene	ND	0.001	mg/L							
Dibenz[a,h]anthracene	ND	0.001	mg/L							
Benzo[g,h,i]perylene	ND	0.001	mg/L							
Surrogate: Nitrobenzene-d5	0.0288		mg/L	0.0500		57.6	5.17-184			
Surrogate: 2-Fluorobiphenyl	0.0264		mg/L	0.0500		52.8	7.39-192			
Surrogate: Terphenyl-dl4	0.0316		mg/L	0.0500		63.2	27.5-139			

Cardinal Laboratories

*=Accredited Analyte

PLEASE NOTE: Liability and Damages. Cardinal's liability and client's exclusive remedy for any claim arising, whether based in contract or tort, shall be limited to the amount paid by client for analyses. All claims, including those for negligence or any other cause whatsoever shall be deemed waived unless made in writing and received by Cardinal within thirty (30) days after completion of the applicable service. In no event shall Cardinal be liable for incidental or consequential damage including, without limitation, business interruptions, loss of use, or loss of profits incurred by client, its subsidiaries, affiliates or successors arising out of or related to the performance of the services hereunder by Cardinal, regardless of whether such claim is based upon any of the above stated reasons or otherwise. Results relate only to the samples identified above. This report shall not be reproduced except in full with written approval of Cardinal Laboratories.

Celey D. Keene, Lab Director/Quality Manager



PHONE (575) 393-2326 ° 101 E. MARLAND ° HOBBS, NM 88240

Analytical Results For:

AXIS ENVIROMENTAL
121 INDIAN RIDGE RD
BELTON TX, 76513

Project: G STATE 4
Project Number: NONE GIVEN
Project Manager: BRAD FREEMAN
Fax To:

Reported:
08-Jan-25 14:15

Polynuclear Aromatic Compounds by GC/MS - Quality Control**Cardinal Laboratories**

Analyte	Result	Reporting Limit	Units	Spike Level	Source Result	%REC Limits	RPD	RPD Limit	Notes
---------	--------	--------------------	-------	----------------	------------------	----------------	-----	--------------	-------

Batch 4122602 - SW846-3510**LCS (4122602-BS1)**

Prepared: 26-Dec-24 Analyzed: 08-Jan-25

Naphthalene	0.007	0.001	mg/L	0.0100		74.4	46.9-122		
2-Methylnaphthalene	0.007	0.001	mg/L	0.0100		73.8	48.1-126		
1-Methylnaphthalene	0.007	0.0005	mg/L	0.0100		74.5	47.6-126		
Acenaphthylene	0.008	0.001	mg/L	0.0100		77.4	50.2-124		
Acenaphthene	0.008	0.001	mg/L	0.0100		76.1	49.4-119		
Fluorene	0.008	0.001	mg/L	0.0100		80.4	50.1-126		
Phenanthrene	0.009	0.001	mg/L	0.0100		86.5	53.6-120		
Anthracene	0.009	0.001	mg/L	0.0100		87.0	51.9-120		
Carbazole	0.009	0.001	mg/L	0.0100		85.8	54-123		
Fluoranthene	0.008	0.001	mg/L	0.0100		83.7	54.9-126		
Pyrene	0.008	0.001	mg/L	0.0100		79.9	50.2-124		
Benzo[a]anthracene	0.008	0.001	mg/L	0.0100		79.7	49.9-123		
Chrysene	0.008	0.001	mg/L	0.0100		81.3	50.1-125		
Benzo[b]fluoranthene	0.008	0.001	mg/L	0.0100		84.4	52.1-125		
Benzo[k]fluoranthene	0.008	0.001	mg/L	0.0100		84.1	49.3-131		
Benzo[a]pyrene	0.009	0.0002	mg/L	0.0100		86.8	52.9-126		
Indeno[1,2,3-cd]pyrene	0.008	0.001	mg/L	0.0100		84.4	50-132		
Dibenz[a,h]anthracene	0.008	0.001	mg/L	0.0100		83.7	51.7-129		
Benzo[g,h,i]perylene	0.008	0.001	mg/L	0.0100		83.9	50.7-130		
Surrogate: Nitrobenzene-d5	0.0316		mg/L	0.0500		63.3	5.17-184		
Surrogate: 2-Fluorobiphenyl	0.0302		mg/L	0.0500		60.3	7.39-192		
Surrogate: Terphenyl-d14	0.0384		mg/L	0.0500		76.8	27.5-139		

LCS Dup (4122602-BSD1)

Prepared: 26-Dec-24 Analyzed: 08-Jan-25

Naphthalene	0.007	0.001	mg/L	0.0100		72.7	46.9-122	2.31	3.46
2-Methylnaphthalene	0.007	0.001	mg/L	0.0100		73.1	48.1-126	0.953	4.47
1-Methylnaphthalene	0.008	0.0005	mg/L	0.0100		77.3	47.6-126	3.69	4.3
Acenaphthylene	0.008	0.001	mg/L	0.0100		78.3	50.2-124	1.16	3.88
Acenaphthene	0.008	0.001	mg/L	0.0100		79.0	49.4-119	3.74	3.77
Fluorene	0.008	0.001	mg/L	0.0100		80.1	50.1-126	0.374	4.31
Phenanthrene	0.008	0.001	mg/L	0.0100		84.2	53.6-120	2.69	5.04
Anthracene	0.008	0.001	mg/L	0.0100		83.3	51.9-120	4.35	4.49

Cardinal Laboratories

*=Accredited Analyte

PLEASE NOTE: Liability and Damages. Cardinal's liability and client's exclusive remedy for any claim arising, whether based in contract or tort, shall be limited to the amount paid by client for analyses. All claims, including those for negligence or any other cause whatsoever shall be deemed waived unless made in writing and received by Cardinal within thirty (30) days after completion of the applicable service. In no event shall Cardinal be liable for incidental or consequential damage including, without limitation, business interruptions, loss of use, or loss of profits incurred by client, its subsidiaries, affiliates or successors arising out of or related to the performance of the services hereunder by Cardinal, regardless of whether such claim is based upon any of the above stated reasons or otherwise. Results relate only to the samples identified above. This report shall not be reproduced except in full with written approval of Cardinal Laboratories.

Celey D. Keene, Lab Director/Quality Manager



PHONE (575) 393-2326 ° 101 E. MARLAND ° HOBBS, NM 88240

Analytical Results For:

AXIS ENVIROMENTAL
121 INDIAN RIDGE RD
BELTON TX, 76513

Project: G STATE 4
Project Number: NONE GIVEN
Project Manager: BRAD FREEMAN
Fax To:

Reported:
08-Jan-25 14:15

Polynuclear Aromatic Compounds by GC/MS - Quality Control**Cardinal Laboratories**

Analyte	Result	Reporting Limit	Units	Spike Level	Source Result	%REC Limits	RPD	RPD Limit	Notes
---------	--------	--------------------	-------	----------------	------------------	----------------	-----	--------------	-------

Batch 4122602 - SW846-3510**LCS Dup (4122602-BSD1)**

Prepared: 26-Dec-24 Analyzed: 08-Jan-25

Carbazole	0.008	0.001	mg/L	0.0100		84.5	54-123	1.53	4.78	
Fluoranthene	0.009	0.001	mg/L	0.0100		86.8	54.9-126	3.64	6.19	
Pyrene	0.008	0.001	mg/L	0.0100		77.1	50.2-124	3.57	7.75	
Benzo[a]anthracene	0.008	0.001	mg/L	0.0100		77.6	49.9-123	2.67	3.03	
Chrysene	0.008	0.001	mg/L	0.0100		78.1	50.1-125	4.02	3.42	QR-04
Benzo[b]fluoranthene	0.008	0.001	mg/L	0.0100		82.9	52.1-125	1.79	6.95	
Benzo[k]fluoranthene	0.008	0.001	mg/L	0.0100		83.5	49.3-131	0.716	8.16	
Benzo[a]pyrene	0.008	0.0002	mg/L	0.0100		82.2	52.9-126	5.44	3.27	QR-04
Indeno[1,2,3-cd]pyrene	0.008	0.001	mg/L	0.0100		83.2	50-132	1.43	4.11	
Dibenz[a,h]anthracene	0.008	0.001	mg/L	0.0100		82.3	51.7-129	1.69	4.77	
Benzo[g,h,i]perylene	0.008	0.001	mg/L	0.0100		83.4	50.7-130	0.598	6.35	
Surrogate: Nitrobenzene-d5	0.0306		mg/L	0.0500		61.1	5.17-184			
Surrogate: 2-Fluorobiphenyl	0.0308		mg/L	0.0500		61.7	7.39-192			
Surrogate: Terphenyl-d14	0.0375		mg/L	0.0500		75.1	27.5-139			

Cardinal Laboratories

*=Accredited Analyte

PLEASE NOTE: Liability and Damages. Cardinal's liability and client's exclusive remedy for any claim arising, whether based in contract or tort, shall be limited to the amount paid by client for analyses. All claims, including those for negligence or any other cause whatsoever shall be deemed waived unless made in writing and received by Cardinal within thirty (30) days after completion of the applicable service. In no event shall Cardinal be liable for incidental or consequential damage including, without limitation, business interruptions, loss of use, or loss of profits incurred by client, its subsidiaries, affiliates or successors arising out of or related to the performance of the services hereunder by Cardinal, regardless of whether such claim is based upon any of the above stated reasons or otherwise. Results relate only to the samples identified above. This report shall not be reproduced except in full with written approval of Cardinal Laboratories.

Celey D. Keene, Lab Director/Quality Manager



PHONE (575) 393-2326 ° 101 E. MARLAND ° HOBBS, NM 88240

Notes and Definitions

QR-04	The RPD for the BS/BSD was outside of historical limits.
GC-NC	8260 confirmation analysis was performed; initial GC results were not supported by GC/MS analysis and are reported as ND.
BS1	Blank spike recovery above laboratory acceptance criteria. Results for analyte potentially biased high.
ND	Analyte NOT DETECTED at or above the reporting limit
RPD	Relative Percent Difference
**	Samples not received at proper temperature of 6°C or below.
***	Insufficient time to reach temperature.
-	Chloride by SM4500Cl-B does not require samples be received at or below 6°C Samples reported on an as received basis (wet) unless otherwise noted on report

Cardinal Laboratories

*=Accredited Analyte

PLEASE NOTE: Liability and Damages. Cardinal's liability and client's exclusive remedy for any claim arising, whether based in contract or tort, shall be limited to the amount paid by client for analyses. All claims, including those for negligence or any other cause whatsoever shall be deemed waived unless made in writing and received by Cardinal within thirty (30) days after completion of the applicable service. In no event shall Cardinal be liable for incidental or consequential damage including, without limitation, business interruptions, loss of use, or loss of profits incurred by client, its subsidiaries, affiliates or successors arising out of or related to the performance of the services hereunder by Cardinal, regardless of whether such claim is based upon any of the above stated reasons or otherwise. Results relate only to the samples identified above. This report shall not be reproduced except in full with written approval of Cardinal Laboratories.

A handwritten signature in black ink, appearing to read "Celey D. Keene", is written over a horizontal line.

Celey D. Keene, Lab Director/Quality Manager

Attachment 2

LPH Thickness Graph

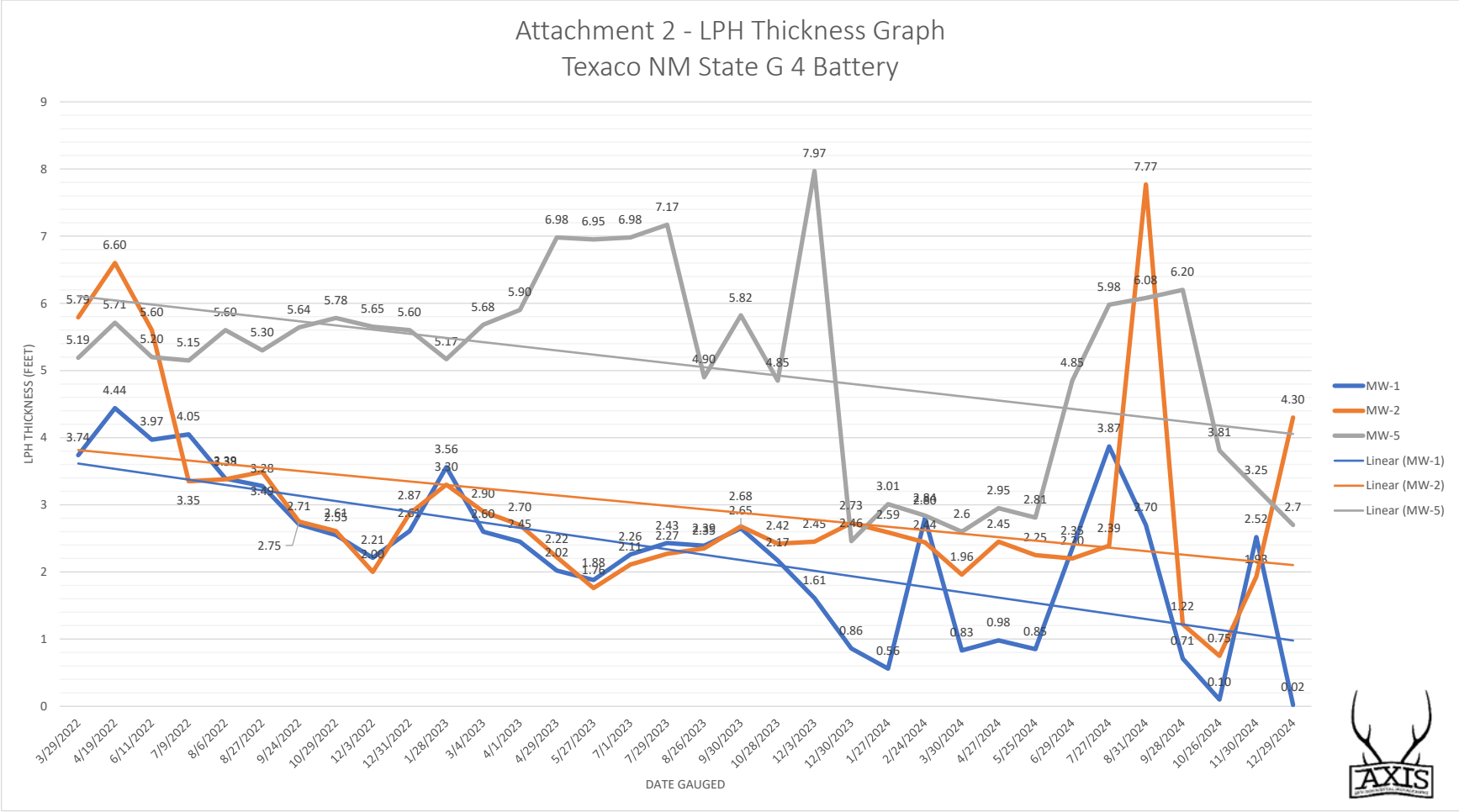

Sante Fe Main Office
Phone: (505) 476-3441

General Information
Phone: (505) 629-6116

Online Phone Directory
<https://www.emnrd.nm.gov/ocd/contact-us>

State of New Mexico
Energy, Minerals and Natural Resources
Oil Conservation Division
1220 S. St Francis Dr.
Santa Fe, NM 87505

CONDITIONS

Action 504168

CONDITIONS

Operator: HESS CORPORATION 1501 McKinney Street Houston, TX 77010	OGRID:
	495
	Action Number: 504168
	Action Type: [UF-GWA] Ground Water Abatement (GROUND WATER ABATEMENT)

CONDITIONS

Created By	Condition	Condition Date
shanna.smith	Transition from submitting annual monitoring and sampling reports to submitting quarterly monitoring and sampling reports.	9/16/2025
shanna.smith	Clarify the 2024 Annual Site Update report states gradient is to the northeast. Figure 2 and 3 show gradient to the northwest.	9/16/2025
shanna.smith	All groundwater samples will be analyzed according to all constituents in 20.6.2.3103 NMAC Pursuant to 19.15.30.9 B(2) NMAC. Operators may request to reduce sampling constituents based upon future results.	9/16/2025
shanna.smith	OCD records indicate that an approved Stage 1 plan is not on file. Pursuant to 19.15.30 NMAC Hess must submit a Stage 1 Abatement plan no later than December 16, 2025 that meets all of the requirements of 19.15.30.13 NMAC.	9/16/2025
shanna.smith	Alternatively, if a Stage 1/Stage 2 Abatement Report has been approved by OCD, provide a copy of Stage 1/ Stage 2 Abatement Report by October 14, 2025, so OCD can update our Online records.	9/16/2025
shanna.smith	The 2024 AGWMM on March 31, 2025, is approved with COA's. A Closure Report must be submitted separately for OCD review and approval.	9/16/2025