

**State of New Mexico**  
**Energy, Minerals and Natural Resources**  
**Oil Conservation Division**  
**1220 S. St Francis Dr.**  
**Santa Fe, NM 87505**

**APPLICATION FOR PERMIT TO DRILL, RE-ENTER, DEEPEN, PLUGBACK, OR ADD A ZONE**

1. Operator Name and Address HESS CORPORATION P.O. BOX 840 SEMINOLE, TX 79360		2. OGRID Number 495
		3. API Number 30-021-20508
4. Property Code 133	5. Property Name MITCHELL	6. Well No. 181

**7. Surface Location**

UL - Lot B	Section 18	Township 18N	Range 30E	Lot Idn B	Feet From 1200	N/S Line N	Feet From 1650	E/W Line E	County HARDING
---------------	---------------	-----------------	--------------	--------------	-------------------	---------------	-------------------	---------------	-------------------

**8. Pool Information**

WEST BRAVO DOME CO2 GAS	96387
-------------------------	-------

**Additional Well Information**

9. Work Type New Well	10. Well Type CO2	11. Cable/Rotary	12. Lease Type Private	13. Ground Level Elevation 4503
14. Multiple N	15. Proposed Depth	16. Formation Tubb	17. Contractor	18. Spud Date 4/3/2010
Depth to Ground water		Distance from nearest fresh water well		Distance to nearest surface water
Pit: Liner: Synthetic <input type="checkbox"/> mils thick Clay <input type="checkbox"/> Pit Volume: bbls Drilling Method: Closed Loop System <input checked="" type="checkbox"/> Fresh Water <input type="checkbox"/> Brine <input type="checkbox"/> Diesel/Oil-based <input type="checkbox"/> Gas/Air <input type="checkbox"/>				

**19. Proposed Casing and Cement Program**

Type	Hole Size	Casing Type	Casing Weight/ft	Setting Depth	Sacks of Cement	Estimated TOC
Surf	12.25	8.625	24	750	400	0
Prod	7.875	4.5	12.75	2139	350	0

**Casing/Cement Program: Additional Comments**

TOC is estimated at Surface
-----------------------------

**Proposed Blowout Prevention Program**

Type	Working Pressure	Test Pressure	Manufacturer
DoubleRam	2000	2000	SHAFFER

I hereby certify that the information given above is true and complete to the best of my knowledge and belief. I further certify that the drilling pit will be constructed according to NMOCD guidelines <input type="checkbox"/> , a general permit <input type="checkbox"/> , or an (attached) alternative OCD-approved plan <input type="checkbox"/> . Printed Name: Electronically filed by Rita Smith Title: Engineering Tech Email Address: rsmith@hess.com Date: 12/18/2009	<b>OIL CONSERVATION DIVISION</b>	
	Approved By: Ed Martin	
	Title: District Supervisor	
	Approved Date: 1/13/2009	Expiration Date: 1/13/2011
	Phone: 432-758-6726	

SECTION 18, TOWNSHIP 18 NORTH, RANGE 30 EAST, N.M.P.M.,  
HARDING COUNTY, NEW MEXICO.

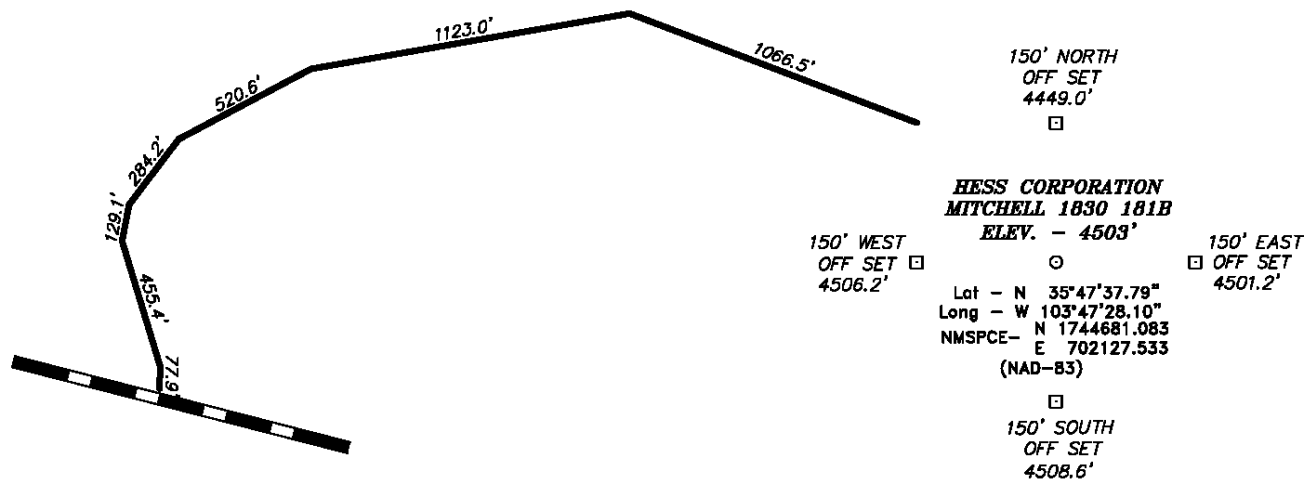

**BASIN SURVEYS** P.O. BOX 1786-HOBBS, NEW MEXICO

W.O. Number: 21823 Drawn By: J. SMALL

Date: 11-09-2009 Disk: JMS 21823

**HESS CORPORATION**

REF: MITCHELL 1830 181B / WELL PAD TOPO

THE MITCHELL 1830 181B LOCATED 1200'  
FROM THE NORTH LINE AND 1650' FROM THE EAST LINE OF  
SECTION 18, TOWNSHIP 18 NORTH, RANGE 30 EAST,  
N.M.P.M., HARDING COUNTY, NEW MEXICO.

Survey Date: 11-01-2009 Sheet 1 of 1 Sheets

## Permit Comments

Operator: HESS CORPORATION , 495

Well: MITCHELL #181

API: 30-021-20508

Created By	Comment	Comment Date
rsmith	UNORTHODOX LOCATION HESS OWNS THE OFFSET	12/18/2009