



Surface Reclamation Complete Report

Well Name: DAGGER DRAW #010 & BATTERY

API: 30-015-26662

Well Location: M-19-19S-25E

Surface Owner: SANTO LEGADO LLC & MARIGOLD LLP & TULPAN LLC

Reclamation Complete Date:

Total Acres reclaimed: 1.75 acres

Seed Mix:

Mix	Species	lb/acre (Drilled)	lb/acre (Broadcast)
NMSLO - Loamy (L)	Black Grama	2.0	4.0
"	Blue Grama	2.0	4.0
"	Sideoats Grama	2.0	4.0
"	Sand Dropseed	1.0	2.0
"	Alkali Sacaton	2.5	5.0
"	Little Bluestem	2.5	5.0
"	Firewheel (Gaillardia)	1.0	2.0
"	Fourwing Saltbush	1.0	2.0
"	Common Winterfat	0.5	1.0

Weights should be as pounds of pure live seed.

Note:

EOG will conduct an annual surface reclamation monitoring field visit in 2024 to determine if successful vegetation regrowth is established.

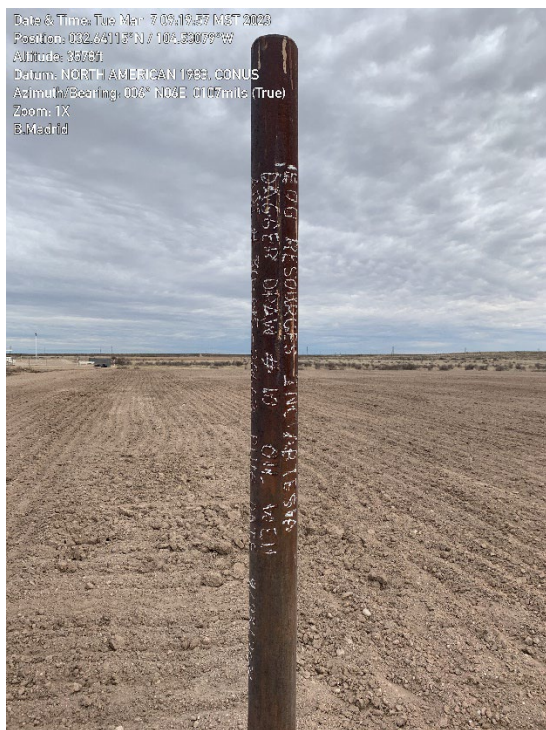

On-Site Regulatory Reclamation Inspection		Date:	3 / 7 / 2023	
Site Name: DAGGER DRAW #010				
API Number: 30-0 15 28862		Plug Date: 9 / 23 / 2021		Inspection: <input type="checkbox"/> Initial <input type="checkbox"/> Monitoring <input type="checkbox"/> Active <input type="checkbox"/> Corrective <input checked="" type="checkbox"/> Final
<input type="checkbox"/> Facility Site-No associated well on location				
Was this the last remaining or only well on the location?			YES	NO
Are there any abandoned pipelines that are going to remain on the location?			✓	
Is there any production equipment or structure (not including steel marker, poured onsite concrete bases, or pipelines) that are going to remain on location?			✓	✓
If any production equipment or structure (including 3rd party) is to remain on location, please specify.			3rd party electrical/cathodic boxes.	
Site Evaluation				
Recontoured back to original State/Topsoil Replaced			YES	NO
Have the rat hole and cellar been filled and leveled?			✓	
Have the cathodic protection holes been properly abandoned & reclaimed?			✓	
Rock or Caliche Surfacing materials have been removed?			✓	
Section Comments:				
All Facilities Removed for Final Reclamation				
Have all of the pipelines & production equipment been cleared? (other than the listed above)			✓	
Has all of the required junk and trash been cleared from the location?			✓	
Have all of the required anchors, dead men, tie downs and risers have been cut off at least two feet below ground level?			✓	
Have all of the required metal bolts and other materials have been removed?			✓	
Have all the required portable bases been removed?			✓	
Section Comments:				
Dry Hole Marker			YES	NO
Has a steel marker been installed per COA requirements?			✓	
Check One: <input type="checkbox"/> Buried <input checked="" type="checkbox"/> Above Ground				
Required DIHM Information:				
<input checked="" type="checkbox"/> Operator Name <input checked="" type="checkbox"/> UL or Qty/Ctr <input checked="" type="checkbox"/> API Number <input checked="" type="checkbox"/> County <input type="checkbox"/> Federal Lease # (Fed Only)				
<input checked="" type="checkbox"/> Lease Name & Number <input checked="" type="checkbox"/> Sec-Tier-Ring <input checked="" type="checkbox"/> Footage <input checked="" type="checkbox"/> P&A Date				
Free of Oil or Salt Contaminated Soil			YES	NO
Have all the required pits been remediated in compliance with OCD rules and the terms of the Operator's pit permit and closure plan?			✓	
Have all other environmental concerns been addressed as per OCD rules?			✓	
If any environmental concerns remain on the location, please specify.				
Abandoned Pipelines			YES	NO
Only need to provide answers in this group, if any pipelines have been abandoned (in accordance with 19.15.35.10 NMAC).				
Have all fluids have been removed from any abandoned pipelines?				
Have all abandoned pipelines been confirmed to NOT contain additional regulated NORM, other than that which accumulated under normal operation?				
Have all accessible points of abandoned pipelines been permanently capped?				
Section Comments:				
Last Remaining or Only Well on the Location			YES	NO
Please answer all questions that apply in this group, specifically if there is no longer going to be any well or facility remaining at this location.				
Have all electrical service poles and lines been removed from the location?			✓	
Is there any electrical utility distribution infrastructure that is remaining on the location?			✓	
Have all the battery and pit location(s) have been remediated in compliance with OCD rules and the terms of the Operator's pit permit and closure plan?			✓	
Have all the retrievable pipelines, production equipment been removed from the location?			✓	
Has all the junk and trash been removed from the location?			✓	
Section Comments: 3rd party electrical/cathodic boxes.				
Environmental Only: Do not have to be met to pass inspection				
This section corresponds with questions on the Reclamation Inspection Form in Environmental but not related to NMOCD forms.				
Free of Noxious or Invasive Weeds? (Note species or treatment in remarks)			Met	Not Met
Site Stability? Erosion controls in place (if necessary) & working.			✓	
Signs of seeding completion? (Broadcast/Drilled)			✓	
Revegetation Success as compared to background? Met >75%.			Circle One: 0%	25% 50% 75% 100%
Adequate Reclamation Fence Installed?				✓
Section Comments:				
Additional Findings or Comments: Inspection sweep completed; all EOG oil & gas trash/junk removed.				
Verification of 3rd party equipment needed.				
Inspector: B. Madrid				
<input type="checkbox"/> READY FOR FAN SUBMITTAL <input type="checkbox"/> NEEDS FURTHER REVIEW				
Picture Checklist:				
<input checked="" type="checkbox"/> DIHM <input checked="" type="checkbox"/> Background <input checked="" type="checkbox"/> 3rd Party Equipment <input type="checkbox"/> Contamination <input type="checkbox"/>				
<input checked="" type="checkbox"/> Site Corners <input checked="" type="checkbox"/> Access Road <input type="checkbox"/> EOG Equipment <input type="checkbox"/> Trash/Junk <input type="checkbox"/>				
Inspection Result				
<input checked="" type="radio"/> PASS <input type="radio"/> FAIL				

On-Site Inspection Form v1.xlsx

2/13/2023



Surface Owner Approval of Reclamation completed with Well P&A

Well Name: Dagger Draw Com Battery

API: 30-015-26662

Location: NW/4SW/4 being approximately 2.75 acres in total area.

Section: 19
Township: 19 South
Range: 25 East
County: Eddy

Surface owner: Ownbey Estates - Coy Ownbey
PO Box 642
Gruver, TX 79040

I hereby agree that EOG Resources, Inc. has completed all surface reclamation activities to meet our requirements as surface landowner for the above noted well. There is 3rd party equipment (tinhorn, pipeline risers and markers, steel pipeline, steel open pipeline), which are all located off pad. The tinhorn is located on the southwest side of the battery pad. The pipeline risers, steel pipeline, steel open pipeline and the pipeline steel markers are all located on the southeast side of the pad. Surface landowner is aware of the equipment that is left off the battery pad and therefore EOG Resources, Inc. will not be responsible.

Surface Owner Name: Ownbey Estates - Coy Ownbey

Surface Owner Signature: Barbara Cluck

Dated: 4-4-2023

EOG Representative Name: Keith Kistner

EOG Representative Signature: KK

Dated: 3/27/2023

Trixy Duke

From: cluck_cattle@gruver.net
Sent: Tuesday, April 4, 2023 12:51 PM
To: Trixy Duke
Subject: Dagger Draw Reclamation
Attachments: Dagger Draw Reclamation.pdf

[You don't often get email from cluck_cattle@gruver.net. Learn why this is important at <https://aka.ms/LearnAboutSenderIdentification>]

CAUTION: This email originated from outside of the organization. Do not click links or open attachments unless you recognize the sender and know the content is safe.

Trixy — I have attached a signed copy of the reclamation letter you sent to the Ownbey Estates c/o Coy Ownbey. Coy has passed and Barbara being one of the remaining surface owners under agreement of all other owners has signed the document.

Ray Spradlin -- Bookkeeper

On-Site Regulatory Reclamation Inspection		Date: <u>3 / 7 / 2023</u>				
Site Name: <u>DAGGER DRAW COM BATTERY (NDDUP UNIT #080)</u>						
API Number: <u>30-0 15 24284</u>	Plug Date: <u>11 / 8 / 2010</u>	Inspection: <input type="checkbox"/> Initial <input type="checkbox"/> Monitoring <input type="checkbox"/> Active <input type="checkbox"/> Corrective <input checked="" type="checkbox"/> Final				
<input type="checkbox"/> Facility Site-No associated well on location						
Was this the last remaining or only well on the location?		YES NO <input checked="" type="checkbox"/> <input type="checkbox"/>				
Are there any abandoned pipelines that are going to remain on the location?		<input type="checkbox"/> <input checked="" type="checkbox"/>				
Is there any production equipment or structure (not including steel marker, poured onsite concrete bases, or pipelines) that are going to remain on location?		<input checked="" type="checkbox"/> <input type="checkbox"/>				
If any production equipment or structure (including 3rd party) is to remain on location, please specify. VALVE BOX WITHIN PAD, LINE SEGMENT SE OFF PAD REMAINING DUE TO LINE CROSSING CONFIGURATION						
Site Evaluation						
Recontoured back to original State/Topsoil Replaced		YES NO <input checked="" type="checkbox"/> <input type="checkbox"/>				
Have the rat hole and cellar been filled and leveled?		<input checked="" type="checkbox"/> <input type="checkbox"/>				
Have the cathodic protection holes been properly abandoned & reclaimed?		<input checked="" type="checkbox"/> <input type="checkbox"/>				
Rock or Caliche Surfacing materials have been removed?		<input checked="" type="checkbox"/> <input type="checkbox"/>				
Section Comments:						
All Facilities Removed for Final Reclamation						
Have all of the pipelines & production equipment been cleared? (other than the listed above)		<input checked="" type="checkbox"/> <input type="checkbox"/>				
Has all of the required junk and trash been cleared from the location?		<input checked="" type="checkbox"/> <input type="checkbox"/>				
Have all of the required anchors, dead men, tie downs and risers have been cut off at least two feet below ground level?		<input checked="" type="checkbox"/> <input type="checkbox"/>				
Have all of the required metal bolts and other materials have been removed?		<input checked="" type="checkbox"/> <input type="checkbox"/>				
Have all the required portable bases been removed?		<input checked="" type="checkbox"/> <input type="checkbox"/>				
Section Comments:						
Dry Hole Marker		YES NO				
Has a steel marker been installed per COA requirements?		<input checked="" type="checkbox"/> <input type="checkbox"/>				
Check One: <input type="checkbox"/> Buried <input checked="" type="checkbox"/> Above Ground		<input checked="" type="checkbox"/> <input type="checkbox"/>				
Required DHM Information:						
<input checked="" type="checkbox"/> Operator Name <input checked="" type="checkbox"/> UL or Qty/Qty <input checked="" type="checkbox"/> API Number <input checked="" type="checkbox"/> County <input type="checkbox"/> Federal Lease # (Fed Only)						
<input checked="" type="checkbox"/> Lease Name & Number <input checked="" type="checkbox"/> Sec-Two-Ring <input checked="" type="checkbox"/> Footage <input checked="" type="checkbox"/> PSA Date						
Free of Oil or Salt Contaminated Soil		YES NO				
Have all the required pits been remediated in compliance with OCD rules and the terms of the Operator's pit permit and closure plan?		<input checked="" type="checkbox"/> <input type="checkbox"/>				
Have all other environmental concerns been addressed as per OCD rules?		<input checked="" type="checkbox"/> <input type="checkbox"/>				
If any environmental concerns remain on the location, please specify.						
Abandoned Pipelines						
Only need to provide answers in this group, if any pipelines have been abandoned (in accordance with 19. 15. 35. 10 NMOC).						
Have all fluids have been removed from any abandoned pipelines?		YES NO <input checked="" type="checkbox"/> <input checked="" type="checkbox"/>				
Have all abandoned pipelines been confirmed to <u>NOT</u> contain additional regulated NORM, other than that which accumulated under normal operation?		<input checked="" type="checkbox"/> <input checked="" type="checkbox"/>				
Have all accessible points of abandoned pipelines been permanently capped?		<input checked="" type="checkbox"/> <input checked="" type="checkbox"/>				
Section Comments:						
Last Remaining or Only Well on the Location		YES NO				
Please answer all questions that apply in this group, specifically if there is no longer going to be any well or facility remaining at this location.						
Have all electrical service poles and lines been removed from the location?		<input checked="" type="checkbox"/> <input type="checkbox"/>				
Is there any electrical utility distribution infrastructure that is remaining on the location?		<input checked="" type="checkbox"/> <input type="checkbox"/>				
Have all the battery and pit location(s) have been remediated in compliance with OCD rules and the terms of the Operator's pit permit and closure plan?		<input checked="" type="checkbox"/> <input type="checkbox"/>				
Have all the retrievable pipelines, production equipment been removed from the location?		<input checked="" type="checkbox"/> <input type="checkbox"/>				
Has all the junk and trash been removed from the location?		<input checked="" type="checkbox"/> <input type="checkbox"/>				
Section Comments: <u>3rd party electrical/cathodic boxes.</u>						
Environmental Only: Do not have to be met to pass inspection						
This section corresponds with questions on the Reclamation Inspection Form in iEnvironmental but not related to NIMOC forms.						
Free of Noxious or Invasive Weeds? (Note species or treatment in remarks)		Met Not Met <input checked="" type="checkbox"/> <input type="checkbox"/>				
Site Stability? Erosion controls in place (if necessary) & working.		<input checked="" type="checkbox"/> <input type="checkbox"/>				
Signs of seedling completion? (Broadcast/Drilled)		<input checked="" type="checkbox"/> <input type="checkbox"/>				
Revegetation Success as compared to background? Met >75%.		Circle One: <input checked="" type="radio"/> 0% <input type="radio"/> 25% <input type="radio"/> 50% <input type="radio"/> 75% <input type="radio"/> 100%				
Adequate Reclamation Installed?		<input type="checkbox"/> <input checked="" type="checkbox"/>				
Section Comments: <u>Fence installed per updated procedures instead of berm</u>						
Additional Findings or Comments: <u>Inspection sweep completed; all EOG oil & gas trash/junk removed.</u>						
Inspector: <u>B. Madrid</u>						
<input type="checkbox"/> READY FOR FAN SUBMITTAL <input type="checkbox"/> NEEDS FURTHER REVIEW						
<table border="1" style="width: 100%; border-collapse: collapse;"> <thead> <tr> <th colspan="2">Inspection Result</th> </tr> </thead> <tbody> <tr> <td style="text-align: center;"><input checked="" type="radio"/> PASS</td> <td style="text-align: center;"><input type="radio"/> FAIL</td> </tr> </tbody> </table>			Inspection Result		<input checked="" type="radio"/> PASS	<input type="radio"/> FAIL
Inspection Result						
<input checked="" type="radio"/> PASS	<input type="radio"/> FAIL					
Picture Checklist: <input checked="" type="checkbox"/> DHM <input checked="" type="checkbox"/> Background <input type="checkbox"/> 3rd Party Equipment <input type="checkbox"/> Contamination <input type="checkbox"/> <input checked="" type="checkbox"/> Site Corners <input checked="" type="checkbox"/> Access Road <input checked="" type="checkbox"/> EOG Equipment <input type="checkbox"/> Trash/Junk <input type="checkbox"/>						

Date & Time: Tue Mar 7 10:10:37 MST 2023
Position: 032.64412°N / 104.52933°W
Altitude: 3580ft
Datum: NORTH AMERICAN 1983, CONUS
Azimuth/Bearing: 076° N76E 1351mils (True)
Zoom: 1X
B.Madrid



District I

1625 N. French Dr., Hobbs, NM 88240
Phone:(575) 393-6161 Fax:(575) 393-0720

District II

811 S. First St., Artesia, NM 88210
Phone:(575) 748-1283 Fax:(575) 748-9720

District III

1000 Rio Brazos Rd., Aztec, NM 87410
Phone:(505) 334-6178 Fax:(505) 334-6170

District IV

1220 S. St Francis Dr., Santa Fe, NM 87505
Phone:(505) 476-3470 Fax:(505) 476-3462

State of New Mexico
Energy, Minerals and Natural Resources
Oil Conservation Division
1220 S. St Francis Dr.
Santa Fe, NM 87505

DEFINITIONS

Action 207787

DEFINITIONS

Operator: EOG RESOURCES INC P.O. Box 2267 Midland, TX 79702	OGRID: 7377
	Action Number: 207787
	Action Type: [C-103] Sub. Release After P&A (C-103Q)

DEFINITIONS

For the sake of brevity and completeness, please allow for the following in all groups of questions and for the rest of this application:

- lease and well location, hereinafter "location";
- flowlines or pipelines, hereinafter "pipelines";
- and non-retrieved or abandoned, hereinafter "abandoned".

District I

1625 N. French Dr., Hobbs, NM 88240
Phone:(575) 393-6161 Fax:(575) 393-0720

District II

811 S. First St., Artesia, NM 88210
Phone:(575) 748-1283 Fax:(575) 748-9720

District III

1000 Rio Brazos Rd., Aztec, NM 87410
Phone:(505) 334-6178 Fax:(505) 334-6170

District IV

1220 S. St Francis Dr., Santa Fe, NM 87505
Phone:(505) 476-3470 Fax:(505) 476-3462

State of New Mexico
Energy, Minerals and Natural Resources
Oil Conservation Division
1220 S. St Francis Dr.
Santa Fe, NM 87505

QUESTIONS

Action 207787

QUESTIONS

Operator: EOG RESOURCES INC P.O. Box 2267 Midland, TX 79702	OGRID: 7377
	Action Number: 207787
	Action Type: [C-103] Sub. Release After P&A (C-103Q)

QUESTIONS

Subsequent Report of: Location Ready For OCD Inspection After P&A	
Was this the last remaining or only well on the location	Yes
Are there any abandoned pipelines that are going to remain on the location	No
Is there any production equipment or structure (not including steel marker, poured onsite concrete bases, or pipelines) that is going to remain on the location	Yes
If any production equipment or structure is to remain on the location, please specify	3rd party electrical/cathodic boxes

Site Evaluation

Please answer all the questions in this group.

Have all the required pits been remediated in compliance with OCD rules and the terms of the Operator's pit permit and closure plan	Yes
Have the rat hole and cellar been filled and leveled	Yes
Have the cathodic protection holes been properly abandoned	Yes
Has a steel marker, at least 4 inches in diameter and at least 4 feet above ground level, been set in concrete	Yes
The (concrete-set) steel marker shows: Must attach marker photograph(s). *	THE OPERATOR NAME, LEASE NAME AND WELL NUMBER AND LOCATION, INCLUDING UNIT LETTER, SECTION, TOWNSHIP AND RANGE, SHALL BE WELDED, STAMPED OR OTHERWISE PERMANENTLY ENGRAVED INTO THE MARKER'S METAL.
Has the location been leveled as nearly as possible to original ground contour	Yes
Have all the required pipelines and other production equipment been cleared	Yes
Has all the required junk and trash been cleared from the location	Yes
Have all the required anchors, dead men, tie downs and risers have been cut off at least two feet below ground level	Yes
Have all the required metal bolts and other materials have been removed	Yes

Poured onsite concrete bases do not have to be removed.

Have all the the required portable bases been removed	Yes
Have all other environmental concerns have been addressed as per OCD rules	Yes
If any environmental concerns remain on the location, please specify	Not answered.

* Proof of the site marker (photograph) is required.

Please submit any other site photographs that would assist in documenting the above answers, site features, additional concerns, or other nearby / remaing structures and equipment.

District I

1625 N. French Dr., Hobbs, NM 88240
 Phone:(575) 393-6161 Fax:(575) 393-0720

District II

811 S. First St., Artesia, NM 88210
 Phone:(575) 748-1283 Fax:(575) 748-9720

District III

1000 Rio Brazos Rd., Aztec, NM 87410
 Phone:(505) 334-6178 Fax:(505) 334-6170

District IV

1220 S. St Francis Dr., Santa Fe, NM 87505
 Phone:(505) 476-3470 Fax:(505) 476-3462

State of New Mexico
Energy, Minerals and Natural Resources
Oil Conservation Division
1220 S. St Francis Dr.
Santa Fe, NM 87505

QUESTIONS, Page 2

Action 207787

QUESTIONS (continued)

Operator: EOG RESOURCES INC P.O. Box 2267 Midland, TX 79702	OGRID: 7377
	Action Number: 207787
	Action Type: [C-103] Sub. Release After P&A (C-103Q)

QUESTIONS

Abandoned Pipelines	
<i>Only need to provide answers in this group, if any pipelines have been abandoned (in accordance with 19.15.35.10 NMAC).</i>	
Have all fluids have been removed from any abandoned pipelines	Not answered.
Have all abandoned pipelines been confirmed to NOT contain additional regulated NORM, other than that which accumulated under normal operation	Not answered.
Have all accessible points of abandoned pipelines been permanently capped	Not answered.

Last Remaining or Only Well on the Location	
<i>Please answer all questions that apply in this group, specifically if there is no longer going to be any well or facility remaining at this location.</i>	
Have all electrical service poles and lines been removed from the location	Yes
Is there any electrical utility distribution infrastructure that is remaining on the location	Yes
Have all the battery and pit location(s) have been remediated in compliance with OCD rules and the terms of the Operator's pit permit and closure plan	Yes
Have all the retrievable pipelines, production equipment been removed from the location	Yes
Has all the junk and trash been removed from the location	Yes

District I

1625 N. French Dr., Hobbs, NM 88240
Phone:(575) 393-6161 Fax:(575) 393-0720

District II

811 S. First St., Artesia, NM 88210
Phone:(575) 748-1283 Fax:(575) 748-9720

District III

1000 Rio Brazos Rd., Aztec, NM 87410
Phone:(505) 334-6178 Fax:(505) 334-6170

District IV

1220 S. St Francis Dr., Santa Fe, NM 87505
Phone:(505) 476-3470 Fax:(505) 476-3462

State of New Mexico
Energy, Minerals and Natural Resources
Oil Conservation Division
1220 S. St Francis Dr.
Santa Fe, NM 87505

ACKNOWLEDGMENTS

Action 207787

ACKNOWLEDGMENTS

Operator: EOG RESOURCES INC P.O. Box 2267 Midland, TX 79702	OGRID: 7377
	Action Number: 207787
	Action Type: [C-103] Sub. Release After P&A (C-103Q)

ACKNOWLEDGMENTS

<input checked="" type="checkbox"/>	I hereby certify that all the work has been completed for this location and the site is ready for an OCD scheduled inspection.
-------------------------------------	--

District I
1625 N. French Dr., Hobbs, NM 88240
Phone:(575) 393-6161 Fax:(575) 393-0720

District II
811 S. First St., Artesia, NM 88210
Phone:(575) 748-1283 Fax:(575) 748-9720

District III
1000 Rio Brazos Rd., Aztec, NM 87410
Phone:(505) 334-6178 Fax:(505) 334-6170

District IV
1220 S. St Francis Dr., Santa Fe, NM 87505
Phone:(505) 476-3470 Fax:(505) 476-3462

State of New Mexico
Energy, Minerals and Natural Resources
Oil Conservation Division
1220 S. St Francis Dr.
Santa Fe, NM 87505

CONDITIONS

Action 207787

CONDITIONS

Operator: EOG RESOURCES INC P.O. Box 2267 Midland, TX 79702	OGRID: 7377
	Action Number: 207787
	Action Type: [C-103] Sub. Release After P&A (C-103Q)

CONDITIONS

Created By	Condition	Condition Date
gcordero	None	4/19/2023