

Santa Fe Main Office
Phone: (505) 476-3441
General Information
Phone: (505) 629-6116

Online Phone Directory Visit:
<https://www.emnrd.nm.gov/ocd/contact-us/>

State of New Mexico
Energy, Minerals and Natural Resources

OIL CONSERVATION DIVISION
1220 South St. Francis Dr.
Santa Fe, NM 87505

Form C-103
Revised July 18, 2013

SUNDRY NOTICES AND REPORTS ON WELLS (DO NOT USE THIS FORM FOR PROPOSALS TO DRILL OR TO DEEPEN OR PLUG BACK TO A DIFFERENT RESERVOIR. USE "APPLICATION FOR PERMIT" (FORM C-101) FOR SUCH PROPOSALS.) 1. Type of Well: Oil Well <input type="checkbox"/> Gas Well <input checked="" type="checkbox"/> Other Injection <input type="checkbox"/>		WELL API NO. 30-025-01499
2. Name of Operator BXP Operating, LLC		5. Indicate Type of Lease STATE <input checked="" type="checkbox"/> FEE <input type="checkbox"/>
3. Address of Operator 1515 West Calle Sur, Suite 174, Hobbs, NM 88240		6. State Oil & Gas Lease No.
4. Well Location Unit Letter <u>C</u> : <u>660</u> feet from the <u>North</u> line and <u>1980</u> feet from the <u>West</u> line Section <u>20</u> Township <u>17S</u> Range <u>33E</u> NMPM Lea County		7. Lease Name or Unit Agreement Name CAPROCK MALJAMAR UNIT
11. Elevation (Show whether DR, RKB, RT, GR, etc.) 4205' GL		8. Well Number #42
		9. OGRID Number 329487
		10. Pool name or Wildcat (43329) Maljamar; Grayburg- San Andres

12. Check Appropriate Box to Indicate Nature of Notice, Report or Other Data

NOTICE OF INTENTION TO:		SUBSEQUENT REPORT OF:	
PERFORM REMEDIAL WORK <input type="checkbox"/>	PLUG AND ABANDON <input type="checkbox"/>	REMEDIAL WORK <input type="checkbox"/>	ALTERING CASING <input type="checkbox"/>
TEMPORARILY ABANDON <input type="checkbox"/>	CHANGE PLANS <input type="checkbox"/>	COMMENCE DRILLING OPNS. <input type="checkbox"/>	P AND A <input checked="" type="checkbox"/>
PULL OR ALTER CASING <input type="checkbox"/>	MULTIPLE COMPL. <input type="checkbox"/>	CASING/CEMENT JOB <input type="checkbox"/>	
DOWNHOLE COMMINGLE <input type="checkbox"/>			
CLOSED-LOOP SYSTEM <input type="checkbox"/>			
OTHER: <input type="checkbox"/>		OTHER: <input type="checkbox"/>	

13. Describe proposed or completed operations. (Clearly state all pertinent details, and give pertinent dates, including estimated date of starting any proposed work). SEE RULE 19.15.7.14 NMAC. For Multiple Completions: Attach wellbore diagram of proposed completion or recompletion.

See attached report 1-27-25 thru 2-05-25

Spud Date:

Rig Release Date:

I hereby certify that the information above is true and complete to the best of my knowledge and belief.

SIGNATURE [Signature] TITLE Agent DATE 3/3/2025

Type or print name M. Y. Merchant E-mail address: mymerch@penrocoil.com PHONE: 575-492-1236
For State Use Only

APPROVED BY: _____ TITLE _____ DATE _____

Conditions of Approval (if any):

OPERATOR : BXP OPERATING

LEASE NAME : CAPROCK MALJAMR UNIT #42

PLUG DATE : 2-4-2025

API # 30-025-01499

COUNTY : LEA COUNTY

DMH INSTALLED : 2-21-25

Description of Work:

1-27-25 24HR NOTICE ROBERT TRUJILLO
1-28-25 MOVE IN RIG UP , DIG OUT CSG VALVES SHUT DOWN
1-29-25 TBG PRESSURE 1750# R/U KILL TRUCK ESTAB INJEC RATE TBG PRESSURE UP UNABLE TO PUMP IN TO PERFS R/D RELEASE KILL TRUCK , R/U WL SHOOT HOLES IN TBG @ 4100' R/D WL SECURE WELL SHUT DOWN
1-30-25 CIRC HOLE W/ 180BBL 18.8# MUD N/U BOP POOH W/ TBG AND PACKER. R/U WL RUN GAUGE RING POOH SET 7" CIBP @ 4058' OK'D BY OCD ROBERT TRUJILLO DUMP BAIL 35' CMT CTC @ 4023' SHUT DOWN
1-31-25 NO BUBBLE WELL STAYING FULL RIH TAG CMT @ 4015' CIRC OUT KILL MUD , CIRC HOLE W/ 180BBL 10# GELLED BRINE, PRESSURE TEST CSG 500# HOLD 30MIN GOOD. POOH W/ TBG R/D WL RUN CBL FROM 4015' TO SURF SHUT DOWN
2-3-25 ROBERT W/ OCD OK'D TO RIH EOT@ 2100' SPOT 35SXS CLASS C 14.8# CMT 8.22BBL SLURRY DIS 5.45BBL 10# GELLED BRINE CTC @ 1895' WOC 4HRS , RIH TAGGED @ 1890' POOH. RIH W/ PKR SET @ 1181' PERF @ 1381' SHUT DOWN
2-4-25 PKR @ 1181' ESTA INJE RATE 1BBL/MIN @ 1000# MIX 50SXS CLASS C 14.8# 11.75BBL SLURRY DIS 11.5BBL 10# GELLED BRINE WOC 4 HRS , RIH TAGGED @ 1265' POOH L/D. OK'D BY ROBERT W/ OCD, RIH EOT @ 300' MIX 50SXS CLASS C 14.8 11.75 BBL FILL UP CCSG FROM 300'- SURFACE POOH TOP OFF WELL N/D BOP MONITOR WELL STAYING FULL RELEASE ALL 3RD PARTY EQUIPMENT SHUT DOWN.
2-5-25 CMT AT SURFACE RIG DOWN PULLING UNIT CLEAN UP LOCATION MOVE OFF
2-21-25 DHM INSTALLED

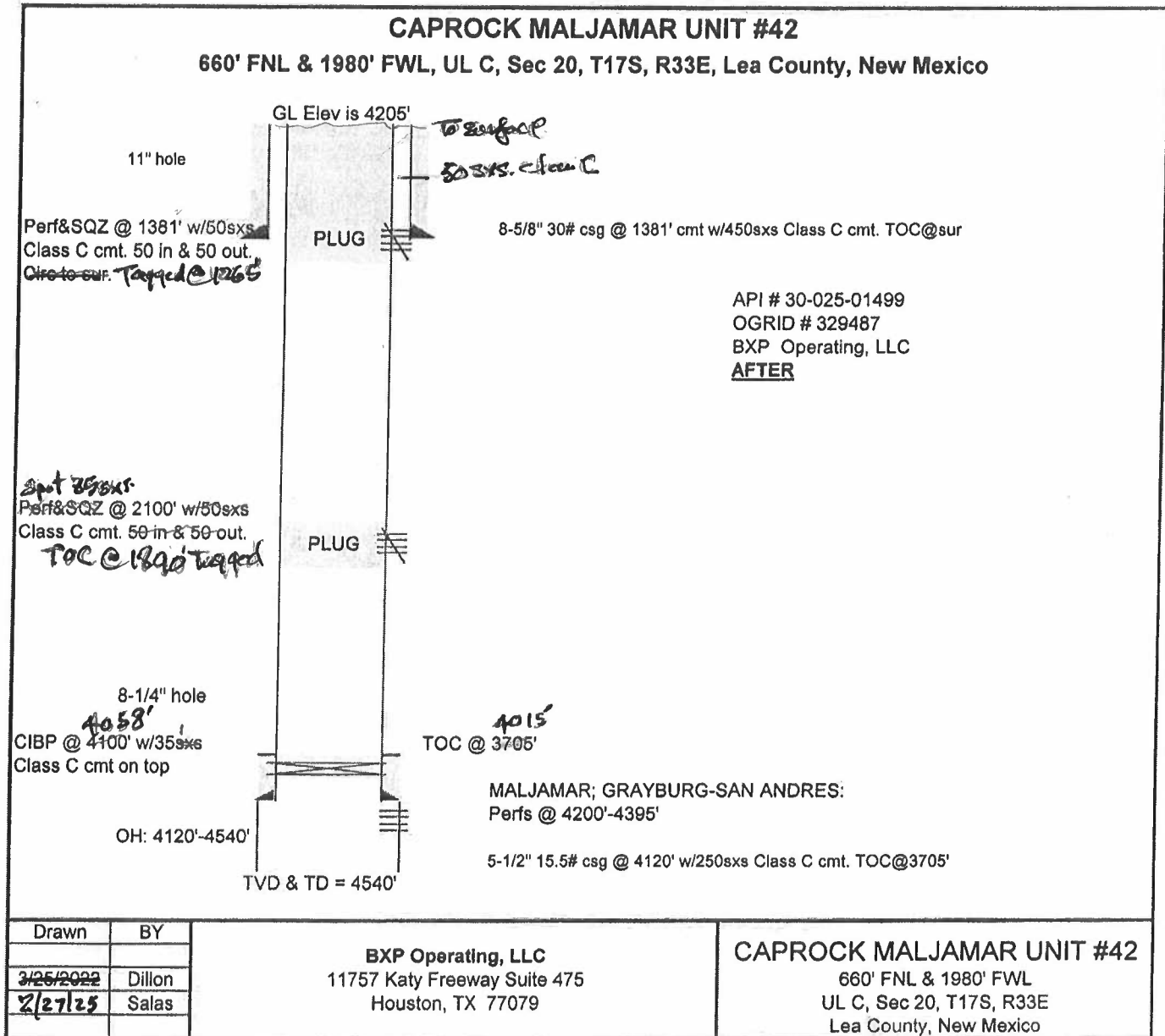



March 02, 2025 9:58 AM

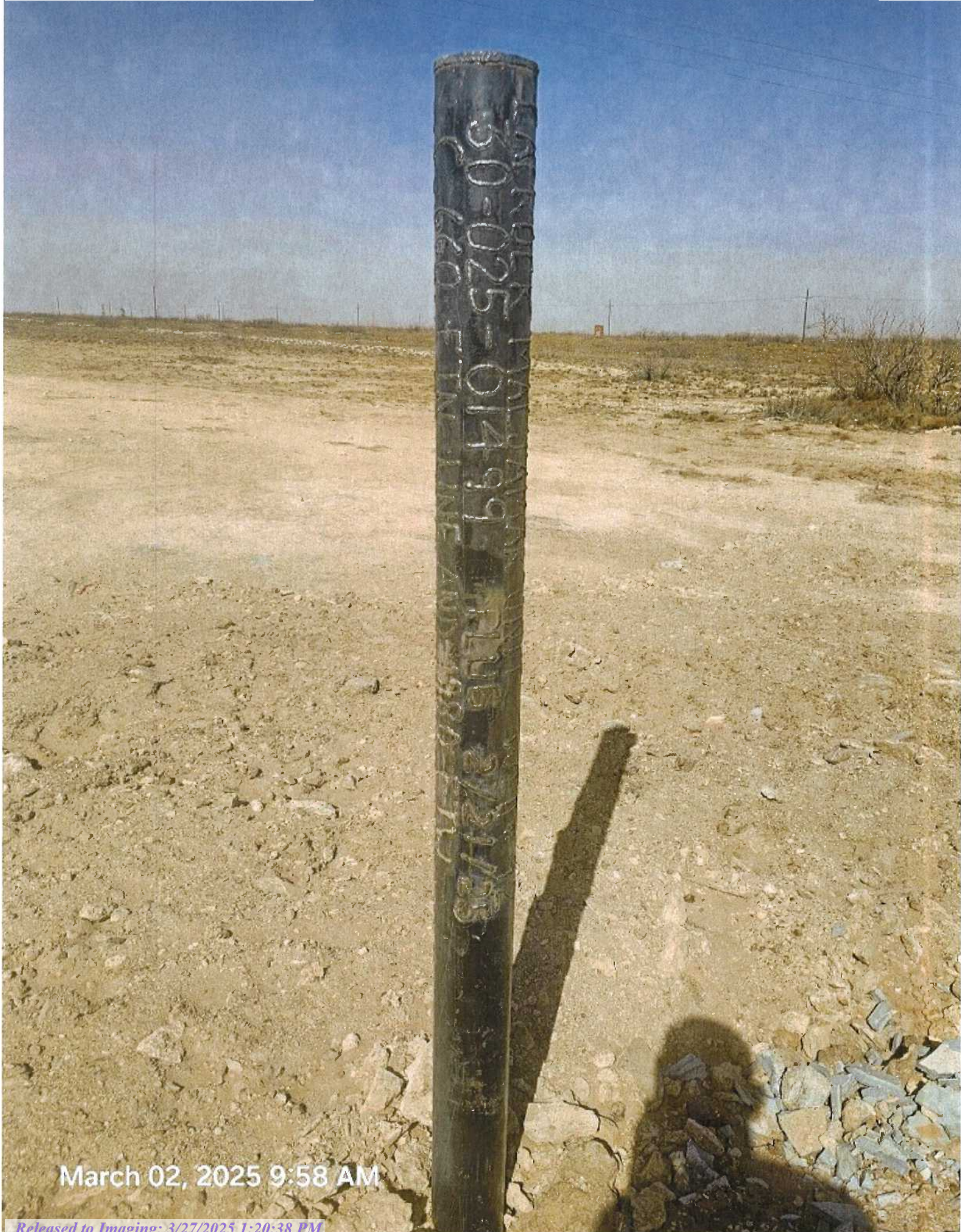

March 02, 2025 9:58 AM

Sante Fe Main Office
Phone: (505) 476-3441

General Information
Phone: (505) 629-6116

Online Phone Directory
<https://www.emnrd.nm.gov/ocd/contact-us>

State of New Mexico
Energy, Minerals and Natural Resources
Oil Conservation Division
1220 S. St Francis Dr.
Santa Fe, NM 87505

CONDITIONS

Action 441710

CONDITIONS

Operator: BXP Operating, LLC 11757 KATY FREEWAY HOUSTON, TX 77079	OGRID: 329487
	Action Number: 441710
	Action Type: [C-103] Sub. Plugging (C-103P)

CONDITIONS

Created By	Condition	Condition Date
gcordero	Clean Location in accordance with 19.15.25.10 NMAC.	3/27/2025
gcordero	Submit C-103Q within one year of plugging.	3/27/2025