



Via email

P.O. Box 2267
Midland, Texas 79702
Phone: (432) 265-6804

Nov 7, 2025

New Mexico Oil Conservation Division
Attn: Mr. Leonard Lowe
1220 South St. Francis
Santa Fe, NM 87505
Via: Leonard.Lowe@state.nm.us

Re: Notification and Verification of a Standard Well Location for the Midnight
Hour 10 Fed Com 761H (30-015-55275), Sec 10, T26S, R30E, Eddy
County, NM

Dear Mr. Lowe:

Included with this letter are the following documents demonstrating that the above-mentioned well will be drilled at a standard oil well location:

- C-102 Plat dated June 22, 2023, showing the permitted location of the Midnight Hour 10 Fed Com 761H, respectively.
- "Area of Common Ownership Plat" separately showing the spacing units for the well; and
- Certification of Ownership demonstrating the outlined area on the plat is comprised of fee leases, with uniform ownership.

19.15.16.15.C(7) NMAC provides that in area of common ownership the setback requirements only apply to the outer boundary of the area of uniform ownership, not the spacing unit within the area of uniform ownership. Since the area to the east towards which this well encroaches is within the documented "area of common ownership," this well is at a standard location and approval of a non-standard location for the well is not necessary.

Please place this Notification and Verification of a Standard Well Location in the well files for Midnight Hour 10 Fed Com 761H (30-015-55275).

Kayla McConnell

A handwritten signature in black ink that reads "Kayla McConnell".

EOG Resources
Regulatory Specialist

C-102 Submit Electronically Via OCD Permitting	State of New Mexico Energy, Minerals & Natural Resources Department OIL CONSERVATION DIVISION	Revised July 9, 2024	
		Submittal Type:	<input type="checkbox"/> Initial Submittal
			<input checked="" type="checkbox"/> Amended Report
		<input type="checkbox"/> As Drilled	
Property Name and Well Number MIDNIGHT HOUR 10 FED COM 761H			

WELL LOCATION AND ACREAGE DEDICATION PLAT

API Number 30-015-55275	Pool Code :: 442	Pool Name RWTRNG'UCI G-Y QNHECOR'HI CU+
Property Code 555225	Property Name MIDNIGHT HOUR 10 FED COM	Well Number 761H
OGRID No. 7377	Operator Name EOG RESOURCES, INC.	Ground Level Elevation 3170'
Surface Owner: <input type="checkbox"/> State <input type="checkbox"/> Fee <input type="checkbox"/> Tribal <input checked="" type="checkbox"/> Federal		Mineral Owner: <input type="checkbox"/> State <input type="checkbox"/> Fee <input type="checkbox"/> Tribal <input checked="" type="checkbox"/> Federal

Surface Location

UL or Lot No. H	Section 10	Township 26 S	Range 30 E	Lot	Feet from the N/S 2040 FNL	Feet from the E/W 120 FEL	Latitude N 32.058958°	Longitude W 103.860853°	County EDDY
---------------------------	----------------------	-------------------------	----------------------	-----	--------------------------------------	-------------------------------------	---------------------------------	-----------------------------------	-----------------------

Bottom Hole Location If Different From Surface

UL or Lot No. M	Section 14	Township 26 S	Range 30 E	Lot	Feet from the N/S 330 FSL	Feet from the E/W 40 FWL	Latitude N 32.036233°	Longitude W 103.860391°	County EDDY
---------------------------	----------------------	-------------------------	----------------------	-----	-------------------------------------	------------------------------------	---------------------------------	-----------------------------------	-----------------------

Dedicated Acres 960	Infill or Defining Well INFILL	Defining Well API 30-015-49540	Overlapping Spacing Unit (Y/N) Y	Consolidated Code C
Order Numbers NMNM 105774392			Well Setbacks are under Common Ownership: <input checked="" type="checkbox"/> Yes <input type="checkbox"/> No	

Kick Off Point (KOP)

UL or lot no. L	Section 11	Township 26 S	Range 30 E	Lot	Feet from the N/S 2608 FSL	Feet from the E/W 40 FWL	Latitude N 32.057116°	Longitude W 103.860329°	County EDDY
---------------------------	----------------------	-------------------------	----------------------	-----	--------------------------------------	------------------------------------	---------------------------------	-----------------------------------	-----------------------

First Take Point (FTP)

UL or lot no. L	Section 11	Township 26 S	Range 30 E	Lot	Feet from the N/S 2328 FSL	Feet from the E/W 40 FWL	Latitude N 32.056347°	Longitude W 103.860326°	County EDDY
---------------------------	----------------------	-------------------------	----------------------	-----	--------------------------------------	------------------------------------	---------------------------------	-----------------------------------	-----------------------

Last Take Point (LTP)

UL or lot no. M	Section 14	Township 26 S	Range 30 E	Lot	Feet from the N/S 330 FSL	Feet from the E/W 40 FWL	Latitude N 32.036233°	Longitude W 103.860391°	County EDDY
---------------------------	----------------------	-------------------------	----------------------	-----	-------------------------------------	------------------------------------	---------------------------------	-----------------------------------	-----------------------

Unitized Area or Area of Uniform Interest COM AGREEMENT	Spacing Unity Type <input checked="" type="checkbox"/> Horizontal <input type="checkbox"/> Vertical	Ground Floor Elevation 3195'
---	--	--

OPERATOR CERTIFICATION <i>I hereby certify that the information contained herein is true and complete to the best of my knowledge and belief, and, if the well is a vertical or directional well, that this organization either owns a working interest or unleased mineral interest in the land including the proposed bottom hole location or has a right to drill this well at this location pursuant to a contract with an owner of a working interest or unleased mineral interest, or to a voluntary pooling agreement or a compulsory pooling order heretofore entered by the division.</i> <i>If this well is a horizontal well, I further certify that this organization has received The consent of at least one lessee or owner of a working interest or unleased mineral interest in each tract (in the target pool or formation) in which any part of the well's completed interval will be located or obtained a compulsory pooling order from the division.</i> <div><div><i>Kayla McConnell</i></div><div>2; 464247</div></div> <div>SignatureDate</div> <div>MC[NC'O EEQP P GNN</div> <div>Print Name</div> <div>MC[NCaO EEQP P GNNB GQI TGUQWTEGUEQO</div> <div>E-mail Address</div>	SURVEYORS CERTIFICATION <div></div> <div><div>Signature and Seal of Professional Surveyor</div><div>Date</div></div> <div><i>I hereby certify that the well location shown on this plat was plotted from field notes of actual surveys made by me or under my supervision, and that the same is true and correct to the best of my belief.</i></div> <div>MITCHELL L. MCDONALD, N.M. P.L.S.</div> <div><div>Certificate Number</div><div>Date of Survey</div></div> <div>29821<div>JUNE 22, 2023</div></div>
--	--

Note: No allowable will be assigned to this completion until all interests have been consolidated or a non-standard unit has been approved by the division.

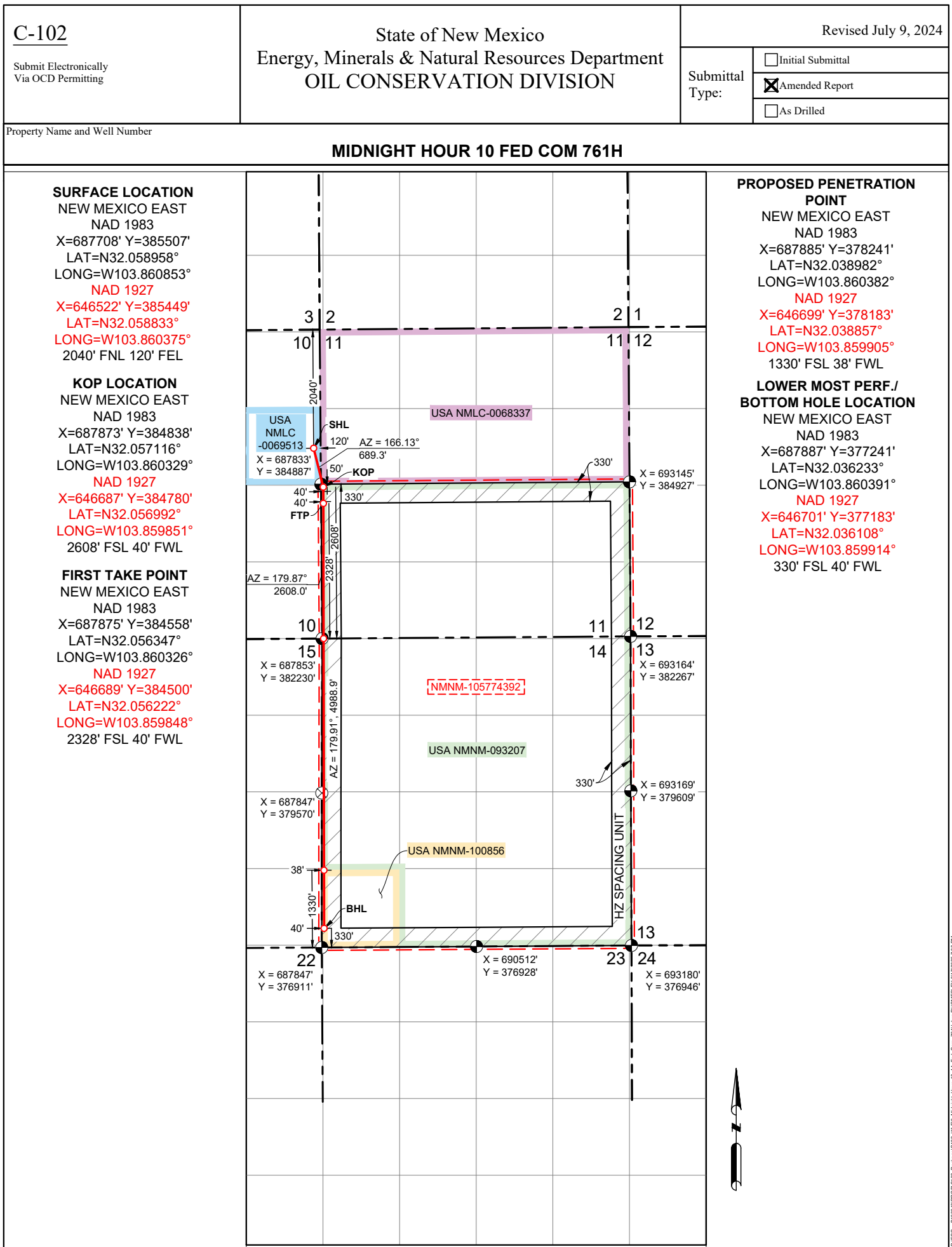

Midnight Hour 10 Fed Com #761H

S/2 of Sections 10 and 11 and All of Sections 14 and 15, T-26S-R30E

Eddy County, New Mexico

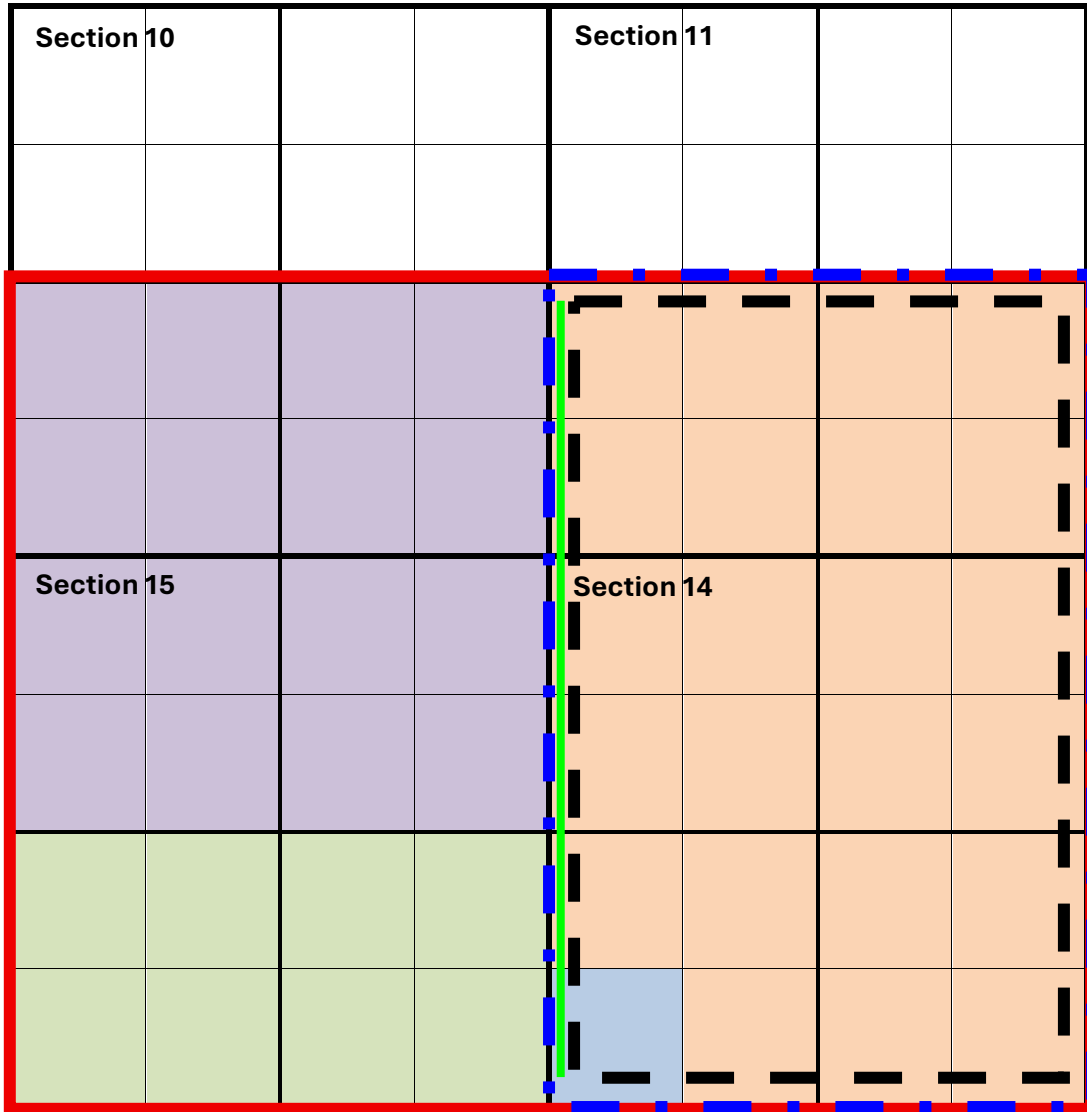

NMNM 105504273
(Legacy: NMNM 100558)

NMNM 105368159
(Legacy: NMNM 102036)

NMNM 105444076
(Legacy: NMNM 093207)

NMNM 105507751
(Legacy: NMNM 100856)

Area of Common
Ownership

Spacing Unit

Setback Boundary

Midnight Hour 10 Fed
Com #761H

Certification of Ownership

I have reviewed the ownership of the oil and gas leasehold for the Wolfcamp formation covering the following leases and tracts for purposes of identifying an “area of common ownership” as set forth in NMAC 19.15.16.15.B(8) and C(7):

Federal Oil & Gas Lease NMNM 100558 covering the S/2 of Section 10 and the N/2 of Section 15, Township 26 South, Range 30 East, in Eddy County, New Mexico;

Federal Oil & Gas Lease NMNM 102036 covering the S/2 of Section 15, Township 26 South, Range 30 East, in Eddy County, New Mexico;

Federal Oil & Gas Lease NMNM 093207 covering the S/2 of Section 11 and the N/2, SE/4, N/2 SW/4, and SE/4 SW/4 of Section 14, Township 26 South, Range 30 East, in Eddy County, New Mexico;

Federal Oil & Gas Lease NMNM 100856 covering the SW/4 SW/4 of Section 14, Township 26 South, Range 30 East, in Eddy County, New Mexico.

As of this date below, the ownership in the above-described leases and lands is identical ownership as defined in 19.15.12.7 B NMAC.

EOG Resources, Inc.

Bella Sikes

Bella Sikes | Landman

432.236.1283

Bella_Sikes@eogresources.com

Dated: September 22, 2025

Sante Fe Main Office
Phone: (505) 476-3441

General Information
Phone: (505) 629-6116

Online Phone Directory
<https://www.emnrd.nm.gov/ocd/contact-us>

State of New Mexico
Energy, Minerals and Natural Resources
Oil Conservation Division
1220 S. St Francis Dr.
Santa Fe, NM 87505

CONDITIONS

Action 535229

CONDITIONS

Operator: EOG RESOURCES INC 5509 Champions Drive Midland, TX 79706	OGRID: 7377
	Action Number: 535229
	Action Type: [C-103] Sub. General Sundry (C-103Z)

CONDITIONS

Created By	Condition	Condition Date
llowe	None	1/2/2026