

**District I**

1625 N. French Dr., Hobbs, NM 88240

**District II**

1301 W. Grand Avenue, Artesia, NM 88210

**District III**

1000 Rio Brazos Rd., Aztec, NM 87410

**District IV**

1220 S. St. Francis Dr., Santa Fe, NM 87505

**State of New Mexico**  
**Energy, Minerals & Natural Resources Department**

**OIL CONSERVATION DIVISION**

1220 South St. Francis Dr.

Santa Fe, NM 87505

**RECEIVED**

2009 JUL 22 PM 1 45

Form C-102

Revised October 12, 2005

Submit to Appropriate District Office

State Lease - 4 Copies

Fee Lease - 3 Copies



AMENDED REPORT

**WELL LOCATION AND ACREAGE DEDICATION PLAT**

<sup>1</sup> API Number 30-021-20140	<sup>2</sup> Pool Code 96387	<sup>3</sup> Pool Name West Bravo Dome CO2 GAS
<sup>4</sup> Property Code 16752	<sup>5</sup> Property Name <del>State 1830</del> WEST BRAVO DOME UNIT	<sup>6</sup> Well Number 291 G
<sup>7</sup> OGRID No. 495	<sup>8</sup> Operator Name HESS Corporation	<sup>9</sup> Elevation 162' 4395'

<sup>10</sup> Surface Location

UL or lot No.	Sec.	Township	Range	Lot Idn	Feet from the	North/South Line	Feet from the	East/West Line	County
G	29	18N	30E	G	1980'	North	1980'	East	Harding

<sup>11</sup> Bottom Hole Location If Different From Surface

UL or lot No.	Sec.	Township	Range	Lot Idn	Feet from the	North/South Line	Feet from the	East/West Line	County

<sup>12</sup> Dedicated Acres 640	<sup>13</sup> Joint or Infill N	<sup>14</sup> Consolidation Code C	<sup>15</sup> Order No.
--------------------------------------	------------------------------------	---------------------------------------	-------------------------

No allowable will be assigned to this completion until all interests have been consolidated or a non-standard unit has been approved by the division.

<sup>16</sup> HESS Corporation TR 1 State	HESS Corporation 1980' North		<sup>17</sup> OPERATOR CERTIFICATION I hereby certify that the information contained herein is true and complete to the best of my knowledge and belief, and that this organization either owns a working interest or unleased mineral interest in the land including the proposed bottom hole location or has a right to drill this well at this location pursuant to a contract with an owner of such a mineral or working interest, or to a voluntary pooling agreement or a compulsory pooling order heretofore entered by the division. <b>Rita C. Smith</b> Digitally signed by Rita C. Smith DN: cn=Rita C. Smith, o=Hess Corp, ou=Engineering, email=rsmith@hess.com, c=US Date: 2009.07.20 14:11:37 -05'00' Signature: <b>Smith</b> Printed Name: <b>Rita C. Smith</b> 7-2009 Date of Survey Signature and Seal of Professional Surveyor: Certificate Number
	HESS Corporation TR 2 State 1980' East		
	HESS Corporation TR 2 State State 1830 291G		
	TR 3 T.E. Mitchell & Sons, Inc		
TR 3 T.E. Mitchell & Sons, Inc			

OK Ed Martin 7/31/09

**District I**

1625 N. French Dr., Hobbs, NM 88240

**District II**

1301 W. Grand Avenue, Artesia, NM 88210

**District III**

1000 Rio Brazos Rd., Aztec, NM 87410

**District IV**

1220 S. St. Francis Dr., Santa Fe, NM 87505

**State of New Mexico**

Energy, Minerals &amp; Natural Resources Department

**OIL CONSERVATION DIVISION**

1220 South St. Francis Dr.

Santa Fe, NM 87505

Form C-102

Revised October 12, 2005

Submit to Appropriate District Office

State Lease - 4 Copies

Fee Lease - 3 Copies

☒ AMENDED REPORT**WELL LOCATION AND ACREAGE DEDICATION PLAT**

<sup>1</sup> API Number 30-021-20140	<sup>2</sup> Pool Code 96387	<sup>3</sup> Pool Name West Bravo Dome CO2 GAS
<sup>4</sup> Property Code 16752	<sup>5</sup> Property Name State 1830	<sup>6</sup> Well Number 291 G
<sup>7</sup> OGRID No. 495	<sup>8</sup> Operator Name HESS Corporation	<sup>9</sup> Elevation 1.62'

**<sup>10</sup> Surface Location**

UL or lot No.	Sec.	Township	Range	Lot Idn	Feet from the	North/South Line	Feet from the	East/West Line	County
G	29	18N	30E	G	1980'	North	1980'	East	Harding

**<sup>11</sup> Bottom Hole Location If Different From Surface**

UL or lot No.	Sec.	Township	Range	Lot Idn	Feet from the	North/South Line	Feet from the	East/West Line	County
<sup>12</sup> Dedicated Acres 640	<sup>13</sup> Joint or Infill N	<sup>14</sup> Consolidation Code C	<sup>15</sup> Order No.						

No allowable will be assigned to this completion until all interests have been consolidated or a non-standard unit has been approved by the division.

<sup>16</sup> HESS Corporation TR 1 State		HESS Corporation	<b><sup>17</sup> OPERATOR CERTIFICATION</b> I hereby certify that the information contained herein is true and complete to the best of my knowledge and belief, and that this organization either owns a working interest or unleased mineral interest in the land including the proposed bottom hole location or has a right to drill this well at this location pursuant to a contract with an owner of such a mineral or working interest, or to a voluntary pooling agreement or a compulsory pooling order heretofore entered by the division.  Rita C. Smith Digitally signed by Rita C. Smith DN: cn=Rita C. Smith, o=Hess Corporation-Engineering, email=rsmith@hess.com, c=US Date: 2005.07.20 14:11:37 -05'00'  Signature Rita C. Smith Printed Name
TR 3		HESS Corporation TR 2 State	
T.E. Mitchell & Sons, Inc		HESS Corporation	<b><sup>18</sup> SURVEYOR CERTIFICATION</b> I hereby certify that the well location shown on this plat was plotted from field notes of actual surveys made by me or under my supervision, and that the same is true and correct to the best of my belief.  Date of Survey  Signature and Seal of Professional Surveyor:  Certificate Number
HESS TR 2 State		TR 3	
T.E. Mitchell & Sons, Inc			

District I  
1625 N. French Dr., Hobbs, NM 88240  
District II  
1301 W. Grand Avenue, Artesia, NM 88210  
District III  
1000 Rio Brazos Rd., Aztec, NM 87410  
District IV  
1220 S. St. Francis Dr., Santa Fe, NM 87505

State of New Mexico  
Energy, Minerals & Natural Resources Department  
**OIL CONSERVATION DIVISION**  
1220 South St. Francis Dr.  
Santa Fe, NM 87505

Form C-102  
Revised October 12, 2005  
Submit to Appropriate District Office  
State Lease - 4 Copies  
Fee Lease - 3 Copies

☒ AMENDED REPORT

**WELL LOCATION AND ACREAGE DEDICATION PLAT**

API Number 30-021-20140		Pool Code 96387		Pool Name West Bravo Dome CO2 Gas	
Property Code 16752		Property Name State 1830			Well Number 291G
OGRID No. 495		Operator Name Hess Corporation			Elevation 4395'

**10 Surface Location**

UL or lot no.	Section	Township	Range	Lot Idn	Feet from the	North/South line	Feet from the	East/West line	County
G	29	18N	30E	G	1980'	NORTH	1980'	EAST	HARDING

**11 Bottom Hole Location If Different From Surface**

UL or lot no.	Section	Township	Range	Lot Idn	Feet from the	North/South line	Feet from the	East/West line	County
Dedicated Acres 640		Joint or Infill N		Consolidation Code C		Order No.			

No allowable will be assigned to this completion until all interests have been consolidated or a non-standard unit has been approved by the division.

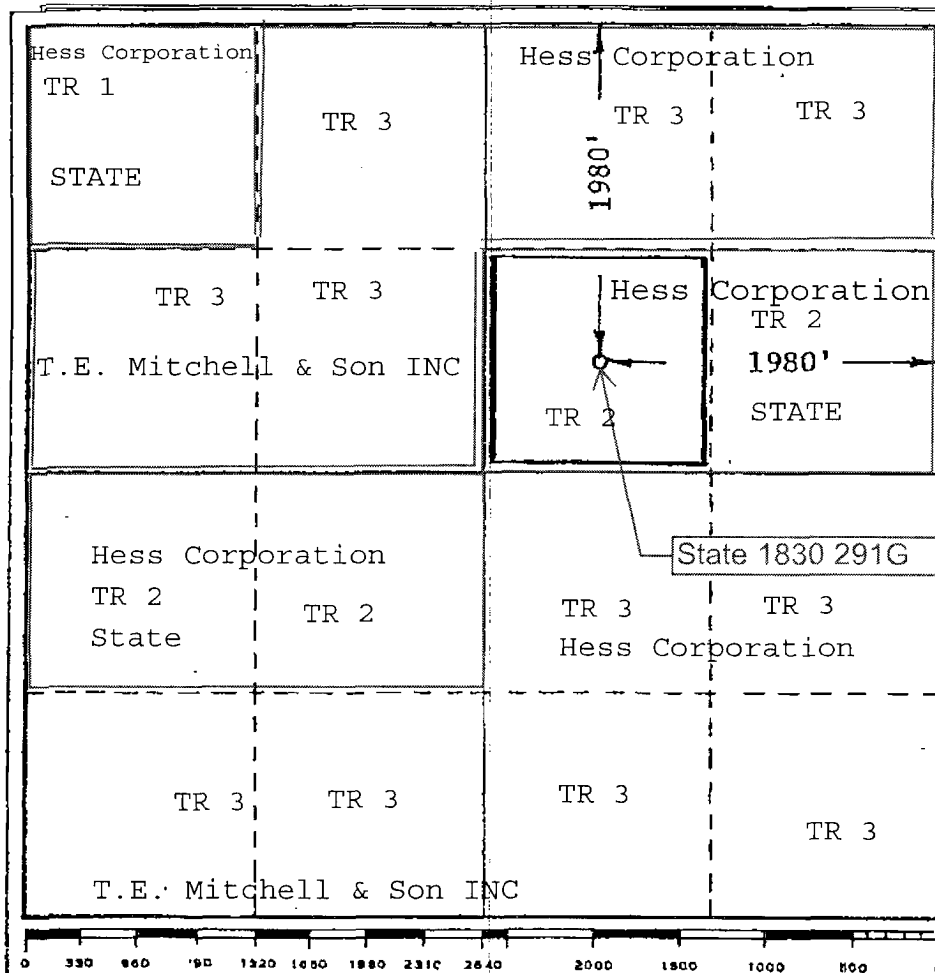

**17 OPERATOR CERTIFICATION**

I hereby certify that the information contained herein is true and complete to the best of my knowledge and belief, and that this organization either owns a working interest or unleased mineral interest in the land including the proposed bottom hole location or has a right to drill this well at this location pursuant to a contract with an owner of such a mineral or working interest, or to a voluntary pooling agreement or a compulsory pooling order therefore entered by the division.

Digitally signed by Rita C. Smith  
DN: cn=Rita C. Smith, o=Hess  
email=rsmit@hess.com, c=US  
Date: 2009.07.16 14:16:26 -05'00'

Signature: Rita C. Smith  
Printed Name: Rita C Smith 7-16-2009

I hereby certify that the well location shown on this plat was plotted from field notes of actual surveys made by me or under my supervision, and that the same is true and correct to the best of my knowledge and belief.

Date Surveyed: April 9, 1981  
Registered Professional Engineer  
and Land Surveyor  
3239  
Certificate No. JOHN M. WEST 676  
PATRICK A. ROMERO 6463  
Ronald J. Eidson 3239