

DATE IN 9-24-04	SUSPENSE 10/1/04	ENGINEER jones	LOGGED IN 9-24-04	TYPE SWD	APPROV. PSEM0426848422
-----------------	------------------	----------------	-------------------	----------	------------------------

ABOVE THIS LINE FOR DIVISION USE ONLY

**NEW MEXICO OIL CONSERVATION DIVISION**  
**- Engineering Bureau -**  
 1220 South St. Francis Drive, Santa Fe, NM 87505



**ADMINISTRATIVE APPLICATION CHECKLIST**

THIS CHECKLIST IS MANDATORY FOR ALL ADMINISTRATIVE APPLICATIONS FOR EXCEPTIONS TO DIVISION RULES AND REGULATIONS WHICH REQUIRE PROCESSING AT THE DIVISION LEVEL IN SANTA FE

**Application Acronyms:**

[NSL-Non-Standard Location] [NSP-Non-Standard Proration Unit] [SD-Simultaneous Dedication]  
 [DHC-Downhole Commingling] [CTB-Lease Commingling] [PLC-Pool/Lease Commingling]  
 [PC-Pool Commingling] [OLS - Off-Lease Storage] [OLM-Off-Lease Measurement]  
 [WFX-Waterflood Expansion] [PMX-Pressure Maintenance Expansion]  
 [SWD-Salt Water Disposal] [IPI-Injection Pressure Increase]  
 [EOR-Qualified Enhanced Oil Recovery Certification] [PPR-Positive Production Response]

[1] **TYPE OF APPLICATION** - Check Those Which Apply for [A]

[A] Location - Spacing Unit - Simultaneous Dedication  
☐ NSL ☐ NSP ☐ SD

Check One Only for [B] or [C]

[B] Commingling - Storage - Measurement  
☐ DHC ☐ CTB ☐ PLC ☐ PC ☐ OLS ☐ OLM

[C] Injection - Disposal - Pressure Increase - Enhanced Oil Recovery  
☐ WFX ☐ PMX ☒ SWD ☐ IPI ☐ EOR ☐ PPR

[D] Other: Specify \_\_\_\_\_

[2] **NOTIFICATION REQUIRED TO:** - Check Those Which Apply, or ☐ Does Not Apply

- [A] ☐ Working, Royalty or Overriding Royalty Interest Owners
- [B] ☐ Offset Operators, Leaseholders or Surface Owner
- [C] ☐ Application is One Which Requires Published Legal Notice
- [D] ☐ Notification and/or Concurrent Approval by BLM or SLO  
U.S. Bureau of Land Management - Commissioner of Public Lands, State Land Office
- [E] ☐ For all of the above, Proof of Notification or Publication is Attached, and/or,
- [F] ☐ Waivers are Attached

[3] **SUBMIT ACCURATE AND COMPLETE INFORMATION REQUIRED TO PROCESS THE TYPE OF APPLICATION INDICATED ABOVE.**

[4] **CERTIFICATION:** I hereby certify that the information submitted with this application for administrative approval is accurate and complete to the best of my knowledge. I also understand that no action will be taken on this application until the required information and notifications are submitted to the Division.

**Note:** Statement must be completed by an individual with managerial and/or supervisory capacity.

Print or Type Name

Signature

Title

Date

e-mail Address



Devon Energy Corporation  
20 North Broadway  
Oklahoma City, Oklahoma 73102-8260

September 22, 2004

Oil Conservation Division  
1220 South St. Francis Dr.  
Santa Fe, New Mexico 87505

RE: Form C-108, Application for Authorization to Inject  
North Pure Gold 9 Federal 17  
API#: 30-015-33368  
Lease: NMNM77046  
Eddy County, NM  
Section 9, T23S, R31E

2004 SEP 24 AM 11 04

Gentlemen:

Please find attached Devon Energy Production Company, LP's Form C-108, Application for Authorization to Inject. Devon wishes to take produced waters from the Delaware and re-inject back into the Delaware for pressure maintenance purposes using the North Pure Gold 9 Federal 17.

A copy of this application has been filed with the OCD-Atesia office, Bureau of Land Management in Roswell, appropriate surface land owner, and leasehold operator.

If you have any questions, please contact Jim Blount at (405)-228-4301 or myself at (405)-552-4615. Thank you for your cooperation in this matter.

Sincerely,

Ronnie Slack  
Engineering Technician

RS/rs

Enclosure

cc: OCD, Artesia Office  
BLM-Roswell, NM

**APPLICATION FOR AUTHORIZATION TO INJECT**

- I. PURPOSE: \_\_\_\_\_ Secondary Recovery    ☒ Pressure Maintenance    \_\_\_\_\_ Disposal    \_\_\_\_\_ Storage  
Application qualifies for administrative approval?    ☒ Yes    \_\_\_\_\_ No
- II. OPERATOR: \_\_\_\_\_ Devon Energy Production Company, LP \_\_\_\_\_  
ADDRESS: \_\_\_\_\_ 20 North Broadway, Suite 1500, Oklahoma City, Oklahoma 73102 \_\_\_\_\_  
CONTACT PARTY: \_\_\_\_\_ Ronnie Slack \_\_\_\_\_ PHONE: \_\_\_\_\_ 405-552-4615
- III. WELL DATA: Complete the data required on the reverse side of this form for each well proposed for injection.  
Additional sheets may be attached if necessary.
- IV. Is this an expansion of an existing project?    ☒ Yes    \_\_\_\_\_ No  
If yes, give the Division order number authorizing the project: \_\_\_\_\_ SWD-925 \_\_\_\_\_
- V. Attach a map that identifies all wells and leases within two miles of any proposed injection well with a one-half mile radius circle drawn around each proposed injection well. This circle identifies the well's area of review.
- VI. Attach a tabulation of data on all wells of public record within the area of review which penetrate the proposed injection zone. Such data shall include a description of each well's type, construction, date drilled, location, depth, record of completion, and a schematic of any plugged well illustrating all plugging detail.
- VII. Attach data on the proposed operation, including:
1. Proposed average and maximum daily rate and volume of fluids to be injected;
  2. Whether the system is open or closed;
  3. Proposed average and maximum injection pressure;
  4. Sources and an appropriate analysis of injection fluid and compatibility with the receiving formation if other than reinjected produced water; and,
  5. If injection is for disposal purposes into a zone not productive of oil or gas at or within one mile of the proposed well, attach a chemical analysis of the disposal zone formation water (may be measured or inferred from existing literature, studies, nearby wells, etc.).
- \*VIII. Attach appropriate geologic data on the injection zone including appropriate lithologic detail, geologic name, thickness, and depth. Give the geologic name, and depth to bottom of all underground sources of drinking water (aquifers containing waters with total dissolved solids concentrations of 10,000 mg/l or less) overlying the proposed injection zone as well as any such sources known to be immediately underlying the injection interval.
- IX. Describe the proposed stimulation program, if any.
- \*X. Attach appropriate logging and test data on the well. (If well logs have been filed with the Division, they need not be resubmitted).
- \*XI. Attach a chemical analysis of fresh water from two or more fresh water wells (if available and producing) within one mile of any injection or disposal well showing location of wells and dates samples were taken.
- XII. Applicants for disposal wells must make an affirmative statement that they have examined available geologic and engineering data and find no evidence of open faults or any other hydrologic connection between the disposal zone and any underground sources of drinking water.
- XIII. Applicants must complete the "Proof of Notice" section on the reverse side of this form.
- XIV. Certification: I hereby certify that the information submitted with this application is true and correct to the best of my knowledge and belief.
- NAME: \_\_\_\_\_ Ronnie Slack \_\_\_\_\_ TITLE: \_\_\_\_\_ Engineering Technician
- SIGNATURE: \_\_\_\_\_ *Ronnie Slack* \_\_\_\_\_ DATE: \_\_\_\_\_ 9/22/04 \_\_\_\_\_
- E-MAIL ADDRESS: \_\_\_\_\_ Ronnie.Slack@DVN.com \_\_\_\_\_
- \* If the information required under Sections VI, VIII, X, and XI above has been previously submitted, it need not be resubmitted. Please show the date and circumstances of the earlier submittal: \_\_\_\_\_

DISTRIBUTION: Original and one copy to Santa Fe with one copy to the appropriate District Office

### III. WELL DATA

- A. The following well data must be submitted for each injection well covered by this application. The data must be both in tabular and schematic form and shall include:
- (1) Lease name; Well No.; Location by Section, Township and Range; and footage location within the section.
  - (2) Each casing string used with its size, setting depth, sacks of cement used, hole size, top of cement, and how such top was determined.
  - (3) A description of the tubing to be used including its size, lining material, and setting depth.
  - (4) The name, model, and setting depth of the packer used or a description of any other seal system or assembly used.
- Division District Offices have supplies of Well Data Sheets which may be used or which may be used as models for this purpose. Applicants for several identical wells may submit a "typical data sheet" rather than submitting the data for each well.
- B. The following must be submitted for each injection well covered by this application. All items must be addressed for the initial well. Responses for additional wells need be shown only when different. Information shown on schematics need not be repeated.
- (1) The name of the injection formation and, if applicable, the field or pool name.
  - (2) The injection interval and whether it is perforated or open-hole.
  - (3) State if the well was drilled for injection or, if not, the original purpose of the well.
  - (4) Give the depths of any other perforated intervals and detail on the sacks of cement or bridge plugs used to seal off such perforations.
  - (5) Give the depth to and the name of the next higher and next lower oil or gas zone in the area of the well, if any.

### XIV. PROOF OF NOTICE

All applicants must furnish proof that a copy of the application has been furnished, by certified or registered mail, to the owner of the surface of the land on which the well is to be located and to each leasehold operator within one-half mile of the well location.

Where an application is subject to administrative approval, a proof of publication must be submitted. Such proof shall consist of a copy of the legal advertisement which was published in the county in which the well is located. The contents of such advertisement must include:

- (1) The name, address, phone number, and contact party for the applicant;
- (2) The intended purpose of the injection well; with the exact location of single wells or the Section, Township, and Range location of multiple wells;
- (3) The formation name and depth with expected maximum injection rates and pressures; and,
- (4) A notation that interested parties must file objections or requests for hearing with the Oil Conservation Division, 1220 South St. Francis Dr., Santa Fe, New Mexico 87505, within 15 days.

NO ACTION WILL BE TAKEN ON THE APPLICATION UNTIL PROPER PROOF OF NOTICE HAS BEEN SUBMITTED.

---

NOTICE: Surface owners or offset operators must file any objections or requests for hearing of administrative applications within 15 days from the date this application was mailed to them.

INJECTION WELL DATA SHEET

OPERATOR: \_\_\_\_\_ Devon Energy Production Company, LP \_\_\_\_\_

WELL NAME & NUMBER: \_\_\_\_\_ North Pure Gold 9 Federal 17 \_\_\_\_\_

WELL LOCATION: \_\_\_\_\_ 1265' FSL & 35' FWL \_\_\_\_\_ M \_\_\_\_\_ Sec \_\_\_\_\_ 9 \_\_\_\_\_ 23S \_\_\_\_\_ 31E \_\_\_\_\_  
FOOTAGE LOCATION \_\_\_\_\_ UNIT LETTER \_\_\_\_\_ SECTION \_\_\_\_\_ TOWNSHIP \_\_\_\_\_ RANGE \_\_\_\_\_

WELLBORE SCHEMATIC

WELL CONSTRUCTION DATA  
Surface Casing

Hole Size: \_\_\_\_\_ 17-1/2" \_\_\_\_\_ Casing Size: \_\_\_\_\_ 13-3/8" \_\_\_\_\_  
Cemented with: \_\_\_\_\_ 650 \_\_\_\_\_ sx. \_\_\_\_\_ or \_\_\_\_\_ ft<sup>3</sup> \_\_\_\_\_  
Top of Cement: \_\_\_\_\_ Surface \_\_\_\_\_ Method Determined: Circ. cement

Intermediate Casing

Hole Size: \_\_\_\_\_ 11" \_\_\_\_\_ Casing Size: \_\_\_\_\_ 8-5/8" \_\_\_\_\_  
Cemented with: \_\_\_\_\_ 1100 \_\_\_\_\_ sx. \_\_\_\_\_ or \_\_\_\_\_ ft<sup>3</sup> \_\_\_\_\_  
Top of Cement: \_\_\_\_\_ Surface \_\_\_\_\_ Method Determined: Circ cement

Production Casing

Hole Size: \_\_\_\_\_ 7-7/8" \_\_\_\_\_ Casing Size: \_\_\_\_\_ 5-1/2" \_\_\_\_\_  
Cemented with: \_\_\_\_\_ 1235 \_\_\_\_\_ sx. \_\_\_\_\_ or \_\_\_\_\_ ft<sup>3</sup> \_\_\_\_\_  
Top of Cement: \_\_\_\_\_ 1500' \_\_\_\_\_ Method Determined: \_\_\_\_\_ CBL Log

Total Depth: \_\_\_\_\_ 8,080' \_\_\_\_\_

Injection Interval (Perforated)

\_\_\_\_\_ 7,744' \_\_\_\_\_ feet to \_\_\_\_\_ 7,952' \_\_\_\_\_

**INJECTION WELL DATA SHEET**

Tubing Size: 2-3/8", 4.7# Lining Material: IPC

Type of Packer: 5-1/2" Lok Set

Packer Setting Depth: 7,695'

Other Type of Tubing/Casing Seal (if applicable): \_\_\_\_\_

Additional Data

1. Is this a new well drilled for injection? Yes X No

If no, for what purpose was the well originally drilled? Producing Oil Well

2. Name of the Injection Formation: Delaware

3. Name of Field or Pool (if applicable): Los Medanos ( Delaware )

4. Has the well ever been perforated in any other zone(s)? List all such perforated intervals and give plugging detail, i.e. sacks of cement or plug(s) used.

The only current perforated interval in the North Pure Gold 9 Federal 17, is the Delaware Lower Brushy Canyon at 7,926' – 7,934 and 7,942' – 7,952'. Perforations will be added in the Delaware Lower Brushy Canyon from 7,744' to 7,800'. The total injection interval will be from 7,744' to 7,952'

5. Give the name and depths of any oil or gas zones underlying or overlying the proposed injection zone in this area: \_\_\_\_\_

There are no lower oil zones in the area of review. The next lower gas zone is the Morrow at 13,966' in the North Pure Gold 8 Fed #1. There are no productive oil / gas zones in the area of review above the proposed injection interval at 7,744' to 7,952' in the North Pure Gold 9 Federal #17.

**North Pure Gold 9 Federal 17**  
**APPLICATION FOR INJECTION**  
**Form C-108 Section VII to XII**

**VII Attach data on the proposed operation, including:**

- (1) Proposed average injection rate: 200 BWPD  
Proposed maximum injection rate: 500 BWPD
- (2) The system will be a closed system.
- (3) Proposed average injection pressure: 800 psi  
Proposed max injection pressure: 1500 psi
- (4) The proposed injection fluid is produced water from the Delaware that will be re-injected into the Delaware.
- (5) A water analysis is attached for the North Pure Gold 8 Fed 11. Similar Delaware produced waters will be injected into the North Pure Gold 9-17.

**VIII**

The proposed injection interval is located in the Delaware Lower Brushy Canyon formation. This Permian age reservoir is approximately 208 feet thick in the North Pure Gold 9 Federal 17. The proposed injection interval is from 7,744 to 7,800'; '7,926' to 7,934'; and 7,942 to 7,952.

No wells using fresh water drinking aquifers are reported in the proposed well review area. See attached Well / Surface Data Report per New Mexico Office of the State Engineer.

- IX** The current open interval at 7,926' - 7,934' and 7,942' - 7,952' will not be stimulated. The perf addition at 7,744' - 7,800' will be acidized with approximately 2000 gallons of acid.
- X** Logging & test data have previously been submitted to the OCD.
- XI** No fresh water wells are reported within one mile of proposed conversion well. This information per New Mexico Office of the State Engineer is attached.
- XII** An examination of this area has determined there are no open faults or other hydrologic connection between the disposal zone and any underground drinking water.

**North Pure Gold 9 Federal # 17**  
**APPLICATION FOR INJECTION**  
**Form C-108 Section III**

**III. Well Data--On Injection Well**

**A. Injection Well Information**

- (1) **Lease** North Pure Gold 9 Federal  
**Well No** #17  
**Location** 1265' FSL & 35' FWL  
**Sec,Twn,Rnge** Sec 9, T23S-R31E, Unit M  
**Cnty, State** Eddy County, New Mexico
- (2) **Casing** 13-3/8", 48#, H40, @ 620' in 17-1/2" hole. Cmt'd w/ 650 sxs.  
TOC @ surface. Cement circulated.  
  
8-5/8", 32#, J55, @ 4,097' in 11" hole. Cmt'd w/ 1100 sxs.  
TOC @ surface. Cement circulated.  
  
5-1/2" 15.5 & 17#, J55, @ 8,080'. Cmt'd w/ 1235 sxs.  
TOC @ 1500', determined by Cement Bond Log
- (3) **Injection Tubing** 2-3/8" , 4.7#, IPC tubing run to 7,695'
- (4) **Packer** 5-1/2" Lok Set @ 7,695'

**B. Other Well Information**

- (1) **Injection Formation:** Delaware Lower Brushy Canyon  
**Field Name:** Los Medanos Delaware
- (2) **Injection Interval:** 7,744' - 7,800' (cased hole, perforated)  
7,926' - 7,934' (cased hole, perforated)  
7,942' - 7,952' (cased hole, perforated)

(3) **Original Purpose of Wellbore:**

The North Pure Gold 9 Federal #17 was spud on April 9, 2004 and drilled to 8,080' TD. The well was completed in the Delaware Lower Brushy Canyon at 7,926' - 7,934' and 7,942' - 7,952' as an oil well. This well is currently (Aug-2004) averaging approximately 4 BOD, 3 MCFD, and 42 BWD on rod pump.

(4) **Other perforated intervals:**

The current perforated interval in this wellbore is at 7,926' - 7,934' and 7,942' - 7,952'. The proposed injection interval is 7,744' - 7,800' (perf add); 7,926' - 7,934'; and 7,942' - 7,952'.

(5) **Give the depth to and the name of the next higher and next lower oil or gas zone in the area of the well if any.**

There are no lower productive oil zones in the area of review. The next lower gas zone is the Morrow at 13,966' in the North Pure Gold 8 Fed #1. There are no productive oil / gas zones in the area of review above the proposed injection interval at 7,744' - 7,800'; 7,926' - 7,934'; 7,942' - 7,952'.



DEVON ENERGY PRODUCTION COMPANY, LP

C108 ITEM VI--Well Tabulation in Review Area for North Pure Gold 9 Fed 17

Count	Operator	Well Name	API NO	Sec Twn Range	Type	Status	Spud Date	Comp Date	TD	PBTD	Comp Zone	Comp Interval	Casing Program	TOC
1	Devon Energy Prod Co LP	North Pure Gold 8 Fed 1	30-015-26296	8 T23S R31E	Gas	ACT	3/24/1990	7/4/1990	14821	14703	Morrow	13966' - 13986'	13-3/8", 48#, @ 628, w/ 800 sxs 9-5/8", 40#, @ 4125, w/2500 sx 7", 29&26#, @ 11718', w/1100 sxs 4-1/2", @ 11380 to 14820, w/510 sxs	Surf Surf 5140' liner top
2	Devon Energy Prod Co LP	North Pure Gold 8 Fed 2	30-015-27597	8 T23S R31E	Oil	ACT	1/28/1994	2/25/1994	8080	8035	Delaware	7870' - 7910'	13-3/8", 48#, @ 605, w/ 600 sxs 8-5/8", 32#, @ 4096', w/1850 sx 5-1/2", 15.5&17#, @ 8080', w/1700 sxs	Surf Surf 3520-log
3	Devon Energy Prod Co LP	North Pure Gold 8 Fed 3	30-015-27610	8 T23S R31E	Oil	ACT	2/12/1994	3/27/1994	8196	8134	Delaware	7864' - 7930'	13-3/8", 48#, @ 582, w/ 600 sxs 8-5/8", 32#, @ 4068', w/1900 sx 5-1/2", 15.5&17#, @ 8196', w/1150 sxs	Surf Surf 3050-log
4	Devon Energy Prod Co LP	North Pure Gold 8 Fed 5	30-015-27598	8 T23S R31E	Oil	ACT	10/18/1993	11/13/1993	8070	8023	Delaware	7860' - 7900'	13-3/8", 48#, @ 590, w/ 350 sxs 8-5/8", 32#, @ 4045', w/2200 sx 5-1/2", 15.5&17#, @ 8070', w/895 sxs	Surf Surf 3416-log
5	Devon Energy Prod Co LP	North Pure Gold 8 Fed 6	30-015-27618	8 T23S R31E	Oil	ACT	2/10/1994	3/24/1994	8082	8000	Delaware	7822' - 7890'	13-3/8", 48#, @ 584, w/ 600 sxs 8-5/8", 32#, @ 4016', w/1900 sx 5-1/2", 15.5&17#, @ 8082', w/900 sxs	Surf Surf 3456-log
6	Devon Energy Prod Co LP	North Pure Gold 8 Fed 9	30-015-27600	8 T23S R31E	Oil	ACT	10/5/1993	11/1/1993	8100	7999	Delaware	7880' - 7910'	13-3/8", 48#, @ 585, w/ 600 sxs 8-5/8", 32#, @ 4072', w/2100 sx 5-1/2", 15.5&17#, @ 8010', w/1095 sxs	Surf Surf 2800-log
7	Devon Energy Prod Co LP	North Pure Gold 8 Fed 11  Apprvd for salt water injection into Delaware Lower Brushy Canyon @ 7900-7933' by OCD on 6-2-04. Water injection has not commenced.	30-015-32619	8 T23S R31E	Oil	SI	2/10/2003	3/20/2003	8160	8056	Delaware-Cherry Canyon Delaware-Brushy Canyon	7256' - 7530' 7900' - 7933'	13-3/8", 48#, @ 461' w/490 sxs 8-5/8", 32#, @ 4056' w/ 1090 sxs 5-1/2", 15.5# & 17#, @ 8160' w/800 sxs	Surf Surf 3900'-log
8	Devon Energy Prod Co LP	North Pure Gold 9 Fed 1	30-015-27178	9 T23S R31E	Oil	ACT	10/25/1992	12/24/1992	8125		Delaware	7954'-8020'	13-3/8", 48#, @ 652, w/ 800 sxs 8-5/8", 32#, @ 4060', w/2500 sxs 5-1/2", 15.5 & 17#, @ 8125', w/1600 sxs	Surf Surf 2000-est.
9	Devon Energy Prod Co LP	North Pure Gold 9 Fed 2	30-015-27479	9 T23S R31E	Oil	ACT	5/29/1994	6/23/1994	8120	8076	Delaware	7900' - 7940'	13-3/8", 48#, @ 425, w/ 351 sxs 8-5/8", 32#, @ 3998', w/1000 sxs 5-1/2", 15.5 & 17#, @ 8120', w/675 sxs	Surf Surf 3500-log
10	Devon Energy Prod Co LP	North Pure Gold 9 Fed 3	30-015-27442	9 T23S R31E	Oil	ACT	6/19/1993	7/15/1993	8120	8073	Delaware	7920' - 7976'	13-3/8", 48#, @ 590' w/800 sxs 8-5/8", 32#, @ 4090' w/ 1800 sxs 5-1/2", 15.5# & 17#, @ 8120' w/1160 sxs	Surf Surf 2720-log
11	Devon Energy Prod Co LP	North Pure Gold 9 Fed 4	30-015-27443	9 T23S R31E	Oil	ACT	7/5/1993	8/1/1993	8123		Delaware	7910'-7960'	13-3/8", 48#, @ 575' w/800 sxs 8-5/8", 32#, @ 4064' w/ 1700 sxs 5-1/2", 15.5# & 17#, @ 8123' w/1050 sxs	Surf Surf 3835'-log

DEVON ENERGY PRODUCTION COMPANY, LP														
C108 ITEM VI--Well Tabulation in Review Area for North Pure Gold 9 Fed 17														
Count	Operator	Well Name	API NO	Sec Twn Range	Type	Status	Spud Date	Comp Date	TD	PBTD	Comp Zone	Comp Interval	Casing Program	TOC
12	Devon Energy Prod Co LP	North Pure Gold 9 Fed 17	30-015-33368	9 T23S R31E	Oil	ACT	4/9/2004	5/24/2004	8080	8036	Delaware - (Lower Brushy Canyon)	7926'-7952'	13-3/8", 48#, @ 620', w/ 650 sxs. 8-5/8", 32#, @ 4097', w/ 1100 sxs 5-1/2", 15.5#-17#, @ 8080' w/1235 sxs	Surf Surf 1500'-log
13	Devon Energy Prod Co LP	North Pure Gold C-17 Fed 5	30-015-27392	17 T23S R31E	Oil	ACT	5/6/1993	5/30/1993	8100	8080	Delaware	7904' - 7954'	13-3/8", 48#, @ 588' w/800 sxs 8-5/8", 32#, @ 4084' w/ 2100 sxs 5-1/2", 15.5# & 17#, @ 8100' w/1160 sxs	Surf Surf 3210'-log
14	Yates Petroleum Corp	Medano VA ST 16	30-015-27324	16 T23S R31E	Oil	ACT	5/31/1993	6/23/1993	8130		Delaware	7811' - 8003'	13-3/8", 54.5#, @ 500' w/475 sxs 9-5/8", 40# & 36#, @ 4038' w/ 1750 sxs 5-1/2", 15.5# & 17#, @ 8130' w/1200 sxs	Surf Surf 3470'-log
15	Yates Petroleum Corp	Medano VA ST 17	30-015-27325	16 T23S R31E	Oil	ACT	4/26/1993	5/25/1993	8087	8026	Delaware	7757' - 7945'	13-3/8", 54.5#, @ 505' w/475 sxs 9-5/8", 36# & 40#, @ 3995' w/ 1450 sxs 5-1/2", 15.5# & 17#, @ 8087' w/1205 sxs	Surf Surf 718'-calc

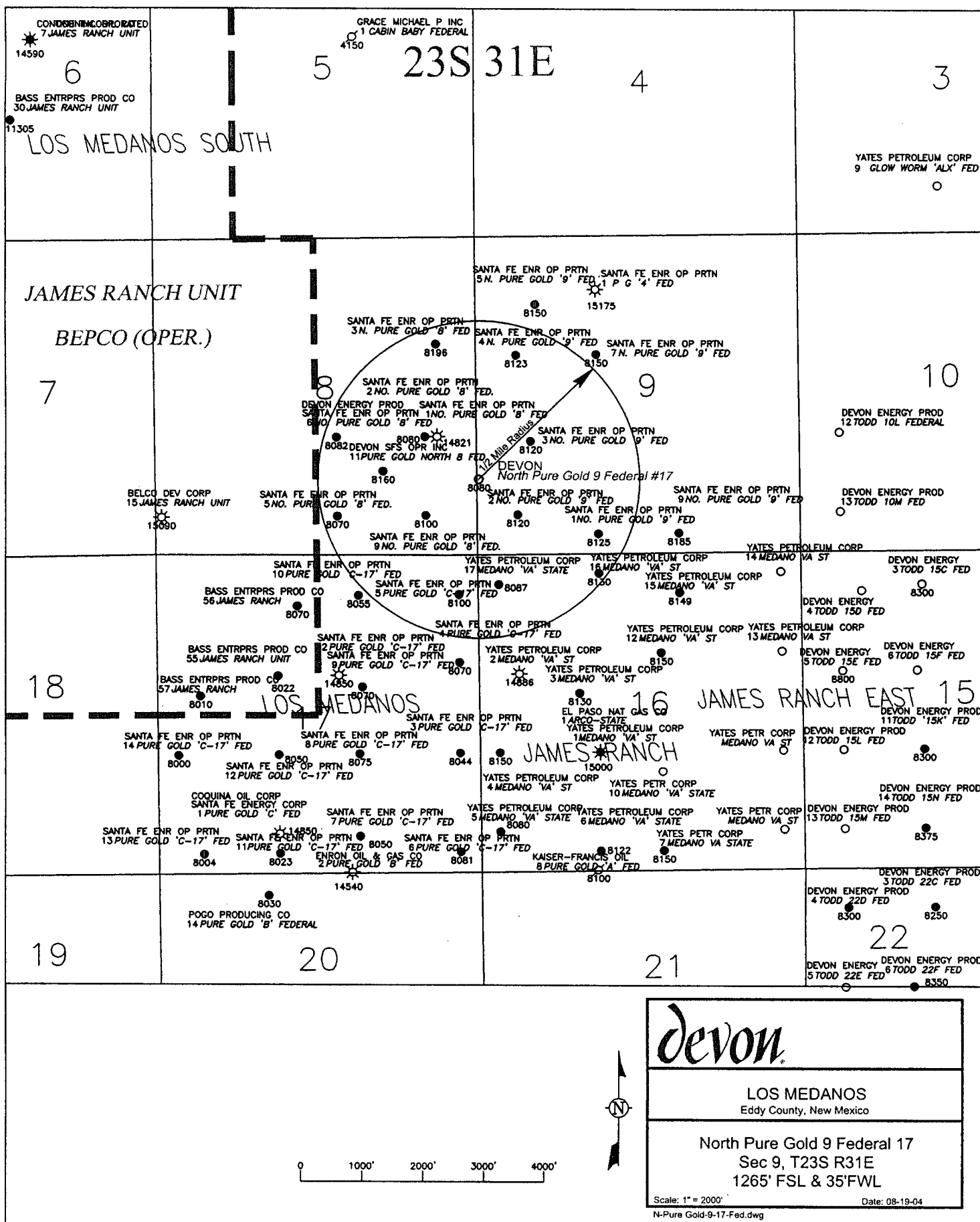

UNITED STATES  
DEPARTMENT OF THE INTERIOR  
BUREAU OF LAND MANAGEMENT

FORM APPROVED  
Budget Bureau No. 1004-0135  
Expires March 31, 1993

SUNDRY NOTICES AND REPORTS ON WELLS

Do not use this form for proposals to drill or to deepen or reentry to a different reservoir.  
Use "APPLICATION FOR PERMIT—" for such proposals

SUBMIT IN TRIPLICATE

1. Type of Well  
☒ Oil Well    ☐ Gas Well    ☐ Other \_\_\_\_\_
2. Name of Operator  
**DEVON ENERGY PRODUCTION COMPANY, LP.**
3. Address and Telephone No.  
**20 NORTH BROADWAY, SUITE 1500, OKLAHOMA CITY, OKLAHOMA 73102**
4. Location of Well (Footage. Sec., T., R., M., or Survey Description)  
**Sec 9, T23S, R31E, 1265' FSL & 35' FWL, Unit M**

5. Lease Designation and Serial No.  
**NMNM77046**
6. If Indian, Allottee or Tribe Name
7. If Unit or CA, Agreement Designation
8. Well Name and No.  
**North Pure Gold 9 Federal 17**
9. API Well No.  
**30-015-33368**
10. Field and Pool, or Exploratory Area  
**Los Medanos; Delaware**
11. County or Parish, State  
**EDDY COUNTY, NM**

CHECK APPROPRIATE BOX(s) TO INDICATE NATURE OF NOTICE, REPORT, OR OTHER DATA

TYPE OF SUBMISSION	TYPE OF ACTION	
<input checked="" type="checkbox"/> Notice of Intent	<input type="checkbox"/> Abandonment	<input type="checkbox"/> Change of Plans
<input type="checkbox"/> Subsequent Report	<input type="checkbox"/> Recompletion	<input type="checkbox"/> New Construction
<input type="checkbox"/> Final Abandonment Notice	<input type="checkbox"/> Plugging Back	<input type="checkbox"/> Non-Routine Fracturing
	<input type="checkbox"/> Casing Repair	<input type="checkbox"/> Water Shut-Off
	<input type="checkbox"/> Altering Casing	<input checked="" type="checkbox"/> Conversion to Injection
	<input type="checkbox"/> Other _____	<input type="checkbox"/> Dispose Water

(Note: Report results of multiple completion on Well Completion or Recompletion Report and Log form.)

13. Describe Proposed or Completed Operations (Clearly state all pertinent details, and give pertinent dates, including estimated date of starting any proposed work. If well is directionally drilled, give subsurface locations and measured and true vertical depths for all markers and zones pertinent to this work.)\*

DEPCO is submitting a request to convert this well to salt water injection for pressure maintenance purposes. Please find copy of C108 application attached.

1. Add perforations in Delaware-Lower Brushy Canyon from 7,744' to 7,800'. Total injection interval will be from 7,744' – 7,800'; 7,926' – 7,934'; and 7,942' – 7,952'.
2. Stimulate perforations from 7,744' to 7,800' with 2000 gallons acid.
3. Run 2-3/8", 4.7#, IPC tubing and 5-1/2" packer. Set packer at 7,695'. Initiate water injection at a rate of 200 BWPD with injection pressures from 800 psi to 1500 psi.

14. I hereby certify that the foregoing is true and correct

Signed Ronnie Slack Title Engineering Technician Date 9/22/04  
(This space for Federal or State office use)

Approved by \_\_\_\_\_ Title \_\_\_\_\_ Date \_\_\_\_\_  
Conditions of approval, if any:

Title 18 U.S.C. Section 1001, makes it a crime for any person knowingly and willfully to make to any department or agency of the United States any false, fictitious or fraudulent statements or representation to any matter within its jurisdiction.

\*See Instruction on Reverse Side

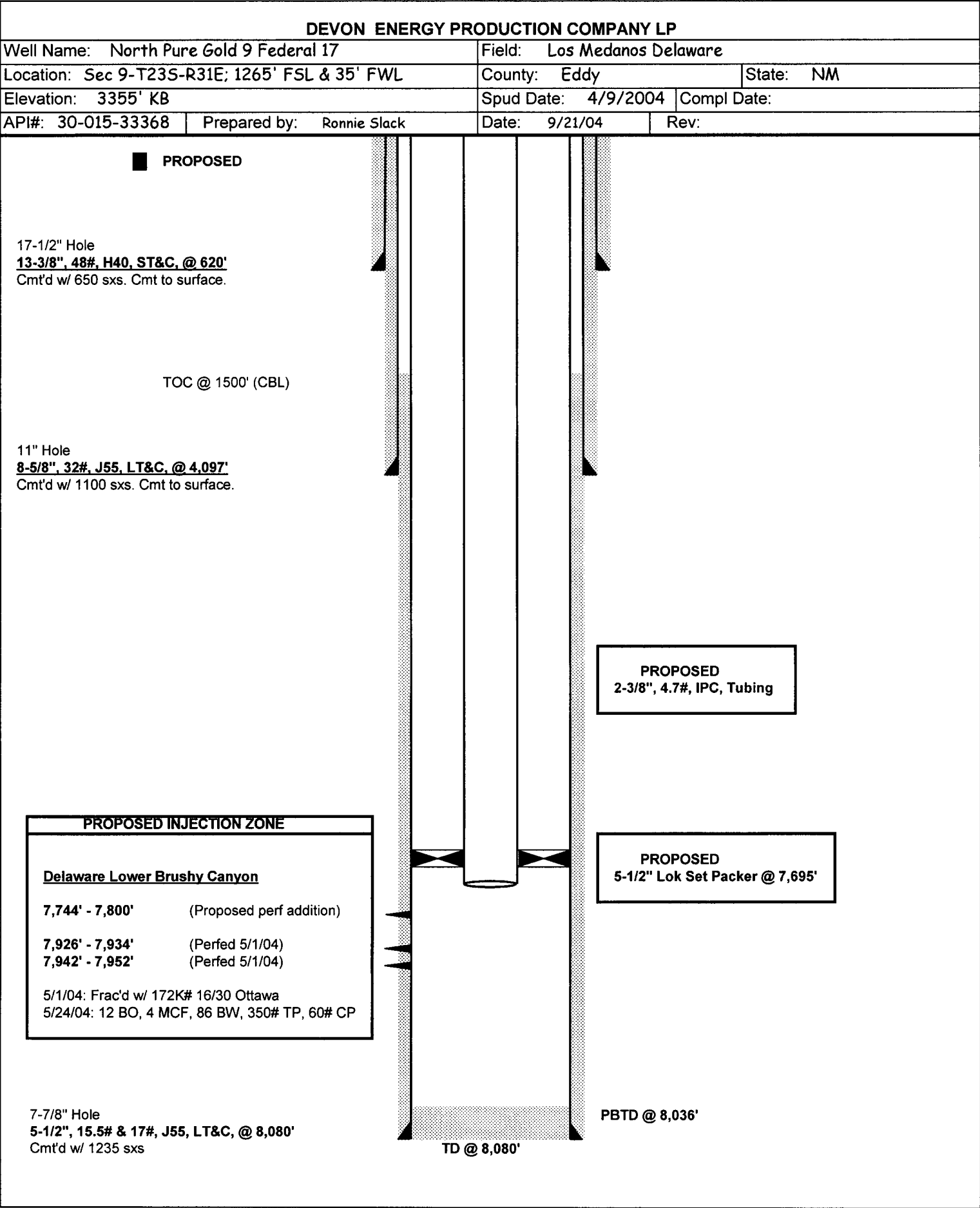

DEVON ENERGY PRODUCTION COMPANY LP

Well Name: North Pure Gold 9 Federal 17		Field: Los Medanos Delaware	
Location: Sec 9-T23S-R31E; 1265' FSL & 35' FWL		County: Eddy	State: NM
Elevation: 3355' KB		Spud Date: 4/9/2004	Compl Date: 4/23/04
API#: 30-015-33368	Prepared by: Ronnie Slack	Date: 8/18/04	Rev:

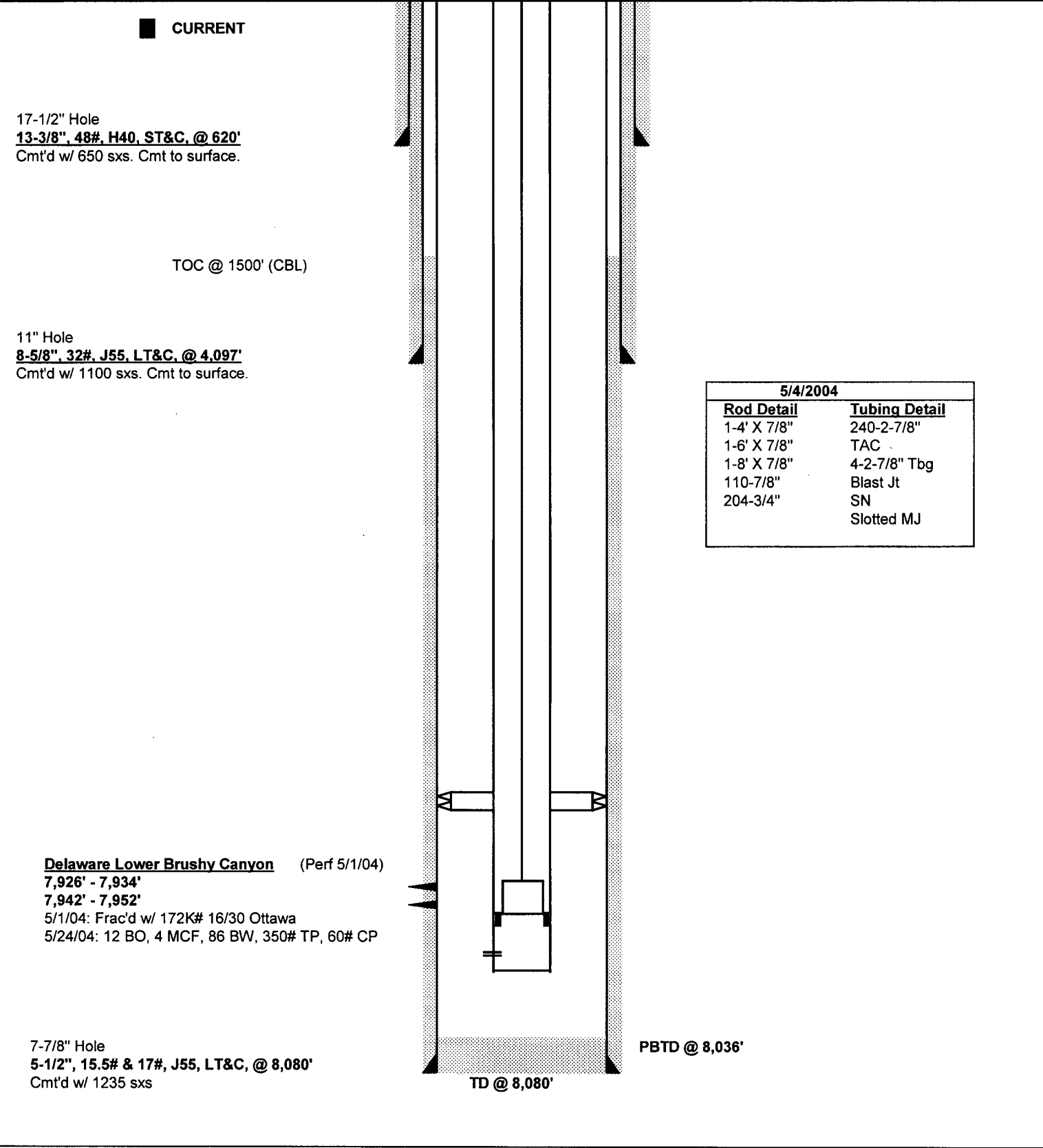



Water Analysis

Date: 02-Jun-03

2708 West County Road, Hobbs NM 88240  
Phone (505) 392-5556 Fax (505) 392-7307

Analyzed For

Company	Well Name	County	State
Devon	Pure Gold 8-11	Lea	New Mexico

Sample Source Swab Sample Sample # 1

Formation Depth

Specific Gravity	1.195	SG @ 60 °F	1.197
pH	7.37	Sulfides	Absent
Temperature (°F)	71	Reducing Agents	

Cations

Sodium (Calc)	in Mg/L	70,031	in PPM	58,486
Calcium	in Mg/L	39,600	in PPM	33,077
Magnesium	in Mg/L	960	in PPM	802
Soluble Iron (FE2)	in Mg/L	25.0	in PPM	21

Anions

Chlorides	in Mg/L	180,000	in PPM	150,351
Sulfates	in Mg/L	200	in PPM	167
Bicarbonates	in Mg/L	146	in PPM	122

Total Hardness (as CaCO3)	in Mg/L	103,000	in PPM	85,034
Total Dissolved Solids (Calc)	in Mg/L	290,962	in PPM	243,036
Equivalent NaCl Concentration	in Mg/L	241,990	in PPM	202,130

Scaling Tendencies

*Calcium Carbonate Index	5,797,440
Below 500,000 Remote / 500,000 - 1,000,000 Possible / Above 1,000,000 Probable	
*Calcium Sulfate (Gyp) Index	7,920,000
Below 500,000 Remote / 500,000 - 10,000,000 Possible / Above 10,000,000 Probable	

\*This Calculation is only an approximation and is only valid before treatment of a well or several weeks after treatment.

Remarks rw=08@711

Report # 1288

Affidavit of Publication

State of New Mexico,  
County of Eddy, ss.

Dawn Higgins, being first duly sworn, on oath says:

That she is Business Manager of the Carlsbad Current-Argus, a newspaper published daily at the City of Carlsbad, in said county of Eddy, state of New Mexico and of general paid circulation in said county; that the same is a duly qualified newspaper under the laws of the State wherein legal notices and advertisements may be published; that the printed notice attached hereto was published in the regular and entire edition of said newspaper and not in supplement thereof on the date as follows, to wit:

August 26 2004  
2004  
2004  
2004

That the cost of publication is \$ 38.37  
and that payment thereof has been made and will be  
assessed as court costs.

Dawn Higgins

Subscribed and sworn to before me this

27 day of August, 2004  
Stephanie Dobson

My commission expires 12-13-05

Notary Public

August 26, 2004

Legal Notice

Devon Energy Production Company, LP, 20 North Broadway, Oklahoma City, OK 73102-8260 has filed form C-108 (Application for Authorization to Inject) with the New Mexico Oil Conservation Division seeking administrative approval for an injection well. The proposed well the North Pure Gold 9 Federal 17, located SWSW 1265' FSL & 35 FWL, Section 9, Township 23 South, Range 31 East, in Eddy County, New Mexico, will be used for pressure maintenance. Disposal waters from the Delaware will be re-injected into the Delaware Lower Brushy Canyon at a depth of 7926' to 7952' with a maximum pressure of 1550 psi and a maximum rate of 500 BWPD.

All interested parties opposing the aforementioned must file objections or requests for a hearing with the Oil Conservation Division, 1220 South Saint Francis Drive, Santa Fe, New Mexico 87505-5472, within 15 days. Additional information can be obtained by contacting Jim Blount at (405) 228-4301.



New Mexico Office of the State Engineer  
Well Reports and Downloads

Township: 23S

Range: 31E

Sections: 4,5,7,8,9,10,15,16,17,18

NAD27 X:

Y:

Zone:

Search Radius:

County:

Basin:

Number:

Suffix:

Owner Name: (First) (Last)

☐ Non-Domestic

☐ Domestic

☒ All

Well / Surface Data Report

Avg Depth to Water Report

Water Column Report

Clear Form

WATERS Menu

Help

WELL / SURFACE DATA REPORT 09/20/2004									
(acre ft per annum)									
DB File Nbr	Use	Diversion	Owner	Well Number	(quarters are 1=NW 2=NE 3=SW 4=SE)				UTM are in Mete
					Tw	Rng	Sec	q q q	UTM Zone Easti
C 02664	MON	0	SANDIA NATIONAL LABORATORIES	C 02664	23S	31E	05	2 3 3	13 6130
C 02725	MON	0	U.S. DEPT. OF ENERGY, WIPP	C 02725	23S	31E	05	1 1 1	13 6122
C 02774	MON	0	U.S. DEPT. OF ENERGY - WIPP	C 02774	23S	31E	04	3 1 3	13 6139
C 02775	MON	0	U.S. DEPT. OF ENERGY - WIPP	C 02775	23S	31E	05	1 1 1	13 6122
C 02776	MON	0	U.S. DEPT. OF ENERGY - WIPP	C 02776	23S	31E	05	1 1 2	13 6124
C 02777	MON	0	U.S. DEPT. OF ENERGY - WIPP	C 02777	23S	31E	15	2 2 2	13 6169

Record Count: 6

New Mexico Office of the State Engineer  
Well Reports and Downloads

Township: 23S Range: 31E Sections: 4,5,7,8,9,10,15,16,17,18

NAD27 X: Y: Zone: Search Radius:

County: Basin: Number: Suffix:

Owner Name: (First) (Last) C Non-Domestic C Domestic All

Well / Surface Data Report Avg Depth to Water Report Water Column Report

Clear Form WATERS Menu Help

AVERAGE DEPTH OF WATER REPORT 09/20/2004

Bsn					Tw			Rng			Sec			Zone			X			Y			Wells			Min			Max			Avg			(Depth Water in Feet)																																																																																																																																																																																																																																																																																																																																																																																																																																																																																																																																																																																																																																																																																																																																																																																																																																																																																																																																																																																																																																																																																																																																																																																																																																																																																																																																																																																																																																																																																																																																																																																																																																																																																																

No Records found, try again

Application For Injection  
Devon Energy Prod Co LP  
North Pure Gold 9 Federal 17  
Form C-108 Section XIV

Proof of Notice to Leasehold Operators within 1/2 mile of North Pure Gold 9 Federal 17

Yates Petroleum Corporation  
105 South Fourth Street  
Artesia, NM 88210

A copy of this application has been mailed to the above leasehold operator pertaining to Devon Energy's application for salt water injection in the North Pure Gold 9 Federal 17.

Date Mailed: 9/22/04

Signature: Ronnie Slack

Date: 9/22/04

Ronnie Slack, Engineering Technician  
Devon Energy Production Co., L.P.  
20 N. Broadway, Suite 1500  
Oklahoma City, OK 73102

Application For Injection  
Devon Energy Prod Co LP  
North Pure Gold 9 Federal 17  
Form C-108 Section XIV

Proof of Notice to Surface Land Owner

J.C. & Francis Mills  
Family Partnership  
P.O. Box 190  
Abernathy, TX 79311

A copy of this application has been mailed to the above surface land owner by certified mail, pertaining to Devon Energy's application for salt water disposal in the North Pure Gold 9 Federal 17.

Date Mailed: 9/22/04

Signature: Ronnie Slack

Date: 9/22/04

Ronnie Slack, Engineering Technician  
Devon Energy Production Co., L.P.  
20 N. Broadway, Suite 1500  
Oklahoma City, OK 73102